

PLY GEM WINDOWS SERIES 1500 HORIZONTAL SLIDER WINDOW (IMPACT)

NOTES:

1. THE PRODUCT SHOWN HEREIN IS DESIGNED AND MANUFACTURED TO COMPLY WITH THE REQUIREMENTS OF THE 2018 INTERNATIONAL BUILDING CODE AND 2018 INTERNATIONAL RESIDENTIAL CODE.
2. THIS PRODUCT IS MISSILE LEVEL D, WIND ZONE 3 IMPACT RESISTANT. WHEN USED IN WIND ZONE 3 OR BELOW AREAS, THIS PRODUCT DOES NOT REQUIRE THE USE OF APPROVED IMPACT PROTECTIVE DEVICES (SHUTTERS).
3. ANCHOR TYPE, SIZE, SPACING, EMBEDMENT, AND EDGE DISTANCE SHALL BE AS SPECIFIED IN THESE DRAWINGS. USE APPROPRIATE ANCHORAGE FROM TABLE I ACCORDING TO SUBSTRATE TYPE. A MINIMUM CENTER-TO-CENTER SPACING OF 3" SHALL BE MAINTAINED BETWEEN ALL INSTALLATION FASTENERS IN ANY DIRECTION.
4. ANCHOR EMBEDMENT TO SUBSTRATE SHALL BE BEYOND WALL DRESSING OR STUCCO. FOR MASONRY OPENINGS WITH WOOD BUCKS LESS THAN 1-1/2" THICK, EMBEDMENT SHALL BE BEYOND WOOD BUCKS, IF USED, AND INTO MASONRY SUBSTRATE. WOOD BUCKS WITH MASONRY ARE OPTIONAL.
5. WOOD, METAL, OR MASONRY OPENINGS, BUCKS, AND BUCK FASTENERS, BY OTHERS, SHALL BE PROPERLY DESIGNED AND INSTALLED BY OTHERS TO TRANSFER SUPERIMPOSED LOADS TO THE STRUCTURE. ADEQUACY OF THE STRUCTURE TO RECEIVED THESE LOADS SHALL BE VERIFIED BY THE CONTRACTOR OR AUTHORITY HAVING JURISDICTION (AHJ).
6. IT IS THE RESPONSIBILITY OF THE ARCHITECT OR ENGINEER OF RECORD OR AS APPROVED BY THE AHJ TO SELECT PLY GEM PRODUCTS TO MEET ALL APPLICABLE LOCAL LAWS, BUILDING CODES, ORDINANCES, OR OTHER SAFETY REQUIREMENTS FOR EACH INSTALLATION.
7. SHIMS ARE REQUIRED WHERE GAPS OF GREATER THAN 1/16" EXIST BETWEEN OPENING AND FRAME. MAX. SHIM STACK IS 1/4". SHIMS SHALL BE LOAD-BEARING AND CAPABLE OF TRANSFERRING LOADS TO THE SUBSTRATE.
8. SEALING AND FLASHING STRATEGIES FOR OVERALL WATER INFILTRATION RESISTANCE OF THE INSTALLED PRODUCT SHALL BE THE RESPONSIBILITY OF OTHERS USING ASTM E 2112 AND IS NOT ADDRESSED BY THIS DOCUMENT.
9. INSTALLED GLAZING SHALL COMPLY WITH ASTM E 1300.
10. ALL FASTENERS PENETRATING INTO PRESSURE TREATED WOOD SHALL BE CAPABLE OF PREVENTING CORROSION DUE TO REACTION WITH PRESSURE TREATMENT CHEMICALS. ANY DISSIMILAR MATERIALS THAT COME INTO CONTACT SHALL BE PROTECTED TO PREVENT REACTIONS IN ACCORDANCE WITH CODE REQUIREMENTS.
11. A WIND LOAD DURATION FACTOR $C_d = 1.6$ WAS USED FOR THE ANALYSIS OF WOOD SCREWS ONLY.
12. PRODUCTS SHALL BE CONSTRUCTED AS SPECIFIED IN TEST REPORTS NATIONAL CERTIFIED TESTING LABORATORIES I10-I6008-I.
13. DESIGNATION "X" IS FOR OPERABLE PANEL AND "O" IS FOR FIXED PANEL.
14. USE 100% PURE SILICONE CAULK COMPLIANT WITH AAMA 800 SECTION I - SEALANT SPECIFICATIONS FOR USE WITH ARCHITECTURAL FENESTRATION PRODUCTS.
15. USE A BACKER ROD ON ALL JOINTS >3/4" DEEP AND/OR WIDER THAN 1/4". FINISHED CAULK JOINT SHOULD BE A MINIMUM OF 3/8" DEEP.

SIZE CHART					
OVERALL SIZE		PRODUCT RATING	MAX. DESIGN PRESSURE	CONFIGURATION	MISSILE IMPACT RATING
WIDTH	HEIGHT				
62-15/16"	48-1/16"	HS-LC50	+50/-60 PSF	XO <u>OR</u> OX	LARGE & SMALL MISSILE IMPACT

TABLE OF CONTENTS	
SHEET	SHEET DESCRIPTION
1	INSTALLATION & GENERAL NOTES
2	ELEVATIONS & ANCHOR SCHEDULE
3	CROSS SECTIONS
4	SECTIONS & GLAZING DETAILS

TABLE I: INSTALLATION FASTENERS TABLE

ID	SUBSTRATE TYPE	ANCHOR TYPE	MIN. EMBED.	MIN. EDGE DISTANCE
FIN INSTALLATION				
A	2X MIN. SPRUCE-PINE-FIR WOOD (G=0.42)	#8 WOOD SCREW	1-1/2"	7/16"
B	16 GAUGE (0.060") STEEL 36 KSI MIN. OR 1/8" ALUM. 6063-T5 MIN.	#10-16 SELF-DRILLING SCREW (TEKS/DRIL-FLEX/KWIK-FLEX)	FULL, PLUS 3 THREADS MIN.	7/16"
FRAME OR CLIP INSTALLATION				
C	CONCRETE (2 KSI MIN.)	3/16" ITW TAPCON	1-1/2"	1-1/8"
D	HOLLOW OR GROUT-FILLED CMU (I17 PCF MIN.)	3/16" ITW TAPCON	1"	2"
E	2X MIN. SOUTHERN PINE WOOD (G=0.55)	3/16" ITW TAPCON	1-3/8"	7/8"
F	2X MIN. SOUTHERN PINE WOOD (G=0.55)	#10 WOOD SCREW	1-3/8"	7/8"
G	16 GAUGE (0.060") STEEL 36 KSI MIN. OR 1/8" ALUM. 6063-T5 MIN.	#10-16 SELF-DRILLING SCREW (TEKS/DRIL-FLEX/KWIK-FLEX)	FULL, PLUS 3 THREADS MIN.	1/2"

NOTE: ALL SCREWS AND TAPCONS SHALL HAVE MOD. TRUSS, PAN, OR HEX WASHER HEAD, 0.42" MIN. HEAD OR WASHER DIAMETER FOR FIN ANCHORS, 0.355" MIN. HEAD OR WASHER DIAMETER FOR FRAME ANCHORS.

TITLE: SERIES 1500 HORIZONTAL SLIDER WINDOW INSTALLATION AND GENERAL NOTES	DATE	BY	DATE
	06.17.13	LMH	12.10.17
	DWN BY:	LMH	07.10.18
	ADS	LMH	07.31.20
	NO.	REVISION DESCRIPTION	
	B	ADDED NOTES & TABLE I	
	C	UPDATED PER EC 07-008 & N18-001, W-1867	
	D	CODE UPDATE	
	CHK BY:		
	SCALE:		
	NTS		



7/30/2020
LUCAS A. TURNER, P.E.
TXPE # 115094
TURNER ENGINEERING &
CONSULTING, INC.
(TBPE REG. # F-18075)
2428 OLD NATCHEZ TRACE
TRAIL, CAMDEN, TN 38320
PH. 941-380-1574

DWG #:
PGW20ITX
SHEET: **1-TX** OF 4

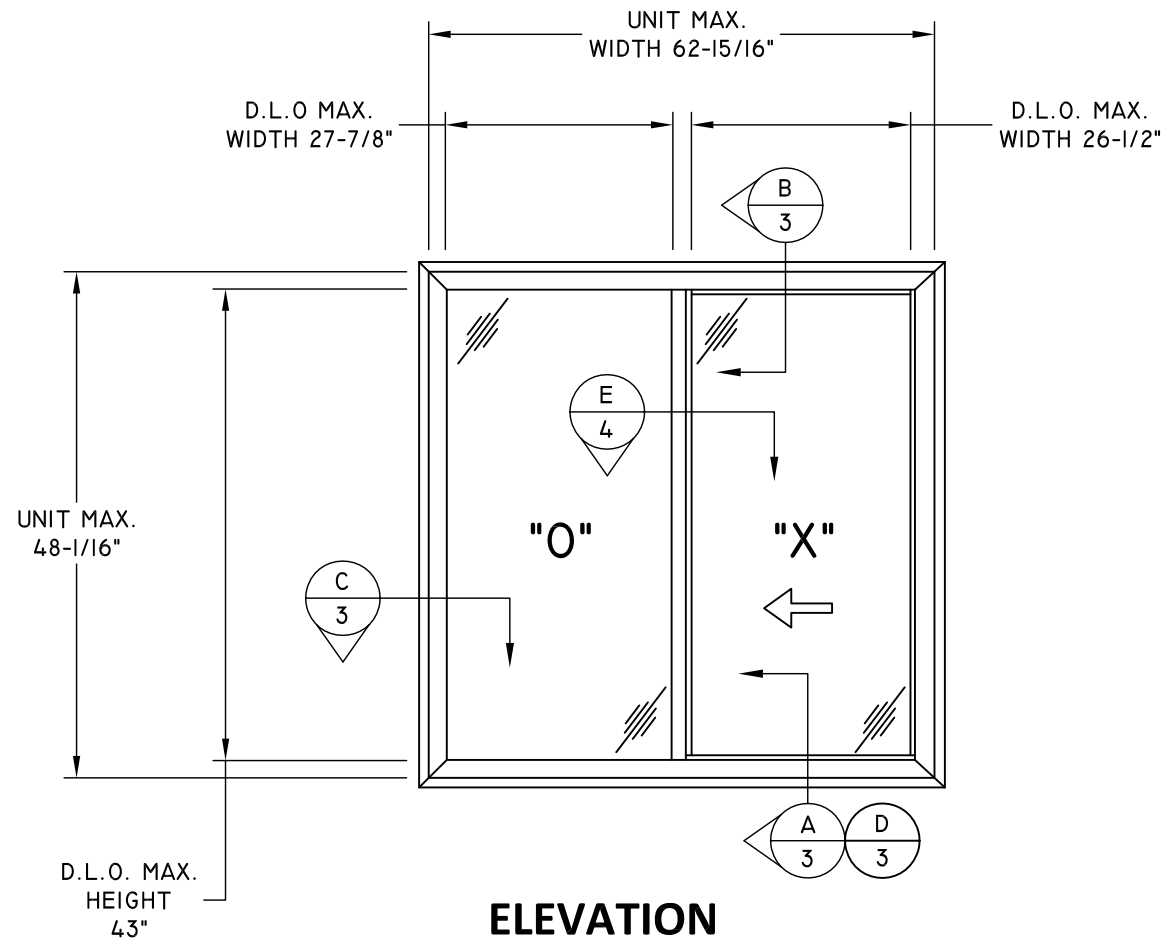

ELEVATION

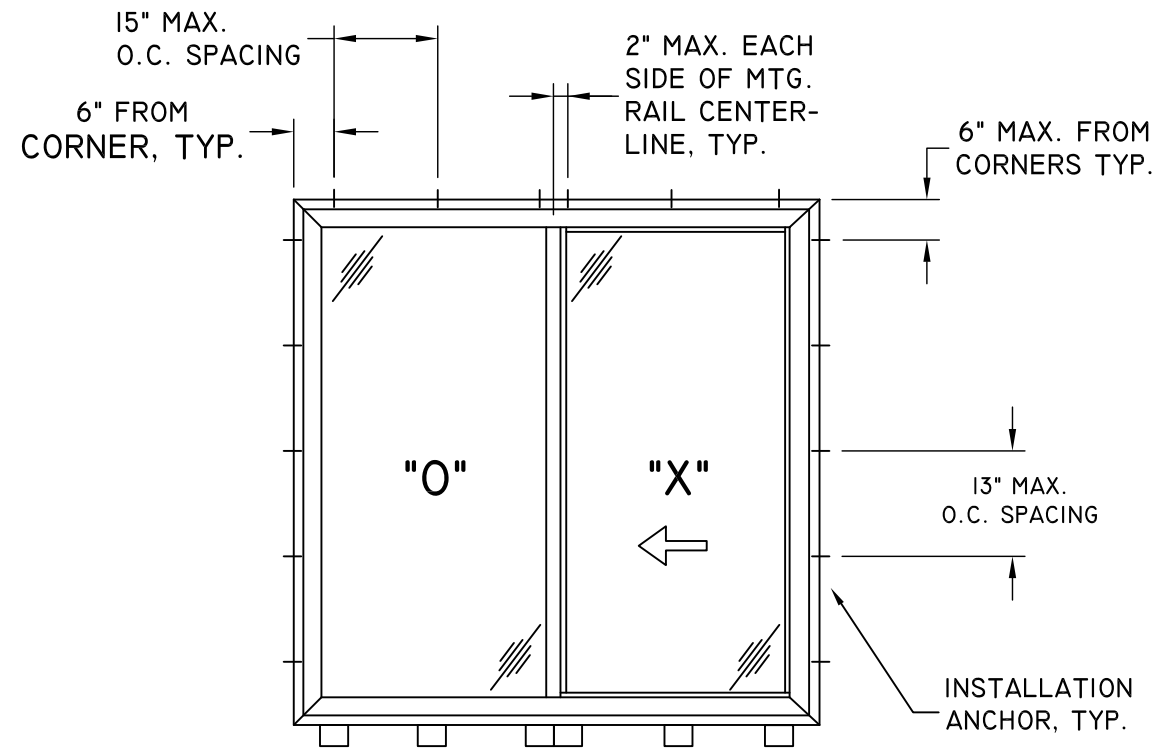

NOTE: USE ANCHOR CLIPS AT THE SILL FOR UNITS USING FRAME INSTALLATION METHOD, AT SAME SPACING AS ANCHORS AT HEAD

ANCHOR LAYOUT

FRAME INSTALLATION

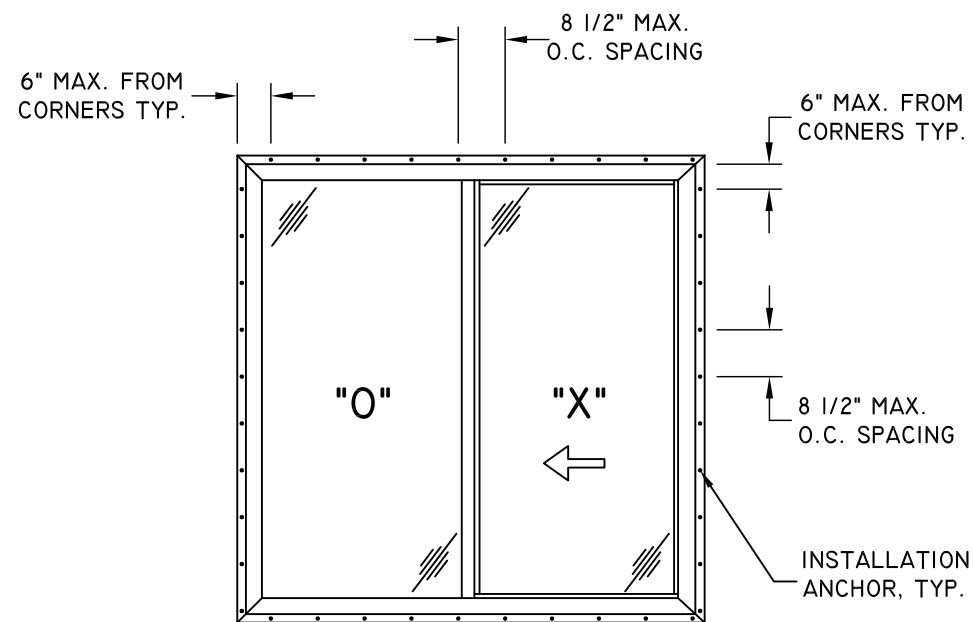

ANCHOR LAYOUT

FIN INSTALLATION

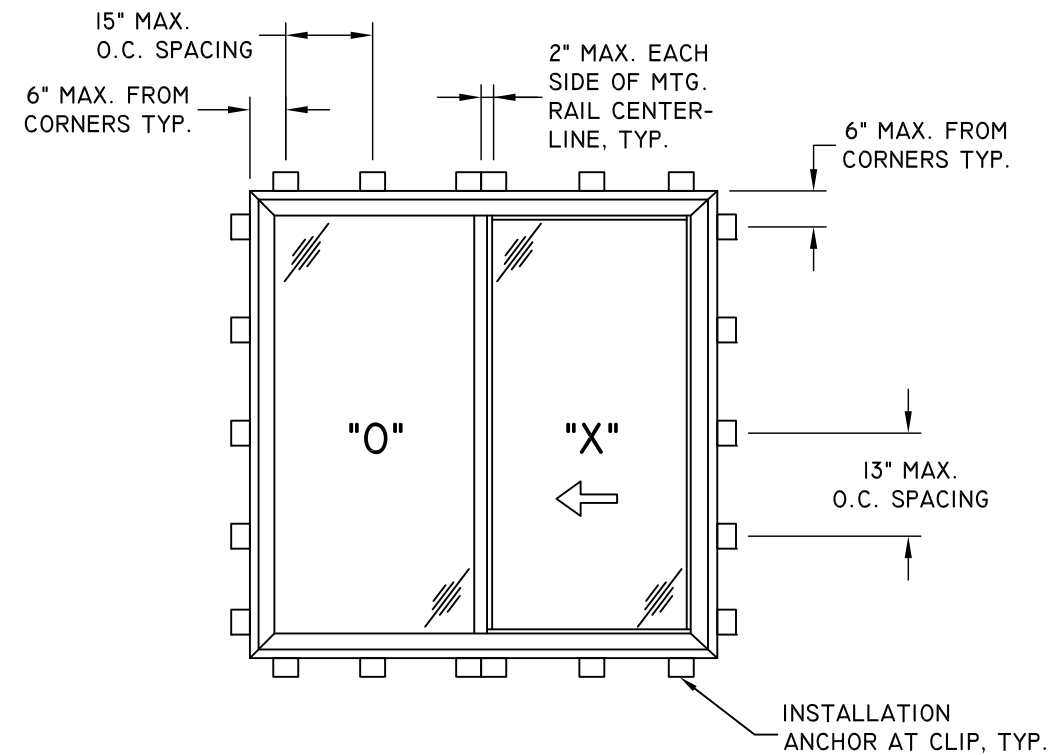

ANCHOR LAYOUT

CLIP INSTALLATION

TITLE: SERIES 1500 HORIZONTAL SLIDER WINDOW ELEVATIONS & ANCHOR SCHEDULE		NO.	REVISION DESCRIPTION	BY	DATE
B	ADDED NOTES & TABLE 1			LMH	12.10.17
C	UPDATED PER EC 07-008 & N18-001, W-1867			LMH	07.10.18
D	CODE UPDATE			LMH	07.31.20

DATE:	06.17.13	DWN BY:	ADS	CHK BY:		SCALE:	NTS
-------	----------	---------	-----	---------	--	--------	-----



7/30/2020
LUCAS A. TURNER, P.E.
TX PE # 115094
TURNER ENGINEERING & CONSULTING, INC.
(TBPE REG. # F-18075)
2428 OLD NATCHEZ TRACE TRAIL, CAMDEN, TN 38320
PH. 941-380-1574

DWG #: **PGW20ITX**

SHEET: **2** OF **4**

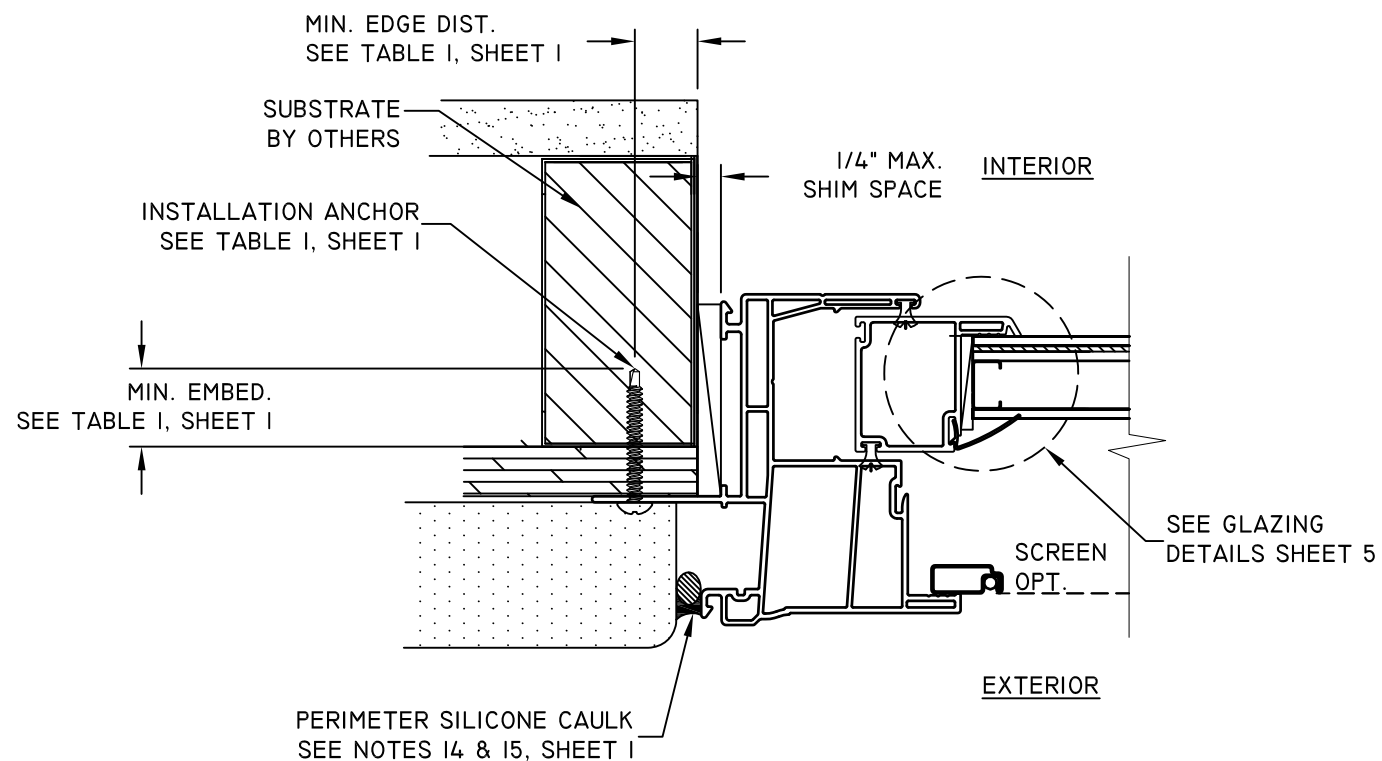

HORIZONTAL SECTION

JAMB
BRICKMOULD FRAME - FIN INSTALLATION

C
3

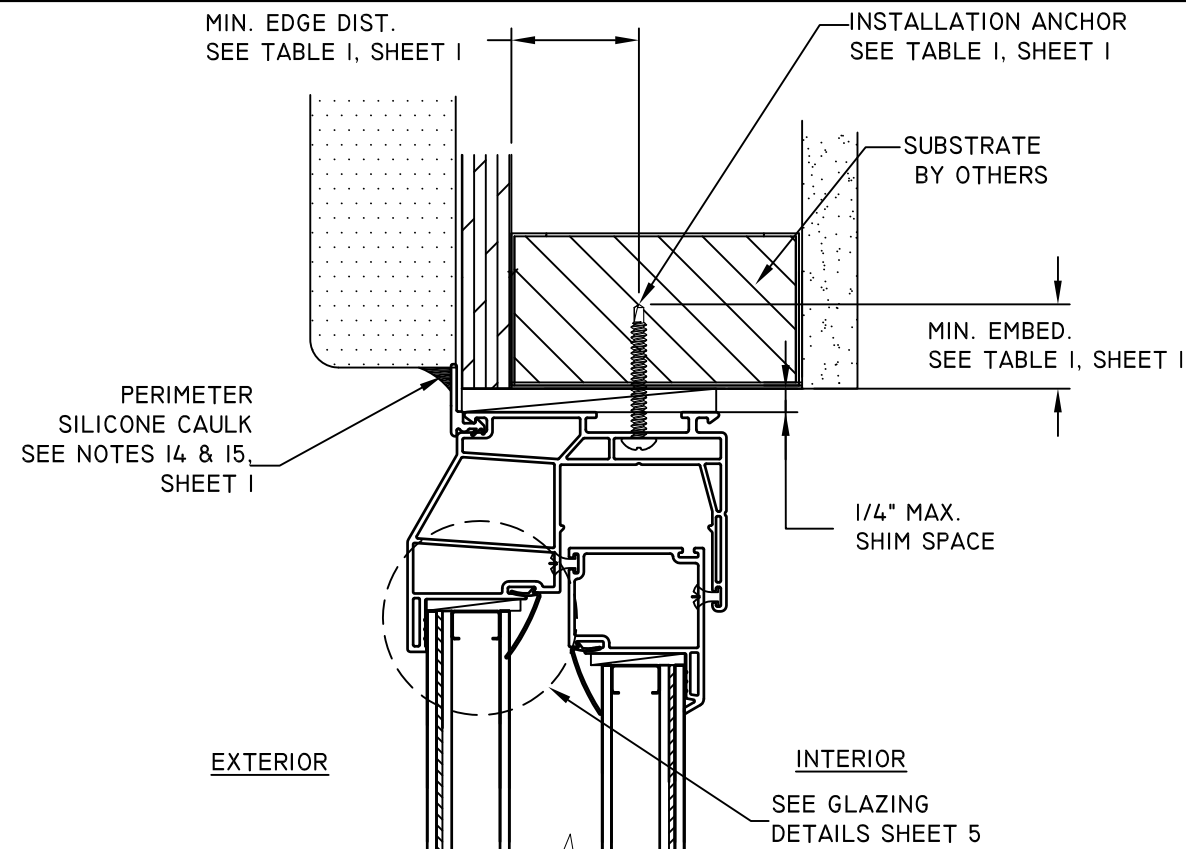

VERTICAL SECTION

HEAD
BEVELED FRAME - FRAME INSTALLATION

B
3

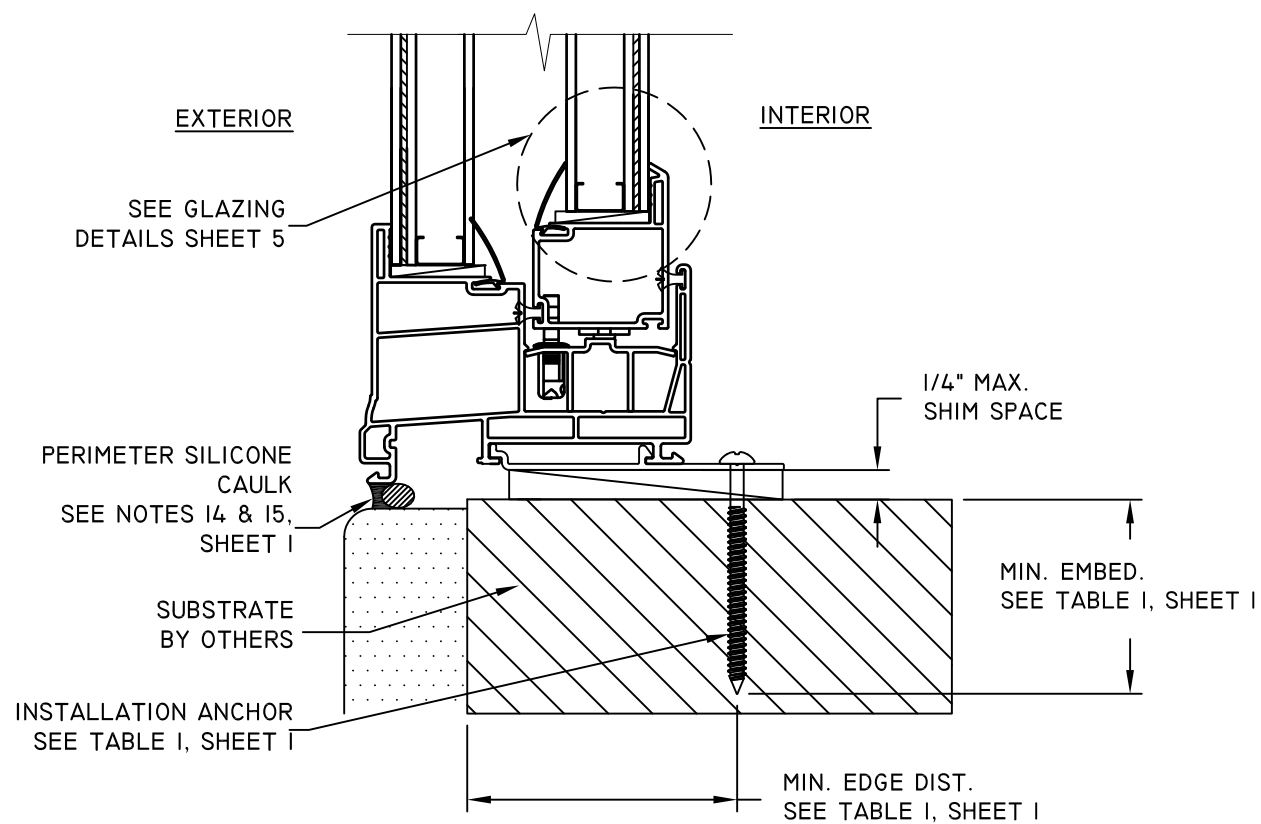

VERTICAL SECTION

SILL
BRICKMOULD FRAME - CLIP INSTALLATION

A
3

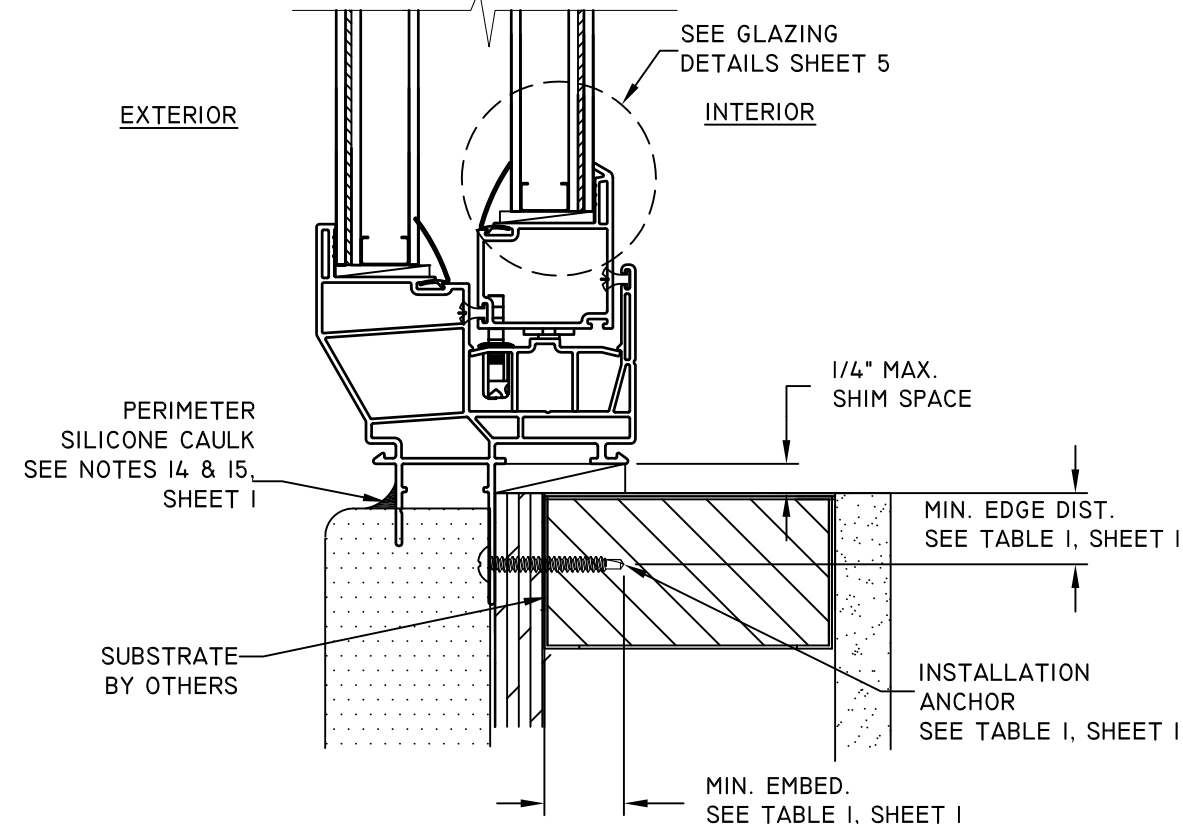

VERTICAL SECTION

SILL
BEVELED FRAME - FIN INSTALLATION

D
3

TITLE: SERIES 1500 HORIZONTAL SLIDER WINDOW CROSS SECTIONS		NO.	REVISION DESCRIPTION	BY	DATE
B	ADDED NOTES & TABLE I			LMH	12.10.17
C	UPDATED PER EC 07-008 & N18-001, W-1867			LMH	07.10.18
D	CODE UPDATE			LMH	07.31.20

DATE:	06.17.13
DWN BY:	ADS
CHK BY:	
SCALE:	NTS



7/30/2020
LUCAS A. TURNER, P.E.
TX PE # 115094
TURNER ENGINEERING &
CONSULTING, INC.
(TBPE REG. # F-18075)
2428 OLD NATCHEZ TRACE
TRAIL, CAMDEN, TN 38320
PH. 941-380-1574

DWG #:
PGW20ITX
SHEET: **3** OF **4**

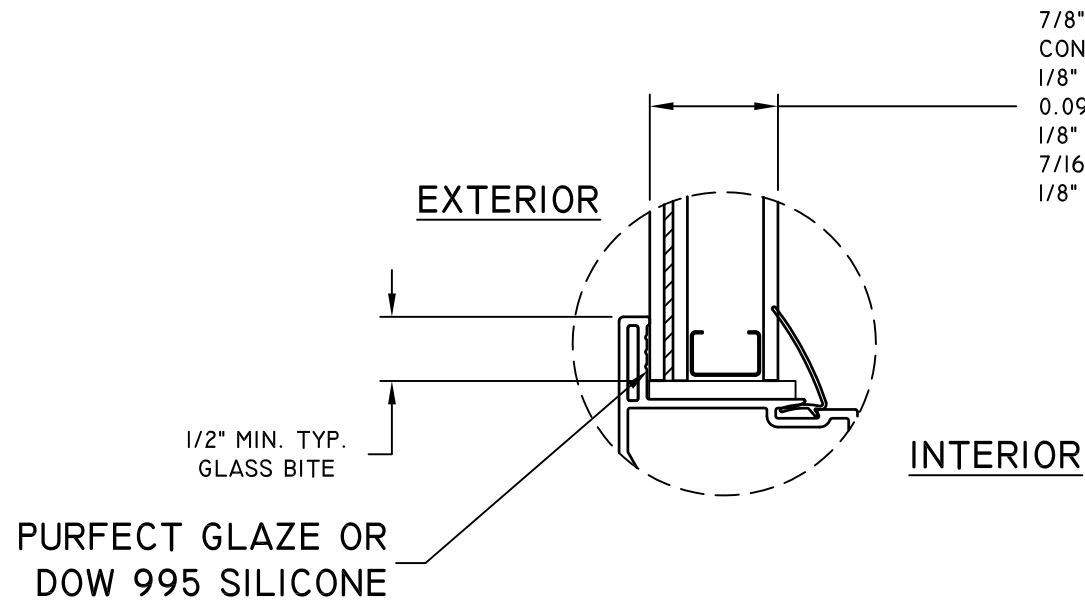

GLAZING DETAIL 1

FIXED LITE

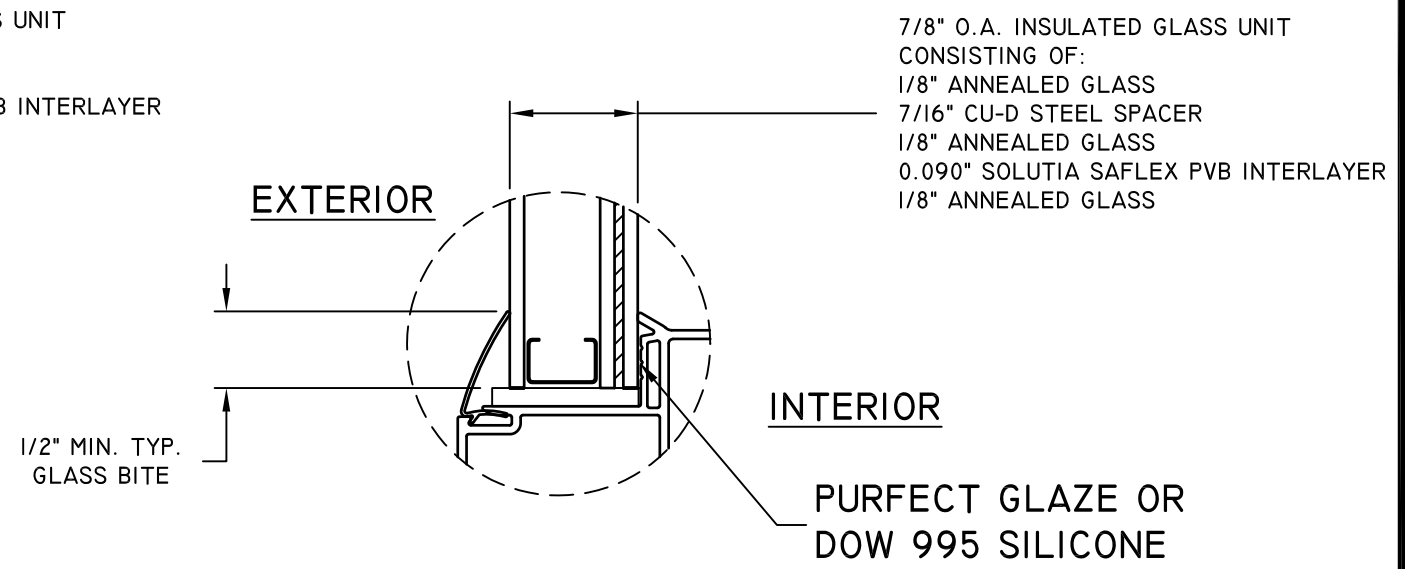

GLAZING DETAIL 2

SASH LITE

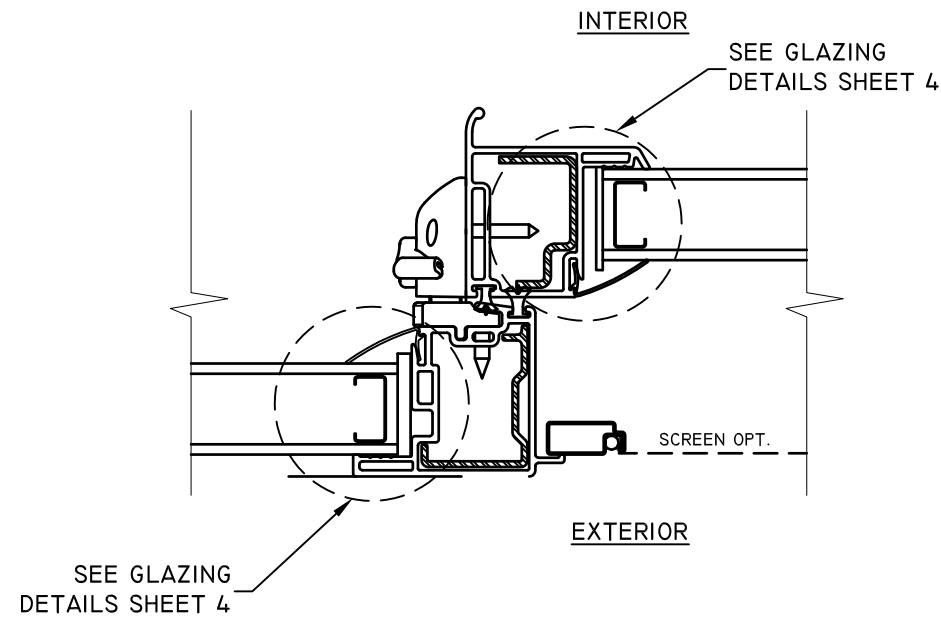

E
4

HORIZONTAL SECTION

MEETING STILE
TYPICAL

TITLE: SERIES 1500 HORIZONTAL SLIDER WINDOW SECTION & GLAZING DETAILS	NO.	REVISION DESCRIPTION	BY	DATE		
	B	ADDED NOTES & TABLE 1	LMH	12.10.17		
	C	UPDATED PER EC 07-008 & N18-001, W-1867	LMH	07.10.18		
	D	CODE UPDATE	LMH	07.31.20		
DATE:	06.17.13	DWN BY:	ADS	CHK BY:	SCALE:	NTS



7/30/2020
LUCAS A. TURNER, P.E.
TX PE # 115094
TURNER ENGINEERING &
CONSULTING, INC.
(TBPE REG. # F-18075)
2428 OLD NATCHEZ TRACE
TRAIL, CAMDEN, TN 38320
PH. 941-380-1574

DWG #:
PGW20ITX

SHEET: **4** OF **4**