

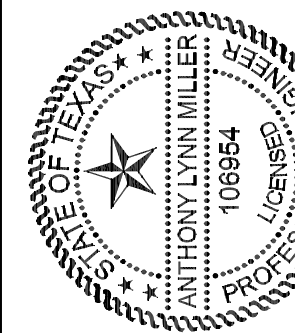

**MODEL 9550 (OX/XO) &  
MODEL 9550-3 (XOX)  
HORIZONTAL ROLLER WINDOW,  
LM/SM IMPACT RESISTANT,  
FLANGE, EQUAL-LEG & FIN FRAMES**

DP RATING	LARGE & SMALL MISSILE IMPACT RESISTANT
SEE TABLES 1 & 2	



*A. Lynn Miller* 01/05/22  
A. LYNN MILLER, P.E., P.E.# 106954

1) THIS PRODUCT HAS BEEN DESIGNED & TESTED TO COMPLY WITH THE REQUIREMENTS OF THE 2018 INTERNATIONAL BUILDING CODE (IBC) AND THE 2018 INTERNATIONAL RESIDENTIAL CODE (IRC) FOR THE DESIGN PRESSURES LISTED.

2) SHUTTERS ARE NOT REQUIRED WHEN USED IN WIND-BORNE DEBRIS REGIONS.

3) MASONRY ANCHORS MAY BE USED INTO WOOD. ALL WOOD BUCKS LESS THAN 1-1/2" THICK ARE TO BE CONSIDERED 1X INSTALLATIONS. 1X WOOD BUCKS ARE OPTIONAL IF UNIT IS INSTALLED DIRECTLY TO SUBSTRATE. WOOD BUCKS DEPICTED AS 2X ARE 1-1/2" THICK OR GREATER.

4) ANCHOR EMBEDMENT TO BASE MATERIAL SHALL BE BEYOND WALL DRESSING OR STUCCO. USE ANCHORS OF SUFFICIENT LENGTH.

5) MAX. 1/4" SHIMS ARE REQUIRED AT EACH ANCHOR LOCATION WHERE THE PRODUCT IS NOT FLUSH TO THE SUBSTRATE. USE SHIMS CAPABLE OF TRANSFERRING APPLIED LOADS.

6) THE ANCHORAGE METHODS SHOWN HAVE BEEN DESIGNED TO RESIST THE WIND LOADS CORRESPONDING TO THE REQUIRED DESIGN PRESSURE. THE 33-1/3% STRESS INCREASE HAS NOT BEEN USED IN THE DESIGN OF THIS PRODUCT. THE 1.6 LOAD DURATION FACTOR WAS USED FOR THE EVALUATION OF ANCHORS INTO WOOD. ANCHORS THAT COME INTO CONTACT WITH OTHER DISSIMILAR MATERIALS SHALL MEET THE REQUIREMENTS OF THE BUILDING CODE FOR CORROSION RESISTANCE.

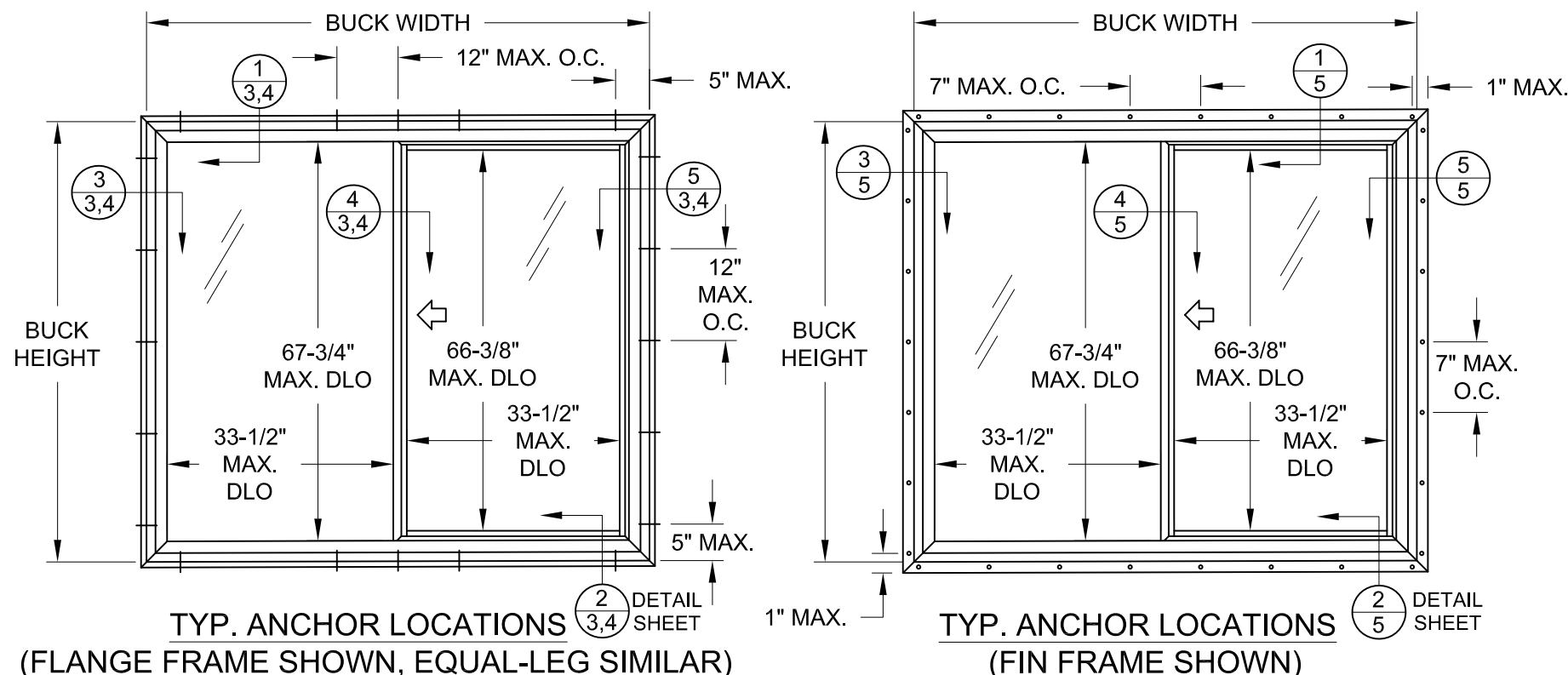

TABLE 1: DESIGN PRESSURES

Buck Width	Buck Height	Configuration	Impact Level	Frame Type	Glass Types	Certification	Design Pressure	
							(+) psf	(-) psf
74"	63"	XO/OX	LM/SM	All	1 or 2	NI011844, NI011844.01, NI0111904	50.0	60.0
74"	72"	XO/OX	LM/SM	Flange, Equal-Leg	1 or 2	NI0113761	45.0	50.0

1) FOR SIZES NOT SHOWN, ROUND UP TO THE NEXT AVAILABLE WIDTH OR HEIGHT DIMENSION.  
2) FOR GLASS TYPES, SEE SHEET 7.

FIRM REG. NO.: F-23136  
COPYRIGHT © 2022  
NEWSOUTH WINDOW SOLUTIONS  
LIMITED LICENSE TO MAKE  
COPIES FOR PERMITTING

PREPARED BY: A. LYNN MILLER, P.E.  
1070 TECHNOLOGY DR  
N. VENICE, FL 34275  
(941)-480-1600

9000 SERIES HORIZ. ROLLER MODELS 9550 & 9550-3, LM	BY:	
GENERAL NOTES, XO DESIGN PRESSURES & ANCHOR ELEVATION	REVISION:	
NEWSOUTH WINDOW SOLUTIONS 10741 CROSSROADS COMMERCE BLVD. TAMPA, FL 33610	DATE:	
	#:	
	DATE:	11/11/21
	SCALE:	NTS
	BY:	JENS ROSOWSKI
	DRAWING #:	HR9550-TDI-01
	SHEET:	1 OF 7

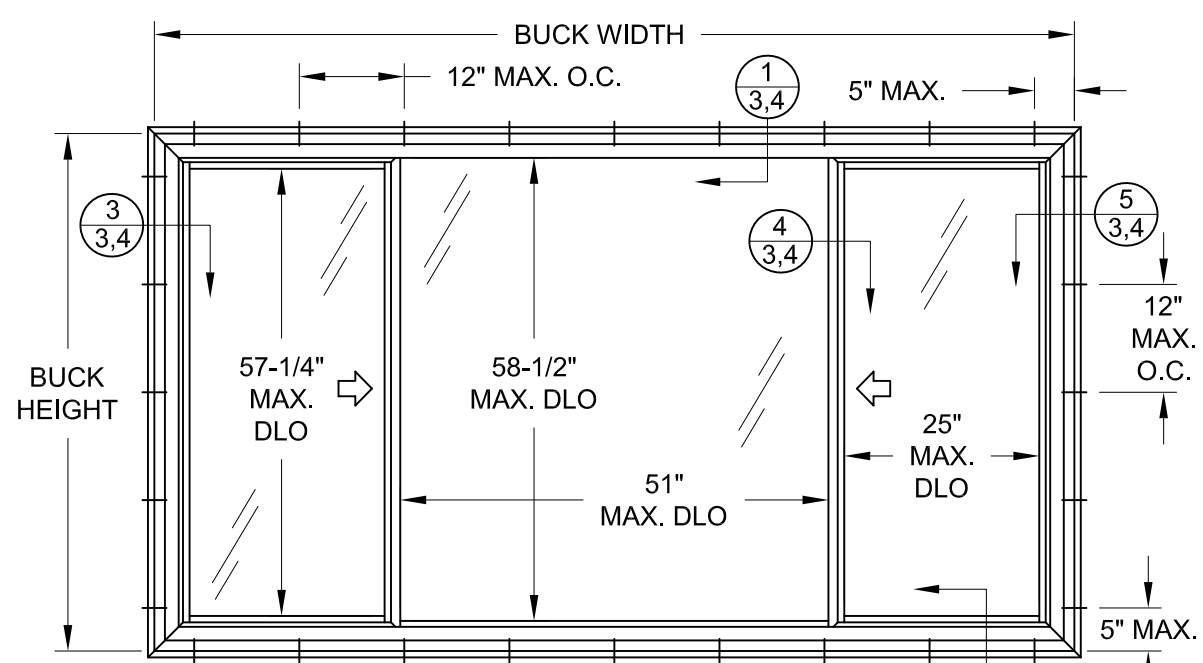

TYP. ANCHOR LOCATIONS  
(FLANGE FRAME SHOWN, EQUAL-LEG SIMILAR)  
(1/4 - 1/2 - 1/4 CONFIGURATION SHOWN)

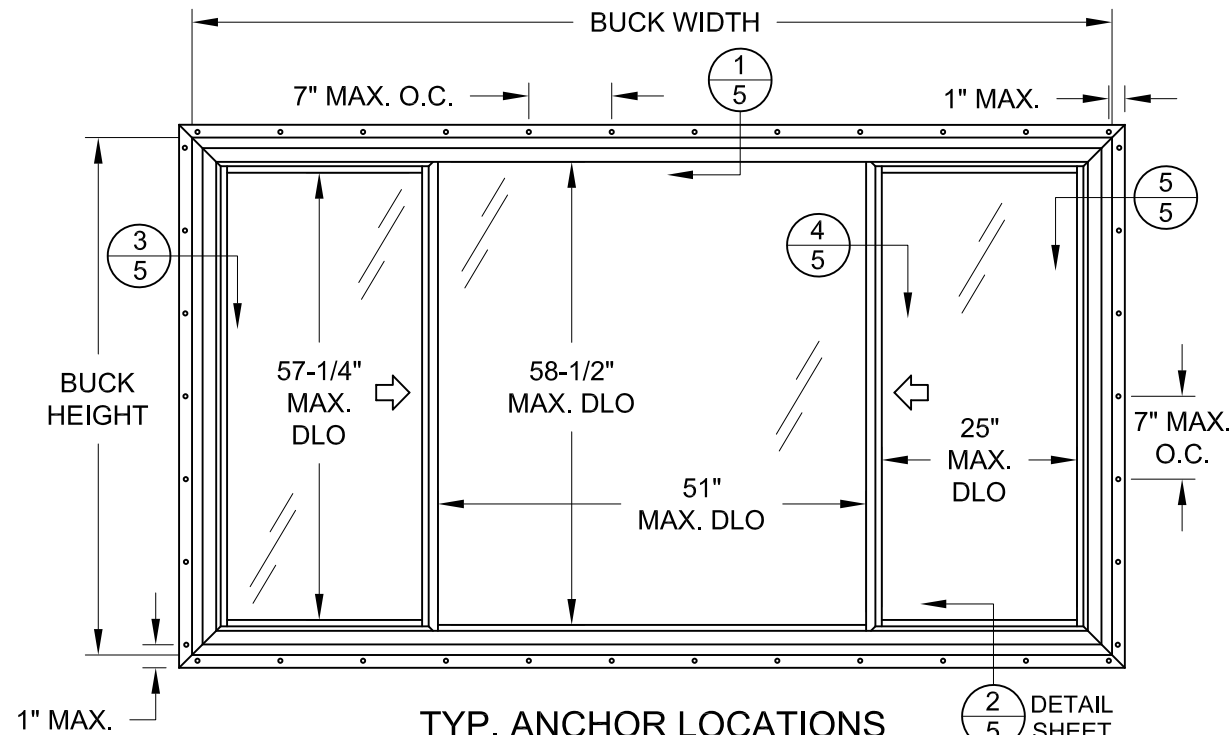

TYP. ANCHOR LOCATIONS  
(FIN FRAME SHOWN)  
(1/4 - 1/2 - 1/4 CONFIGURATION SHOWN)

TABLE 2: XOX DESIGN PRESSURES

Buck Width	Buck Height	Configuration	Impact Level	Frame Type	Glass Types	Certification	Design Pressure	
							(+) psf	(-) psf
82-7/8"	63"	1/3 - 1/3 - 1/3 XOX	LM/SM	Fin	1, 2, 3 or 4 (operable) 3 or 4 (fixed lite)	NI012055 & NI011846	45.0	45.0
82-7/8"	63"	1/3 - 1/3 - 1/3 XOX	LM/SM	Flange & Equal-Leg	1, 2, 3 or 4 (operable) 3 or 4 (fixed lite)	NI012055 & NI015371	50.0	50.0
111"	63"	1/4 - 1/2 - 1/4 XOX	LM/SM	Fin	1, 2, 3 or 4 (operable) 3 or 4 (fixed lite)	NI012055 & NI011846	45.0	45.0
111"	63"	1/4 - 1/2 - 1/4 XOX	LM/SM	Flange & Equal-Leg	1, 2, 3 or 4 (operable) 4 (fixed lite)	NI012055 & NI015371	50.0	50.0
111"	63"	1/4 - 1/2 - 1/4 XOX	LM/SM	Flange & Equal-Leg	1, 2, 3 or 4 (operable) 3 (fixed lite)	NI012055 & NI015371	See Table 2A	

1) FOR SIZES NOT SHOWN, ROUND UP TO THE NEXT AVAILABLE WIDTH OR HEIGHT DIMENSION.  
2) FOR GLASS DESCRIPTIONS, SEE SHEET 7.

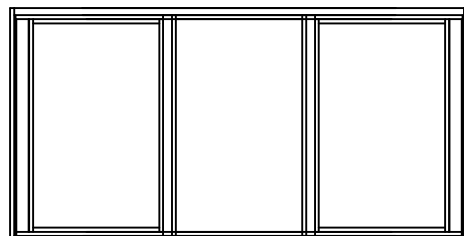

WINDOW MAY BE A 1/4 - 1/2 - 1/4 CONFIGURATION (AS SHOWN ABOVE) OR 1/3 - 1/3 - 1/3 CONFIGURATION (AS SHOWN TO THE LEFT) PROVIDED DLO (DAYLITE OPENING) SIZES ARE NOT EXCEEDED.

TABLE 2A:

Design Pressure	XOX 1/4 - 1/2 - 1/4 using Glass Type 3 at Fixed Lite for Flange & Equal-Leg Frame Types					
	Width					
	72"	84"	96"	108"	111"	
54"	+50/-50	+50/-50	+50/-50	+50/-50	+50/-50	
60"	+50/-50	+50/-50	+50/-50	+50/-50	+50/-50	
63"	+50/-50	+50/-50	+50/-50	+50/-50	N/A	

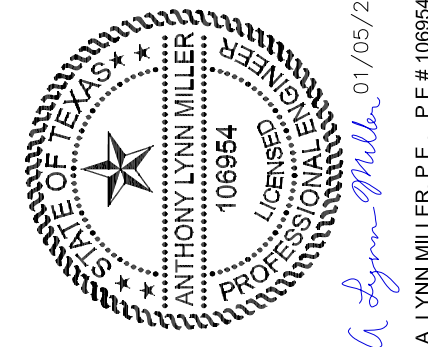

FIRM REG. NO.: F-23136

COPYRIGHT © 2022  
NEWSOUTH WINDOW SOLUTIONS  
LIMITED LICENSE TO MAKE  
COPIES FOR PERMITTING

PREPARED BY: A. LYNN MILLER, P.E.  
1070 TECHNOLOGY DR  
N. VENICE, FL 34275  
(941)-480-1600

9000 SERIES HORIZ. ROLLER  
MODELS 9550 & 9550-3, LM

GENERAL NOTES, XOX DESIGN  
PRESSURES & ANCHOR ELEVATION

NEWSOUTH WINDOW SOLUTIONS  
10741 CROSSROADS COMMERCE BLVD.  
TAMPA, FL 33610

REVISION:

DATE:

#:

DATE: 11/11/21

SCALE: NTS

BY: JENS ROSOWSKI

DRAWING # :  
HR9550-TDI-01

SHEET: 2 OF 7

1 HEAD FLANGE FRAME X-SECTION INTO 2X WOOD OR MASONRY

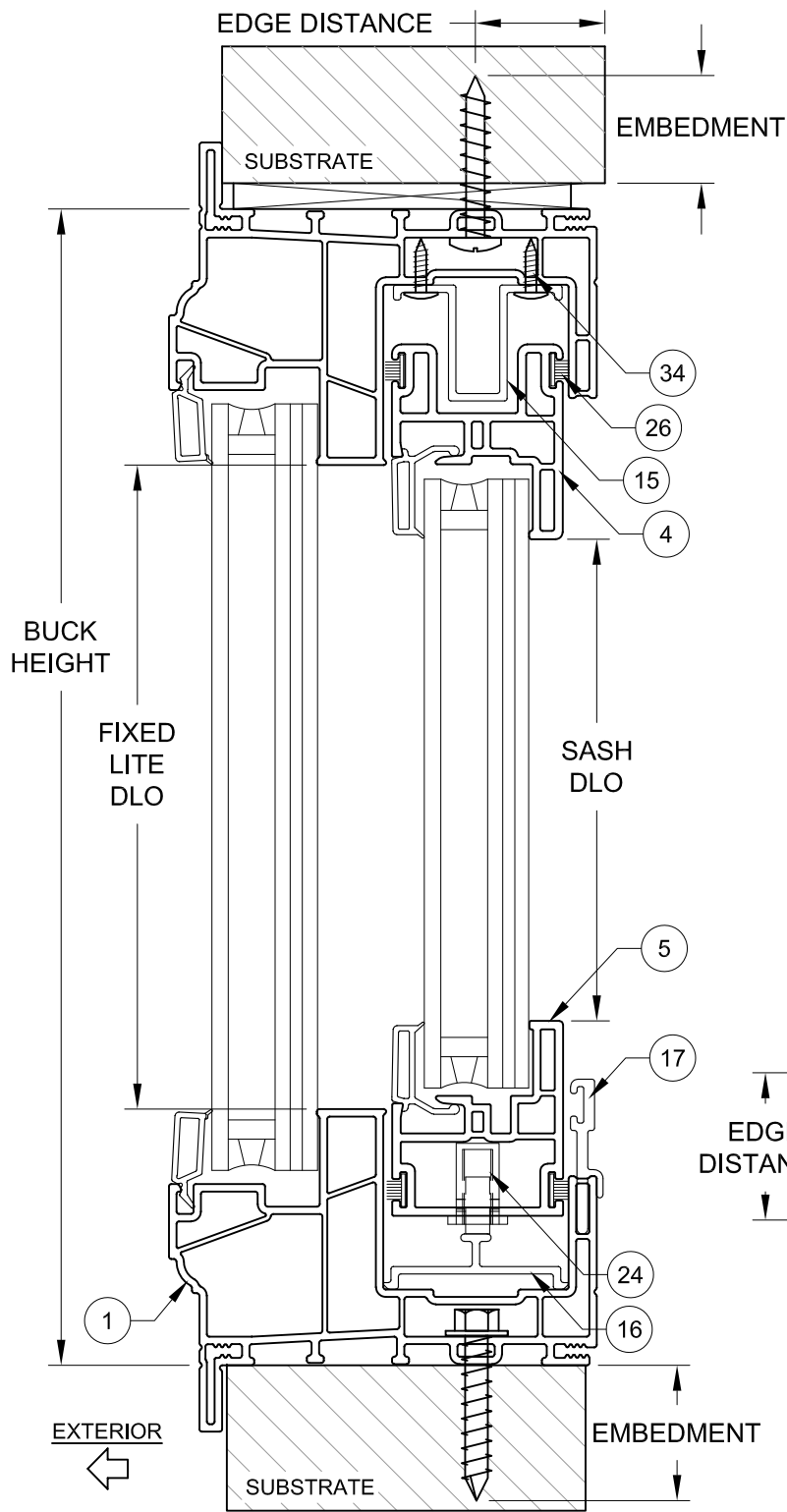

2 SILL FLANGE FRAME X-SECTION INTO 2X WOOD OR MASONRY

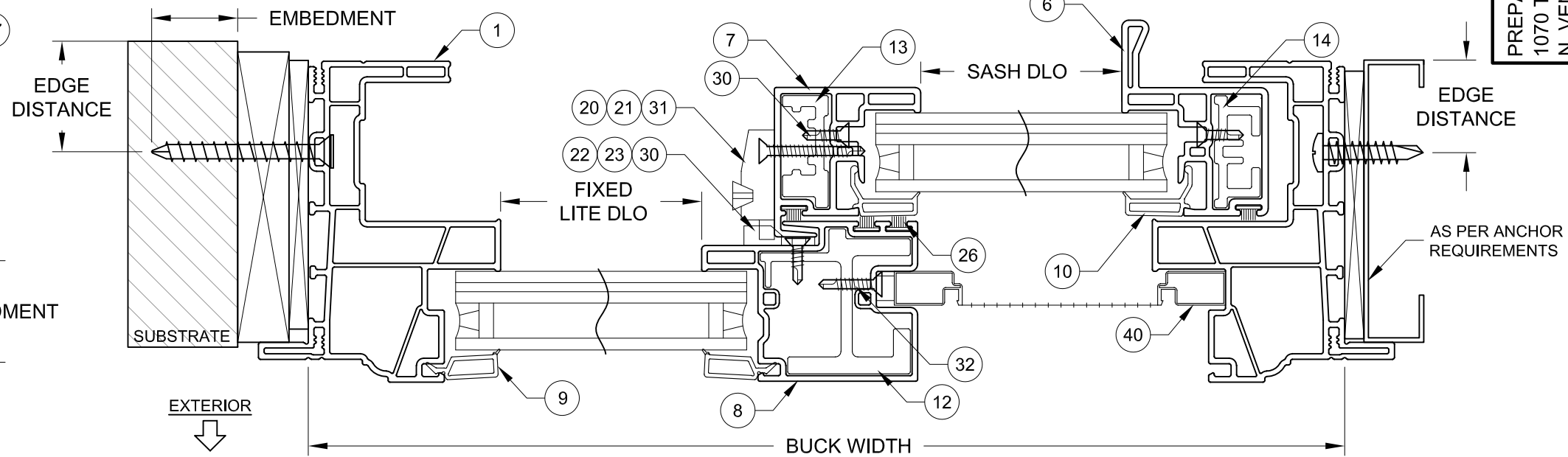

3 JAMB FLANGE FRAME X-SECTION THRU 1X INTO 2X WOOD OR MASONRY

4 MEETING RAIL X-SECTION SHOWN FOR OX CONFIGURATION (XOX SIMILAR)

5 JAMB FLANGE FRAME X-SECTION USING SCREWS INTO METAL

TABLE 3: INSTALLATION ANCHORS

Anchor	Substrate	Minimum Edge Distance	Minimum Embedment
#10 or #12 Steel or 410 SS Screw	Southern Pine (SG = .55)	9/16"	1-3/8"
	Aluminum, 6063-T5 min.	3/8"	0.050"
	Steel Stud, Gr. 33 min.	3/8"	0.045" (20 Ga)
	A36 Steel	3/8"	0.050"
3/16" Steel Ultracon	Concrete (min. 2.9 ksi)	1"	1-3/8"
	Grouted CMU, (ASTM C-90)	2-1/2"	2-1/4"
	Southern Pine (SG = .55)	1"	1-3/8"
3/16" Steel Ultracon+	Concrete (min. 2.9 ksi)	1"	1-3/4"
	UngROUTED CMU, (ASTM C-90)	1"	1-1/4"
	Southern Pine (SG = .55)	1"	1-3/8"
1/4" Steel Ultracon or Ultracon+	Concrete (min. 3.0 ksi)	1"	1-3/8"
	UngROUTED CMU, (ASTM C-90)	1"	1-1/4"
	Southern Pine (SG = .55)	1"	1-3/8"

- 1) ANCHOR MUST EXTEND A MINIMUM OF 3 THREADS BEYOND ANY METAL SUBSTRATE.
- 2) "UNGROUTED CMU" VALUES MAY BE USED FOR GROUTED CMU APPLICATIONS.
- 3) ALL ANCHOR HEAD TYPES ARE APPLICABLE.

INSTALLATION NOTES:

1) CONCRETE ANCHOR LOCATIONS AT THE CORNERS MAY BE LOWERED TO MAINTAIN THE MINIMUM EDGE DISTANCE TO MORTAR JOINTS. SEE SHEET 1 FOR ANCHOR SPACING REQUIREMENTS.

2) CONCRETE ANCHOR LOCATIONS NOTED AS "MAX. ON CENTER" MUST BE ADJUSTED TO MAINTAIN THE MINIMUM EDGE DISTANCE TO MORTAR JOINTS. ADDITIONAL CONCRETE ANCHORS MAY BE REQUIRED TO ENSURE THE "MAX. ON CENTER" DIMENSION IS NOT EXCEEDED.

3) ANY INSTALLATION OPTION SHOWN (2X BUCK, 1X BUCK, DIRECT TO MASONRY, STEEL STUD) MAY BE USED ON ANY SIDE OF THE WINDOW.

4) USE ONLY SUBSTRATE APPROPRIATE ANCHORS LISTED IN ANCHOR TABLE. FOLLOW EMBEDMENT AND EDGE DISTANCE LIMITS. MAX. SHIM THICKNESS TO BE 1/4". ANY INSTALLATION OPTION SHOWN MAY BE USED ON ANY OR ALL SIDES OF THE WINDOW.



A. Lynn Miller 01/05/22  
A. LYNN MILLER, P.E., P.E.# 106954

FIRM REG. NO.: F-23136

COPYRIGHT © 2022  
NEWSOUTH WINDOW SOLUTIONS  
LIMITED LICENSE TO MAKE  
COPIES FOR PERMITTING

PREPARED BY: A. LYNN MILLER, P.E.  
1070 TECHNOLOGY DR  
N. VENICE, FL 34275  
(941)-480-1600

9000 SERIES HORIZ. ROLLER  
MODELS 9550 & 9550-3, LM  
FLANGE INSTALLATION & ANCHOR TYPES  
NEWSOUTH WINDOW SOLUTIONS  
10741 CROSSROADS COMMERCE BLVD.  
TAMPA, FL 33610

BY:	
REVISION:	
DATE:	
#:	
DATE:	11/11/21
SCALE:	NTS
BY:	JENS ROSOWSKI
DRAWING #:	HR9550-TDI-01
SHEET:	3 OF 7



1 HEAD EQUAL-LEG FRAME X-SECTION INTO 2X WOOD OR MASONRY

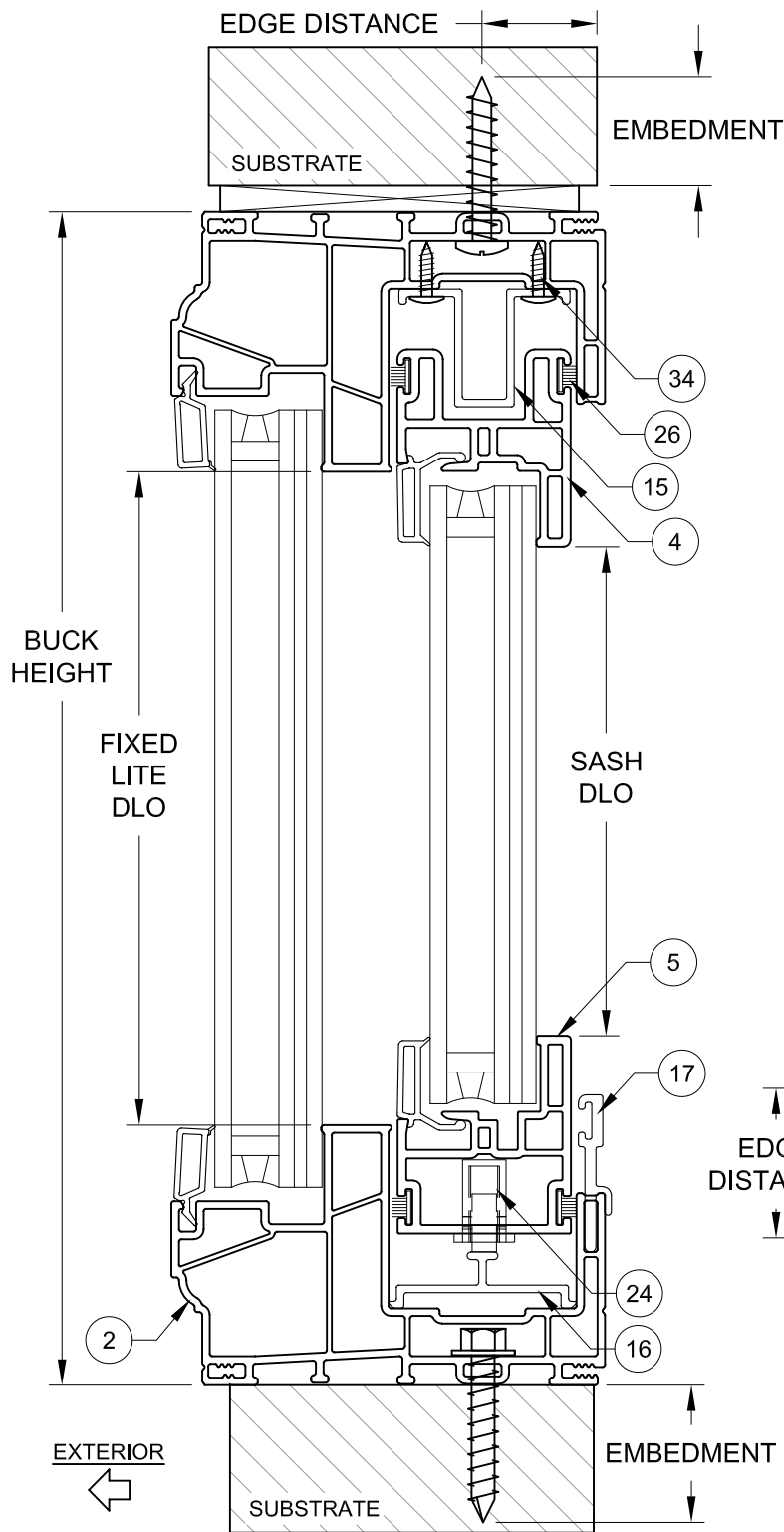

2 SILL EQUAL-LEG FRAME X-SECTION INTO 2X WOOD OR MASONRY

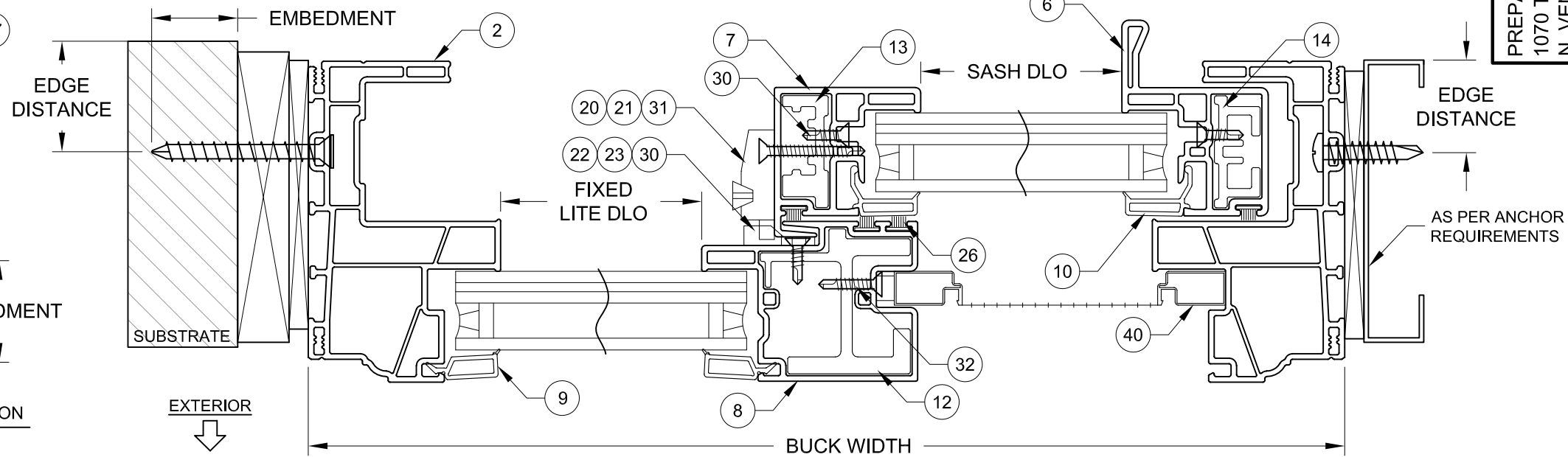

3 JAMB EQUAL-LEG FRAME X-SECTION THRU 1X INTO 2X WOOD OR MASONRY

4 MEETING RAIL X-SECTION SHOWN FOR OX CONFIGURATION (XOX SIMILAR)

5 JAMB EQUAL-LEG FRAME X-SECTION USING SCREWS INTO METAL

TABLE 4: INSTALLATION ANCHORS

Anchor	Substrate	Minimum Edge Distance	Minimum Embedment
#10 or #12 Steel or 410 SS Screw	Southern Pine (SG = .55)	9/16"	1-3/8"
	Aluminum, 6063-T5 min.	3/8"	0.050"
	Steel Stud, Gr. 33 min.	3/8"	0.045" (20 Ga)
	A36 Steel	3/8"	0.050"
3/16" Steel Ultracon	Concrete (min. 2.9 ksi)	1"	1-3/8"
	Grouted CMU, (ASTM C-90)	2-1/2"	2-1/4"
	Southern Pine (SG = .55)	1"	1-3/8"
3/16" Steel Ultracon+	Concrete (min. 2.9 ksi)	1"	1-3/4"
	UngROUTED CMU, (ASTM C-90)	1"	1-1/4"
	Southern Pine (SG = .55)	1"	1-3/8"
1/4" Steel Ultracon or Ultracon+	Concrete (min. 3.0 ksi)	1"	1-3/8"
	UngROUTED CMU, (ASTM C-90)	1"	1-1/4"
	Southern Pine (SG = .55)	1"	1-3/8"

- 1) ANCHOR MUST EXTEND A MINIMUM OF 3 THREADS BEYOND ANY METAL SUBSTRATE.
- 2) "UNGROUTED CMU" VALUES MAY BE USED FOR GROUTED CMU APPLICATIONS.
- 3) ALL ANCHOR HEAD TYPES ARE APPLICABLE.

INSTALLATION NOTES:

1) CONCRETE ANCHOR LOCATIONS AT THE CORNERS MAY BE LOWERED TO MAINTAIN THE MINIMUM EDGE DISTANCE TO MORTAR JOINTS. SEE SHEET 1 FOR ANCHOR SPACING REQUIREMENTS.

2) CONCRETE ANCHOR LOCATIONS NOTED AS "MAX. ON CENTER" MUST BE ADJUSTED TO MAINTAIN THE MINIMUM EDGE DISTANCE TO MORTAR JOINTS. ADDITIONAL CONCRETE ANCHORS MAY BE REQUIRED TO ENSURE THE "MAX. ON CENTER" DIMENSION IS NOT EXCEEDED.

3) ANY INSTALLATION OPTION SHOWN (2X BUCK, 1X BUCK, DIRECT TO MASONRY, STEEL STUD) MAY BE USED ON ANY SIDE OF THE WINDOW.

4) USE ONLY SUBSTRATE APPROPRIATE ANCHORS LISTED IN ANCHOR TABLE. FOLLOW EMBEDMENT AND EDGE DISTANCE LIMITS. MAX. SHIM THICKNESS TO BE 1/4". ANY INSTALLATION OPTION SHOWN MAY BE USED ON ANY OR ALL SIDES OF THE WINDOW.



FIRM REG. NO.: F-23136

COPYRIGHT © 2022  
NEWSOUTH WINDOW SOLUTIONS  
LIMITED LICENSE TO MAKE  
COPIES FOR PERMITTING

PREPARED BY: A. LYNN MILLER, P.E.  
1070 TECHNOLOGY DR  
N. VENICE, FL 34275  
(941)-480-1600

9000 SERIES HORIZ. ROLLER  
MODELS 9550 & 9550-3, LM

EQUAL-LEG INSTALLATION &  
ANCHOR TYPES

NEWSOUTH WINDOW SOLUTIONS  
10741 CROSSROADS COMMERCE BLVD.  
TAMPA, FL 33610

BY:	
REVISION:	
DATE:	
#:	
DATE:	11/11/21
SCALE:	NTS
BY:	JENS ROSOWSKI
DRAWING #:	HR9550-TDI-01
SHEET:	4 OF 7

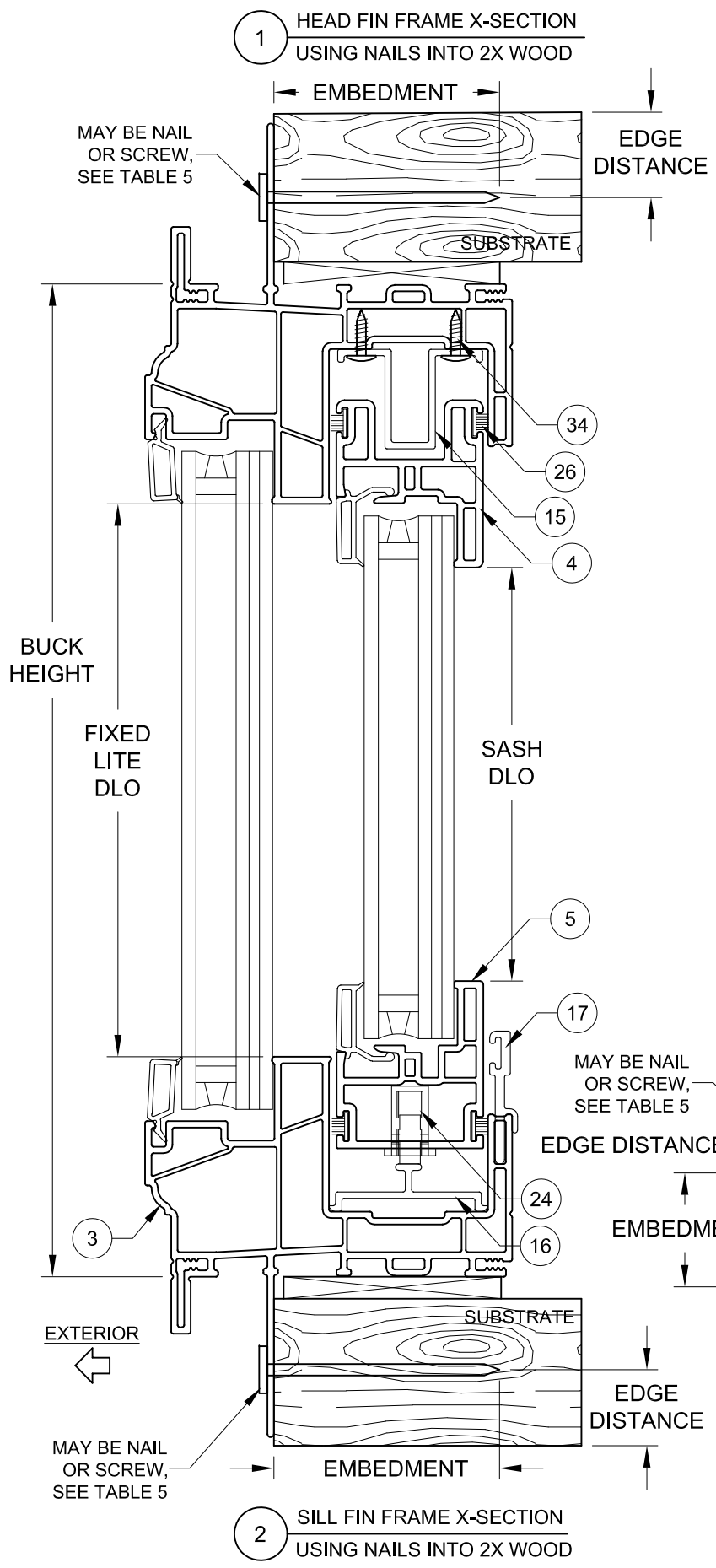

TABLE 5: INSTALLATION ANCHORS

Anchor	Substrate	Min. Edge Distance	Min. Embedment
2-1/2" x .113" Box Nail	P.T. Southern Pine (SG = .55)	5/16"	2-7/16"
2-1/2" x .131" Common Nail	P.T. Southern Pine (SG = .55)	3/8"	2-7/16"
2-1/2" x .145" Roofing Nail	P.T. Southern Pine (SG = .55)	3/8"	2-7/16"
#10 Steel SMS	P.T. Southern Pine (SG = .55)	1/2"	1-3/8"
	Aluminum, 6063-T5 min.	3/8"	1/8"
	Steel Stud, Gr. 33 min.	3/8"	0.036
	A36 Steel	3/8"	1/8"

1) ANCHOR MUST EXTEND A MINIMUM OF 3 THREADS BEYOND ANY METAL SUBSTRATE.  
 2) ALL ANCHOR HEAD TYPES ARE APPLICABLE.

INSTALLATION NOTES:

- 1) SEE SHEET 1 FOR SPACING REQUIREMENTS.
- 2) GLASS SHOWN IS FOR ILLUSTRATIVE PURPOSES ONLY AND MAY DIFFER TO MEET DESIGN REQUIREMENTS.
- 3) FLANGE MAY BE REMOVED.
- 4) USE ONLY SUBSTRATE APPROPRIATE ANCHORS LISTED IN ANCHOR TABLE. FOLLOW EMBEDMENT AND EDGE DISTANCE LIMITS. ANY INSTALLATION OPTION SHOWN MAY BE USED ON ANY OR ALL SIDES OF THE WINDOW.
- 5) MAX. SHIM THICKNESS TO BE 1/4". MAX. SHIM SPACING TO BE 18".

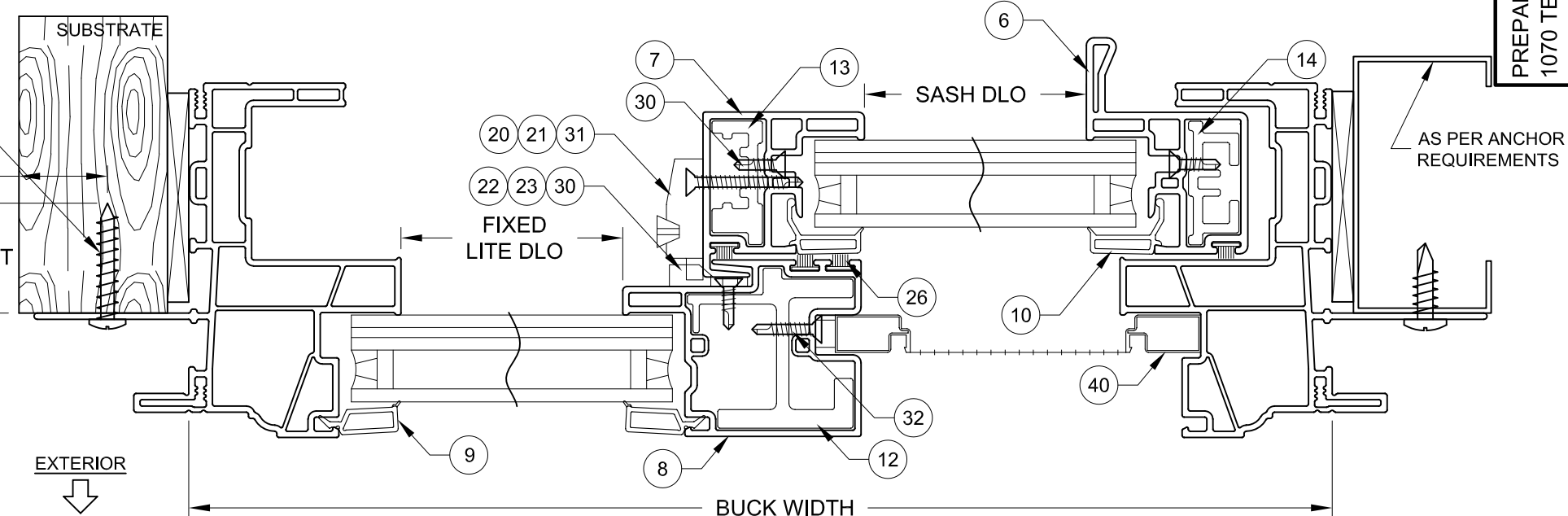

FIRM REG. NO.: F-23136  
 COPYRIGHT © 2022  
 NEWSOUTH WINDOW SOLUTIONS  
 LIMITED LICENSE TO MAKE  
 COPIES FOR PERMITTING

PREPARED BY: A. LYNN MILLER, P.E.  
 1070 TECHNOLOGY DR  
 N. VENICE, FL 34275  
 (941)-480-1600

9000 SERIES HORIZ. ROLLER  
 MODELS 9550 & 9550-3, LM  
 FIN INSTALLATION & ANCHOR TYPES  
 NEWSOUTH WINDOW SOLUTIONS  
 10741 CROSSROADS COMMERCE BLVD.  
 TAMPA, FL 33610

BY:	
REVISION:	
DATE:	
#:	
DATE:	11/11/21
SCALE:	NTS
BY:	JENS ROSOWSKI
DRAWING #:	HR9550-TDI-01
SHEET:	5 OF 7

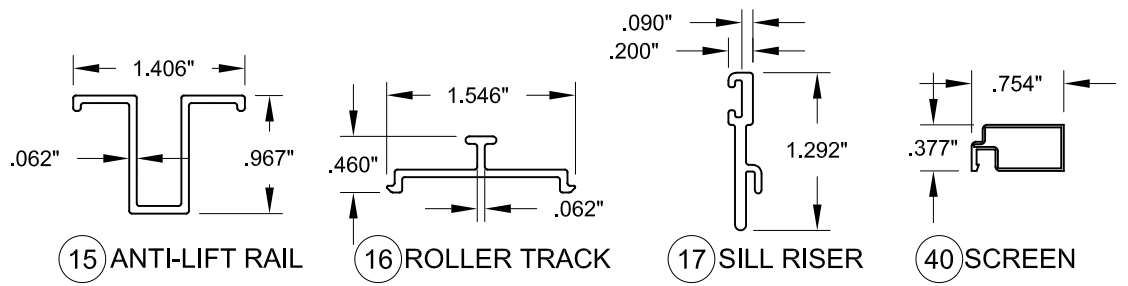
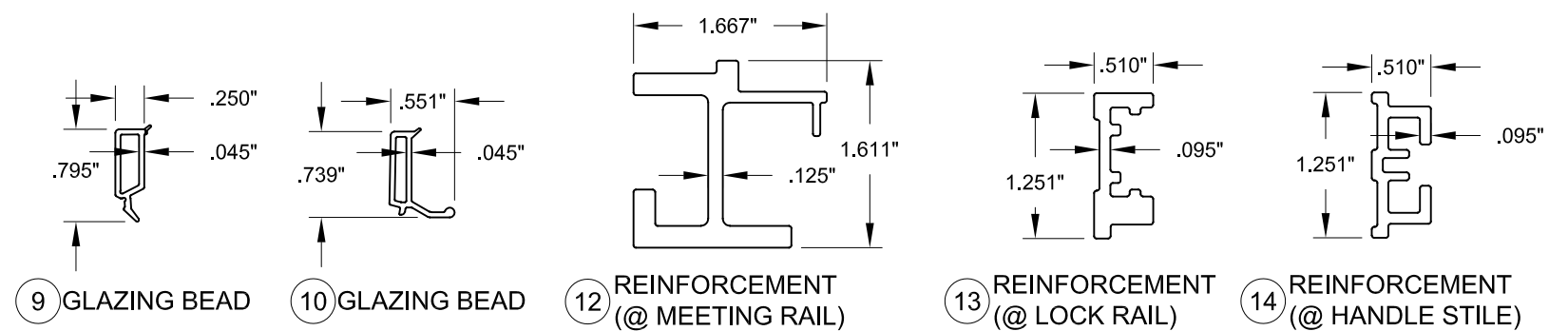
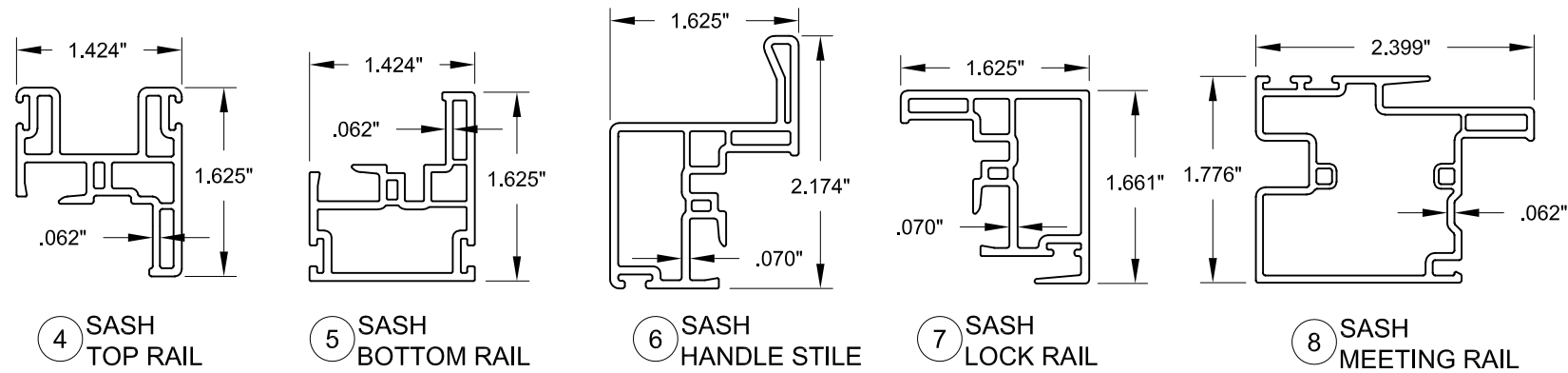
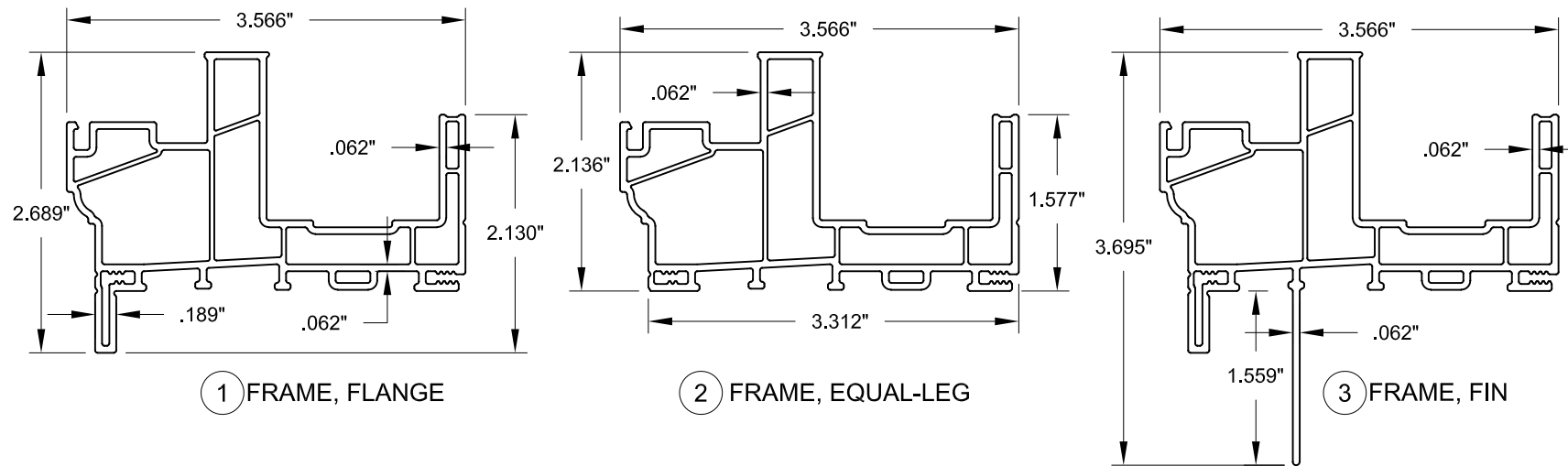

TABLE 6:

BILL OF MATERIALS			
ITEM #	PART #	DESCRIPTION	MATERIAL
1		Frame, Flange	PVC
2	9439	Frame, Equal-Leg	PVC
3		Frame, Fin	PVC
4	9478	Sash Top Rail	PVC
5	9424	Sash Bottom Rail	PVC
6	9475	Sash Handle Stile	PVC
7	9476	Sash Lock Rail	PVC
8	9477	Sash Meeting Rail	PVC
9	9436	Glazing Bead	PVC
10	9425	Glazing Bead	PVC
12	6165	Reinforcement @ Meeting Rail	6063-T6
13	6163	Reinforcement @ Lock Rail	6063-T6
14	6166	Reinforcement @ Handle Stile	6063-T6
15	6162	Anti-Lift Rail	6063-T6
16	6161	Roller Track	6063-T6
17	6158	Sill Riser	6063-T6
20	8097	Cam Lock	
21	8097	Autolock	
22	8302	Cam Lock Keeper	Zinc
23	8100	Autolock Keeper	Zinc
24	8153	Roller Assm.	
25	8223	Weep Cover	Composite
26	4007	Weatherstrip, .270" x .250" Polyfin	
30	1003	Screw, #6 x 1/2" PFH	Steel
31	1007	Screw, #6 x 1-1/4" PFH	Steel
32	1012	Screw, #6 x 3/4" PFH	Steel
33	1015	Screw, #8 x 1/2" PTRUSS	Steel
34	1067	Screw, #6 x 3/8" PPH	Steel
35		Sika 552, Dow 791/983/995 Backbedding	
36		IG Spacer	varies
37		Setting Block	varies
40	6244	Screen	Nylon

THE APPROVED WHITE, RIGID PVC EXTERIOR EXTRUSIONS FOR DOORS ARE TO BE PRODUCED BY EXTRUDERS' LICENSEES UNDER "AAMA CERTIFICATION PROGRAMS FOR RIGID PVC EXTRUSIONS".



FIRM REG. NO.: F-23136  
 COPYRIGHT © 2022  
 NEWSOUTH WINDOW SOLUTIONS  
 LIMITED LICENSE TO MAKE  
 COPIES FOR PERMITTING

PREPARED BY: A. LYNN MILLER, P.E.  
 1070 TECHNOLOGY DR  
 N. VENICE, FL 34275  
 (941)-480-1600

9000 SERIES HORIZ. ROLLER  
 MODELS 9550 & 9550-3, LM  
 EXTRUSIONS & BOM  
 NEWSOUTH WINDOW SOLUTIONS  
 10741 CROSSROADS COMMERCE BLVD.  
 TAMPA, FL 33610

REVISION:	BY:			
DATE:				
#:				
DATE: 11/11/21				
SCALE: NTS				
BY: JENS ROSOWSKI				
DRAWING #: HR9550-TDI-01				
SHEET: 6 OF 7				



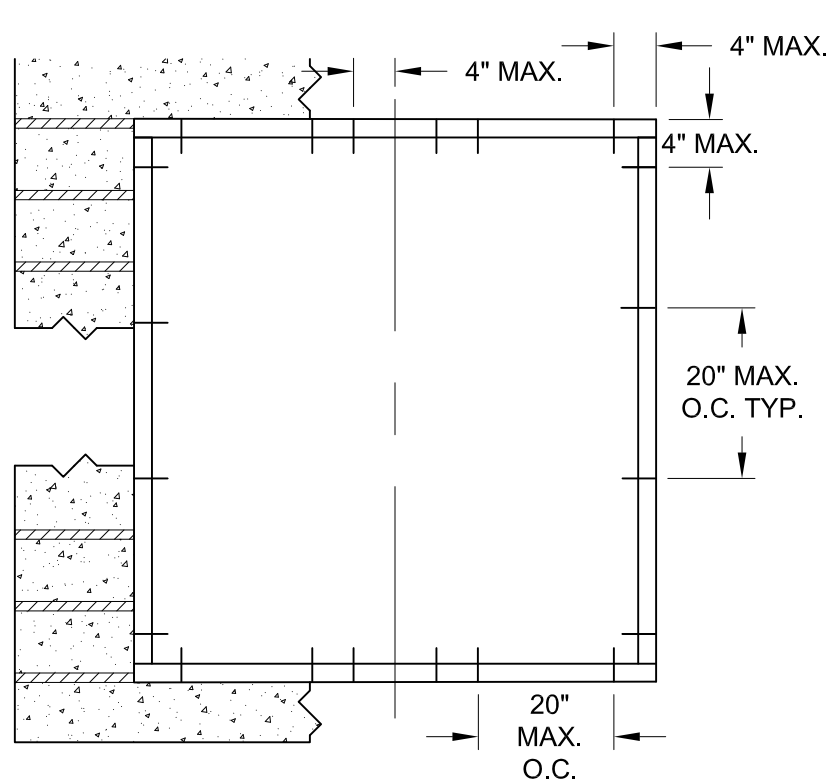

**XO/OX BUCK ANCHORAGE DETAIL**

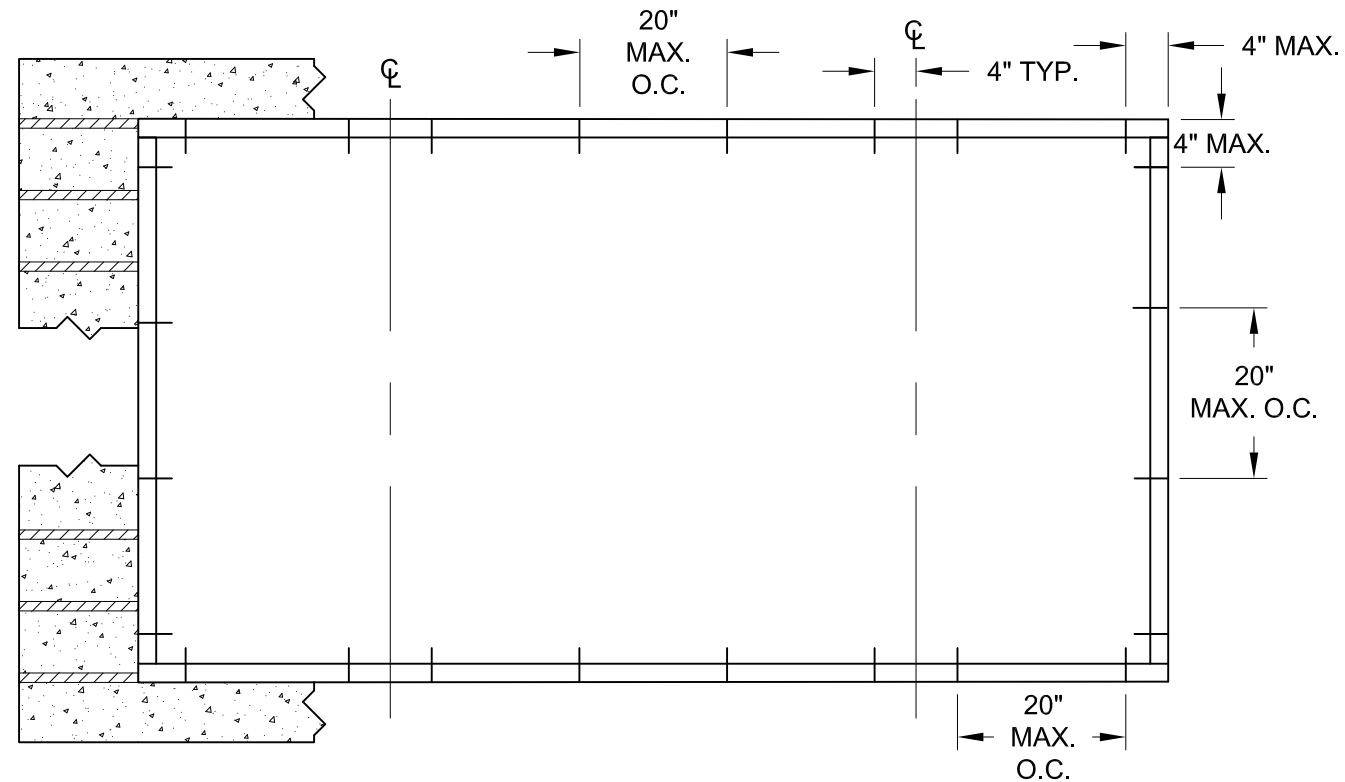

**XOX BUCK ANCHORAGE DETAIL**

**TABLE 7:**

Anchor	Substrate	Minimum Edge Distance	Minimum Embedment
1/4" Steel Ultracon or Ultracon+	Concrete (min. 3.0 ksi)	1"	1-3/8"
	UngROUTED CMU, (ASTM C-90)	1"	1-1/4"

- "UNGROUTED CMU" VALUES MAY BE USED FOR GROUTED CMU APPLICATIONS.
- ALL ANCHOR HEAD TYPES ARE APPLICABLE.
- MASONRY ANCHOR LOCATIONS AT THE CORNERS MAY BE ADJUSTED TO MAINTAIN THE MINIMUM EDGE DISTANCE TO MORTAR JOINTS.
- MASONRY ANCHOR LOCATIONS NOTED AS "MAX. ON CENTER" MUST BE ADJUSTED TO MAINTAIN THE MINIMUM EDGE DISTANCE TO MORTAR JOINTS, ADDITIONAL MASONRY ANCHORS MAY BE REQUIRED TO ENSURE THE "MAX. ON CENTER" DIMENSION IS NOT EXCEEDED.

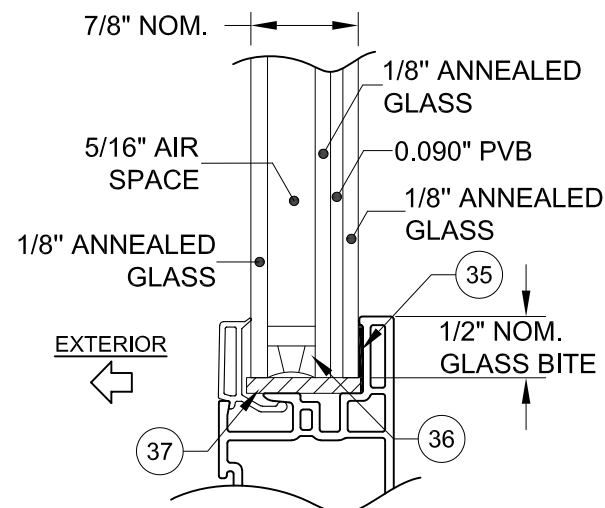

**GLASS TYPE 1**

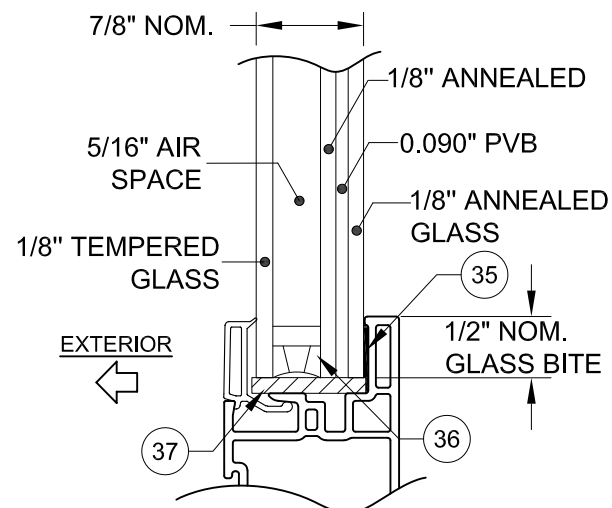

**GLASS TYPE 2**

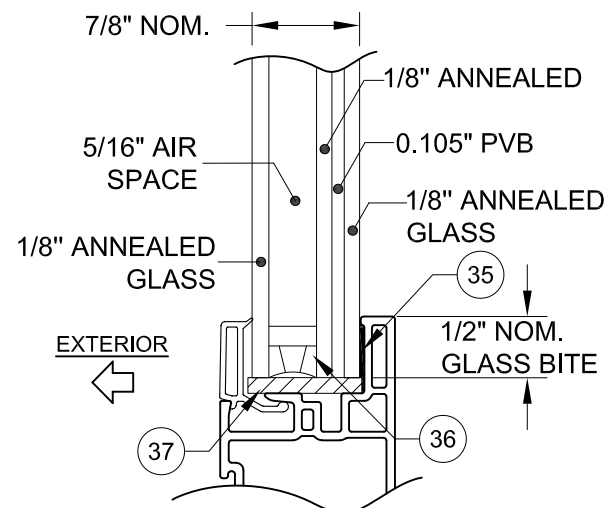

**GLASS TYPE 3**

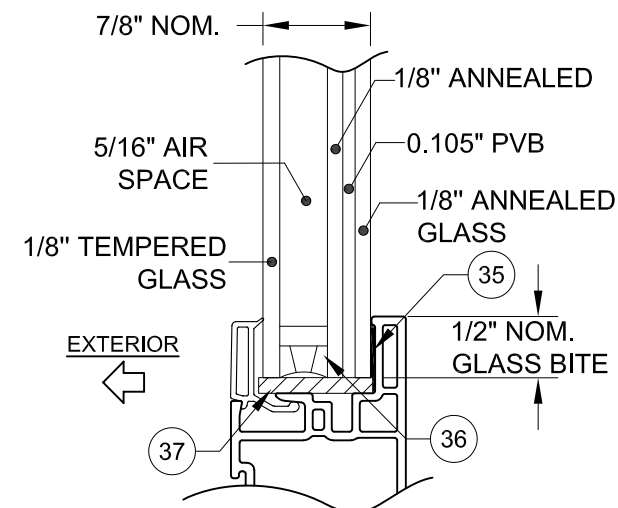

**GLASS TYPE 4**

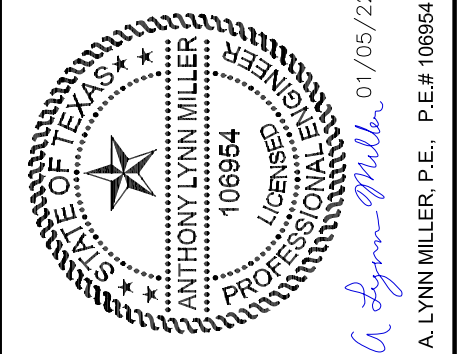

FIRM REG. NO.: F-23136

COPYRIGHT © 2022  
NEWSOUTH WINDOW SOLUTIONS  
LIMITED LICENSE TO MAKE  
COPIES FOR PERMITTING

PREPARED BY: A. LYNN MILLER, P.E.  
1070 TECHNOLOGY DR  
N. VENICE, FL 34275  
(941)-480-1600

9000 SERIES HORIZ. ROLLER  
MODELS 9550 & 9550-3, LM  
WOOD BUCK INSTALLATION  
NEWSOUTH WINDOW SOLUTIONS  
10741 CROSSROADS COMMERCE BLVD.  
TAMPA, FL 33610

BY:				
REVISION:				
DATE:				
#:				
DATE:	11/11/21			
SCALE:	NTS			
BY:	JENS ROSOWSKI			
DRAWING #:	HR9550-TDI-01			
SHEET:	7 OF 7			