



8000 SERIES, DOUBLE HUNG WINDOW, NON-IMPACT RESISTANT, EQUAL SPLIT, MODEL 8400



GENERAL NOTES:

- 1) THIS PRODUCT HAS BEEN DESIGNED AND TESTED TO COMPLY WITH THE REQUIREMENTS OF THE 2018 INTERNATIONAL BUILDING CODE.
- 2) SHUTTERS ARE REQUIRED WHEN USED IN WIND-BORNE DEBRIS REGIONS.
- 3) PRODUCT ANCHORS SHALL BE AS LISTED AND SPACED AS SHOWN ON DETAILS. ANCHOR EMBEDMENT TO BASE MATERIAL SHALL BE BEYOND WALL DRESSING OR STUCCO.
- 4) FOR 2X STUD FRAMING CONSTRUCTION, ANCHORING OF THESE UNITS SHALL BE THE SAME AS THAT SHOWN FOR 2X BUCK MASONRY CONSTRUCTION. 1X BUCKS ARE OPTIONAL, IF USED, INSTALLATION ANCHORS WILL GO THRU THE 1X INTO THE MASONRY CONSTRUCTION. CAN INSTALL DIRECTLY INTO MASONRY WITH A 1/4" MAX SHIM.
- 5) DESIGN PRESSURES:
 - A. NEGATIVE DESIGN LOADS BASED ON STRUCTURAL TEST PRESSURE, FRAME ANALYSIS AND GLASS PER ASTM E1300.
 - B. POSITIVE DESIGN LOADS BASED ON WATER TEST PRESSURE, STRUCTURAL TEST PRESSURE, FRAME ANALYSIS AND GLASS PER ASTM E1300.
- 6) THE ANCHORAGE METHODS SHOWN HAVE BEEN DESIGNED TO RESIST THE WINDLOADS CORRESPONDING TO THE REQUIRED DESIGN PRESSURE. THE 33-1/3% STRESS INCREASE HAS NOT BEEN USED IN THE DESIGN OF THIS PRODUCT. THE 1.6 LOAD DURATION FACTOR WAS USED FOR THE EVALUATION OF ANCHORS INTO WOOD. ANCHORS THAT COME INTO CONTACT WITH OTHER DISSIMILAR MATERIALS SHALL BE COATED OR CORROSION RESISTANT AS SPECIFIED IN THE 2018 INTERNATIONAL BUILDING CODE.
- 7) SIZES MUST BE VERIFIED FOR COMPLIANCE WITH EGRESS REQUIREMENTS PER THE INTERNATIONAL BUILDING CODE.

TABLE 1: DESIGN PRESSURES

| Width | Height | Design Pressure | | Certification Number |
|-------|--------|-----------------|---------|----------------------|
| | | (+) psf | (-) psf | |
| 44" | 63" | 50 | 50 | NI014846 |

TABLE 2: INSTALLATION ANCHORS

| Anchor Type | Substrate | Min. Embedment | Min. Edge Distance | Min. On Center |
|----------------------------------|--------------|----------------|--------------------|----------------|
| 1/4" Elco Ultracon and Ultracon+ | Concrete/CMU | 1-3/8" | 1" | 4" |
| #10 SMS | Wood | 1-3/8" | 9/16" | 1" |
| #10 SMS | Steel Stud | .056" | 5/8" | 1" |

ANCHOR NOTES:

- 1) CONCRETE ANCHOR LOCATIONS AT THE CORNERS MAY BE ADJUSTED TO MAINTAIN THE MINIMUM EDGE DISTANCE TO MORTOR JOINTS.
- 2) CONCRETE ANCHOR LOCATIONS NOTED AS "MAX. ON CENTER" MUST BE ADJUSTED TO MAINTAIN THE MINIMUM EDGE DISTANCE TO MORTOR JOINTS, ADDITIONAL CONCRETE ANCHORS MAY BE REQUIRED TO ENSURE THE "MAX. ON CENTER" DIMENSION IS NOT EXCEEDED.
- 3) SHEET METAL SCREWS MUST PENETRATE A MIN. OF 3 THREADS THRU THE STEEL STUD.

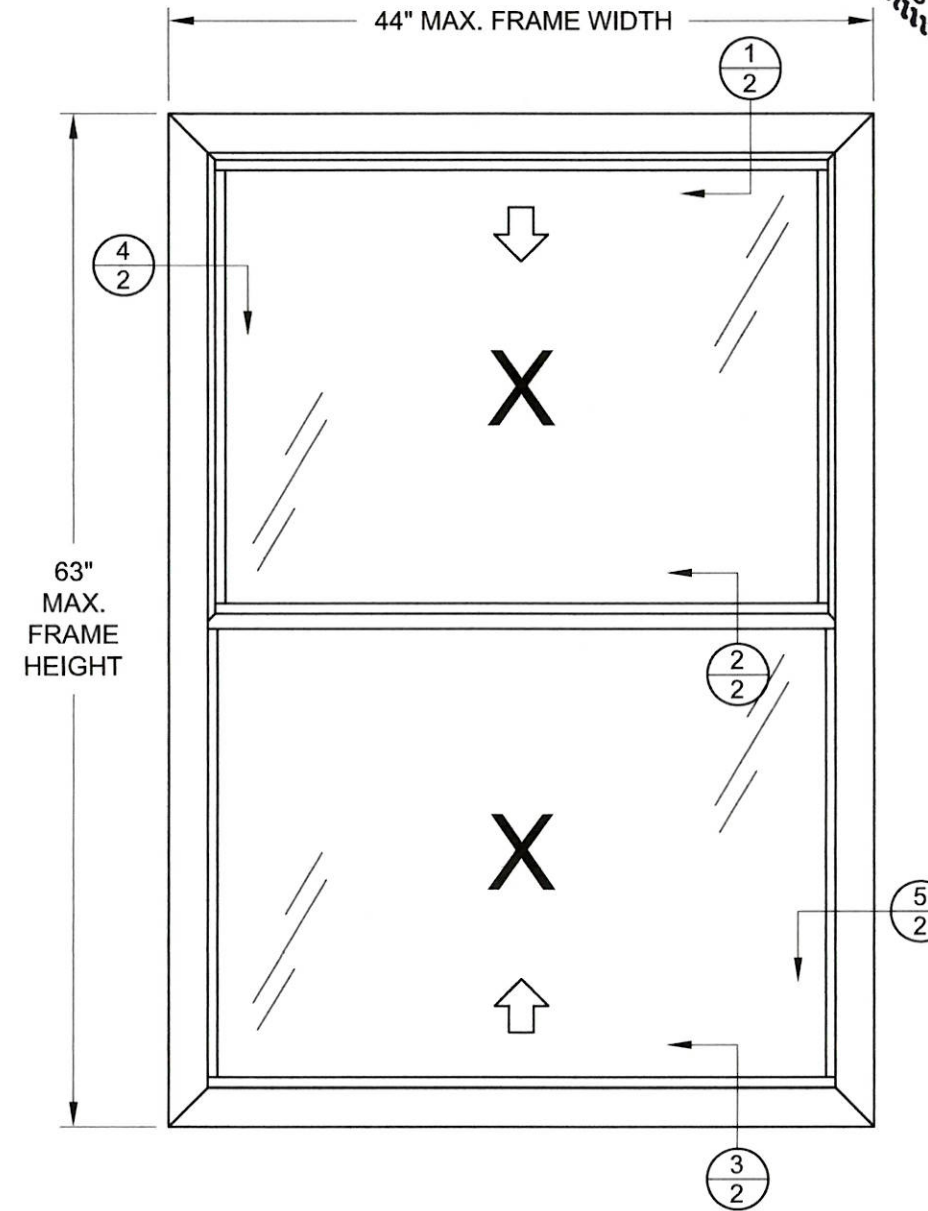

| | |
|-------------------------|---|
| GENERAL NOTES..... | 1 |
| DP & ANCHOR TABLES..... | 1 |
| ELEVATION..... | 1 |
| SECTION VIEWS..... | 2 |
| GLAZING DETAILS..... | 2 |
| 2x BUCK ANCHORAGE..... | 3 |
| FRAME ANCHORAGE..... | 3 |
| EXTRUSIONS..... | 4 |
| BILL OF MATERIALS..... | 4 |

A. LYNN MILLER, P.E., P.E.# 106954
 1070 TECHNOLOGY DR
 N. VENICE, FL 34275
 (941)-480-1600
 COPYRIGHT © 2020
 NEWSOUTH WINDOW SOLUTIONS
 LIMITED LICENSE TO MAKE COPIES
 FOR PERMITTING

| | |
|------------|---|
| BY: | 8000 SERIES DOUBLE HUNG |
| REVISION: | GENERAL NOTES, DESIGN PRESSURES, AND ANCHORS NEWSOUTH WINDOW SOLUTIONS 10741 CROSSROADS COMMERCE BLVD. TAMPA, FL 33610 |
| DATE: | |
| #: | |
| DATE: | 06/04/2020 |
| SCALE: | NTS |
| BY: | E KOSS |
| DRAWING #: | DH8400NI - TDI |
| SHEET: | 1 OF 4 |

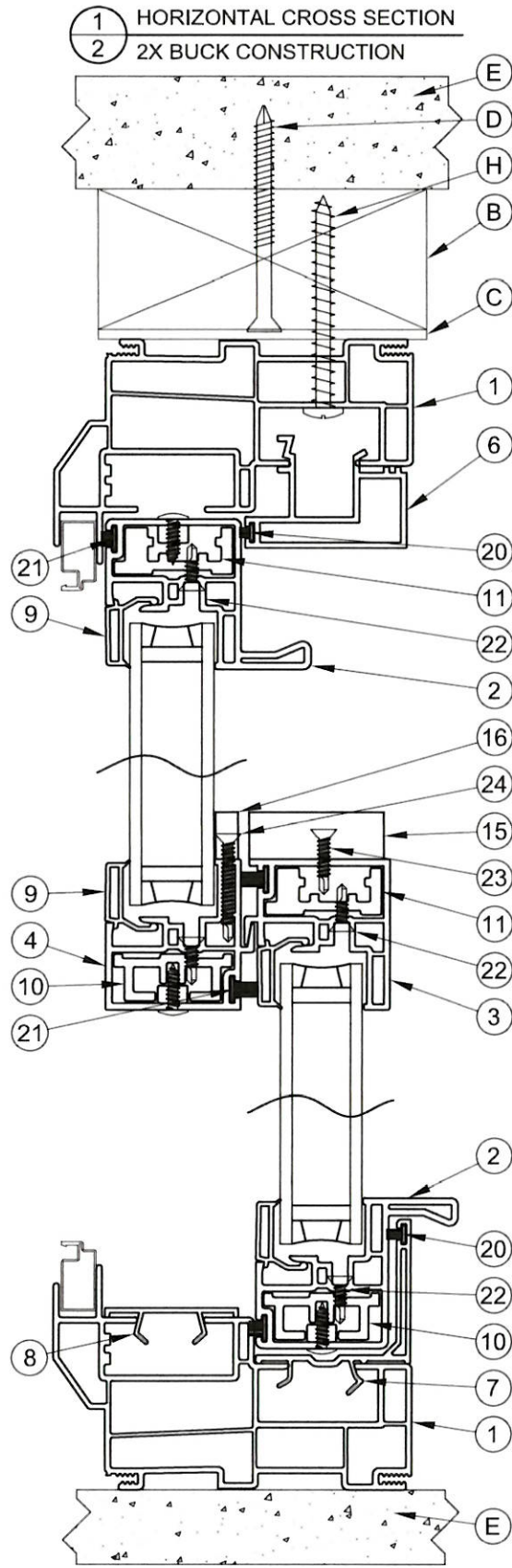

2 HORIZONTAL CROSS SECTION
2 MEETING RAIL

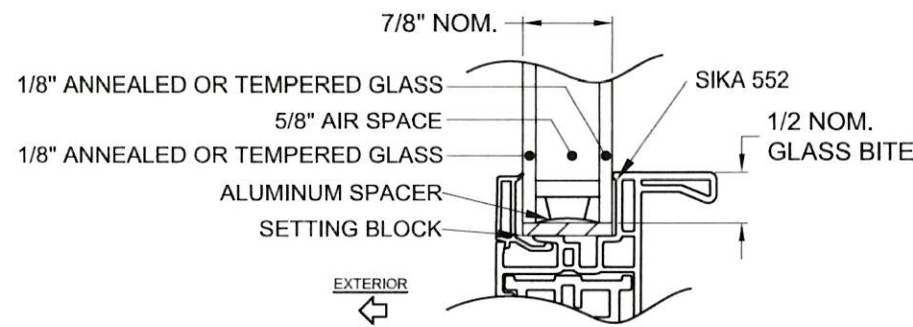
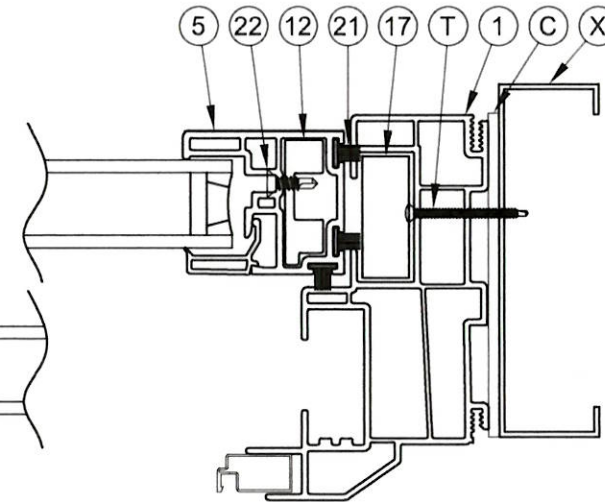
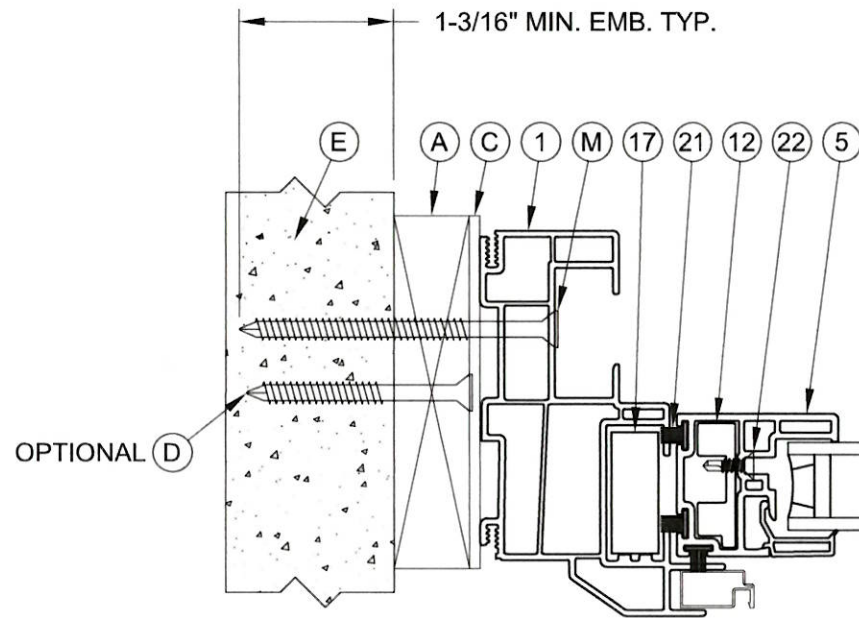

GLAZING DETAILS

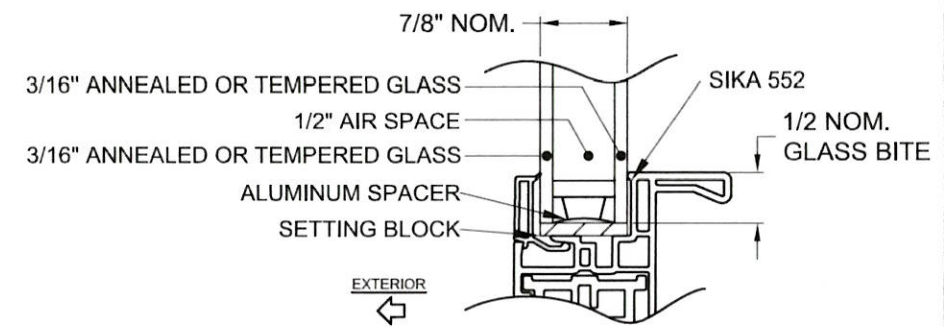

NOTES:

- 1) FOR INSTALLATION INTO 1X BUCK CONSTRUCTION, BUCK TO CONCRETE ANCHORS (IF USED) MUST BE AT LEAST 4" FROM PRODUCT INSTALLATION ANCHORS THRU 1X BUCK INTO MASONRY AND FOLLOW MASONRY ANCHOR REQUIREMENTS FROM TABLE 2. APPLIES TO ALL FRAMES.
- 2) ANY INSTALLATION OPTION SHOWN (2X BUCK, 1X BUCK, DIRECT TO MASONRY, STEEL STUD) MAY BE USED ON ANY SIDE OF THE WINDOW.



A. LYNN MILLER, P.E., P.E.# 106954
1070 TECHNOLOGY DR
N. VENICE, FL 34275
(941)-480-1600
COPYRIGHT © 2020
NEWSOUTH WINDOW SOLUTIONS
LIMITED LICENSE TO MAKE COPIES
FOR PERMITTING

| | |
|------------|---|
| BY: | 8000 SERIES DOUBLE HUNG |
| REVISION: | SECTION VIEWS AND GLAZING DETAILS |
| DATE: | NEWSOUTH WINDOW SOLUTIONS 10741 CROSSROADS COMMERCE BLVD. TAMPA, FL 33610 |
| #: | |
| DATE: | 06/04/2020 |
| SCALE: | NTS |
| BY: | E KOSS |
| DRAWING #: | DH8400NI - TDI |
| SHEET: | 2 OF 4 |



A. LYNN MILLER, P.E., P.E.# 106954
 1070 TECHNOLOGY DR
 N. VENICE, FL 34275
 (941)-480-1600
 COPYRIGHT © 2020
 NEWSOUTH WINDOW SOLUTIONS
 LIMITED LICENSE TO MAKE COPIES
 FOR PERMITTING

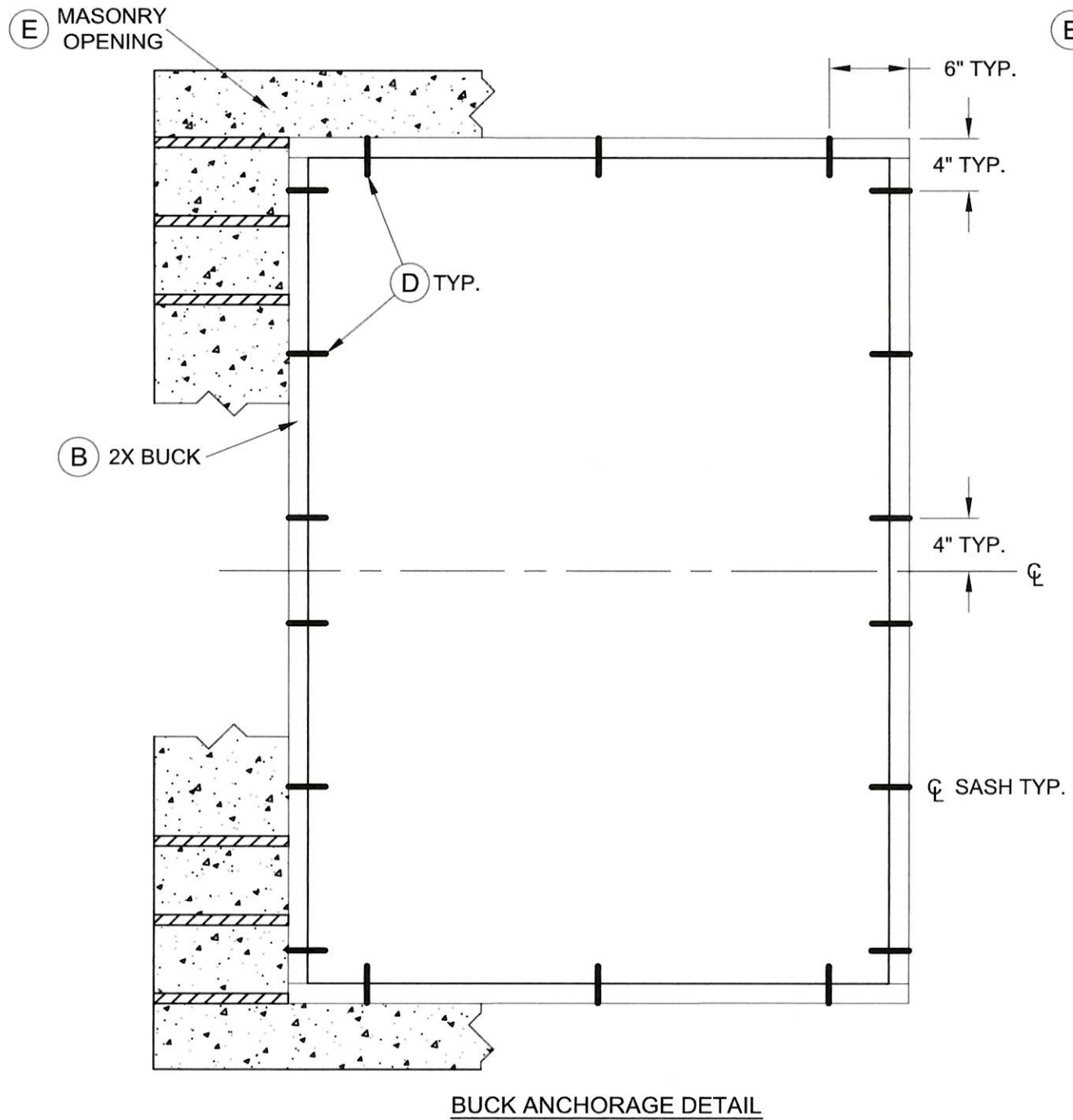

BUCK ANCHORAGE DETAIL

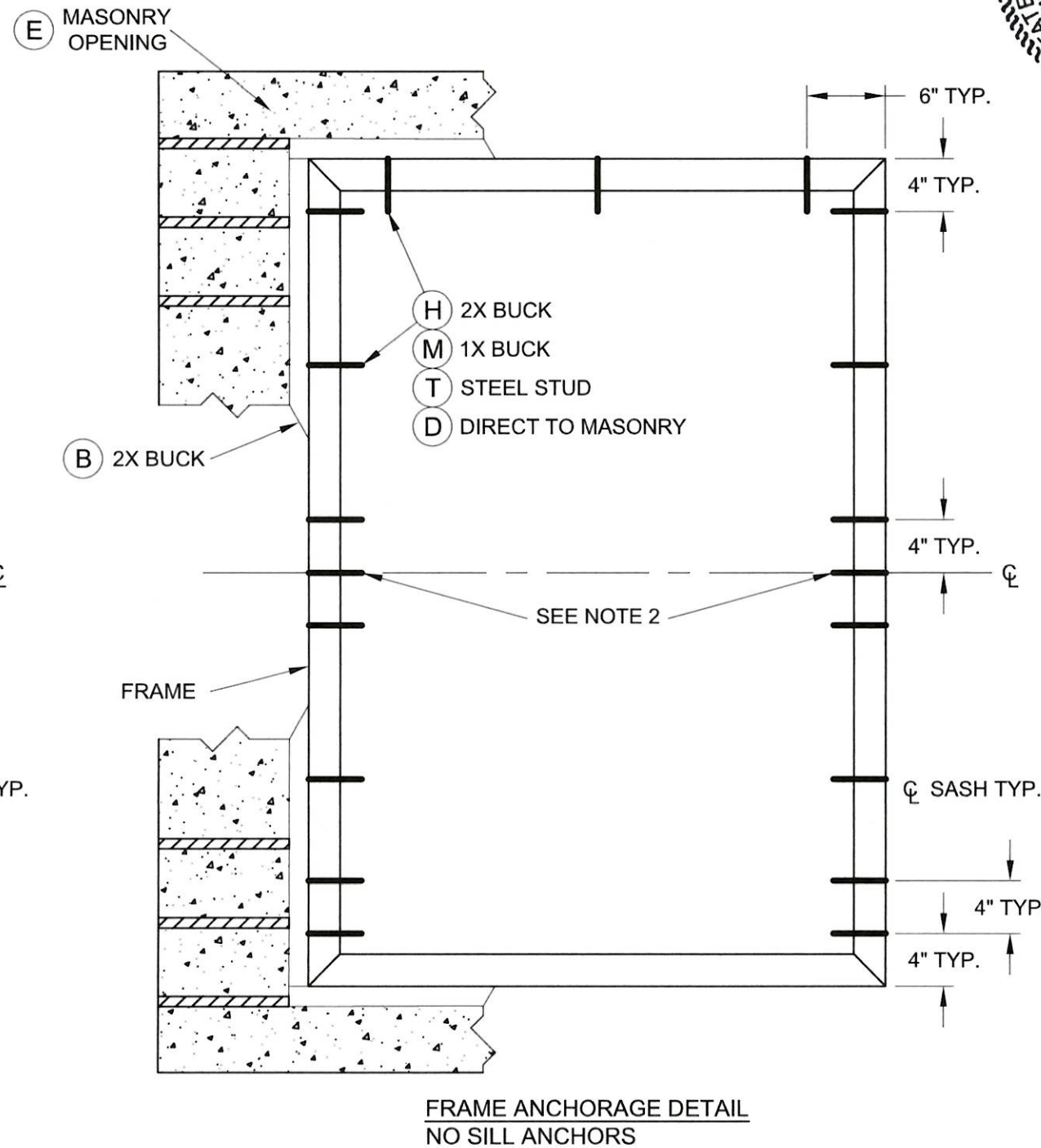

FRAME ANCHORAGE DETAIL
 NO SILL ANCHORS

- NOTES:**
- 1) 1X BUCK CONSTRUCTION, BUCK TO CONCRETE ANCHORS (IF USED) MUST BE AT LEAST 4" FROM PRODUCT INSTALLATION ANCHORS THRU 1X BUCK INTO MASONRY AND FOLLOW MASONRY ANCHOR REQUIREMENTS FROM TABLE 2.
 - 2) ANCHOR THRU TILT LATCH INTO SUBSTRATE USING SIMILAR FLAT HEAD ANCHOR.

| | |
|------------|--|
| BY: | 8000 SERIES DOUBLE HUNG |
| REVISION: | 2X BUCK AND FRAME ANCHORAGE NEWSOUTH WINDOW SOLUTIONS 10741 CROSSROADS COMMERCE BLVD. TAMPA, FL 33610 |
| DATE: | |
| #: | |
| DATE: | 06/04/2020 |
| SCALE: | 1:4 |
| BY: | E KOSS |
| DRAWING #: | DH8400NI - TDI |
| SHEET: | 3 OF 4 |

BILL OF MATERIALS

| ITEM # | DESCRIPTION | MATERIAL |
|--------|--|----------|
| A | 1X BUCK (SG>=0.42) | WOOD |
| B | 2X BUCK (SG>=0.42) | WOOD |
| C | 1/4" MAX SHIM SPACE | - |
| D | 1/4" X 2-3/4" ELCO ULTRACON OR ULTRACON+ CONCRETE SCREW | STEEL |
| E | MASONRY - 3000 PSI MIN CONCRETE CONFORMING TO ACI 301 OR HOLLOW BLOCK CONFORMING TO ASTM C90 | CONCRETE |
| H | #10 X 2-1/2" PPH SMS | STEEL |
| M | 1/4" X 3-1/4" ELCO ULTRACON OR ULTRACON+ CONCRETE SCREW | STEEL |
| T | #10-16 PH SELF-DRILLING SMS (3 THREADS MIN. THRU STUD) | STEEL |
| X | STEEL STUD MIN THICKNESS 0.0346" (ASTM A1003 GRADE 33, FY=50 KSI MIN., FU=65 KSI MIN.) | STEEL |
| 1 | FRAME | PVC |
| 2 | LIFT RAIL (UPPER SASH TOP RAIL / LOWER SASH BTM RAIL) | PVC |
| 3 | LOCK RAIL (LOWER SASH TOP RAIL) | PVC |
| 4 | KEEPER RAIL (UPPER SASH BTM RAIL) | PVC |
| 5 | SASH STILE | PVC |
| 6 | HEAD ADAPTOR | PVC |
| 7 | SILL ADAPTOR (RISER) | PVC |
| 8 | SILL CAP | PVC |
| 9 | GLAZING BEAD | PVC |
| 10 | REINFORCEMENT (KEEPER RAIL / LOWER SASH BTM RAIL) | ALUM |
| 11 | REINFORCEMENT (LOCK RAIL / UPPER SASH TOP RAIL) | ALUM |
| 12 | REINFORCEMENT (SASH STILES) | ALUM |
| 13 | TILT LATCH | STEEL |
| 14 | PIVOT BAR | |
| 15 | LOCK | ZINC |
| 16 | KEEPER | ZINC |
| 17 | COIL BALANCER | |
| 18 | WEEP COVER | NYLON |
| 19 | SCREEN | |
| 20 | WTSP, .187" x .270" POLYFIN | |
| 21 | WTSP, .270" X .250" POLYFIN | |
| 22 | #6 x 1/2" PFH (REINFORCEMENT) | |
| 23 | #6 x 3/4" PFH (KEEPER) | |
| 24 | #6 x 1-1/4" PFH (LOCK) | |
| 25 | #8 x 1/2" PTRUSS | |

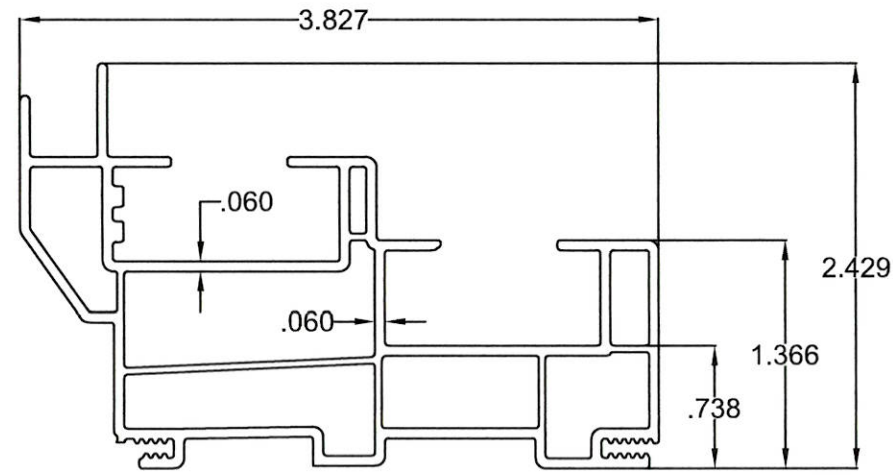

① FRAME

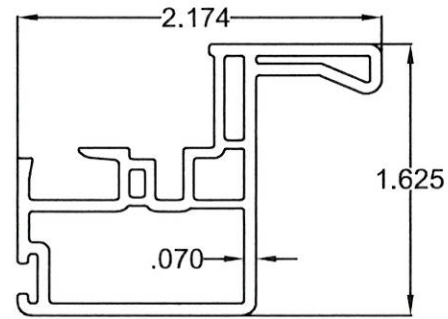

② LIFT RAIL

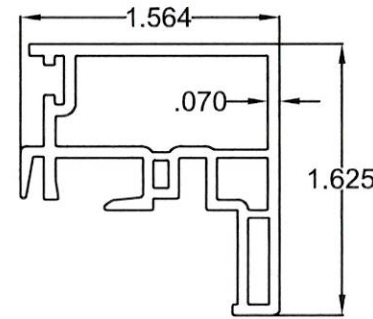

③ LOCK RAIL

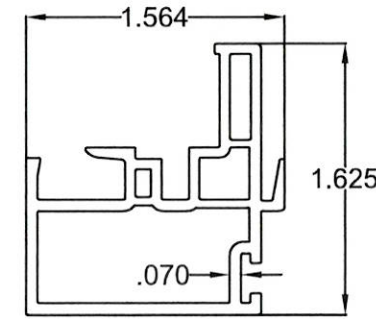

④ KEEPER RAIL

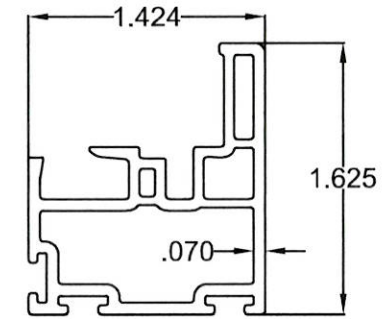

⑤ SASH STILE

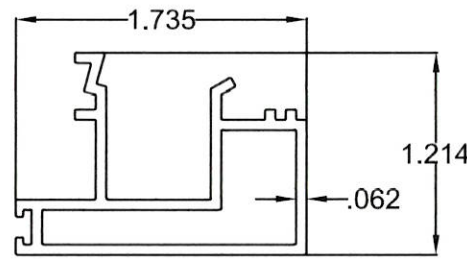

⑥ HEAD ADAPTOR

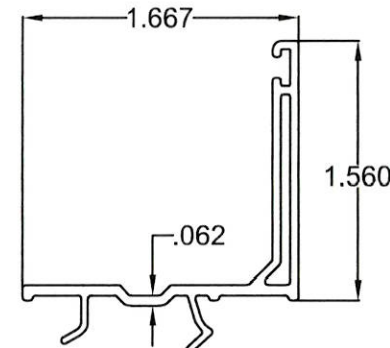

⑦ SILL ADAPTOR (RISER)

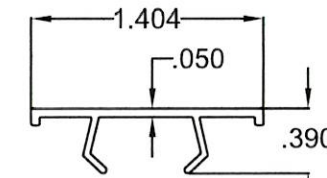

⑧ SILL CAP

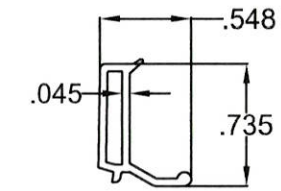

⑨ GLAZING BEAD

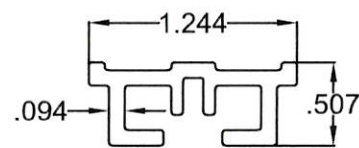

⑩ REINFORCEMENT (KEEPER / BTM RAIL)

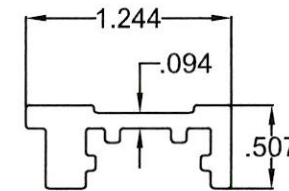

⑪ REINFORCEMENT (LOCK / TOP RAIL)

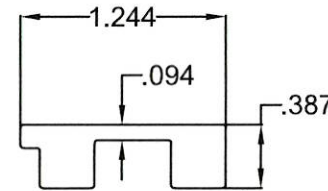

⑫ REINFORCEMENT (STILES)

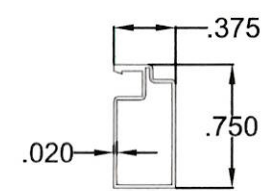

⑲ SCREEN

THE APPROVED WHITE, RIGID PVC EXTERIOR EXTRUSIONS FOR DOORS ARE TO BE PRODUCED BY EXTRUDERS' LICENSEES UNDER "AAMA CERTIFICATION PROGRAMS FOR RIGID PVC EXTRUSIONS".



A. LYNN MILLER, P.E., P.E.# 106954
 1070 TECHNOLOGY DR
 N. VENICE, FL 34275
 (941) 480-1600
 COPYRIGHT © 2020
 NEWSOUTH WINDOW SOLUTIONS
 LIMITED LICENSE TO MAKE COPIES
 FOR PERMITTING

| | |
|------------|---|
| BY: | 8000 SERIES DOUBLE HUNG |
| REVISION: | EXTRUSIONS / BILL OF MATERIALS |
| DATE: | NEWSOUTH WINDOW SOLUTIONS 10741 CROSSROADS COMMERCE BLVD. TAMPA, FL 33610 |
| #: | |
| DATE: | 06/04/2020 |
| SCALE: | 10:1 |
| BY: | E KOSS |
| DRAWING #: | DH8400NI - TDI |
| SHEET: | 4 OF 4 |