

MODEL 6500 SYSTEMS 1 AND 2 DOUBLE HUNG - LARGE MISSILE IMPACT

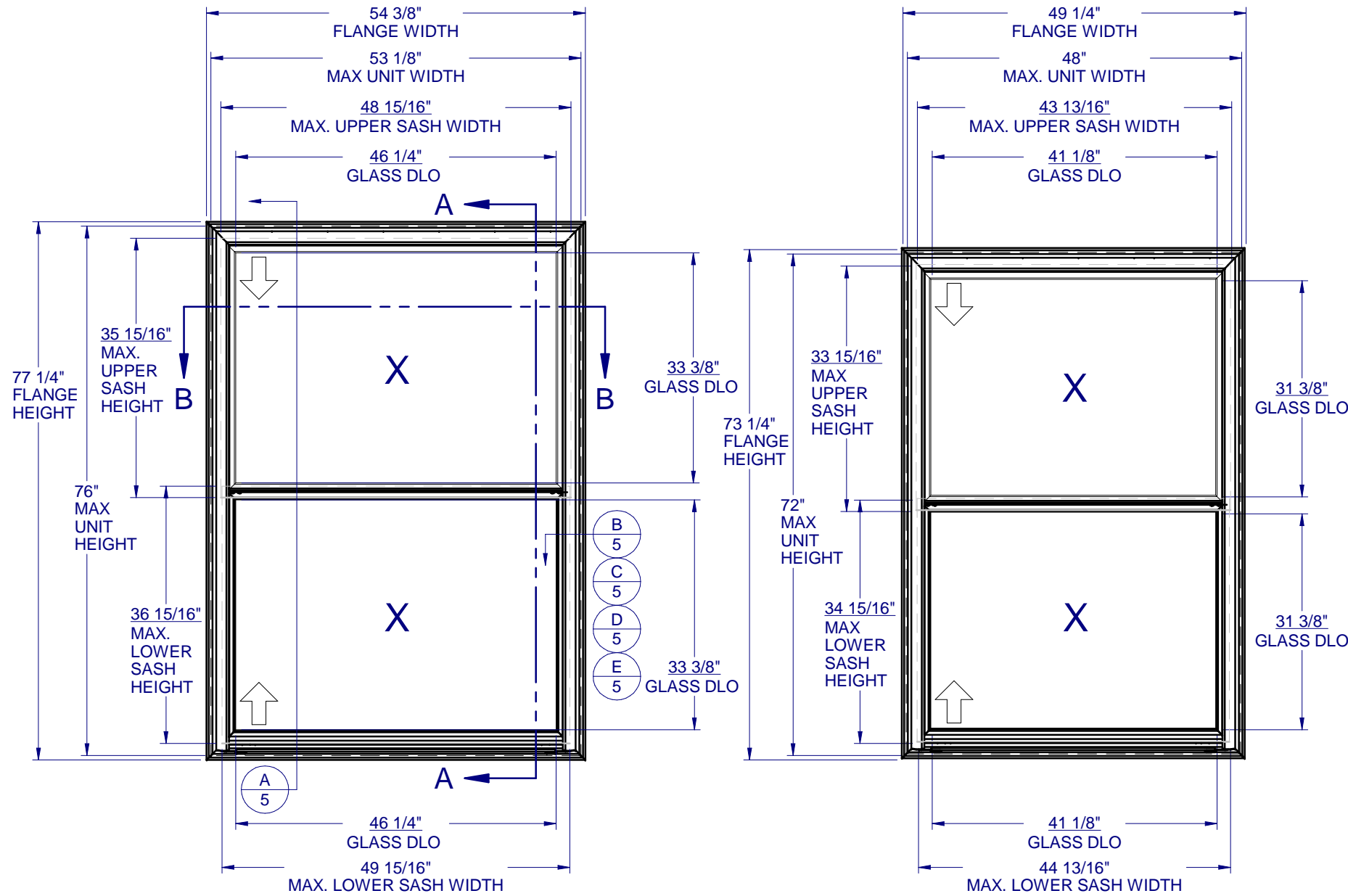

SYSTEM 2
(CAR 138-545/138-1335)
MAXIMUM ALLOWABLE DESIGN PRESSURE: +45/-45 PSF

SYSTEM 1
(CAR 138-560/138-1355)
MAXIMUM ALLOWABLE DESIGN PRESSURE: +50/-50 PSF

TABLE OF CONTENTS

- GENERAL NOTES & ELEVATIONS.....1
- SECTION VIEWS & GLAZING.....2
- EXTRUSIONS & B.O.M.....3
- ANCHOR SCHEDULE & NOTES.....4
- INSTALLATION DETAILS.....5

GENERAL NOTES:

1. THE PRODUCT SHOWN HEREIN IS DESIGNED AND MANUFACTURED TO COMPLY WITH THE REQUIREMENTS OF THE 2018 INTERNATIONAL BUILDING CODE (IBC) AND 2018 INTERNATIONAL RESIDENTIAL CODE (IRC), WITH TEXAS REVISIONS, WITH TEXAS REVISIONS..
2. GLAZING OPTIONS: (SEE SHEET 2)
3. CONFIGURATIONS: "X/X".
4. ANCHORAGE: THE 33 1/3% STRESS INCREASE HAS NOT BEEN USED IN THE DESIGN OF THIS PRODUCT. SEE SHEET 5 FOR ANCHOR DETAILS. WINDLOAD DURATION FACTOR Cd=1.6 WAS USED FOR WOOD ANCHOR CALCULATIONS.
5. PRODUCT APPROVED FOR IMPACT RESISTANCE. SHUTTERS ARE NOT REQUIRED.
6. ALL FRAMES AND VENTS FULLY WELDED. SMALL JOINT SEAM SEALANT USED AT FIXED MEETING RAIL AND JAMB.
7. SERIES / MODEL DESIGNATION DH-6500.
8. THE DESIGNATION X AND O STAND FOR THE FOLLOWING:
X = OPERABLE SASH
9. SECTION CALLOUTS APPLY TO ALL ELEVATIONS IN A SIMILAR LOCATION.
10. EXTERNAL WEEP SLOT = 1/2 x 2-1/2" LOCATED 5" FROM BOTH ENDS.

Custom
WINDOW SYSTEMS
1900 SW 44TH AVE.
OCALA, FLORIDA 34474
WWW.CWS.CC

6500 PVC DOUBLE HUNG IMPACT

NO.	DESCRIPTION:	BY:	DATE:
B	REVISED TO TDI REQUEST	MS	04/15/22
A	REVISED TO TDI REQUEST	JML	3/22/17



5/3/2022

LUCAS A. TURNER, P.E.
TX PE # 115094
2428 OLD NATCHEZ TRC TRL
CAMDEN, TN 38320
PH. 941-380-1574

SHEET DESCRIPTION:

GENERAL NOTES AND ELEVATIONS

DRAWN BY:	DATE:
EMK	11/12/15
DWG #:	REV.:
TDI-1069	B
SCALE:	SHEET
1:20	1 OF 5

**6500 PVC
DOUBLE HUNG
IMPACT**

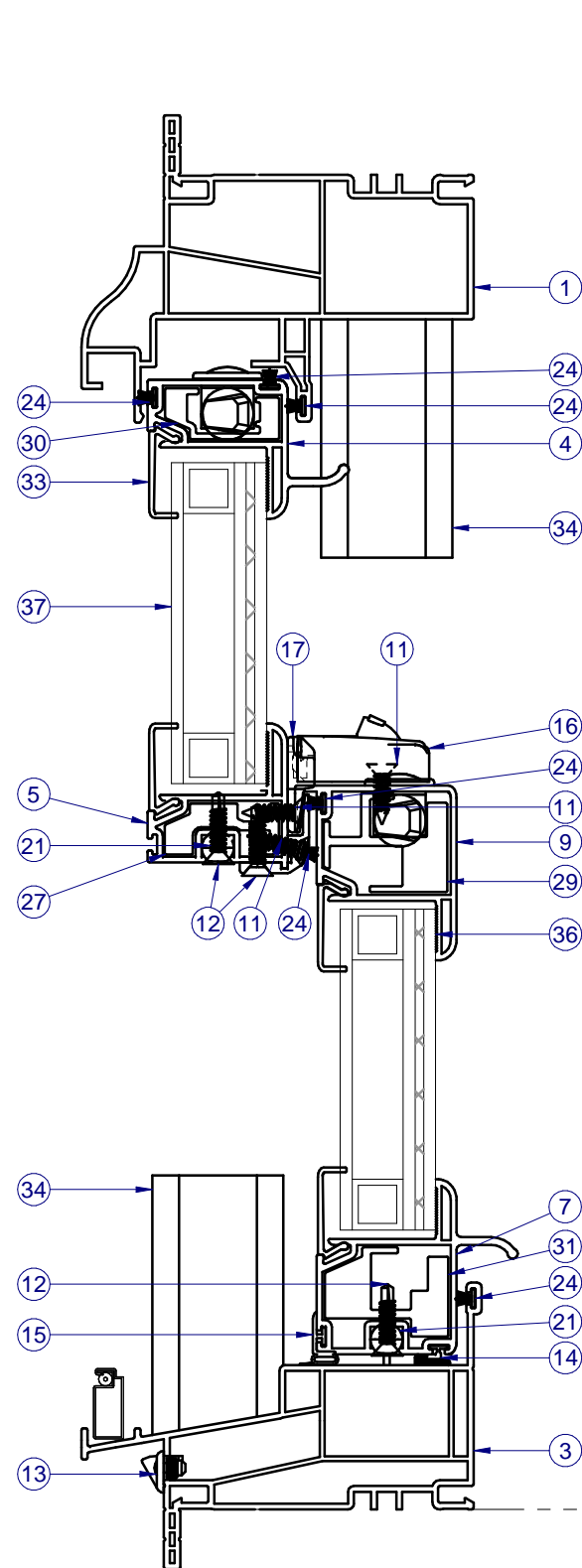

SECTION VIEW A-A

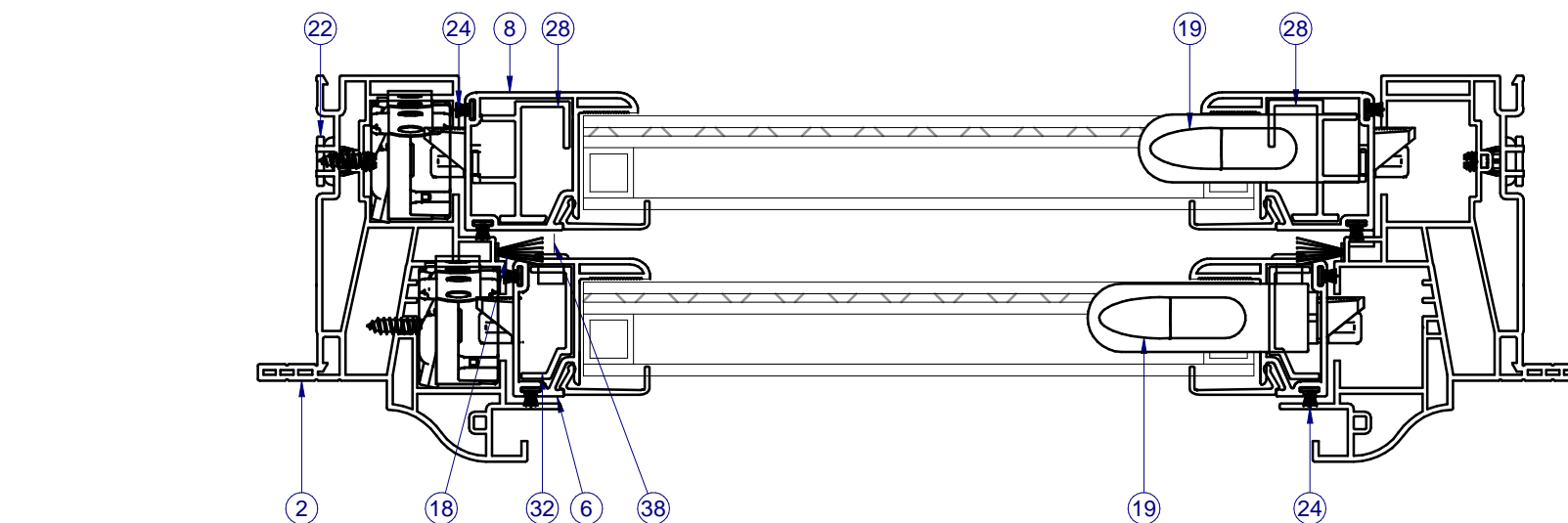

SECTION VIEW B-B

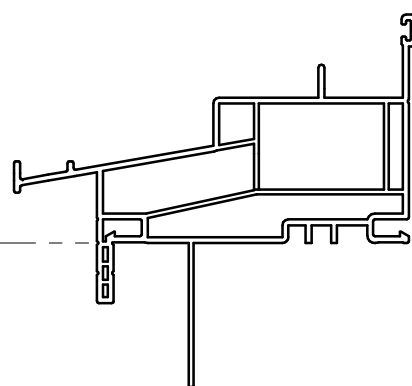

ALTERNATE FIN FRAME

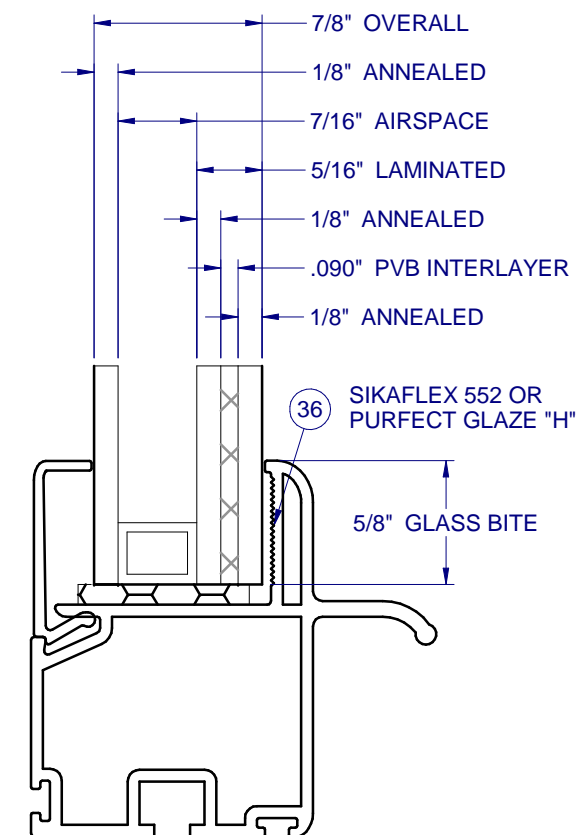

SYSTEMS 1 & 2

NO.		DESCRIPTION:	BY:	DATE:
B		REVISED TO TDI REQUEST	MS	04/15/22
A		REVISED TO TDI REQUEST	JML	3/22/17

REVISIONS



5/3/2022

LUCAS A. TURNER, P.E.
TX PE # 115094
2428 OLD NATCHEZ TRC TRL
CAMDEN, TN 38320
PH. 941-380-1574

SHEET DESCRIPTION:

**SECTION VIEWS AND
GLAZING DETAIL**

DRAWN BY:	DATE:
EMK	11/12/15
DWG #:	REV.:
TDI-1069	B
SCALE:	SHEET
1:2	2 OF 5

PARTS LIST

ITEM	PART #	DESCRIPTION	MATERIAL	VENDOR
1	H-6121	HEAD, OUTERFRAME	PVC	ATN
2	H-6122	JAMBS, OUTERFRAME	PVC	ATN
3	H-6123	SILL, OUTERFRAME	PVC	ATN
4	H-6130	TOP RAIL, UPPER SASH	PVC	ATN
5	H-6131	BOTTOM RAIL, UPPER SASH	PVC	ATN
6	H-6132	SASH SIDE RAIL, UPPER SASH	PVC	ATN
7	H-6133	BOTTOM RAIL, LOWER SASH	PVC	ATN
8	H-6134	SASH SIDE RAIL, LOWER SASH	PVC	ATN
9	H-6135	TOP RAIL, LOWER SASH	PVC	ATN
10	P-3028	SETTING BLOCK	RUBBER	FRANK LOWE
11	P-3515	#8 x 5/8 PHIL FLAT WHITE SMS	STEEL	FASTENAL
12	P-4146	#8 X 3/4 PHIL FLAT TEK.	STEEL	FASTENAL
13	P-5420	WEEP COVER	NYLON	M&M
14	P-5085	WSTP, .355 X 333BULB VINYL		AMESBURY
15	P-5086	WSTP, .300 X 187BULB VINYL		AMESBURY
16	P-3783	LOCKS		INTERLOCK
17	P-3784	KEEPERS		INTERLOCK
18	P-5424	WSTP., .500 X 1.5" ADHESIVE BACK STRIP		ULTRAFAB
19	P-5392	SASH TILT LATCH	NYLON	CALDWELL
21	P-5396	PIVOT BAR	SS	CALDWELL
22	P-5412	JAMB JACK	STEEL	MERCHANTS
24	P-3305	WSTP., .270 X 187		ULTRAFAB
25	S-2001	INTERLOCK RAIL	ALUM	ASCEND
27	S-2003	REINF, BOT RAIL, UPPER SASH	ALUM	ASCEND
28	S-2004	REINF, SIDE RAIL, LOWER SASH	ALUM	ASCEND
29	S-2005	REINF, TOP RAIL, LOWER SASH, & SIDE RAIL LOWER SAS	ALUM	ASCEND
30	S-2006	REINF, SASH TOP AND SIDE RAIL, UPPER SASH	ALUM	ASCEND
31	S-2010	REINF, BOTTOM RAIL, LOWER SASH	ALUM	ASCEND
32	S-2027	REINF, SIDE RAIL, UPPER SASH	ALUM	ASCEND
33	S-6141	GLAZING BEAD	PVC	ATN
34	S-6142	SASH STOP		
35		BALANCERS - CONSTANT FORCE RT		CALDWELL
36		HOTMELT	SILICONE	TRUSEAL
37	GLASS	SEE SHEET 2		
38	P-5425	WSTP, .200 X 5/8" X 5/8" DUST PLUG		ULTRAFAB
39	P-3218	SCREEN FRAME	ALUM	FLA SCREEN
40	P-4754	SCREEN CORNER KEY	NYLON	FLA SCREEN
41	P-3228	SCREEN SPLINE		DAPA
42	P-3029	SCREEN LIFTS		SUMMIT
43	P-3033	SCREEN SPRINGS		FLA SCREEN

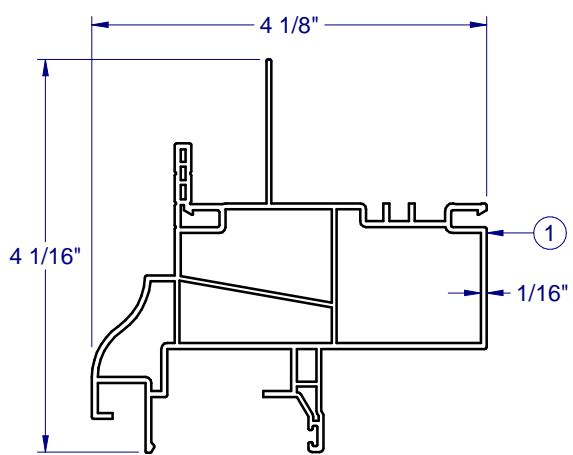

PVC FRAME HEAD
H-6121

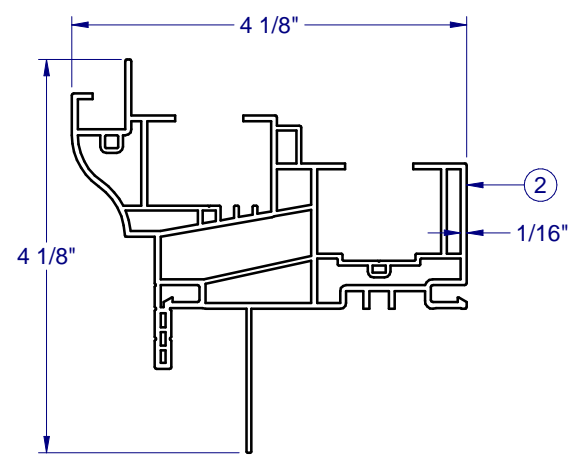

PVC FRAME JAMB
H-6122

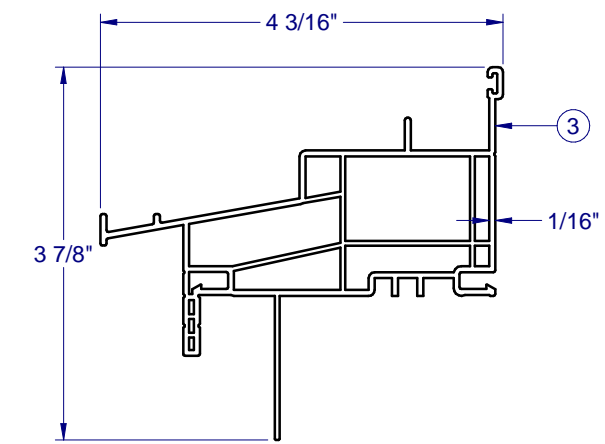

PVC FRAME SILL
H-6123

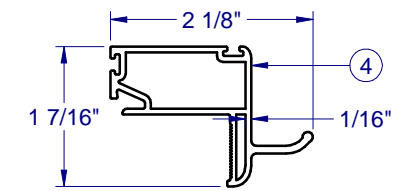

PVC TOP RAIL UPPER
H-6130

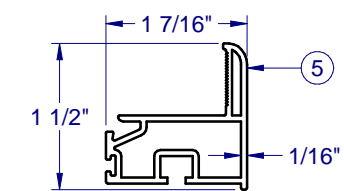

PVC BOT RAIL UPPER
H-6131

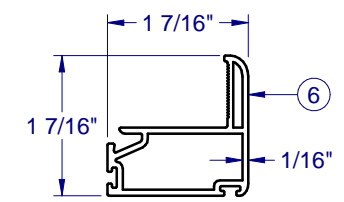

PVC SSR UPPER
H-6132

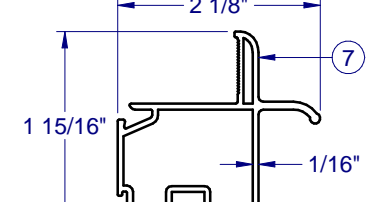

PVC BTM RAIL LOWER
H-6133

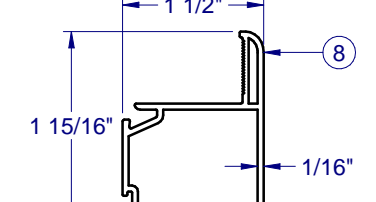

PVC SSR LOWER
H-6134

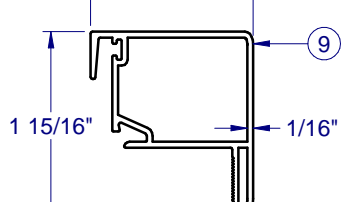

PVC TOP RAIL LOWER
H-6135

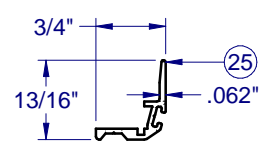

INTERLOCK
S-2001

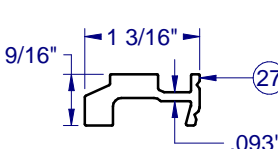

REINFORCEMENT
S-2003

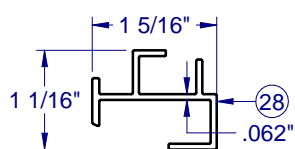

REINFORCEMENT
S-2004

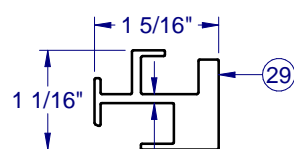

REINFORCEMENT
S-2005

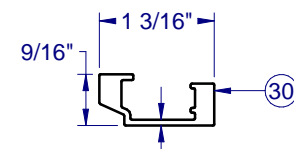

REINFORCEMENT
S-2006

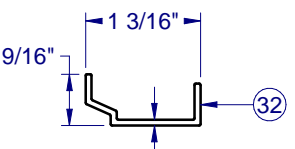

REINFORCEMENT
S-2027

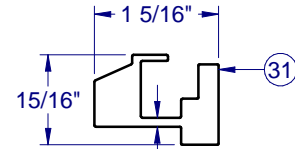

REINFORCEMENT
S-2010

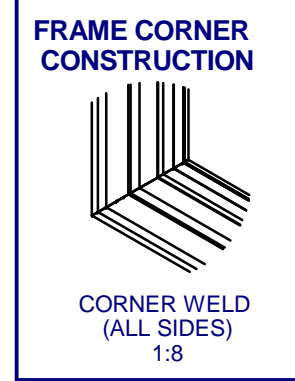

**FRAME CORNER
CONSTRUCTION**

CORNER WELD
(ALL SIDES)
1:8

Custom
WINDOW SYSTEMS

1900 SW 44TH AVE.
OCALA, FLORIDA 34474
WWW.CWS.CC

**6500 PVC
DOUBLE HUNG
IMPACT**

					04/15/22	DATE:
				MS	3/22/17	BY:
				JML		NO.:
						DESCRIPTION:
						REVISIONS



5/3/2022

LUCAS A. TURNER, P.E.
TX PE # 115094
2428 OLD NATCHEZ TRC TRL
CAMDEN, TN 38320
PH. 941-380-1574

SHEET DESCRIPTION:
BOM AND EXTRUSIONS

DRAWN BY:	DATE:
EMK	11/12/15
DWG #:	REV.:
TDI-1069	B
SCALE:	SHEET
1:2	3 OF 5

LINE ITEMS NOT USED:
20, 23, 26

NOTE: ALL EXTRUSIONS ARE ALUM. 6063-T6 UNLESS OTHERWISE NOTED.

**6500 PVC
DOUBLE HUNG
IMPACT**

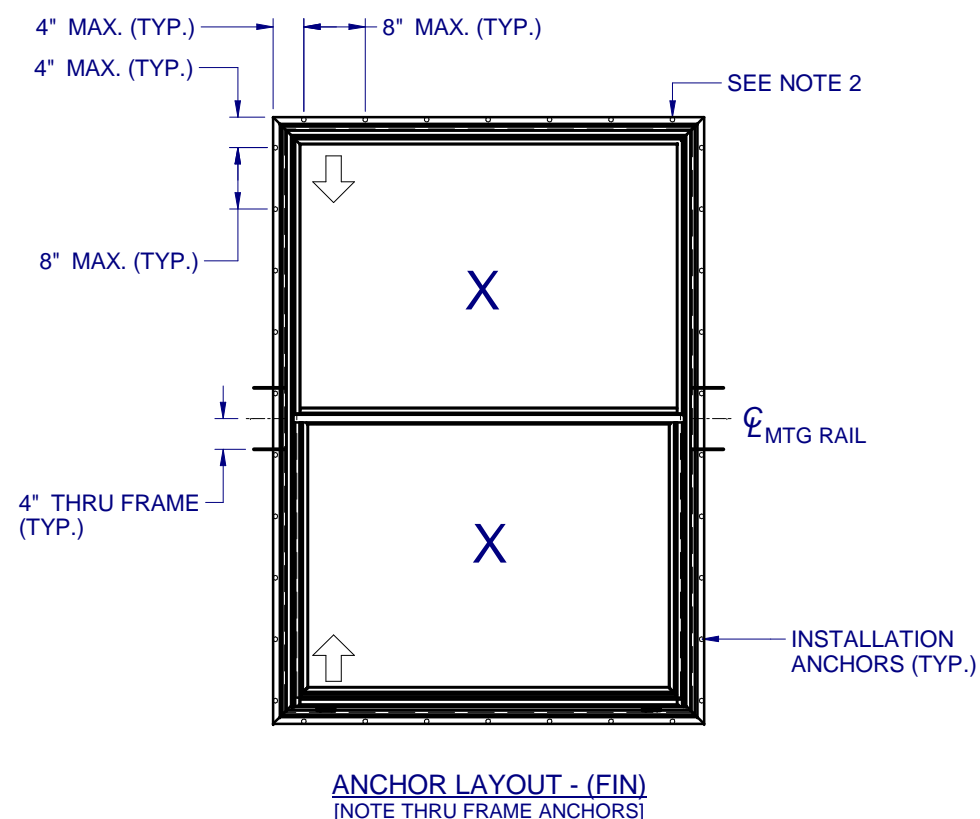
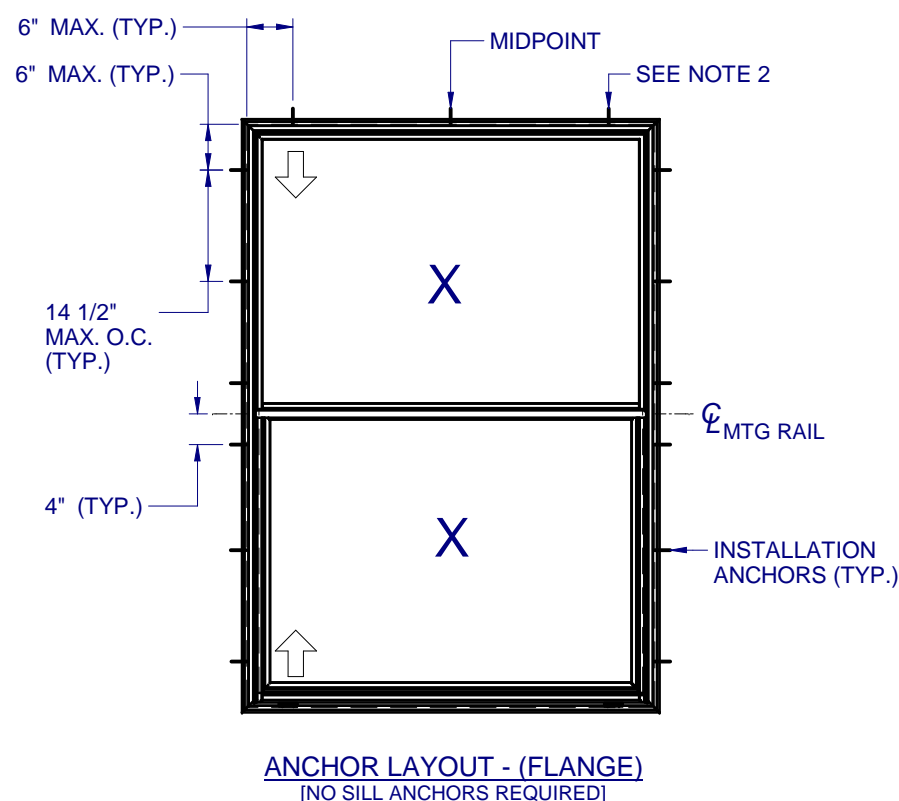

NOTES:

1. INSTALL ONE ANCHOR AT EACH INSTALLATION LOCATION.
2. SHIM AS REQ AT EACH INSTALLATION ANCHOR USING LOAD BEARING SHIMS. MAX. ALLOWABLE SHIM STACK TO BE 1/4". USE SHIMS WHERE SPACE GREATER THAN 1/16" IS PRESENT. LOAD BEARING SHIMS SHALL BE CONSTRUCTED OF HIGH DENSITY PLASTIC OR BETTER. WOOD SHIMS ARE NOT ALLOWED.
3. ANCHOR TYPE, SIZE, SPACING AND EMBEDMENT SHALL BE AS SPECIFIED IN THESE DRAWINGS, SEE TABLE 1, SHEET 5.
4. ALL INSTALLATION ANCHORS MUST BE MADE OF OR PROTECTED WITH A CORROSION RESISTANT MATERIAL OR COATING. DISSIMILAR METALS OR MATERIALS IN CONTACT WITH PRESSURE TREATED WOOD MUST BE PROTECTED TO PREVENT REACTION.
5. INSTALLATION ANCHORS SHALL BE IN ACCORDANCE WITH ANCHOR MANUFACTURER'S INSTALLATION INSTRUCTIONS, AND ANCHORS SHALL NOT BE USED IN SUBSTRATES WITH STRENGTHS LESS THAN THE MINIMUM SPECIFIED IN TABLE 1, SHEET 5.
6. ANCHOR EMBEDMENT TO SUBSTRATE SHALL BE BEYOND WALL DRESSING OR STUCCO. FOR CONCRETE/CMU OPENINGS, EMBEDMENT SHALL BE BEYOND WOOD BUCKS, IF USED, INTO SUBSTRATE. INSTALLATIONS INTO SOLID CONCRETE OR GROUT-FILLED CMU MAY INCLUDE BUT DO NOT REQUIRE 1X WOOD BUCKS BETWEEN THE PRODUCT AND THE SUBSTRATE. INSTALLATIONS INTO HOLLOW CMU REQUIRE THE USE OF 1X WOOD BUCKS BETWEEN THE PRODUCT AND SUBSTRATE.
7. A MINIMUM CENTER-TO-CENTER SPACING SHALL BE MAINTAINED BETWEEN ALL FASTENERS: 3-9/16" FOR MASONRY, 1" FOR WOOD AND METAL.
8. WOOD OR MASONRY OPENINGS, BUCKS AND BUCK FASTENERS SHALL BE PROPERLY DESIGNED BY THE ARCHITECT OR ENGINEER OF RECORD AND INSTALLED TO TRANSFER WIND LOADS TO THE STRUCTURE. SUBSTRATES SHALL MEET THE MINIMUM STRENGTH REQUIREMENTS AS SHOWN IN TABLE 1, SHEET 5. CONCRETE AND MASONRY SUBSTRATES MAY NOT BE CRACKED.
9. SEALING AND FLASHING STRATEGIES FOR OVERALL WATER RESISTANCE OF INSTALLATION SHALL BE DONE BY OTHERS FOLLOWING THE CURRENT VERSION OF THE REFERENCE DOCUMENTS: FMA/AAMA 100(FIN WINDOWS), FMA/AAMA 200(FLANGE WINDOWS), FMA/WDMA 250(BOX WINDOWS), FMA/AAMA/WDMA 300(EXTERIOR DOORS)

REVISIONS		NO.:	DESCRIPTION:	BY:	DATE:
B	REVISED TO TDI REQUEST	MS	04/15/22		
A	REVISED TO TDI REQUEST	JML	3/22/17		



5/3/2022

LUCAS A. TURNER, P.E.
TX PE # 115094
2428 OLD NATCHEZ TRC TRL
CAMDEN, TN 38320
PH. 941-380-1574

SHEET DESCRIPTION:
ANCHOR SCHEDULE AND NOTES

DRAWN BY:	DATE:
EMK	11/12/15
DWG #:	REV.:
TDI-1069	B
SCALE:	SHEET
1:25	4 OF 5

**6500 PVC
DOUBLE HUNG
IMPACT**

				04/15/22	DATE:
		MS			
		JML		3/22/17	DATE:
					BY:
					NO.:
					DESCRIPTION:
					REVISIONS

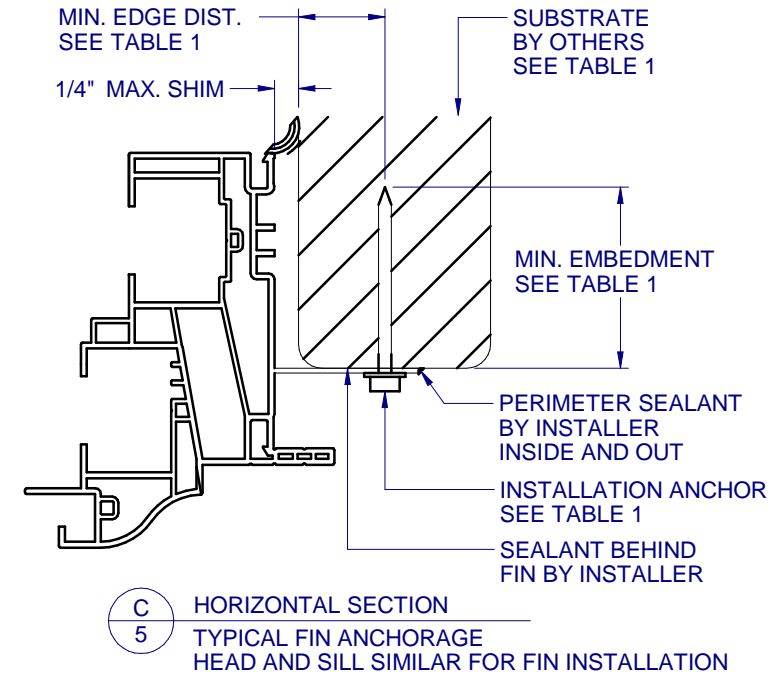
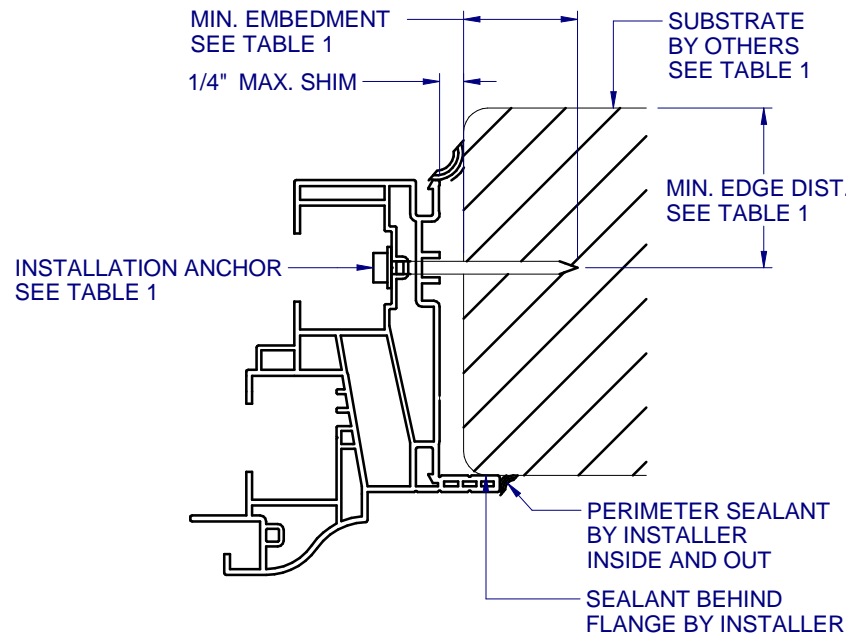
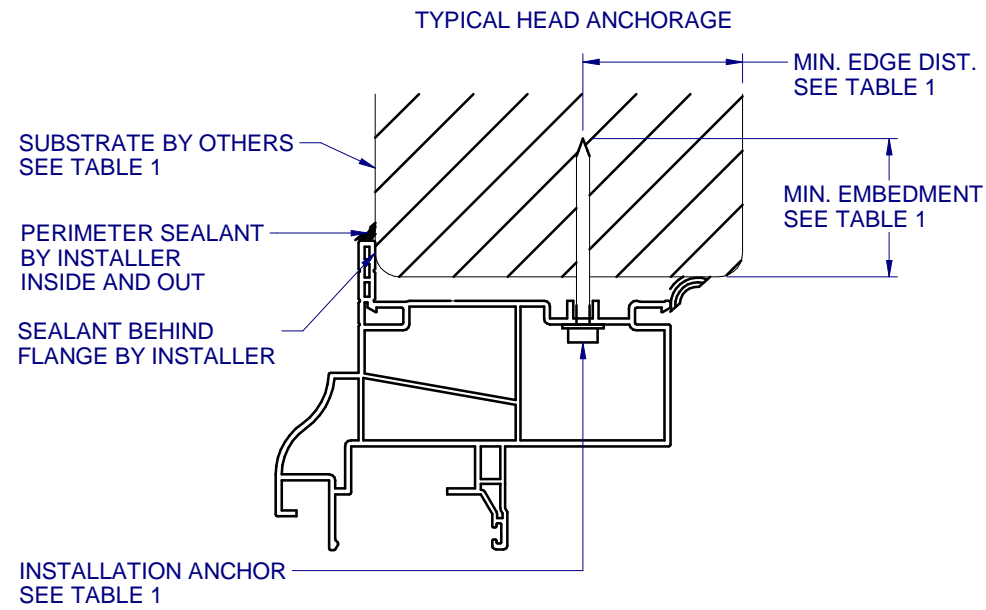

NOTE: ADDITIONAL THRU-FRAME ANCHORS (AS SHOWN IN DET. B/5) REQ'D AT MTG RAIL. SEE SHEET 4 ANCHOR LAYOUT.

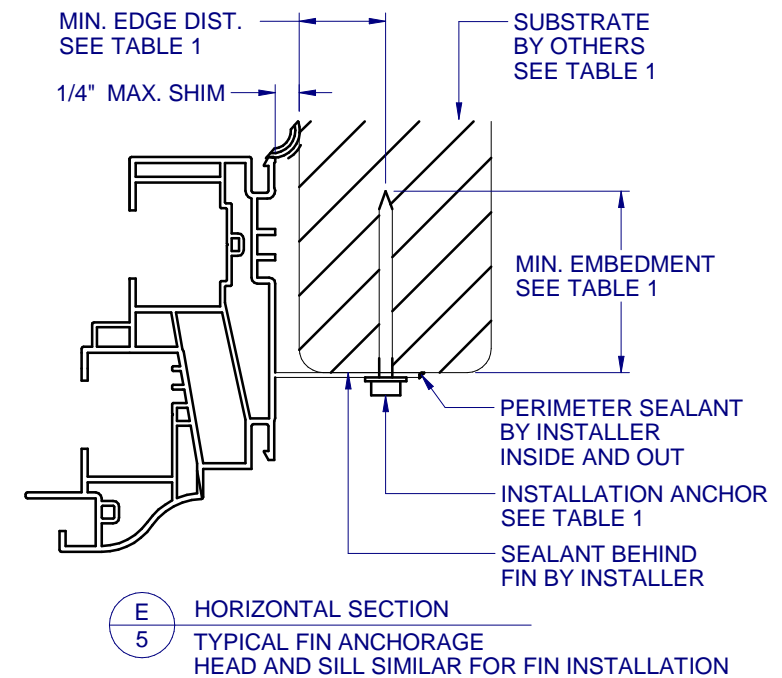
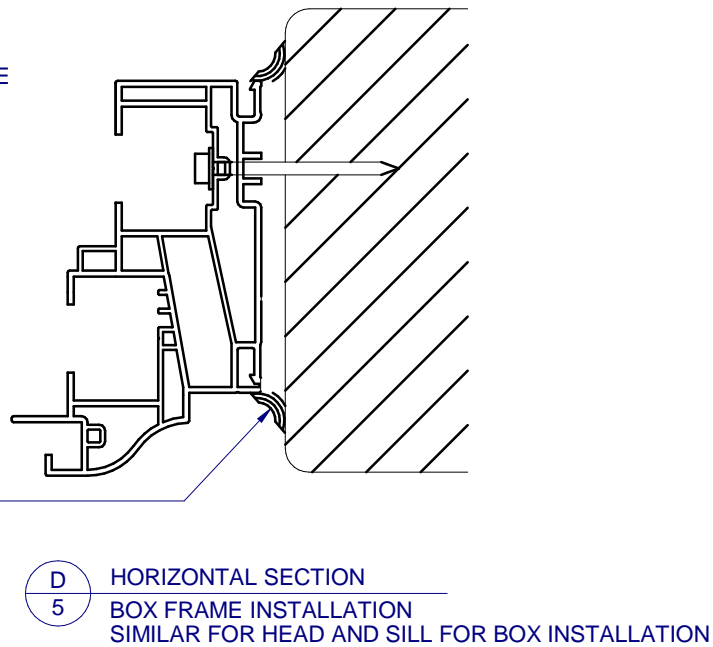
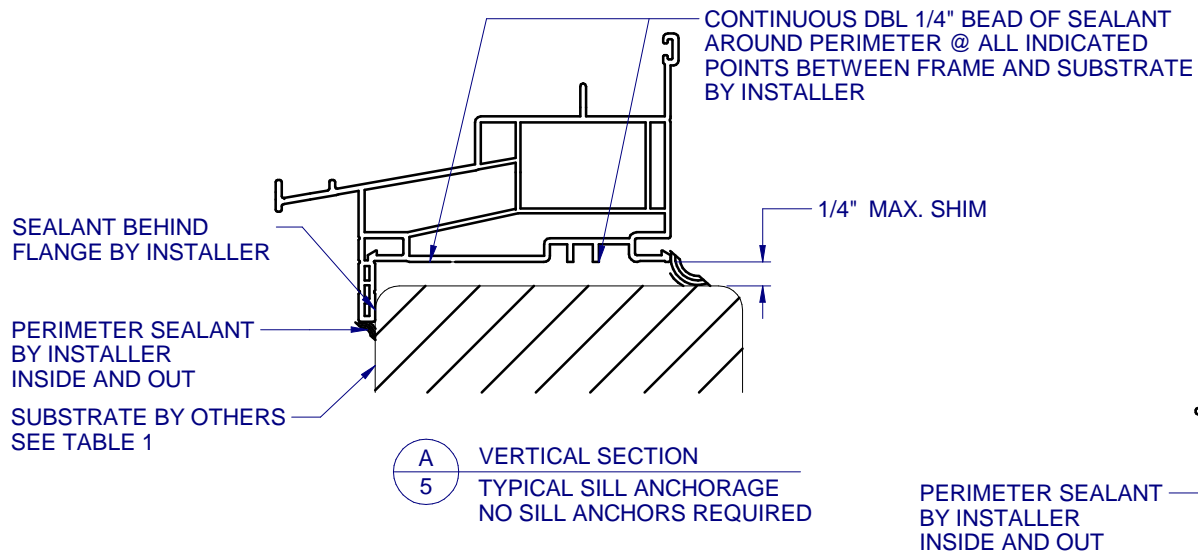

5/3/2022

LUCAS A. TURNER, P.E.
TX PE # 115094
2428 OLD NATCHEZ TRC TRL
CAMDEN, TN 38320
PH. 941-380-1574

SHEET DESCRIPTION:

INSTALLATION DETAILS

DRAWN BY:	DATE:
EMK	11/12/15
DWG #:	REV.:
TDI-1069	B
SCALE:	SHEET
1:2	5 OF 5

TABLE 1: APPROVED INSTALLATION FASTENERS

FRAME TYPE	SUBSTRATE TYPE	ANCHOR TYPE	MIN. EMBEDMENT	MIN. EDGE DIST.
FLANGE	CONCRETE (2.0 KSI MIN.)	3/16" ITW TAPCON	1-1/2"	1-1/8"
FLANGE	HOLLOW OR GROUT-FILLED CMU (117 PCF MIN.)	3/16" ITW TAPCON	1"	2"
FLANGE	CONCRETE (2.85 KSI MIN.)	3/16" ELCO ULTRACON	1"	1"
FLANGE	GROUT-FILLED CMU (ASTM C-90)	3/16" ELCO ULTRACON	1-3/4"	2-1/2"
FLANGE	2X MIN. SOUTHERN PINE (G=0.55)	3/16" ITW TAPCON OR ELCO ULTRACON	1-3/8"	7/8"
FLANGE	2X MIN. SOUTHERN PINE (G=0.55)	#10 PHILLIPS PH SCREW	2"	7/8"
FLANGE	16 GAUGE (0.060") MIN. STEEL STUD (33 KSI YIELD MIN)	#10-16 HILTI KWIK-FLEX OR ITW TEKS SELF-DRILLING SCREW	FULL THREAD THRU 0.060"	7/16"
FLANGE	1/8" ALUM. (6063-T5 MIN.) OR 1/8" STEEL (33 KSI MIN.)	#10 GRADE 5 SELF-TAPPING / DRILLING SCREW	FULL THREAD THRU 0.125"	7/16"
FIN	2X MIN. SOUTHERN PINE (G=0.55)	#10 PHILLIPS PH SCREW	2"	1/2"

FLANGE REMOVAL NOTE: PARTIALLY OR FULLY REMOVING THE FLANGE, UP TO AND INCLUDING A BOX-FRAME APPLICATION IS ACCEPTABLE PROVIDED:

- MIN. 1/4" FILLET OF CONSTRUCTION-GRADE ADHESIVE CAULK IS APPLIED INSIDE AND OUT, FULL PERIMETER, BY INSTALLER.
- PRODUCT ANCHORAGE IS IN ACCORDANCE WITH REQUIREMENTS AS SHOWN FOR FLANGE WINDOWS.