

SERIES 300/85 HP ALUMINUM SINGLE HUNG WINDOW w/ NAILING FIN "NON-IMPACT"

EVALUATED FOR USE IN THE STATE OF TEXAS

The Single Hung Window described herein complies with the 2006 International Residential Code (IRC), Sections R301 & R613 and the 2006 International Building Code (IBC), Sections 1405.12, 1609, 1714.5, 2403 and 2404 (including Texas revisions) subject to the following conditions:

1. Anchors shall be as listed and spaced as shown in the details. Anchor embedment to base material shall be beyond wall dressing or stucco.
2. When used in areas requiring wind-borne debris protection this product is required to be protected with an impact resistant covering that complies with Section R301.2.1.2 of the IRC and Section 1609.1.2 of the IBC.
3. Allowable design pressure requirements must be equal to or less than the design pressure rating shown in the design pressure chart, sheet 1 of this drawing.
4. Conditions not covered by this drawing are subject to further engineering analysis.

TABLE OF CONTENTS	
SHEET#	DESCRIPTION
1	Typical elevations, design pressures and general notes
2	Cross sections
3	Buck & frame anchoring
4	Bill of materials, glazing details & components

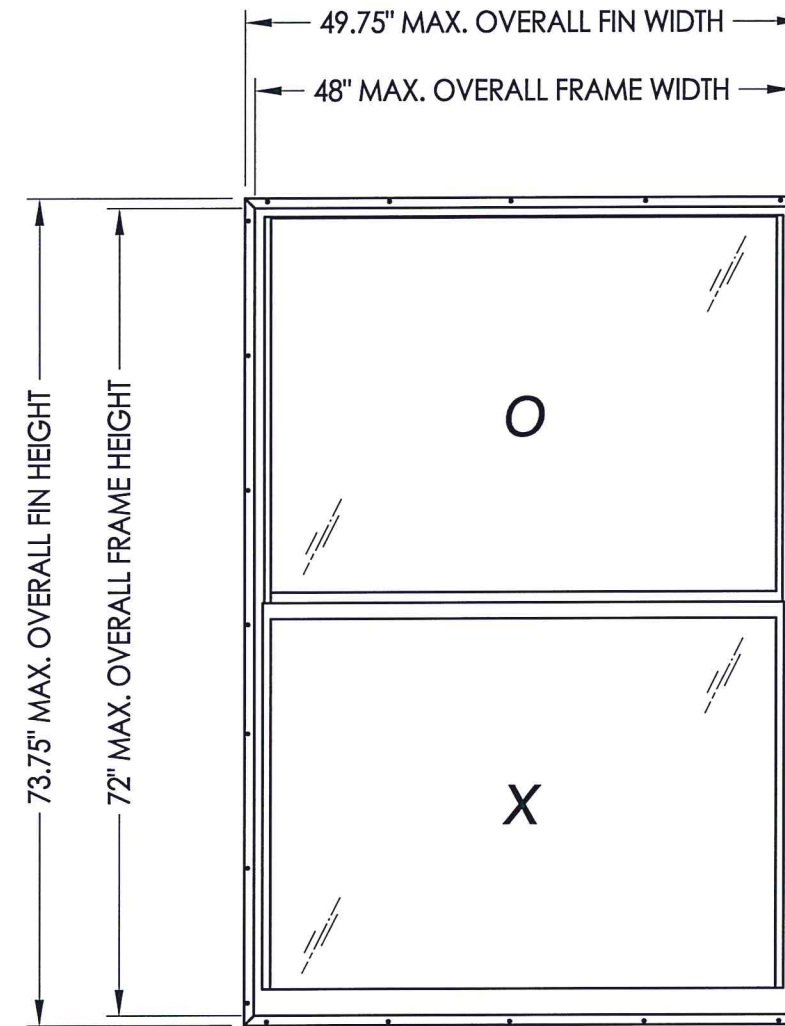

48" X 72" FRAME SHOWN

MAX. O.A. FRAME DIMENSION	MAX. D.L.O. DIMENSION	GLAZING	DESIGN PRESSURE (PSF)	
			POSITIVE	NEGATIVE
44.0" X 84.0"	41.13" X 39.5"	G1	+35.0	-35.0
48.0" X 72.0"	45.06" X 33.38"	G1	+50.0	-50.0

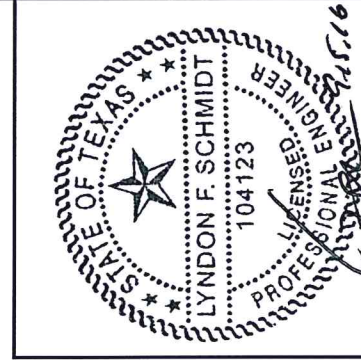

Documents Prepared By: Lyndon F. Schmidt, P.E.
 TEXAS P.E. #104123

RW BUILDING CONSULTANTS, INC.
 P.O. Box 230 Vairico FL, 33595
 Phone No.: 813.659.9197

TEXAS BOARD OF PROFESSIONAL ENGINEERS
 CERTIFICATE OF REGISTRATION # F-11852

PRODUCT: ATRIUM SINGLE HUNG WINDOW

PART OR ASSEMBLY: TYPICAL ELEVATION, DESIGN PRESSURES & GENERAL NOTES

NO.	DATE	BY	REVISIONS

DATE: 11/03/15
 SCALE: N.T.S.
 DWG. BY: JK
 CHK. BY: LFS
 DRAWING NO.: TX-4572
 SHEET 1 OF 4

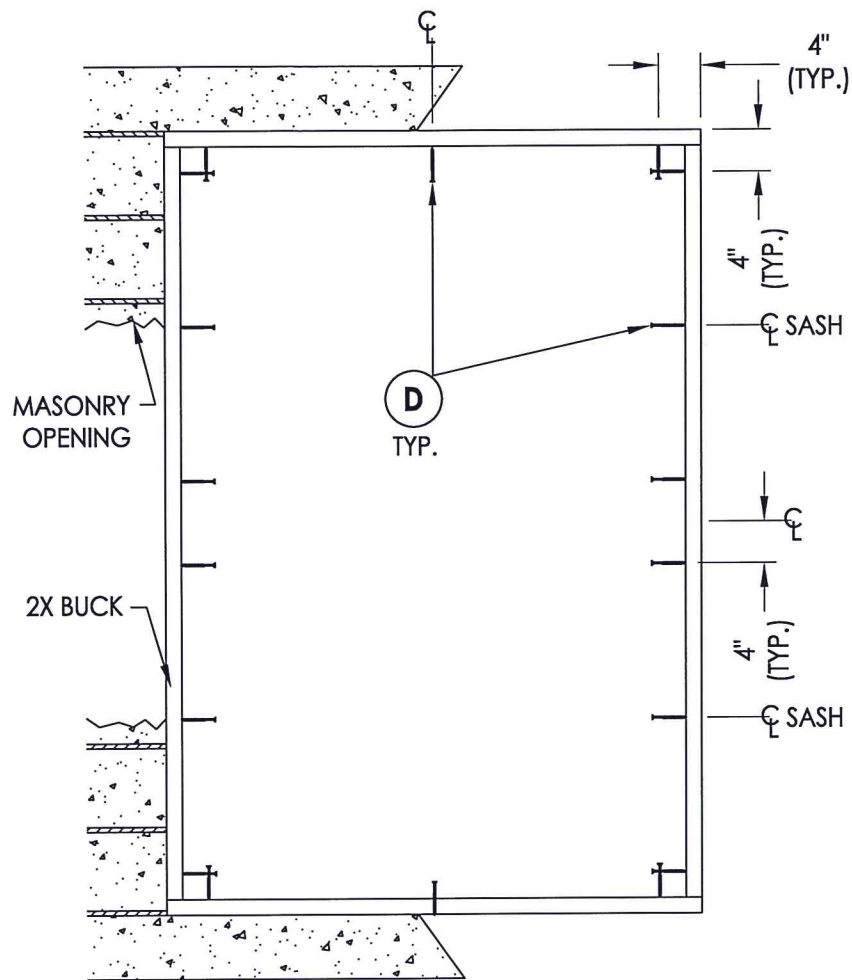

BUCK ANCHORING

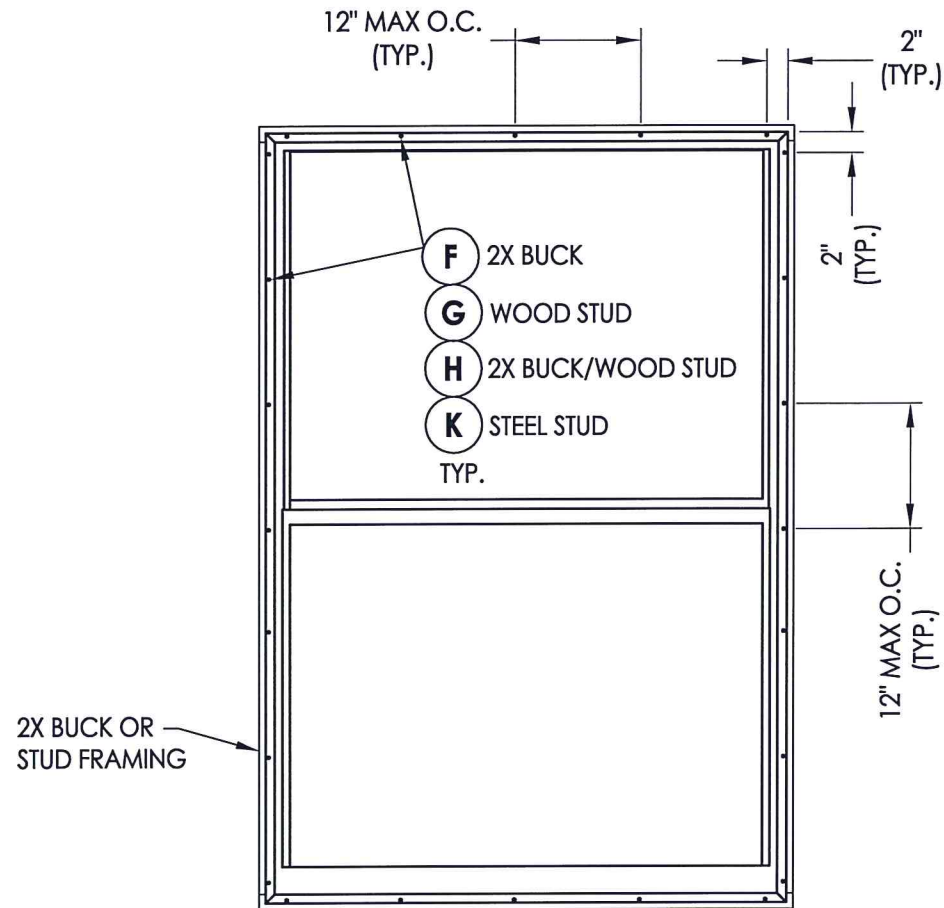

FRAME ANCHORING

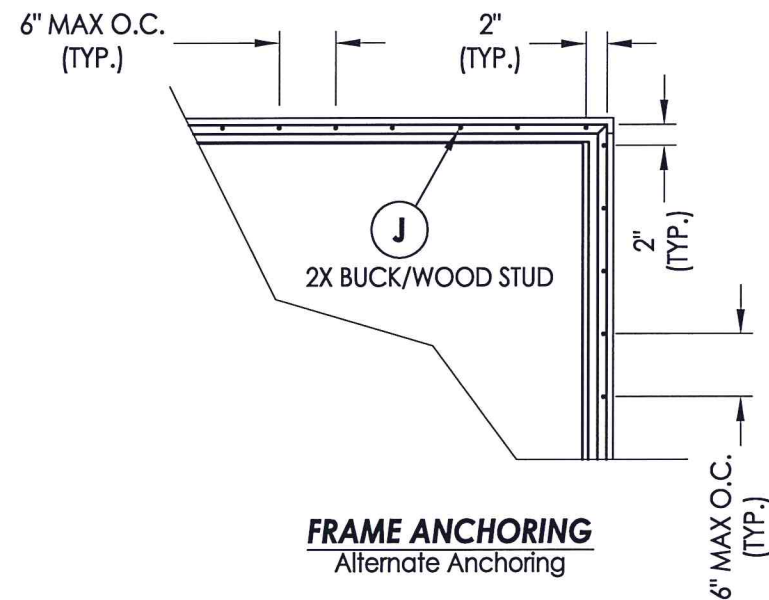

FRAME ANCHORING
Alternate Anchoring

CONCRETE ANCHOR NOTES:

1. Concrete anchor locations at the corners may be adjusted to maintain the min. edge distance to mortar joints.
2. Concrete anchor locations noted as "MAX. ON CENTER" must be adjusted to maintain the min. edge distance to mortar joints, additional concrete anchors may be required to ensure the "MAX. ON CENTER" dimension are not exceeded.
3. Concrete anchor table:

ANCHOR TYPE	ANCHOR SIZE	MIN. EMBEDMENT	MIN. CLEARANCE TO MASONRY EDGE	MIN. CLEARANCE TO ADJACENT ANCHOR
ITW TAPCON®	1/4"	1-1/4"	2"	4"
ELCO ULTRACON®	1/4"	1-1/4"	1"	4"

WOOD SCREW INSTALLATION NOTES:

1. Maintain a minimum 5/8" edge distance, 1" end distance, & 1" o.c. spacing of wood screws to prevent the splitting of wood.

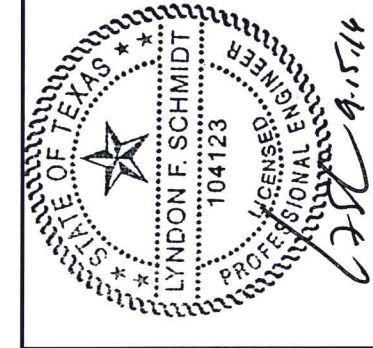

Documents Prepared By: Lyndon F. Schmidt, P.E.
TEXAS P.E. #104123
RW BUILDING CONSULTANTS, INC.
P.O. Box 230 Vairico FL 33595
Phone No.: 813.659.9197
TEXAS BOARD OF PROFESSIONAL ENGINEERS
CERTIFICATE OF REGISTRATION # F-11652

PRODUCT: ATRIUM SINGLE HUNG WINDOW
PART OR ASSEMBLY: BUCK & FRAME ANCHORING

NO.	DATE	BY

DATE: 11/03/15
SCALE: N.T.S.
DWG. BY: JK
CHK. BY: LFS
DRAWING NO.: TX-4572
SHEET 3 OF 4

BILL OF MATERIALS		
ITEM #	DESCRIPTION	MATERIAL
A	2X FRAMING (SG >= 0.42)	WOOD
B	2X BUCK (SG >= 0.42)	WOOD
C	1/8" MAX. SHIM SPACE	-
D	1/4" PFH ELCO OR ITW CONCRETE SCREW (1-1/4" MIN. EMBEDMENT)	STEEL
E	MASONRY - 3,000 PSI MIN. CONCRETE CONFORMING TO ACI 301 OR HOLLOW BLOCK CONFORMING TO ASTM C90	CONCRETE
F	#8 X 1" PH SMS (7/8" MIN. EMBEDMENT)	STEEL
G	#8 X 1-1/2" PH SMS (7/8" MIN. EMBEDMENT)	STEEL
H	10d COMMON NAIL (0.148" Ø Shank, 0.312" Ø Head)	STEEL
J	10 GAUGE ROOFING NAIL (1-3/4" LENGTH w/ 7/16" Ø Head)	STEEL
K	#10 SELF-DRILLING SMS	STEEL
X	METAL STUD Min. Thk 0.033" (ASTM A653 Grade 33, Fy=33 ksi min., Fu=45 ksi min.)	-
1	HEAD	6063-T5 ALUM
2	SILL	6063-T5 ALUM
3	JAMB	6063-T5 ALUM
4	SASH TOP RAIL	6063-T5 ALUM
5	SASH BOTTOM RAIL	6063-T5 ALUM
6	FIXED MEETING RAIL	6063-T5 ALUM
7	SASH STILE	6063-T5 ALUM
9	SASH STOP	PVC
10	GLAZING BEAD	PVC
11	PILE WEATHERSTRIP w/ FIN	-
12	3/8" Ø BULB SEAL	VINYL
13	SASH LOCKS (2)	-

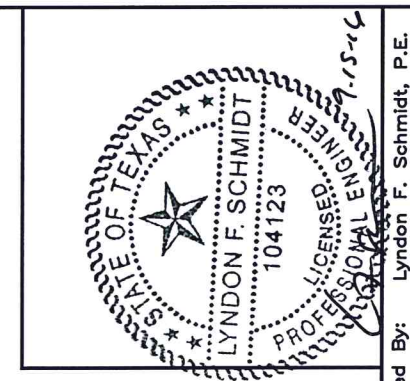
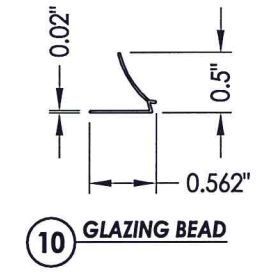
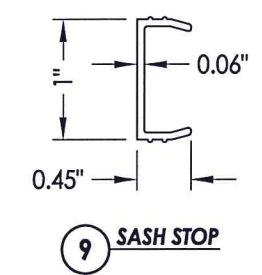
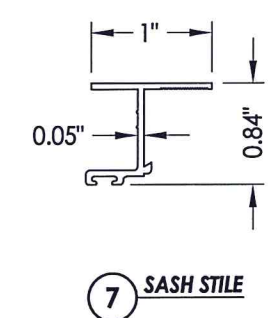
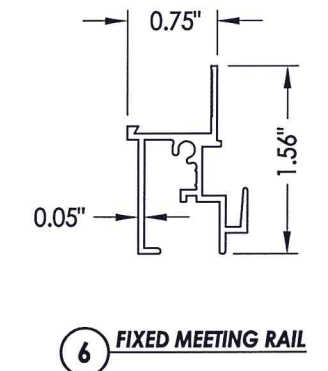
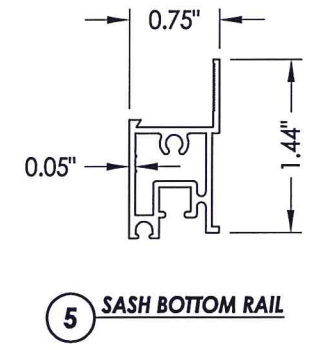
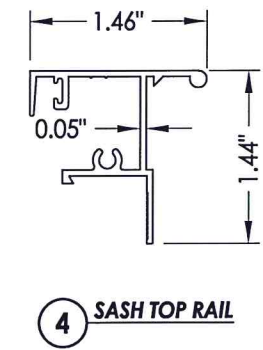
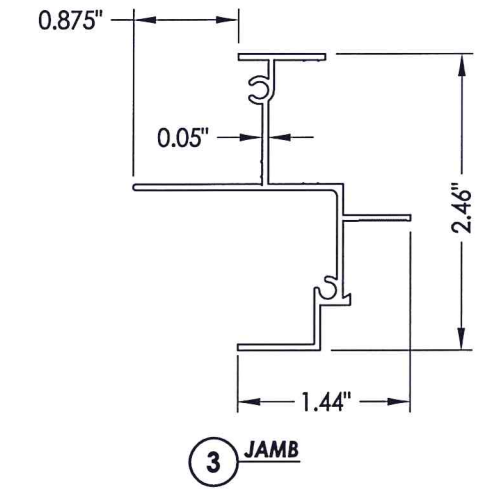
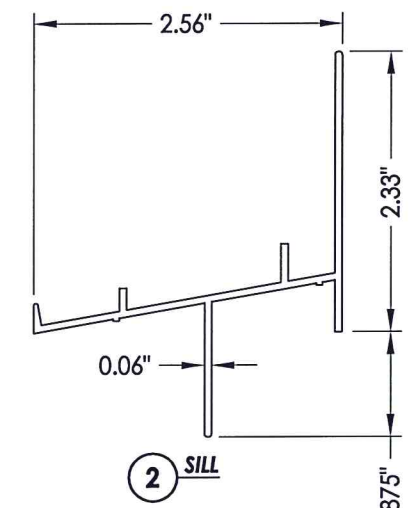
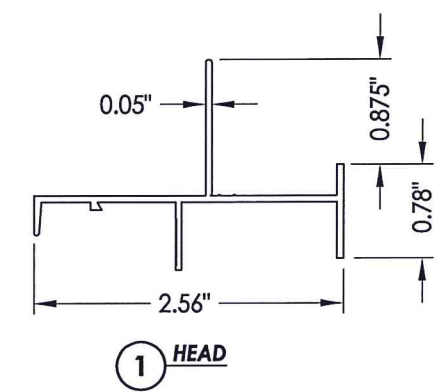
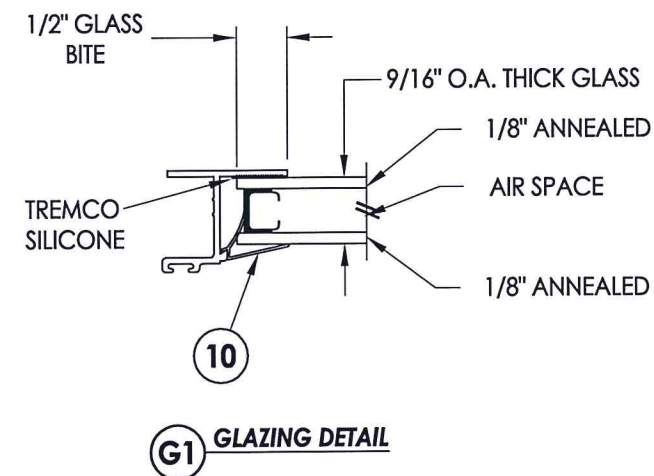

Documents Prepared By: Lyndon F. Schmidt, P.E.
TEXAS P.E. #104123

R.W. BUILDING CONSULTANTS, INC.
P.O. Box 230 Valrico FL, 33595
Phone No.: 813.659.9197

TEXAS BOARD OF PROFESSIONAL ENGINEERS
CERTIFICATE OF REGISTRATION # F-11852

PRODUCT: ATRIUM SINGLE HUNG WINDOW

PART OR ASSEMBLY: BILL OF MATERIALS, GLAZING DETAIL & COMPONENTS

NO.	DATE	BY	REVISIONS

DATE: 11/03/15
SCALE: N.T.S.
DWG. BY: JK
CHK. BY: LFS
DRAWING NO.: TX-4572
SHEET 4 OF 4