

WINCORE™

WINDOWS & DOORS

250 Staunton Turnpike, Parkersburg, WV 26104

400 Series Vinyl Single Hung Window "NON-IMPACT"

EVALUATED FOR USE IN THE STATE OF TEXAS

TDI WIN-2158

The Wincore Single Hung Window described herein complies with the 2018 International Residential Code (IRC), Sections R301 & R609 and the 2018 International Building Code (IBC), Sections 1404.13, 1609, 1709.5, 2403 and 2404 subject to the following conditions:

1. Anchors shall be as listed and spaced as shown in the details. Anchor embedment to base material shall be beyond wall dressing or stucco.
2. When used in areas requiring wind-borne debris protection this product is required to be protected with an impact resistant covering that complies with Section R301.2.1.2 of the IRC and Section 1609.1.2 of the IBC.
3. Allowable design pressure requirements must be equal to or less than the design pressure rating shown in the design pressure chart, sheet 1 of this drawing.
4. Conditions not covered by this drawing are subject to further engineering analysis.

TABLE OF CONTENTS

| SHEET# | DESCRIPTION |
|--------|--|
| 1 | Typical elevations, design pressures & general notes |
| 2 | Vertical & horizontal cross sections & frame anchoring |
| 3 | Bill of materials, components & glazing details |

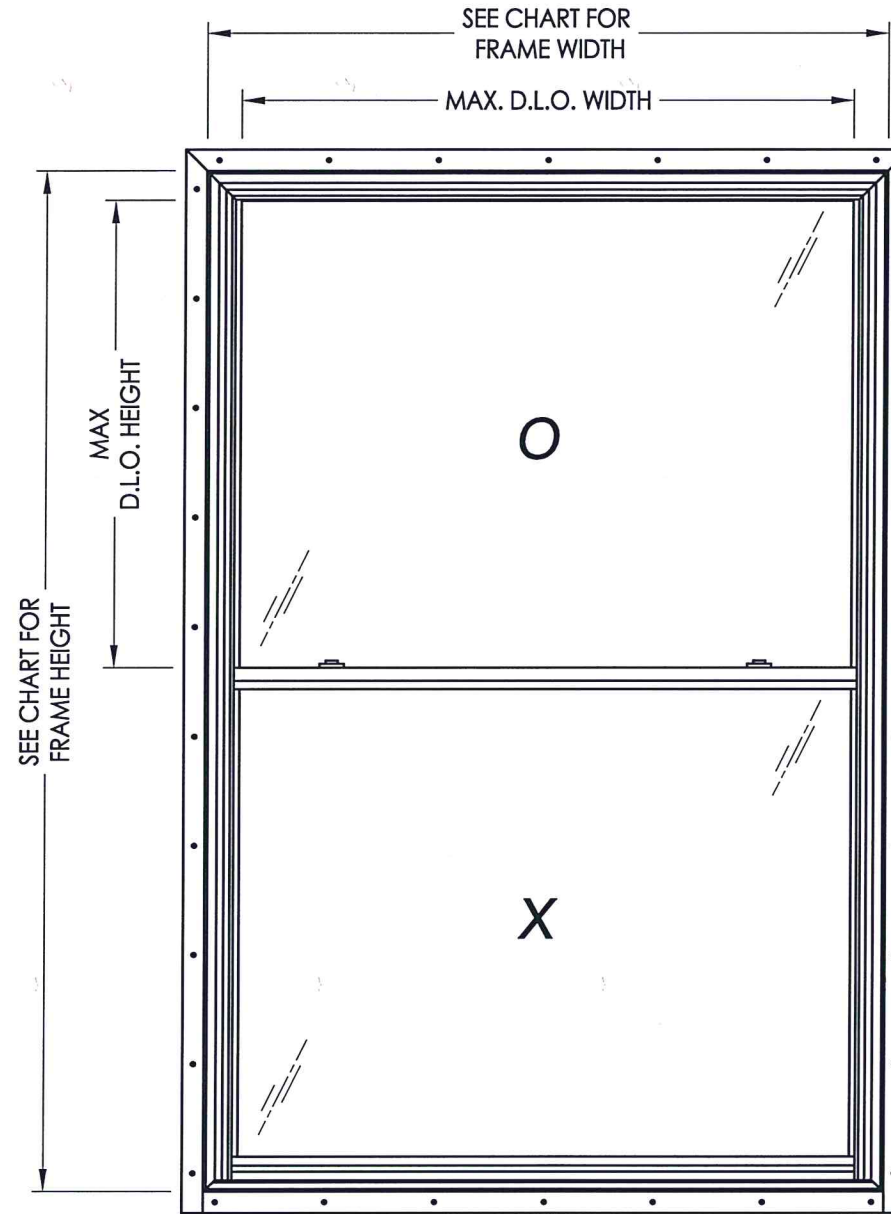

| MAX. FRAME DIMENSION | MAX. FIXED D.L.O. DIMENSION | GLASS TYPE | DESIGN PRESSURE (PSF) | | BOTTOM RAIL REINFORCEMENT REQUIRED |
|----------------------|-----------------------------|------------|-----------------------|----------|------------------------------------|
| | | | POSITIVE | NEGATIVE | |
| 36.0" X 80.0" | 31.5" X 36.75" | G1 | +50.0 | -50.0 | YES |
| 48.0" X 72.0" | 43.5" X 32.75" | G2 | +50.0 | -50.0 | YES |
| 48.0" X 96.0" | 43.5" X 55" | G2 | +40.0 | -40.0 | NO |
| 40.0" X 84.0" | 35.5" X 38.5" | G2 | +35.0 | -35.0 | YES |
| 52.0" X 77.0" | 47.5" X 35.25" | G2 | +35.0 | -35.0 | YES |
| 36.0" X 96.0" | 31.5" X 44.75" | G2 | +30.0 | -30.0 | NO |
| 48.0" X 96.0" | 43.5" X 44.75" | G3 | +30.0 | -30.0 | NO |

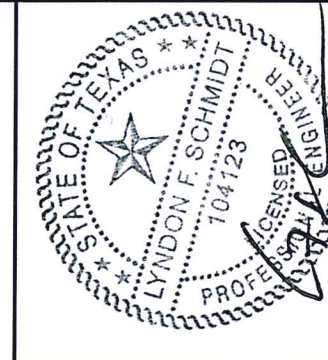

Documents Prepared By: Lyndon F. Schmidt, P.E.
TEXAS P.E. #104123

RW BUILDING CONSULTANTS, INC.
P.O. Box 230 Valrico FL, 33595
Phone No.: 813.659.9197
TEXAS BOARD OF PROFESSIONAL ENGINEERS
CERTIFICATE OF REGISTRATION # F-11852

PRODUCT: 400 SERIES Vinyl Single Hung Window
PART OR ASSEMBLY: TYPICAL ELEVATION, DESIGN PRESSURES & GENERAL NOTES

| NO. | DATE | BY | REVISIONS |
|-----|---------|-----|------------------------|
| 1 | 1/21/20 | LFS | UPDATE TO 2018 IBC/IRC |

DATE: 1/06/16
SCALE: N.T.S.
DWG. BY: JK
CHK. BY: LFS
DRAWING NO.: TX-4591
SHEET 1 OF 3

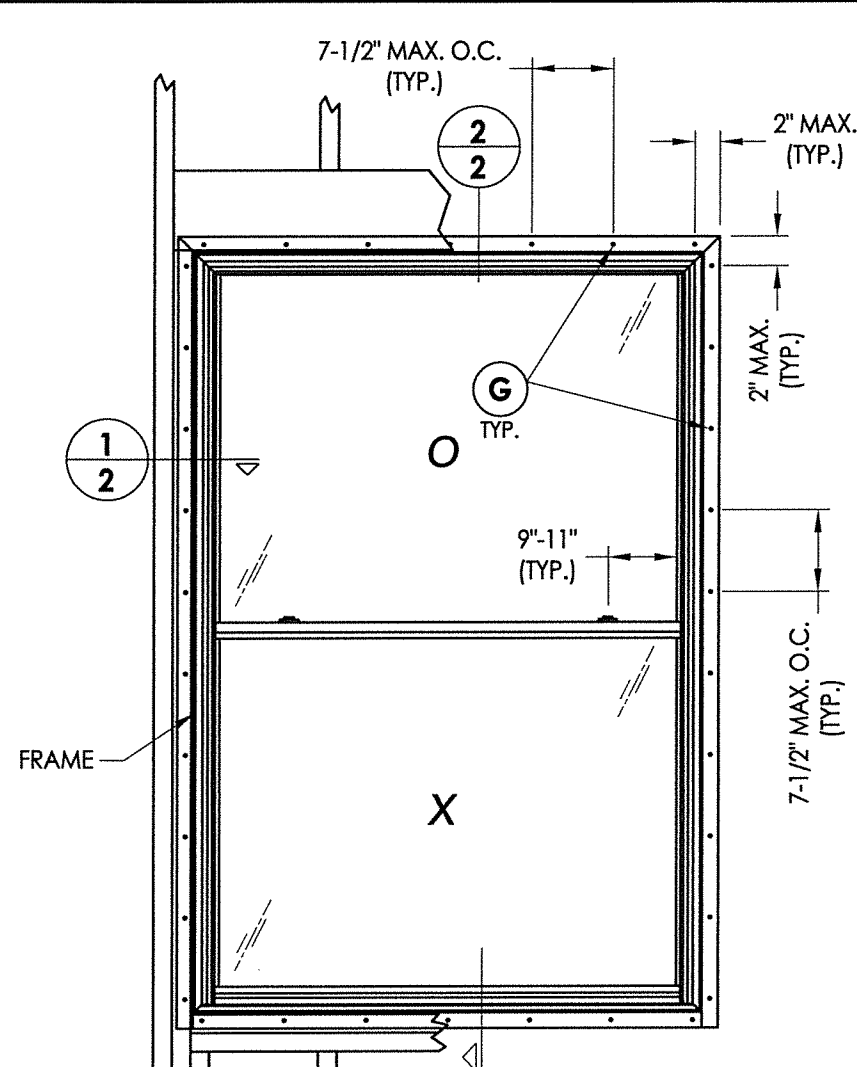

2x framing to be designed by the engineer or architect of record.

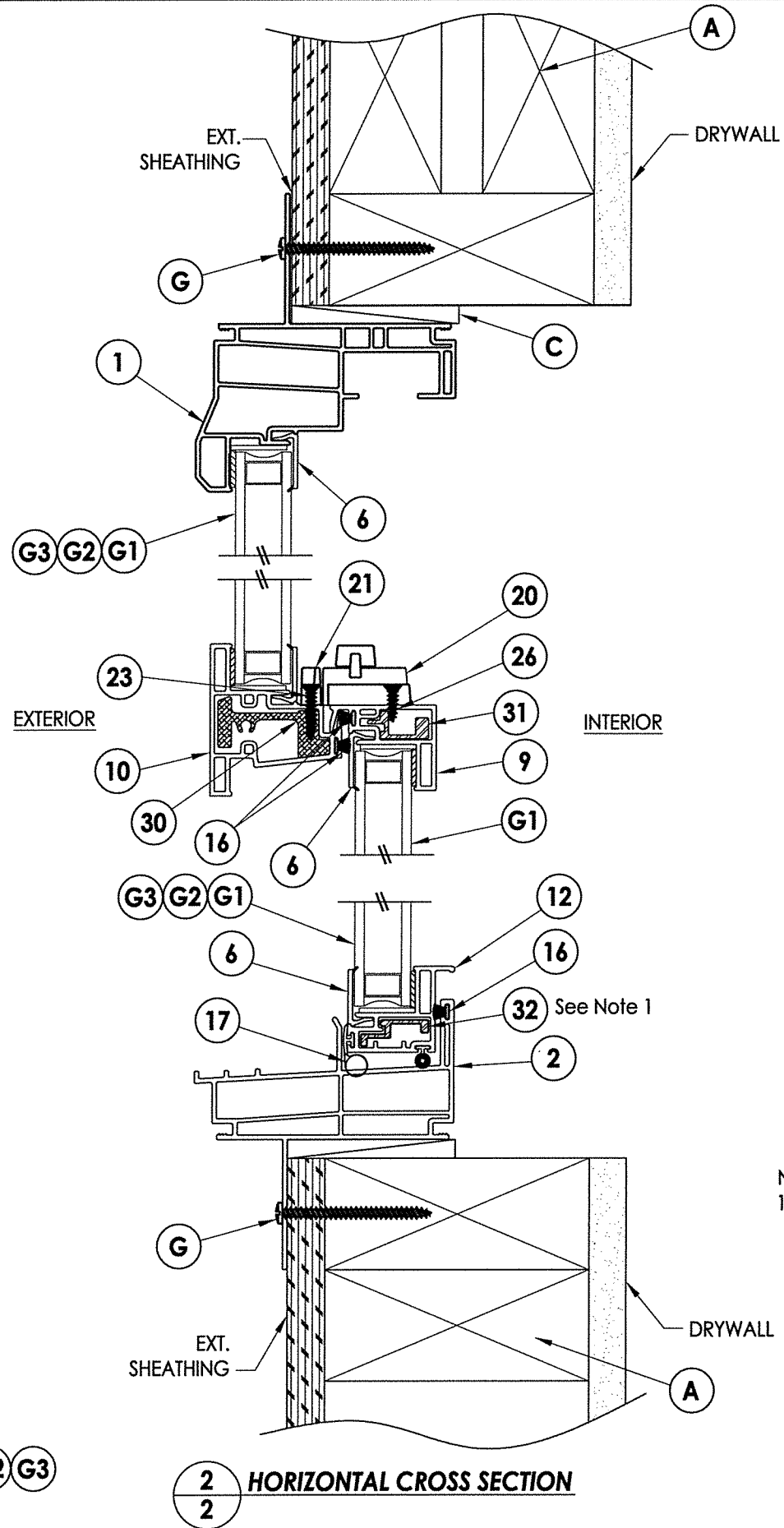
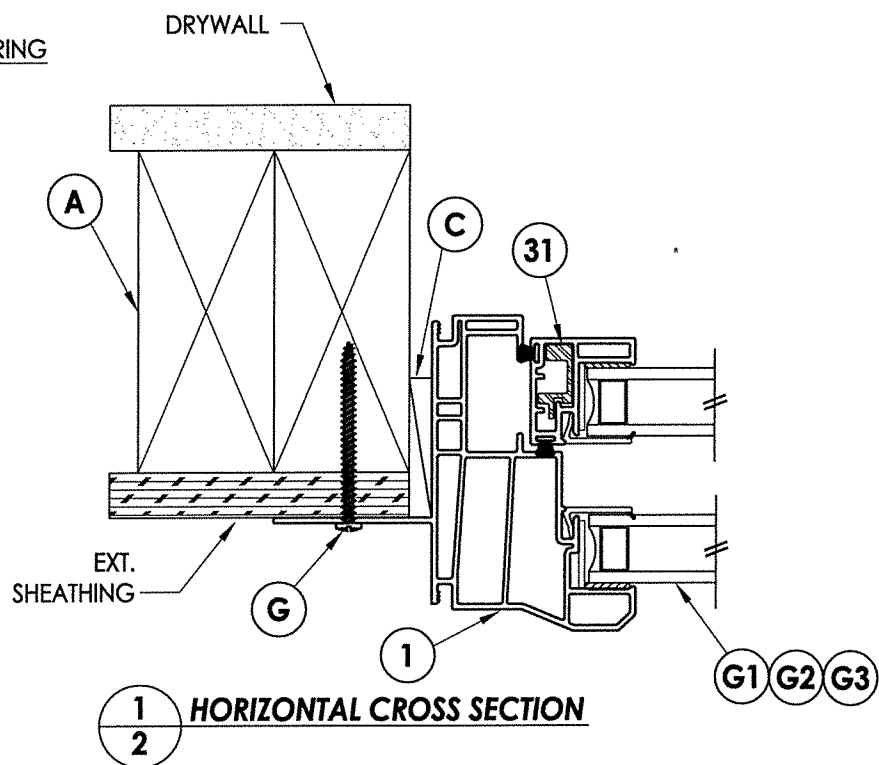

Note:
1. See Sheet 1 for bottom rail reinforcement requirements.

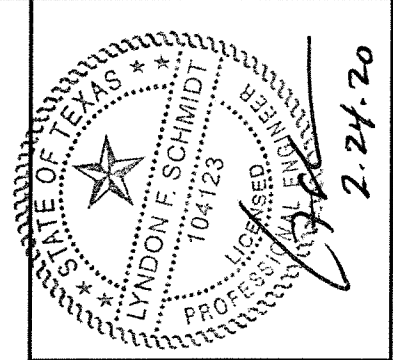

| | | |
|--|--|------------------------|
| Documents Prepared By: Lyndon F. Schmidt, P.E. TEXAS P.E. #104123 | | |
| RW BUILDING CONSULTANTS, INC. P.O. Box 230 Vairico FL, 33595 Phone No.: 813.659.9197 | | |
| PRODUCT: | 400 SERIES Vinyl Single Hung Window | |
| PART OR ASSEMBLY: | VERTICAL & HORIZONTAL CROSS SECTIONS & FRAME ANCHORING | |
| DATE: | 1/06/16 | |
| SCALE: | N.T.S. | |
| DWG. BY: | JK | |
| CHK. BY: | LFS | |
| DRAWING NO.: | TX-4591 | |
| SHEET | 2 OF 3 | |
| NO. | DATE | REVISIONS |
| 1 | 1/21/20 | UPDATE TO 2018 IBC/IRC |
| LFS | | BY |

| BILL OF MATERIALS | | |
|-------------------|--|----------|
| ITEM # | DESCRIPTION | MATERIAL |
| A | 2X FRAMING SG >= 0.42 | WOOD |
| C | 1/4" MAX. SHIM SPACE | - |
| G | #8 X 2-1/2" PFH WOOD SCREW (1-3/4" MIN. EMBEDMENT) | STEEL |
| 1 | FRAME HEAD AND JAMB* | PVC |
| 2 | FRAME SILL* | PVC |
| 5 | SASH STILE* | PVC |
| 6 | GLAZING BEAD* | PVC |
| 9 | LOCK RAIL LOWER SASH* | PVC |
| 10 | STAYBAR* | PVC |
| 12 | BOTTOM RAIL LOWER SASH* | PVC |
| 16 | WEATHERSTRIP ULTRA FAB .270 PILE - 270 -1875B | - |
| 17 | WEATHERSTRIP SILLBULB (AMESBURY 32690) | - |
| 20 | LOCK 8513 / 8845 LAWRENCE | PVC |
| 21 | KEEPER 2700 - 214 LAWRENCE | PVC |
| 23 | #6 X 3/4" PFH (VINYL LOCK SCREWS) | STEEL |
| 24 | SASH TILT LATCH - ASHLAND | PVC |
| 26 | #6 X 1/2" PFH (VINYL LOCK SCREWS) | STEEL |
| 30 | REINFORCEMENT (FIXED MEETING RAIL) ALUM. 6063-T6 | ALUM |
| 31 | REINFORCEMENT (MEETING RAIL/SASH STILES) ALUM. 6063-T6 | ALUM |
| 32 | REINFORCEMENT (BTM. RAIL) ALUM. 6063-T6 | ALUM |

* THE APPROVED WHITE RIGID PVC EXTERIOR EXTRUSIONS FOR WINDOWS ARE TO BE PRODUCED BY EXTRUDERS LICENSEES IN "AAMA CERTIFICATION PROGRAMS FOR RIGID PVC EXTRUSIONS".

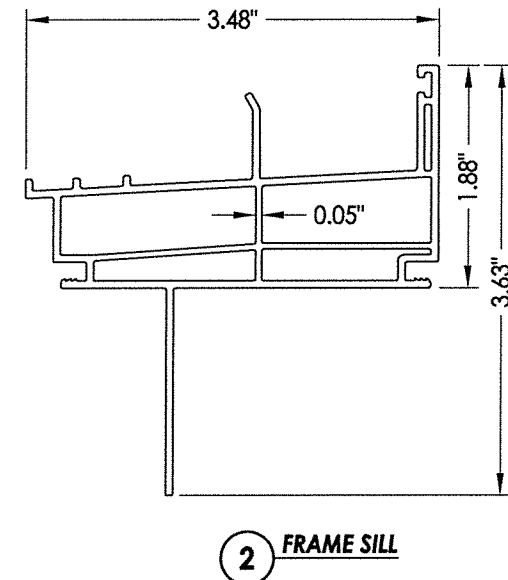
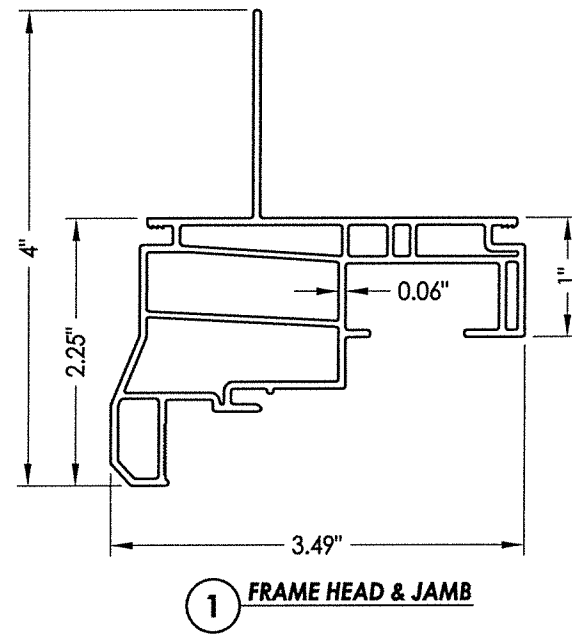

1 FRAME HEAD & JAMB

2 FRAME SILL

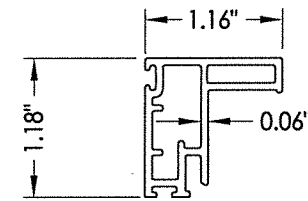

5 SASH STILE

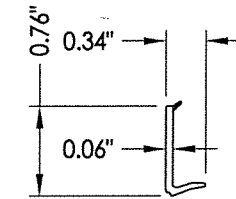

6 GLAZING BEAD

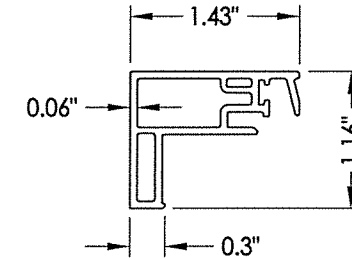

9 LOCK RAIL Lower Sash

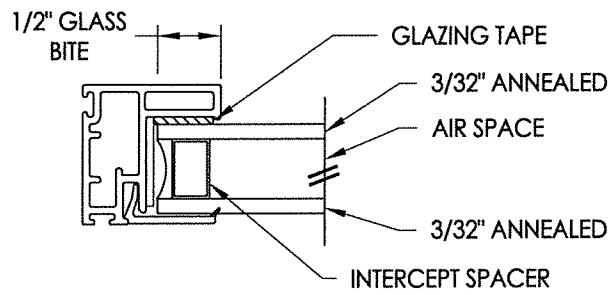

G1 GLAZING DETAIL

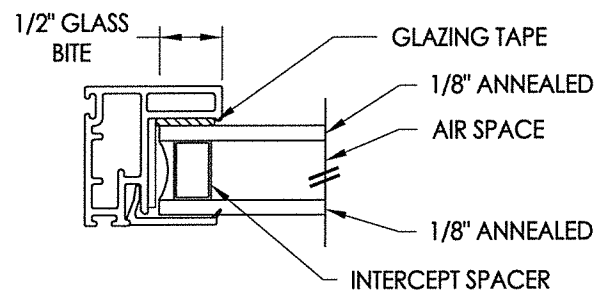

G2 GLAZING DETAIL

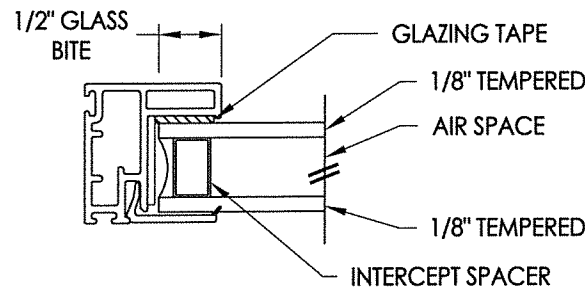

G3 GLAZING DETAIL

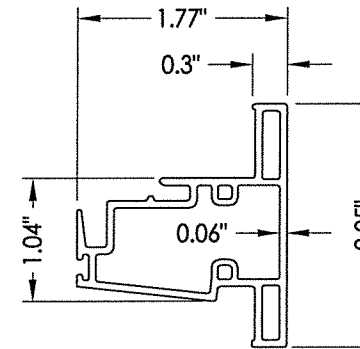

10 STAYBAR

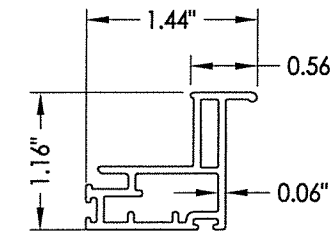

12 BOTTOM RAIL Lower Sash

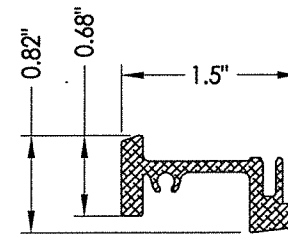

30 REINFORCEMENT FIXED MEETING RAIL

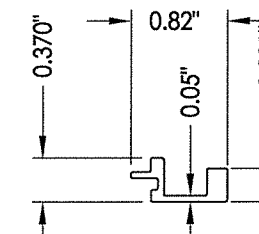

31 REINFORCEMENT MEETING RAIL/SASH STILE

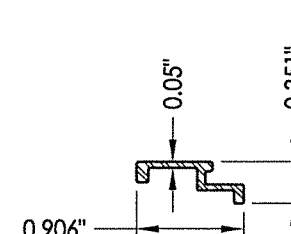

32 REINFORCEMENT BTM. RAIL

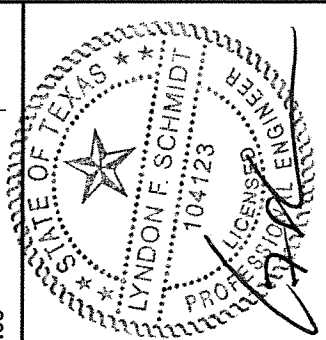

2-24-20

Documents Prepared By: Lyndon F. Schmidt, P.E.
TEXAS P.E. #104123

R.W. BUILDING CONSULTANTS, INC.
P.O. Box 230 Valrico FL 33595
Phone No.: 813.659.9197

TEXAS BOARD OF PROFESSIONAL ENGINEERS
CERTIFICATE OF REGISTRATION # F-11852

PRODUCT: 400 SERIES Vinyl Single Hung Window
PART OR ASSEMBLY: BILL OF MATERIALS & GLAZING DETAILS

| NO. | DATE | BY | REVISIONS |
|-----|---------|-----|------------------------|
| 1 | 1/21/20 | LFS | UPDATE TO 2018 IBC/IRC |

DATE: 1/06/16
SCALE: N.T.S.
DWG. BY: JK
CHK. BY: LFS
DRAWING NO.: TX-4591
SHEET 3 OF 3