



100 FOURTH AVE NORTH
BAYPORT, MN 55003-1096

PH: (651) 264-5150 FX: (651) 264-5485

TITLE: A-SERIES DOUBLE HUNG WINDOW (IMPACT)

INSTALLATION & GENERAL NOTES

PREPARED BY: BUILDING DROPS, INC.
398 E. DANIA BEACH BLVD., STE. 338
DANIA BEACH, FL 33004
PH: (954) 399-8478
FAX: (954) 744-4738
WEB: www.buildingdrops.com

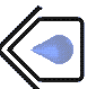

REMARKS	BY	DATE

THE INSTALLATION DETAILS DESCRIBED HEREIN ARE GENERIC AND MAY NOT REFLECT ACTUAL CONDITIONS FOR A SPECIFIC SITE. IF SITE CONDITIONS CAUSE INSTALLATION TO DEVIATE FROM THE REQUIREMENTS DETAILED HEREIN, A LICENSED ENGINEER OR ARCHITECT SHALL PREPARE SITE SPECIFIC DOCUMENTS FOR USE WITH THIS DOCUMENT.



HERMES F. NORERO, P.E.
TEXAS P.E. No 118471
BUILDING DROPS, INC
398 E. DANIA BEACH BLVD. # 338
DANIA BEACH, FL 33004
TBPE FIRM No. 13734

DATE: 03.13.20

DWG. BY: MS

CHK. BY: HFN

SCALE: NTS

DWG. #: AWD270

SHEET:

1

OF 6

ANDERSEN CORPORATION

A-SERIES DOUBLE HUNG WINDOW (IMPACT)

INSTALLATION NOTES:

- ONE (1) INSTALLATION ANCHOR IS REQUIRED AT EACH ANCHOR LOCATION SHOWN.
- THE NUMBER OF INSTALLATION ANCHORS DEPICTED IS THE MINIMUM NUMBER OF ANCHORS TO BE USED FOR PRODUCT INSTALLATION OF THE MAXIMUM SIZE LISTED.
- INSTALL INDIVIDUAL INSTALLATION ANCHORS WITHIN A TOLERANCE OF ±1/2 INCH THE DEPICTED LOCATION & SPACING IN THE ANCHOR LAYOUT DETAILS (I.E., WITHOUT CONSIDERATION OF TOLERANCES). TOLERANCES ARE NOT CUMULATIVE FROM ONE INSTALLATION ANCHOR TO THE NEXT.
- SHIM AS REQUIRED AT EACH INSTALLATION ANCHOR WITH LOAD BEARING SHIM(S). MAXIMUM ALLOWABLE SHIM STACK TO BE 3/8 INCH. SHIM WHERE SPACE OF 1/16 INCH OR GREATER OCCURS. SHIM(S) SHALL BE CONSTRUCTED OF HIGH DENSITY PLASTIC OR BETTER.
- INSTALLATION CLIP:** FOR INSTALLATION INTO WOOD FRAMING USE TWO (2) #10 WOOD SCREWS PER LOCATION OF SUFFICIENT LENGTH TO ACHIEVE 1 1/2 INCH MINIMUM EMBEDMENT INTO WOOD SUBSTRATE.
- INSTALLATION CLIP:** FOR INSTALLATION INTO METAL STUD OR APPROVED MULLION USE TWO (2) #10-16 GR. 5 SELF-TAPPING SCREW PER LOCATION OF SUFFICIENT LENGTH TO ACHIEVE A MINIMUM OF 3 THREADS PENETRATION BEYOND METAL FRAME SUBSTRATE.
- INSTALLATION CLIP:** FOR INSTALLATION THROUGH 1X BUCK TO CONCRETE/MASONRY, OR DIRECTLY INTO CONCRETE/MASONRY, USE TWO (2) 3/16 INCH DIAMETER ITW TAPCONS OR ONE (1) 1/4" ITW TAPCON PER LOCATION OF SUFFICIENT LENGTH TO ACHIEVE 1 1/4 INCH MINIMUM EMBEDMENT. ANCHORS SHALL BE INSTALLED THROUGH CLIP SUCH THAT A MINIMUM 1 3/4" O.C. SPACING IS MAINTAINED.
- MINIMUM EMBEDMENT AND EDGE DISTANCE EXCLUDE WALL FINISHES, INCLUDING BUT NOT LIMITED TO STUCCO, FOAM, BRICK VENEER, AND SIDING.
- INSTALLATION ANCHORS AND ASSOCIATED HARDWARE MUST BE MADE OF CORROSION RESISTANT MATERIAL OR HAVE A CORROSION RESISTANT COATING.
- FOR HOLLOW BLOCK AND GROUT FILLED BLOCK, DO NOT INSTALL INSTALLATION ANCHORS INTO MORTAR JOINTS. EDGE DISTANCE IS MEASURED FROM FREE EDGE OF BLOCK OR EDGE OF MORTAR JOINT INTO FACE SHELL OF BLOCK.
- INSTALLATION ANCHORS SHALL BE INSTALLED IN ACCORDANCE WITH ANCHOR MANUFACTURER'S INSTALLATION INSTRUCTIONS, AND ANCHORS SHALL NOT BE USED IN SUBSTRATES WITH STRENGTHS LESS THAN THE MINIMUM STRENGTH SPECIFIED BY THE ANCHOR MANUFACTURER.
- INSTALLATION ANCHOR CAPACITIES FOR PRODUCTS HEREIN ARE BASED ON SUBSTRATE MATERIALS WITH THE FOLLOWING PROPERTIES:
 - WOOD - MINIMUM SPECIFIC GRAVITY OF 0.55.
 - CONCRETE - MINIMUM COMPRESSIVE STRENGTH OF 3000 PSI.
 - GROUT-FILLED CMU- UNIT STRENGTH CONFORMS TO ASTM C-90 WITH MINIMUM COMPRESSIVE STRENGTH OF 2000 PSI AND GROUT CONFORMS TO ASTM C 476, MINIMUM GROUT COMPRESSIVE STRENGTH OF 2000 PSI.
 - HOLLOW BLOCK CMU - UNIT STRENGTH CONFORMS TO ASTM C-90 WITH MINIMUM COMPRESSIVE STRENGTH OF 2000 PSI.
 - STEEL - MINIMUM YIELD STRENGTH OF 33 KSI. MINIMUM WALL THICKNESS OF 35.9 MIL (0.0359" or 20 GAUGE). MIN. 1/2" EDGE DISTANCE.
 - ALUMINUM - MINIMUM ALLOY 6063-T5. MINIMUM WALL THICKNESS OF 0.078". MIN. 1/2" EDGE DISTANCE.

GENERAL NOTES:

- THE PRODUCT SHOWN HEREIN IS DESIGNED AND MANUFACTURED TO COMPLY WITH THE 2018 INTERNATIONAL BUILDING CODE (IBC) AND 2018 INTERNATIONAL RESIDENTIAL CODE (IRC) AND HAS BEEN EVALUATED ACCORDING TO THE FOLLOWING:
 - AAMA/WDMA/CSA 101/I.S.2/A440-17
 - ASTM E1886-13a
 - ASTM E1996-14a
- ADEQUACY OF THE EXISTING STRUCTURAL CONCRETE/MASONRY, 2X FRAMING, AND METAL FRAMING AS A MAIN WIND FORCE RESISTING SYSTEM CAPABLE OF WITHSTANDING AND TRANSFERRING APPLIED PRODUCT LOADS TO THE FOUNDATION IS THE RESPONSIBILITY OF THE ENGINEER OR ARCHITECT OF RECORD FOR THE PROJECT OF INSTALLATION.
- 1X AND 2X BUCKS (WHEN USED) SHALL BE DESIGNED AND ANCHORED TO PROPERLY TRANSFER ALL LOADS TO THE STRUCTURE. BUCK DESIGN AND INSTALLATION IS THE RESPONSIBILITY OF THE ENGINEER OR ARCHITECT OF RECORD FOR THE PROJECT OF INSTALLATION.
- THE INSTALLATION DETAILS DESCRIBED HEREIN ARE GENERIC AND MAY NOT REFLECT ACTUAL CONDITIONS FOR A SPECIFIC SITE. IF SITE CONDITIONS CAUSE INSTALLATION TO DEVIATE FROM THE REQUIREMENTS DETAILED HEREIN, A LICENSED ENGINEER OR ARCHITECT SHALL PREPARE SITE SPECIFIC DOCUMENTS.
- APPROVED IMPACT PROTECTIVE SYSTEM **IS NOT REQUIRED** ON THIS PRODUCT IN AREAS REQUIRING IMPACT RESISTANCE.
- WINDOW FRAME MATERIAL: PINE
- CLADDING MATERIAL: FIBREX ® AND FIBERGLASS
- IN ACCORDANCE WITH THE FBC, WOOD COMPONENTS SHALL HAVE BEEN PRESERVATIVE TREATED OR SHALL BE OF A DURABLE SPECIES.
- GLASS MEETS THE REQUIREMENTS OF ASTM E 1300 GLASS CHARTS. SEE SHEET 4 FOR GLAZING DETAILS.

TABLE OF CONTENTS	
SHEET	SHEET DESCRIPTION
1	INSTALLATION & GENERAL NOTES
2	ELEVATION & ANCHOR LAYOUTS
3	VERTICAL SECTIONS
4	HORIZONTAL SECTIONS & GLAZING OPTIONS
5	BILL OF MATERIALS & COMPONENTS
6	COMPONENTS

OVERALL SIZE		DESIGN PRESSURE	MISSILE IMPACT RATING
WIDTH	HEIGHT		
47 1/4"	95 1/4"	+70/- 70 PSF	LARGE & SMALL MISSILE IMPACT



100 FOURTH AVE NORTH
BAYPORT, MN 55003-1096

PH: (651) 264-5150 FX: (651) 264-5485

TITLE: A-SERIES DOUBLE HUNG WINDOW (IMPACT)
ELEVATIONS & ANCHOR LAYOUTS

PREPARED BY: BUILDING DROPS, INC.
398 E. DANIA BEACH BLVD., STE. 338
DANIA BEACH, FL 33004
PH: (954) 399-8478
FAX: (954) 744-4738
WEB: www.buildingdrops.com



REMARKS	BY	DATE

THE INSTALLATION DETAILS DESCRIBED HEREIN ARE GENERIC AND MAY NOT REFLECT ACTUAL CONDITIONS FOR A SPECIFIC SITE. IF SITE CONDITIONS CAUSE INSTALLATION TO DEVIATE FROM THE REQUIREMENTS DETAILED HEREIN, A LICENSED ENGINEER OR ARCHITECT SHALL PREPARE SITE SPECIFIC DOCUMENTS FOR USE WITH THIS DOCUMENT.



HERMES F. NORERO, P.E.
TEXAS P.E. No 118471
BUILDING DROPS, INC
398 E. DANIA BEACH BLVD. # 338
DANIA BEACH, FL 33004
TBPE FIRM No. 13734

DATE:	03.13.20
DWG. BY:	MS
CHK. BY:	HFN
SCALE:	NTS
DWG. #:	AWD270
SHEET:	2

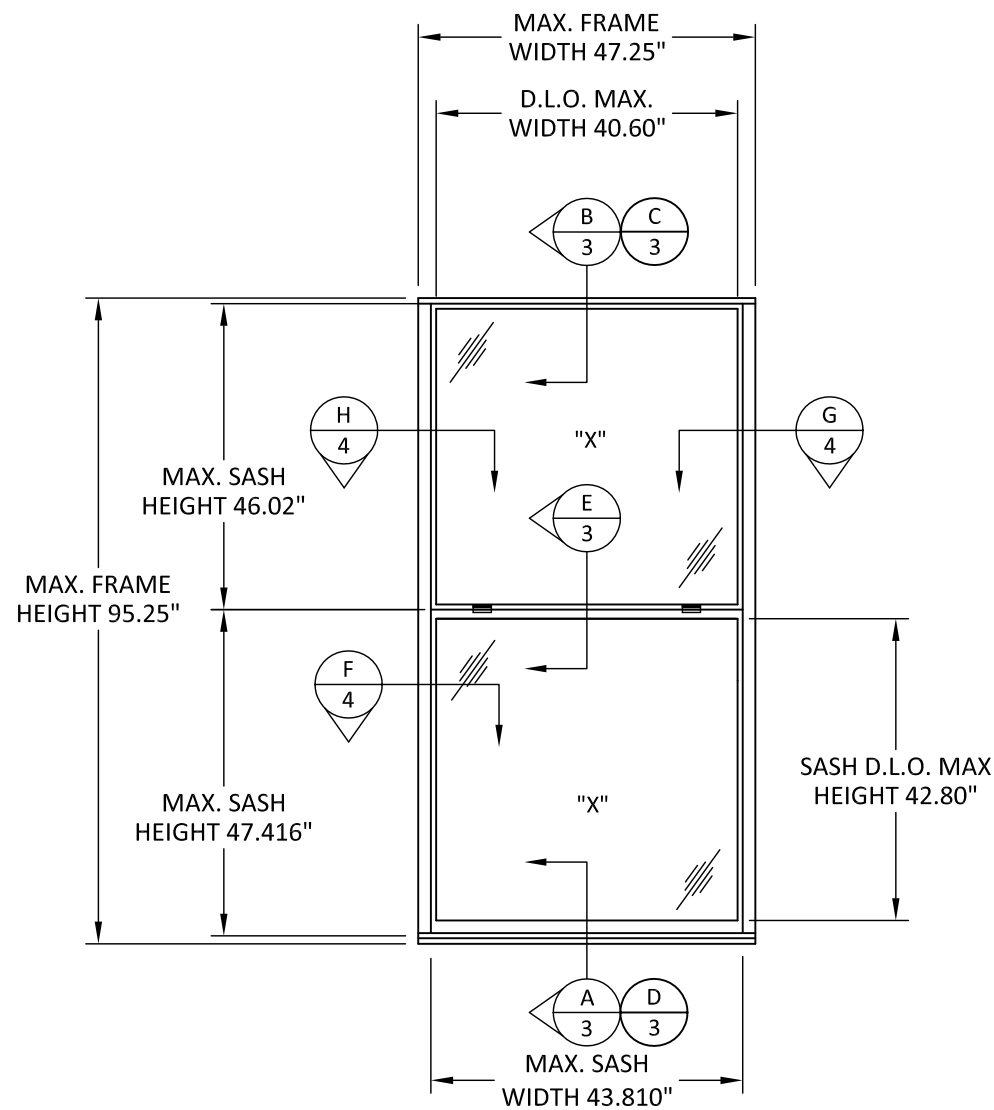

TYPICAL ELEVATION
EQUAL LITE

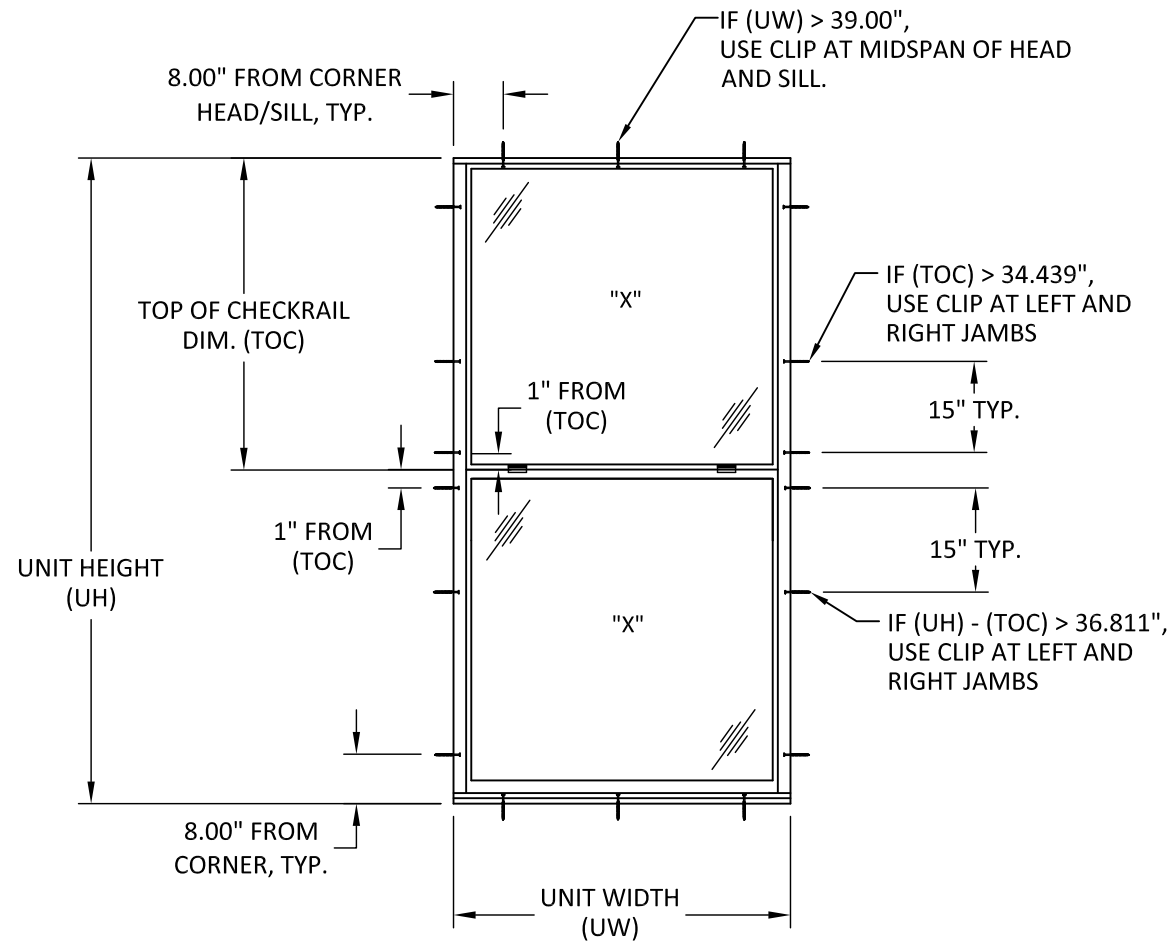

ANCHOR LAYOUT
INSTALLATION CLIPS

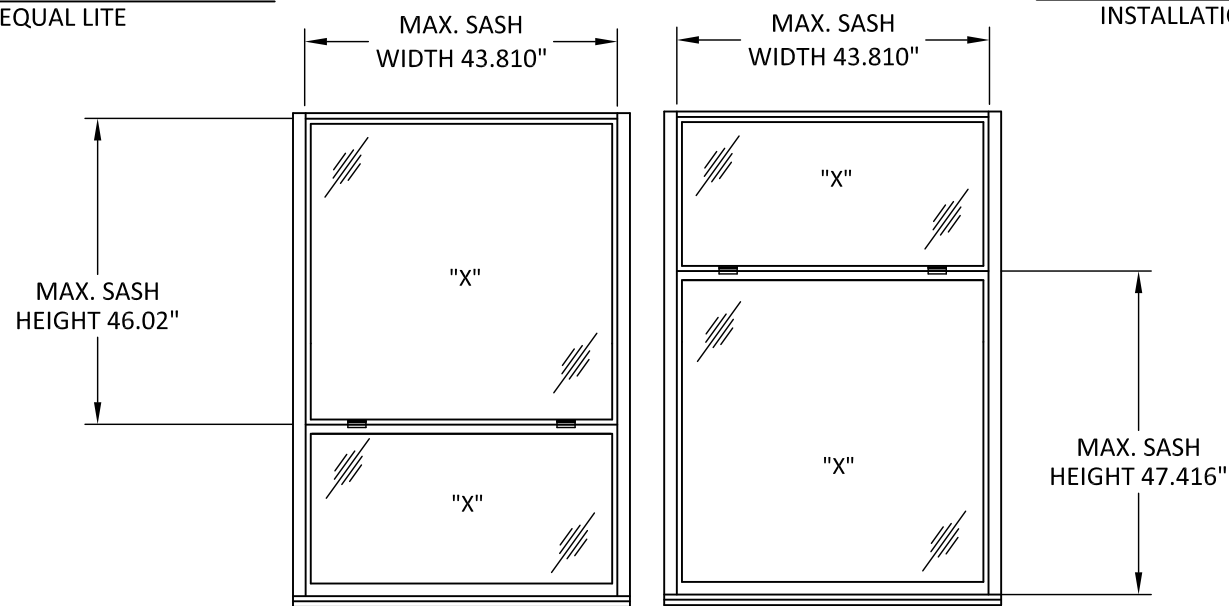

TYPICAL ELEVATION
UNEQUAL LITE

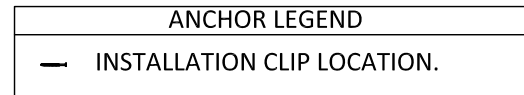

NOTE: COTTAGE AND REVERSE COTTAGE CONFIGURATIONS ARE QUALIFIED SUCH THAT MAXIMUM SASH DIMENSIONS DO NOT EXCEED THOSE SHOWN.

4/20/2020 9:20 AM s:\projects\andersen windows\tel-20-0302-1 - tdi submittal - fg reinforced mullion revision\dwg\awd270 a-series dh.dwg



100 FOURTH AVE NORTH
BAYPORT, MN 55003-1096
PH: (651) 264-5150 FX: (651) 264-5485

TITLE: A-SERIES DOUBLE HUNG WINDOW (IMPACT)
VERTICAL SECTIONS

PREPARED BY:
BUILDING DROPS, INC.
398 E. DANIA BEACH BLVD., STE. 338
DANIA BEACH, FL 33004
PH: (954) 399-8478
FAX: (954) 744-4738
WEB: www.buildingdrops.com

REMARKS	BY	DATE

THE INSTALLATION DETAILS DESCRIBED HEREIN ARE GENERIC AND MAY NOT REFLECT ACTUAL CONDITIONS FOR A SPECIFIC SITE. IF SITE CONDITIONS CAUSE INSTALLATION TO DEVIATE FROM THE REQUIREMENTS DETAILED HEREIN, A LICENSED ENGINEER OR ARCHITECT SHALL PREPARE SITE SPECIFIC DOCUMENTS FOR USE WITH THIS DOCUMENT.



HERMES F. NORERO, P.E.
TEXAS P.E. No. 118471
BUILDING DROPS, INC
398 E. DANIA BEACH BLVD., # 338
DANIA BEACH, FL 33004
TBPE FIRM No. 13734

DATE:	03.13.20
DWG. BY:	MS
CHK. BY:	HFN
SCALE:	NTS
DWG. #:	AWD270
SHEET:	3

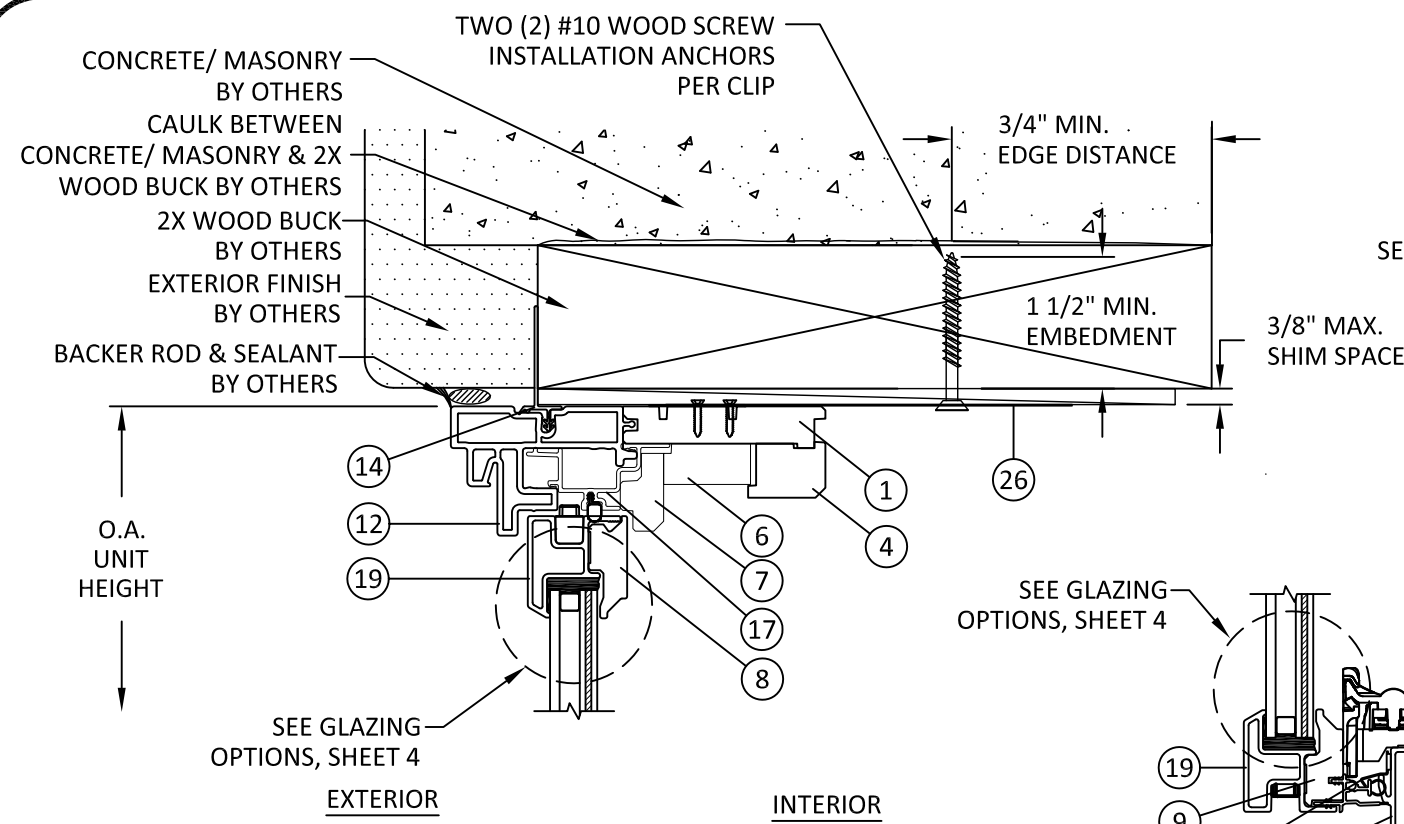

B
3
VERTICAL SECTION
HEAD - 2X WOOD BUCK
INSTALLATION CLIP

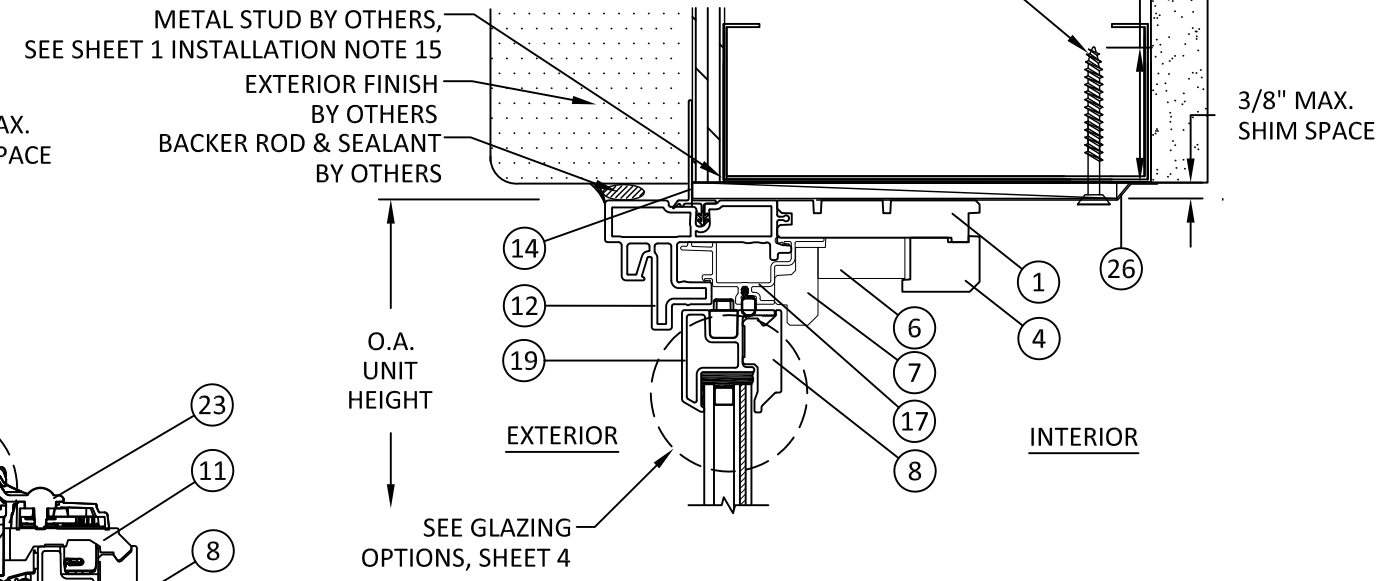

C
3
VERTICAL SECTION
HEAD - METAL STUD
INSTALLATION CLIP

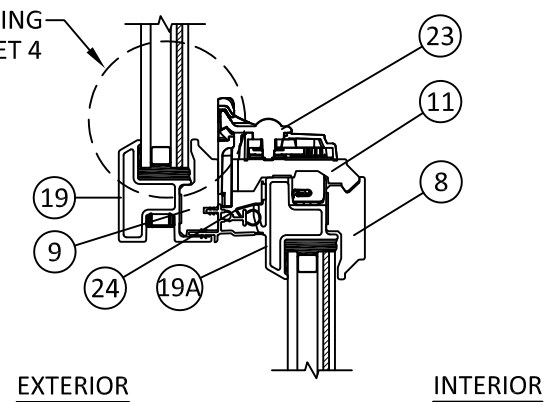

E
3
VERTICAL SECTION
MEETING RAIL

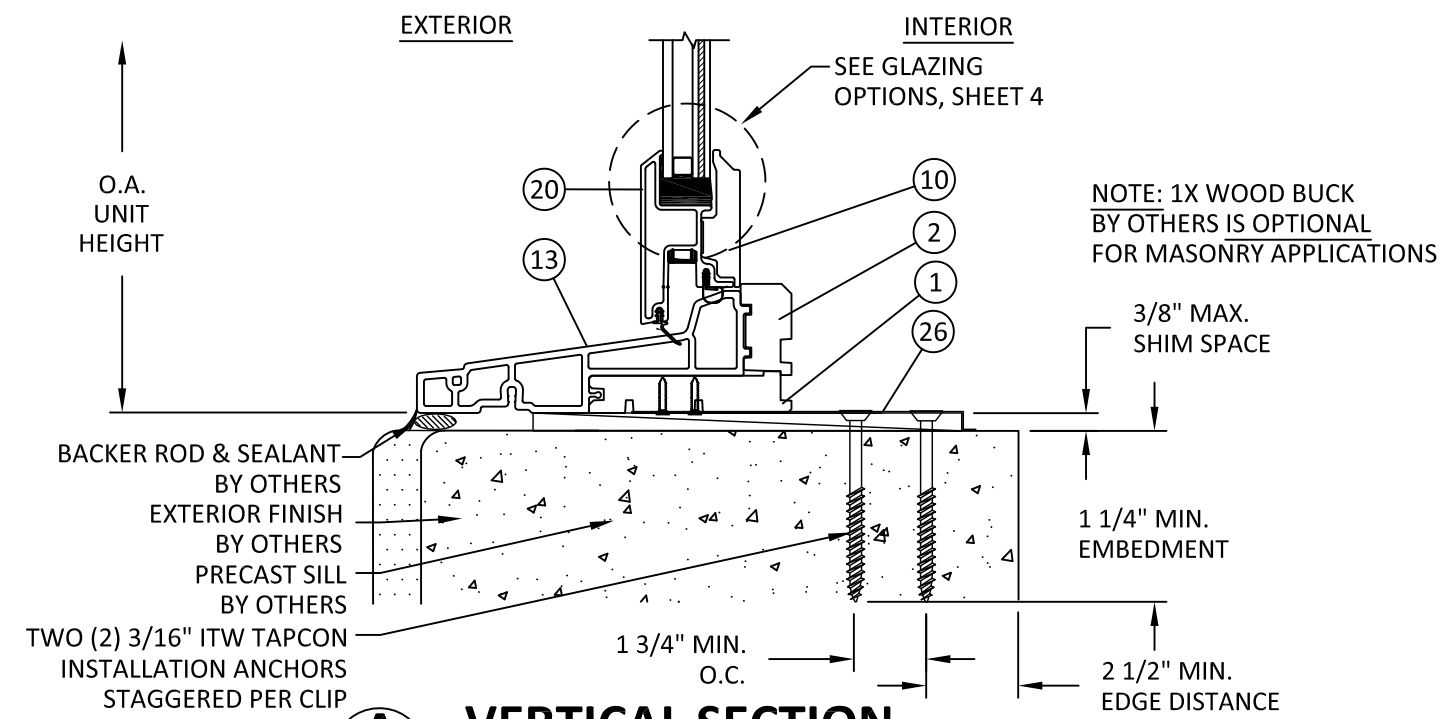

A
3
VERTICAL SECTION
SILL - CONCRETE/MASONRY
INSTALLATION CLIP

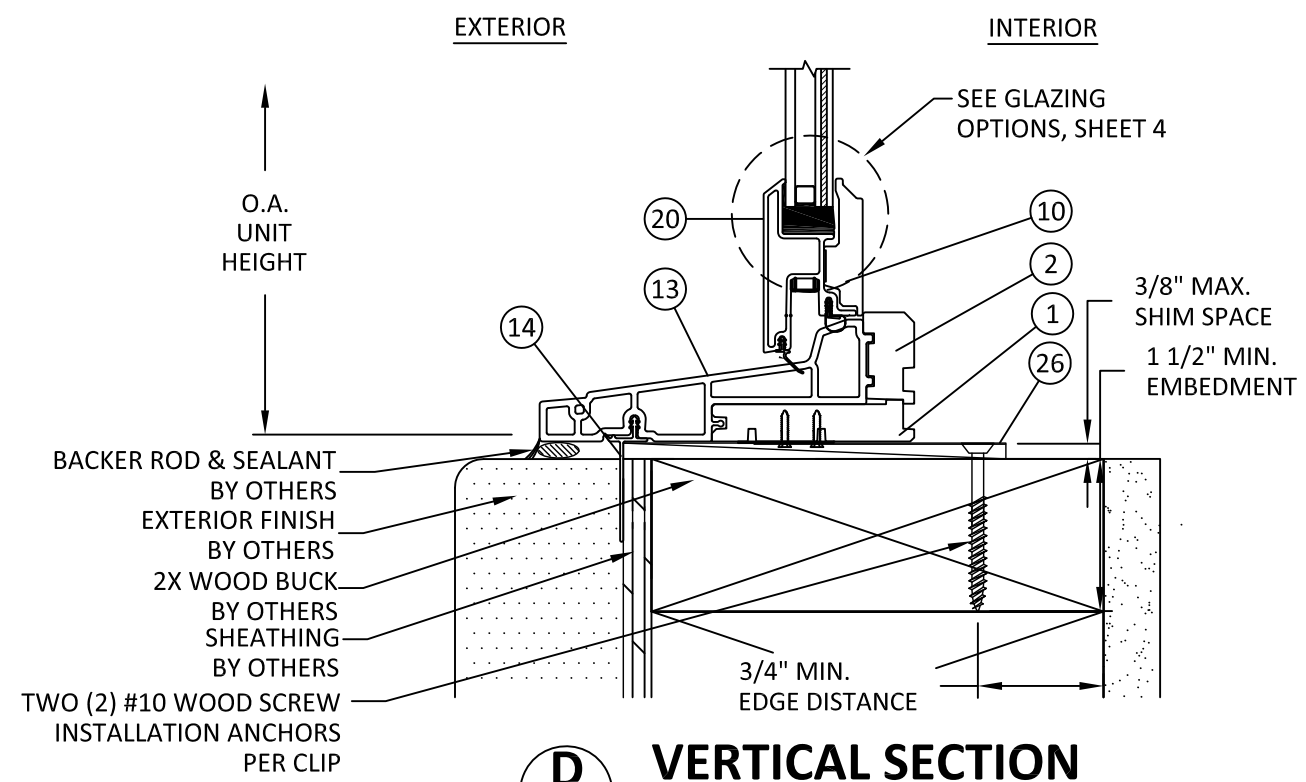

D
3
VERTICAL SECTION
SILL - 2X WOOD FRAME
INSTALLATION CLIP

4/20/2020 9:21 AM s:\projects\andersen_windows\tdr-20-0302-1 - tdr submittal - fig reinforced mullion revision\dwg\awd270 a-series dh.dwg



100 FOURTH AVE NORTH
BAYPORT, MN 55003-1096

PH: (651) 264-5150 FX: (651) 264-5485

TITLE: A-SERIES DOUBLE HUNG WINDOW (IMPACT)
HORIZONTAL SECTIONS & GLAZING OPTIONS

PREPARED BY: BUILDING DROPS, INC.
398 E. DANIA BEACH BLVD., STE. 338
DANIA BEACH, FL 33004
PH: (954) 399-8478
FAX: (954) 744-4738
WEB: www.buildingdrops.com

REMARKS	BY	DATE

THE INSTALLATION DETAILS DESCRIBED HEREIN ARE GENERIC AND MAY NOT REFLECT ACTUAL CONDITIONS FOR A SPECIFIC SITE. IF SITE CONDITIONS CAUSE INSTALLATION TO DEVIATE FROM THE REQUIREMENTS DETAILED HEREIN, A LICENSED ENGINEER OR ARCHITECT SHALL PREPARE SITE SPECIFIC DOCUMENTS FOR USE WITH THIS DOCUMENT.



HERMES F. NORERO, P.E.
TEXAS P.E. No. 118471
BUILDING DROPS, INC
398 E. DANIA BEACH BLVD. # 338
DANIA BEACH, FL 33004
TBPE FIRM No. 13734

DATE:	03.13.20
DWG. BY:	MS
CHK. BY:	HFN
SCALE:	NTS
DWG. #:	AWD270
SHEET:	4

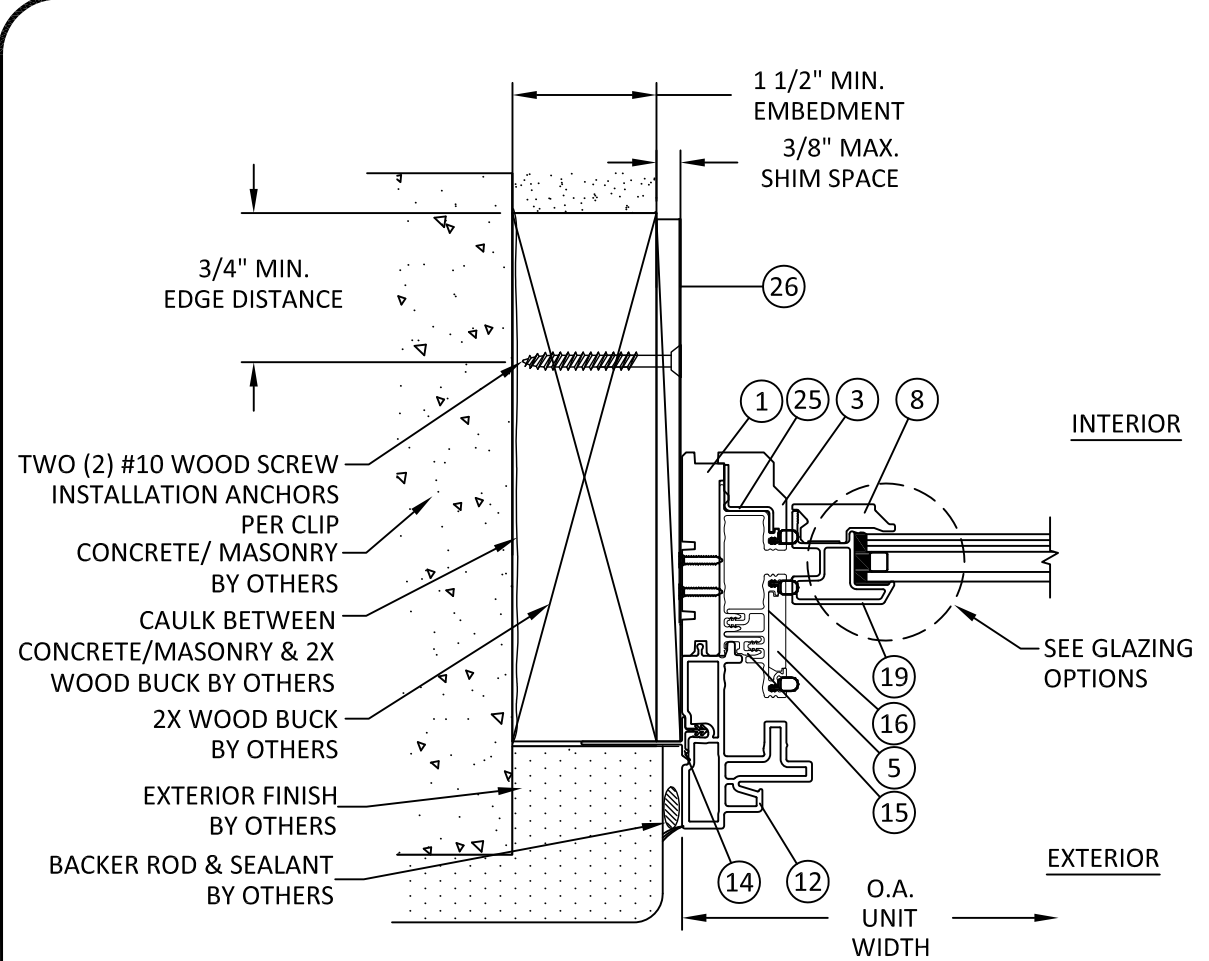

F4 HORIZONTAL SECTION
JAMB - 2X WOOD BUCK
INSTALLATION CLIP

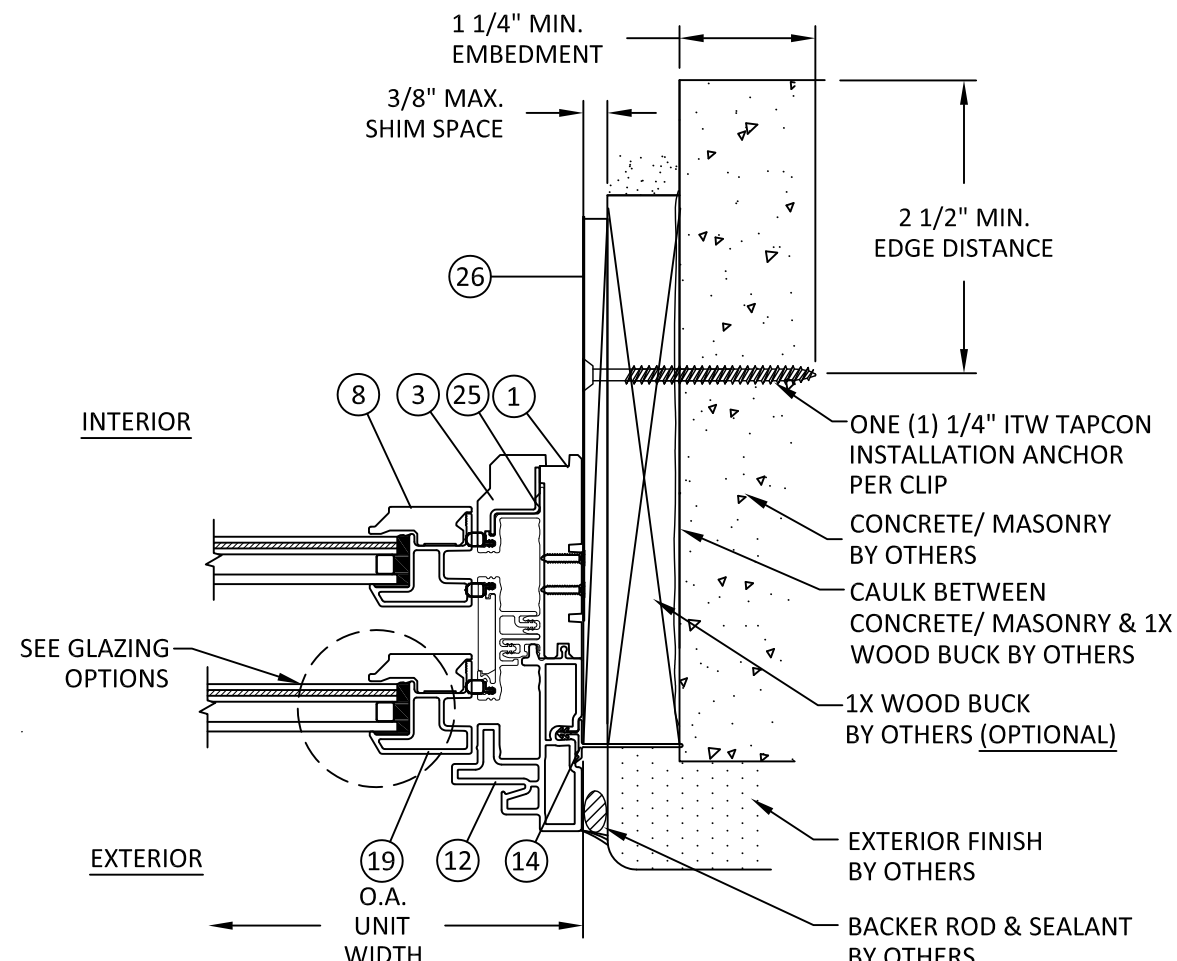

G4 HORIZONTAL SECTION
JAMB - CONCRETE/MASONRY
INSTALLATION CLIP

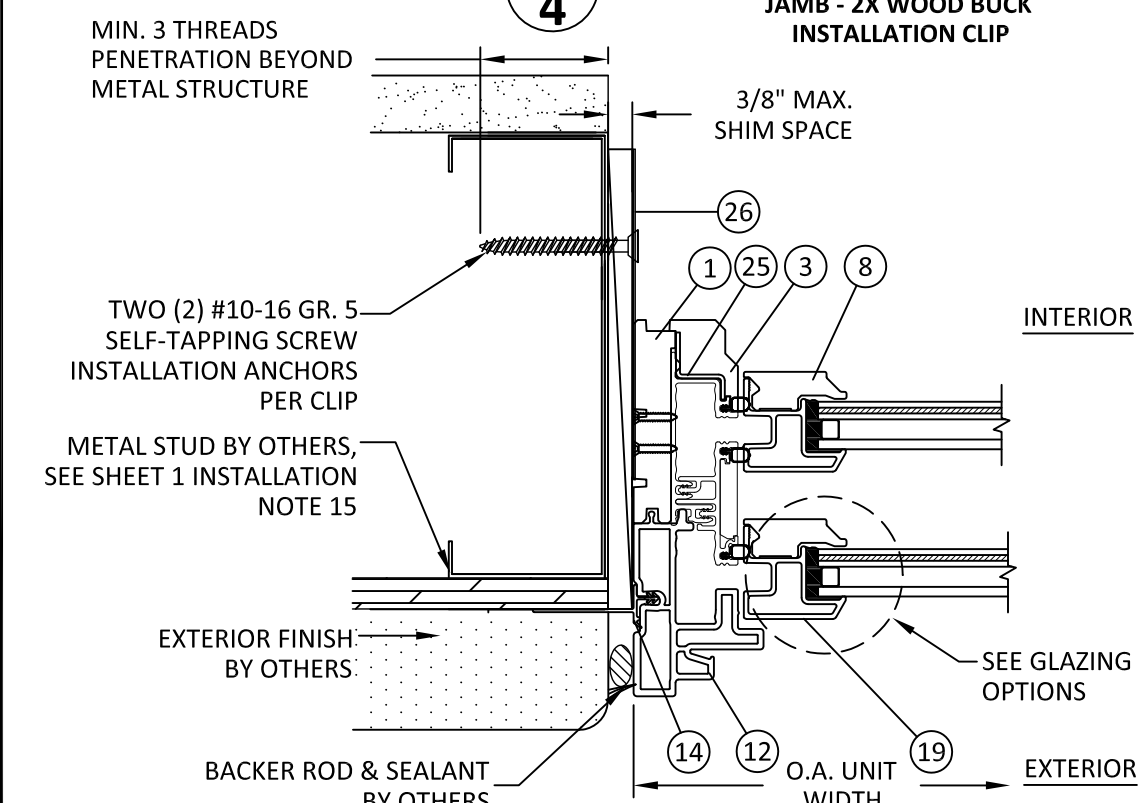

H4 HORIZONTAL SECTION
JAMB-METAL STUD
INSTALLATION CLIP

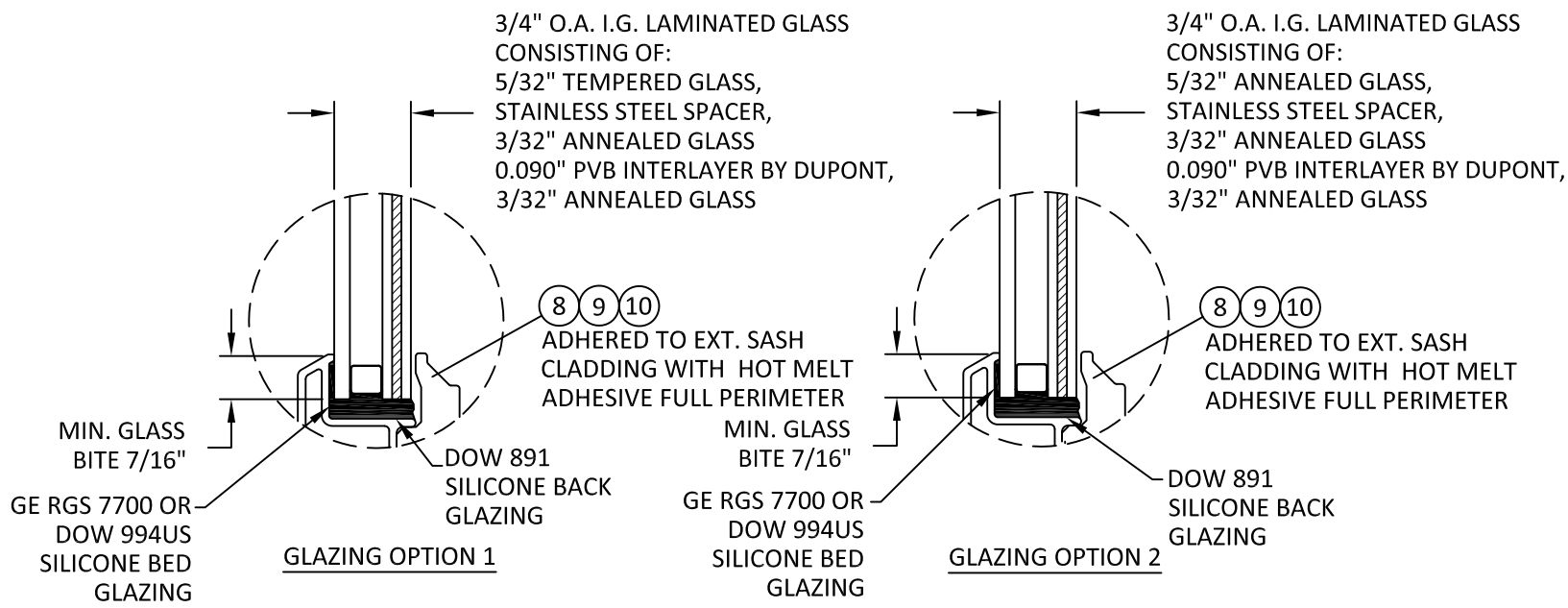

NOTE:
1) FIXED GLASS LITES GREATER THAN 36" IN WIDTH SHALL HAVE TWO APPROVED SETTING BLOCKS AS SPECIFIED IN THE FBC.
2) FOR INSTALLATION ABOVE 30 FT. ABOVE GRADE IN AREAS REQUIRING IMPACT RESISTANCE, ALL UNITS MUST BE SAFETY GLAZED OR COVERED BY AN IMPACT PROTECTIVE SYSTEM PER THE FBC.

4/20/2020 9:21 AM
s:\projects\andersen\windows\tdi-20-0302-1-tdi-submittal-fig-reinforced-mullion-revision\dwgs\awd270-a-series-dh.dwg



100 FOURTH AVE NORTH
BAYPORT, MN 55003-1096
PH: (651) 264-5150 FX: (651) 264-5485

TITLE: A-SERIES DOUBLE HUNG WINDOW (IMPACT)
BILL OF MATERIALS & COMPONENTS

PREPARED BY:

BUILDING DROPS, INC.
398 E. DANIA BEACH BLVD., STE. 338
DANIA BEACH, FL 33004
PH: (954) 399-8478
FAX: (954) 744-4738
WEB: www.buildingdrops.com

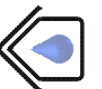

REMARKS	BY	DATE

THE INSTALLATION DETAILS DESCRIBED HEREIN ARE GENERIC AND MAY NOT REFLECT ACTUAL CONDITIONS FOR A SPECIFIC SITE. IF SITE CONDITIONS CAUSE INSTALLATION TO DEVIATE FROM THE REQUIREMENTS DETAILED HEREIN, A LICENSED ENGINEER OR ARCHITECT SHALL PREPARE SITE SPECIFIC DOCUMENTS FOR USE WITH THIS DOCUMENT.



HERMES F. NORERO, P.E.
TEXAS P.E. No. 118471
BUILDING DROPS, INC
398 E. DANIA BEACH BLVD. # 338
DANIA BEACH, FL 33004
TBPE FIRM No. 13734

DATE:	03.13.20
DWG. BY:	MS
CHK. BY:	HFN
SCALE:	NTS
DWG. #:	AWD270
SHEET:	5

BILL OF MATERIALS

ITEM #	DESCRIPTION	MATERIAL	MANUFACTURER
1	FRAME	WOOD	ANDERSEN
2	INTERIOR TRIM STOP, SILL	WOOD	ANDERSEN
3	INTERIOR TRIM STOP, JAMB	WOOD	ANDERSEN
4	INTERIOR TRIM STOP, HEAD	WOOD	ANDERSEN
5	INTERIOR CENTER JAMB TRIM	WOOD	ANDERSEN
6	FILLER BLOCK, HEAD	WOOD	ANDERSEN
7	PARTING STOP, HEAD	WOOD	ANDERSEN
8	SASH RAIL/STILE, INTERIOR	WOOD	ANDERSEN
9	UPPER SASH CHECKRAIL, INTERIOR	WOOD	ANDERSEN
10	LOWER SASH BOTTOM RAIL, INTERIOR	WOOD	ANDERSEN
11	LOWER SASH CHECKRAIL CAP, INTERIOR	WOOD	ANDERSEN
12	FRAME CLADDING, EXTERIOR	FIBREX®	ANDERSEN
13	SILL FRAME CLADDING, EXTERIOR	FIBREX®	ANDERSEN
14	NAILING FLANGE	RIGID PVC	ANDERSEN
15	SIDE JAMB LINER	RIGID PVC	ANDERSEN
16	BALANCE COVER	RIGID PVC	ANDERSEN
17	HEAD JAMB LINER	RIGID PVC	ANDERSEN
18	UPPER SASH CHECKRAIL WEATHERSTRIP	-	-
19	SASH RAIL/STILE, EXTERIOR	FIBERGLASS	ANDERSEN
19A	CHECKRAIL LOWER SASH	FIBERGLASS	ANDERSEN
20	LOWER SASH BOTTOM RAIL, EXTERIOR	FIBERGLASS	ANDERSEN
21	HEAD/JAMB WEATHERSTRIP	-	-
22	BOTTOM RAIL WEATHERSTRIP	-	-
23	SWEEP LOCK AND KEEPER	-	-
24	INTERLOCK, CHECKRAIL	304 SS	-
25	LOAD BRACKET, CHECKRAIL	GALV. STEEL	-
26	INSTALLATION CLIP	304 SS	-

NOTE: ALL WOOD COMPONENTS ARE PINE (MIN. SG = 0.40)

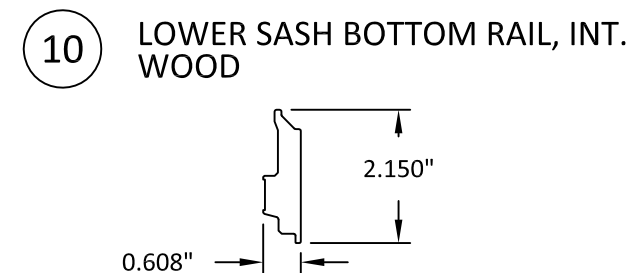
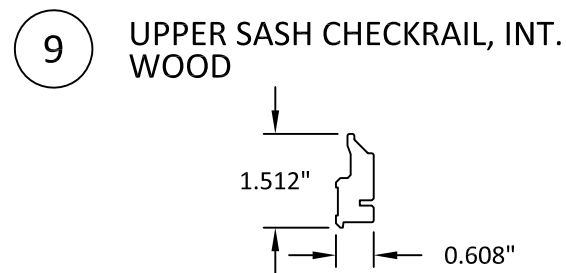
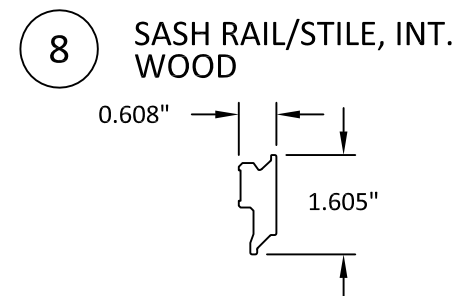
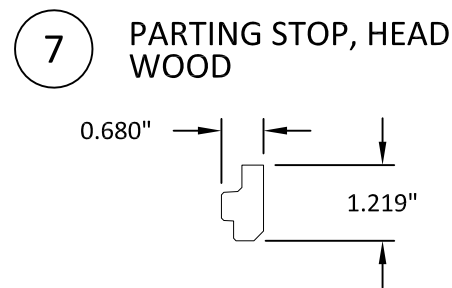
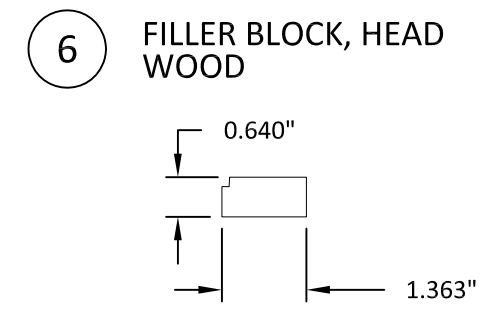
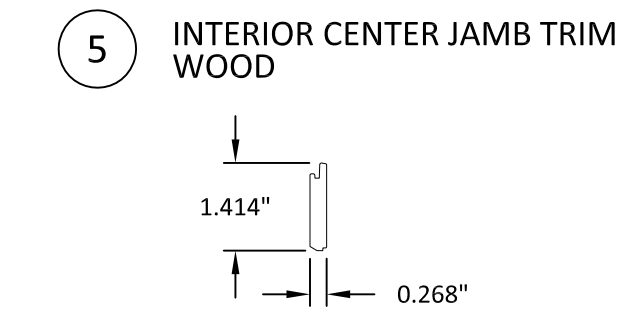
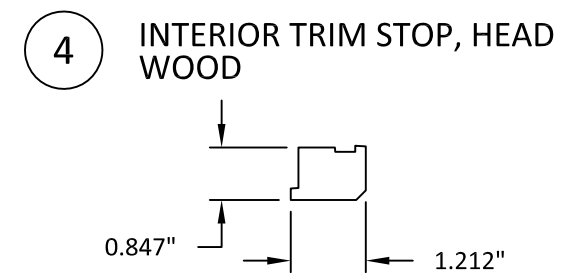
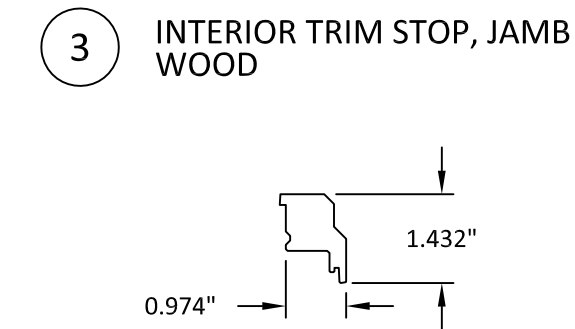
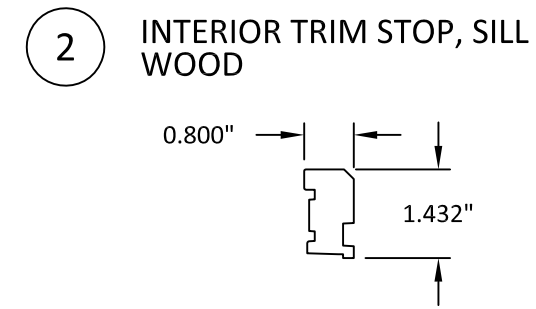
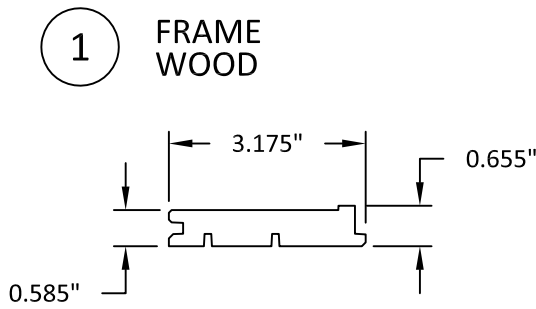

4/20/2020 9:21 AM s:\projects\andersen windows\tel-20-0302-1 - tdi submittal - fg reinforced mullion revision\dwg\awd270 a-series dh.dwg



100 FOURTH AVE NORTH
BAYPORT, MN 55003-1096

PH: (651) 264-5150 FX: (651) 264-5485

TITLE: A-SERIES DOUBLE HUNG WINDOW (IMPACT)

COMPONENTS

PREPARED BY: BUILDING DROPS, INC.

398 E. DANIA BEACH BLVD., STE. 338
DANIA BEACH, FL 33004
PH: (954) 399-8478
FAX: (954) 744-4738
WEB: www.buildingdrops.com



REMARKS	BY	DATE

THE INSTALLATION DETAILS DESCRIBED HEREIN ARE GENERIC AND MAY NOT REFLECT ACTUAL CONDITIONS FOR A SPECIFIC SITE. IF SITE CONDITIONS CAUSE INSTALLATION TO DEVIATE FROM THE REQUIREMENTS DETAILED HEREIN, A LICENSED ENGINEER OR ARCHITECT SHALL PREPARE SITE SPECIFIC DOCUMENTS FOR USE WITH THIS DOCUMENT.



HERMES F. NORERO, P.E.
TEXAS P.E. No. 118471
BUILDING DROPS, INC
398 E. DANIA BEACH BLVD. # 338
DANIA BEACH, FL 33004
TBPE FIRM No. 13734

DATE:	03.13.20
DWG. BY:	MS
CHK. BY:	HFN
SCALE:	NTS
DWG. #:	AWD270
SHEET:	6

11 LOW. SASH CHECKRAIL CAP, INT. WOOD

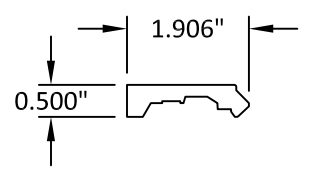

12 FRAME CLADDING, EXT. FIBREX

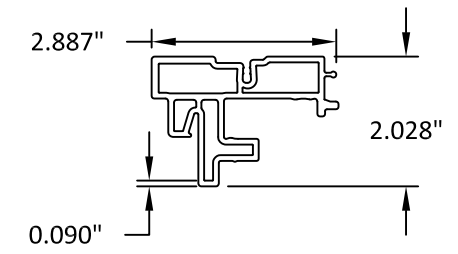

13 SILL FRAME CLADDING, EXT. FIBREX

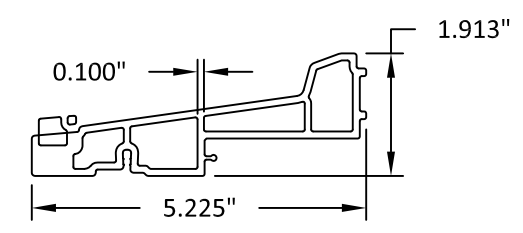

14 NAILING FLANGE RIGID PVC

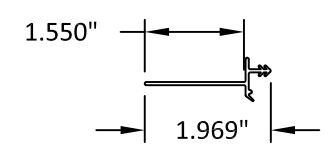

15 SIDE JAMB LINER RIGID PVC

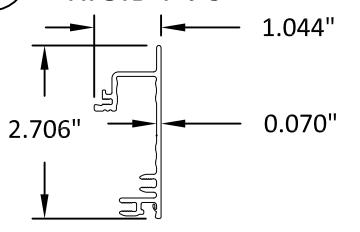

16 BALANCE COVER RIGID PVC

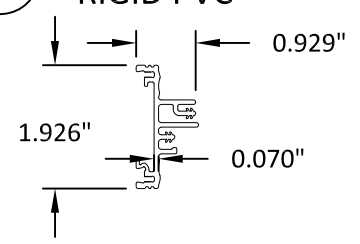

17 HEAD JAMB LINER RIGID PVC

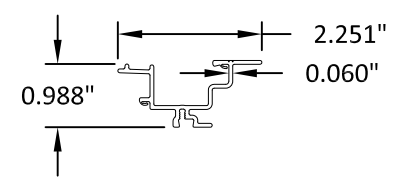

19 SASH RAIL/STILE, EXT. FIBERGLASS

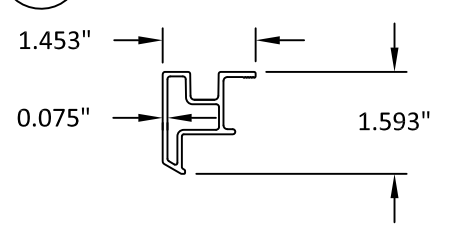

20 LOWER SASH BOTTOM RAIL, EXT. FIBERGLASS

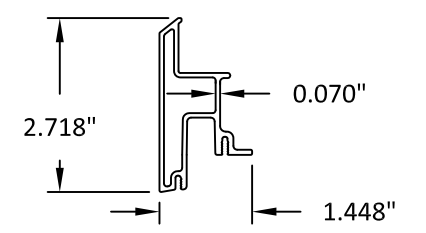

24 INTERLOCK, CHECKRAIL 304 SS

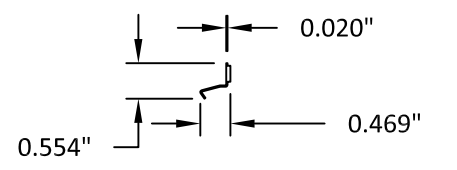

25 LOAD BRACKET CHECKRAIL GALV. STEEL (INTERLOCK)

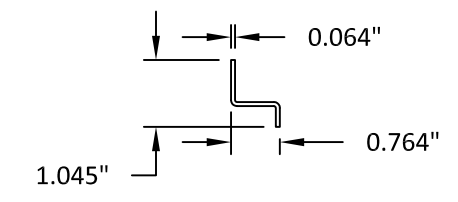

26 INSTALLATION CLIPS 304 SS

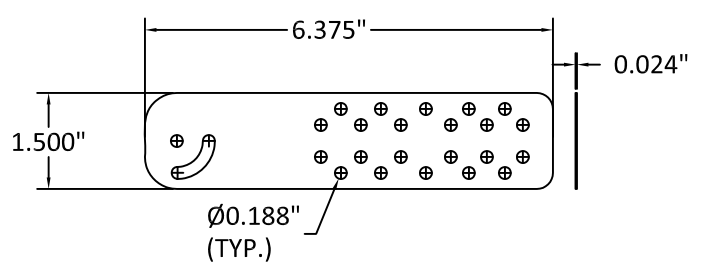

NOTE: INSTALLATION CLIPS SHALL BE ATTACHED TO WINDOW FRAME WITH TWO (2) #8 X 5/8" SCREWS

4/20/2020 9:21 AM s:\projects\andersen windows\tai-20-0302-1 - tdi submittal - fg reinforced mullion revision\dwg\awd270 a-series dh.dwg