

2x framing to be designed by the engineer or architect of record based on wind loads and the cladding being used (typ.).

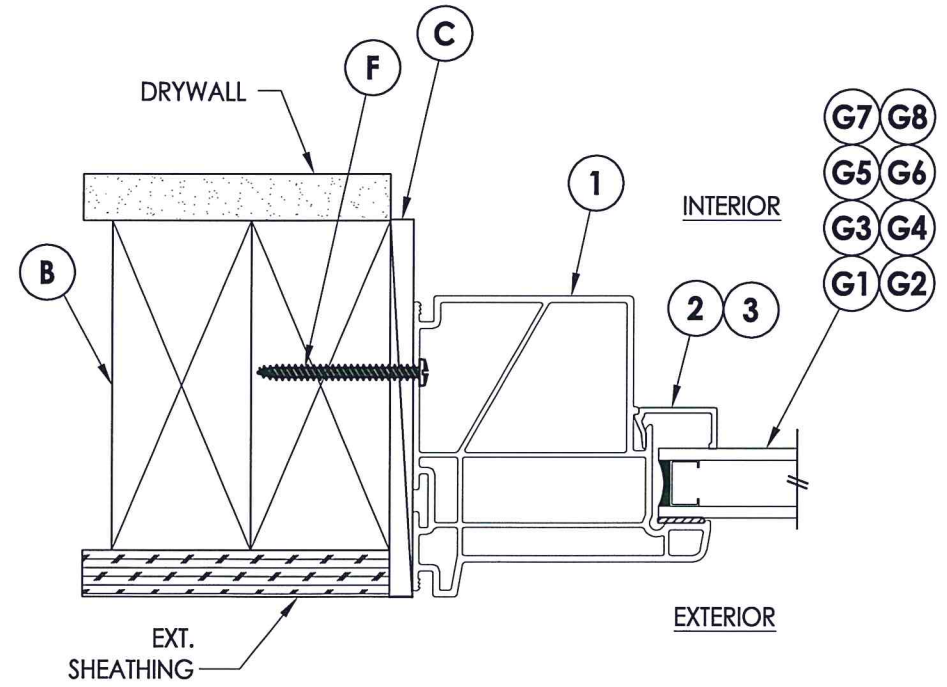

1

2

**CROSS SECTION**

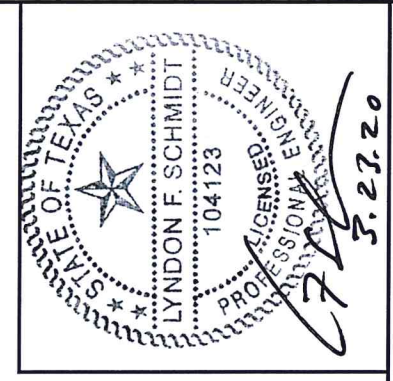

Documents Prepared By: Lyndon F. Schmidt, P.E.  
TEXAS P.E. #104123

**RW** BUILDING CONSULTANTS, INC.  
P.O. Box 230 Valrico FL 33595  
Phone No.: 813.659.9197

TEXAS BOARD OF PROFESSIONAL ENGINEERS  
CERTIFICATE OF REGISTRATION # F-11852

PRODUCT:	5400S/7000/9900 SERIES FIXED WINDOW
PART OR ASSEMBLY:	CROSS SECTION

NO.	DATE	DESCRIPTION	BY
1	1/21/20	UPDATE TO 2018 IBC/IRC	LFS
			BY

DATE:	9/4/14
SCALE:	N.T.S.
DWG. BY:	JK
CHK. BY:	LFS
DRAWING NO.:	TX-4465
SHEET	2 OF 3

R:\Clients\Wincore PERMANENT\B - (2018) Texas Dept of Ins\WIN 1156 - Fixed Casement\5400 - 7700 - 9900\C - Drawings\2018 IBC UPDATE\TX-4465.dwg, 3.2

BILL OF MATERIALS		
ITEM #	DESCRIPTION	MATERIAL
B	2X FRAMING (SG >= 0.42)	WOOD
C	1/4" MAX. SHIM SPACE	-
F	#10 X 2" PH SMS (1-3/8" MIN. EMB.)	STEEL
1	FRAME (CP6201)*	PVC
2	GLAZING BEAD (BV62)*	PVC
3	GLAZING BEAD (BV79)*	PVC

\* THE APPROVED WHITE RIGID PVC EXTERIOR EXTRUSIONS FOR WINDOWS ARE TO BE PRODUCED BY EXTRUDERS LICENSEES IN "CERTIFICATION PROGRAMS FOR RIGID PVC EXTRUSIONS".

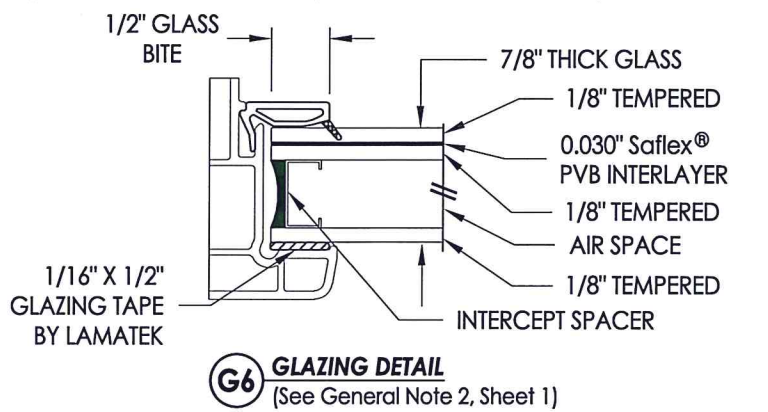
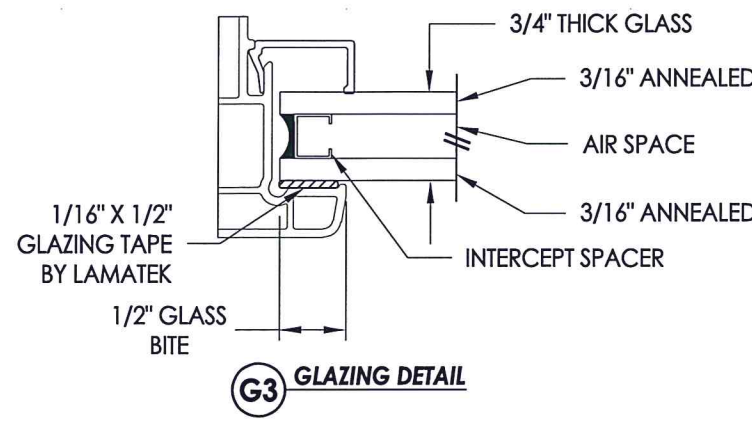
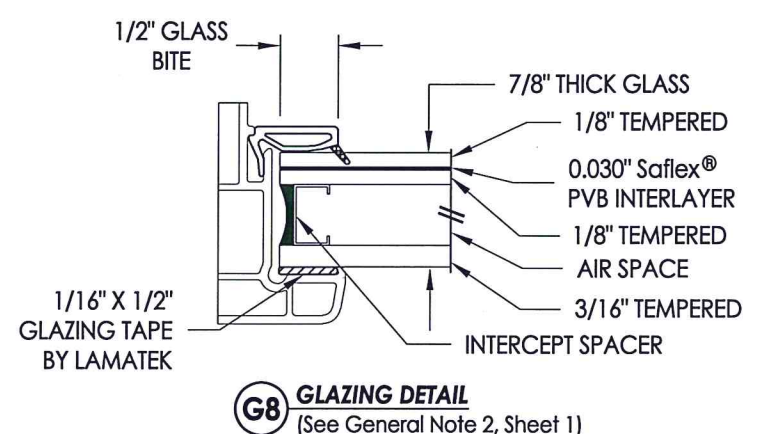
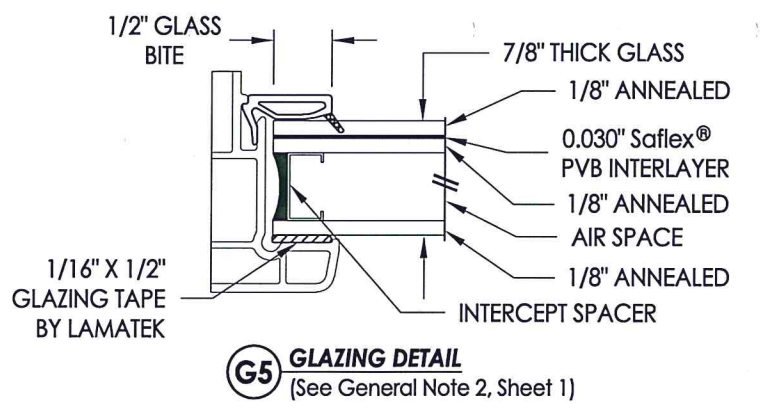
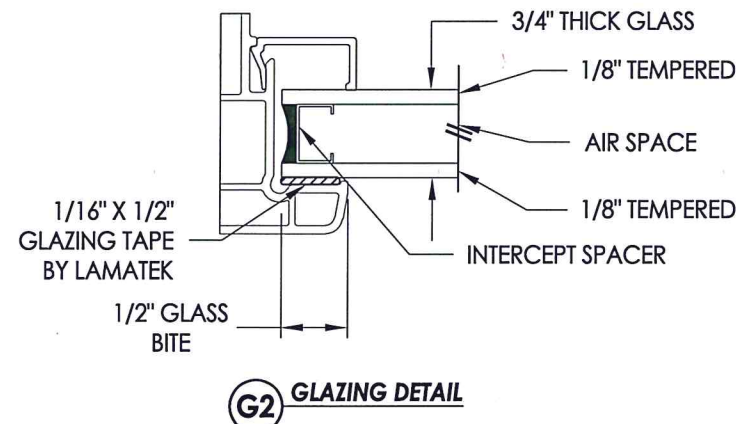
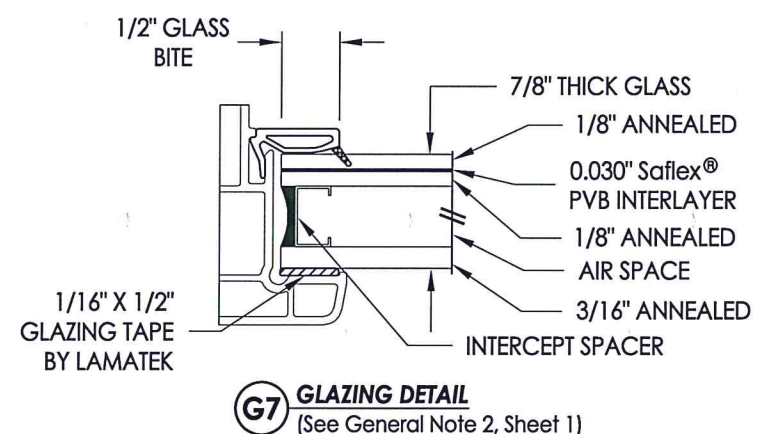
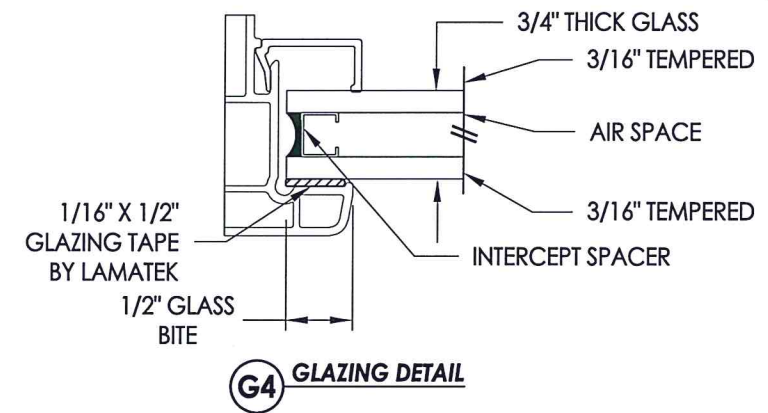
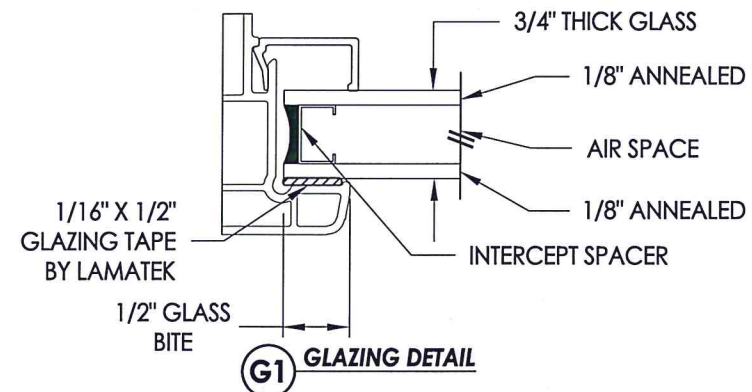
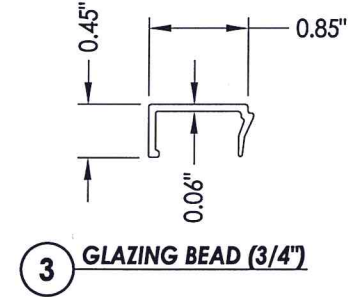
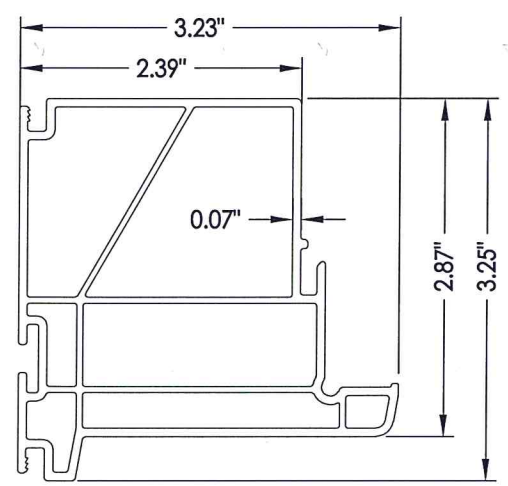
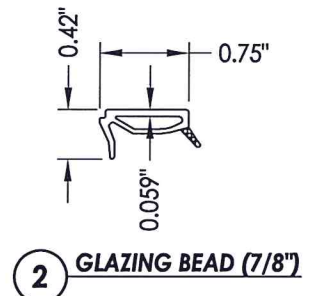

Documents Prepared By: Lyndon F. Schmidt, P.E.  
TEXAS P.E. #104123

**R.W.** BUILDING CONSULTANTS, INC.  
P.O. Box 230 Valrico FL 33595  
Phone No.: 813.659.9197

TEXAS BOARD OF PROFESSIONAL ENGINEERS  
CERTIFICATE OF REGISTRATION # F-11852

PRODUCT:	5400S/7000/9900 SERIES FIXED WINDOW	
PART OR ASSEMBLY:	BILL OF MATERIALS, COMPONENTS AND GLAZING DETAILS	
NO.	DATE	BY
1	1/21/20	LFS
UPDATE TO 2018 IBC/IRC		
REVISIONS		
DATE:	9/4/14	
SCALE:	N.T.S.	
DWG. BY:	JK	
CHK. BY:	LFS	
DRAWING NO.:	TX-4465	
SHEET	3 OF 3	

© 2014 R.W. BUILDING CONSULTANTS INC.