

MODEL 650 SYSTEMS 1 AND 2 DOUBLE HUNG - NON-IMPACT

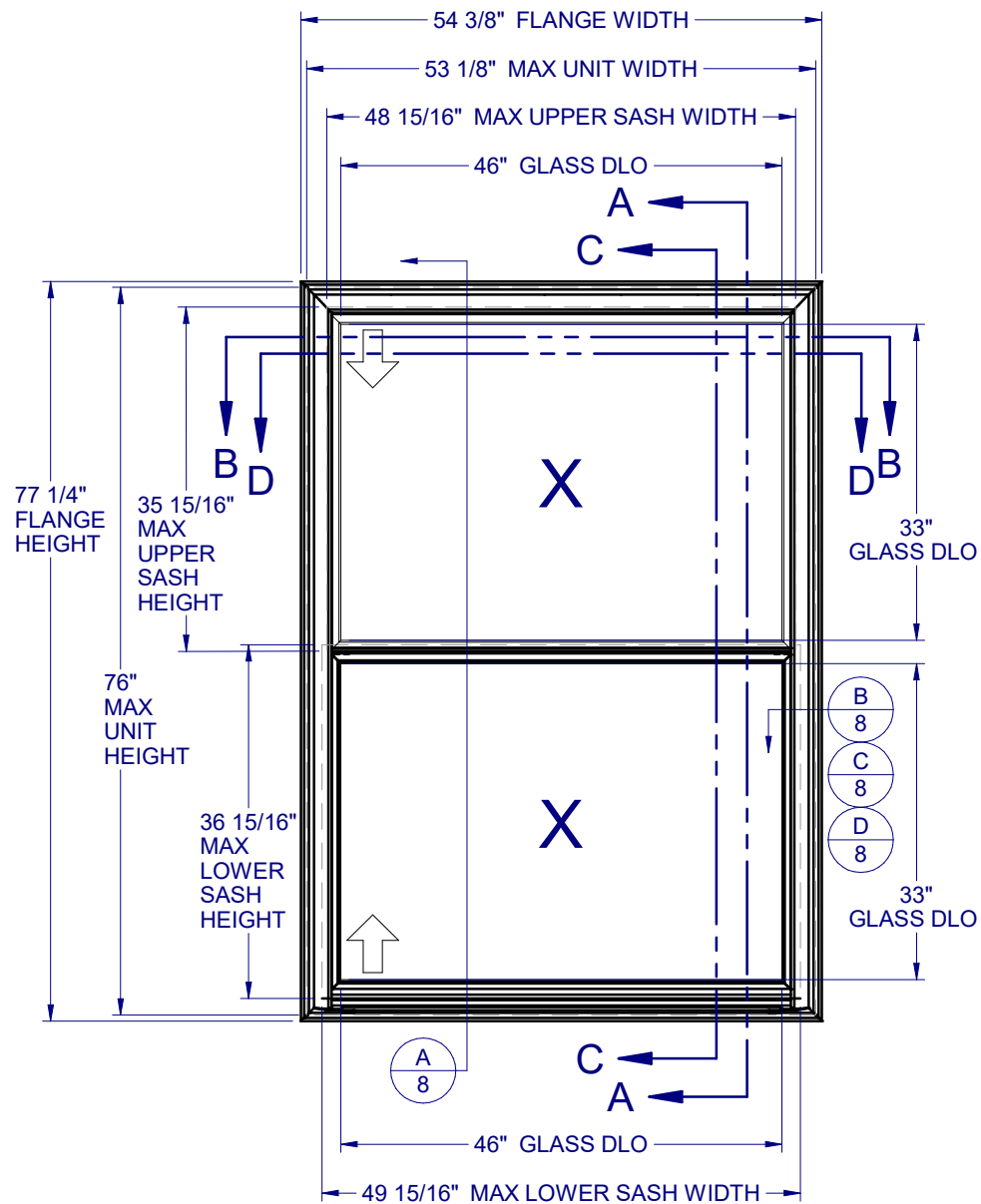

**EQUAL SPLIT
SYSTEM 1
(CAR 138-1307)**

MAXIMUM ALLOWABLE DESIGN PRESSURE: +50/-50

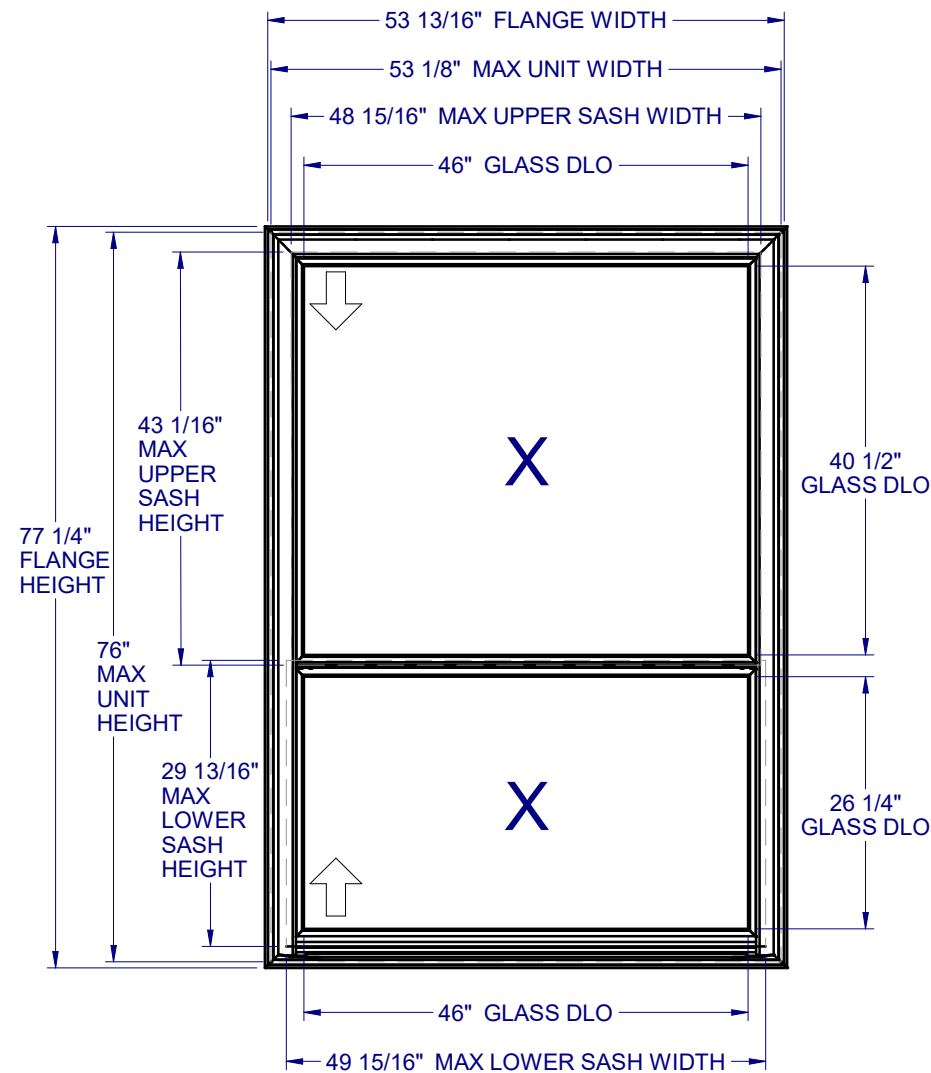

**ORIEL
SYSTEM 2
(CAR 138-1378)**

MAXIMUM ALLOWABLE DESIGN PRESSURE: +50/-50 PSF

GENERAL NOTES:

1. THE PRODUCT SHOWN HEREIN IS DESIGNED AND MANUFACTURED TO COMPLY WITH THE REQUIREMENTS OF THE 2018 INTERNATIONAL BUILDING CODE AND 2018 INTERNATIONAL RESIDENTIAL CODE.
2. GLAZING OPTIONS: (SEE SHEET 3)
3. CONFIGURATIONS: "X/X".
4. ANCHORAGE: THE 33 1/3% STRESS INCREASE HAS NOT BEEN USED IN THE DESIGN OF THIS PRODUCT. SEE SHEET 8 FOR ANCHOR DETAILS. WINDLOAD DURATION FACTOR Cd=1.6 WAS USED FOR WOOD ANCHOR CALCULATIONS.
5. NOT APPROVED FOR IMPACT RESISTANCE. IMPACT PROTECTIVE SYSTEM IS REQUIRED IN WIND BORNE DEBRIS REGION.
6. ALL FRAMES AND VENTS FULLY WELDED. SMALL JOINT SEAM SEALANT USED AT FIXED MEETING RAIL AND JAMB.
7. SERIES / MODEL DESIGNATION DH-650.
8. THE DESIGNATION X AND O STAND FOR THE FOLLOWING:
X = OPERABLE SASH
9. SECTION CALLOUTS APPLY TO ALL ELEVATIONS IN A SIMILAR LOCATION.
10. EXTERNAL WEEP SLOT = 1/2 x 2-1/2" LOCATED 5" FROM BOTH ENDS.



1900 SW 44TH AVE.
OCALA, FLORIDA 34474
WWW.CWS.CC

**650 PVC
DOUBLE HUNG
NON-IMPACT**

| NO. | DESCRIPTION: | BY: | DATE: |
|-----|------------------------|-----|---------|
| C | REVISED TO TDI REQUEST | JLD | 7/23/21 |
| B | REVISED TO TDI REQUEST | JML | 3/8/17 |
| A | REVISED TO TDI REQUEST | JML | 8/2/16 |

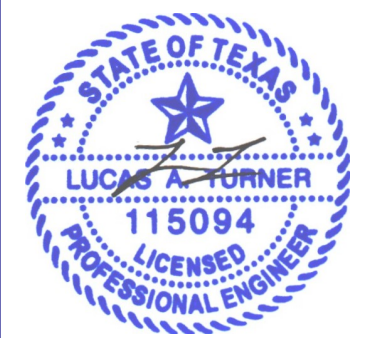

8/5/2021

LUCAS A. TURNER, P.E.
TX PE # 115094
2428 Old Natchez Trc Trl
Camden, TN 38320
PH. 941-380-1574

SHEET DESCRIPTION:
**GENERAL NOTES AND
ELEVATIONS**

| | |
|--------------------------|--------------------------|
| DRAWN BY: EMK | DATE: 12/17/15 |
| DWG #: TDI-936 | REV.: C |
| SCALE: 1:20 | SHEET 1 OF 6 |

TABLE OF CONTENTS

GENERAL NOTES & ELEVATIONS.....1
 DP CHARTS.....2
 GLAZING DETAILS.....3
 SECTION VIEWS & ALT FRAME.....4-5
 EXTRUSIONS & B.O.M.....6
 ANCHOR SCHEDULE & NOTES.....7
 INSTALLATION DETAILS.....8

**650 PVC
DOUBLE HUNG
NON-IMPACT**

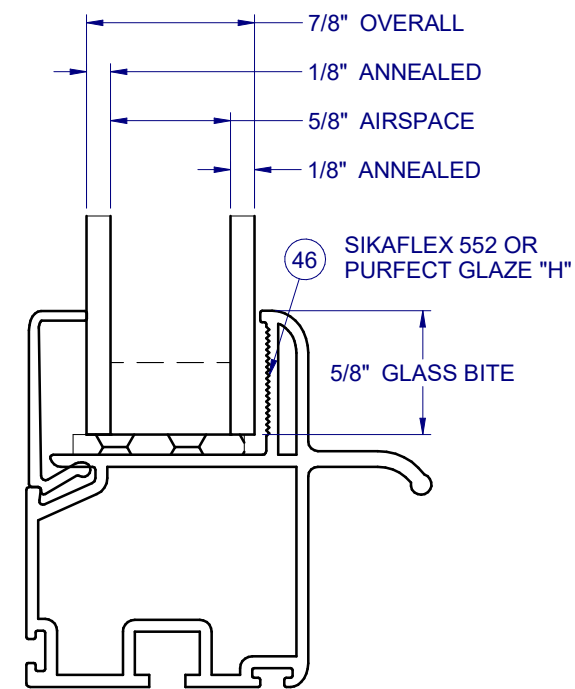

SYSTEM 1 (BOTH SASH'S)
SYSTEM 2 (LOWER SASH ONLY)

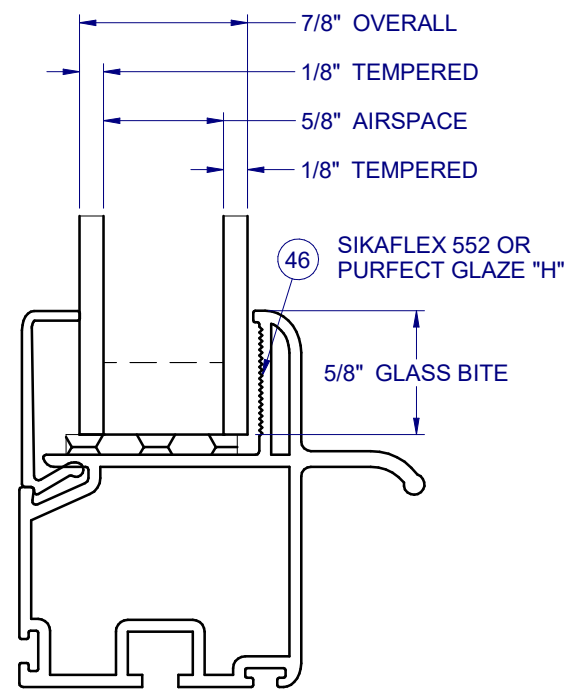

SYSTEM 1 (BOTH SASH'S)
SYSTEM 2 (LOWER SASH ONLY)

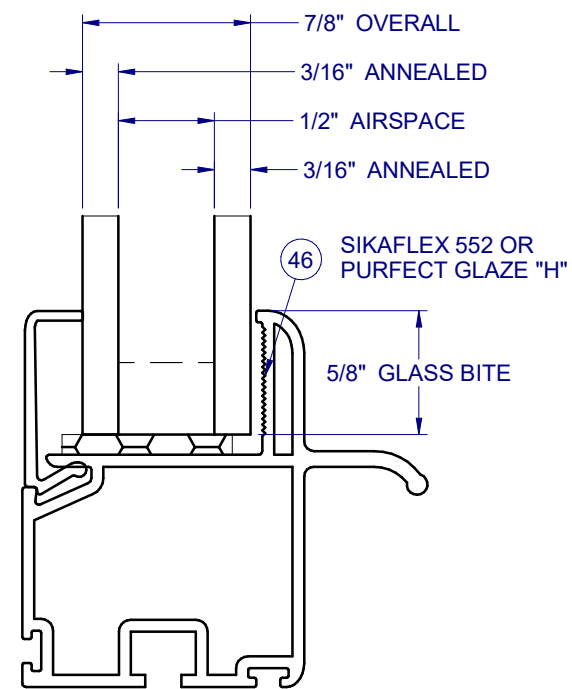

SYSTEM 2 (UPPER SASH ONLY)

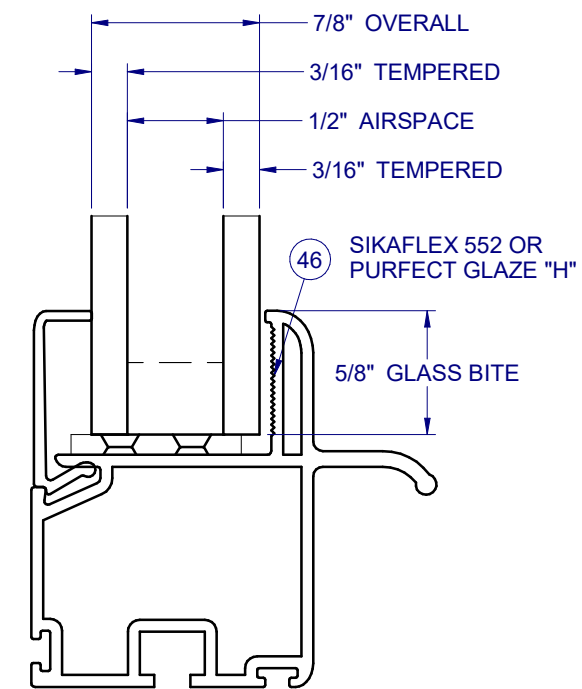

SYSTEM 2 (UPPER SASH ONLY)

| NO. | DESCRIPTION: | BY: | DATE: |
|-----|------------------------|-----|---------|
| C | REVISED TO TDI REQUEST | JLD | 7/23/21 |
| B | REVISED TO TDI REQUEST | JML | 3/8/17 |
| A | REVISED TO TDI REQUEST | JML | 8/2/16 |



8/5/2021

LUCAS A. TURNER, P.E.
TX PE # 115094
2428 Old Natchez Trc Trl
Camden, TN 38320
PH. 941-380-1574

SHEET DESCRIPTION:

GLAZING DETAILS

| | |
|--------------------------|--------------------------|
| DRAWN BY: EMK | DATE: 12/17/15 |
| DWG #: TDI-936 | REV.: C |
| SCALE: 1:1 | SHEET 2 OF 6 |

REVISIONS

**650 PVC
DOUBLE HUNG
NON-IMPACT**

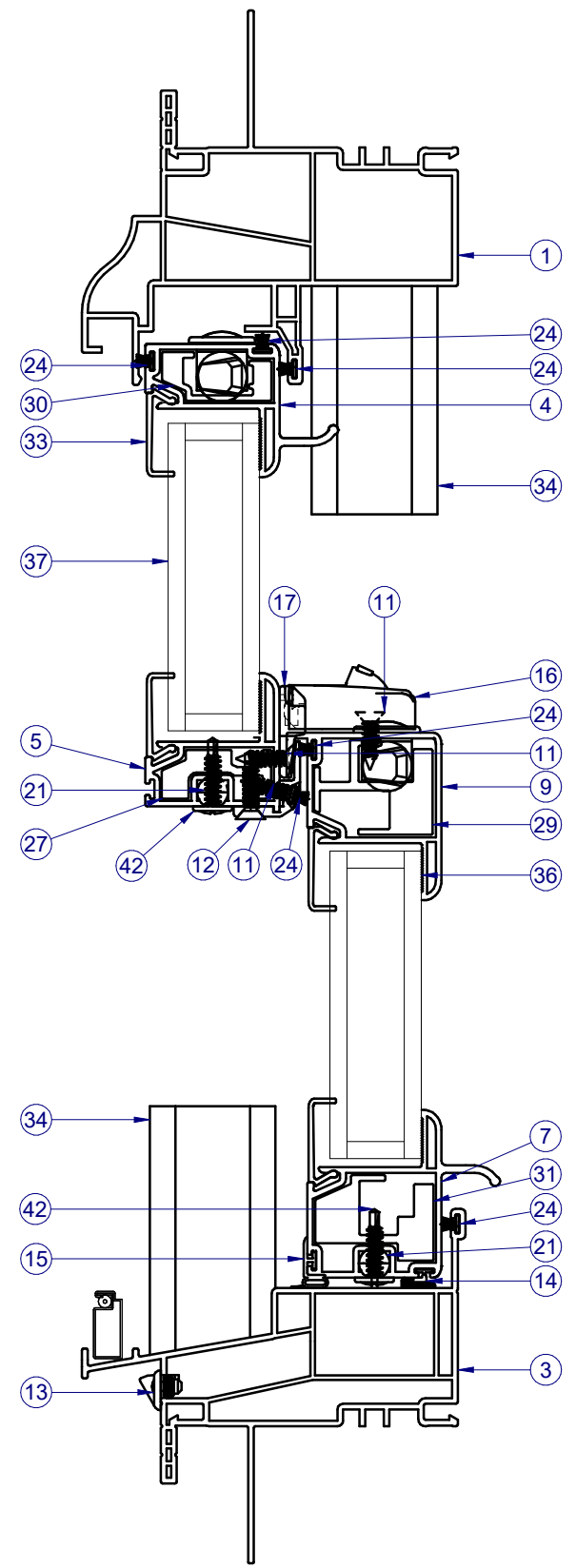

SECTION VIEW C-C

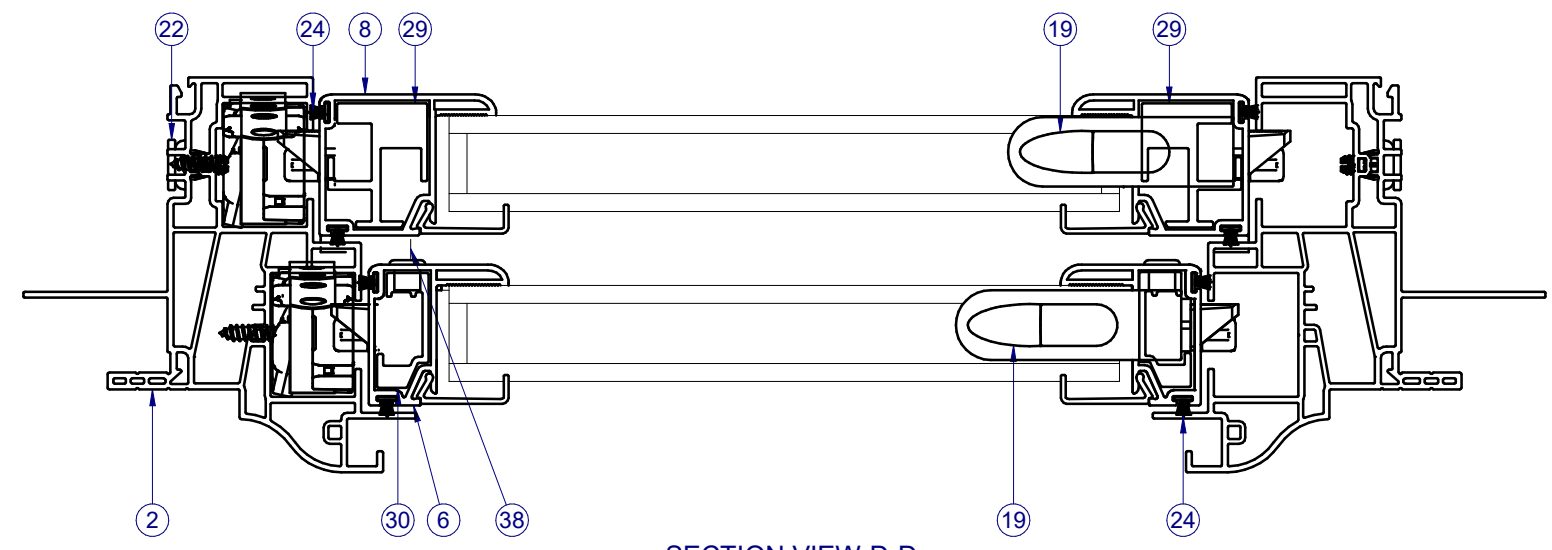

SECTION VIEW D-D

| NO.: | | DESCRIPTION: | BY: | DATE: |
|------|-----------------------|--------------|---------|-------|
| C | REVISD TO TDI REQUEST | JLD | 7/23/21 | |
| B | REVISD TO TDI REQUEST | JML | 3/8/17 | |
| A | REVISD TO TDI REQUEST | JML | 8/2/16 | |

REVISIONS



8/5/2021

LUCAS A. TURNER, P.E.
TX PE # 115094
2428 Old Natchez Trc Trl
Camden, TN 38320
PH. 941-380-1574

SHEET DESCRIPTION:

**SECTION VIEWS
OVER 37" WIDE**

| | |
|--------------------------|--------------------------|
| DRAWN BY: EMK | DATE: 12/17/15 |
| DWG #: TDI-936 | REV.: C |
| SCALE: 1:2 | SHEET 3 OF 6 |

PARTS LIST

| ITEM | PART # | DESCRIPTION | MATERIAL | VENDOR |
|------|--------|--|----------|------------|
| 1 | H-6121 | HEAD, OUTERFRAME | PVC | ATN |
| 2 | H-6122 | JAMBS, OUTERFRAME | PVC | ATN |
| 3 | H-6123 | SILL, OUTERFRAME | PVC | ATN |
| 4 | H-6130 | TOP RAIL, UPPER SASH | PVC | ATN |
| 5 | H-6131 | BOTTOM RAIL, UPPER SASH | PVC | ATN |
| 6 | H-6132 | SASH SIDE RAIL, UPPER SASH | PVC | ATN |
| 7 | H-6133 | BOTTOM RAIL, LOWER SASH | PVC | ATN |
| 8 | H-6134 | SASH SIDE RAIL, LOWER SASH | PVC | ATN |
| 9 | H-6135 | TOP RAIL, LOWER SASH | PVC | ATN |
| 10 | P-5612 | SETTING BLOCK | RUBBER | FRANK LOWE |
| 11 | P-4641 | #8 x 5/8 PHIL FLAT WHITE SMS | STEEL | FASTENAL |
| 12 | P-4146 | #8 X 3/4 PHIL FLAT TEK. | STEEL | FASTENAL |
| 13 | P-5420 | WEEP COVER | NYLON | M&M |
| 14 | P-5085 | WSTP, .355 X 333BULB VINYL | | AMESBURY |
| 15 | P-5471 | WSTP, .950 X .450 T-SLOT, HOLLOW FOAM | | AMESBURY |
| 16 | P-3783 | LOCKS | | INTERLOCK |
| 17 | P-3784 | KEEPERS | | INTERLOCK |
| 19 | P-5392 | SASH TILT LATCH | NYLON | CALDWELL |
| 21 | P-5396 | PIVOT BAR | SS | CALDWELL |
| 22 | P-5412 | JAMB JACK | STEEL | MERCHANTS |
| 24 | P-3305 | WSTP., .270 X 187 | | ULTRAFAB |
| 25 | S-2001 | INTERLOCK RAIL | ALUM | ASCEND |
| 27 | S-2003 | REINF, BOT RAIL, UPPER SASH | ALUM | ASCEND |
| 29 | S-2005 | REINF, TOP RAIL, LOWER SASH, & SIDE RAIL LOWER SAS | ALUM | ASCEND |
| 30 | S-2006 | REINF, SASH SIDE RAIL, UPPER SASH | ALUM | ASCEND |
| 31 | S-2010 | REINF, BOTTOM RAIL, LOWER SASH | ALUM | ASCEND |
| 33 | S-6141 | GLAZING BEAD | PVC | ATN |
| 34 | S-5592 | SASH STOP | | |
| 35 | | BALANCERS - CONSTANT FORCE RT | | CALDWELL |
| 36 | | HOTMELT | SILICONE | TRUSEAL |
| 37 | GLASS | SEE SHEET 2 | | |
| 39 | P-3218 | SCREEN FRAME | ALUM | FLA SCREEN |
| 40 | P-4754 | SCREEN CORNER KEY | NYLON | FLA SCREEN |
| 41 | P-3228 | SCREEN SPLINE | | DAPA |
| 42 | P-5435 | #8 X 3/4 PHIL MOD TRUSS TEK | STEEL | FASTENAL |
| 43 | P-3033 | SCREEN SPRINGS | | FLA SCREEN |
| 44 | P-5444 | #8 x 7/8" PHILLIPS FH TEK | | |

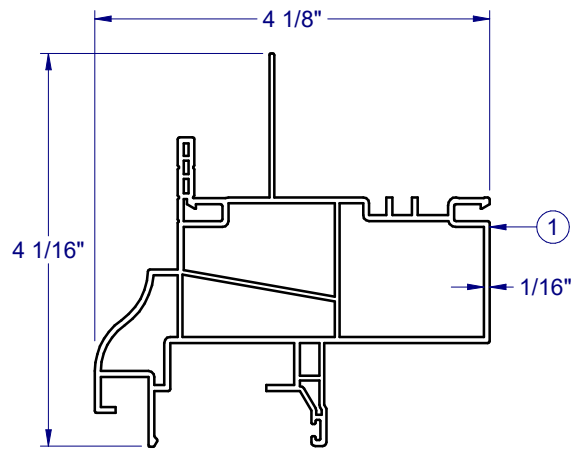

PVC FRAME HEAD
H-6121

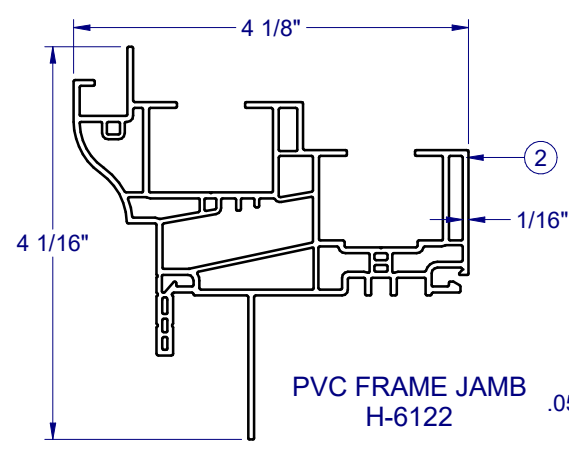

PVC FRAME JAMB
H-6122

FRAME CORNER CONSTRUCTION

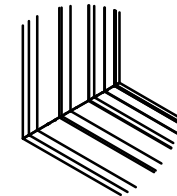

CORNER WELD
(ALL SIDES)
1:8

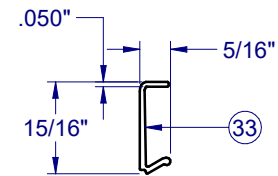

PVC GLAZING BEAD - S-6141

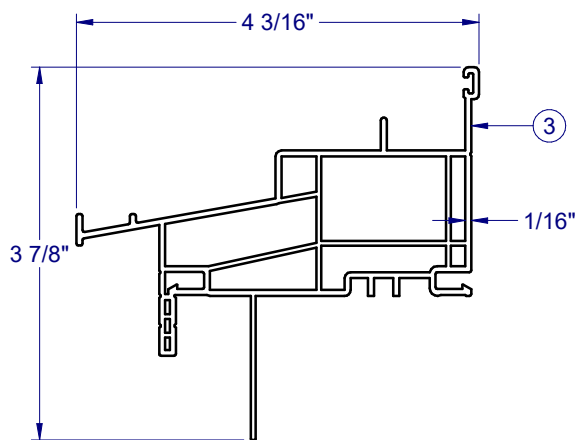

PVC FRAME SILL
H-6123

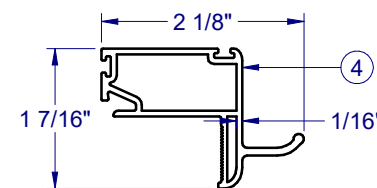

PVC TOP RAIL UPPER
H-6130

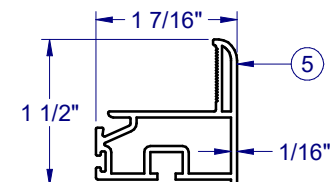

PVC BOT RAIL UPPER
H-6131

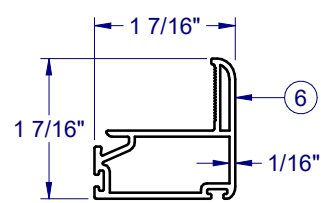

PVC SSR UPPER
H-6132

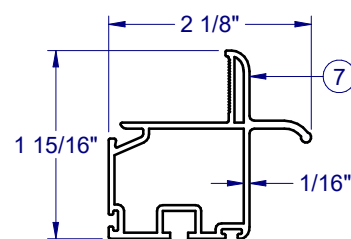

PVC BTM RAIL LOWER
H-6133

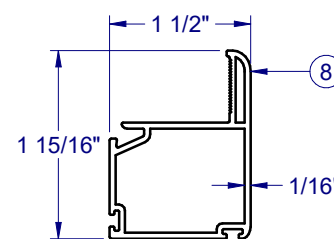

PVC SSR LOWER
H-6134

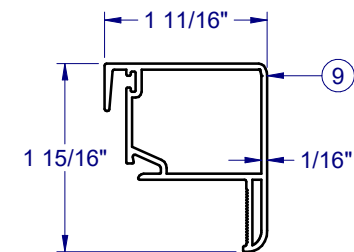

PVC TOP RAIL LOWER
H-6135

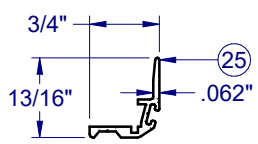

INTERLOCK
S-2001

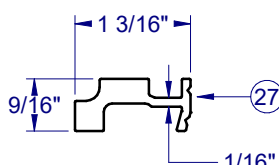

REINFORCEMENT
S-2003

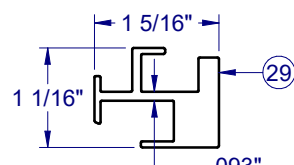

REINFORCEMENT
S-2005

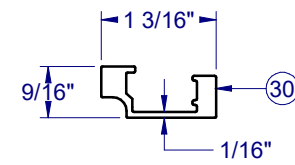

REINFORCEMENT
S-2006

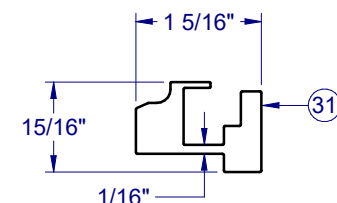

REINFORCEMENT
S-2010



1900 SW 44TH AVE.
OCALA, FLORIDA 34474
WWW.CWS.CC

**650 PVC
DOUBLE HUNG
NON-IMPACT**

| NO. | DESCRIPTION: | BY: | DATE: |
|-----|------------------------|-----|---------|
| C | REVISED TO TDI REQUEST | JLD | 7/23/21 |
| B | REVISED TO TDI REQUEST | JML | 3/8/17 |
| A | REVISED TO TDI REQUEST | JML | 8/2/16 |

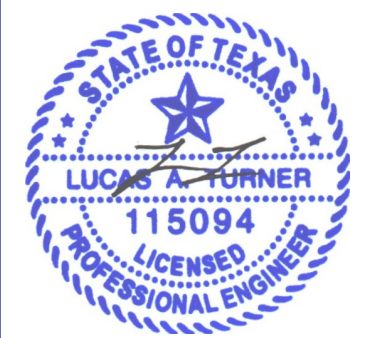

8/5/2021

LUCAS A. TURNER, P.E.
TX PE # 115094
2428 Old Natchez Trc Trl
Camden, TN 38320
PH. 941-380-1574

SHEET DESCRIPTION:
BOM AND EXTRUSIONS

| | |
|--------------------------|--------------------------|
| DRAWN BY: EMK | DATE: 12/17/15 |
| DWG #: TDI-936 | REV.: C |
| SCALE: 1:2 | SHEET 4 OF 6 |

LINE ITEMS NOT USED:
23

NOTE: ALL EXTRUSIONS ARE ALUM. 6063-T6 UNLESS OTHERWISE NOTED.

**650 PVC
DOUBLE HUNG
NON-IMPACT**

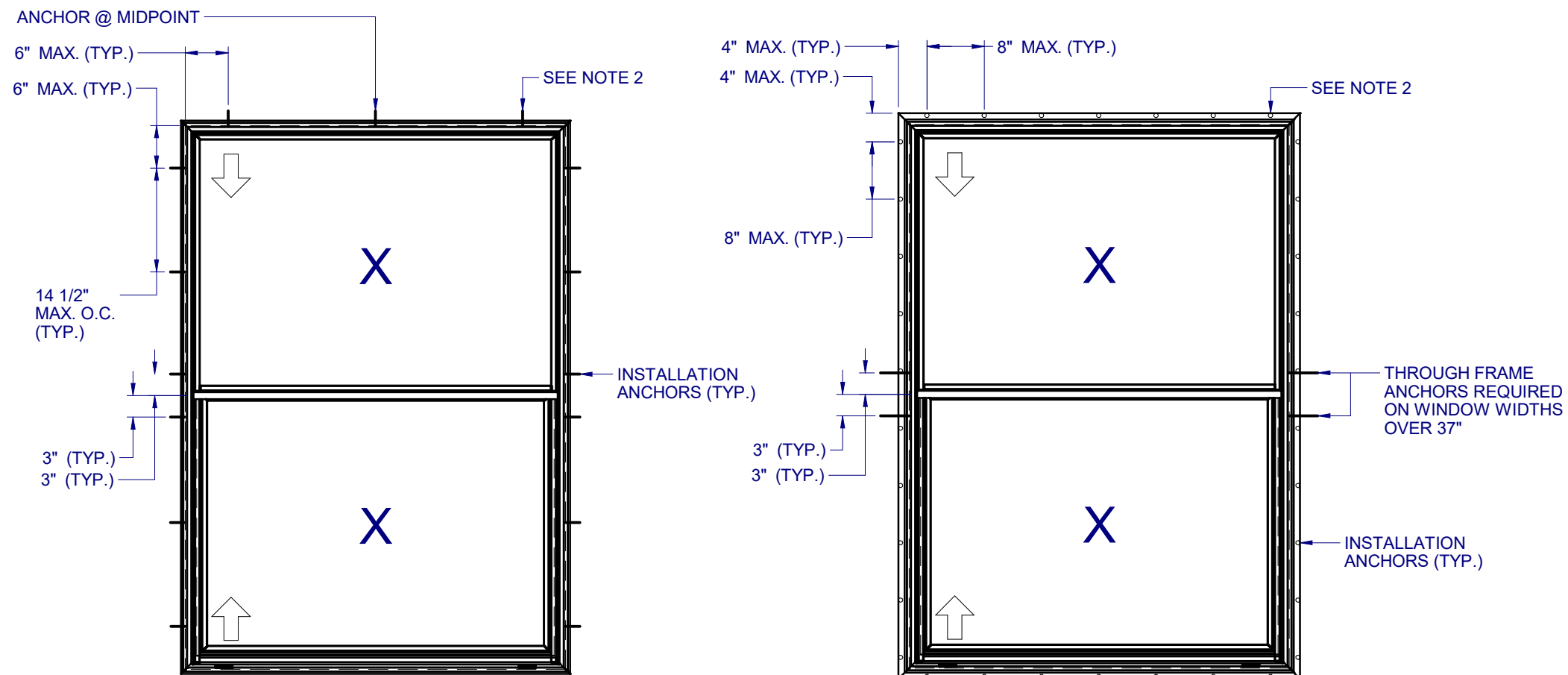

ANCHOR LAYOUT - (FLANGE)
[NO SILL ANCHORS REQUIRED]

ANCHOR LAYOUT - (FIN)
NOTE: THRU FRAME ANCHORS @ MTG RAIL

NOTES:

1. INSTALL ONE ANCHOR AT EACH INSTALLATION LOCATION. SILL ANCHOR SPACING SAME AS HEAD.
2. SHIM AS REQ AT EACH INSTALLATION ANCHOR USING LOAD BEARING SHIMS. MAX. ALLOWABLE SHIM STACK TO BE 1/4". USE SHIMS WHERE SPACE GREATER THAN 1/16" IS PRESENT. LOAD BEARING SHIMS SHALL BE CONSTRUCTED OF HIGH DENSITY PLASTIC OR BETTER. WOOD SHIMS ARE NOT ALLOWED.
3. ANCHOR TYPE, SIZE, SPACING AND EMBEDMENT SHALL BE AS SPECIFIED IN THESE DRAWINGS, SEE TABLE 1, SHEET 8.
4. ALL INSTALLATION ANCHORS MUST BE MADE OF OR PROTECTED WITH A CORROSION RESISTANT MATERIAL OR COATING. DISSIMILAR METALS OR MATERIALS IN CONTACT WITH PRESSURE TREATED WOOD MUST BE PROTECTED TO PREVENT REACTION.
5. INSTALLATION ANCHORS SHALL BE IN ACCORDANCE WITH ANCHOR MANUFACTURER'S INSTALLATION INSTRUCTIONS, AND ANCHORS SHALL NOT BE USED IN SUBSTRATES WITH STRENGTHS LESS THAN THE MINIMUM SPECIFIED IN TABLE 1, SHEET 8.
6. ANCHOR EMBEDMENT TO SUBSTRATE SHALL BE BEYOND WALL DRESSING OR STUCCO. FOR CONCRETE/CMU OPENINGS, EMBEDMENT SHALL BE BEYOND WOOD BUCKS, IF USED, INTO SUBSTRATE - 1X BUCKS ARE OPTIONAL.
7. A MINIMUM CENTER-TO-CENTER SPACING SHALL BE MAINTAINED BETWEEN ALL FASTENERS: 3" FOR MASONRY, 1" FOR WOOD AND METAL.
8. WOOD OR MASONRY OPENINGS, BUCKS AND BUCK FASTENERS SHALL BE PROPERLY DESIGNED BY THE ARCHITECT OR ENGINEER OF RECORD AND INSTALLED TO TRANSFER WIND LOADS TO THE STRUCTURE. SUBSTRATES SHALL MEET THE MINIMUM STRENGTH REQUIREMENTS AS SHOWN IN TABLE 1, SHEET 8. CONCRETE AND MASONRY SUBSTRATES MAY NOT BE CRACKED.
9. SEALING AND FLASHING STRATEGIES FOR OVERALL WATER RESISTANCE OF INSTALLATION SHALL BE DONE BY OTHERS FOLLOWING THE CURRENT VERSION OF THE REFERENCE DOCUMENTS:
FMA/AAMA 100(FIN WINDOWS), FMA/AAMA 200(FLANGE WINDOWS), FMA/WDMA 250(BOX WINDOWS), FMA/AAMA/WDMA 300(EXTERIOR DOORS)

| NO. | DESCRIPTION: | BY: | DATE: |
|-----|------------------------|-----|---------|
| C | REVISED TO TDI REQUEST | JLD | 7/23/21 |
| B | REVISED TO TDI REQUEST | JML | 3/8/17 |
| A | REVISED TO TDI REQUEST | JML | 8/2/16 |
| | | | |

REVISIONS

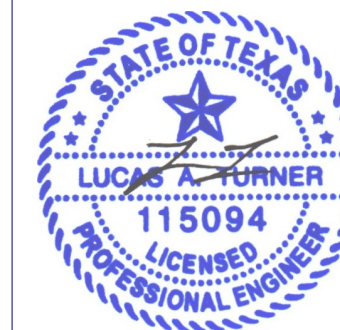

8/5/2021

LUCAS A. TURNER, P.E.
TX PE # 115094
2428 Old Natchez Trc Trl
Camden, TN 38320
PH. 941-380-1574

SHEET DESCRIPTION:
ANCHOR SCHEDULE AND NOTES

| | |
|-----------|----------|
| DRAWN BY: | DATE: |
| EMK | 12/17/15 |
| DWG #: | REV.: |
| TDI-936 | C |
| SCALE: | SHEET |
| 1:20 | 5 OF 6 |

**650 PVC
DOUBLE HUNG
NON-IMPACT**

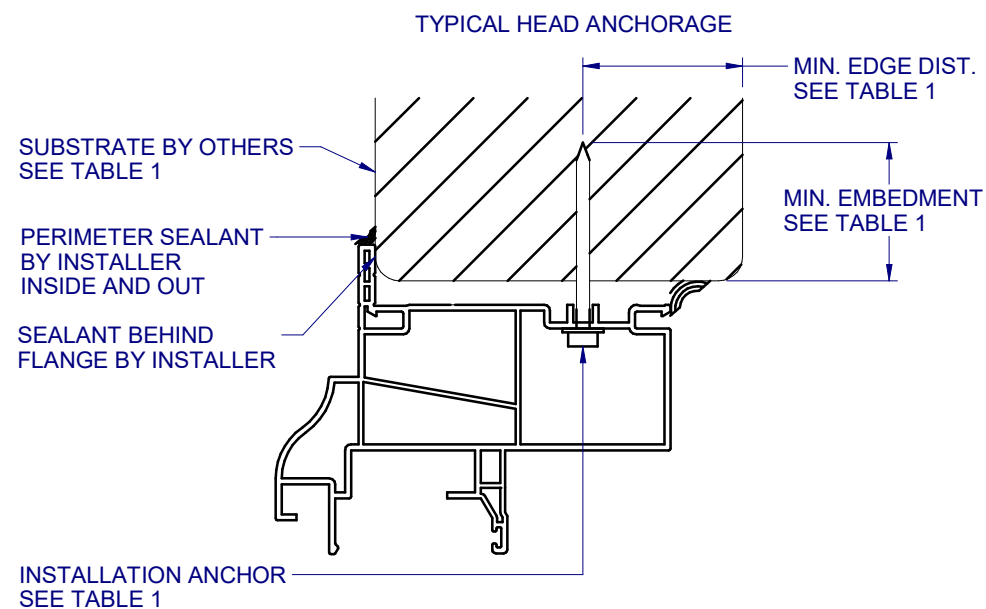

A
8 VERTICAL SECTION
TYPICAL SILL ANCHORAGE
NO SILL ANCHORS REQUIRED

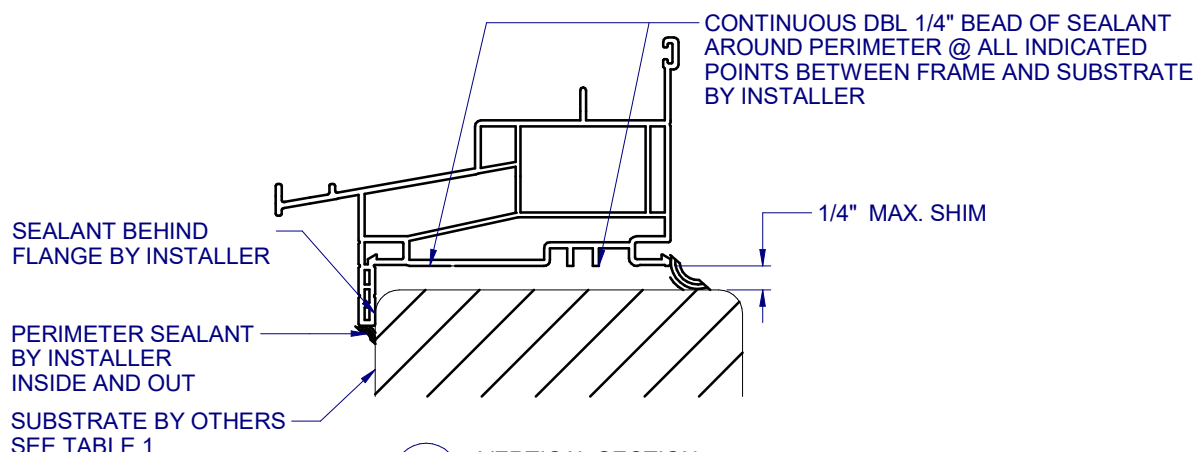

B
8 HORIZONTAL SECTION
TYPICAL JAMB ANCHORAGE

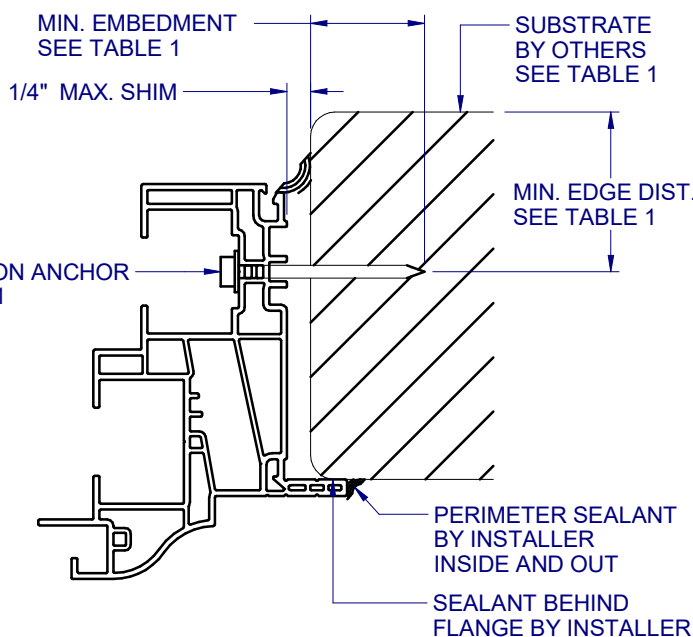

C
8 HORIZONTAL SECTION
TYPICAL FIN ANCHORAGE
HEAD AND SILL SIMILAR FOR FIN INSTALLATION

NOTE: ADDITIONAL THRU-FRAME ANCHORS (AS SHOWN IN DET. B/7) REQ'D AT MTG RAIL FOR UNIT WIDTHS OVER 37", SEE SHEET 7 ANCHOR LAYOUT

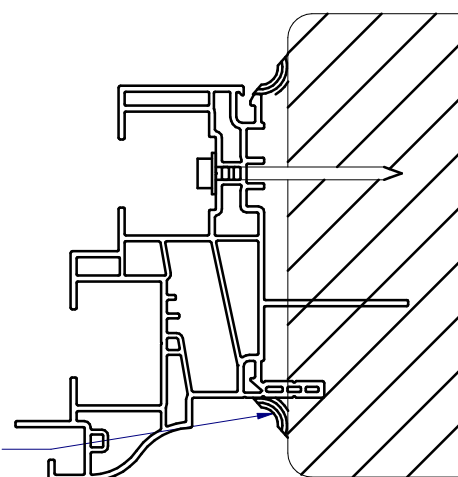

D
8 HORIZONTAL SECTION
BOX FRAME INSTALLATION
SIMILAR FOR SILL AND JAMBS FOR BOX INSTALLATION

FLANGE REMOVAL NOTE: PARTIALLY OR FULLY REMOVING THE FLANGE, UP TO AND INCLUDING A BOX-FRAME APPLICATION IS ACCEPTABLE PROVIDED:

- MIN. 1/4" FILLET OF CONSTRUCTION-GRADE ADHESIVE CAULK IS APPLIED INSIDE AND OUT, FULL PERIMETER, BY INSTALLER.
- PRODUCT ANCHORAGE IS IN ACCORDANCE WITH REQUIREMENTS AS SHOWN FOR FLANGE WINDOWS.

TABLE 1: APPROVED INSTALLATION FASTENERS

| FRAME TYPE | SUBSTRATE TYPE | ANCHOR TYPE | MIN. EMBEDMENT | MIN. EDGE DIST. |
|------------|---|--|-------------------------|-----------------|
| FLANGE | CONCRETE (2.0 KSI MIN.) | 3/16" ITW TAPCON | 1" | 1-1/8" |
| FLANGE | HOLLOW OR GROUT-FILLED CMU (117 PCF MIN.) | 3/16" ITW TAPCON | 1" | 2" |
| FLANGE | CONCRETE (2.85 KSI MIN.) | 3/16" ELCO ULTRACON | 1" | 1" |
| FLANGE | GROUT-FILLED CMU (ASTM C-90) | 3/16" ELCO ULTRACON | 1-1/4" | 2-1/2" |
| FLANGE | 2X MIN. SOUTHERN PINE (G=0.55) | 3/16" ITW TAPCON OR ELCO ULTRACON | 1-3/8" | 7/8" |
| FLANGE | 2X MIN. SOUTHERN PINE (G=0.55) | #10 PHILLIPS PH SHEET METAL SCREW W/ WASHER COMBO | 2" | 7/8" |
| FLANGE | 16 GAUGE (0.060") MIN. STEEL STUD (33 KSI YIELD MIN) | #10-16 HILTI KWIK-FLEX OR ITW TEKS SELF-DRILLING SCREW | FULL THREAD THRU 0.060" | 7/16" |
| FLANGE | 1/8" ALUM. (6063-T5 MIN.) OR 1/8" STEEL (33 KSI MIN.) | #10 GRADE 5 SELF-TAPPING / DRILLING SCREW | FULL THREAD THRU 0.125" | 7/16" |
| FIN | 2X MIN. SOUTHERN PINE (G=0.55) | #10 PHILLIPS PH SHEET METAL SCREW W/ WASHER COMBO | 2" | 1/2" |

| NO. | DESCRIPTION: | BY: | DATE: |
|-----|------------------------|-----|---------|
| C | REVISED TO TDI REQUEST | JLD | 7/23/21 |
| B | REVISED TO TDI REQUEST | JML | 3/8/17 |
| A | REVISED TO TDI REQUEST | JML | 8/2/16 |

REVISIONS



8/5/2021

LUCAS A. TURNER, P.E.
TX PE # 115094
2428 Old Natchez Trc Trl
Camden, TN 38320
PH. 941-380-1574

SHEET DESCRIPTION:

INSTALLATION DETAILS

| | |
|-----------|----------|
| DRAWN BY: | DATE: |
| EMK | 12/17/15 |
| DWG #: | REV.: |
| TDI-936 | C |
| SCALE: | SHEET |
| 1:2 | 6 OF 6 |