







	B	C	D	E
1	1620 Single Hung - Bill of Materials	Last update: 9/16/2016		
2		  Report #: G1518 Date: 1/13/2017 Verified by: <i>Shirley P. Mahesh</i>		
3	Description	MIWD Part No.	Vendor Part No.	Rev.
4	ITEMS IN YELLOW ARE OPTIONS NOT RELEASED FOR PRODUCTION			
5	ITEMS IN RED NEED PART NUMBERS ESTABLISHED			
6	Mainframe:			
7	Finless:			
8	Mainframe Head/Jamb, Finless, 240" - Almond	V010080A	V-1008	-
9	Mainframe Head/Jamb, Finless, 240" - White	V010080C	V-1008	-
10	Mainframe Head/Jamb, Finless, 240" - Clay	V010080D	V-1008	-
11	Mainframe Head/Jamb, Finless, 240" - White (Ext), Hillside Oak (Int)	V010080H	V-1008	-
12	Mainframe Head/Jamb, Finless, 240" - White (Ext), Natural Oak (Int)	V010080N	V-1008	-
13	Mainframe Head/Jamb, Finless, 240" - White (Ext), Colonial Cherry (Int)	V010080Z	V-1008	-
14	Mainframe Head/Jamb, Finless, 240" - Almond (Ext), Hillside Oak (Int)	V010082H	V-1008	-
15	Mainframe Head/Jamb, Finless, 240" - Almond (Ext), Natural Oak (Int)	V010082N	V-1008	-
16	Mainframe Head/Jamb, Finless, 240" - Almond (Ext), Colonial Cherry (Int)	V010082Z	V-1008	-
17	Mainframe Head/Jamb, Finless 240" - Bronze (Ext), White (Int)	V010087B	V-1008	-
18				
19	Mainframe Sill, Finless, w/ Weatherstrip, 240" - Almond	V010130A	V-1013	-
20	Mainframe Sill, Finless, w/ Weatherstrip, 240" - White	V010130C	V-1013	-
21	Mainframe Sill, Finless, w/ Weatherstrip, 240" - Clay	V010130D	V-1013	-
22	Mainframe Sill, Finless, w/ Weatherstrip, 240" - White (Ext), Hillside Oak (Int)	V010130H	V-1013	-
23	Mainframe Sill, Finless, w/ Weatherstrip, 240" - White (Ext), Natural Oak (Int)	V010130N	V-1013	-
24	Mainframe Sill, Finless, w/ Weatherstrip, 240" - White (Ext), Colonial Cherry (Int)	V010130Z	V-1013	-
25	Mainframe Sill, Finless, w/ Weatherstrip, 240" - Almond (Ext), Hillside Oak (Int)	V010132H	V-1013	-
26	Mainframe Sill, Finless, w/ Weatherstrip, 240" - Almond (Ext), Natural Oak (Int)	V010132N	V-1013	-
27	Mainframe Sill, Finless, w/ Weatherstrip, 240" - Almond (Ext), Colonial Cherry (Int)	V010132Z	V-1013	-
28	Mainframe Sill, Finless, w/ Weatherstrip, 240" - Bronze (Ext), White (Int)	V010137B	V-1013	-
29				
30	Fin:			
31	Mainframe Head/Jamb, Fin, 240" - Almond	V010070A	V-1007	-
32	Mainframe Head/Jamb, Fin, 240" - White	V010070C	V-1007	-
33	Mainframe Head/Jamb, Fin, 240" - Clay	V010070D	V-1007	-
34	Mainframe Head/Jamb, Fin, 240" - White (Ext), Hillside Oak (Int)	V010070H	V-1007	-
35	Mainframe Head/Jamb, Fin, 240" - White (Ext), Natural Oak (Int)	V010070N	V-1007	-
36	Mainframe Head/Jamb, Fin, 240" - White (Ext), Colonial Cherry (Int)	V010070Z	V-1007	-
37	Mainframe Head/Jamb, Fin, 240" - Almond (Ext), Hillside Oak (Int)	V010072H	V-1007	-
38	Mainframe Head/Jamb, Fin, 240" - Almond (Ext), Natural Oak (Int)	V010072N	V-1007	-
39	Mainframe Head/Jamb, Fin, 240" - Almond (Ext), Colonial Cherry (Int)	V010072Z	V-1007	-
40	Mainframe Head/Jamb, Fin 240" - Bronze (Ext), White (Int)	V010077B	V-1007	-
41				
42	Mainframe Sill, Fin, w/ Weatherstrip, 240" - Almond	V010120A	V-1012	-
43	Mainframe Sill, Fin, w/ Weatherstrip, 240" - White	V010120C	V-1012	-
44	Mainframe Sill, Fin, w/ Weatherstrip, 240" - Clay	V010120D	V-1012	-
45	Mainframe Sill, Fin, w/ Weatherstrip, 240" - White (Ext), Hillside Oak (Int)	V010120H	V-1012	-
46	Mainframe Sill, Fin, w/ Weatherstrip, 240" - White (Ext), Natural Oak (Int)	V010120N	V-1012	-
47	Mainframe Sill, Fin, w/ Weatherstrip, 240" - White (Ext), Colonial Cherry (Int)	V010120Z	V-1012	-
48	Mainframe Sill, Fin, w/ Weatherstrip, 240" - Almond (Ext), Hillside Oak (Int)	V010122H	V-1012	-
49	Mainframe Sill, Fin, w/ Weatherstrip, 240" - Almond (Ext), Natural Oak (Int)	V010122N	V-1012	-
50	Mainframe Sill, Fin, w/ Weatherstrip, 240" - Almond (Ext), Colonial Cherry (Int)	V010122Z	V-1012	-
51	Mainframe Sill, Fin, w/ Weatherstrip, 240" - Bronze (Ext), White (Int)	V010127B	V-1012	-
52				
53	Fin w/J: (NOT RELEASED)			
54	Mainframe Head/Jamb, Fin w/J, 240" - Almond	V010060A	V-1006	-
55	Mainframe Head/Jamb, Fin w/J, 240" - White	V010060C	V-1006	-
56	Mainframe Head/Jamb, Fin w/J, 240" - Clay	V010060D	V-1006	-
57	Mainframe Head/Jamb, Fin w/J, 240" - White (Ext), Hillside Oak (Int)	V010060H	V-1006	-
58	Mainframe Head/Jamb, Fin w/J, 240" - White (Ext), Natural Oak (Int)	V010060N	V-1006	-
59	Mainframe Head/Jamb, Fin w/J, 240" - White (Ext), Colonial Cherry (Int)	V010060Z	V-1006	-
60	Mainframe Head/Jamb, Fin w/J, 240" - Almond (Ext), Hillside Oak (Int)	V010062H	V-1006	-
61	Mainframe Head/Jamb, Fin w/J, 240" - Almond (Ext), Natural Oak (Int)	V010062N	V-1006	-
62	Mainframe Head/Jamb, Fin w/J, 240" - Almond (Ext), Colonial Cherry (Int)	V010062Z	V-1006	-
63	Mainframe Head/Jamb, Fin w/J, 240" - Bronze (Ext), White (Int)	V010067B	V-1006	-
64				
65	Mainframe Sill, Fin w/J, w/ Weatherstrip, 240" - Almond	V010110A	V-1011	-
66	Mainframe Sill, Fin w/J, w/ Weatherstrip, 240" - White	V010110C	V-1011	-
67	Mainframe Sill, Fin w/J, w/ Weatherstrip, 240" - Clay	V010110D	V-1011	-
68	Mainframe Sill, Fin w/J, w/ Weatherstrip, 240" - White (Ext), Hillside Oak (Int)	V010110H	V-1011	-
69	Mainframe Sill, Fin w/J, w/ Weatherstrip, 240" - White (Ext), Natural Oak (Int)	V010110N	V-1011	-
70	Mainframe Sill, Fin w/J, w/ Weatherstrip, 240" - White (Ext), Colonial Cherry (Int)	V010110Z	V-1011	-
71	Mainframe Sill, Fin w/J, w/ Weatherstrip, 240" - Almond (Ext), Hillside Oak (Int)	V010112H	V-1011	-
72	Mainframe Sill, Fin w/J, w/ Weatherstrip, 240" - Almond (Ext), Natural Oak (Int)	V010112N	V-1011	-
73	Mainframe Sill, Fin w/J, w/ Weatherstrip, 240" - Almond (Ext), Colonial Cherry (Int)	V010112Z	V-1011	-
74	Mainframe Sill, Fin w/J, w/ Weatherstrip, 240" - Bronze (Ext), White (Int)	V010117B	V-1011	-
75				
76	Flange:			
77	Mainframe Head/Jamb, Flange, 240" - Almond	V010100A	V-1010	-
78	Mainframe Head/Jamb, Flange, 240" - White	V010100C	V-1010	-
79	Mainframe Head/Jamb, Flange, 240" - Clay	V010100D	V-1010	-
80	Mainframe Head/Jamb, Flange, 240" - White (Ext), Hillside Oak (Int)	V010100H	V-1010	-
81	Mainframe Head/Jamb, Flange, 240" - White (Ext), Natural Oak (Int)	V010100N	V-1010	-
82	Mainframe Head/Jamb, Flange, 240" - White (Ext), Colonial Cherry (Int)	V010100Z	V-1010	-
83	Mainframe Head/Jamb, Flange, 240" - Almond (Ext), Hillside Oak (Int)	V010102H	V-1010	-
84	Mainframe Head/Jamb, Flange, 240" - Almond (Ext), Natural Oak (Int)	V010102N	V-1010	-
85	Mainframe Head/Jamb, Flange, 240" - Almond (Ext), Colonial Cherry (Int)	V010102Z	V-1010	-
86	Mainframe Head/Jamb, Flange, 240" - Bronze (Ext), White (Int)	V010107B	V-1010	-
87				
88	Mainframe Sill, Flange, w/ Weatherstrip, 240" - Almond	V010150A	V-1015	-
89	Mainframe Sill, Flange, w/ Weatherstrip, 240" - White	V010150C	V-1015	-
90	Mainframe Sill, Flange, w/ Weatherstrip, 240" - Clay	V010150D	V-1015	-
91	Mainframe Sill, Flange, w/ Weatherstrip, 240" - White (Ext), Hillside Oak (Int)	V010150H	V-1015	-
92	Mainframe Sill, Flange, w/ Weatherstrip, 240" - White (Ext), Natural Oak (Int)	V010150N	V-1015	-
93	Mainframe Sill, Flange, w/ Weatherstrip, 240" - White (Ext), Colonial Cherry (Int)	V010150Z	V-1015	-
94	Mainframe Sill, Flange, w/ Weatherstrip, 240" - Almond (Ext), Hillside Oak (Int)	V010152H	V-1015	-
95	Mainframe Sill, Flange, w/ Weatherstrip, 240" - Almond (Ext), Natural Oak (Int)	V010152N	V-1015	-
96	Mainframe Sill, Flange, w/ Weatherstrip, 240" - Almond (Ext), Colonial Cherry (Int)	V010152Z	V-1015	-
97	Mainframe Sill, Flange, w/ Weatherstrip, 240" - Bronze (Ext), White (Int)	V010157B	V-1015	-
98				
99	Operable Screen Track No Leg 180" Vertical (Aluminum) Mill Wht WP .187x.210	M2341000	M-2341	
100	Operable Screen Track No Leg 180" Vertical (Aluminum) White Wht WP .187x.210	M234100A	M-2341	
101	Operable Screen Track No Leg 180" Vertical (Aluminum) Almond Gry WP .187x.210	M234100C	M-2341	
102	Operable Screen Track No Leg 180" Vertical (Aluminum) Clay Gry WP .187x.210	M234100D	M-2341	
103				
104	Balance, 3 LB, Inverted Coil Single, 150/BX	BL500310	24C0009103	
105	Balance, 4 LB, Inverted Coil Single, 150/BX	BL500311	24C0009104	
106	Balance, 5 LB, Inverted Coil Single, 150/BX	BL500312	24C0009105	
107	Balance, 6 LB, Inverted Coil Single, 150/BX	BL500313	24C0009106	
108	Balance, 7 LB, Inverted Coil Single, 150/BX	BL500314	24C0009107	
109	Balance, 8 LB, Inverted Coil Single, 150/BX	BL500315	24C0009108	
110	Balance, 9 LB, Inverted Coil Single, 150/BX	BL500316	24C0009109	
111	Balance, 10 LB, Inverted Coil Single, 150/BX	BL500317	24C0009110	
112	Balance, 11 LB, Inverted Coil Double, 100/BX	BL500318	24C0009211	
113	Balance, 12 LB, Inverted Coil Double, 100/BX	BL500319	24C0009212	
114	Balance, 13 LB, Inverted Coil Double, 100/BX	BL500320	24C0009213	
115	Balance, 14 LB, Inverted Coil Double, 100/BX	BL500321	24C0009214	

B		C	D	E
1	1620 Single Hung - Bill of Materials	Last update: 9/16/2016		
2	  Report #: G1518 Date: 1/13/2017 Verified by: <i>John P. Mahall</i>			
3		MIWD Part No.	Vendor Part No.	Rev.
116	Balance, 15 LB, Inverted Coil Double, 100/BX	BL500322	24C0009215	
117	Balance, 16 LB, Inverted Coil Double, 100/BX	BL500323	24C0009216	
118	Balance, 17 LB, Inverted Coil Double, 100/BX	BL500324	24C0009217	
119	Balance, 18 LB, Inverted Coil Double, 100/BX	BL500325	24C0009218	
120	Balance, 19 LB, Inverted Coil Double, 100/BX	BL500326	24C0009219	
121	Balance, 20 LB, Inverted Coil Double, 100/BX	BL500327	24C0009220	
122	Balance, 21 LB, Inverted Coil Triple, 50/BX	BL500328	24C0009321	
123	Balance, 22 LB, Inverted Coil Triple, 50/BX	BL500329	24C0009322	
124	Balance, 23 LB, Inverted Coil Triple, 50/BX	BL500330	24C0009323	
125	Balance, 24 LB, Inverted Coil Triple, 50/BX	BL500331	24C0009324	
126	Balance, 25 LB, Inverted Coil Triple, 50/BX	BL500332	24C0009325	
127	Balance, 26 LB, Inverted Coil Triple, 50/BX	BL500333	24C0009326	
128	Balance, 27 LB, Inverted Coil Triple, 50/BX	BL500334	24C0009327	
129	Balance, 28 LB, Inverted Coil Triple, 50/BX	BL500335	24C0009328	
130	Balance, 29 LB, Inverted Coil Triple, 50/BX	BL500336	24C0009329	
131	Balance, 30 LB, Inverted Coil Triple, 50/BX	BL500337	24C0009330	
132				
133	Balance Screw, #8-15 x 3/4" PFH, Zinc	FS000220		-
134				
135	Dust Pad, 1" Die Cut 1.7 LB Poly Foam (White)	WS30280C		-
136				
137	Vent Stop, Push Button - Almond	L000091A	1760_109	-
138	Vent Stop, Push Button - White	L000091C	1760_005	-
139	Vent Stop, Push Button - Clay	L000091D	1760_005	-
140	Vent Stop, Push Button - Brown	L000091X	1760_202	-
141				
142	Foam Tape, 7/16" x 2 1/2"	MS300420	G-7162	-
143				
144	J-Hook, Reinforced, Left	HD006130	14065-999	-
145	J-Hook, Reinforced, Right	HD006140	14066-999	-
146				
147	J-Hook Screw, Shipment, #8 x 1" PPH, SMS, SS	FS002980	CBS8X1SS	-
148	J-Hook Screw, Installation, #8 x 2" PPH, SMS, SS			
149				
150	Fixed Meeting Rail:			
151	Fixed Meeting Rail, w/Weatherstrip, 240" - Almond	V101600A	V-1016	
152	Fixed Meeting Rail, w/Weatherstrip, 240" - White	V101600C	V-1016	
153	Fixed Meeting Rail, w/Weatherstrip, 240" - Clay	V101600D	V-1016	
154	Fixed Meeting Rail, w/ Weatherstrip, 240" - White (Ext), Hillside Oak (Int)	V101600H	V-1016	
155	Fixed Meeting Rail, w/ Weatherstrip, 240" - White (Ext), Natural Oak (Int)	V101600N	V-1016	
156	Fixed Meeting Rail, w/ Weatherstrip, 240" - White (Ext), Colonial Cherry (Int)	V101600Z	V-1016	
157	Fixed Meeting Rail, w/ Weatherstrip, 240" - Almond (Ext), Hillside Oak (Int)	V101602H	V-1016	
158	Fixed Meeting Rail, w/ Weatherstrip, 240" - Almond (Ext), Natural Oak (Int)	V101602N	V-1016	
159	Fixed Meeting Rail, w/ Weatherstrip, 240" - Almond (Ext), Colonial Cherry (Int)	V101602Z	V-1016	
160	Fixed Meeting Rail, w/ Weatherstrip, 240" - Bronze (Ext), White (Int)	V101607B	V-1016	
161				
162	Attachment Screws #8 x 2 1/2" Vinyl HLD Truss HD 410	FS000270		
163				
164	Fixed Meeting Rail Aluminum Reinforcement	M2343010	M-2343	
165				
166				
167	Adjustable Keeper, Face Mount - Almond	K000200A	8383.104	-
168	Adjustable Keeper, Face Mount - White	K000200C	8383.008	-
169	Adjustable Keeper, Face Mount - Clay	K000200D	8383.304	-
170	Adjustable Keeper, Face Mount - EarthTone	K000200x	8383.202	-
171				
172	Keeper Screw, #6 x 3/4" PFH, #2 Self-Drill, 9/64" Point, 410 SS - Almond	FS00510A	-	-
173	Keeper Screw, #6 x 3/4" PFH, #2 Self-Drill, 9/64" Point, 410 SS - White	FS00510C	-	-
174	Keeper Screw, #6 x 3/4" PFH, #2 Self-Drill, 9/64" Point, 410 SS - Brown	FS00510X	-	-
175	Keeper Screw, #6 x 3/4" PFH, #2 Self-Drill, 9/64" Point, 410 SS - Clay	FS00510D	-	-
176				
177	Setting Blocks 1/8" x 7/8" x 7/8" for 7/8" IG thickness	MS100050		
178	Setting Blocks 1/8" x 3/4" x 3/4" for 3/4" IG thickness	MS100010		
179	Glazing		Pecora 896TBS	
180				
181	Sealant			-
182				
183	I.G. Unit, Thickness and Make-Up varies with option selected			-
184				
185	Glazing Bead, 3/4" IG, 192" - Almond	V090400A	V-904	-
186	Glazing Bead, 3/4" IG, 192" - White	V090400C	V-904	-
187	Glazing Bead, 3/4" IG, 192" - Bronze, White	V090400B	V-904	-
188	Glazing Bead, 3/4" IG, 192" - Clay	V090400D	V-904	-
189				
190	Glazing Bead, 7/8" IG, 192" - Almond	V067600A	V-676	D
191	Glazing Bead, 7/8" IG, 192" - White	V067600C	V-676	D
192	Glazing Bead, 7/8" IG, 192" - Bronze, White	V067601B	V-676	D
193	Glazing Bead, 7/8" IG, 192" - Clay	V090400D	V-676	-
194				
195	Bottom Sash (Standard Sash):			
196	Bottom Sash, Top Rail, w/ Weatherstrip, 192" - Almond	V067500A	V-675	F
197	Bottom Sash, Top Rail, w/ Weatherstrip, 192" - White	V067500C	V-675	F
198	Bottom Sash, Top Rail, w/ Weatherstrip, 192" - Clay	V067500D	V-675	F
199	Bottom Sash, Top Rail, w/ Weatherstrip, 192" - White (Ext), Hillside Oak (Int)	V067500H	V-675	F
200	Bottom Sash, Top Rail, w/ Weatherstrip, 192" - White (Ext), Natural Oak (Int)	V067500N	V-675	F
201	Bottom Sash, Top Rail, w/ Weatherstrip, 192" - White (Ext), Colonial Cherry (Int)	V067500Z	V-675	F
202	Bottom Sash, Top Rail, w/ Weatherstrip, 192" - Almond (Ext), Hillside Oak (Int)	V067501H	V-675	F
203	Bottom Sash, Top Rail, w/ Weatherstrip, 192" - Almond (Ext), Natural Oak (Int)	V067501N	V-675	F
204	Bottom Sash, Top Rail, w/ Weatherstrip, 192" - Almond (Ext), Colonial Cherry (Int)	V067501Z	V-675	F
205	Bottom Sash, Top Rail, w/ Weatherstrip, 192" - Bronze (Ext), White (Int)	V067500B	V-675	F
206				
207	Lock Rail Liner - (Aluminum) Various lengths and part no. - part no. for 14" (Primary Reinf)	M2115000	M-2115	-
208				
209	Lock Rail Liner - (Fiberglass) Various lengths and part no. - part no. for 14" (Secondary Reinf)	MS400340		-
210				
211				
212	Bottom Sash, Bottom Rail, 192" - Almond	V067200A	V-672	C
213	Bottom Sash, Bottom Rail, 192" - White	V067200C	V-672	C
214	Bottom Sash, Bottom Rail, 192" - Clay	V067200D	V-672	D
215	Bottom Sash, Bottom Rail, 192" - White (Ext), Hillside Oak (Int)	V067200H	V-672	C
216	Bottom Sash, Bottom Rail, 192" - White (Ext), Natural Oak (Int)	V067200N	V-672	C
217	Bottom Sash, Bottom Rail, 192" - White (Ext), Colonial Cherry (Int)	V067200Z	V-672	C
218	Bottom Sash, Bottom Rail, 192" - Almond (Ext), Hillside Oak (Int)	V067201H	V-672	C
219	Bottom Sash, Bottom Rail, 192" - Almond (Ext), Natural Oak (Int)	V067201N	V-672	C
220	Bottom Sash, Bottom Rail, 192" - Almond (Ext), Colonial Cherry (Int)	V067201Z	V-672	C
221	Bottom Sash, Bottom Rail, 192" - Bronze (Ext), White (Int)	V067200B	V-672	C
222				
223	Bottom Sash, Bottom Rail, Interior Bulb Seal, .187 x .350 - Almond	MS20002A	32087111891500	-
224	Bottom Sash, Bottom Rail, Interior Bulb Seal, .187 x .350 - White	MS20002C	32087112191500	-
225	Bottom Sash, Bottom Rail, Interior Bulb Seal, .187 x .350 - Black	MS20002L	G32087L	-
226				
227	Bottom Sash, Bottom Rail, Exterior Bulb Seal, .187 x .350 - Almond	MS30000A	32324	-
228	Bottom Sash, Bottom Rail, Exterior Bulb Seal, .187 x .350 - White	MS30000C	32324	-

	B	C	D	E
1	1620 Single Hung - Bill of Materials	Last update: 9/16/2016		
2		 		
3	Description	MIWD Part No.	Vendor Part No.	Rev.
229	Bottom Sash, Bottom Rail, Exterior Bulb Seal, .187 x .350 - Black	MS30000L	32324	-
230				
231	Bottom Sash, Stile, w/ Weatherstrip - Almond	V067000A	V-670	B
232	Bottom Sash, Stile, w/ Weatherstrip - White	V067000C	V-670	B
233	Bottom Sash, Stile, w/ Weatherstrip - Clay	V067000D	V-670	B
234	Bottom Sash, Stile, w/ Weatherstrip - White (Ext), Hillside Oak (Int)	V067000H	V-670	B
235	Bottom Sash, Stile, w/ Weatherstrip - White (Ext), Natural Oak (Int)	V067000N	V-670	B
236	Bottom Sash, Stile, w/ Weatherstrip - White (Ext), Colonial Cherry (Int)	V067000Z	V-670	B
237	Bottom Sash, Stile, w/ Weatherstrip - Almond (Ext), Hillside Oak (Int)	V067001H	V-670	B
238	Bottom Sash, Stile, w/ Weatherstrip - Almond (Ext), Natural Oak (Int)	V067001N	V-670	B
239	Bottom Sash, Stile, w/ Weatherstrip - Almond (Ext), Colonial Cherry (Int)	V067001Z	V-670	B
240	Bottom Sash, Stile, w/ Weatherstrip - Bronze (Ext), White (Int)	V067002B	V-670	B
241				
242	Lift Rail/Stile Reinforcement - (Aluminum) Various lengths and part no. - part no. for 14" (Primary Reinf)	M2266000	M-2266	-
243				
244	Lift Rail/Stile Reinforcement - (Fiberglass), Bottom Sash, Bottom Rail (Secondary Reinf)	MS400330	MS400330	
245				
246	Dust Plug, 5/8", Kiss Cut - White	WS30001C	430875WHAK0600	-
247	Dust Plug, 5/8", Kiss Cut - Gray	WS30001G	430875GYAK0600	-
248				
249	Lock, Standard:			
250	Cam Lock, Left - Almond	LL00014A	A3074140324	-
251	Cam Lock, Left - White	LL00014C	A3074140342	-
252	Cam Lock, Left - Dayton Brown	LL00014T	A30741403TB	-
253	Cam Lock, Left - Brass Plated	LL000441	A3074140313	-
254	Cam Lock, Left - Brushed Nickel	LL000442	A3074140319	-
255				
256	Cam Lock, Right - Almond	LR00014A	A3074140224	-
257	Cam Lock, Right - White	LR00014C	A3074140242	-
258	Cam Lock, Right - Dayton Brown	LR00014T	A30741402TB	-
259	Cam Lock, Right - Brass Plated	LR000441	A3074140213	-
260	Cam Lock, Right - Brushed Nickel	LR000442	A3074140219	-
261				
262	Hybrid Recessed Cam Lock Left - Almond	LL00068A	98181-L.104	-
263	Hybrid Recessed Cam Lock Left - White	LL00068C	98181-L.008	-
264	Hybrid Recessed Cam Lock Left - Earthtone	LL00068T	98181-L.202	-
265	Hybrid Recessed Cam Lock Left - Clay	LL00068D	98181-L	-
266				
267	Hybrid Recessed Cam Lock Right - Almond	LR00068A	98181-R.104	
268	Hybrid Recessed Cam Lock Right - White	LR00068C	98181-R.008	
269	Hybrid Recessed Cam Lock Right - Earthtone	LR00068T	98181-R.202	
270	Hybrid Recessed Cam Lock Right - Clay	LR00068D	98181-R	-
271				
272	Lock, Window World Logo			
273	Cam Lock, Window World, Left - Almond	LL00064A	A30741411.24	-
274	Cam Lock, Window World, Left - White	LL00064C	A30741411.42	-
275	Cam Lock, Window World, Left - Brown	LL00064T	A30741411.TB	-
276	Cam Lock, Window World, Left - Clay	LL00064D	A30741411	-
277				
278	Cam Lock, Window World, Right - Almond	LR00064A	A30741409.24	-
279	Cam Lock, Window World, Right - White	LR00064C	A30741409.42	-
280	Cam Lock, Window World, Right - Brown	LR00064T	A30741409.TB	-
281	Cam Lock, Window World, Right - Clay	LR00064D	A30741409	-
282				
283	Cam Lock Screw, #6-13 x 7/8", Tec Self-Tap - Almond	FS00700A	-	-
284	Cam Lock Screw, #6-13 x 7/8", Tec Self-Tap - White	FS00700C	-	-
285	Cam Lock Screw, #6-13 x 7/8", Tec Self-Tap - Clay	FS00700D	-	-
286	Cam Lock Screw, #6-13 x 7/8", Tec Self-Tap - Brown		-	-
287	Cam Lock Screw, #6-13 x 7/8", Tec Self-Tap - Brushed Nickel		2682	-
288	Cam Lock Screw, #6-13 x 7/8", Tec Self-Tap - Brass		2681	-
289				
290	Aluminum Reinforcement, B, Tilt-Latch, 4", Bottom Sash, Top Rail, 150"	M2116000	M-2116	A
291				
292	Tilt-Latch Assembly, High-Performance, Universal - Almond	TL00003A	75005-999-KH4	-
293	Tilt-Latch Assembly, High-Performance, Universal - White	TL00003C	75005-999-KH1	-
294	Tilt-Latch Assembly, High-Performance, Universal - Clay	TL00003D	75005-999-	-
295				
296				
297	Tilt-Latch Screw, #8 x 1" PFH, #6 Head, SMS, A, U48, 410 SS - Almond	FS00419A	-	-
298	Tilt-Latch Screw, #8 x 1" PFH, #6 Head, SMS, A, U48, 410 SS - White	FS00419C	-	-
299	Tilt-Latch Screw, #8 x 1" PFH, #6 Head, SMS, A, U48, 410 SS - Clay	FS00419D	-	-
300				
301	Pivot Bar, Locking Head, Offset, Zinc	HD100046		-
302				
303	Pivot Bar Screw,	FS000080		-
304				
305	Glazing		896 TBS	-
306				
307	Setting Block, 1/16" x 7/8" x 7/8"	MS100030	G062028K780GD	-
308	Setting Block, 1/8" x 7/8" x 7/8"	MS100050	G125028K780GD	-
309	Setting Block, 3/16" x 7/8" x 7/8"	MS100060	G187028K780GD	-
310	Setting Block, 1/8" x 7/8" x 3"	MS100190	RV859	-
311				
312	Glass Panel, 3/4" Overall IG, Make-up Varies with Options	-	-	-
313	Glass Panel, 7/8" Overall IG, Make-up Varies with Options	-	-	-
314				
315	Glazing Bead, 3/4" IG, 192" - Almond	V090400A	V-904	-
316	Glazing Bead, 3/4" IG, 192" - White	V090400C	V-904	-
317	Glazing Bead, 3/4" IG, 192" - Bronze, White	V090400B	V-904	-
318	Glazing Bead, 3/4" IG, 192" - Clay	V090400D	V-904	-
319				
320	Glazing Bead, 7/8" IG, 192" - Almond	V067600A	V-676	D
321	Glazing Bead, 7/8" IG, 192" - White	V067600C	V-676	D
322	Glazing Bead, 7/8" IG, 192" - Bronze, White	V067601B	V-676	D
323	Glazing Bead, 7/8" IG, 192" - Clay	V090400D	V-676	-
324				
325	Roll Form Half Screen (Standard):			
326	Screen Frame - White	SC30003C	A-105-6C	
327	Screen Frame - Almond	SC30003A	A-105-6A	
328	Screen Frame - Bronze	SC30003B	A-105-6B	
329	Screen Frame - Clay	SC30003D	A-105-6B	
330				
331	Screen Corner Key Right Dimple - White	IM10011M	AI205MOCDMPL_200205066501	
332	Screen Corner Key Right Dimple - Almond	IM10007K	AI205KDMPL	
333	Screen Corner Key Right Dimple - Dark Bronze	IM10010B	AI205DBDMPL	
334	Screen Corner Key Right Dimple - Clay (Not Available Yet)	IM10011D	AI205LWBDMPL	
335				
336	Screen Corner Key Left Dimple - White	IM10010M	AI205MOCDMPL_200205066501	
337	Screen Corner Key Left Dimple - Almond	IM10006K	AI205KDMPL	
338	Screen Corner Key Left Dimple - Dark Bronze	IM10010B	AI205DBDMPL	
339	Screen Corner Key Left Dimple - Clay (Not Available Yet)	IM10010D	AI205LWBDMPL	
340				
341	Screen Corner Key - White	IM10009M	AI205PMOC	

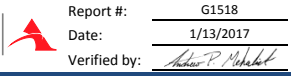
	B	C	D	E
1	1620 Single Hung - Bill of Materials	Last update: 9/16/2016		
2		  Report #: G1518 Date: 1/13/2017 Verified by: <i>[Signature]</i>		
3	Description	MIWD Part No.	Vendor Part No.	Rev.
342	Screen Corner Key - Almond	IM10010K	AI205PK	
343	Screen Corner Key - Dark Bronze	IM10009B	AI205P-DB	
344	Screen Corner Key - Clay (Not Available Yet)	IM10009D	AI205P-LWB	
345				
346	Finger Pull - Clear	IM00830	AI34270D00C32	
347				
348	Leaf Spring, Stainless Steel, 3"	HD002380	402A402G402	-
349				
350	Screen Mesh	Varies	Varies	-
351				
352	Screen Spline, Solid Foam, 0.140" Dia	SC60140L	1406000-1-SP	-
353				
354	Screen Warning Label	LB000003	GX7166	-
355				
356	Grids:			
357	Grid, 5/8" Flat, 144" - Almond	GD20013S	-	-
358	Grid, 5/8" Flat, 144" - White	GD20013C	-	-
359	Grid, 5/8" Flat, Two-Tone, 156" - White (Ext), Med-Oak (Int)	GD20600H	G31658DO/AW-01L	-
360	Grid, 5/8" Flat, Two-Tone, 156" - White (Ext), Oak (Int)	GD20600N	G31658LO/AW-01L	-
361	Grid, 5/8" Flat, Two-Tone, 156" - White (Ext), Earthtone (Int)	GD20600X	G31658ET/AW-01L	-
362	Grid, 5/8" Flat, Two-Tone, 156" - White (Ext), Cherry (Int)	GD20600Z	G31658CR/AW-01L	-
363	Grid, 5/8" Flat, Two-Tone, 156" - Almond (Ext), Med-Oak (Int)	GD20601H	G31658DO/T-01L	-
364	Grid, 5/8" Flat, Two-Tone, 156" - Almond (Ext), Oak (Int)	GD20601N	G31658LO/T-01L	-
365	Grid, 5/8" Flat, Two-Tone, 156" - Almond (Ext), Earthtone (Int)	GD20601X	G31658ET/T-01L	-
366	Grid, 5/8" Flat, Two-Tone, 156" - Almond (Ext), Cherry (Int)	GD20601Z	G31658CR/T-01L	-
367	Grid, 5/8" Flat, Two-Tone, 156" - Bronze (Ext), White (Int)	GD20423C	31658	-
368				
369	Clip, 5/8" Flat, Grid, Concealed, Cross	IM200000	GI165	-
370				
371	Clip, Grid Lock, End, 3/16" x 5/8" x 1/2"	IM20009G	316-50GL-580	-
372	Clip, Grid Lock, End, 3/16" x 5/8" x 1/4" (Triple)	HD00607L	40025GL580	-
373	Clip, Grid Lock, End, 3/16" x 5/8" x 3/16" (Triple)	HD00608L	40018GL580	-
374	Pin, Grid, End, 3/16" x 5/8" x 11/16" (7/8" I.G.)	HD00170G	316-62GL-580	-
375				
376				
377	Grid, 7/8" Flat, 144" - Almond	GD20014S	-	-
378	Grid, 7/8" Flat, 144" - White	GD20014C	G189SBG144	-
379				
380	Clip, 7/8" Flat, Grid, 4-Way, Cross	IM000910	I-219	-
381				
382	Clip, Grid Lock, End, 3/16" x 13/16" x 7/16"	HD00265G	330-43GL-340	-
383	Clip, Grid Lock, End, 3/16" x 3/4" x 1/4" (Triple)	HD00605L	43025GL340	-
384	Pin, Grid, End, 3/16" x 3/4" or 3/16" x 13/16" (7/8" I.G.)	HD00161G	33062GL340	-
385				
386				
387	Grid, 5.5mm x 11/16" Contour, 152" - Almond	GD21000A	EDA5.518T-05A	-
388	Grid, 5.5mm x 11/16" Contour, 152" - White	GD21000C	EDA5.518AW-05A	-
389	Grid, 5.5mm x 11/16" Contour, Laminate, 152" - White (Ext), Hillside Oak (Int)	GD21000H	EDA5.518TT	-
390	Grid, 5.5mm x 11/16" Contour, Laminate, 152" - White (Ext), Natural Oak (Int)	GD21000N	EDA5.518TT	-
391	Grid, 5.5mm x 11/16" Contour, Laminate, 152" - White (Ext), Earthtone (Int)	GD21000X	EDA5.518TT	-
392	Grid, 5.5mm x 11/16" Contour, Laminate, 152" - White (Ext), Colonial Cherry (Int)	GD21000Z	EDA5.518TT	-
393	Grid, 5.5mm x 11/16" Contour, Laminate, 152" - Almond (Ext), Hillside Oak (Int)	GD21001H	EDA5.518TT	-
394	Grid, 5.5mm x 11/16" Contour, Laminate, 152" - Almond (Ext), Natural Oak (Int)	GD21001N	EDA5.518TT	-
395	Grid, 5.5mm x 11/16" Contour, Laminate, 152" - Almond (Ext), Colonial Cherry (Int)	GD21001Z	EDA5.518TT	-
396	Grid, 5.5mm x 11/16" Contour, Laminate, 152" - Bronze (Ext), White (Int)	GD21000Q	EDA5.518TT	-
397				
398	Muntin, Joiner, Fish Mouth, Part A, 5.5mm x 11/16"	HD402060	DDE5.5AFMA-1	-
399	Muntin, Joiner, Fish Mouth, Part B, 5.5mm x 11/16"	HD402061	DDE5.5AFMB-1	-
400				
401	Clip, Grid Lock, End, 5.5mm x 18mm x 1/2"	HD001962	380-50GL-180	-
402				
403				
404	Grid, 5.5mm x 15/16" Contour, 156" - Almond	GD21010A	EDA5.525T-01	-
405	Grid, 5.5mm x 15/16" Contour, 156" - White	GD21010C	EDA5.525AW-01	-
406				
407	Muntin, Joiner, Fish Mouth, Part A, 5.5mm x 15/16"	HD402070	DDE5.525AFMA	-
408	Muntin, Joiner, Fish Mouth, Part B, 5.5mm x 15/16"	HD402071	DDE5.525AFMB	-
409				
410	Clip, Grid Lock, End, 5.5mm x 25mm x 1/2"	HD001961	382-50GL-250	-
411				
412	Miscellaneous Accessories:			
413				
414	Snap-In J-Channel, 156" - Almond	V681300A	V-6813	B
415	Snap-In J-Channel, 156" - White	V681300C	V-6813	B
416				
417	Head Expander, 1", 192" - Almond	V000100A	V-001	-
418	Head Expander, 1", 192" - White	V000100C	V-001	-
419	Head Expander, 1", 192" - Clay	V000100D	V-001	-
420	Head Expander, 1", 192" - White (Ext), Hillside Oak (Int)	V000100H	V-001	-
421	Head Expander, 1", 192" - White (Ext), Natural Oak (Int)	V000100N	V-001	-
422	Head Expander, 1", 192" - White (Ext), Colonial Cherry (Int)	V000100Z	V-001	-
423	Head Expander, 1", 192" - Almond (Ext), Hillside Oak (Int)	V000101H	V-001	-
424	Head Expander, 1", 192" - Almond (Ext), Natural Oak (Int)	V000101N	V-001	-
425	Head Expander, 1", 192" - Almond (Ext), Colonial Cherry (Int)	V000101Z	V-001	-
426	Head Expander, 1", 192" - Bronze (Ext), White (Int)	V000105B	V-001	-
427				
428	Sill Angle, 192" - Almond	V727602A	V-7276	-
429	Sill Angle, 192" - White	V727602C	V-7276	-
430	Sill Angle, 192" - Bronze (Ext), White (Int)	V027600B	V-7276	-
431	Sill Angle, 192" - Clay	V727602D	V-7276	-
432				
433	Extension Jamb, 4 9/16" (2 13/16"), Wood, Finger Jointed, White Pine, Primed	WD100125	-	-
434	Extension Jamb, 6 9/16" (4 13/16"), Wood, Finger Jointed, White Pine, Primed	WD100130	-	-
435				
436	Staple, 7/32" Crown, 1 3/8" Legs	-	SX50351-3/8G	-
437				
438	Corner, Extension Jamb, Cardboard, 3" x 3"	PK000501	-	-
439				
440	Staple, Corner, Extension Jamb, Cardboard, 1" x 1/2", 16 Ga.	FS004700	-	-
441				
442				
443	Mullions:			
444	Standard Mullion:			
445	Joiner Strip, Vinyl, 192" - Almond	V846301A	GV8463A192	-
446	Joiner Strip, Vinyl, 192" - White	V846301C	GV8463C192	-
447	Joiner Strip, Vinyl, 192" - Clay	V846301D	GV8463D192	-
448	Joiner Strip, Vinyl, 192" - Hillside Oak	V846300H	GV8463CH192	-
449	Joiner Strip, Vinyl, 192" - Natural Oak	V846300N	GV8463CN192	-
450	Joiner Strip, Vinyl, 192" - Colonial Cherry	V846300Z	-	-
451	Joiner Strip, Vinyl, 192" - Bronze	V846302B	GV8463CQ192	-
452				
453	Foam Tape, Mulling, 3/16" x 3", 50' Roll, Double-Sided Adhesive	MS300370	-	-

	B	C	D	E
1	1620 Single Hung - Bill of Materials	Last update: 9/16/2016		
2				
3	Description	MIWD Part No.	Vendor Part No.	Rev.
454				
455	Flange Mullion:			
456	Mull, HP, Aluminum, Vertical / Horizontal, 180" - Almond	M230000A	M-2300	-
457	Mull, HP, Aluminum, Vertical / Horizontal, 180" - White	M230000C	M-2300	-
458				
459	Mull, HP, Aluminum, Horizontal, Twin / Triple, 180" - Almond	M230100A	M-2301	-
460	Mull, HP, Aluminum, Horizontal, Twin / Triple, 180" - White	M230100C	M-2301	-
461				
462	Drip Cap, J-Channel, 183" - Almond	M180000A	M1800AM1800A183	-
463	Drip Cap, J-Channel, 183" - White	M180000C	M1800C183	-
464				
465	Drip Cap, Fin, 183" - Almond	M179900A	M1799AM1799A183	A
466	Drip Cap, Fin, 183" - White	M179900C	M1799CM1799C183	A
467	Drip Cap, Fin, 183" - Brown	M179900X	M1799X183	A
468				
469	Drip Cap, Finless, 183" - Almond	M164300A	M1643A183	A
470	Drip Cap, Finless, 183" - White	M164300C	M1643C183	A
471				
472				
473	Optional Window Opening Control Device (W.O.C.D.):			
474	Window Opening Control Device, Snap-In - Almond	HD40130A	1761VBG	-
475	Window Opening Control Device, Snap-In - White	HD40130C	1761JEW	-
476	Window Opening Control Device, Snap-In - Clay	HD40130D	1761	-
477				
478				
479	Packaging:			
480	Label, Window Warning	LB000003	GX7166	-
481				
482	Label, NFRC, 4" x 8", Thermal Transfer	LB000006	9916502G10317	-
483				
484	Label, AAMA - Gold	LB000750	029-019	-
485				
486	Label, Product (Misc.), 3" x 6", Shipping	LB000119	9916360	-
487				
488	Label, MIWD, 8 1/2" x 11", DH/NC, Backer	LB000700	29169	-
489	Label, Window World, 8 1/2" x 11", Care and Cleaning on Back	LB000740	31559	-
490				
491	Package Material, Cardboard Corner, Small	PK000109	GCB137_125# KRAFT	-
492	Package Material, Cardboard Corner, Large	PK000342	G256451	-
493				
494	Package Material, Honeycomb Strip, Small, 48" x 3" x 1", 1/2" Cell, Cookie Cut, 6"	PK000606	-	-
495	Package Material, Honeycomb Strip, Large, 4" x 40" x 3-1/2", PSA, 1-Side	PK000008	BCB1894	-
496				
497	Shipping Blocks, 2" x 2" x 6"	WD000016	-	-
498	Shipping Blocks, 2" x 2" x 120" (As Needed)		-	-
499				
500				
501				

	Report #:	G1518
	Date:	1/13/2017
	Verified by:	<i>Andrew P. Mahabadi</i>

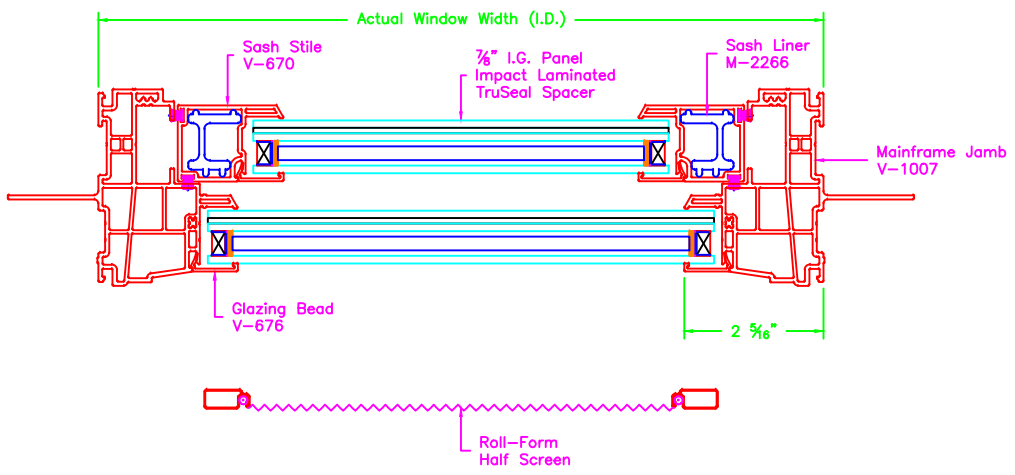
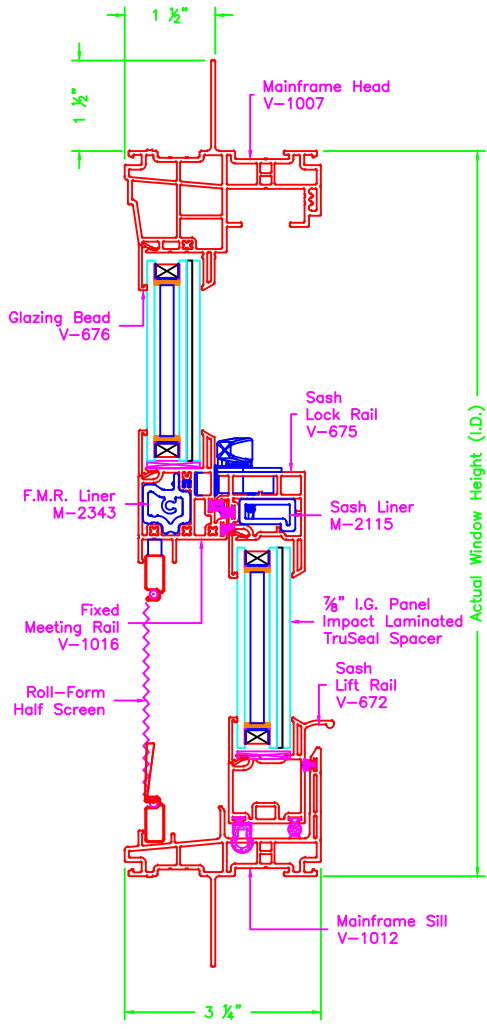

	Report #:	G1518
	Date:	1/13/2017
	Verified by:	<i>Andrew P. Mahab</i>

				MATERIAL: FINISH: UNSPECIFIED WALL: AREA: WEIGHT: PERIMETER:		MI WINDOWS AND DOORS, LLC. 650 WEST MARKET STREET GRATZ, PA 17030-0370 <small>The information, design or data shown on this document or electronic media is the exclusive property of MI Windows and Doors, LLC. It is considered confidential and proprietary and is made available for limited use only. Its use or reproduction without the expressed written consent of MI Windows and Doors, LLC., is prohibited.</small>		DESCRIPTION: 1620 Series Single Hung Impact with Mounting Fin Mainframe PRODUCT: 1620 DATE: 10/26/16 SCALE: 1:2 PART NUMBER: DFTM: BRS DRAWING NUMBER: CS-000400		
LTR	ECN #	REVISIONS	DATE	BY						

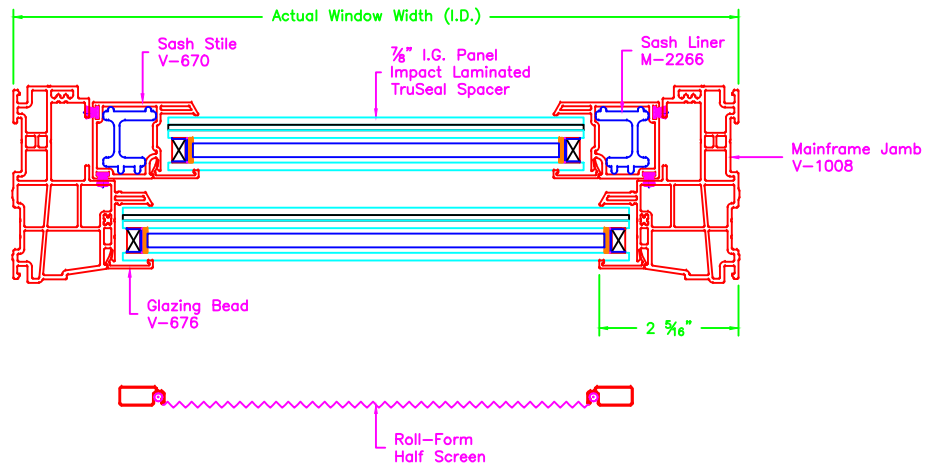
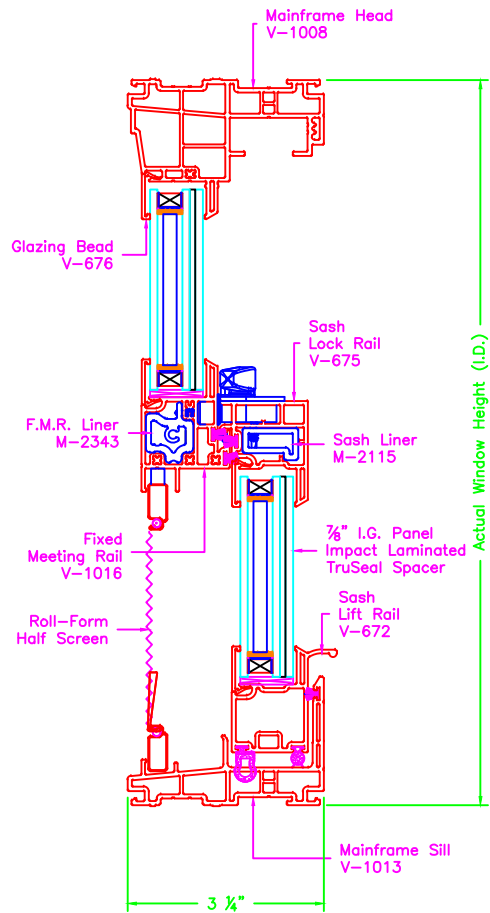

	Report #:	G1518
	Date:	1/13/2017
	Verified by:	<i>Andrew P. Mehabet</i>

				MATERIAL: FINISH: UNSPECIFIED WALL: AREA: WEIGHT: PERIMETER:		 MI WINDOWS AND DOORS, LLC. 650 WEST MARKET STREET GRATZ, PA 17030-0370 <small>The information, design or data shown on this document or electronic media is the exclusive property of MI Windows and Doors, LLC. It is considered confidential and proprietary and is made available for limited use only. Its use or reproduction without the expressed written consent of MI Windows and Doors, LLC., is prohibited.</small>		DESCRIPTION: 1620 Series Single Hung Impact with Finless Mainframe PRODUCT: 1620 DATE: 10/26/16 SCALE: 1:2 PART NUMBER: DFTM: BRS DRAWING NUMBER: CS-000401		
LTR	ECN #	REVISIONS	DATE	BY						

REVISION A

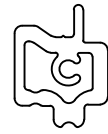

Scale 1:1

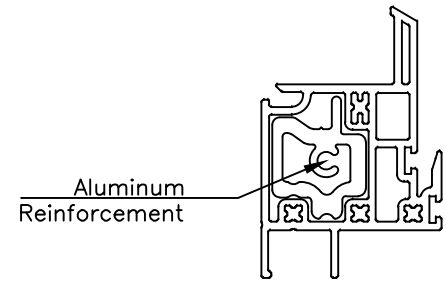
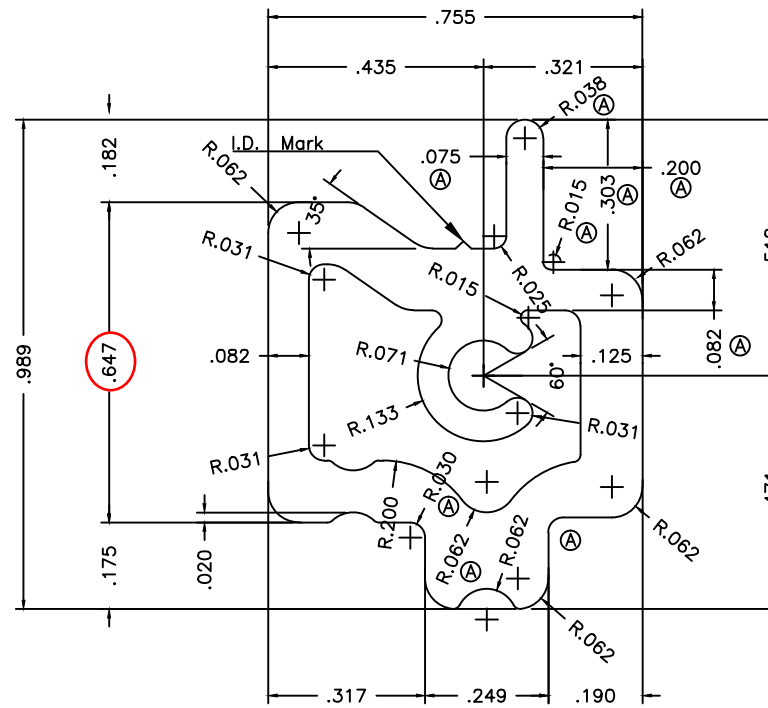

Report #: G1518

Date: 1/13/2017

Verified by: *Andrew P. Mahabadi*

				MATERIAL: 6063 T5		MIND MI WINDOWS AND DOORS 850 WEST MARKET STREET GWATZ, PA 17030-0370		DESCRIPTION: 1620 SH 1630 SS Fixed Meeting Rail Reinforcement		
				FINISH: Mill	UNSPECIFIED WALL:			PRODUCT: 1620 Single Hung, 1630 Single Slide DATE:		
				AREA: .312	Noted			SCALE: 4:1		PART NUMBER: M-2343
				WEIGHT: .374 Per/F	BREAK ALL CORNERS R.015, UNLESS OTHERWISE SPECIFIED	The information, design or data shown on this document or electronic media is the exclusive property of MI Windows and Doors, LLC. It is considered confidential and proprietary and is made available for limited use only. Its use or reproduction without the expressed written consent of MI Windows and Doors, LLC., is prohibited.				
A		Revision to Reinforcement to ease insertion.		07/20/16	HAL	DFTM: HAL DRAWING NUMBER: AE-000162				
LTR	ECN #	REVISIONS			DATE	BY				

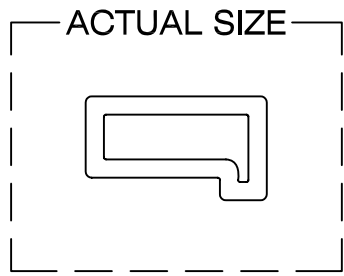
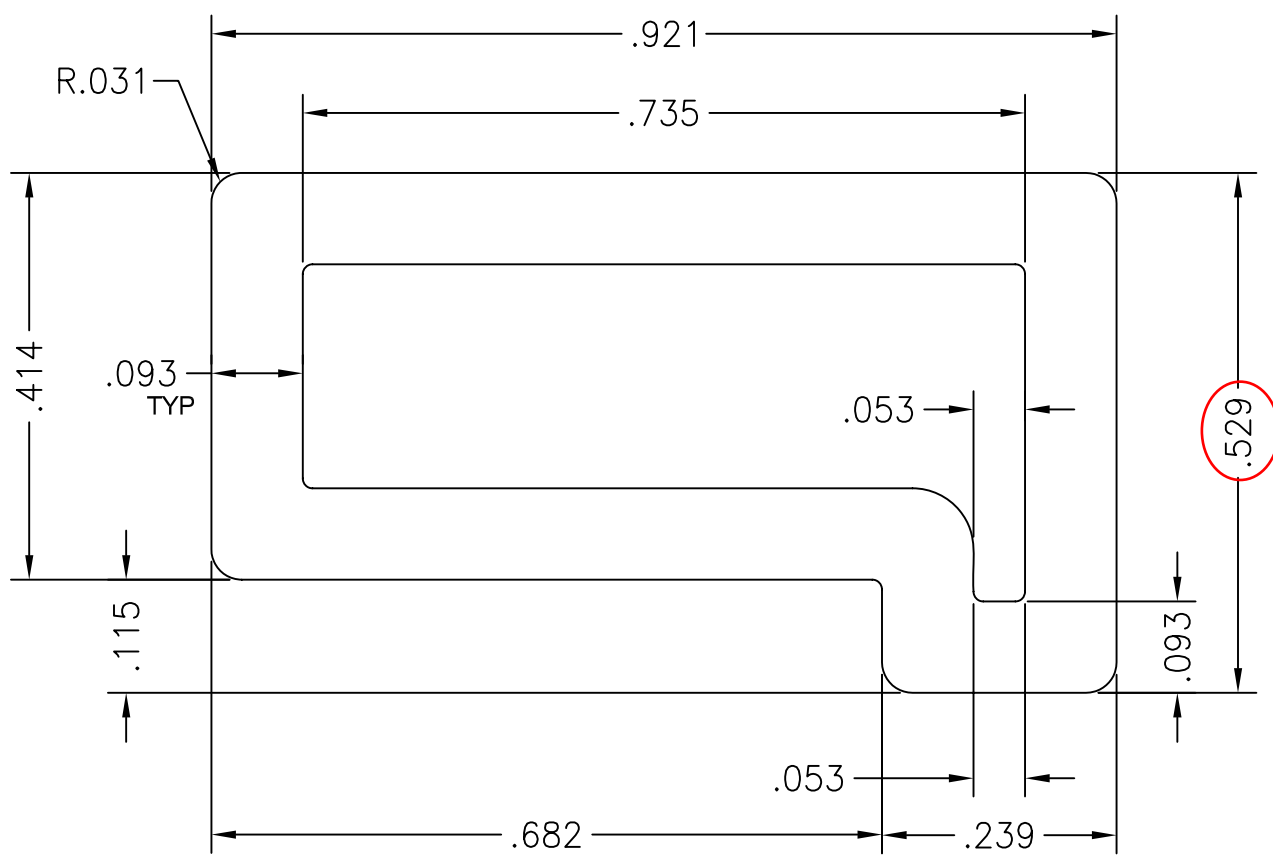



 Report #: G1518
 Date: 1/13/2017
 Verified by: *Andrew P. Mahabadi*

BREAK UNSPECIFIED SHARP CORNERS: R.010



MI WINDOWS AND DOORS
 650 WEST MARKET STREET • GRATZ, PA • 17030-0370

The information, design or data shown on this document or electronic media is the exclusive property of MI WINDOWS AND DOORS, INC. It is considered confidential and proprietary and is made available for limited use only. Its use or reproduction without the expressed written consent of MI WINDOWS AND DOORS, INC., is prohibited.

TITLE Series 3540 'Impact' Single Hung Lock Rail Reinforcement-A

DFTM. BRS		DATE 6/19/06	SCALE 5:1	CUSTOMER NAME				
AREA 0.234		PERIM. 2.829	EXT. PERIM. 4.937	WT./FT. 0.281	FACTOR -			
CIRCLE SIZE 1-2		CLASS HOLLOW	ALLOY/TEMPOR 6063-T5		FINISH -			
LTR		DESCRIPTION REVISIONS	BY	DATE	PLANT LOC. MILLERSBURG	THERMAL CAVITY -	DWG/PART NO. M-2115	REV. -

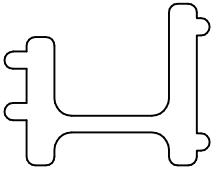
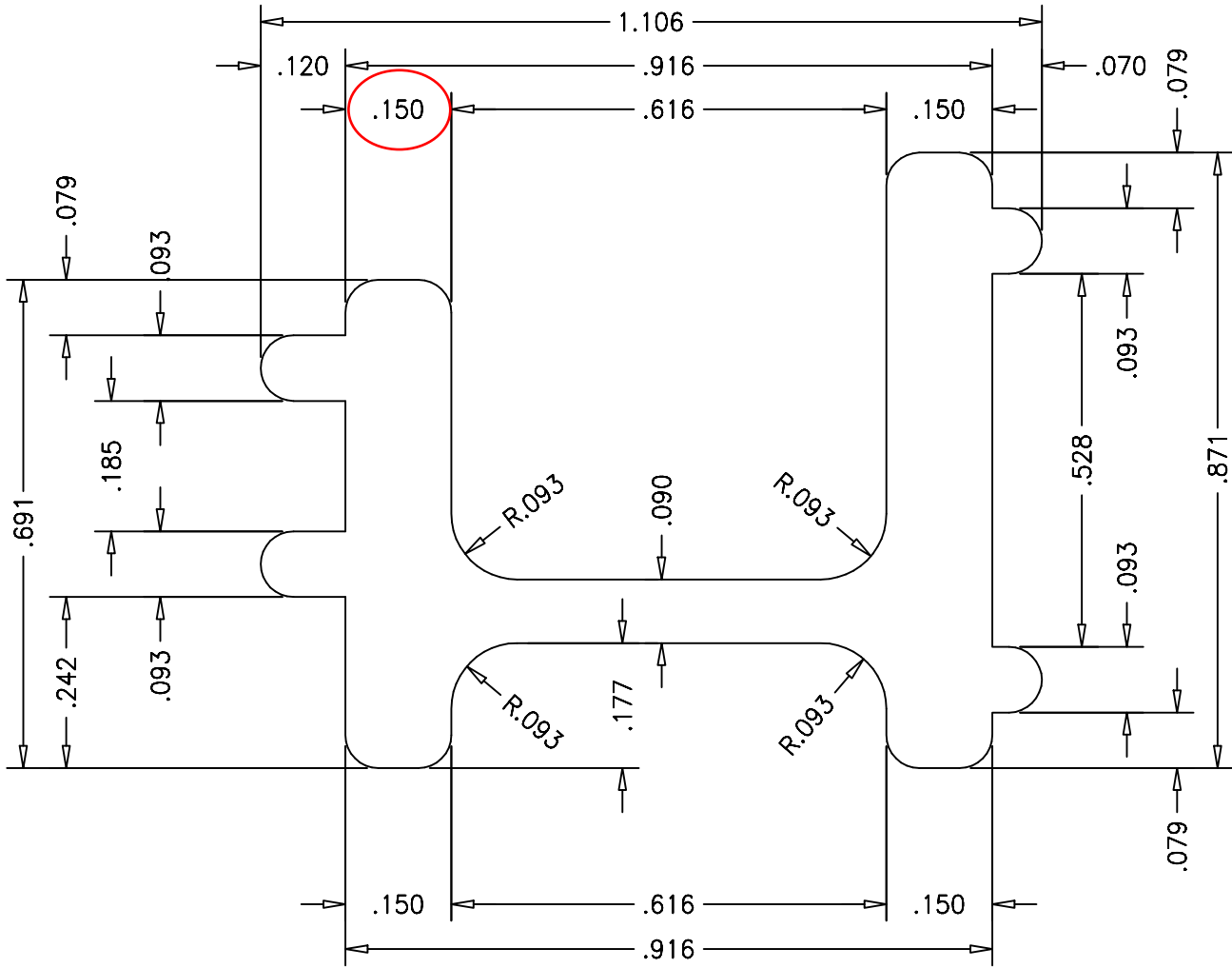

Actual Size

	Report #:	G1518
	Date:	1/20/2017
	Verified by:	<i>Andrew P. Mohabat</i>

Note:
 Unspecified Wall Thickness .100
 Unspecified Radii - .047 R.
 Break sharp corners and fillet - .015 R.



MI WINDOWS AND DOORS
 650 WEST MARKET STREET • GRATZ, PA • 17030-0370

The information, design or data shown on this document or electronic media is the exclusive property of MI WINDOWS AND DOORS, INC. It is considered confidential and proprietary and is made available for limited use only. Its use or reproduction without the expressed written consent of MI WINDOWS AND DOORS, INC., is prohibited.

TITLE 1650 HP Double Hung
Keeper Rail Reinforcement

DFTM.	DATE	SCALE	CUSTOMER NAME				
V.M.R.	7-16-09	4:1	Hegins (Xact), Salisbury				
AREA	PERIM.	EXT. PERIM.	WT./FT.	FACTOR			
.325		5.057	.390				
CIRCLE SIZE	CLASS	ALLOY/TEMPOR		FINISH			
1-2	Solid	6063-T5		Mill			
LTR	DESCRIPTION	BY	DATE	PLANT LOC.	THERMAL CAVITY	DWG/PART NO.	REV.
	REVISIONS			Metals-PA	None	M-2266	-

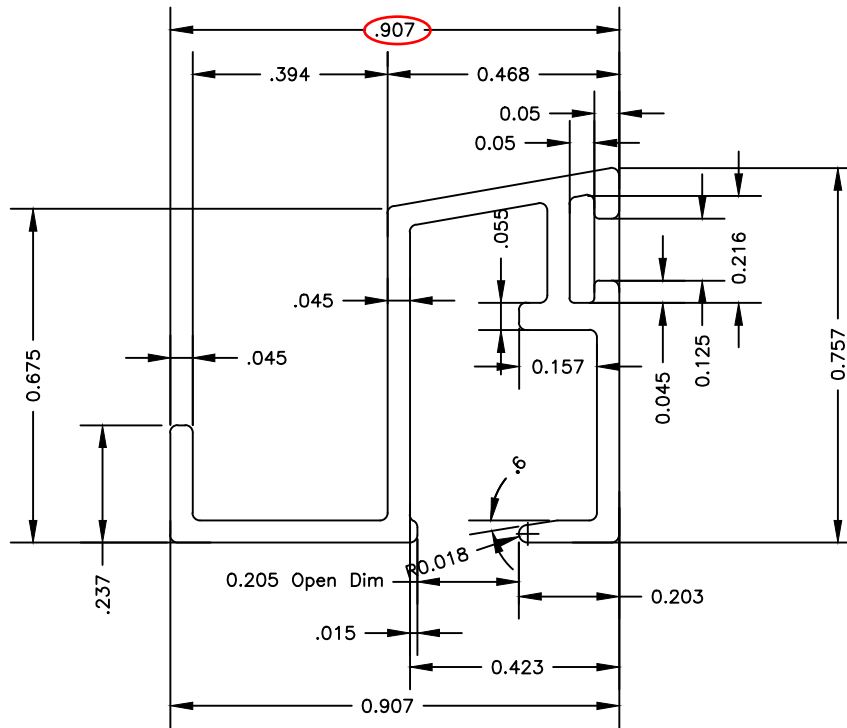

Exposed Surface
Painted Area

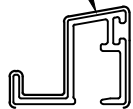

Operating
Screen Track
W/O Leg
4 : 1

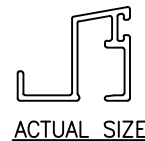

	Report #:	G1518
	Date:	1/13/2017
	Verified by:	<i>Andrew P. Mehalak</i>

		MATERIAL: Aluminum 6063 T5 (Solid)		MI WINDOWS AND DOORS 800 WEST MARKET STREET ORWATZ, PA 17030-0370	DESCRIPTION: 1630/1620 Operable Screen Track W/O Leg	
		FINISH: Painted	UNSPECIFIED WALL: 0.045		PRODUCT: 1630 Single Slide, 1620 Single Hung DATE: 10/27/15	
		AREA: 0.130	BREAK ALL CORNERS R.015, UNLESS OTHERWISE SPECIFIED	SCALE: 4:1		PART NUMBER: M-2341
		WEIGHT: 0.156		DFTM: HAL		DRAWING NUMBER: AE-000159
LTR	ECN #	REVISIONS	DATE	BY	PERIMETER: 5.636	

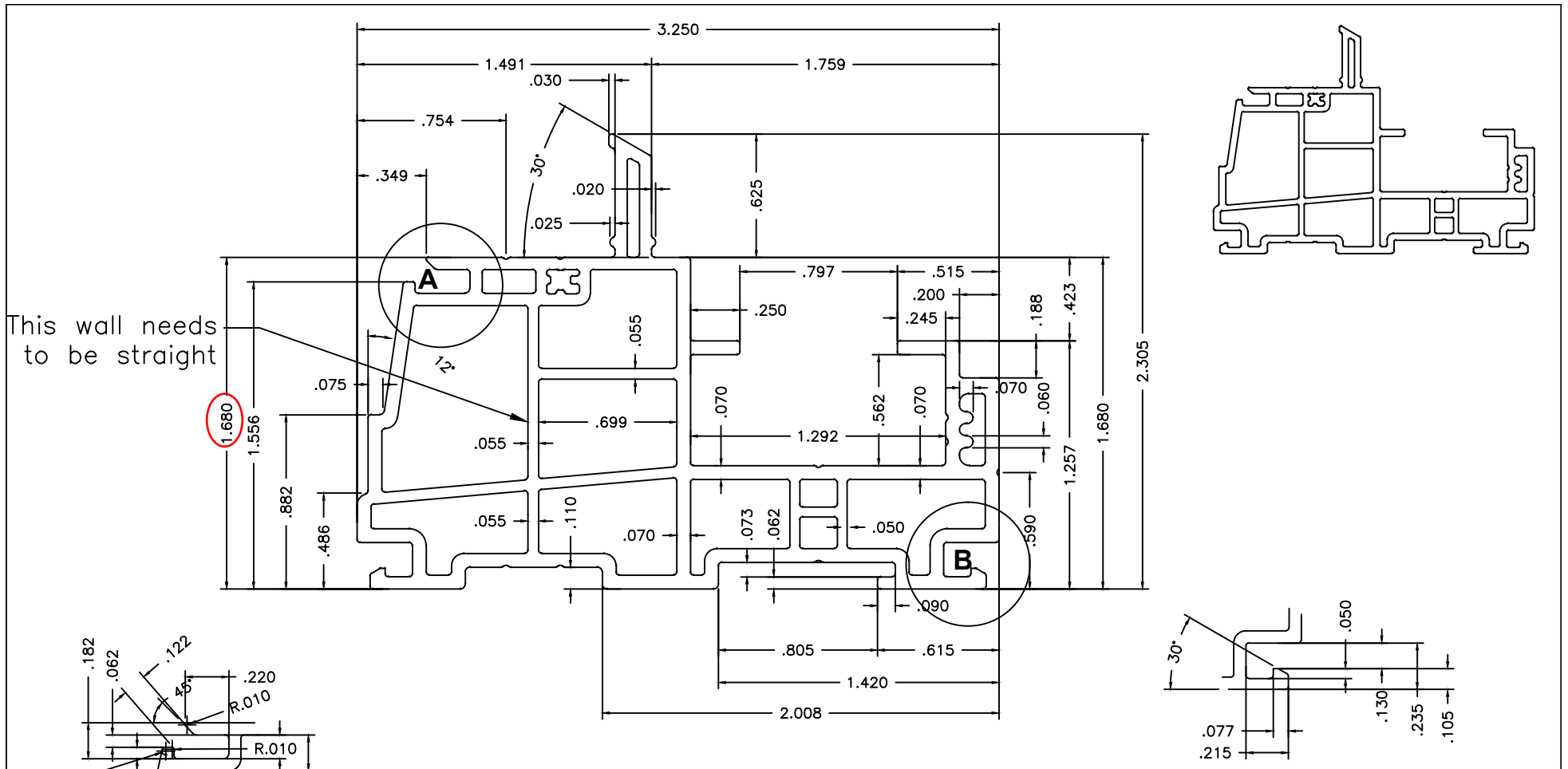

This wall needs to be straight

1.680

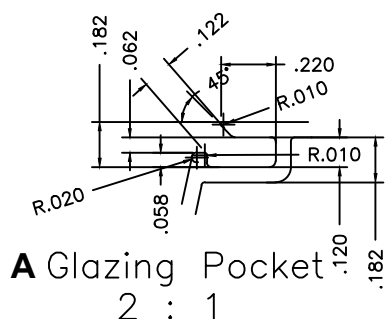

A Glazing Pocket
2 : 1

	Report #:	G1518
	Date:	1/13/2017
	Verified by:	<i>Andrew P. Mohr</i>

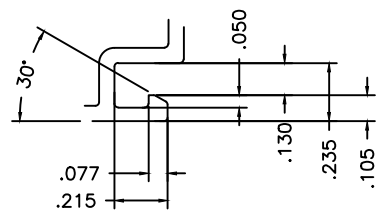

B Accessory Groove
2 : 1

		MATERIAL: Vinyl		MI WINDOWS AND DOORS 800 WEST MARKET STREET ORTZ, PA 17030-0370	DESCRIPTION: 1620 Single Hung Head/Jamb Finless	
		FINISH:	UNSPECIFIED WALL: .070		PRODUCT: 1620 Single Hung	
		AREA: 1.255	BREAK ALL CORNERS R.015, UNLESS OTHERWISE SPECIFIED		SCALE: 2 : 1	DATE: 12/09/14
		WEIGHT: .793	PERIMETER: 36.671		PART NUMBER: V-1008	
LTR	ECN #	REVISIONS	DATE	BY	DFTM: HAL	DRAWING NUMBER: VE-000024

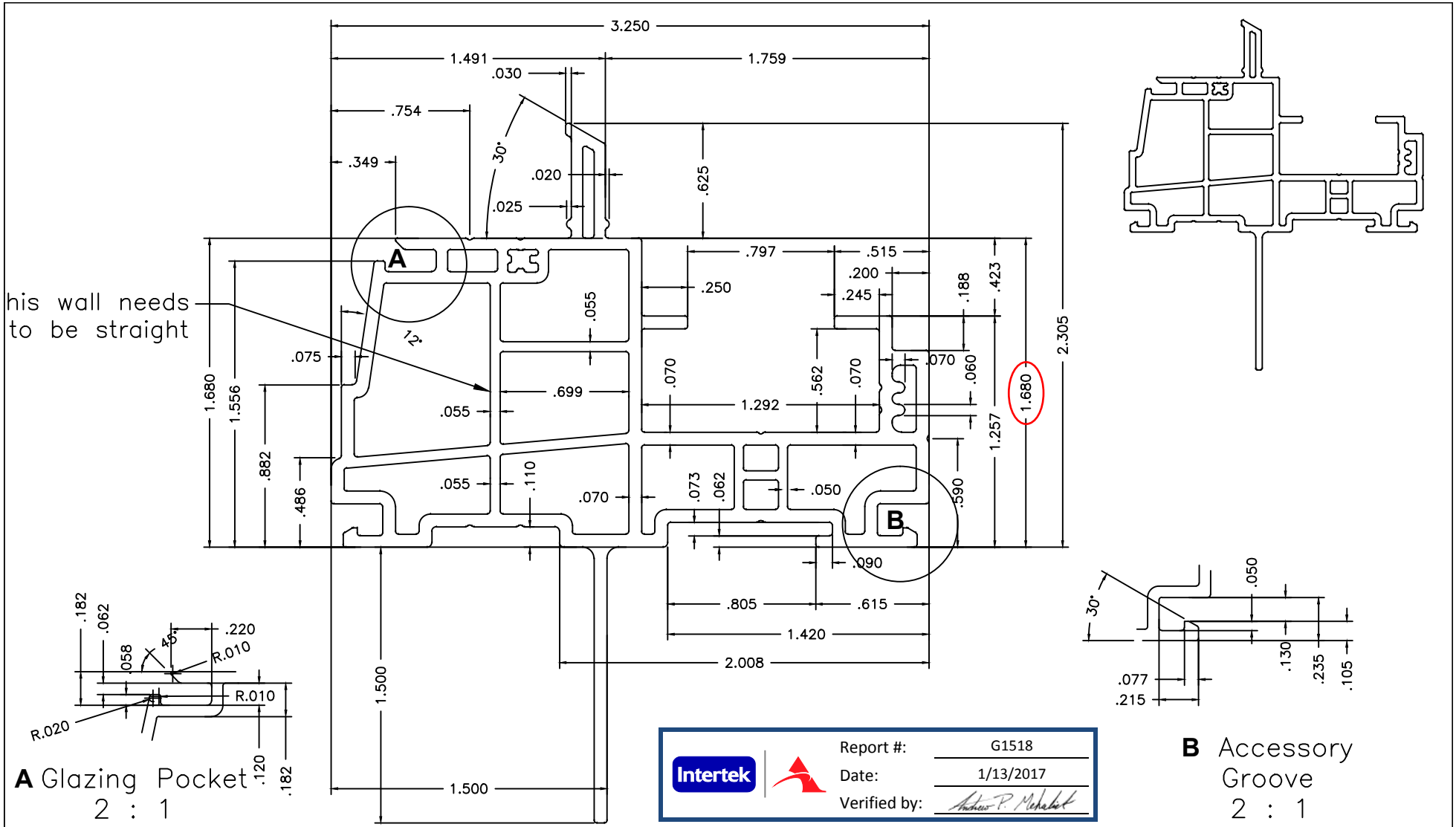

this wall needs to be straight

A Glazing Pocket
2 : 1

B Accessory Groove
2 : 1

	Report #:	G1518
	Date:	1/13/2017
	Verified by:	<i>Andrew P. Mehalick</i>

				MATERIAL: Vinyl				DESCRIPTION: 1620 Single Hung Head/Jamb Fin				
				FINISH:				PRODUCT: 1620 Single Hung		DATE: 12/09/14		
				AREA: 1.361		UNSPECIFIED WALL: .070		SCALE: 2 : 1		PART NUMBER: V-0006		
				WEIGHT: .860		BREAK ALL CORNERS R.015, UNLESS OTHERWISE SPECIFIED		DFTM: HAL		DRAWING NUMBER: VE-000023		
				PERIMETER: 39.606		The information, design or data shown on this document or electronic media is the exclusive property of MI Windows and Doors, LLC. It is considered confidential and proprietary and is made available for limited use only. Its use or reproduction without the expressed written consent of MI Windows and Doors, LLC, is prohibited.						
LTR	ECN #	REVISIONS	DATE	BY								

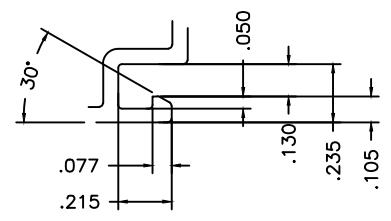
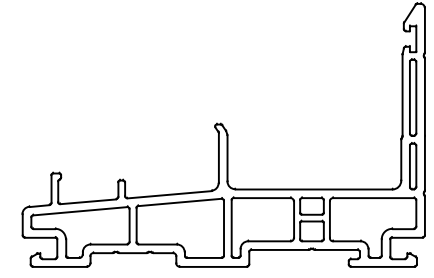
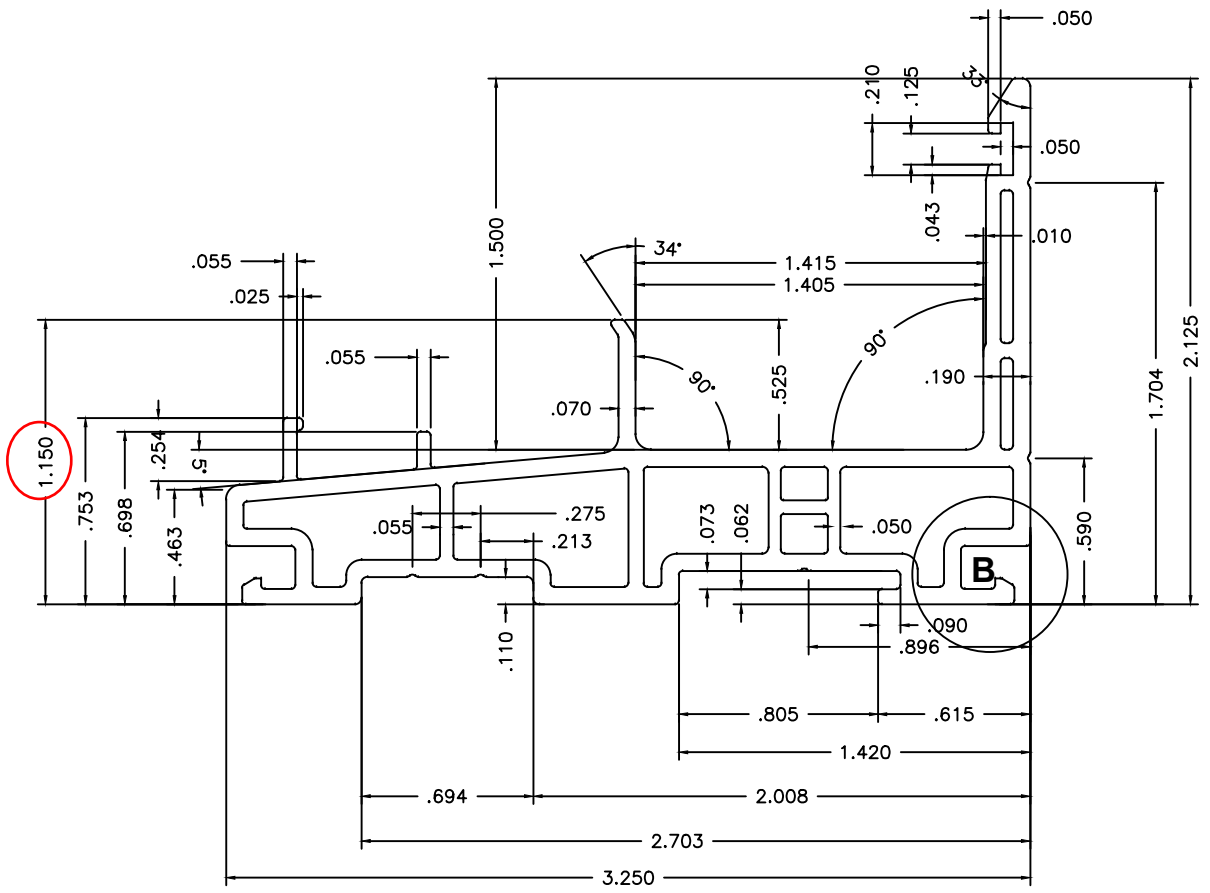

	Report #:	G1518
	Date:	1/13/2017
	Verified by:	<i>Andrew P. Mahabadi</i>

B Accessory Groove
2 : 1

		MATERIAL: Vinyl		MI WINDOWS AND DOORS <small>850 WEST MARKET STREET ORTZ, PA 17030-0370</small>	DESCRIPTION: 1620 Single Hung Sill Finless	
		FINISH:	UNSPECIFIED WALL: .070		PRODUCT: 1620 Single Hung	
		AREA: 0.927	BREAK ALL CORNERS R.015, UNLESS OTHERWISE SPECIFIED		DATE: 12/09/14	
		WEIGHT: .585			The information, design or data shown on this document or electronic media is the exclusive property of MI Windows and Doors, LLC. It is considered confidential and proprietary and is made available for limited use only. Its use or reproduction without the expressed written consent of MI Windows and Doors, LLC, is prohibited.	
		PERIMETER: 26.254	DFTM: HAL		DRAWING NUMBER: VE-000020	
LTR	ECN #	REVISIONS	DATE	BY		



Report #: G1518
 Date: 1/13/2017
 Verified by: *Andrew P. Mahabadi*

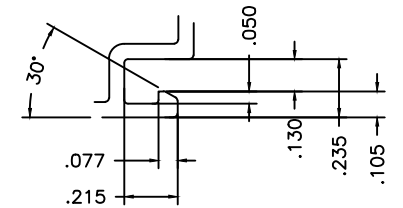
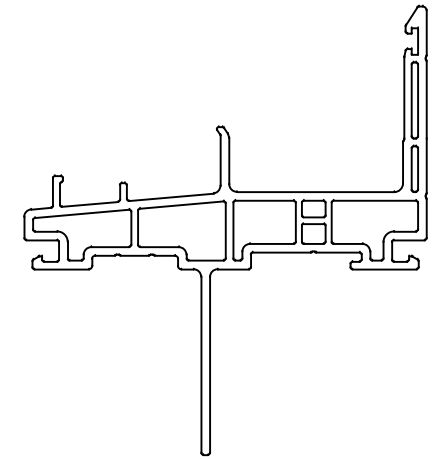
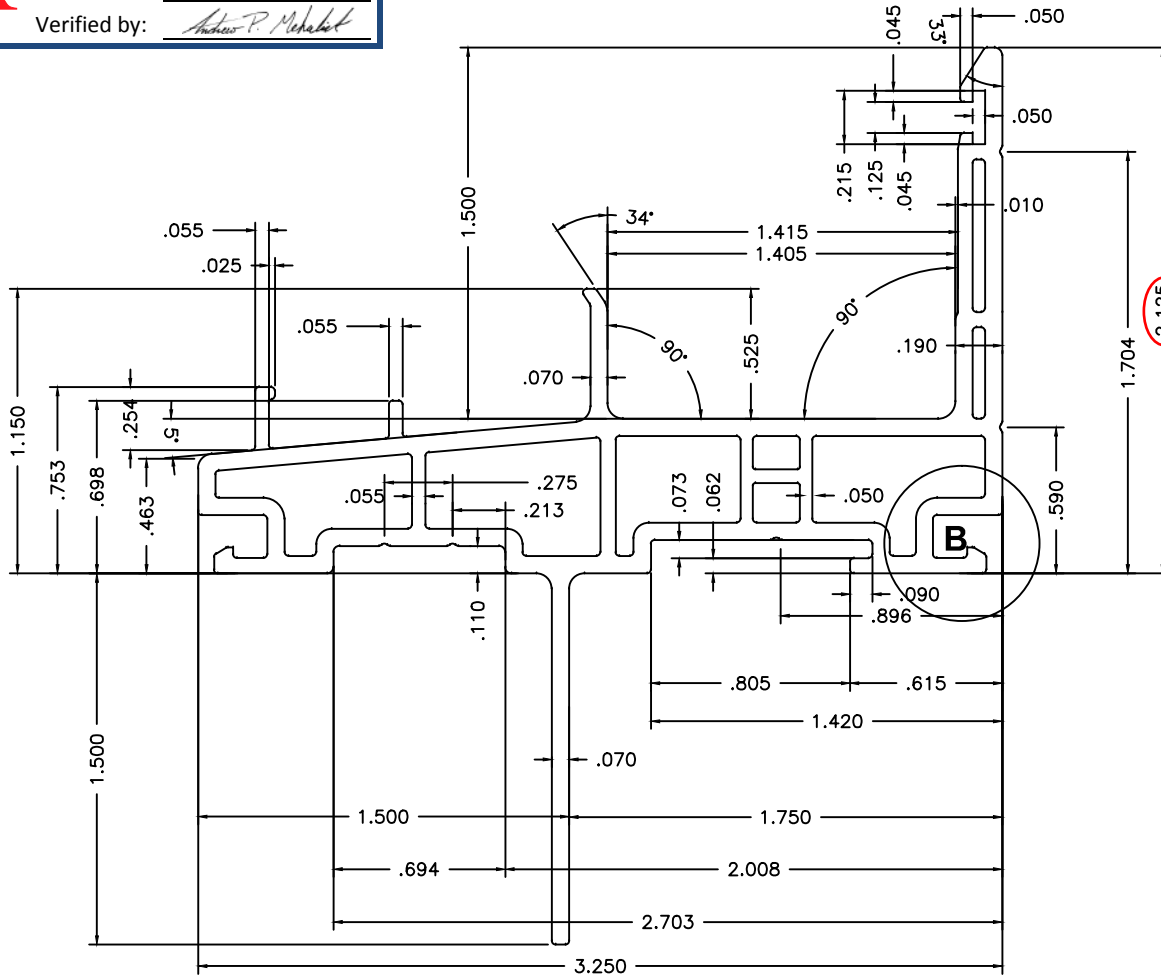

B Accessory Groove
 2 : 1

				MATERIAL: Vinyl		MIWD MI WINDOWS AND DOORS 800 WEST MARKET STREET ORTZ, PA 17030-0370		DESCRIPTION: 1620 Single Hung Sill Fin				
				FINISH:				PRODUCT: 1620 Single Hung		DATE: 12/09/14		
				AREA: 1.035		UNSPECIFIED WALL: .070		SCALE: 2 : 1		PART NUMBER: V-1012		
				WEIGHT: .654		BREAK ALL CORNERS R.015, UNLESS OTHERWISE SPECIFIED		DFTM: HAL		DRAWING NUMBER: VE-000019		
				PERIMETER: 29.203		The information, design or data shown on this document or electronic media is the exclusive property of MI Windows and Doors, LLC. It is considered confidential and proprietary and is made available for limited use only. Its use or reproduction without the expressed written consent of MI Windows and Doors, LLC, is prohibited.						
LTR	ECN #	REVISIONS	DATE	BY								

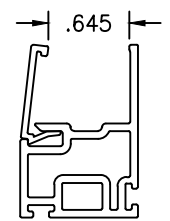
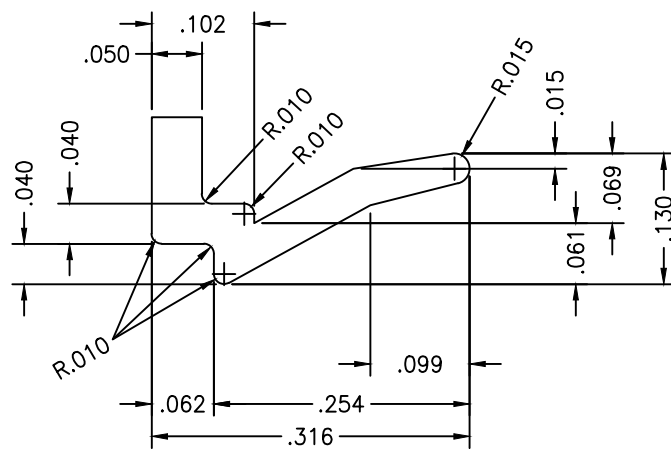
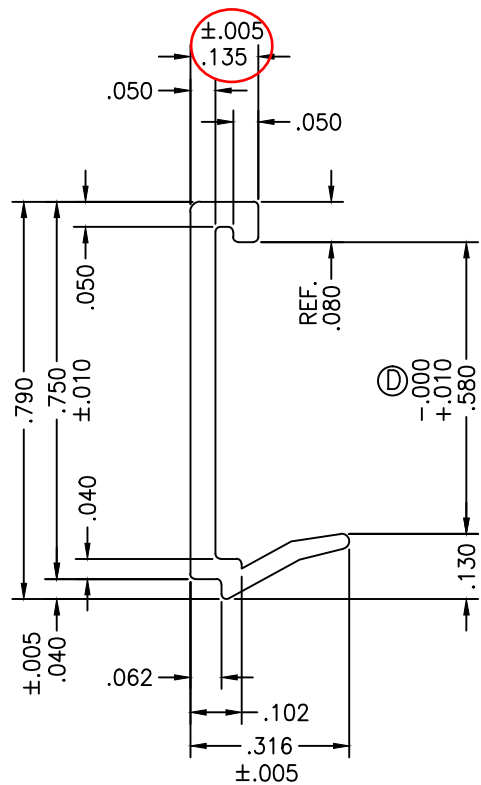

ACTUAL SIZE

DETAIL A
8X SCALE

NOTE:
 MATERIAL - RIGID PVC
 UNSPECIFIED WALL THICK. - .050 +.000
 AREA - .055 -.003
 WT/FT - .035



 Report #: G1518
 Date: 1/13/2017
 Verified by: *Andrew P. Mahabadi*

The information, design or data shown on this document or electronic media is the exclusive property of MI WINDOWS AND DOORS, INC. It is considered confidential and proprietary and is made available for limited use only. Its use or reproduction without the expressed written consent of MI WINDOWS AND DOORS, INC. is prohibited.				 MI WINDOWS AND DOORS 650 WEST MARKET STREET • GRATZ, PA • 17030-0370	
D	REVISED TOLERANCE WAS ±.005	VR	7-24-03	TITLE 1650 DOUBLE HUNG GLAZING BEAD	
C	REDESIGN	VR	7-9-03		
B	REDUCED NUB .010 - TO MAKE REMOVAL EASIER	VR	5-12-03		
LTR.	DESCRIPTION REVISIONS	BY	DATE	DPTH V.M.R. 4-12-01	SCALE 4:1
				DWG/PART NO. V-676	REV D

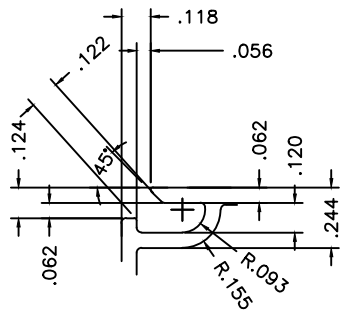

 Report #: G1518
 Date: 1/13/2017
 Verified by: *Andrew P. Mehalak*

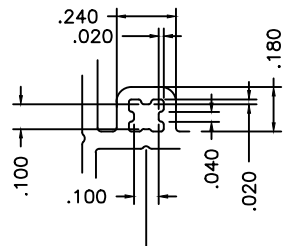

A Glazing Pocket
2 : 1

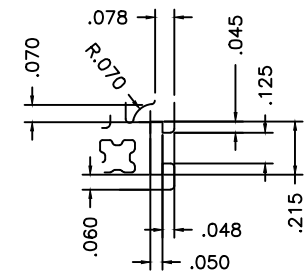
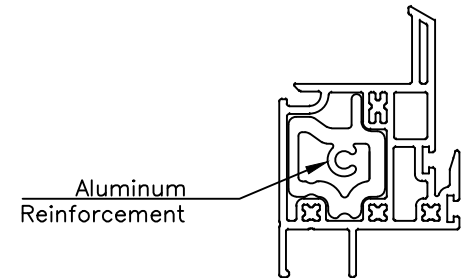
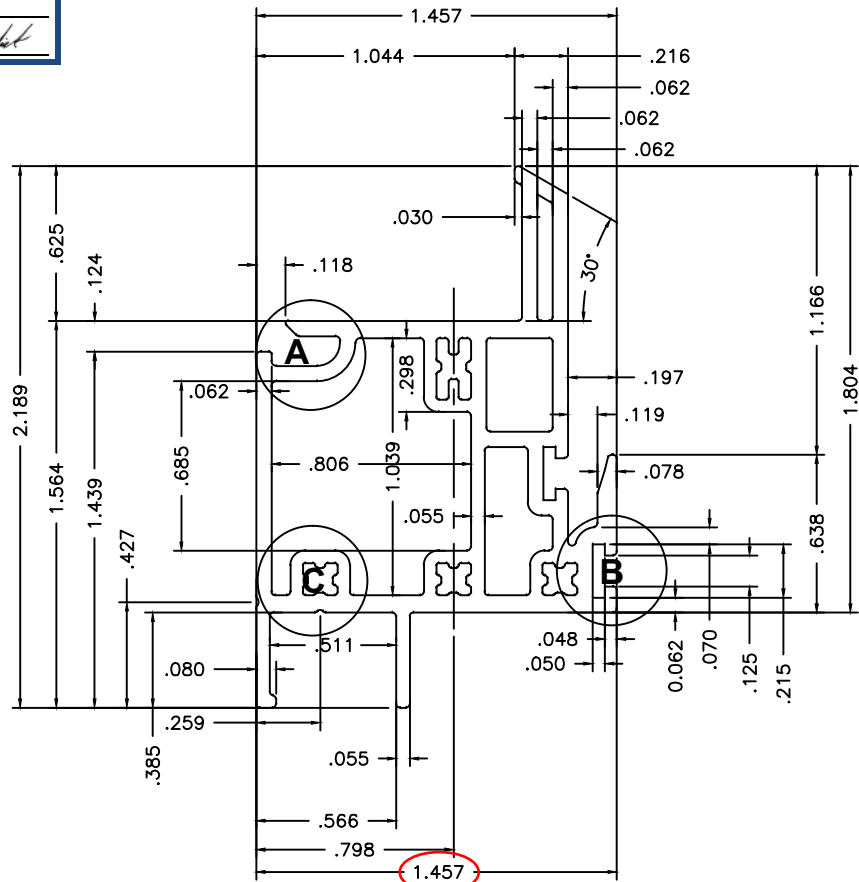

C Typ. Screw Boss
2 : 1



B Typ. Weather Stripping Pocket
2 : 1

			MATERIAL: Vinyl		 800 WEST MARKET STREET ORWATZ, PA 17030-0370	DESCRIPTION: 1620 SH 1630 SS Fixed Meeting Rail		
			FINISH:	UNSPECIFIED WALL: .062 - .070		PRODUCT: 1620 Single Hung 1630 Single Slide		DATE: 12/09/14
			AREA: .663	BREAK ALL CORNERS R.015, UNLESS OTHERWISE SPECIFIED		SCALE: 2 : 1		PART NUMBER: V-1016
			WEIGHT: .419			PERIMETER: 20.522	DFTM: HAL	
LTR	ECN #	REVISIONS	DATE	BY				