



Product Evaluation

RC589 | 0918

Engineering Services Program

The following product has been evaluated for compliance with the wind loads specified in the International Residential Code (IRC) and the International Building Code (IBC).

This product evaluation is not an endorsement of this product or a recommendation that this product be used. The Texas Department of Insurance has not authorized the use of any information contained in the product evaluation for advertising, or other commercial or promotional purpose.

This product evaluation is intended for use by those individuals who are following the design wind load criteria in Chapter 3 of the IRC and Section 1609 of the IBC. The design loads determined for the building or structure shall not exceed the design load rating specified for the products shown in the limitations section of this product evaluation. This product evaluation does not relieve a Texas licensed engineer of his responsibilities as outlined in the Texas Insurance Code, the Texas Administrative Code, and the Texas Engineering Practice Act.

For more information, contact TDI Engineering Services Program at (800) 248-6032.

Evaluation ID: RC-589

Effective Date: September 1, 2018

Re-evaluation Date: September 2022

Product Name: StealthBond® Steel Roof Panels: 5V Crimp-24" (26-gauge); SM-RIB-36" (29-gauge); and Standing Seam-24" (26-gauge) Installed over a Plywood Deck

Manufacturer: Southeastern Metals Manufacturing Company (SEMCO)
11801 Industry Drive
Jacksonville, Florida 32218
(904) 757-4200

and

Dot Metals
18757 Bracken Drive
San Antonio, TX 78266
(800)

Product Description:

The StealthBond® 5V Crimp-24", SM-Rib-36", and Standing Seam-24" metal panels are cold-formed from steel conforming to ASTM A792 with an AZ 50 protective coating to inhibit corrosion. Standing Seam-24" and 5V Crimp-24" are manufactured from CS Type B steel. SM-Rib 36" panels are manufactured from Grade 80 steel.

Design Pressures: Design wind pressure limitations are specified in Tables 1, 2, and 3.

Underlayment: A minimum of one layer of No. 30 (Type II) asphalt felt must be used. The underlayment used must comply with one or more of the following: ASTM D 226, ASTM D 4869, or ASTM D 1970. The felt must be installed with 6" side laps and 3" end laps. The felt must be fastened to the roof deck with

corrosion resistant fasteners in accordance with the manufacturer's installation instructions. Fasteners must be applied along the overlaps not farther apart than 36" on center.

Deck: Minimum 15/32" plywood.

Roof Framing: Roof framing must be spaced a maximum of 24" on center.

Installation over an Existing Roof Covering: Installation over an existing roof covering is not permitted.

Roof Slope: The metal roof panels in this evaluation must not be installed on roofs with a slope less than 2:12.

Installation Instructions

General Installation Requirements: All IRC and IBC requirements must be satisfied and manufacturer's installation instructions followed unless otherwise specified by this product evaluation.

Table 1

Attachment of 26-gauge 5V Crimp Panel to minimum 15/32" plywood roof decks

System	Deck Thickness (inches)	Design Pressure (psf)	Fastener Type	Attachment to Plywood
1	15/32	-67.5	StealthBond® Adhesive	29-gauge "StealthBond®" straps are spaced 24" o.c. and attached perpendicular to the wood supports with 12-gauge x 1-1/4" ring shank nails. Nails are installed in three equally spaced staggered rows 6" o.c. and 1" from the strap edge. The 5-V Crimp panels are adhered to each "StealthBond" strap in a continuous 3/8" wide bead of StealthBond®. The perimeter of the specimen is attached with No. 10-14 x 1-1/2" HWH wood screws spaced 8" o.c.

Table 2

Attachment of 26-gauge Standing Seam Panel to minimum 15/32" inch plywood roof decks

System	Deck Thickness (inches)	Design Pressure (psf)	Fastener Type	Attachment to Plywood
2	15/32	-90.0	StealthBond® Adhesive	29 gauge "StealthBond®" straps are spaced 24" o.c. and attached perpendicular to the wood supports with 12-gauge x 1-1/4" ring shank nails. Nails are installed in three equally spaced staggered rows 6" o.c. and 1" from the strap edge. The Standing Seam panels are adhered to each "StealthBond®" strap in a continuous 3/8" wide bead of StealthBond®. The perimeter of the specimen is attached with No. 10-14 x 1-1/2" HWH wood screws spaced 8" o.c.

Table 3

Attachment of 29 gauge SM-Rib Panel to minimum 15/32" inch plywood roof decks

System	Deck Thickness (inches)	Design Pressure (psf)	Fastener Type	Attachment to Plywood
3	15/32	-112.5	StealthBond® Adhesive	29 gauge "Stealth Bond" straps are spaced 24" o.c. and attached perpendicular to the wood supports with 12-gauge x 1-1/4" ring shank nails. Nails are installed in three equally spaced staggered rows 6" o.c. and 1" from the strap edge. The 5-V Crimp panels are adhered to each "StealthBond®" strap in a continuous 3/8" wide bead of StealthBond®. The perimeter of the specimen is attached with No. 10-14 x 1-1/2" HWH wood screws spaced 8" o.c.

Trims, Closures, and Accessories: Components, such as the eave trim, rake trim, ridge trim, hip trim, and valley trim shall be installed as required by the manufacturer.

Panel Ends and End Laps: As required by the manufacturer.

Panel Edges: As required by the manufacturer.

Sm-rib

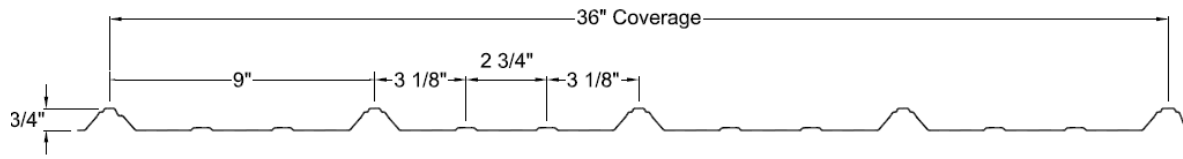

5 V Crimp

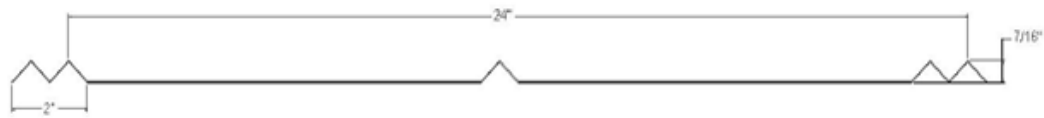

5-V Crimp Profile

Standing Seam

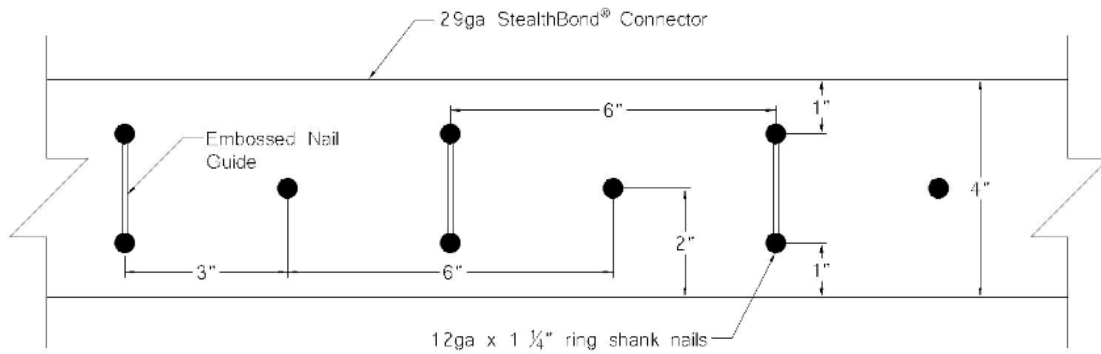
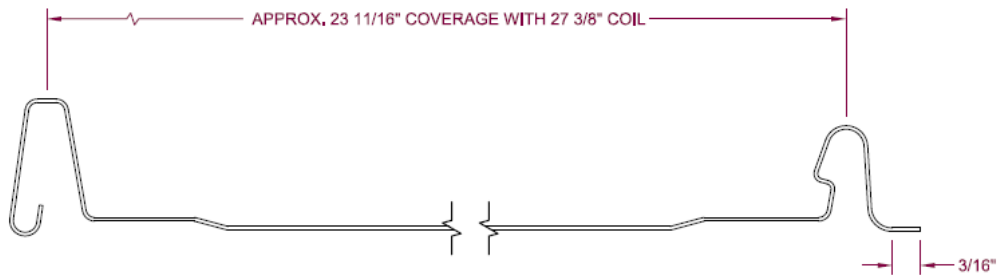

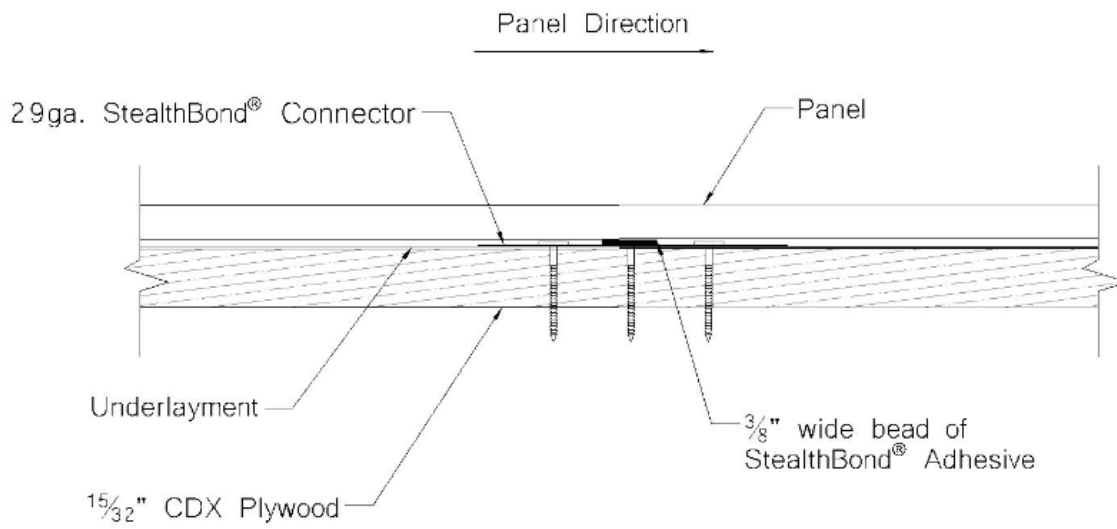

Note: Keep the manufacturer's installation instructions available on the job site during the installation. Use corrosion resistant fasteners as specified in the IRC, the IBC, and the Texas Revisions.