

# TEXAS DEPARTMENT OF INSURANCE

Engineering Services Program / MC 103-3A 333 Guadalupe Street P.O. Box 149104 Austin, Texas 78714-9104  
Phone No. (512) 322-2212 Fax No. (512) 463-6693

---

## PRODUCT EVALUATION RC-132

Effective February 1, 2013

*The following product has been evaluated for compliance with the wind loads specified in **International Residential Code (IRC)** and the **International Building Code (IBC)**. This product shall be subject to reevaluation **October 2015**.*

*This product evaluation is not an endorsement of this product or a recommendation that this product be used. The Texas Department of Insurance has not authorized the use of any information contained in the product evaluation for advertising, or other commercial or promotional purpose.*

*This product evaluation is intended for use by those individuals who are following the design wind load criteria in Chapter 3 of the IRC and Section 1609 of the IBC. The design loads determined for the building or structure shall not exceed the design load rating specified for the products shown in the limitations section of this product evaluation. This product evaluation does not relieve a Texas licensed engineer of his responsibilities as outlined in the Texas Insurance Code, the Texas Administrative Code, and the Texas Engineering Practice Act.*

**R-Panel Roof Panels** manufactured by

**General Shelters of Texas**  
**709 Southview Circle**  
**Center, Texas 75935**  
**(936) 598-1426**

is acceptable in designated catastrophe areas along the Texas Gulf Coast when installed in accordance with the manufacturer's installation instructions and this product evaluation.

## PRODUCT DESCRIPTION

General Shelters of Texas R-Panel roof panels are manufactured from 26 gauge coated steel conforming to ASTM A792, Grade 50, with a minimum yield strength of 50,000 psi. The panels have an AZ 50 hot-dip aluminum zinc alloy coating conforming to ASTM A792.

The panels are 36 inches in width and have a nominal rib height of  $1\frac{1}{4}$  inch.

## LIMITATIONS

**Design Wind Pressure:** For installation of the R-Panel roof panels to nominal  $\frac{15}{32}$  inch plywood panel decks, design wind pressure limitations are specified in Table 1.

**Roof Deck:** The roof deck shall be minimum nominal  $\frac{15}{32}$  inch plywood.

**Roof Deck Attachment:** The roof deck shall be secured to the roof framing to resist the required design pressures.

**Installation Over an Existing Roof Covering:** Installation over an existing roof covering is limited to a maximum of one existing layer of composition shingles, wood shingles or shakes, built-up roofing, or roll roofing. The thickness of the plywood deck shall comply with the requirements of this evaluation report. Note: Inspection of the existing roof deck must be made before installing the roof panels. The condition of the existing roof deck must be acceptable to receive the roof panels before the roof panel installation can proceed.

**Roof Slope:** The R-Panel roof panels shall not be installed on roofs with a roof slope less than  $\frac{1}{2}$ :12.

## INSTALLATION INSTRUCTIONS

### General Installation Requirements:

The installation of the panels shall be limited to extending two inches beyond the plane of the fascia board.

### Panel Installation Requirements

**Panels:** Panels shall be attached to the roof deck in accordance with Table 1. Refer to Figures 1-4 in this evaluation report for illustrations of the attachment details.

**Table 1**

Attachment of R-Panel Roof Panel to nominal  $\frac{15}{32}$  inch plywood panel deck:

### Design Pressure: -59.25 psf

Fastener into Roof Deck	Fastener Pattern	Fastener Spacing	Lap Fastener
One (1) No. 9-16/8 x $1\frac{1}{2}$ "	12"-12"-12"	24" on center	$\frac{1}{4}$ "-14x $\frac{7}{8}$ " @ 20" o.c.

**Underlayment:** Minimum one layer of No. 30 (Type II) asphalt felt shall be used. The underlayment used shall comply with ASTM D 226, ASTM D 4869, or ASTM D 1970. The felt shall be installed with minimum 6-inch side laps and 3-inch head laps. The underlayment shall be applied with corrosion resistant fasteners in accordance with manufacturer's installation instructions. Fasteners shall be applied along the overlaps not farther apart than 36 inches on center. **Note:** An optional radiant barrier may be installed beneath the panels in conjunction with the underlayment.

### Anchorage:

**Panels:** The R-Panel roof panels shall be secured to the plywood deck in accordance with Table 1 with minimum #9-16/8 x  $1\frac{1}{2}$  inch HWH Kwikseal Woodbinder screws, manufactured by Sealtite. If the panels are laid directly over an existing roof covering, then minimum #9-16/8 x 2 inch HWH Kwikseal Woodbinder screws, manufactured by Sealtite, are required. Refer to Figure 1 for an illustration of the fastening pattern. The fasteners shall be long enough to penetrate completely through the wood structural panels with a minimum exposure of  $\frac{1}{4}$  inch below the underside of the wood structural panels.

**Valley and Rake Trim:** The valley and rake trim shall be installed as shown in Figure 2.

**Ridge Cap and Hip Trim:** The ridge cap and hip trim shall be installed as shown in Figure 3.

**Eave Trim:** The eave trim shall be installed as shown in Figure 4.

**Alternative Fasteners:** Substitution of equivalent fasteners shall meet the following requirements:

- #9-16/8 HWH Kwikseal Woodbinder screws, manufactured by Sealtite.
- Ultimate withdrawal (pullout)  $\geq$  318 lbs. in  $\frac{15}{32}$  inch plywood

**Note:** The manufacturer's installation instructions shall be on the job site during the installation. All fasteners shall be corrosion resistant as specified in the International Residential Code (IRC), the International Building Code (IBC), and the Texas Revisions.

GENERAL SHELTERS OF TEXAS R-PANEL TYPICAL DETAILS OVER PLYWOOD

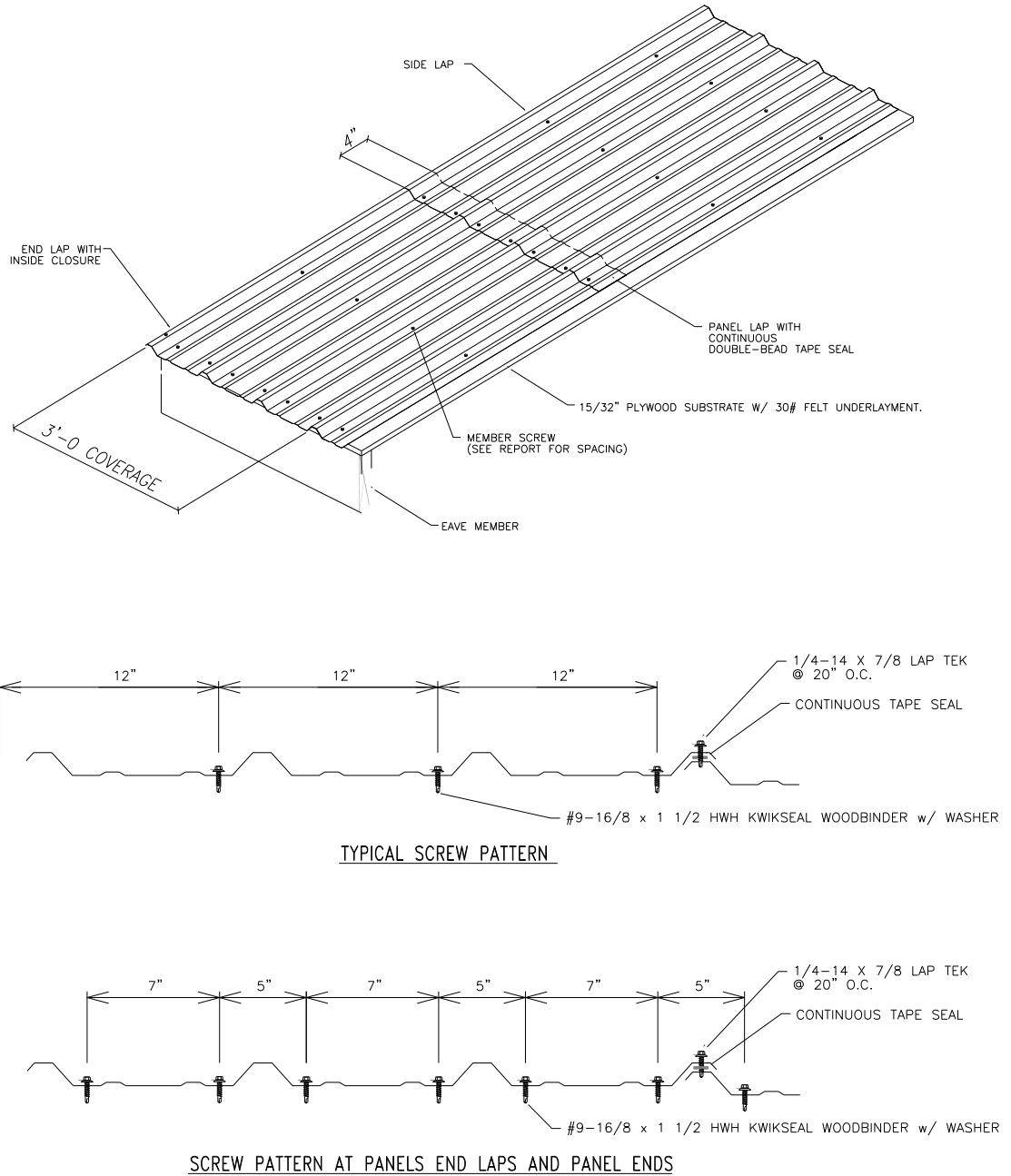

Figure 1: Fastener Pattern

GENERAL SHELTERS OF TEXAS R-PANEL TYPICAL DETAILS OVER PLYWOOD

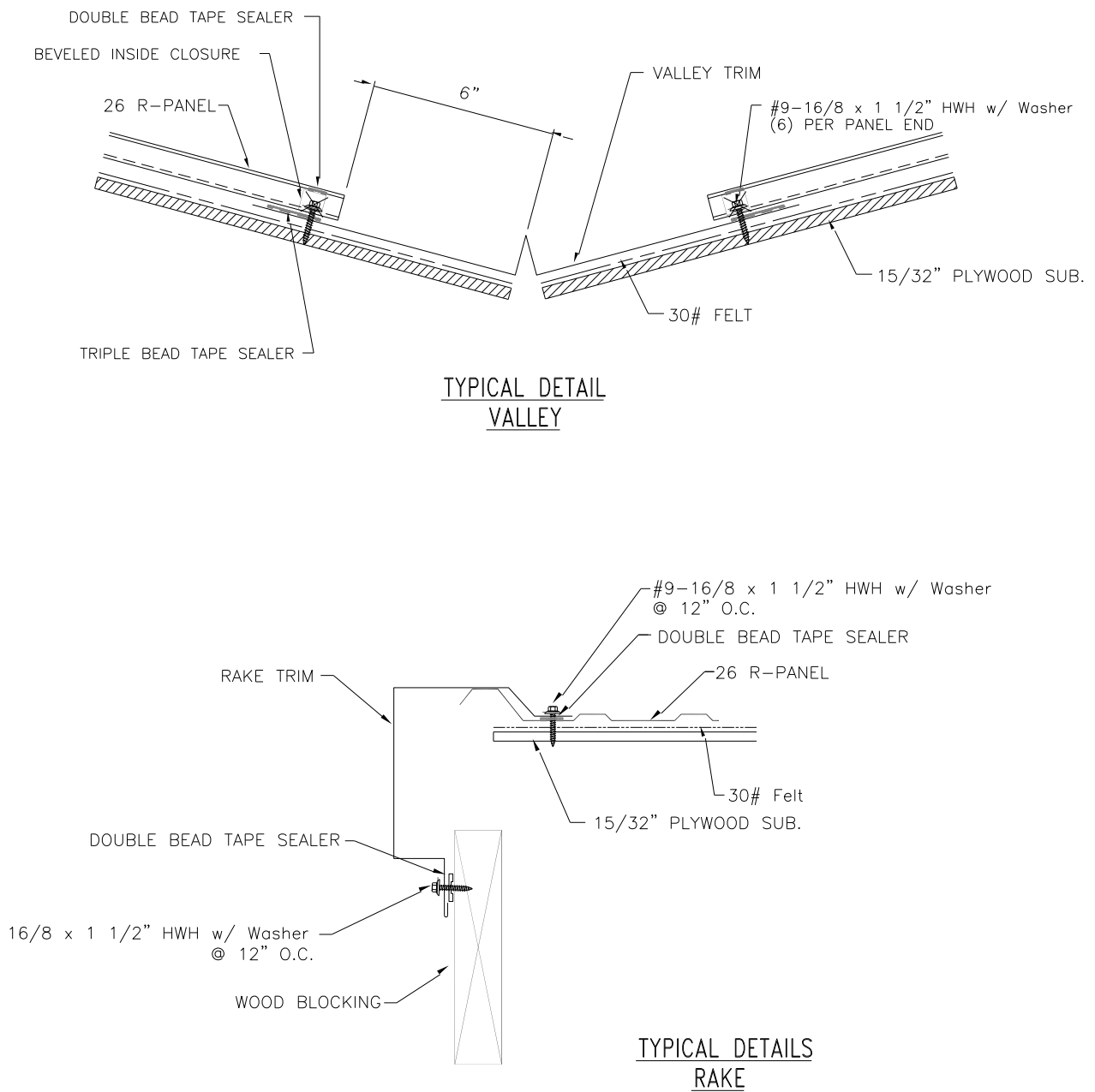
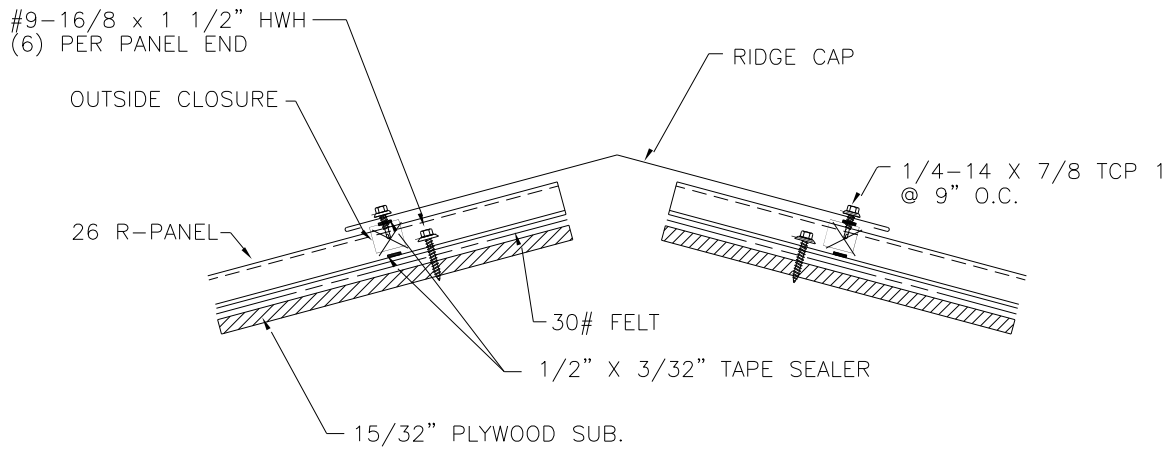
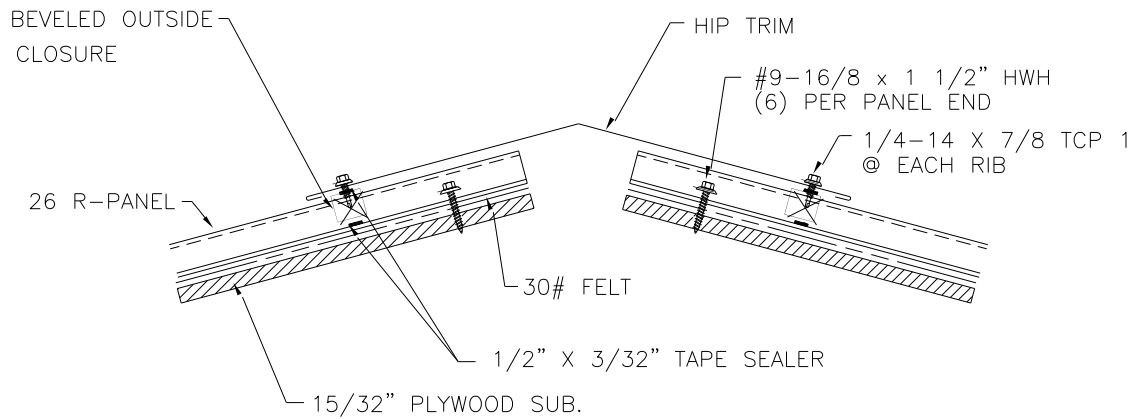

Figure 2: Valley and Rake Details

GENERAL SHELTERS OF TEXAS R-PANEL TYPICAL DETAILS OVER PLYWOOD



TYPICAL DETAILS  
RIDGE



TYPICAL DETAILS

Figure 3: Ridge and Hip Details

GENERAL SHELTERS OF TEXAS R-PANEL TYPICAL DETAILS OVER PLYWOOD

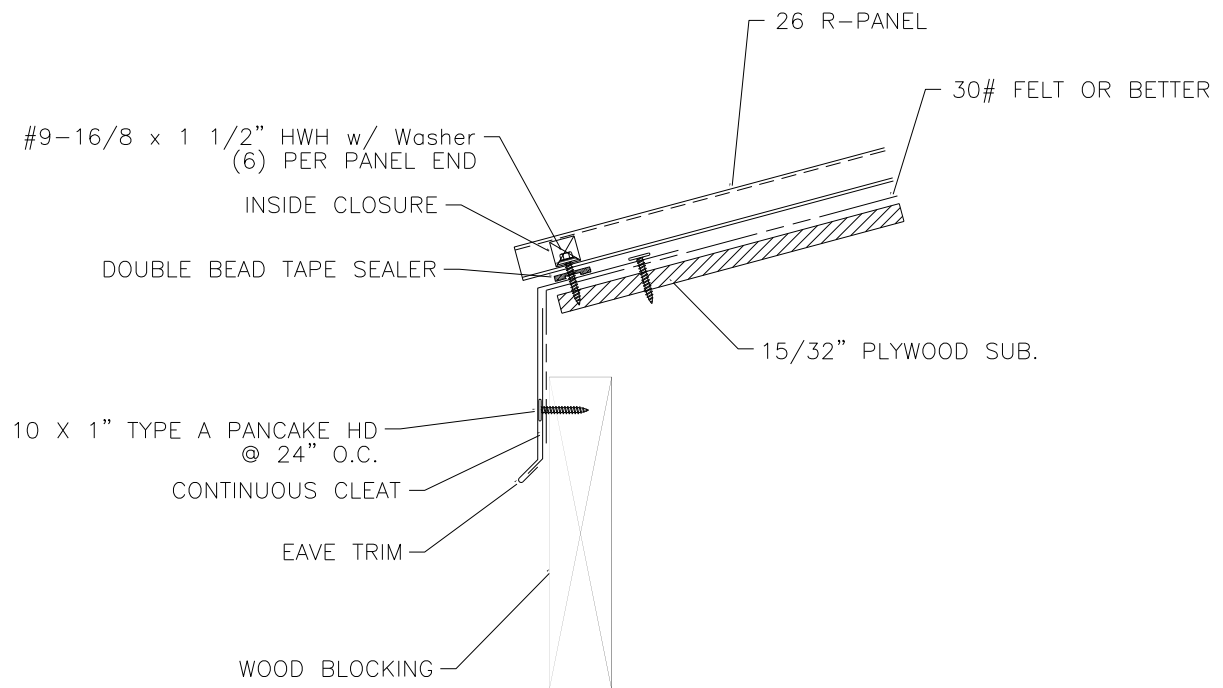

TYPICAL DETAILS  
EAVE

Figure 4: Eave Detail