

CLOPAY MODEL 902
IDEAL MODEL C2AL

UP TO 22'-2" WIDE X 18'-0" HIGH

| REVISIONS | | | | | |
|-----------|-------|---------|---------|--------|---------------------------------|
| REV. NO. | ZONE: | DATE: | ECN NO. | APPVD: | DESCRIPTION |
| 04 | - | 08/2012 | - | - | REVISED FOR TDI |
| 05 | - | 06/2013 | - | - | REMOVED ACRYLIC GLAZING OPTION. |
| 06 | - | 08/2016 | - | - | REMOVED WIND SPEED TABLE. |

THE OPTIONAL GLAZING SHOWN ON THIS DRAWING MEETS THE WIND LOAD REQUIREMENTS OF THE FLORIDA BUILDING CODE OR INTERNATIONAL BUILDING CODE BUT DOES NOT MEET THE IMPACT RESISTANT REQUIREMENT FOR WINDBORNE DEBRIS REGIONS (REF. CHAPTER 16 FBC/IBC)

DOOR IS MADE OF 6063-T5 ALUMINUM EXTRUSIONS.
WALL THICKNESS:
TOP & BOTTOM RAILS .075
INTER. TOP & BOTTOM RAILS .075
TOP HAS .1 x 1.875" FIN
INTER. TOP RAIL CAP .040
SINGLE & DOUBLE END STILES .075
CENTER STILES .062

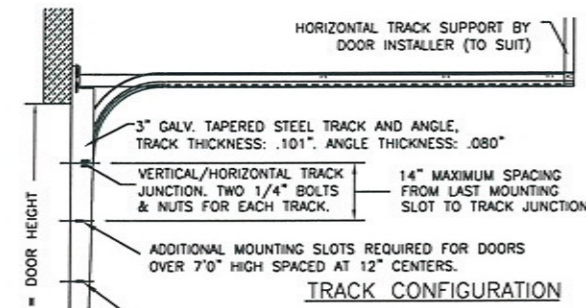

| DOOR HEIGHT "L" | "L" |
|-----------------|------|
| 8'-0" | 88" |
| 9'-0" | 100" |
| 10'-0" | 112" |
| 12'-0" | 136" |
| 14'-0" | 160" |
| 15'-0" | 172" |
| 16'-0" | 184" |
| 17'-0" | 196" |
| 18'-0" | 208" |

| DOOR HEIGHT 'A' | NUMBER OF SECTIONS |
|--------------------|--------------------|
| UP TO 8'-0" | 4 |
| 8'-3" THRU 10'-0" | 5 |
| 10'-3" THRU 12'-0" | 6 |
| 12'-3" THRU 14'-0" | 7 |
| 14'-3" THRU 16'-0" | 8 |
| 16'-3" THRU 18'-0" | 9 |

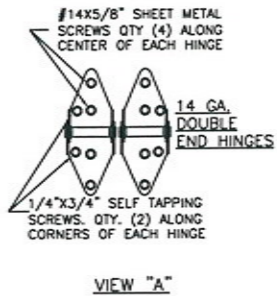
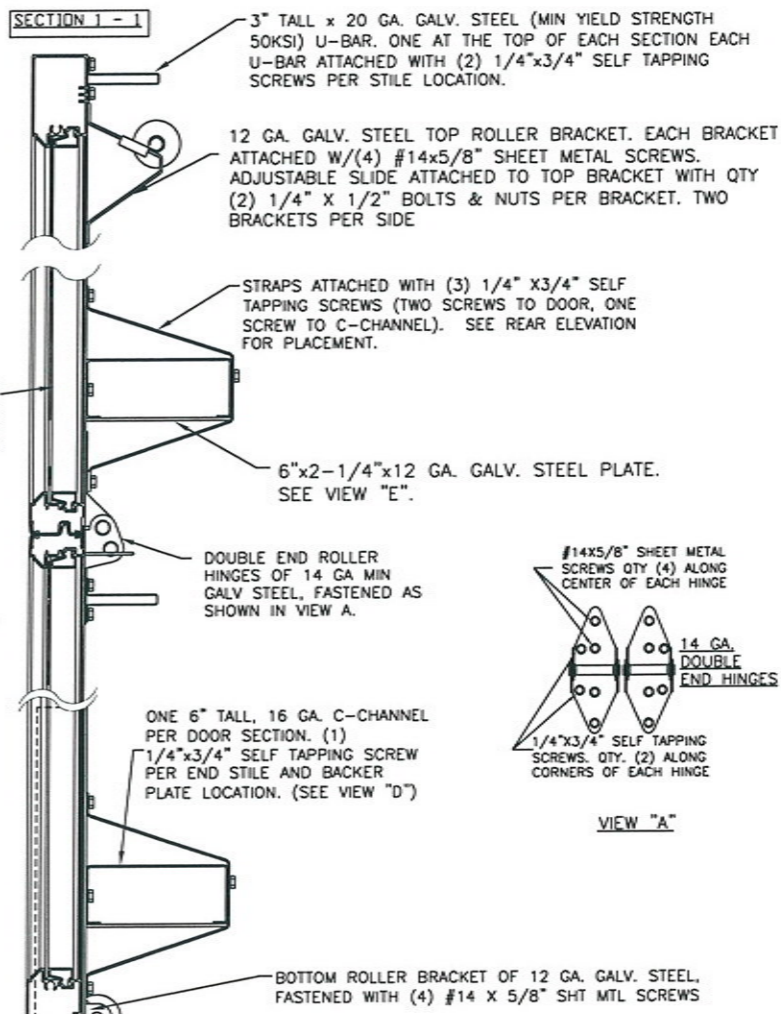
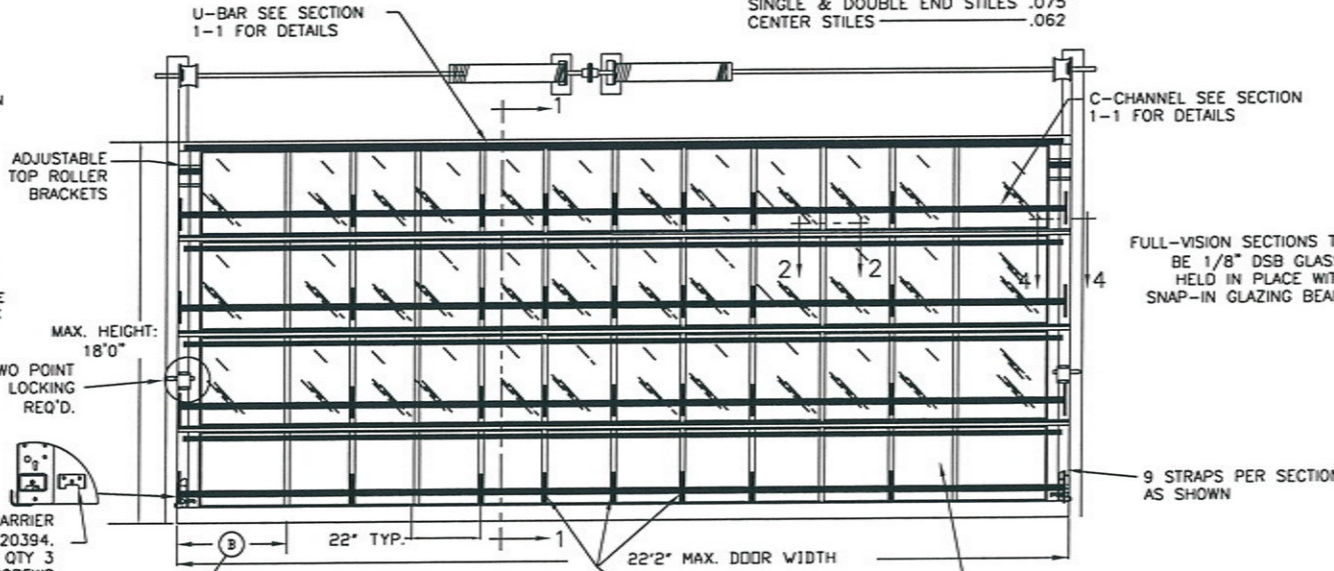

NOTE: DOUBLE TRACK LOW HEADROOM, HI-LIFT TRACK, FOLLOW-THE-ROOF TRACK, AND VERTICAL LIFT TRACK ARE AVAILABLE OPTIONS. 3" TRACK ALSO AVAILABLE.

NOTE: CENTER STILES ALWAYS 22" FROM CENTER TO CENTER. FOR ANY GIVEN DOOR WIDTH, DIMENSION 'B' THIS DIMENSION WILL NOT BE GREATER THAN 23" OR LESS THAN 18"

AT THE CENTER OF EACH C-CHANNEL ATTACH THREE 6"x2-1/4"x12 GA. STEEL PLATE TO THE UNDERSIDE OF THE C-CHANNEL WITH (4) 1/4"x3/4" SELF TAPPING SCREWS.

FULL-VISION SECTIONS TO BE 1/8" DSB GLASS, HELD IN PLACE WITH SNAP-IN GLAZING BEAD.

PANEL IN BOTTOM SECTION CAN BE .050" THICK SMOOTH ALUMINUM.

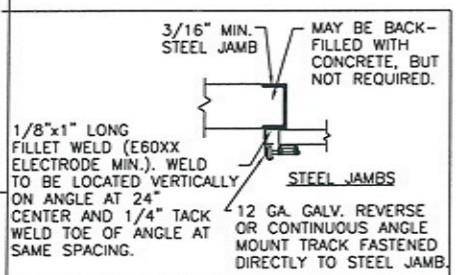

COR-LOVLY CENTER HINGE ON EVERY OTHER STILE STARTING WITH CENTER OF DOOR.

COR-LOVLY CENTER HINGE OF 16 GA. GALV. STEEL, ATTACHED TO INTER. BOTTOM RAIL WITH (2) #14 x 5/8" SHT MTL SCREWS AND TWO INTER. TOP RAIL WITH (2) 1/4" - 20 x 1/2" HEX HEAD MACHINE SCREWS & NUTS

END STILES FASTENED TO RAILS WITH FULL LENGTH 5/16" STEEL RODS AND FLANGE NUTS

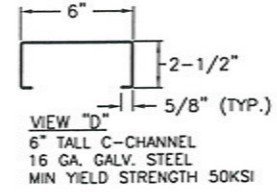
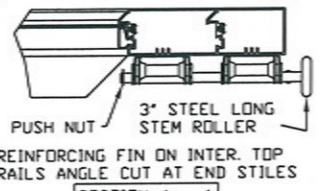

BOTTOM SECTION REINFORCED WITH A TEMPERED ALUMINUM EXTRUSION WITH INTEGRAL RETAINER FOR FLEXIBLE VINYL ASTRAGAL

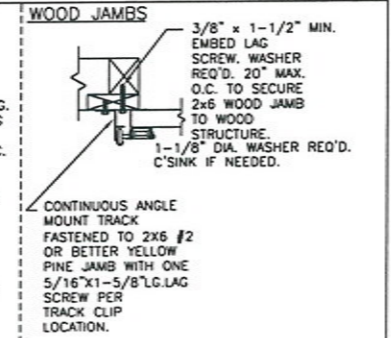
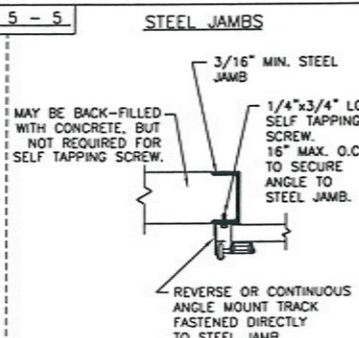
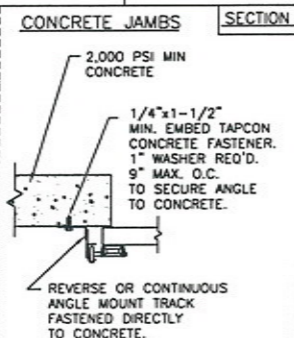
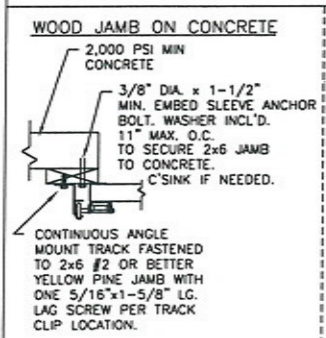

THE DESIGN OF THE SUPPORTING STRUCTURAL ELEMENTS IS THE RESPONSIBILITY OF THE BUILDING ENGINEER OR ARCHITECT OF RECORD.

DESIGN ENGINEER: MARK WESTERFIELD, P.E.
FLORIDA P.E. #48495, NC P.E. #23832, TEXAS P.E. #91513
DESIGN LOADS: +30 & -30 P.S.F.
TEST LOADS: +45 & -45 P.S.F.

MANUFACTURING PRODUCT CODE:
MPC C-AL-1F499

Unless Stated Otherwise TOLERANCES are

| | |
|---------|---------|
| .0 | = ±.031 |
| .00 | = ±.015 |
| .000 | = ±.005 |
| .0000 | = ±.001 |
| Degrees | = ±1/2° |

Clopay
Building Products Company
8585 Duke Boulevard
Mason, OH 45040 USA
Tel. No. 513-770-4800
Fax No. 513-770-4853

DESCRIPTION: M/N 902, C2AL, 22'2" WIDE DES. +30/-30 PSF

| | | | |
|------------------|----------------|--------------|-------------|
| DRAWN BY: BFA | DATE: 11/12/04 | SCALE: NONE | DWG. SIZE B |
| CHECKED BY: - | DATE: - | SHEET 1 OF 1 | |
| DWG. NO.: 103324 | VER: TDI | | |

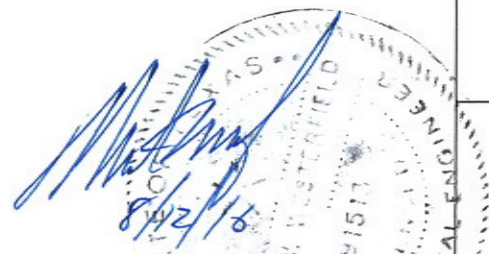

CLOPAY CORP.
ALL RIGHTS RESERVED.

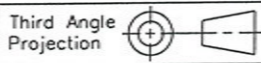

Unless Stated Otherwise DIMENSIONS ARE IN INCHES.