

DRAWING NO. 944

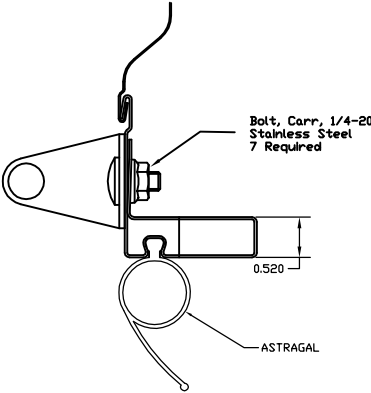
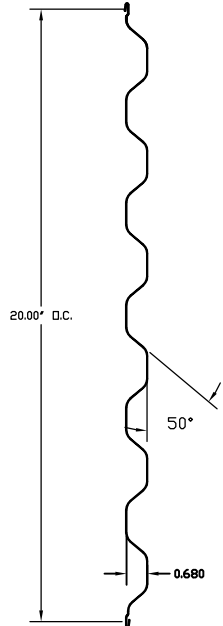
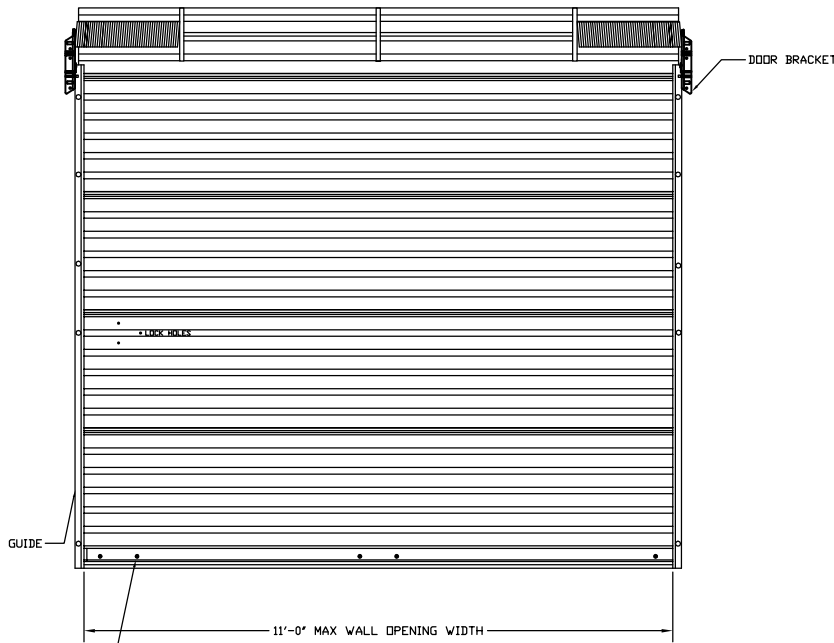

BOTTOM BAR ASSEMBLY

22 GAUGE (0.030" MIN.) ASTM A1011 GALVALUME, HOT DIPPED, MIN. YIELD OF 50 KSI, ROLL FORMED. BACKUP ANGLE TO BE MANUFACTURED FROM 12 GAUGE ASTM A-653 STEEL, HOT DIPPED GALVANIZED PER ASTM A-924 (G-40)

DOOR PANEL

26 GAUGE (0.018" MIN.) GRADE 80 STEEL PER ASTM A-653 STEEL, HOT DIPPED GALVANIZED PER ASTM A-924 (G-40). WITH FULL COAT OF PRIMER AND BAKED POLYESTER FINISH COAT.

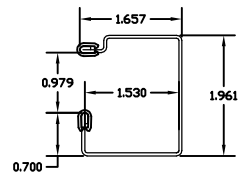

GUIDE DETAIL - LH SHOWN

18 GAUGE (0.047" MIN.) ASTM A-653 STEEL, HOT DIPPED GALVANIZED PER ASTM A-924 (G-40). FACTORY INSTALLED POLYPROPYLENE GUIDE RUNNER.

SPACEGUARD LATCH FACTORY INSTALLED - STEEL AND ZINC CAST PART WITH POWDER COATING FINISH. SECURED WITH 3 - 3/8" JAM NUTS

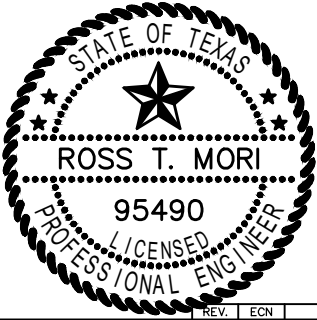

THIS DRAWING AND ALL PARTS THEREOF ARE THE EXCLUSIVE PROPERTY OF TRAC RITE DOOR, INC. AND MAY NOT BE REPRODUCED IN WHOLE OR PART WITHOUT WRITTEN PERMISSION.		<p>314 Wilburn Road, Sun Prairie, WI 53590 Phone: 800-448-8979 Fax: 800-236-8722 www.tracrite.com</p>	
TOLERANCE (UNLESS OTHERWISE SPECIFIED) LINEAR: ± .032" ANGULAR: ± 2'			
DATE	2-15-22	DESCRIPTION	944 DOOR
BY	JSB	APP'D	JSB
SCALE	N/A	SIZE	B
DRAWING NO.	944	REV.	--
		SHEET	1 OF 2

REV.	ECN	DESCRIPTION	BY	DATE
------	-----	-------------	----	------

DRAWING NO. 944

SUPERIMPOSED LOAD DIAGRAM
GUIDE FASTENERS @ 35.1875" MAX. O.C.

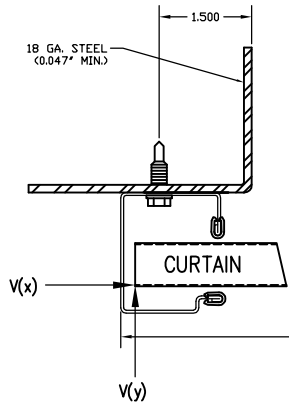

OUTSIDE

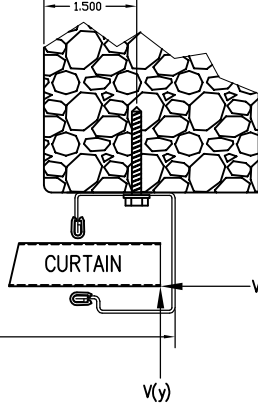

CONCRETE/FILLED BLOCK JAMBS
RH GUIDE MOUNT SHOWN

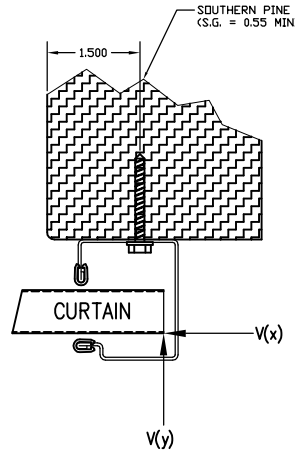

WOOD JAMBS
RH GUIDE MOUNT SHOWN

MAX DOOR WIDTH	MAX DOOR HEIGHT	DESIGN LOAD + (PSF)	V _x + (PLF)	V _y + (PLF)	DESIGN LOAD - (PSF)	V _x - (PLF)	V _y - (PLF)
7'-0"	12'-0"	24	0	84	26	0	91
8'-0"	12'-0"	22	0	88	24	0	96
9'-0"	12'-0"	20	0	90	22	0	99
10'-0"	12'-0"	16	0	80	18	0	90
11'-0"	12'-0"	14	0	77	16	0	88

STEEL JAMBS
LH GUIDE MOUNT SHOWN

DOOR MOUNTING BRACKET TO STEEL

14 GAUGE (0.075" MIN.) ASTM A-653 STEEL, HOT DIPPED GALVANIZED PER ASTM A-924. EVERY BRACKET INCLUDES GREASE PACKED BALL BEARING.

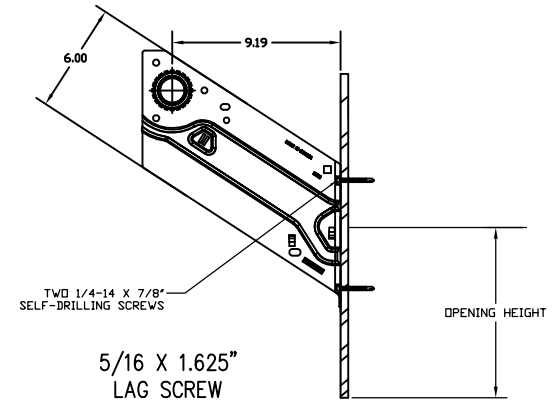

NOTES:

- STRUCTURAL PERFORMANCE UNDER UNIFORM LOAD PER ASTM E 330 TO SAFELY RESIST A POSITIVE OR NEGATIVE WIND LOAD AS NOTED ABOVE. A TEST LOAD OF 1.5 X DESIGN LOAD HAS BEEN USED.
- ALL DOORS COMPLY WITH THE 2018 IRC/IBC.
- THE DOOR ASSEMBLY SHALL BE INSTALLED IN ACCORDANCE WITH THE MANUFACTURER'S INSTALLATION INSTRUCTIONS.
- WIND LOADS FOR BUILDING OPENINGS SHALL BE DETERMINED BY A PROFESSIONAL ENGINEER USING APPROPRIATE WIND SPEED AND DESIGN CRITERIA. THIS DOOR MAY BE USED WHERE THE DESIGN LOAD MEETS OR EXCEEDS THE DESIGN LOAD FOR THE BUILDING OPENING.
- SUPERIMPOSED LOADS ON THE JAMBS FROM THIS DOOR ARE DESIGNED AS V(x) AND V(y) HEREIN. CONTRACTORS SHALL HAVE BUILDING ENGINEER VERIFY ADEQUACY OF BUILDING STRUCTURE TO RESIST SUPERIMPOSED LOAD V(x), V(y), AND BRACKET LOADS SHOWN
- ALL WELDING SHALL BE PERFORMED BY QUALIFIED WELDERS IN ACCORDANCE WITH A.W.S. SPECIFICATIONS, LATEST EDITION. ALL WELDING ELECTRODES SHALL CONFORM TO A.W.S. A5.1 GRADE E-70.
- ALL BOLTS AND WASHERS SHALL BE GALVANIZED OR STAINLESS STEEL WITH A MINIMUM TENSILE STRENGTH OF 60 KSI.
- FASTENERS NOTES
 - EMBEDMENT LENGTH DOES NOT INCLUDE STUCCO FINISH.
 - FOR HOLLOW MASONRY, FILL ALL CELLS @ ANCHOR WITH 2500 PSI GROUT.
 - ANCHORS SHALL BE INSTALLED IN ACCORDANCE WITH MANUFACTURERS SPECIFICATIONS.

FASTENERS REQUIRED

MOUNTING CONSTRUCTION	DOOR GUIDE	DOOR BRACKET
STEEL	SELF-DRILLING SCREW 1/4-14 x 7/8"	SELF-DRILLING SCREW 1/4-14 x 7/8"
WOOD	LAG SCREW 1/4 X 1 1/2"	LAG SCREW 5/16 X 1 5/8"
CONCRETE	DEWALT SCREW BOLT+ 1/4" X 1 3/4"	DEWALT SCREW BOLT+ 3/8" X 4"

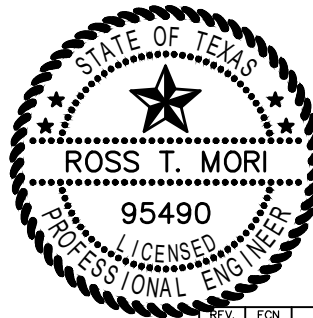

THIS DRAWING AND ALL PARTS THEREOF ARE THE EXCLUSIVE PROPERTY OF TRAC RITE DOOR, INC. AND MAY NOT BE REPRODUCED IN WHOLE OR PART WITHOUT WRITTEN PERMISSION.		<p>314 Wilburn Road, Sun Prairie, WI 53590 Phone: 800-448-8979 Fax: 800-236-8722 www.tracrite.com</p>	
TOLERANCE (UNLESS OTHERWISE SPECIFIED) LINEAR: ± .032" ANGULAR: ± 2'			
DATE	02-15-22	DESCRIPTION	944 DOOR
BY	JSB	APP'D	JSB
SCALE	N/A	SIZE	B
DRAWING NO.	944	REV.	---
		SHEET	2 OF 2