

Overall Section Thickness = 2"
Base Section Thickness = 1-3/8"

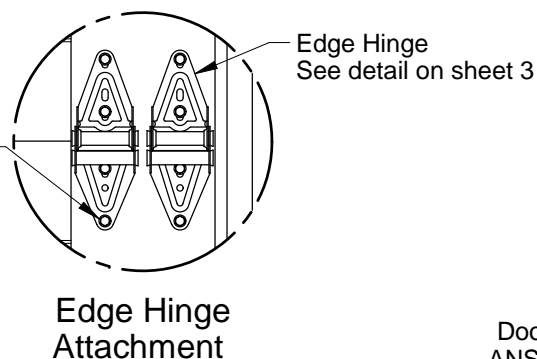
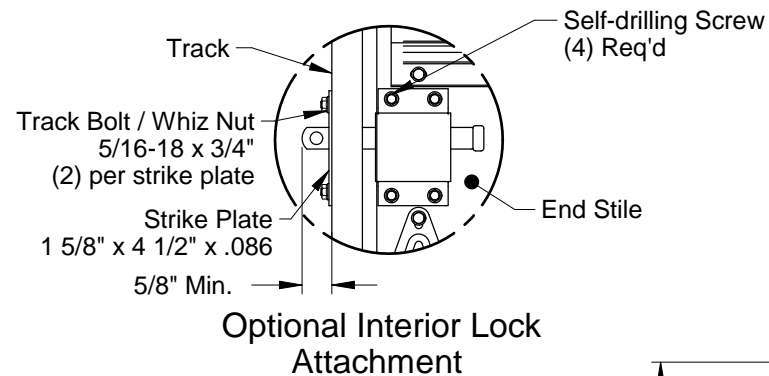
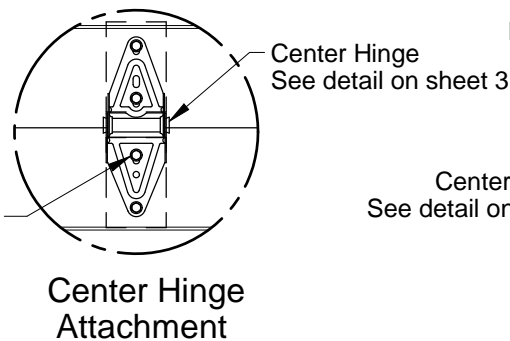
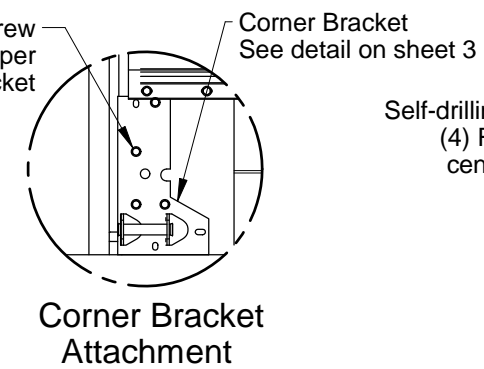
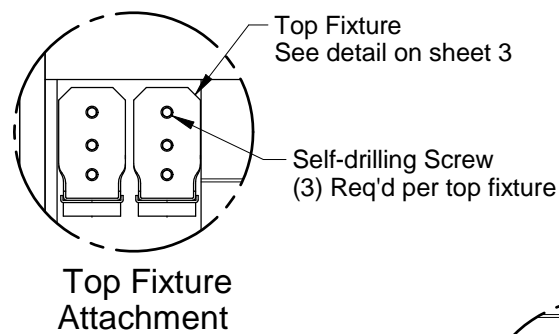
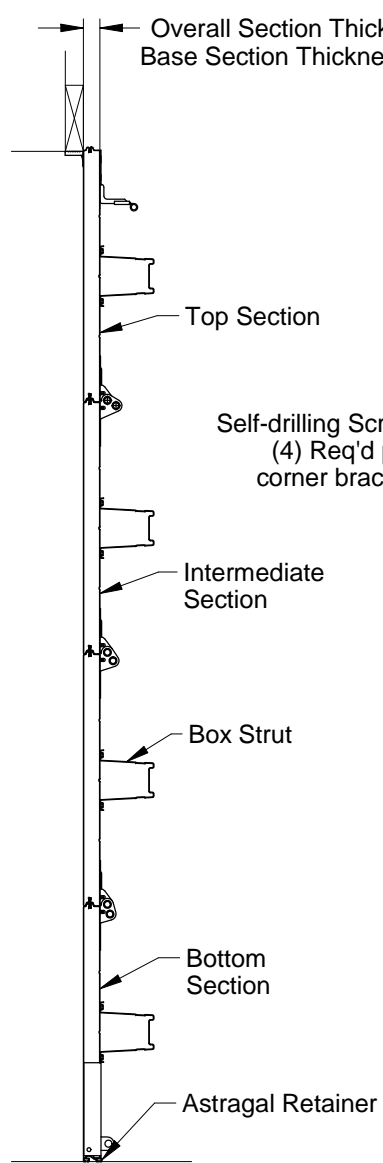

Interior Skin
.013 thick G-40 galvanized steel with an epoxy primer and baked on polyester finish which is roll-formed with wood grain texture.

Exterior Skin
.014 thick G-40 galvanized steel with an epoxy primer and baked on polyester finish which is roll-formed with wood grain texture.

Exterior Trim Board
.625 Thick x 5.00 Wide PVC Trim Board

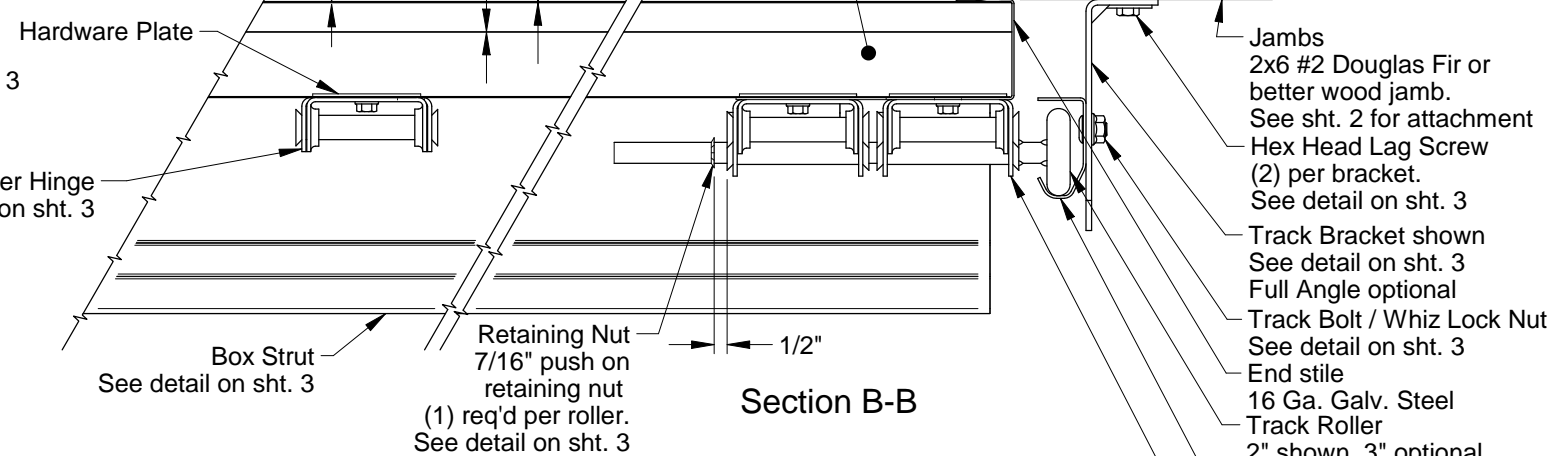

Section B-B

Door Height
7'-0" High shown
Other door heights available up to 10'-0" using 18" or 21" high sections

Steel Reinforcement
(1) Box strut per section, fastened to all center and end stiles using (2) self-drilling screws at each center stile and (4) at each end stile.

Locks required on doors not electrically operated.

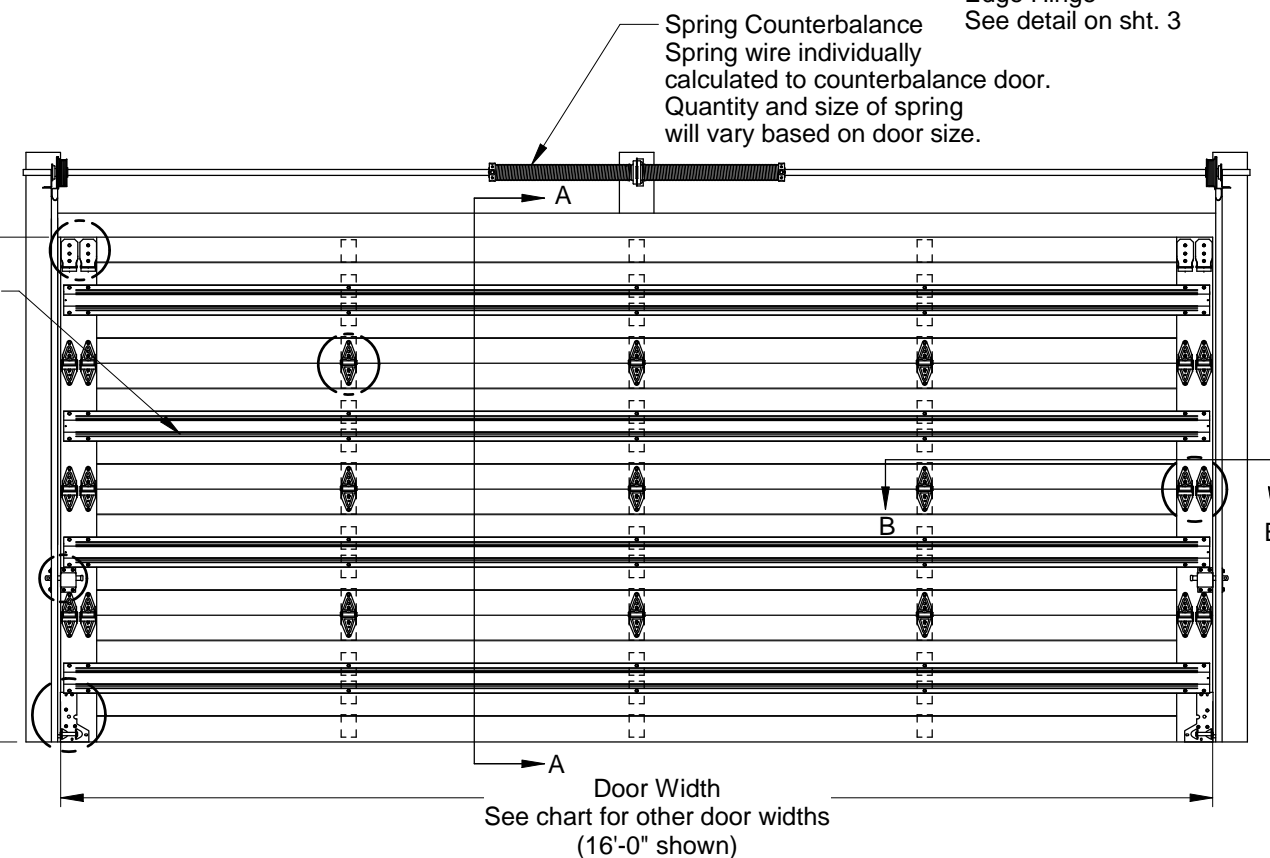

Interior Elevation

Doors tested per ANSI/DASMA 108 for static air pressure and ANSI/DASMA 115 for large missile impact and cyclic wind pressure

Maximum Door Width	Hinges per Section	Design Loads	
8'-0"	1	52.4	-57.0
9'-0"	1		
10'-0"	2	32.7	-39.4
16'-0"	3		
18'-0"	3	25.9	-31.1

John E. Scates
2560 King Arthur Blvd, Ste 124-54
Lewisville, TX 75056
FL PE #51737
TX PE #56308-f2203

Rev.	Description	ECO	Date	ECO: 7679.01
B	Removed vent option on sheet 1.	7679.04	12/09/19	
A	New release for production.	7679.01	02/15/19	

Scale: None
Drawn by: R. Frey
Checked by: G. Wedekind
Date: 02/15/19



1101 East River Road
Dixon, IL 61021

Title: Spec, Wind Load RockCreeke	
No. P-2906	Sheet 1 of 3
Rev B	

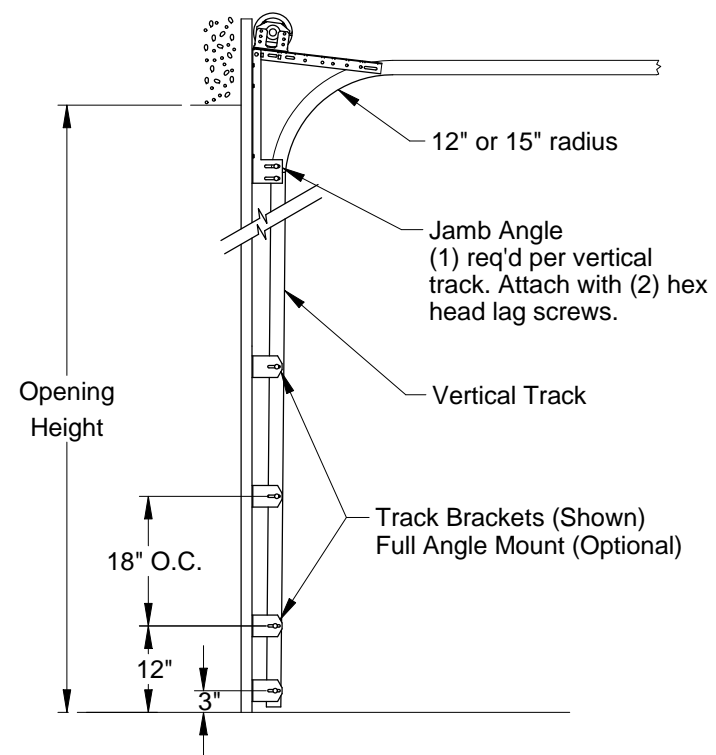

Typical Track Installation

Normal headroom track shown, low headroom, lift clearance and vertical lift track available

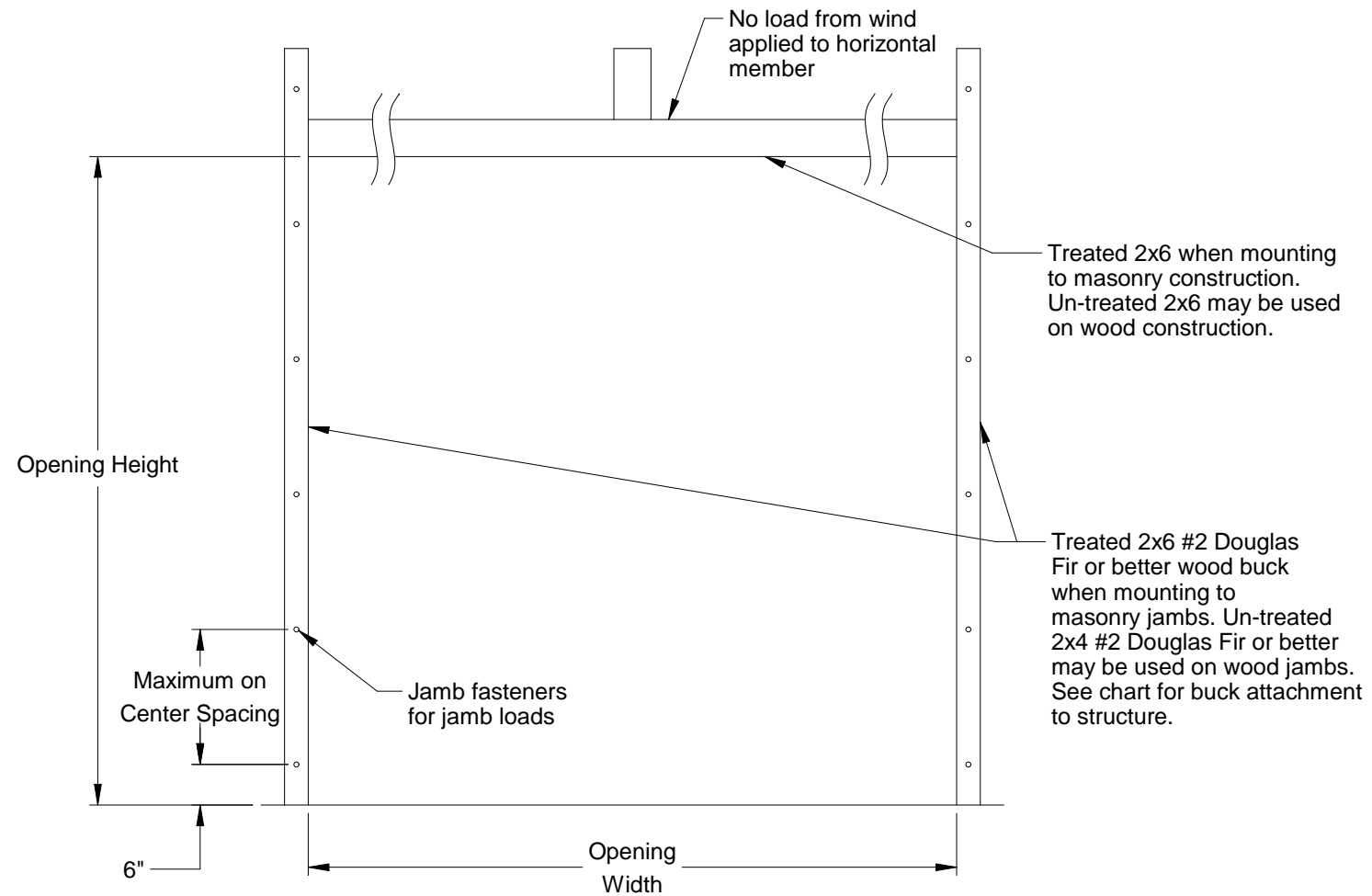

Jamb Attachment Notes:

1. Maximum Positive Load per Jamb = $(10'-0" \times 52.4 \text{ PSF}) / 2 = 262 \text{ lbs. per foot.}$
2. Maximum Negative Load per Jamb = $(16'-0" \times -57.0 \text{ PSF}) / 2 = 316 \text{ lbs. per foot.}$
3. Design of the supporting structure shall be the sole responsibility of the building designer and shall be designed for the jamb loads listed in notes 1 and 2.
4. Alternate jamb attachments may be used if approved by a registered Professional Engineer.
5. DASMA Technical Data Sheet TDS-161 may be used for alternate jamb attachments.
6. 3/8" diameter lag screws required 1/16" pilot hole and 1-1/2" minimum required distance.

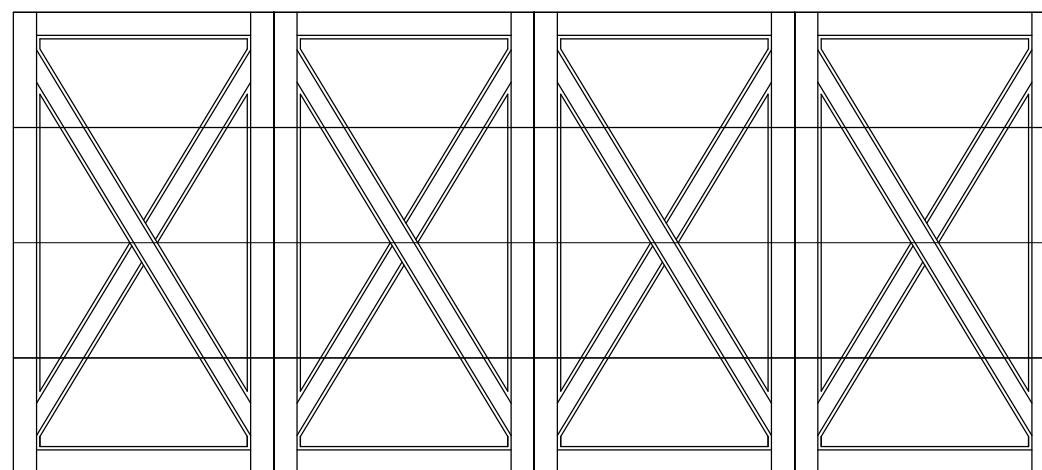

Exterior Elevation

Flush section with decorative trim boards. Arrangement of boards will vary based on design, cross bucks shown.

2x6 Attachment to Structure

Structure Type	Fastener Type	Minimum Embedment	Minimum Edge Distance	Minimum on Center Spacing	Maximum on Center Spacing	Allowable Tension Load
2500 PSI Min. Concrete	1/4" Tapcon+ (Plus) with 1-1/8" OD Washer	2"	2.5	6"	24"	526
Southern Pine	3/8" x 3" Lag with 1-1/8" OD Washer	1.50"	1.50"	1.50"	24"	655
Spruce Pine Fir	3/8" x 3" LAG with 1-1/8" OD Washer	1.50"	1.50"	1.50"	22"	482

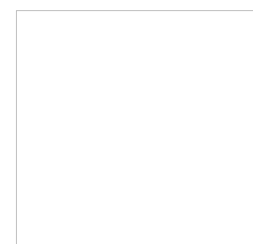

John E. Scates
2560 King Arthur Blvd, Ste 124-54
Lewisville, TX 75056
FL PE #51737
TX PE #56308-f2203

Scale: None	<p>1101 East River Road Dixon, IL 61021</p>	Title: Spec, Wind Load RockCreeke	
Drawn by: R. Frey		No. P-2906	Sheet 2
Checked by: G. Wedekind			Rev B
Date: 02/15/19			
ECO: 7679.01			

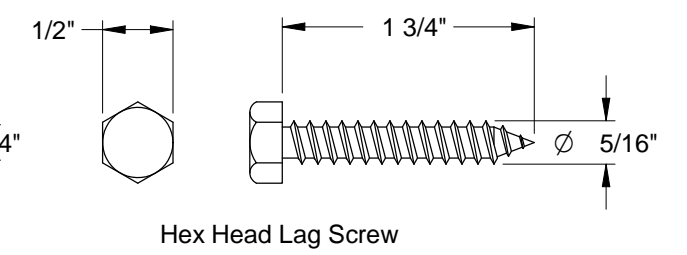
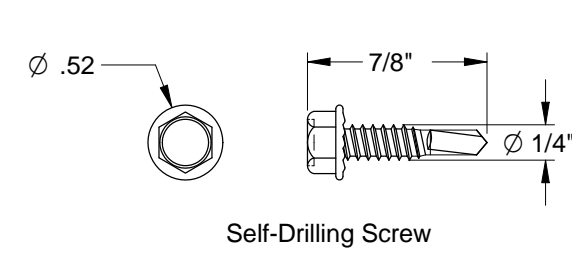
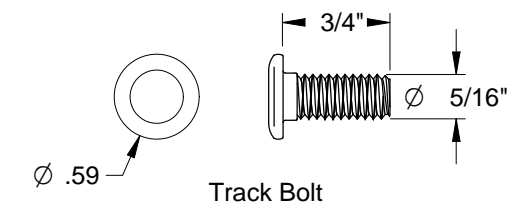
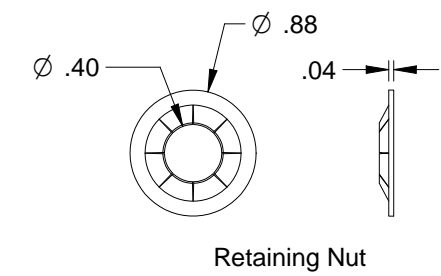
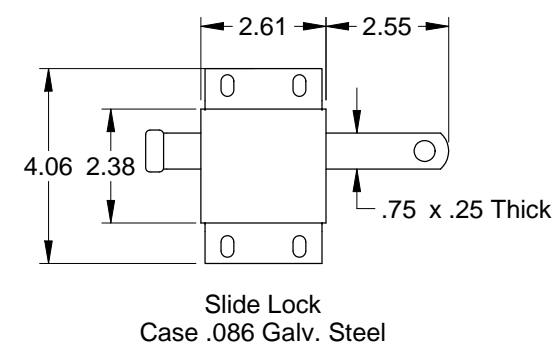
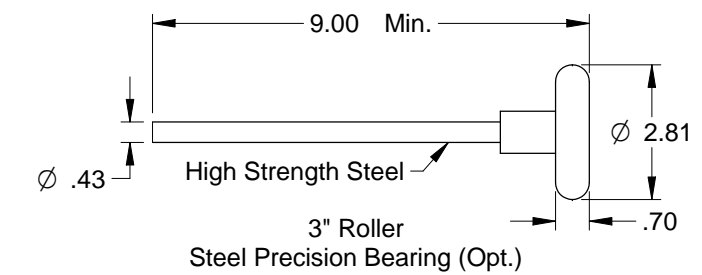
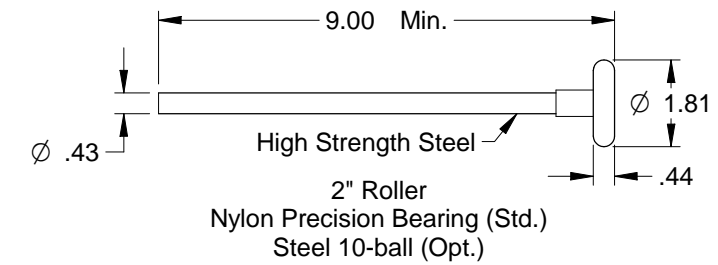
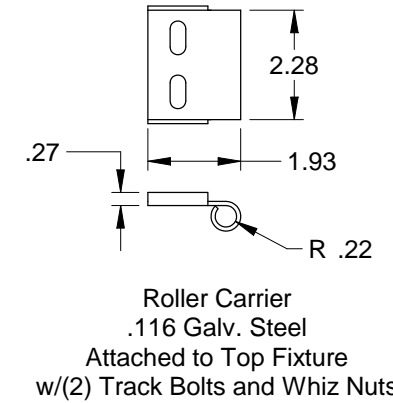
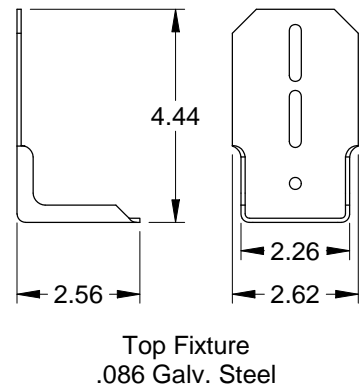
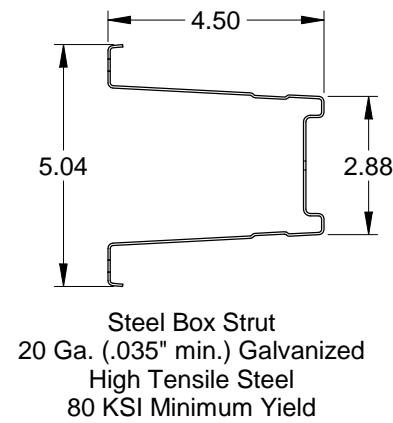
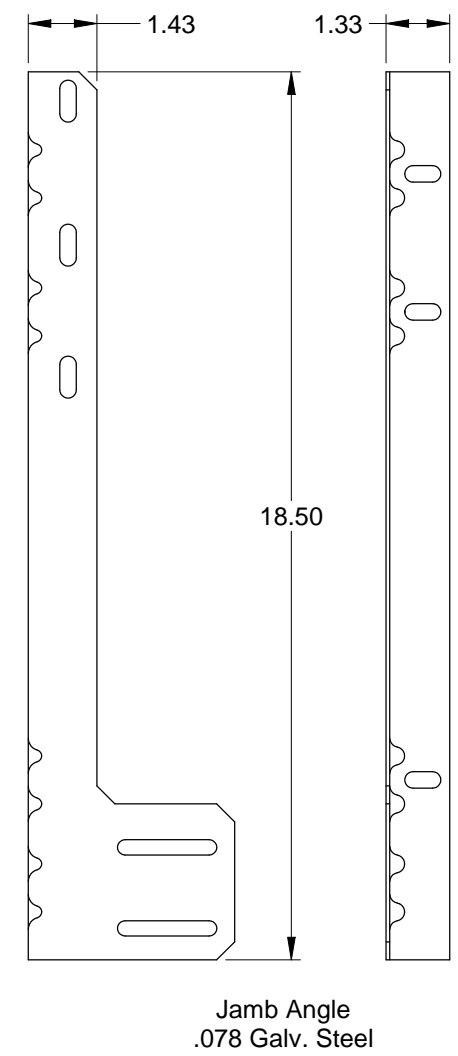
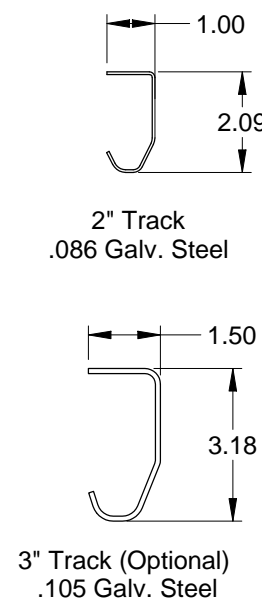
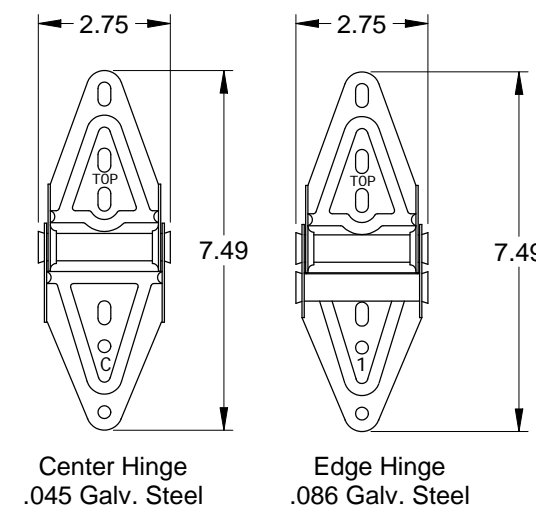
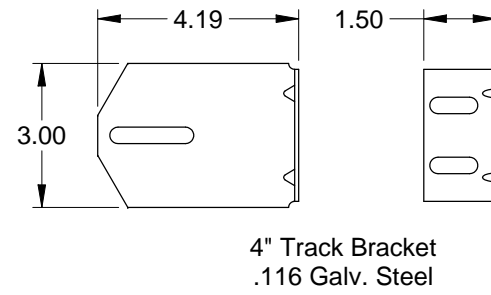
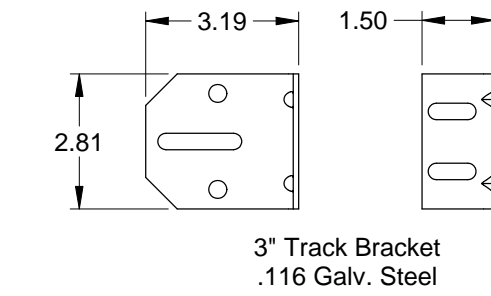
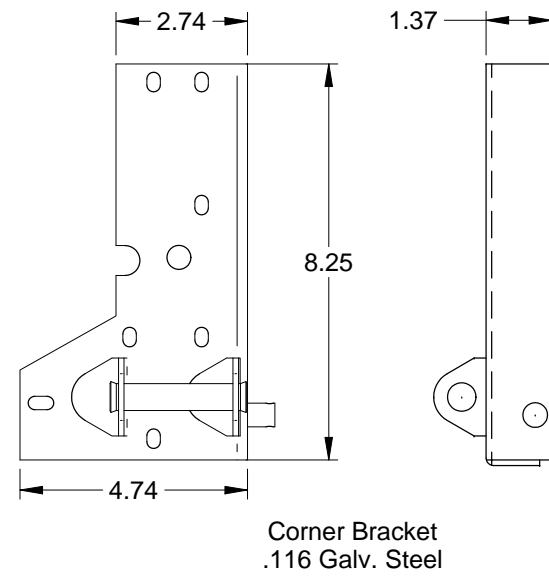

John E. Scates
2560 King Arthur Blvd, Ste 124-54
Lewisville, TX 75056
FL PE #51737
TX PE #56308-f2203

Scale: None
Drawn by: R. Frey
Checked by: G. Wedekind
Date: 02/15/19
ECO: 7679.01



Title: Spec, Wind Load RockCreeke		
No. P-2906	Sheet 3	Rev B