

Steel Section  
BuildMark .017 thick G-40 galvanized steel  
TradeMark .023 thick G-40 galvanized steel with an epoxy primer and baked on polyester finish which is roll-formed with wood grain texture.

Blocking  
2-1/8" x 1-1/2"  
Typical each end of each section

Perimeter Seal  
Nailed 8" O.C. with 4d steel nails

Center Stile  
20 Ga. Galv. Steel  
Tox locked and glued to panel.

Center Hinge  
See detail on sheet 3

Box Strut / U-bar  
See details on sht. 3

Retaining Nut  
7/16" push on retaining nut  
(1) req'd per roller.  
See detail on sht. 3

Jamb  
2x6 #2 Douglas Fir or better wood jamb.  
See sht. 2 for attachment

Hex Head Lag Screw  
(2) per bracket.  
See detail on sht. 3

Track Bracket shown  
See detail on sht. 3  
Full Angle optional

Track Bolt / Whiz Lock Nut  
See detail on sht. 3

Track Roller  
See detail on sht. 3

End Stile  
18 Ga. Galv. Steel  
Tox locked to panel.

Track, 2" shown, 3" optional  
See detail on sht. 3

Edge Hinge  
See detail on sht. 3

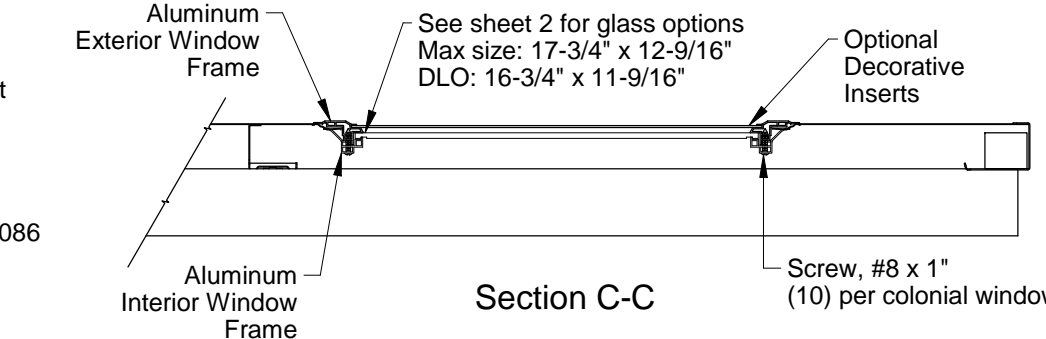

Windows (Optional)  
See options on sht. 2  
One row maximum

Steel Reinforcement  
(1) Box strut per section,  
(2) ubar on window section fastened to all center and end stiles using (2) sheet metal screws at each stile.

Locks required on doors not electrically operated.  
See detail on sht 3.

Door Height  
7'- 0" High shown  
Other door heights available up to 16'-0" using 18" or 21" high sections

Doors tested per ANSI/DASMA 108 for static air pressure and ANSI/DASMA 115 for large missile impact and cyclic wind pressure

Max. Door Width	Colonial			Ranch			Carriage House		
	Stiles per Sect.	Hinges per Sect.	Design Loads	Stiles per Sect.	Hinges per Sect.	Design Loads	Stiles per Sect.	Hinges per Sect.	Design Loads
8'-0"	3	1	29.7 -33.1	3	1	29.7 -33.1	3	1	29.7 -33.1
9'-0"	3	1		3	1		3	1	
10'-0"	4	2		3	1		3	1	
12'-0"	5	3		5	3		5	3	
14'-0"	6	4		5	3		5	3	
16'-0"	7	5	7	5	7	5			

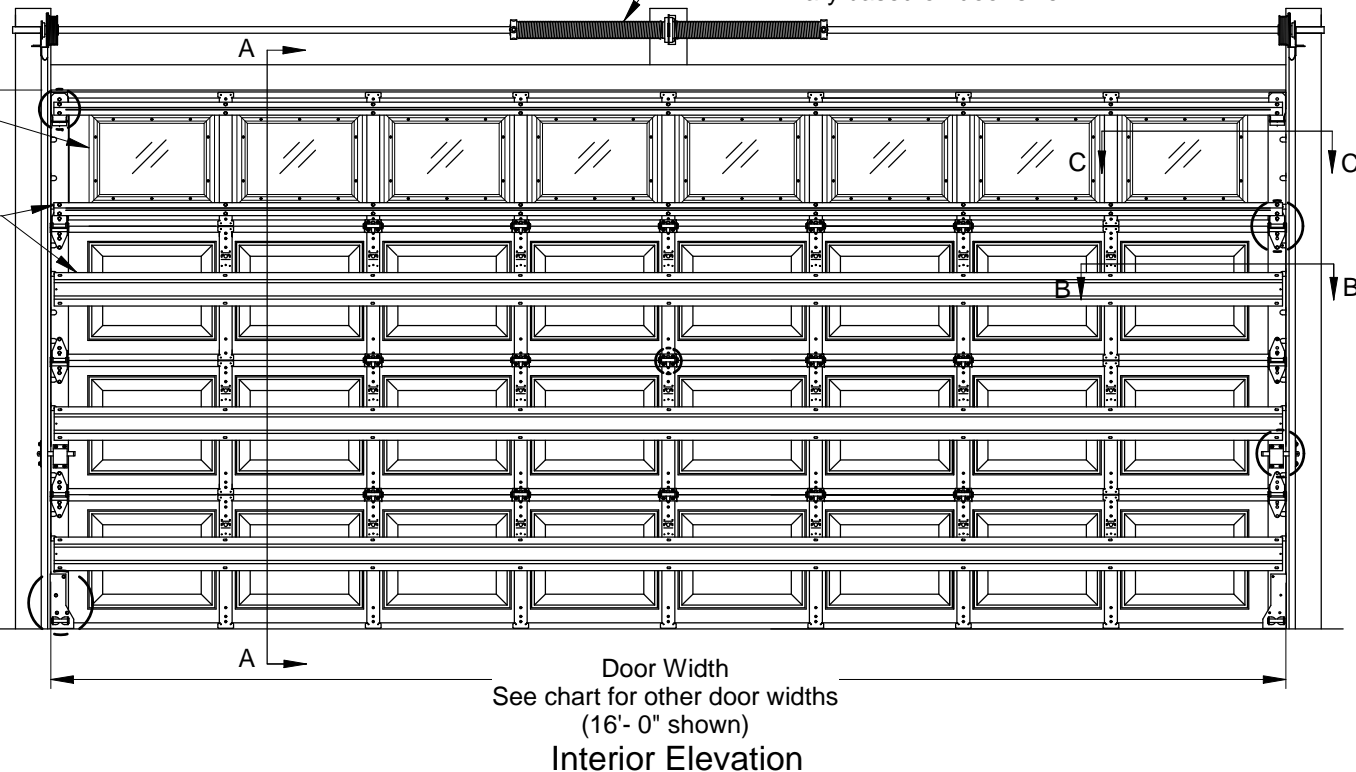

John E. Scates  
2560 King Arthur Blvd, Ste 124-54  
Lewisville, TX 75056  
FL PE #51737  
TX PE #56308-12203

Rev.	Description	ECO	Date	ECO: 7679.01
B	Removed vent option on sheet 1.	7679.04	12/09/19	
A	New release for production.	7679.01	02/18/19	

Scale: None  
Drawn by: R. Frey  
Checked by: G. Wedekind  
Date: 02/18/19

**RAYNOR**  
1101 East River Road  
Dixon, IL. 61021

Title: Spec, Wind Load BuildMark / TradeMark

No. **P-2904** Sheet 1 of 3 Rev **B**

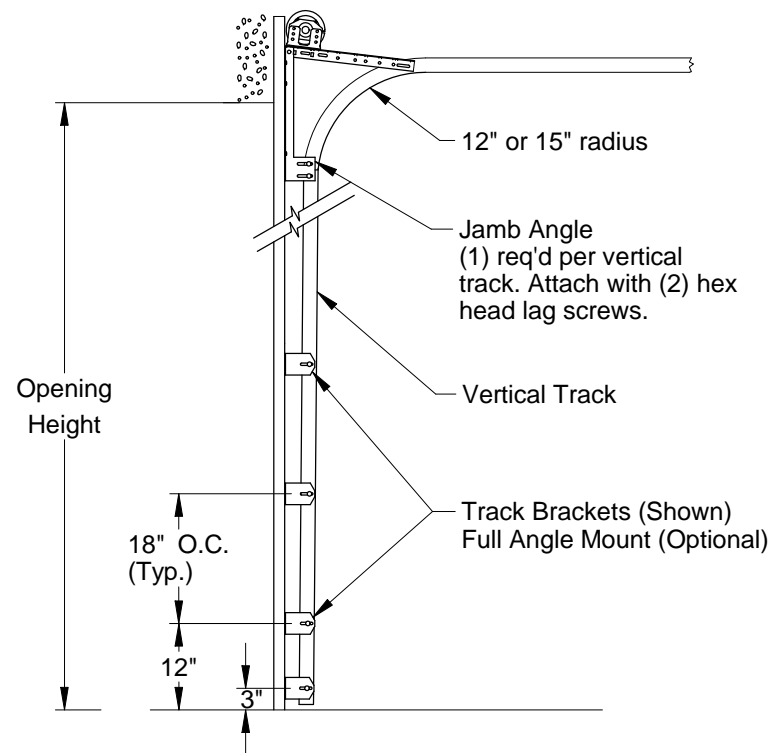

**Typical Track Installation**  
Normal headroom track shown, low headroom, lift clearance and vertical lift track available

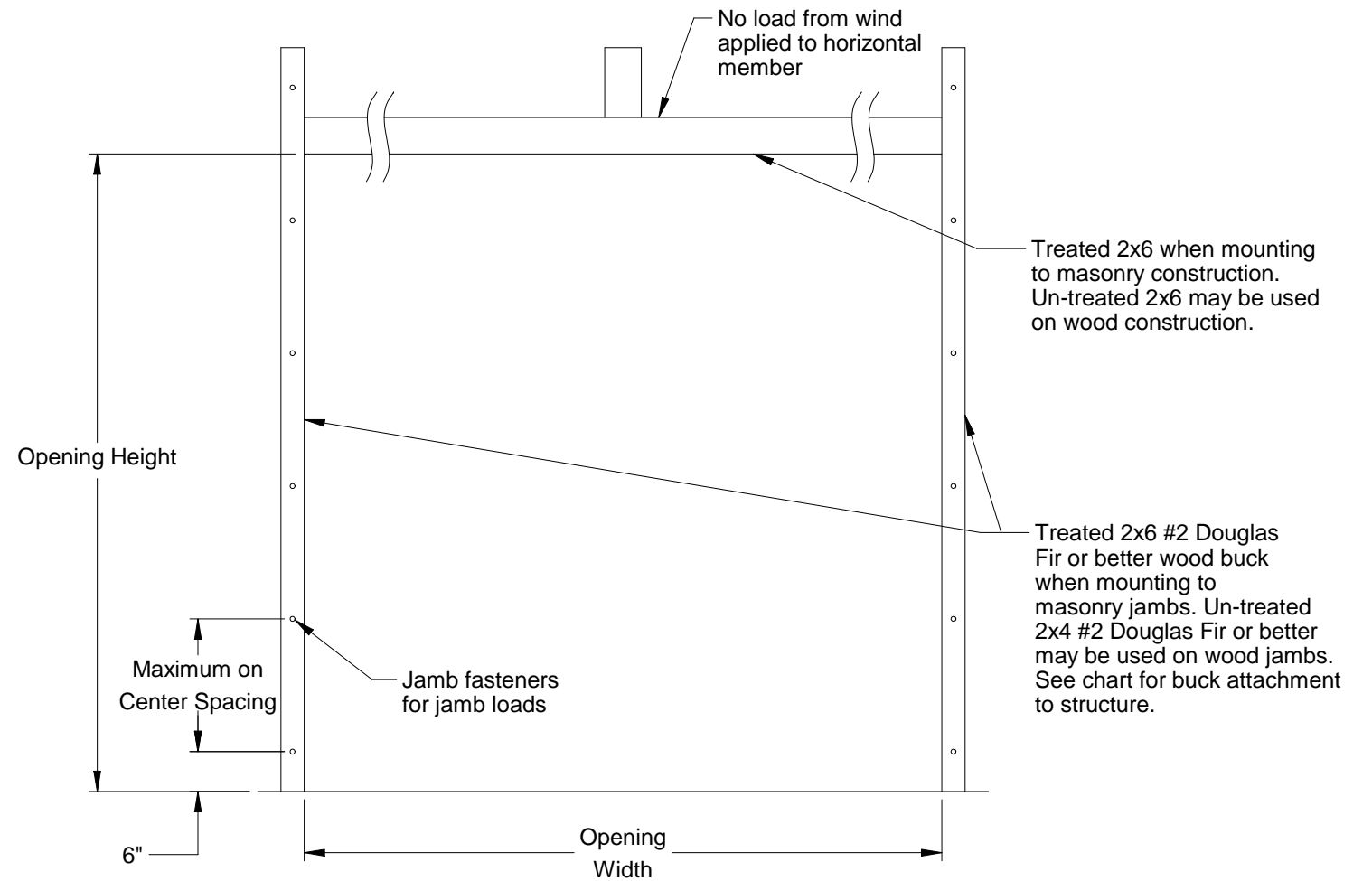

**Jamb Attachment Notes:**

1. Maximum Positive Load per Jamb =  $(16'-0" \times 29.7 \text{ PSF}) / 2 = 238 \text{ lbs. per foot.}$
2. Maximum Negative Load per Jamb =  $(16'-0" \times -33.1 \text{ PSF}) / 2 = 265 \text{ lbs. per foot.}$
3. Design of the supporting structure shall be the sole responsibility of the building designer and shall be designed for the jamb loads listed in notes 1 and 2.
4. Alternate jamb attachments may be used if approved by a registered Professional Engineer.
5. DASMA Technical Data Sheet TDS-161 may be used for alternate jamb attachments.
6. 3/8" diameter lag screws required 1/16" pilot hole and 1-1/2" minimum required distance.

**2x6 Attachment to Structure**

Structure Type	Fastener Type	Minimum Embedment	Minimum Edge Distance	Minimum on Center Spacing	Maximum on Center Spacing	Allowable Tension Load
2500 PSI Min. Concrete	1/4" Tapcon+ (Plus) with 1-1/8" OD Washer	2"	2.5	6"	24"	526
Southern Pine	3/8" x 3" Lag with 1-1/8" OD Washer	1.50"	1.50"	1.50"	24"	655
Spruce Pine Fir	3/8" x 3" LAG with 1-1/8" OD Washer	1.50"	1.50"	1.50"	24"	482

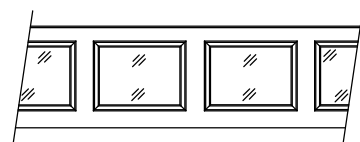

**Window Options**

Colonial windows:  
1/4" Polycarbonate

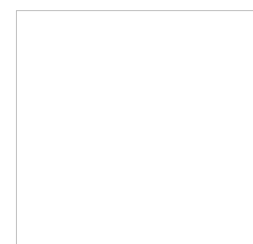

John E. Scates  
2560 King Arthur Blvd, Ste 124-54  
Lewisville, TX 75056  
FL PE #51737  
TX PE #56308-f2203

Scale: None
Drawn by: R. Frey
Checked by: G. Wedekind
Date: 02/18/19
ECO: 7679.01



1101 East River Road  
Dixon, IL 61021

Title: Spec, Wind Load  
BuildMark / TradeMark

No. P-2904

Sheet 2

Rev B

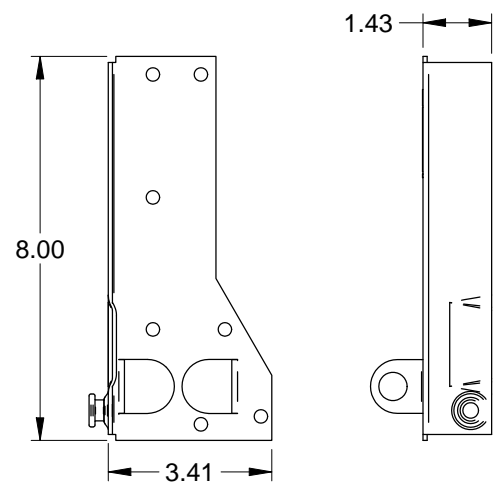

Corner Bracket  
.086 Galv. Steel

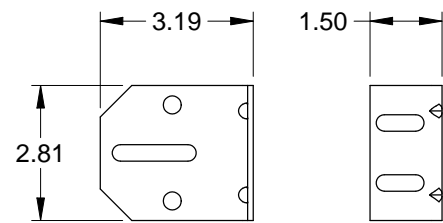

3" Track Bracket  
.116 Galv. Steel

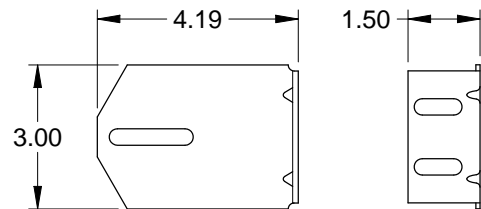

4" Track Bracket  
.116 Galv. Steel

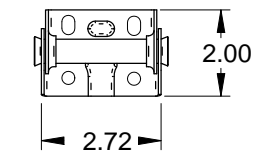

Center Hinge  
.045 Galv. Steel

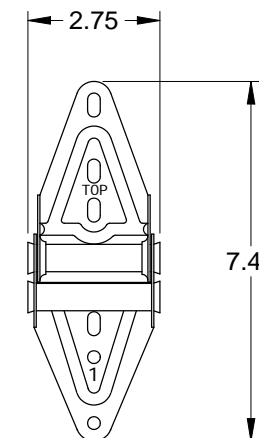

Edge Hinge  
.086 Galv. Steel

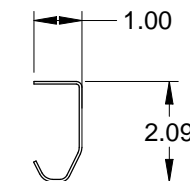

2" Track  
.086 Galv. Steel

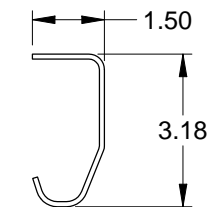

3" Track (Optional)  
.105 Galv. Steel

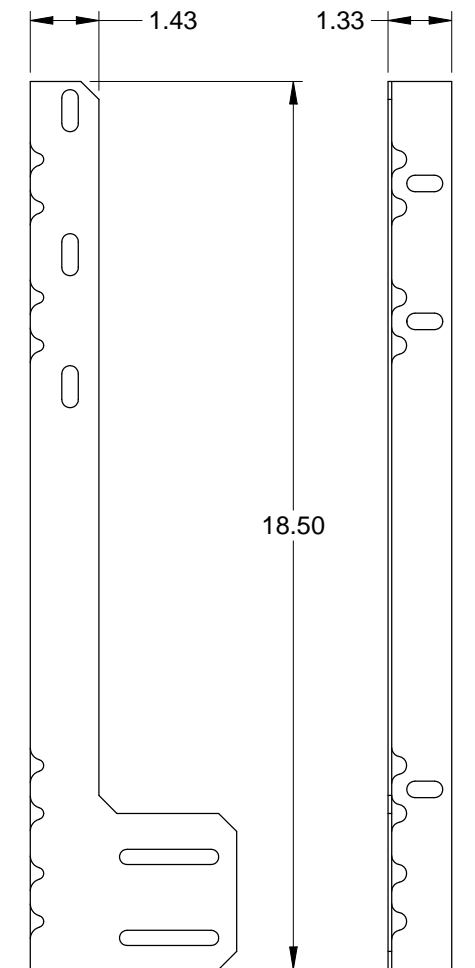

Jamb Angle  
.078 Galv. Steel

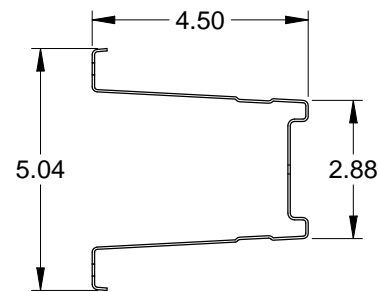

Steel Box Strut  
20 Ga. (.035" Min.) Galvanized  
High Tensile Steel  
80 KSI Minimum Yield

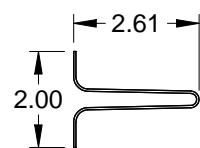

Steel U-Bar  
18 Ga. (.049" min.) Galvanized  
High Tensile Steel  
80 KSI Minimum Yield

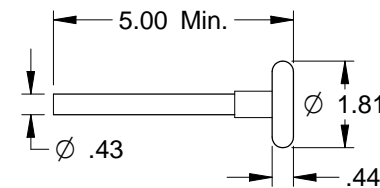

2" Roller  
Nylon 11-ball (Std.)  
Steel 10-ball (Opt.)

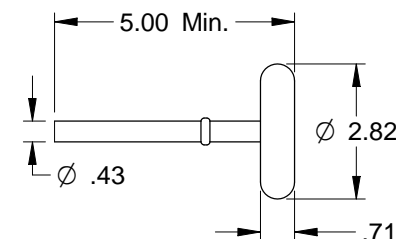

3" Roller  
Steel 10-ball (Opt.)

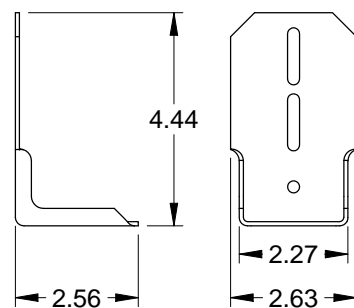

Top Fixture  
.086 Galv. Steel

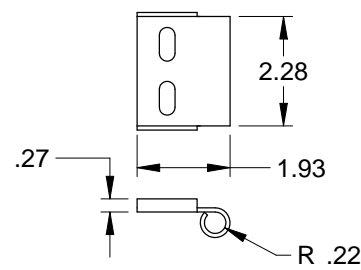

Roller Carrier  
.116 Galv. Steel  
Attached to Top Fixture  
w/(2) Track Bolts and Whiz Nuts

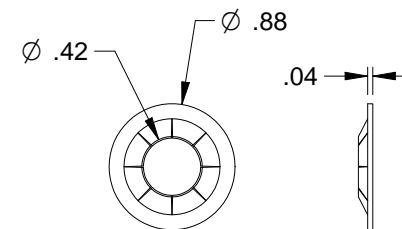

Retaining Nut

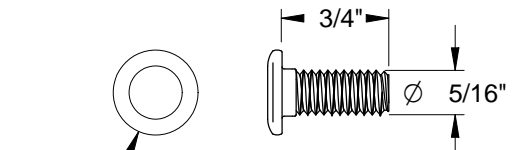

Track Bolt

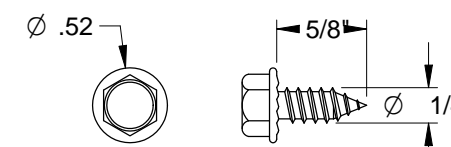

Sheet Metal Screw

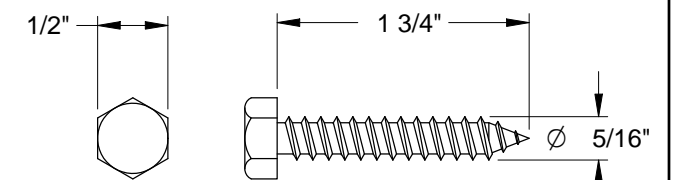

Hex Head Lag Screw

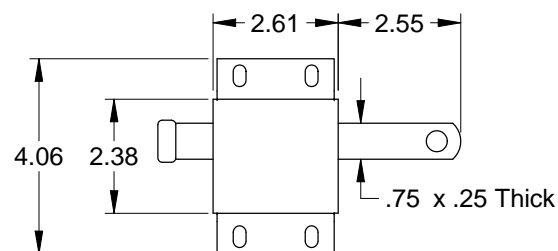

Slide Lock  
Case .086 Galv. Steel

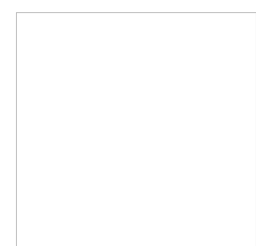

John E. Scates  
2560 King Arthur Blvd, Ste 124-54  
Lewisville, TX 75056  
FL PE #51737  
TX PE #56308-f2203

Scale: None
Drawn by: R. Frey
Checked by: G. Wedekind
Date: 02/18/19
ECO: 7679.01



1101 East River Road  
Dixon, IL 61021

Title:  
Spec, Wind Load  
BuildMark / TradeMark

No. P-2904

Sheet  
3

Rev  
B