

Doors tested per ANSI/DASMA 108 for static air pressure

Maximum Door Width	Stiles per Sect.	Hinges per Sect.	Design Load
8'-2"	1	1	47.3 -53.5
9'-2"	2	2	42.1 -47.7
10'-2"	2	2	38.0 -43.0
12'-2"	2	2	26.5 -30.0
14'-2"	3	3	23.3 -25.9
16'-2"	3	3	20.4 -22.7

John E. Scates  
 2560 King Arthur Blvd, Ste 124-54  
 Lewisville, TX 75056  
 FL PE #51737  
 TX PE #56308-12203

Professional Engineer's seal provided only for verification of wind load construction details

Scale: None		Title: Spec, Wind Load AlumaView - AV300	
Drawn by: R. Frey		No. P-2810	Sheet 1 of 3
Checked by: G. Wedekind	1101 East River Road Dixon, IL. 61021	Rev B	
Date: 01/29/19			
ECO: 7679.01			

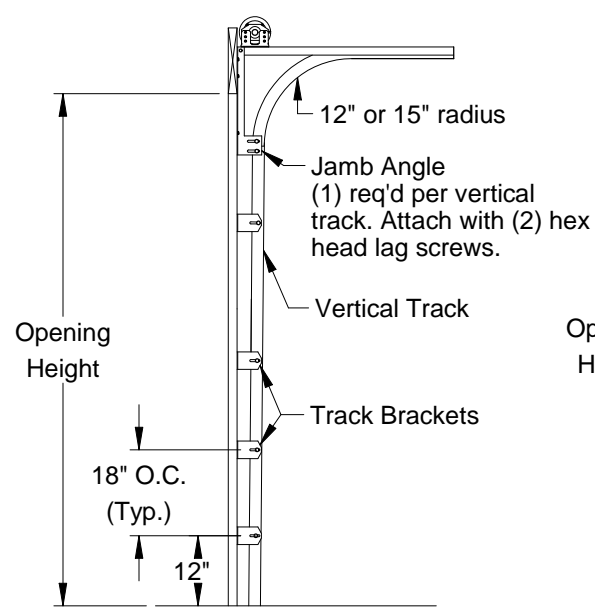

**Typical Track Installation  
Bracket Mount  
Wood Jamb**

Normal headroom track shown, low headroom, lift clearance and vertical lift track available

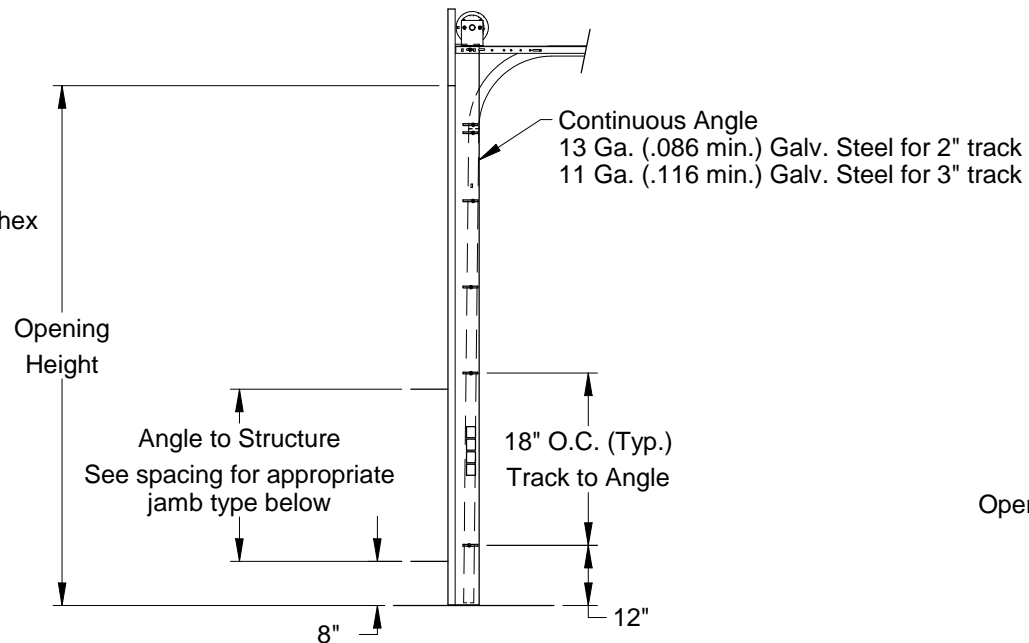

**Typical Track Installation  
Angle Mount  
Wood, Steel or Concrete Jamb**

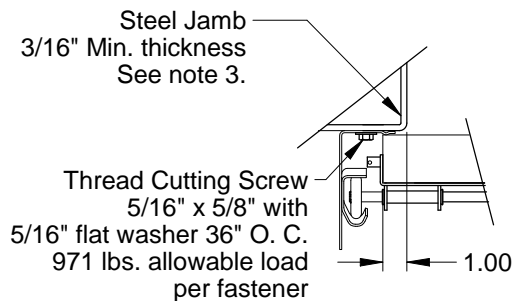
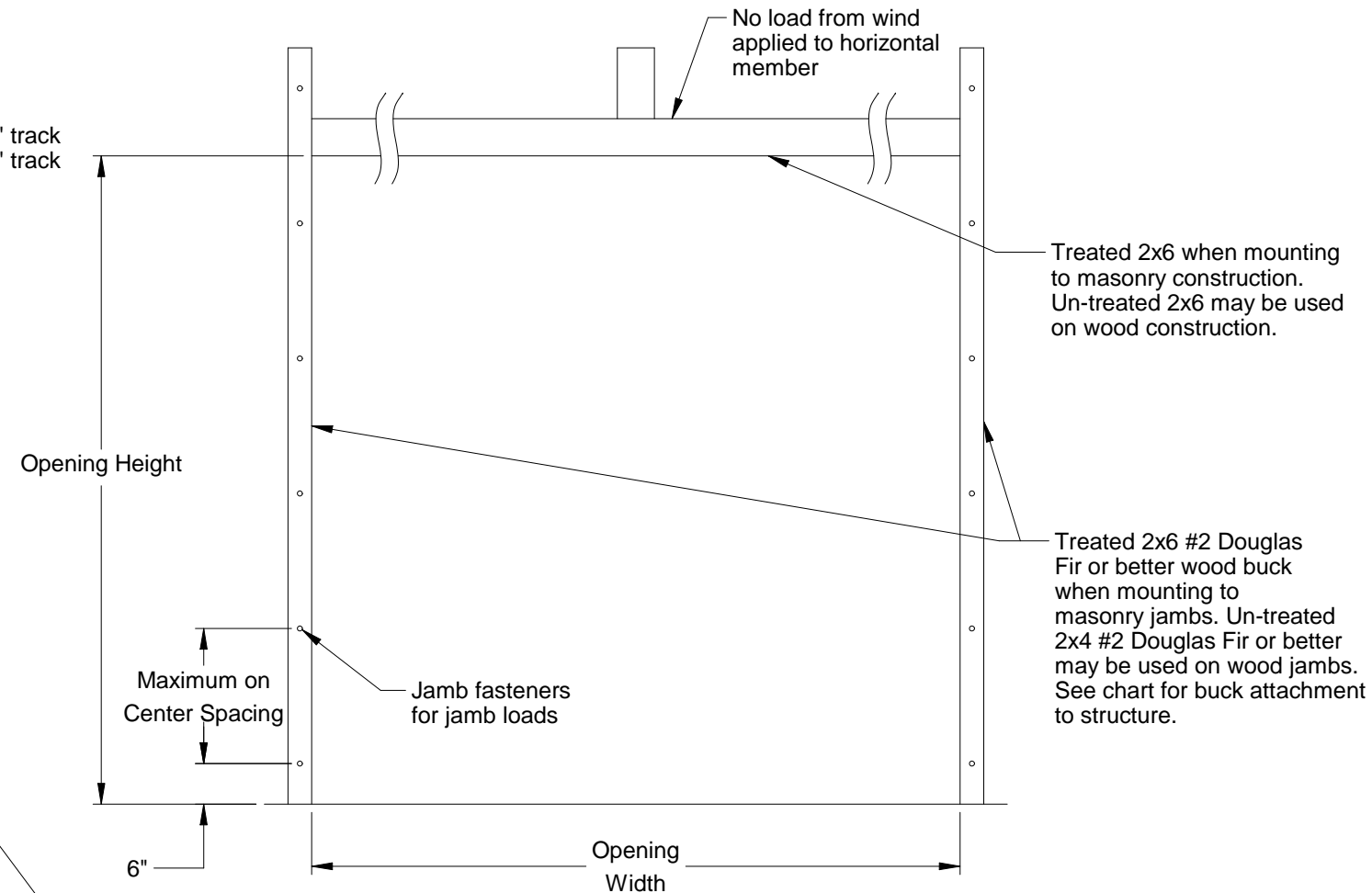

**Track Assembly Attachment  
to Steel Jamb**

2" Track Angle Mount Turned-in (shown)  
3" Track Angle Mount Available

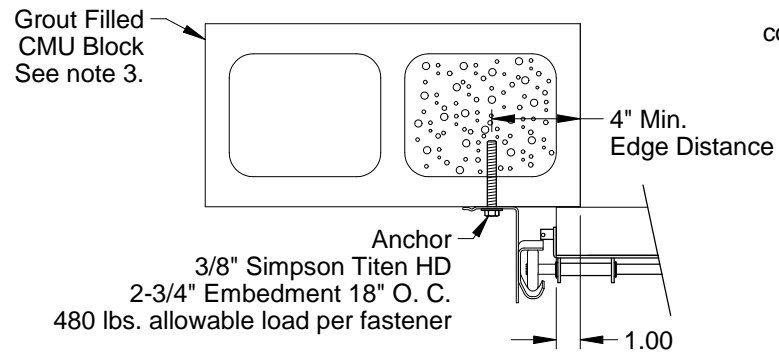

**Track Assembly Attachment  
to Grout Filled CMU Block**

2" Track Angle Mount Turned-out (shown)  
3" Track Angle Mount Available

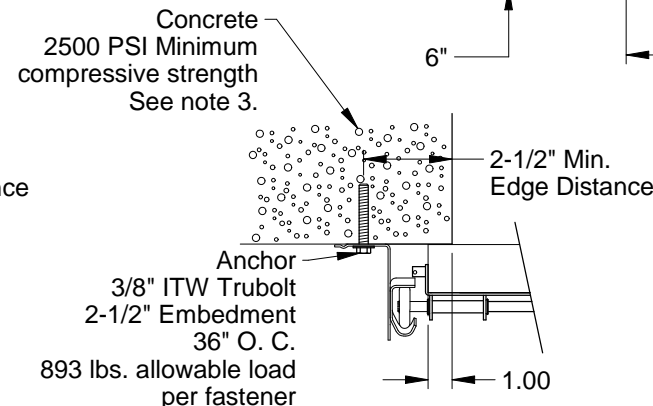

**Track Assembly Attachment  
to 2500 PSI Min. Concrete**

2" Track Angle Mount Turned-out (shown)  
3" Track Angle Mount Available

**Jamb Attachment Notes:**

1. Maximum Positive Load per Jamb =  $(10'-2" \times 38.0 \text{ PSF}) / 2 = 194 \text{ lbs. per foot.}$
2. Maximum Negative Load per Jamb =  $(10'-2" \times -43.0 \text{ PSF}) / 2 = 219 \text{ lbs. per foot.}$
3. Design of the supporting structure shall be the sole responsibility of the building designer and shall be designed for the jamb loads listed in notes 1 and 2.
4. Alternate jamb attachments may be used if approved by a registered Professional Engineer.
5. DASMA Technical Data Sheet TDS-161 may be used for alternate jamb attachments.
6. 3/8" diameter lag screws required 1/16" pilot hole and 1-1/2" minimum required distance.

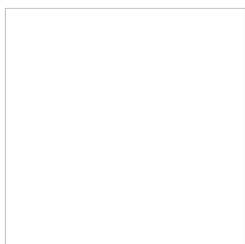

John E. Scates  
2560 King Arthur Blvd, Ste 124-54  
Lewisville, TX 75056  
FL PE #51737  
TX PE #56308-12203

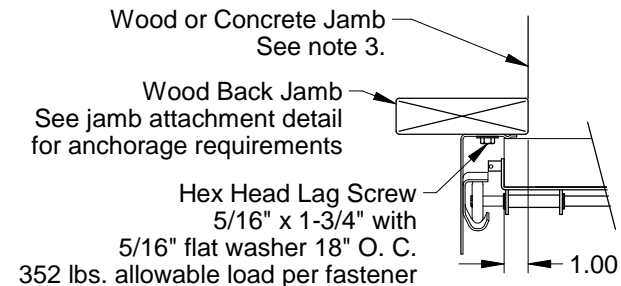

**Track Assembly Attachment  
to Wood Back Jamb**

2" Track Angle Mount Turned-in (shown)  
3" Track Angle Mount Available

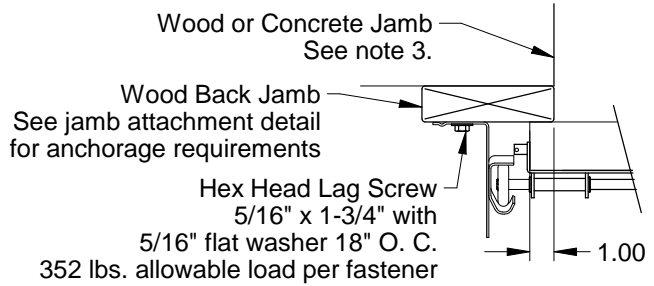

**Track Assembly Attachment  
to Wood Back Jamb**

2" Track Angle Mount Turned-out (shown)  
3" Track Angle Mount Available

2x6 Attachment to Structure						
Structure Type	Fastener Type	Minimum Embedment	Minimum Edge Distance	Minimum on Center Spacing	Maximum on Center Spacing	Allowable Tension Load
2500 PSI Min. Concrete	1/4" Tapcon+ (Plus) with 1-1/8" OD Washer	2"	2.5"	6"	24"	526
Southern Pine	3/8" x 3" Lag with 1-1/8" OD Washer	1.50"	1.50"	1.50"	24"	655
Spruce Pine Fir	3/8" x 3" LAG with 1-1/8" OD Washer	1.50"	1.50"	1.50"	24"	482

Scale: None
Drawn by: R. Frey
Checked by: G. Wedekind
Date: 01/29/19
ECO: 7679.01



Title: Spec, Wind Load AlumaView - AV300	
No. P-2810	Sheet 2
	Rev B

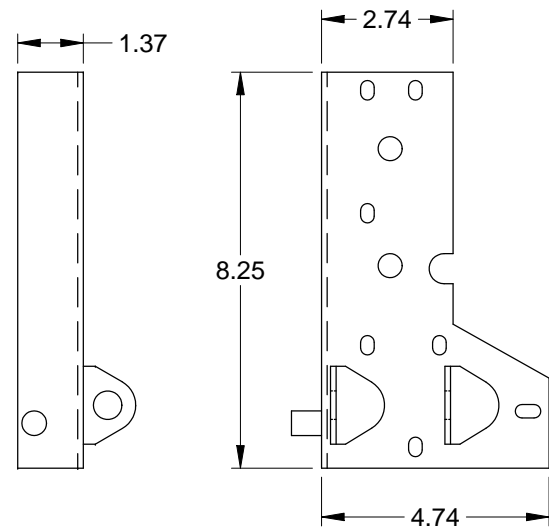

Corner Bracket  
(For doors over 600 lbs.)  
.116 Galv. Steel

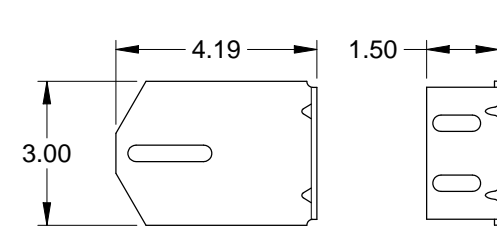

4" Track Bracket  
.116 Galv. Steel

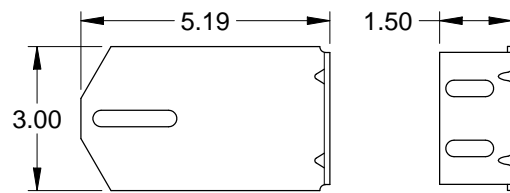

5" Track Bracket  
.116 Galv. Steel

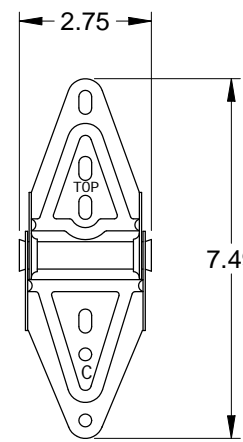

Center Hinge  
.045 Galv. Steel

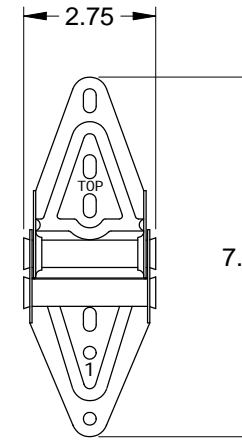

Edge Hinge  
.086 Galv. Steel

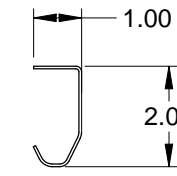

2" Track  
.055 Galv. Steel

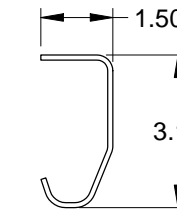

3" Track (Optional)  
.105 Galv. Steel

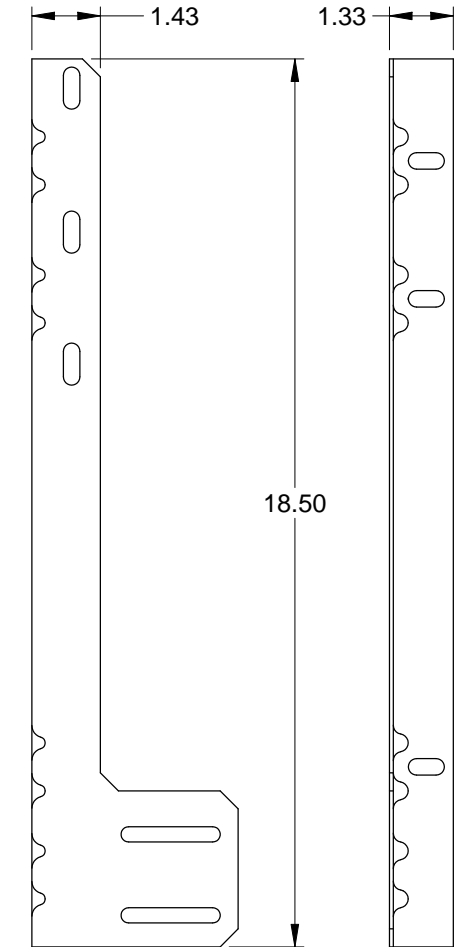

Jamb Angle  
.078 Galv. Steel

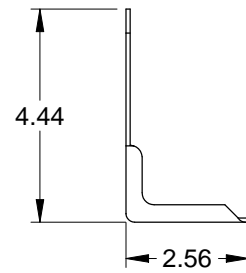

Top Fixture  
.086 Galv. Steel

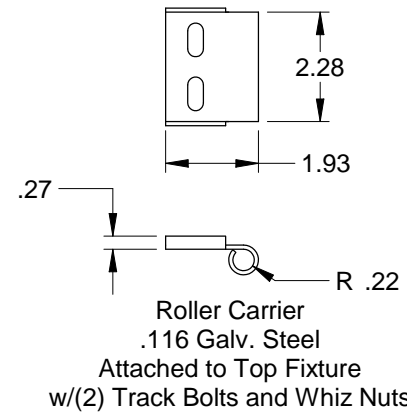
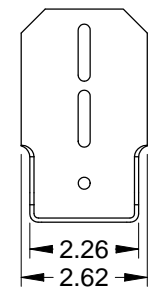

Roller Carrier  
.116 Galv. Steel  
Attached to Top Fixture  
w/(2) Track Bolts and Whiz Nuts

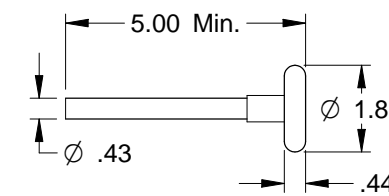

2" Roller  
Nylon 11-ball (Std.)  
Steel 10-ball (Opt.)

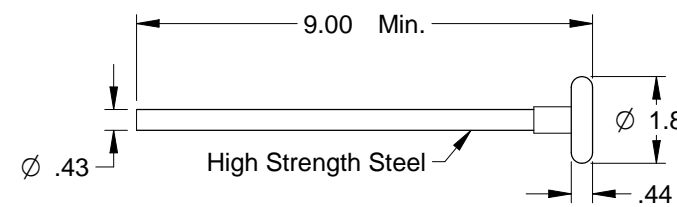

2" Roller  
Nylon Precision Bearing (Std.)  
Steel 10-ball (Opt.)

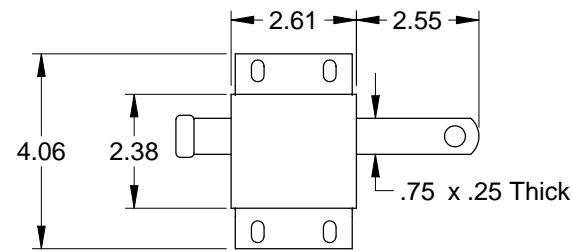

Slide Lock  
Case .086 Galv. Steel

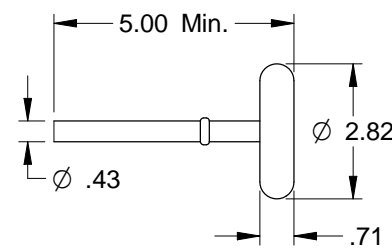

3" Roller  
Steel 10-ball (Opt.)

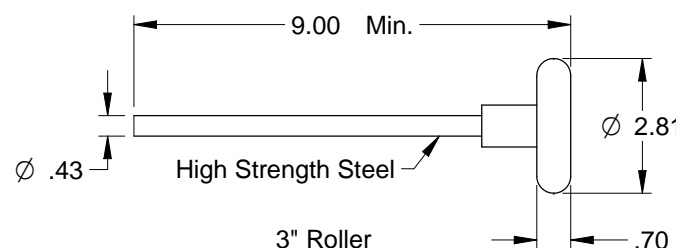

3" Roller  
Steel Precision Bearing (Opt.)

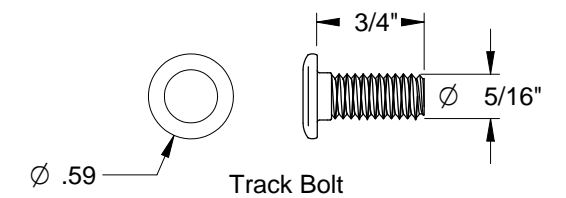

Track Bolt

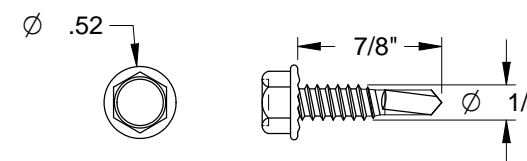

Self-Drilling Screw

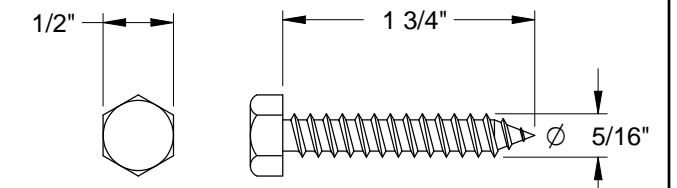

Hex Head Lag Screw

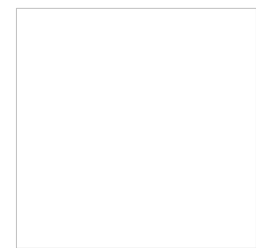

John E. Scates  
2560 King Arthur Blvd, Ste 124-54  
Lewisville, TX 75056  
FL PE #51737  
TX PE #56308-f2203

Scale: None	 1101 East River Road Dixon, IL 61021	Title: Spec, Wind Load Alumaview - AV300	
Drawn by: R. Frey		No. P-2810	Sheet 3
Checked by: G. Wedekind			Rev B
Date: 01/29/19		ECO: 7679.01	