

Doors tested per ANSI/DASMA 108 for static air pressure

Maximum Door Width	Colonial			Ranch			Carriage House		
	Stiles per Sect.	Hinges per Sect.	Design Loads	Stiles per Sect.	Hinges per Sect.	Design Loads	Stiles per Sect.	Hinges per Sect.	Design Loads
8'-0"	1	1	27.9 -31.5	1	1	27.9 -31.5	1	1	27.9 -31.5
	3	1	34.9 -39.5	3	1	34.9 -39.5	3	1	34.9 -39.5
9'-0"	1	1	24.8 -28.0	1	1	24.8 -28.0	1	1	24.8 -28.0
	3	1	31.0 -35.1	3	1	31.0 -35.1	3	1	31.0 -35.1
10'-0"	2	2	20.1 -22.7	3	1	20.1 -22.7	3	1	20.1 -22.7
	4	2	25.1 -28.4						

John E. Scates  
 2560 King Arthur Blvd, Ste 124-54  
 Lewisville, TX 75056  
 FL PE #51737  
 TX PE #56308-f2203

Professional Engineer's seal provided only for verification of wind load construction details

Rev.	Description	ECO	Date
B	Removed vent option on sheet 1.	7679.02	12/09/19
A	New release for production.	7679.01	01/08/19

Scale: None
Drawn by: R. Frey
Checked by: G. Wedekind
Date: 01/08/19
ECO: 7679.01



Title: Spec, Wind Load BuildMark / TradeMark	
No. P-2803	Sheet 1 of 3
Rev B	

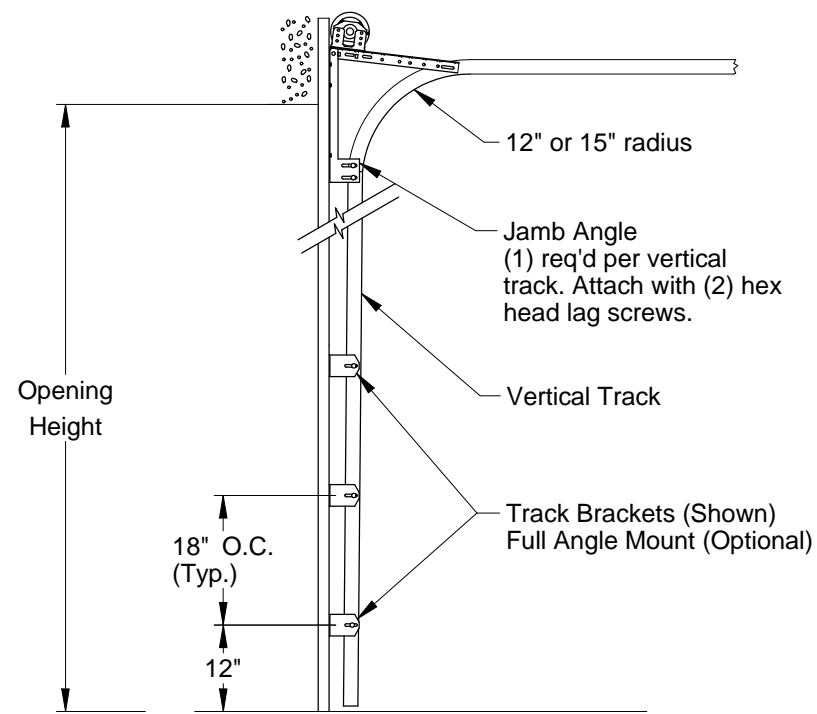

**Typical Track Installation**  
Normal headroom track shown, low headroom, lift clearance and vertical lift track available

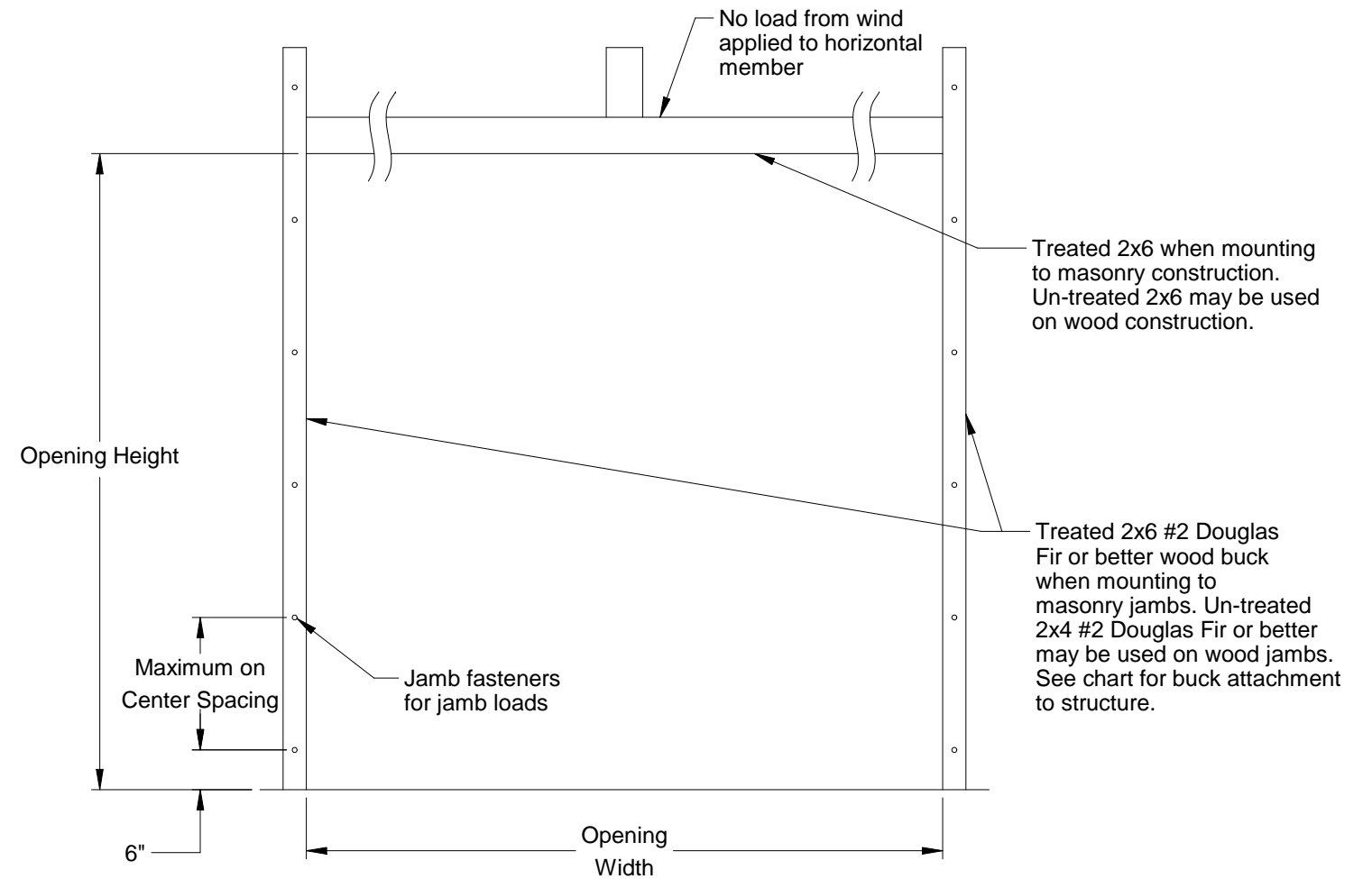

**Jamb Attachment Notes:**

1. Maximum Positive Load per Jamb = (9'-0" x 31.0 PSF) / 2 = 140 lbs. per foot.
2. Maximum Negative Load per Jamb = (9'-0" x -35.1 PSF) / 2 = 158 lbs. per foot.
3. Design of the supporting structure shall be the sole responsibility of the building designer and shall be designed for the jamb loads listed in notes 1 and 2.
4. Alternate jamb attachments may be used if approved by a registered Professional Engineer.
5. DASMA Technical Data Sheet TDS-161 may be used for alternate jamb attachments.
6. 3/8" diameter lag screws required 1/16" pilot hole and 1-1/2" minimum required distance.

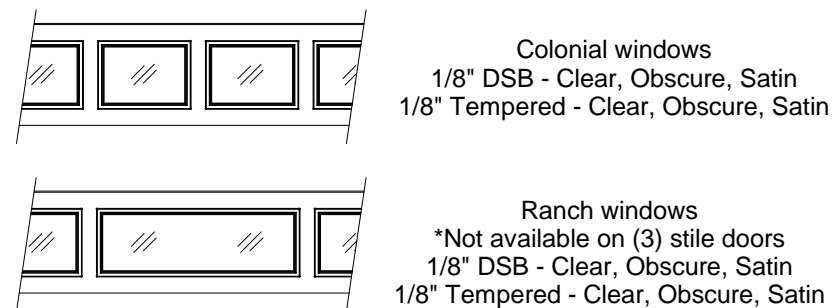

**Window Options**

2x6 Attachment to Structure						
Structure Type	Fastener Type	Minimum Embedment	Minimum Edge Distance	Minimum on Center Spacing	Maximum on Center Spacing	Allowable Tension Load
2500 PSI Min. Concrete	1/4" Tapcon+ (Plus) with 1-1/8" OD Washer	2"	2.5	6"	24"	526
Southern Pine	3/8" x 3" Lag with 1-1/8" OD Washer	1.50"	1.50"	1.50"	24"	655
Spruce Pine Fir	3/8" x 3" LAG with 1-1/8" OD Washer	1.50"	1.50"	1.50"	24"	482

John E. Scates  
2560 King Arthur Blvd, Ste 124-54  
Lewisville, TX 75056  
FL PE #51737  
TX PE #56308-f2203

Scale: None	 1101 East River Road Dixon, IL 61021	Title: Spec, Wind Load BuildMark / TradeMark		
Drawn by: R. Frey		No. P-2803	Sheet 2	Rev B
Checked by: G. Wedekind				
Date: 01/08/19 ECO: 7679.01				

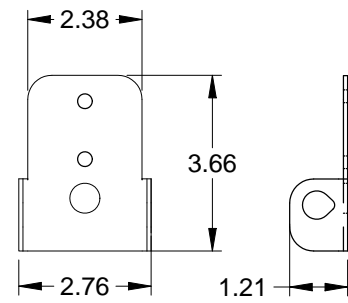

Roller Carrier  
.086 Galv. Steel

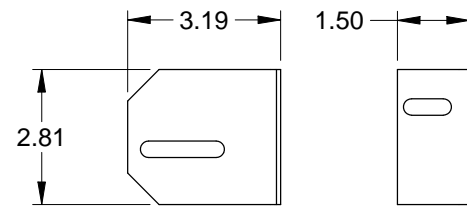

3" Track Bracket  
.086 Galv. Steel

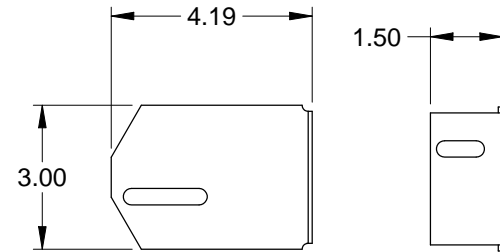

4" Track Bracket  
.086 Galv. Steel

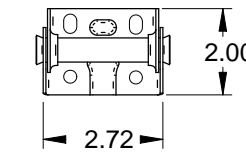

Center Hinge  
.045 Galv. Steel

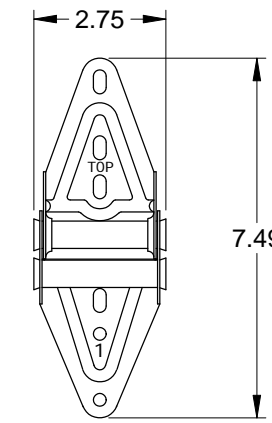

Edge Hinge  
.086 Galv. Steel

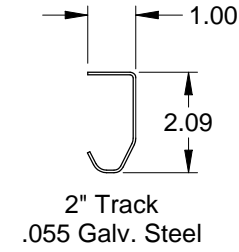

2" Track  
.055 Galv. Steel

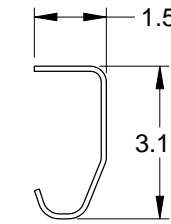

3" Track (Optional)  
.105 Galv. Steel

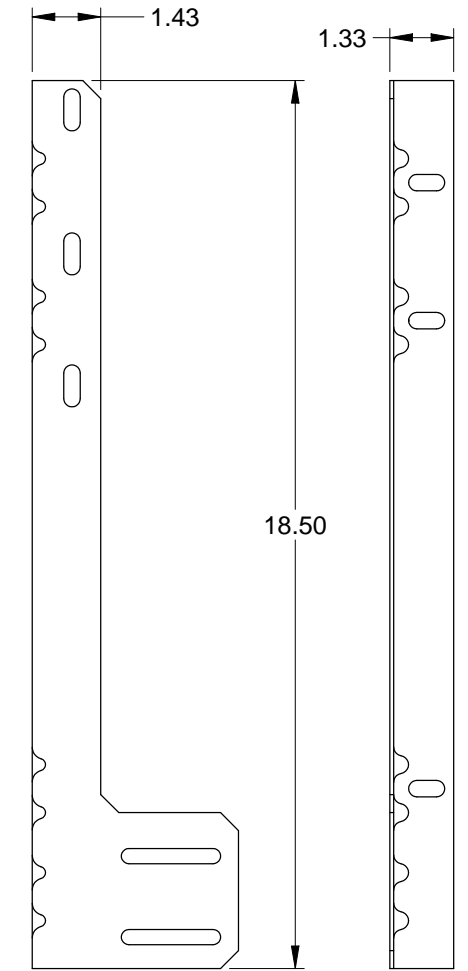

Jamb Angle  
.078 Galv. Steel

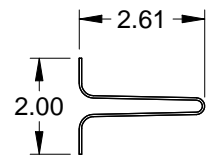

Steel U-Bar  
18 Ga. (.049" min.) Galvanized  
High Tensile Steel  
80 KSI Minimum Yield

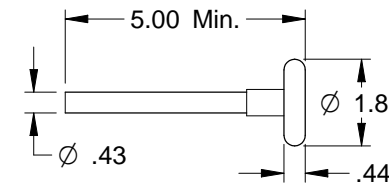

2" Roller  
Nylon 11-ball (Std.)  
Steel 10-ball (Opt.)

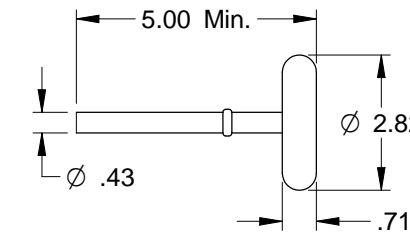

3" Roller  
Steel 10-ball (Opt.)

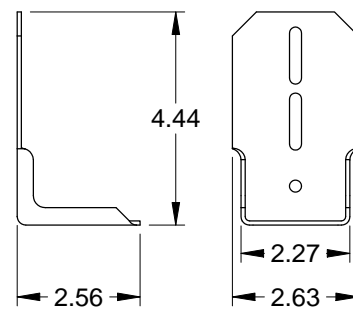

Top Fixture  
.086 Galv. Steel

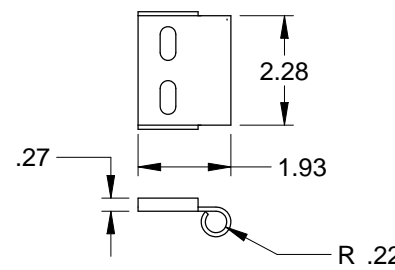

Roller Carrier  
.116 Galv. Steel  
Attached to Top Fixture  
w/(2) Track Bolts and Whiz Nuts

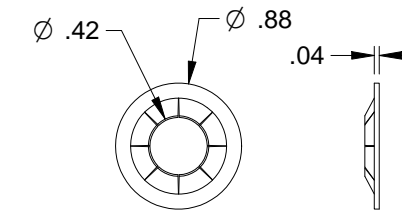

Retaining Nut

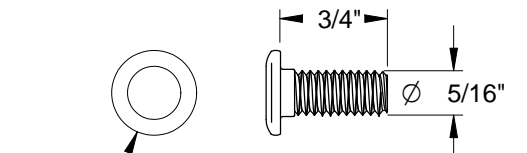

Track Bolt

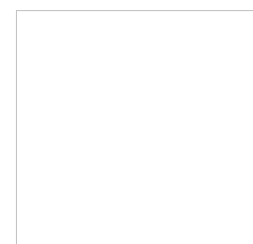

John E. Scates  
2560 King Arthur Blvd, Ste 124-54  
Lewisville, TX 75056  
FL PE #51737  
TX PE #56308-f2203

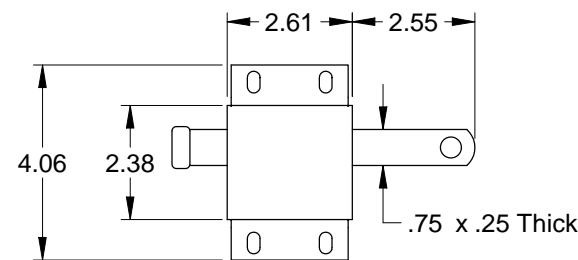

Slide Lock  
Case .086 Galv. Steel

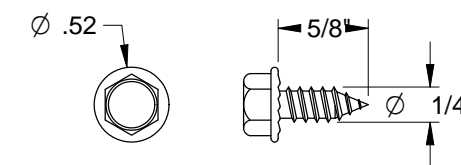

Sheet Metal Screw

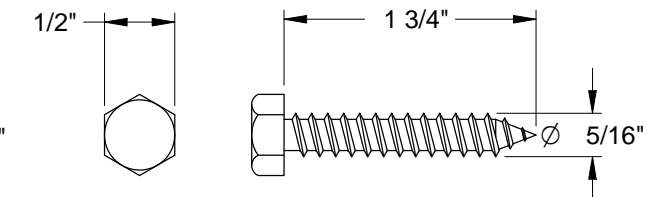

Hex Head Lag Screw

Scale: None	<p>1101 East River Road Dixon, IL 61021</p>	Title: Spec, Wind Load BuildMark / TradeMark	
Drawn by: R. Frey		No. P-2803	Sheet 3
Checked by: G. Wedekind			Rev B
Date: 01/08/19			
ECO: 7679.01			