

INTERIOR ELEVATION

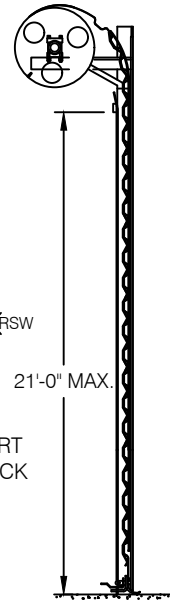

SIDE ELEVATION

STEEL JAMB

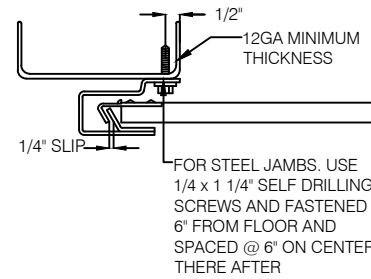

CMU POURED BLOCK JAMB

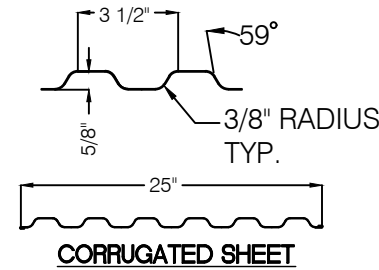
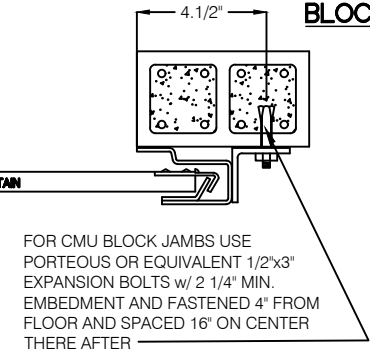

CONCRETE JAMB

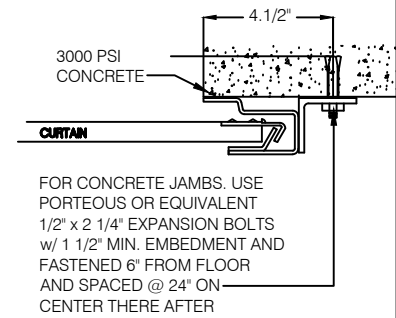

ONE LOCK LOCATED AT EACH END OF CURTAIN.

John E. Scates, P.E.
2560 King Arthur Blvd, Ste 124-54
Lewisville, TX 75056
FL PE 51737
TX PE 56308 / F2203

Professional Engineer's seal provided only for verification of windload construction details.

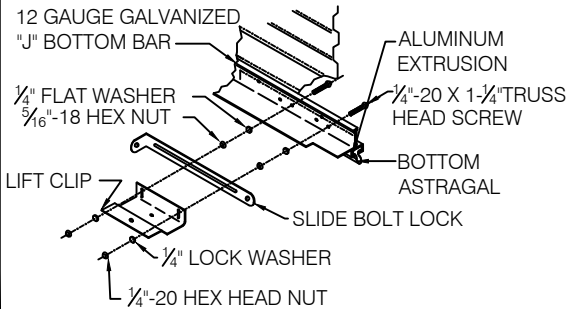

SLIDE BOLT LOCK AND BOTTOM BAR

ASTAAMERICA
BY JANUS INTERNATIONAL

638 Cassville White Rd NW
Cartersville, GA 30121
PH: (770) 974-2600
Fax: (770) 974-1455
www.astaamerica.com

MODEL 203 WINDLOAD RATED WINDLOCK COMMERCIAL SHEET DOOR

SEAL				
SCALE : VARIES (DO NOT SCALE DRAWINGS)				
TOLERANCES		TEST SIZE 14'-0"W x 10'H	12GA + CONCRETE DESIGN PRESSURE +35.0 / -35.0	
FRACTION = +/- 1/32				FILLED CMU DESIGN PRESSURE +27.0 / -30.0
.X = +/- .032				
.XX = +/- .015				
.XXX = +/- .005 < +/- 5		MODELS 203 204		
DRAWN BY: SR ISSUE: 4-6-21		DRAWING # 203-TDI		
		SHEET 1 OF 2		

GENERAL NOTES:

1. STEEL FOR CORRUGATED SHEET ASTM-A653 WITH MINIMUM YIELD STRENGTH OF 80 KSI AND TENSILE STRENGTH OF 82 KSI. (GRADE 80).
2. GUIDES AND GUIDE INSERT FORMED (12) GAUGE GALVANIZED STEEL.
3. COMPLIES WITH IBC/IRC 2018.
4. (10) GAUGE GALVANIZED STEEL WINDLOCK CLIP FASTENED WITH TWO 3/16" x .440" POP RIVETS ON FOUR CORRUGATIONS PER SIDE OF EACH SHEET.
5. THIS DOOR HAS BEEN DESIGNED AND TESTED IN ACCORDANCE WITH THE FLORIDA BUILDING CODE AND THE INTERNATIONAL BUILDING CODE. THE DESIGN WIND PRESSURES REQUIRED FOR ANY DOOR SHALL BE DETERMINED USING THE APPROPRIATE SECTION OF THE CODE HAVING JURISDICTION WHERE THE BUILDING IS LOCATED.
6. THIS DOOR HAS BEEN SUCCESSFULLY TESTED TO:THE UNIFORM STATIC AIR PRESSURE TEST PER ASTM E-330 AND ANSI/DASMA 108. DESIGN PRESSURE OF +35.0 / -35.0 PSF FOR 12GA STEEL AND CONCRETE JAMBS AND +27.0 PSF / -30.0 PSF FOR FILLED CMU.
7. ALL FASTENERS SHALL BE GALVANIZED OR ZINC COATED WITH A MINIMUM TENSILE STRENGTH OF 60 KSI.

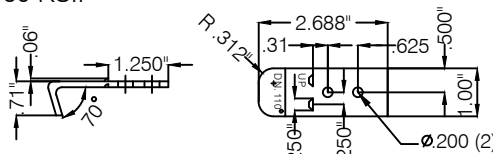

WINDLOCK CLIP
(SEE NOTE #4)

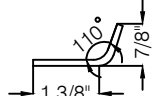

GUIDE INSERT
(SEE NOTE #2)

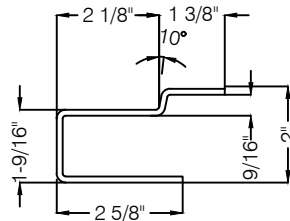

SEE NOTE #2

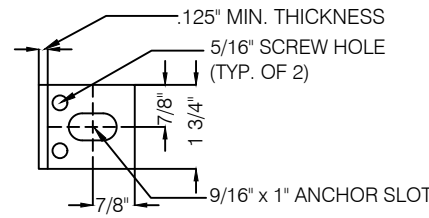

HEAVY DUTY GUIDE CLIP

SUPERIMPOSED LOAD DIAGRAM

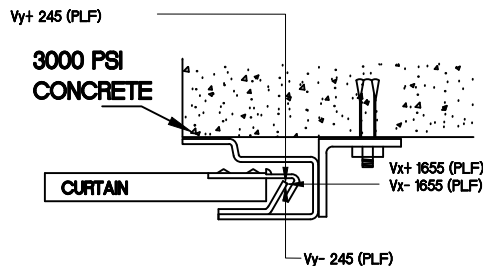

RH GUIDE MOUNT SHOWN

John E. Scates, P.E.
2560 King Arthur Blvd, Ste
124-54
Lewisville, TX 75056
FL PE 51737
TX PE 56308 / F2203

Professional Engineer's seal
provided only for verification
of windload construction
details.

Extrapolated Design Pressures (PSF)

Opening Width	12GA Steel & Concrete	Filled CMU
8'	+61.2/-61.2	+47.2/-52.5
9'	+54.4/-54.4	+42.0/-46.6
10'	+49.0/-49.0	+37.8/-42.0
11'	+44.5/-44.5	+34.3/-38.2
12'	+40.8/-40.8	+31.5/-35.0
13'	+37.7/-37.7	+29/-32.3
14'	+35.0/-35.0	+27.0/-30.0
15'	+31.2/-31.2	+24.0/-26.7
16'	+28.1/-28.1	+21.6/-24.0
17'	+25.4/-25.4	+19.5/-21.7
18'	+23.2/-23.2	+17.8/-19.8
19'	+21.3/-21.3	+16.3/-18.1
20'	+19.6/-19.6	+15.0/-16.7

ASTAAMERICA
BY JANUS INTERNATIONAL

638 Cassville White Rd NW
Cartersville, GA 30121
PH: (770) 974-2600
Fax: (770) 974-1455
www.astaamerica.com

MODEL 203 WINDLOAD RATED WINDLOCK COMMERCIAL SHEET DOOR

SEAL

SCALE : VARIES (DO NOT SCALE DRAWINGS)

TOLERANCES

FRACTION = +/- 1/32

.X = +/- .032

.XX = +/- .015

.XXX = +/- .005 < =/- 5

TEST SIZE
14'-0"W x 10'H

12GA + CONCRETE
DESIGN PRESSURE
+35.0 / -35.0

FILLED CMU
DESIGN PRESSURE
+27.0 / -30.0

MODELS

203

204

DRAWN BY: SR ISSUE: 4-6-21

DRAWING # 203-TDI

SHEET 2 OF 2