

CLOPAY MODEL 902
IDEAL MODEL C2AL

THIS PRODUCT COMPLIES
WITH THE 2018 IBC/IRC.

UP TO 22'-2" WIDE X 18'-0" HIGH

REVISIONS					
REV. NO.	ZONE:	DATE:	ECN NO.	APPVD:	DESCRIPTION
05	-	06/2013	-	-	REMOVED ACRYLIC GLAZING OPTION.
06	-	08/2016	-	-	REMOVED WIND SPEED TABLE.
07	-	02/2022	-	-	REVISED FOR TDI.

THE OPTIONAL GLAZING SHOWN ON THIS DRAWING MEETS THE WIND LOAD REQUIREMENTS OF THE FLORIDA BUILDING CODE OR INTERNATIONAL BUILDING CODE BUT DOES NOT MEET THE IMPACT RESISTANT REQUIREMENT FOR WINDBORNE DEBRIS REGIONS (REF. CHAPTER 16 FBC/IBC)

ALUMINUM FULL VISION WINDOW LITES, SINGLE PANE OR INSULATED. ALL PANES ANNEALED GLASS OR STRONGER. SINGLE PANES 1/8" OR THICKER. INSULATED WINDOWS 1/2" THICK, CONSISTING OF (2) PANES 1/8" THICK. MAXIMUM DLO 33" X 21-3/4".

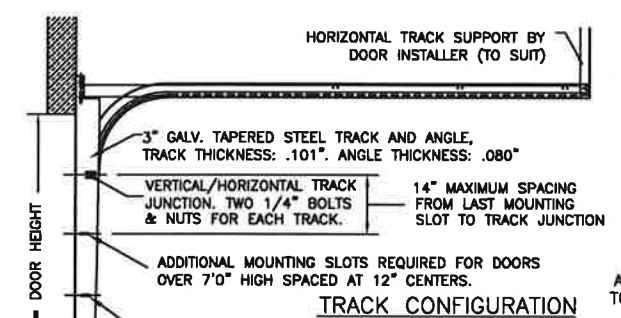

DOOR HEIGHT	"L"
8'-0"	88"
9'-0"	100"
10'-0"	112"
12'-0"	136"
14'-0"	160"
15'-0"	172"
16'-0"	184"
17'-0"	196"
18'-0"	208"

DOOR HEIGHT 'A'	NUMBER OF SECTIONS
UP TO 8'-0"	4
8'-3" THRU 10'-0"	5
10'-3" THRU 12'-0"	6
12'-3" THRU 14'-0"	7
14'-3" THRU 16'-0"	8
16'-3" THRU 18'-0"	9

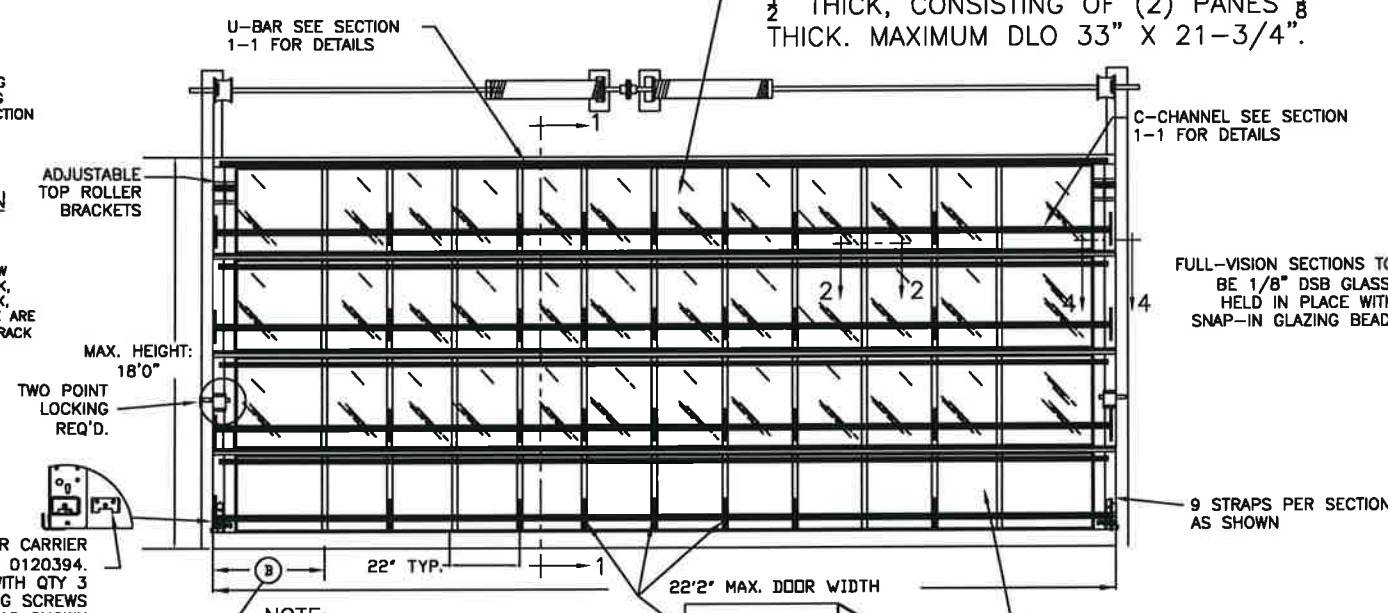

SECTION 1-1

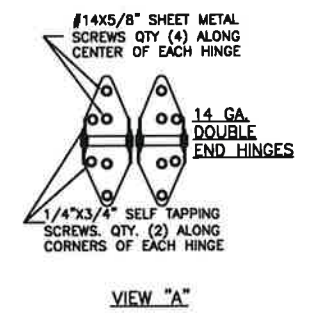
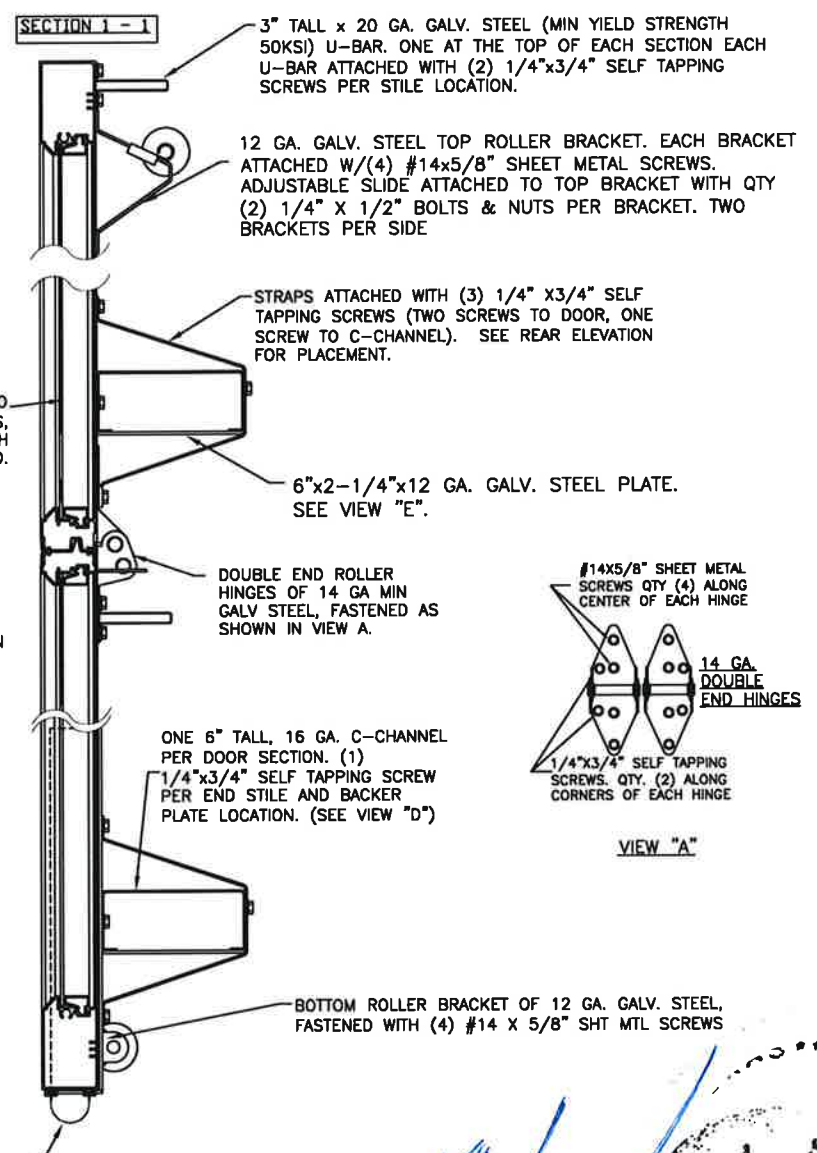

DOOR IS MADE OF 6063-T5 ALUMINUM EXTRUSIONS.

6" WALL THICKNESS:	
TOP & BOTTOM RAILS	.075
INTER. TOP & BOTTOM RAILS	.075
TOP HAS 2" x 1/4" 8.875" FIN	
INTER. TOP RAIL CAP	.040
SINGLE & DOUBLE END STILES	.075
1" CENTER STILES	.062
6" TALL C-CHANNEL	
16 GA. GALV. STEEL	
MIN YIELD STRENGTH 50KSI	

D
C
B
A

D
C
B
A

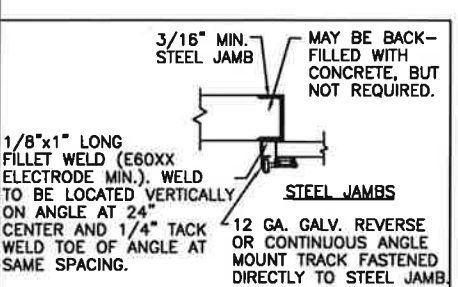

CENTER STILES FASTENED TO RAILS WITH FULL LENGTH 5/16" STEEL RODS AND FLANGE NUTS

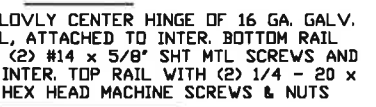

END STILES FASTENED TO RAILS WITH FULL LENGTH 5/16" STEEL RODS AND FLANGE NUTS

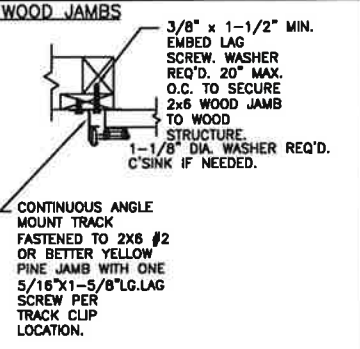
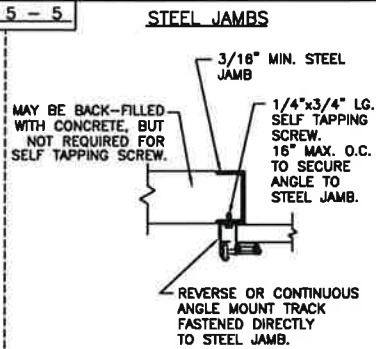
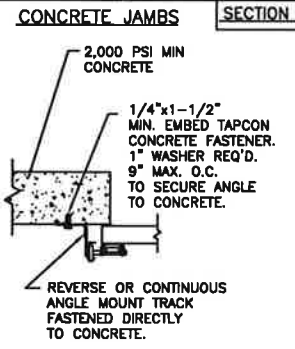
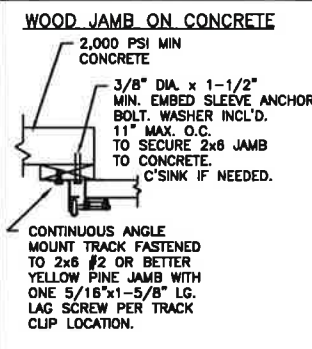
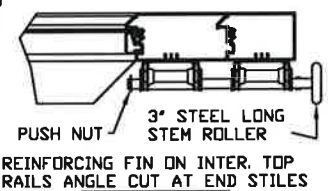

THE DESIGN OF THE SUPPORTING STRUCTURAL ELEMENTS IS THE RESPONSIBILITY OF THE BUILDING ENGINEER OR ARCHITECT OF RECORD.

DESIGN ENGINEER: MARK WESTERFIELD, P.E.
FLORIDA P.E. #48495, NC P.E. #23832, TEXAS P.E. #91513
DESIGN LOADS: +30 & -30 P.S.F.
TEST LOADS: +45 & -45 P.S.F.



Unless Stated Otherwise TOLERANCES are

.0	= ±.031
.00	= ±.015
.000	= ±.005
.0000	= ±.001
Degrees	= ±1/2°

Clopay CORPORATION
8585 Duke Boulevard
Mason, OH 45040 USA
Tel. No. 513-770-4800
Fax No. 513-770-4853

MANUFACTURING PRODUCT CODE:
MPC: C-AL-1F499

CLOPAY WINDLOAD RATING
W5

DESCRIPTION: M/N 902, C2AL, 22'2" WIDE DES. +30/-30 PSF	DRAWN BY: BFA	DATE: 11/12/04	SCALE: NONE	DWG. SIZE: B
CHECKED BY: -	DATE: -	SHEET 1 OF 1	VER: TDI	

CLOPAY CORP.
ALL RIGHTS RESERVED.



Unless Stated Otherwise DIMENSIONS ARE IN INCHES.