

NOTE: DOUBLE TRACK LOW HEADROOM, HI-LIFT TRACK, FOLLOW-THE-ROOF TRACK, AND VERTICAL LIFT TRACK ARE AVAILABLE OPTIONS. 3" TRACK ALSO AVAILABLE.

MAX 12'-2" WIDE X 18'-0" HIGH

MODELS AVAILABLE (CLOPAY/ HOLMES/ IDEAL)

MODELS 524, 520/ 224/ C4ST, C0ST

INSULATED MODELS 524S, 520S, 524V/ 224S/ C4SS, C0SS, C4SV

HORIZONTAL TRACK END HANGER BRACKET (SUPPLIED BY DOOR INSTALLER) CLOSES ROLLER CHANNEL. INTERMEDIATE HANGER REQUIRED FOR DOORS IF HORIZONTAL TRACK DEFLECTION EXCEEDS 1/240TH OF THE DOOR HEIGHT

THIS PRODUCT COMPLIES WITH THE 2018 IBC/IRC.

THE OPTIONAL GLAZING SHOWN ON THIS DRAWING MEETS THE WIND LOAD REQUIREMENTS OF THE FLORIDA BUILDING CODE OR INTERNATIONAL BUILDING CODE BUT DOES NOT MEET THE IMPACT RESISTANT REQUIREMENT FOR WINDBORNE DEBRIS REGIONS (REF. CHAPTER 16 FBC/IBC)

DOOR HEIGHT 'A'	NUMBER OF SECTIONS
UP TO 8'-0"	4
8'-3" THRU 10'-0"	5
10'-3" THRU 12'-0"	6
12'-3" THRU 14'-0"	7
14'-3" THRU 16'-0"	8
16'-3" THRU 18'-0"	9

MAX. SECTION HEIGHT: 24"

REVISIONS					
REV. NO.	ZONE:	DATE:	ECN NO.	APPVD:	DESCRIPTION
09	-	10/2005	-	-	ADDED ROLLER OPTION.
10	-	11/2008	-	-	UPDATED JAMB ATTACHMENT; ADDED MPC.
11	-	02/2012	-	-	UPDATED WINDCODE CHART.
12	-	08/2012	-	-	REVISED FOR TDI.
13	-	06/2013	-	-	REMOVED ACRYLIC/WIRE GLAZING. SPECIFIED FV DIMENSIONS.
14	-	08/2016	-	-	REMOVED WIND SPEED TABLE.
15	-	02/2022	-	-	REVISED FOR TDI.

SECTIONS ARE 1-7/8" THK PANELS ROLL FORMED OF .022" MIN. HOT DIPPED GALVANIZING, ROLL FORMED STEEL.

OPTIONAL ALUMINUM FULL VISION WINDOW LITE SECTIONS AVAILABLE. SINGLE PANE OR INSULATED. ALL PANES ANNEALED GLASS OR STRONGER. SINGLE PANES 3/8" OR THICKER. INSULATED WINDOWS 1/2" THICK, CONSISTING OF (2) PANES 3/8" THICK. MAXIMUM DLO 47" X 21-3/4". FULL VISION SECTIONS TO HAVE 2" X 2" X 1/8" L-ANGLE HORIZONTAL REINFORCEMENT, ATTACHED TO THE REINFORCING RIB WITH (2) 1/4"-20 X 5/8" HEX HEAD BOLTS AND NUTS AT EVERY HINGE LOCATION.

3" x 20 GA. GALV. STEEL U-BAR. TWO U-BARS PER DOOR SECTION. U-BARS ATTACHED AT EACH STILE LOCATION WITH TWO 1/4" X 3/4" SELF TAPPING SCREWS.

OPTIONAL SINGLE PANE OR INSULATED WINDOW LITES. ALL PANES ANNEALED GLASS OR STRONGER. SINGLE PANES 1/8" OR THICKER. INSULATED WINDOWS 1/2" THICK, CONSISTING OF (2) PANES 1/8" THICK. FRAMES SECURED WITH QTY. (10) #8-11 CROSS RECESSED PAN HEAD, TYPE A TAPPING SCREW WITH (3) SCREWS ON EACH HORIZONTAL EDGE AND (2) ON EACH VERTICAL EDGE. SCREW LENGTH 1-1/2" FOR INSULATED DOORS AND 0.75" FOR UNINSULATED DOORS. MAXIMUM DLO 21-1/4" X 3-1/4".

TWO POINT LOCKING REQ'D

SECTION 1 - 1

BOTTOM SECTION REINFORCED WITH TEMPERED ALUMINUM EXTRUSION WITH INTEGRAL RETAINER FOR FLEXIBLE VINYL ASTRAGAL

DESIGN LOADS: +30 & -30 P.S.F.
TEST LOADS +45 & -45 P.S.F.

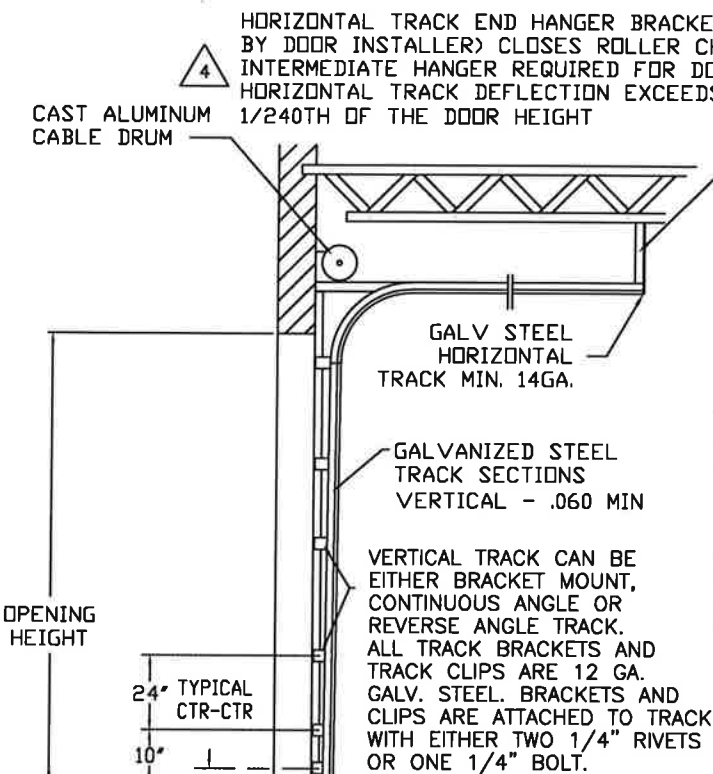

SIDE ELEVATION STANDARD-LIFT TRACK DETAILS

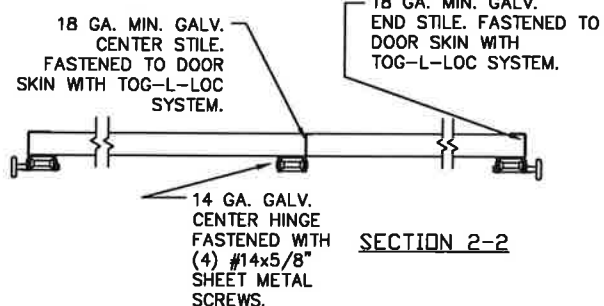

SECTION 2-2

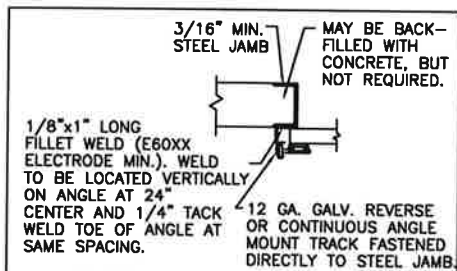
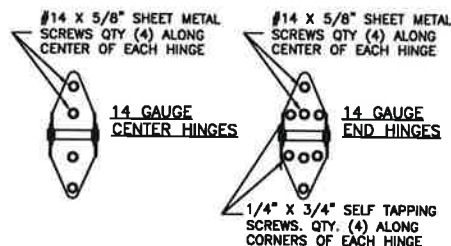

WELDED STEEL JAMBS

WOOD JAMB ON CONCRETE

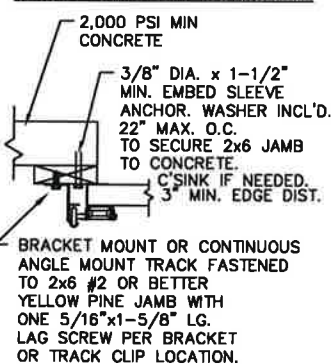

CONCRETE JAMBS

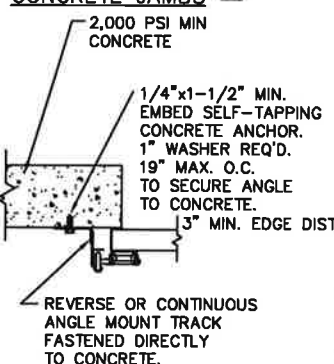

SELF-TAPPING SCREWS

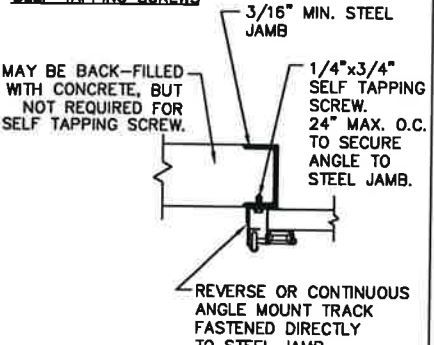

WOOD JAMBS

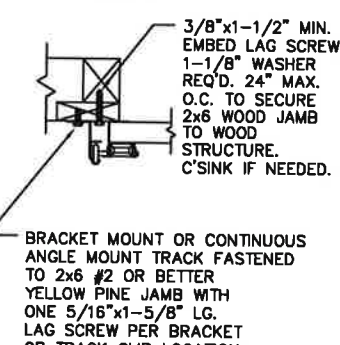

THE DESIGN OF THE SUPPORTING STRUCTURAL ELEMENTS IS THE RESPONSIBILITY OF THE BUILDING ENGINEER OR ARCHITECT OF RECORD.

MARK WESTERFIELD, P.E.
FLORIDA P.E. #48495, NC P.E. #23832,
TEXAS P.E. #91513

CLOPAY CORP.
ALL RIGHTS RESERVED.

Unless Stated Otherwise TOLERANCES are
.0 = ±.031
.00 = ±.015
.000 = ±.005
.0000 = ±.001
Degrees = ±1/2'

Clopay CORPORATION
8585 Lake Boulevard
Mason, OH 45040 USA
Tel. No. 513-770-4800
Fax No. 513-770-4853

DESCRIPTION: COMMERCIAL RIBBED DOOR, +/- 30 PSF DESIGN LOAD

DRAWN BY: RJM

DATE: 4/15/99

SCALE: NOTED

CHECKED BY: MWW

DATE: 4/99

SHEET 1 OF 1

DWG. NO.: 101869

VER: TDI

MANUFACTURING PRODUCT CODE:
MPC: C-PAN-1E448

WINDLOAD RATING
W5

DWG. SIZE B