



A SENNECA COMPANY

# HURRICANE SERIES FIBERGLASS DOUBLE DOOR OUTSWING "NON-IMPACT"

EVALUATED FOR USE IN THE STATE OF TEXAS

**DR-982**

The Fiberglass Door system described herein complies with the 2018 International Residential Code (IRC), Sections R301 & R609 and the 2018 International Building Code (IBC), Sections 1404.13, 1609, 1709.5, 2403 and 2404 subject to the following conditions:

1. Anchors shall be as listed and spaced as shown in the details. Anchor embedment to base material shall be beyond wall dressing or stucco.
2. When used in areas requiring wind-borne debris protection this product is required to be protected with an impact resistant covering that complies with Section R301.2.1.2 of the IRC and Section 1609.1.2 of the IBC.
3. Allowable design pressure requirements must be equal to or less than the design pressure rating shown in the design pressure chart, sheet 1 of this drawing.
4. Conditions not covered by this drawing are subject to further engineering analysis.

### TABLE OF CONTENTS

SHEET #	DESCRIPTION
1	Typical elevations, design pressures & general notes
2	Door panel details
3	Horizontal cross sections
4	Vertical cross sections
5	Frame anchoring & hardware details
6	Bill of materials & components

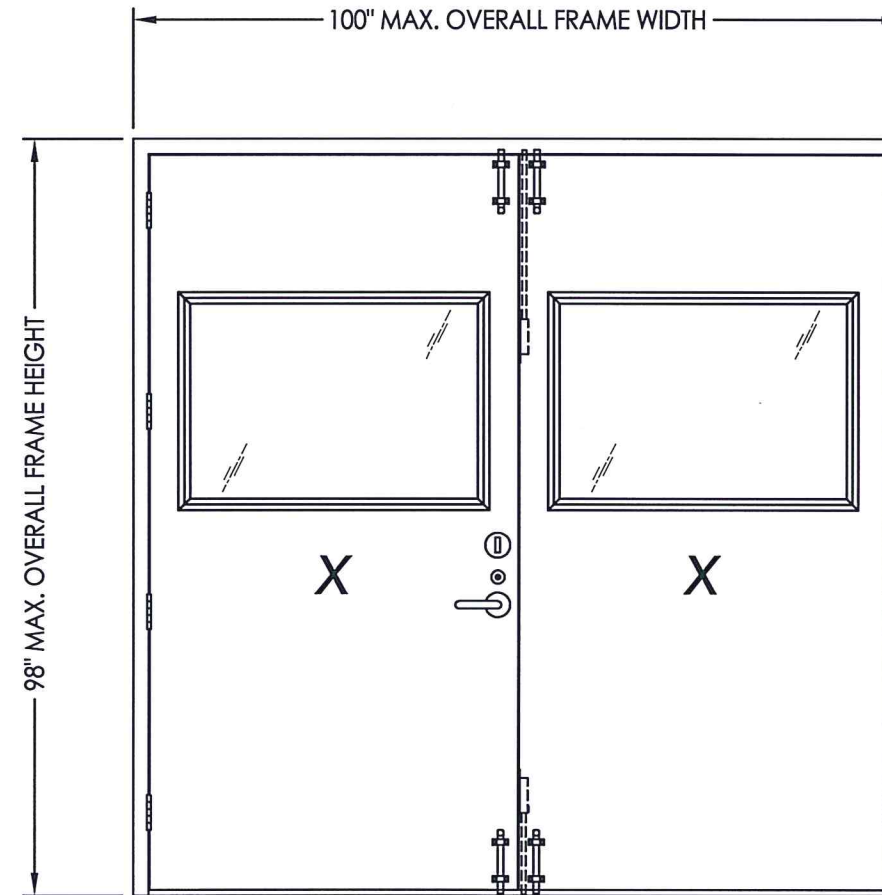

GLAZED PANELS SHOWN  
(OPAQUE SIMILAR)

MAX FRAME DIMENSION	DOOR TYPE	DESIGN PRESSURE (PSF) OUTSWING	
		POSITIVE	NEGATIVE
100" x 98"	OPAQUE	+90.0	-90.0
100" x 98"	GLAZED	+90.0	-90.0

SURFACE BOLTS REQUIRED @ TOP & BOTTOM OF EACH DOOR

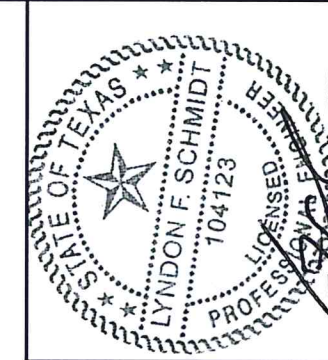

Documents Prepared By: Lyndon F. Schmidt, P.E.  
TEXAS P.E. #104123

**RW** BUILDING CONSULTANTS, INC.  
P.O. Box 230 Valrico FL 33595  
Phone No.: 813.659.9197

CERTIFICATE OF REGISTRATION # F-11852

PRODUCT:	FIBERGLASS DOOR
PART OR ASSEMBLY:	TYPICAL ELEVATION, DESIGN PRESSURES & GENERAL NOTES
DATE	1/19/22
NO.	1
BY	LFS
REVISIONS	UPDATE TO 2018 IBC/IRC
DATE	5/14/18
SCALE	N.T.S.
DWG. BY	JK
CHK. BY	LFS
DRAWING NO.:	TX-4846
SHEET	1 OF 6

Z:\Clients\Senneca\B - Texas Dept of Ins\Tiger Door\DR 982 Tiger Fiberglass Door - Non-Impact\Drawings\TX-4844.45.46 REV.dwg

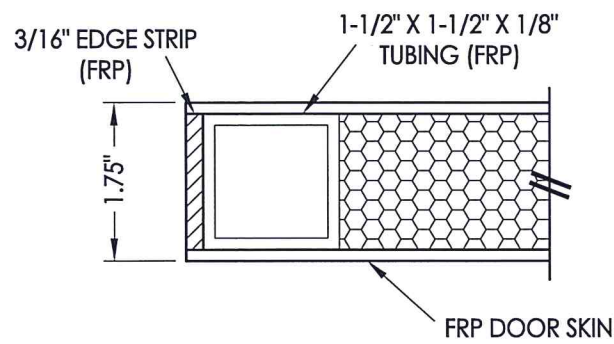

**1**  
**2** HORIZONTAL CROSS SECTION

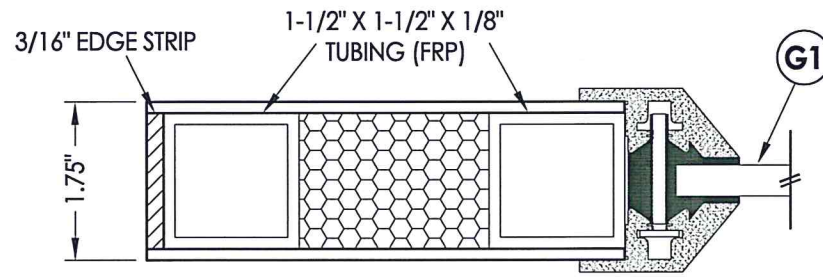

**2**  
**2** HORIZONTAL CROSS SECTION

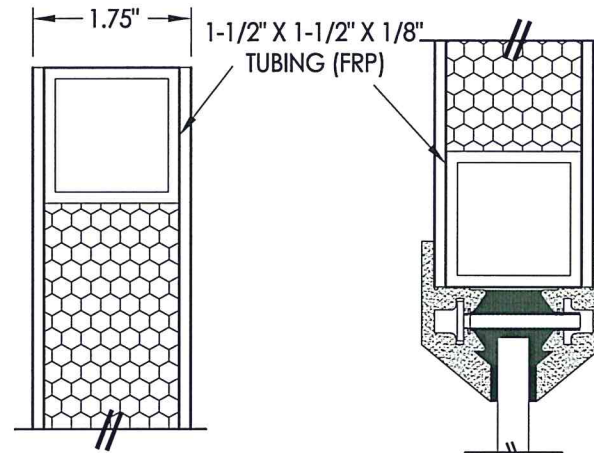

**3**  
**2** VERTICAL CROSS SECTION

EXTERIOR INTERIOR

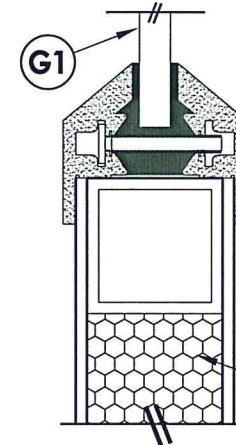

**5**  
**2** VERTICAL CROSS SECTION

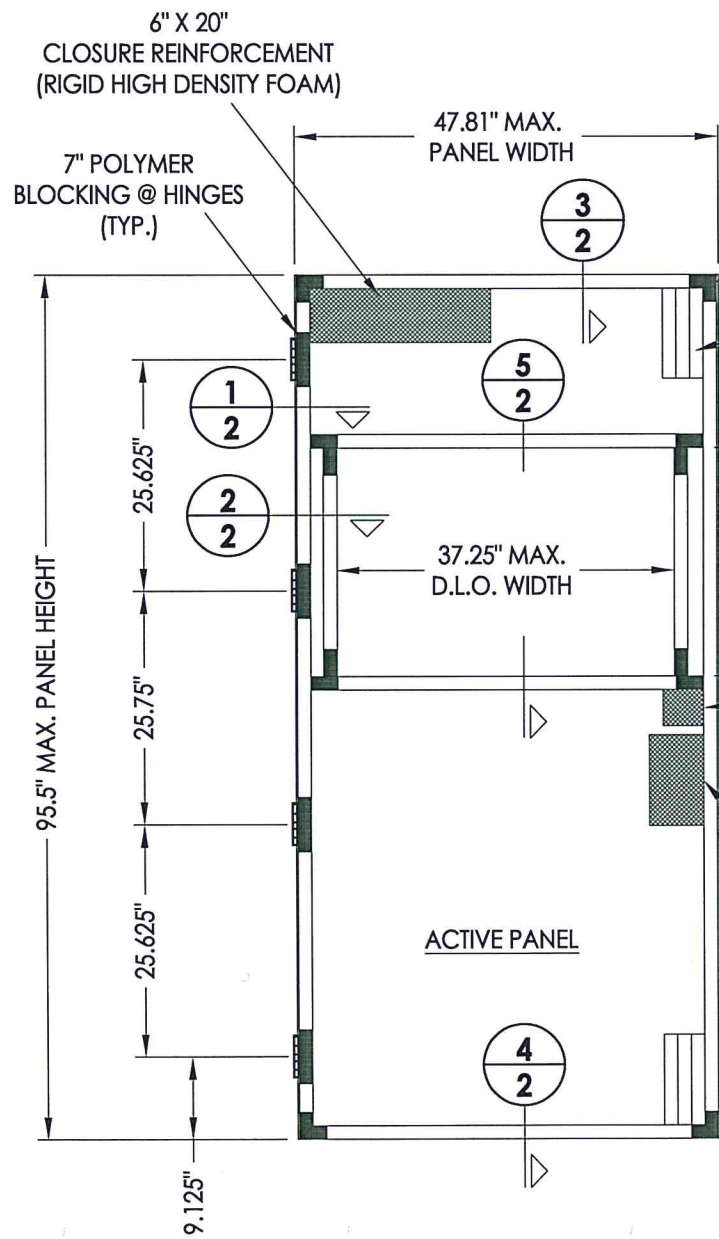

**40** FIBERGLASS DOOR PANELS  
TIGER DOOR

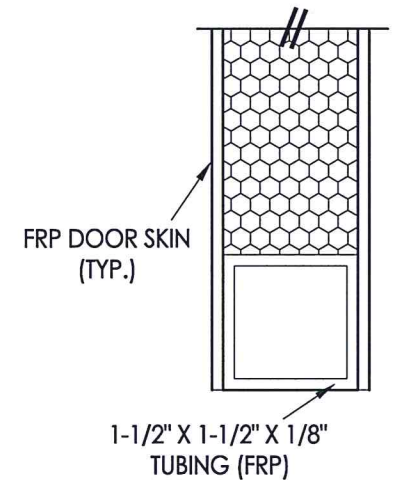
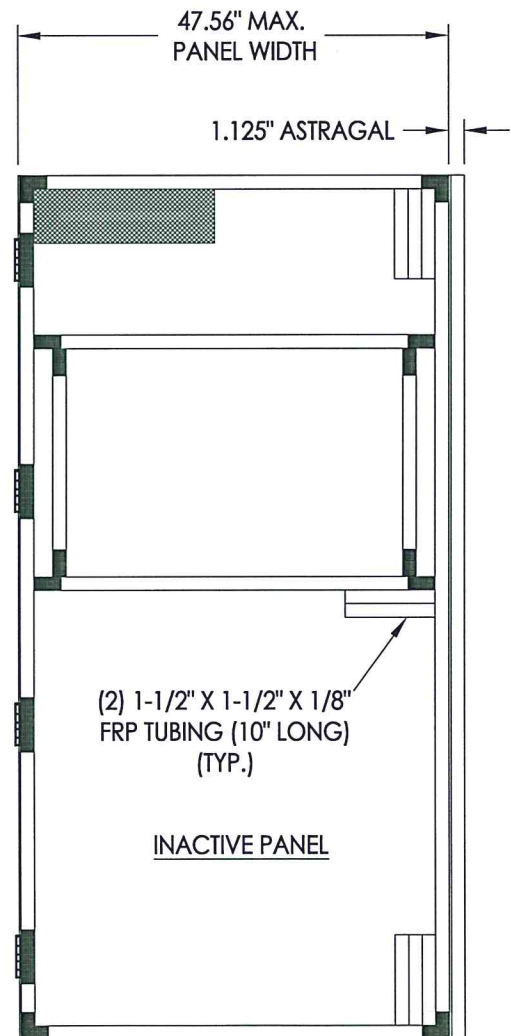

**4**  
**2** VERTICAL CROSS SECTION

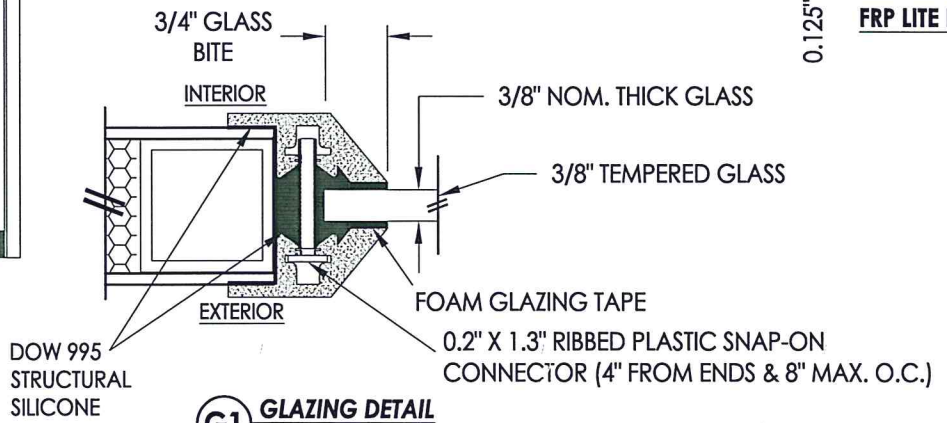
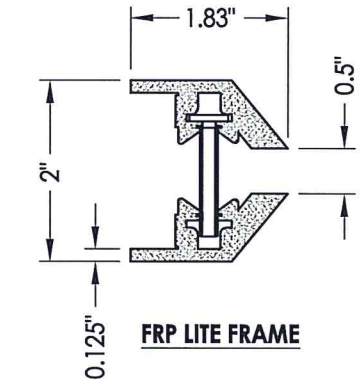

**G1** GLAZING DETAIL

DOOR SKIN: 0.125" MIN. THICKNESS  
DOOR CORE: POLYPROPYLENE HONEYCOMB



Documents Prepared By: Lyndon F. Schmidt, P.E.  
TEXAS P.E. #104123

**RW** BUILDING CONSULTANTS, INC.  
P.O. Box 230 Vairico FL 33595  
Phone No.: 813.659.9197

CERTIFICATE OF REGISTRATION # F-11852

PRODUCT:		FIBERGLASS DOOR	
PART OR ASSEMBLY:		DOOR PANEL DETAILS	
NO.	DATE	BY	REVISIONS
1	1/19/22	LFS	UPDATE TO 2018 IBC/IRC
DATE: 5/14/18		SCALE: N.T.S.	
DWG. BY: JK		CHK. BY: LFS	
DRAWING NO.: TX-4846		SHEET 2 OF 6	

© 2018 R.W. BUILDING CONSULTANTS INC.

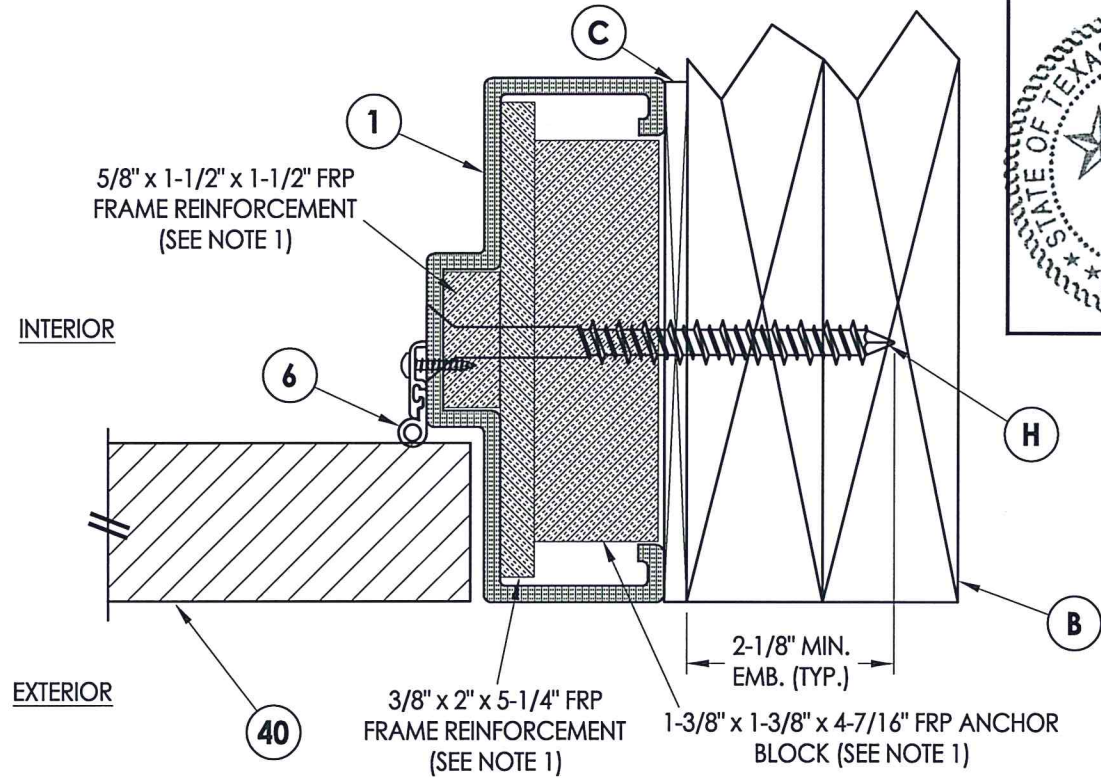
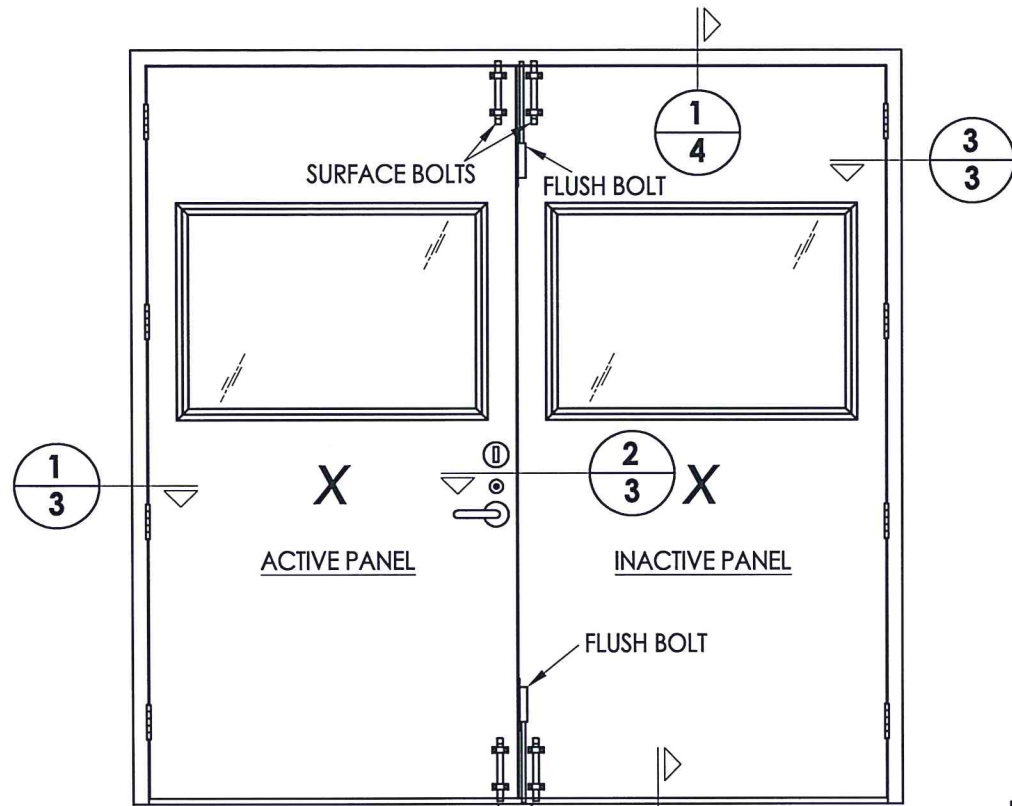

Documents Prepared By: Lyndon F. Schmidt, P.E.  
TEXAS P.E. #104123

**RW** BUILDING CONSULTANTS, INC.  
P.O. Box 230 Valrico FL, 33595  
Phone No.: 813.659.9197

CERTIFICATE OF REGISTRATION # F-11852

HARDWARE CHART	
MANUFACTURER	MODEL
SCHLAGE	MORTISE LOCK: L 9000 SERIES
SARGENT	DEADBOLT: 480 SERIES
ROCKWOOD	SURFACE BOLTS: 580-8
ROCKWOOD	FLUSH BOLTS: 556WS

**3 HORIZONTAL CROSS SECTION**  
3 Outswing configuration

- NOTES:
1. ALL FRP REINFORCEMENTS/ANCHOR BLOCKS ARE SECURED TO THE FRAME WITH LORD 7542A/B URETHANE ADHESIVE.
  2. FRAME REINFORCEMENTS SHOWN IN SECTION 3/3 ARE REQUIRED AT EACH ANCHOR LOCATION.
  3. FRP ASTRAGAL IS SECURED TO THE INACTIVE DOOR WITH LORD 7542/7545 URETHANE ADHESIVE.

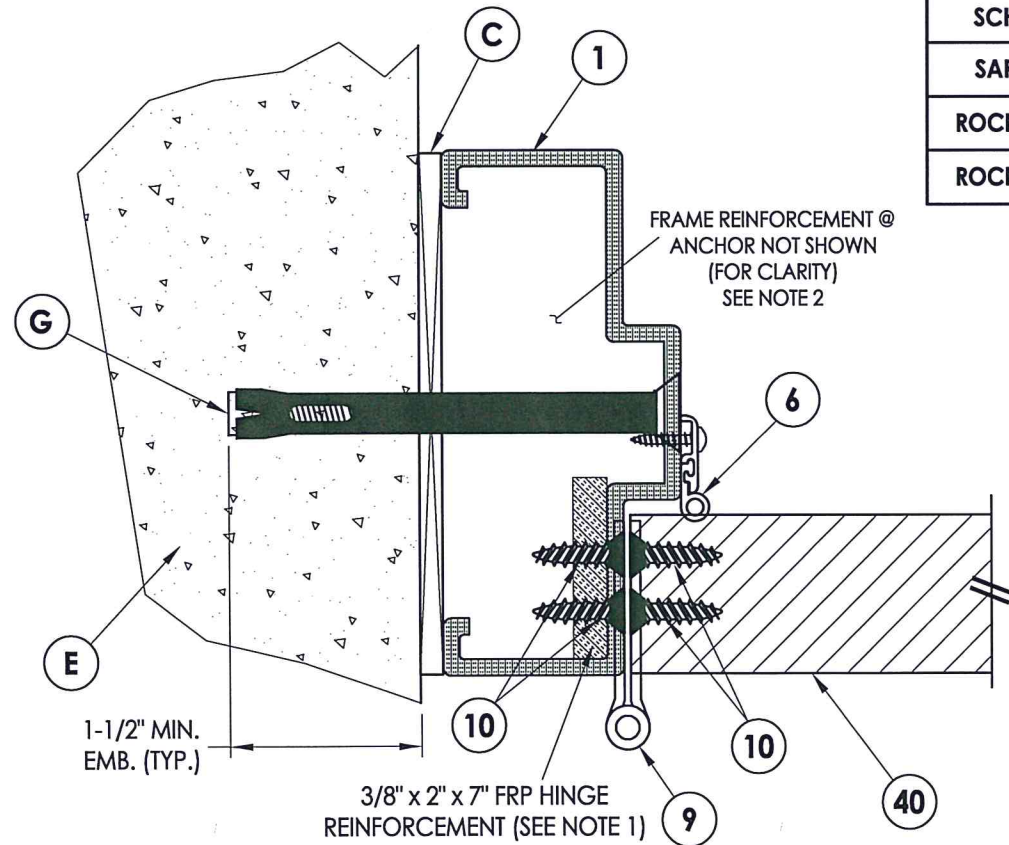

**1 HORIZONTAL CROSS SECTION**  
3 Outswing configuration

INTERIOR

EXTERIOR

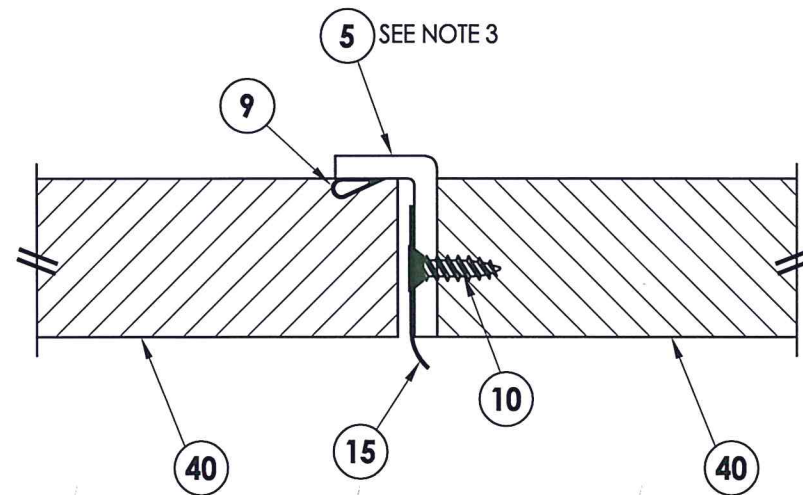

**2 HORIZONTAL CROSS SECTION**  
3 Outswing configuration

PRODUCT: FIBERGLASS DOOR

PART OR ASSEMBLY: HORIZONTAL CROSS SECTIONS

NO.	DATE	BY	REVISIONS
1	1/19/22	LFS	UPDATE TO 2018 IBC/IRC

DATE: 5/14/18  
SCALE: N.T.S.  
DWG. BY: JK  
CHK. BY: LFS  
DRAWING NO.: TX-4846  
SHEET 3 OF 6

NOTES:  
 1. ALL FRP REINFORCEMENTS/ANCHOR BLOCKS ARE SECURED TO THE FRAME WITH LORD 7542A/B URETHANE ADHESIVE.

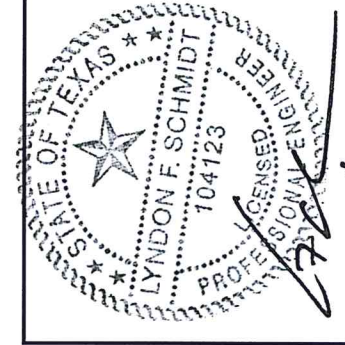

Documents Prepared By: Lyndon F. Schmidt, P.E.  
 TEXAS P.E. #104123

**RW** BUILDING CONSULTANTS, INC.  
 P.O. Box 230 Valrico FL 33595  
 Phone No.: 813.659.9197

CERTIFICATE OF REGISTRATION # F-11852

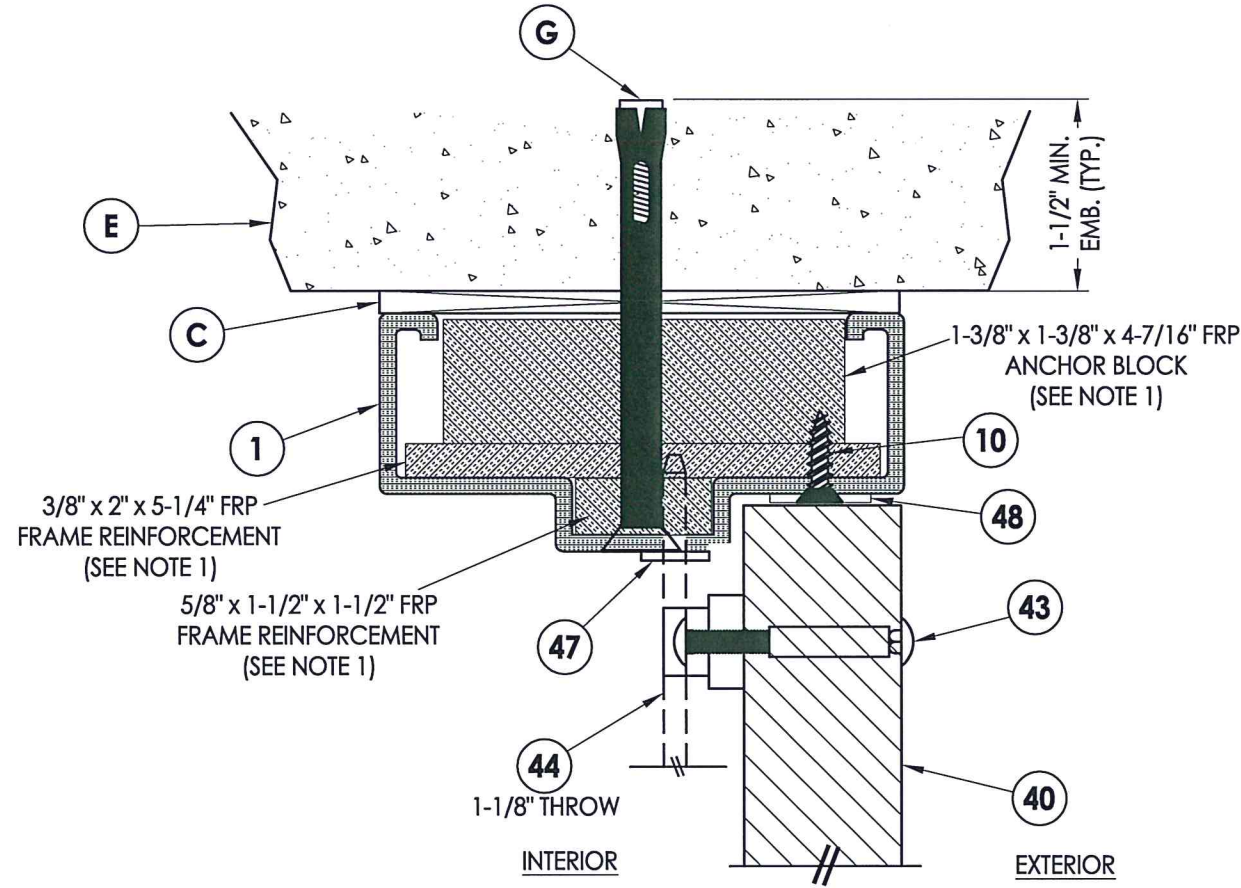

**1** VERTICAL CROSS SECTION  
**4** Outswing configuration

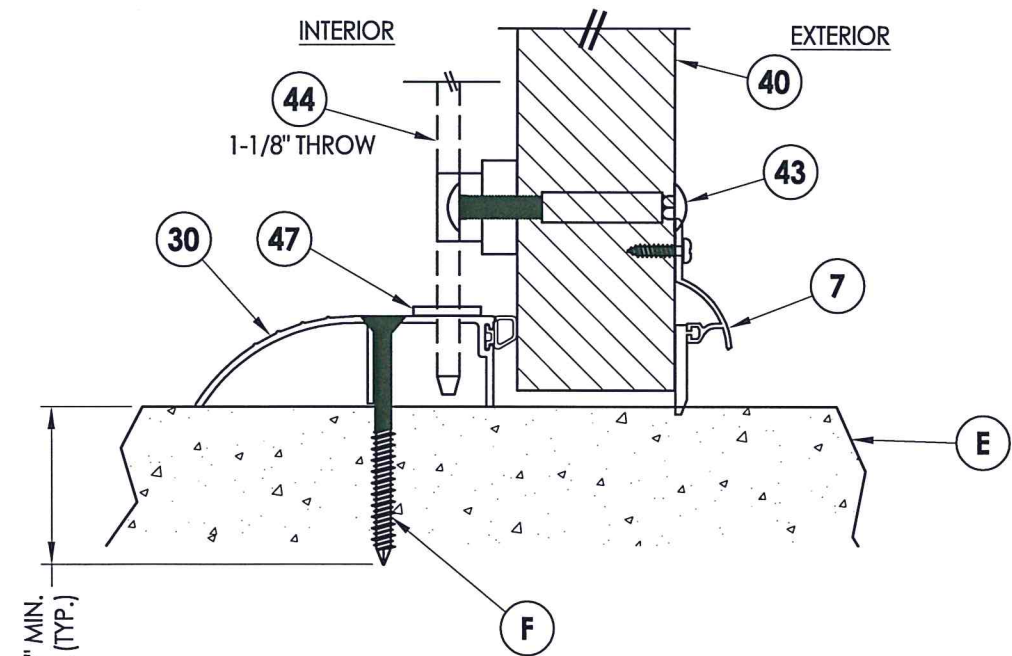

**2** VERTICAL CROSS SECTION  
**4** Outswing Sill

PRODUCT:	FIBERGLASS DOOR	
PART OR ASSEMBLY:	HORIZONTAL CROSS SECTIONS	
NO.	DATE	BY
1	1/19/22	IBC/IRC
REVISIONS		
DATE:	5/14/18	
SCALE:	N.T.S.	
DWG. BY:	JK	
CHK. BY:	LFS	
DRAWING NO.:	TX-4846	
SHEET	4	OF 6

Z:\Clients\Senneca\B - Texas Dept of Ins\Tiger Door\DR 982 Tiger Fiberglass Door - Non-Impact\Drawings\TX-4844.45.46 REV.dwg

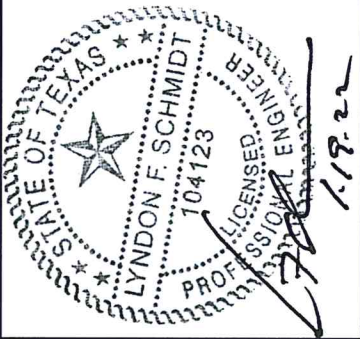
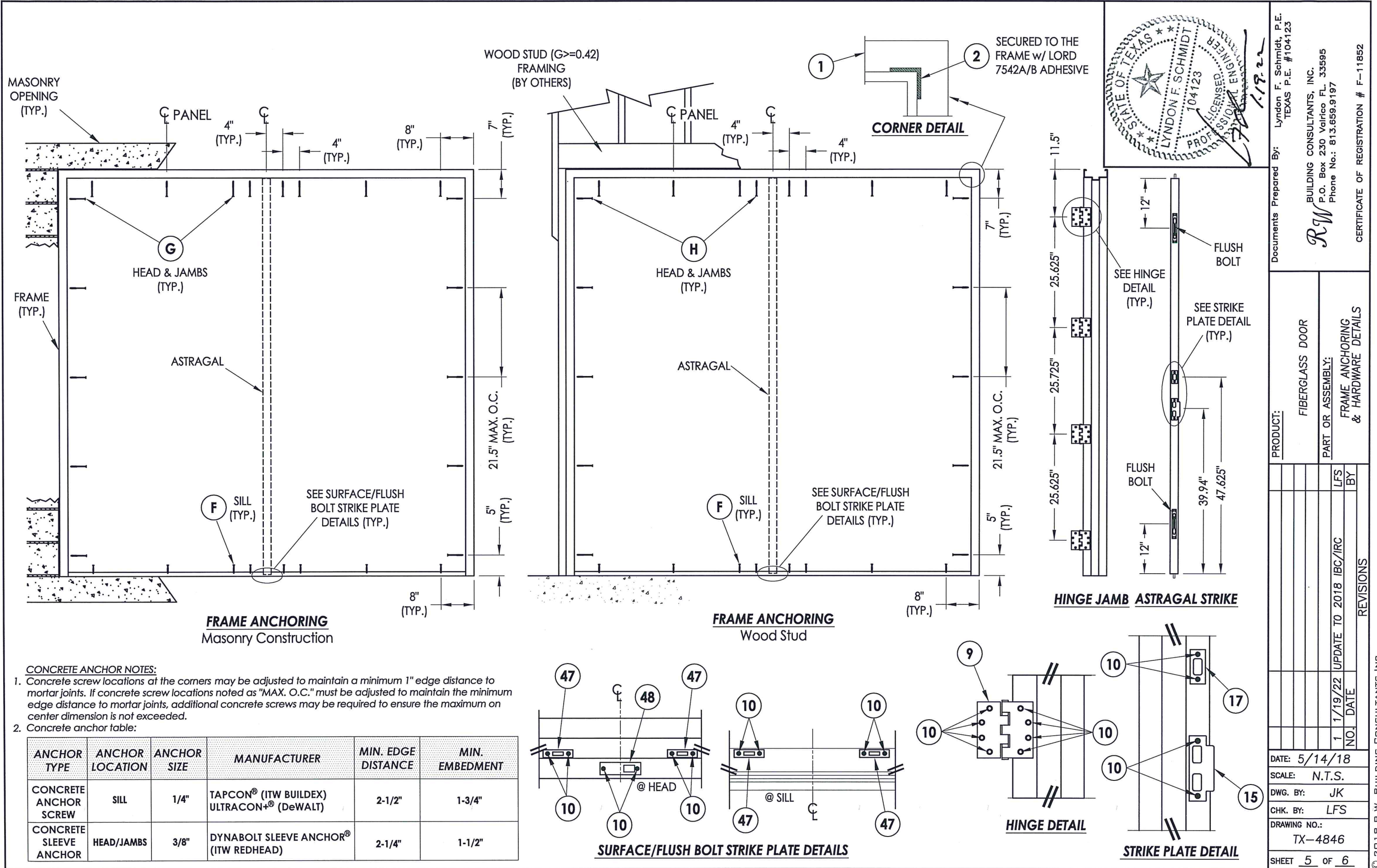

Documents Prepared By: Lyndon F. Schmidt, P.E.  
 TEXAS P.E. #104123

RW BUILDING CONSULTANTS, INC.  
 P.O. Box 230 Valrico FL 33595  
 Phone No.: 813.659.9197

CERTIFICATE OF REGISTRATION # F-11852

PRODUCT: FIBERGLASS DOOR

PART OR ASSEMBLY: FRAME ANCHORING & HARDWARE DETAILS

NO.	DATE	REVISIONS
1	1/19/22	UPDATE TO 2018 IBC/IRC
LFS		BY

DATE: 5/14/18

SCALE: N.T.S.

DWG. BY: JK

CHK. BY: LFS

DRAWING NO.: TX-4846

SHEET 5 OF 6

© 2018 R.W. BUILDING CONSULTANTS INC.

**BILL OF MATERIALS**

ITEM #	DESCRIPTION	MATERIAL
C	1/4" MAX. SHIM SPACE	-
E	MASONRY - 3,000 PSI MIN. CONCRETE CONFORMING TO ACI 301 OR HOLLOW BLOCK (GROUT FILLED) CONFORMING TO ASTM C90	CONCRETE
F	1/4" x 2-3/4" PFH DeWALT OR ITW CONCRETE SCREW	STEEL
G	3/8"Ø DYNABOLT SLEEVE ANCHOR	STEEL
H	3/8"Ø x 5" LAG SCREW	STEEL
1	DOOR FRAME (FRP)	FIBERGLASS
2	FRAME CORNER REINFORCEMENT (FRP)	FIBERGLASS
3	REMOVABLE MULLION (FRP)	FIBERGLASS
5	ASTRAGAL	FIBERGLASS
6	WEATHERSTRIP	NEOPRENE
7	DOOR SWEEP	VINYL
8	WEATHERSTRIP (NGP 5050 GASKET)	NEOPRENE
9	4-1/2" X 4-1/2" BUTT HINGE	SS
10	#12 X 1" PFH SMS	SS
15	MORTISE LATCH & DEADBOLT STRIKE PLATE	SS
16	LATCH STRIKE PLATE	SS
17	DEADBOLT STRIKE PLATE	STEEL
30	OUTSWING THRESHOLD	ALUM
40	DOOR PANEL - SEE DOOR PANEL DETAIL SHEET FOR CONSTRUCTION DETAILS	-
43	8-32 X 1" MACHINE SCREW w/ 1-3/4" SEX BOLT	STEEL
44	SURFACE BOLT - ROCKWOOD 580-8	SS
47	SURFACE BOLT STRIKE PLATE	SS
48	FLUSH BOLT STRIKE PLATE	SS

FIBER REINFORCED PLASTIC (FRP)

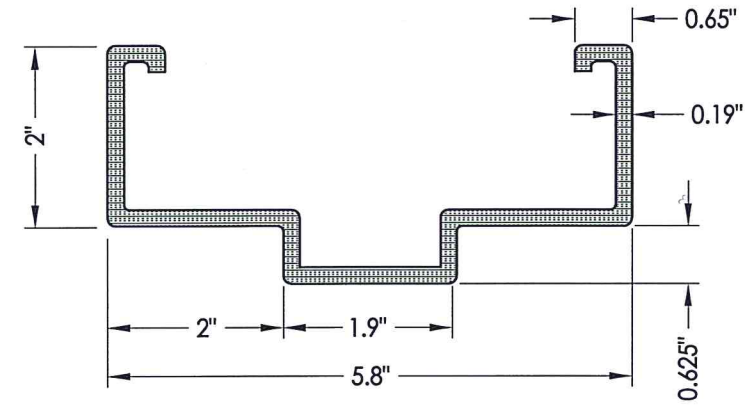

1 DOOR FRAME (FRP)

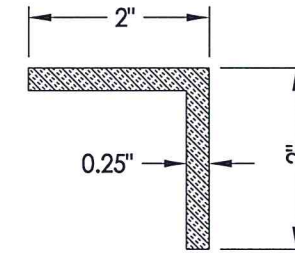

2 FRAME CORNER REINFORCEMENT 5" LONG

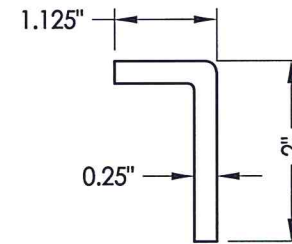

3 ASTRAGAL (FRP)

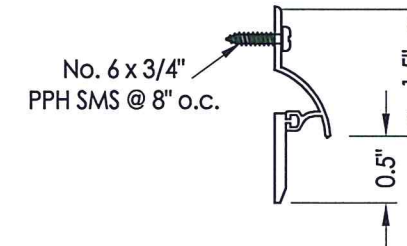

7 DOOR SWEEP NGP 101 VA

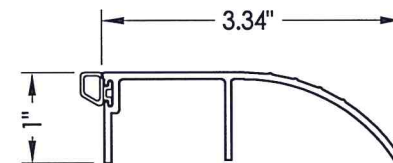

30 OUTSWING THRESHOLD Pemko 2051-T

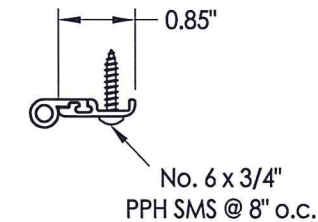

6 WEATHERSTRIP NGP 137N

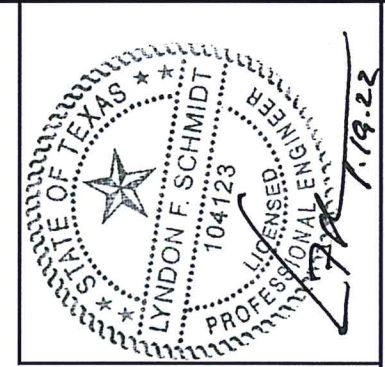

Documents Prepared By: Lyndon F. Schmidt, P.E.  
TEXAS P.E. #104123

**RW** BUILDING CONSULTANTS, INC.  
P.O. Box 230 Valrico FL 33595  
Phone No.: 813.659.9197

CERTIFICATE OF REGISTRATION # F-11852

PRODUCT:	FIBERGLASS DOOR	
PART OR ASSEMBLY:	BILL OF MATERIALS & COMPONENTS	
NO.	DATE	BY
1	1/19/22	LFS
UPDATE TO 2018 IBC/IRC		
REVISIONS		
DATE:	05/14/18	
SCALE:	N.T.S.	
DWG. BY:	JK	
CHK. BY:	LFS	
DRAWING NO.:	TX-4846	
SHEET	6 OF 6	