

THERMA-TRU® DOORS

Fiber-Classic® & Smooth-Star®

COMPOSITE EDGE OPAQUE FIBERGLASS SINGLE DOOR IN SWING / OUT SWING "NON-IMPACT"

EVALUATED FOR USE IN THE STATE OF TEXAS

TDI DR-947

The Fiberglass Door system described herein complies with the 2018 International Residential Code (IRC), Sections R301 & R609 and the 2018 International Building Code (IBC), Sections 1404.13, 1609, 1709.5, 2403 and 2404 subject to the following conditions:

1. Anchors shall be as listed and spaced as shown in the details. Anchor embedment to base material shall be beyond wall dressing or stucco.
2. When used in areas requiring wind-borne debris protection this product is required to be protected with an impact resistant covering that complies with Section R301.2.1.2 of the IRC and Section 1609.1.2 of the IBC.
3. Allowable design pressure requirements must be equal to or less than the design pressure rating shown in the design pressure chart, sheet 1 of this drawing.
4. Conditions not covered by this drawing are subject to further engineering analysis.
5. Fiber-Classic and Smooth-Star Door and Sidelite panels require the use of "J" part numbers. These door and sidelite panels must be stained or painted within six months of installation.

TABLE OF CONTENTS	
SHEET #	DESCRIPTION
1	Typical Elevations, Design Pressures & General Notes
2	Door Panel Details
3	Elevations
4	Horizontal & Vertical Cross Sections
5	Vertical Cross Sections (Thresholds)
6	Frame Anchoring & Hardware Details
7	Components
8	Bill of Materials

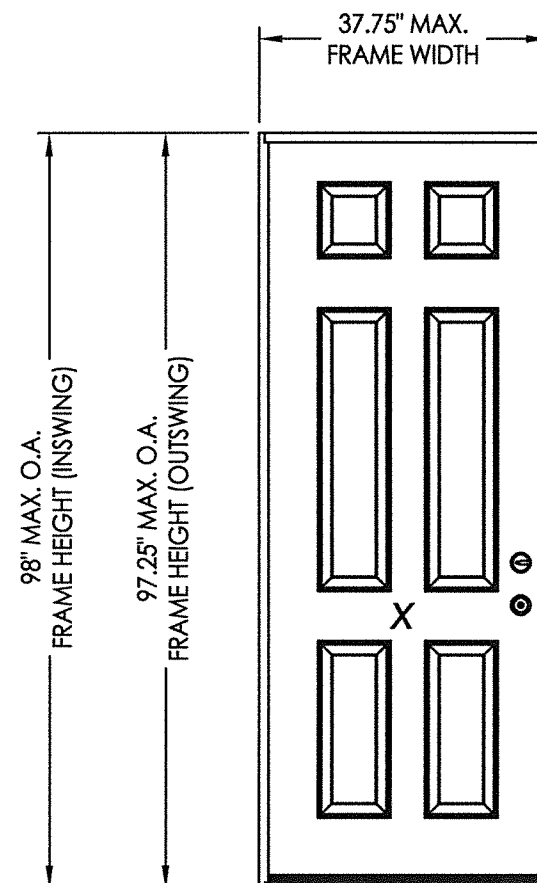

CONFIGURATION	LOCK HARDWARE CENTERLINE	LOCK HARDWARE	DESIGN PRESSURE (PSF) INSWING		DESIGN PRESSURE (PSF) OUTSWING	
			POSITIVE	NEGATIVE	POSITIVE	NEGATIVE
X	5-1/2"	Latch & Deadbolt	+60.0	-67.0	+60.0	-60.0
X	12"	Latch & Deadbolt	+67.0	-67.0	+67.0	-67.0
X	N/A	Multipoint	+50.0	-50.0	+50.0	-50.0

See Sheet 3 for Hardware Specifications

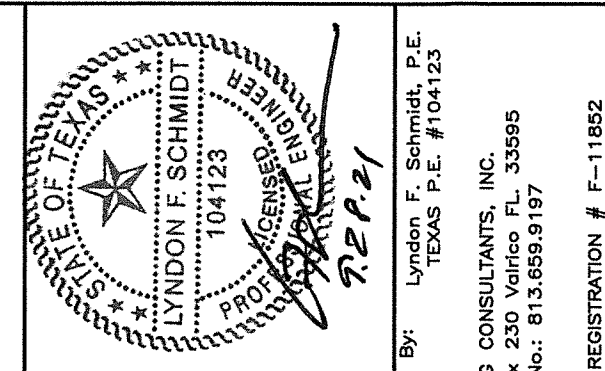

Documents Prepared By: Lyndon F. Schmidt, P.E.
TEXAS P.E. #104123

RW BUILDING CONSULTANTS, INC.
P.O. Box 230 Valrico FL 33595
Phone No.: 813.659.9197

CERTIFICATE OF REGISTRATION # F-11852

PRODUCT: THERMA-TRU FIBERGLASS DOOR
PART OR ASSEMBLY: TYPICAL ELEVATION, DESIGN PRESSURES & GENERAL NOTES

NO.	DATE	REVISIONS
1	9/28/21	UPDATE TO 2018 IBC/IRC CODE

DATE: 11/14/17
SCALE: N.T.S.
DWG. BY: JK
CHK. BY: LFS
DRAWING NO.: TX-4721
SHEET 1 OF 8

Z:\Clients\Therma Tru PERMANENT\B - Texas Dept of Ins\TDI - DR 947 - 68 & 80 Opaque Comp Edge Non-Impact (TX 4716 - 4727)\C - Drawings\TX-4721-23.dwg

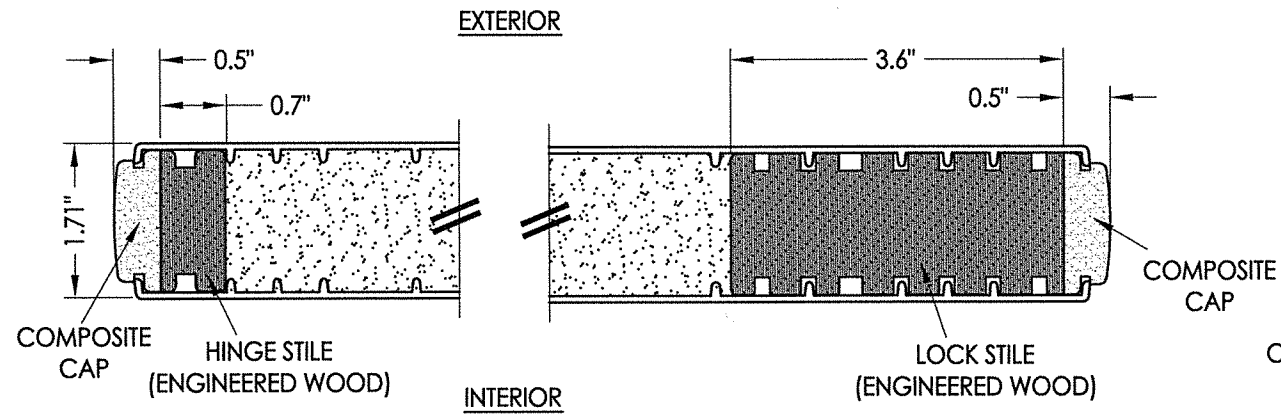

1
2 HORIZONTAL CROSS SECTION

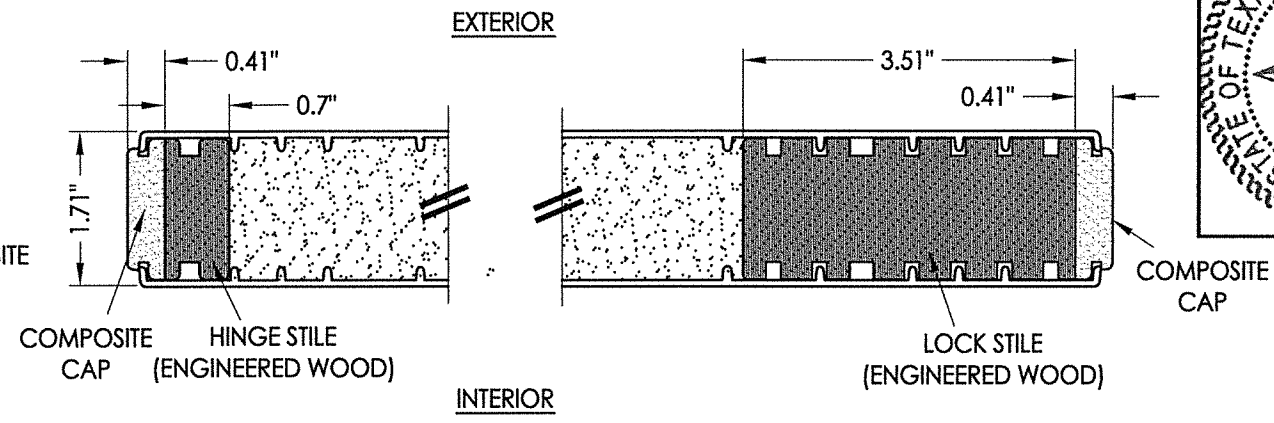

2
2 HORIZONTAL CROSS SECTION

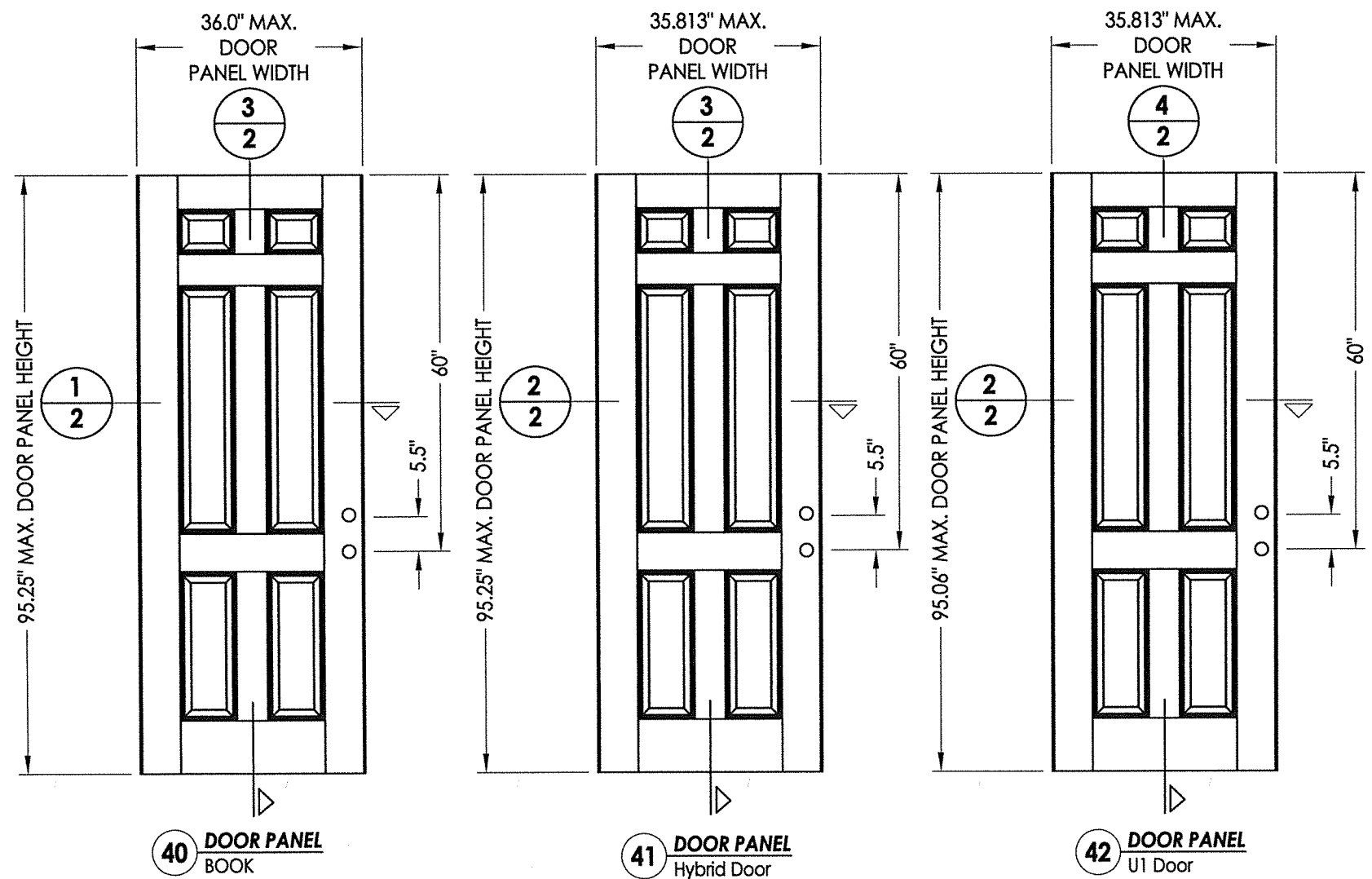

40 DOOR PANEL BOOK

41 DOOR PANEL Hybrid Door

42 DOOR PANEL U1 Door

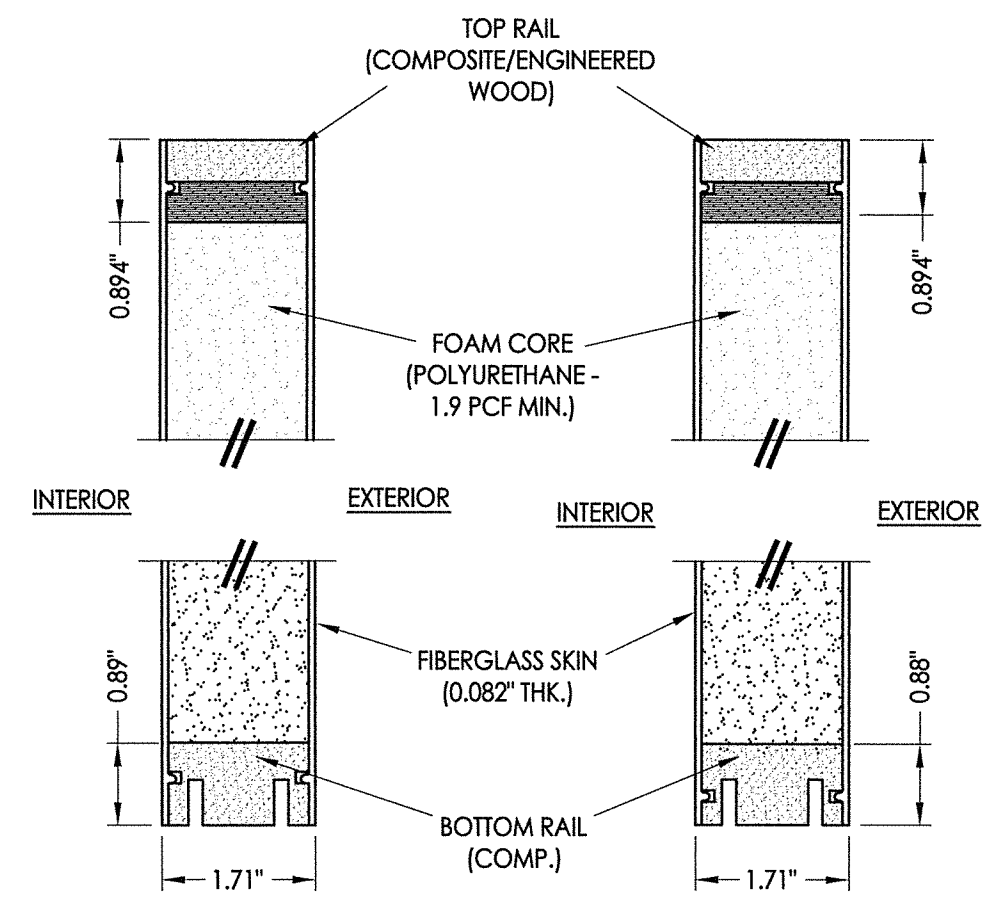

3
2 VERTICAL CROSS SECTION

4
2 VERTICAL CROSS SECTION

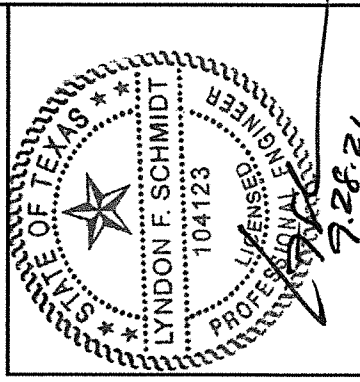

Documents Prepared By: Lyndon F. Schmidt, P.E.
TEXAS P.E. #104123

RW BUILDING CONSULTANTS, INC.
P.O. Box 230 Valrico FL 33595
Phone No.: 813.659.9197

CERTIFICATE OF REGISTRATION # F-11852

PRODUCT: THERMA-TRU FIBERGLASS DOOR	
PART OR ASSEMBLY: DOOR PANEL DETAILS	
NO.	DATE
1	9/28/21
UPDATE TO 2018 IBC/IRC CODE	
LFS	BY
REVISIONS	
DATE: 11/14/17	
SCALE: N.T.S.	
DWG. BY: JK	
CHK. BY: LFS	
DRAWING NO.: TX-4721	
SHEET 2 OF 8	

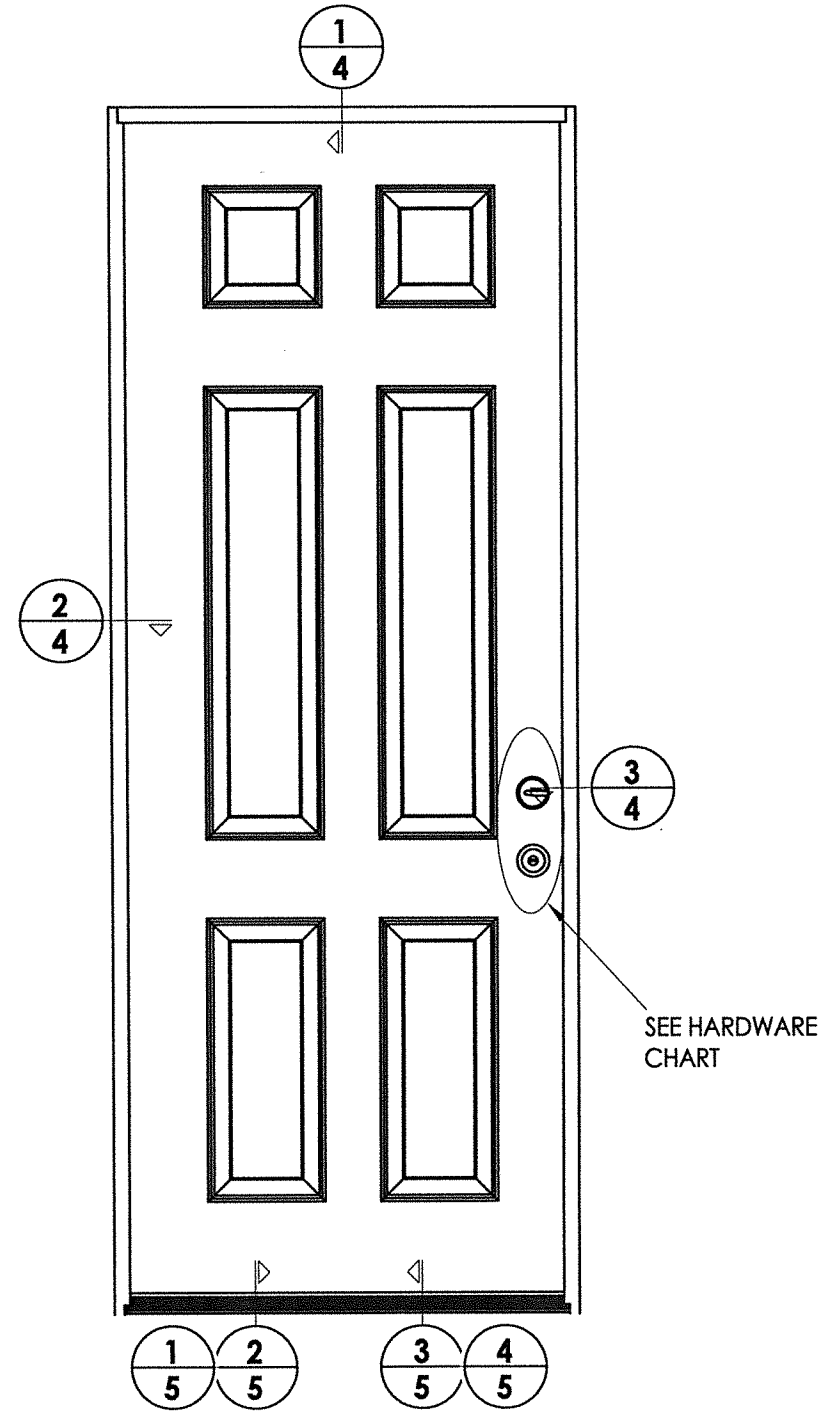

HARDWARE TABLE	
MANUFACTURER	MODEL
SCHLAGE	KNOB: F51 DEADBOLT: B60
KWIKSET	KNOB: SIGNATURE SERIES DEADBOLT: SIGNATURE SERIES (980)
HOPPE (THERMA-TRU)	MULTIPOINT : MPDGART (3 pt. Manual Tongue)

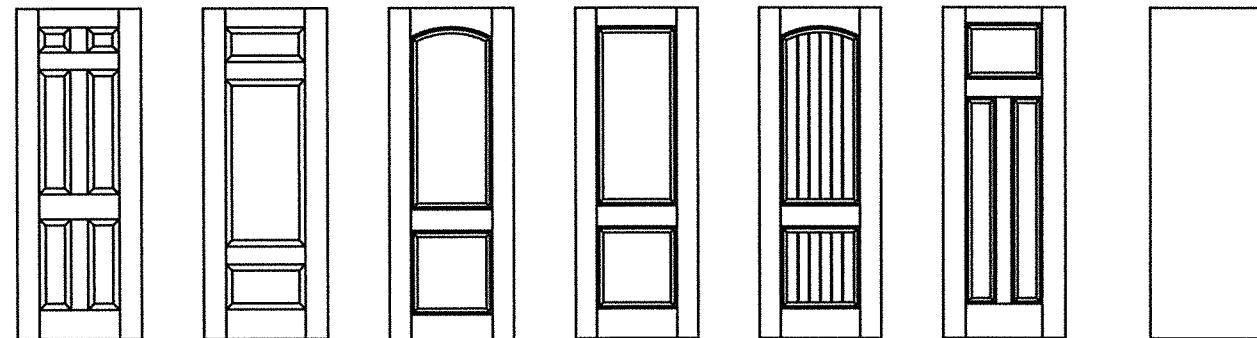

Fiber-Classic/Smooth-Star Door Panel Options

Panel options shown are for illustration and are representative only
(similar opaque panel configurations are allowed)

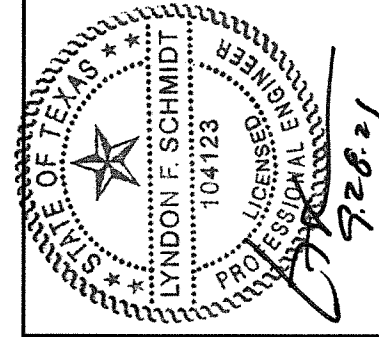

Documents Prepared By: Lyndon F. Schmidt, P.E.
TEXAS P.E. #104123

RW BUILDING CONSULTANTS, INC.
P.O. Box 230 Valrico FL, 33595
Phone No.: 813.659.9197

CERTIFICATE OF REGISTRATION # F-11852

PRODUCT: THERMA-TRU
FIBERGLASS DOOR
PART OR ASSEMBLY: ELEVATIONS

NO.	DATE	REVISIONS	LFS	BY
1	9/28/21	UPDATE TO 2018 IBC/IRC CODE	LFS	BY

DATE: 11/14/17
SCALE: N.T.S.
DWG. BY: JK
CHK. BY: LFS
DRAWING NO.: TX-4721
SHEET 3 of 8

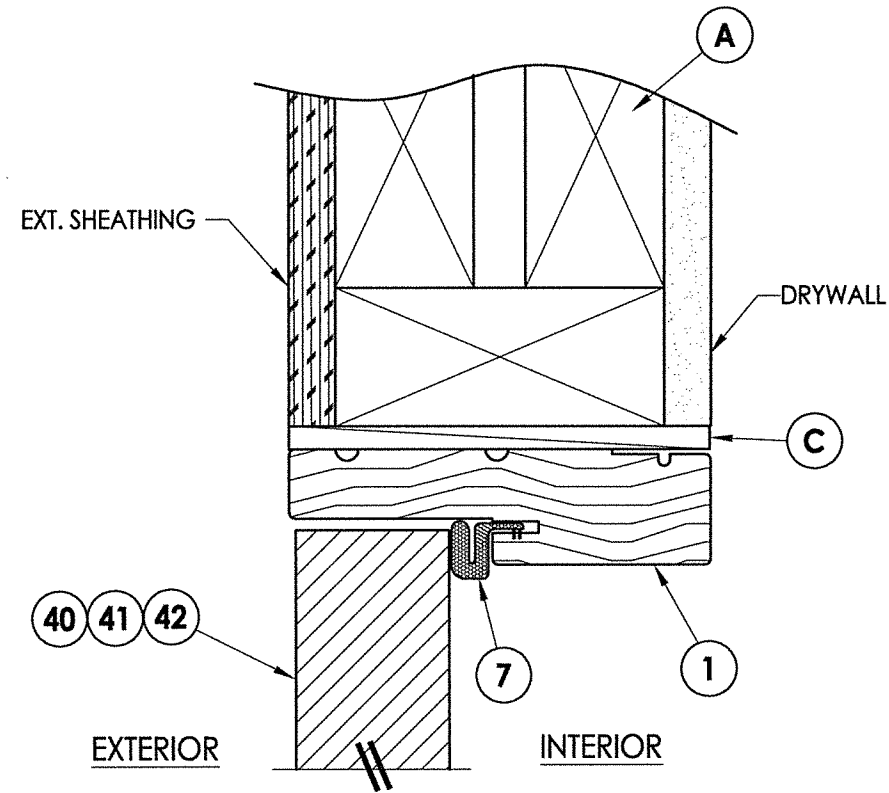

1 VERTICAL CROSS SECTION
4 Outswing shown (Inswing similar)

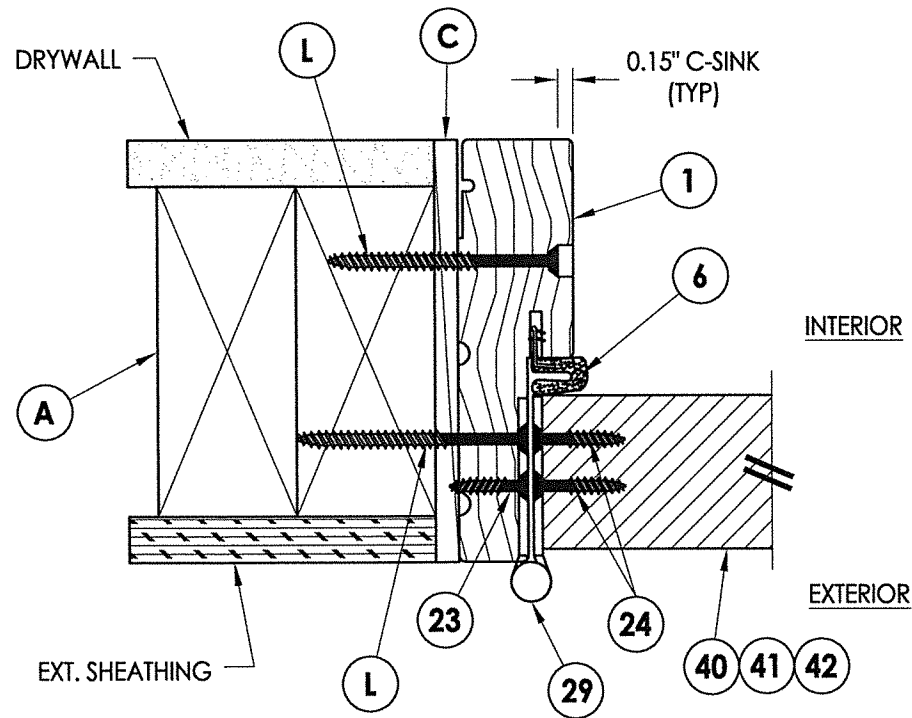

2 HORIZONTAL CROSS SECTION
4 Outswing shown (Inswing similar)

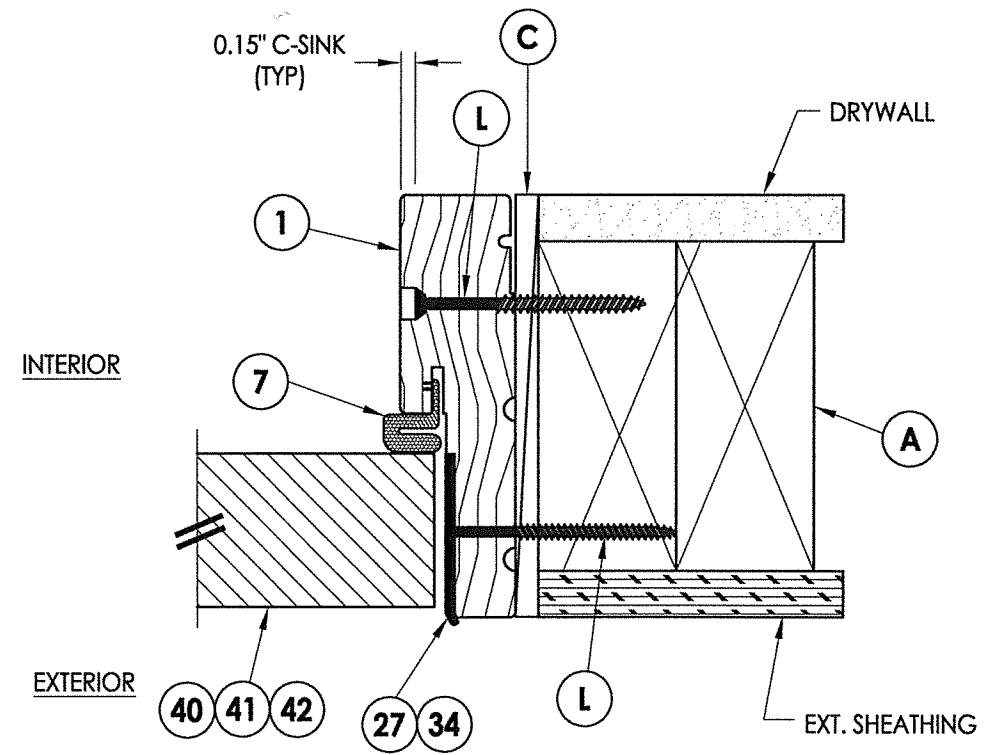

3 HORIZONTAL CROSS SECTION
4 Outswing shown (Inswing similar)

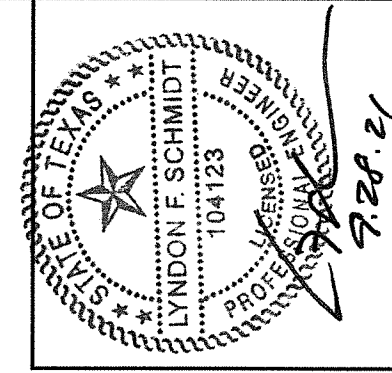

Documents Prepared By: Lyndon F. Schmidt, P.E.
 TEXAS P.E. #104123

RW BUILDING CONSULTANTS, INC.
 P.O. Box 230 Valrico FL 33595
 Phone No.: 813.659.9197

CERTIFICATE OF REGISTRATION # F-11852

PRODUCT: THERMA-TRU FIBERGLASS DOOR
 PART OR ASSEMBLY: HORIZONTAL & VERTICAL CROSS SECTIONS

NO.	DATE	REVISIONS	BY
1	9/28/21	UPDATE TO 2018 IBC/IRC CODE	LFS

DATE: 11/14/17

SCALE: N.T.S.

DWG. BY: JK

CHK. BY: LFS

DRAWING NO.: TX-4721

SHEET 4 OF 8

Z:\Clients\Therma Tru PERMANENT\B - Texas Dept of Ins\TDI - DR 947 - 6'8 & 8'0 Opaque Comp Edge Non-Impact (TX 4716 - 4727)\C - Drawings\TX-4721-23.dwg

Notes:

- 1. Sill Item #'s 16, 32, 33, 34, 35, 36, 37, 38 & 39 are attached to jambs w/ (3) #8 X 2-1/2" pph screws at each end.
- Sill Item #'s 17 & 18 are attached to jambs w/ (2) #8 X 2-1/2" pph screws at each end.
- Sill Item #15 is attached to jambs utilizing (2) #10 X 1-1/2" pph screws at each end.

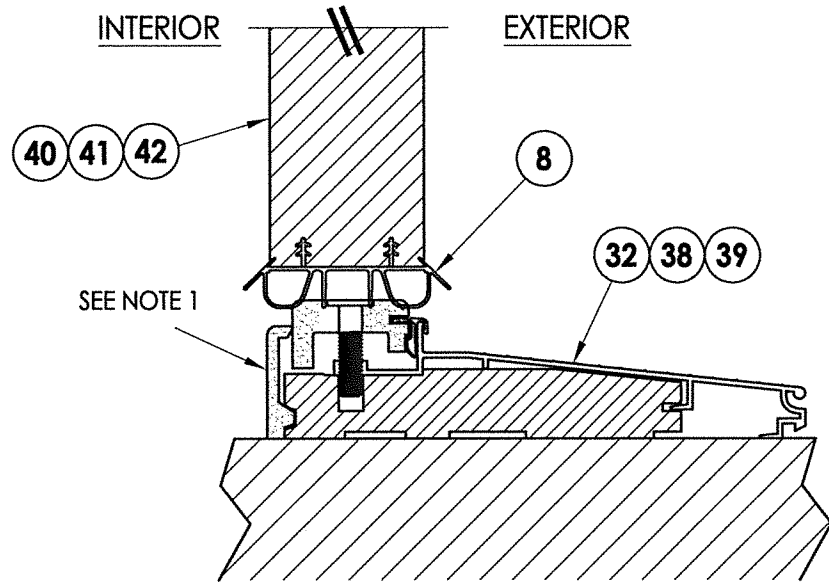
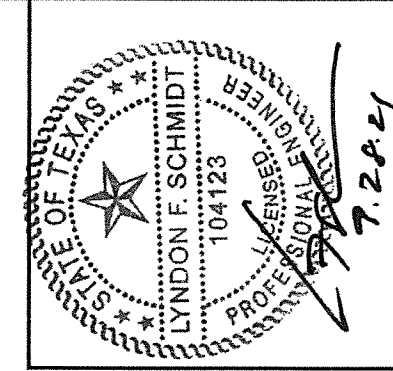

1 VERTICAL CROSS SECTION
5 Inswing Sill

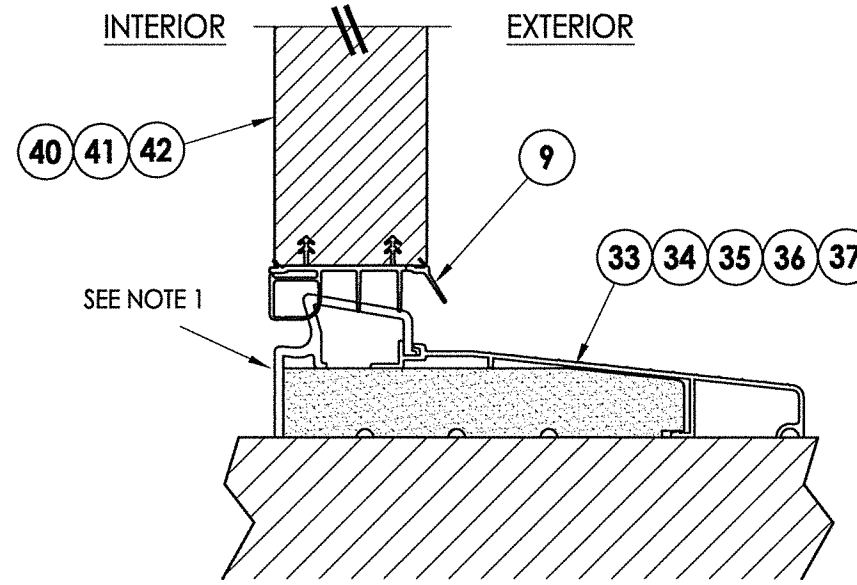

2 VERTICAL CROSS SECTION
5 Inswing Sill

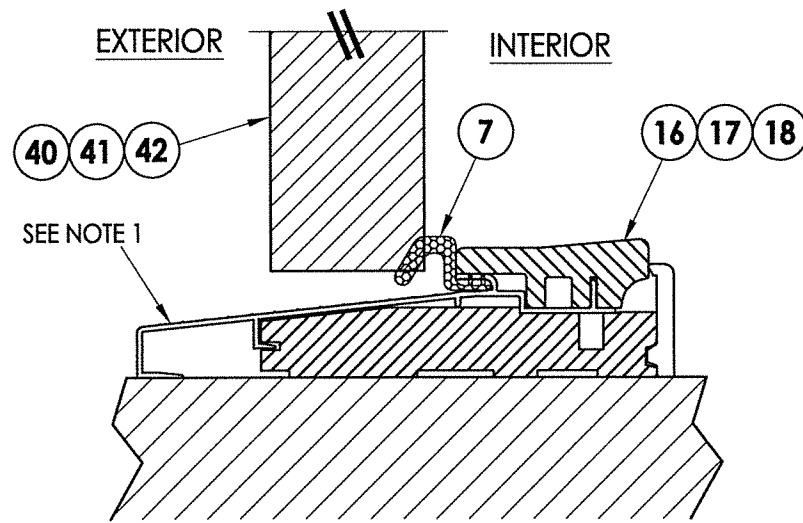

3 VERTICAL CROSS SECTION
5 Outswing Sill (Coastal Sill Shown)

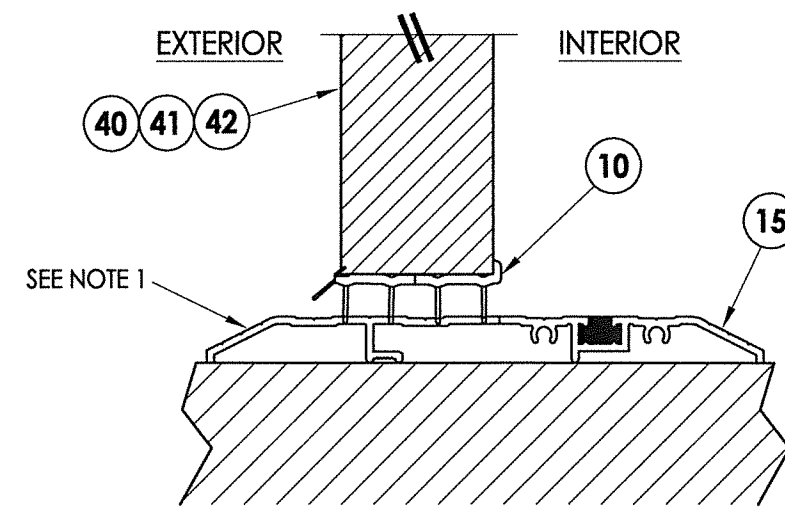

4 VERTICAL CROSS SECTION
5 Public Access Sill

Documents Prepared By: Lyndon F. Schmidt, P.E. TEXAS P.E. #104123			
PRODUCT: THERMA-TRU FIBERGLASS DOOR		PART OR ASSEMBLY: VERTICAL CROSS SECTIONS (THRESHOLDS)	
DATE: 11/14/17	SCALE: N.T.S.	NO. 1	DATE 9/28/21
DWG. BY: JK	CHK. BY: LFS	NO.	DATE
DRAWING NO.: TX-4721	REVISIONS		
SHEET 5 OF 8	© 2017 R.W. BUILDING CONSULTANTS INC. CERTIFICATE OF REGISTRATION # F-11852		

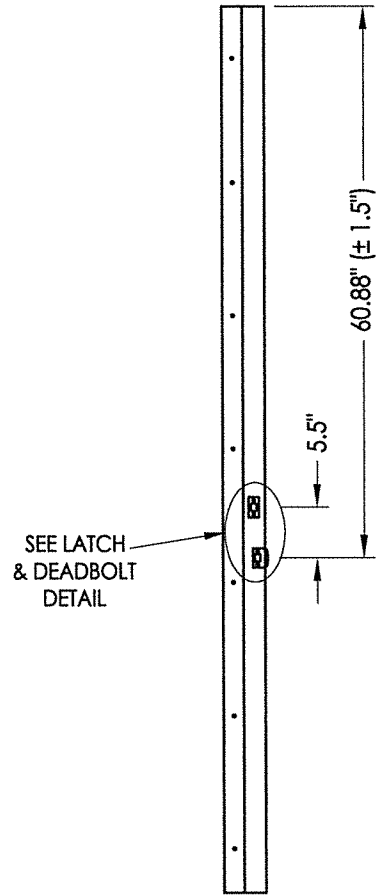

STRIKE JAMB
Latch and Deadbolt

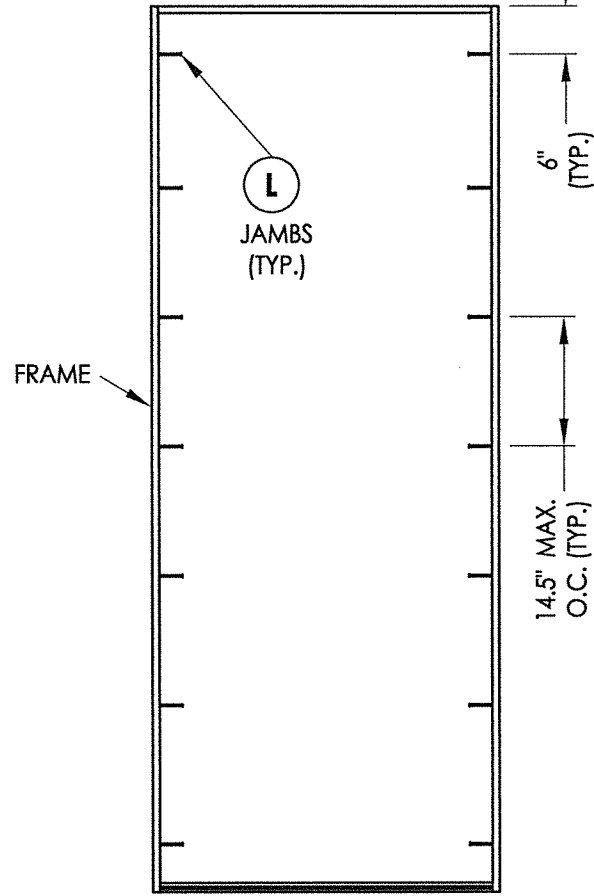

X
FRAME ANCHORING

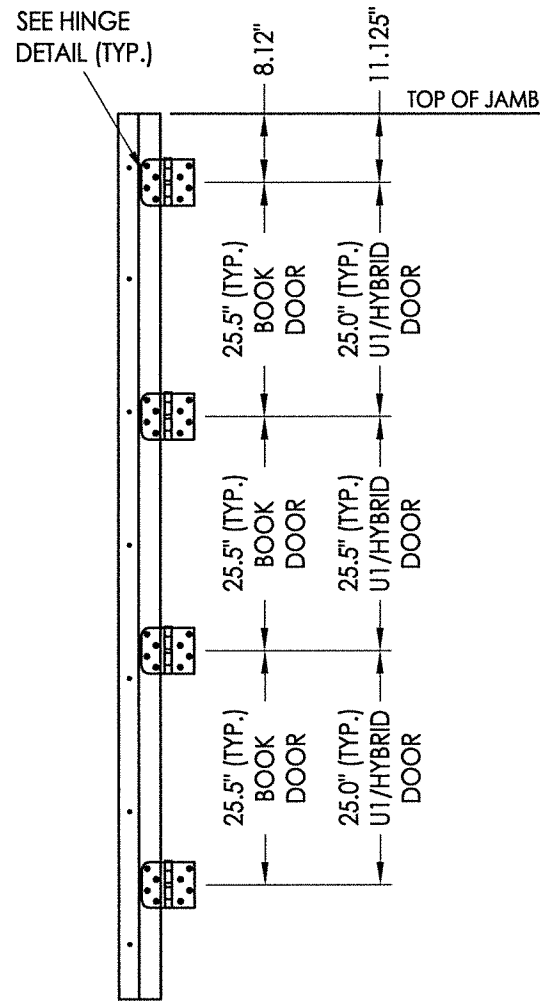

HINGE JAMB

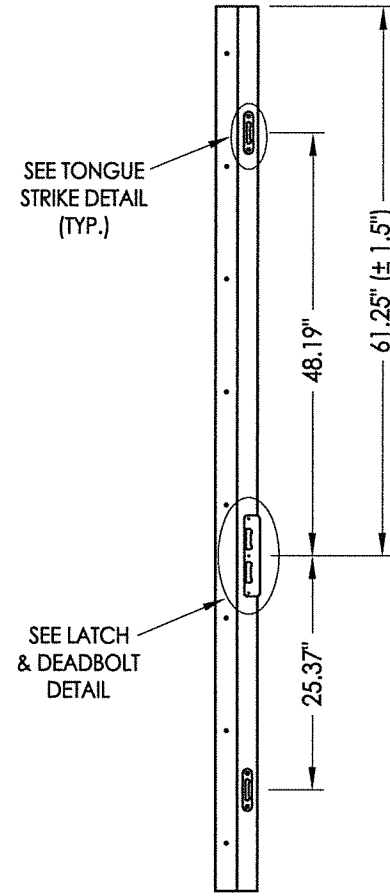

STRIKE JAMB
Multipoint Lock

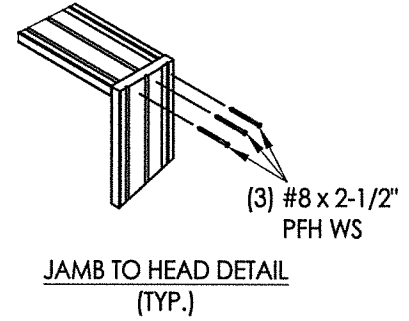

JAMB TO HEAD DETAIL
(TYP.)

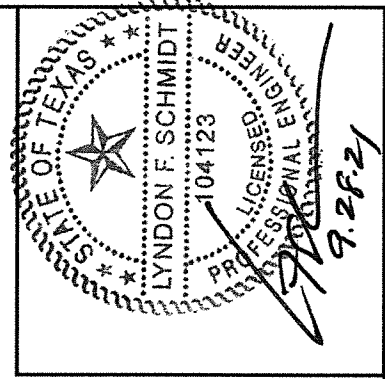

Documents Prepared By: Lyndon F. Schmidt, P.E.
TEXAS P.E. #104123

R.W. BUILDING CONSULTANTS, INC.
P.O. Box 230 Valrico FL 33595
Phone No.: 813.659.9197

CERTIFICATE OF REGISTRATION # F-11852

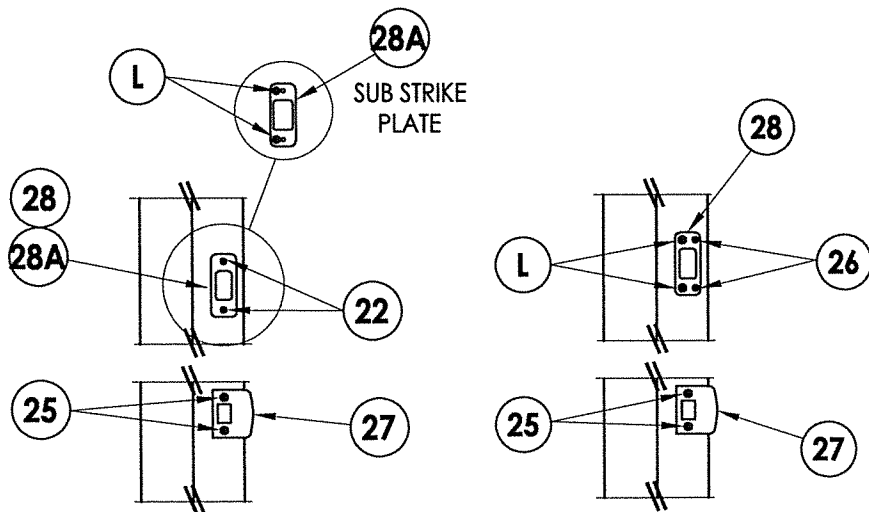

LATCH & DEADBOLT DETAIL
Schlage

LATCH & DEADBOLT DETAIL
Kwikset

LATCH & DEADBOLT STRIKE DETAILS
(Standard Deadbolt Strike Plate)

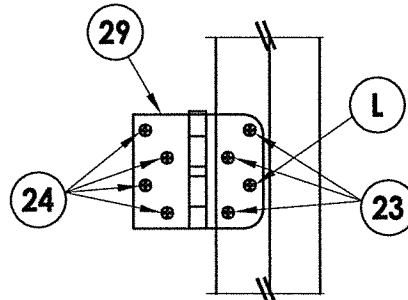

HINGE DETAIL

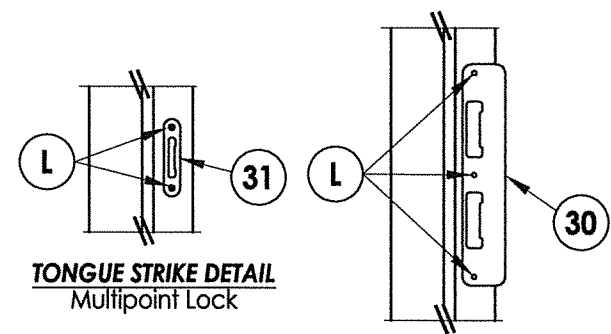

TONGUE STRIKE DETAIL
Multipoint Lock

LATCH & DEADBOLT DETAIL
Multipoint Lock

MULTIPOINT LOCK STRIKE DETAILS

PRODUCT:	Therma-TRU FIBERGLASS DOOR
PART OR ASSEMBLY:	FRAME ANCHORING & HARDWARE DETAILS

NO.	DATE	REVISIONS
1	9/28/21	UPDATE TO 2018 IBC/IRC CODE
		LFS
		BY

DATE:	11/14/17
SCALE:	N.T.S.
DWG. BY:	JK
CHK. BY:	LFS
DRAWING NO.:	TX-4721
SHEET	6 OF 8

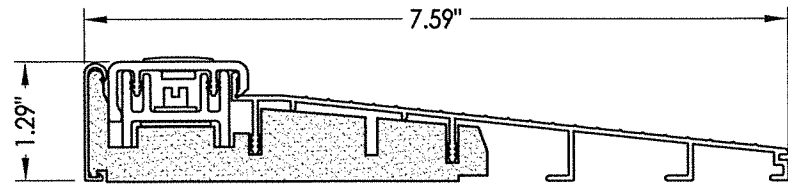

32 INSWING THRESHOLD
Inswing Basic Composite Adjustable Sill 7-1/2"

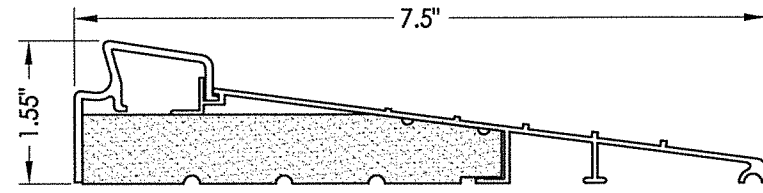

37 INSWING THRESHOLD
Inswing Basic Fixed 7-1/2" Sill

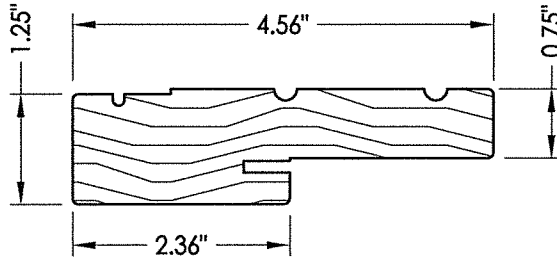

1 WOOD JAMB

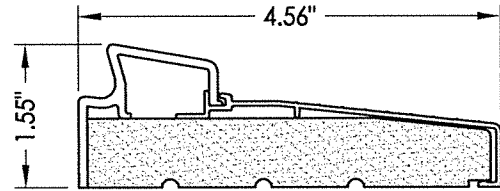

33 INSWING THRESHOLD
Inswing Basic Fixed Sill

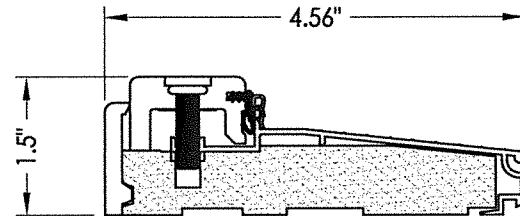

38 INSWING THRESHOLD
Inswing Composite Adjustable Sill

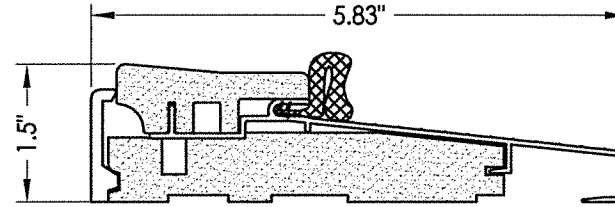

16 OUTSWING THRESHOLD
Composite Sill

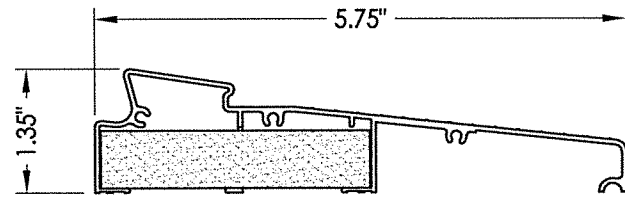

34 INSWING THRESHOLD
Inswing Moderate Climate Sill 1-3/8"

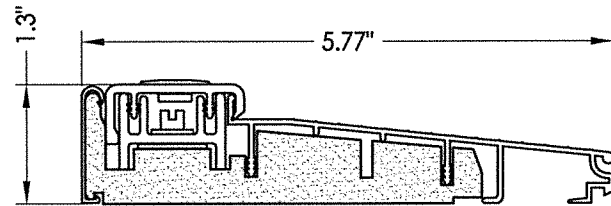

39 INSWING THRESHOLD
Inswing Basic Composite Adjustable Sill

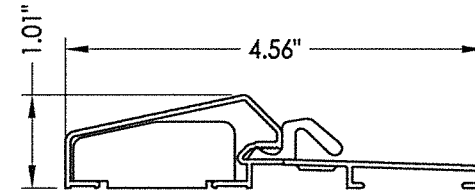

17 OUTSWING THRESHOLD
Composite / Aluminum Sill

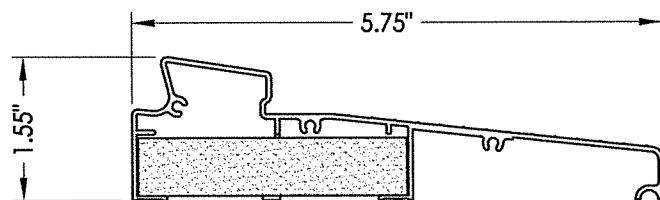

35 INSWING THRESHOLD
Inswing Moderate Climate Sill

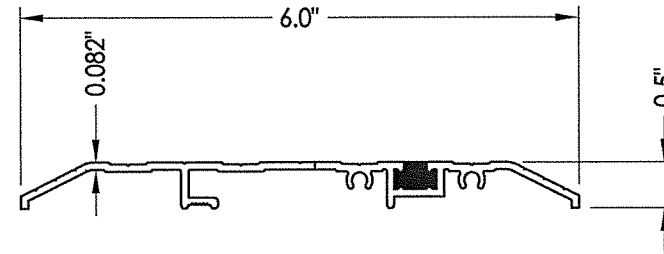

15 PUBLIC ACCESS THRESHOLD

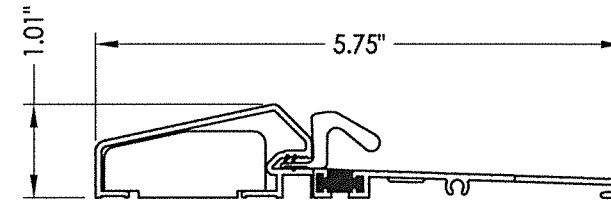

18 OUTSWING THRESHOLD
Composite / Aluminum Sill
(Thermal Break)

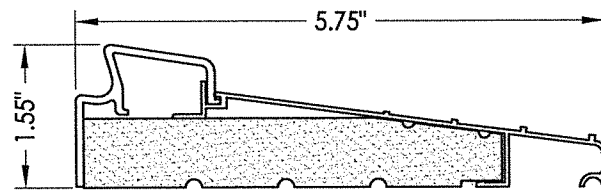

36 INSWING THRESHOLD
Inswing Basic Fixed 5-3/4" Sill

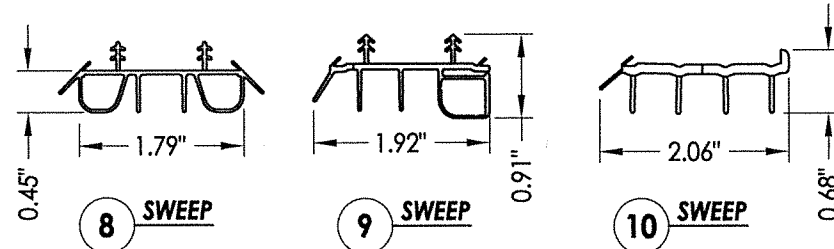

8 SWEEP

9 SWEEP

10 SWEEP

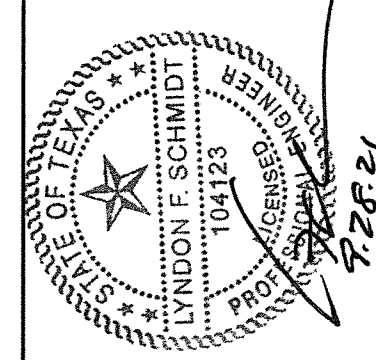

Documents Prepared By: Lyndon F. Schmidt, P.E.
TEXAS P.E. #104123

RW BUILDING CONSULTANTS, INC.
P.O. Box 230 Valrico FL 33595
Phone No.: 813.659.9197

CERTIFICATE OF REGISTRATION # F-11852

PRODUCT:	THERMA-TRU FIBERGLASS DOOR
PART OR ASSEMBLY:	COMPONENTS

NO.	DATE	REVISIONS	BY
1	9/28/21	UPDATE TO 2018 IBC/IRC CODE	LFS

DATE:	11/14/17
SCALE:	N.T.S.
DWG. BY:	JK
CHK. BY:	LFS
DRAWING NO.:	TX-4721
SHEET	7 OF 8

