

# THERMA-TRU® DOORS

Fiber-Classic® & Smooth-Star®

## COMPOSITE EDGE OPAQUE FIBERGLASS DOUBLE DOOR w/ or w/out SIDELITES INSWING/OUTSWING "NON-IMPACT"

EVALUATED FOR USE IN THE STATE OF TEXAS

**TDI DR-947**

The Fiberglass Door system described herein complies with the 2018 International Residential Code (IRC), Sections R301 & R609 and the 2018 International Building Code (IBC), Sections 1404.13, 1609, 1709.5, 2403 and 2404 subject to the following conditions:

1. Anchors shall be as listed and spaced as shown in the details. Anchor embedment to base material shall be beyond wall dressing or stucco.
2. When used in areas requiring wind-borne debris protection this product is required to be protected with an impact resistant covering that complies with Section R301.2.1.2 of the IRC and Section 1609.1.2 of the IBC.
3. Allowable design pressure requirements must be equal to or less than the design pressure rating shown in the design pressure chart, sheet 1 of this drawing.
4. Conditions not covered by this drawing are subject to further engineering analysis.
5. Fiber-Classic and Smooth-Star Door and Sidelite panels require the use of "J" part numbers. These door and sidelite panels must be stained or painted within six months of installation.

TABLE OF CONTENTS	
SHEET #	DESCRIPTION
1	Typical Elevations, Design Pressures & General Notes
2	Door Panel Details
3	Sidelite Panel Details
4	Elevations
5	Horizontal & Vertical Cross Sections
6	Vertical Cross Sections (Thresholds)
7	Frame Anchoring
8	Hardware Details
9	Glazing Details
10	Components
11	Bill of Materials

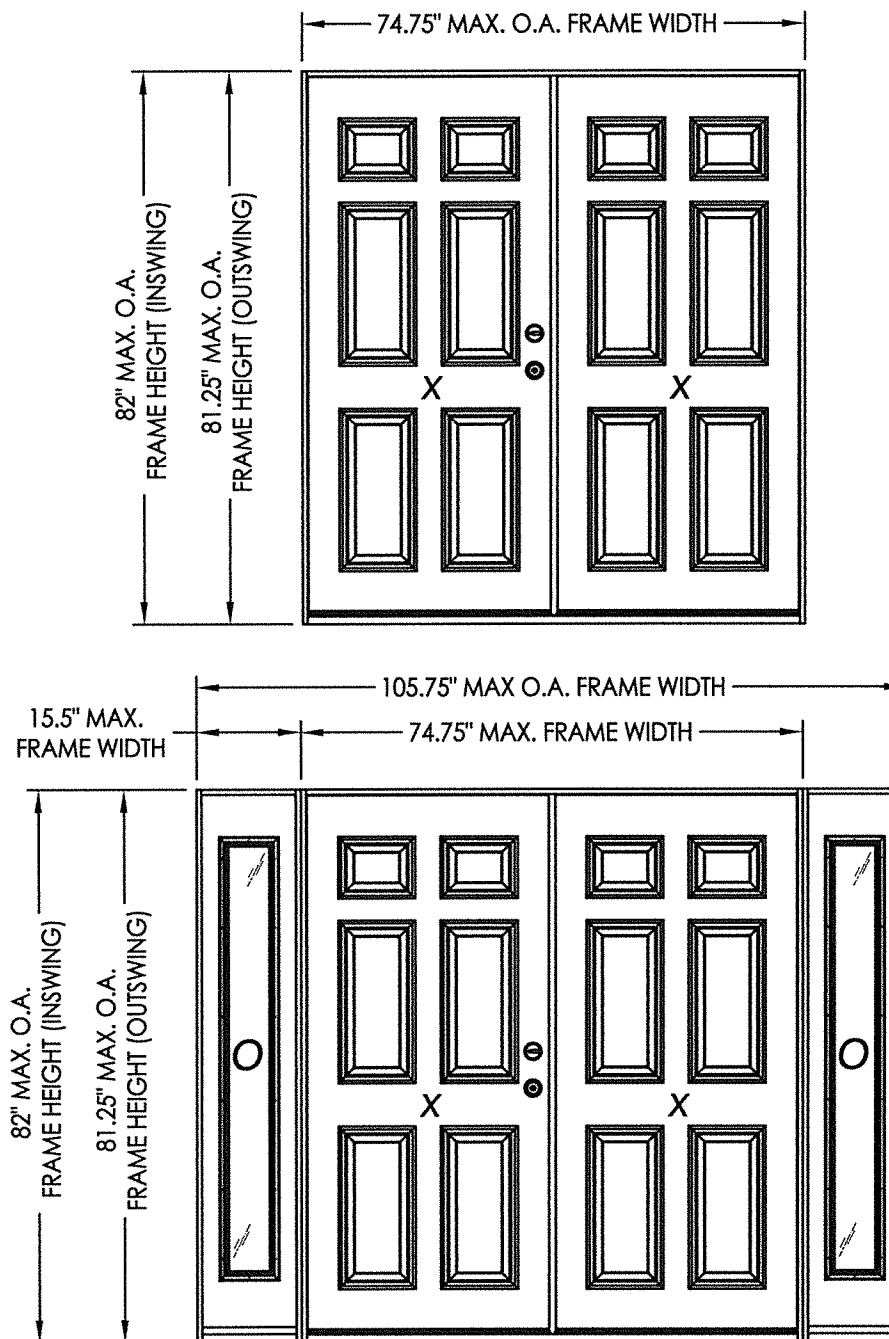

CONFIGURATION	ASTRAGAL	LOCK HARDWARE	DESIGN PRESSURE (PSF) INSWING		DESIGN PRESSURE (PSF) OUTSWING	
			POSITIVE	NEGATIVE	POSITIVE	NEGATIVE
XX, OXXO	STANDARD	Latch & Deadbolt	+40.0	-45.0	+40.0	-40.0
XX, OXXO	STANDARD	Multipoint	+55.0	-55.0	+55.0	-55.0
XX, OXXO	COASTAL	Latch & Deadbolt	+55.0	-60.0	+60.0	-60.0
XX, OXXO	COASTAL	Multipoint	+55.0	-60.0	+67.0	-67.0

See Sheet 4 for Hardware Specifications

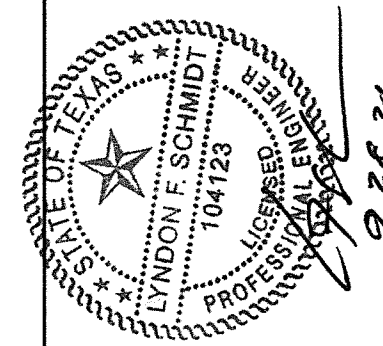

Documents Prepared By: Lyndon F. Schmidt, P.E.  
TEXAS P.E. #104123

**RW** BUILDING CONSULTANTS, INC.  
P.O. Box 250 Valrico FL 33595  
Phone No.: 813.659.9197

CERTIFICATE OF REGISTRATION # F-11852

PRODUCT: THERMA-TRU  
FIBERGLASS DOOR

PART OR ASSEMBLY:  
TYPICAL ELEVATION, DESIGN  
PRESSURES & GENERAL NOTES

NO.	DATE	REVISIONS
1	9/28/21	UPDATE TO 2018 IBC/IRC CODE
		LFS
		BY

DATE: 11/14/17

SCALE: N.T.S.

DWG. BY: JK

CHK. BY: LFS

DRAWING NO.: TX-4718

SHEET 1 OF 11

Z:\Clients\Therma Tru PERMANENT\B - Texas Dept of Ins\TDI - DR 947 - 6'8 & 8'0 Opaque Comp Edge Non-Impact (TX 4716 - 4727)\C - Drawings\TX-4716-18.dwg

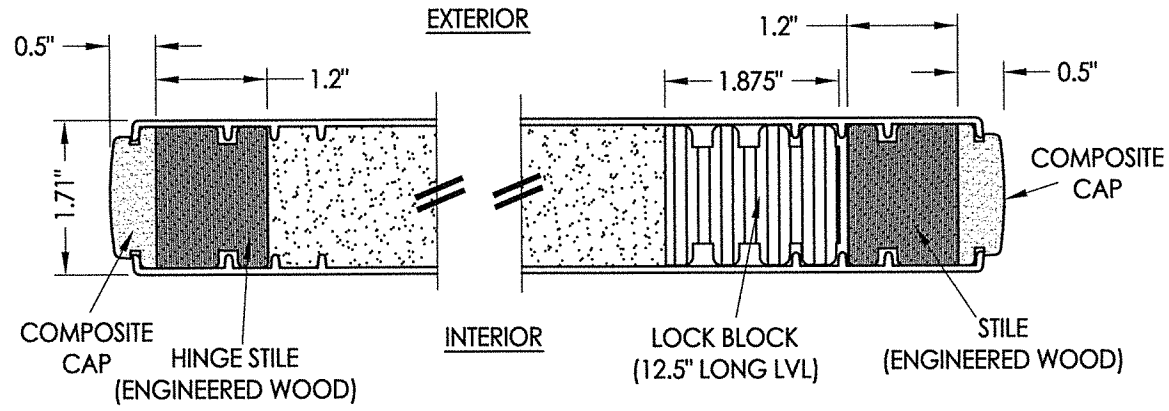

**1**  
**2** HORIZONTAL CROSS SECTION

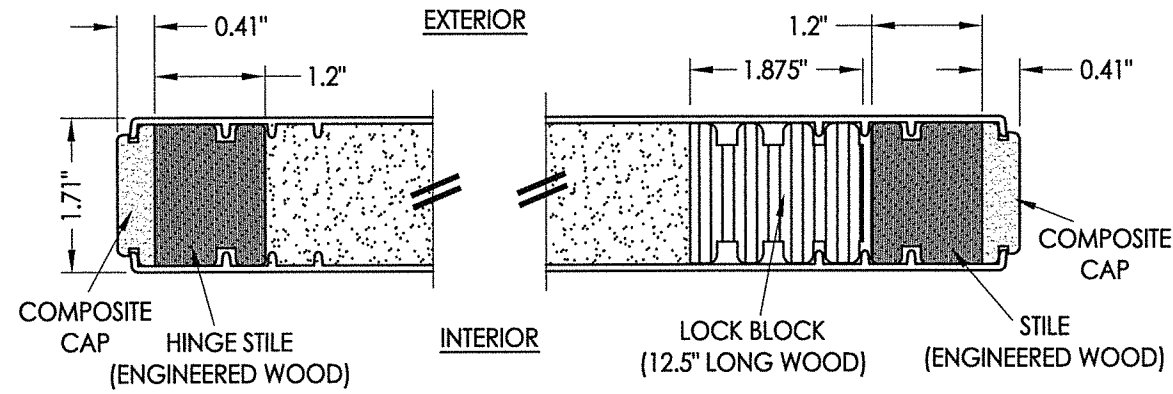

**2**  
**2** HORIZONTAL CROSS SECTION

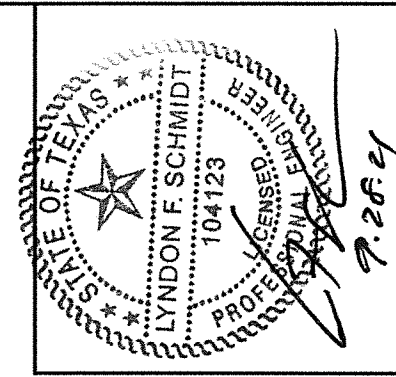

Documents Prepared By: Lyndon F. Schmidt, P.E.  
TEXAS P.E. #104123

**RW** BUILDING CONSULTANTS, INC.  
P.O. Box 230 Valrico FL 33595  
Phone No.: 813.659.9197

CERTIFICATE OF REGISTRATION # F-11852

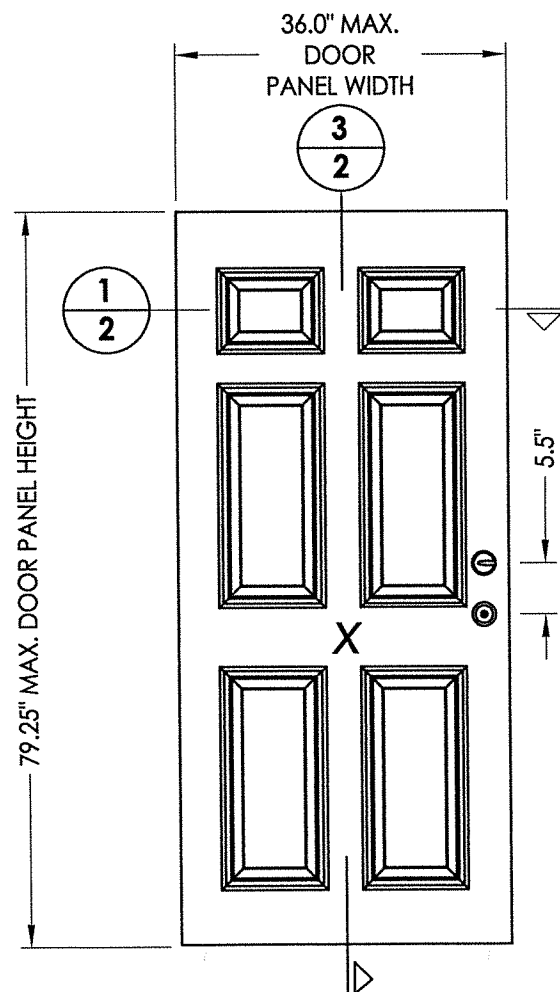

**40** DOOR PANEL BOOK

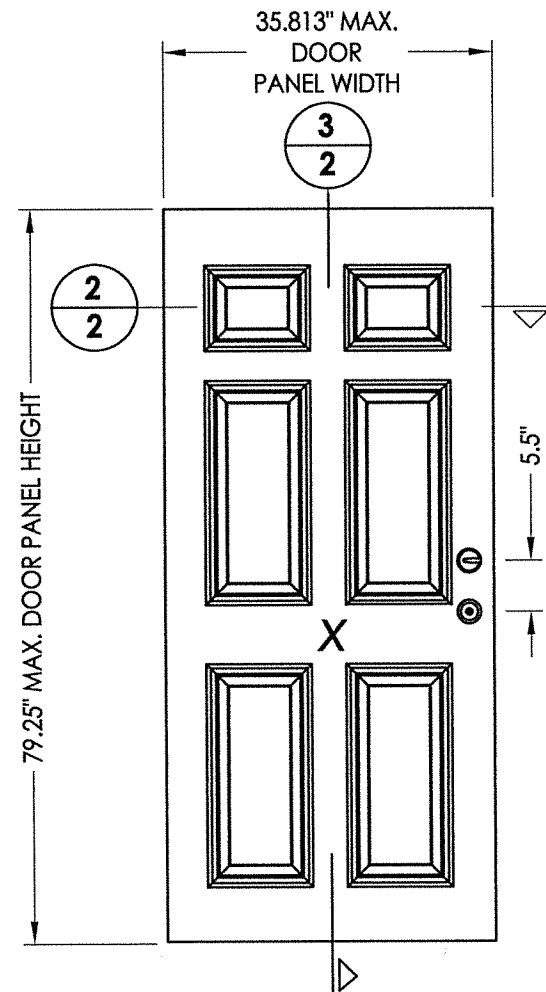

**41** DOOR PANEL Hybrid Door

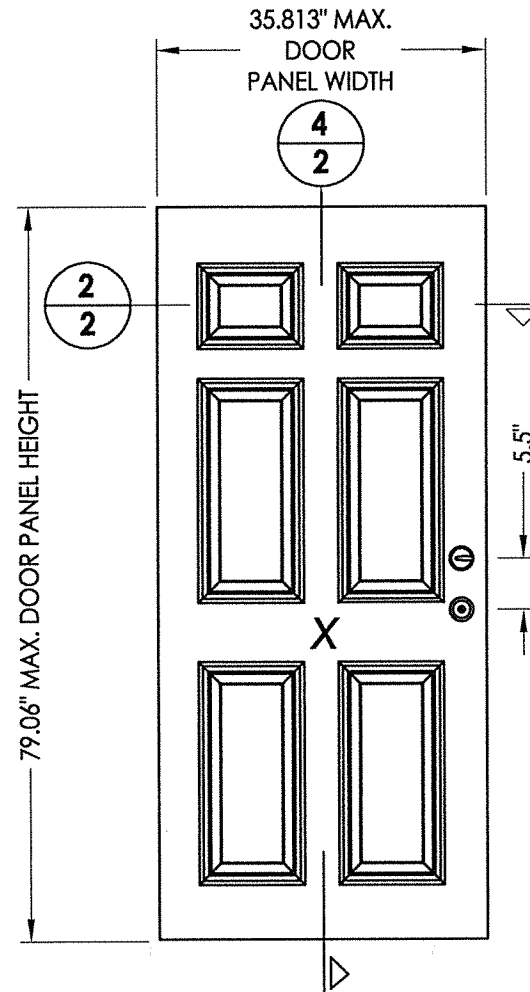

**42** DOOR PANEL U1 Door

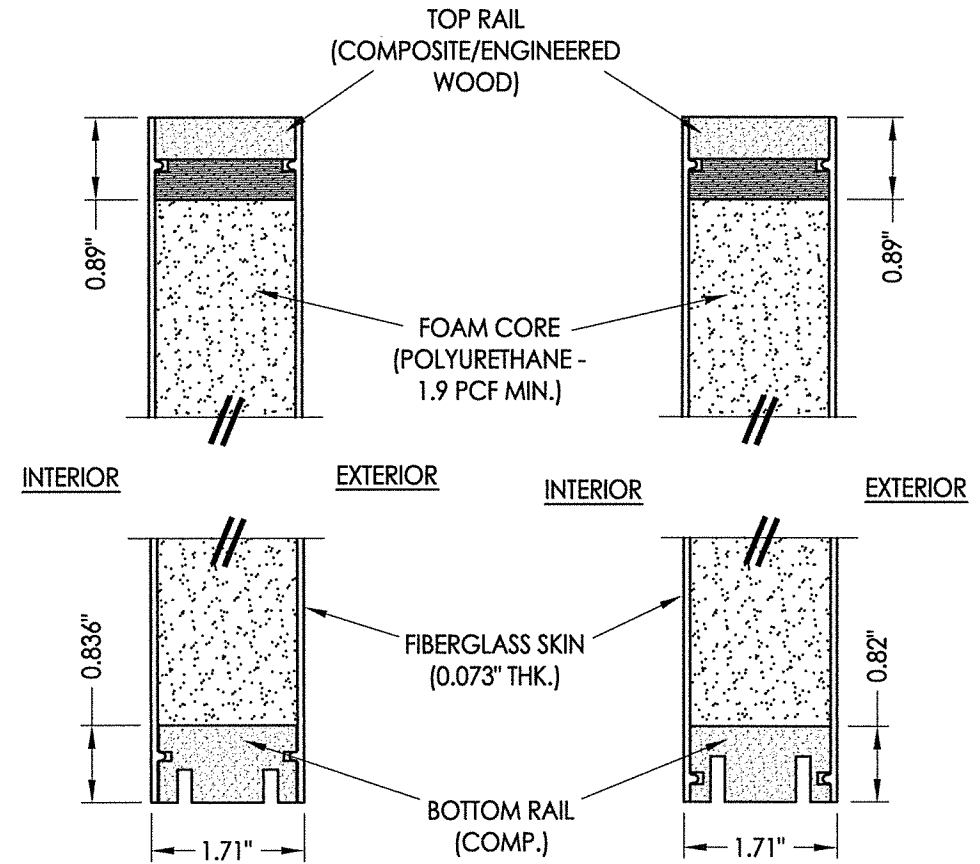

**3**  
**2** VERTICAL CROSS SECTION

**4**  
**2** VERTICAL CROSS SECTION

PRODUCT: THERMA-TRU FIBERGLASS DOOR		PART OR ASSEMBLY: DOOR PANEL DETAILS	
NO.	DATE	LFS	BY
1	9/28/21	UPDATE TO 2018 IBC/IRC CODE	
REVISIONS			
DATE: 11/14/17			
SCALE: N.T.S.			
DWG. BY: JK			
CHK. BY: LFS			
DRAWING NO.: TX-4718			
SHEET 2 OF 11			

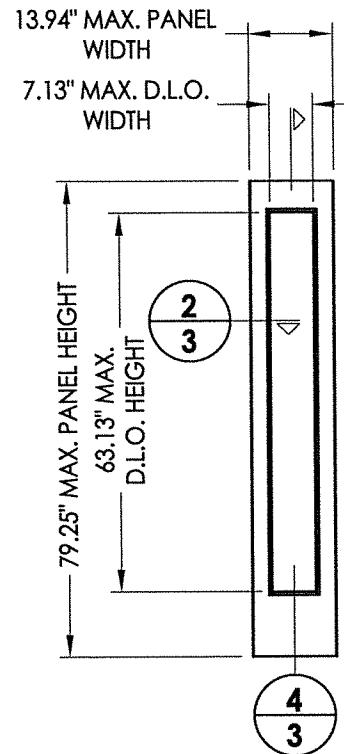

**60 SIDELITE PANEL**  
Full Lite  
Flush Glazed

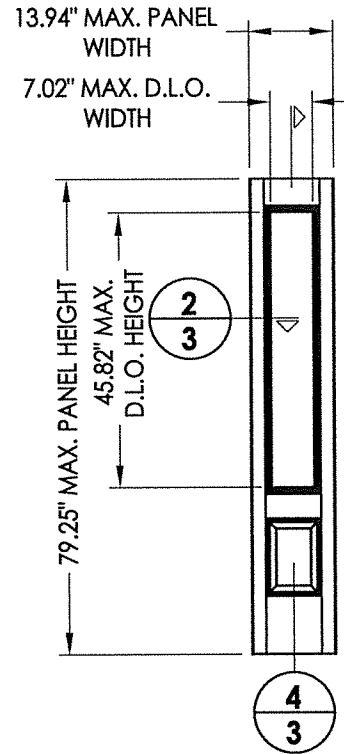

**60 SIDELITE PANEL**  
3/4 Lite  
Flush Glazed

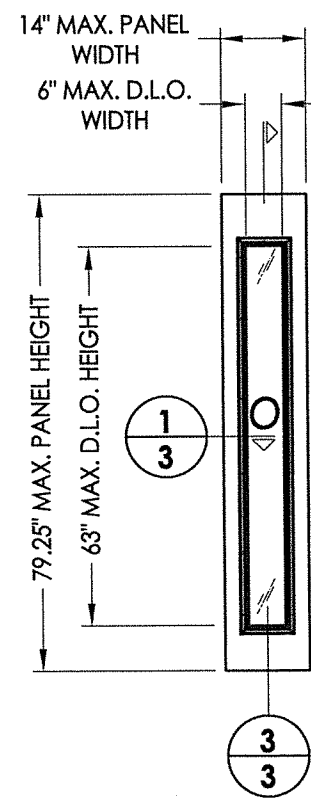

**50 SIDELITE PANEL**  
Full Lite  
Lip Lite

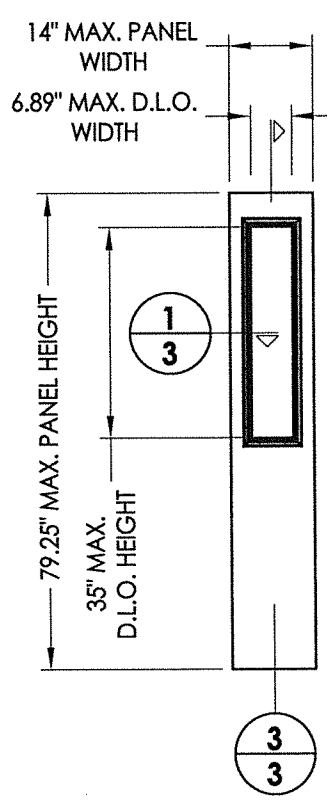

**50 SIDELITE PANEL**  
Half Lite  
Lip Lite

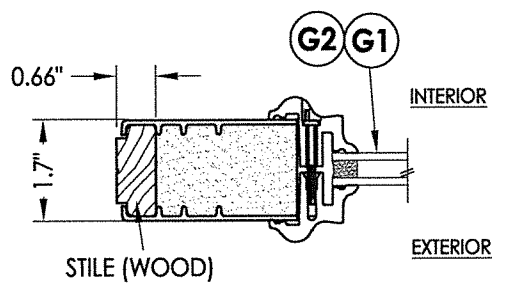

**1 HORIZONTAL CROSS SECTION**  
Lip Lite Glazing

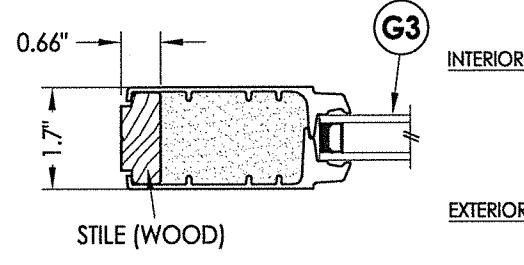

**2 HORIZONTAL CROSS SECTION**  
Flush Glazing

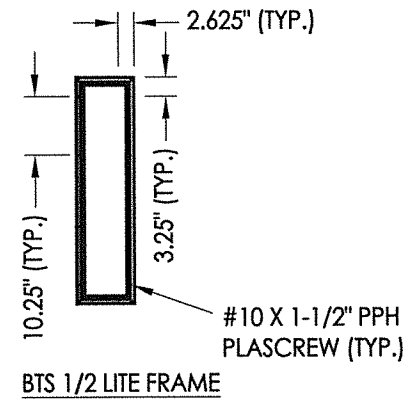

**BTS 1/2 LITE FRAME**

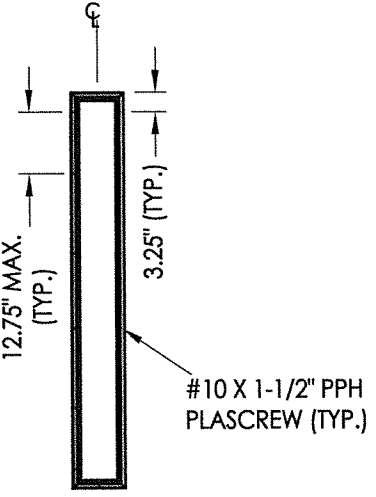

**BTS FULL LITE FRAME**

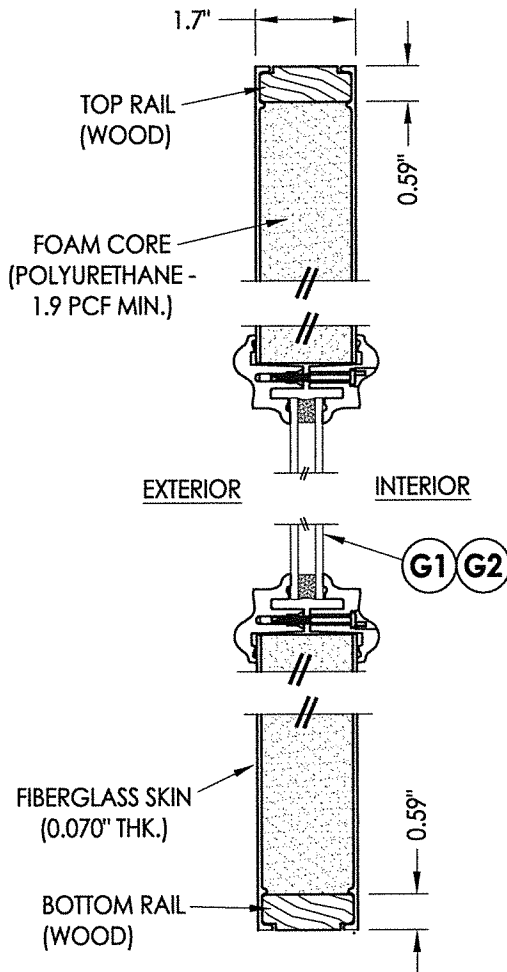

**3 VERTICAL CROSS SECTION**  
Lip Lite Glazing Shown

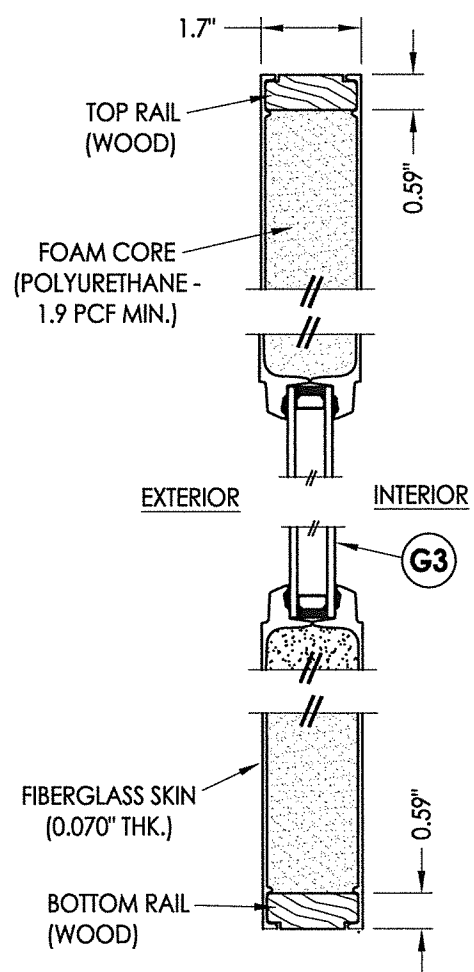

**4 VERTICAL CROSS SECTION**  
Flush Glazing Shown

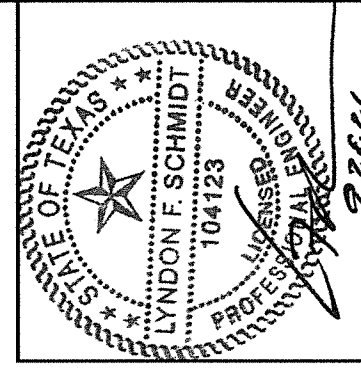

Documents Prepared By: Lyndon F. Schmidt, P.E.  
TEXAS P.E. #104123

**RW** BUILDING CONSULTANTS, INC.  
P.O. Box 230 Valrico FL, 33595  
Phone No.: 813.659.9197

CERTIFICATE OF REGISTRATION # F-11852

PRODUCT:		THERMA TRU FIBERGLASS DOOR	
PART OR ASSEMBLY:		SIDELITE PANEL DETAILS	
NO.	DATE	LFS	BY
1	9/28/21	UPDATE TO 2018 IBC/IRC CODE	
DATE: 11/14/17		SCALE: N.T.S.	
DWG. BY: JK		CHK. BY: LFS	
DRAWING NO.: TX-4718		SHEET 3 OF 11	

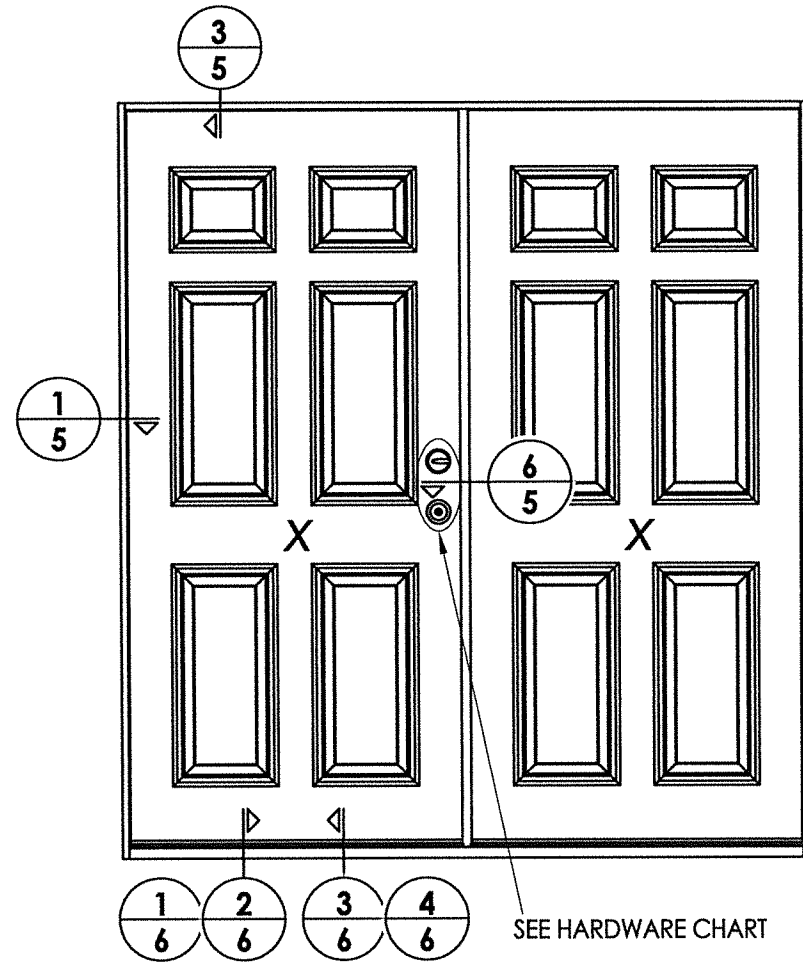

ELEVATION  
XX

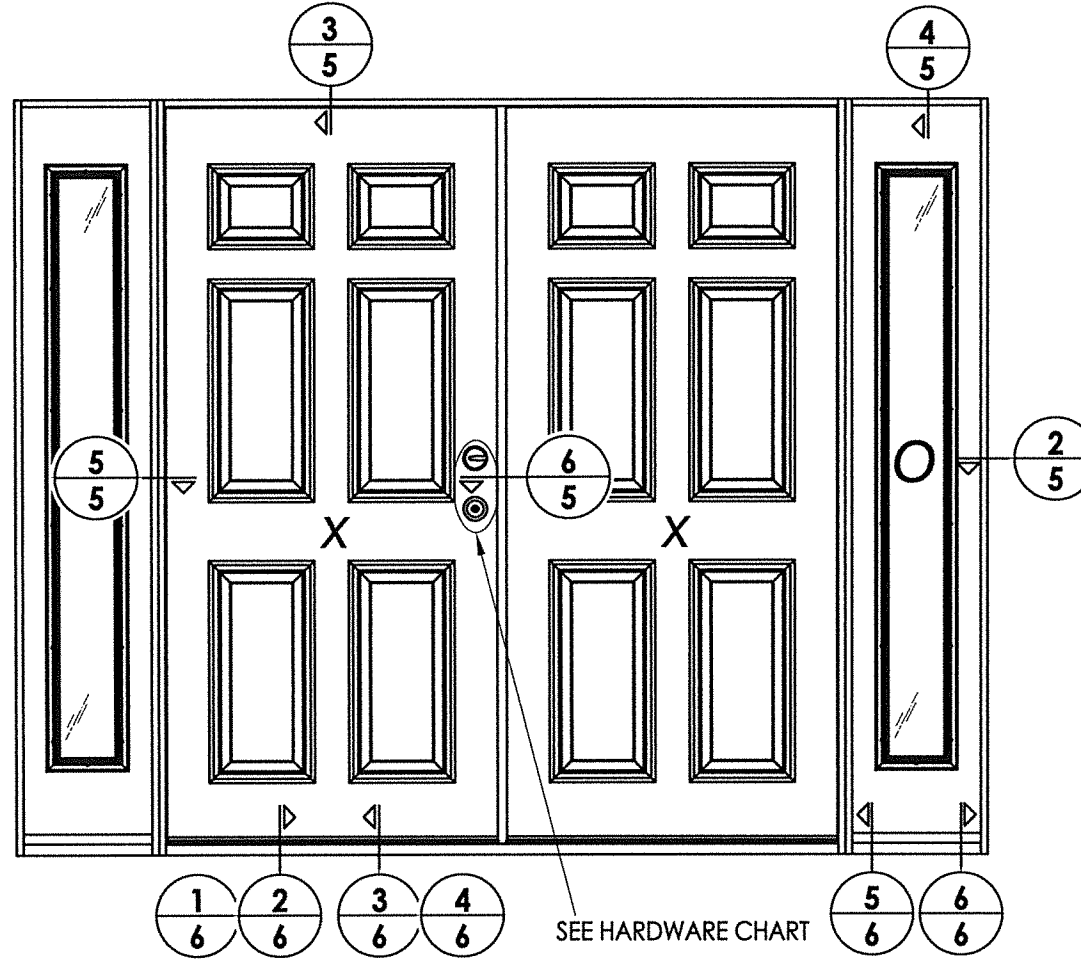

ELEVATION  
OXO

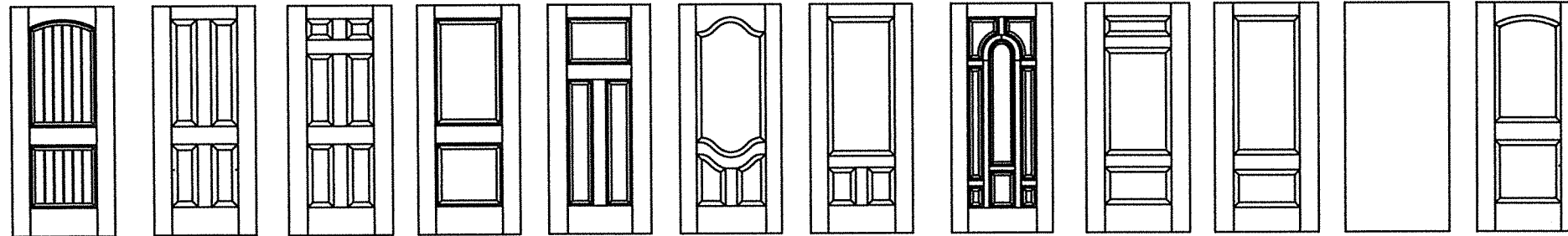

**Fiber-Classic/Smooth-Star Door Panel Options**  
Panel options shown are for illustration and are representative only  
(similar opaque panel configurations are allowed)

HARDWARE TABLE	
MANUFACTURER	MODEL
SCHLAGE	KNOB: F51 DEADBOLT: B60
KWIKSET	KNOB: SIGNATURE SERIES DEADBOLT: SIGNATURE SERIES (980)
HOPPE (THERMA-TRU)	MULTIPOINT : MPDGSB (3 pt. Manual Shootbolt)

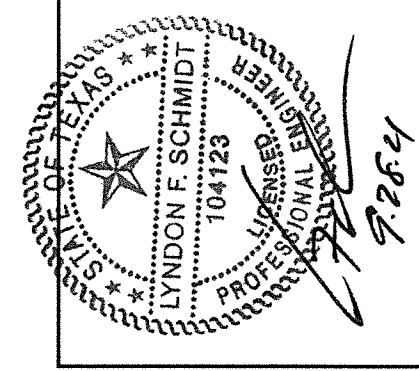

Documents Prepared By: Lyndon F. Schmidt, P.E.  
TEXAS P.E. #104123

**RW** BUILDING CONSULTANTS, INC.  
P.O. Box 230 Valrico FL, 33595  
Phone No.: 813.659.9197

CERTIFICATE OF REGISTRATION # F-11852

PRODUCT: THERMA-TRU FIBERGLASS DOOR  
PART OR ASSEMBLY: ELEVATIONS

NO.	DATE	REVISIONS
1	9/28/21	UPDATE TO 2018 IBC/IRC CODE
		LFS BY

DATE: 11/14/17  
SCALE: N.T.S.  
DWG. BY: JK  
CHK. BY: LFS  
DRAWING NO.: TX-4718  
SHEET 4 OF 11

Z:\Clients\Therma Tru PERMANENT.B - Texas Dept of Ins\TDI - DR 947 - 6'8 & 8'0 Opaque Comp Edge Non-Impact (TX 4716 - 4727)C - Drawings\TX-4716-18.dwg

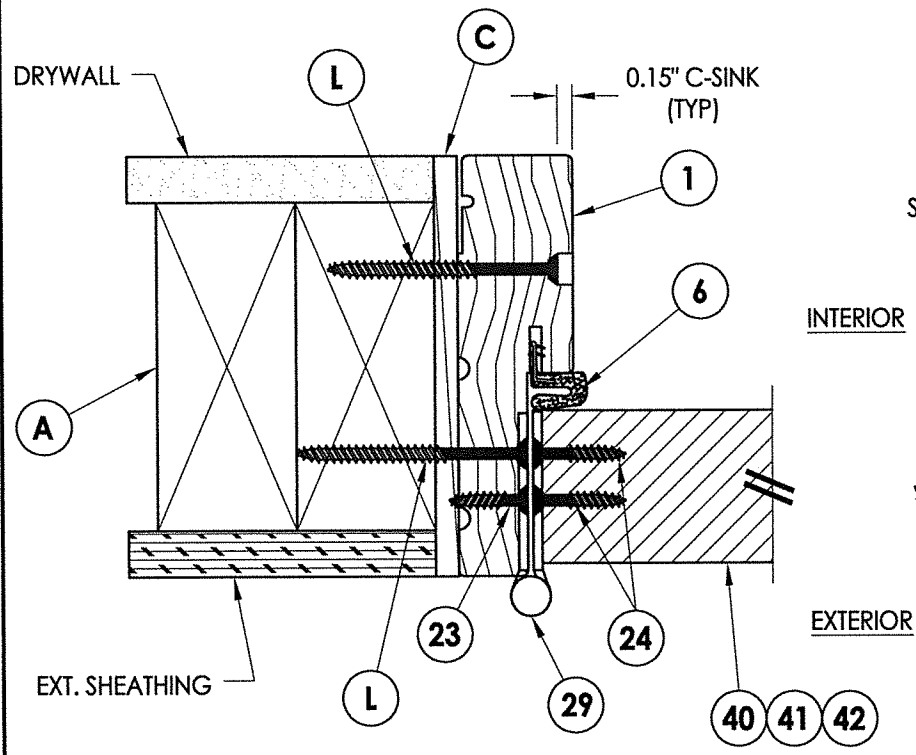

**1 HORIZONTAL CROSS SECTION**  
**5** Shown w/ 2X Buck  
 Outswing shown (Inswing similar)

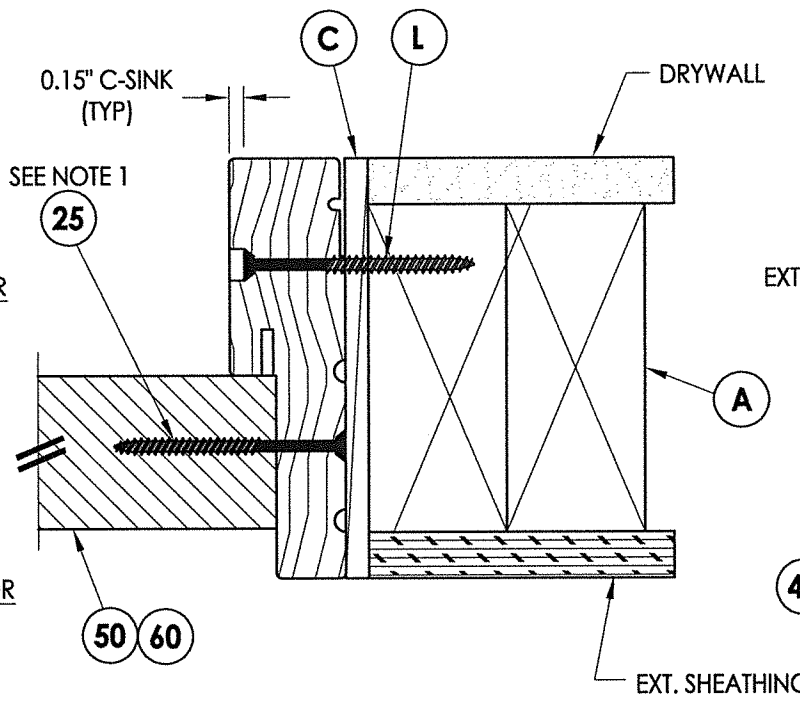

**2 HORIZONTAL CROSS SECTION**  
**5** Shown w/ 2X Buck  
 Outswing shown (Inswing similar)

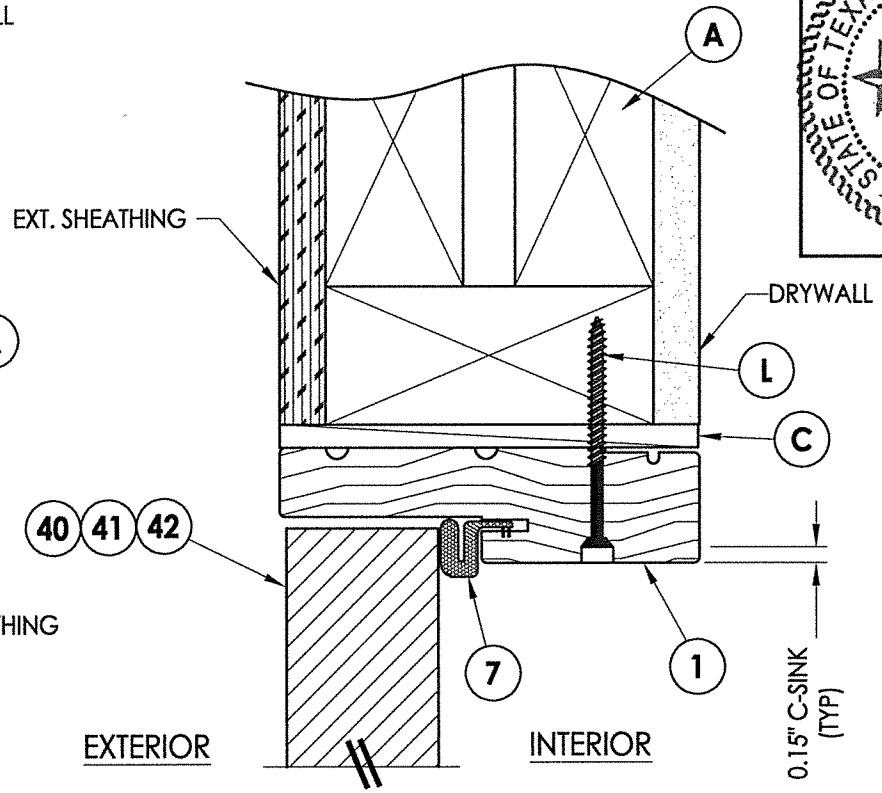

**3 VERTICAL CROSS SECTION**  
**5** Shown w/ 2X Buck  
 Outswing shown (Inswing similar)

Notes:  
 1. Sidelite assembly screws located 7" from top and 14" from bottom & 2 more screws equally spaced between (4 screws total per side jamb).  
 2. Sidelite assembly screws located 4" from each end (2 screws along head jamb).

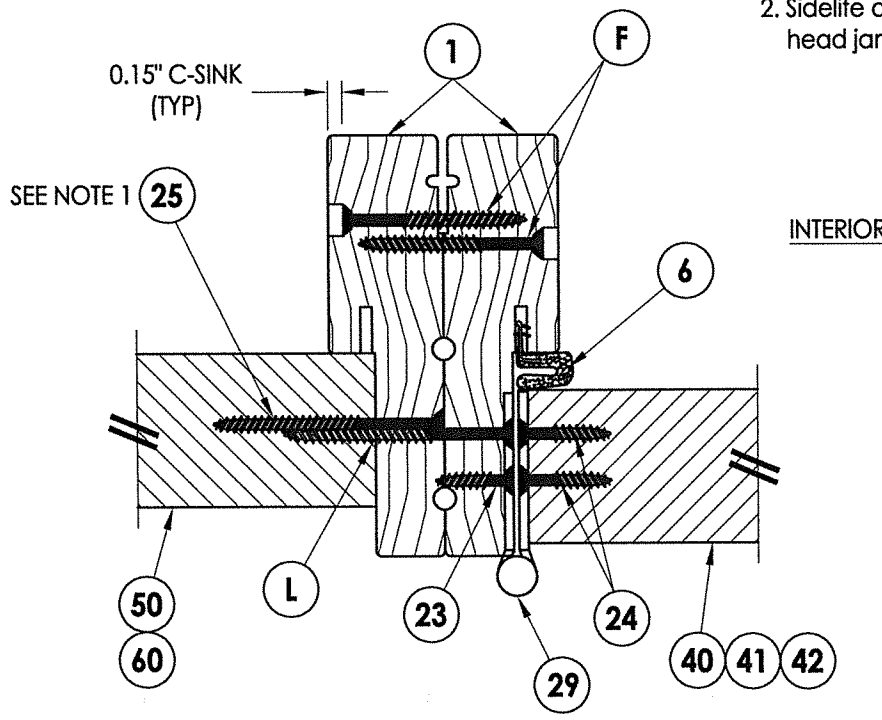

**5 HORIZONTAL CROSS SECTION**  
**5** Outswing shown (Inswing similar)

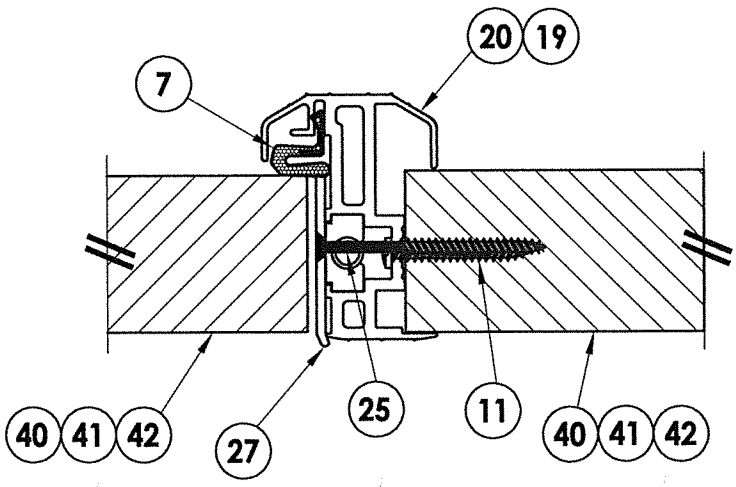

**6 HORIZONTAL CROSS SECTION**  
**5** Outswing shown (Inswing similar)

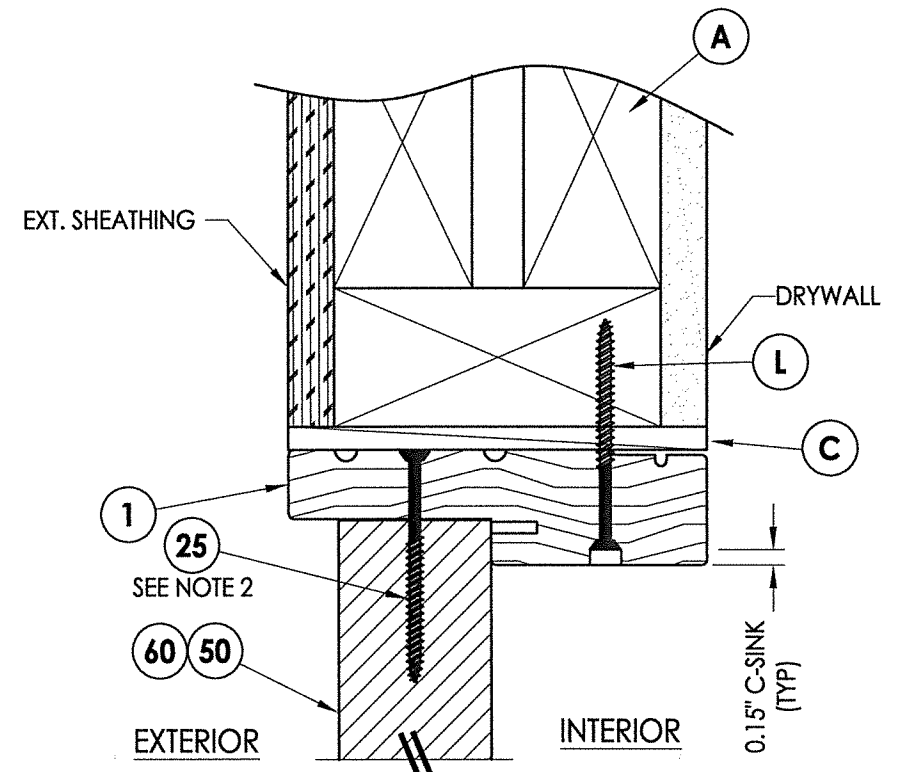

**4 VERTICAL CROSS SECTION**  
**5** Shown w/ 2X Buck  
 Outswing shown (Inswing similar)

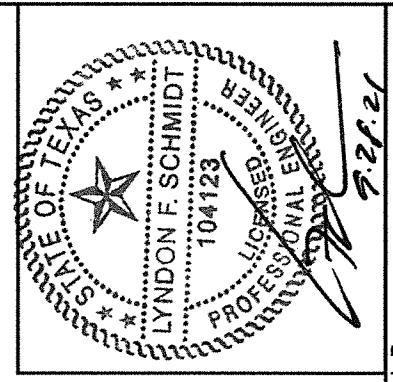

Documents Prepared By: Lyndon F. Schmidt, P.E.  
 TEXAS P.E. #104123  
**RW** BUILDING CONSULTANTS, INC.  
 P.O. Box 230 Valrico FL 33595  
 Phone No.: 813.659.9197  
 CERTIFICATE OF REGISTRATION # F-11852

PRODUCT: THERMA-TRU FIBERGLASS DOOR  
 PART OR ASSEMBLY: HORIZONTAL & VERTICAL CROSS SECTIONS

NO.	DATE	BY
1	9/28/21	LFS

DATE: 11/14/17  
 SCALE: N.T.S.  
 DWG. BY: JK  
 CHK. BY: LFS  
 DRAWING NO.: TX-4718  
 SHEET 5 OF 11

Z:\Clients\Therma Tru PERMANENT\B - Texas Dept of Ins\TDI - DR 947 - 6'8 & 8'0 Opaque Comp Edge Non-Impact (TX-4716 - 4727)\C - Drawings\TX-4716-18.dwg

**Notes:**

- Sill Item #'s 16, 32, 34, 35, 36, 37, 38 & 39 are attached to jambs w/ (3) #8 X 2-1/2" pfh screws at each end.  
Sill Item #'s 17 & 18 are attached to jambs w/ (2) #8 X 2-1/2" pfh screws at each end.  
Sill Item #15 is attached to jambs utilizing (2) #10 X 2" pph screws at each end.
- Sidelite assembly screws located 4" from each end (2 screws along sill).

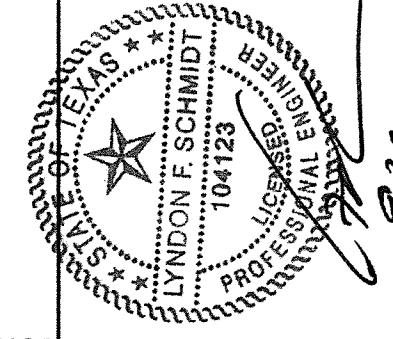

Documents Prepared By: Lyndon F. Schmidt, P.E.  
TEXAS P.E. #104123

RW BUILDING CONSULTANTS, INC.  
P.O. Box 230 Valrico FL 33595  
Phone No.: 813.659.9197

CERTIFICATE OF REGISTRATION # F-11852

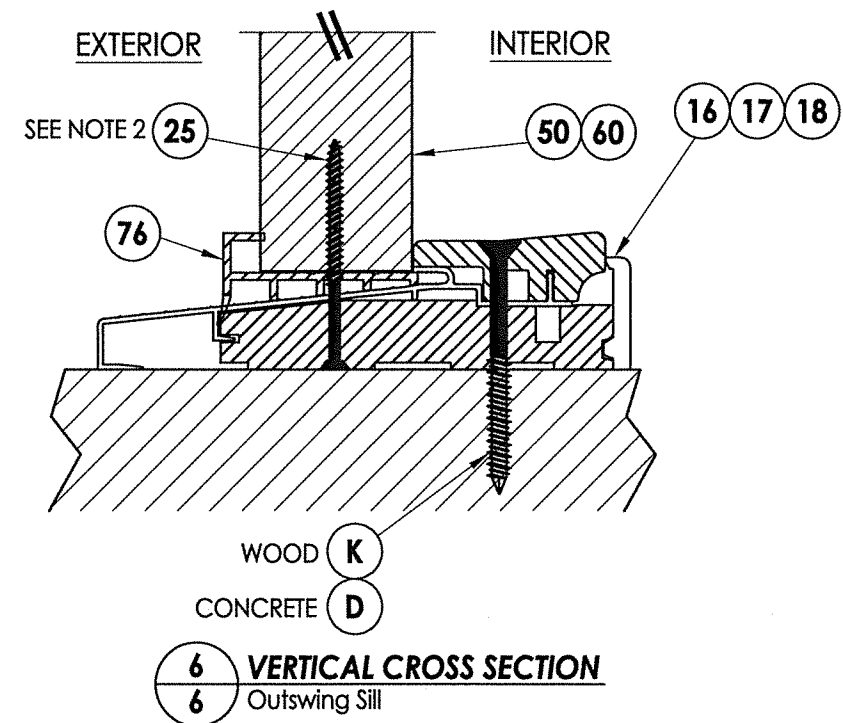
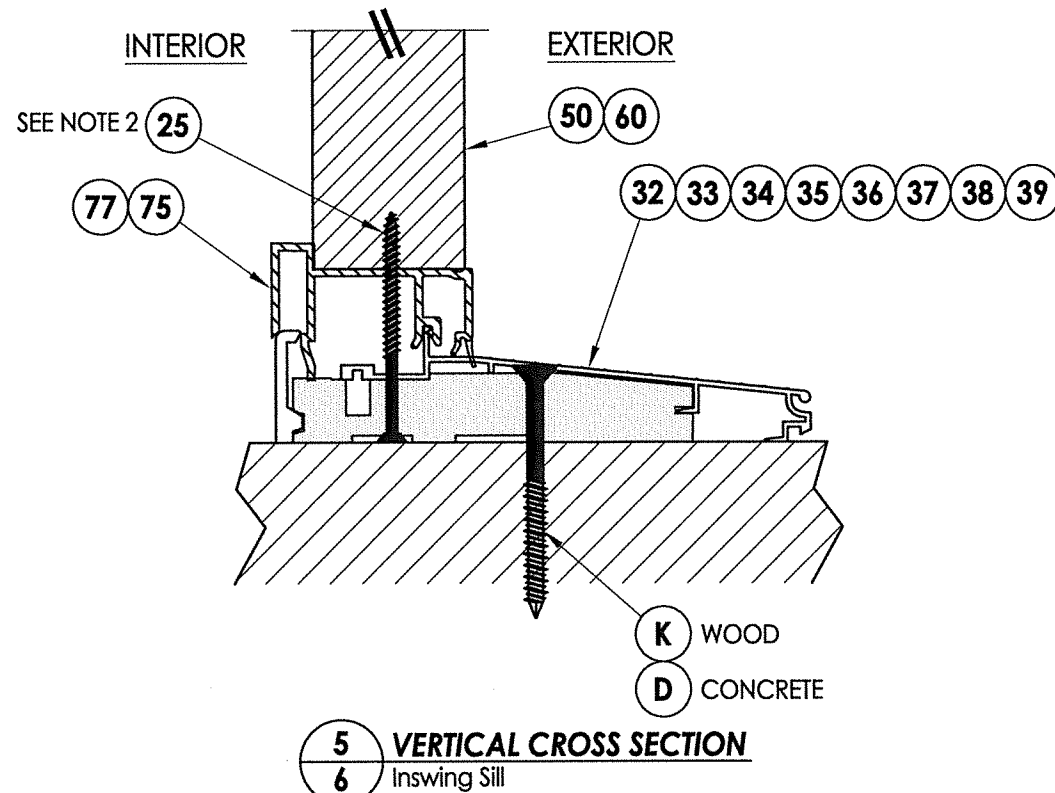
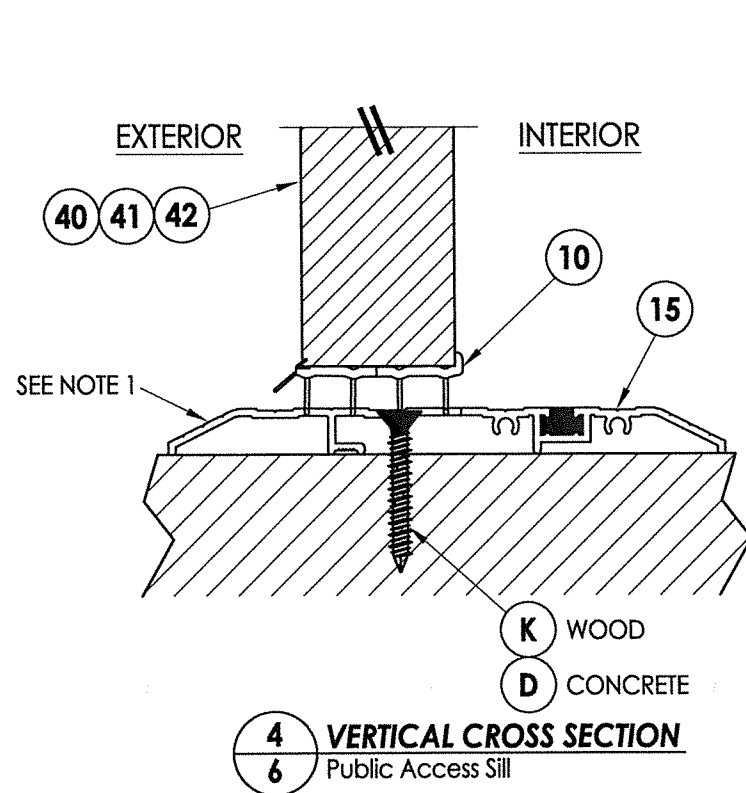
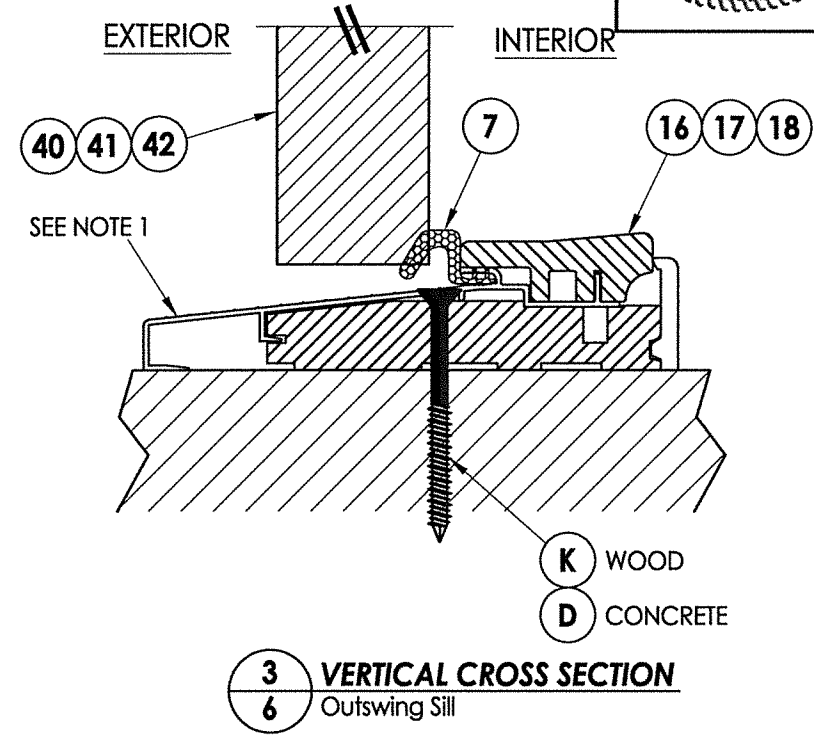
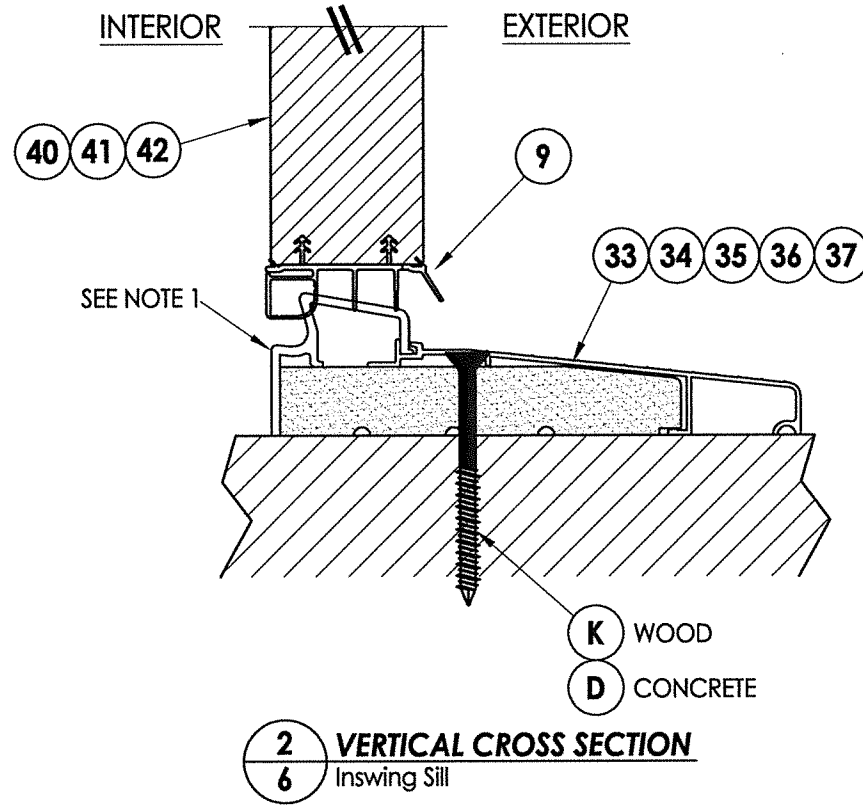
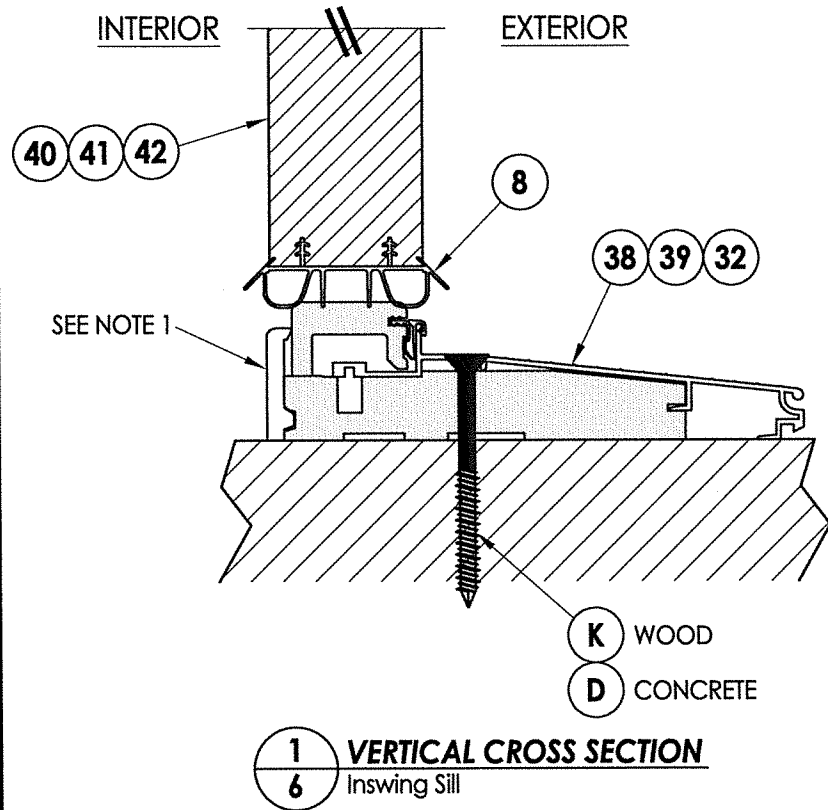

PRODUCT:		THERMA-TRU FIBERGLASS DOOR	
PART OR ASSEMBLY:		VERTICAL CROSS SECTIONS (THRESHOLDS)	
NO.	DATE	BY	LFS
1	9/28/21	DATE	DATE
UPDATE TO 2018 IBC/IRC CODE			
REVISIONS			
DATE: 11/14/17			
SCALE: N.T.S.			
DWG. BY: JK			
CHK. BY: LFS			
DRAWING NO.: TX-4718			
SHEET 6 OF 11			

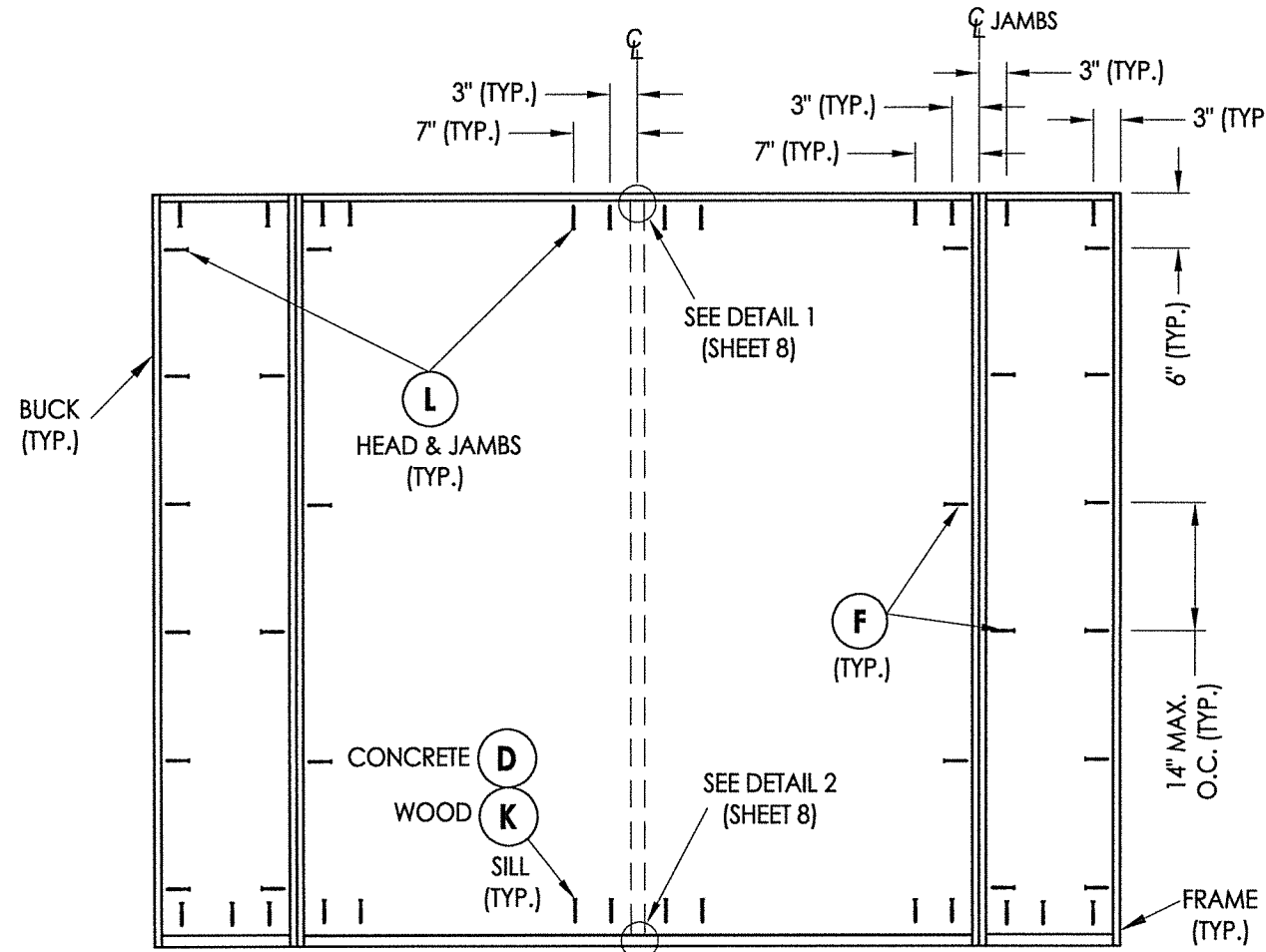
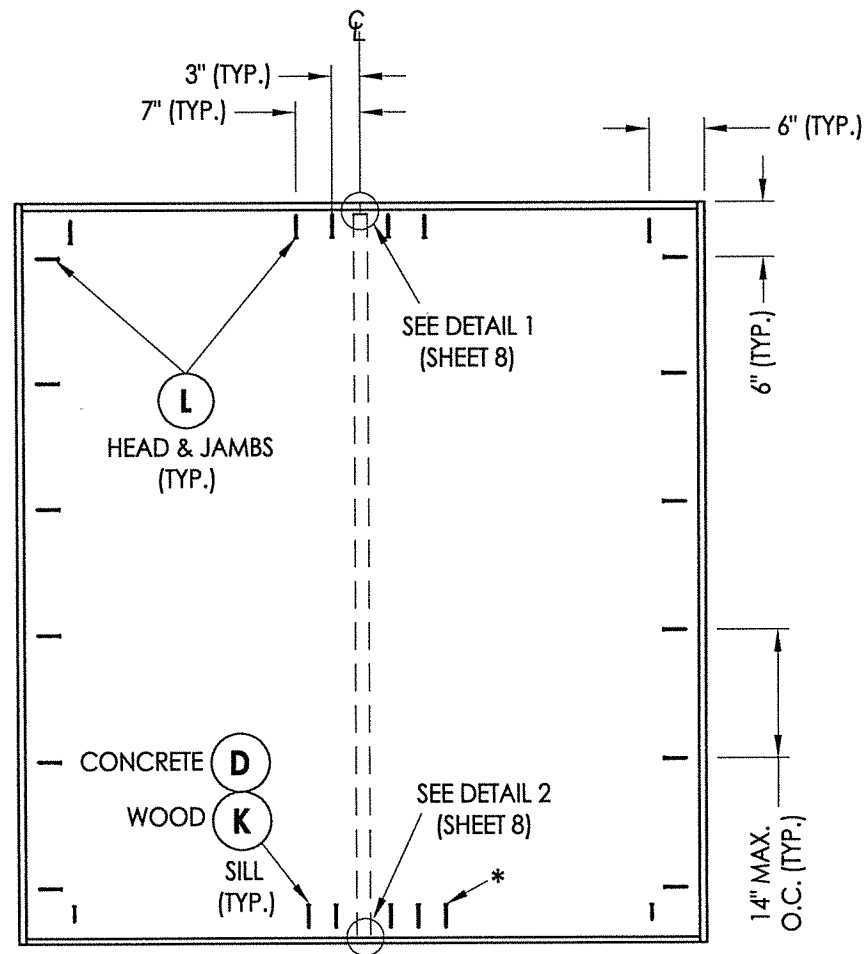
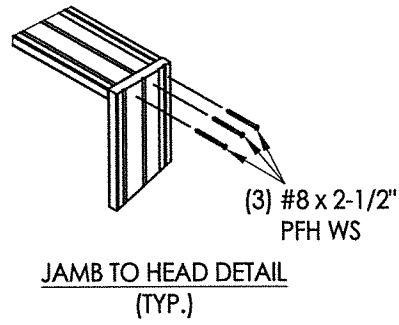

\* THIS ANCHOR REQ'D FOR DESIGN PRESSURE > 55 PSF ONLY

XX

OXXO

**FRAME ANCHORING**

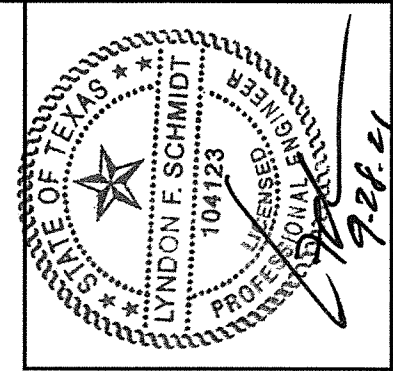

Documents Prepared By: Lyndon F. Schmidt, P.E.  
TEXAS P.E. #104123

**R.W.** BUILDING CONSULTANTS, INC.  
P.O. Box 230 Valrico FL, 33595  
Phone No.: 813.659.9197

CERTIFICATE OF REGISTRATION # F-11852

PRODUCT:	Therma-TRU FIBERGLASS DOOR
PART OR ASSEMBLY:	FRAME ANCHORING

NO.	DATE	REVISIONS
1	9/28/21	UPDATE TO 2018 IBC/IRC CODE
		LFS
		BY

DATE:	11/14/17
SCALE:	N.T.S.
DWG. BY:	JK
CHK. BY:	LFS
DRAWING NO.:	TX-4718
SHEET	7 OF 11

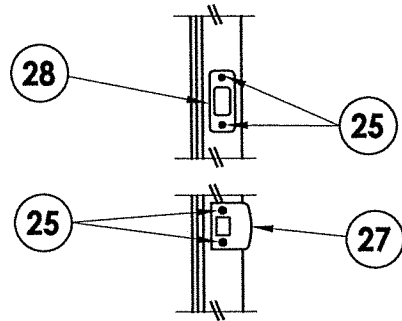

**LATCH & DEADBOLT DETAIL**  
Schlage / Kwikset

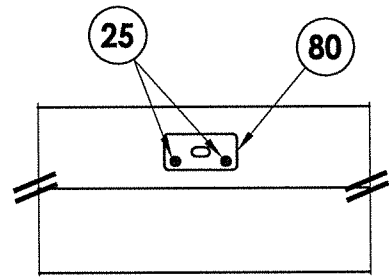

**DETAIL 1**  
Coastal Astragal Strike Plate @ Head

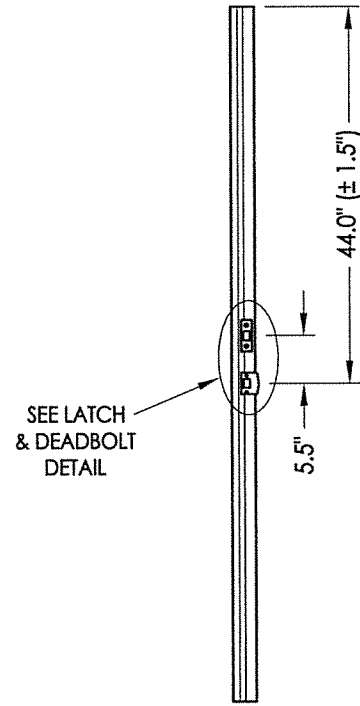

**ASTRAGAL**  
Latch and Deadbolt

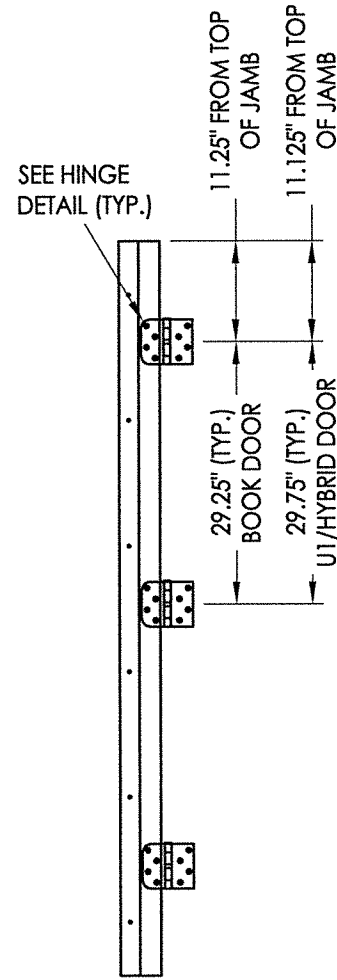

**HINGE JAMB**

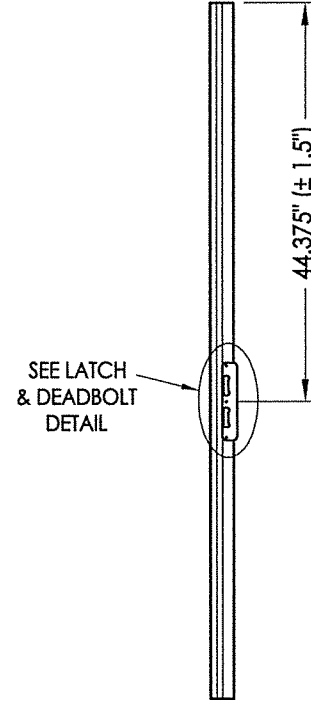

**ASTRAGAL**  
Multipoint Lock

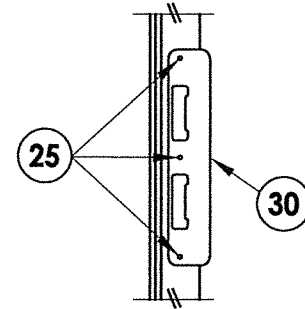

**LATCH & DEADBOLT DETAIL**  
Multipoint Lock

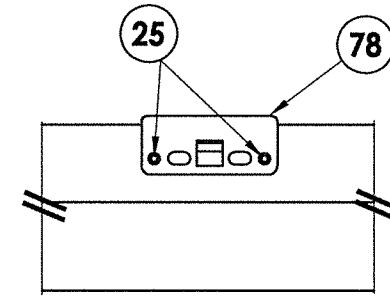

**DETAIL 1**  
Multipoint Lock Strike Plate @ Head

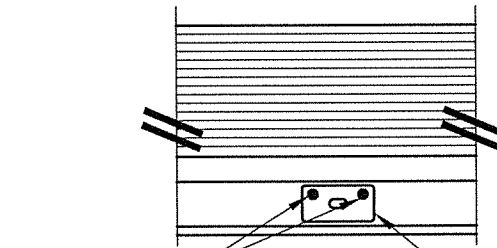

**DETAIL 2**  
Inswing  
Coastal Astragal Strike Plate @ Sill

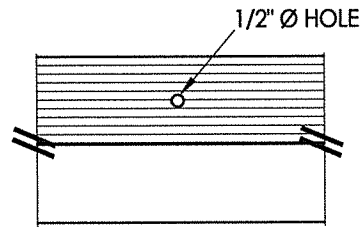

**DETAIL 2**  
Outswing  
Astragal Bolt Hole @ Sill

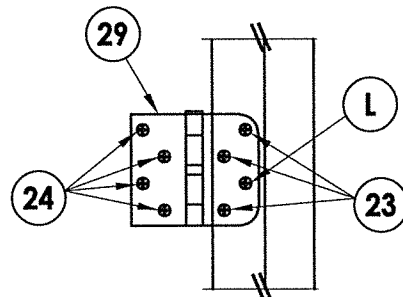

**HINGE DETAIL**

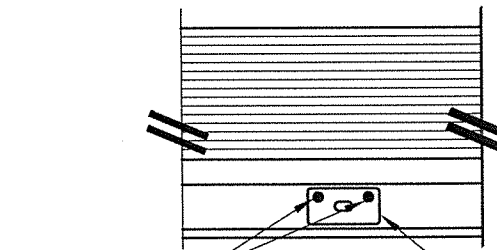

**DETAIL 2**  
Inswing  
Coastal Astragal Strike Plate @ Sill

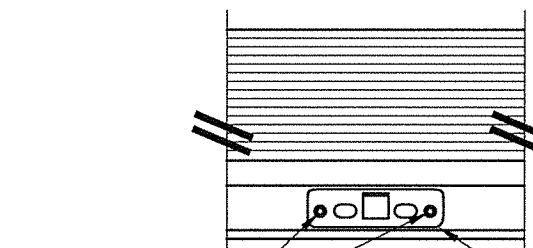

**DETAIL 2**  
Inswing  
Multipoint Lock Strike Plate @ Sill

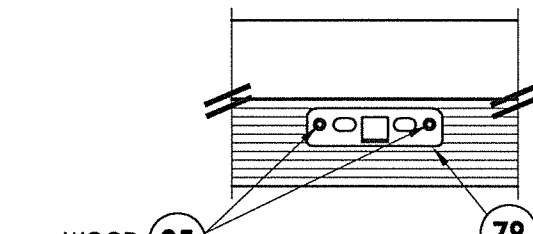

**DETAIL 2**  
Outswing  
Multipoint Lock Strike Plate @ Sill

**MULTIPOINT LOCK STRIKE DETAILS**

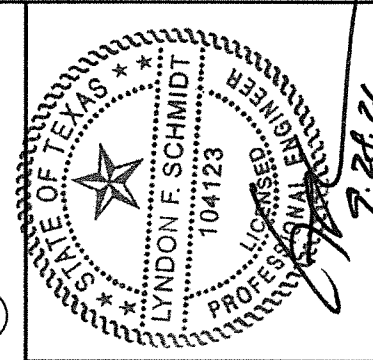

Documents Prepared By: Lyndon F. Schmidt, P.E.  
TEXAS P.E. #104123

**RW** BUILDING CONSULTANTS, INC.  
P.O. Box 230 Valrico FL 33595  
Phone No.: 813.659.9197

CERTIFICATE OF REGISTRATION # F-11852

PRODUCT:	THERMA-TRU FIBERGLASS DOOR
PART OR ASSEMBLY:	HARDWARE DETAILS

NO.	DATE	DESCRIPTION	BY
1	9/28/21	UPDATE TO 2018 IBC/IRC CODE	LFS

DATE:	11/14/17
SCALE:	N.T.S.
DWG. BY:	JK
CHK. BY:	LFS
DRAWING NO.:	TX-4718
SHEET	8 of 11



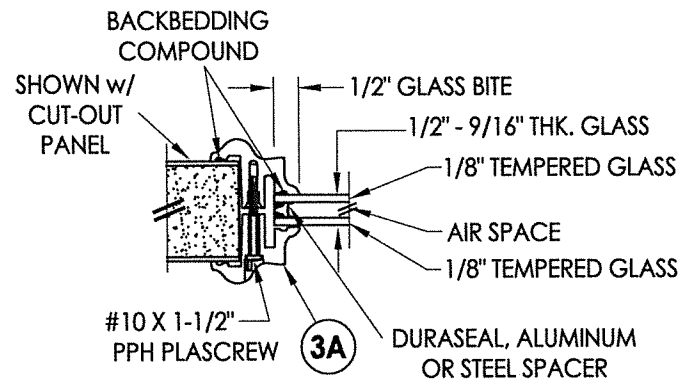

**G1 GLAZING DETAIL**  
BTS Lite Frame  
Sidelites

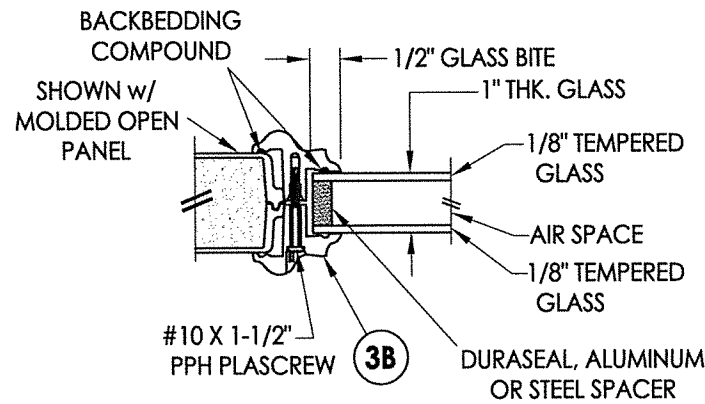

**G2 GLAZING DETAIL**  
BTS Lite Frame  
Sidelites

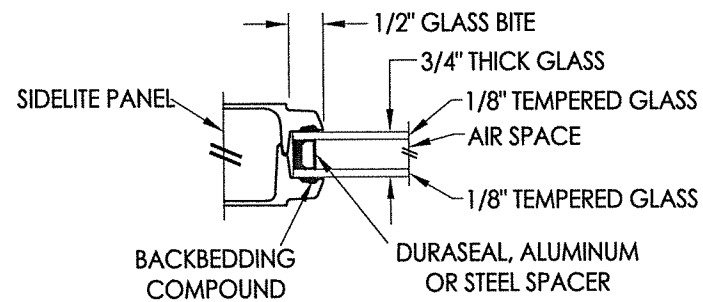

**G3 GLAZING DETAIL**  
Flush Glazing  
Sidelites

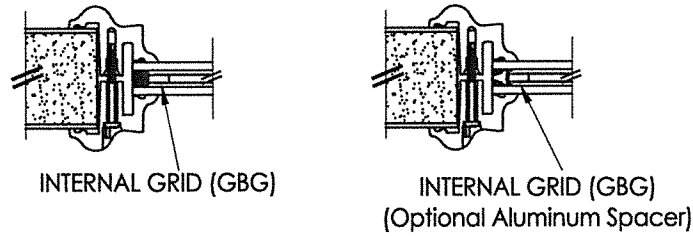

**9/16" INSULATED GLASS INSERT OPTIONS**

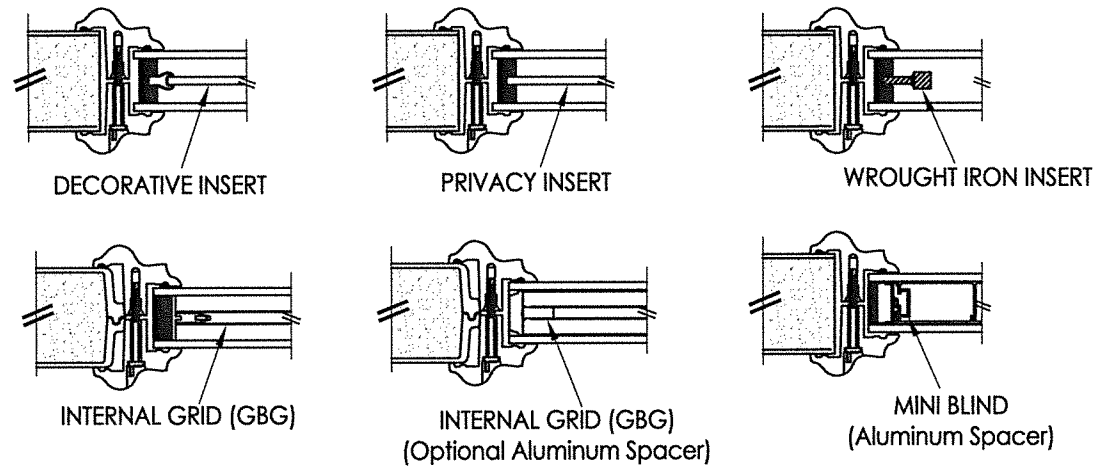

**1" INSULATED GLASS INSERT OPTIONS**

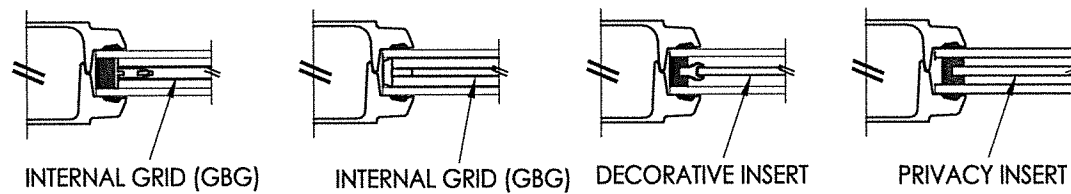

**3/4" INSULATED GLASS INSERT OPTIONS**

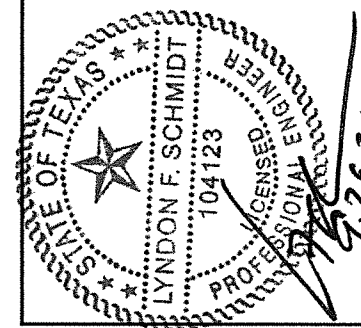

Documents Prepared By: Lyndon F. Schmidt, P.E.  
TEXAS P.E. #104123

**R.W.** BUILDING CONSULTANTS, INC.  
P.O. Box 230 Valrico FL 33595  
Phone No.: 813.659.9197

CERTIFICATE OF REGISTRATION # F-11852

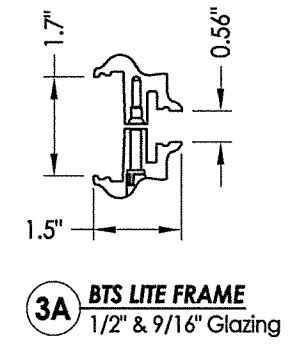

**3A BTS LITE FRAME**  
1/2" & 9/16" Glazing

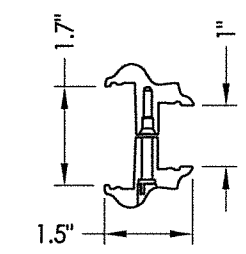

**3B BTS LITE FRAME**  
1" Glazing

PRODUCT: THERMA-TRU FIBERGLASS DOOR	
PART OR ASSEMBLY: GLAZING DETAILS	
NO.	DATE
1	9/28/21
UPDATE TO 2018 IBC/IRC CODE	
LFS	BY
REVISIONS	
DATE: 11/14/17	
SCALE: N.T.S.	
DWG. BY: JK	
CHK. BY: LFS	
DRAWING NO.: TX-4718	
SHEET 9 of 11	

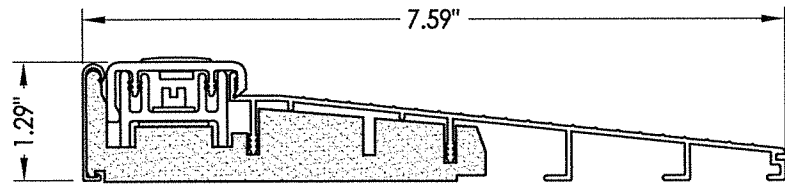

**32 INSWING THRESHOLD**  
Inswing Basic Composite Adjustable Sill 7-1/2"

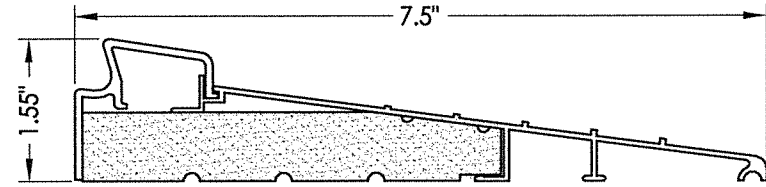

**37 INSWING THRESHOLD**  
Inswing Basic Fixed 7-1/2" Sill

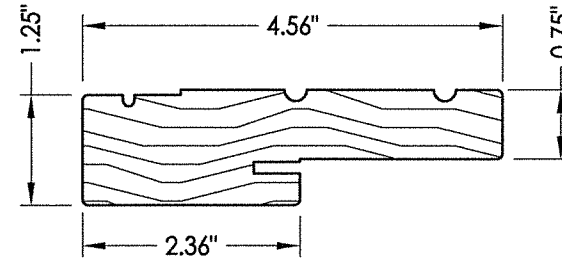

**1 WOOD JAMB**

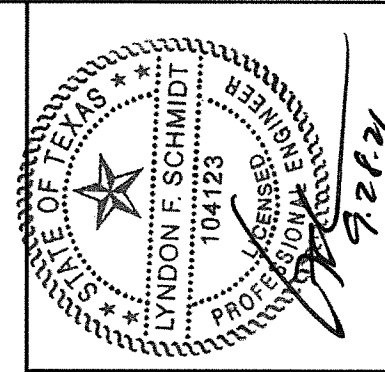

Documents Prepared By: Lyndon F. Schmidt, P.E.  
TEXAS P.E. #104123

**RW** BUILDING CONSULTANTS, INC.  
P.O. Box 230 Vairico FL 33595  
Phone No.: 813.659.9197

CERTIFICATE OF REGISTRATION # F-11852

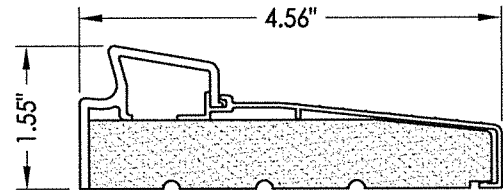

**33 INSWING THRESHOLD**  
Inswing Basic Fixed Sill

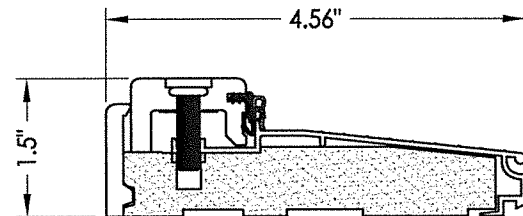

**38 INSWING THRESHOLD**  
Inswing Composite Adjustable Sill

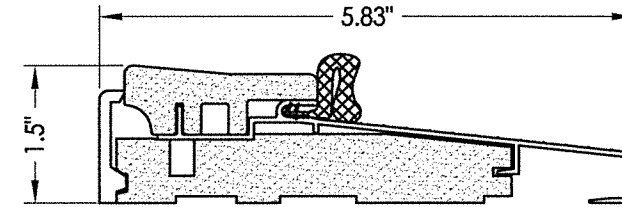

**16 OUTSWING THRESHOLD**  
Composite Sill

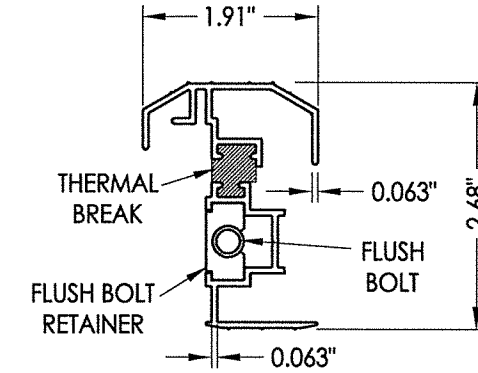

**19 STANDARD ALUMINUM ASTRAGAL**

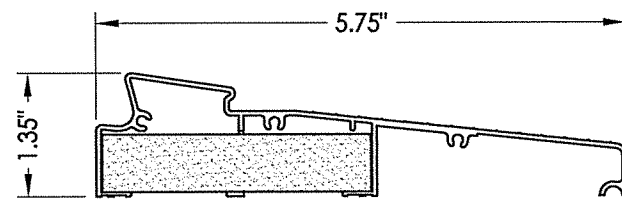

**34 INSWING THRESHOLD**  
Inswing Moderate Climate Sill 1-3/8"

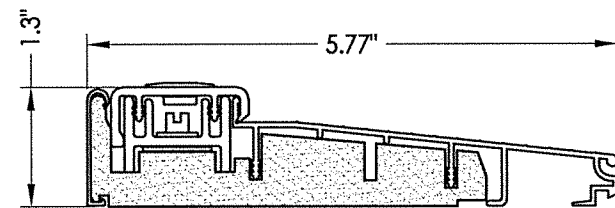

**39 INSWING THRESHOLD**  
Inswing Basic Composite Adjustable Sill

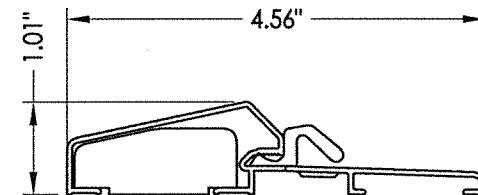

**17 OUTSWING THRESHOLD**  
Composite / Aluminum Sill

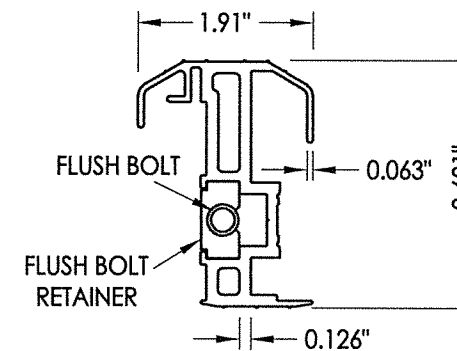

**20 COASTAL ALUMINUM ASTRAGAL**

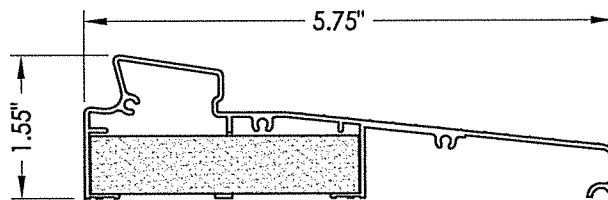

**35 INSWING THRESHOLD**  
Inswing Moderate Climate Sill

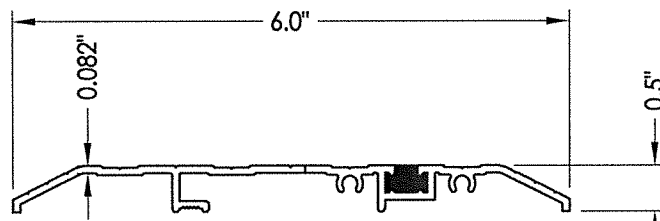

**15 PUBLIC ACCESS THRESHOLD**

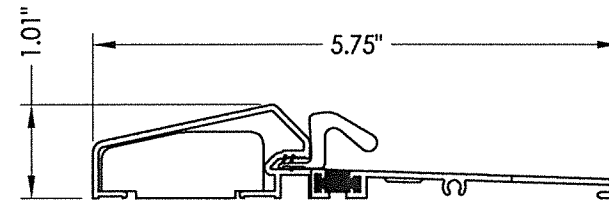

**18 OUTSWING THRESHOLD**  
Composite / Aluminum Sill (Thermal Break)

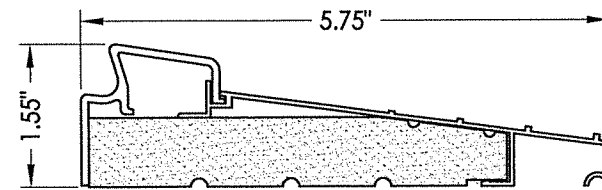

**36 INSWING THRESHOLD**  
Inswing Basic Fixed 5-3/4" Sill

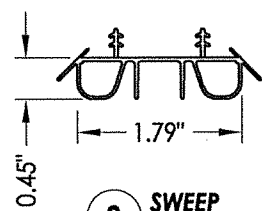

**8 SWEEP**

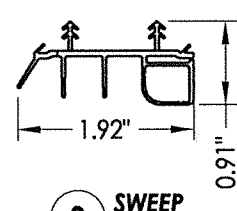

**9 SWEEP**

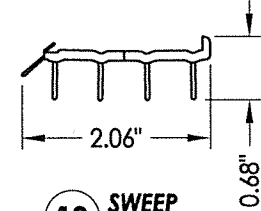

**10 SWEEP**

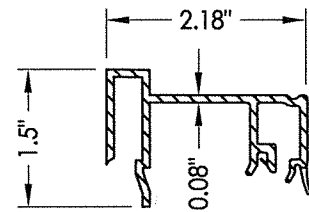

**75 SIDELITE SPACER**  
Inswing

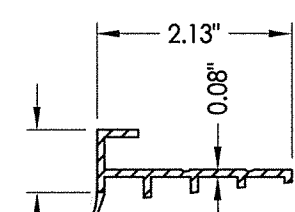

**76 SIDELITE SPACER**  
Outswing

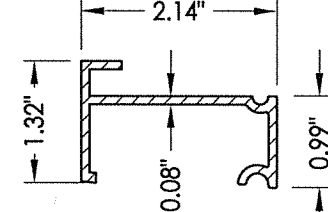

**77 SIDELITE SPACER**  
Inswing Moderate Climate Threshold

PRODUCT:	Therma-TRU FIBERGLASS DOOR
PART OR ASSEMBLY:	COMPONENTS

NO.	DATE	REVISIONS	LFS	BY
1	9/28/21	UPDATE TO 2018 IBC/IRC CODE	LFS	

DATE:	11/14/17
SCALE:	N.T.S.
DWG. BY:	JK
CHK. BY:	LFS
DRAWING NO.:	TX-4718
SHEET	10 of 11

