

GENERAL NOTES AND SPECIFICATIONS:

1. DOUBLE & SINGLE SERIES 8080 & 4080 EMBOSSED OUTSWING COMMERCIAL GALVANNEAL OR STAINLESS STEEL FRAME DOOR SHOWN ON THIS PRODUCT EVALUATION DOCUMENT (P.E.D.) HAS BEEN VERIFIED FOR CODE COMPLIANCE IN ACCORDANCE WITH THE 2018 EDITION OF THE INTERNATIONAL BUILDING CODE, (IBC).

DESIGN WIND LOADS SHALL BE DETERMINED AS PER SECTION 1609 OF THE INTERNATIONAL BUILDING CODE, FOR A BASIC WIND SPEED AS REQUIRED BY THE JURISDICTION WHERE PRODUCT WILL BE INSTALLED, AND FOR A DIRECTIONALITY FACTOR $K_d = 0.85$, IN ACCORDANCE WITH ASCE 7-16 STANDARD, AND SHALL NOT EXCEED THE DESIGN PRESSURE RATING INDICATED ON SHEET 3.

IN ORDER TO VERIFY THAT ANCHORS ON THIS P.E.D., AS TESTED, WERE NOT OVERSTRESSED, A 33% INCREASE IN ALLOWABLE STRESS FOR WIND LOADS WAS NOT USED IN THEIR ANALYSIS. FASTENERS SPACING TO WOOD HAS BEEN DETERMINED IN ACCORDANCE WITH N.D.S. 2018.

THIS DOOR'S ADEQUACY FOR IMPACT AND CYCLIC RESISTANCE HAS BEEN VERIFIED IN ACCORDANCE WITH SECTION 1609.2 OF THE ABOVE MENTIONED CODE AS PER FLORIDA HIGH VELOCITY HURRICANE ZONE PROTOCOLS TAS-201, TAS-202, TAS-203 AS PER CERTIFIED TESTING LABORATORY, REPORTS #CTLA 2045W, #CTLA 2045W-1, #CTLA 2045W-2, #CTLA 2045W-3 AND AS PER SUBMITTED STRUCTURAL CALCULATIONS, PERFORMED AS PER SECTION 1604 OF THE ABOVE MENTIONED BUILDING CODE.

2. ALL COMPONENTS SHALL BE AS SPECIFIED ON APPLICABLE DETAIL SHEETS AND AT BILL OF MATERIALS (SHEET 4) OF THIS DRAWING.

3. COMPLIANCE OF EGRESS / ESCAPE REQUIREMENTS OF THESE DOORS PER INTERNATIONAL BUILDING CODE TO BE DETERMINED BY BUILDING OFFICIALS ON A CASE-BY-CASE BASIS.

4. ALL SCREWS INSTALLED TO BE STAINLESS STEEL 304 OR 316 AISI SERIES AND MEET ASTM A167, OR HOT DIPPED GALVANIZED (AFTER FABRICATION) CARBON STEEL AS PER ASTM A123 OR ASTM A153, OR HOT DIPPED GALVANIZED OR GALVANNEALED (PRIOR TO FABRICATION) AND MEET ASTM A653 WITH 50 ksi YIELD STRENGTH AND 90 hsi TENSILE STRENGTH. BOLTS TO BE ASTM A-307 GALVANIZED STEEL OR AISI 304 SERIES STAINLESS STEEL, WITH 35 Ksi MINIMUM YIELD STRENGTH.

5. ALL WELDING TO CONFORM W/AMERICAN WELDING SOCIETY A.W.S. D.1.3 AND D-19.0 REGULATIONS WITH E60XX ELECTRODES, FOR GALVANNEALED MATERIAL, AND W/AMERICAN WELDING SOCIETY A.W.S. D.1.6 REGULATIONS W/ E-308 ELECTRODES (FU=80k.s.i.) FOR STAINLESS STEEL MATERIAL

6. ALL ANCHORS FOR DOOR FRAME CONNECTIONS TO EXISTING STRUCTURE SHALL BE AS SPECIFIED ON SHEET 10 OF THIS DRAWING. MAXIMUM ANCHORS SPACINGS SHALL BE AS PER SCHEDULE ON SHEET 10 AND ELEVATIONS ON SHEET 2 OF THIS DRAWING. SEE SHEET 2 FOR THRESHOLD ANCHORS, AND SHEET 2 FOR MULLION ANCHORS.

7. PROVIDE MAX. LOAD BEARING SHIM SPACE AS INDICATED ON SHEETS 3.

8. **THIS DOOR WILL NOT REQUIRE A HURRICANE PROTECTION DEVICE.** DOOR MEETS IMPACT RESISTANCE FOR TYPE "D" MISSILE FOR BASIC PROTECTION.

9. THESE DOOR ASSEMBLIES ARE APPROVED FOR WATER AND AIR INFILTRATION AS PER TESTING INDICATED ON GENERAL NOTE 1, AND SHALL BE LIMITED TO DESIGN PRESSURE RATINGS INDICATED ON SHEET 3.

10. PROVIDE SPECIFIED SEALANT AT ALL DOOR FRAME & THRESHOLD COMPONENTS INDICATED ON THIS DRAWING.

11. ALL EXISTING WALLS (STRUCTURE) WHERE DOOR IS TO BE INSTALLED MUST BE BUILT IN ACCORDANCE WITH THE INTERNATIONAL BUILDING CODE AND SHALL BE DESIGNED TO SUSTAIN THE SUPERIMPOSED LOADS TRANSFERRED BY THE DOOR SYSTEM.

12. WOOD BUCKS BY OTHERS, MUST BE ANCHORED PROPERLY TO TRANSFER LOADS TO THE BUILDING STRUCTURE. WOOD BUCKS MUST BE SOUTHERN PINE, $G = 0.55$.

13. ALL ALUMINUM EXTRUSIONS IN CONTACT WITH DISSIMILAR MATERIALS SHALL COMPLY WITH SECTION III-6 OF THE ALUMINUM DESIGN MANUAL 2015 EDITION.

14. PERMIT HOLDER SHALL VERIFY THE ADEQUACY OF THE EXISTING STRUCTURE TO SUSTAIN THE SUPERIMPOSED LOADS TRANSFERRED BY THESE DOORS.

15. (a) THIS P.E.D. PREPARED BY THIS ENGINEER IS GENERIC AND DOES NOT PROVIDE INFORMATION FOR A SITE SPECIFIC PROJECT; I.E. WHERE THE SITE CONDITIONS DEVIATE FROM THE P.E.D.

(b) CONTRACTOR TO BE RESPONSIBLE FOR THE SELECTION, PURCHASE AND INSTALLATION INCLUDING LIFE SAFETY PER THE PRODUCT, BASED ON THIS P.E.D. PROVIDED HE/SHE DOES NOT DEVIATE FROM THE CONDITIONS DETAILED ON THIS DOCUMENT, CONSTRUCTION SAFETY AT SITE IS THE CONTRACTOR'S RESPONSIBILITY.

(c) THIS P.E.D. WILL BE CONSIDERED INVALID IF ALTERED BY ANY MEANS.

(d) SITE SPECIFIC PROJECTS SHALL BE PREPARED BY A PROFESSIONAL ENGINEER OR ARCHITECT WHICH WILL BECOME THE ENGINEER OF RECORD (E.O.R.) FOR THE PROJECT AND WHO WILL BE RESPONSIBLE FOR THE PROPER USE OF THE P.E.D.

(e) ORIGINAL P.E.D. SHALL BEAR THE DATE AND ORIGINAL SEAL AND SIGNATURE OF THE PROFESSIONAL ENGINEER OF RECORD THAT PREPARED IT.

16. PRODUCT MANUFACTURER'S LABEL SHALL BE LOCATED ON A READILY VISIBLE LOCATION AT PRODUCT IN ACCORDANCE WITH TEXAS DEPARTMENT OF INSURANCE REQUIREMENTS. ONE LABEL SHALL BE PLACED FOR EVERY OPENING.

SHEETS CONTENT:

- SHEET #1 INDEX, COVER SHEET & GENERAL NOTES.
- SHEET #2 ASSEMBLY ELEVATIONS No 1 & 2.
- SHEET #3 MAX. DESIGN PRESSURE RATING (psf.) SCHEDULE.
- SHEET #4 BILL OF MATERIALS.
- SHEET #5 COMPONENTS.
- SHEET #6 DOOR CONSTRUCTION DETAILS.
- SHEET #7 VERTICAL SECTIONS AND DOOR FRAME DETAILS.
- SHEET #8 HORIZONTAL SECTIONS & VERTICAL SECTIONS AT HARDWARE.
- SHEET #9 RIM EXIT DEVICE W/ REMOVABLE MULLION.
- SHEET #10 ANCHOR DETAILS & MAX. SPACING SCHEDULE.

THIS DRAWING SHALL ONLY BE USED TO OBTAIN PERMITS UNDER THE TEXAS DEPARTMENT OF INSURANCE JURISDICTION

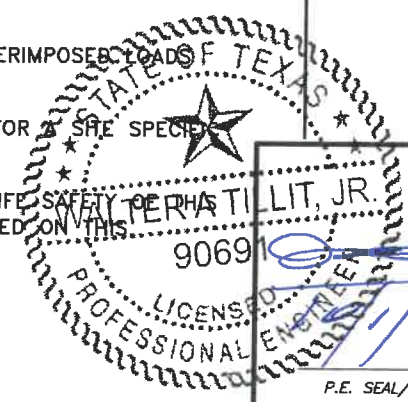

WALTER A. TILLIT Jr P.E.
 PROFESSIONAL ENGINEER
 6355 N.W 36 STREET, STE. 305
 VIRGINIA GARDENS, FL 33166
 PHONE(305) 871-1530 FAX (305) 871-1531
 TEXAS LIC. # 90691
 FIRM REGISTRATION # F-13790

TEXAS DEPARTMENT OF INSURANCE - 2018					
DOUBLE & SINGLE SERIES 8080 & 4080 OUTSWING COMMERCIAL GALVANNEAL OR STAINLESS STEEL FRAME DOOR FLUSH OR EMBOSSED				DRAWN BY: M.P.	
DAYBAR INDUSTRIES LTD				9/29/2021 DATE	
50 WEST DRIVE, BRAMPTON, ON CANADA, L6T 2J4 TEL: 905 625-8000 FAX: 905 625-4204				21-125 DRAWING No	
REV. No	DESCRIPTION	DATE	REV. No	DESCRIPTION	DATE
1	OLD 17-056	9/29/21	3		
2			4		

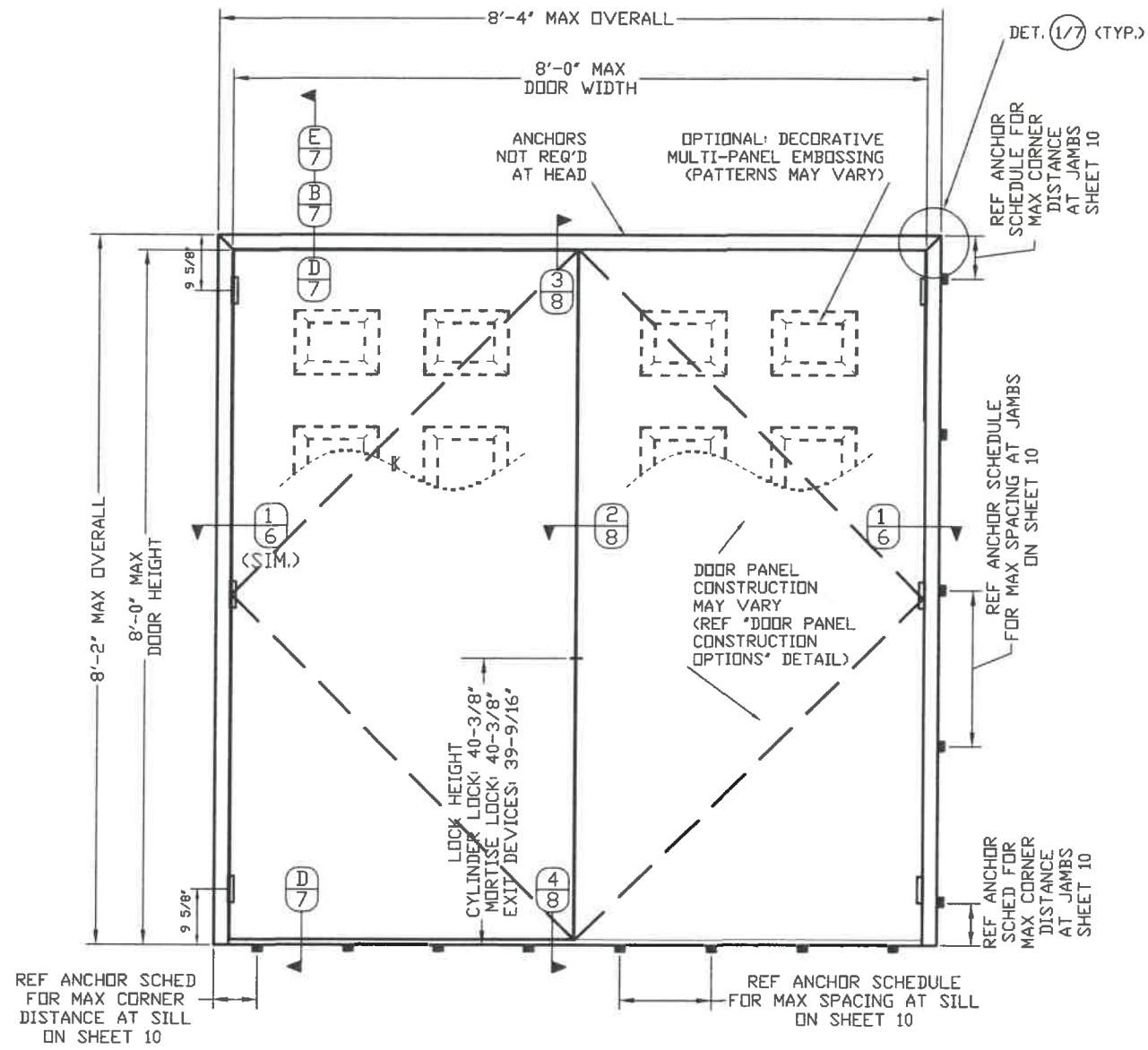

DOUBLE DOOR EXTERIOR ELEVATION: SERIES 8080

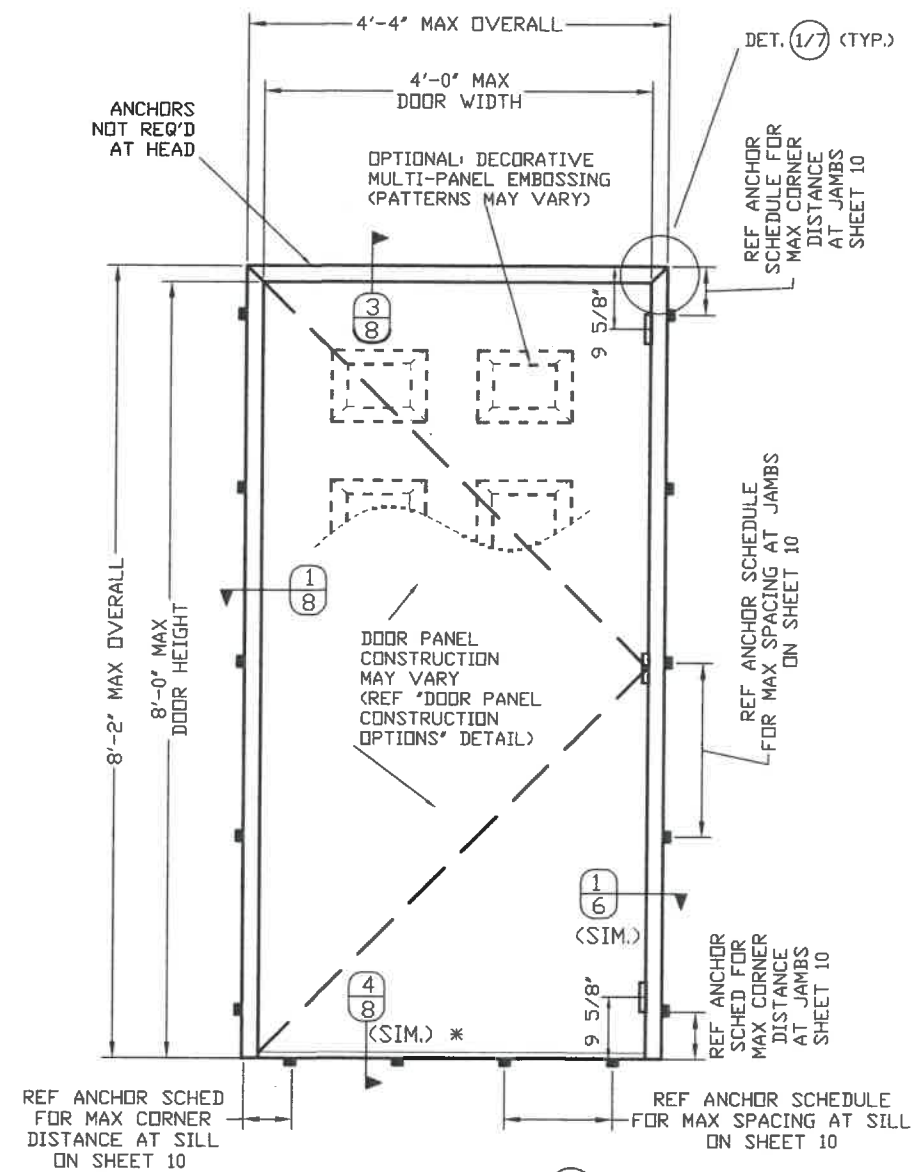

SINGLE DOOR EXTERIOR ELEVATION: SERIES 4080

* NO (18) REQUIRED AT SINGLE DOOR.

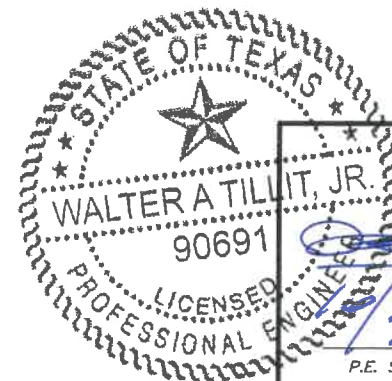

P.E. SEAL/SIGNATURE/DATE

WALTER A. TILLIT Jr. P.E.
 PROFESSIONAL ENGINEER
 6355 N.W. 36 STREET, STE. 305
 VIRGINIA GARDENS, FL 33166
 PHONE(305) 871-1530 FAX (305) 871-1531
 TEXAS LIC. # 90691
 FIRM REGISTRATION # F-13790

TEXAS DEPARTMENT OF INSURANCE - 2018					
DOUBLE & SINGLE SERIES 8080 & 4080 OUTSWING COMMERCIAL GALVANNEAL OR STAINLESS STEEL FRAME DOOR FLUSH OR EMBOSSED				DRAWN BY: M.P.	
DAYBAR INDUSTRIES LTD				9/29/2021 DATE	
50 WEST DRIVE, BRAMPTON, ON CANADA, L6T 2J4 TEL: 905 625-8000 FAX: 905 625-4204				21-125 DRAWING No	
REV. No	DESCRIPTION	DATE	REV. No	DESCRIPTION	DATE
1	OLD 17-056	9/29/21	3		
2			4		

MAX. DESIGN PRESSURE RATING (psf.) SCHEDULE FOR INSTALLATIONS COVERING SERIES 8080 & SERIES 4080 DOORS FOR A GIVEN ANCHOR JAMB TYPE *

ITEM (SEE SHEET 5)	ANCHOR SPECIFICATIONS AT JAMBS *	SERIES 8080 DOOR (SEE SHEET 2)	SERIES 4080 DOOR (SEE SHEET 2)
35	0.157" DIA.x9 1/2" LONG WIRE ANCHOR (SEE DETAIL 1/10)	+50, -50	+70, -70
36	2 PIECE COMBINATION STUD ANCHOR (SEE DETAIL 5/10 & 5A/10)	+50, -50	+70, -70
37	EXISTING MASONRY ANCHOR & E.M.A. (SEE DETAIL 2/10)	+50, -50	+70, -70
37	EXISTING WOOD BUCK ANCHOR W/WOOD SCREW LAG BOLT & E.M.A. (SEE DETAIL 3/10)	+50, -50	+70, -70
37	EXISTING WOOD BUCK ANCHOR W/ STEEL CARRIAGE BOLT & E.M.A. (SEE DETAIL 4/10)	+50, -50	+70, -70
37	CHANNEL IRON THROUGH BOLTING W/3/8" x 3 1/2" STEEL FLAT HEAD MACHINE SCREW & E.M.A. (SEE DETAIL 6/10)	+50, -50	+70, -70
-	CHANNEL IRON W/3/8" STITCH WELD (SEE DETAIL 7/10)	+50, -50	+70, -70

* NOTES ON FRAME HEAD REQUIREMENTS

1. FOR SINGLE & DOUBLE DOORS INSTALLED AT WOOD FRAME BUILDINGS, DOOR HEADS SHALL BE CONTINUOUSLY RETAINED BY EXISTING BUILDINGS WOOD HEADER FOLLOWING DETAILS AS PER SECTION E, SHEET 7.
2. FOR SINGLE & DOUBLE DOORS INSTALLED AT STEEL FRAME BUILDINGS, DOOR HEADS SHALL BE CONTINUOUSLY WELDED TO EXISTING BUILDINGS STEEL FRAME HEADER FOLLOWING DETAILS AS PER SECTION E, SHEET 7 & DETAIL 7 ON SHEET 10.
3. FOR SINGLE & DOUBLE DOORS INSTALLED AT CONCRETE /MASONRY BUILDINGS, DOOR HEADS NEED NOT BE ATTACHED TO EXISTING BUILDINGS HEADER. APPLICABLE TO SECTION E, SHEET 7/8.



WALTER A. TILLIT Jr P.E.
 PROFESSIONAL ENGINEER
 6355 N.W 36 STREET, STE. 305
 VIRGINIA GARDENS, FL 33166
 PHONE(305) 871-1530 FAX (305) 871-1531
 TEXAS LIC. # 90691
 FIRM REGISTRATION # F-13790

TEXAS DEPARTMENT OF INSURANCE - 2018					
DOUBLE & SINGLE SERIES 8080 & 4080 OUTSWING COMMERCIAL GALVANNEAL OR STAINLESS STEEL FRAME DOOR FLUSH OR EMBOSSED				DRAWN BY: M.P.	
DAYBAR INDUSTRIES LTD 50 WEST DRIVE, BRAMPTON, ON CANADA, L6T 2J4 TEL: 905 625-8000 FAX: 905 625-4204				9/29/2021 DATE	
				21-125 DRAWING No	
REV. No	DESCRIPTION	DATE	REV. No	DESCRIPTION	DATE
1	OLD 17-056	9/29/21	3		
2			4		

BILL OF MATERIALS:

ITEM	DESCRIPTION	MATERIAL	SIZE AND SPEC'S
1	PERIMETER FRAME (HEAD, SILL, JAMB)	16ga (0.051") GALVANNEALED STEEL: ASTM A653, TYPE B, WITH A40 PAINTABLE GALV. COATING	(Fy=45ksi, Fu=52ksi) OR AISI 304 SERIES STAINLESS STEEL (Fy=45ksi, Fu=101ksi).
2	DOOR PANEL ASSEMBLY (FLUSH OR EMBOSSED)	GALVANNEALED STEEL: ASTM A924, ASTM A653, TYPE B, WITH A40 PAINTABLE GALV. COATING	(Fy=45ksi, Fu=60ksi) OR AISI 304 SERIES STAINLESS STEEL (Fy=45ksi, Fu=101ksi).
4	THRESHOLD: HAGER 477S	EXTRUDED ALUMINUM 6063-T5 WITH VINYL BUMPER	
5	THRESHOLD: HAGER 520S	EXTRUDED ALUMINUM 6063-T5 WITH VINYL BUMPER	
6	DOOR TOP/BOTTOM CHANNEL: 1.6875' x 1.439'	16ga (0.051") GALVANNEAL STEEL (ASTM A653 WITH G60 COATING) OR S.S (AISI 304 SERIES)	
7	DOOR SNAP-IN TOP/BOTTOM CAP: 1.5625' x 1.00'	20ga (0.032") GALVANNEAL STEEL (ASTM A653 WITH G60 COATING) OR S.S (AISI 304 SERIES)	
8	CONTINUOUS HINGE: HAGER ROTON 780-224 HD	6063-T6 ALUMINUM	
9A	FULL MORTISE HINGE (STANDARD): HAGER #BB-1279	STEEL (PER MFR'S SPECS)	MIN. 4' TO 4.5'x4.5' STANDARD WEIGHT (.134 THK.), ATTACHED TO FRAME W/(4) 12-24x1/2' FHMS.
9B	FULL MORTISE HINGE (STANDARD): HAGER #BB-1191	STAINLESS STEEL (PER MFR'S SPECS)	MIN. 4' TO 4.5'x4.5' STANDARD WEIGHT (.134 THK.), ATTACHED TO FRAME W/(4) 12-24x1/2' FHMS.
10A	FULL MORTISE HINGE (HEAVY): HAGER #BB-1168	STEEL (PER MFR'S SPECS)	MIN. 4' TO 4.5'x4.5' STANDARD WEIGHT (.134 THK.), ATTACHED TO FRAME W/(4) 12-24x1/2' FHMS.
10B	FULL MORTISE HINGE (HEAVY): HAGER #BB-1199	STAINLESS STEEL (PER MFR'S SPECS)	MIN. 4' TO 4.5'x4.5' STANDARD WEIGHT (.134 THK.), ATTACHED TO FRAME W/(4) 12-24x1/2' FHMS.
11	RIM EXIT DEVICE: HAGER 4500 SERIES	STAINLESS STEEL (PER MFR'S SPECS)	
12	RIM STRIKE: HAGER 4920F FOR RIM EXIT DEVICE (11) AT JAMB (1)	STAINLESS STEEL (PER MFR'S SPECS)	W/ TOP LATCH #492 & #4928 AT ENDS. SEE SHEET 5A FOR SIZES
13	SVR EXIT DEVICE: HAGER 4500 SERIES	STAINLESS STEEL (PER MFR'S SPECS)	
14	SVR TOP STRIKE: HAGER 4923F FOR SVR EXIT DEVICE (13) AT HEADER (1)	STAINLESS STEEL (PER MFR'S SPECS)	SEE SHEET 5A FOR SIZES
15	CYLINDRICAL LOCK: HAGER 3400 OR 3500 SERIES	STAINLESS STEEL (PER MFR'S SPECS)	
16	DEAD BOLT: HAGER 3100 SERIES	STAINLESS STEEL (PER MFR'S SPECS)	
17	MORTISE LOCKSET W/ DEADBOLT: HAGER 3800 SERIES	STAINLESS STEEL (PER MFR'S SPECS)	
18	SURFACE BOLT: HAGER #275D (8' LONG)	STAINLESS STEEL (PER MFR'S SPECS)	
19	DOOR HINGE STILE REINFORCEMENT (REQ'D. FOR MORTISE HINGES ONLY)	8ga GALVANNEAL STEEL OR STAINLESS STEEL	
20	FRAME HINGE REINFORCEMENT (REQUIRED FOR MORTISE HINGES ONLY)	8ga GALVANNEAL STEEL OR STAINLESS STEEL	
21	ASTRAGAL STRIKE REINFORCEMENT	12ga GALVANNEAL STEEL OR STAINLESS STEEL	
22	FRAME STRIKE REINFORCEMENT	14ga (0.074") GALVANNEAL STEEL OR STAINLESS STEEL	
23	DOOR LOCK STILE REINF (MORTISE LOCK): 3.500' x 1.660'	14ga (0.074") GALVANNEAL STEEL OR STAINLESS STEEL	
24	CYLINDRICAL LOCK AND DEADBOLT REINFORCEMENT	STEEL, SATIN COATING	
25	DOOR SURFACE BOLT REINFORCEMENT: 1.688' x 3.5' x 9'	14ga (0.074") GALVANNEAL STEEL OR STAINLESS STEEL	
26	DOOR CLOSER REINFORCEMENT: 1.688' x 3.5' x 16.25'	14ga (0.074") GALVANNEAL STEEL OR STAINLESS STEEL	
27	BUTTERFLY ANCHOR CLIP: EMA #PT1-008	STEEL (PER MFR'S SPECS)	
28	MASONRY WIRE ANCHOR	STEEL: Fy=40ksi, Fu=96ksi	
29	CLIP-IN STUD ANCHOR	20ga (0.035") ASTM A653 A-60 GALVANNEALED STEEL	
30	ASTRAGAL WEATHERSTRIPPING: HAGER 872S	PER MFR'S SPECS (NEOPRENE INSERT)	
31	ASTRAGAL WEATHERSTRIPPING: HAGER 874S	PER MFR'S SPECS (NEOPRENE INSERT)	
32	PRESS-ON WEATHERSTRIPPING: HAGER 726S	SILICONE, SELF-ADHESIVE	
33	PERIMETER WEATHERSTRIPPING: HAGER 891S	PER MFR'S SPECS (VINYL BUMPER)	
34	DOOR SWEEP: HAGER 770S	PER MFR'S SPECS (VINYL BUMPER)	
35	WIRE MASONRY FRAME ANCHORS	STEEL W/ MIN. YIELD STRENGTH = 40.2ksi AND MIN. TENSILE STRENGTH = 95.9 Ksi	9 1/2" LONG X 0.157" MIN. DIAMETER.
36	CLIPIN STUD ANCHORS (2 PIECE COMBINATION)	STEEL, ASTM A-653, A-60 GALVANNEAL	1 7/8" X 5 5/8" X 20 GAUGE (.035 MIN) W/ (4)#8 X 1 5/8" WOOD SCREWS.
37	EMA BUTTERFLY ANCHOR (PART #PT1-008)	STEEL	18 GAUGE STEEL SATIN COAT.
38	8' LONG # 275 D HAGER SURFACE BOLT	STEEL W/ US26D FINISH	ENGAGED TO THE DOOR AT TOP AND BOTTOM TO HEADER & THRESHOLD RESPECTIVELY & FASTENED TO DOOR W/ (4) #10-24 x 1 1/2" THRU BOLT EACH CONNECTION.
39	VON DUPRIN #9954 REMOVABLE MULLION	0.125" THICK A 500 GRADE B STEEL	SECURED TO 499 STRIKE PLATE WITH (8) 5/16"-18x1"(MIN.) MACHINE SCREWS.
40	CAULKING GE SILICONE II	SILICONE	AS SHOWN ON DETAIL.
41	SURFACE STRIKE REINFORCEMENT	12 GAGE GALVANNEAL OR STAINLESS STEEL	12 GAGE (.097" MIN.) x 154' x 11.875' LONG (SEE SHEET 9).
42	MULLION FITTING #8620	STEEL	USE AT (39)
43	STRIKE FOR RIM EXIT DEVICE (11) AT REMOVABLE MULLION (39)	0.125" THICK, STEEL, PAINTED FINISH	SEE SHEET 5A FOR SIZES
44	STRIKE FOR DEAD BOLT (16)	0.095" THICK, STEEL, NICKEL FINISH	SEE SHEET 5A FOR SIZES
45	STRIKE FOR CYLINDRICAL LOCK (15)	0.095" THICK, STEEL, NICKEL FINISH	SEE SHEET 5A FOR SIZES
46	STRIKE FOR MORTISE LOCK (17)	0.095" THICK, STEEL, NICKEL FINISH	SEE SHEET 5A FOR SIZES

* AISI 304 SERIES STAINLESS STEEL WITH Fy =45.75 Ksi AND Fu= 101.38 Ksi

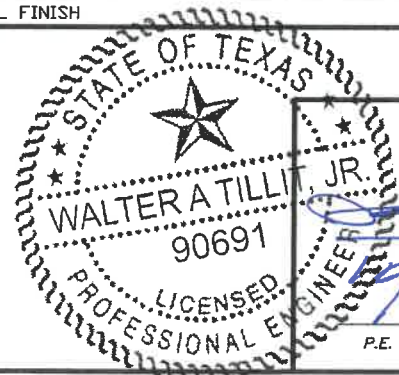

Walter A. Tillit, Jr.
P.E. SEAL/SIGNATURE/DATE

WALTER A. TILLIT Jr P.E.
PROFESSIONAL ENGINEER
6355 N.W 36 STREET, STE. 305
VIRGINIA GARDENS, FL 33166
PHONE(305) 871-1530 FAX (305) 871-1531
TEXAS LIC. # 90691
FIRM REGISTRATION # F-13790

TEXAS DEPARTMENT OF INSURANCE - 2018					
DOUBLE & SINGLE SERIES 8080 & 4080 OUTSWING COMMERCIAL GALVANNEAL OR STAINLESS STEEL FRAME DOOR FLUSH OR EMBOSSED				DRAWN BY: M.P.	
DAYBAR INDUSTRIES LTD				9/29/2021 DATE	
50 WEST DRIVE, BRAMPTON, ON CANADA, L6T 2J4 TEL: 905 625-8000 FAX: 905 625-4204				21-125 DRAWING No	
REV. No	DESCRIPTION	DATE	REV. No	DESCRIPTION	DATE
1	OLD 17-056	9/29/21	3		
2			4		
SHEET 4 OF 10					

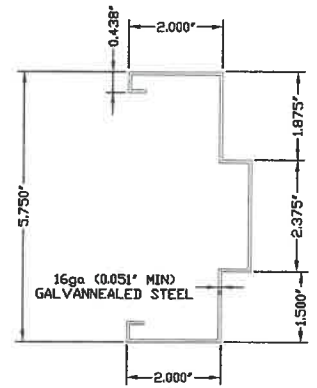

① PERIMETER FRAME

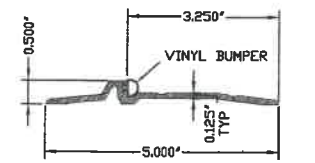

④ THRESHOLD(520S)

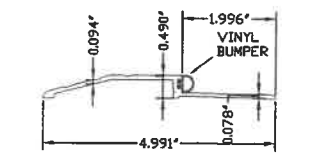

⑤ THRESHOLD(477S)

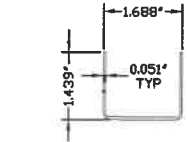

⑥ DOOR TOP/BOTTOM CHANNEL

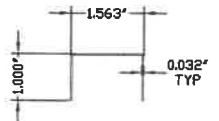

⑦ DOOR SNAP-IN TOP/BOTTOM CAP



⑩ ASTRAGAL SEAL(872S)

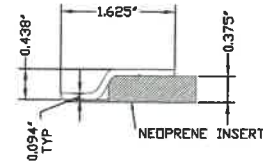

⑪ ASTRAGAL SEAL(874S)

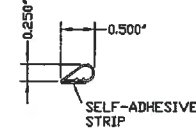

⑫ PRESS-ON SEAL

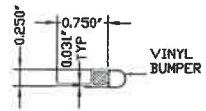

⑬ PERIMETER BUMPER

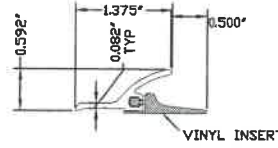

⑭ DOOR SWEEP

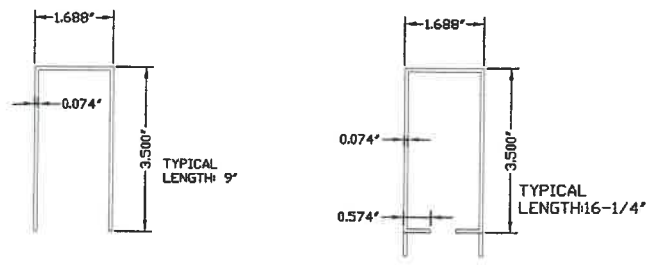

⑲ SURFACE BOLT REINFORCEMENT

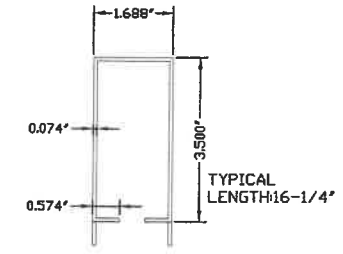

⑳ DOOR CLOSER REINFORCEMENT

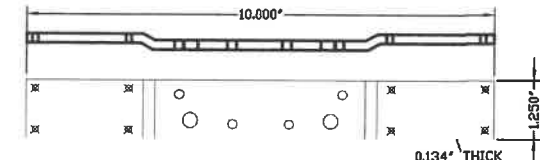

㉑ DOOR STILE HINGE REINF

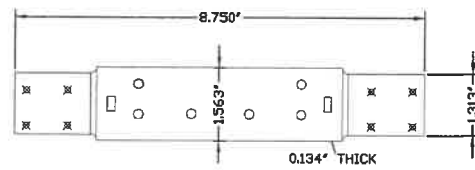

㉒ FRAME HINGE REINF

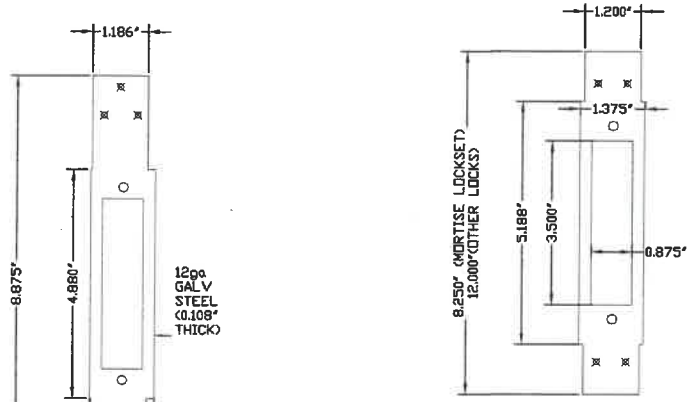

㉓ ASTRAGAL STRIKE REINF

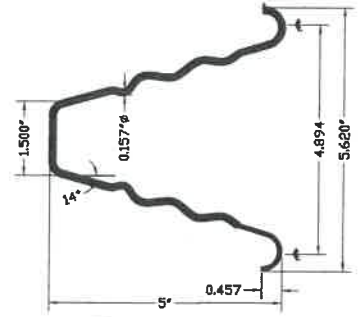

㉔ WIRE ANCHOR FOR DETAIL #21/17
STEEL WIRE ANCHORS
(0.157" DIA, 9 1/2" LONG) IN HORIZ.
Fu Min.=95.9 Ksi, Fy Min.=40.2 Ksi

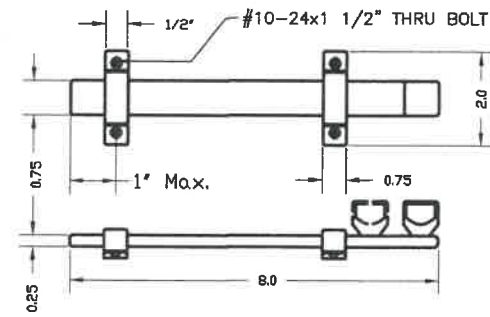

㉕ SURFACE BOLT

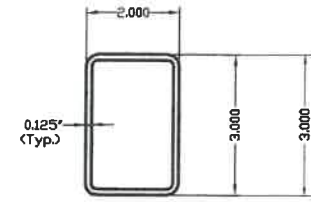

㉖ REMOVABLE MULLION

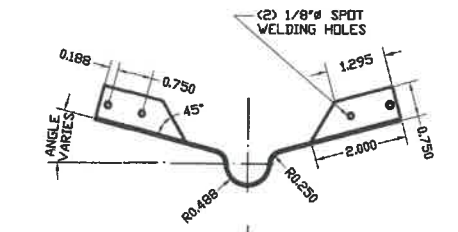

㉗ EMA BUTTERFLY ANCHOR (PART #PT1-008)
FOR DETAILS 2/10, 3/10 4/10 & 6/10
MATERIAL: 18 GA SATIN COAT

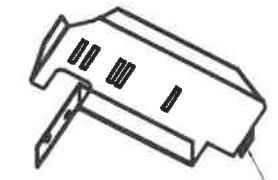

LEAF TO SNAP ANOTHER PIECE

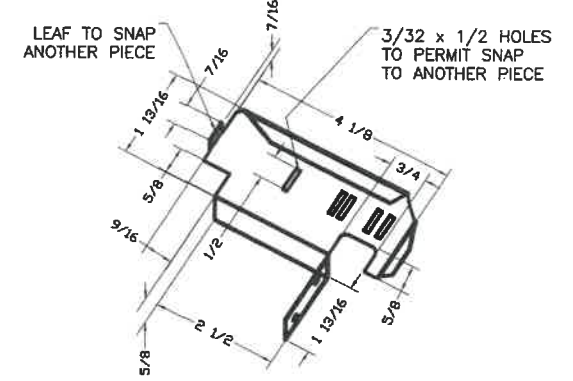

㉘ 2 PIECE COMBINATION STUD ANCHOR FOR DETAILS #5, 5A/10
CLIP-IN STUD ANCHOR MATERIAL: GAUGE 20 (0.035) ASTM A-653, A-60 GALVANNEALED STEEL.

COMPONENTS

STATE OF TEXAS
WALTER A. TILLIT, JR.
90691
LICENSED PROFESSIONAL ENGINEER
P.E. SEAL/SIGNATURE/DATE

WALTER A. TILLIT Jr P.E.
PROFESSIONAL ENGINEER
6355 N.W 36 STREET, STE. 305
VIRGINIA GARDENS, FL 33166
PHONE(305) 871-1530 FAX (305) 871-1531
TEXAS LIC. # 90691
FIRM REGISTRATION # F-13790

TEXAS DEPARTMENT OF INSURANCE - 2018					
DOUBLE & SINGLE SERIES 8080 & 4080 OUTSWING COMMERCIAL GALVANNEAL OR STAINLESS STEEL FRAME DOOR FLUSH OR EMBOSSED			DRAWN BY: M.P.		
DAYBAR INDUSTRIES LTD			9/29/2021 DATE		
50 WEST DRIVE, BRAMPTON, ON CANADA, L6T 2J4 TEL: 905 625-8000 FAX: 905 625-4204			21-125 DRAWING No		
REV. No	DESCRIPTION	DATE	REV. No	DESCRIPTION	DATE
1	OLD 17-056	9/29/21	3		
2			4		

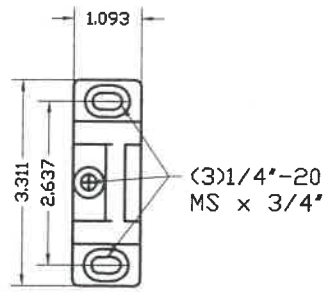

12 HAGER 4920F
STRIKE FOR RIM
EXIT DEVICE (11)
AT JAMB (1)
 MATERIAL: (0.125\"/>

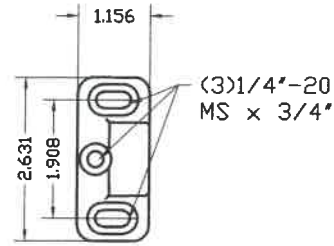

14 HAGER 4923F
STRIKE FOR SVR
EXIT DEVICE (13)
AT HEADER (1)
 MATERIAL: (0.125\"/>

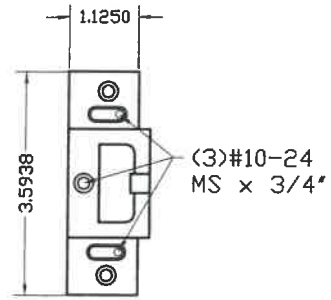

43 STRIKE FOR
RIM EXIT
DEVICE (11) AT
REMOVABLE
MULLION (39)
 MATERIAL: (0.125\"/>

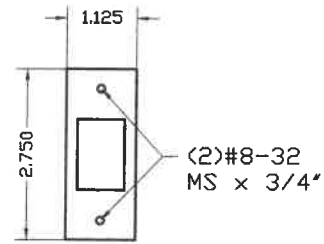

44 STRIKE FOR
DEAD BOLT (16)
 MATERIAL: (0.095\"/>

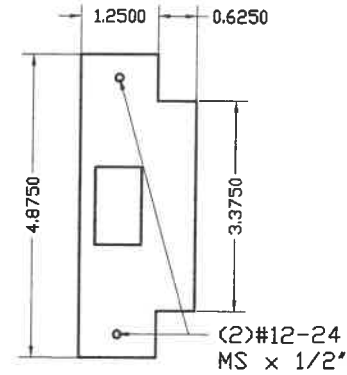

45 STRIKE FOR
CYLINDRICAL LOCK (15)
 MATERIAL: (0.095\"/>

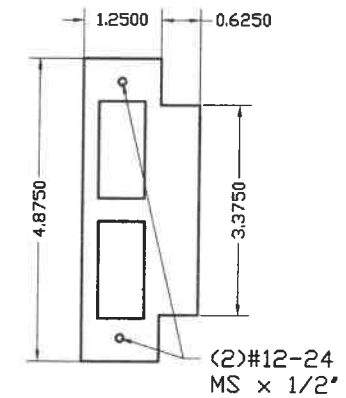

46 STRIKE FOR
MORTISE LOCK (17)
 MATERIAL: (0.095\"/>

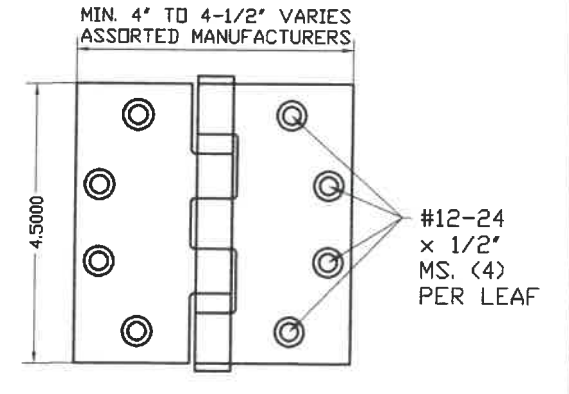

9A, 9B, 10A, 10B
HINGE-HAGER
 MATERIAL: 0.134\"/>

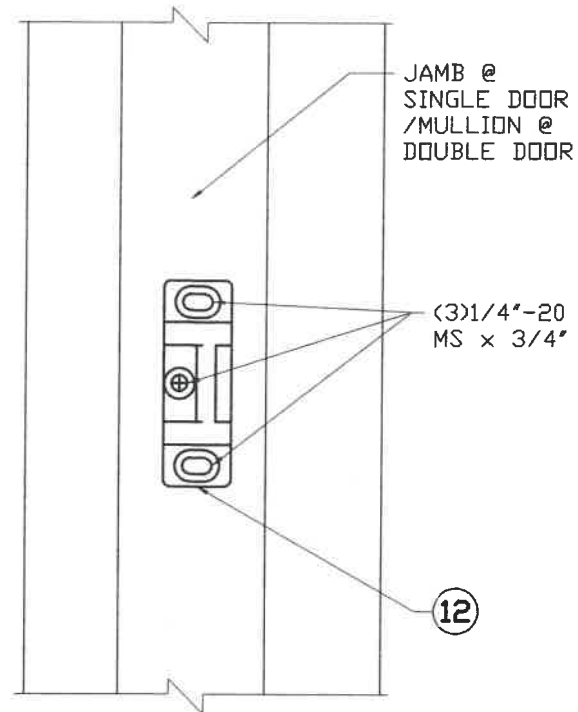

STRIKE DETAIL
ELEVATION
 Rim Exit Device

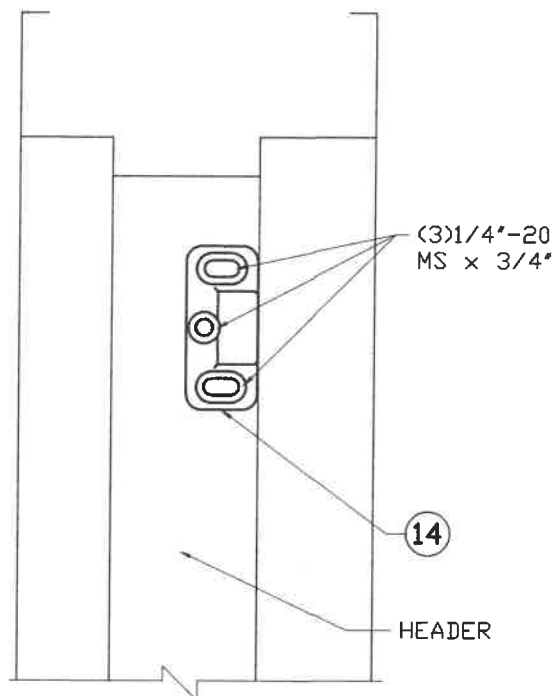

STRIKE DETAIL
BOTTOM VIEW
 SVR Exit Device

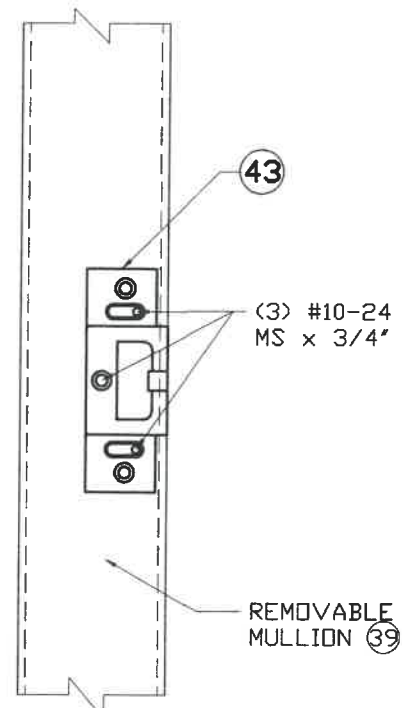

STRIKE DETAIL
ELEVATION
 Rim Exit Device
 REMOVABLE MULLION (39)

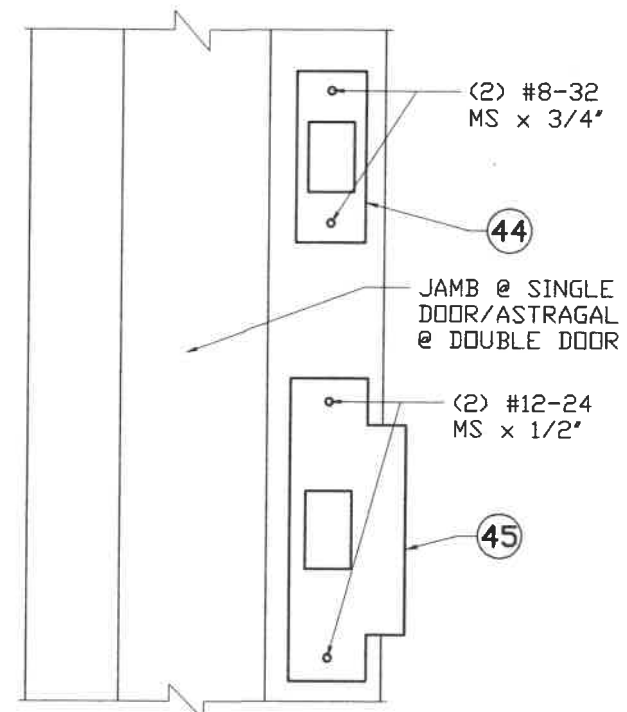

STRIKE DETAIL
ELEVATION
 Latch & Deadbolt

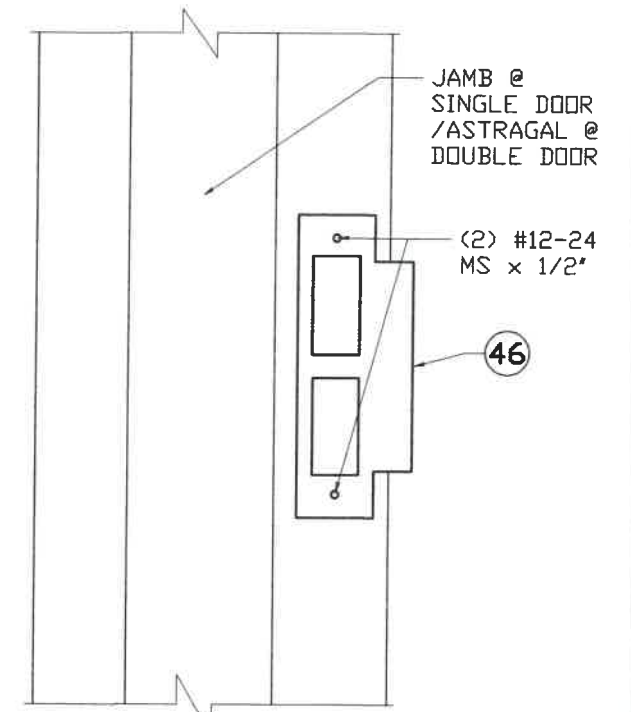

STRIKE DETAIL
ELEVATION
 Mortised Device Latch



Walter A. Tillit, Jr.
 P.E. SEAL/SIGNATURE/DATE

WALTER A. TILLIT Jr P.E.
 PROFESSIONAL ENGINEER
 6355 N.W 36 STREET, STE. 305
 VIRGINIA GARDENS, FL 33166
 PHONE(305) 871-1530 FAX (305) 871-1531
 TEXAS LIC. # 90691
 FIRM REGISTRATION # F-13790

TEXAS DEPARTMENT OF INSURANCE - 2018					
DOUBLE & SINGLE SERIES 8080 & 4080 OUTSWING COMMERCIAL GALVANNEAL OR STAINLESS STEEL FRAME DOOR FLUSH OR EMBOSSED				DRAWN BY: M.P.	
DAYBAR INDUSTRIES LTD 50 WEST DRIVE, BRAMPTON, ON CANADA, L6T 2J4 TEL: 905 625-8000 FAX: 905 625-4204				9/29/2021 DATE	
				21-125 DRAWING No	
REV. No	DESCRIPTION	DATE	REV. No	DESCRIPTION	DATE
1	OLD 17-056	9/29/21	3		
2			4		

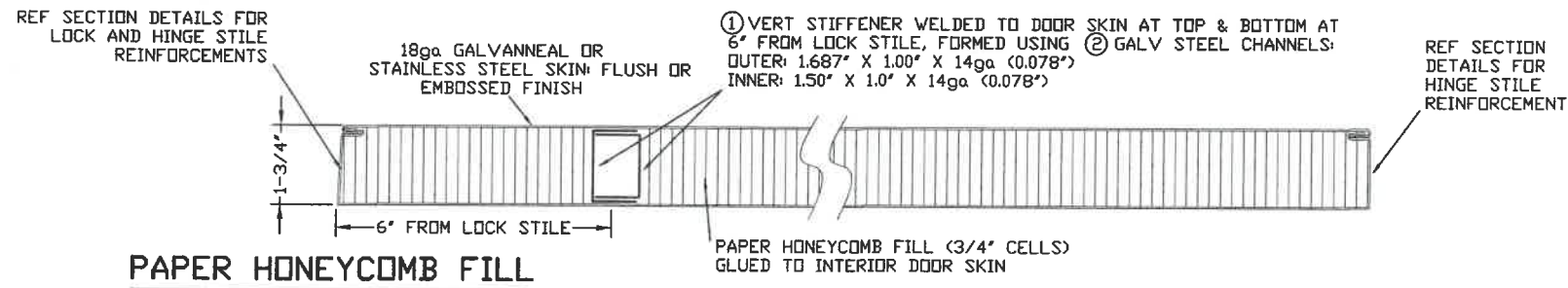

PAPER HONEYCOMB FILL

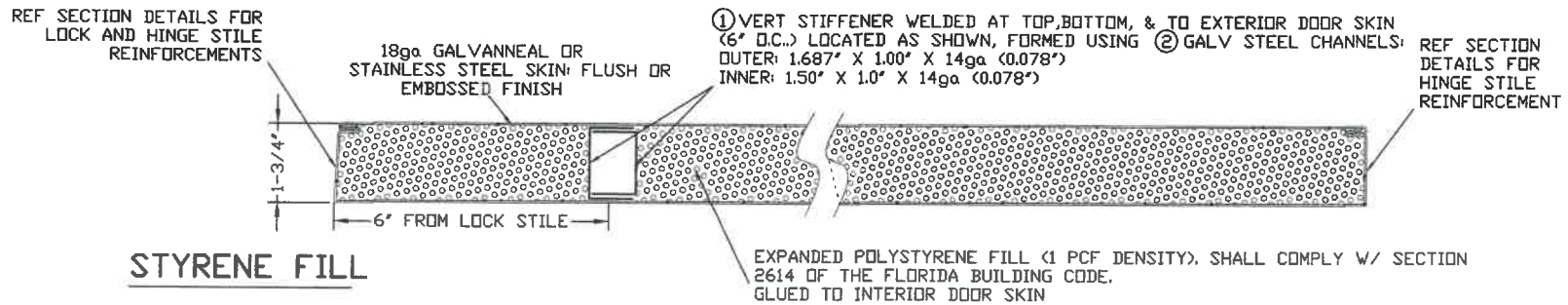

STYRENE FILL

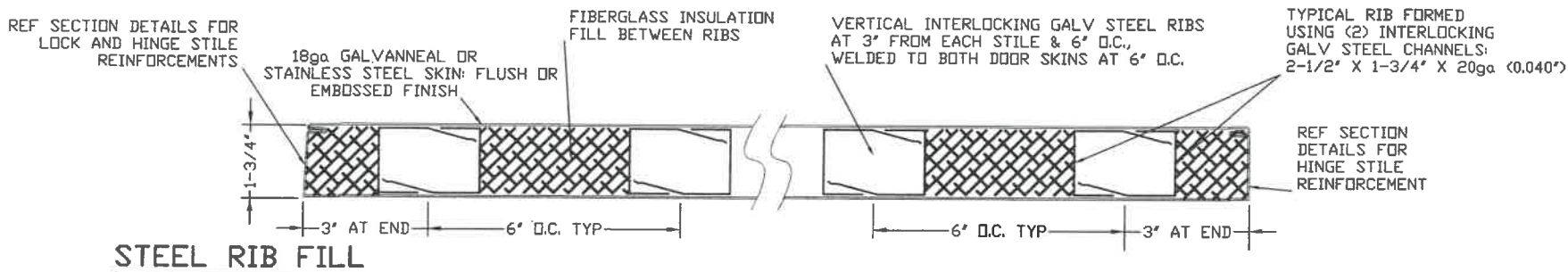

STEEL RIB FILL

DOOR PANEL CONSTRUCTION OPTIONS (HORIZONTAL SECTIONS)

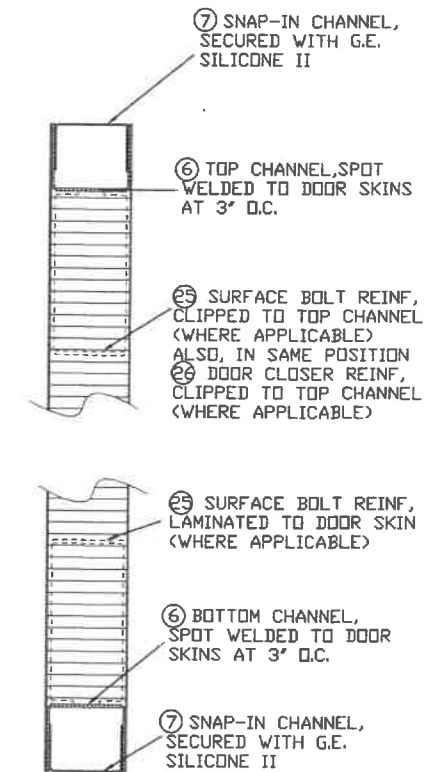

TYPICAL DOOR TOP & BOTTOM CONSTRUCTION (VERTICAL SECTION)

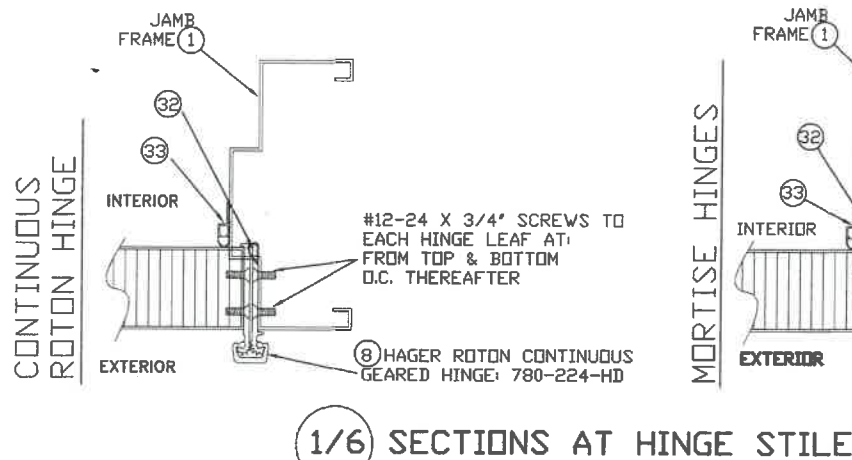

1/6 SECTIONS AT HINGE STILE

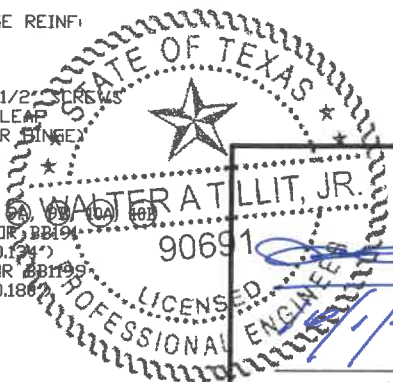

WALTER A. TILLIT Jr P.E.
 PROFESSIONAL ENGINEER
 6355 N.W 36 STREET, STE. 305
 VIRGINIA GARDENS, FL 33166
 PHONE(305) 871-1530 FAX (305) 871-1531
 TEXAS LIC. # 90691
 FIRM REGISTRATION # F-13790

TEXAS DEPARTMENT OF INSURANCE - 2018					
DOUBLE & SINGLE SERIES 8080 & 4080 OUTSWING COMMERCIAL GALVANNEAL OR STAINLESS STEEL FRAME DOOR FLUSH OR EMBOSSED				DRAWN BY: M.P.	
DAYBAR INDUSTRIES LTD				9/29/2021 DATE	
50 WEST DRIVE, BRAMPTON, ON CANADA, L6T 2J4 TEL: 905 625-8000 FAX: 905 625-4204				21-125 DRAWING No	
REV. No	DESCRIPTION	DATE	REV. No	DESCRIPTION	DATE
1	OLD 17-056	9/29/21	3		
2			4		

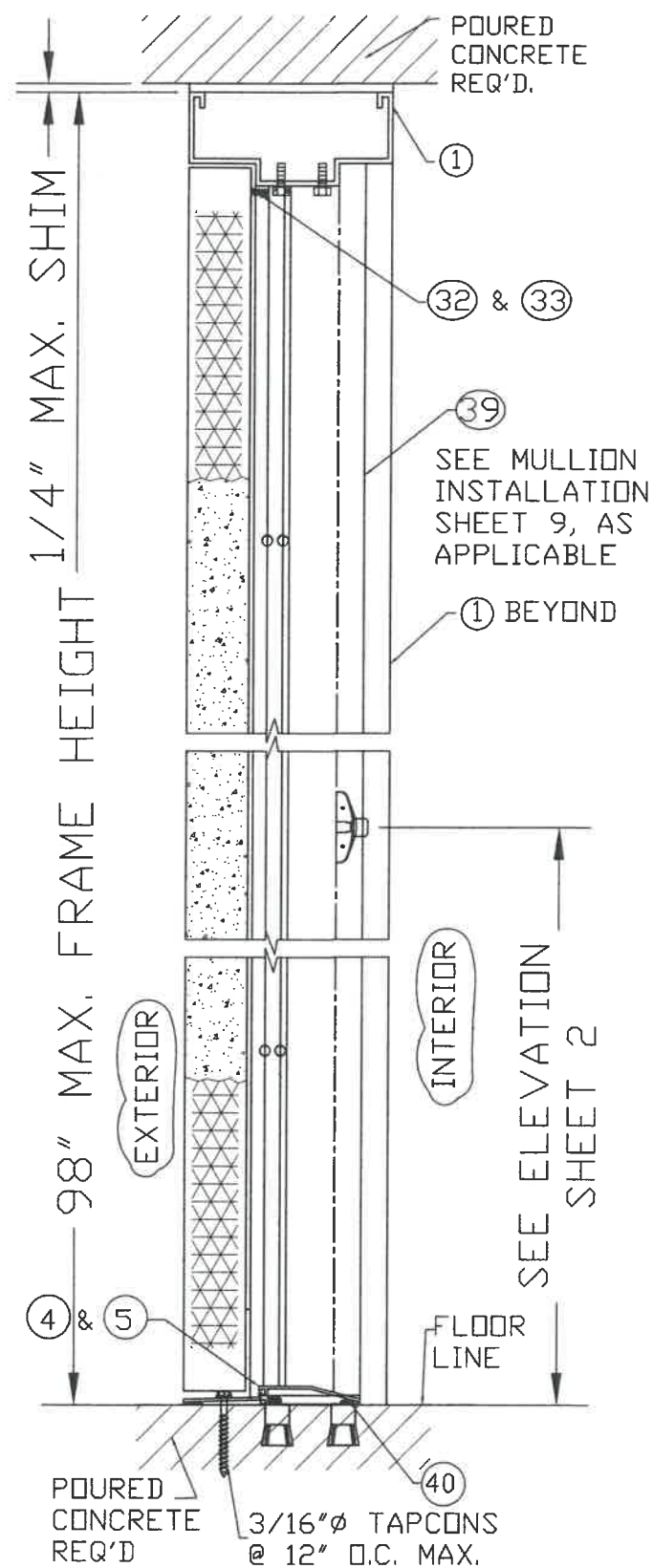

SECTION D-D
SINGLE DOOR DOES NOT NEED MULLION.
LATCH ONTO REINFORCED JAMB

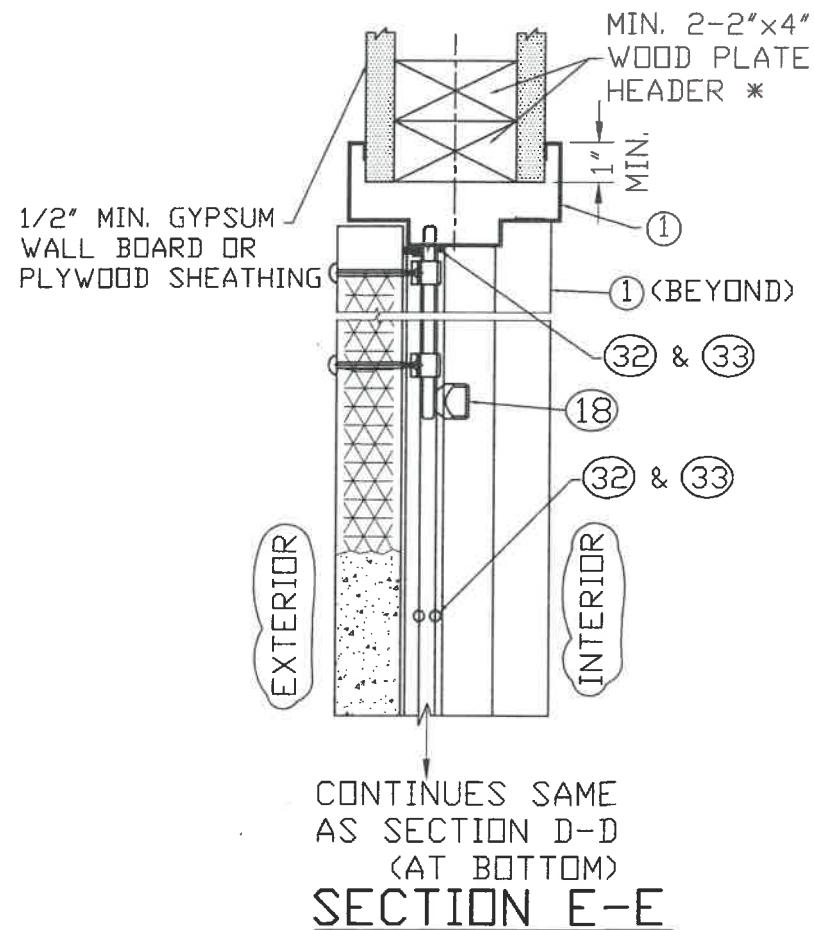

CONTINUES SAME AS SECTION D-D (AT BOTTOM)
SECTION E-E

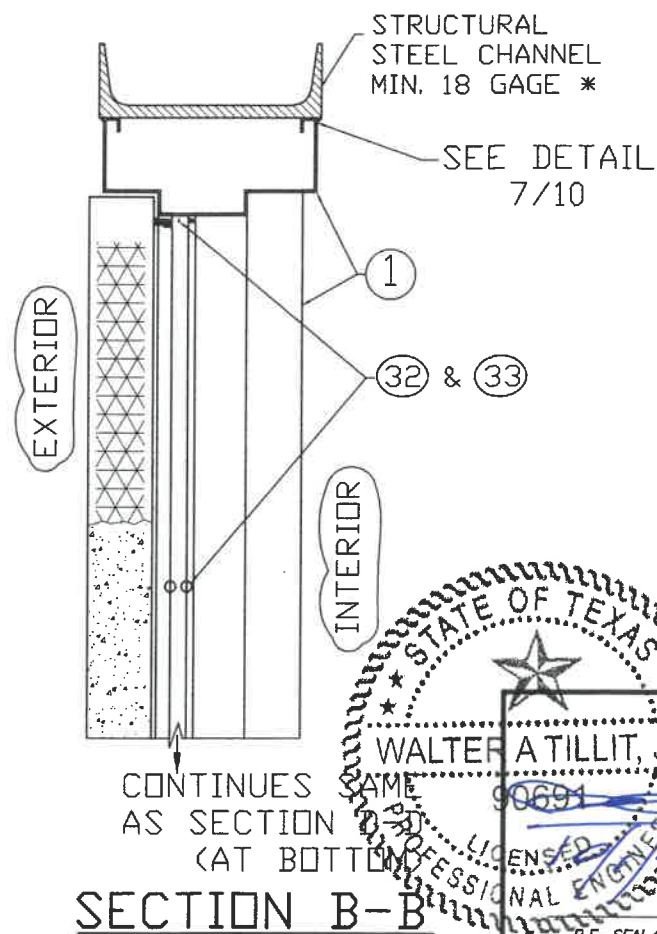

CONTINUES AS SECTION D-D (AT BOTTOM)
SECTION B-B

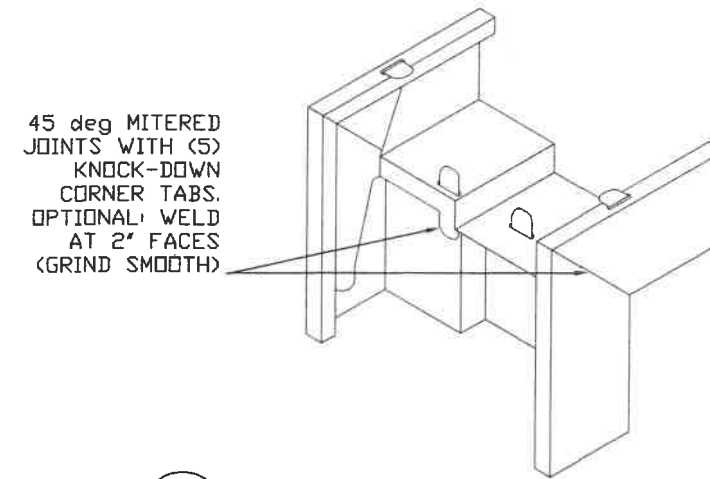

1/7 FRAME CORNER: TABBED KNOCKDOWN ASSEMBLY

* STRUCTURAL MEMBER AT HEADER MUST BE DESIGNED TO CARRY 174 #/FT & BE REVIEWED BY BUILDING OFFICIAL

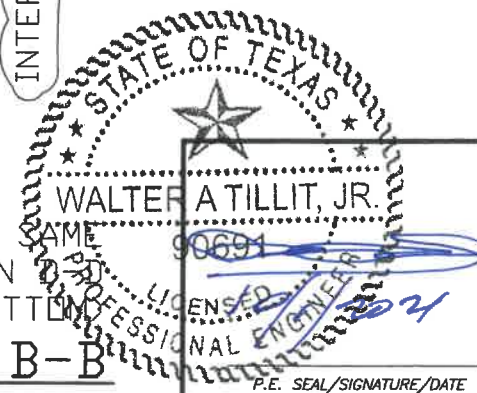

WALTER A. TILLIT Jr P.E.
PROFESSIONAL ENGINEER
6355 N.W 36 STREET, STE. 305
VIRGINIA GARDENS, FL 33166
PHONE (305) 871-1530 FAX (305) 871-1531
TEXAS LIC. # 90691
FIRM REGISTRATION # F-13790

TEXAS DEPARTMENT OF INSURANCE - 2018					
DOUBLE & SINGLE SERIES 8080 & 4080 OUTSWING COMMERCIAL GALVANNEAL OR STAINLESS STEEL FRAME DOOR FLUSH OR EMBOSSED				DRAWN BY: M.P.	
DAYBAR INDUSTRIES LTD				9/29/2021 DATE	
50 WEST DRIVE, BRAMPTON, ON CANADA, L6T 2J4 TEL: 905 625-8000 FAX: 905 625-4204				21-125 DRAWING No	
REV. No	DESCRIPTION	DATE	REV. No	DESCRIPTION	DATE
1	OLD 17-056	9/29/21	3		
2			4		

RIM EXIT DEVICE
SINGLE POINT LATCH

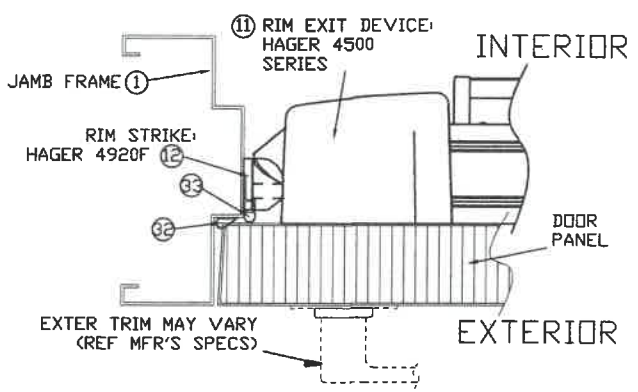

RIM EXIT DEVICE
SINGLE POINT LATCH

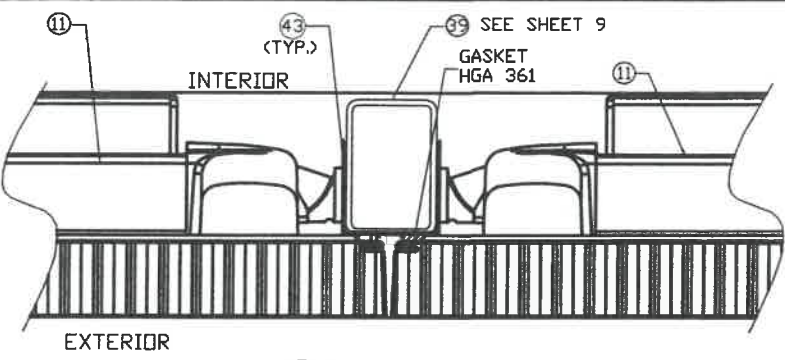

SVR EXIT DEVICE

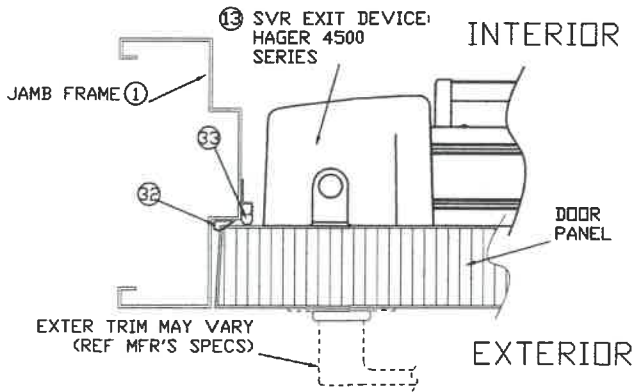

SVR EXIT DEVICE

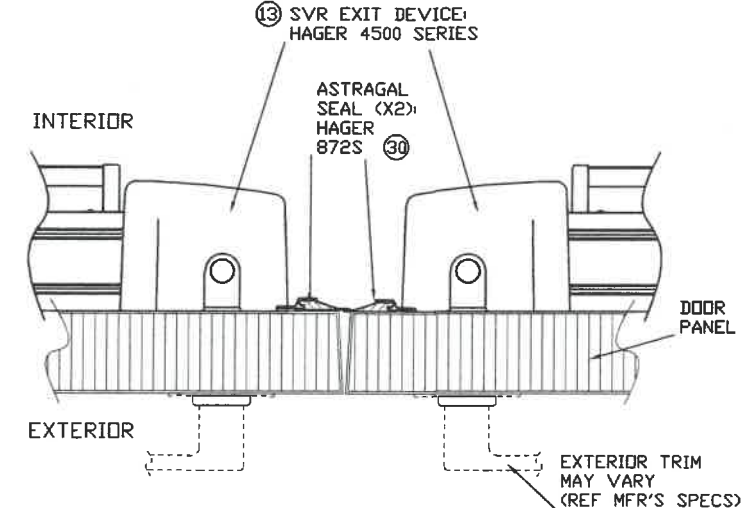

MORTISE LOCK

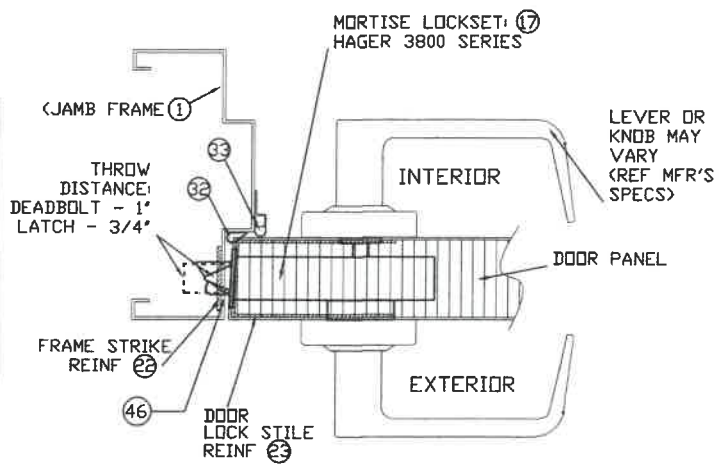

MORTISE LOCK

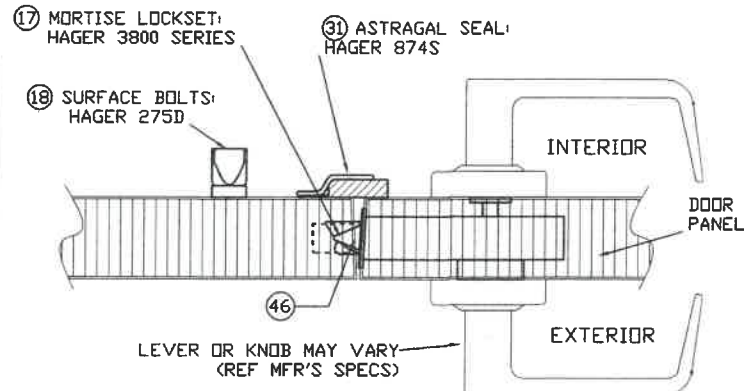

CYLINDRICAL LOCK

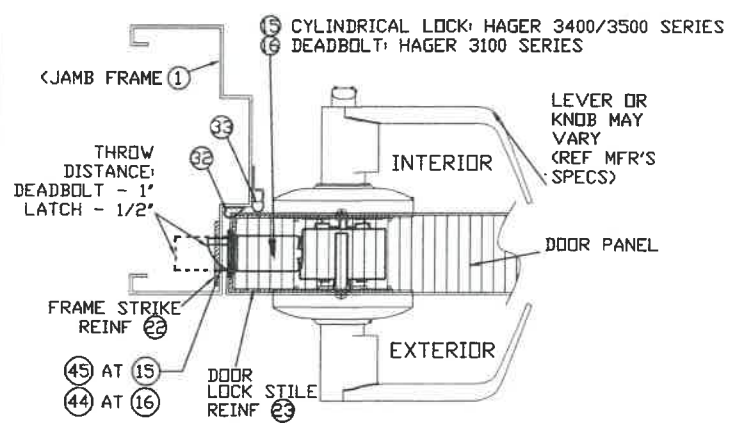

CYLINDRICAL LOCK

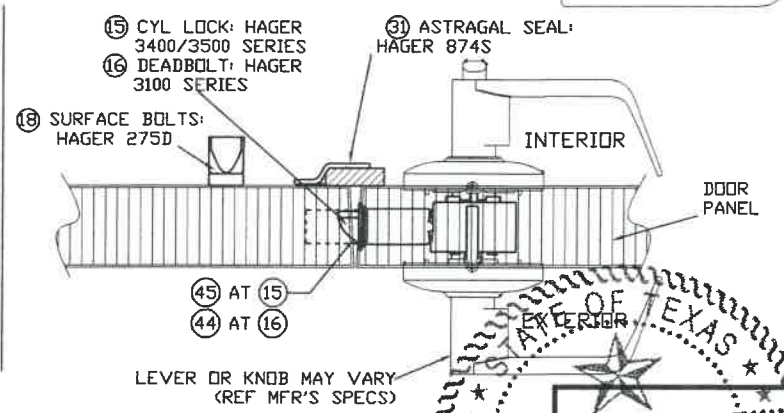

3 VERTICAL SECTION AT DOOR HEAD

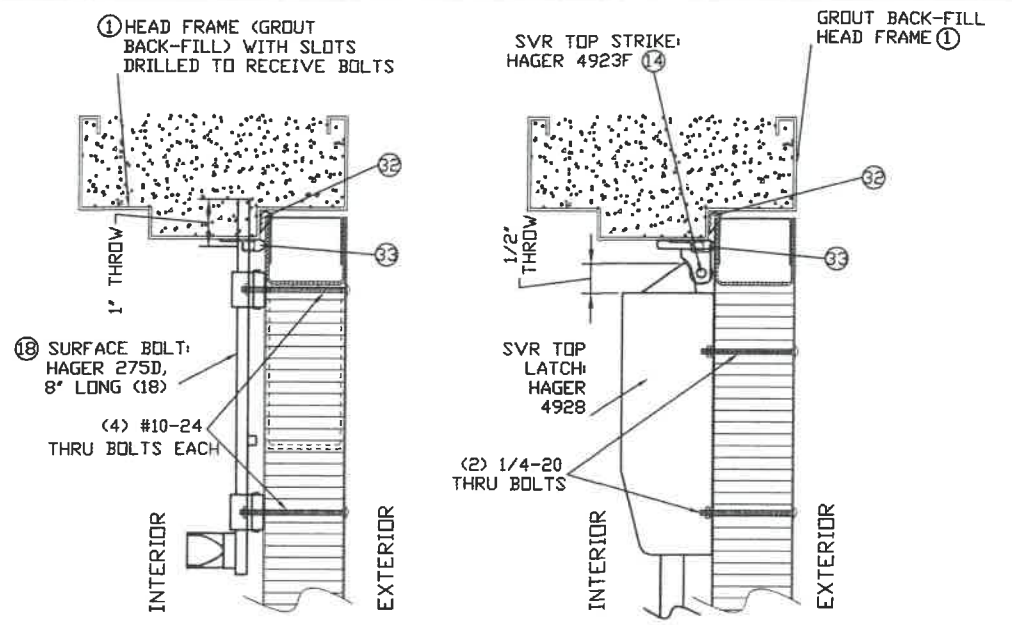

3
8

4 VERTICAL SECTION AT DOOR SILL

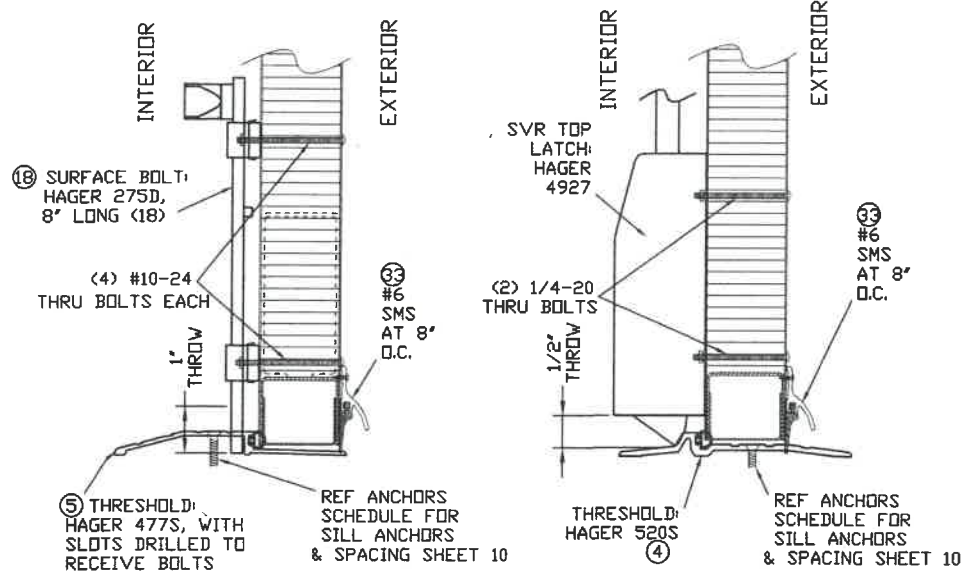

4
8

1 SECTION AT LOCK STILE (SINGLE DOOR)
8 SCALE: 3\"/>

2 SECTION AT LOCK STILE (DOUBLE DOOR)
8 SCALE: 3\"/>

STATE OF TEXAS
WALTER A. TILLIT, JR.
90691
LICENSED PROFESSIONAL ENGINEER
SEAL/SIGNATURE/DATE

WALTER A. TILLIT Jr P.E.
PROFESSIONAL ENGINEER
6355 N.W. 36 STREET, STE. 305
VIRGINIA GARDENS, FL 33166
PHONE (305) 871-1530 FAX (305) 871-1531
TEXAS LIC. # 90691
FIRM REGISTRATION # F-13790

TEXAS DEPARTMENT OF INSURANCE - 2018					
DOUBLE & SINGLE SERIES 8080 & 4080 OUTSWING COMMERCIAL GALVANNEAL OR STAINLESS STEEL FRAME DOOR FLUSH OR EMBOSSED			DRAWN BY: M.P.		
DAYBAR INDUSTRIES LTD			9/29/2021 DATE		
50 WEST DRIVE, BRAMPTON, ON CANADA, L6T 2J4 TEL: 905 625-8000 FAX: 905 625-4204			21-125 DRAWING No		
REV. No	DESCRIPTION	DATE	REV. No	DESCRIPTION	DATE
1	OLD 17-056	9/29/21	3		
2			4		

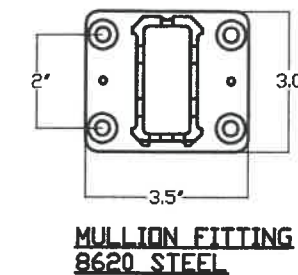
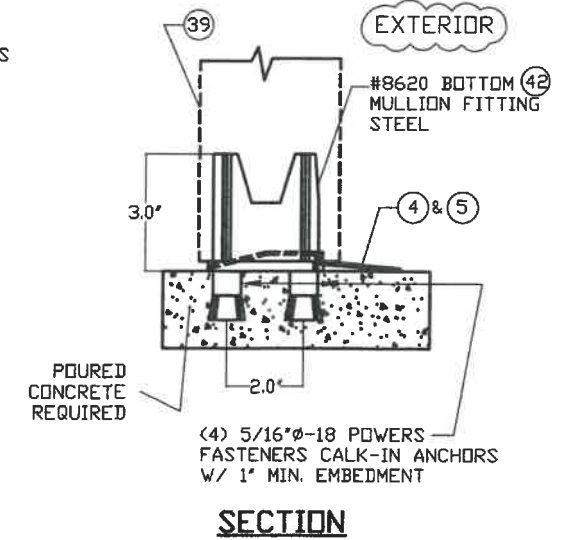
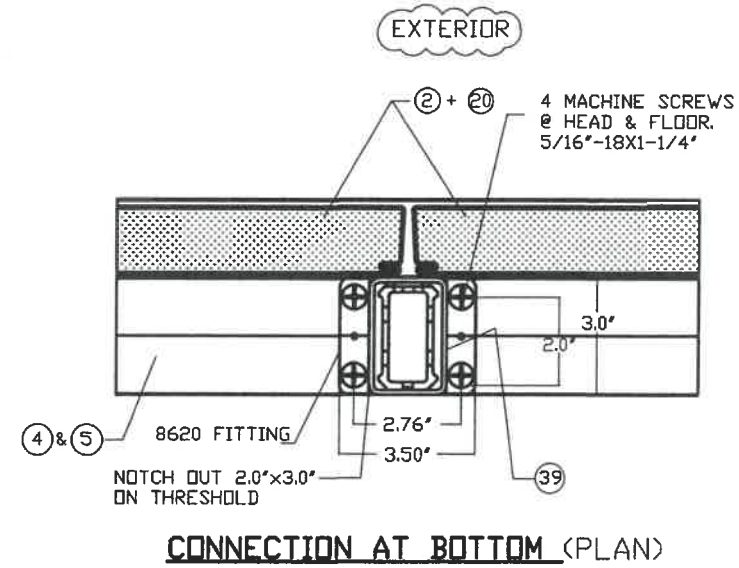
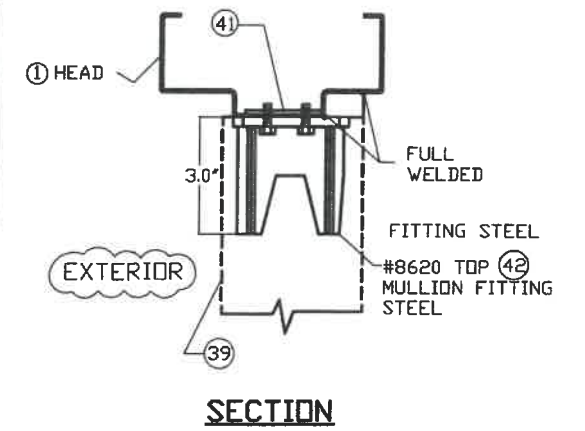
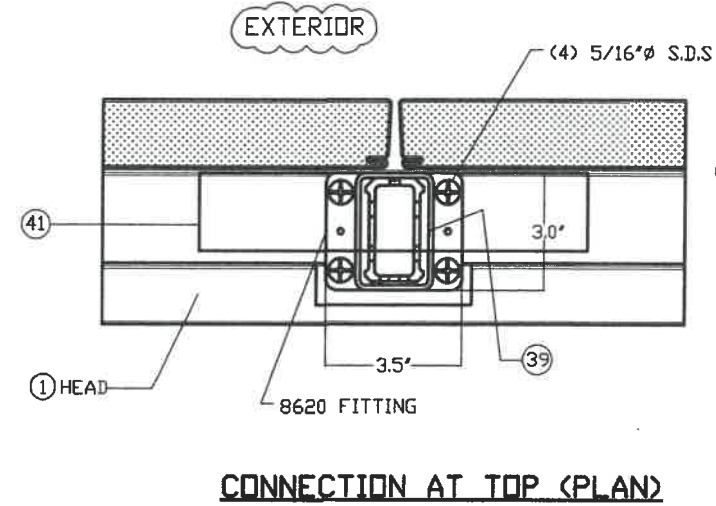
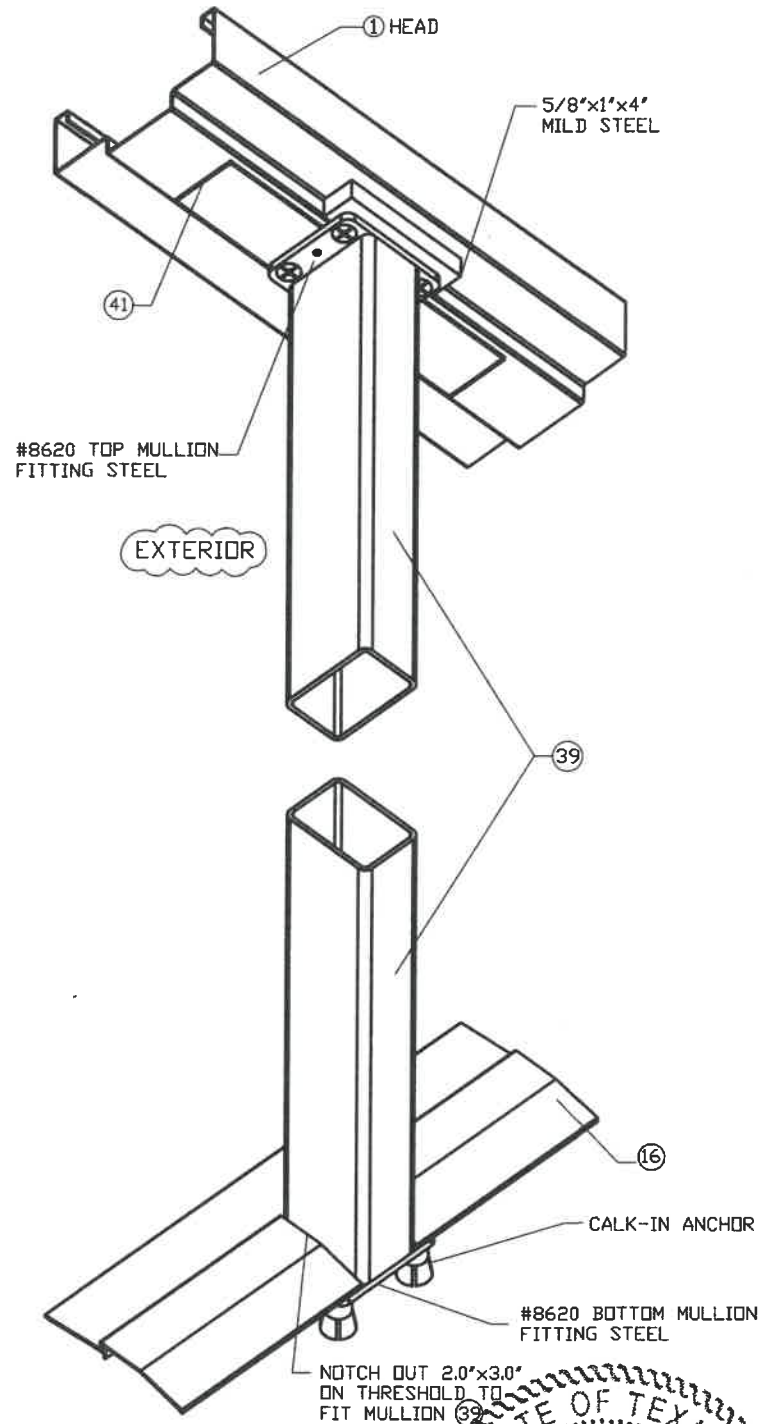
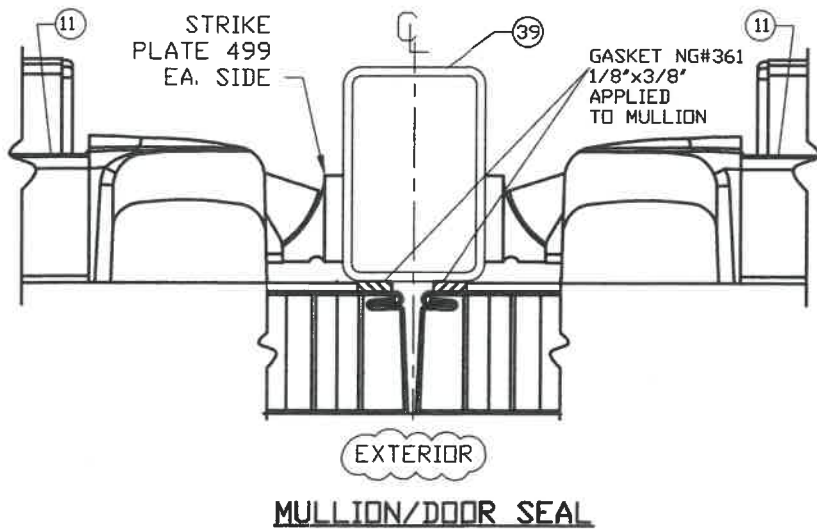
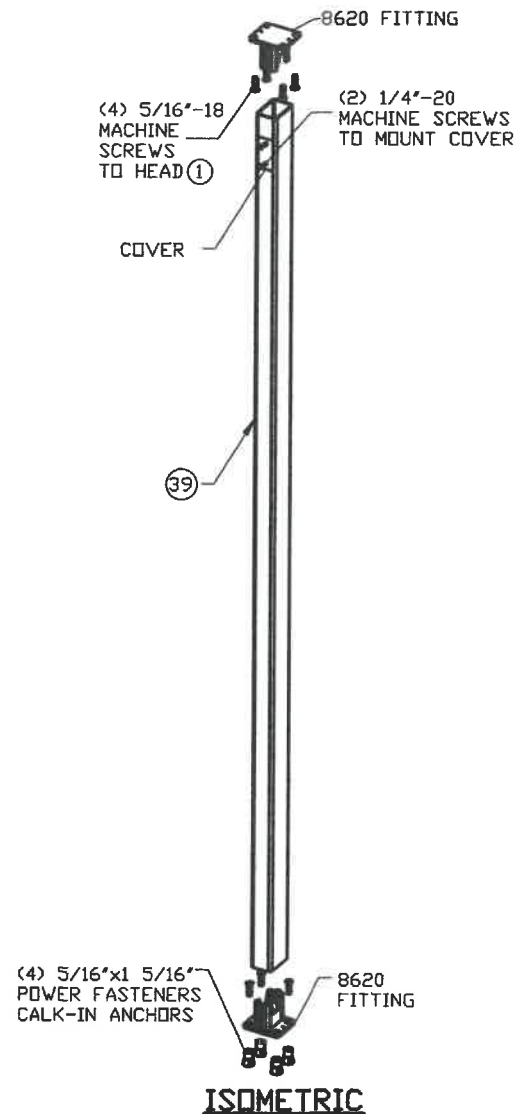

③⑨ VON DUPRIN SERIES 9954 WALTER A. TILLIT, JR. (W/ 499 STRIKE PLATE) MULLION INSTALLATION 90691

STATE OF TEXAS
 WALTER A. TILLIT, JR.
 LICENSED PROFESSIONAL ENGINEER
 90691
 P.E. SEAL/SIGNATURE/DATE

WALTER A. TILLIT Jr P.E.
 PROFESSIONAL ENGINEER
 6355 N.W 36 STREET, STE. 305
 VIRGINIA GARDENS, FL 33166
 PHONE(305) 871-1530 FAX (305) 871-1531
 TEXAS LIC. # 90691
 FIRM REGISTRATION # F-13790

TEXAS DEPARTMENT OF INSURANCE - 2018

DOUBLE & SINGLE SERIES 8080 & 4080
 OUTSWING COMMERCIAL GALVANNEAL OR
 STAINLESS STEEL FRAME DOOR
 FLUSH OR EMBOSSED

DRAWN BY:
M.P.

DAYBAR INDUSTRIES LTD

9/29/2021
DATE

50 WEST DRIVE, BRAMPTON,
 ON CANADA, L6T 2J4
 TEL: 905 625-6000 FAX: 905 625-4204

21-125
DRAWING No

REV. No	DESCRIPTION	DATE	REV. No	DESCRIPTION	DATE
1	OLD 17-056	9/29/21	3		
2			4		

SHEET 9 OF 10

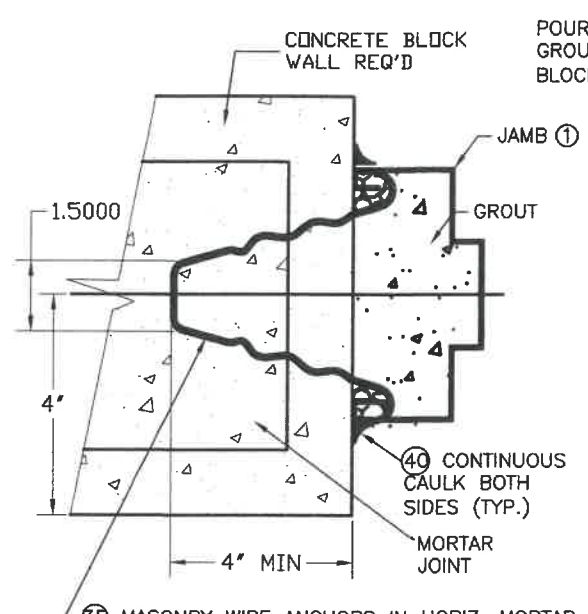

1 WIRE ANCHOR 35 INSTALLATION TO MASONRY WALLS

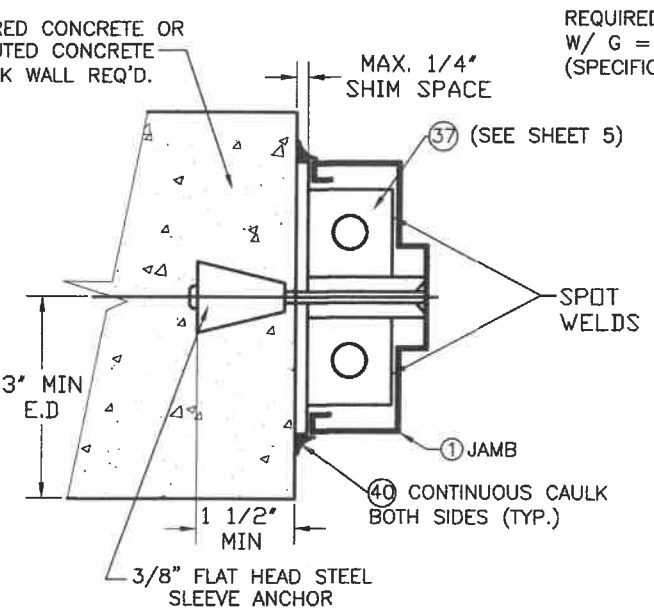

2 INSTALLATION OF SLEEVE ANCHOR TO MASONRY WALLS

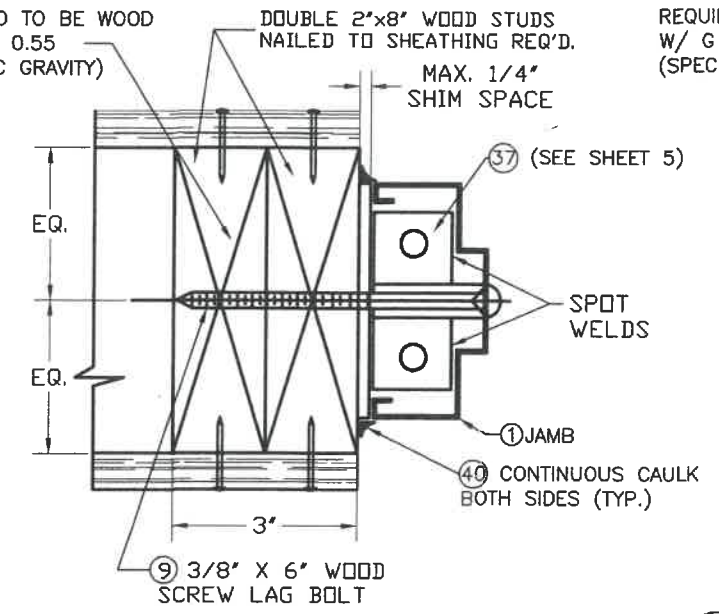

3 INSTALLATION OF 3/8 inch LAG SCREW 9 TO WOOD FRAME WALLS

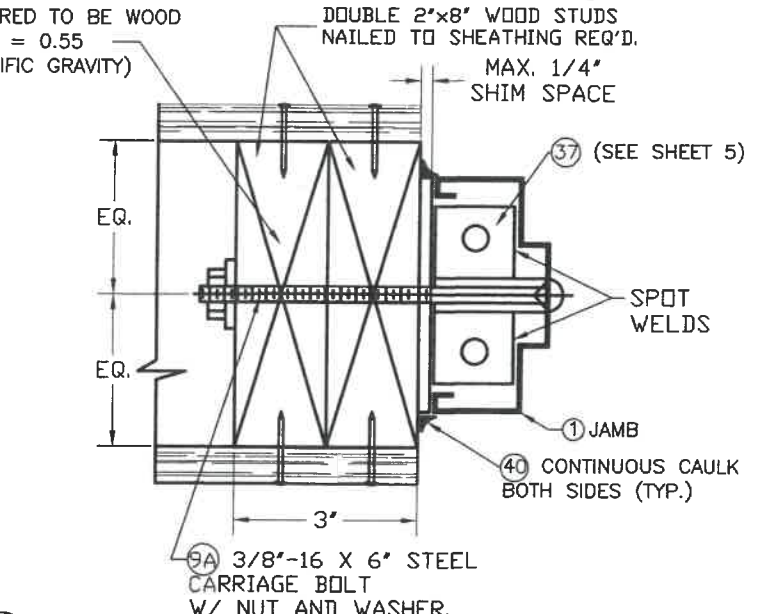

4 INSTALLATION OF 3/8 inch CARRIAGE BOLT 9A TO WOOD FRAME WALLS

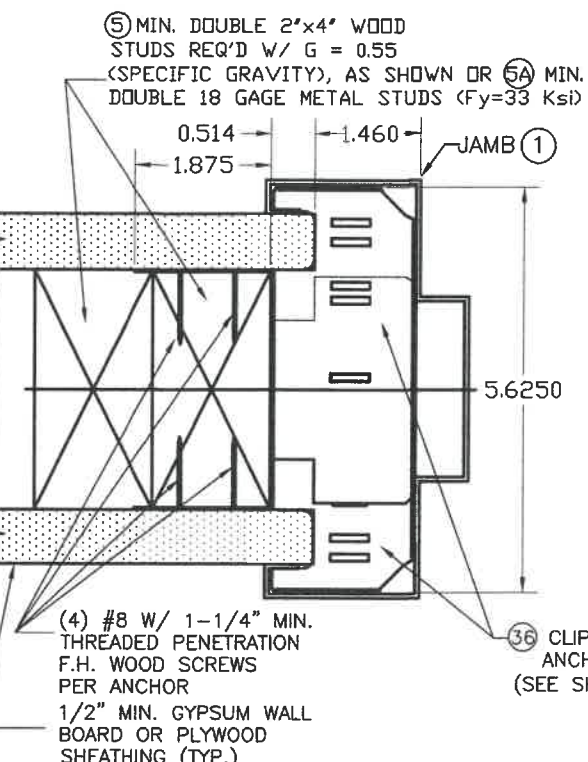

5 & 5A INSTALLATION OF 2 PIECE COMBINATION STUD ANCHOR 36 INTO WOOD FRAME OR METAL STUD WALLS

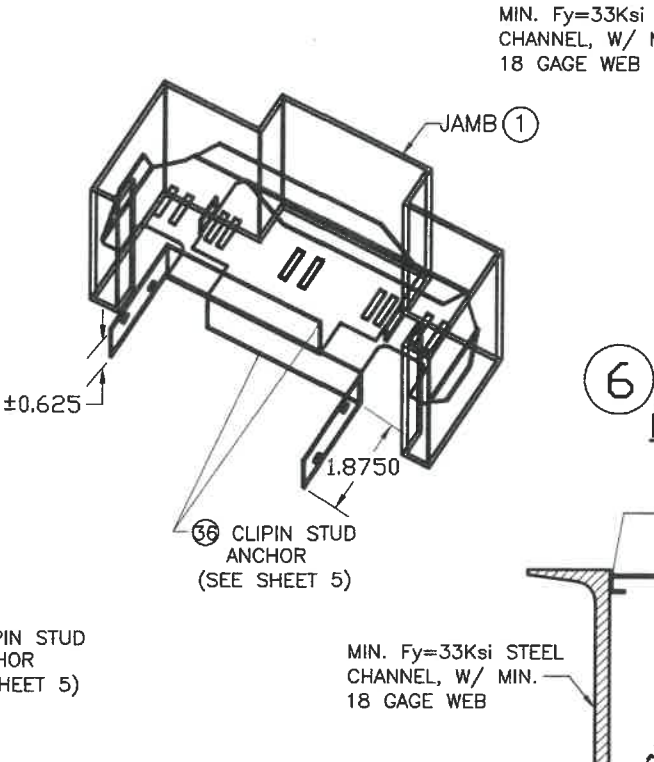

6 INSTALLATION OF 3/8 inch F.H. M.S. TO STEEL CHANNEL

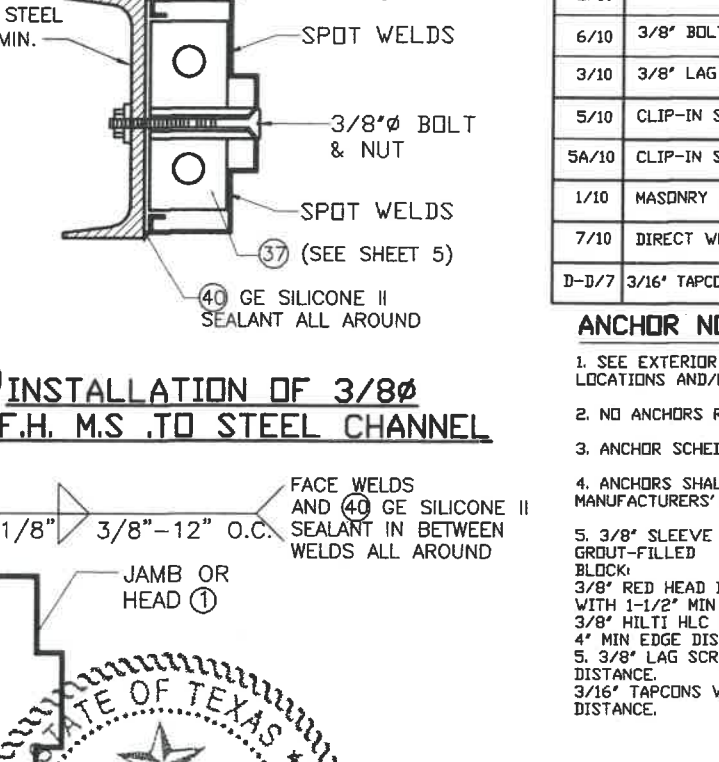

7 INSTALLATION OF JAMB TO A TILLIT, JR. STEEL CHANNEL THRU WELDING

ANCHOR SCHEDULE

DETAIL	ANCHOR	SUBSTRATE	SINGLE DOORS				DOUBLE DOORS			
			SILL		JAMBS		SILL		JAMBS	
			CORNERS	SPACING	CORNERS	SPACING	CORNERS	SPACING	CORNERS	SPACING
2/10	3/8 SLEEVE ANCHORS 4	CONCRETE OR G.F. MASONRY	6"	12" OC	6"	21" OC	6"	12" OC	6"	21" OC
6/10	3/8 BOLT & NUT	STEEL	6"	12" OC	6"	21" OC	6"	12" OC	6"	21" OC
3/10	3/8 LAG SCREWS	WOOD	6"	12" OC	6"	16" OC	6"	12" OC	6"	12" OC
5/10	CLIP-IN STUD ANCHORS	WOOD STUDS	N / A		9"	17" OC	N / A		6"	17" OC
5A/10	CLIP-IN STUD ANCHORS	METAL STUDS	N / A		9"	17" OC	N / A		9"	17" OC
1/10	MASONRY WIRE	MASONRY	N / A		16"	16" OC	N / A		16"	16" OC
7/10	DIRECT WELD	STEEL	N / A		6"	21" OC	N / A		6"	21" OC
D-1/7	3/16 TAPCON ITW/BUILDEX	CONCRETE OR WOOD	5"	12" OC	N / A		5"	12" OC	N / A	

- ANCHOR NOTES:**
- SEE EXTERIOR ELEVATION & ANCHOR SCHEDULE FOR ANCHOR LOCATIONS AND/OR SPACING.
 - NO ANCHORS REQUIRED AT FRAME HEAD.
 - ANCHOR SCHEDULE GIVES MAXIMUM CORNER DISTANCE AND SPACING.
 - ANCHORS SHALL BE INSTALLED IN ACCORDANCE WITH MANUFACTURERS' RECOMMENDATIONS.
 - 3/8 SLEEVE ANCHOR OPTIONS FOR INSTALLATION TO CONCRETE OR GROUT-FILLED BLOCK:
3/8 RED HEAD DYNABOLT SLEEVE ANCHOR WITH 1-1/2 MIN EMBED, 2-1/4 MIN EDGE DISTANCE.
3/8 HILTI HLC SLEEVE ANCHOR WITH 1-1/4 MIN EMBED, 4 MIN EDGE DISTANCE.
3/8 LAG SCREWS SHALL HAVE 2 MIN EMBED & 1-1/2 MIN EDGE DISTANCE.
 - 3/16 TAPCONS W/ 1 1/2 MIN. EMBEDMENT & 2 1/2 MIN. EDGE DISTANCE.
 - MINIMUM EMBEDMENT AND EDGE DISTANCE EXCLUDES STUCCO, FOAM, BRICK, AND OTHER WALL FINISHES.
 - CONCRETE HOST STRUCTURE SHALL HAVE 3,000 PSI MIN COMPRESSIVE STRENGTH. GROUT-FILLED MASONRY SHALL BE ASTM C90 BLOCK WITH MIN 2,000 PSI GROUT.
 - WOOD HOST STRUCTURE SHALL BE "SOUTHERN PINE" G=0.55 OR GREATER DENSITY.
 - WHERE EXISTING STRUCTURE IS WOOD FRAMING, EXISTING CONDITIONS MAY VARY. FIELD VERIFY THAT FASTENERS ARE INTO ADEQUATE WOOD FRAMING MEMBERS, NOT INTO PLYWOOD (U.N.D.).
 - "STEEL" SUBSTRATE SHALL HAVE 18ga (0.048") MIN THICKNESS.
 - MACHINE SCREWS USED WITH SLEEVE ANCHORS SHALL HAVE MINIMUM OF 1/2" ENGAGEMENT OF THREADS IN BASE ANCHOR.
 - MASONRY WIRE ANCHORS ARE ONLY APPLICABLE AT JAMBS.

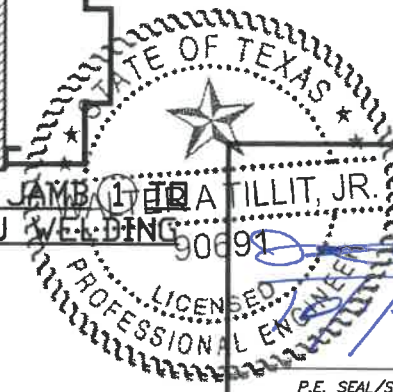

WALTER A. TILLIT Jr P.E.
PROFESSIONAL ENGINEER
6355 N.W 36 STREET, STE. 305
VIRGINIA GARDENS, FL 33166
PHONE(305) 871-1530 FAX (305) 871-1531
TEXAS LIC. # 90691
FIRM REGISTRATION # F-13790

TEXAS DEPARTMENT OF INSURANCE - 2018

DOUBLE & SINGLE SERIES 8080 & 4080
OUTSWING COMMERCIAL GALVANNEAL OR
STAINLESS STEEL FRAME DOOR
FLUSH OR EMBOSSED

DAYBAR INDUSTRIES LTD
50 WEST DRIVE, BRAMPTON,
ON CANADA, L6T 2J4
TEL: 905 625-8000 FAX: 905 625-4204

DRAWN BY: M.P.
DATE: 9/29/2021
21-125
DRAWING No

REV. No	DESCRIPTION	DATE	REV. No	DESCRIPTION	DATE
1	OLD 17-056	9/29/21	3		
2			4		

SHEET 10 OF 10

ANCHOR DETAILS:

P.E. SEAL/SIGNATURE/DATE