

GENERAL NOTES

1. THE PRODUCT SHOWN HEREIN CONSTRUCTED FROM CHELSEA BUILDING PRODUCTS EXTRUDED RIGID PVC FRAMES HAS BEEN TESTED TO AAMA/WDMA/CSA 101/I.S.2/A440-08/11, AAMA 506-11, AND ASTM E1886-05/E1996-12 (WIND ZONE 3, MISSILE LEVEL D), AND MEETS THE REQUIREMENTS OF THE 2018 INTERNATIONAL BUILDING CODE AND INTERNATIONAL RESIDENTIAL CODE
2. THIS PRODUCT IS LARGE MISSILE IMPACT RESISTANT AND DOES NOT REQUIRE THE USE OF IMPACT PROTECTIVE DEVICES (SHUTTERS) IN WIND ZONE 3 (AND BELOW) WINDBORNE DEBRIS REGIONS.
3. THE DESIGN PRESSURES INDICATED IN THIS DRAWING ARE AS LIMITED BY ASTM E-1300 GLASS TABLES, AND TESTED WATER, STRUCTURAL, AND CYCLIC PRESSURES.
4. THIS DOCUMENT ADDRESSES PRODUCT ANCHORAGE TO ACHIEVE THE INDICATED DESIGN PRESSURES AT THE INDICATED SIZES, IN THE CONFIGURATION SHOWN IN THE ELEVATIONS. INSTALL PRODUCTS WITH MAXIMUM SHIM GAP, MINIMUM EDGE DISTANCE AND EMBEDMENT, AND WITH FASTENER TYPE AS SHOWN IN THE DETAILS AND AS INDICATED IN TABLE 1. FOR FULL PRODUCT CONSTRUCTION DETAILS SEE INTERTEK/ATI TEST REPORTS F9932.03-501-44-R2 AND F9932.04-501-44-R2.
5. APPROVED GLAZING IS 7/8" OVERALL INSULATING GLASS 3/16" TEMPERED EXTERIOR + GED STAINLESS STEEL INTERCEPT SPACER + 5/16" LAMINATED LITE INTERIOR CONSISTING OF 1/8" ANNEALED + 0.090" SENTRY GLAS INTERLAYER BY KURARAY + 1/8" ANNEALED. GLAZED WITH SIKAFLEX 552 BACKBEDDING W/ 5/8" GLASS BITE.
6. THE 4/3 ALLOWABLE STRESS INCREASE FACTOR (SHORT-TERM INCREASE FACTOR) HAS NOT BEEN USED IN THE ANCHOR ANALYSIS FOR THIS SYSTEM. THE 1.6 Cd FACTOR WAS USED IN THE ANALYSIS OF ANCHORAGE INTO WOOD SUBSTRATE.
7. THE OPENING SUBSTRATE MATERIALS (FRAMING, MASONRY, BUCKS) AND ATTACHMENT OF BUCKS TO THE SUBSTRATE ARE BY OTHERS AND SHALL BE VERIFIED BY THE ARCHITECT OR ENGINEER OF RECORD OR AS APPROVED BY THE AUTHORITY HAVING JURISDICTION (AHJ). BUCKING, OPENINGS, & BUCKING FASTENERS MUST BE PROPERLY DESIGNED & INSTALLED BY OTHERS TO TRANSFER SUPERIMPOSED LOADS TO THE STRUCTURE. WITH MASONRY OPENINGS, WOOD BUCKS ARE OPTIONAL.
8. DISSIMILAR MATERIALS THAT COME INTO CONTACT SHALL BE COATED OR OTHERWISE PROTECTED TO PREVENT GALVANIC REACTIONS. WOOD BUCKS, IF USED, SHALL BE PRESSURE TREATED, WITH EITHER A TREATMENT OR COATING COMPATIBLE WITH THIS PRODUCT.
9. ALL ANCHORS USED SHALL BE OF A MATERIAL OR HAVE A COATING COMPATIBLE WITH THE PRESSURE TREATED WOOD BUCKS AND ALL OTHER WINDOW MATERIALS.
10. ALL HARDWARE & FASTENERS SHALL BE IN ACCORDANCE WITH THESE DRAWINGS, OR AS APPROVED, SIGNED, AND SEALED BY A TEXAS REGISTERED PROFESSIONAL ENGINEER ON A SITE-SPECIFIC BASIS.
11. SEALING AND FLASHING STRATEGIES FOR OVERALL WATER INFILTRATION RESISTANCE OF THE INSTALLED PRODUCT SHALL BE THE RESPONSIBILITY OF OTHERS AND ARE NOT ADDRESSED BY THIS DOCUMENT.
12. FOR ADDITIONAL REQUIREMENTS SEE GENERAL ANCHOR NOTES, SHEET 3.

CAMELOT SLIDING GLASS DOOR, LARGE MISSILE IMPACT

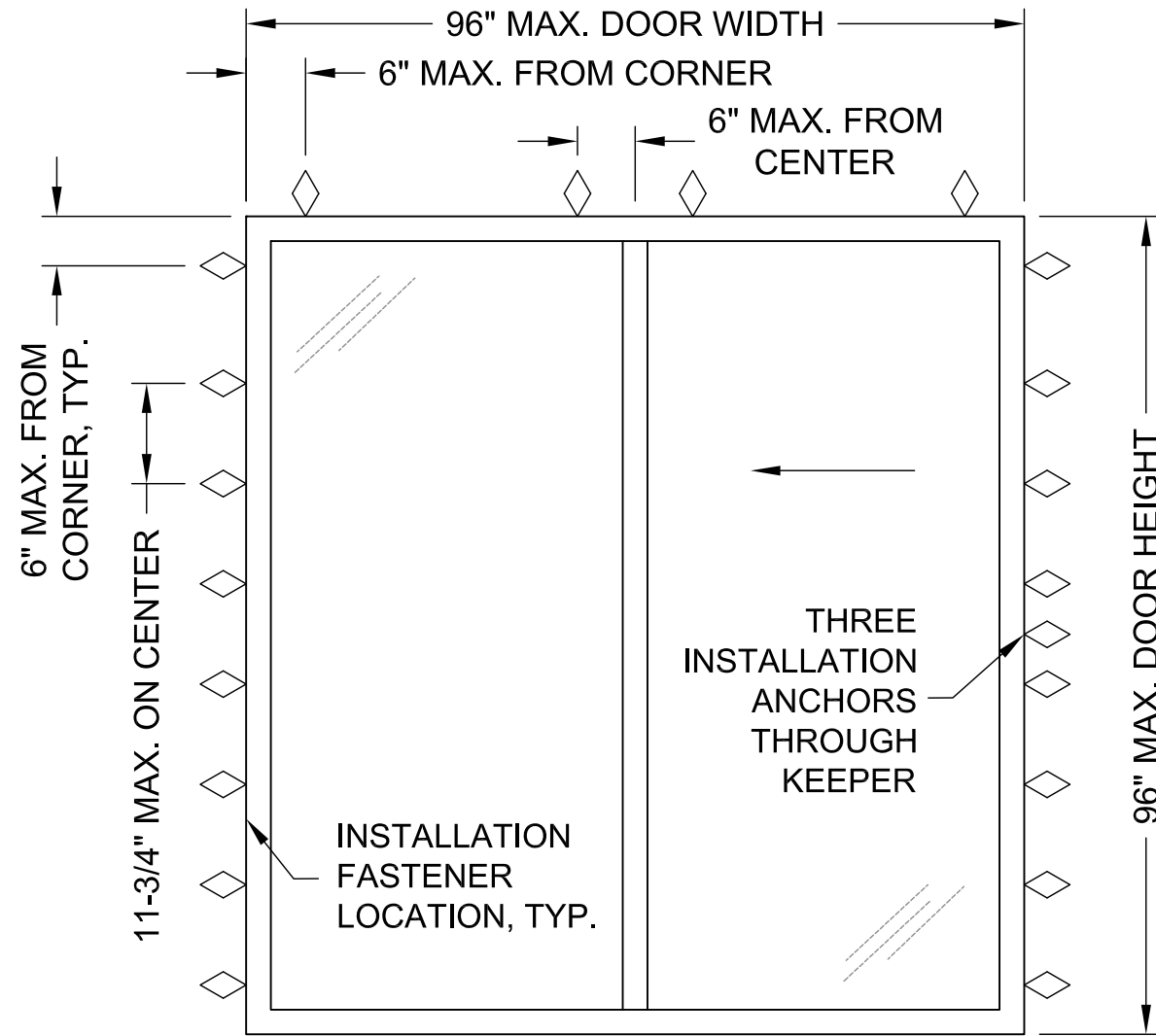

**REPLACEMENT OX OR XO ELEVATION
SEE DETAILS SHEET 3**

DESIGN PRESSURE RATING	IMPACT RATING
+50/-50 PSF	WIND ZONE 3 LARGE MISSILE

NORTHEAST BUILDING PRODUCTS

4280 Aramingo Ave., Philadelphia, PA 19124
Ph. (215) 535-7110 www.nbpwindows.com

SHEET DESCRIPTION: NOTES, ELEVATION	DATE DRAWN: 5/11/2017
REV. A: UPDATE TO 2018 IBC/IRC	SCALE: NTS
DRAWING: TDI-CAMELOT-SGD-LM	SHEET: 1 OF 4



2/18/2021
Lucas A. Turner, P.E.
TX PE #115094
2428 Old Natchez Trc Trl
Camden, TN 38320
Ph. 941-380-1574

CAMELOT SLIDING GLASS DOOR, LARGE MISSILE IMPACT

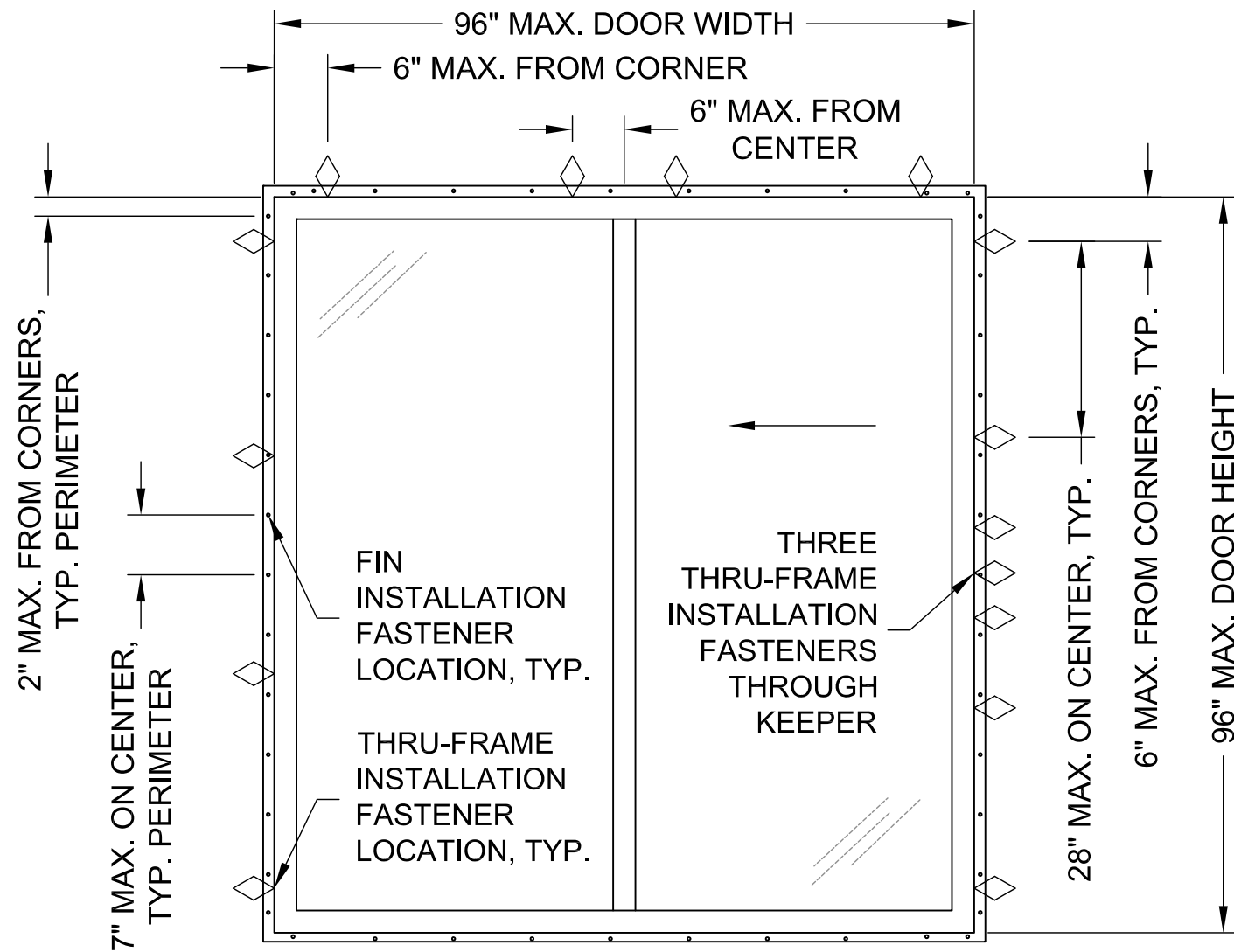

**NEW CONSTRUCTION OX OR XO ELEVATION
SEE DETAILS SHEET 4**

DESIGN PRESSURE RATING	IMPACT RATING
+50/-50 PSF	WIND ZONE 3 LARGE MISSILE

GENERAL ANCHOR NOTES:

1. INSTALL ONE ANCHOR AS INDICATED IN DETAILS ON SHEETS 3 AND 4 AT EACH LOCATION SHOWN IN THE ELEVATIONS ON SHEETS 1 AND 2.
2. INSTALL SHIMS AT EACH ANCHOR LOCATION WHERE A GAP OF 1/16" OR GREATER EXISTS BETWEEN PRODUCT FRAME AND SUBSTRATE.
3. SHIMS SHALL BE LOAD-BEARING (PLASTIC OR METALLIC) AND CAPABLE OF TRANSFERRING LOADS TO SUBSTRATE.
4. SPECIFIED ANCHOR EMBEDMENT TO SUBSTRATE SHALL BE BEYOND WALL FINISH OR STUCCO, BY OTHERS. FOR ATTACHMENT TO METAL SUBSTRATES ENSURE FULL THREAD ENGAGEMENT THROUGH METAL WALL WITH MIN. 3 THREADS BEYOND.
5. FOR MASONRY WITH WOOD BUCKS LESS THAN 1-1/2" THICK, EMBEDMENT SHALL BE BEYOND WOOD BUCKS AND INTO MASONRY. WOOD BUCKS ARE OPTIONAL WITH MASONRY INSTALLATIONS WHERE MASONRY EDGE DISTANCE CONDITIONS ARE MET WITH NO BUCKS. WOOD BUCKS 1-1/2" THICK OR GREATER SHALL HAVE EMBEDMENT INTO THE WOOD BUCKS.
6. ENSURE 4" MIN. ON-CENTER SPACING BETWEEN ANY TWO INSTALLATION ANCHORS (EXCEPTION: 3 ANCHORS IN KEEPER ARE APPROX. 3" APART).



2/18/2021
Lucas A. Turner, P.E.
TX PE #115094
2428 Old Natchez Trc Trl
Camden, TN 38320
Ph. 941-380-1574

NORTHEAST BUILDING PRODUCTS

4280 Aramingo Ave., Philadelphia, PA 19124
Ph. (215) 535-7110 www.nbpwindows.com

SHEET DESCRIPTION: NOTES, ELEVATION	DATE DRAWN: 5/11/2017
REV. A: UPDATE TO 2018 IBC/IRC	SCALE: NTS
DRAWING: TDI-CAMELOT-SGD-LM	SHEET: 2 OF 4

CAMELOT SLIDING GLASS DOOR, LARGE MISSILE IMPACT

SEE GENERAL ANCHOR NOTES, SHEET 2.

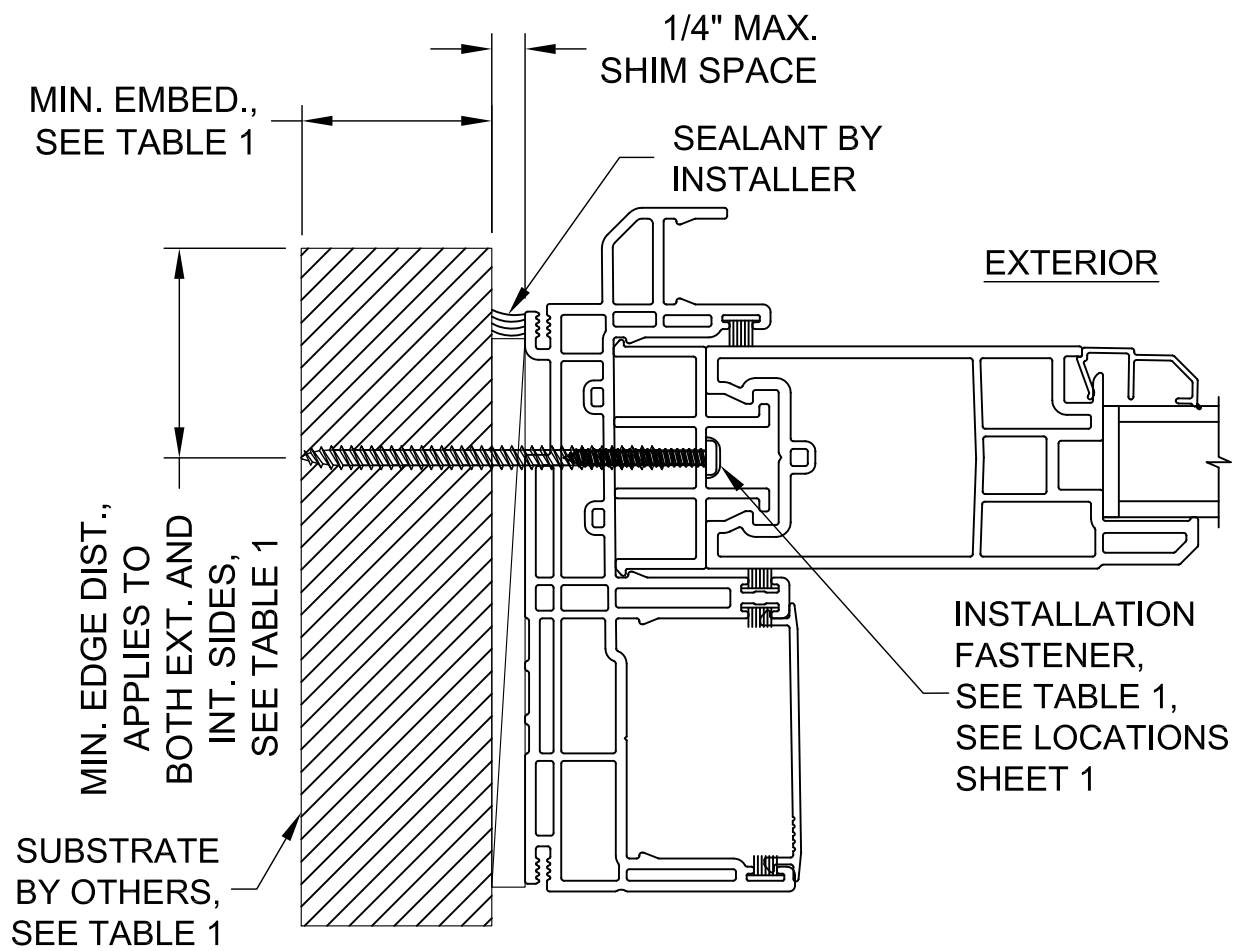

TYPICAL JAMB HORIZONTAL SECTION
(FIXED JAMB SHOWN, LOCK JAMB ANCHORAGE SIMILAR)

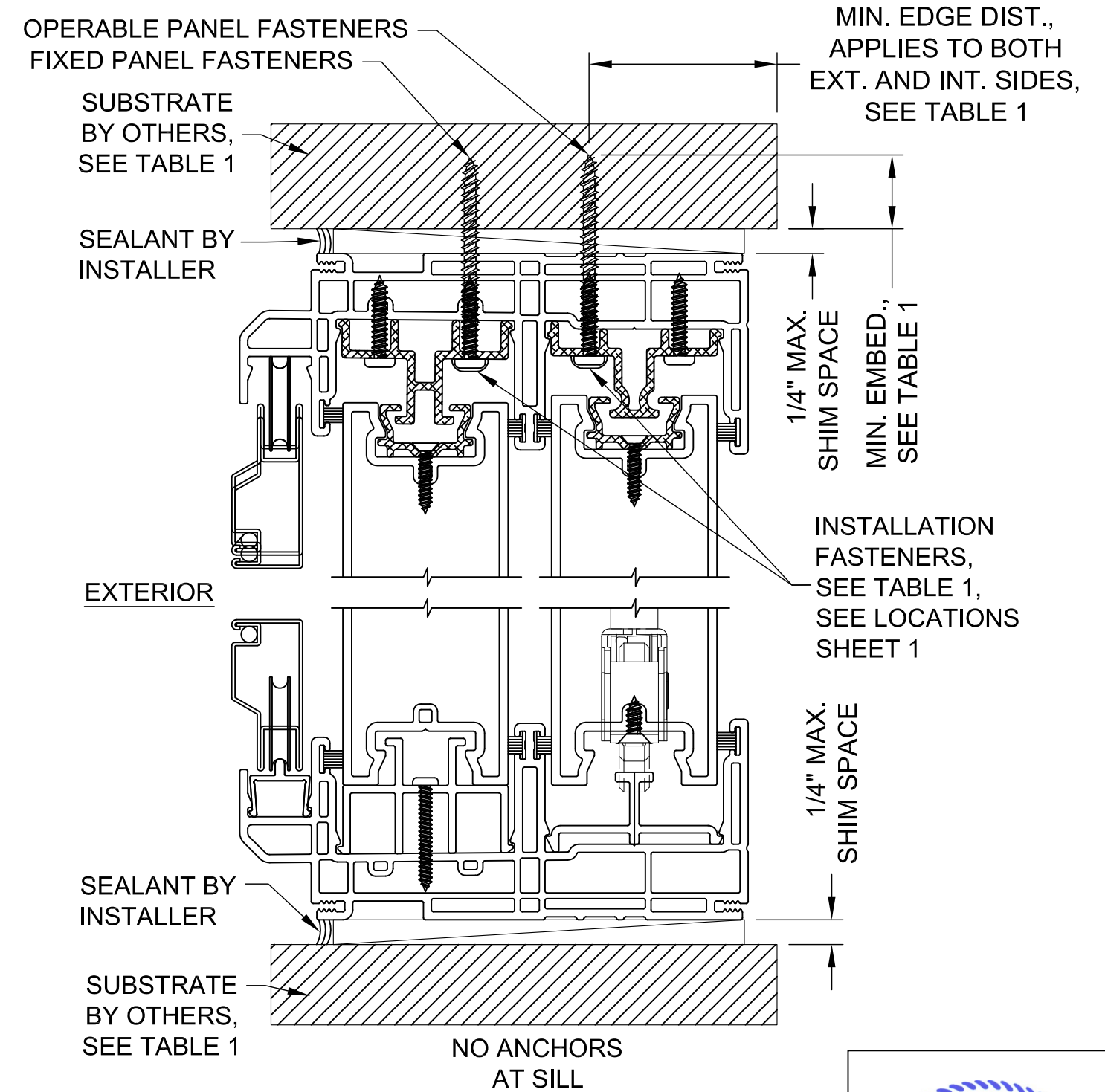

TYPICAL FRAME VERTICAL SECTION

TABLE 1: REPLACEMENT FRAME INSTALLATION ANCHOR REQUIREMENTS TABLE
NOTE: ALL ANCHORS ARE PAN HEAD OR HEX WASHER HEAD

SUBSTRATE TYPE	ANCHOR TYPE	MIN. EMBED.	MIN. EDGE DIST.
HOLLOW OR GROUT-FILLED CMU (117 PCF MIN.)	1/4" ITW TAPCON	1"	1 1/2"
GROUT-FILLED CMU (ASTM C-90)	1/4" ELCO ULTRACON	1 3/4"	2 1/2"
CONCRETE (2.85 KSI MIN.)	1/4" ELCO ULTRACON	1 3/8"	1"
2X MIN. SOUTHERN PINE WOOD (G=0.55)	#12 WOOD SCREW	1 3/8"	1"
16 GAUGE (0.060") MIN. STEEL STUD, 33KSI YIELD MIN., OR 1/8" ALUM. 6063-T5 MIN.	#12-14 HILTI KWIK-FLEX OR ITW TEKS SELF-DRILLING SCREW	FULL	1/2"

NORTHEAST BUILDING PRODUCTS
4280 Aramingo Ave., Philadelphia, PA 19124
Ph. (215) 535-7110 www.nbpwindows.com

SHEET DESCRIPTION: REPLACEMENT INSTALL, ANCHORS	DATE DRAWN: 5/11/2017
REV. A: UPDATE TO 2018 IBC/IRC	SCALE: NTS
DRAWING: TDI-CAMELOT-SGD-LM	SHEET: 3 OF 4



2/18/2021
Lucas A. Turner, P.E.
TX PE #115094
2428 Old Natchez Trc Trl
Camden, TN 38320
Ph. 941-380-1574

CAMELOT SLIDING GLASS DOOR, LARGE MISSILE IMPACT

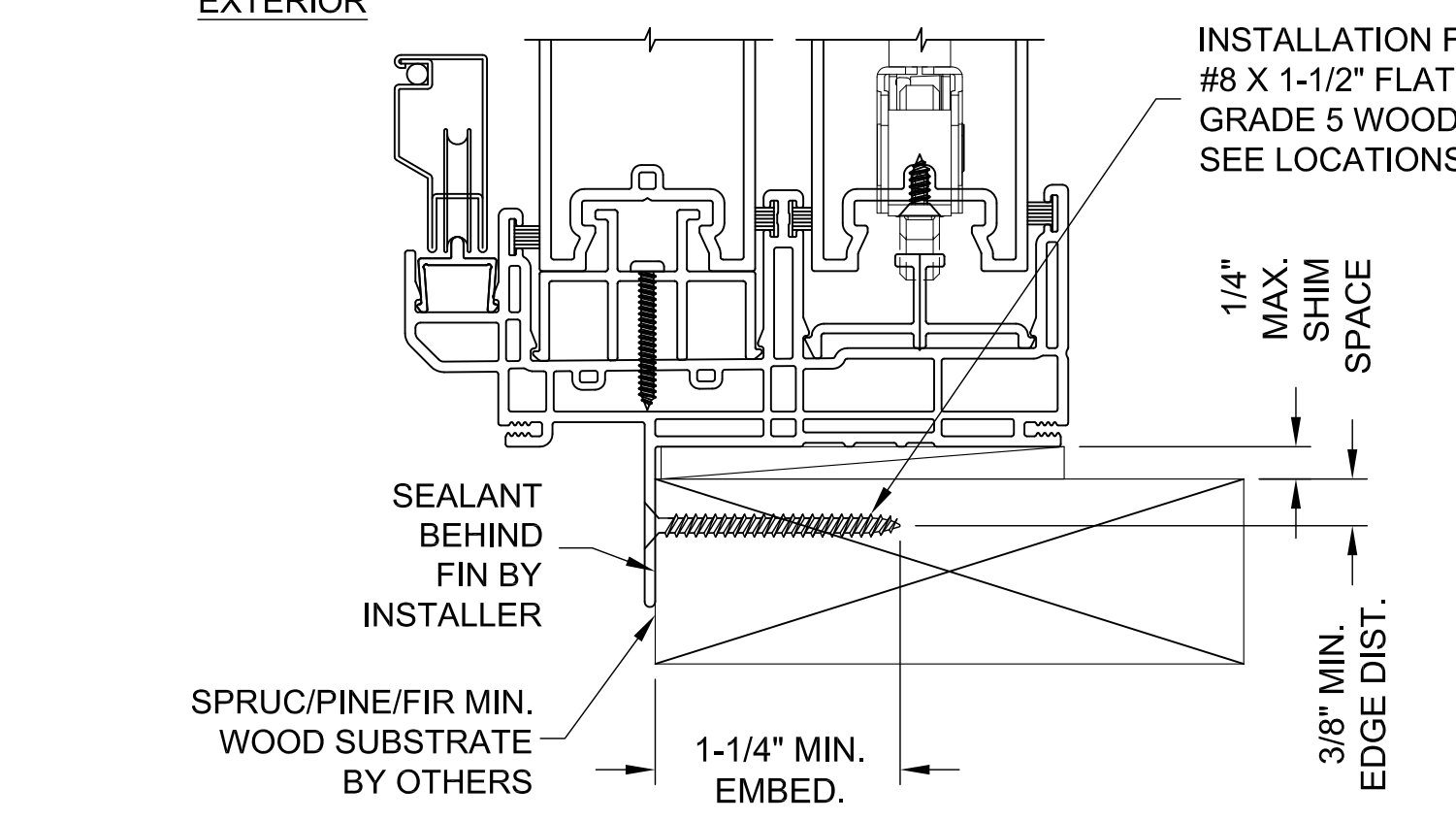
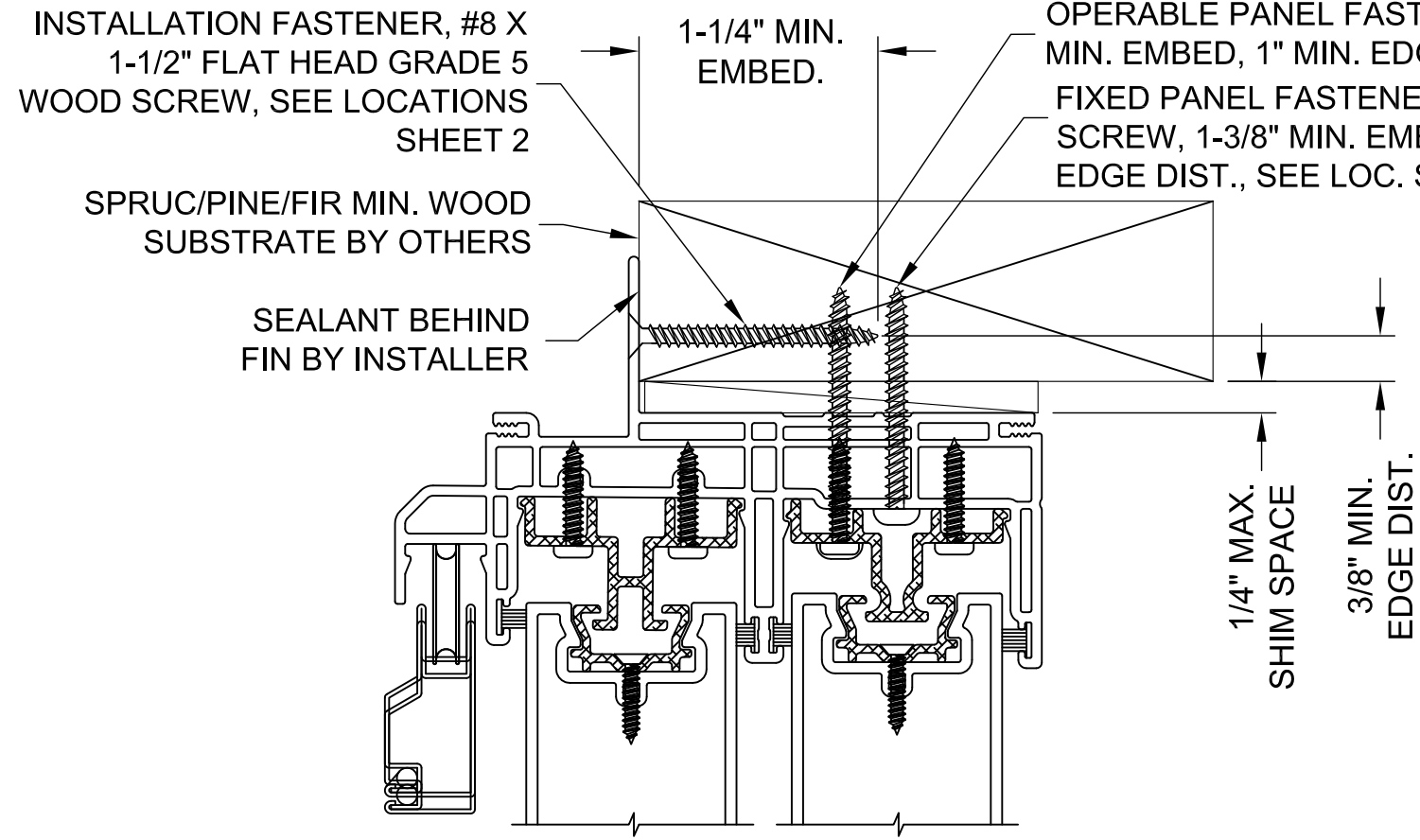

TYPICAL FRAME VERTICAL SECTION

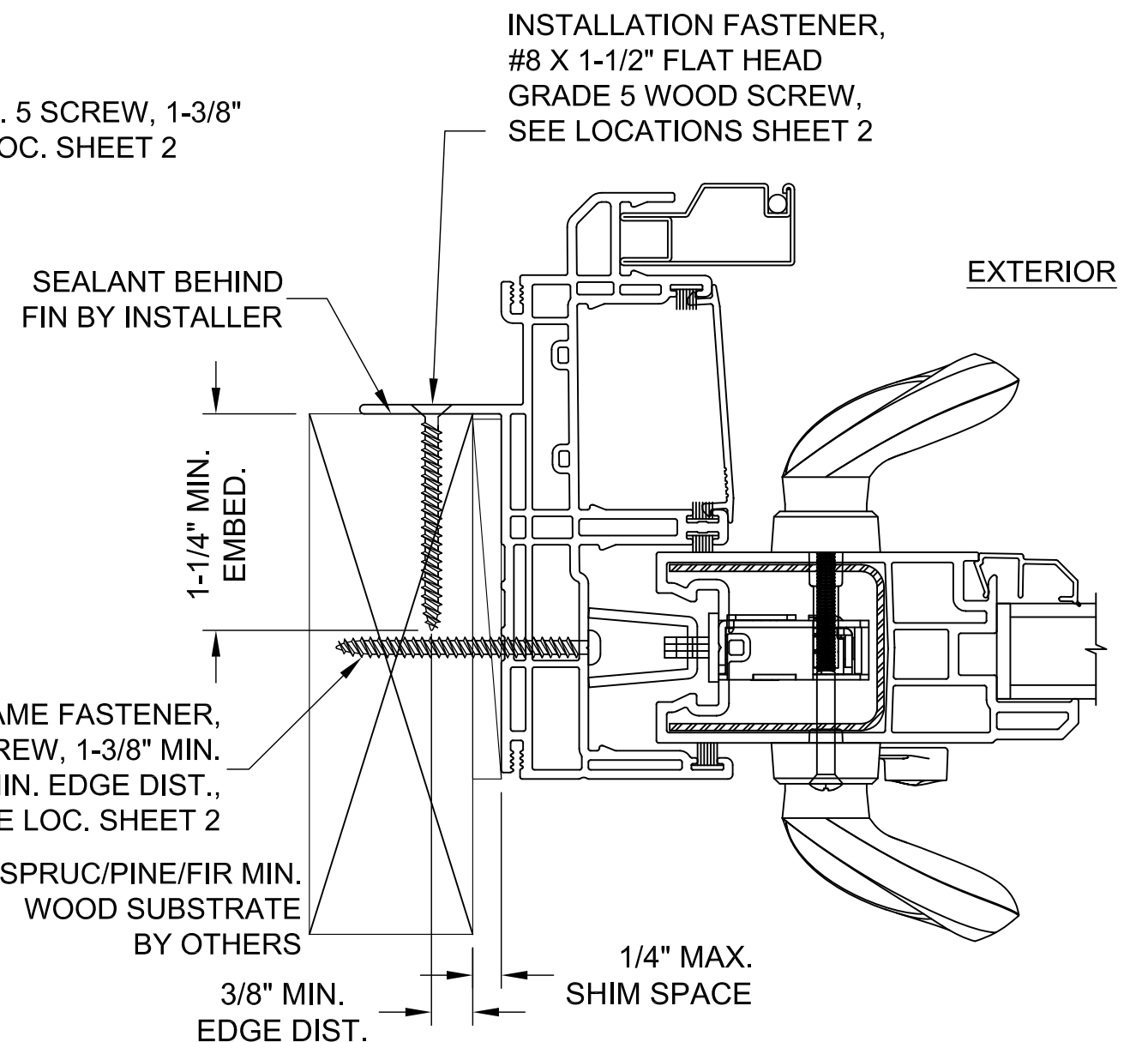

TYPICAL JAMB HORIZONTAL SECTION
(LOCK JAMB SHOWN, FIXED JAMB ANCHORAGE SIMILAR)

SEE GENERAL ANCHOR NOTES, SHEET 2.

NORTHEAST BUILDING PRODUCTS

4280 Aramingo Ave., Philadelphia, PA 19124
Ph. (215) 535-7110 www.nbpwindows.com

SHEET DESCRIPTION: NEW CONSTRUCTION INSTALL	DATE DRAWN: 5/11/2017
REV. A: UPDATE TO 2018 IBC/IRC	SCALE: NTS
DRAWING: TDI-CAMELOT-SGD-LM	SHEET: 4 OF 4



2/18/2021
Lucas A. Turner, P.E.
TX PE #115094
2428 Old Natchez Trc Trl
Camden, TN 38320
Ph. 941-380-1574