

MODEL 8700, 8710, & 8750 SYSTEMS 1 & 2

SWING DOOR & SIDELITE - LARGE MISSILE IMPACT

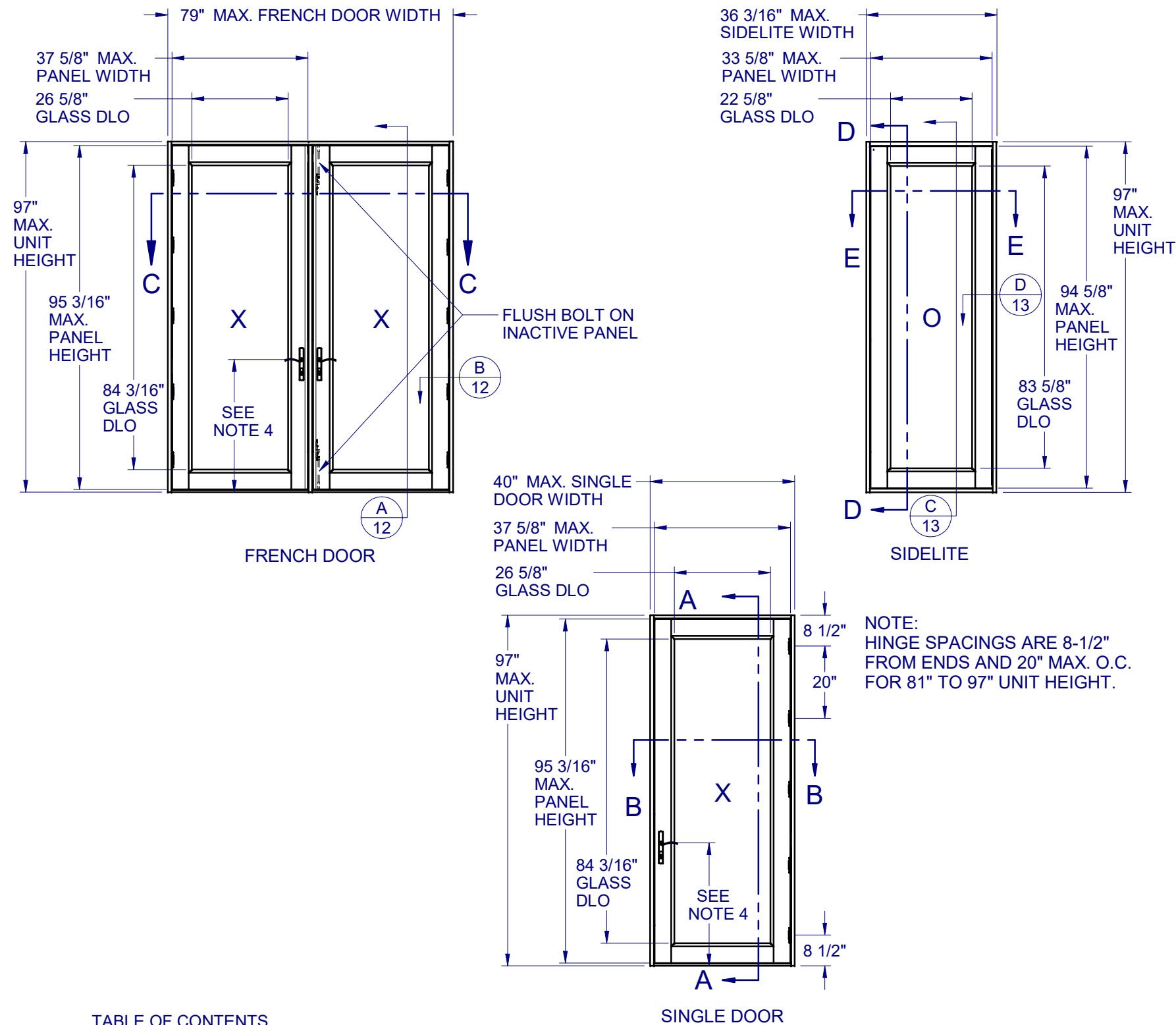

GENERAL NOTES:

1. THE PRODUCT SHOWN HEREIN IS DESIGNED AND MANUFACTURED TO COMPLY WITH THE REQUIREMENTS OF THE 2018 INTERNATIONAL BUILDING CODE AND 2018 INTERNATIONAL RESIDENTIAL CODE.
2. GLAZING OPTIONS: (SEE SHEET 4)
3. CONFIGURATIONS: SINGLE OUTSWING, SINGLE OUTSWING w/SIDELITE(S), FRENCH DOOR(S), FRENCH DOOR(S) w/SIDELITE(S), SIDELITE NOT ATTACHED.
4. LOCK OPTIONS:
UP TO 6'8":
A. DOUBLE BORE w/TWO (2) INTERIOR FLUSH BOLTS. HANDLE SET @ 36"
B. MORTISE LOCK w/ TWO (2) INTERIOR FLUSH BOLTS. HANDLE SET @ 34"
C. MULTIPOINT (4 PT.) HANDLE SET @ 34"
ABOVE 6'8":
A. MULTIPOINT (5 PT.) HANDLE SET @ 34"
5. ANCHORAGE: THE 33 1/3% STRESS INCREASE HAS NOT BEEN USED IN THE DESIGN OF THIS PRODUCT. SEE SHEETS 12-13 FOR ANCHOR DETAILS. WINDLOAD DURATION FACTOR Cd=1.6 WAS USED FOR WOOD ANCHOR CALCULATIONS.
6. PRODUCTS APPROVED FOR IMPACT RESISTANCE. SHUTTERS ARE NOT REQUIRED.
7. ALL FRAMES ARE PROCESSED AND SCREWED TOGETHER. PANELS ARE PROCESSED AND ASSEMBLED VIA TIE ROD.
8. SERIES / MODEL DESIGNATION SD-8700, FD-8750, SLT-8710.
9. THE DESIGNATION X AND O STAND FOR THE FOLLOWING:
X = OPERABLE SASH, O = FIXED SASH
10. SECTION CALLOUTS APPLY TO ALL CONFIGURATIONS IN A SIMILAR LOCATION.
11. INTERIOR FLUSH BOLTS ON ACTIVE PANEL TO BE ENGAGED PRIOR TO SEVERE WEATHER.
12. QUALIFIED ALTERNATIVE LOCKSET/DEADBOLT HARDWARE IS GRADE 2 BY PAMEX AND DELANY.
13. MAX. PANEL WIDTHS APPLY TO ALL CONFIGURATIONS, MULLED OR NON-MULLED UNITS.

Custom
WINDOW SYSTEMS

1900 SW 44TH AVE.
OCALA, FLORIDA 34474
WWW.CWS.CC

8700/10/50 PVC SWING DOOR IMPACT

NO.	DESCRIPTION:	BY:	DATE:
B	REVISED TO TDI REQUEST JLD	JLD	6/07/21
A	REVISED TO TDI REQUEST JML	JML	3/29/17



6/8/2021

LUCAS A. TURNER, P.E.
TX PE # 115094
2428 Old Natchez Trc Trl
Camden, TN 38320
PH. 941-380-1574

SHEET DESCRIPTION:

GENERAL NOTES AND ELEVATIONS

DRAWN BY: EMK	DATE: 11/13/15
DWG #: TDI-641	REV.: -
SCALE: 1:35	SHEET 1 OF 13

TABLE OF CONTENTS

GENERAL NOTES & ELEVATIONS.....	1-3
GLAZING DETAILS.....	4
SECTION VIEWS.....	5-7
BOM.....	8
EXTRUSIONS.....	9
ANCHOR SCHEDULE & NOTES.....	10-11
INSTALLATION DETAILS.....	12-13

8700/10/50 PVC SWING DOOR IMPACT

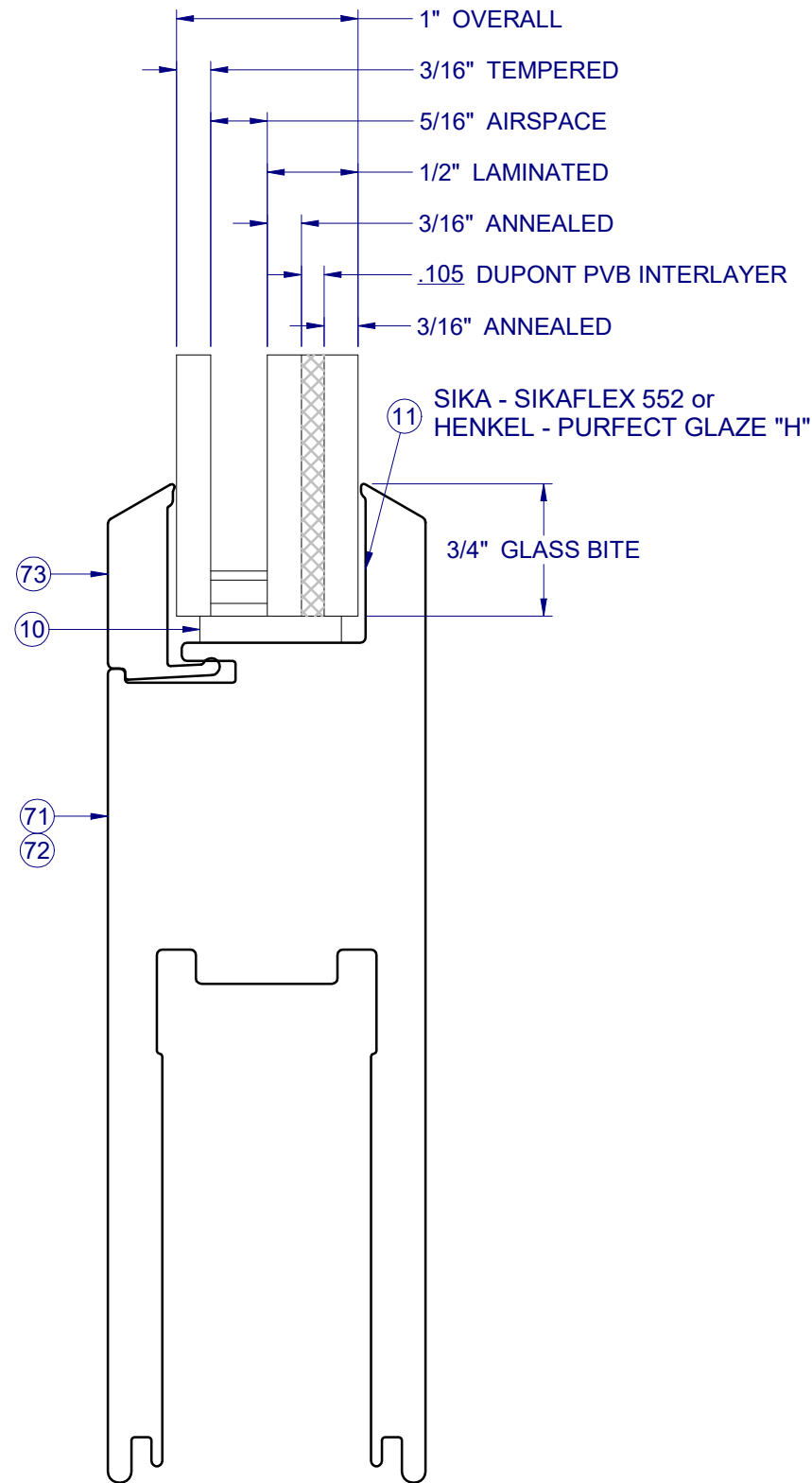

SYSTEM 1

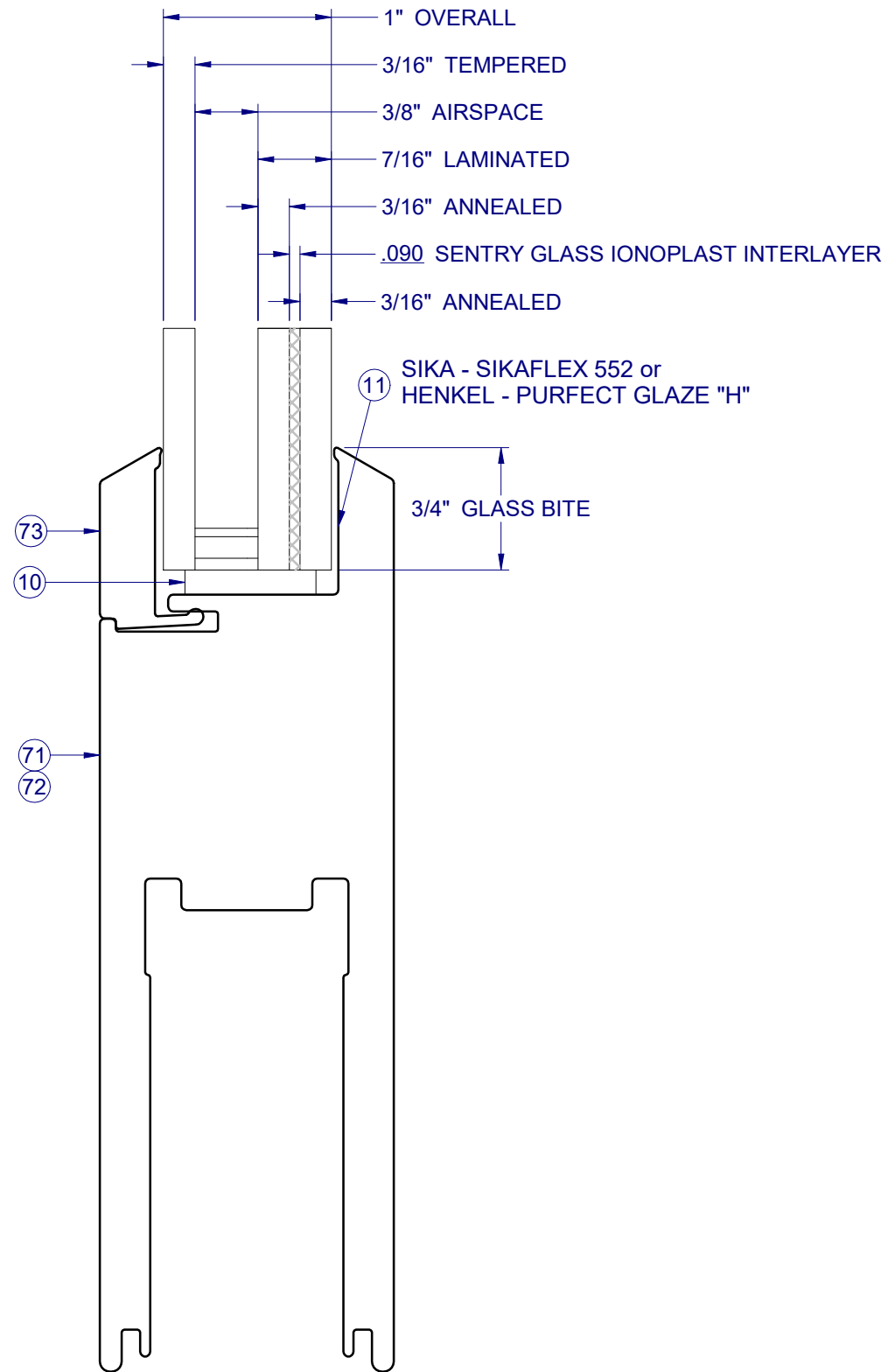

SYSTEM 2

NO.	DESCRIPTION:	BY:	DATE:
B	REVISED TO TDI REQUEST JLD	JLD	6/07/21
A	REVISED TO TDI REQUEST JML	JML	3/29/17

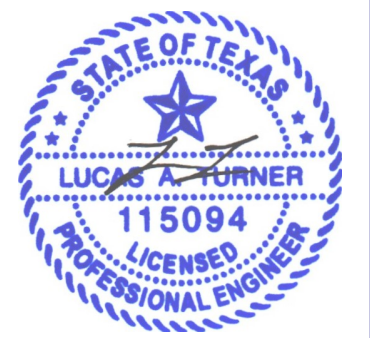

6/8/2021

LUCAS A. TURNER, P.E.
TX PE # 115094
2428 Old Natchez Trc Trl
Camden, TN 38320
PH. 941-380-1574

SHEET DESCRIPTION:

GLAZING DETAILS

DRAWN BY: EMK	DATE: 11/13/15
DWG #: TDI-641	REV.: -
SCALE: 1:1	SHEET 4 OF 13

REVISIONS

8700/10/50 PVC SWING DOOR IMPACT

NO.	DESCRIPTION:	BY:	DATE:
B	REVISED TO TDI REQUEST JLD	JLD	6/07/21
A	REVISED TO TDI REQUEST JML	JML	3/29/17

REVISIONS



6/8/2021

LUCAS A. TURNER, P.E.
TX PE # 115094
2428 Old Natchez Trc Trl
Camden, TN 38320
PH. 941-380-1574

SHEET DESCRIPTION:

**SECTION VIEWS
SINGLE DOOR**

DRAWN BY: EMK	DATE: 11/13/15
DWG #: TDI-641	REV.: -
SCALE: 1:2	SHEET 5 OF 13

INTERIOR

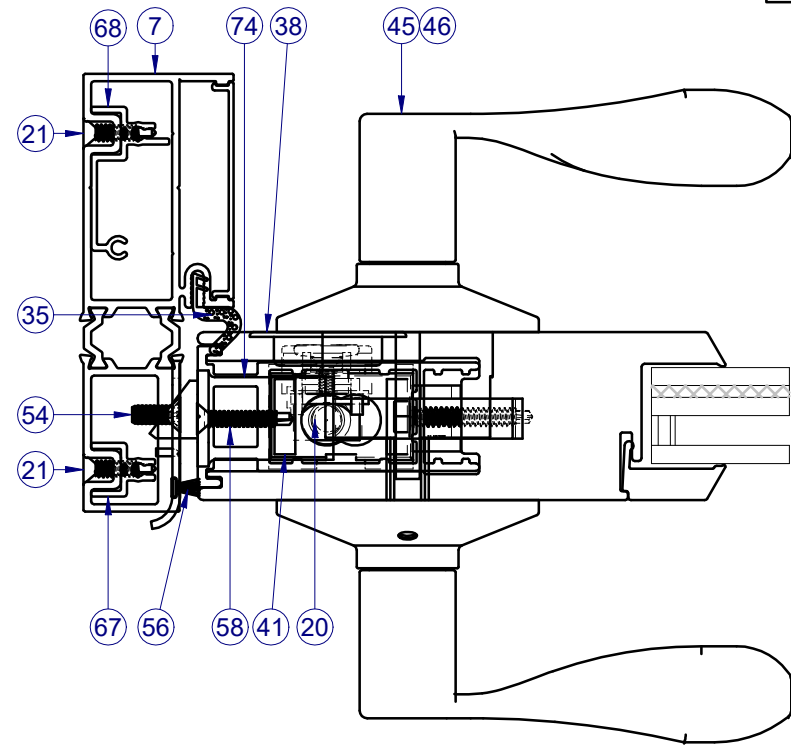

SECTION VIEW B-B

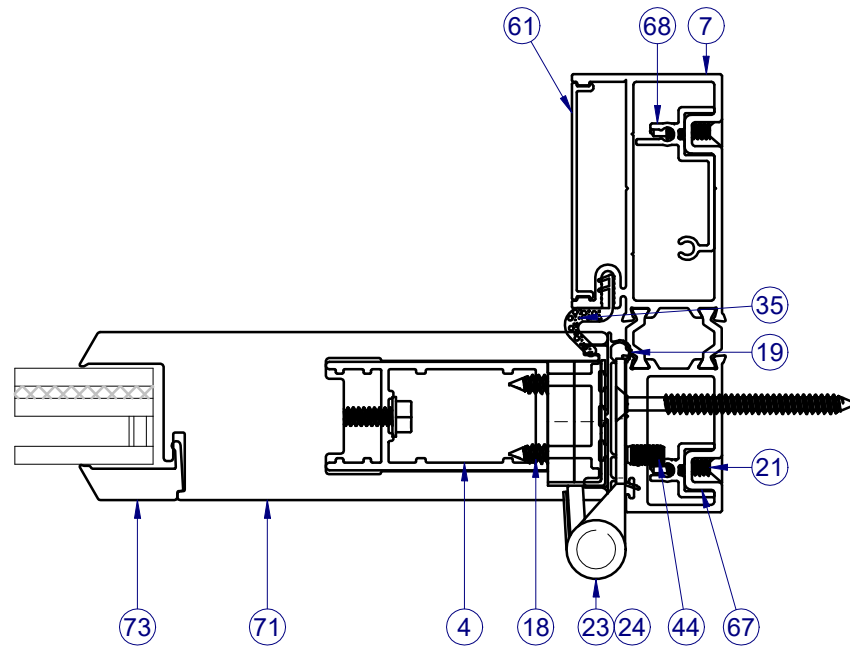

INTERIOR

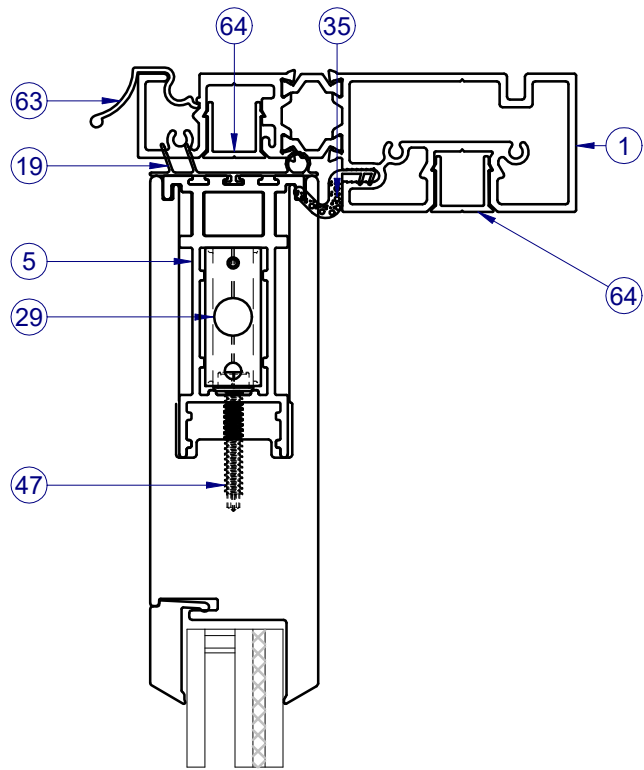

SECTION VIEW A-A

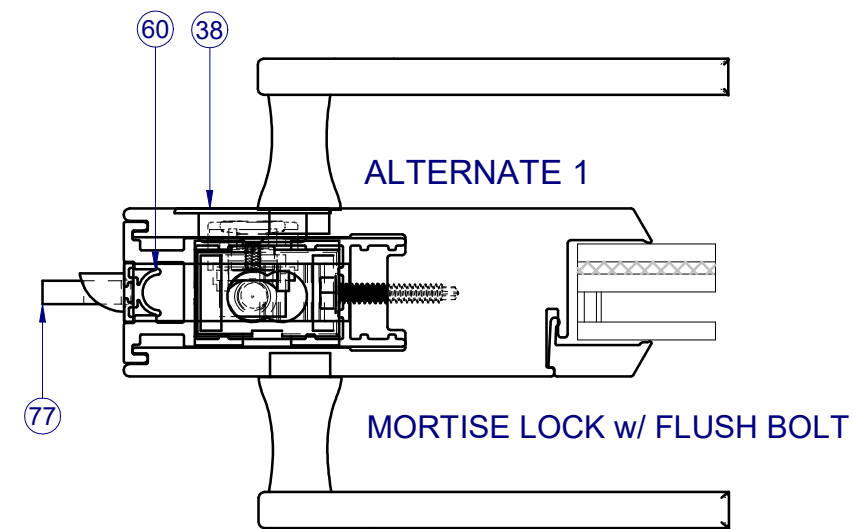
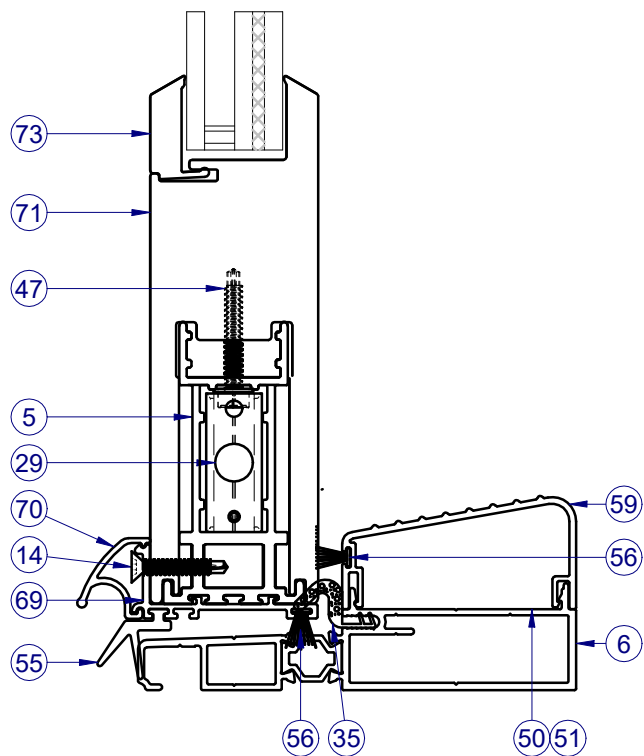

ALTERNATE 1

MORTISE LOCK w/ FLUSH BOLT

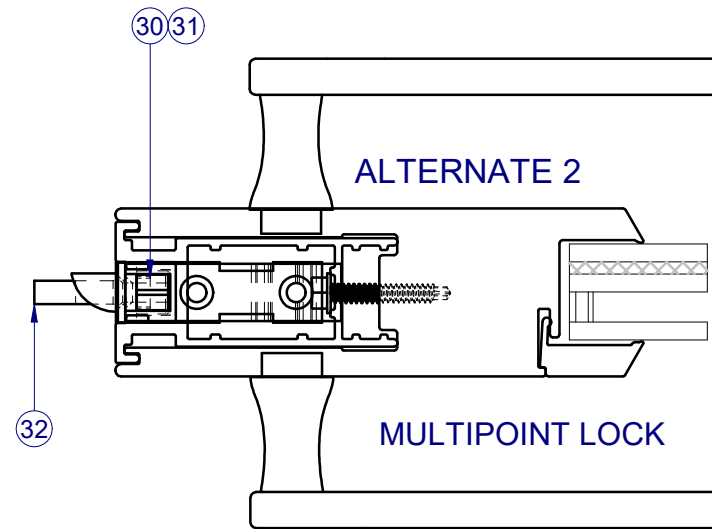

ALTERNATE 2

MULTIPOINT LOCK

ITEMS NOT SHOWN FOR CLARITY:
10-12, 13, 15-17, 22, 43, 48, 54, 57-58

ITEMS NOT USED IN VERSION SHOWN:
2-3, 8-9, 15-16, 25-28, 30-34, 36-40, 43, 52-53, 60, 62, 65-66, 72, 76

**8700/10/50 PVC
SWING DOOR
IMPACT**

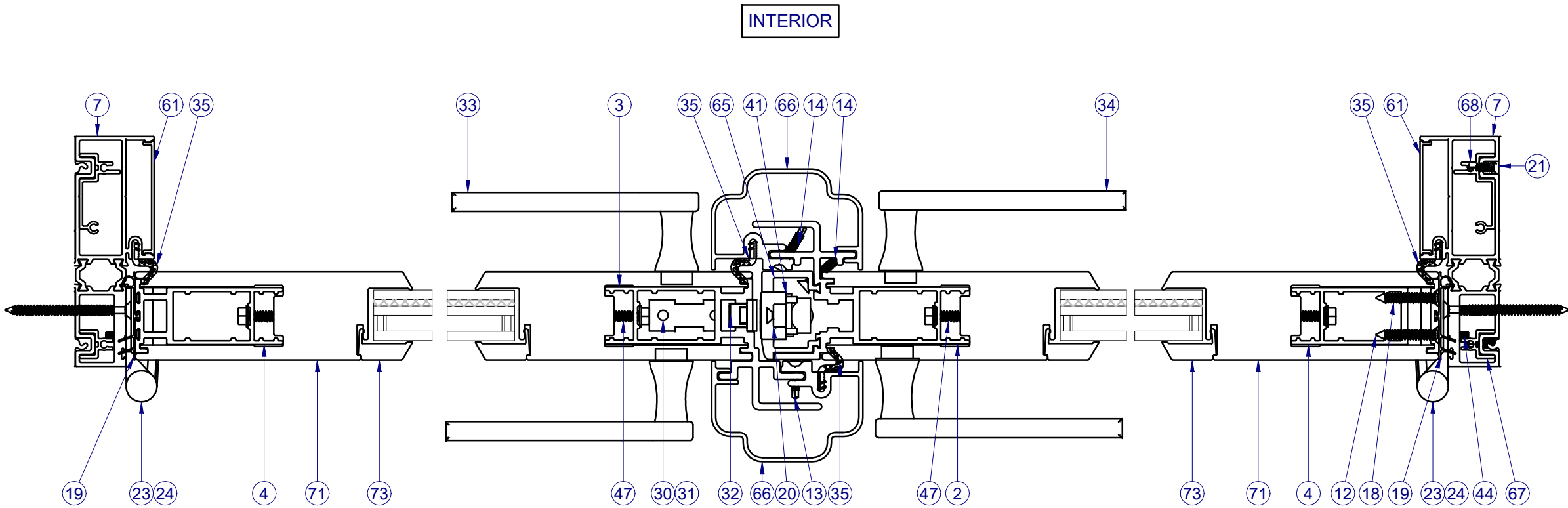

SECTION VIEW C-C

NOTE: VERTICAL SECTION SIMILAR TO SINGLE DOOR, SEE SHEET 5

ITEMS NOT SHOWN FOR CLARITY:
10-13, 15-17, 22, 26-28, 36-39, 43, 54, 57

ITEMS NOT USED IN VERSION SHOWN:
8-9, 15-16, 25, 40, 42, 45-46, 48, 52-53, 58, 60, 74, 76

NO.		DESCRIPTION:	BY:	DATE:
B		REVISED TO TDI REQUEST JLD	JLD	6/07/21
A		REVISED TO TDI REQUEST JML	JML	3/29/17



6/8/2021

LUCAS A. TURNER, P.E.
TX PE # 115094
2428 Old Natchez Trc Trl
Camden, TN 38320
PH. 941-380-1574

SHEET DESCRIPTION:
**SECTION VIEWS
FRENCH DOOR**

DRAWN BY: EMK	DATE: 11/13/15
DWG #: TDI-641	REV.: -
SCALE: 1:2.5	SHEET 6 OF 13

REVISIONS

**8700/10/50 PVC
SWING DOOR
IMPACT**

NO.	DESCRIPTION:	BY:	DATE:
B	REVISED TO TDI REQUEST	JLD	6/07/21
A	REVISED TO TDI REQUEST	JML	3/29/17

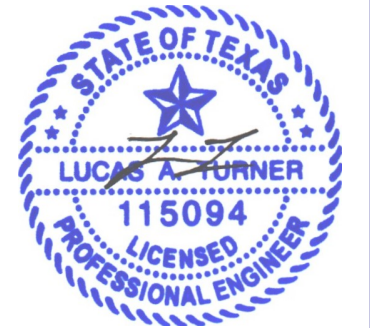

6/8/2021

LUCAS A. TURNER, P.E.
TX PE # 115094
2428 Old Natchez Trc Trl
Camden, TN 38320
PH. 941-380-1574

SHEET DESCRIPTION:

**SECTION VIEWS
ATTACHED SIDELITE**

DRAWN BY:	DATE:
EMK	11/13/15
DWG #:	REV.:
TDI-641	-
SCALE:	SHEET
1:2	7 OF 13

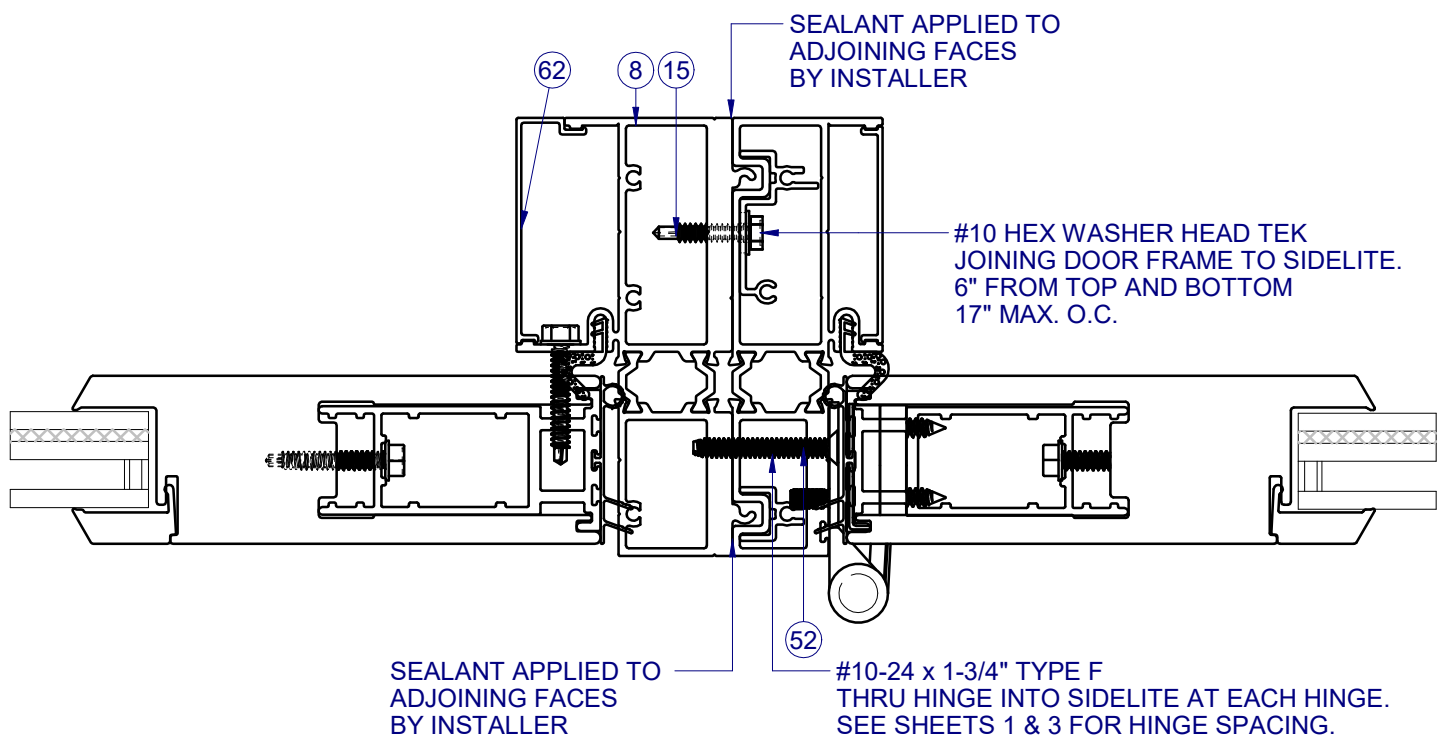
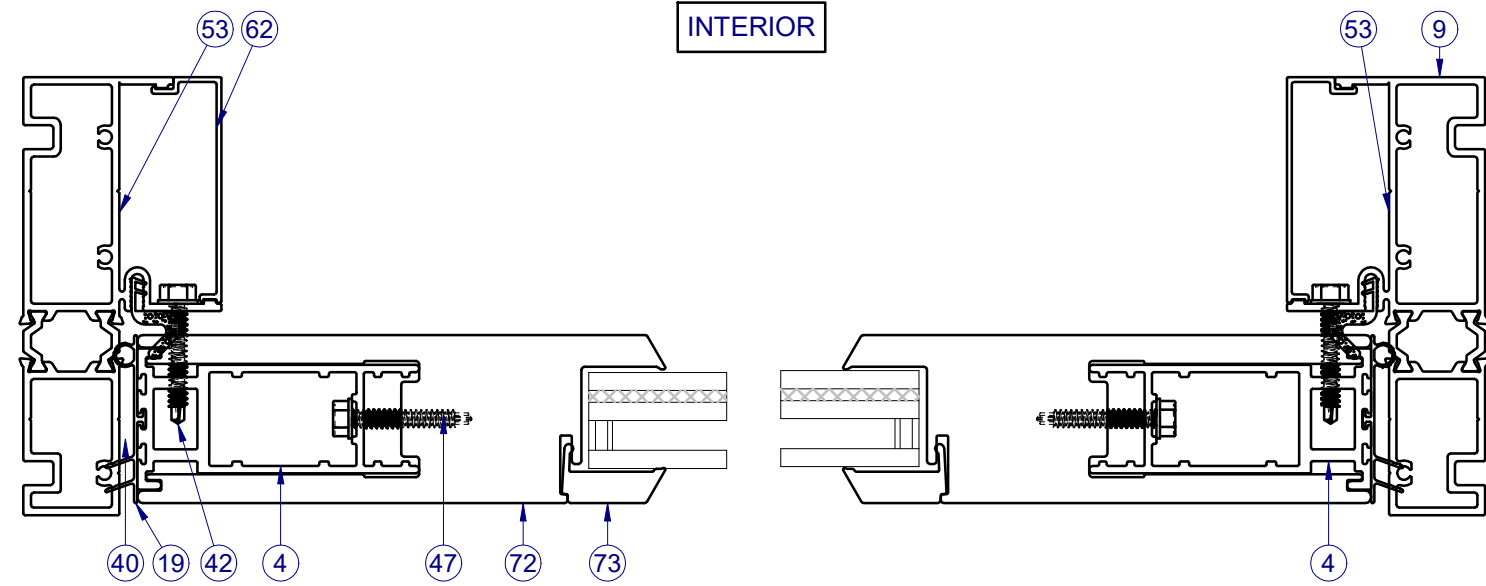
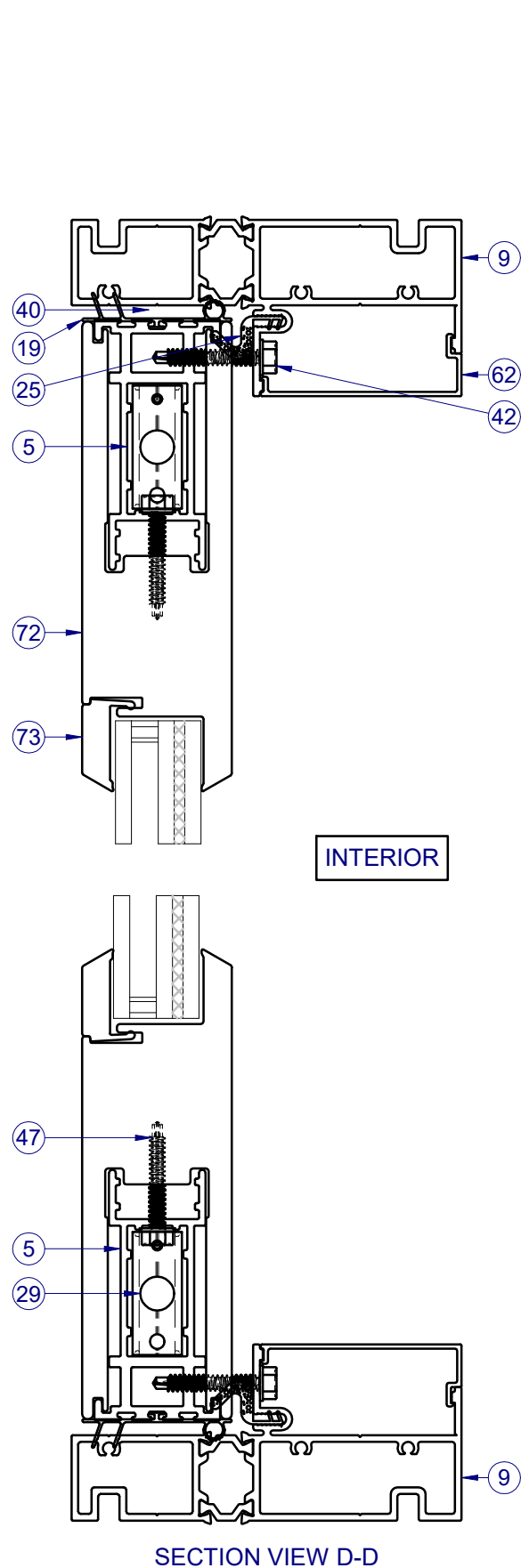

ITEMS NOT SHOWN FOR CLARITY:
10-11, 16, 22, 28, 43, 57

ITEMS NOT USED IN VERSION SHOWN:
1-3, 6-15, 17-18, 20-21, 23-24, 26-27, 30-39, 41, 44-46, 48-52, 54-56, 58-61, 63-71, 74-76

8700/10/50 PVC SWING DOOR IMPACT

NO.	DESCRIPTION:	BY:	DATE:
B	REVISED TO TDI REQUEST JLD	JLD	6/07/21
A	REVISED TO TDI REQUEST JML	JML	3/29/17

REVISIONS

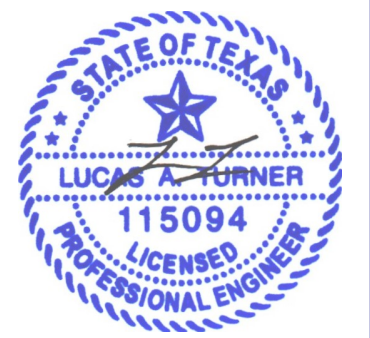

6/8/2021

LUCAS A. TURNER, P.E.
TX PE # 115094
2428 Old Natchez Trc Trl
Camden, TN 38320
PH. 941-380-1574

SHEET DESCRIPTION:
EXTRUSIONS

DRAWN BY: EMK	DATE: 11/13/15
DWG #: TDI-641	REV.: -
SCALE: 1:2	SHEET 9 OF 13

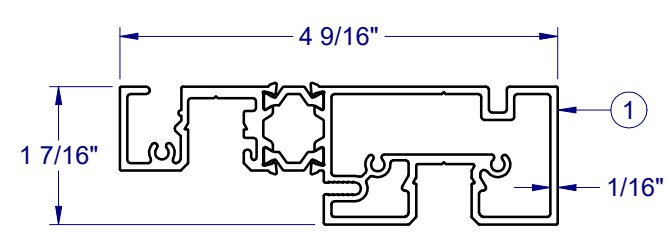

DOOR HEAD-1833

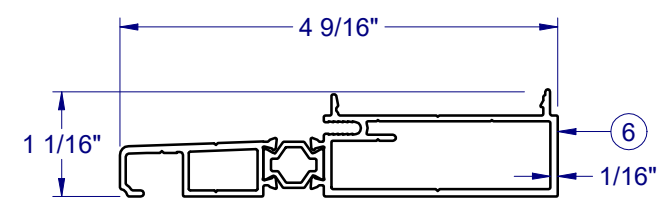

DOOR SILL-1878

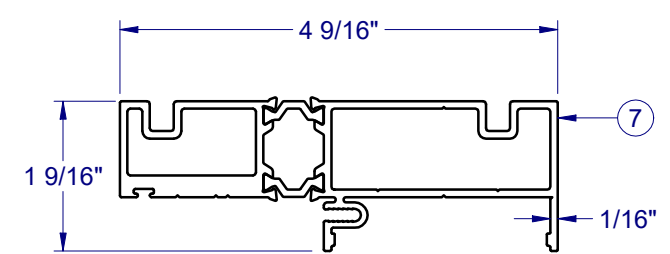

DOOR JAMB-1880

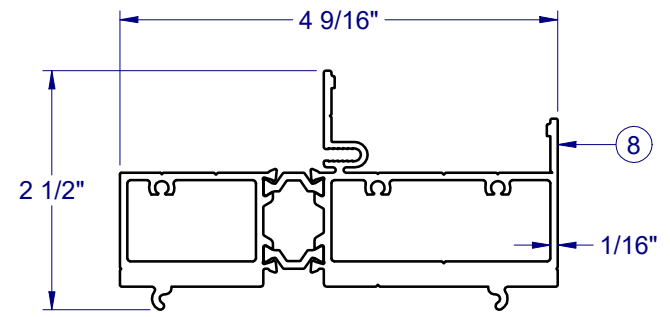

SIDELITE-1881

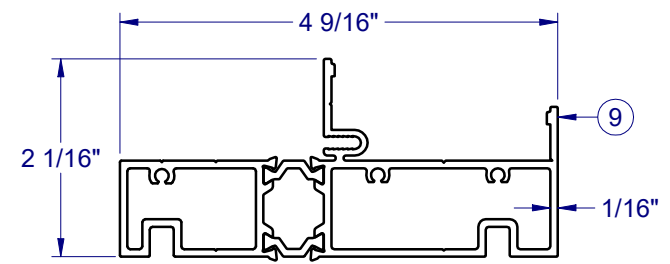

SIDELITE-1900

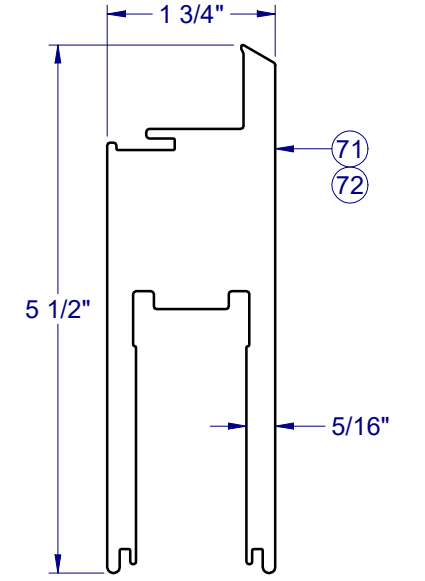

PVC DOOR PANEL - 6083

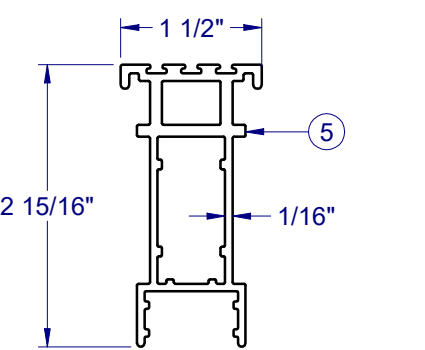

REINFORCEMENT - 1861

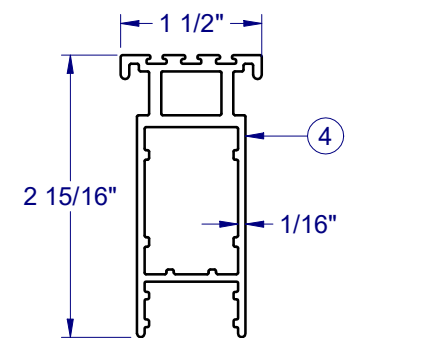

REINFORCEMENT-1860

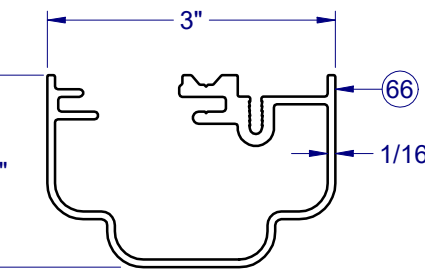

ASTRAGAL COVER-1859

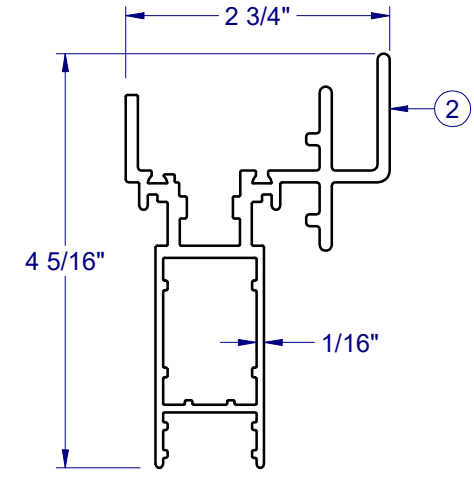

REINFORCEMENT - 1857

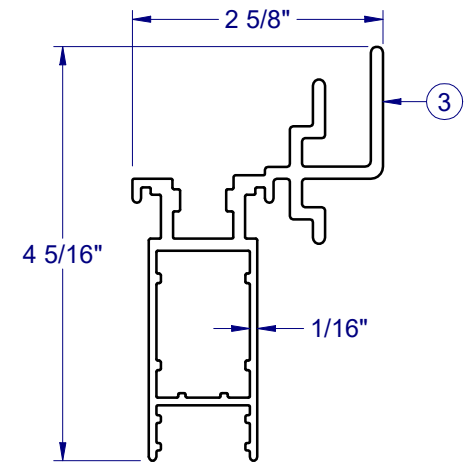

REINFORCEMENT - 1858

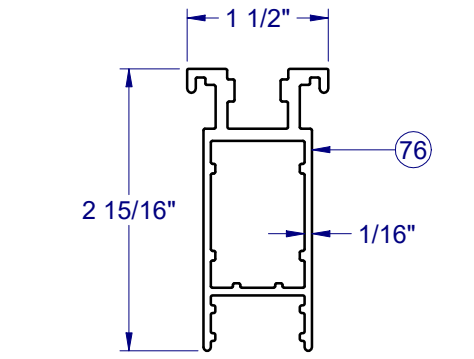

REINFORCEMENT - 1862

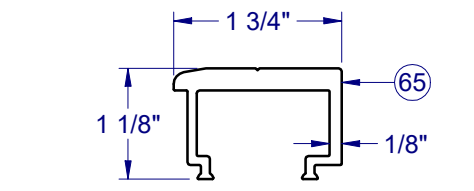

INSERT, INACTIVE PNL -1849

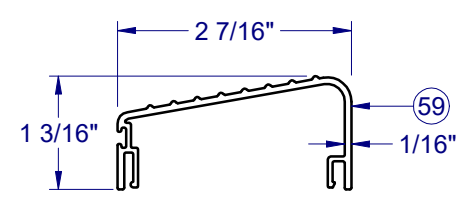

THRESHOLD - 1783

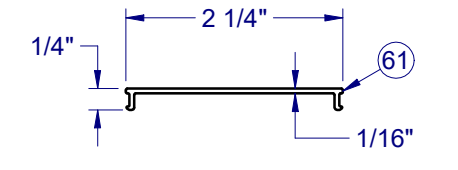

FRAME COVER - 1806

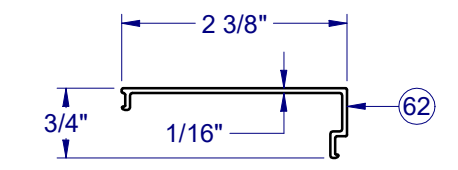

SIDELITE COVER - 1816

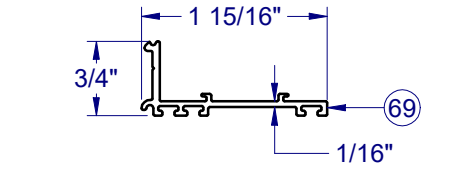

BASE SWEEP - 1915

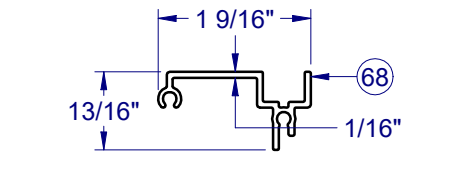

INSERT, BACK - 1865

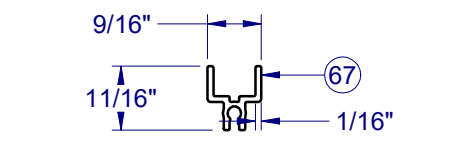

INSERT, FRONT - 1864

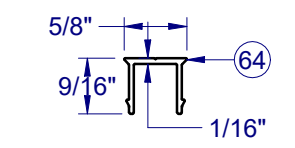

HEAD COVER - 1840

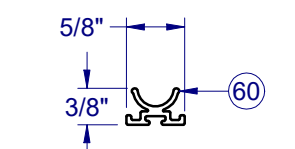

FILLER - 1784

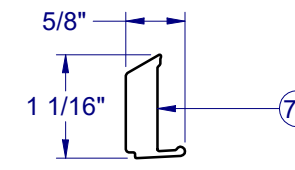

PVC GLAZING BEAD - 6084

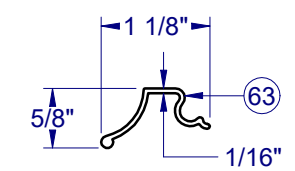

DRIP CAP - 1817

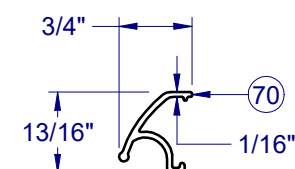

DRIP COVER - 1916

NOTE: ALL EXTRUSIONS ARE 6063-T6 ALUMINUM

*** CIRCLED ANCHOR LOCATIONS REQ'D ONLY IN WOOD AND METAL INSTALLATIONS. DO NOT INSTALL THESE ANCHORS INTO MASONRY.**



1900 SW 44TH AVE.
OCALA, FLORIDA 34474
WWW.CWS.CC

8700/10/50 PVC SWING DOOR IMPACT

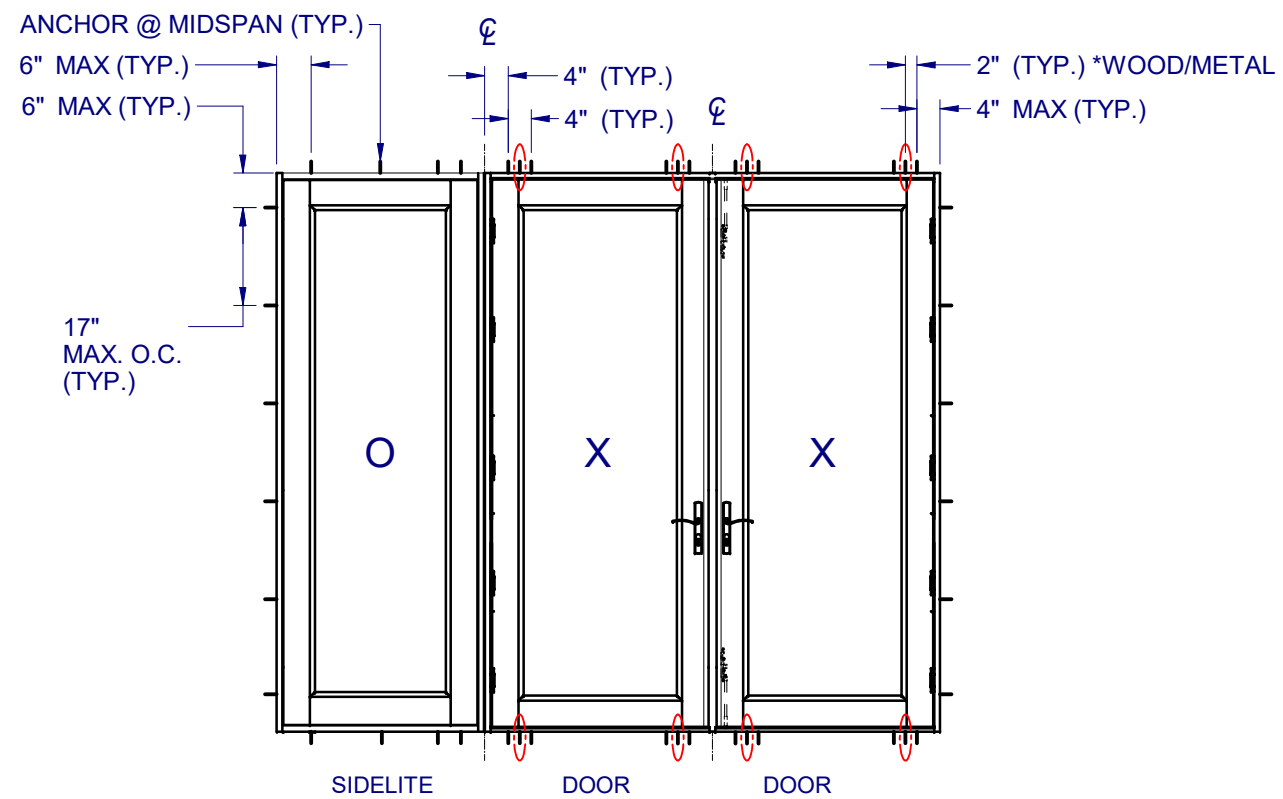
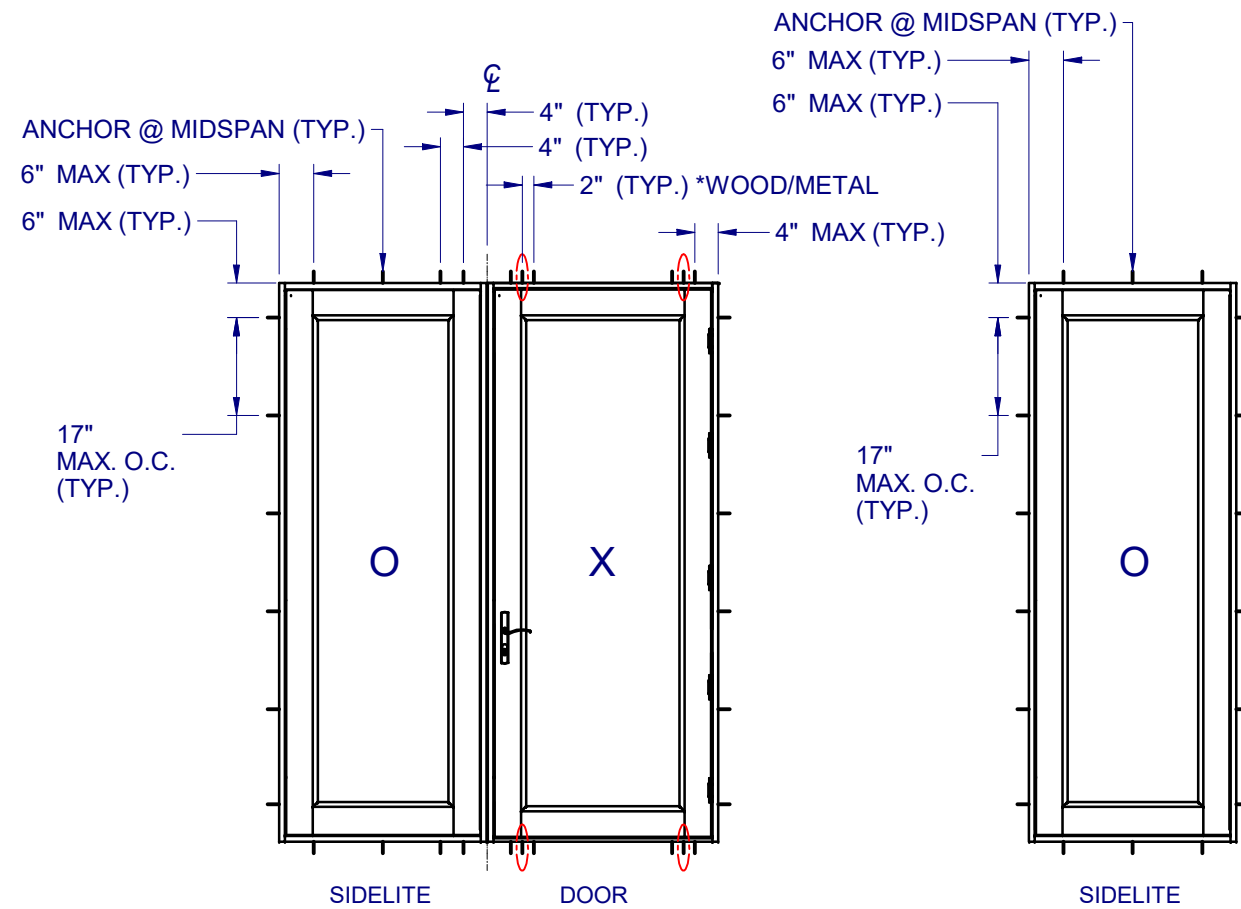
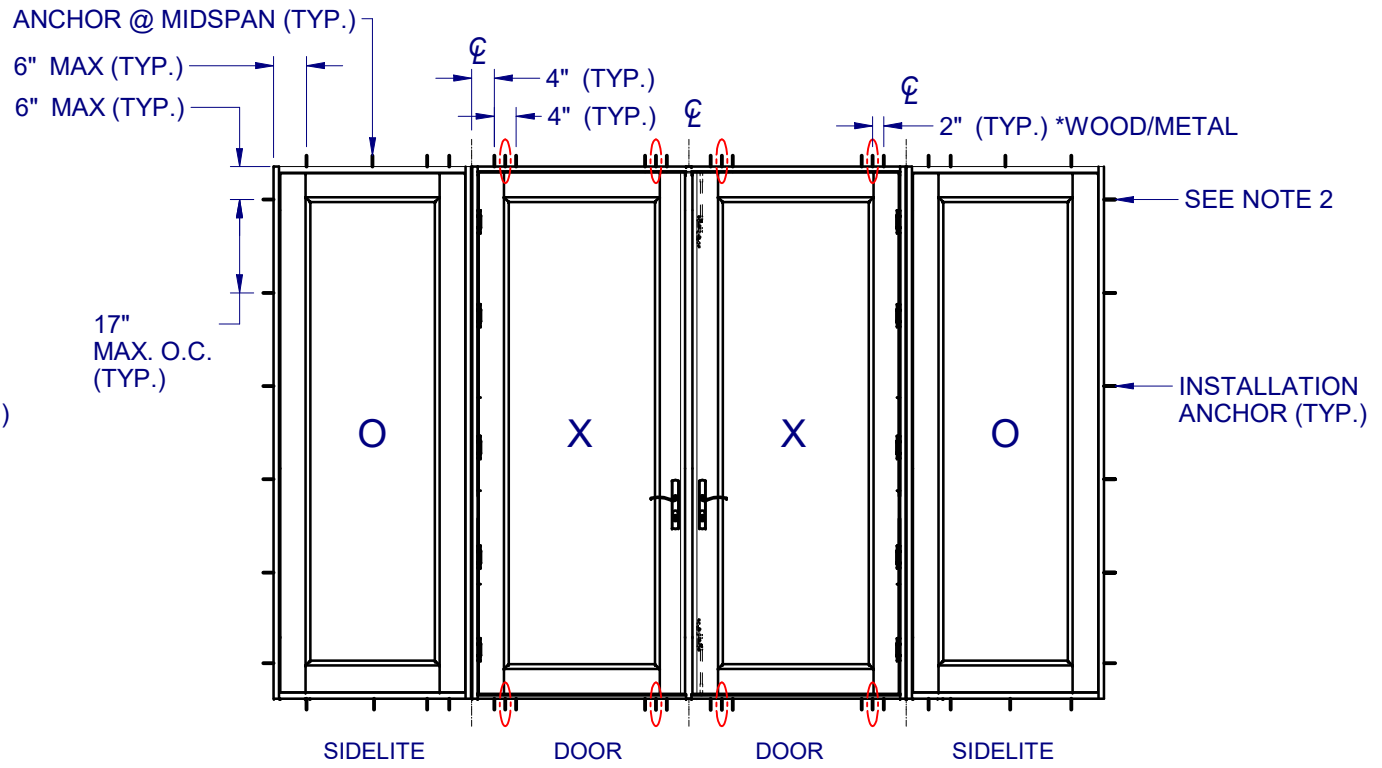
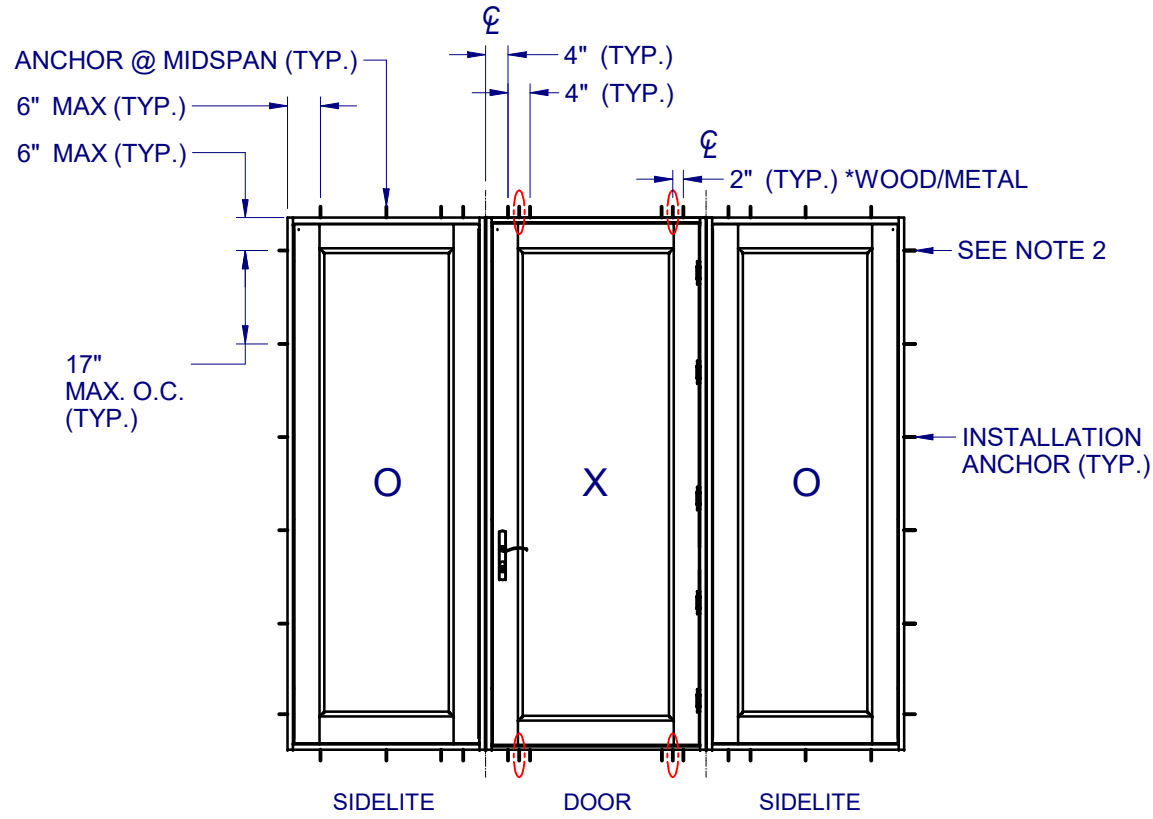

REVISIONS		NO.:	DESCRIPTION:	BY:	DATE:
B	REVISED TO TDI REQUEST	JLD			6/07/21
A	REVISED TO TDI REQUEST	JML			3/29/17



6/8/2021

LUCAS A. TURNER, P.E.
TX PE # 115094
2428 Old Natchez Trc Trl
Camden, TN 38320
PH. 941-380-1574

SHEET DESCRIPTION:
ANCHOR SCHEDULE AND NOTES

DRAWN BY:	DATE:
EMK	11/13/15
DWG #:	REV.:
TDI-641	-
SCALE:	SHEET
1:8	11 OF 13

8700/10/50 PVC SWING DOOR IMPACT

			6/07/21	DATE:
		JLD		BY:
		JML	3/29/17	NO.:
				DESCRIPTION:
				REVISIONS

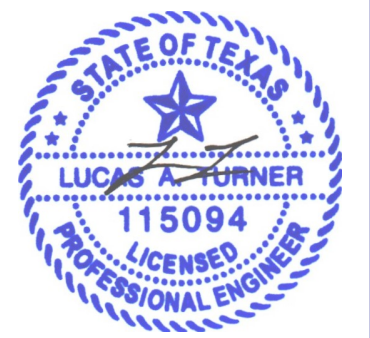

6/8/2021

LUCAS A. TURNER, P.E.
TX PE # 115094
2428 Old Natchez Trc Trl
Camden, TN 38320
PH. 941-380-1574

SHEET DESCRIPTION:
INSTALLATION DETAILS DOOR

DRAWN BY: EMK	DATE: 11/13/15
DWG #: TDI-641	REV.: -
SCALE: 1:2	SHEET 12 OF 13

TYPICAL HEAD ANCHORAGE

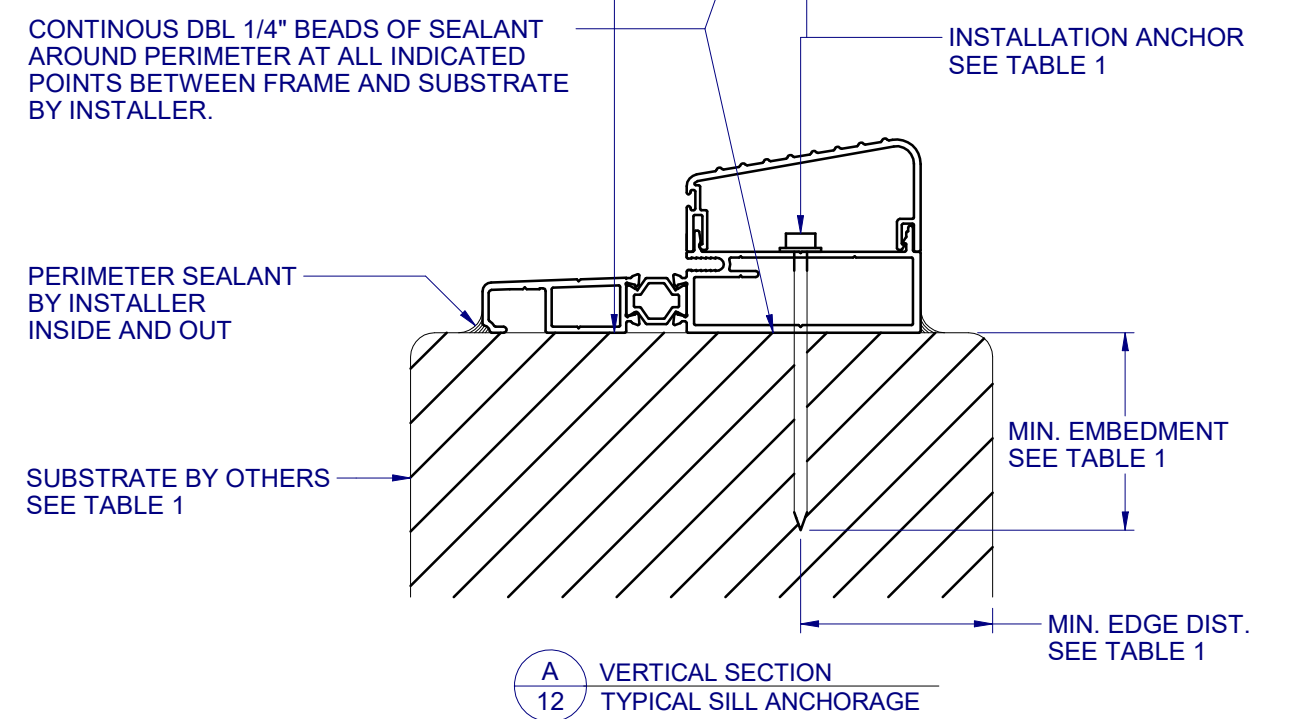
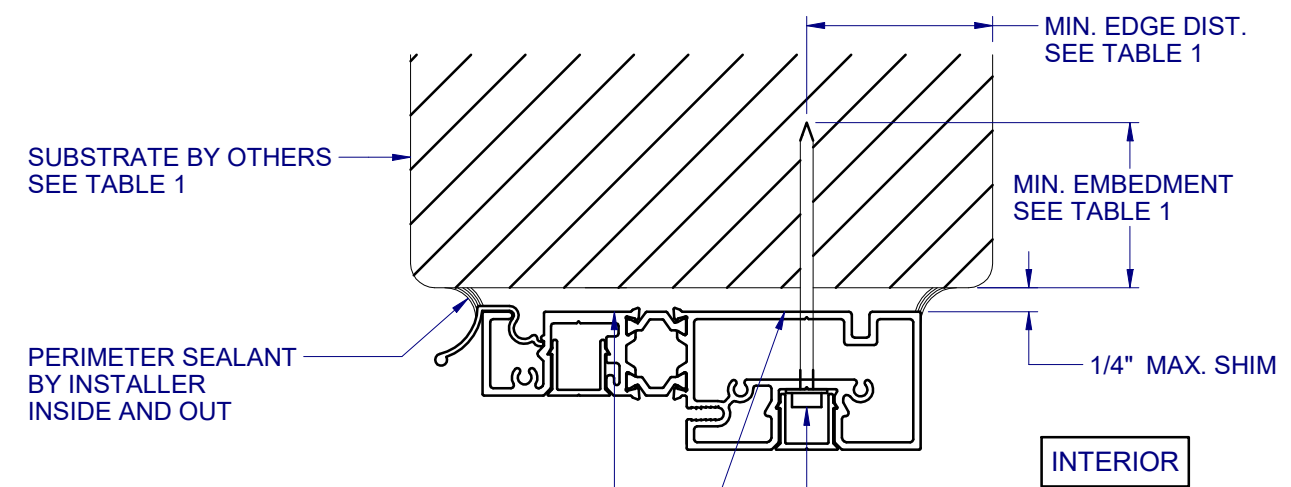

INTERIOR

CONTINUOUS DBL 1/4" BEADS OF SEALANT AROUND PERIMETER AT ALL INDICATED POINTS BETWEEN FRAME AND SUBSTRATE BY INSTALLER.

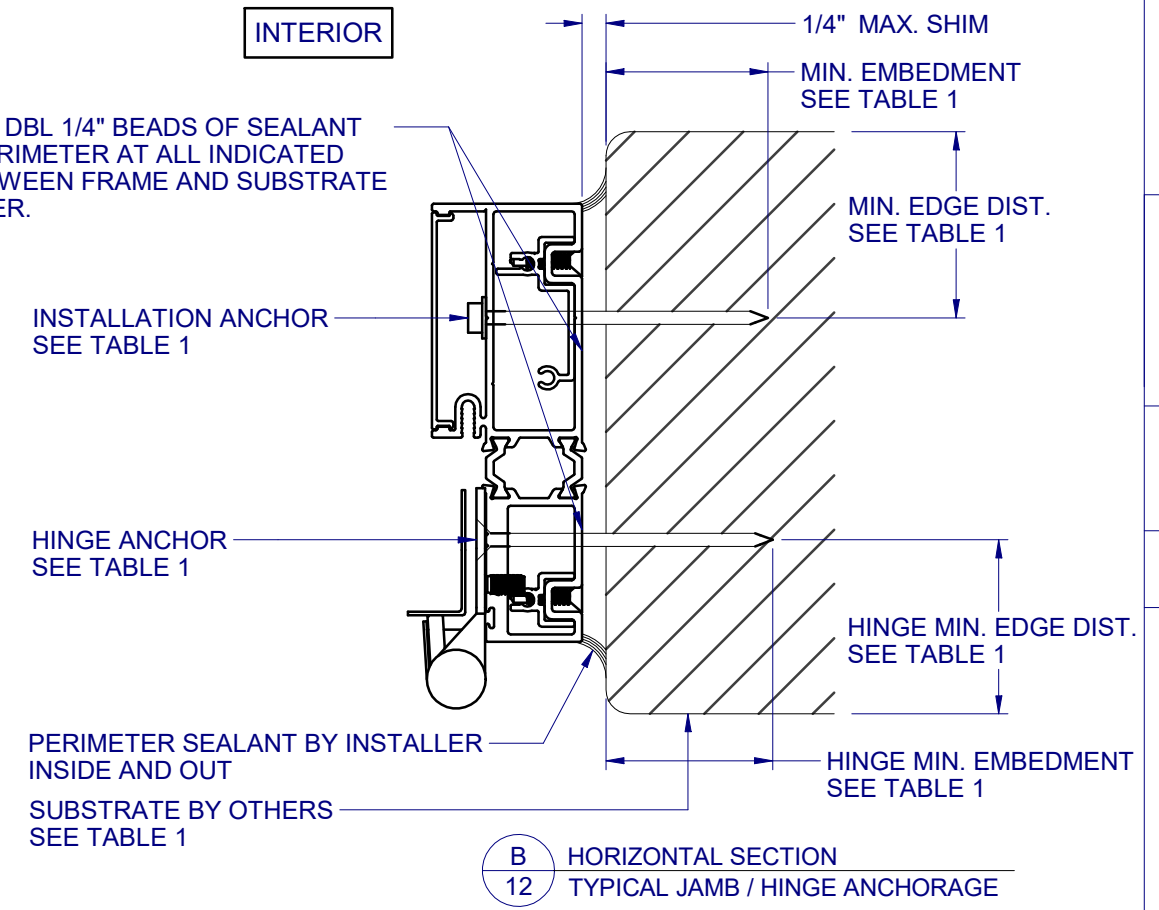

SUBSTRATE TYPE	ANCHOR TYPE	MIN. EMBEDMENT	MIN. EDGE DIST.
CONCRETE (2.85 KSI MIN.)	1/4" ELCO ULTRACON	1-3/4"	2-1/2"
HOLLOW OR GROUT-FILLED CMU (ASTM C-90)	1/4" ELCO ULTRACON	1-1/4"	2-1/2"
2X MIN. SOUTHERN PINE (G=0.55)	1/4" ELCO ULTRACON	1-3/8"	7/8"
2X MIN. SOUTHERN PINE (G=0.55)	#12 WOOD SCREW	1-3/8"	7/8"
16 GAUGE (0.060") MIN. STEEL STUD (33 KSI YIELD MIN)	#12-14 HILTI KWIK-FLEX OR ITW TEKS SELF-DRILLING SCREW	FULL THREAD THRU 0.060"	1/2"
1/8" ALUM. (6063-T5 MIN.) OR 1/8" STEEL (33 KSI MIN.)	#12 GRADE 5 SELF-TAPPING / DRILLING SCREW	FULL THREAD THRU 0.125"	1/2"
HINGE ANCHORS INTO CONCRETE (2.85 KSI MIN.)	3/16" ELCO ULTRACON	1-3/4"	2-1/2"
HINGE ANCHORS INTO HOLLOW OR GROUT-FILLED CMU (ASTM C-90)	3/16" ELCO ULTRACON	1-1/4"	2-1/2"
HINGE ANCHORS INTO 2X MIN. SOUTHERN PINE (G=0.55)	#12 PHILLIPS PH SHEET METAL SCREW	2"	7/8"
HINGE ANCHORS INTO 16 GAUGE (0.060") MIN. STEEL STUD (33 KSI YIELD MIN)	#10-16 HILTI KWIK-FLEX OR ITW TEKS SELF-DRILLING SCREW	FULL THREAD THRU 0.060"	1/2"
HINGE ANCHORS 1/8" ALUM. (6063-T5 MIN.) OR 1/8" STEEL (33 KSI MIN.)	#10 GRADE 5 SELF-TAPPING / DRILLING SCREW	FULL THREAD THRU 0.125"	1/2"

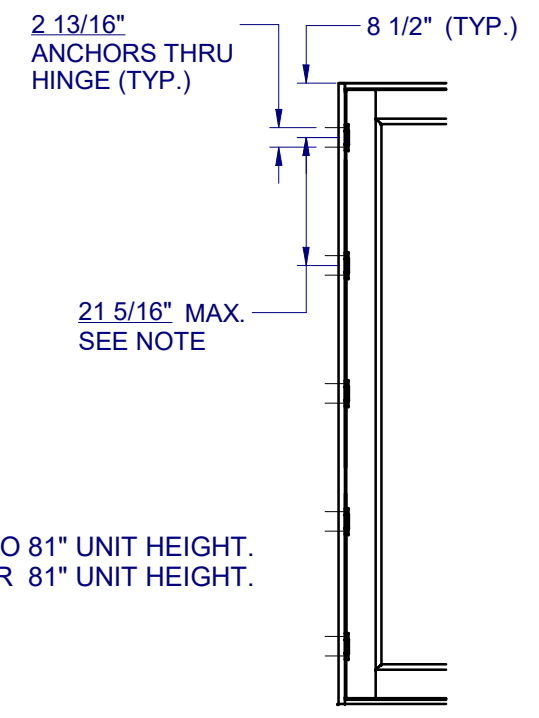

NOTE:
HINGE SPACINGS ARE:
8-1/2" FROM ENDS
21-5/16" MAX. O.C. FOR UP TO 81" UNIT HEIGHT.
20" MAX. O.C. FOR OVER 81" UNIT HEIGHT.

HINGE LAYOUT
1:30

8700/10/50 PVC SWING DOOR IMPACT

NO.	DESCRIPTION:	BY:	DATE:
B	REVISED TO TDI REQUEST JLD	JLD	6/07/21
A	REVISED TO TDI REQUEST JML	JML	3/29/17

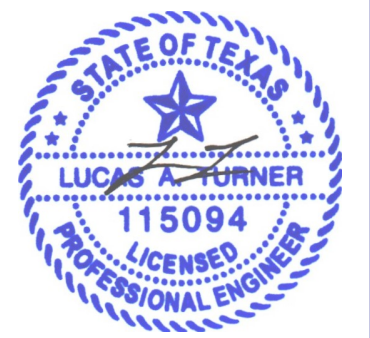

6/8/2021

LUCAS A. TURNER, P.E.
TX PE # 115094
2428 Old Natchez Trc Trl
Camden, TN 38320
PH. 941-380-1574

SHEET DESCRIPTION:
INSTALLATION DETAILS SIDELITE

DRAWN BY: EMK	DATE: 11/13/15
DWG #: TDI-641	REV.: -
SCALE: 1:2	SHEET 13 OF 13

TYPICAL HEAD ANCHORAGE

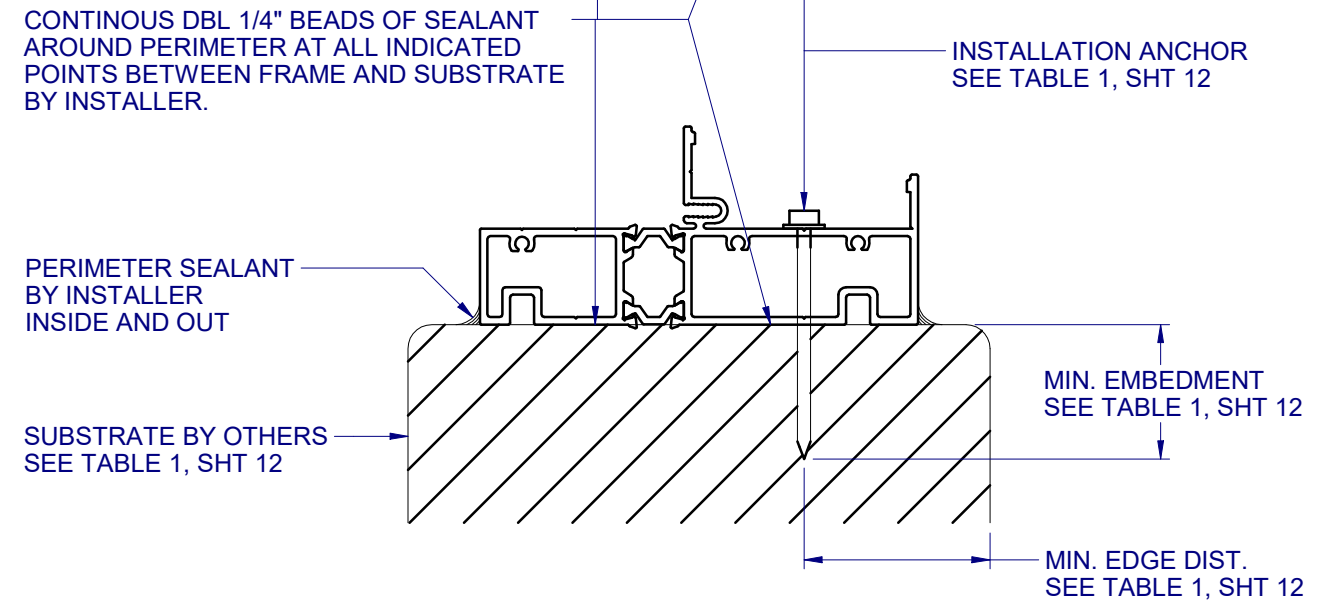
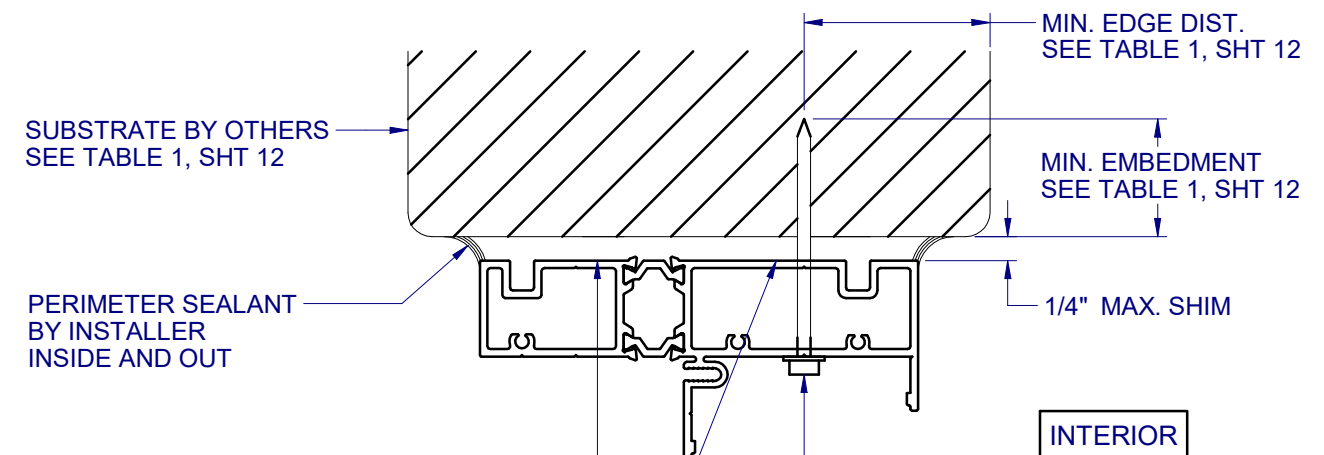

C
13 VERTICAL SECTION
TYPICAL SILL ANCHORAGE

INTERIOR

CONTINUOUS DBL 1/4" BEADS OF SEALANT AROUND PERIMETER AT ALL INDICATED POINTS BETWEEN FRAME AND SUBSTRATE BY INSTALLER.

INSTALLATION ANCHOR SEE TABLE 1, SHT 12

PERIMETER SEALANT BY INSTALLER INSIDE AND OUT

SUBSTRATE BY OTHERS SEE TABLE 1, SHT 12

D
13 HORIZONTAL SECTION
TYPICAL JAMB ANCHORAGE

