

Opaque Fiberglass Door

"NON-IMPACT"

INSWING / OUTSWING

EVALUATED FOR USE IN THE STATE OF TEXAS

DR-853

The Fiberglass Door system described herein complies with the 2018 International Residential Code (IRC), Sections R301 & R609 and the 2018 International Building Code (IBC), Sections 1404.13, 1609, 1709.5, 2403 and 2404 subject to the following conditions:

1. Anchors shall be as listed and spaced as shown in the details. Anchor embedment to base material shall be beyond wall dressing or stucco.
2. When used in areas requiring wind-borne debris protection this product is required to be protected with an impact resistant covering that complies with Section R301.2.1.2 of the IRC and Section 1609.2 of the IBC.
3. Allowable design pressure requirements must be equal to or less than the design pressure rating shown in the design pressure chart, sheet 1 of this drawing.
4. Conditions not covered by this drawing are subject to further engineering analysis.

TABLE OF CONTENTS	
SHEET#	DESCRIPTION
1	Typical elevations, design pressures & general notes
2	Door panel details
3	Horizontal & vertical cross sections
4	Vertical cross sections
5	Frame anchoring

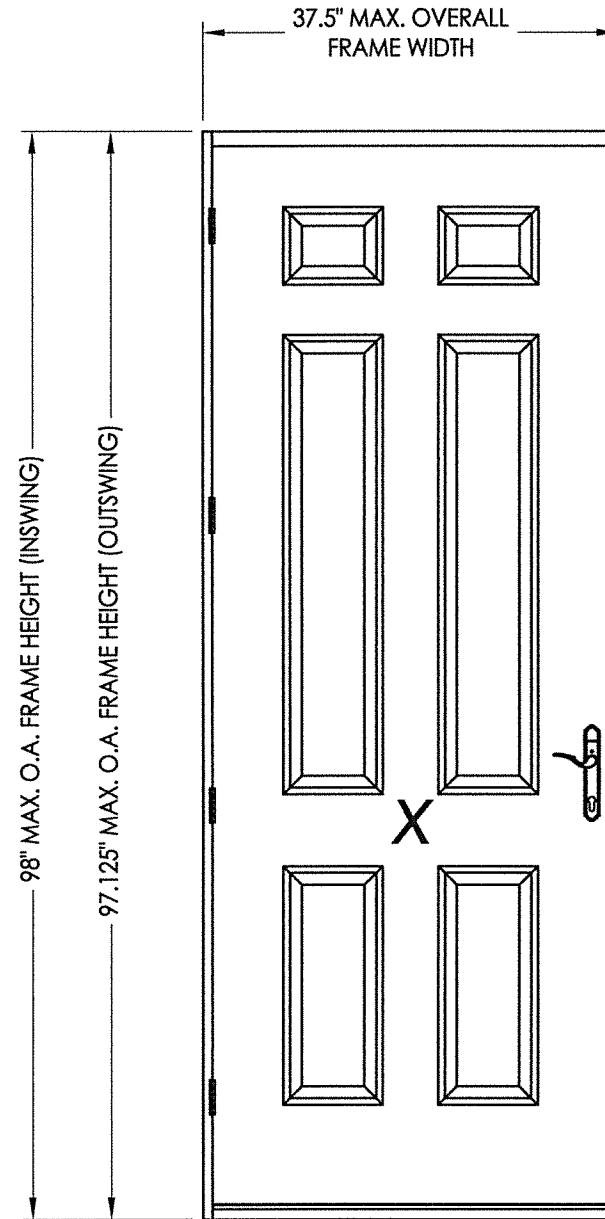

CONFIG.	MODEL	DESIGN PRESSURE (PSF)	
		POSITIVE	NEGATIVE
X	INSWING	+35.0	-40.0
X	OUTSWING	+40.0	-40.0

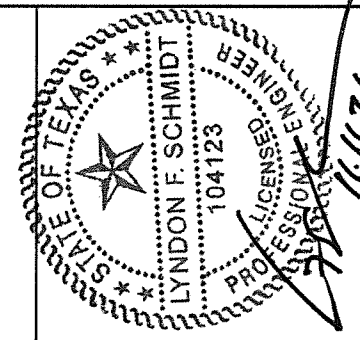

Documents Prepared By: Lyndon F. Schmidt, P.E.
TEXAS P.E. #104123

RW BUILDING CONSULTANTS, INC.
P.O. Box 230 Vairico FL 33595
Phone No.: 813.659.9197

TEXAS BOARD OF PROFESSIONAL ENGINEERS
CERTIFICATE OF REGISTRATION # F-11852

PRODUCT: ENDURA

PART OR ASSEMBLY:
TYPICAL ELEVATION, DESIGN PRESSURES & GENERAL NOTES

NO.	DATE	BY	REVISIONS
1	10/26/21	LFS	UPDATE TO 2018 IBC/IRC CODE

DATE: 11/09/16

SCALE: N.T.S.

DWG. BY: JK

CHK. BY: LFS

DRAWING NO.: TX-4660

SHEET 1 OF 5

Z:\Clients\Endura PERMANENT\B - Texas Dept of Ins\YDI - DR-853 Plastpro FG Opaque (Trilennium)\C - Drawings\TX-4657.60.dwg

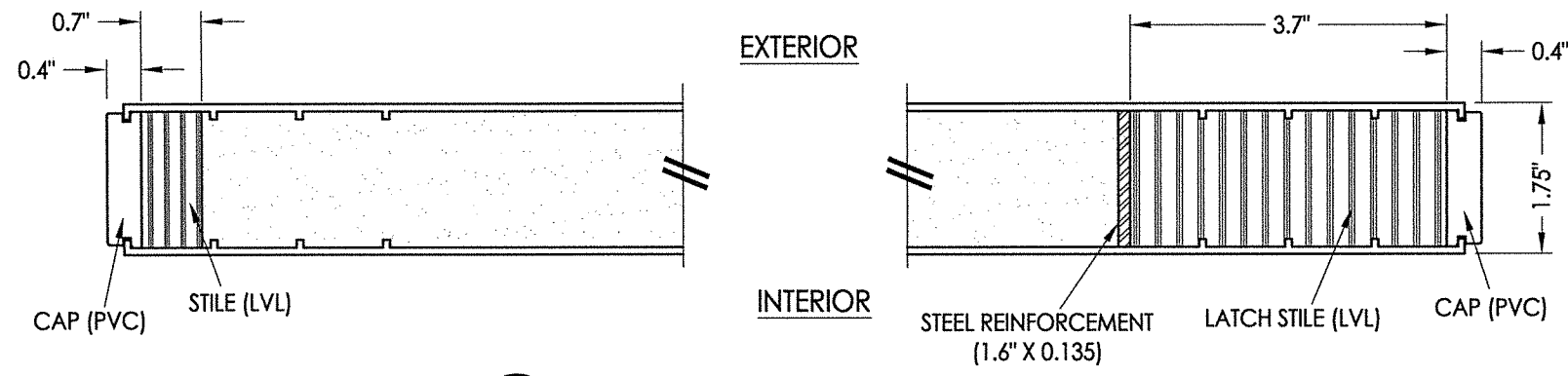

1
2 HORIZONTAL CROSS SECTION

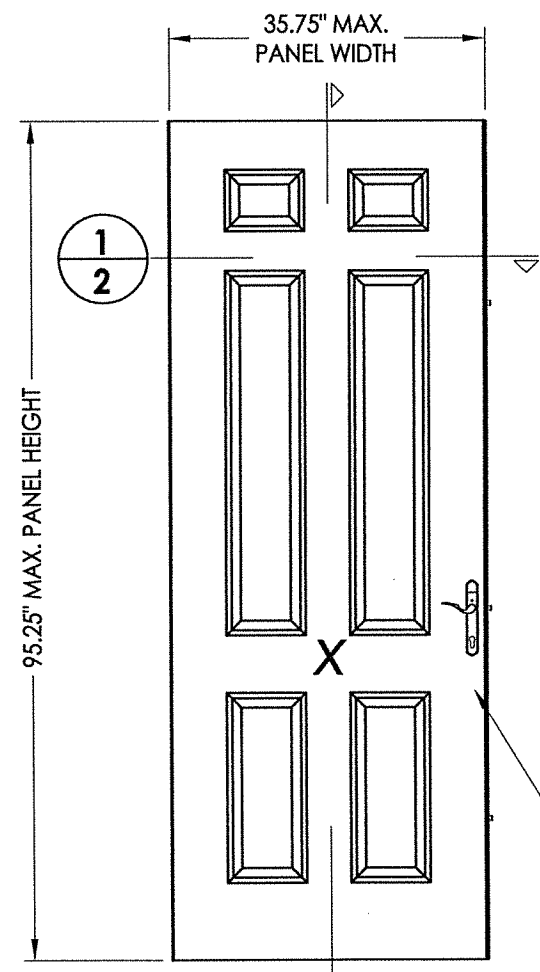

2
2
DOOR PANEL
Plastpro
Fiberglass

DOOR SKIN: FIBERGLASS (0.075" MIN. THICKNESS)
CORE MATERIAL: POLYURETHANE FOAM (1.9 PCF MIN.)

SEE HARDWARE TABLE

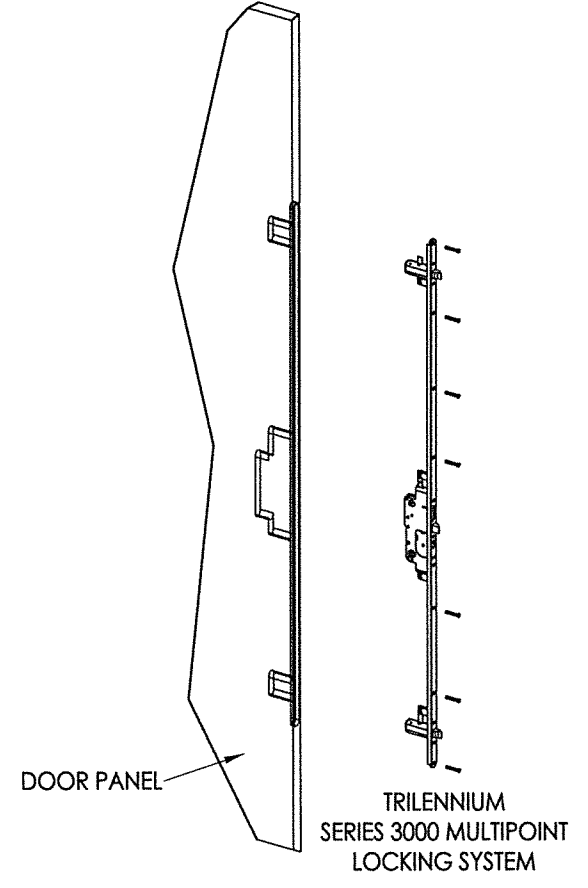

HARDWARE TABLE	
MANUFACTURER	MODEL
Endura	Trilennium® 3000 Series Multipoint lock (3pt.)

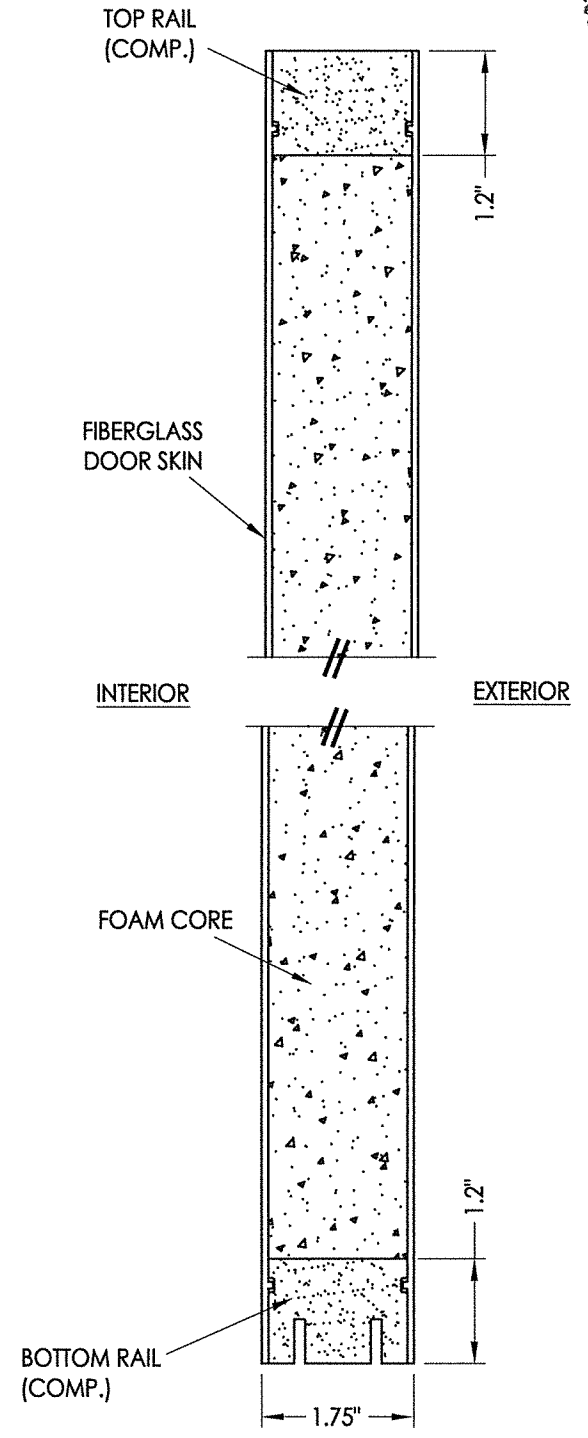

2
2 VERTICAL CROSS SECTION

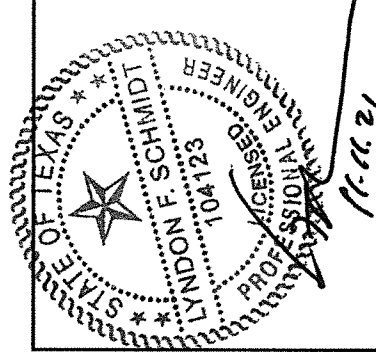

Documents Prepared By: Lyndon F. Schmidt, P.E.
TEXAS P.E. #104123

RW BUILDING CONSULTANTS, INC.
P.O. Box 230 Veirico FL 33595
Phone No.: 813.659.9197

TEXAS BOARD OF PROFESSIONAL ENGINEERS
CERTIFICATE OF REGISTRATION # F-11852

PRODUCT:	ENDURA	
PART OR ASSEMBLY:	DOOR PANEL DETAILS	
NO.	DATE	BY
1	10/26/21	LFS
UPDATE TO 2018 IBC/IRC CODE		
REVISIONS		
DATE: 11/09/16		
SCALE: N.T.S.		
DWG. BY: JK		
CHK. BY: LFS		
DRAWING NO.: TX-4660		
SHEET 2 OF 5		

© 2016 R.W. BUILDING CONSULTANTS INC.

Z:\Clients\Endura PERMANENT\B - Texas Dept of Ins\TDI - DR-853 Plastpro FG Opaque (Trilennium)\C - Drawings\TX-4657.60.dwg

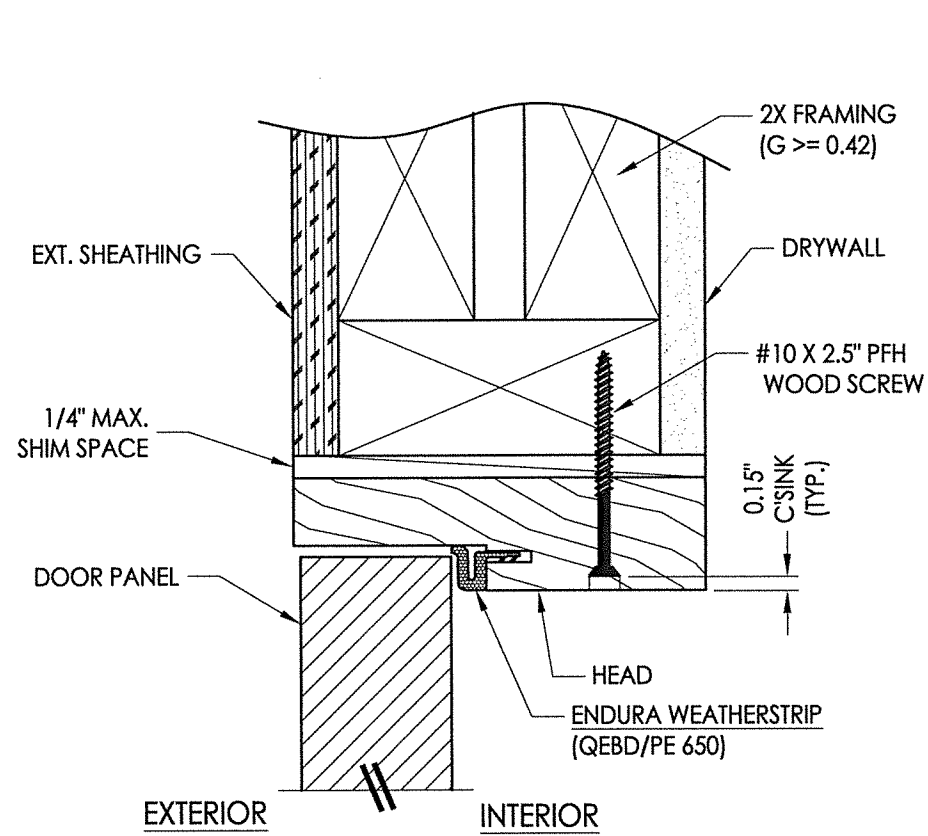

2 VERTICAL CROSS SECTION
 3 Outswing shown - inswing also approved

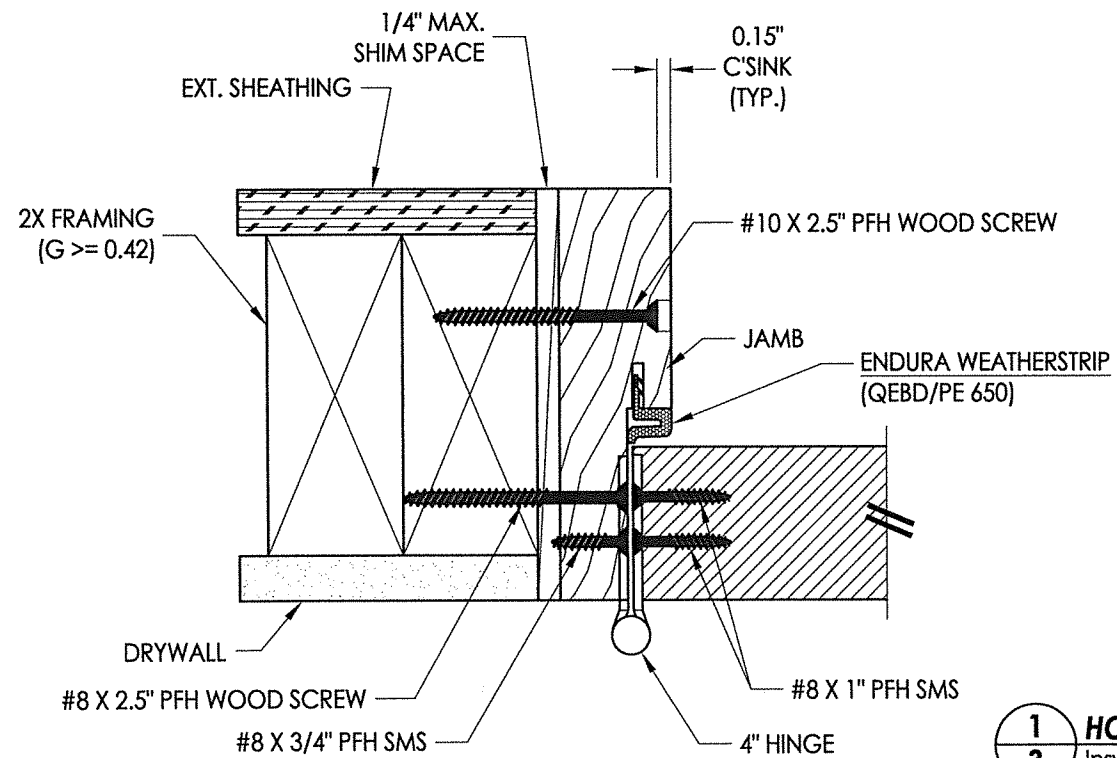
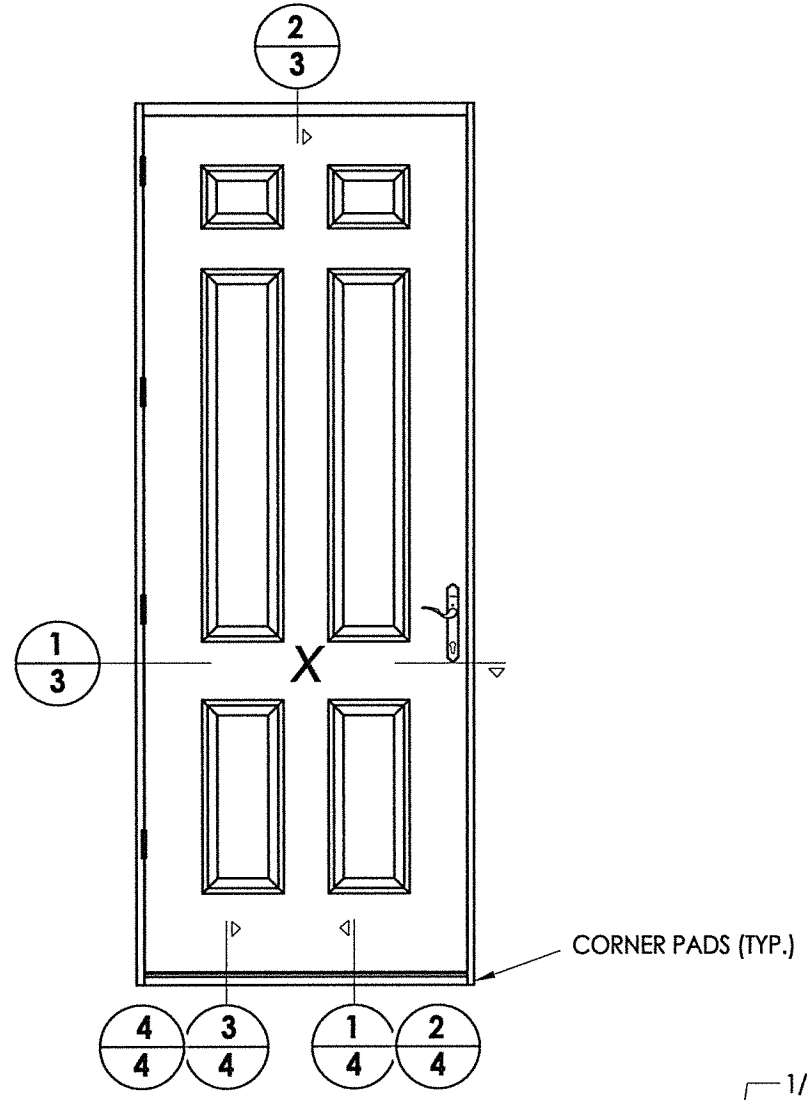

1 HORIZONTAL CROSS SECTION
 3 Inswing shown - Outswing also approved

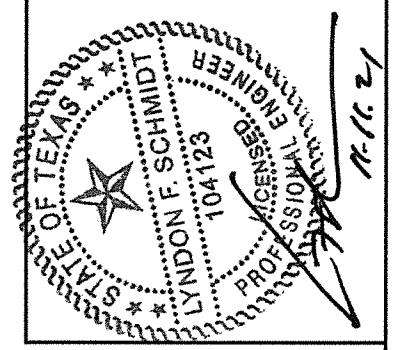
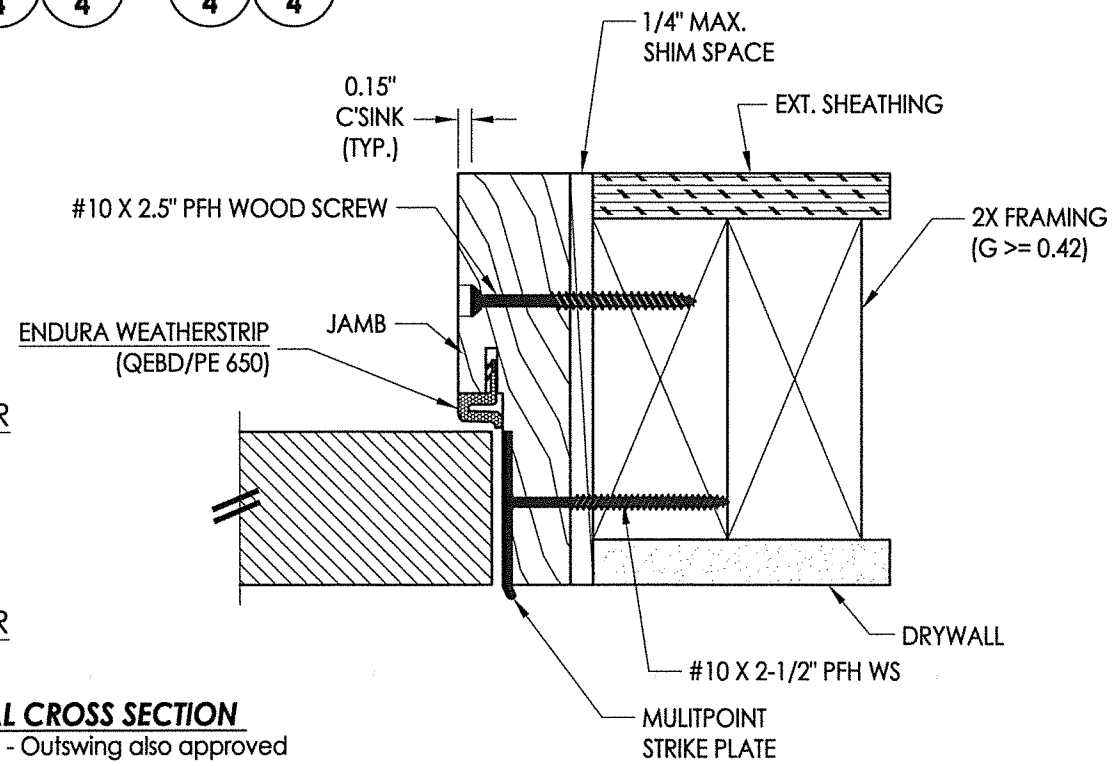

Documents Prepared By: Lyndon F. Schmidt, P.E.
 TEXAS P.E. #104123
RW BUILDING CONSULTANTS, INC.
 P.O. Box 230 Valrico FL 33595
 Phone No.: 813.659.9197
 TEXAS BOARD OF PROFESSIONAL ENGINEERS
 CERTIFICATE OF REGISTRATION # F-11852

PRODUCT: ENDURA
 PART OR ASSEMBLY: HORIZONTAL & VERTICAL CROSS SECTIONS

NO.	DATE	DESCRIPTION	BY
1	10/26/21	UPDATE TO 2018 IBC/IRC CODE	LFS

DATE: 11/09/16
 SCALE: N.T.S.
 DWG. BY: JK
 CHK. BY: LFS
 DRAWING NO.: TX-4660
 SHEET 3 OF 5

Z:\Clients\Endura PERMANENT\B - Texas Dept of Ins\VDI - DR-853 Plastpro FG Opaque (Trilennium)\C - Drawings\TX-4657.60.dwg

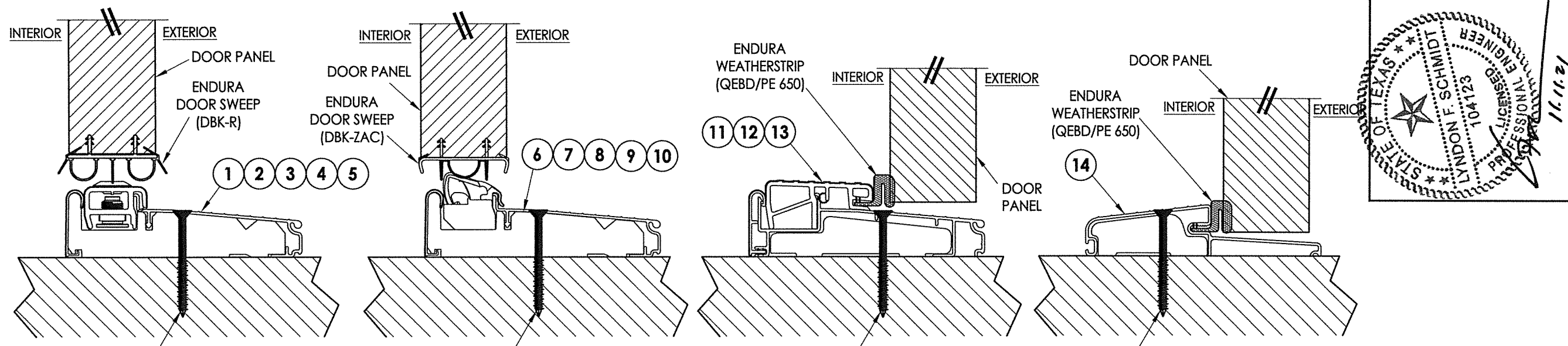

#10 X 2.5" PFH WOOD SCREW OR
1/4" X 2-3/4" DeWALT OR ITW CONCRETE SCREW

#10 X 2.5" PFH WOOD SCREW OR
1/4" X 2-3/4" DeWALT OR ITW CONCRETE SCREW

#10 X 2.5" PFH WOOD SCREW OR
1/4" X 2-3/4" DeWALT OR ITW CONCRETE SCREW

#10 X 2.5" PFH WOOD SCREW OR
1/4" X 2-3/4" DeWALT OR ITW CONCRETE SCREW

1 VERTICAL CROSS SECTION
4 Inswing Adjustable Threshold

2 VERTICAL CROSS SECTION
4 Inswing Articulating Threshold

3 VERTICAL CROSS SECTION
4 Outswing Bump Threshold

4 VERTICAL CROSS SECTION
4 Outswing Bump Threshold

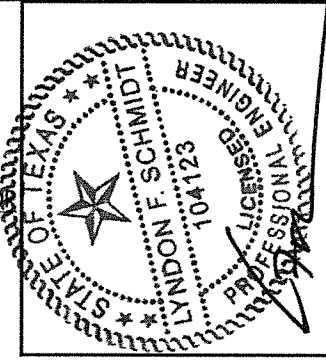

1/11/21

Documents Prepared By: Lyndon F. Schmidt, P.E.
TEXAS P.E. #104123

RW BUILDING CONSULTANTS, INC.
P.O. Box 230 Vairico FL 33595
Phone No.: 813.659.9197
TEXAS BOARD OF PROFESSIONAL ENGINEERS
CERTIFICATE OF REGISTRATION # F-11852

PRODUCT: ENDURA

PART OR ASSEMBLY:
VERTICAL CROSS SECTIONS

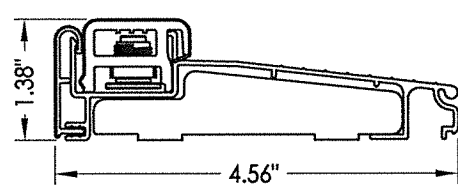

1 INSWING ADJUSTABLE THRESHOLD
ZAIL4565

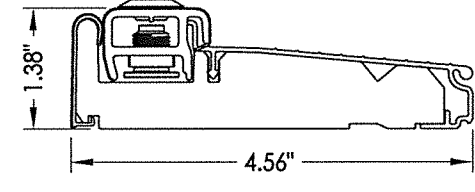

2 INSWING ADJUSTABLE THRESHOLD
ZAI4565FN

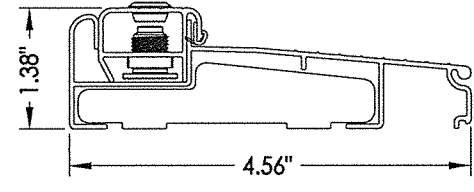

3 INSWING ADJUSTABLE THRESHOLD
ZAILAA4565

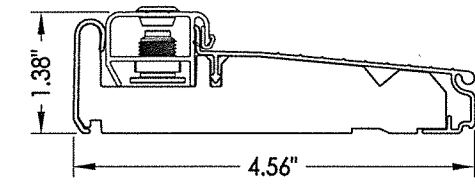

4 INSWING ADJUSTABLE THRESHOLD
ZAIAA4565FN

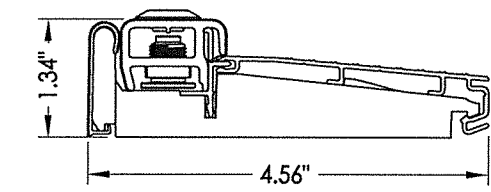

5 INSWING ADJUSTABLE THRESHOLD
ZAI4565RDS

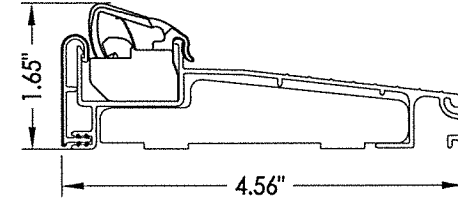

6 INSWING ARTICULATING THRESHOLD
ZAACL4565

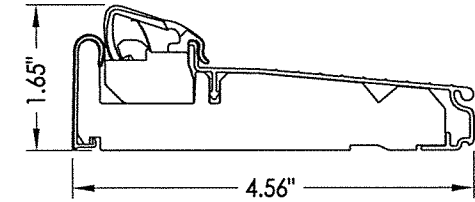

7 INSWING ARTICULATING THRESHOLD
ZAC4565FN

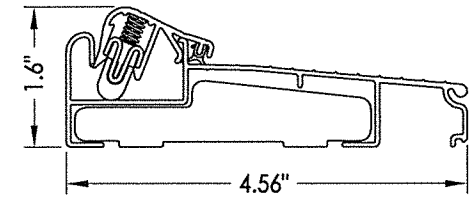

8 INSWING ARTICULATING THRESHOLD
ZACLAA4565

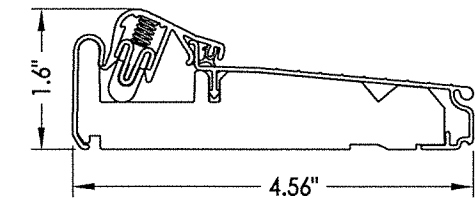

9 INSWING ARTICULATING THRESHOLD
ZACAA4565FN

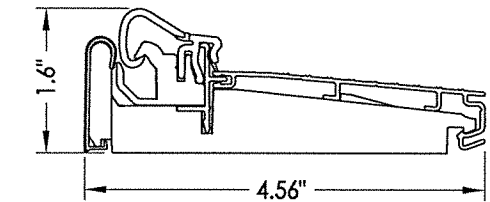

10 INSWING ARTICULATING THRESHOLD
ZAC4565RDS

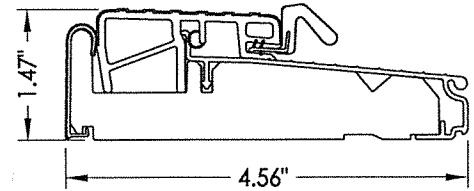

11 OUTSWING THRESHOLD
ZOB4565FN

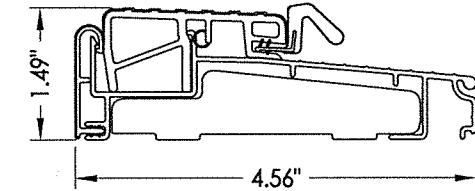

12 OUTSWING THRESHOLD
ZOBL4565

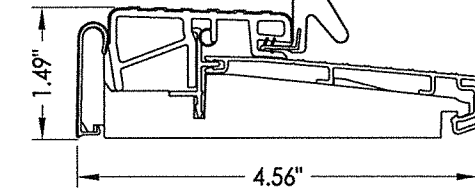

13 OUTSWING THRESHOLD
ZOB4565RDS

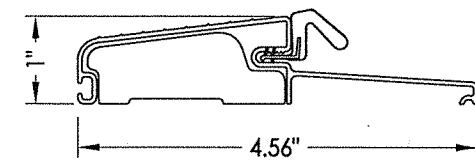

14 OUTSWING THRESHOLD
FOB4566

REVISIONS	
NO.	DATE
1	10/26/21
UPDATE TO 2018 IBC/IRC CODE	
LFS	BY

DATE: 11/09/16
SCALE: N.T.S.
DWG. BY: JK
CHK. BY: LFS
DRAWING NO.: TX-4660
SHEET 4 OF 5

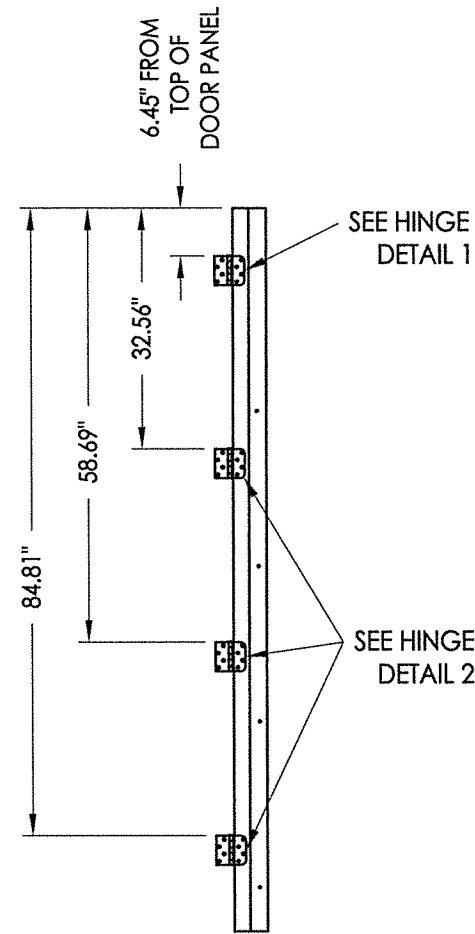

HINGE JAMB

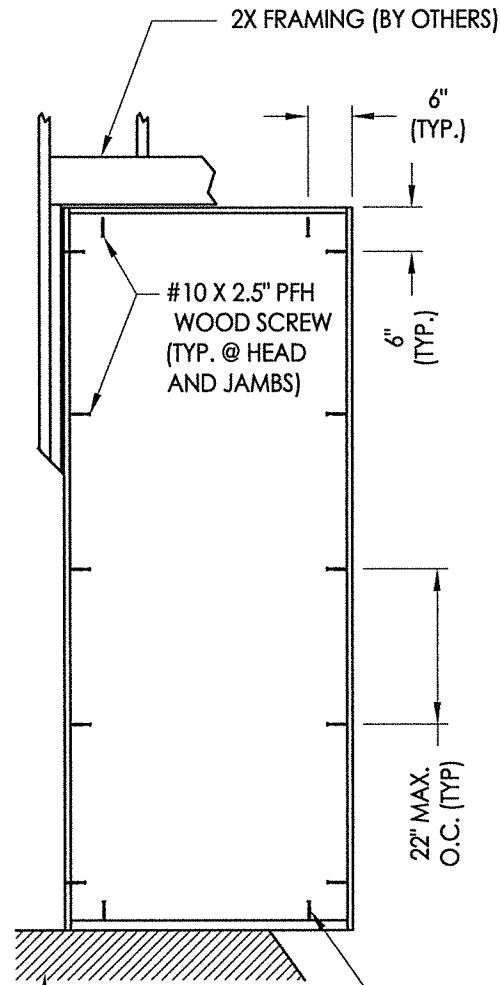

FRAME ANCHORING

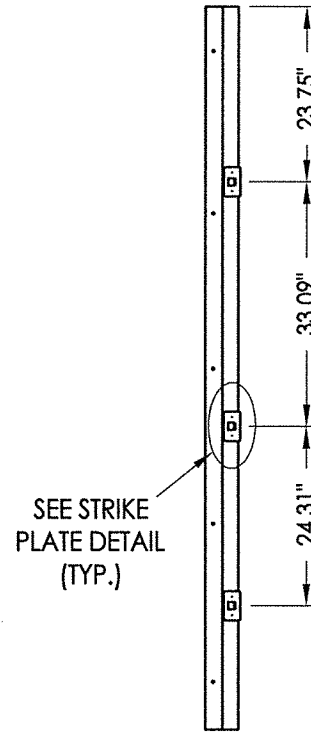

STRIKE JAMB

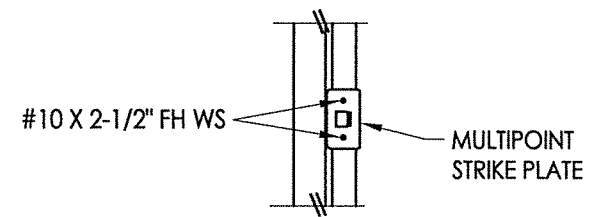

STRIKE PLATE DETAIL

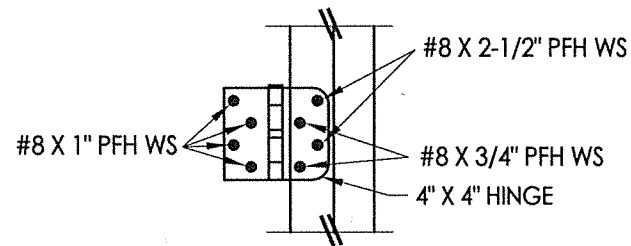

HINGE DETAIL 1

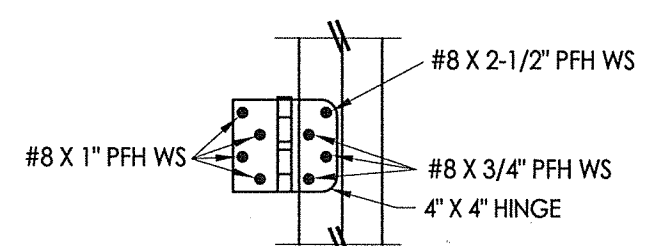

HINGE DETAIL 2

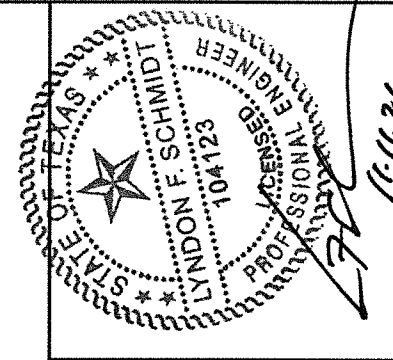

Documents Prepared By: Lyndon F. Schmidt, P.E.
TEXAS P.E. #104123

RW BUILDING CONSULTANTS, INC.
P.O. Box 230 Valrico FL 33595
Phone No.: 813.659.9197

TEXAS BOARD OF PROFESSIONAL ENGINEERS
CERTIFICATE OF REGISTRATION # F-11852

PRODUCT:	ENDURA
PART OR ASSEMBLY:	FRAME ANCHORING

NO.	DATE	DESCRIPTION	BY
1	10/26/21	UPDATE TO 2018 IBC/IRC CODE	LFS

DATE:	11/09/16
SCALE:	N.T.S.
DWG. BY:	JK
CHK. BY:	LFS
DRAWING NO.:	TX-4660
SHEET	5 of 5

CONCRETE ANCHOR NOTES:

- Concrete anchor locations at the corners may be adjusted to maintain the min. edge distance to mortar joints.
- Concrete anchor locations noted as "MAX. ON CENTER" must be adjusted to maintain the min. edge distance to mortar joints, additional concrete anchors may be required to ensure the "MAX. ON CENTER" dimension are not exceeded.
- Concrete anchor table:

ANCHOR TYPE	ANCHOR SIZE	MIN. EMBEDMENT	MIN. CLEARANCE TO MASONRY EDGE	MIN. CLEARANCE TO ADJACENT ANCHOR
ITW TAPCON®	1/4"	1-3/4"	1-1/2"	4"
DeWALT ULTRACON®	1/4"	1-3/4"	1"	4"