

Opaque Fiberglass Door

"NON-IMPACT"

INSWING / OUTSWING

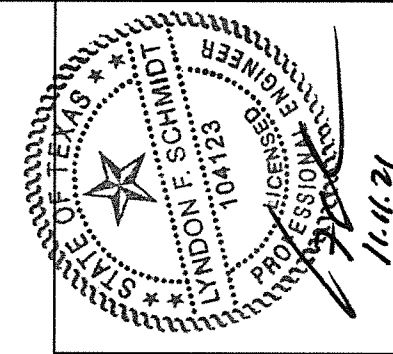
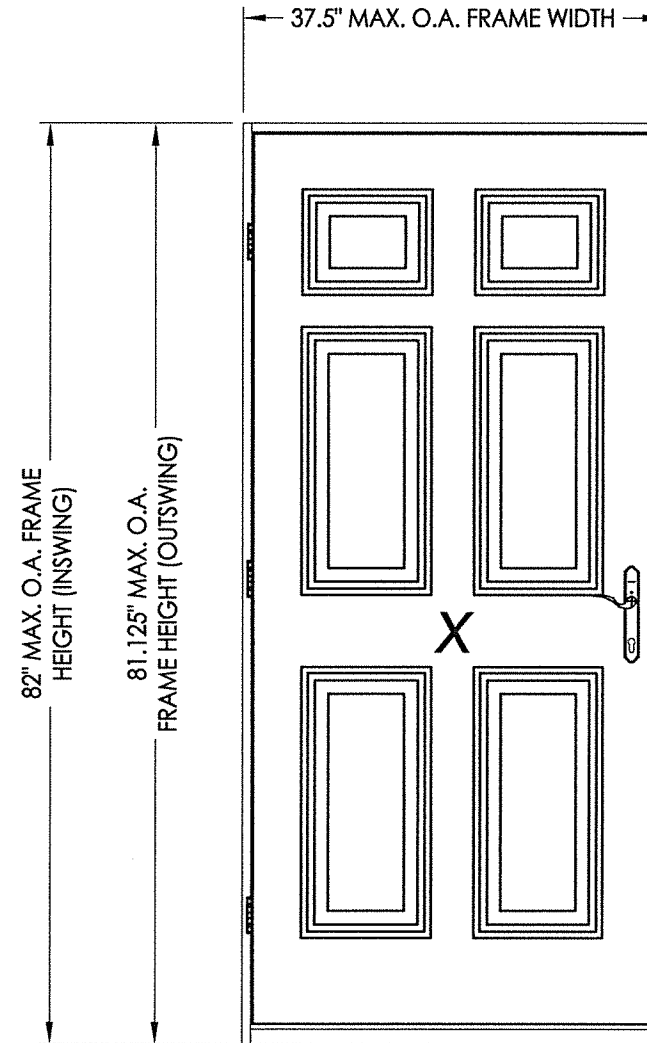

Documents Prepared By: Lyndon F. Schmidt, P.E.
TEXAS P.E. #104123

RW BUILDING CONSULTANTS, INC.
P.O. Box 230 Valrico FL 33595
Phone No.: 813.659.9197
TEXAS BOARD OF PROFESSIONAL ENGINEERS
CERTIFICATE OF REGISTRATION # F-11852

EVALUATED FOR USE IN THE STATE OF TEXAS

DR-853

The Fiberglass Door system described herein complies with the 2018 International Residential Code (IRC), Sections R301 & R609 and the 2018 International Building Code (IBC), Sections 1404.13, 1609, 1709.5, 2403 and 2404 subject to the following conditions:

1. Anchors shall be as listed and spaced as shown in the details. Anchor embedment to base material shall be beyond wall dressing or stucco.
2. When used in areas requiring wind-borne debris protection this product is required to be protected with an impact resistant covering that complies with Section R301.2.1.2 of the IRC and Section 1609.2 of the IBC.
3. Allowable design pressure requirements must be equal to or less than the design pressure rating shown in the design pressure chart, sheet 1 of this drawing.
4. Conditions not covered by this drawing are subject to further engineering analysis.

| TABLE OF CONTENTS | |
|-------------------|--|
| SHEET# | DESCRIPTION |
| 1 | Typical elevations, design pressures & general notes |
| 2 | Door panel details |
| 3 | Horizontal & vertical cross sections |
| 4 | Vertical cross sections |
| 5 | Frame anchoring |

| CONFIG. | MODEL | DESIGN PRESSURE (PSF) | |
|---------|----------|-----------------------|----------|
| | | POSITIVE | NEGATIVE |
| X | INSWING | +30.0 | -30.0 |
| X | OUTSWING | +35.0 | -35.0 |

| | |
|-------------------|---|
| PRODUCT: | ENDURA |
| PART OR ASSEMBLY: | TYPICAL ELEVATION, DESIGN PRESSURES & GENERAL NOTES |
| DATE: | 11/09/16 |
| SCALE: | N.T.S. |
| DWG. BY: | JK |
| CHK. BY: | LFS |
| DRAWING NO.: | TX-4657 |
| SHEET | 1 OF 5 |

Z:\clients\Endura PERMANENT\B - Texas Dept of Ins\TDI - DR-853 Plastpro FG Opaque (Trilennium)\C - Drawings\TX-4657.60.dwg

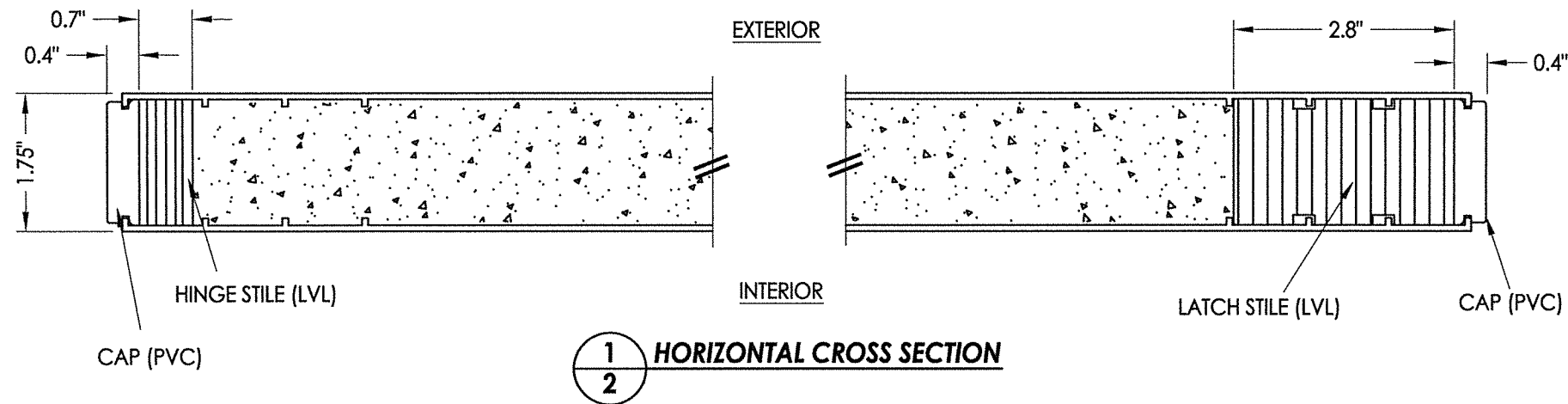

1
2 **HORIZONTAL CROSS SECTION**

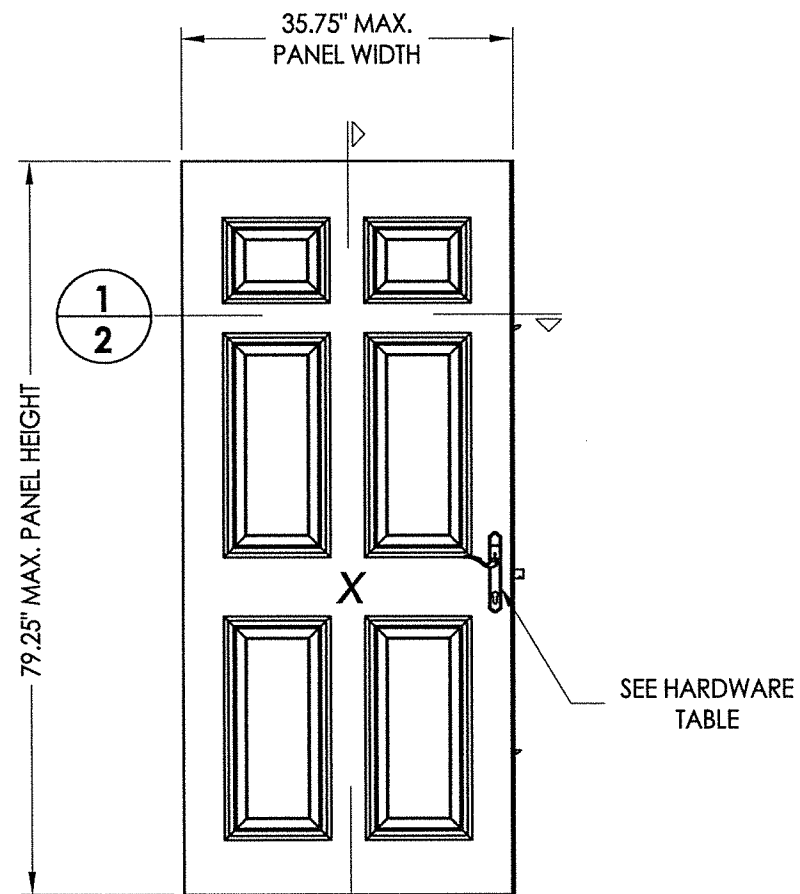

2
2 **DOOR PANEL**
Plastpro
Fiberglass

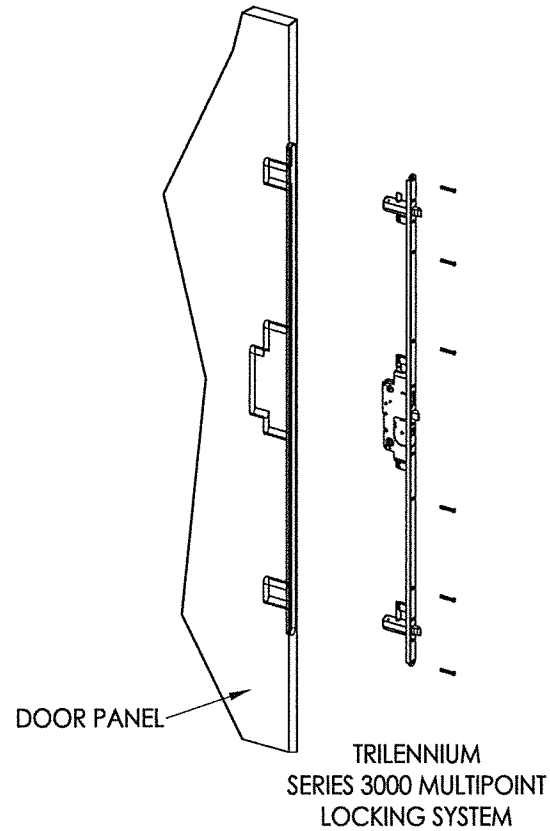

| HARDWARE TABLE | |
|----------------|--|
| MANUFACTURER | MODEL |
| Endura | Trilennium® 3000 Series Multipoint lock (3pt.) |

DOOR SKIN: FIBERGLASS (0.075" MIN. THICKNESS)
CORE MATERIAL: POLYURETHANE FOAM (1.9 PCF MIN.)

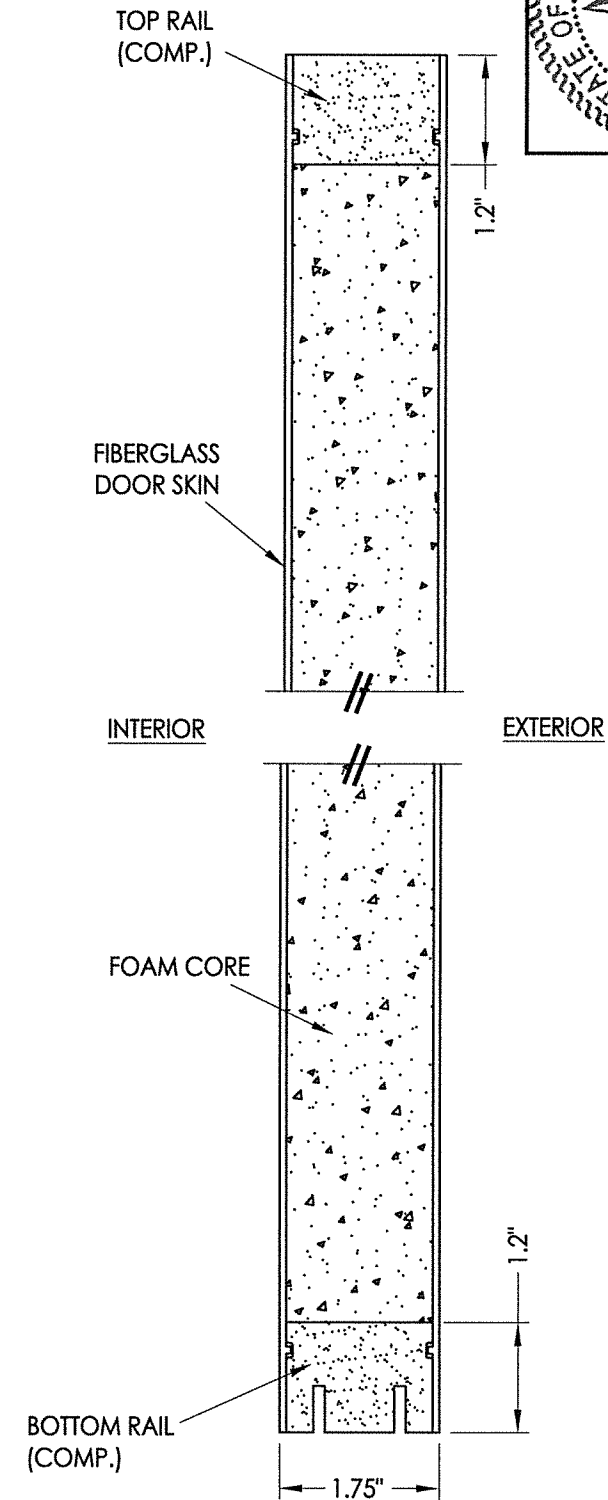

2
2 **VERTICAL CROSS SECTION**

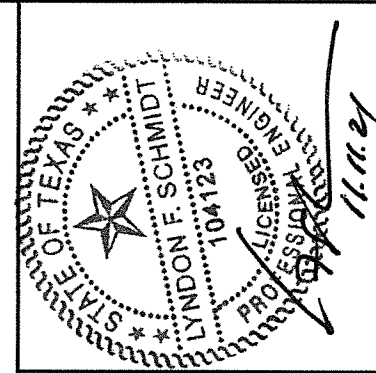

Documents Prepared By: Lyndon F. Schmidt, P.E.
TEXAS P.E. #104123

RW BUILDING CONSULTANTS, INC.
P.O. Box 230 Valrico FL 33595
Phone No.: 813.659.9197
TEXAS BOARD OF PROFESSIONAL ENGINEERS
CERTIFICATE OF REGISTRATION # F-11852

| | |
|-------------------|--------------------|
| PRODUCT: | ENDURA |
| PART OR ASSEMBLY: | DOOR PANEL DETAILS |

| NO. | DATE | BY |
|-----|----------|-----|
| 1 | 10/26/21 | LFS |

| | |
|--------------|----------|
| DATE: | 11/09/16 |
| SCALE: | N.T.S. |
| DWG. BY: | JK |
| CHK. BY: | LFS |
| DRAWING NO.: | TX-4657 |
| SHEET | 2 of 5 |

Z:\Clients\Endura PERMANENT\B - Texas Dept of Ins\TDI - DR-853 Plastpro FG Opaque (Trilennium)\C - Drawings\TX-4657.60.dwg

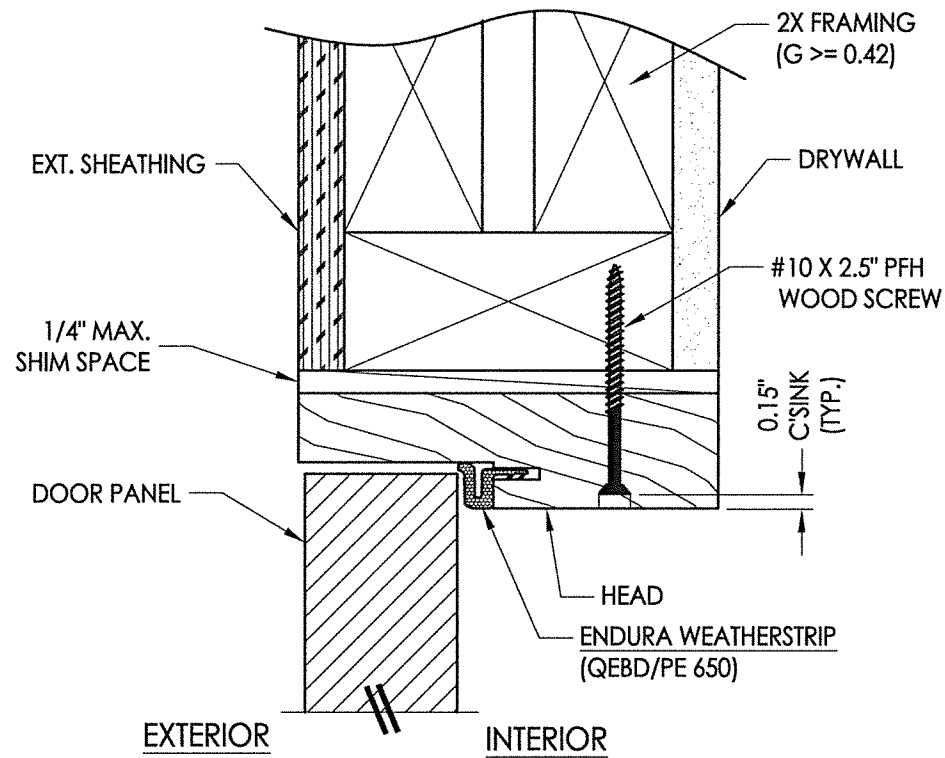
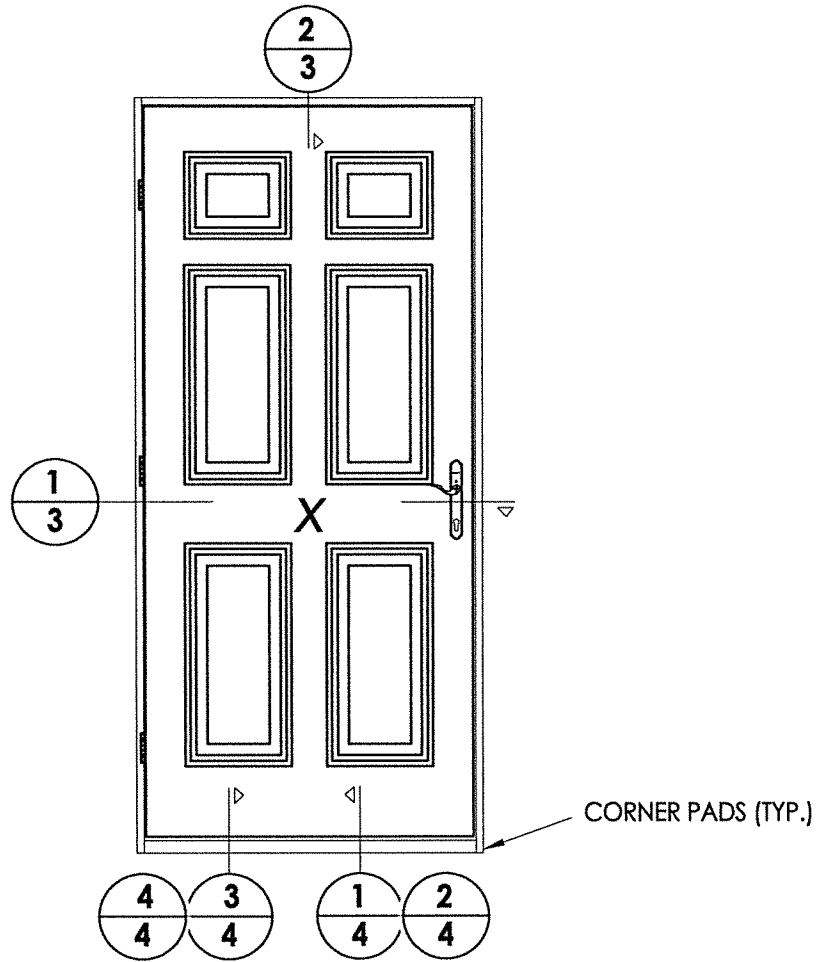

2 VERTICAL CROSS SECTION
3 Outswing shown - inswing
 also approved

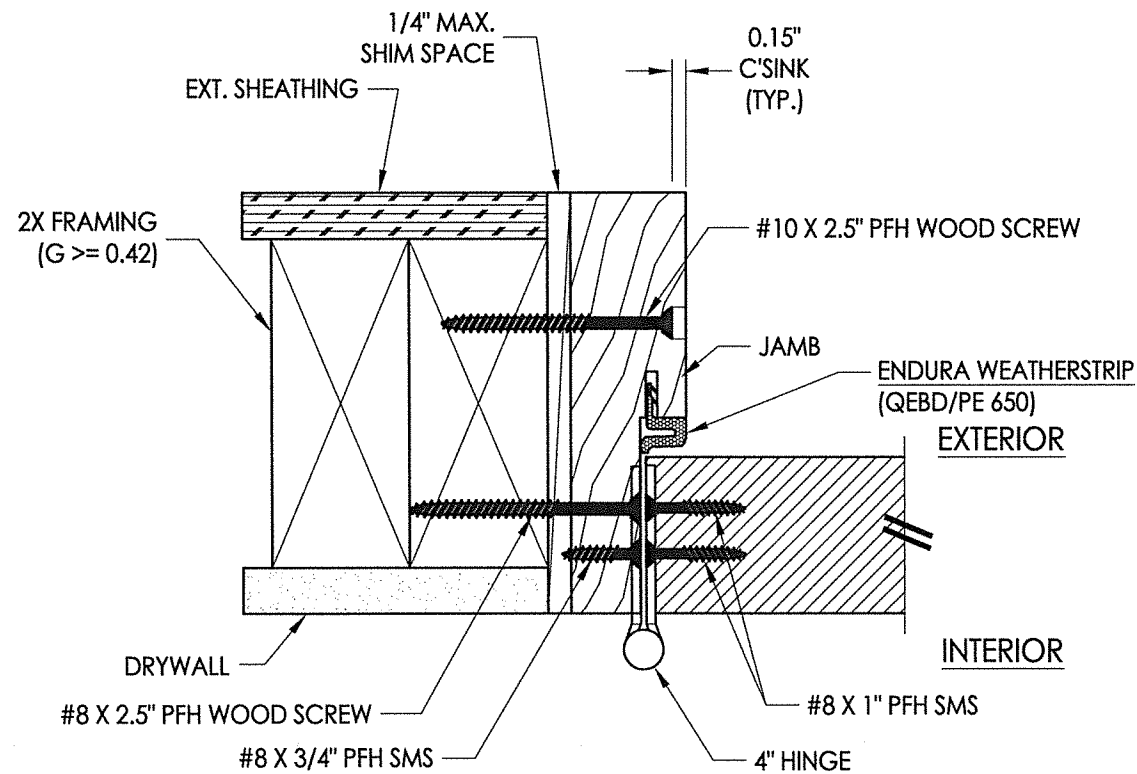

1 HORIZONTAL CROSS SECTION
3 Inswing shown - Outswing also approved

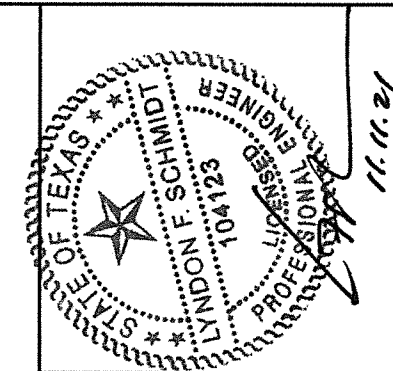
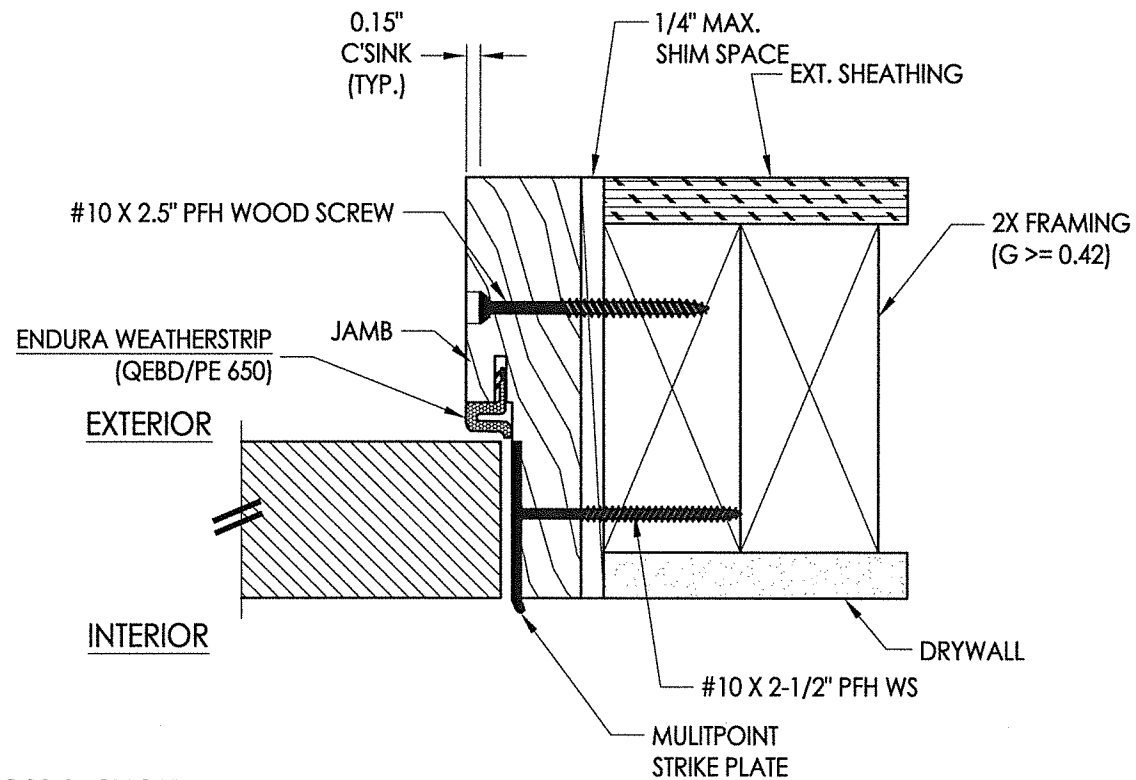

Documents Prepared By: Lyndon F. Schmidt, P.E.
 TEXAS P.E. #104123

RW BUILDING CONSULTANTS, INC.
 P.O. Box 230 Valrico FL 33595
 Phone No.: 813.659.9197

TEXAS BOARD OF PROFESSIONAL ENGINEERS
 CERTIFICATE OF REGISTRATION # F-11852

| | |
|-------------------|---|
| PRODUCT: | ENDURA |
| PART OR ASSEMBLY: | HORIZONTAL & VERTICAL CROSS SECTIONS |

| NO. | DATE | DESCRIPTION | BY |
|-----|----------|-----------------------------|-----|
| 1 | 10/26/21 | UPDATE TO 2018 IBC/IRC CODE | LFS |

| | |
|--------------|----------|
| DATE: | 11/09/16 |
| SCALE: | N.T.S. |
| DWG. BY: | JK |
| CHK. BY: | LFS |
| DRAWING NO.: | TX-4657 |
| SHEET | 3 OF 5 |

© 2016 R.W. BUILDING CONSULTANTS INC.

Z:\Clients\Endura PERMANENT\B - Texas Dept of Ins\TDI - DR-853 Plastpro FG Opaque (Trilennium)\C - Drawings\TX-4657.60.dwg

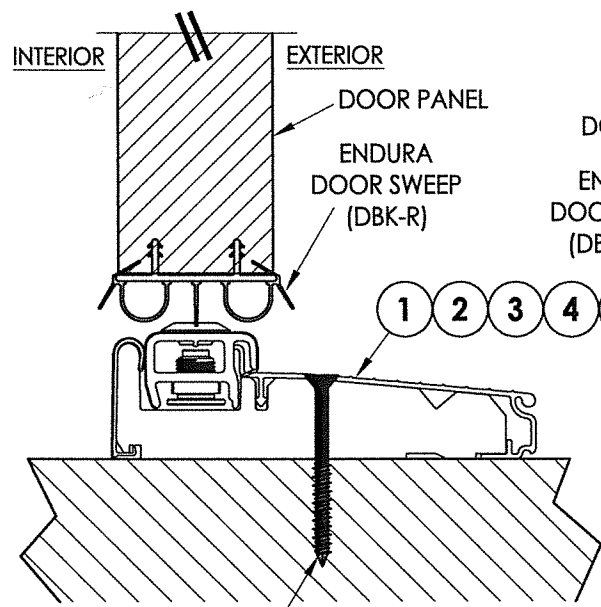

#10 X 2.5" PFH WOOD SCREW OR
1/4" X 2-3/4" DeWALT OR ITW CONCRETE SCREW

1 VERTICAL CROSS SECTION
4 Inswing Adjustable Threshold

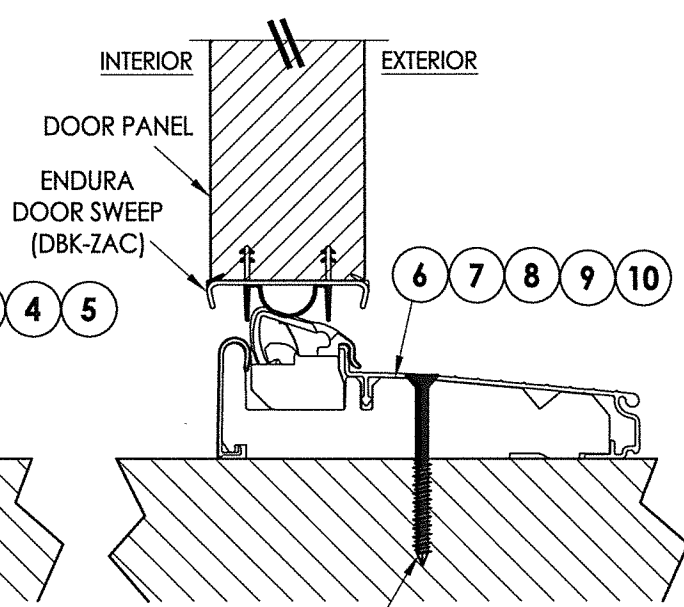

#10 X 2.5" PFH WOOD SCREW OR
1/4" X 2-3/4" DeWALT OR ITW CONCRETE SCREW

2 VERTICAL CROSS SECTION
4 Inswing Articulating Threshold

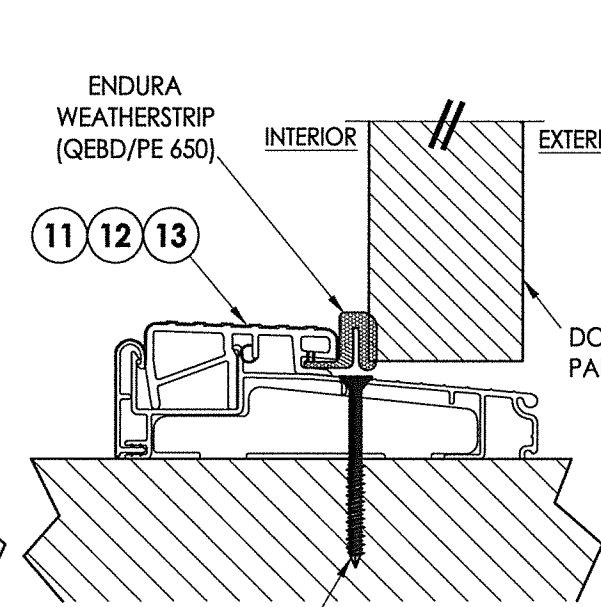

#10 X 2.5" PFH WOOD SCREW OR
1/4" X 2-3/4" DeWALT OR ITW CONCRETE SCREW

3 VERTICAL CROSS SECTION
4 Outswing Bump Threshold

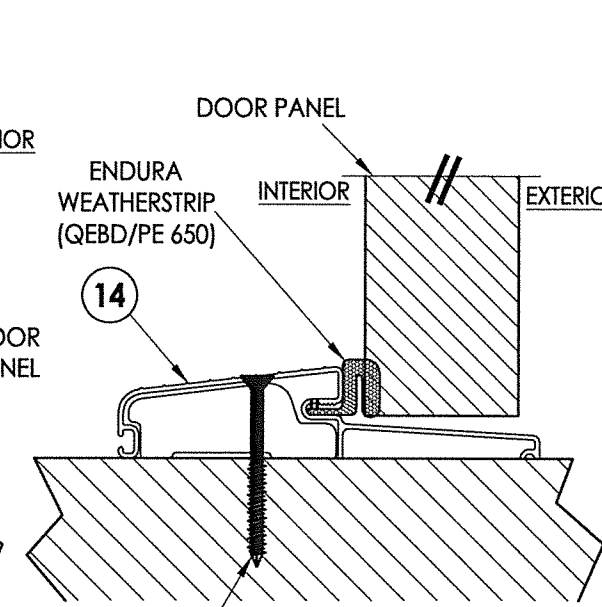

#10 X 2.5" PFH WOOD SCREW OR
1/4" X 2-3/4" DeWALT OR ITW CONCRETE SCREW

4 VERTICAL CROSS SECTION
4 Outswing Bump Threshold

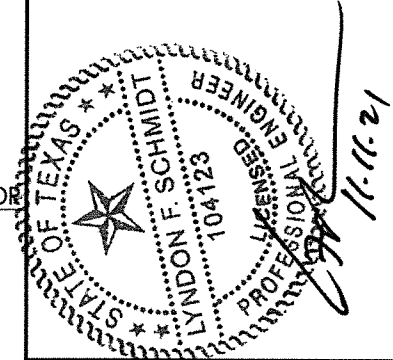

Documents Prepared By: Lyndon F. Schmidt, P.E.
TEXAS P.E. #104123

RW BUILDING CONSULTANTS, INC.
P.O. Box 230 Valrico FL 33595
Phone No.: 813.659.9197

TEXAS BOARD OF PROFESSIONAL ENGINEERS
CERTIFICATE OF REGISTRATION # F-11852

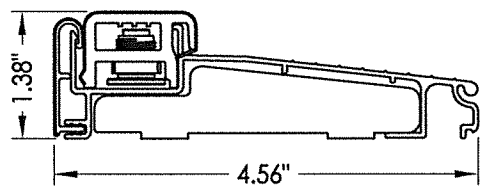

1 INSWING ADJUSTABLE THRESHOLD
ZAI14565

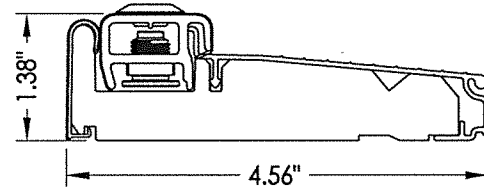

2 INSWING ADJUSTABLE THRESHOLD
ZAI4565FN

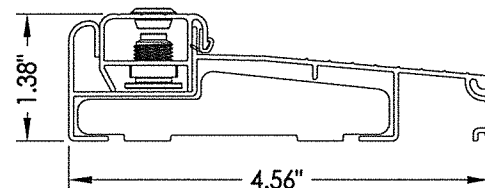

3 INSWING ADJUSTABLE THRESHOLD
ZAI1AA4565

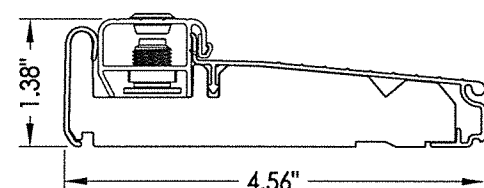

4 INSWING ADJUSTABLE THRESHOLD
ZAI1AA4565FN

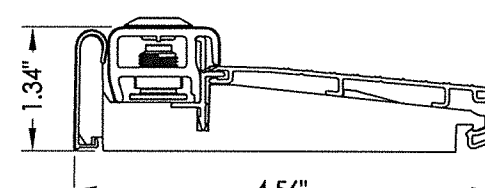

5 INSWING ADJUSTABLE THRESHOLD
ZAI4565RDS

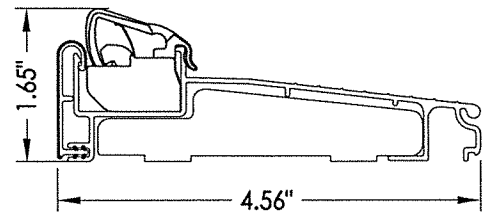

6 INSWING ARTICULATING THRESHOLD
ZAC14565

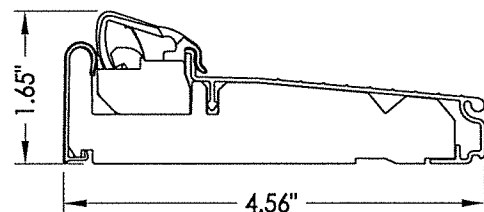

7 INSWING ARTICULATING THRESHOLD
ZAC4565FN

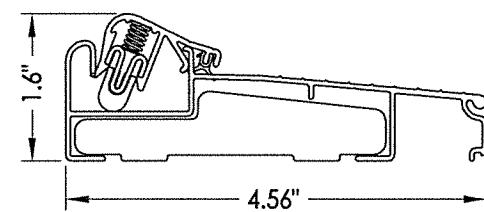

8 INSWING ARTICULATING THRESHOLD
ZAC1AA4565

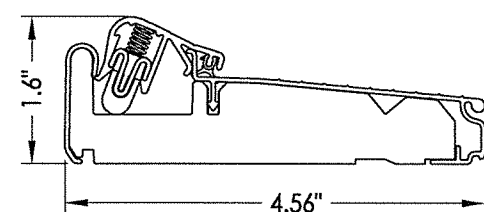

9 INSWING ARTICULATING THRESHOLD
ZACAA4565FN

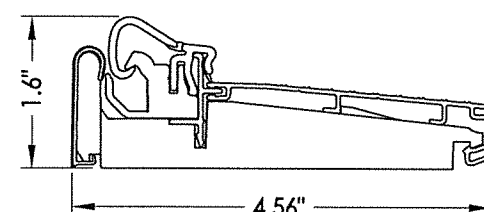

10 INSWING ARTICULATING THRESHOLD
ZAC4565RDS

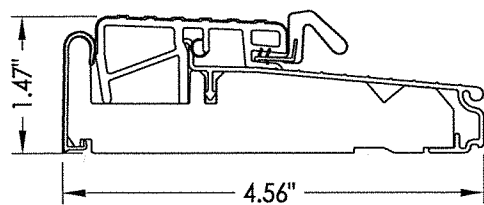

11 OUTSWING THRESHOLD
ZOB4565FN

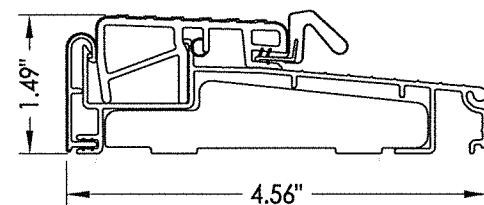

12 OUTSWING THRESHOLD
ZOB14565

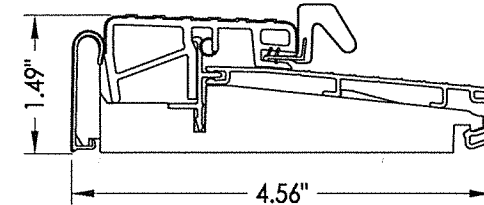

13 OUTSWING THRESHOLD
ZOB4565RDS

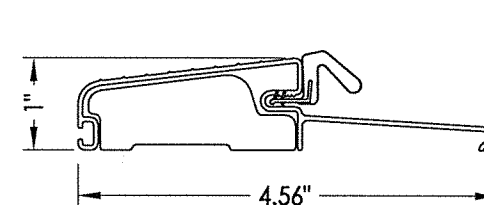

14 OUTSWING THRESHOLD
FOB4566

| | |
|---|----------|
| PRODUCT: ENDURA | |
| PART OR ASSEMBLY: VERTICAL CROSS SECTIONS | |
| NO. | DATE |
| 1 | 10/26/21 |
| REVISIONS | |
| DATE: 11/09/16 | |
| SCALE: N.T.S. | |
| DWG. BY: JK | |
| CHK. BY: LFS | |
| DRAWING NO.: TX-4657 | |
| SHEET 4 OF 5 | |

© 2016 R.W. BUILDING CONSULTANTS INC.

Z:\Clients\Endura PERMANENT\B - Texas Dept of Ins\TDI - DR-853 Plastpro FG Opaque (Trilennium)\C - Drawings\TX-4657.60.dwg

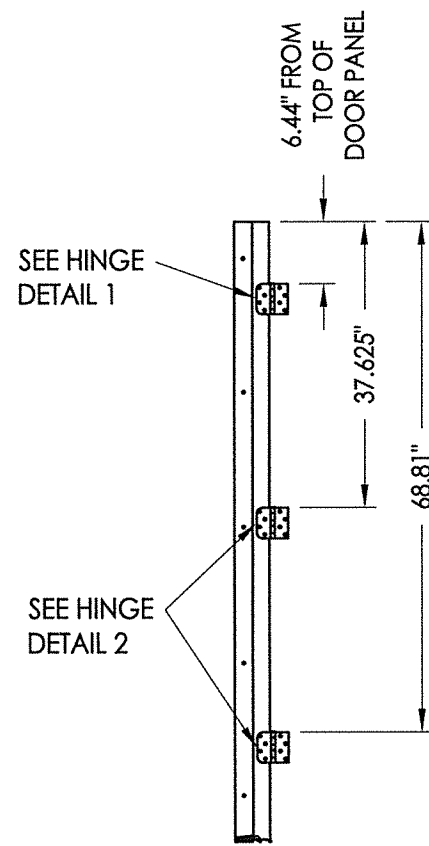

HINGE JAMB

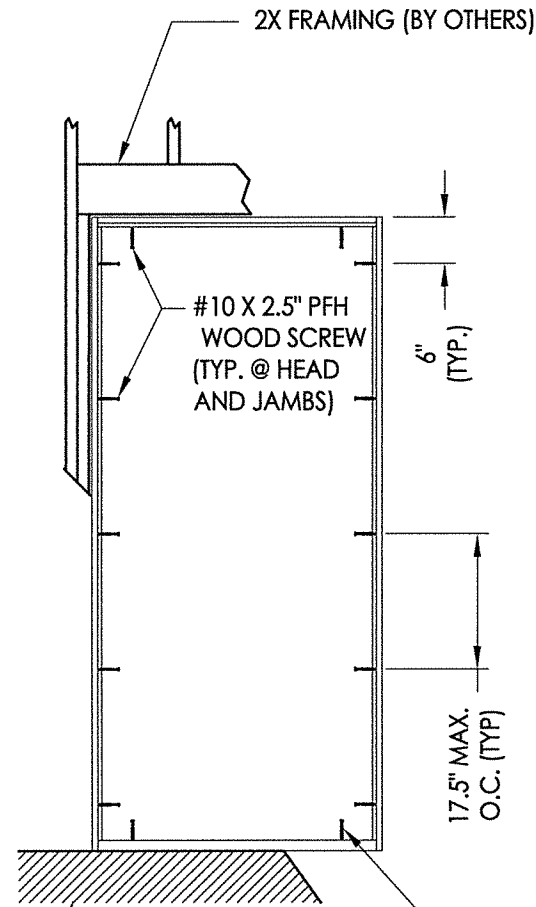

FRAME ANCHORING
X

FLOOR SUBSTRATE MATERIAL (TYP.)
CONCRETE (MIN. 3000 PSI)
WOOD (G >= 0.42)

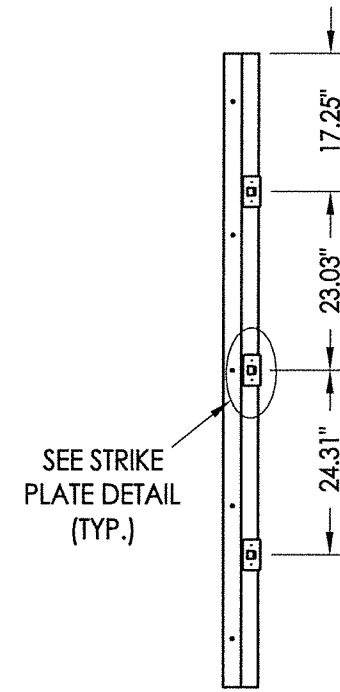

STRIKE JAMB

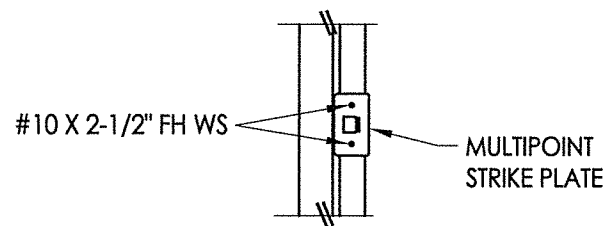

STRIKE PLATE DETAIL

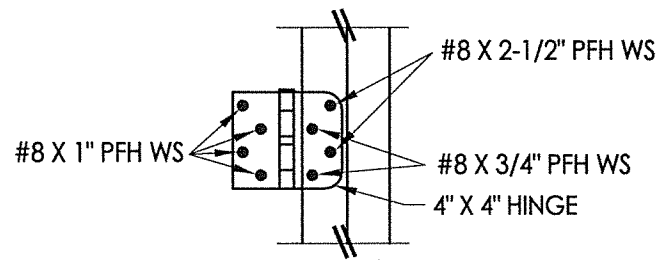

HINGE DETAIL 1

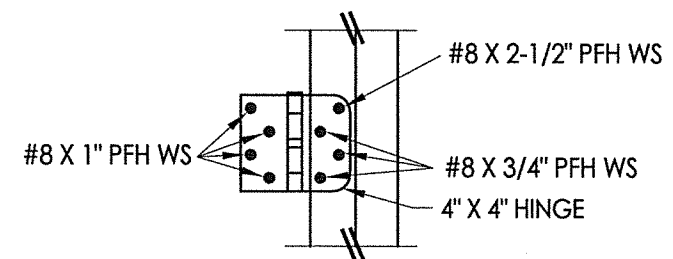

HINGE DETAIL 2

CONCRETE ANCHOR NOTES:

1. Concrete anchor locations at the corners may be adjusted to maintain the min. edge distance to mortar joints.
2. Concrete anchor locations noted as "MAX. ON CENTER" must be adjusted to maintain the min. edge distance to mortar joints, additional concrete anchors may be required to ensure the "MAX. ON CENTER" dimension are not exceeded.
3. Concrete anchor table:

| ANCHOR TYPE | ANCHOR SIZE | MIN. EMBEDMENT | MIN. CLEARANCE TO MASONRY EDGE | MIN. CLEARANCE TO ADJACENT ANCHOR |
|-------------------|-------------|----------------|--------------------------------|-----------------------------------|
| ITW TAPCON® | 1/4" | 1-3/4" | 1-1/2" | 4" |
| DeWALT ULTRACON+® | 1/4" | 1-3/4" | 1" | 4" |

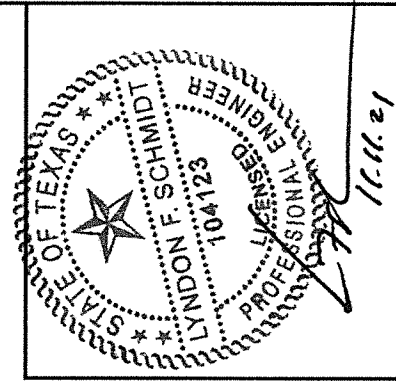

Documents Prepared By: Lyndon F. Schmidt, P.E.
TEXAS P.E. #104123

RW BUILDING CONSULTANTS, INC.
P.O. Box 230 Valrico FL, 33595
Phone No.: 813.659.9197
TEXAS BOARD OF PROFESSIONAL ENGINEERS
CERTIFICATE OF REGISTRATION # F-11852

| | | |
|-----------------------------|-----------------|-----|
| PRODUCT: | ENDURA | |
| PART OR ASSEMBLY: | FRAME ANCHORING | |
| NO. | DATE | BY |
| 1 | 10/26/21 | LFS |
| UPDATE TO 2018 IBC/IRC CODE | | |
| REVISIONS | | |
| DATE: | 11/09/16 | |
| SCALE: | N.T.S. | |
| DWG. BY: | JK | |
| CHK. BY: | LFS | |
| DRAWING NO.: | TX-4657 | |
| SHEET | 5 OF 5 | |