



GLAZED IRON DOUBLE DOOR (Arch Top) IN SWING/OUT SWING "IMPACT"

EVALUATED FOR USE IN THE STATE OF TEXAS

The Iron Door System described herein complies with the 2006 International Residential Code (IRC), Sections R301 & R613 and the 2006 International Building Code (IBC), Sections 1405.12, 1609, 1714.5, 2403 and 2404 (including Texas revisions) subject to the following conditions:

1. Anchors shall be as listed and spaced as shown in the details. Anchor embedment to base material shall be beyond wall dressing or stucco.
2. This system has been tested and evaluated as a large missile impact protective system for installation in the Seaward, Inland I and Inland II areas. This product meets missile level "D" as defined in ASTM E 1996.
3. Allowable design pressure requirements must be equal to or less than the design pressure rating shown in the design pressure chart, sheet 1 of this drawing.
4. For 2x stud framing construction, anchoring of these units shall be the same as that shown for 2x buck masonry construction.
5. Conditions not covered by this drawing are subject to further engineering analysis.

TABLE OF CONTENTS	
SHEET#	DESCRIPTION
1	Typical elevations, design pressures, & general notes
2	Door panel details & glazing details
3	Horizontal & vertical cross sections
4	Buck & frame anchoring
5	Bill of materials & components

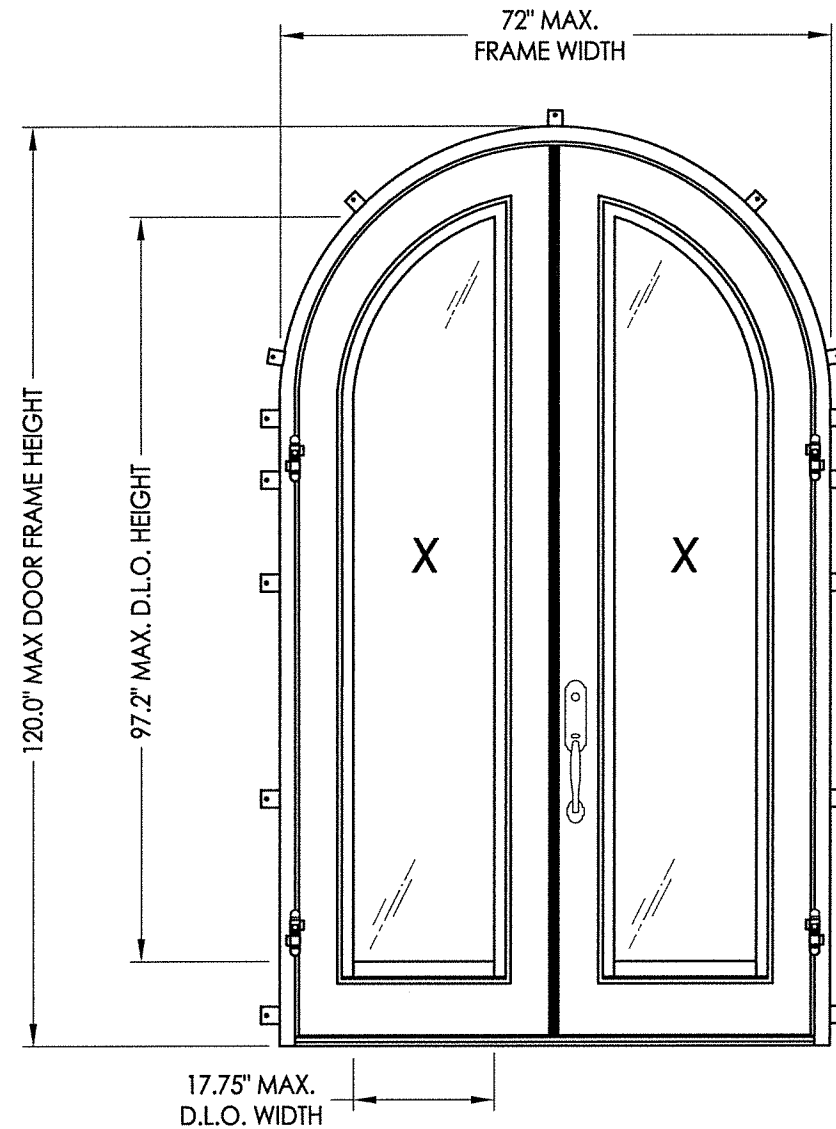

CONFIGURATION	OVERALL FRAME DIMENSION	GLASS TYPE	DESIGN PRESSURE (PSF)			
			IN SWING		OUT SWING	
			POS.	NEG.	POS.	NEG.
XX	72.0" x 120.0"	G1	+70.0	-70.0	+70.0	-70.0
XX	72.0" x 120.0"	G2	+50.0	-50.0	+50.0	-55.0

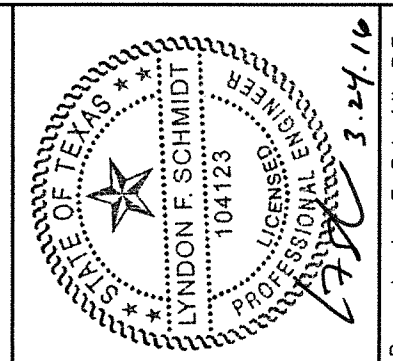

Documents Prepared By: Lyndon F. Schmidt, P.E.
TEXAS P.E. #104123

RW BUILDING CONSULTANTS, INC.
P.O. Box 230 Valrico FL 33595
Phone No.: 813.659.9197

TEXAS BOARD OF PROFESSIONAL ENGINEERS
CERTIFICATE OF REGISTRATION # F-11852

PRODUCT: FLORIDA IRON DOORS

PART OR ASSEMBLY: TYPICAL ELEVATIONS, DESIGN PRESSURES & GENERAL NOTES

NO.	DATE	BY	REVISIONS

DATE: 3/23/16

SCALE: N.T.S.

DWG. BY: JK

CHK. BY: LFS

DRAWING NO.: TX-4606

SHEET 1 OF 5

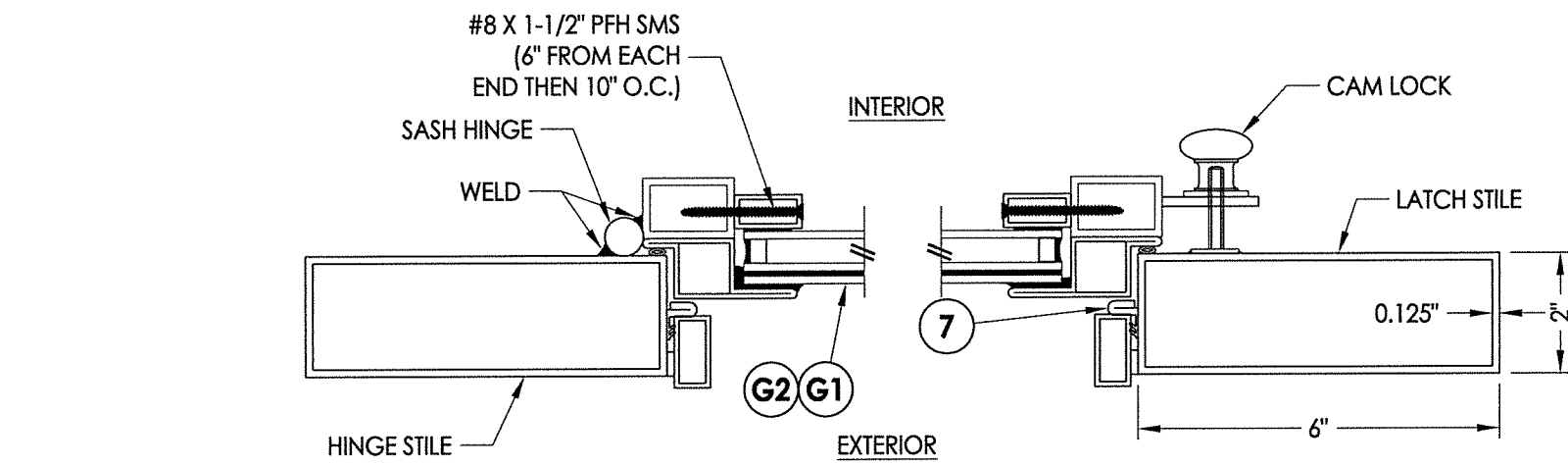

1
2 **HORIZONTAL CROSS SECTION**

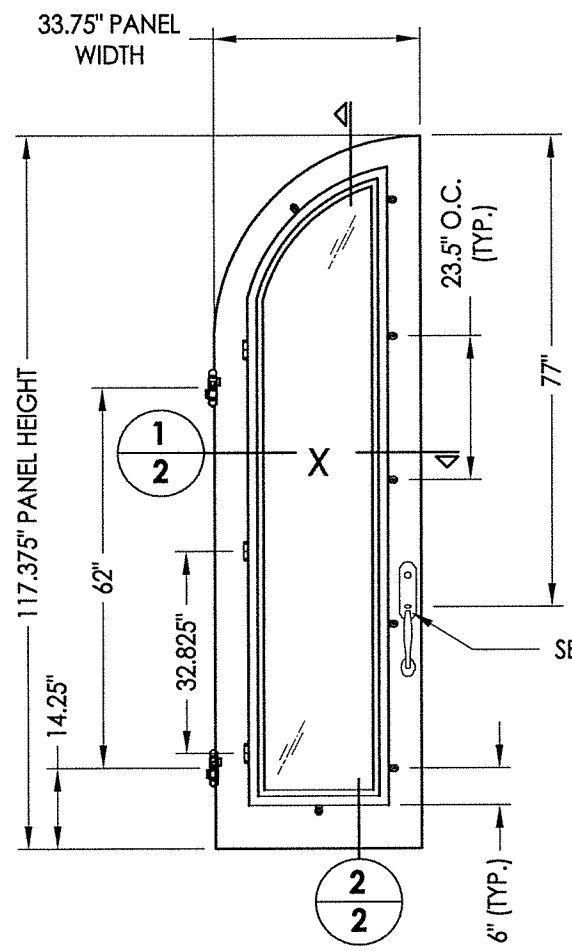

40 **DOOR PANEL**

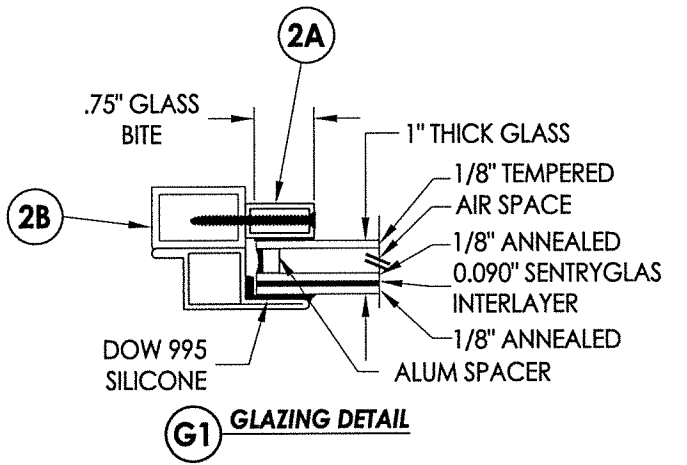

G1 **GLAZING DETAIL**

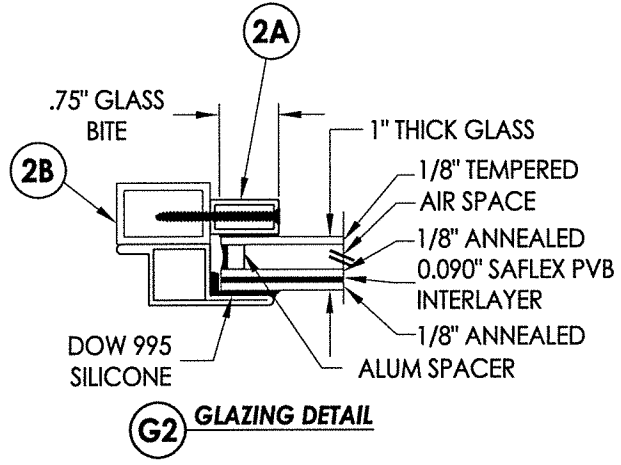

G2 **GLAZING DETAIL**

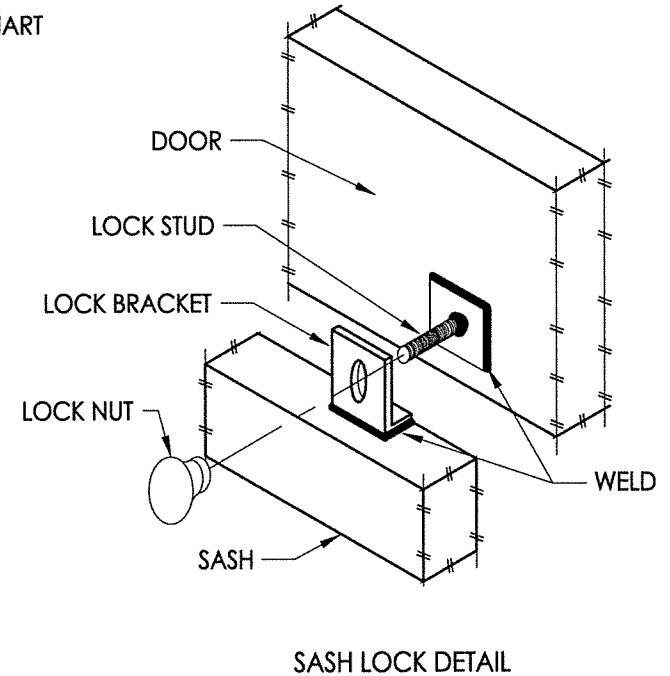

SASH LOCK DETAIL

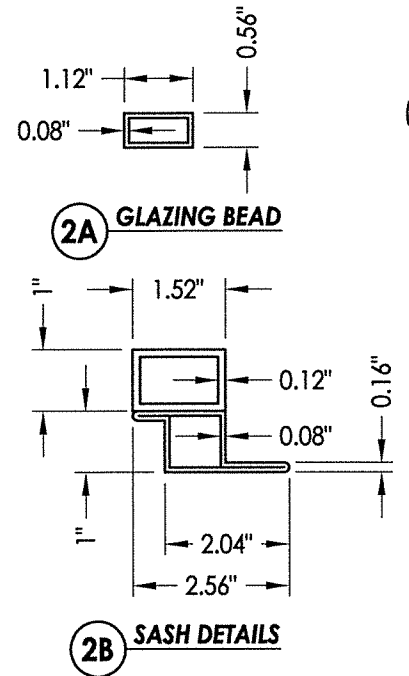

2A **GLAZING BEAD**

2B **SASH DETAILS**

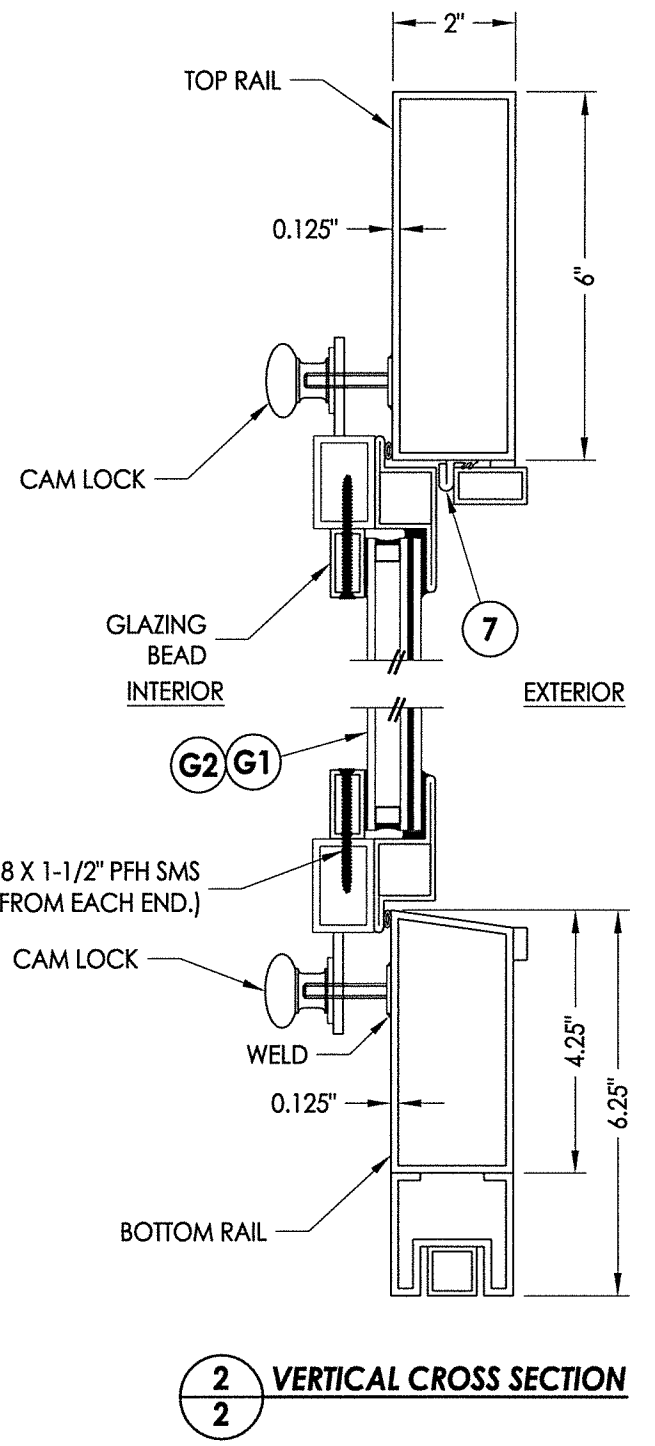

2
2 **VERTICAL CROSS SECTION**

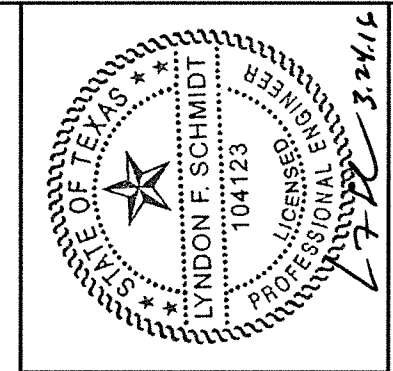

Documents Prepared By: Lyndon F. Schmidt, P.E.
TEXAS P.E. #104123

RW BUILDING CONSULTANTS, INC.
P.O. Box 230 Vairico FL, 33595
Phone No.: 813.659.9197

PRODUCT: FLORIDA IRON DOORS
PART OR ASSEMBLY: DOOR PANEL DETAILS & GLAZING DETAILS

NO.	DATE	BY	REVISIONS

DATE: 3/23/16
SCALE: N.T.S.
DWG. BY: JK
CHK. BY: LFS
DRAWING NO.: TX-4606
SHEET 2 OF 5

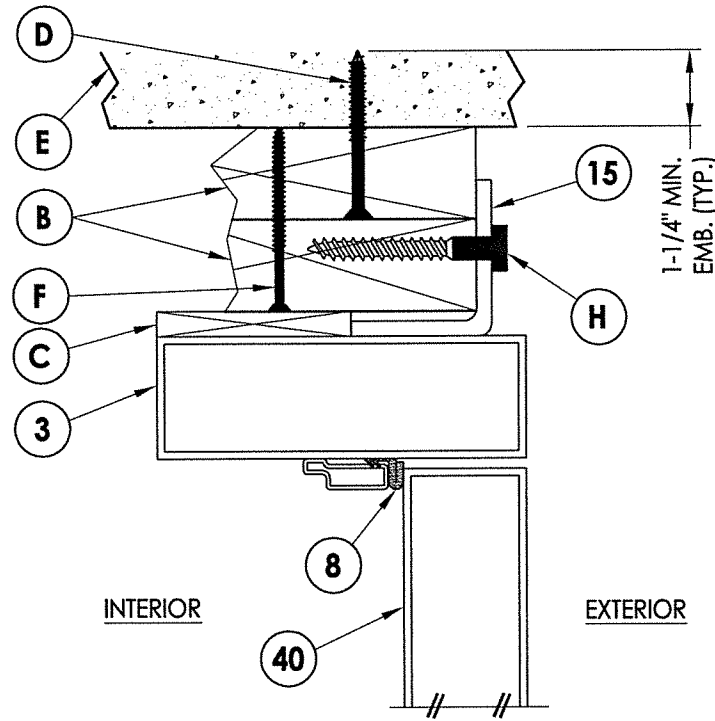

3 VERTICAL CROSS SECTION
3 Outswing

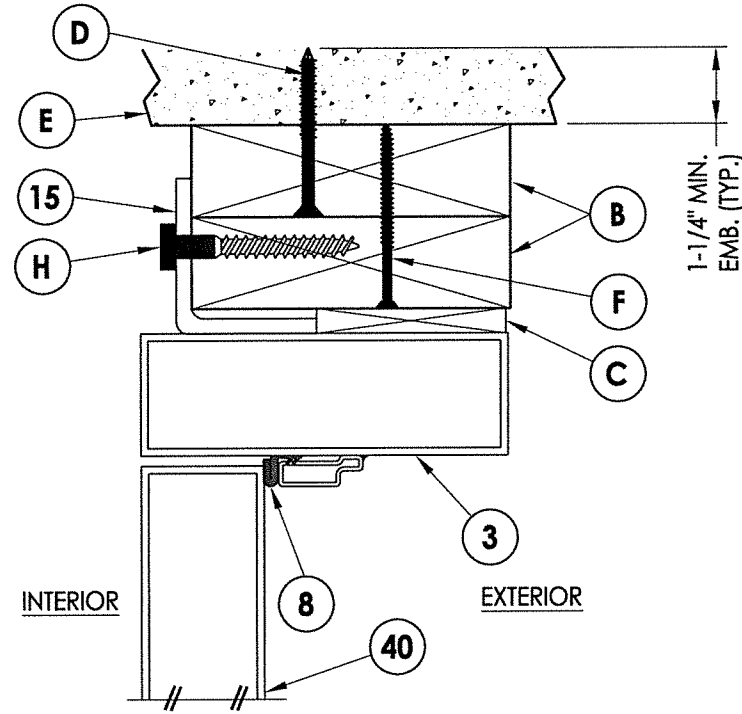

4 VERTICAL CROSS SECTION
3 Inswing

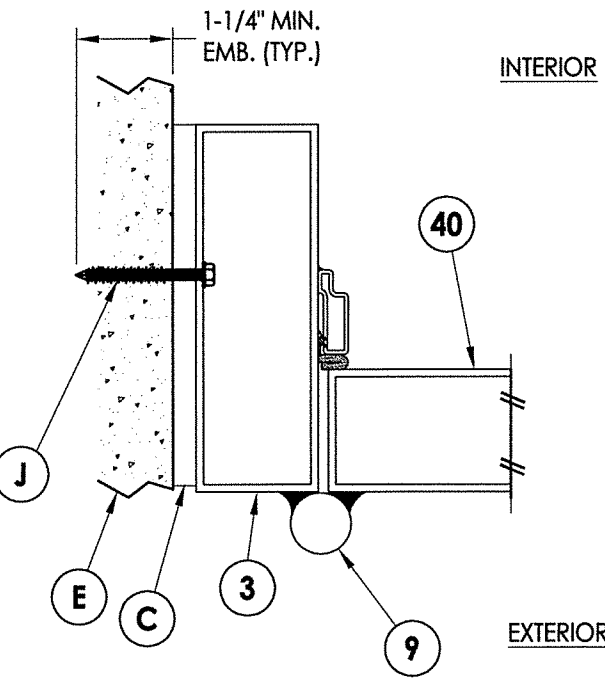
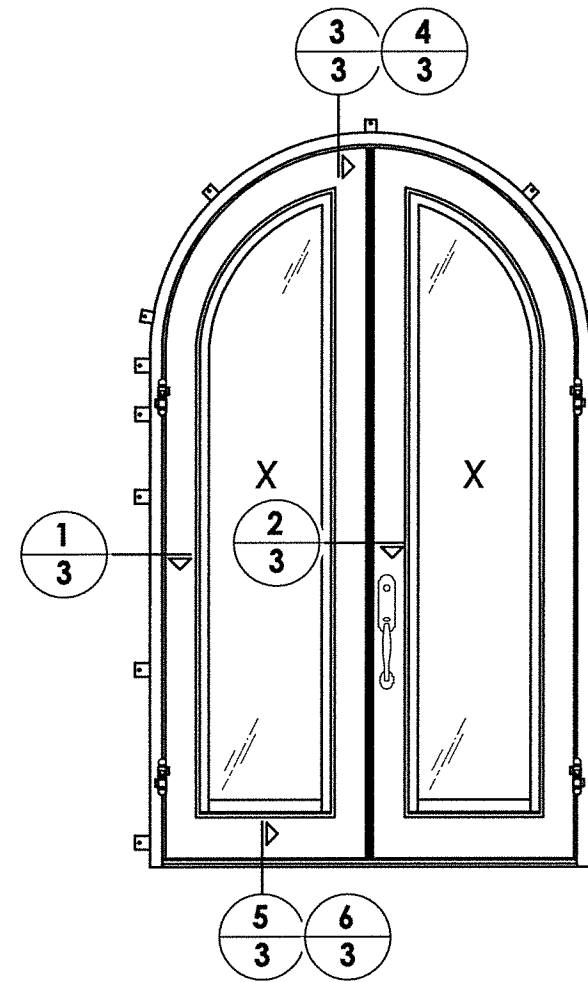

1 HORIZONTAL CROSS SECTION
3 Outswing Shown (Inswing Similar)
Direct to Masonry Anchoring

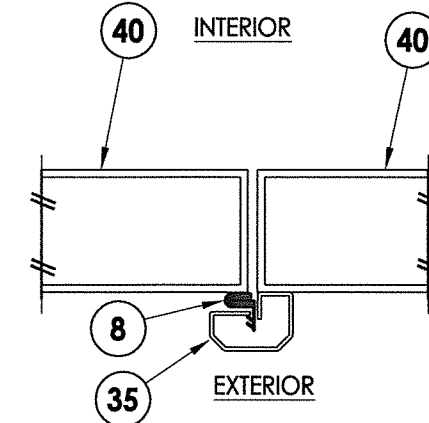

2 HORIZONTAL CROSS SECTION
3 Outswing Shown (Inswing Similar)

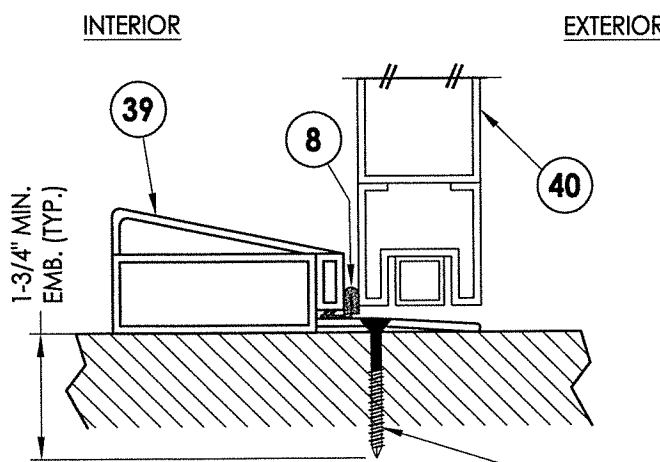

5 VERTICAL CROSS SECTION
3 Outswing

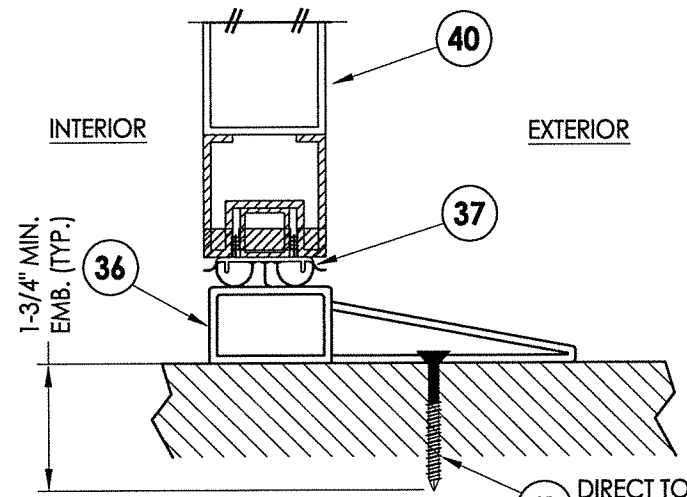

6 VERTICAL CROSS SECTION
3 Inswing

F WOOD
K CONCRETE

K DIRECT TO MASONRY ONLY

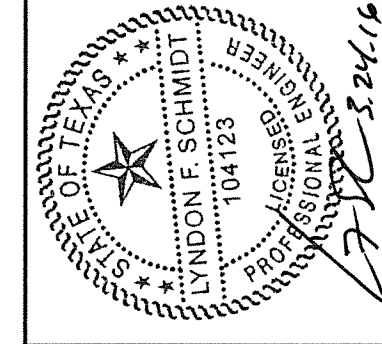

Documents Prepared By: Lyndon F. Schmidt, P.E.
TEXAS P.E. #104123

RW BUILDING CONSULTANTS, INC.
P.O. Box 230 Valrico FL 33595
Phone No.: 813.659.9197

TEXAS BOARD OF PROFESSIONAL ENGINEERS
CERTIFICATE OF REGISTRATION # F-11852

PRODUCT: FLORIDA IRON DOORS

PART OR ASSEMBLY:
HORIZONTAL AND VERTICAL
CROSS SECTIONS

NO.	DATE	BY	REVISIONS

DATE: 3/23/16

SCALE: N.T.S.

DWG. BY: JK

CHK. BY: LFS

DRAWING NO.: TX-4606

SHEET 3 OF 5

R:\Clients\Florida Iron Doors PERMANENT\B - Texas Dept of Ins\DI - XXX\Drawings\TX-4604-7.dwg, 3.4

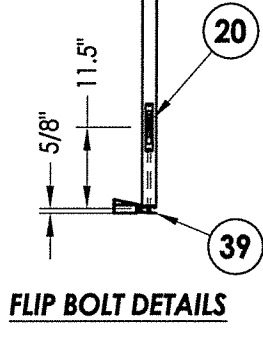
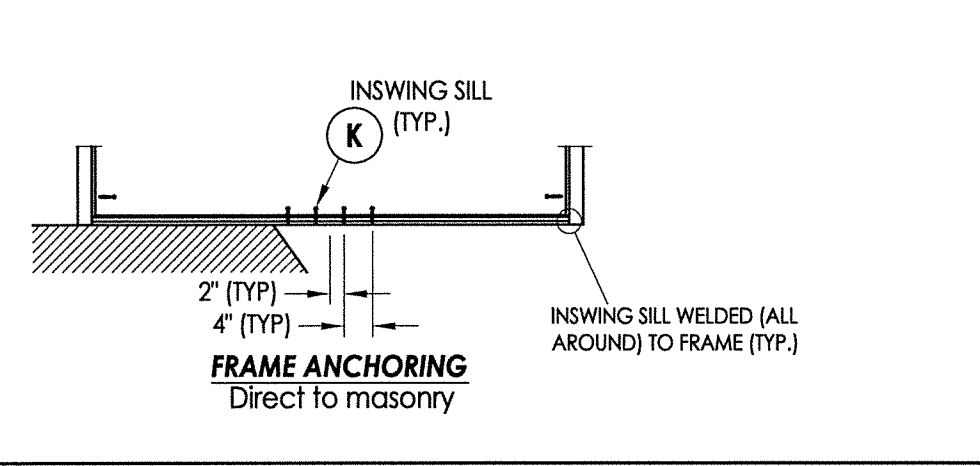
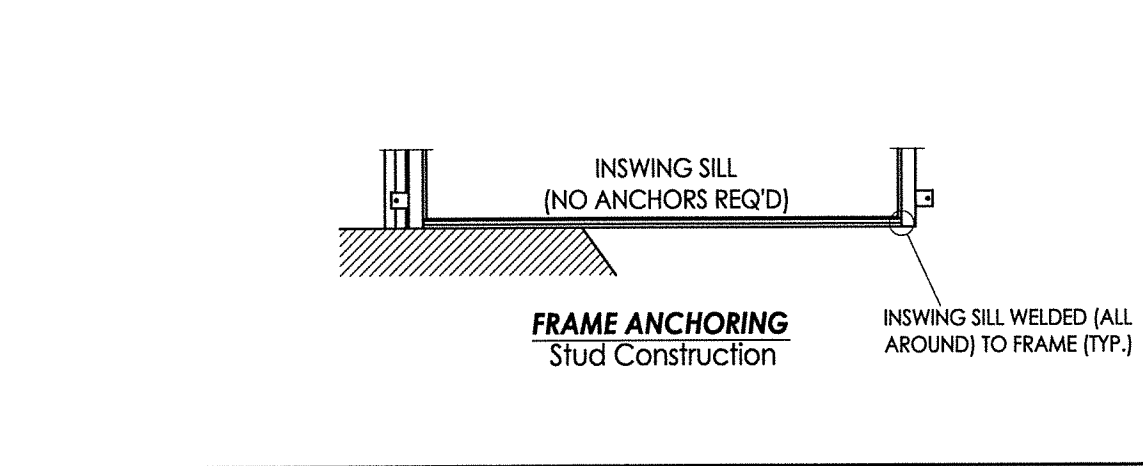
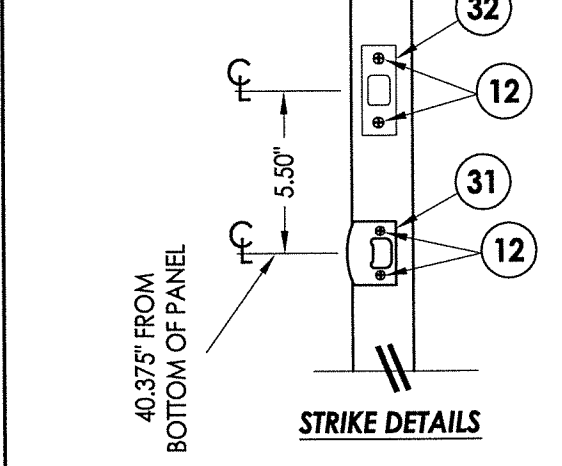
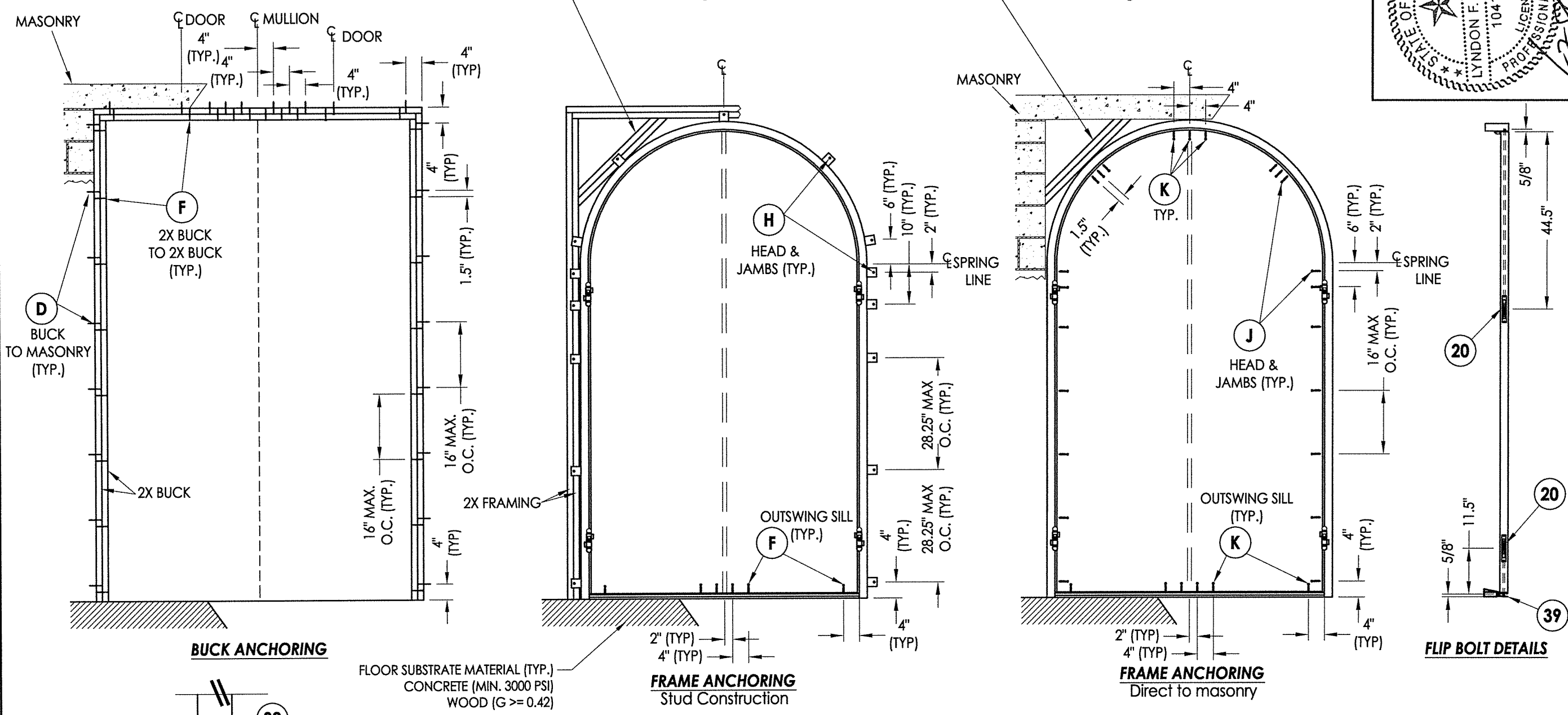

BUCK ANCHORING

FRAME ANCHORING
Stud Construction

FRAME ANCHORING
Direct to masonry

FLIP BOLT DETAILS

FLOOR SUBSTRATE MATERIAL (TYP.)
CONCRETE (MIN. 3000 PSI)
WOOD (G >= 0.42)

2X Framing and connection to substrate to be designed by Architect or Engineer of Record.

2X Framing and connection to substrate to be designed by Architect or Engineer of Record.



Documents Prepared By: Lyndon F. Schmidt, P.E.
TEXAS P.E. #104123
RW BUILDING CONSULTANTS, INC.
P.O. Box 230 Valrico FL 33595
Phone No.: 813.659.9197
TEXAS BOARD OF PROFESSIONAL ENGINEERS
CERTIFICATE OF REGISTRATION # F-11852

PRODUCT:	FLORIDA IRON DOORS
PART OR ASSEMBLY:	BUCK & FRAME ANCHORING

NO.	DATE	BY	REVISIONS

DATE:	3/23/16
SCALE:	N.T.S.
DWG. BY:	JK
CHK. BY:	LFS
DRAWING NO.:	TX-4606
SHEET	4 OF 5

R:\Clients\Florida Iron Doors PERMANENT\B - Texas Dept of Ins\TDI - XXX\Drawings\TX-4604-7.dwg, 3.5

BILL OF MATERIALS

ITEM #	DESCRIPTION	MATERIAL
B	2X BUCK/FRAMING (SG >= 0.42)	WOOD
C	3/8" MAX. SHIM SPACE	-
D	1/4" X 2-3/4" PFH ELCO OR ITW CONCRETE SCREW	STEEL
E	MASONRY - 3,000 PSI MIN. CONCRETE CONFORMING TO ACI301 OR HOLLOW BLOCK CONFORMING TO ASTM C90	CONCRETE
F	#10 X 3" PFH WOOD SCREW (1-1/2" MIN. EMBEDMENT)	STEEL
H	3/8" X 3" HWH LAG SCREW (2-1/2" MIN. EMBEDMENT)	STEEL
J	1/4" X 2-1/4" HWH ELCO OR ITW CONCRETE SCREW (1-1/4" MIN. EMBEDMENT)	STEEL
K	1/4" X 2-1/4" HWH ITW CONCRETE SCREW (1-3/4" MIN. EMBEDMENT)	STEEL
3	FRAME	STEEL
4	GLAZING BEAD	STEEL
5	#8 X 1-1/4" PFH SELF-DRILLING SMS	STEEL
7	WEATHERSTRIP GASKET (.5")	FOAM
8	WEATHERSTRIP GASKET (.67")	FOAM
9	DOOR HINGE	STEEL
12	#8 X 3/4" PFH SELF-DRILLING SMS	STEEL
15	ANCHORING BRACKET	STEEL
20	FLIP BOLT	-
25	#10 X 1-1/2" HH SELF-DRILLING SMS	STEEL
31	LATCH STRIKE PLATE	STEEL
32	DEADBOLT STRIKE PLATE	STEEL
35	ASTRAGAL	STEEL
36	THRESHOLD	STEEL
37	DOOR SWEEP	PVC
39	THRESHOLD	STEEL
40	DOOR PANEL	STEEL

All Door Component Steel: ASTM A36

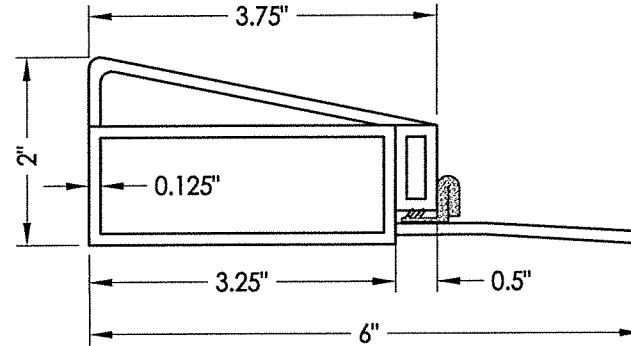

39 THRESHOLD
Outswing

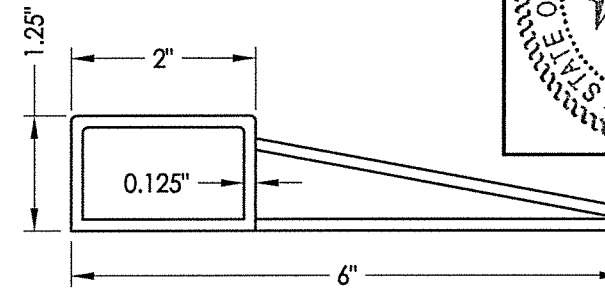

36 THRESHOLD
Inswing

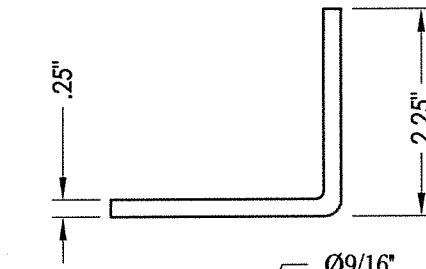

15 ANCHORING BRACKET

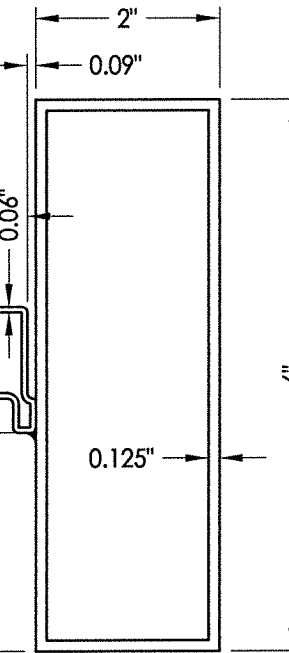
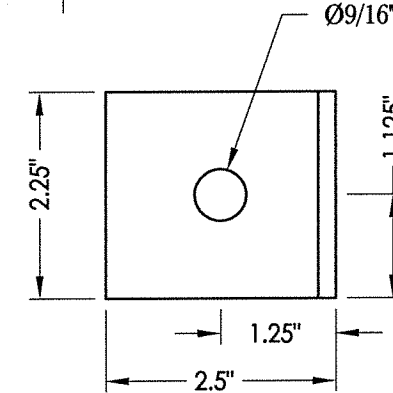

3 FRAME

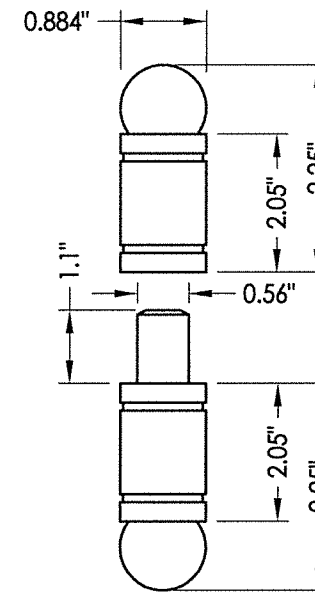

9 HINGE

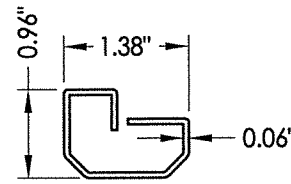

35 ASTRAGAL

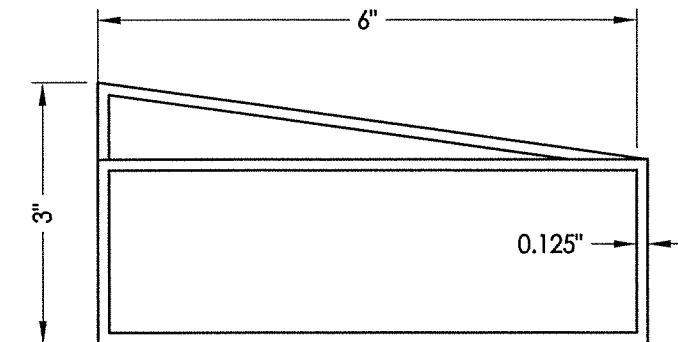

2 TRANSOM SILL

CONCRETE ANCHOR NOTES:

- Concrete anchor locations at the corners may be adjusted to maintain the min. edge distance to mortar joints.
- Concrete anchor locations noted as "MAX. ON CENTER" must be adjusted to maintain the min. edge distance to mortar joints, additional concrete anchors may be required to ensure the "MAX. ON CENTER" dimension are not exceeded.
- Concrete anchor table:

ANCHOR TYPE	ANCHOR SIZE	MIN. EMBEDMENT	MIN. CLEARANCE TO MASONRY EDGE	MIN. CLEARANCE TO ADJACENT ANCHOR
ITW TAPCON®	1/4"	1-1/4" (JAMBS) 1-3/4" (HEAD/SILL)	2-1/2"	4"
ELCO ULTRACON®	1/4"	1-1/4" (JAMBS) 1-3/4" (HEAD/SILL)	2-1/2"	4"

WOOD SCREW INSTALLATION NOTES:

- Maintain a minimum 5/8" edge distance, 1" end distance, & 1" o.c. spacing of wood screws to prevent the splitting of wood.

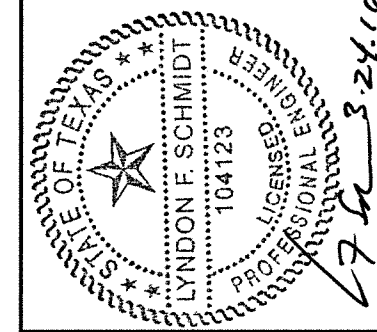

Documents Prepared By: Lyndon F. Schmidt, P.E.
TEXAS P.E. #104123

RW BUILDING CONSULTANTS, INC.
P.O. Box 230 Valrico FL, 33595
Phone No.: 813.659.9197

TEXAS BOARD OF PROFESSIONAL ENGINEERS
CERTIFICATE OF REGISTRATION # F-11852

PRODUCT: FLORIDA IRON DOORS

PART OR ASSEMBLY: BILL OF MATERIALS & COMPONENTS

NO.	DATE	BY	REVISIONS

DATE: 3/23/16

SCALE: N.T.S.

DWG. BY: JK

CHK. BY: LFS

DRAWING NO.: TX-4606

SHEET 5 OF 5