



GLAZED IRON SINGLE DOOR (Arch Top) IN SWING/OUT SWING "IMPACT"

EVALUATED FOR USE IN THE STATE OF TEXAS

The Iron Door System described herein complies with the 2006 International Residential Code (IRC), Sections R301 & R613 and the 2006 International Building Code (IBC), Sections 1405.12, 1609, 1714.5, 2403 and 2404 (including Texas revisions) subject to the following conditions:

1. Anchors shall be as listed and spaced as shown in the details. Anchor embedment to base material shall be beyond wall dressing or stucco.
2. This system has been tested and evaluated as a large missile impact protective system for installation in the Seaward, Inland I and Inland II areas. This product meets missile level "D" as defined in ASTM E 1996.
3. Allowable design pressure requirements must be equal to or less than the design pressure rating shown in the design pressure chart, sheet 1 of this drawing.
4. For 2x stud framing construction, anchoring of these units shall be the same as that shown for 2x buck masonry construction.
5. Conditions not covered by this drawing are subject to further engineering analysis.

TABLE OF CONTENTS	
SHEET#	DESCRIPTION
1	Typical elevations, design pressures, & general notes
2	Door panel details & glazing details
3	Horizontal & vertical cross sections
4	Buck & frame anchoring
5	Components
6	Bill of materials & components

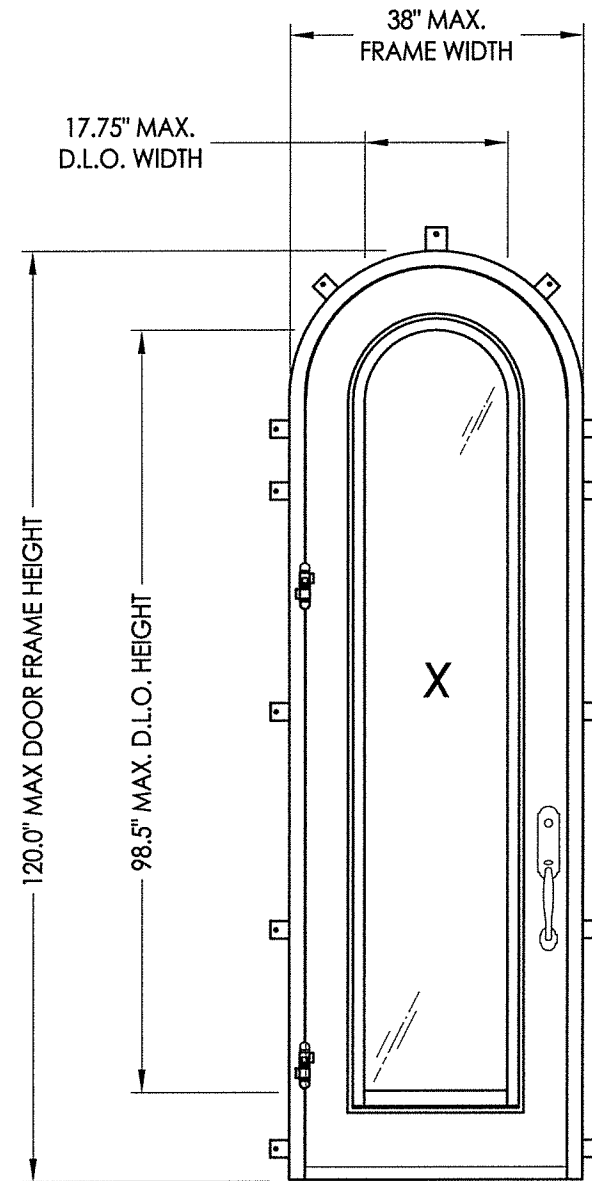

CONFIGURATION	OVERALL FRAME DIMENSION	GLASS TYPE	DESIGN PRESSURE (PSF)			
			IN SWING		OUT SWING	
			POS.	NEG.	POS.	NEG.
X	38.0" x 120.0"	G1	+70.0	-70.0	+70.0	-70.0
X	38.0" x 120.0"	G2	+50.0	-50.0	+50.0	-55.0

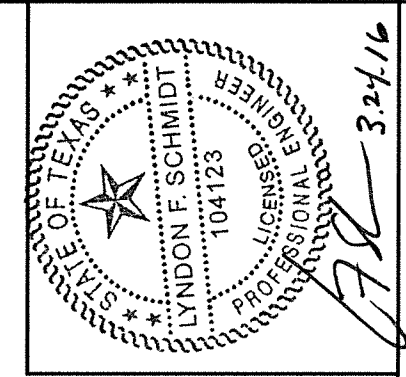

Documents Prepared By: Lyndon F. Schmidt, P.E.
TEXAS P.E. #104123

RW BUILDING CONSULTANTS, INC.
P.O. Box 230 Vairico FL 33595
Phone No.: 813.659.9197

TEXAS BOARD OF PROFESSIONAL ENGINEERS
CERTIFICATE OF REGISTRATION # F-11852

PRODUCT: FLORIDA IRON DOORS
PART OR ASSEMBLY: TYPICAL ELEVATIONS, DESIGN PRESSURES & GENERAL NOTES

NO.	DATE	BY	REVISIONS

DATE: 3/23/16
SCALE: N.T.S.
DWG. BY: JK
CHK. BY: LFS
DRAWING NO.: TX-4604
SHEET 1 OF 5

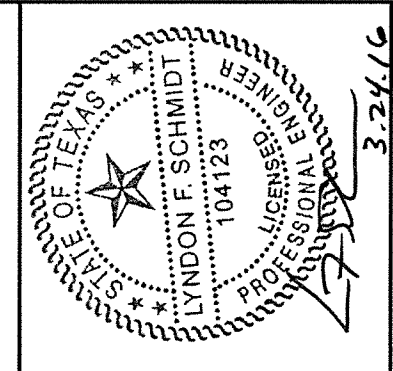

Documents Prepared By: Lyndon F. Schmidt, P.E.
 TEXAS P.E. #104123

RW BUILDING CONSULTANTS, INC.
 P.O. Box 230 Vairico FL 33595
 Phone No.: 813.659.9197

TEXAS BOARD OF PROFESSIONAL ENGINEERS
 CERTIFICATE OF REGISTRATION # F-11852

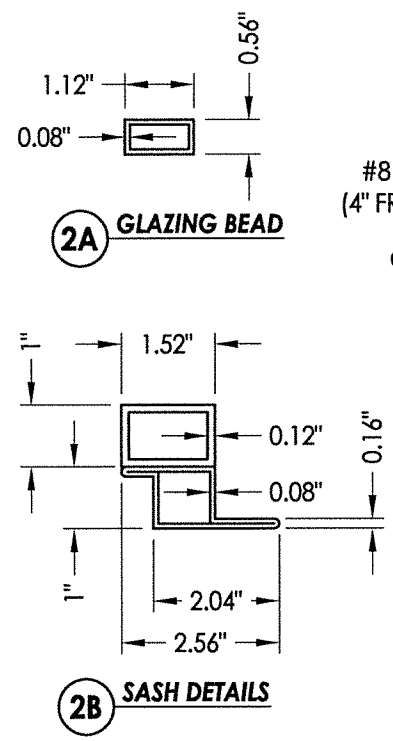
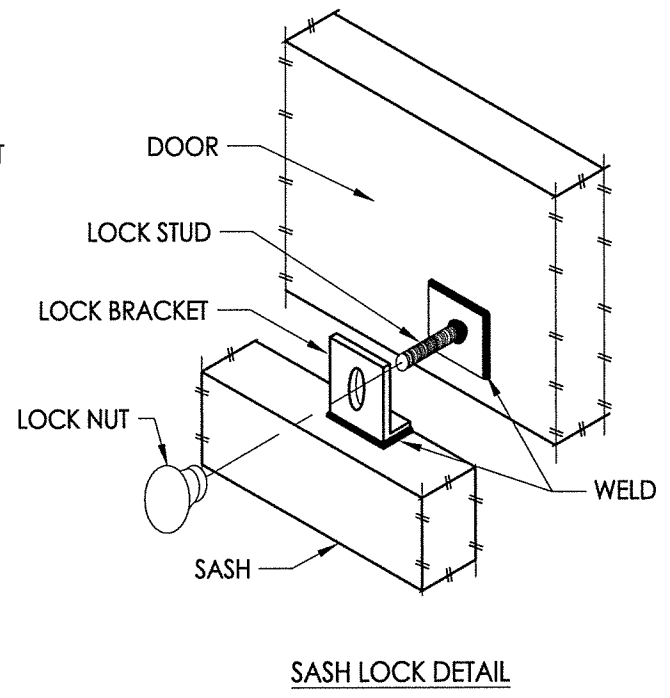
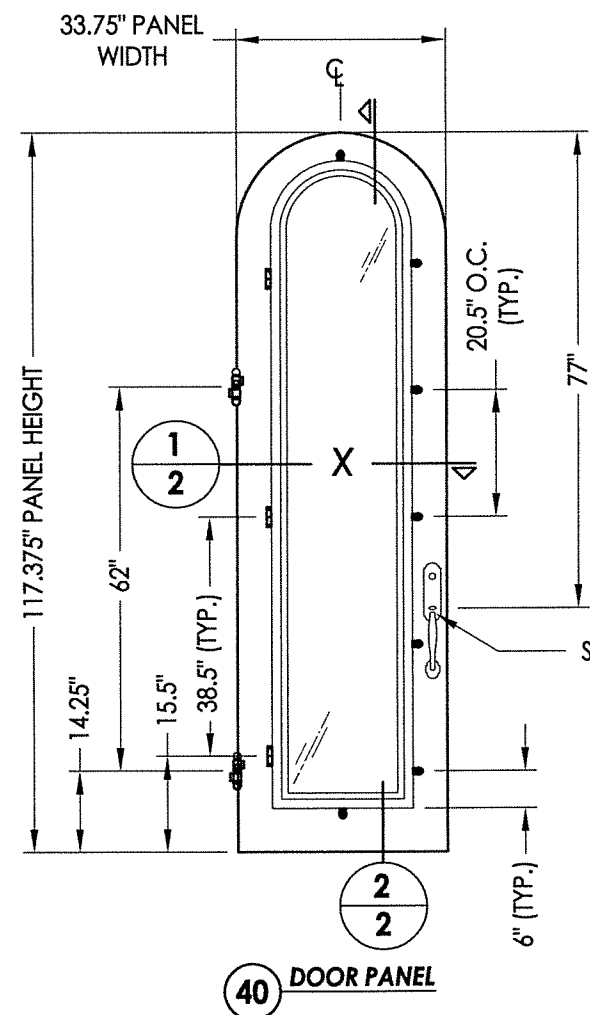
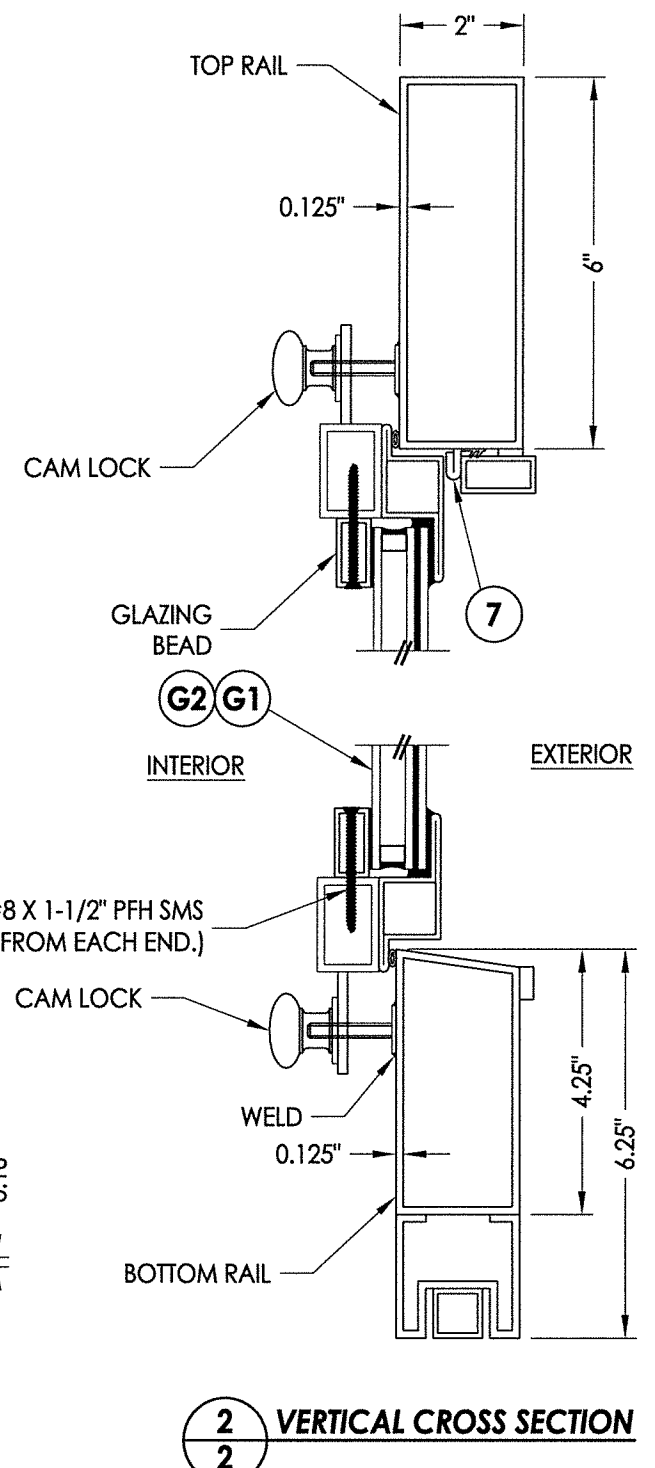
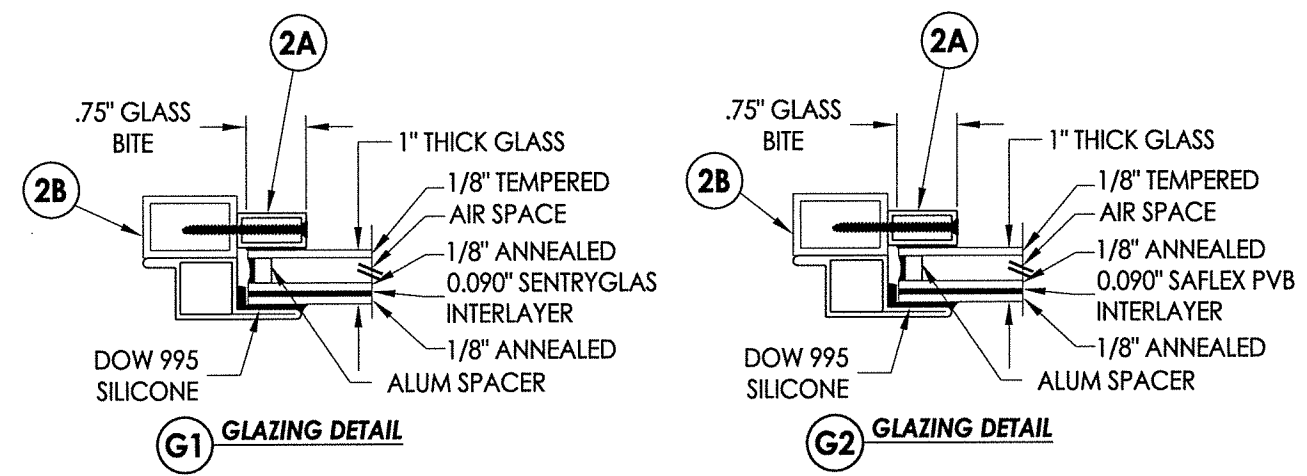
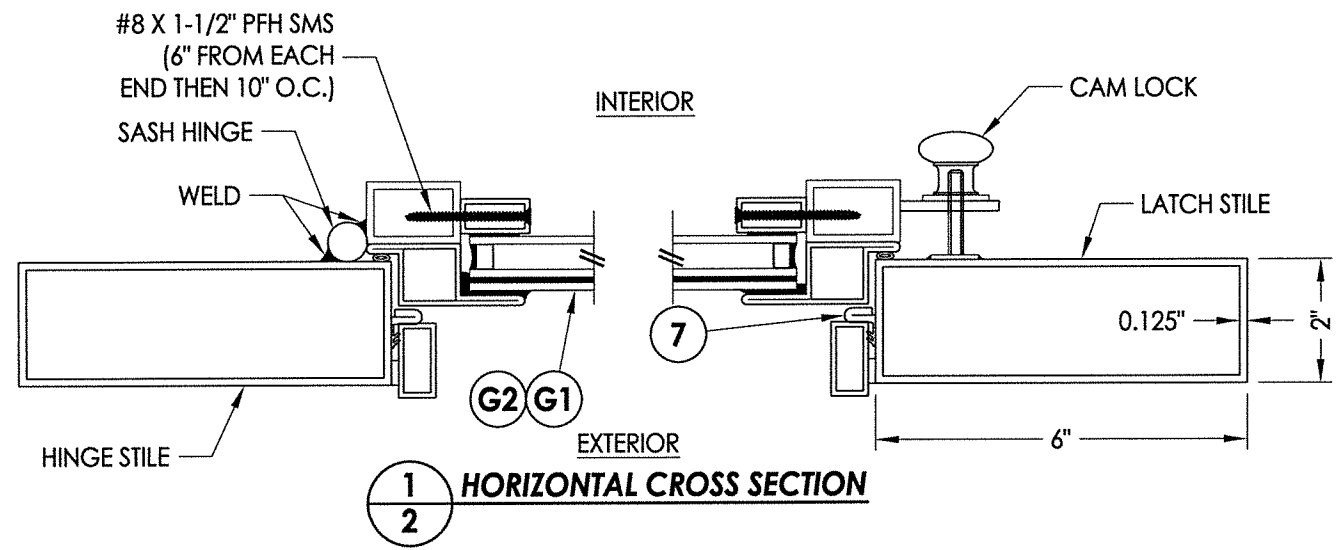

HARDWARE TABLE	
MANUFACTURER	MODEL
WESTIN	HANDLESET (F2)
BALDWIN	HANDLESET (ESTATE SERIES)

PRODUCT:	FLORIDA IRON DOORS
PART OR ASSEMBLY:	DOOR PANEL DETAILS & GLAZING DETAILS
NO.	DATE
BY	REVISIONS
DATE:	3/23/16
SCALE:	N.T.S.
DWG. BY:	JK
CHK. BY:	LFS
DRAWING NO.:	TX-4604
SHEET	2 OF 5

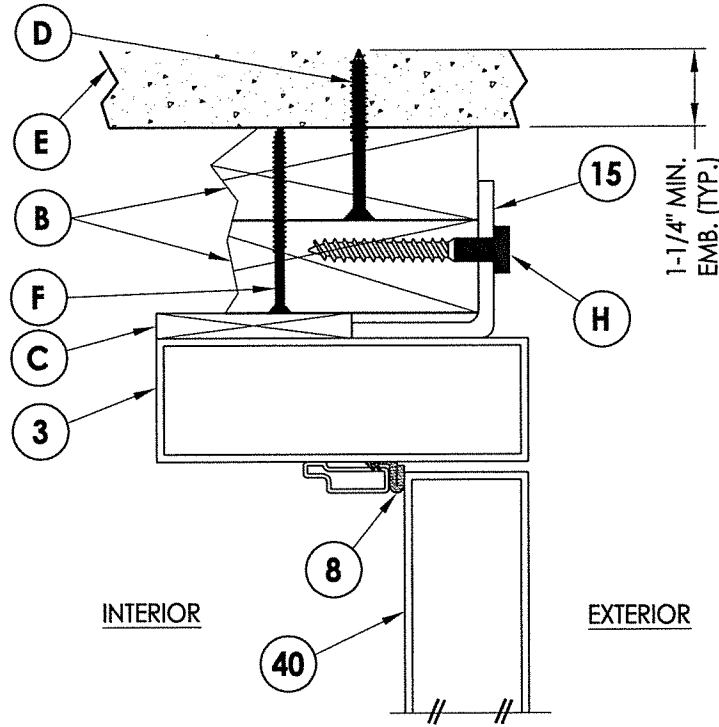

3 VERTICAL CROSS SECTION
3 Outswing

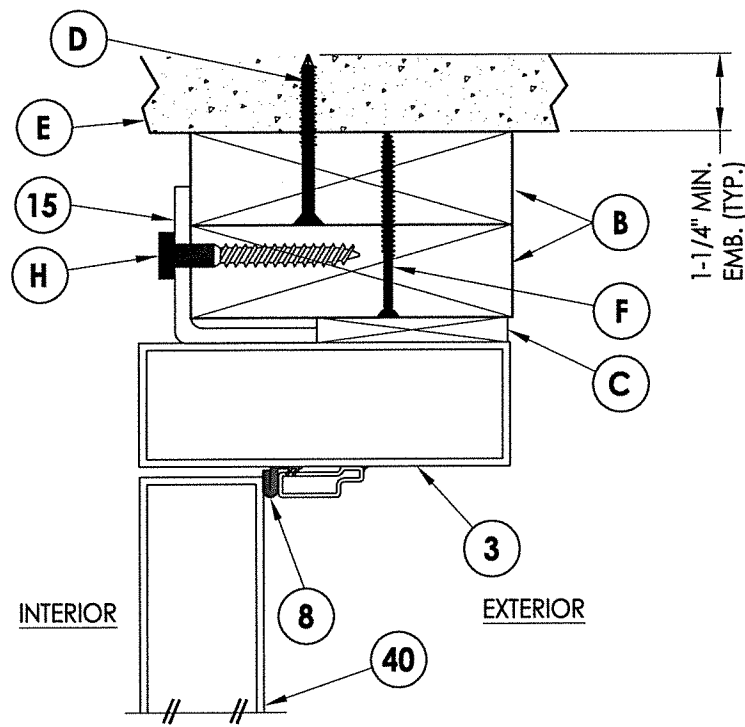

4 VERTICAL CROSS SECTION
3 Inswing

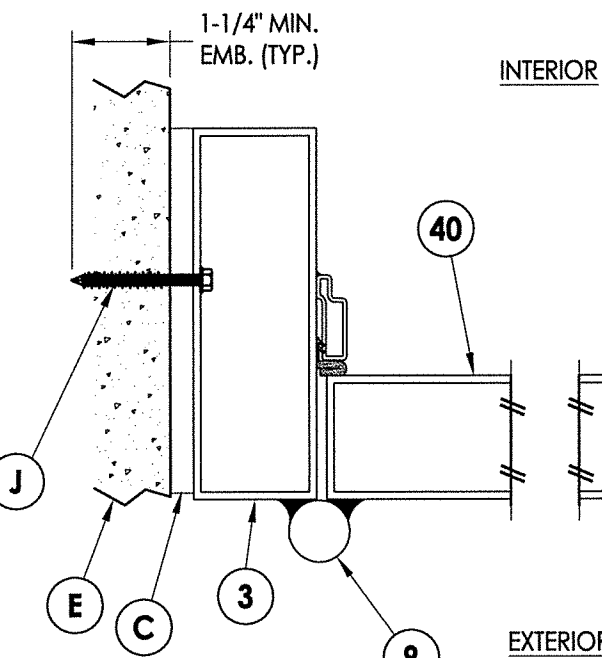
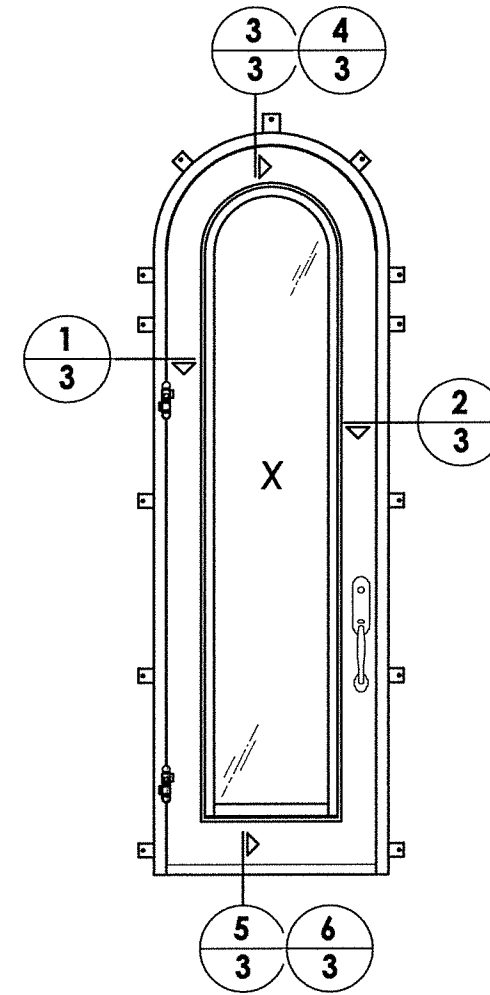

1 HORIZONTAL CROSS SECTION
3 Outswing Shown (Inswing Similar)
Direct to Masonry Anchoring

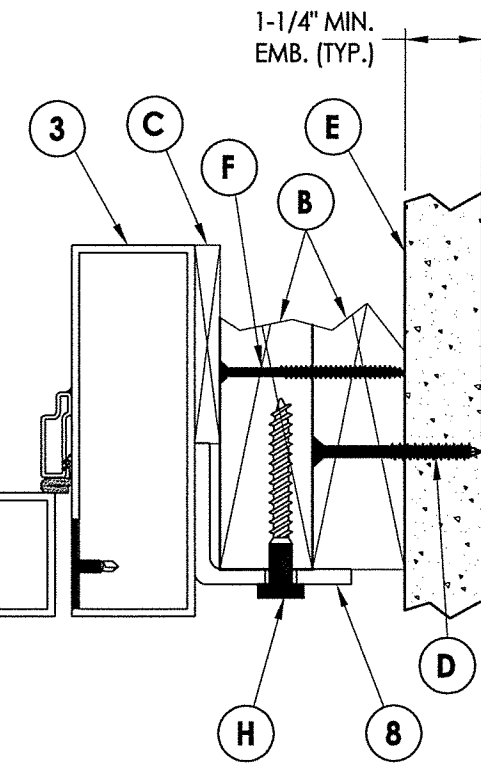

2 HORIZONTAL CROSS SECTION
3 Outswing Shown (Inswing Similar)

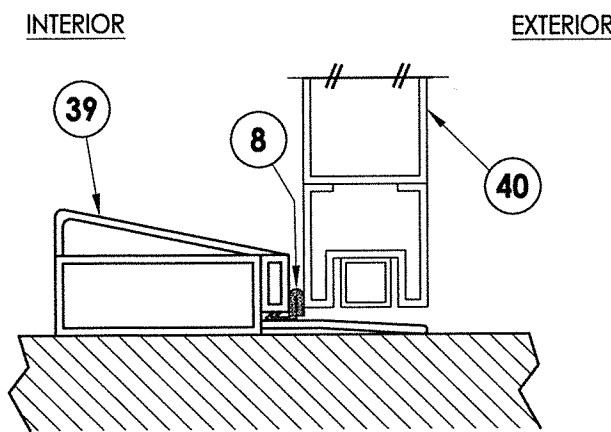

5 VERTICAL CROSS SECTION
3 Outswing

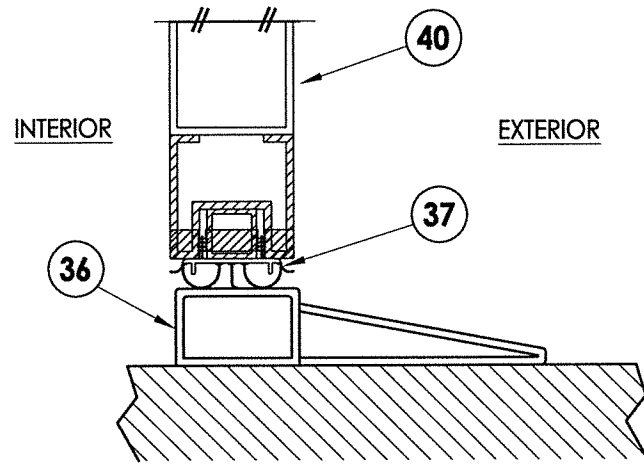

6 VERTICAL CROSS SECTION
3 Inswing

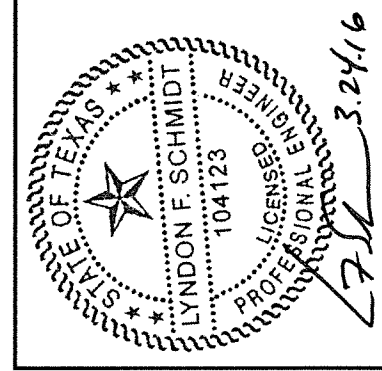

Documents Prepared By: Lyndon F. Schmidt, P.E.
TEXAS P.E. #104123

RW BUILDING CONSULTANTS, INC.
P.O. Box 230 Vairico FL. 33595
Phone No.: 813.659.9197
TEXAS BOARD OF PROFESSIONAL ENGINEERS
CERTIFICATE OF REGISTRATION # F-11852

PRODUCT: FLORIDA IRON DOORS
PART OR ASSEMBLY: HORIZONTAL AND VERTICAL CROSS SECTIONS

NO.	DATE	BY	REVISIONS

DATE: 3/23/16
SCALE: N.T.S.
DWG. BY: JK
CHK. BY: LFS
DRAWING NO.: TX-4604
SHEET 3 OF 5

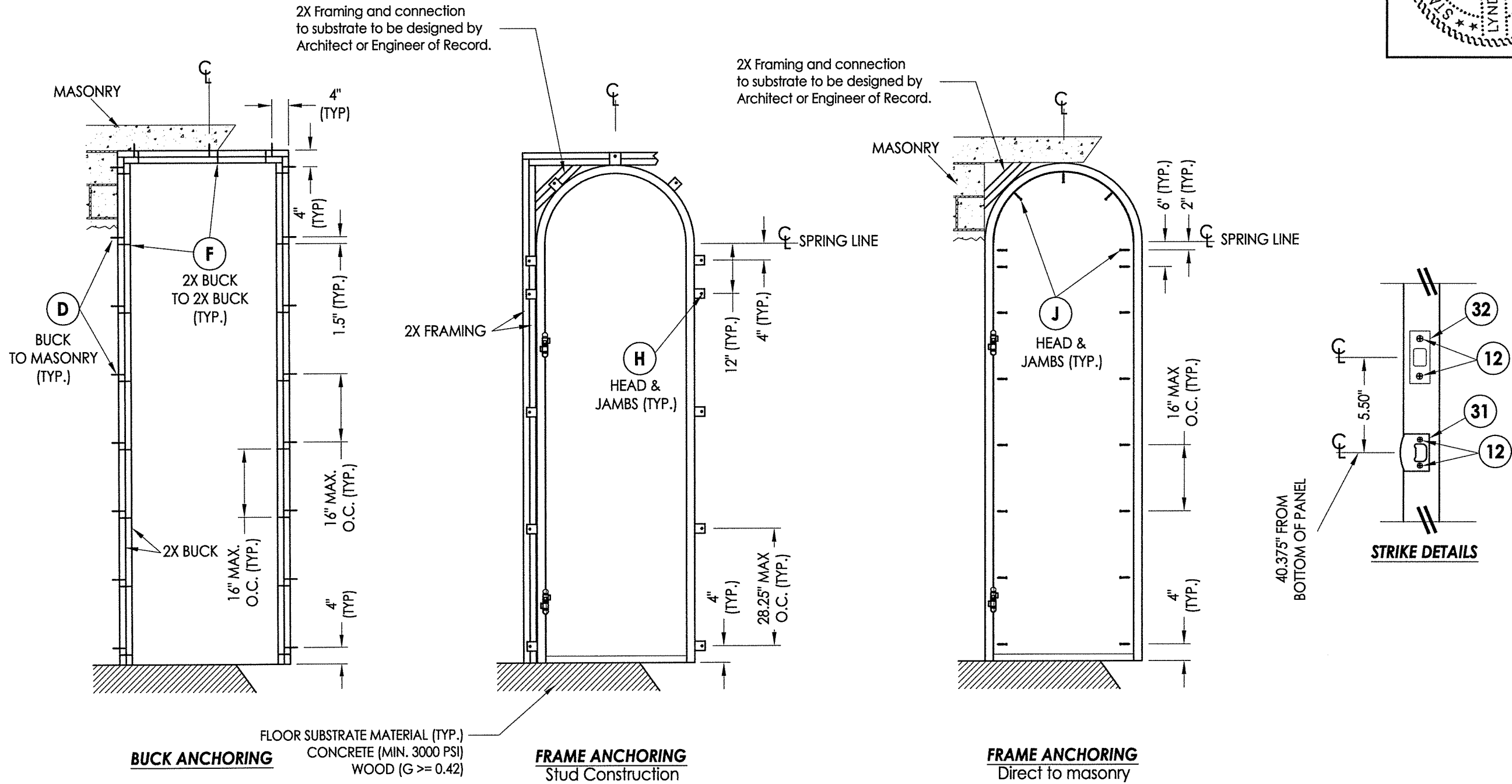

LYNDON F. SCHMIDT
 104123
 PROFESSIONAL ENGINEER
 STATE OF TEXAS

Documents Prepared By: Lyndon F. Schmidt, P.E.
 TEXAS P.E. #104123

R.W. BUILDING CONSULTANTS, INC.
 P.O. Box 230 Valrico FL 33595
 Phone No.: 813.659.9197

TEXAS BOARD OF PROFESSIONAL ENGINEERS
 CERTIFICATE OF REGISTRATION # F-11852

PRODUCT: FLORIDA IRON DOORS	
PART OR ASSEMBLY: BUCK & FRAME ANCHORING	
NO.	DATE
BY	REVISIONS
DATE: 3/23/16	
SCALE: N.T.S.	
DWG. BY: JK	
CHK. BY: LFS	
DRAWING NO.: TX-4604	
SHEET 4 OF 5	

BILL OF MATERIALS		
ITEM #	DESCRIPTION	MATERIAL
B	2X BUCK/FRAMING (SG >= 0.42)	WOOD
C	3/8" MAX. SHIM SPACE	-
D	1/4" X 2-3/4" PFH ELCO OR ITW CONCRETE SCREW	STEEL
E	MASONRY - 3,000 PSI MIN. CONCRETE CONFORMING TO ACI301 OR HOLLOW BLOCK CONFORMING TO ASTM C90	CONCRETE
F	#10 X 3" PFH WOOD SCREW (1-1/2" MIN. EMBEDMENT)	STEEL
H	3/8" X 3" HWH LAG SCREW (2-1/2" MIN. EMBEDMENT)	STEEL
J	1/4" X 2-1/4" HWH ELCO OR ITW CONCRETE SCREW (1-1/4" MIN. EMBEDMENT)	STEEL
3	FRAME	STEEL
4	GLAZING BEAD	STEEL
5	#8 X 1-1/4" PFH SELF-DRILLING SMS	STEEL
7	WEATHERSTRIP GASKET (.5")	FOAM
8	WEATHERSTRIP GASKET (.67")	FOAM
9	DOOR HINGE	STEEL
12	#8 X 3/4" PFH SELF-DRILLING SMS	STEEL
15	ANCHORING BRACKET	STEEL
31	LATCH STRIKE PLATE	STEEL
32	DEADBOLT STRIKE PLATE	STEEL
36	THRESHOLD	STEEL
37	DOOR SWEEP	-
39	THRESHOLD	STEEL
40	DOOR PANEL	STEEL

All Door Component Steel: ASTM A36

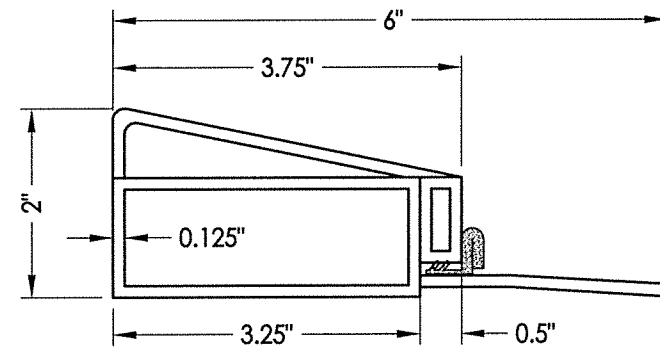

39 THRESHOLD
Outswing

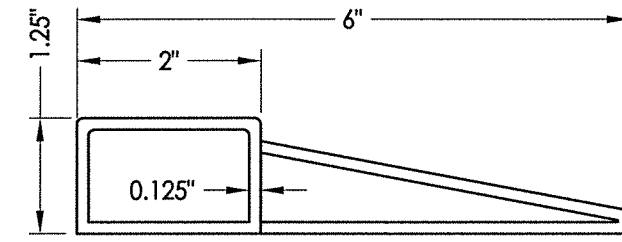

36 THRESHOLD
Inswing

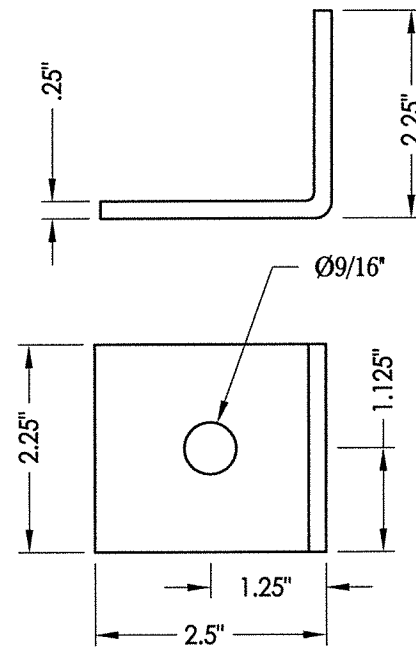

15 ANCHORING BRACKET

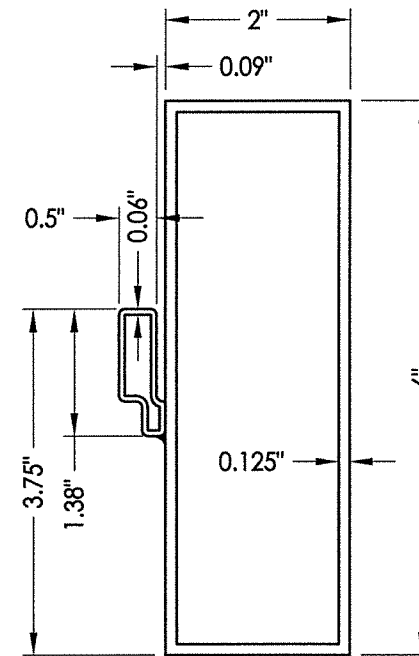

3 FRAME

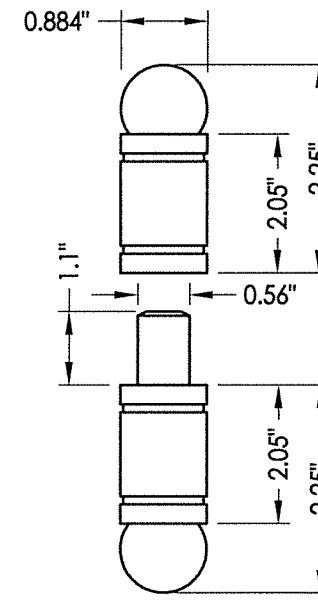

9 HINGE

CONCRETE ANCHOR NOTES:

- Concrete anchor locations at the corners may be adjusted to maintain the min. edge distance to mortar joints.
- Concrete anchor locations noted as "MAX. ON CENTER" must be adjusted to maintain the min. edge distance to mortar joints, additional concrete anchors may be required to ensure the "MAX. ON CENTER" dimension are not exceeded.
- Concrete anchor table:

ANCHOR TYPE	ANCHOR SIZE	MIN. EMBEDMENT	MIN. CLEARANCE TO MASONRY EDGE	MIN. CLEARANCE TO ADJACENT ANCHOR
ITW TAPCON®	1/4"	1-1/4"	2-1/2"	4"
ELCO ULTRACON®	1/4"	1-1/4"	2-1/2"	4"

WOOD SCREW INSTALLATION NOTES:

- WOOD SCREW INSTALLATION NOTES:
Maintain a minimum 5/8" edge distance, 1" end distance, & 1" o.c. spacing of wood screws to prevent the splitting of wood.



Documents Prepared By: Lyndon F. Schmidt, P.E.
TEXAS P.E. #104123

RW BUILDING CONSULTANTS, INC.
P.O. Box 230 Valrico FL 33595
Phone No.: 813.659.9197

TEXAS BOARD OF PROFESSIONAL ENGINEERS
CERTIFICATE OF REGISTRATION # F-11852

PRODUCT: FLORIDA IRON DOORS

PART OR ASSEMBLY: BILL OF MATERIALS & COMPONENTS

NO.	DATE	BY

DATE: 3/23/16
SCALE: N.T.S.
DWG. BY: JK
CHK. BY: LFS
DRAWING NO.: TX-4604
SHEET 5 OF 5