

THERMA-TRU[®] DOORS

Classic-Craft[®]

GLAZED FIBERGLASS DOOR IN SWING / OUT SWING "NON-IMPACT"

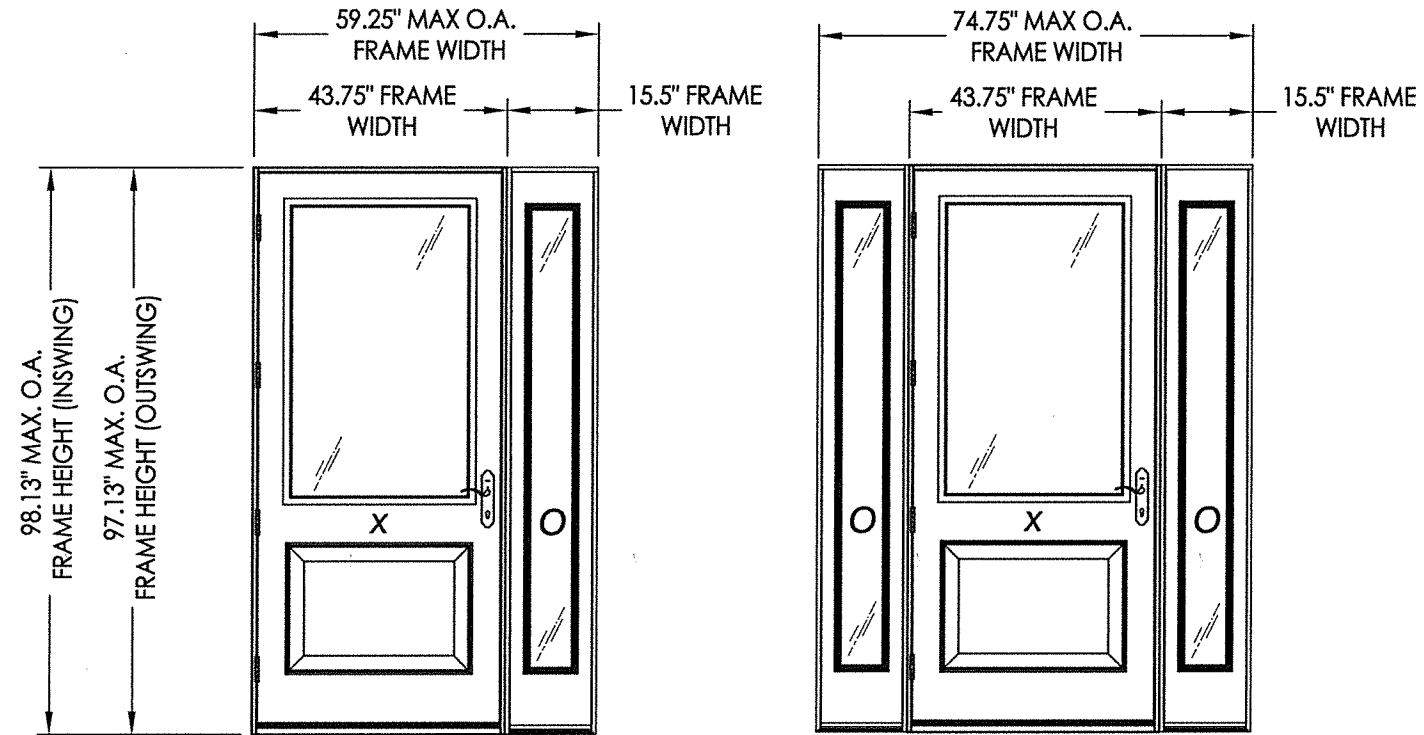

Glazed Door with Sidelites
(Boxed Construction)

CONFIGURATION	Lock Hardware	DESIGN PRESSURE (PSF) IN SWING		DESIGN PRESSURE (PSF) OUT SWING	
		POSITIVE	NEGATIVE	POSITIVE	NEGATIVE
XO, OX, OXO	Multipoint*	+55.0	-60.0	+55.0	-55.0
XO, OX, OXO	Kwikset*	+30.0	-30.0	+30.0	-30.0
XO, OX, OXO	Schlage*	+30.0	-30.0	+30.0	-30.0

*See Sheet 6 for Hardware Specifications

EVALUATED FOR USE IN THE STATE OF TEXAS

The Fiberglass Door system described herein complies with the 2018 International Residential Code (IRC), Sections R301 & R609 and the 2018 International Building Code (IBC), Sections 1404.13, 1609, 1709.5, 2403 and 2404 subject to the following conditions:

1. Anchors shall be as listed and spaced as shown in the details. Anchor embedment to base material shall be beyond wall dressing or stucco.
2. When used in areas requiring wind-borne debris protection, this system is required to be protected with an impact resistant covering that complies with Section R301.2.1.2 of the IRC and Section 1609.2 of the IBC.
3. Allowable design pressure requirements must be equal to or less than the design pressure rating shown in the design pressure chart, sheet 1 of this drawing.
4. Conditions not covered by this drawing are subject to further engineering analysis.

TABLE OF CONTENTS

SHEET#	DESCRIPTION
1	Typical Elevations, Design Pressures & General Notes
2	Door Panel Details (Lite Frame Glazing)
3	Door Panel Flush Glazing Details
4	Lite Frame Glazing Details
5	Sidelite Panel Details
6	Elevations
7	Horizontal & Vertical Cross Sections
8	Vertical Cross Sections (Thresholds)
9	Frame Anchoring & Hardware Details
10	Components
11	Bill of Materials

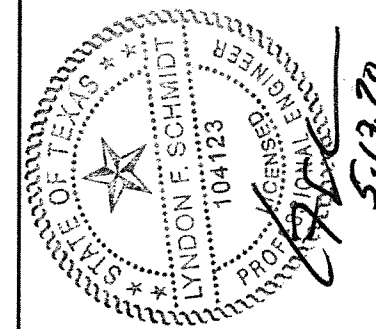

Documents Prepared By: Lyndon F. Schmidt, P.E.
TEXAS P.E. #104123

RW BUILDING CONSULTANTS, INC.
P.O. Box 230 Valrico FL 33595
Phone No.: 813.659.9197

TEXAS BOARD OF PROFESSIONAL ENGINEERS
CERTIFICATE OF REGISTRATION # F-11852

PRODUCT: THERMA-TRU
FIBERGLASS DOOR
PART OR ASSEMBLY:
TYPICAL ELEVATION, DESIGN
PRESSURES & GENERAL NOTES

NO.	DATE	DESCRIPTION	BY
1	5/12/20	UPDATE TO 2018 IBC/IRC CODE	LFS
		REVISIONS	

DATE: 2/10/16
SCALE: N.T.S.
DWG. BY: JK
CHK. BY: LFS
DRAWING NO.: TX-4603
SHEET 1 OF 11

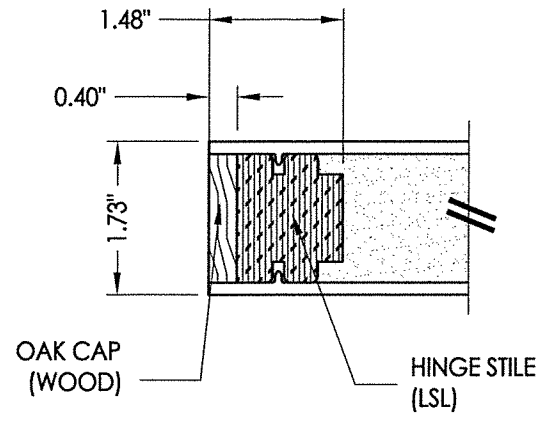

1
2 HORIZONTAL CROSS SECTION

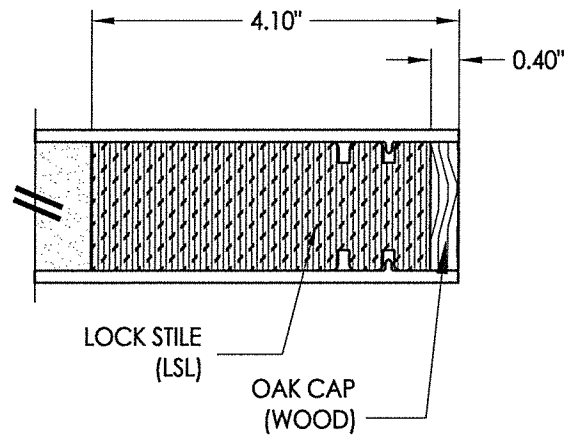

2
2 HORIZONTAL CROSS SECTION

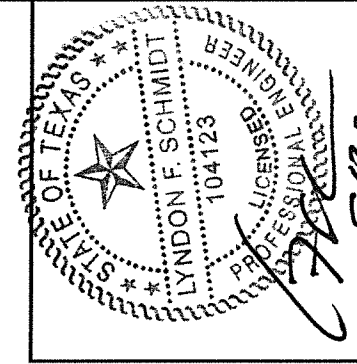
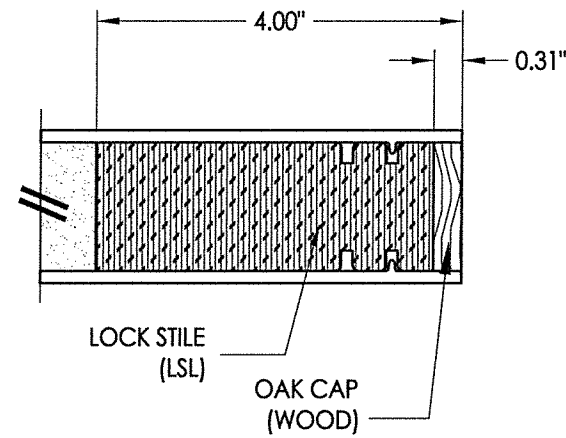
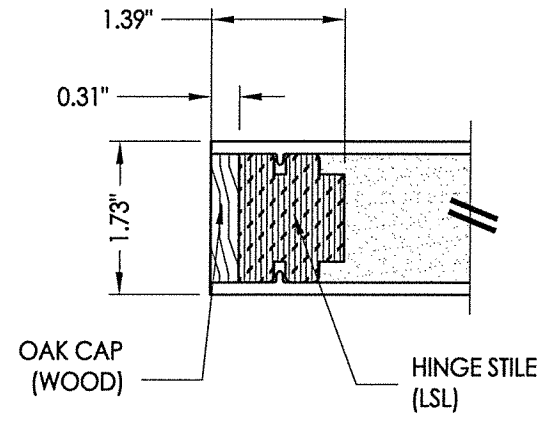

Documents Prepared By: Lyndon F. Schmidt, P.E.
TEXAS P.E. # 104123

R.W. BUILDING CONSULTANTS, INC.
P.O. Box 230 Valrico FL 33595
Phone No.: 813.659.9197
TEXAS BOARD OF PROFESSIONAL ENGINEERS
CERTIFICATE OF REGISTRATION # F-11852

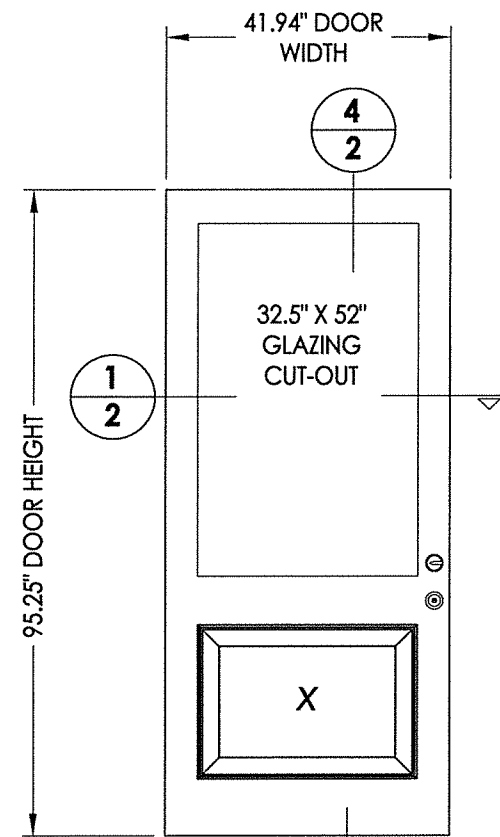

40 DOOR PANEL
Book Door

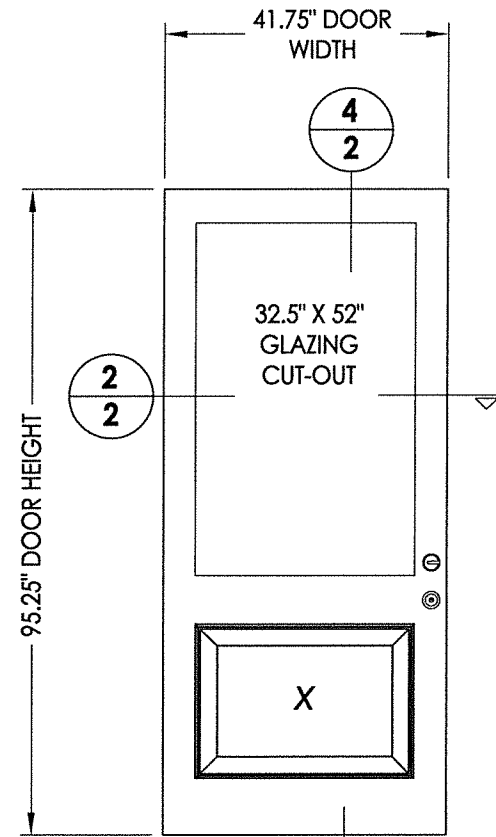

41 DOOR PANEL
Hybrid Door

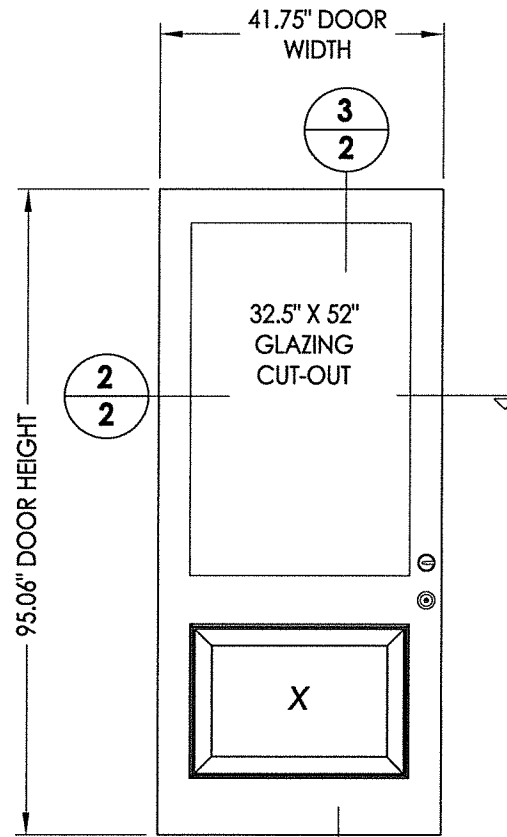

42 DOOR PANEL
U1 Door

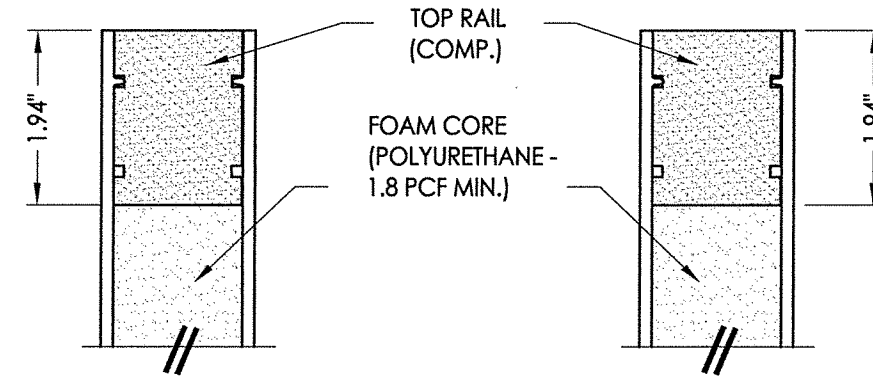

3
2 VERTICAL CROSS SECTION

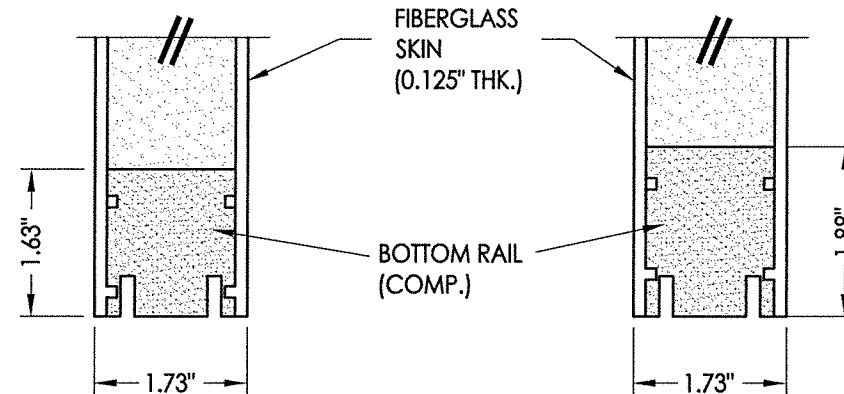

4
2 VERTICAL CROSS SECTION

PRODUCT:	Therma-TRU FIBERGLASS DOOR
PART OR ASSEMBLY:	DOOR PANEL DETAILS (LITE FRAME GLAZING)

NO.	DATE	DESCRIPTION	BY
1	5/12/20	UPDATE TO 2018 IBC/IRC CODE	LFS

DATE:	2/10/16
SCALE:	N.T.S.
DWG. BY:	JK
CHK. BY:	LFS
DRAWING NO.:	TX-4603
SHEET	2 OF 11

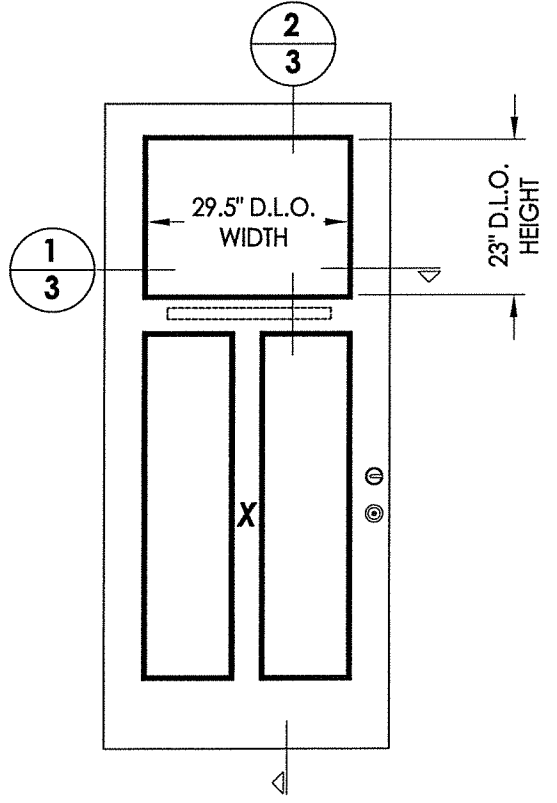
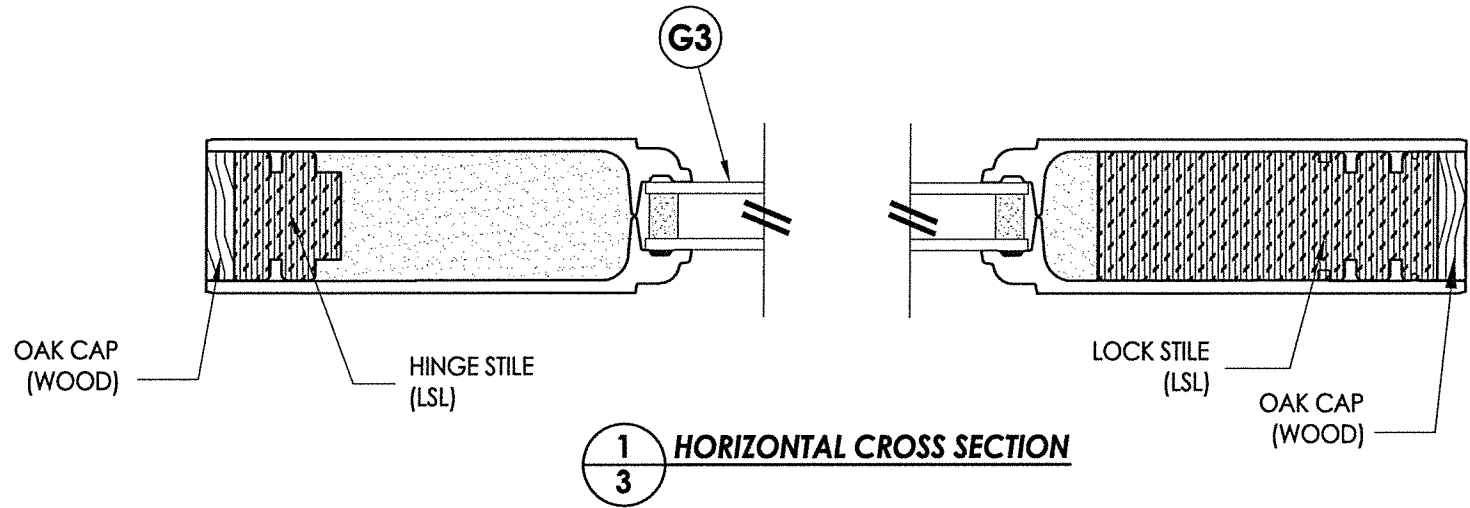

FLUSH GLAZED DOOR PANEL
SEE SHEET 2 FOR PANEL DETAILS

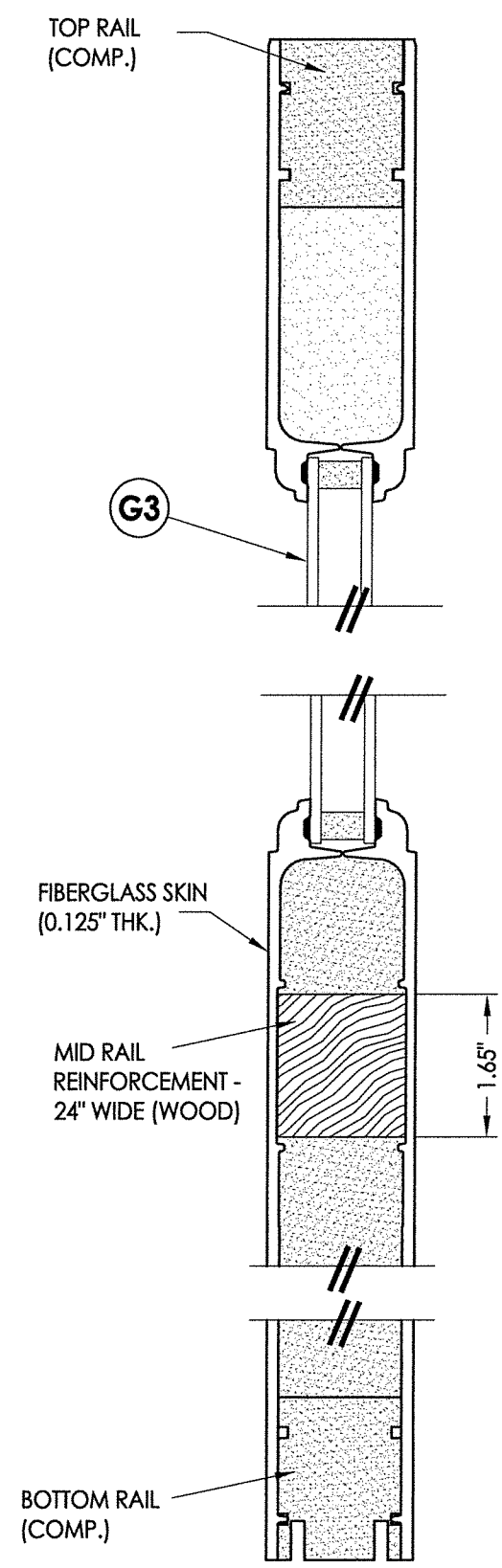
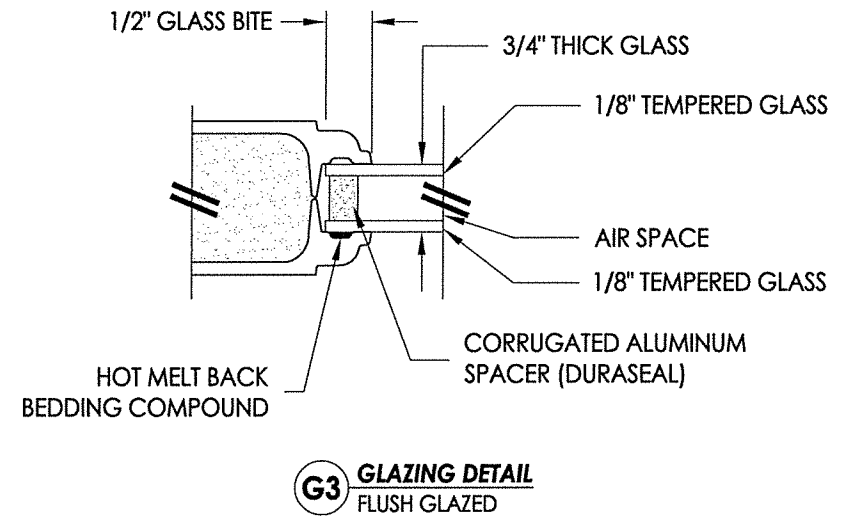

Documents Prepared By: Lyndon F. Schmidt, P.E.
TEXAS P.E. #104123

RW BUILDING CONSULTANTS, INC.
P.O. Box 230 Valrico FL 33595
Phone No.: 813.659.9197

TEXAS BOARD OF PROFESSIONAL ENGINEERS
CERTIFICATE OF REGISTRATION # F-11852

PRODUCT: THERMA-TRU FIBERGLASS DOOR

PART OR ASSEMBLY: DOOR PANEL FLUSH GLAZING DETAILS

NO.	DATE	DESCRIPTION	BY
1	5/12/20	UPDATE TO 2018 IBC/IRC CODE	LFS

DATE: 2/10/16
SCALE: N.T.S.
DWG. BY: JK
CHK. BY: LFS
DRAWING NO.: TX-4603
SHEET 3 OF 11

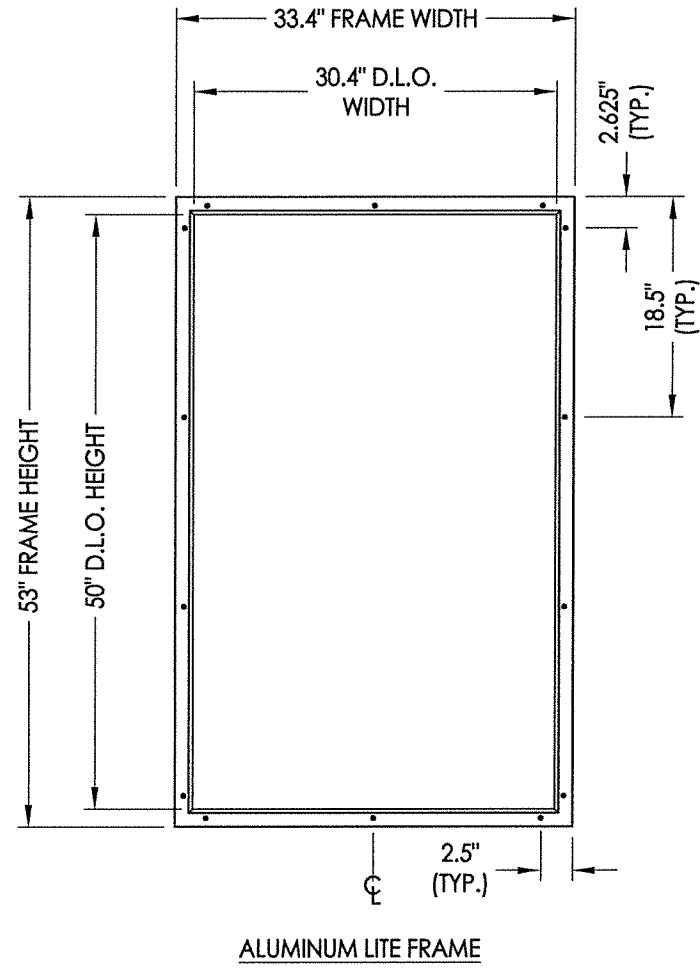

ALUMINUM LITE FRAME

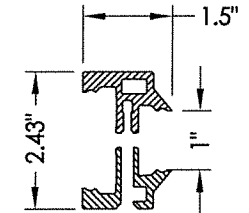

ALUMINUM LITE FRAME

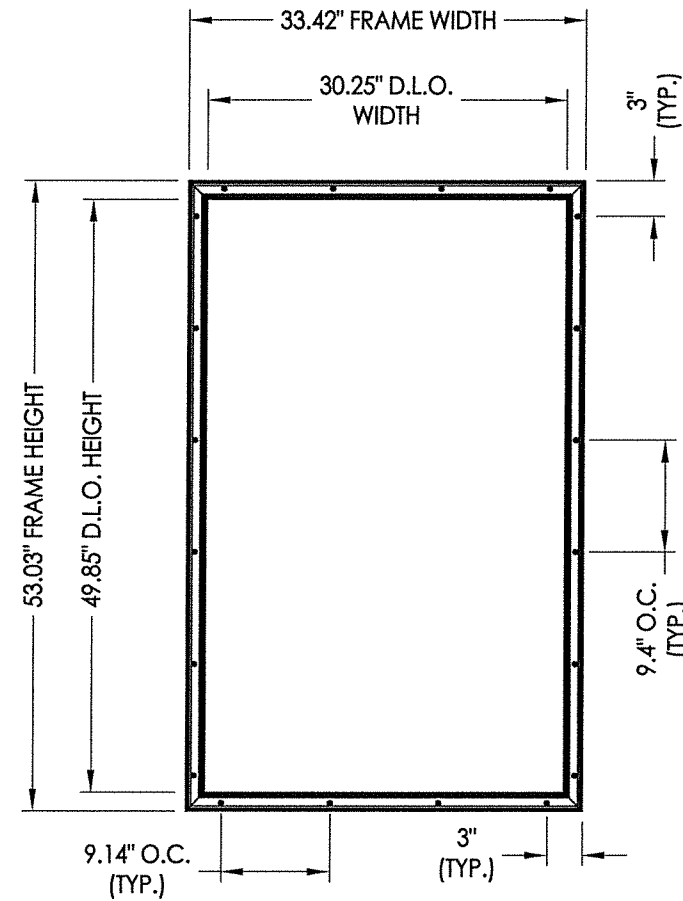

SMC LITE FRAME

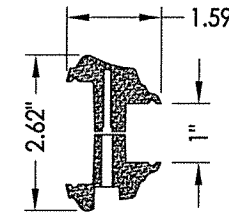

SMC LITE FRAME

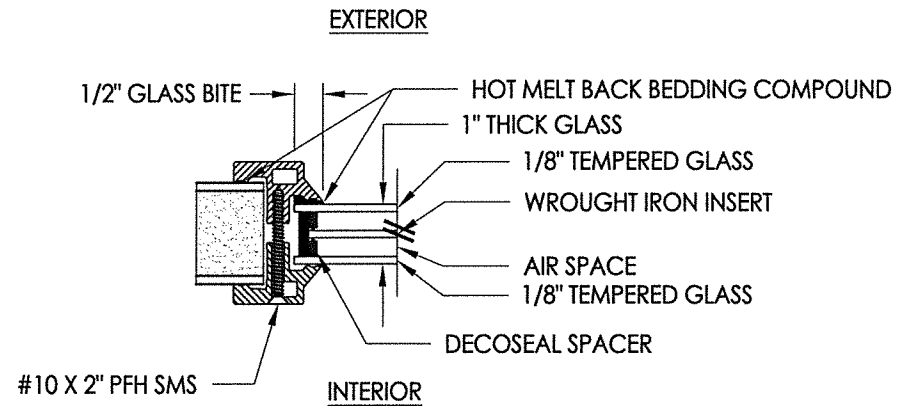

G1 GLAZING DETAIL

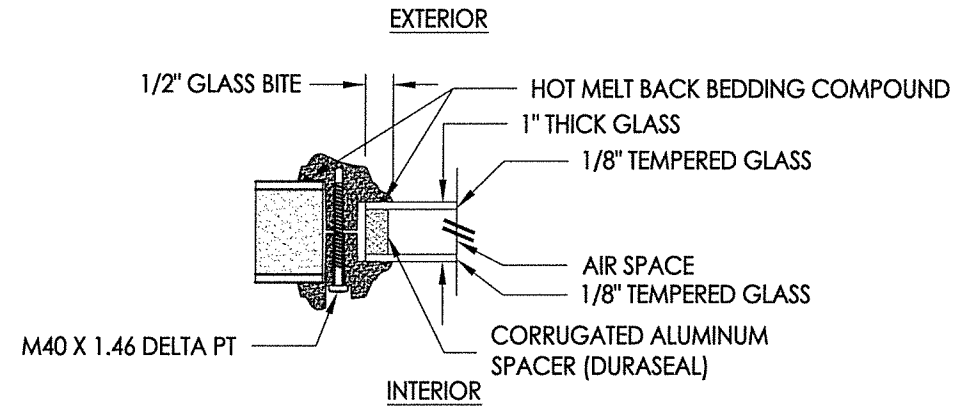

G2 GLAZING DETAIL

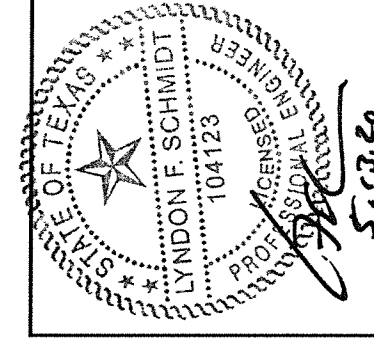

Documents Prepared By: Lyndon F. Schmidt, P.E.
TEXAS P.E. #104123

RW BUILDING CONSULTANTS, INC.
P.O. Box 230 Vairico FL, 33595
Phone No.: 813.659.9197

TEXAS BOARD OF PROFESSIONAL ENGINEERS
CERTIFICATE OF REGISTRATION # F-11852

PRODUCT: THERMA-TRU FIBERGLASS DOOR

PART OR ASSEMBLY: LITE FRAME GLAZING DETAILS

NO.	DATE	DESCRIPTION	BY
1	5/12/20	UPDATE TO 2018 IBC/IRC CODE	LFS

DATE: 2/10/16

SCALE: N.T.S.

DWG. BY: JK

CHK. BY: LFS

DRAWING NO.: TX-4603

SHEET 4 OF 11

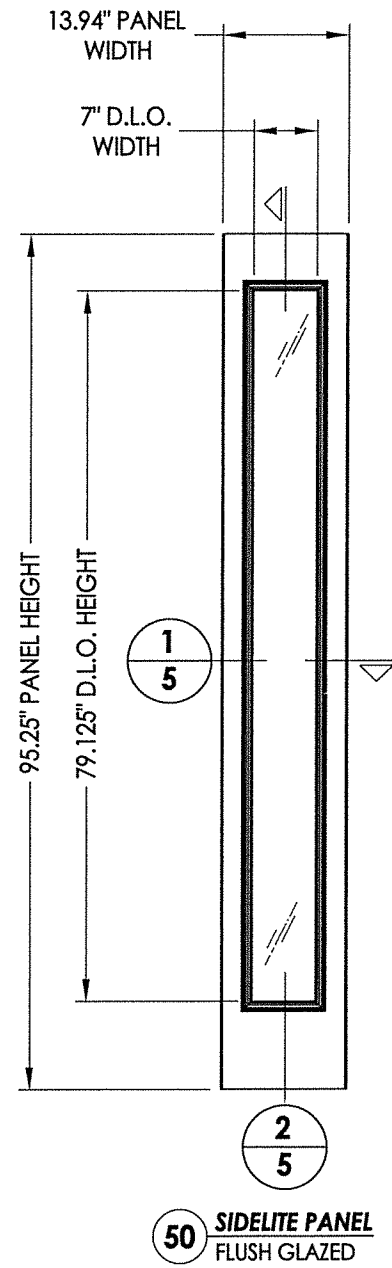

50 SIDELITE PANEL
FLUSH GLAZED

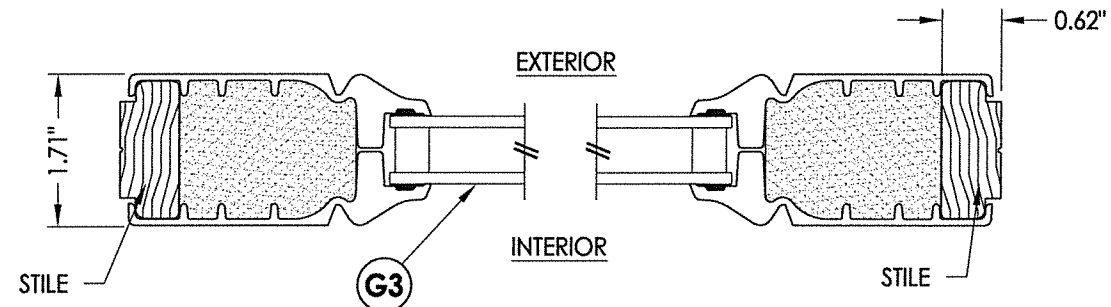

1
5 HORIZONTAL CROSS SECTION

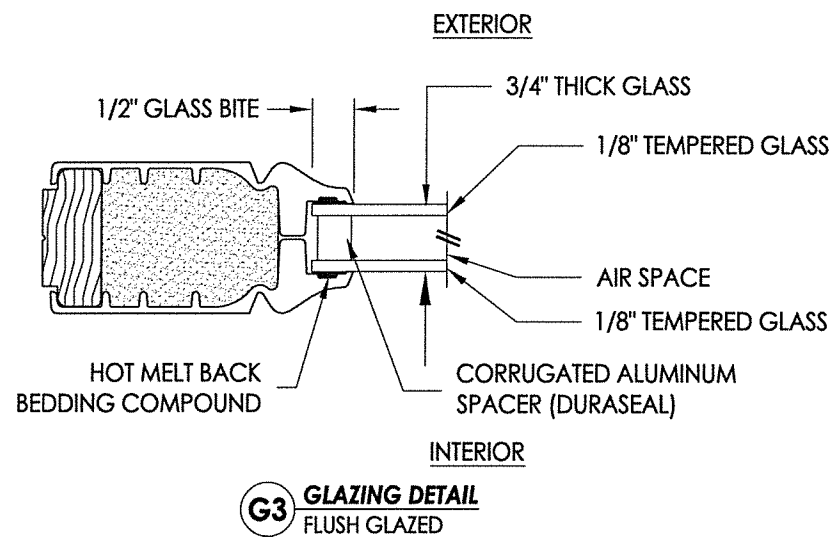

G3 GLAZING DETAIL
FLUSH GLAZED

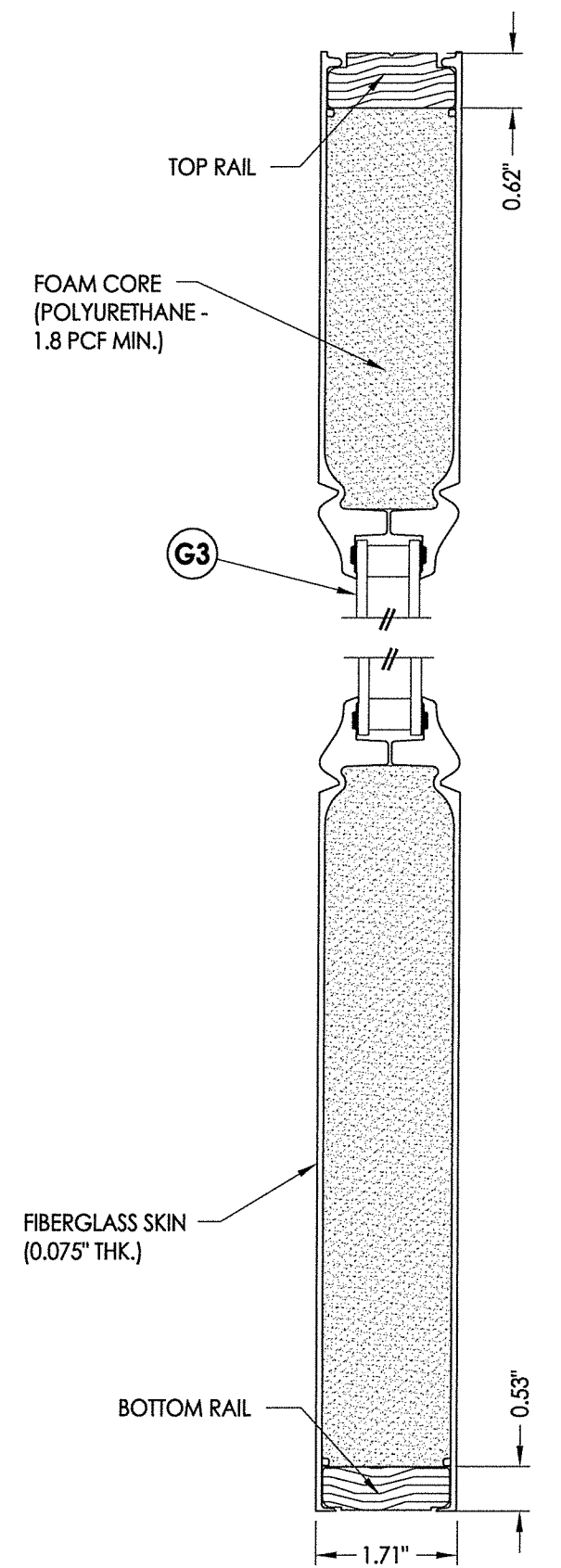

2
5 VERTICAL CROSS SECTION

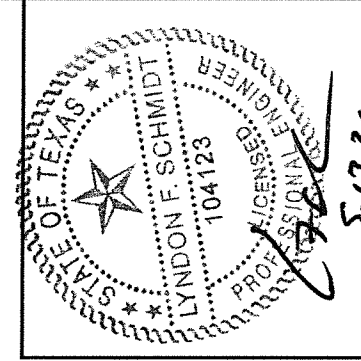

Documents Prepared By: Lyndon F. Schmidt, P.E.
TEXAS P.E. #104123

RW BUILDING CONSULTANTS, INC.
P.O. Box 230 Valrico FL 33595
Phone No.: 813.659.9197

TEXAS BOARD OF PROFESSIONAL ENGINEERS
CERTIFICATE OF REGISTRATION # F-11852

PRODUCT: THERMA-TRU
FIBERGLASS DOOR

PART OR ASSEMBLY:
SIDELITE PANEL
DETAILS

REVISIONS	
NO.	DATE
1	5/12/20
	UPDATE TO 2018 IBC/IRC CODE
	LFS
	BY

DATE: 2/10/16
SCALE: N.T.S.
DWG. BY: JK
CHK. BY: LFS
DRAWING NO.: TX-4603
SHEET 5 OF 11

R:\Clients\Therma Tru PERMANENT\B - Texas Dept of Ins\TDI - DR 785 - 8-0 Glazed Classic Craft Non-Impact\C - Drawings\TX-4602.03.dwg, 7.2

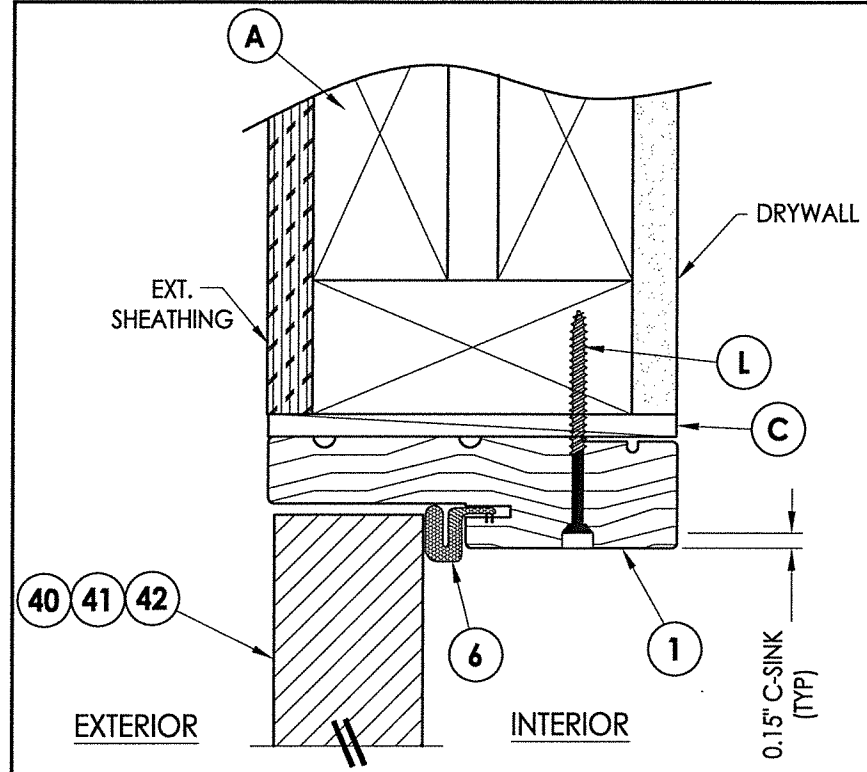

1 VERTICAL CROSS SECTION
7 Outswing shown (Inswing similar)

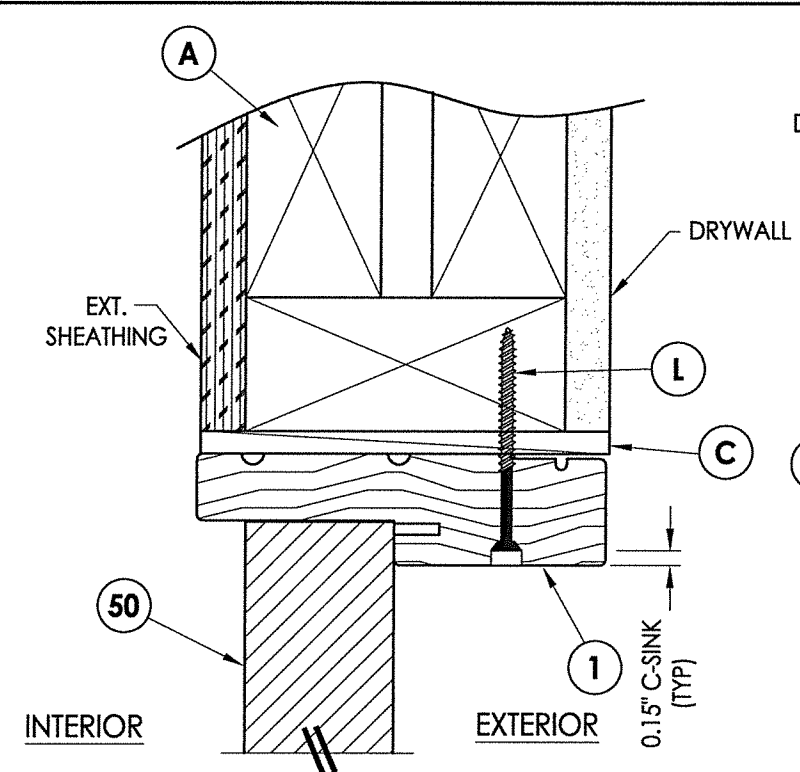

2 VERTICAL CROSS SECTION
7 Outswing shown (Inswing similar)

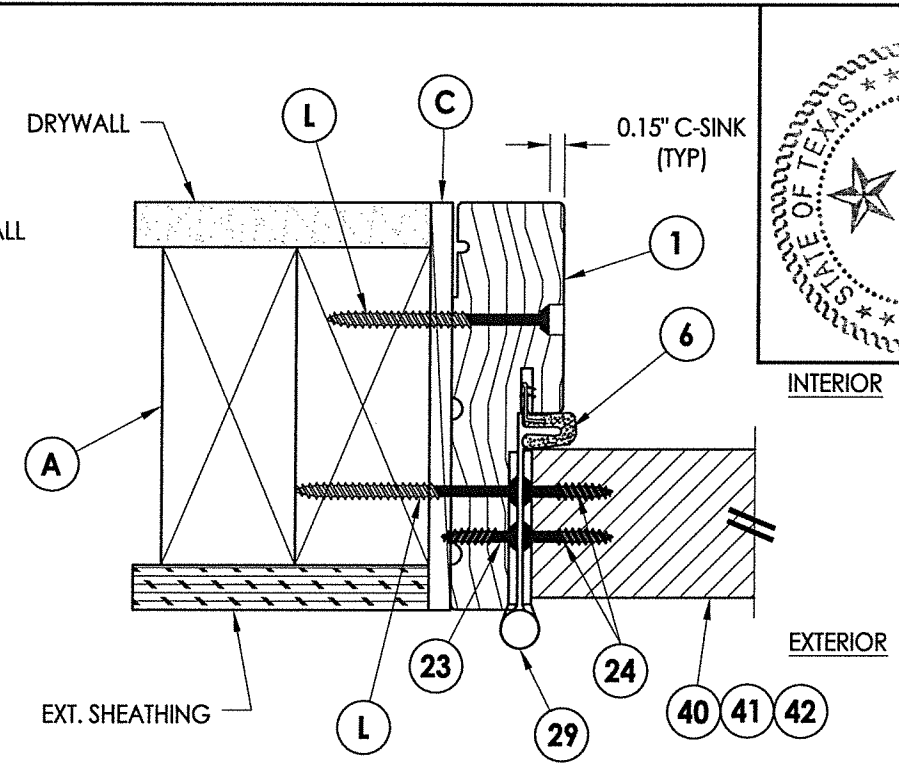

3 HORIZONTAL CROSS SECTION
7 Outswing shown (Inswing similar)

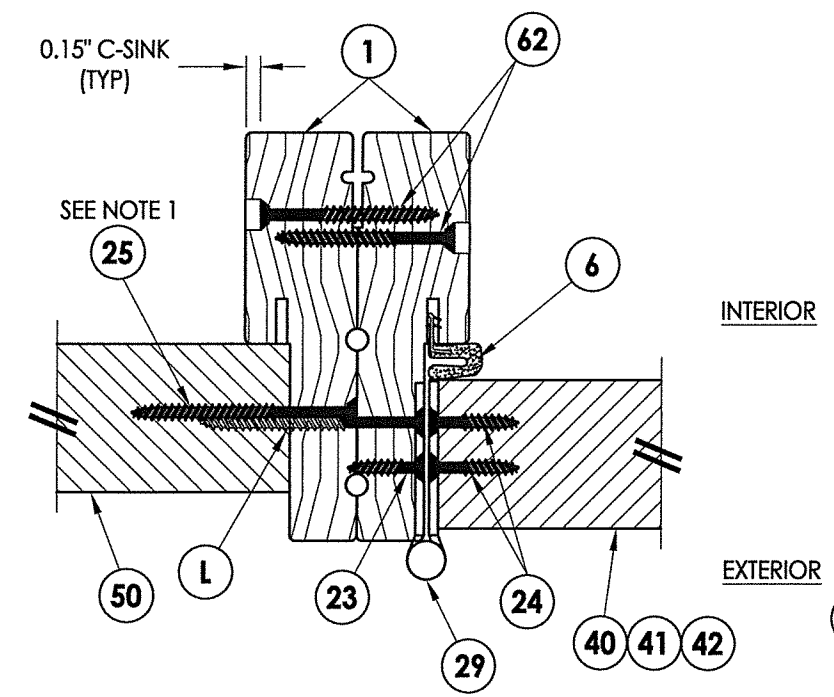

4 HORIZONTAL CROSS SECTION
7 Outswing shown (Inswing similar)

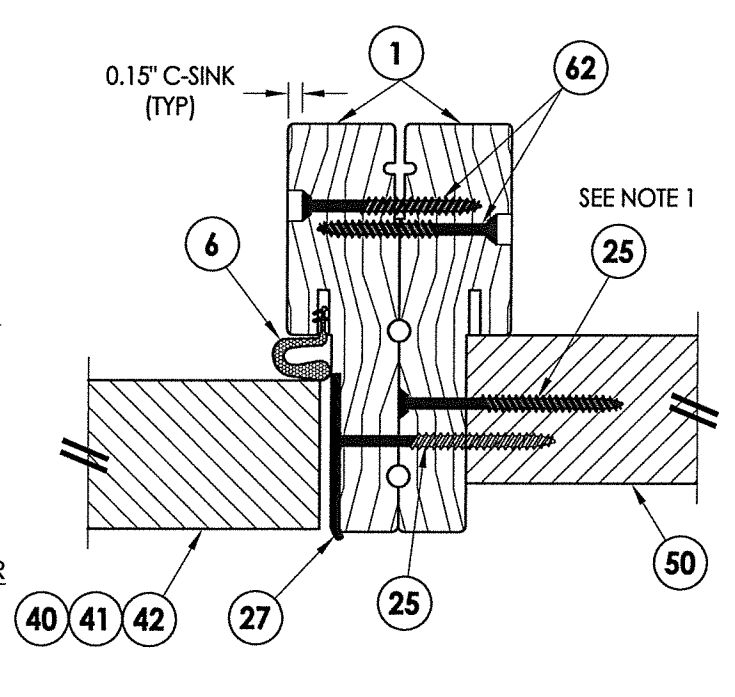

5 HORIZONTAL CROSS SECTION
7 Outswing shown (Inswing similar)

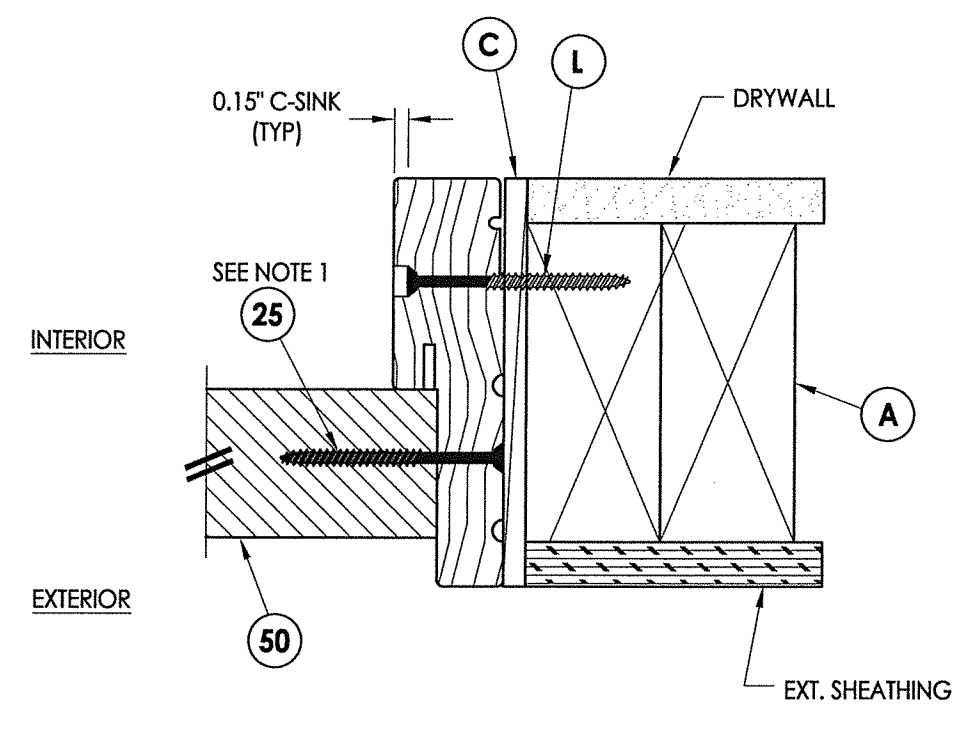

6 HORIZONTAL CROSS SECTION
7 Outswing shown (Inswing similar)

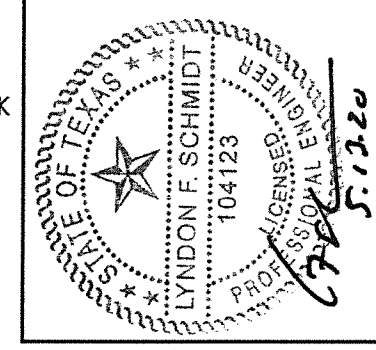

Documents Prepared By: Lyndon F. Schmidt, P.E.
 TEXAS P.E. #104123

R.W. BUILDING CONSULTANTS, INC.
 P.O. Box 230 Valrico FL 33595
 Phone No.: 813.659.9197

TEXAS BOARD OF PROFESSIONAL ENGINEERS
 CERTIFICATE OF REGISTRATION # F-11852

PRODUCT: THERMA-TRU
 FIBERGLASS DOOR

PART OR ASSEMBLY:
 HORIZONTAL & VERTICAL
 CROSS SECTIONS

NO.	DATE	DESCRIPTION	BY
1	5/12/20	UPDATE TO 2018 IBC/IRC CODE	LFS

DATE: 2/10/16
 SCALE: N.T.S.
 DWG. BY: JK
 CHK. BY: LFS
 DRAWING NO.: TX-4603
 SHEET 7 OF 11

© 2016 R.W. BUILDING CONSULTANTS INC.

R:\Clients\Therma Tru PERMANENT\B - Texas Dept of Ins\TDI - DR 785 - 8-0 Glazed Classic Craft Non-Impact\C - Drawings\TX-4602.03.dwg, 8.2

Note:

- 1. Sill Item #'s 13, 16, 17, 19 & 20 are attached to jambs w/ (3) #8 X 2-1/2" pfh screws at each end.
- Sill Item #'s 14 & 15 are attached to jambs w/ (2) #8 X 2-1/2" pfh screws at each end.
- Sill Item # 18 is attached to jambs utilizing (4) #10 X 1-1/2" pph screws at each end.

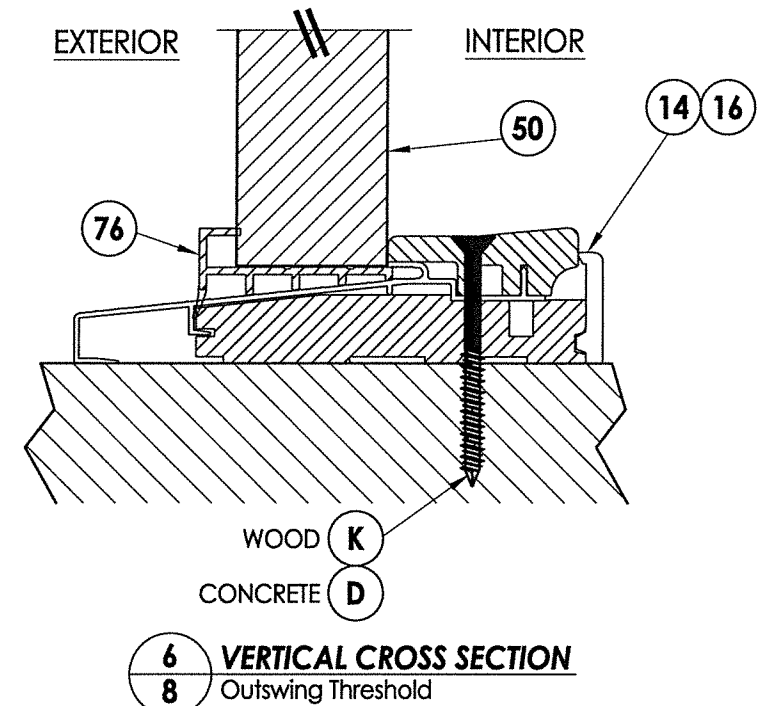
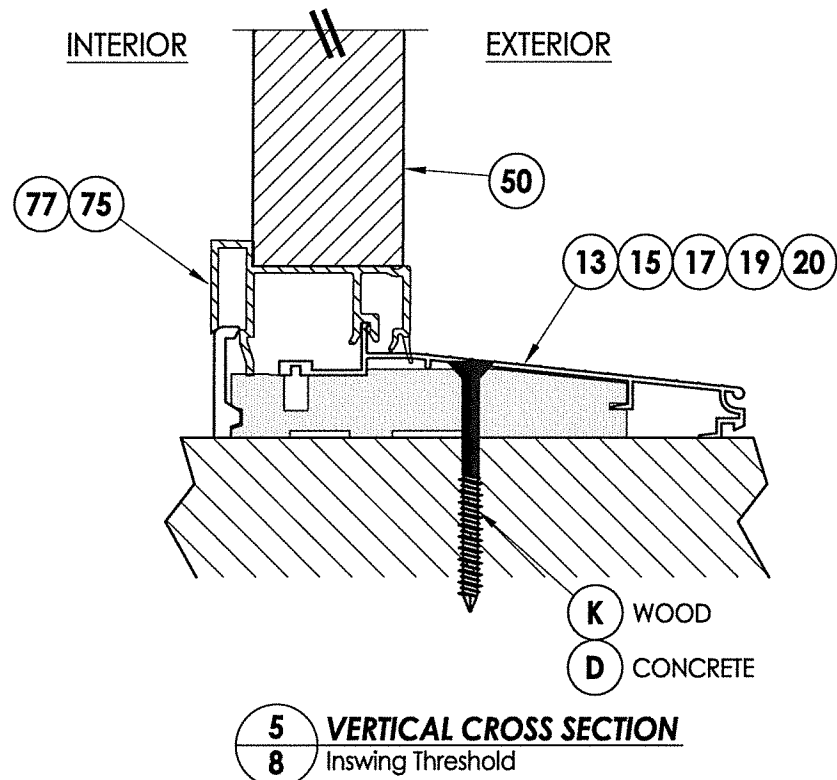
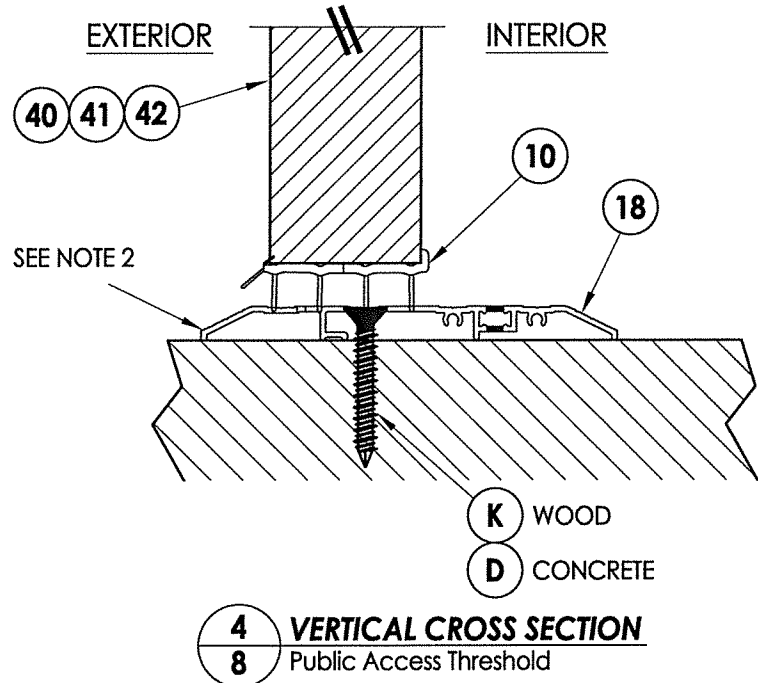
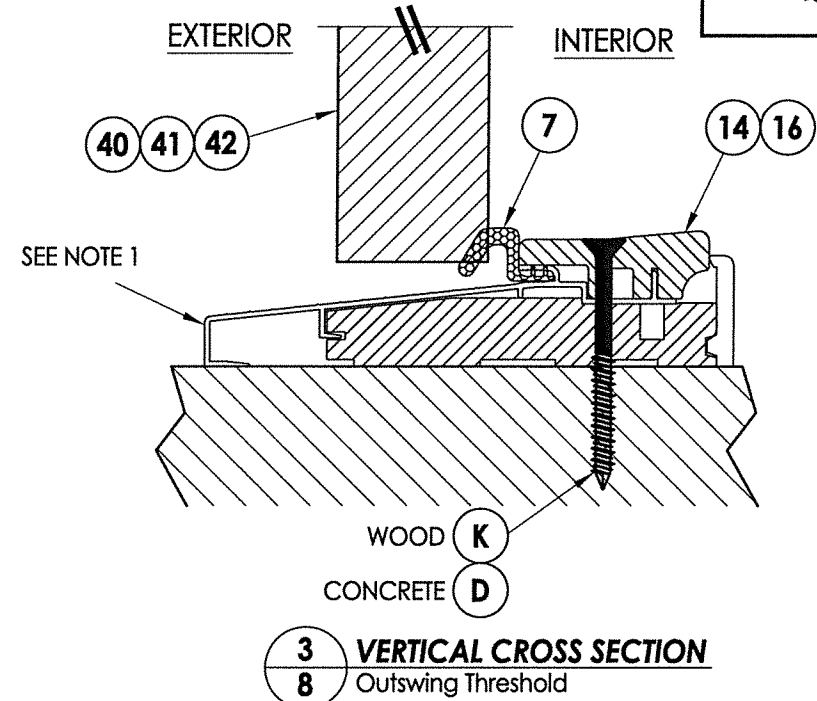
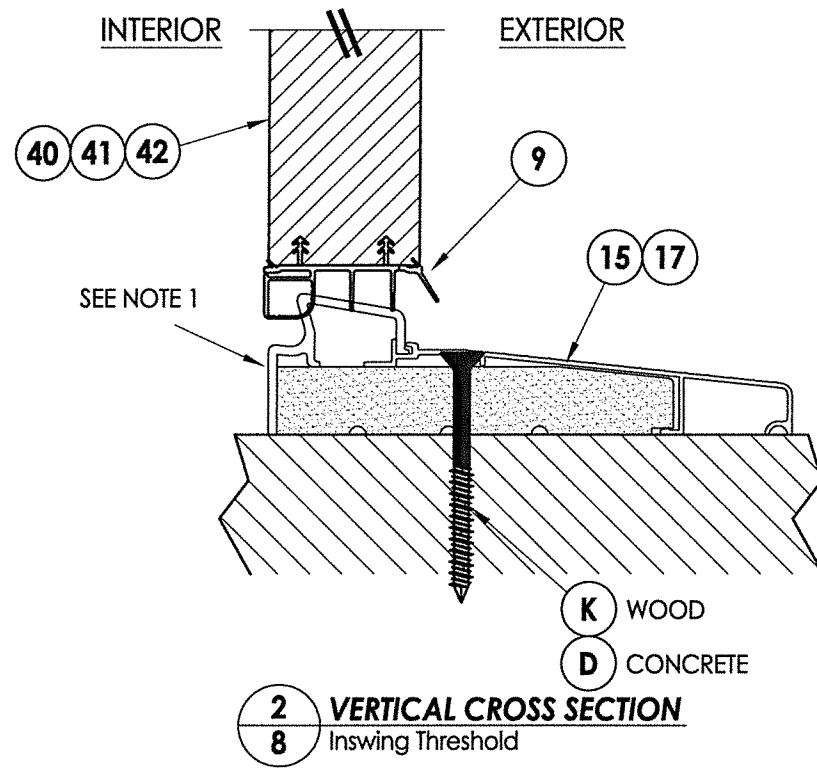
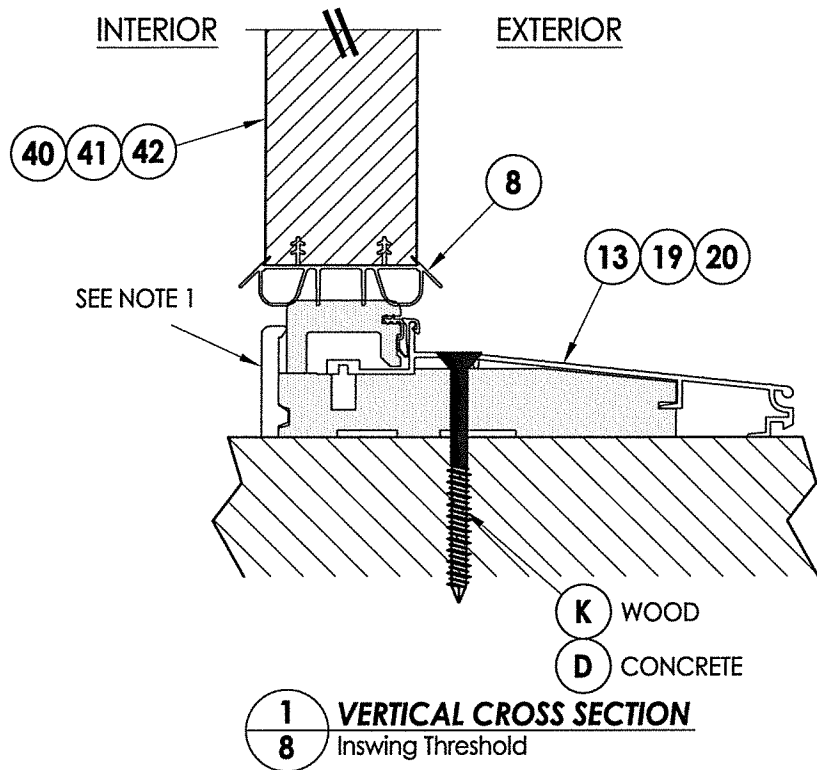
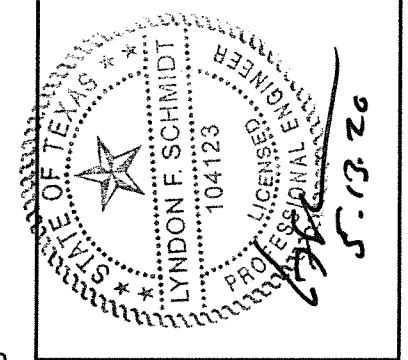

Documents Prepared By: Lyndon F. Schmidt, P.E.
TEXAS P.E. #104123

RW BUILDING CONSULTANTS, INC.
P.O. Box 230 Valrico FL 33595
Phone No.: 813.659.9197
TEXAS BOARD OF PROFESSIONAL ENGINEERS
CERTIFICATE OF REGISTRATION # F-11852

PRODUCT: THERMA-TRU FIBERGLASS DOOR	
PART OR ASSEMBLY: VERTICAL CROSS SECTIONS (THRESHOLDS)	
NO.	DATE
1	5/12/20
UPDATE TO 2018 IBC/IRC CODE	
LFS	BY
REVISIONS	
DATE: 2/10/16	
SCALE: N.T.S.	
DWG. BY: JK	
CHK. BY: LFS	
DRAWING NO.: TX-4603	
SHEET 8 OF 11	

© 2016 R.W. BUILDING CONSULTANTS INC.

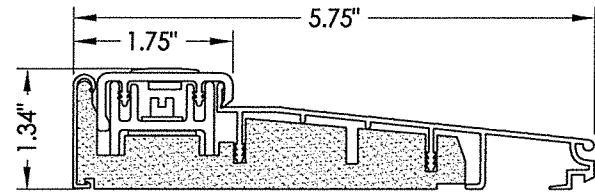

13 INSWING THRESHOLD
Adjustable

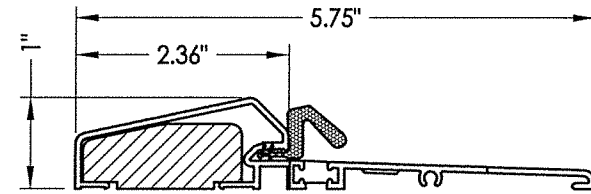

14 OUTSWING THRESHOLD

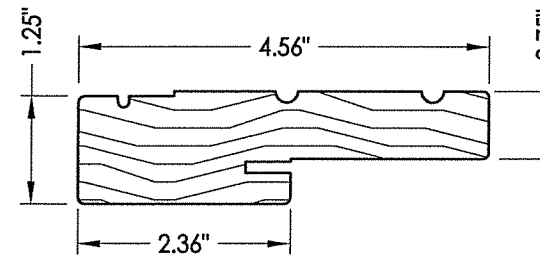

1 WOOD JAMB

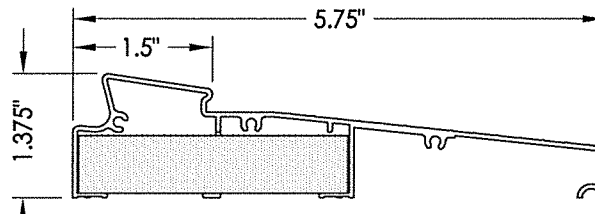

15 INSWING THRESHOLD
Moderate Climate

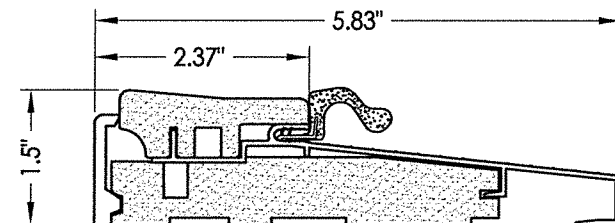

16 OUTSWING THRESHOLD

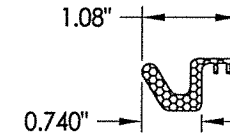

6 WEATHERSTRIP
Medium Reach

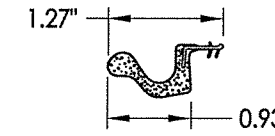

7 WEATHERSTRIP
Long Reach

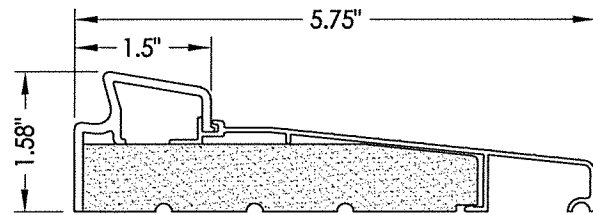

17 INSWING THRESHOLD
Basic Fixed

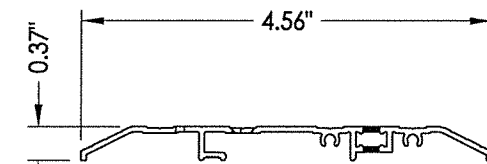

18 PUBLIC ACCESS THRESHOLD

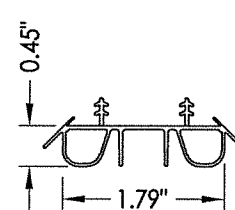

8 SWEEP

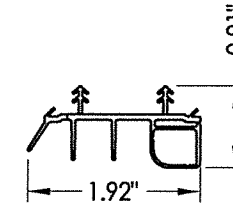

9 SWEEP

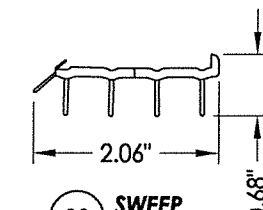

10 SWEEP

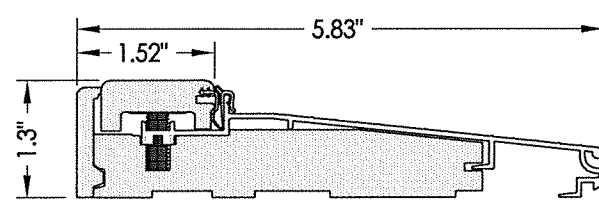

19 INSWING THRESHOLD
Adjustable

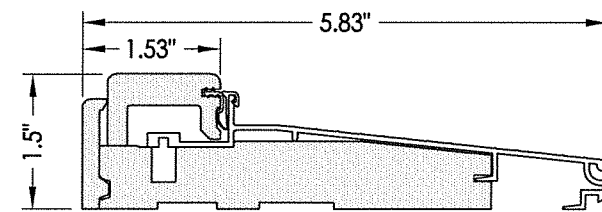

20 INSWING THRESHOLD
Adjustable

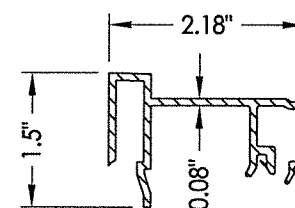

75 SIDELITE SPACER
Inswing

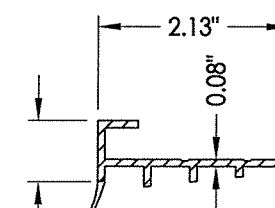

76 SIDELITE SPACER
Outswing

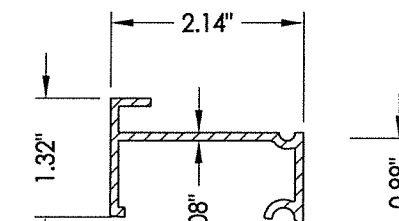

77 INSWING SIDELITE
Adapter
Moderate Climate Threshold

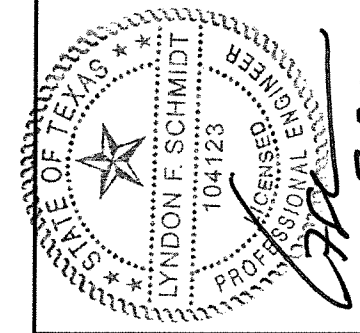

Documents Prepared By: Lyndon F. Schmidt, P.E.
TEXAS P.E. #104123

RW BUILDING CONSULTANTS, INC.
P.O. Box 230 Valrico FL 33595
Phone No.: 813.659.9197

TEXAS BOARD OF PROFESSIONAL ENGINEERS
CERTIFICATE OF REGISTRATION # F-11852

PRODUCT:		THERMA-TRU FIBERGLASS DOOR	
PART OR ASSEMBLY:		COMPONENTS	
NO.	DATE	UPDATE TO 2018 IBC/IRC CODE	BY
1	5/12/20		LFS
REVISIONS			
DATE: 2/10/16			
SCALE: N.T.S.			
DWG. BY: JK			
CHK. BY: LFS			
DRAWING NO.: TX-4603			
SHEET 10 OF 11			

BILL OF MATERIALS		
ITEM #	DESCRIPTION	MATERIAL
A	1X FRAMING (SG >= 0.42)	WOOD
C	1/4" MAX. SHIM SPACE	-
D	1/4" PFH ELCO OR ITW CONCRETE SCREW (1-3/4" MIN. EMBEDMENT)	STEEL
L	#10 X 2-1/2" PFH WOOD SCREW (1.15" MIN. EMBEDMENT)	STEEL
1	JAMB (FINGER JOINT PINE)	WOOD
6	WEATHERSTRIP (Medium Reach)	FOAM
7	WEATHERSTRIP (Long Reach)	FOAM
8	SWEEP	VINYL
9	SWEEP (Use w/ Moderate Climate Threshold)	VINYL
10	SWEEP (Use w/ Public Access Threshold)	VINYL
13	INSWING THRESHOLD	ALUM/COMP
14	OUTSWING THRESHOLD	ALUM/COMP
15	INSWING THRESHOLD	ALUM/COMP
16	OUTSWING THRESHOLD	ALUM/COMP
17	INSWING THRESHOLD	ALUM/COMP
18	PUBLIC ACCESS THRESHOLD	ALUM
19	INSWING THRESHOLD	ALUM/COMP
20	INSWING THRESHOLD	ALUM/COMP
23	#10 x 3/4" PFH WOOD SCREW	STEEL
24	#10 x 1" PFH WOOD SCREW	STEEL
25	#8 x 2-1/2" PFH WOOD SCREW	STEEL
27	LATCH STRIKE PLATE	STEEL
28	DEADBOLT STRIKE PLATE	STEEL
29	4" X 4" HINGE	STEEL
34	MULTIPOINT LATCH & DEADBOLT STRIKE PLATE	STEEL
37	MULTIPOINT TONGUE STRIKE PLATE	STEEL
40	DOOR PANEL (BOOK DOOR)	-
41	DOOR PANEL (HYBRID DOOR)	-
42	DOOR PANEL (U1 DOOR)	-
50	14" SIDELITE PANEL (FLUSH GLAZED)	-
62	#10 X 2" PFH WOOD SCREW	STEEL
75	SIDELITE SPACER (INSWING)	PVC
76	SIDELITE SPACER (OUTSWING)	PVC
77	SIDELITE SPACER (INSWING) - Moderate Climate Threshold	PVC

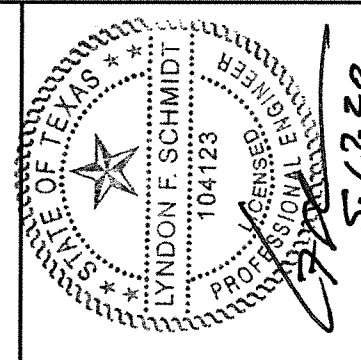

Documents Prepared By: Lyndon F. Schmidt, P.E.
TEXAS P.E. #104123

R.W. BUILDING CONSULTANTS, INC.
P.O. Box 230 Valrico FL 33595
Phone No.: 813.659.9197

TEXAS BOARD OF PROFESSIONAL ENGINEERS
CERTIFICATE OF REGISTRATION # F-11852

PRODUCT: THERMA-TRU FIBERGLASS DOOR

PART OR ASSEMBLY: BILL OF MATERIALS

NO.	DATE	UPDATE TO 2018 IBC/IRC CODE	LFS	BY
1	5/12/20			

DATE: 2/10/16

SCALE: N.T.S.

DWG. BY: JK

CHK. BY: LFS

DRAWING NO.: TX-4603

SHEET 11 OF 11

CONCRETE ANCHOR NOTES:

- Concrete anchor locations at the corners may be adjusted to maintain the min. edge distance to mortar joints.
- Concrete anchor locations noted as "MAX. ON CENTER" must be adjusted to maintain the min. edge distance to mortar joints, additional concrete anchors may be required to ensure the "MAX. ON CENTER" dimension are not exceeded.
- Concrete anchor table:

ANCHOR TYPE	ANCHOR SIZE	MIN. EMBEDMENT	MIN. CLEARANCE TO MASONRY EDGE	MIN. CLEARANCE TO ADJACENT ANCHOR
ITW TAPCON®	1/4"	1-1/4"	2"	4"
ELCO ULTRACON®	1/4"	1-1/4"	1"	4"

WOOD SCREW INSTALLATION NOTES:

- Maintain a minimum 5/8" edge distance, 1" end distance, & 1" o.c. spacing of wood screws to prevent the splitting of wood.