

STEVES AND SONS

203 Humble Ave.
San Antonio, TX 78225

GLAZED WOOD DOOR w/ ARCH TRANSOM INSWING / OUTSWING "NON-IMPACT"

EVALUATED FOR USE IN THE STATE OF TEXAS

The Wood Door system described herein complies with the 2018 International Residential Code (IRC), Sections R301 & R609 and the 2018 International Building Code (IBC), Sections 1404.13, 1609, 1709.5, 2403 and 2404 subject to the following conditions:

1. Anchors shall be as listed and spaced as shown in the details. Anchor embedment to base material shall be beyond wall dressing or stucco.
2. When used in areas requiring wind-borne debris protection this product is required to be protected with an impact resistant covering that complies with Section R301.2.1.2 of the IRC and Section 1609.1.2 of the IBC.
3. Allowable design pressure requirements must be equal to or less than the design pressure rating shown in the design pressure chart, sheet 1 of this drawing.
4. Conditions not covered by this drawing are subject to further engineering analysis.

TABLE OF CONTENTS

SHEET #	DESCRIPTION
1	Typical elevation, design pressures & general notes
2	Door panel & glazing details
3	Elevations
4	Horizontal cross section
5	Vertical cross sections
6	Frame anchoring
7	Bill of materials & components

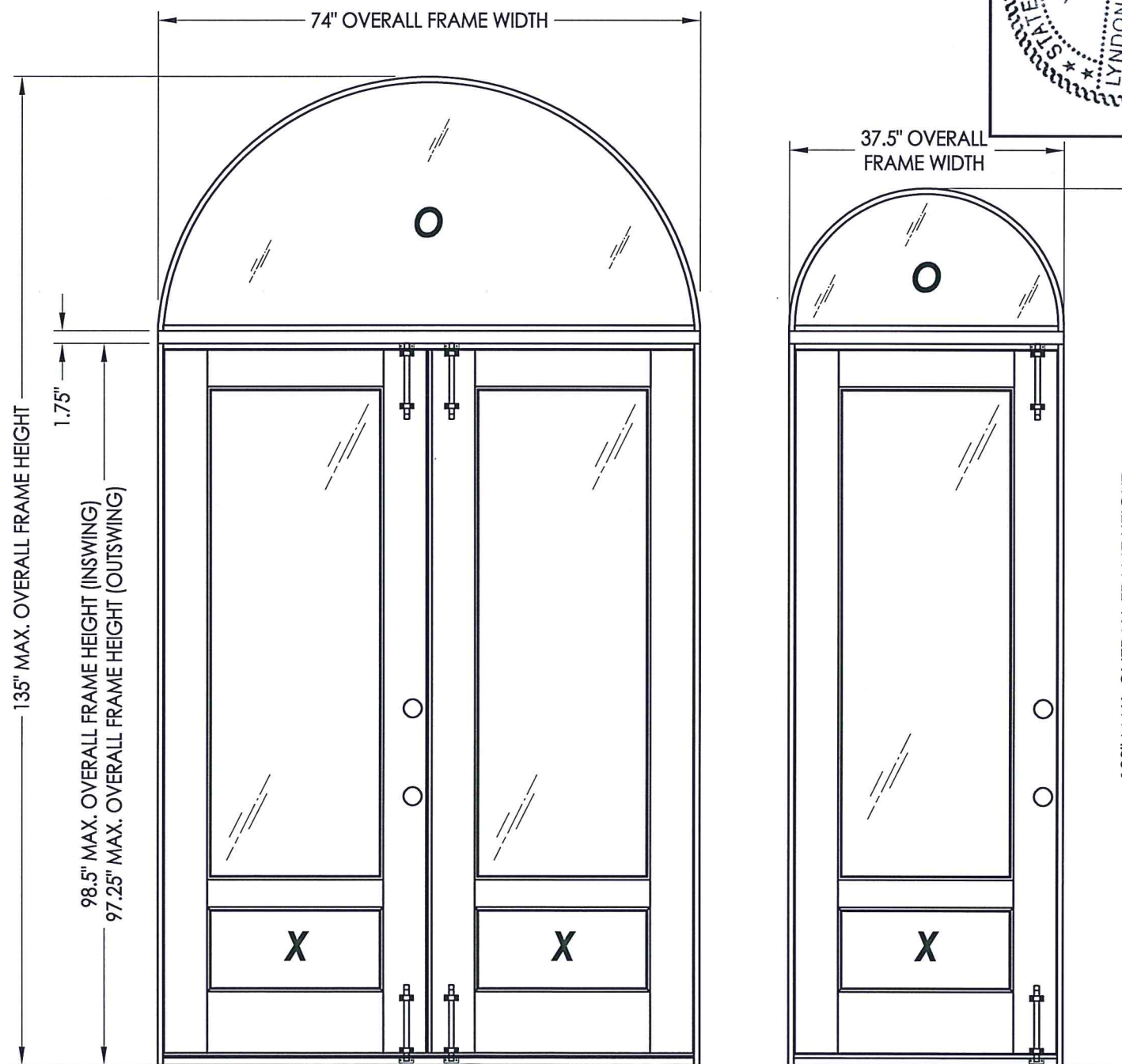

CONFIGURATION	OVERALL FRAME DIMENSION	GLASS TYPE	DESIGN PRESSURE (PSF) INSWING		DESIGN PRESSURE (PSF) OUTSWING	
			POSITIVE	NEGATIVE	POSITIVE	NEGATIVE
O X	37.5" x 120.0"	G1	+55.0	-55.0	+55.0	-55.0
O XX	74.0" x 135.0"	G1	+55.0	-55.0	+55.0	-55.0

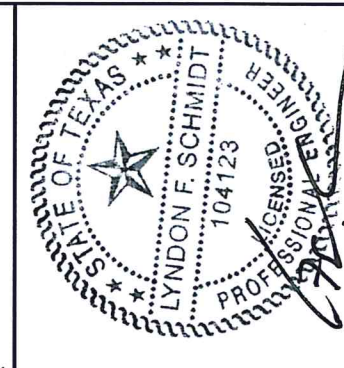

Documents Prepared By: Lyndon F. Schmidt, P.E.
TEXAS P.E. #104123

RW BUILDING CONSULTANTS, INC.
P.O. Box 230 Valrico FL 33595
Phone No.: 813.659.9197
TEXAS BOARD OF PROFESSIONAL ENGINEERS
CERTIFICATE OF REGISTRATION # F-11852

PRODUCT: STEVES AND SONS WOOD DOOR
PART OR ASSEMBLY: TYPICAL ELEVATION, DESIGN PRESSURES & GENERAL NOTES

NO.	DATE	REVISIONS
1	11/19/20	UPDATE TO 2018 IBC/IRC
LFS		BY

DATE: 9/29/15
SCALE: N.T.S.
DWG. BY: JK
CHK. BY: LFS
DRAWING NO.: TX-4567
SHEET 1 OF 7

R:\Clients\Steves and Sons - Permanent\B - Texas Dept of Ins\Hinged Doors - Wood\DR-781C - Drawings\TX-4565-68.dwg, 2.3

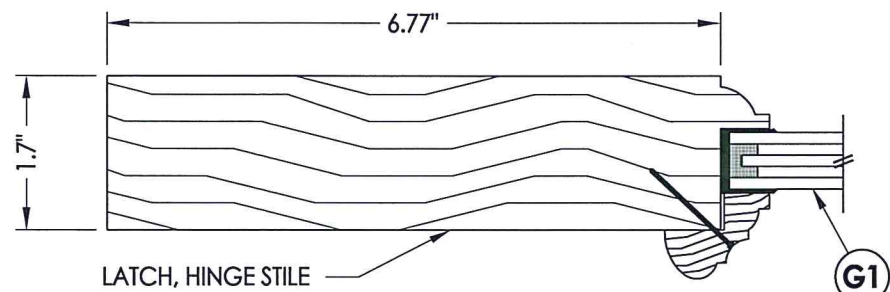

1
2 HORIZONTAL CROSS SECTION

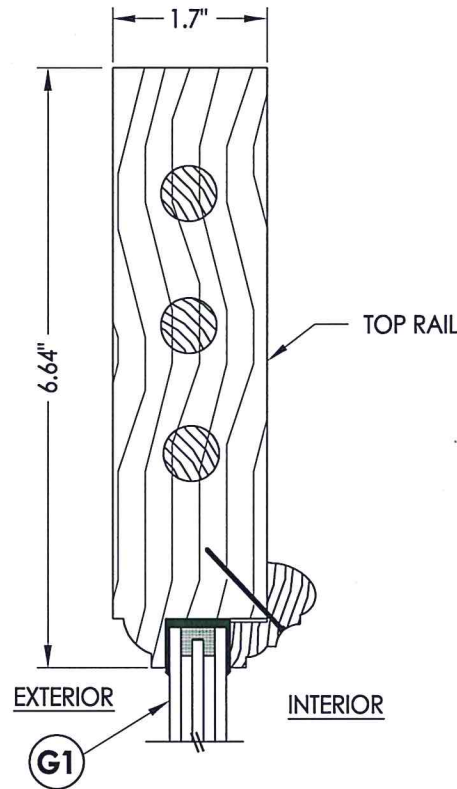

2
2 VERTICAL CROSS SECTION

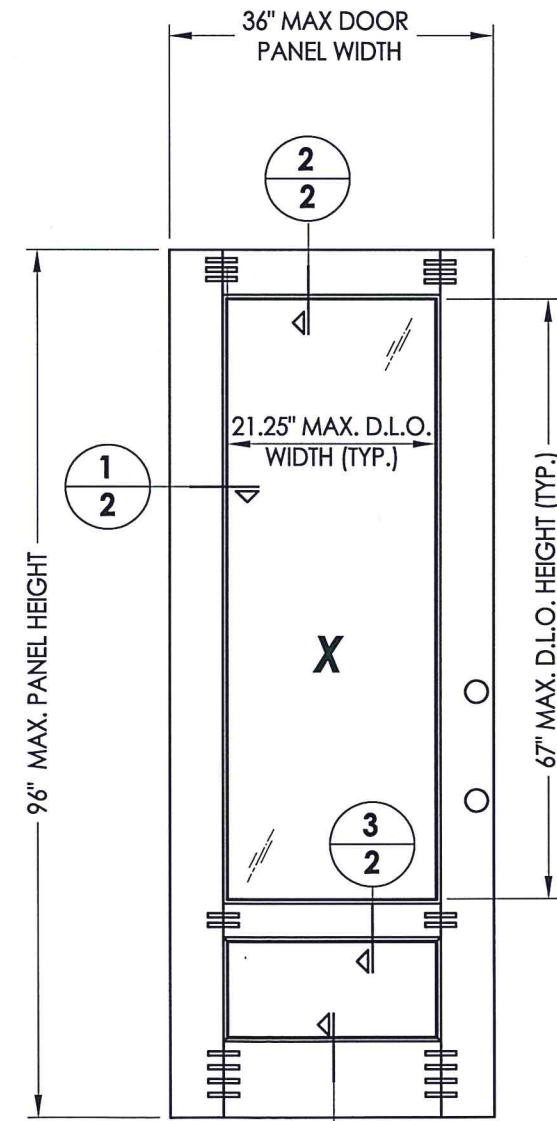

4
2 DOOR PANEL

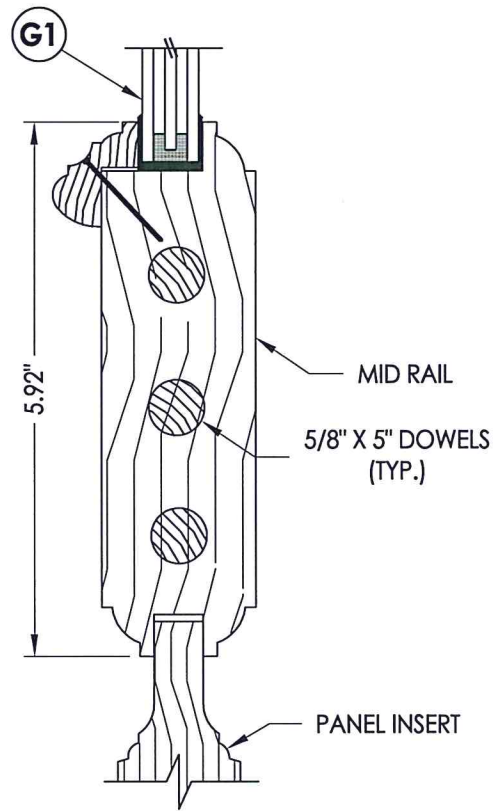

3
2 VERTICAL CROSS SECTION

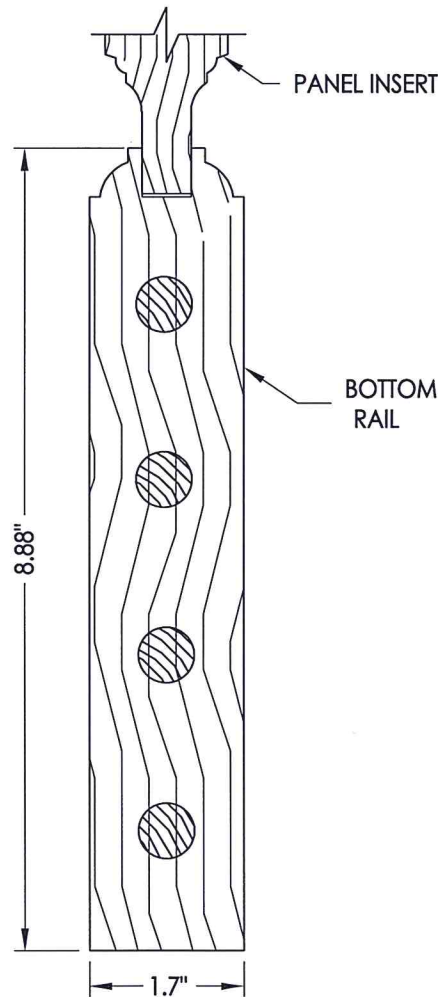

4
2 VERTICAL CROSS SECTION

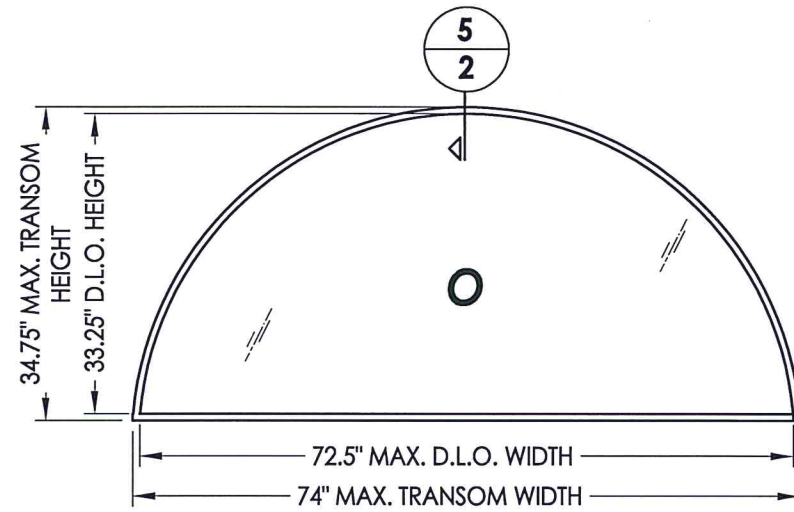

40 TRANSOM PANEL

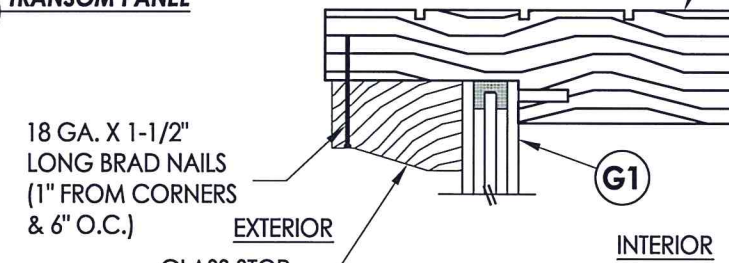

5
2 VERTICAL CROSS SECTION

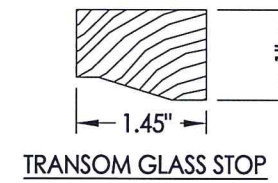

TRANSOM GLASS STOP

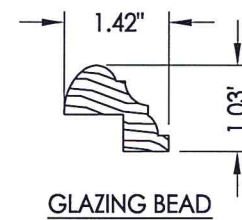

GLAZING BEAD

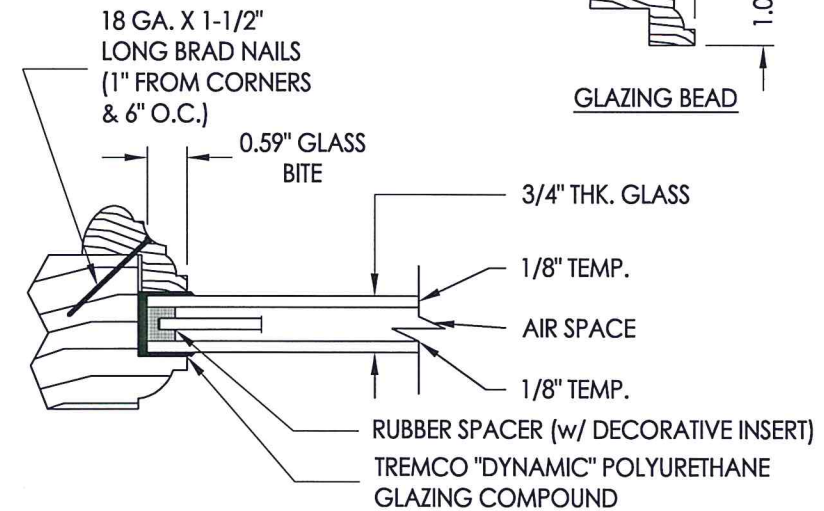

G1 GLAZING DETAIL

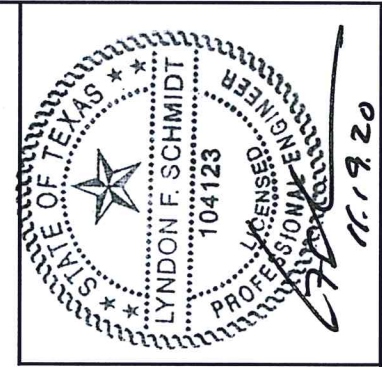

Documents Prepared By: Lyndon F. Schmidt, P.E.
TEXAS P.E. #104123

RW BUILDING CONSULTANTS, INC.
P.O. Box 230 Valrico FL 33595
Phone No.: 813.659.9197
TEXAS BOARD OF PROFESSIONAL ENGINEERS
CERTIFICATE OF REGISTRATION # F-11852

PRODUCT: STEVES AND SONS
WOOD DOOR

PART OR ASSEMBLY: DOOR PANEL
& GLAZING DETAILS

NO.	DATE	REVISIONS
1	11/19/20	UPDATE TO 2018 IBC/IRC
LFS		BY

DATE: 9/29/15

SCALE: N.T.S.

DWG. BY: JK

CHK. BY: LFS

DRAWING NO.: TX-4567

SHEET 2 OF 7

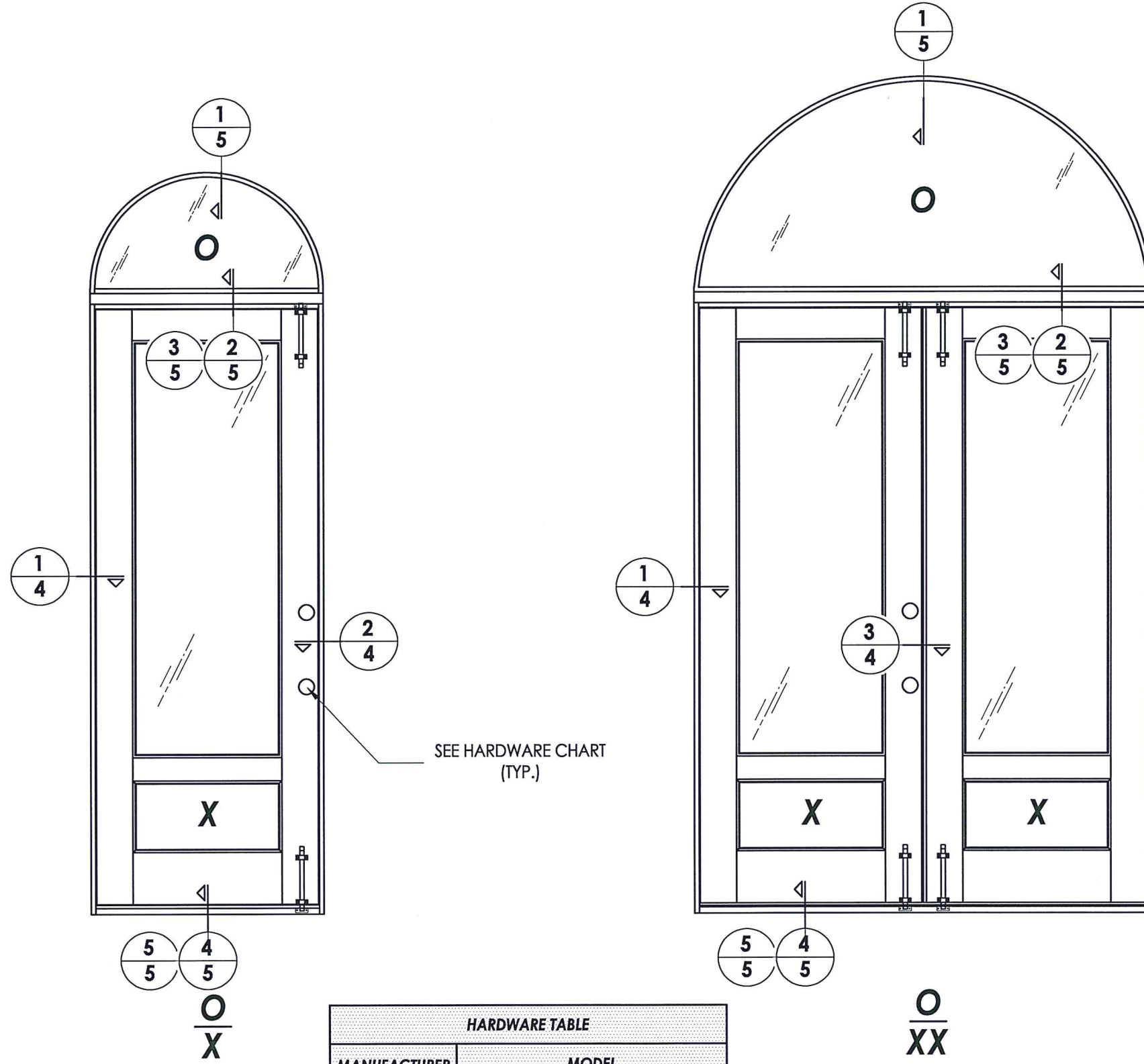

HARDWARE TABLE	
MANUFACTURER	MODEL
DEXTER	KNOB: "J" Series DEADBOLT: "J" Series

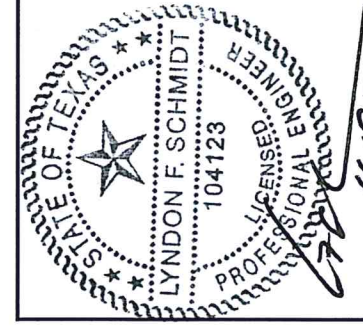

Documents Prepared By: Lyndon F. Schmidt, P.E.
TEXAS P.E. #104123

RW BUILDING CONSULTANTS, INC.
P.O. Box 230 Valrico FL, 33595
Phone No.: 813.659.9197
TEXAS BOARD OF PROFESSIONAL ENGINEERS
CERTIFICATE OF REGISTRATION # F-11852

PRODUCT: STEVES AND SONS WOOD DOOR
PART OR ASSEMBLY: ELEVATIONS

NO.	DATE	REVISIONS
1	11/19/20	UPDATE TO 2018 IBC/IRC
		LFS BY

DATE: 9/29/15
SCALE: N.T.S.
DWG. BY: JK
CHK. BY: LFS
DRAWING NO.: TX-4567
SHEET 3 OF 7

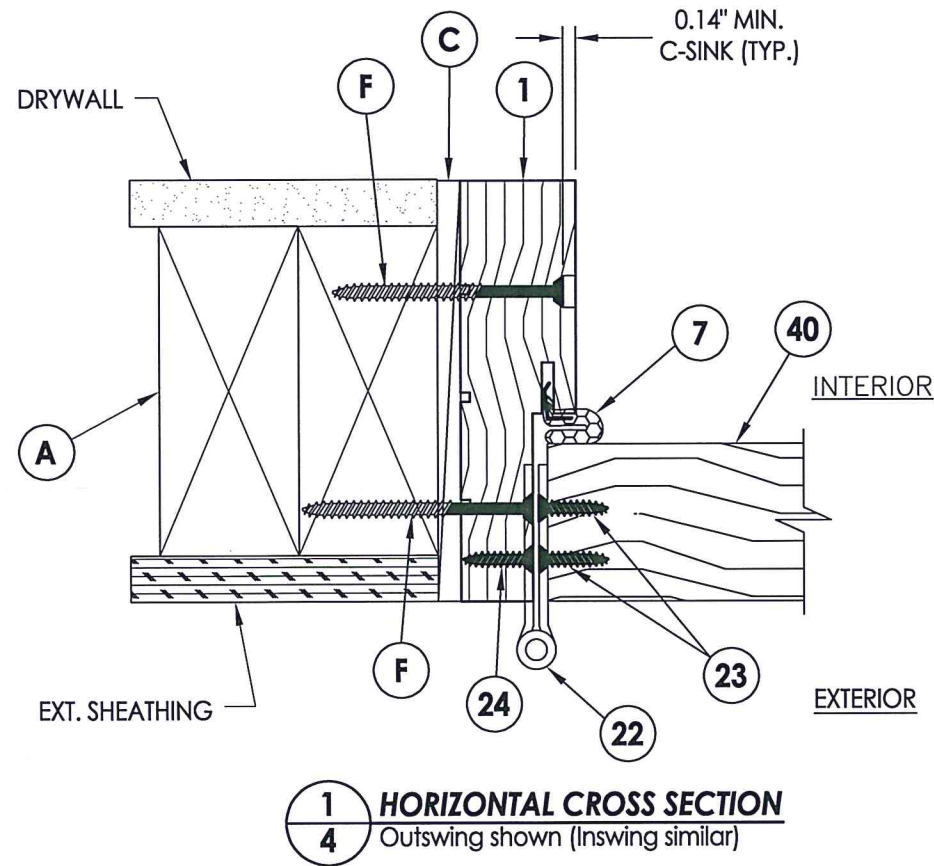

1 HORIZONTAL CROSS SECTION
4 Outswing shown (Inswing similar)

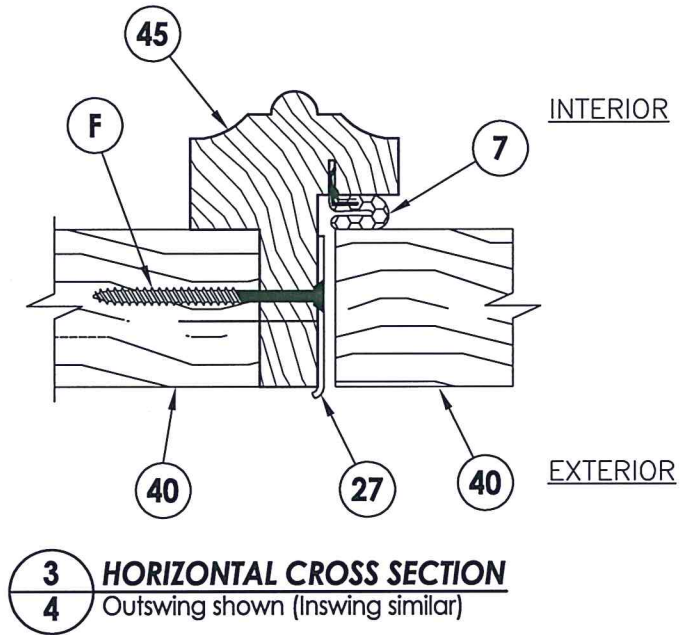

3 HORIZONTAL CROSS SECTION
4 Outswing shown (Inswing similar)

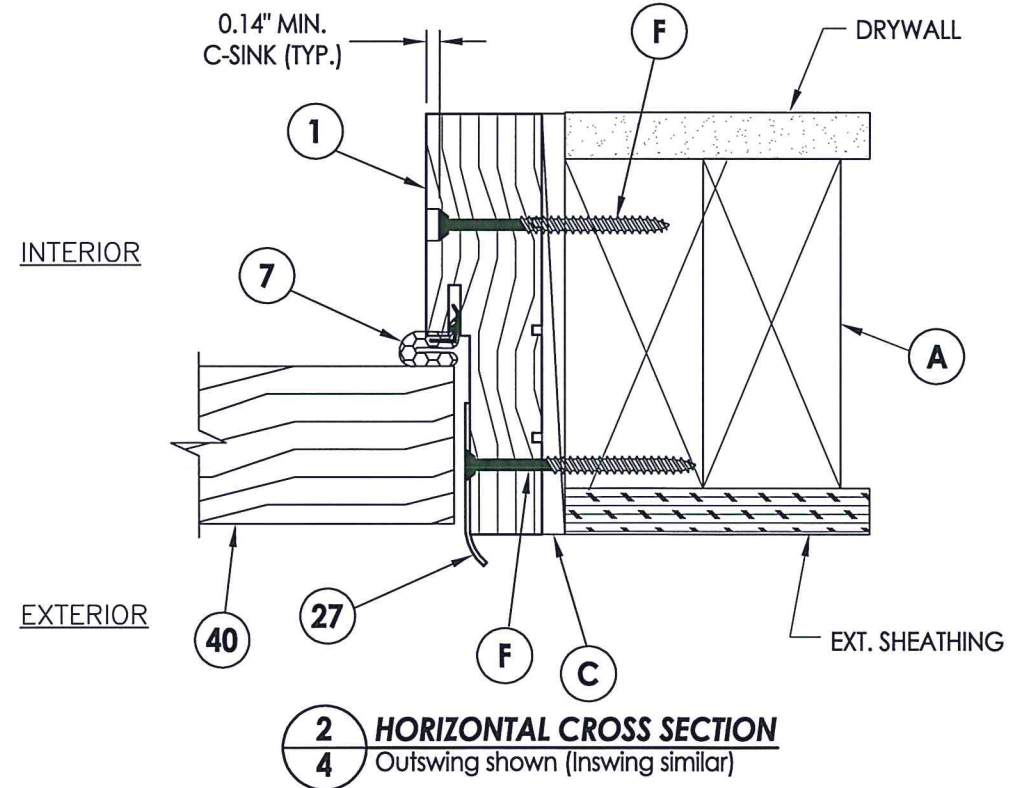

2 HORIZONTAL CROSS SECTION
4 Outswing shown (Inswing similar)

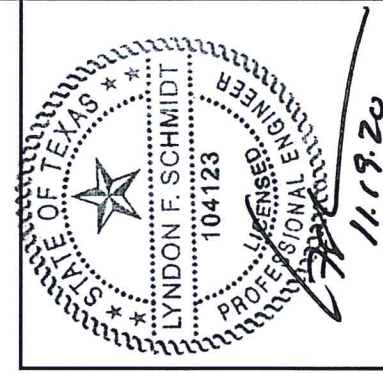

Documents Prepared By: Lyndon F. Schmidt, P.E.
 TEXAS P.E. #104123

RW BUILDING CONSULTANTS, INC.
 P.O. Box 230 Vairico FL. 33595
 Phone No.: 813.659.9197

TEXAS BOARD OF PROFESSIONAL ENGINEERS
 CERTIFICATE OF REGISTRATION # F-11852

PRODUCT: STEVES AND SONS WOOD DOOR

PART OR ASSEMBLY: HORIZONTAL CROSS SECTIONS

NO.	DATE	REVISIONS
1	11/19/20	UPDATE TO 2018 IBC/IRC
		LFS
		BY

DATE: 9/29/15
 SCALE: N.T.S.
 DWG. BY: JK
 CHK. BY: LFS
 DRAWING NO.: TX-4567
 SHEET 4 OF 7

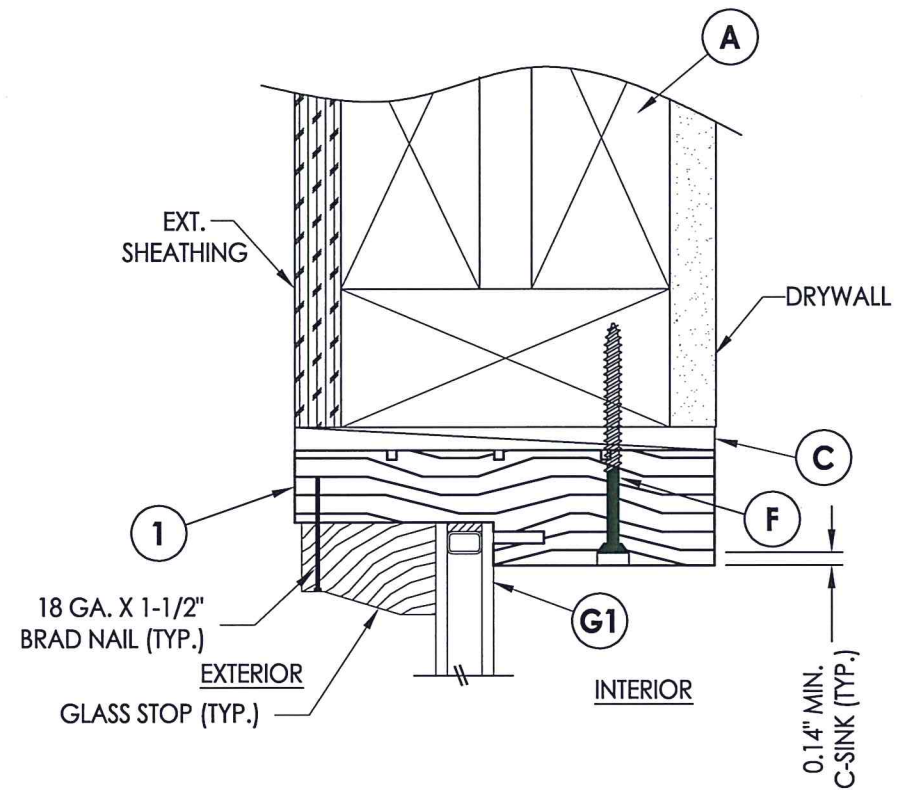

1 VERTICAL CROSS SECTION
5 Outswing shown (Inswing similar)

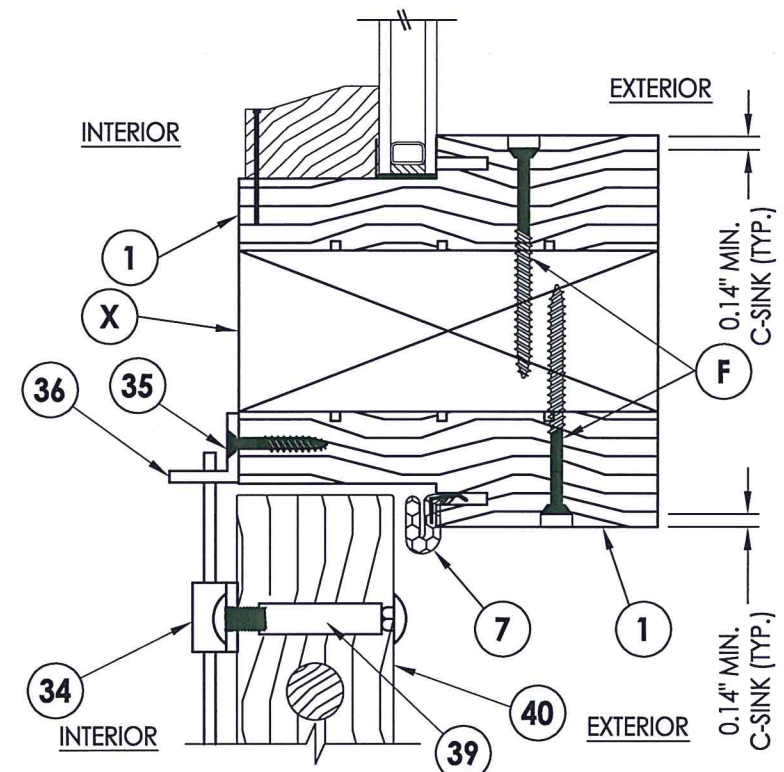

2 VERTICAL CROSS SECTION
5 Inswing

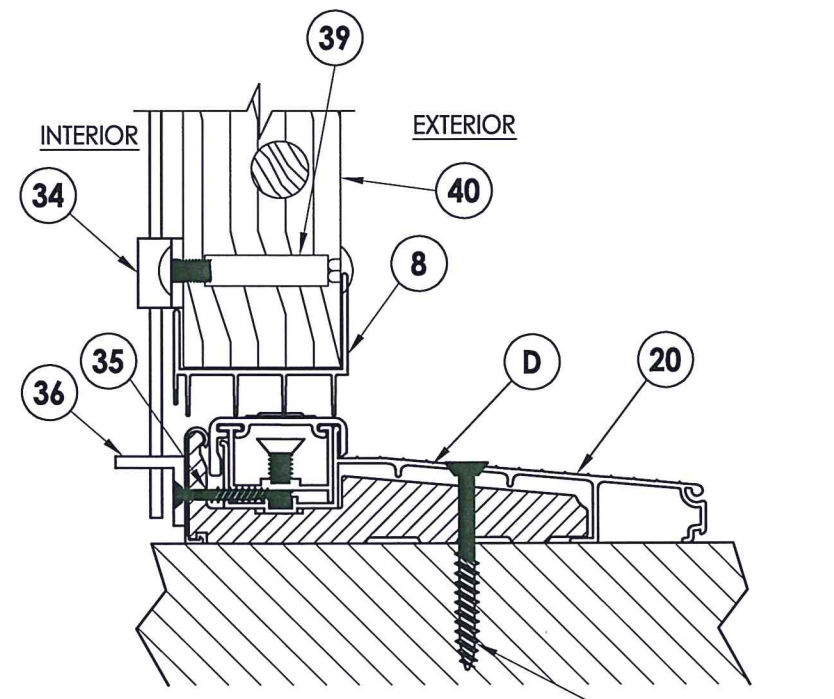

4 VERTICAL CROSS SECTION
5 Inswing sill

K WOOD
D CONCRETE

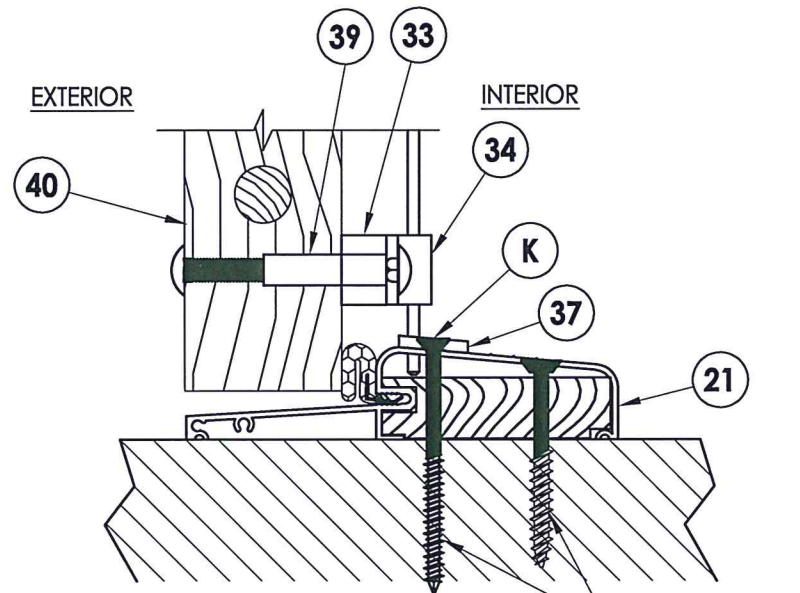

5 VERTICAL CROSS SECTION
5 Outswing sill

K WOOD
D CONCRETE

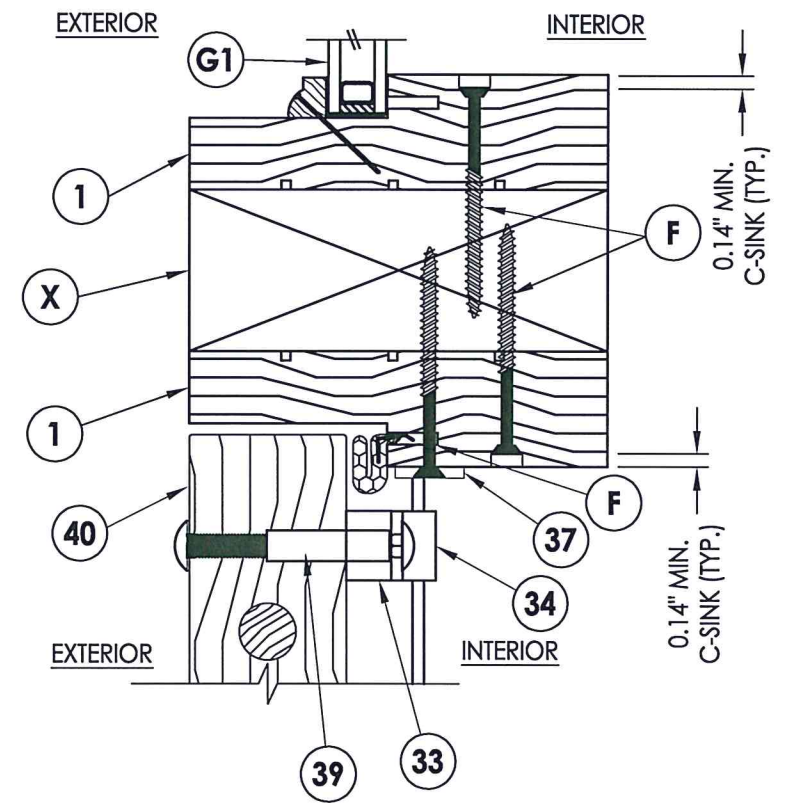

3 VERTICAL CROSS SECTION
5 Outswing

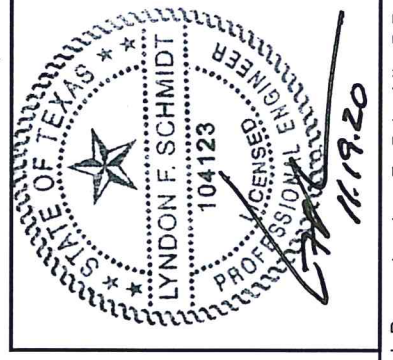

Documents Prepared By: Lyndon F. Schmidt, P.E.
 TEXAS P.E. #104123

RW BUILDING CONSULTANTS, INC.
 P.O. Box 230 Vairico FL, 33595
 Phone No.: 813.659.9197

TEXAS BOARD OF PROFESSIONAL ENGINEERS
 CERTIFICATE OF REGISTRATION # F-11852

PRODUCT: STEVES AND SONS WOOD DOOR

PART OR ASSEMBLY: VERTICAL CROSS SECTIONS

NO.	DATE	REVISIONS
1	11/19/20	UPDATE TO 2018 IBC/IRC
LFS	BY	

DATE: 9/29/15
 SCALE: N.T.S.
 DWG. BY: JK
 CHK. BY: LFS
 DRAWING NO.: TX-4567
 SHEET 5 OF 7

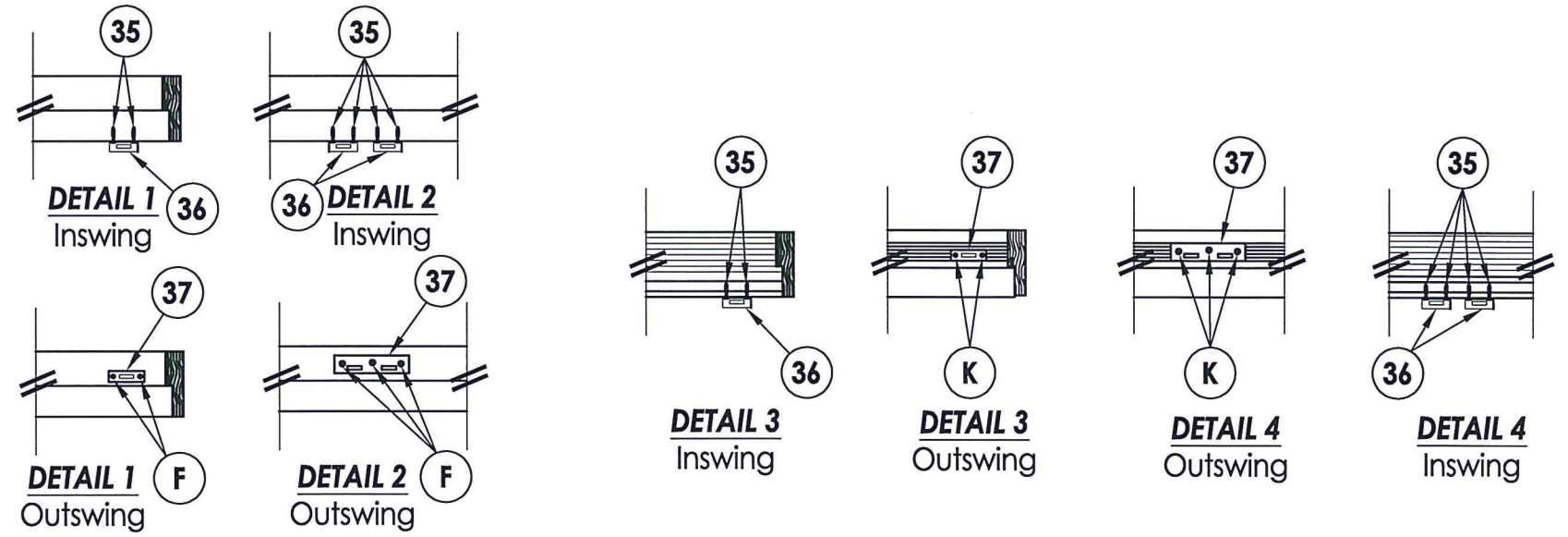
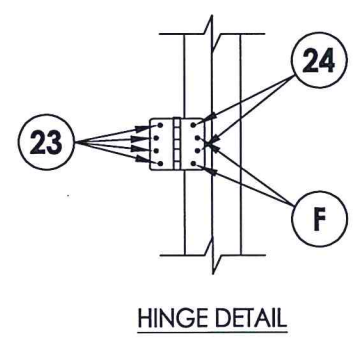
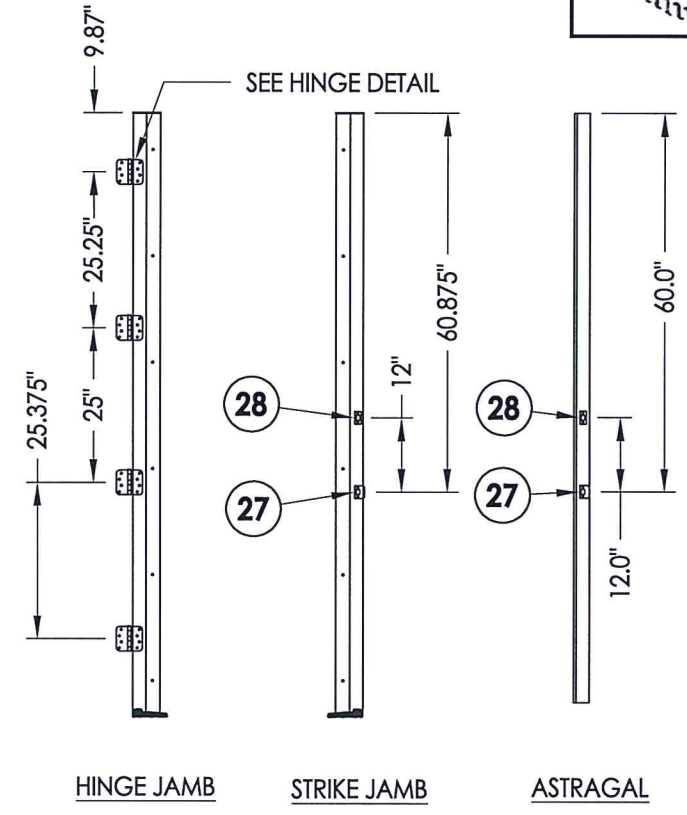
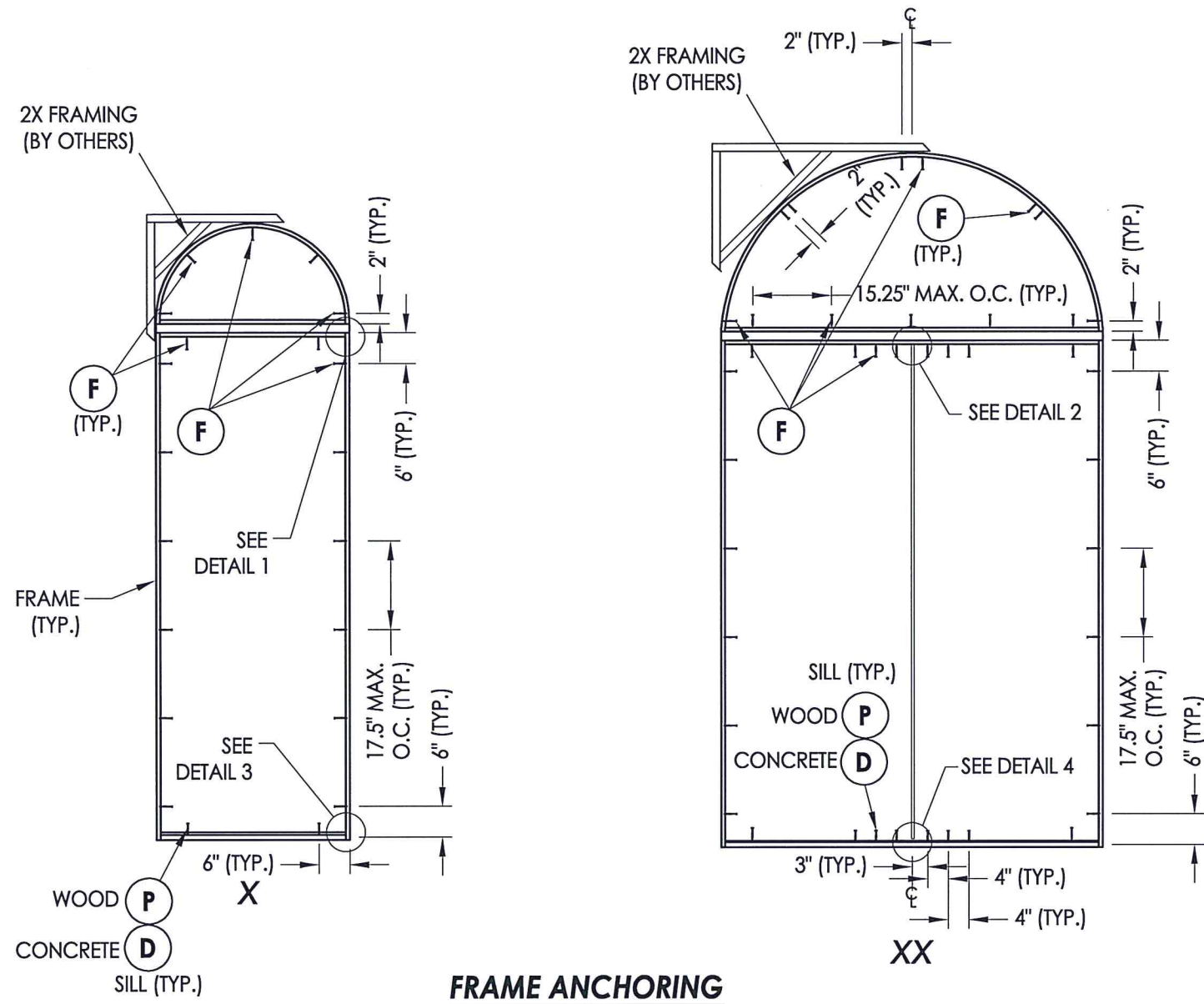

Documents Prepared By: Lyndon F. Schmidt, P.E.
TEXAS P.E. #104123

RW BUILDING CONSULTANTS, INC.
P.O. Box 230 Vairico FL, 33595
Phone No.: 813.659.9197

TEXAS BOARD OF PROFESSIONAL ENGINEERS
CERTIFICATE OF REGISTRATION # F-11852

PRODUCT: STEVES AND SONS WOOD DOOR

PART OR ASSEMBLY: BUCK ANCHORING

NO.	DATE	REVISIONS
1	11/19/20	UPDATE TO 2018 IBC/IRC
		LFS
		BY

DATE: 9/29/15

SCALE: N.T.S.

DWG. BY: JK

CHK. BY: LFS

DRAWING NO.: TX-4567

SHEET 6 OF 7

BILL OF MATERIALS

ITEM #	DESCRIPTION	MATERIAL
A	2X FRAMING (G >= 0.42)	WOOD
C	1/4" MAX. SHIM SPACE	-
D	1/4" PFH DeWALT OR ITW CONCRETE SCREW (1-3/4" MIN. EMBEDMENT)	STEEL
F	#8 X 2-1/2" PFH WOOD SCREW (1.15" MIN. EMBEDMENT)	STEEL
K	3/16" PFH ITW CONCRETE SCREW (1-3/4" MIN. EMBEDMENT)	STEEL
P	#10 PFH WOOD SCREW (1-3/4" MIN. EMBEDMENT)	STEEL
X	1-3/4" X 4-5/8" SOUTHERN YELLOW PINE MULLION (G >= 0.55)	WOOD
1	HEAD AND SIDE JAMB	WOOD
7	WEATHERSTRIP (QLON)	FOAM
8	DOOR SWEEP	WOOD
19	SIDELITE SPACER	PVC
20	INSWING SILL	WOOD
21	OUTSWING SILL	WOOD
22	4" x 4" HINGE	STEEL
23	#9 X 3/4" PFH WOOD SCREW	STEEL
24	#8 X 3/4" PFH WOOD SCREW	STEEL
27	LATCH STRIKE PLATE	STEEL
28	DEADBOLT STRIKE PLATE	STEEL
33	SURFACE BOLT SPACER	-
34	SURFACE BOLT (IVES 454 8" LONG)	STEEL
35	#8 X 1" PFH WOOD SCREW	STEEL
36	SURFACE BOLT GUIDE PLATE	STEEL
37	SURFACE BOLT STRIKE	STEEL
39	#10 X 2" SEX BOLT	STEEL
40	WOOD DOOR PANEL	-
45	ASTRAGAL (MAHOGANY)	WOOD

NOTE: WOOD DOOR COMPONENTS: PINE CORE w/ MAHOGANY LAMINATE

CONCRETE ANCHOR NOTES:

- Concrete anchor locations at the corners may be adjusted to maintain the min. edge distance to mortar joints.
- Concrete anchor locations noted as "MAX. ON CENTER" must be adjusted to maintain the min. edge distance to mortar joints, additional concrete anchors may be required to ensure the "MAX. ON CENTER" dimension are not exceeded.
- Concrete anchor table:

ANCHOR TYPE	ANCHOR SIZE	MIN. EMBEDMENT	MIN. CLEARANCE TO MASONRY EDGE	MIN. CLEARANCE TO ADJACENT ANCHOR
ITW TAPCON®	1/4"	1-1/4"	2"	4"
DeWALT ULTRACON®	1/4"	1-1/4"	1"	4"
ITW TAPCON®	3/16"	1-1/4"	3"	1-1/2"

WOOD SCREW INSTALLATION NOTES:

- Maintain a minimum 5/8" edge distance, 1" end distance, & 1" o.c. spacing of wood screws to prevent the splitting of wood.

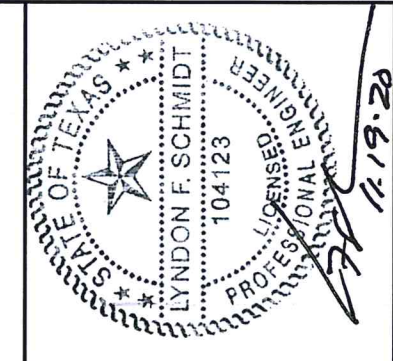

Documents Prepared By: Lyndon F. Schmidt, P.E.
TEXAS P.E. #104123

RW BUILDING CONSULTANTS, INC.
P.O. Box 230 Valrico FL 33595
Phone No.: 813.659.9197

TEXAS BOARD OF PROFESSIONAL ENGINEERS
CERTIFICATE OF REGISTRATION # F-11852

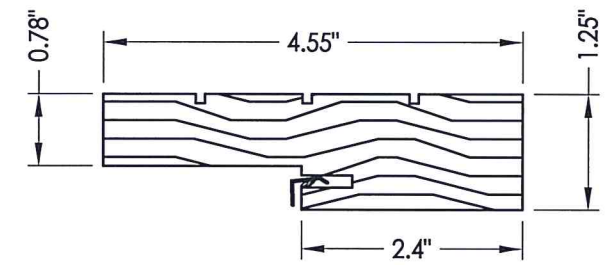

1 FRAME

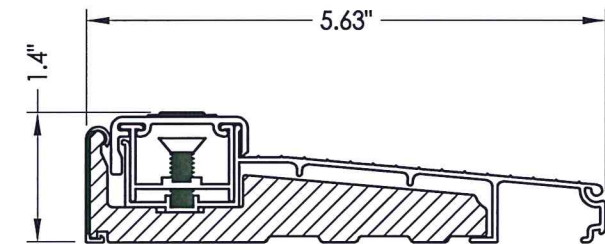

20 INSWING THRESHOLD

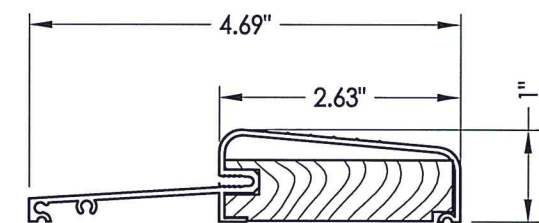

21 OUTSWING THRESHOLD

18 GA. X 1-1/2" LONG BRAD NAILS (1" FROM CORNERS & 6" O.C.)

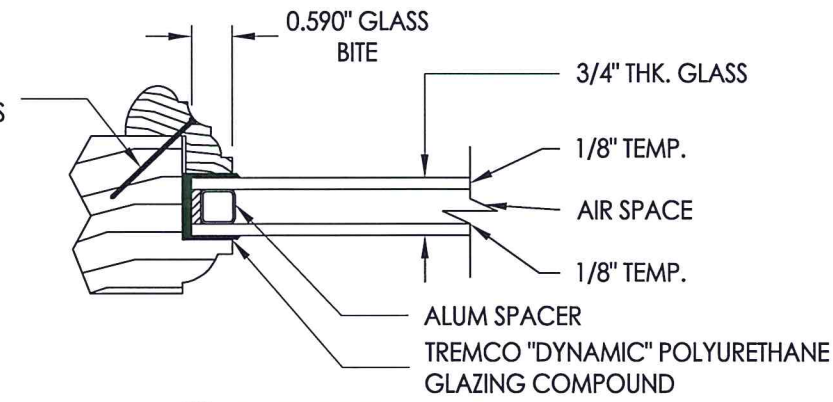

G1 GLAZING DETAIL

PRODUCT:	STEVES AND SONS WOOD DOOR	
PART OR ASSEMBLY:	BILL OF MATERIALS & COMPONENTS	
NO.	DATE	BY
1	11/19/20	LFS
UPDATE TO 2018 IBC/IRC		
REVISIONS		
DATE:	9/29/15	
SCALE:	N.T.S.	
DWG. BY:	JK	
CHK. BY:	LFS	
DRAWING NO.:	TX-4567	
SHEET	7 OF 7	