

# Glazed Fiberglass Door

## "NON-IMPACT"

### INSWING / OUTSWING

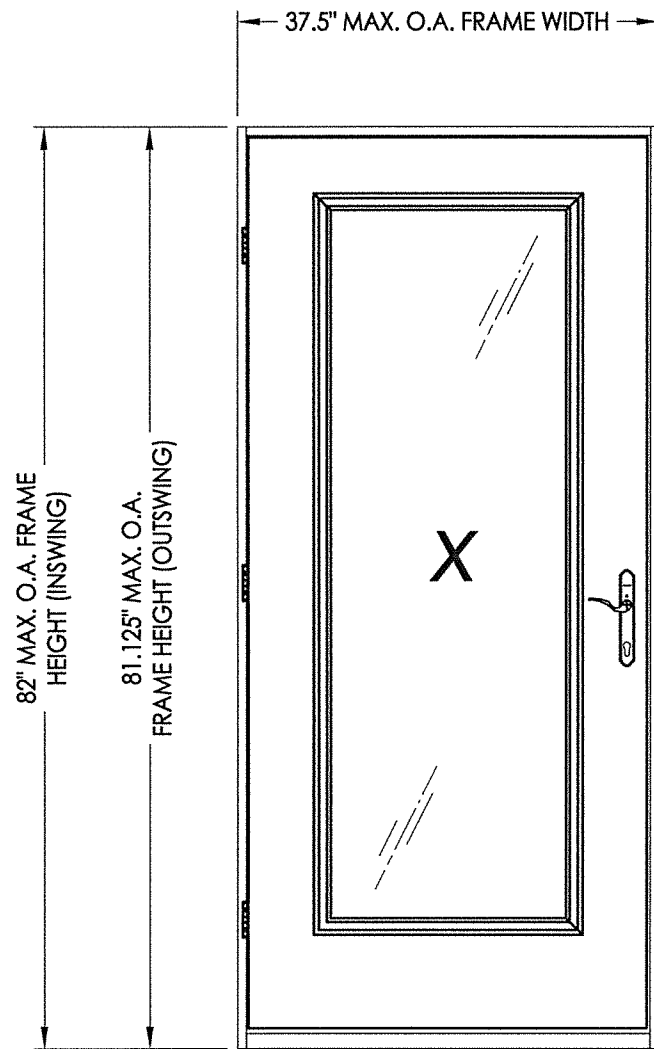

EVALUATED FOR USE IN THE STATE OF TEXAS

**TDI DR-709**

The Fiberglass Door system described herein complies with the 2018 International Residential Code (IRC), Sections R301 & R609 and the 2018 International Building Code (IBC), Sections 1404.13, 1609, 1709.5, 2403 and 2404 subject to the following conditions:

1. Anchors shall be as listed and spaced as shown in the details. Anchor embedment to base material shall be beyond wall dressing or stucco.
2. When used in areas requiring wind-borne debris protection this product is required to be protected with an impact resistant covering that complies with Section R301.2.1.2 of the IRC and Section 1609.1.2 of the IBC.
3. Allowable design pressure requirements must be equal to or less than the design pressure rating shown in the design pressure chart, sheet 1 of this drawing.
4. Conditions not covered by this drawing are subject to further engineering analysis.

TABLE OF CONTENTS	
SHEET#	DESCRIPTION
1	Typical elevations, design pressures & general notes
2	Door panel details (lip lite insert glazing)
3	Door panel details (flush glazing)
4	Horizontal & vertical cross sections
5	Vertical cross sections
6	Frame anchoring

CONFIG.	GLAZING	MODEL	DESIGN PRESSURE (PSF) ULTIMATE TRILENNIUM ASTRAGAL	
			POSITIVE	NEGATIVE
X	LIP LITE INSERT	INSWING	+30.0	-30.0
X	LIP LITE INSERT	OUTSWING	+30.0	-30.0
X	FLUSH GLAZED	INSWING	+55.0	-55.0
X	FLUSH GLAZED	OUTSWING	+70.0	-70.0

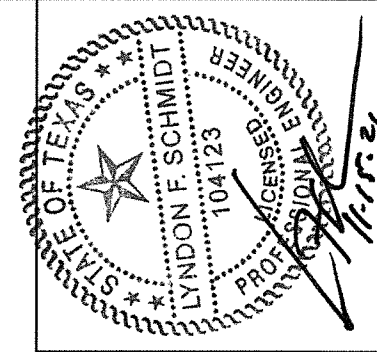

Documents Prepared By: Lyndon F. Schmidt, P.E.  
TEXAS P.E. #104123

**RW** BUILDING CONSULTANTS, INC.  
P.O. Box 230 Valrico FL 33595  
Phone No.: 813.659.9197

TEXAS BOARD OF PROFESSIONAL ENGINEERS  
CERTIFICATE OF REGISTRATION # F-11852

PRODUCT:	ENDURA
PART OR ASSEMBLY:	TYPICAL ELEVATION, DESIGN PRESSURES & GENERAL NOTES
DATE:	11/09/16
SCALE:	N.T.S.
DWG. BY:	JK
CHK. BY:	LFS
DRAWING NO.:	TX-4663
SHEET	1 OF 6

Z:\Clients\Endura PERMANENT\B - Texas Dept of Ins\TDI - DR-709 Plastpro FG Glazed\C - Drawings\TX-4663.dwg

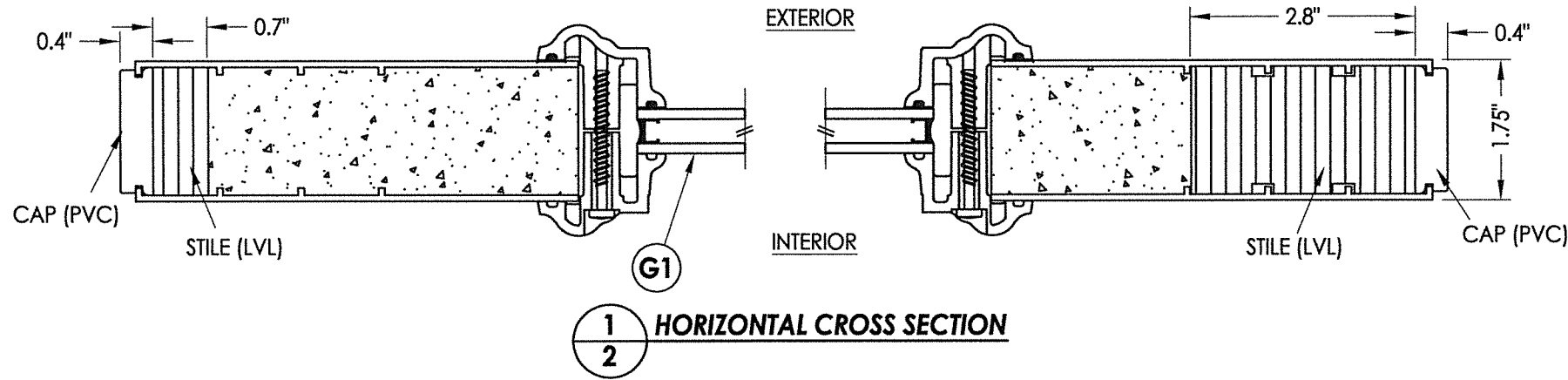

**1**  
**2** HORIZONTAL CROSS SECTION

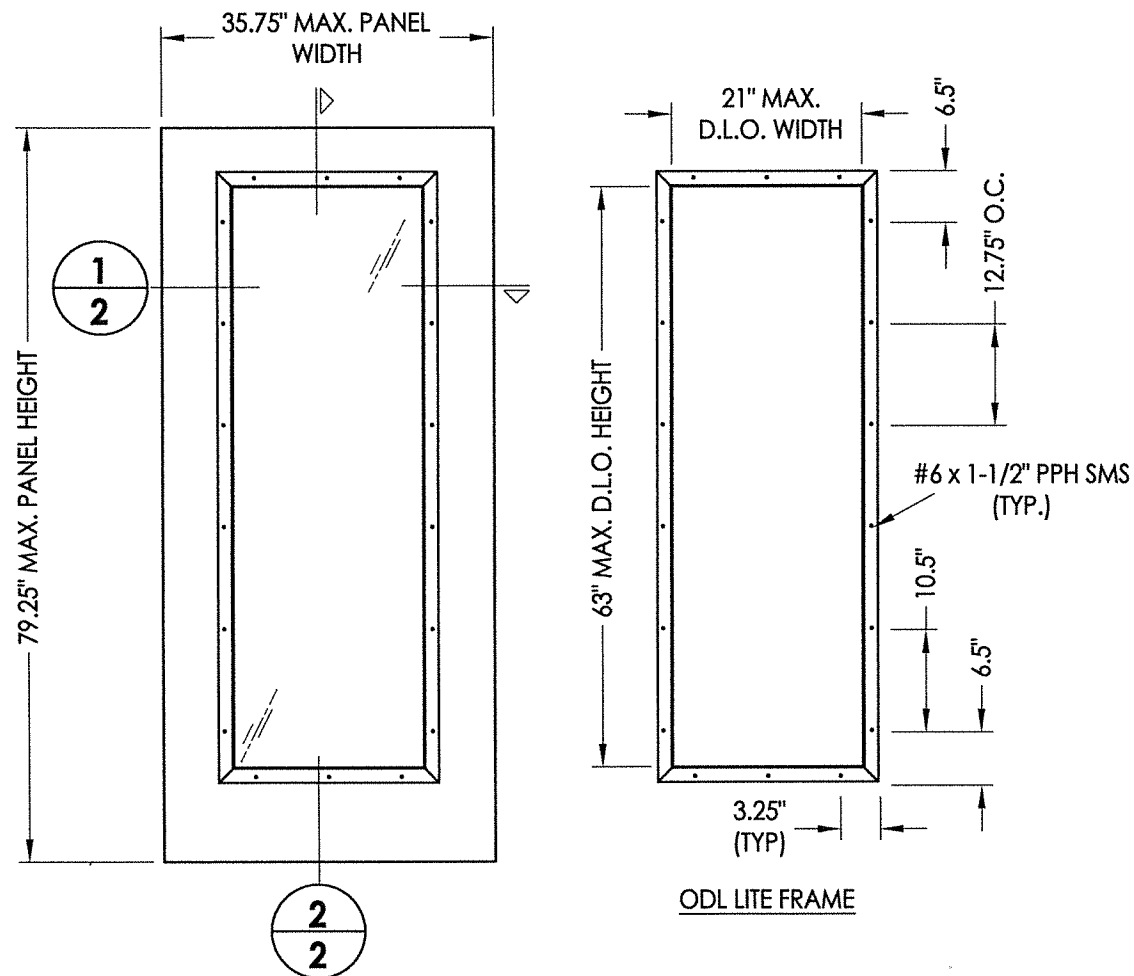

**2**  
**2** DOOR PANEL  
Plastpro  
Fiberglass

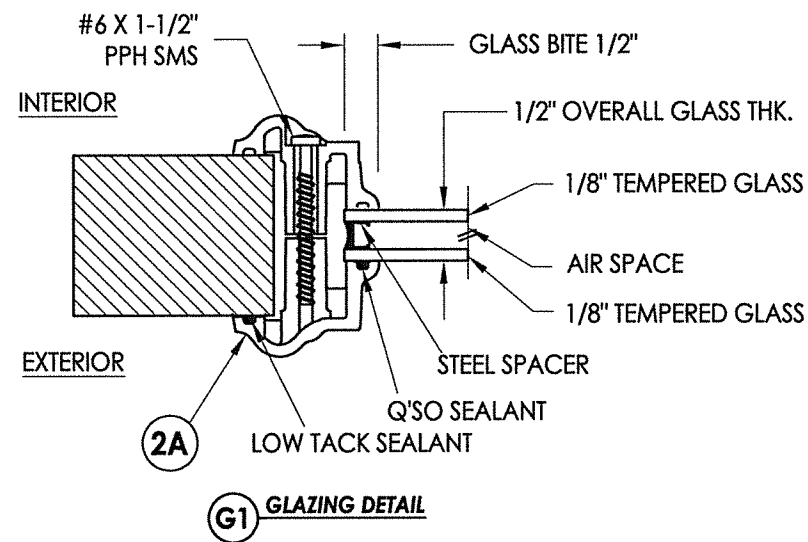

**G1** GLAZING DETAIL

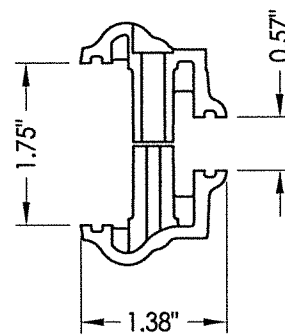

**2A** OD LITE FRAME  
HP Polypropylene

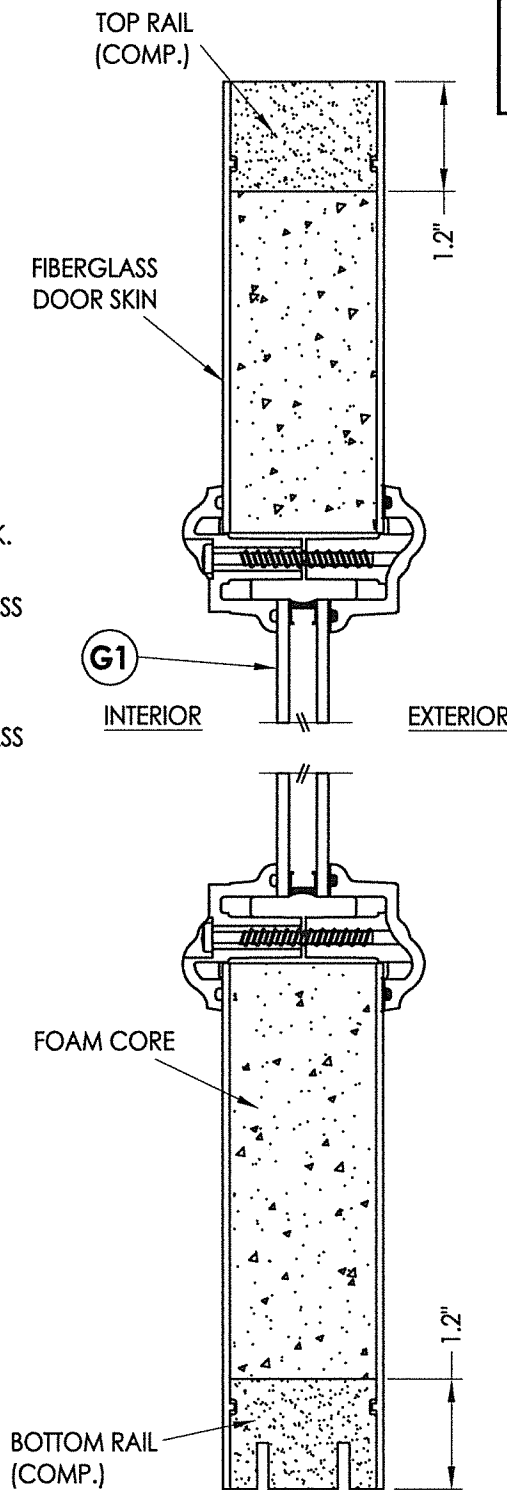

**2**  
**2** VERTICAL CROSS SECTION

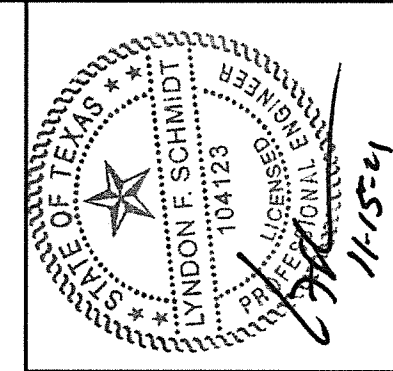

Documents Prepared By: Lyndon F. Schmidt, P.E.  
TEXAS P.E. #104123

**RW** BUILDING CONSULTANTS, INC.  
P.O. Box 230 Valrico FL 33596  
Phone No.: 813.659.9197  
TEXAS BOARD OF PROFESSIONAL ENGINEERS  
CERTIFICATE OF REGISTRATION # F-11852

PRODUCT:	ENDURA	
PART OR ASSEMBLY:	DOOR PANEL DETAILS	
DATE:	11/09/16	
SCALE:	N.T.S.	
DWG. BY:	JK	
CHK. BY:	LFS	
DRAWING NO.:	TX-4663	
SHEET	2 OF 6	
REVISIONS		
NO.	DATE	BY
2	11/11/21	LFS
1	10/08/18	LFS

DOOR PANEL SKIN: FIBERGLASS (0.075" MIN. THICKNESS)  
CORE MATERIAL: POLYURETHANE FOAM (1.9 PCF MIN.)

Z:\Clients\Endura PERMANENT\B - Texas Dept of Ins\TDI - DR-709 Plastpro FG Glazed\C - Drawings\TX-4663.65.dwg

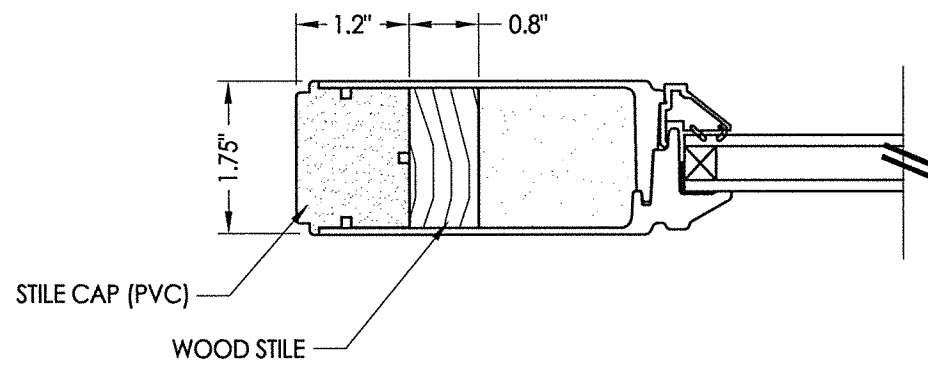

**1**  
**3** HORIZONTAL CROSS SECTION

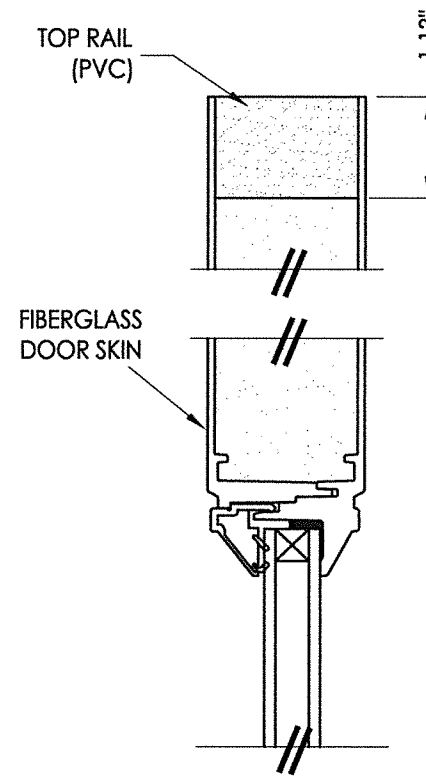
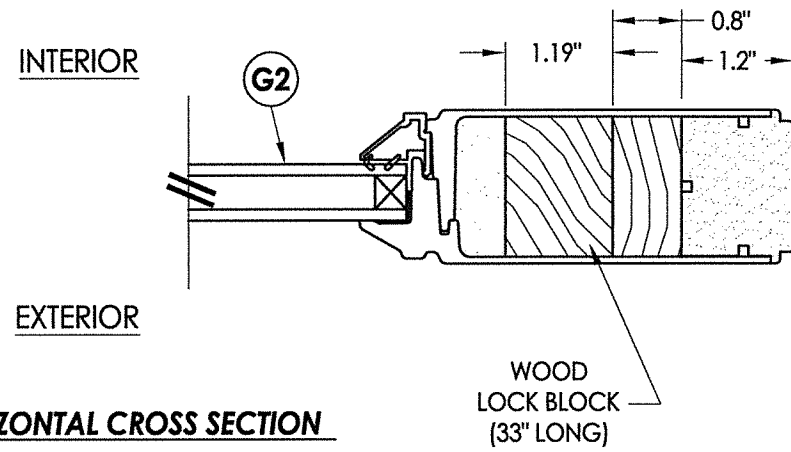

**2**  
**3** VERTICAL CROSS SECTION

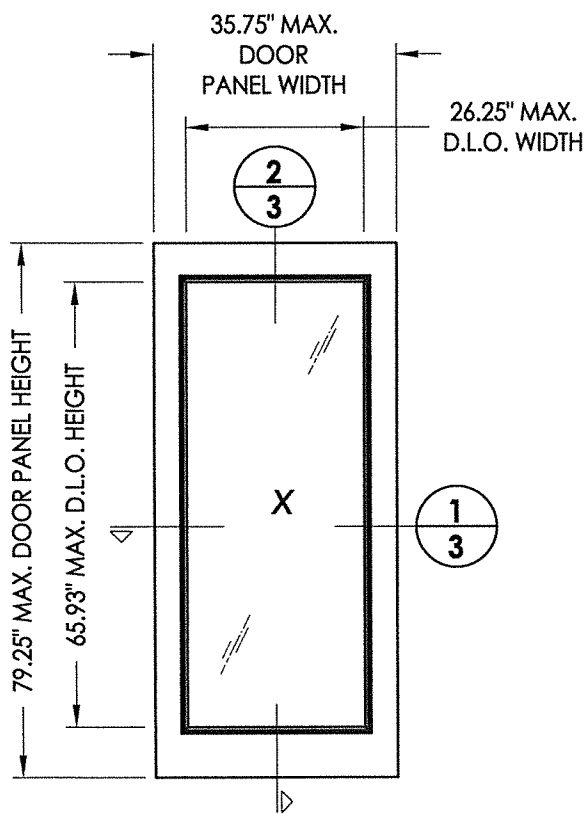
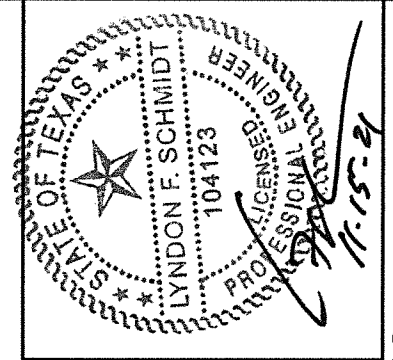

**DOOR PANEL**  
Plastpro  
Fiberglass

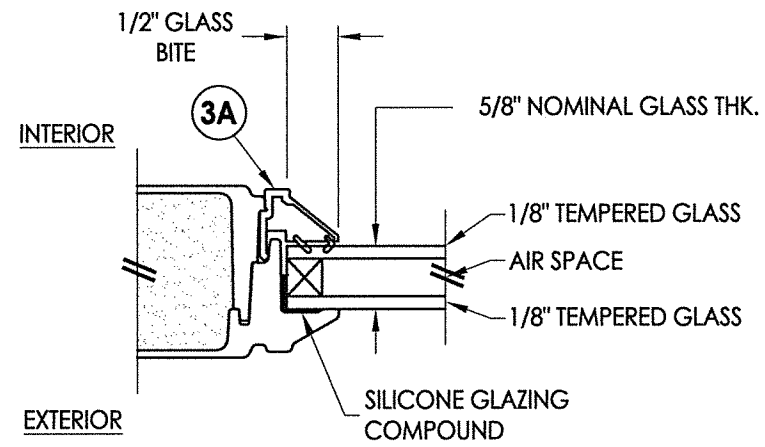

**G2** GLAZING DETAIL  
Flush Glazing

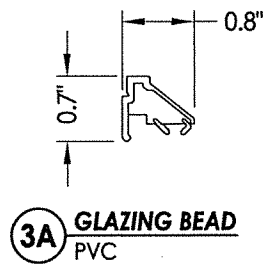

**3A** GLAZING BEAD  
PVC

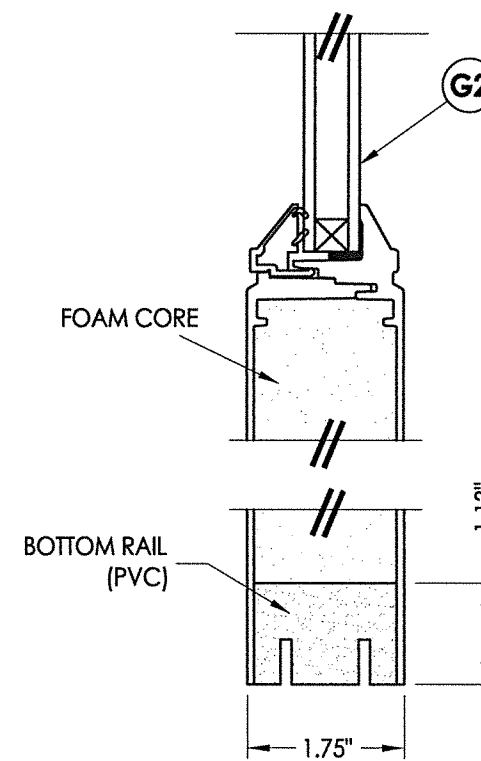

DOOR PANEL SKIN: FIBERGLASS (0.075" MIN. THICKNESS)  
CORE MATERIAL: POLYURETHANE FOAM (1.9 PCF MIN.)

Documents Prepared By: Lyndon F. Schmidt, P.E.  
TEXAS P.E. #104123

**RW** BUILDING CONSULTANTS, INC.  
P.O. Box 230 Valrico FL 33595  
Phone No.: 813.659.9197

TEXAS BOARD OF PROFESSIONAL ENGINEERS  
CERTIFICATE OF REGISTRATION # F-11852

PRODUCT: ENDURA

PART OR ASSEMBLY: DOOR PANEL DETAILS

NO.	DATE	REVISIONS
2	11/11/21	UPDATE TO 2018 IBC/IRC CODE
1	10/08/18	ADDED FLUSH GLAZING
		LFS
		BY

DATE: 11/09/16  
SCALE: N.T.S.  
DWG. BY: JK  
CHK. BY: LFS  
DRAWING NO.: TX-4663  
SHEET 3 OF 6

Z:\Clients\Endura PERMANENT\B - Texas Dept of Ins\TDI - DR-709 Plastpro FG Glazed\C - Drawings\TX-4663.65.dwg

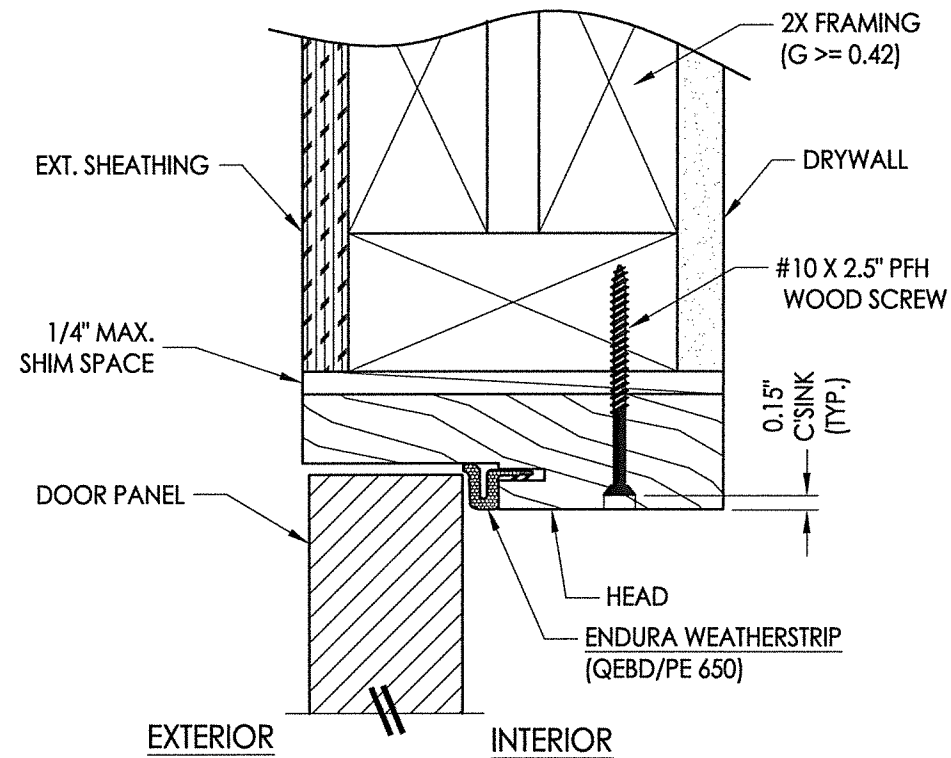
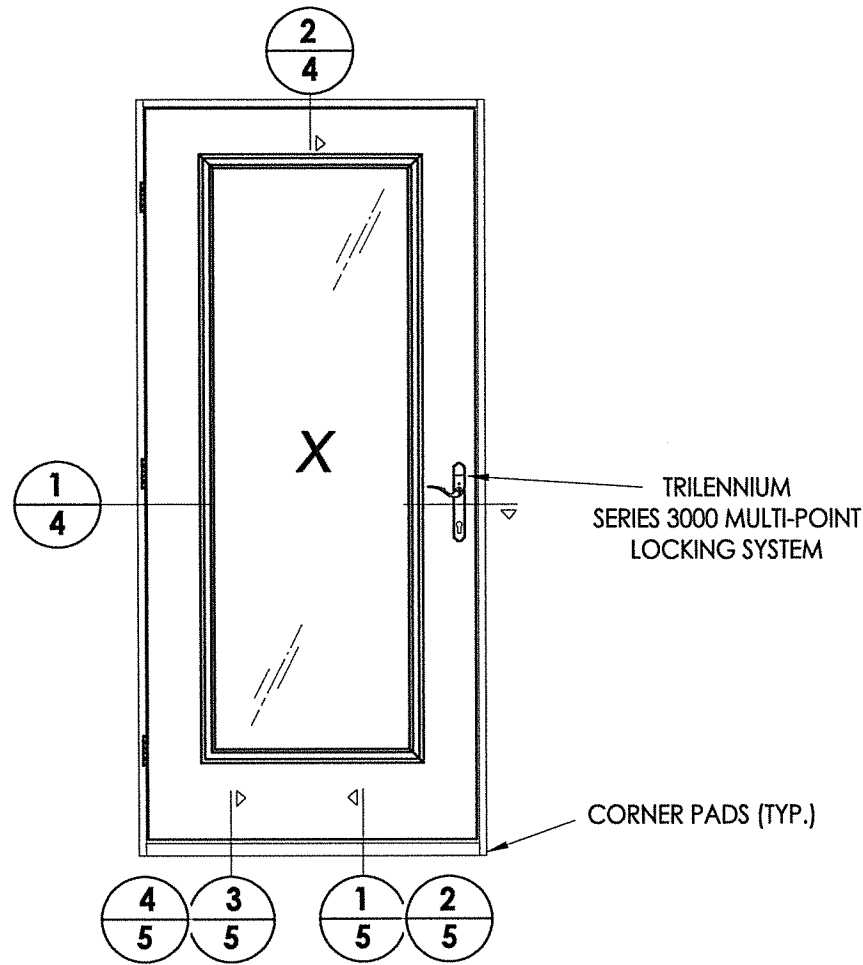

**2 VERTICAL CROSS SECTION**

Outswing shown - inswing  
also approved

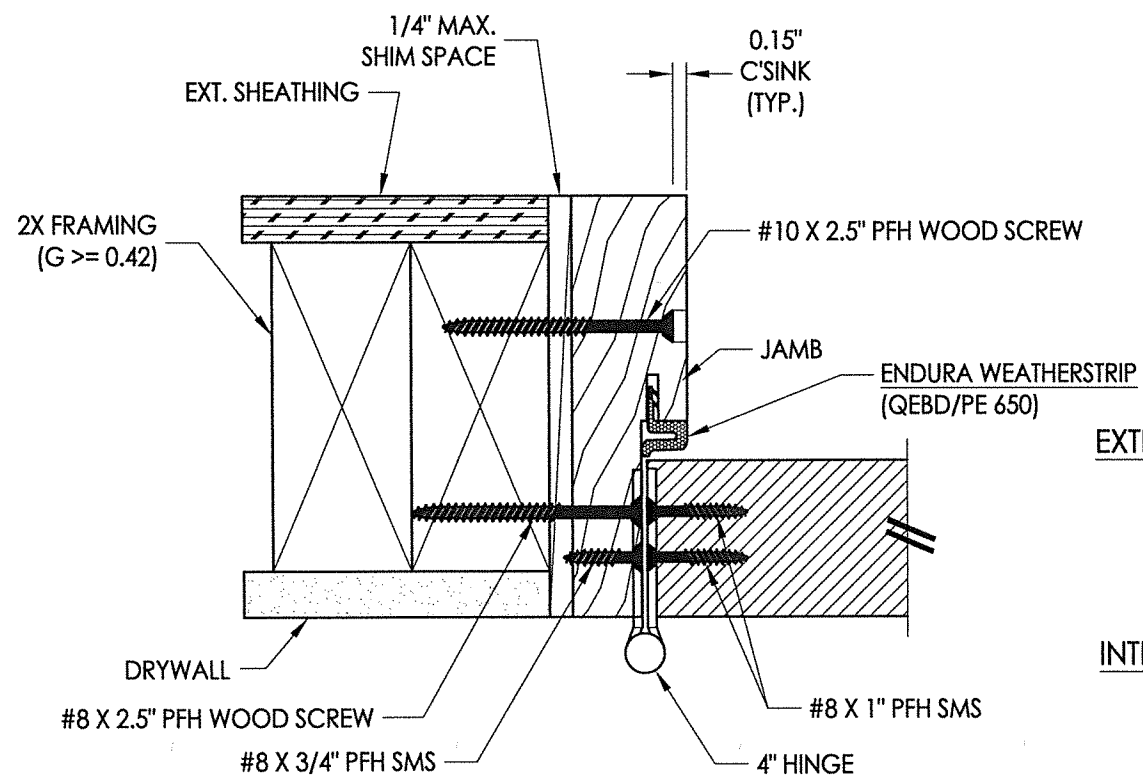

**1 HORIZONTAL CROSS SECTION**

Inswing shown - Outswing also approved

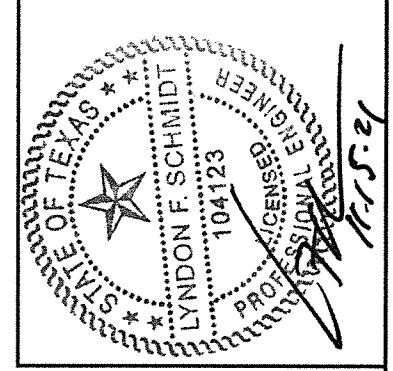
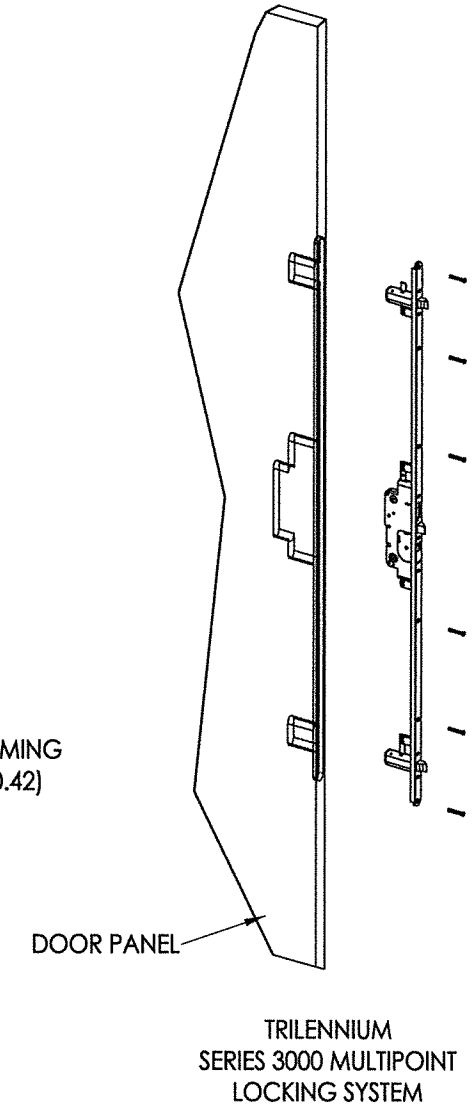
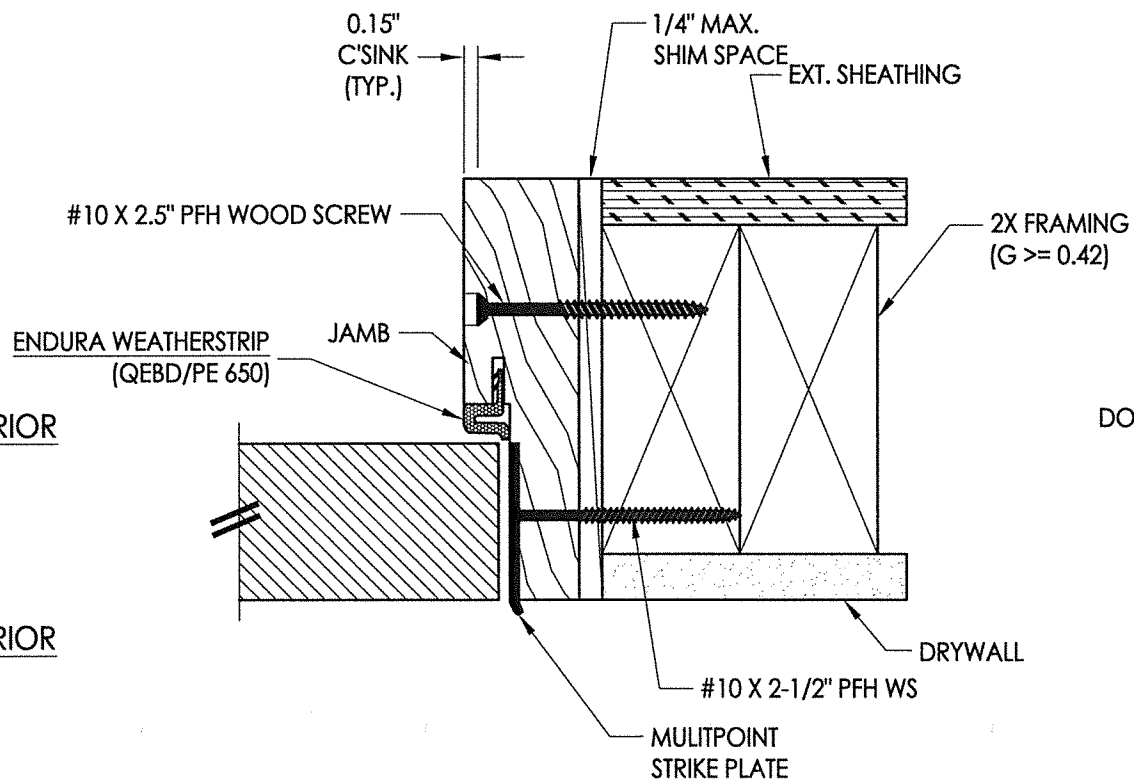

Documents Prepared By: Lyndon F. Schmidt, P.E.  
TEXAS P.E. #104123

**RW** BUILDING CONSULTANTS, INC.  
P.O. Box 230 Vairico FL 33595  
Phone No.: 813.659.9197

TEXAS BOARD OF PROFESSIONAL ENGINEERS  
CERTIFICATE OF REGISTRATION # F-11852

PRODUCT:	ENDURA	
PART OR ASSEMBLY:	HORIZONTAL & VERTICAL CROSS SECTIONS	
NO.	DATE	BY
2	11/11/21	LFS
1	10/08/18	LFS
REVISIONS		
DATE:	11/09/16	
SCALE:	N.T.S.	
DWG. BY:	JK	
CHK. BY:	LFS	
DRAWING NO.:	TX-4663	
SHEET	4	OF 6

Z:\Clients\Endura PERMANENT B - Texas Dept of Ins\TDI - DR-709 Plastpro FG Glazed\C - Drawings\TX-4663.65.dwg

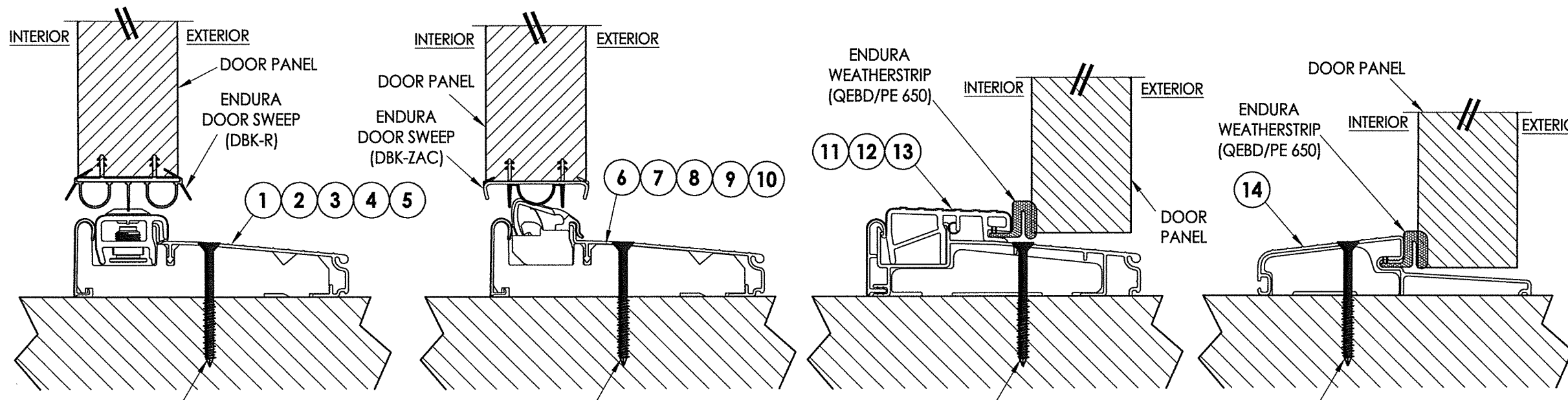

#10 X 2.5" PFH WOOD SCREW OR  
1/4" X 2-3/4" DeWALT OR ITW CONCRETE SCREW

#10 X 2.5" PFH WOOD SCREW OR  
1/4" X 2-3/4" DeWALT OR ITW CONCRETE SCREW

#10 X 2.5" PFH WOOD SCREW OR  
1/4" X 2-3/4" DeWALT OR ITW CONCRETE SCREW

#10 X 2.5" PFH WOOD SCREW OR  
1/4" X 2-3/4" DeWALT OR ITW CONCRETE SCREW

**1 VERTICAL CROSS SECTION**  
5 Inswing Adjustable Threshold

**2 VERTICAL CROSS SECTION**  
5 Inswing Articulating Threshold

**3 VERTICAL CROSS SECTION**  
5 Outswing Bump Threshold

**4 VERTICAL CROSS SECTION**  
5 Outswing Bump Threshold

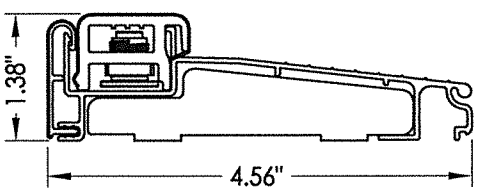

**1 INSWING ADJUSTABLE THRESHOLD**  
ZAIL4565

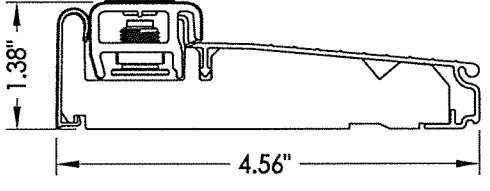

**2 INSWING ADJUSTABLE THRESHOLD**  
ZAI4565FN

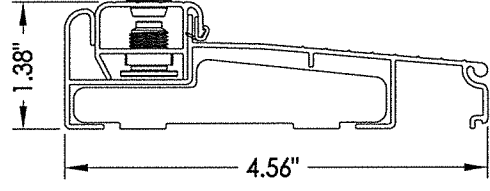

**3 INSWING ADJUSTABLE THRESHOLD**  
ZAILAA4565

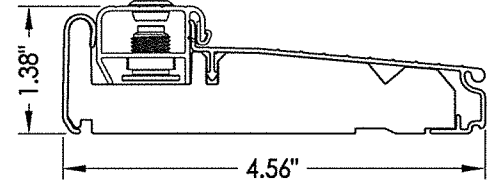

**4 INSWING ADJUSTABLE THRESHOLD**  
ZAIAA4565FN

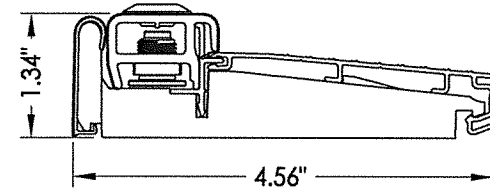

**5 INSWING ADJUSTABLE THRESHOLD**  
ZAI4565RDS

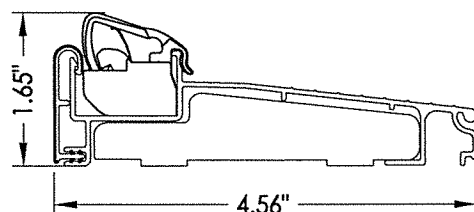

**6 INSWING ARTICULATING THRESHOLD**  
ZACL4565

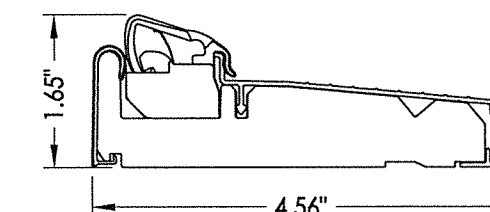

**7 INSWING ARTICULATING THRESHOLD**  
ZAC4565FN

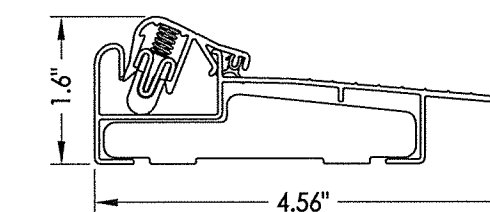

**8 INSWING ARTICULATING THRESHOLD**  
ZACLAA4565

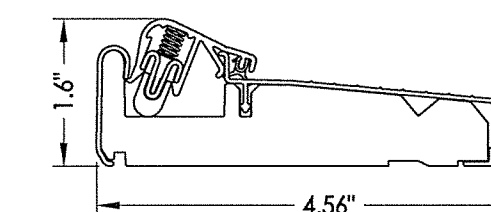

**9 INSWING ARTICULATING THRESHOLD**  
ZACAA4565FN

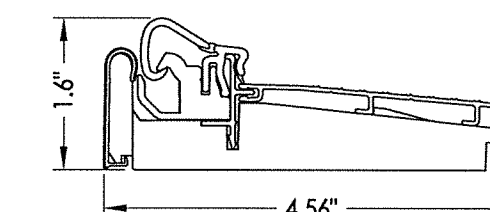

**10 INSWING ARTICULATING THRESHOLD**  
ZAC4565RDS

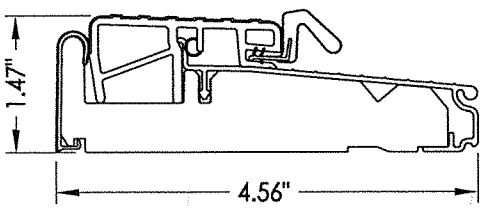

**11 OUTSWING THRESHOLD**  
ZOB4565FN

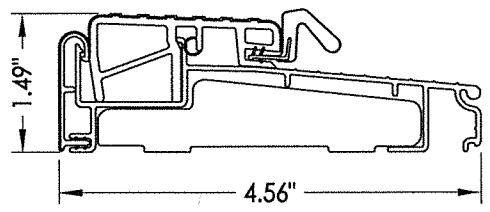

**12 OUTSWING THRESHOLD**  
ZOBL4565

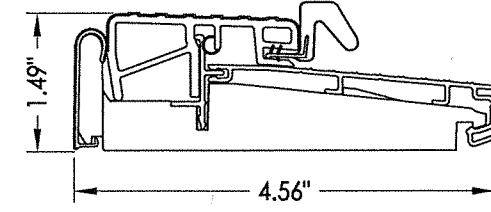

**13 OUTSWING THRESHOLD**  
ZOB4565RDS

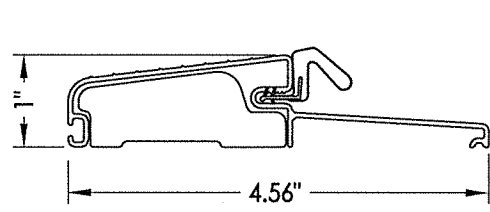

**14 OUTSWING THRESHOLD**  
FOB4566

MAX. DESIGN PRESSURE = ±55 PSF

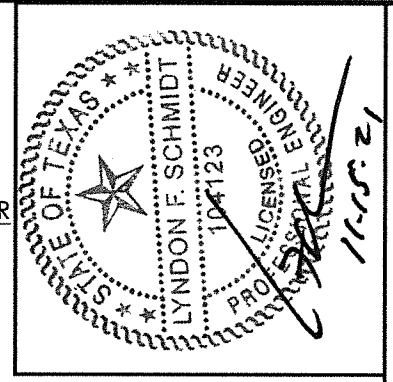

Documents Prepared By: Lyndon F. Schmidt, P.E.  
TEXAS P.E. #104123

**RW** BUILDING CONSULTANTS, INC.  
P.O. Box 230 Valrico FL 33595  
Phone No.: 813.659.9197  
TEXAS BOARD OF PROFESSIONAL ENGINEERS  
CERTIFICATE OF REGISTRATION # F-11852

PRODUCT: ENDURA  
PART OR ASSEMBLY:  
VERTICAL CROSS SECTIONS

NO.	DATE	BY
2	11/11/21	LFS
1	10/08/18	LFS

REVISIONS

DATE: 11/09/16  
SCALE: N.T.S.  
DWG. BY: JK  
CHK. BY: LFS  
DRAWING NO.: TX-4663  
SHEET 5 OF 6

© 2016 R.W. BUILDING CONSULTANTS INC.

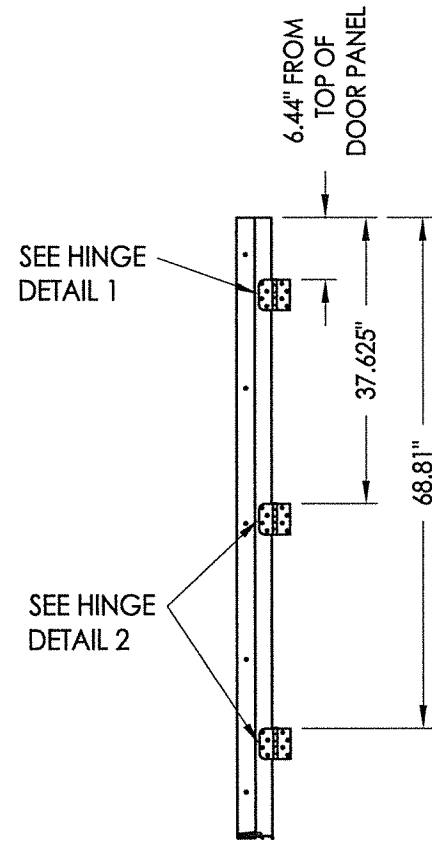

**HINGE JAMB**

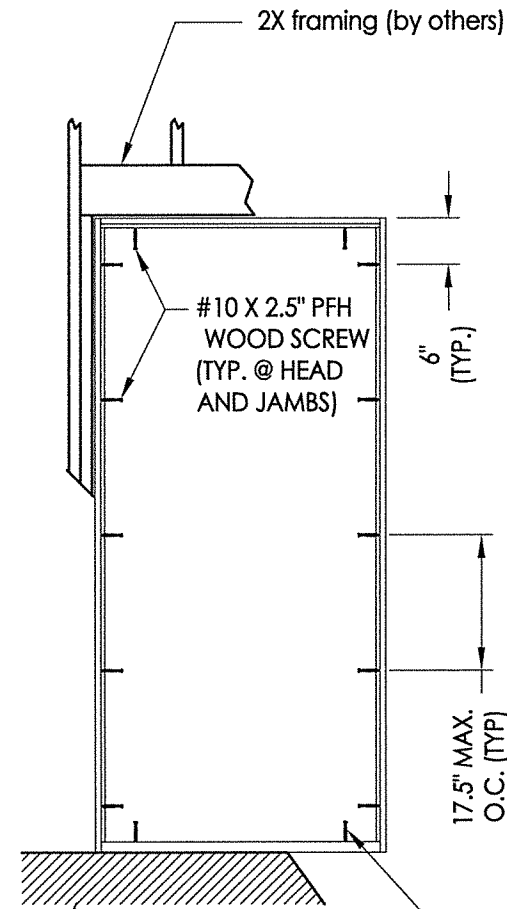

**FRAME ANCHORING**

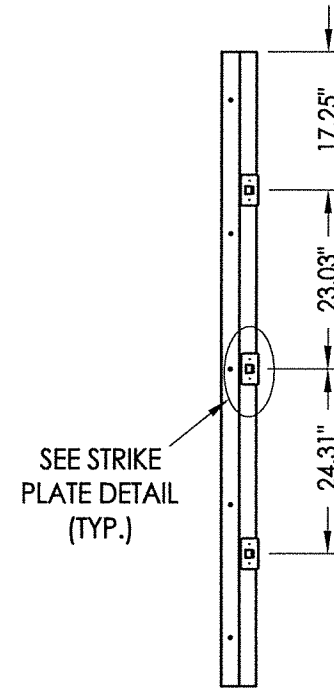

**STRIKE JAMB**

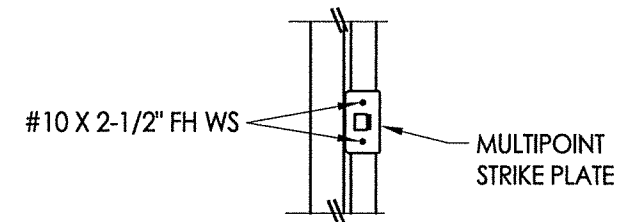

**STRIKE PLATE DETAIL**

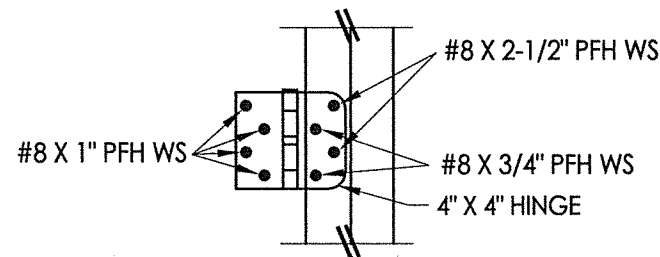

**HINGE DETAIL 1**

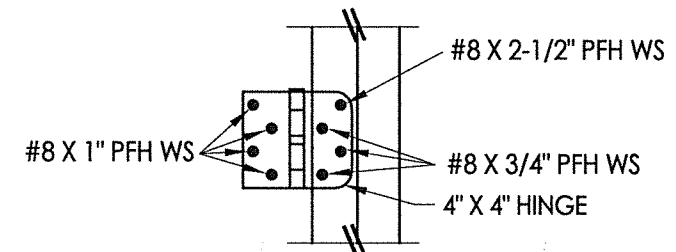

**HINGE DETAIL 2**

FLOOR SUBSTRATE MATERIAL (TYP.)  
 CONCRETE (MIN. 3000 PSI)  
 WOOD (G >= 0.42)

**CONCRETE ANCHOR NOTES:**

1. Concrete anchor locations at the corners may be adjusted to maintain the min. edge distance to mortar joints.
2. Concrete anchor locations noted as "MAX. ON CENTER" must be adjusted to maintain the min. edge distance to mortar joints, additional concrete anchors may be required to ensure the "MAX. ON CENTER" dimension are not exceeded.
3. Concrete anchor table:

ANCHOR TYPE	ANCHOR SIZE	MIN. EMBEDMENT	MIN. CLEARANCE TO MASONRY EDGE	MIN. CLEARANCE TO ADJACENT ANCHOR
ITW TAPCON®	1/4"	1-3/4"	1-1/2"	4"
DeWALT ULTRACON+®	1/4"	1-3/4"	1"	4"

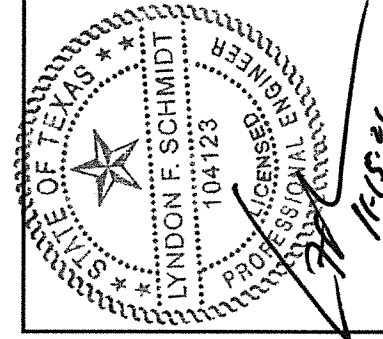

Documents Prepared By: Lyndon F. Schmidt, P.E.  
 TEXAS P.E. #104123

**RW** BUILDING CONSULTANTS, INC.  
 P.O. Box 230 Vairlico FL 33595  
 Phone No.: 813.659.9197

PRODUCT: ENDURA  
 PART OR ASSEMBLY: FRAME ANCHORING

NO.	DATE	REVISIONS
2	11/11/21	UPDATE TO 2018 IBC/IRC CODE
1	10/08/18	ADDED FLUSH GLAZING
		LFS
		BY

DATE: 11/09/16  
 SCALE: N.T.S.  
 DWG. BY: JK  
 CHK. BY: LFS  
 DRAWING NO.: TX-4663  
 SHEET 6 OF 6