

# THERMA TRU<sup>®</sup> DOORS

Fiber-Classic<sup>®</sup> & Smooth-Star<sup>®</sup>

## "VENTED" SIDELITES W/ GLAZED FIBERGLASS DOOR IN SWING "NON-IMPACT"

### EVALUATED FOR USE IN THE STATE OF TEXAS

The Fiberglass Door system described herein complies with the 2018 International Residential Code (IRC), Sections R301 & R609 and the 2018 International Building Code (IBC), Sections 1404.13, 1609, 1709.5, 2403 and 2404 subject to the following conditions:

1. Anchors shall be as listed and spaced as shown in the details. Anchor embedment to base material shall be beyond wall dressing or stucco.
2. When used in areas requiring wind-borne debris protection this product is required to be protected with an impact resistant covering that complies with Section R301.2.1.2 of the IRC and Section 1609.1.2 of the IBC.
3. Allowable design pressure requirements must be equal to or less than the design pressure rating shown in the design pressure chart, sheet 1 of this drawing.
4. Conditions not covered by this drawing are subject to further engineering analysis.
5. Fiber-Classic and Smooth-Star Door and Sidelite panels require the use of "J" part numbers. These door and sidelite panels must be stained or painted within six months of installation.

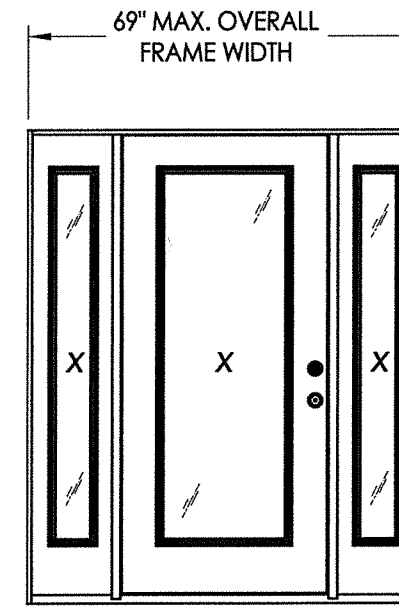
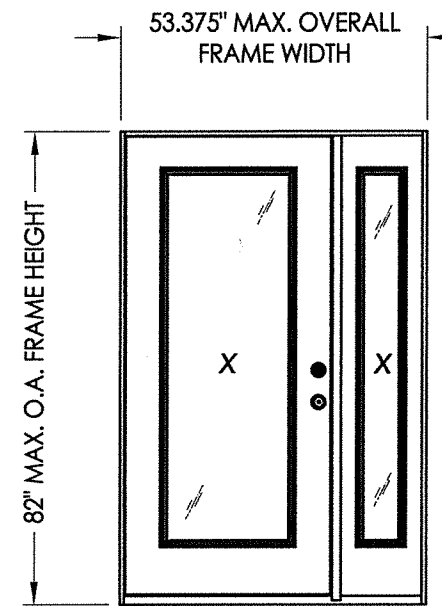
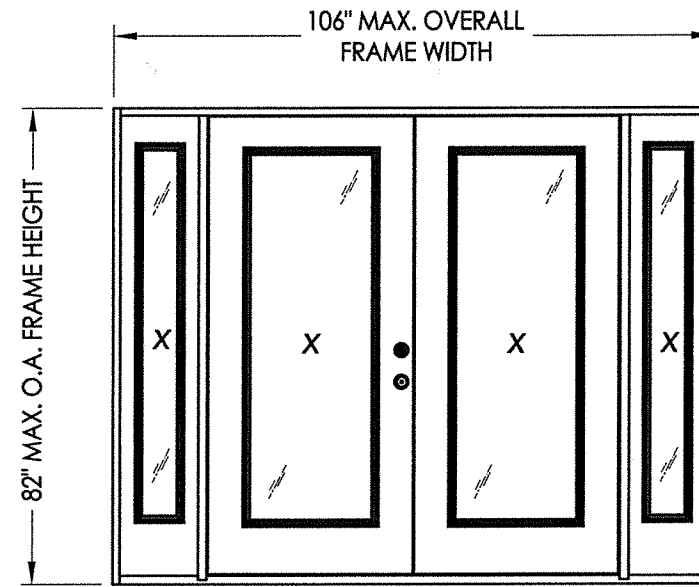
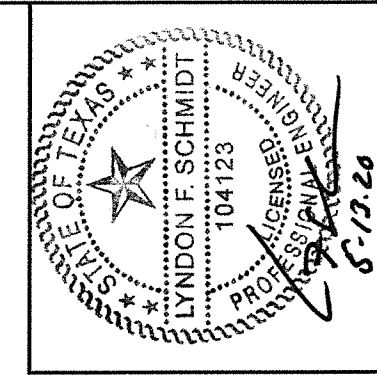

TABLE OF CONTENTS	
SHEET#	DESCRIPTION
1	Typical elevations, design pressures & general notes
2	Door panel details
3	Sidelite panel details and glazing details
4	Elevations
5	Horizontal cross sections
6	Vertical cross sections
7	Frame anchoring
8	Hardware details
9	Hardware strike details
10	Bill of materials and components

CONFIGURATION	MAX. FRAME DIMENSION	DOOR GLAZING TYPE	DESIGN PRESSURE (PSF) Multi-Point Door Lock		DESIGN PRESSURE (PSF) Lock & Deadbolt	
			POSITIVE	NEGATIVE	POSITIVE	NEGATIVE
XX	53.375" x 82.0"	FLUSH GLAZING	+55.0	-55.0	+65.0	-65.0
		LIP LITE GLAZING	+40.0	-40.0	+45.0	-45.0
XXX	69.0" x 82.0"	FLUSH GLAZING	+55.0	-55.0	+65.0	-65.0
		LIP LITE GLAZING	+40.0	-40.0	+45.0	-45.0
XXXX	106.0" x 82.0"	FLUSH GLAZING	+55.0	-55.0	+30.0	-30.0
		LIP LITE GLAZING	+30.0	-30.0	+40.0	-40.0



Documents Prepared By: Lyndon F. Schmidt, P.E.  
TEXAS P.E. #104123

**RW** BUILDING CONSULTANTS, INC.  
P.O. Box 230 Vairico FL 33595  
Phone No.: 813.659.9197  
TEXAS BOARD OF PROFESSIONAL ENGINEERS  
CERTIFICATE OF REGISTRATION # F-11852

PRODUCT: THERMA TRU  
PART OR ASSEMBLY:  
TYPICAL ELEVATION, DESIGN PRESSURES & GENERAL NOTES

NO.	DATE	BY	REVISIONS
2	5/13/20	LFS	UPDATE TO 2018 IBC/IRC CODE
1	7/16/15	LFS	ADDED GENERAL NOTE 5.

DATE: 1/2/13  
SCALE: N.T.S.  
DWG. BY: JK  
CHK. BY: LFS  
DRAWING NO.: TX-4293  
SHEET 1 OF 10



R:\Clients\Therma Tru PERMANENT\B - Texas Dept of Ins\TDI - DR 641 - 68 - 80 Glazed SS FG NonImp IS Vented Sidelites\C - Drawings\TX-4293.dwg, 3.2

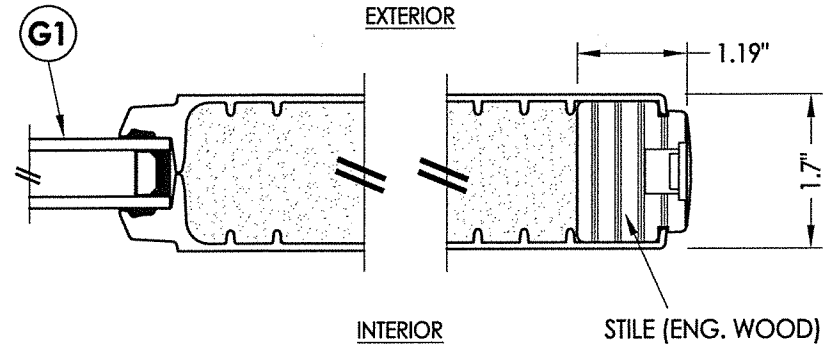

**1** HORIZONTAL CROSS SECTION  
**3** Flush Glazing

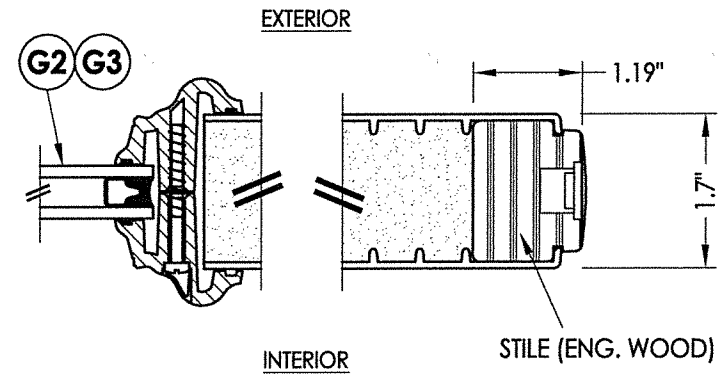

**1** HORIZONTAL CROSS SECTION  
**3** Lip Lite Glazing

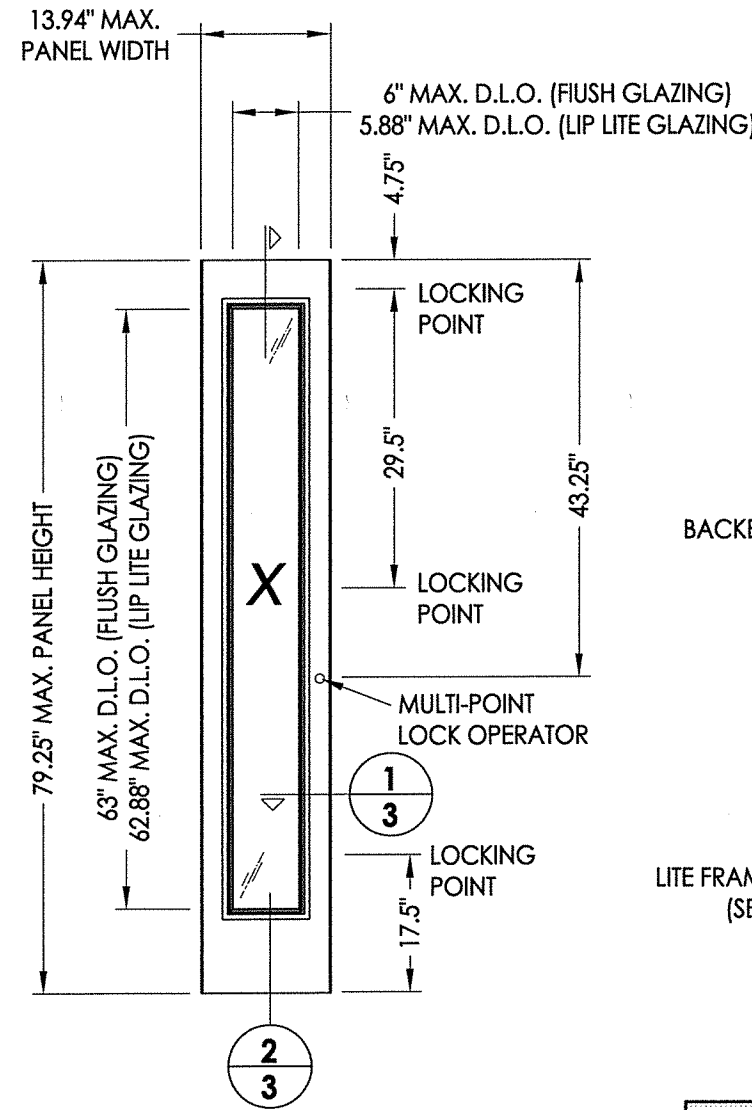

**50** SIDELITE PANEL  
VENTED

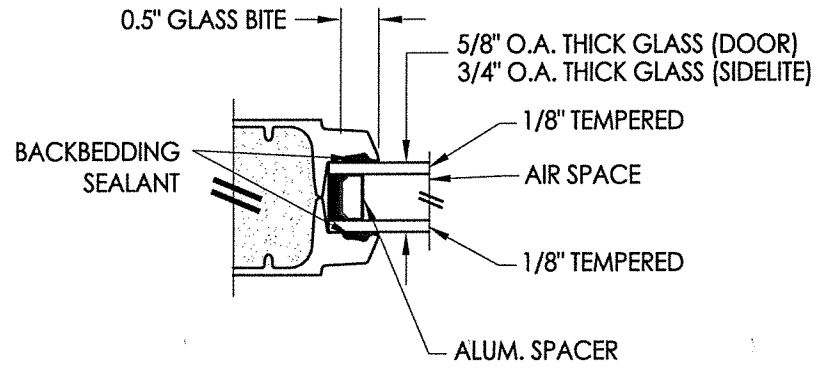

**G1** GLAZING DETAIL (3/4" IG)  
Flush Glazed

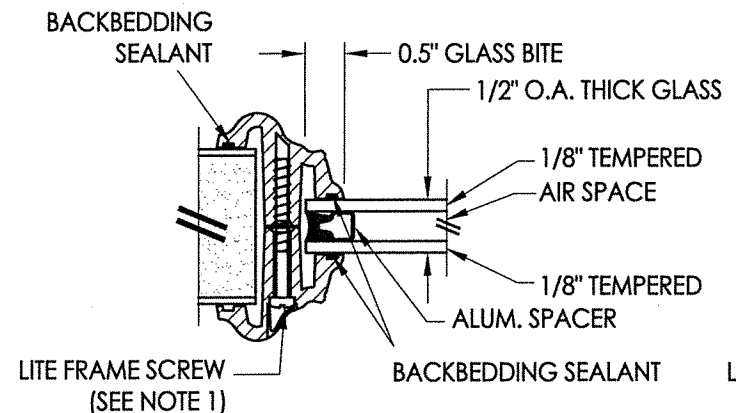

**G2** GLAZING DETAIL (1/2" IG)  
Lip Lite Frame (BTS)

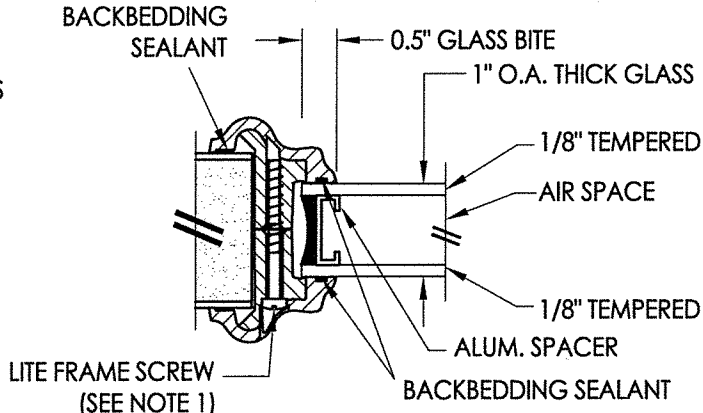

**G3** GLAZING DETAIL (1" IG)  
Lip Lite Frame (BTS)

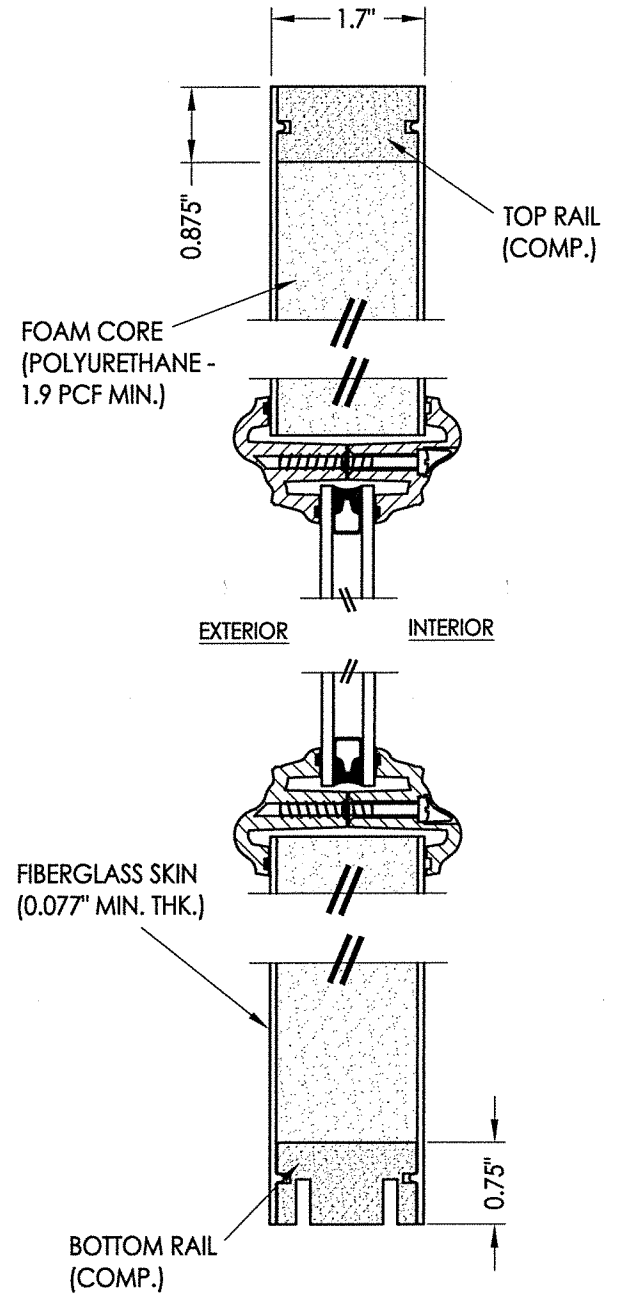

**2** VERTICAL CROSS SECTION  
**3**

HARDWARE TABLE	
MANUFACTURER	MODEL
HOPPE	MULTI-POINT: OSL SERIES (Sidelite)

NOTE:  
1. Lite frame screws (#8 x 1-1/2" PH SMS), 14 total per sidelite, evenly spaced.  
2. Lite frame screws (#8 x 1-1/2" PH SMS), 18 total per door, evenly spaced.

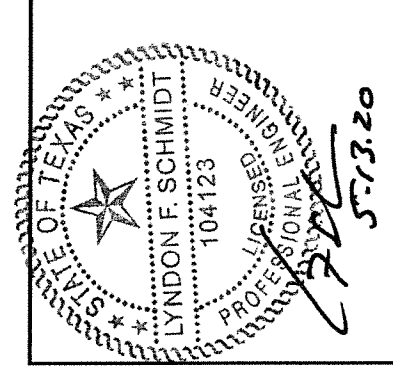

Documents Prepared By: Lyndon F. Schmidt, P.E.  
TEXAS P.E. #104123

**RW** BUILDING CONSULTANTS, INC.  
P.O. Box 230 Valrico FL 33595  
Phone No.: 813.659.9197  
TEXAS BOARD OF PROFESSIONAL ENGINEERS  
CERTIFICATE OF REGISTRATION # F-11852

PRODUCT:	Therma-Tru	
PART OR ASSEMBLY:	SIDELITE PANEL DETAILS & GLAZING DETAILS	
NO.	DATE	BY
2	5/13/20	LFS
1	7/16/15	LFS
REVISIONS		
DATE:	1/2/13	
SCALE:	N.T.S.	
DWG. BY:	JK	
CHK. BY:	LFS	
DRAWING NO.:	TX-4293	
SHEET	3 OF 10	

© 2013 R.W. BUILDING CONSULTANTS INC.

R:\Clients\Therma Tru PERMANENT\B - Texas Dept of Ins\TDI - DR 641 - 68 - 80 Glazed SS FG NonImp IS Vented Sidelites\C - Drawings\TX-4293.dwg, 4.2

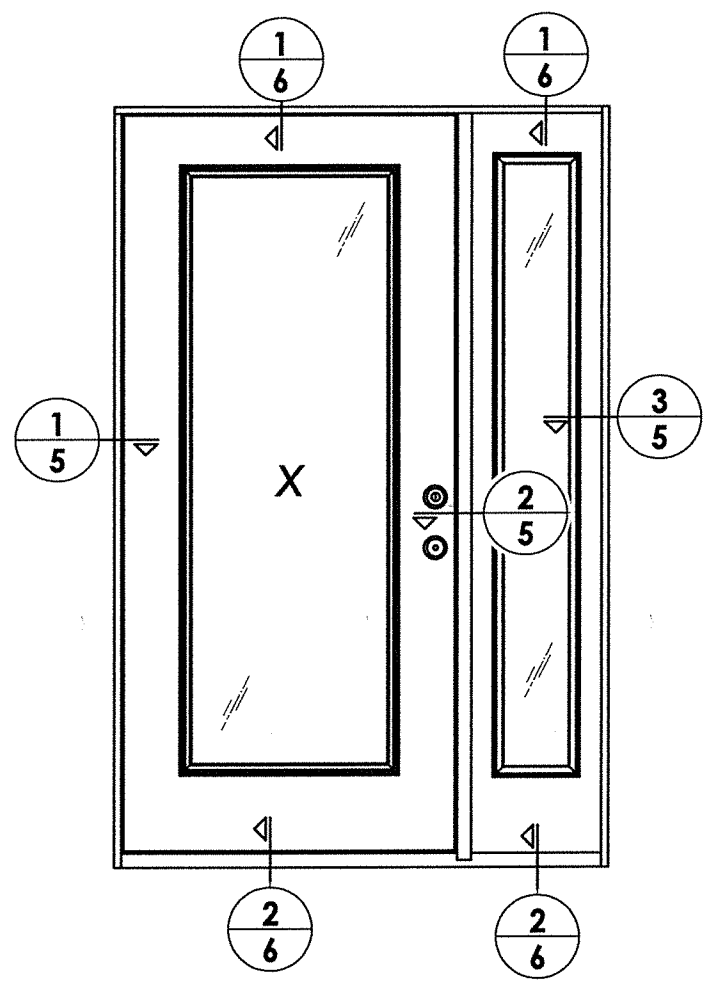

ELEVATION  
XX

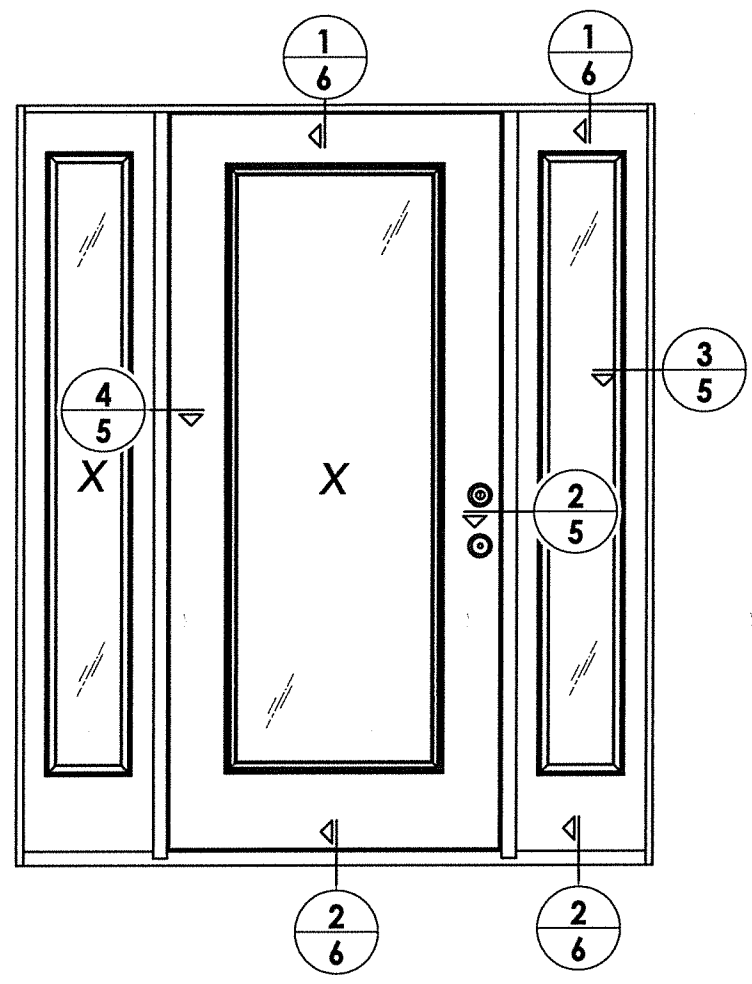

ELEVATION  
XXX

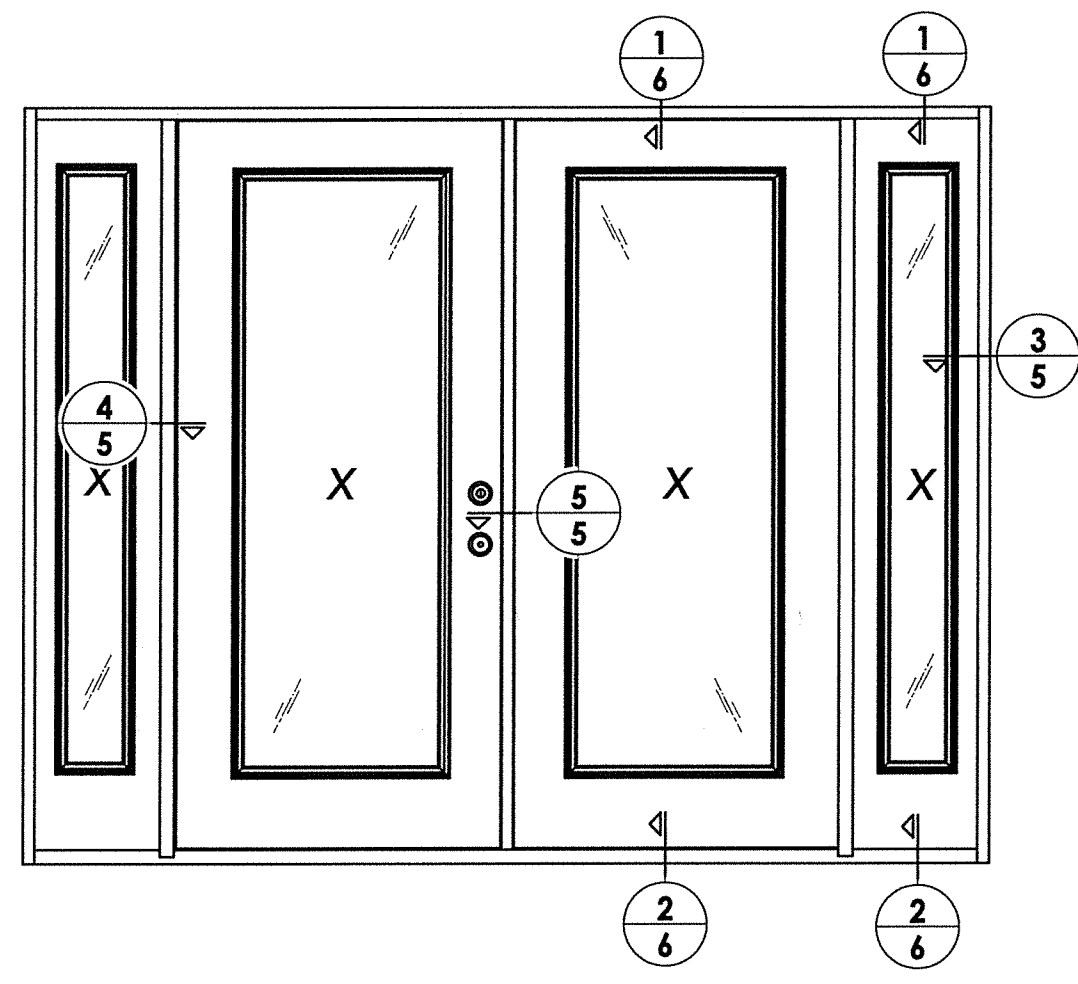

ELEVATION  
XXXX

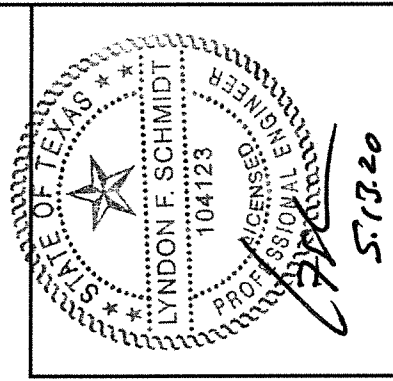

Documents Prepared By: Lyndon F. Schmidt, P.E.  
TEXAS P.E. #104123

**RW** BUILDING CONSULTANTS, INC.  
P.O. Box 230 Valrico FL 33595  
Phone No.: 813.659.9197

TEXAS BOARD OF PROFESSIONAL ENGINEERS  
CERTIFICATE OF REGISTRATION # F-11852

PRODUCT: THERMA-TRU	
PART OR ASSEMBLY: ELEVATIONS	
NO.	DATE
2	5/13/20
1	7/16/15
REVISIONS	
DATE: 1/2/13	
SCALE: N.T.S.	
DWG. BY: JK	
CHK. BY: LFS	
DRAWING NO.: TX-4293	
SHEET 4 of 10	





\* The frame jambs and vertical mullions are secured to the head and sill with (3) #8 x 2-1/2" wood screws each.

2X FRAMING TO BE DESIGNED BY THE ENGINEER OR ARCHITECT OF RECORD (TYP.)

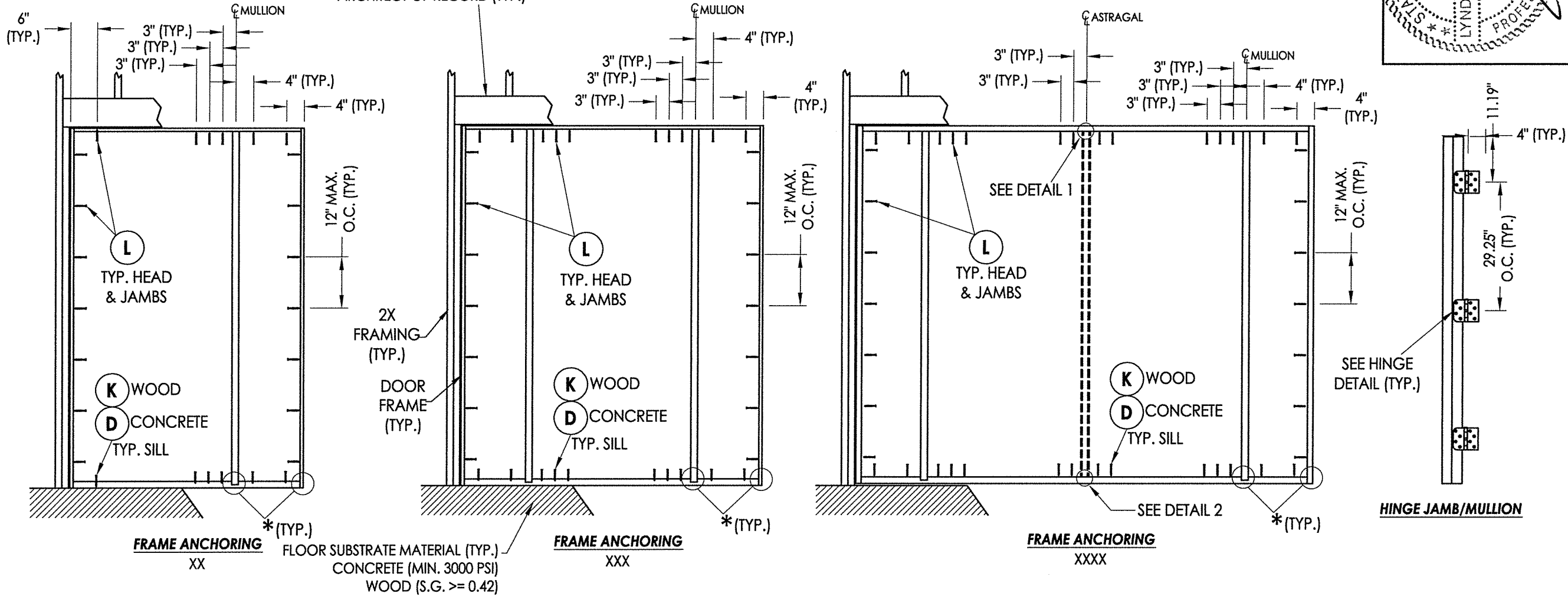

**CONCRETE ANCHOR NOTES:**

- Concrete anchor locations at the corners may be adjusted to maintain the min. edge distance to mortar joints.
- Concrete anchor locations noted as "MAX. ON CENTER" must be adjusted to maintain the min. edge distance to mortar joints, additional concrete anchors may be required to ensure the "MAX. ON CENTER" dimension are not exceeded.
- Concrete anchor table:

ANCHOR TYPE	ANCHOR SIZE	MIN. EMBEDMENT	MIN. CLEARANCE TO MASONRY EDGE	MIN. CLEARANCE TO ADJACENT ANCHOR
ITW TAPCON®	1/4"	1-3/4"	2-1/2"	3"
ELCO ULTRACON®	1/4"	1-3/4"	1"	3"

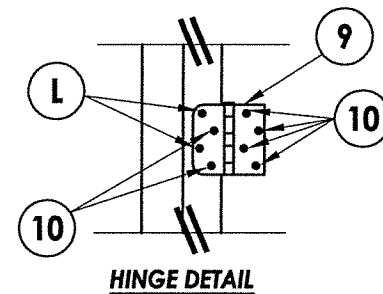
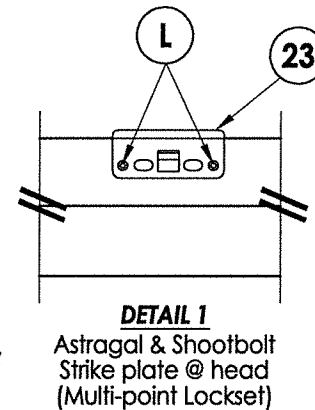
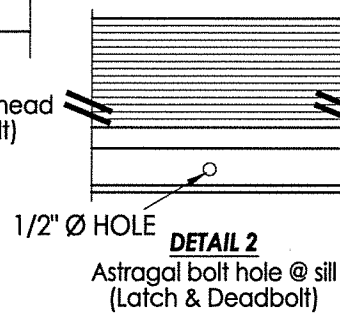
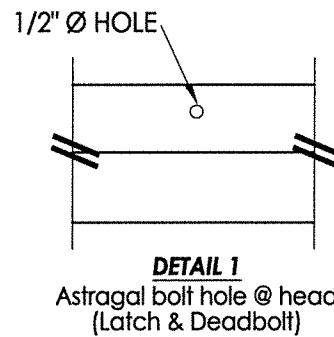

HINGE JAMB/MULLION

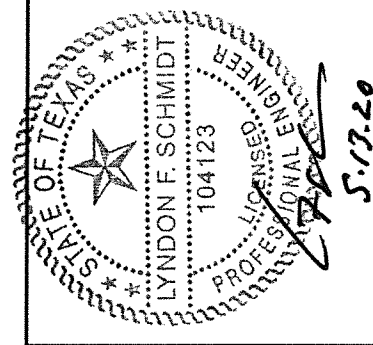

Documents Prepared By: Lyndon F. Schmidt, P.E.  
TEXAS P.E. #104123

RW BUILDING CONSULTANTS, INC.  
P.O. Box 230 Valrico FL 33595  
Phone No.: 813.659.9197  
TEXAS BOARD OF PROFESSIONAL ENGINEERS  
CERTIFICATE OF REGISTRATION # F-11852

PRODUCT: THERMA-TRU

PART OR ASSEMBLY: FRAME ANCHORING

NO.	DATE	BY	REVISIONS
2	5/13/20	LFS	UPDATE TO 2018 IBC/IRC CODE
1	7/16/15	LFS	ADDED GENERAL NOTE 5.

DATE: 1/2/13

SCALE: N.T.S.

DWG. BY: JK

CHK. BY: LFS

DRAWING NO.: TX-4293

SHEET 7 OF 10





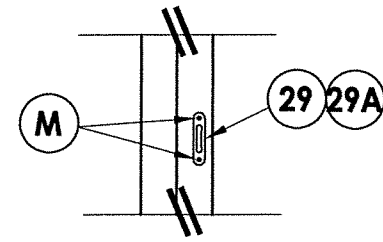

**TONGUE STRIKE DETAIL**  
Single Door/Sidelite

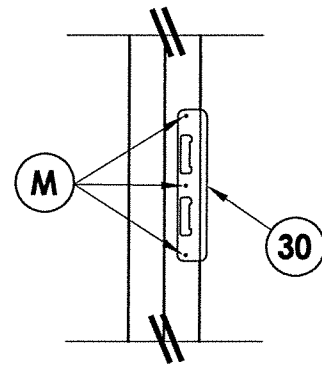

**LATCH & DEADBOLT DETAIL**  
Single Door

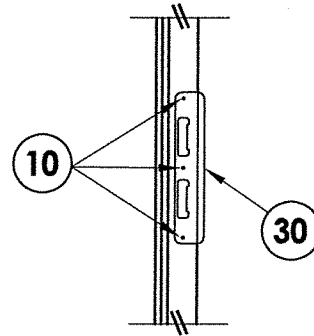

**LATCH & DEADBOLT DETAIL**  
Double Door

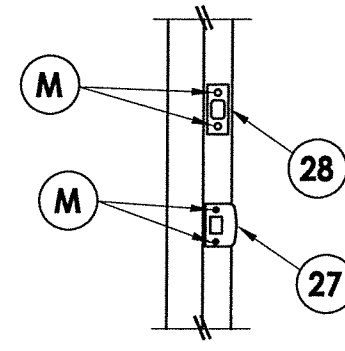

**LATCH & DEADBOLT DETAIL**  
Single Door

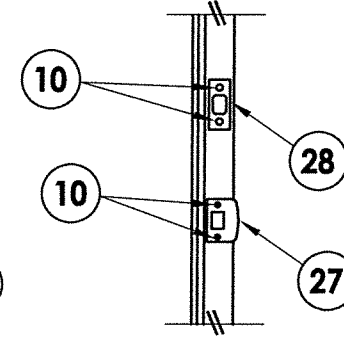

**LATCH & DEADBOLT DETAIL**  
Double Door

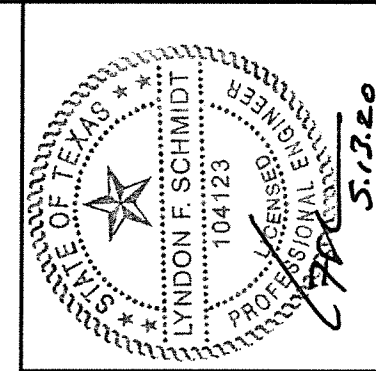

Documents Prepared By: Lyndon F. Schmidt, P.E.  
TEXAS P.E. #104123

**RW** BUILDING CONSULTANTS, INC.  
P.O. Box 230 Valrico FL 33595  
Phone No.: 813.659.9197  
TEXAS BOARD OF PROFESSIONAL ENGINEERS  
CERTIFICATE OF REGISTRATION # F-11852

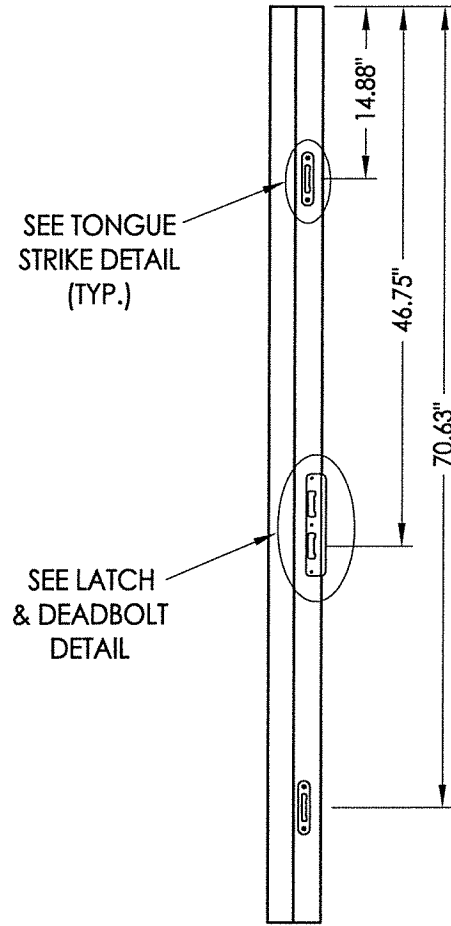

**STRIKE JAMB / MULLION**  
Single Door

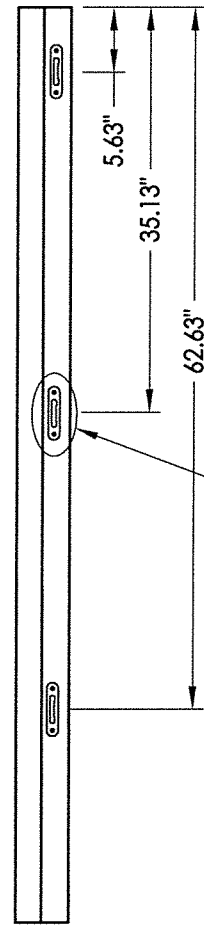

**STRIKE MULLION**  
Sidelite

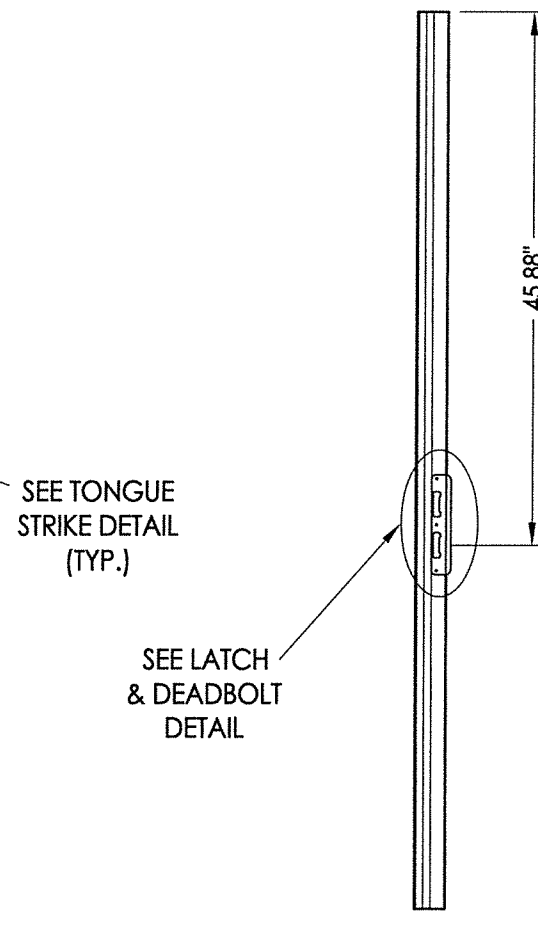

**ASTRAGAL STRIKE**  
Double Door

**MULTI-POINT LOCK STRIKE DETAILS**

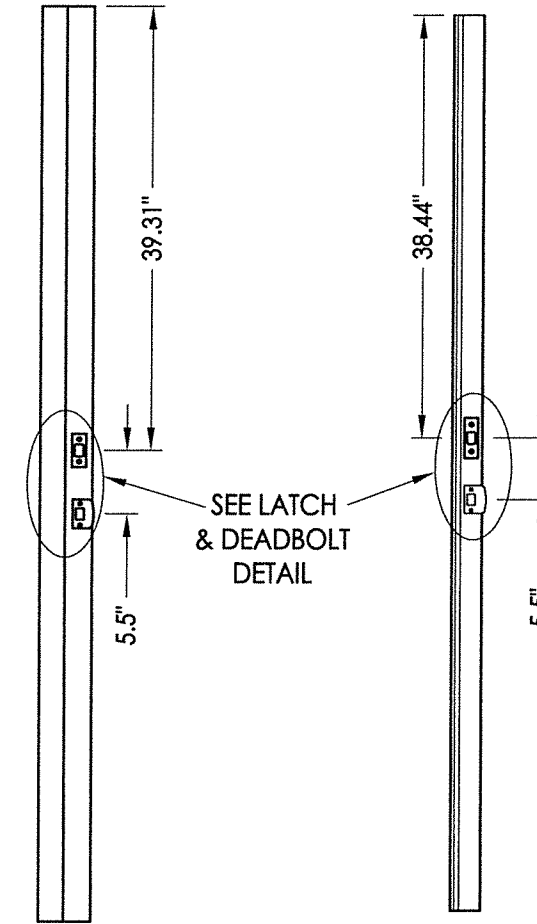

**STRIKE JAMB / MULLION**  
Single Door

**ASTRAGAL STRIKE**  
Double Door

**LATCH & DEADBOLT STRIKE DETAILS**

PRODUCT:	THERMA-TRU
PART OR ASSEMBLY:	HARDWARE STRIKE DETAILS

NO.	DATE	BY	REVISIONS
2	5/13/20	LFS	UPDATE TO 2018 IBC/IRC CODE
1	7/16/15	LFS	ADDED GENERAL NOTE 5.

DATE:	1/2/13
SCALE:	N.T.S.
DWG. BY:	JK
CHK. BY:	LFS
DRAWING NO.:	TX-4293
SHEET	9 of 10

R:\Clients\Therma Tru PERMANENT\B - Texas Dept of Ins\TDI - DR 641 - 68 - 80 Glazed SS FG NonImp IS Vented Sidelites\C - Drawings\TX-4293.dwg, 10.2

BILL OF MATERIALS		
ITEM #	DESCRIPTION	MATERIAL
A	2X FRAMING (G >= 0.42)	WOOD
C	1/4" MAX. SHIM SPACE	-
D	1/4" ELCO OR ITW CONCRETE SCREW (1-3/4" MIN. EMBEDMENT)	STEEL
K	#12 X 3" PFH WOOD SCREW (1-1/2" MIN. EMBEDMENT)	STEEL
L	#10 X 2-1/2" PFH WOOD SCREW (1.15" MIN. EMBEDMENT)	STEEL
M	#8 X 1-1/4" PFH WOOD SCREW	STEEL
1	HEAD AND SIDE JAMB (FINGER-JONTEDED PINE) (G >= 0.42)	WOOD
2	INTEGRAL MULLION (FINGER-JONTEDED PINE) (G >= 0.42)	WOOD
7	WEATHER-STRIP (THERMA-TRU)	FOAM
8	DOOR BOTTOM SWEEP	PVC
9	4" X 4" HINGE	STEEL
10	#10 X 3/4" PFH WOOD SCREW	STEEL
11	#10 X 1-3/4" PFH WOOD SCREW	STEEL
22	COASTAL ALUMINUM ASTRAGAL	ALUM
23	ASTRAGAL & SHOOTBOLT STRIKE PLATE (AT HEAD)	STEEL
24	ASTRAGAL & SHOOTBOLT STRIKE PLATE (AT SILL)	STEEL
27	LATCH STRIKE PLATE (STANDARD)	STEEL
28	DEADBOLT PLATE (STANDARD)	STEEL
29	TONGUE STRIKE PLATE (DOOR TONGUE SYSTEM)	STEEL
29A	TONGUE STRIKE PLATE (SIDELITE TONGUE SYSTEM)	STEEL
30	LATCH & DEADBOLT STRIKE PLATE (TONGUE SYSTEM)	STEEL
33	INSWING THRESHOLD	ALUM/COMP
40	FIBERGLASS DOOR PANEL -SMOOTH STAR/ FIBER CLASSIC	-
50	FIBERGLASS SIDELITE PANEL -SMOOTH STAR/ FIBER CLASSIC	-

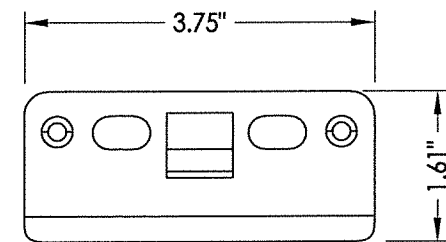

**23** **ASTRAGAL & SHOOTBOLT**  
Strike plate @ head

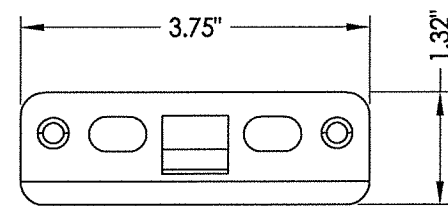

**24** **ASTRAGAL & SHOOTBOLT**  
Strike plate @ sill

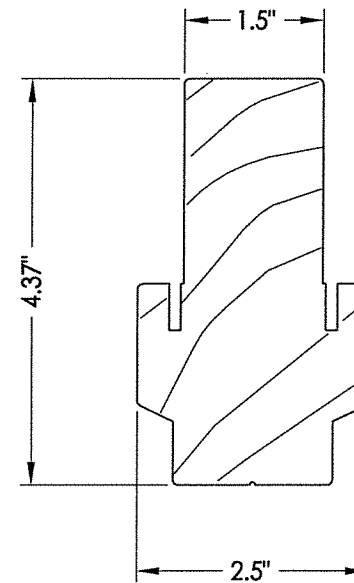

**2** **INTEGRAL MULLION**

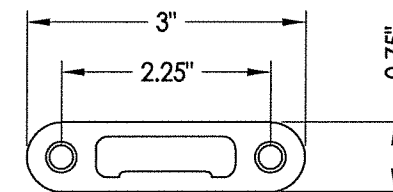

**29A** **TONGUE STRIKE PLATE**  
Sidelite Tongue system

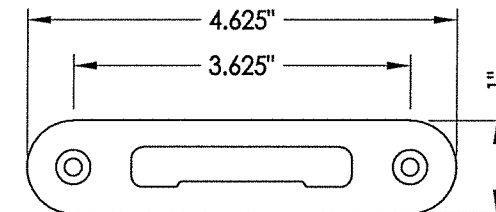

**29** **TONGUE STRIKE PLATE**  
Door Tongue system

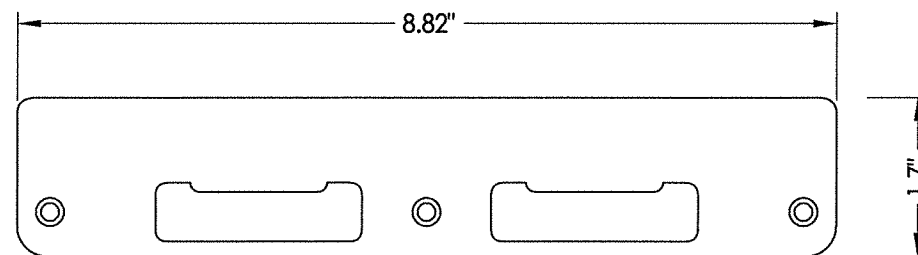

**30** **LATCH & DEADBOLT STRIKE PLATE**  
Tongue system

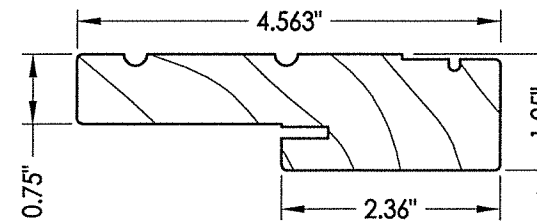

**1** **HEAD & JAMB**

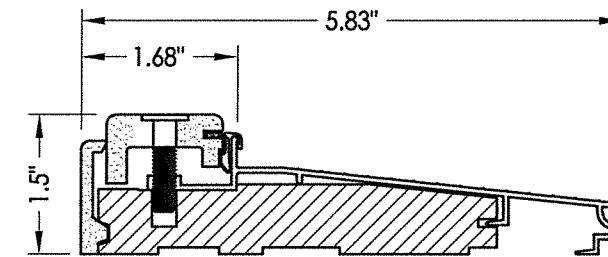

**33** **INSWING THRESHOLD**

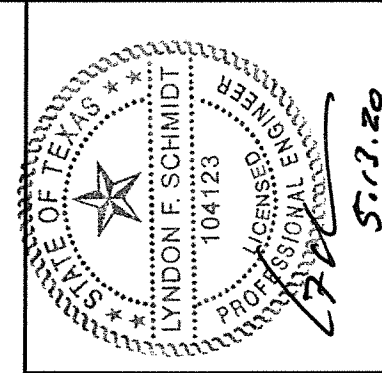

Documents Prepared By: Lyndon F. Schmidt, P.E.  
TEXAS P.E. #104123

**RW** BUILDING CONSULTANTS, INC.  
P.O. Box 230 Valrico FL 33595  
Phone No.: 813.659.9197  
TEXAS BOARD OF PROFESSIONAL ENGINEERS  
CERTIFICATE OF REGISTRATION # F-11852

PRODUCT: THERMA-TRU

PART OR ASSEMBLY:  
BILL OF MATERIAL &  
COMPONENTS

NO.	DATE	REVISIONS
2	5/13/20	UPDATE TO 2018 IBC/IRC CODE
1	7/16/15	ADDED GENERAL NOTE 5.
		LFS
		BY

DATE: 1/2/13  
SCALE: N.T.S.  
DWG. BY: JK  
CHK. BY: LFS  
DRAWING NO.: TX-4293  
SHEET 10 OF 10