



215 EAST ROOSEVELT AVE.
ZEELAND, MI 49464

Distributed by: Guardian Building Products
7603 Prairie Oak Drive
Building 6, Suite 100
Houston, TX 77086

FIBERGLASS ENTRY DOOR IN SWING / OUT SWING "IMPACT"

EVALUATED FOR USE IN THE STATE OF TEXAS

The Fiberglass Glazed Door described herein complies with the 2006 International Residential Code (IRC), Sections R301 & R613 and the 2006 International Building Code (IBC), Sections 1405.12, 1609, 1714.5, 2403 and 2404 (including Texas revisions) subject to the following conditions:

1. Anchors shall be as listed and spaced as shown in the details. Anchor embedment to base material shall be beyond wall dressing or stucco.
2. This system has been tested and evaluated as a large missile impact protective system for installation in the Seaward, Inland I and Inland II areas. This product meets missile level "D" as defined in ASTM E 1996.
3. Allowable design pressure requirements must be equal to or less than the design pressure rating shown in the design pressure chart, sheet 1 of this drawing.
4. Conditions not covered by this drawing are subject to further engineering analysis.

TABLE OF CONTENTS

| SHEET # | DESCRIPTION |
|---------|------------------------------------------------------|
| 1 | Typical elevations, design pressures & general notes |
| 2 | Door/Sidelite panel details |
| 3 | Lite frame and glazing details |
| 4 | Elevations |
| 5 | Horizontal cross sections |
| 6 | Vertical cross sections |
| 7 | Vertical cross sections |
| 8 | Frame anchoring |
| 9 | Astragal details |
| 10 | Bill of materials & components |

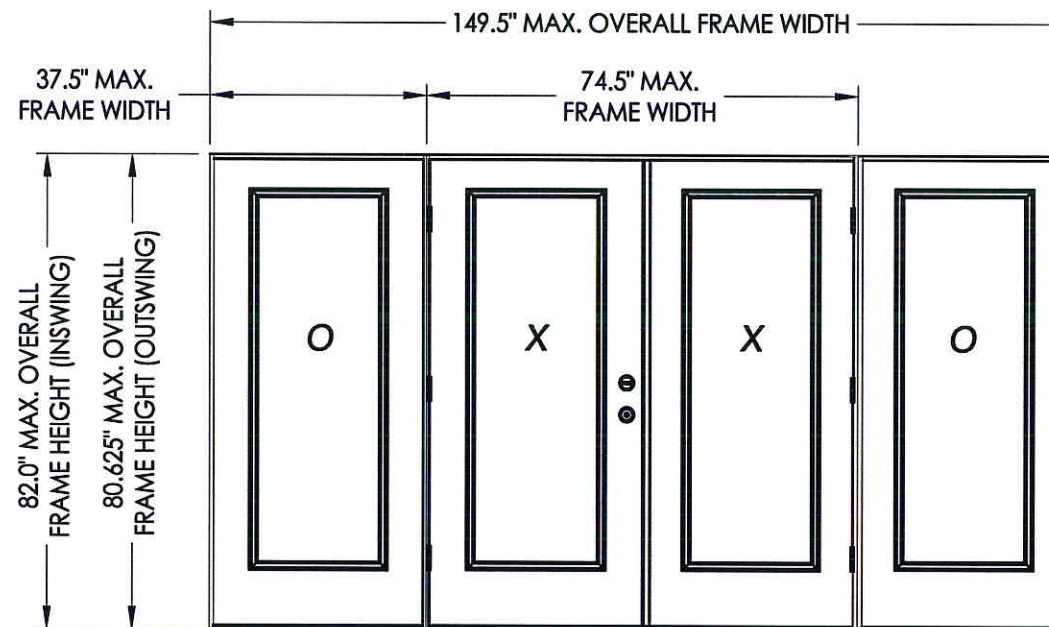
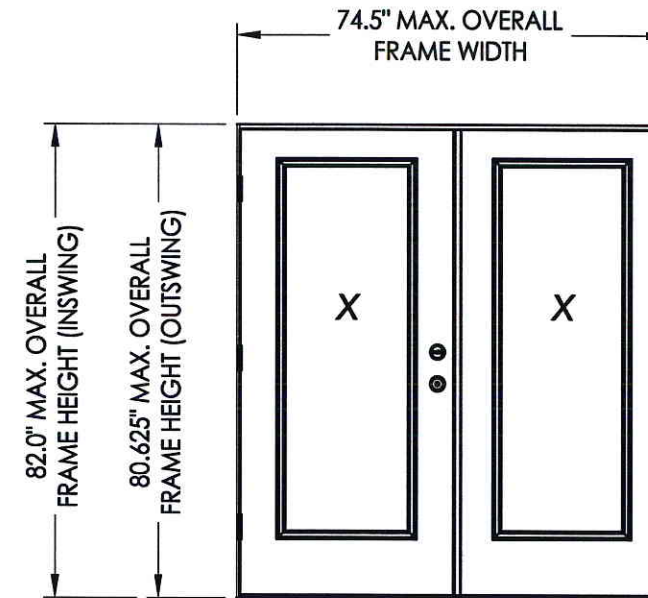

| CONFIGURATION | MAX. FRAME DIMENSION | DESIGN PRESSURE (PSF) INSWING | | DESIGN PRESSURE (PSF) OUTSWING | |
|---------------|----------------------|-------------------------------|----------|--------------------------------|----------|
| | | POSITIVE | NEGATIVE | POSITIVE | NEGATIVE |
| XX | 74.5" x 82.0" | +45.0 | -50.0 | +45.0 | -45.0 |
| OXXO | 149.5" x 82.0" | +45.0 | -50.0 | +45.0 | -45.0 |

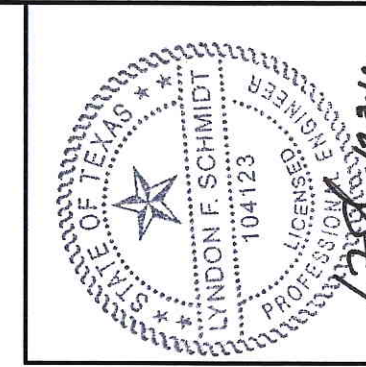

Documents Prepared By: Lyndon F. Schmidt, P.E.
TEXAS P.E. #104123

RW BUILDING CONSULTANTS, INC.
P.O. Box 230 Valrico FL 33595
Phone No.: 813.659.9197

TEXAS BOARD OF PROFESSIONAL ENGINEERS
CERTIFICATE OF REGISTRATION # F-11852

PRODUCT: FIBERGLASS DOOR
PART OR ASSEMBLY: TYPICAL ELEVATION, DESIGN PRESSURES & GENERAL NOTES

| NO. | DATE | BY | REVISIONS |
|-----|------|----|-----------|
| | | | |
| | | | |
| | | | |

DATE: 11/8/12
SCALE: N.T.S.
DWG. BY: JK
CHK. BY: LFS
DRAWING NO.: TX-4271
SHEET 1 OF 10

R:\A - Projects\Project Folders\Proj 1601 - 1700\PF 1676\D. RWBC Drawings\TX-4270-71.dwg, 2.2

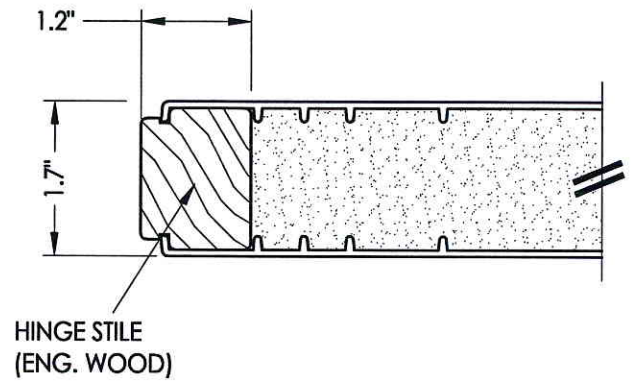

HINGE STILE
(ENG. WOOD)

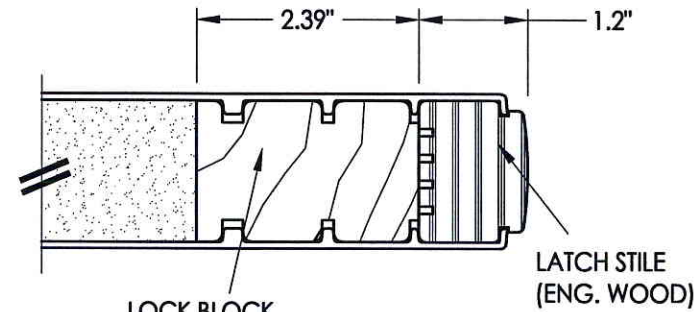

LOCK BLOCK
21.5" LONG (WOOD)

LATCH STILE
(ENG. WOOD)

1
2 HORIZONTAL CROSS SECTION

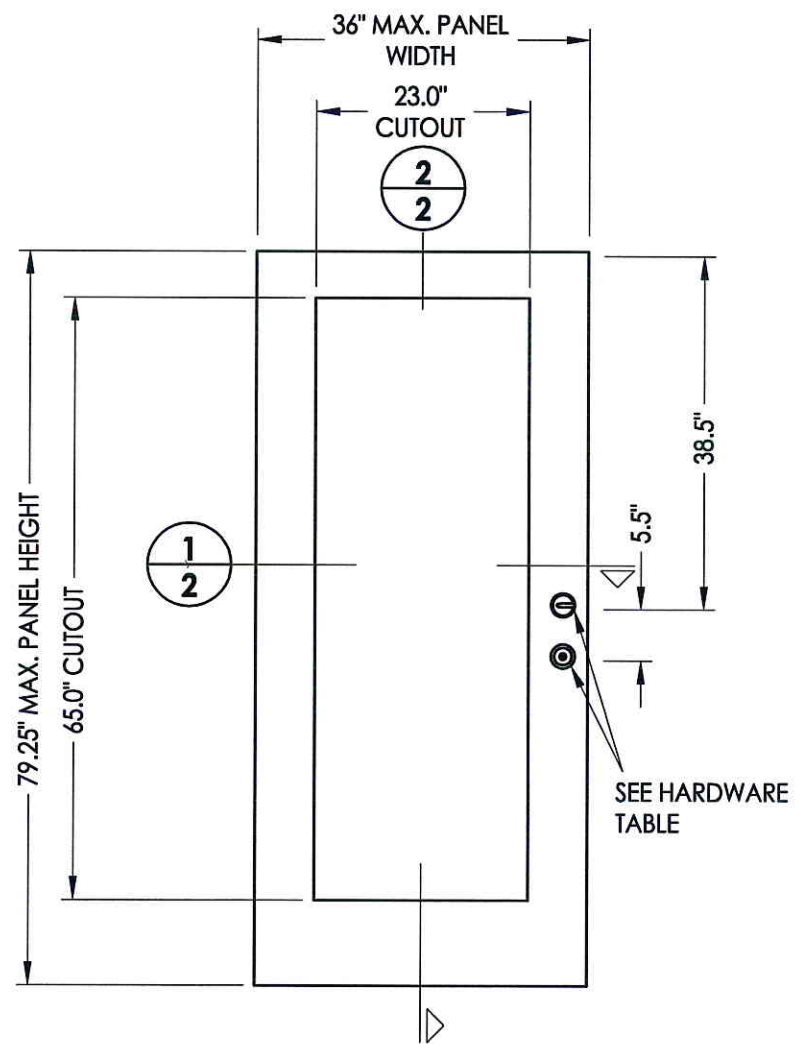

- 40 DOOR PANEL**
Fiber Classic (Therma-Tru)
- 50 SIDELITE PANEL**
Fiber Classic (Therma-Tru)

| HARDWARE TABLE | | |
|----------------|--------------------|--------------------------------------------|
| MANUFACTURER | MODEL | |
| KWIKSET | KNOB: DEADBOLT: | SIGNATURE SERIES SIGNATURE SERIES (980) |

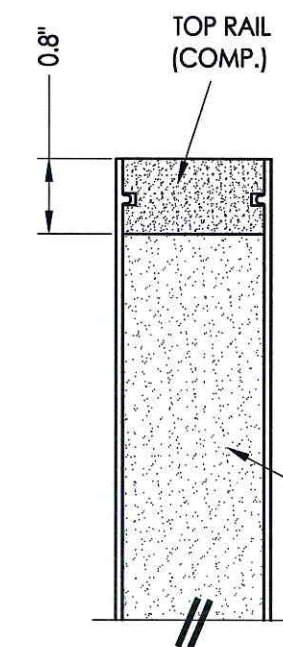

TOP RAIL
(COMP.)

FOAM CORE
(POLYURETHANE -
1.9 PCF MIN.)

FIBERGLASS SKIN
(0.075" MIN. THK.)

BOTTOM RAIL
(COMP.)

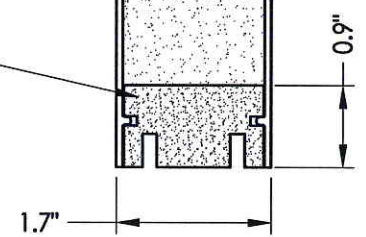

2
2 VERTICAL CROSS SECTION



Documents Prepared By: Lyndon F. Schmidt, P.E.
TEXAS P.E. #104123

RW BUILDING CONSULTANTS, INC.
P.O. Box 230 Valrico FL 33595
Phone No.: 813.659.9197

TEXAS BOARD OF PROFESSIONAL ENGINEERS
CERTIFICATE OF REGISTRATION # F-11852

PRODUCT: FIBERGLASS DOOR

PART OR ASSEMBLY: DOOR/SIDELITE PANEL DETAILS

| NO. | DATE | BY | REVISIONS |
|-----|------|----|-----------|
| | | | |
| | | | |
| | | | |
| | | | |

DATE: 11/8/12

SCALE: N.T.S.

DWG. BY: JK

CHK. BY: LFS

DRAWING NO.: TX-4271

SHEET 2 of 10

2X FRAMING TO BE DESIGNED BY THE ENGINEER OR ARCHITECT OF RECORD BASED ON WIND LOADS AND THE CLADDING BEING USED (TYP.).

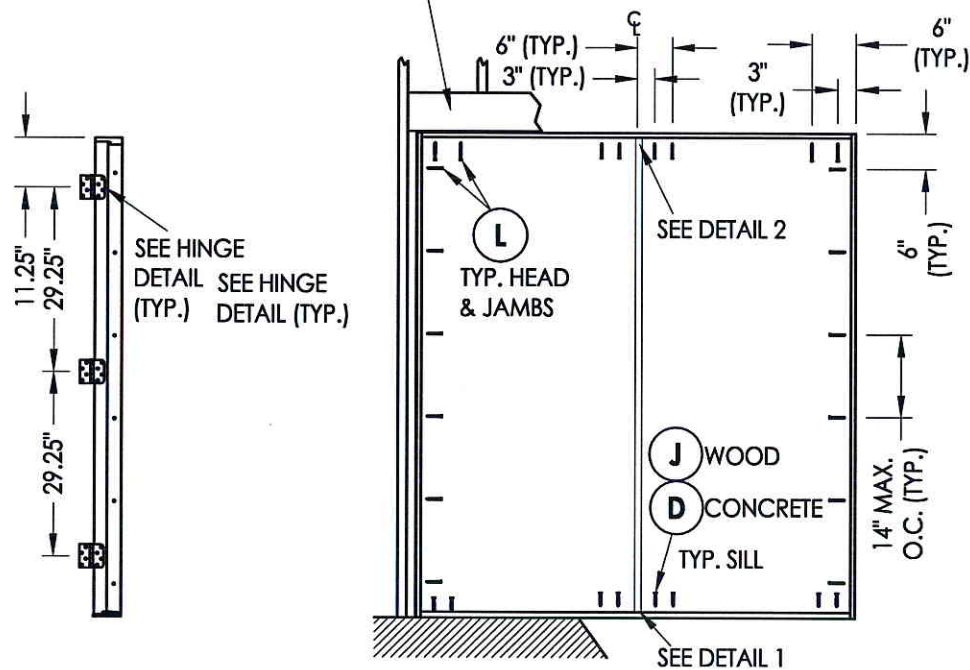

HINGE JAMB

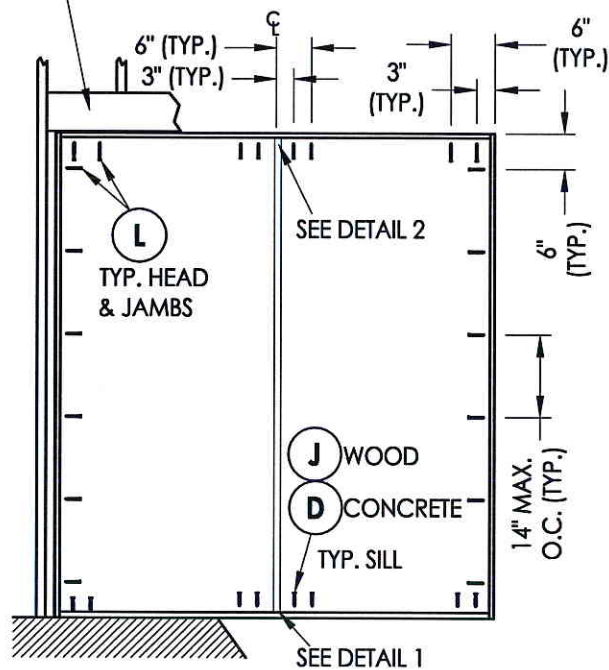

FRAME ANCHORING XX

FLOOR SUBSTRATE MATERIAL (TYP.)
CONCRETE (MIN. 3000 PSI)
WOOD (G >= 0.42)

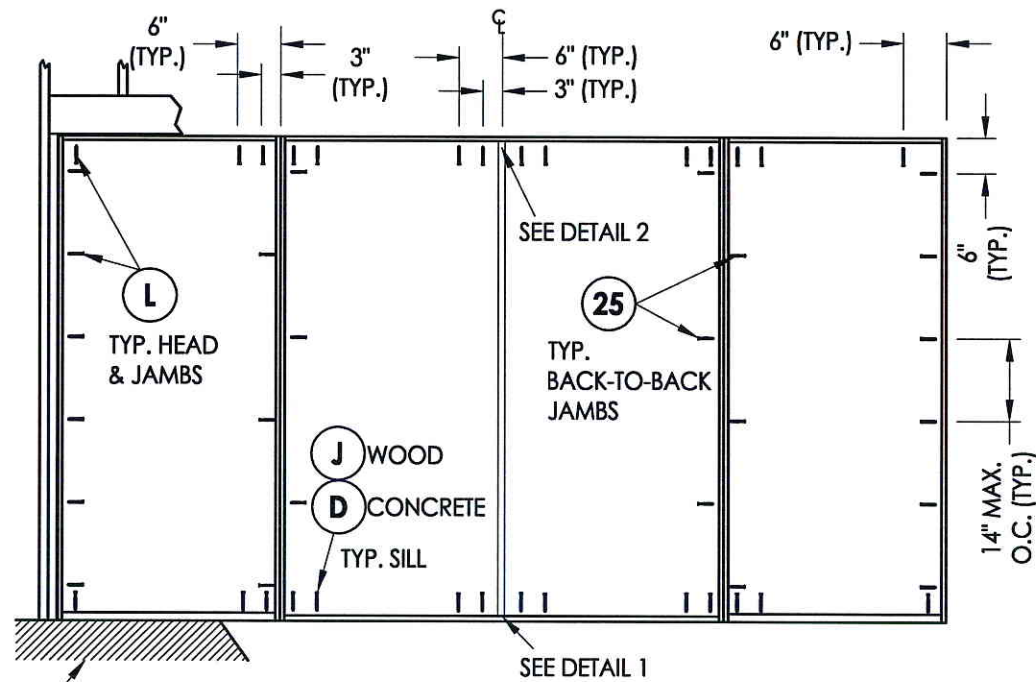

FRAME ANCHORING OXXO

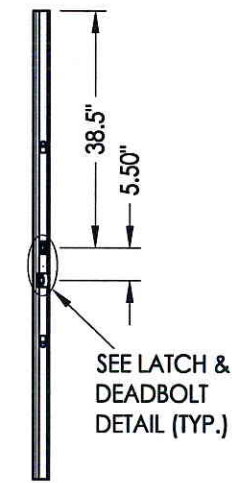

ASTRAGAL STRIKE

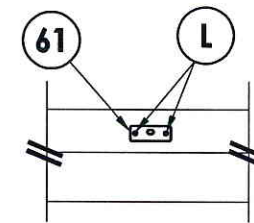

DETAIL 2
Astragal strike plate @ head

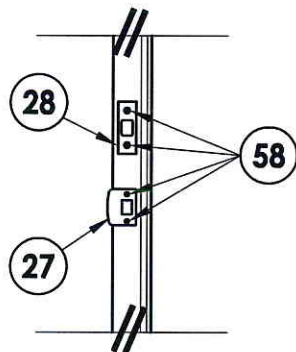

LATCH & DEADBOLT DETAIL

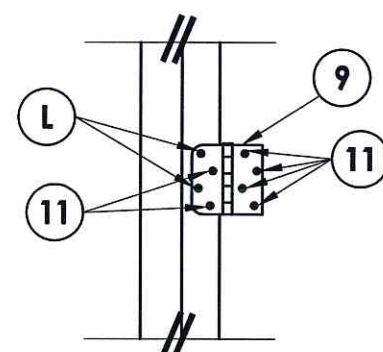

HINGE DETAIL

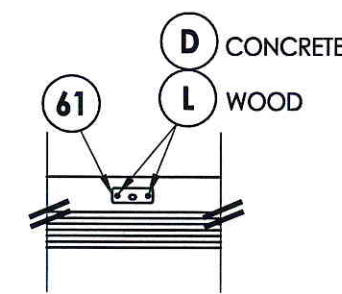

DETAIL 1
Astragal strike plate @ sill (Outswing)

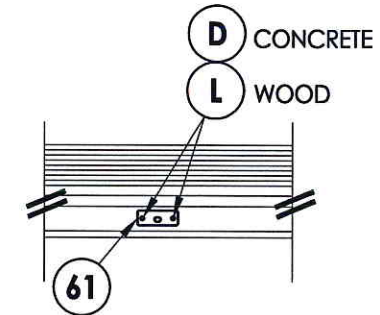

DETAIL 1
Astragal strike plate @ sill (Inswing)

CONCRETE ANCHOR NOTES:

- Concrete anchor locations at the corners may be adjusted to maintain the min. edge distance to mortar joints.
- Concrete anchor locations noted as "MAX. ON CENTER" must be adjusted to maintain the min. edge distance to mortar joints, additional concrete anchors may be required to ensure the "MAX. ON CENTER" dimension are not exceeded.
- Concrete anchor table:

| ANCHOR TYPE | ANCHOR SIZE | MIN. EMBEDMENT | MIN. CLEARANCE TO MASONRY EDGE | MIN. CLEARANCE TO ADJACENT ANCHOR |
|----------------|-------------|----------------|--------------------------------|-----------------------------------|
| ITW TAPCON® | 1/4" | 1-3/4" | 2-1/2" | 3" |
| ELCO ULTRACON® | 1/4" | 1-3/4" | 1" | 3" |



Documents Prepared By: Lyndon F. Schmidt, P.E.
TEXAS P.E. #104123

RW BUILDING CONSULTANTS, INC.
P.O. Box 230 Vairico FL 33595
Phone No.: 813.659.8187

TEXAS BOARD OF PROFESSIONAL ENGINEERS
CERTIFICATE OF REGISTRATION # F-11852

| | |
|-------------------|-----------------|
| PRODUCT: | FIBERGLASS DOOR |
| PART OR ASSEMBLY: | FRAME ANCHORING |

| NO. | DATE | BY | REVISIONS |
|-----|------|----|-----------|
| | | | |
| | | | |
| | | | |

| | |
|--------------|---------|
| DATE: | 11/8/12 |
| SCALE: | N.T.S. |
| DWG. BY: | JK |
| CHK. BY: | LFS |
| DRAWING NO.: | TX-4271 |
| SHEET | 8 of 10 |

R:\A - Projects\Project Folders\Proj 1601 - 1700\PF 1676\D. RWBC Drawings\TX-4270-71.dwg, 10.2

| BILL OF MATERIALS | | |
|-------------------|--------------------------------------------------------------|-----------|
| ITEM # | DESCRIPTION | MATERIAL |
| B | 2X FRAMING (G >= 0.42) | WOOD |
| C | 1/4" MAX. SHIM SPACE | - |
| D | 1/4" PFH ITW CONCRETE SCREW (1-3/4" MIN. EMB.) | STEEL |
| J | #10 X 3" PFH WOOD SCREW (1-1/2" MIN. EMB.) | STEEL |
| L | #10 X 2-1/2" PFH WOOD SCREW (1.15" MIN. EMB.) | STEEL |
| 1 | HEAD & JAMB | COMP |
| 7 | WEATHERSTRIP (THERMA-TRU) | FOAM |
| 8 | DOOR BOTTOM SWEEP | VINYL |
| 9 | 4" HINGE (THERMA-TRU) W/ 5/8" RADIUS CORNERS | STEEL |
| 11 | #9 X 3/4" PFH WOOD SCREW | STEEL |
| 24 | #10 X 1-1/2" PFH WOOD SCREW | STEEL |
| 25 | #10 X 2" PFH WOOD SCREW | STEEL |
| 27 | LATCH STRIKE PLATE | STEEL |
| 28 | DEADBOLT STRIKE PLATE | STEEL |
| 30 | OUTSWING THRESHOLD | ALUM/COMP |
| 32 | #8 X 3" PFH WS | STEEL |
| 36 | INSWING THRESHOLD | ALUM/COMP |
| 39 | INSWING SIDELITE SEAT | PVC |
| 40 | DOOR PANEL - SEE DOOR PANEL DETAIL SHEET FOR DETAILS | - |
| 50 | SIDELITE PANEL - SEE SIDELITE PANEL DETAIL SHEET FOR DETAILS | - |
| 57 | #8 X 2" PFH SMS | STEEL |
| 58 | #8 X 2-1/2" PFH WOOD SCREW | STEEL |
| 60 | ASTRAGAL (THERMA-TRU) | ALUM |
| 61 | ASTRAGAL STRIKE PLATE | STEEL |

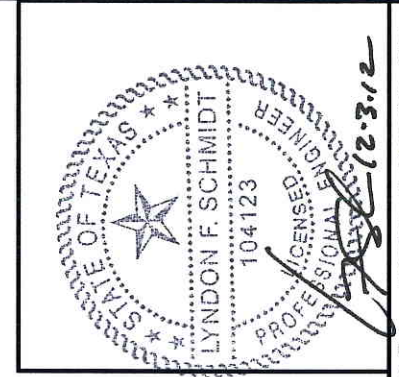

Documents Prepared By: Lyndon F. Schmidt, P.E.
TEXAS P.E. #104123

RW BUILDING CONSULTANTS, INC.
P.O. Box 230 Valrico FL 33595
Phone No.: 813.659.9197

TEXAS BOARD OF PROFESSIONAL ENGINEERS
CERTIFICATE OF REGISTRATION # F-11852

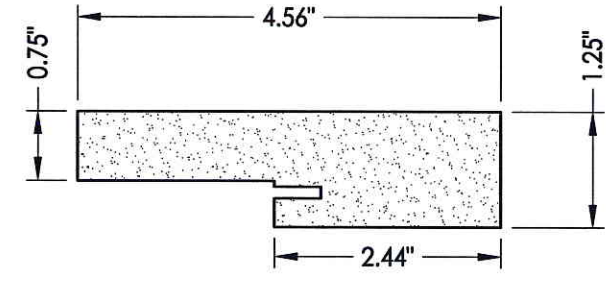

1 HEAD & JAMB
Composite

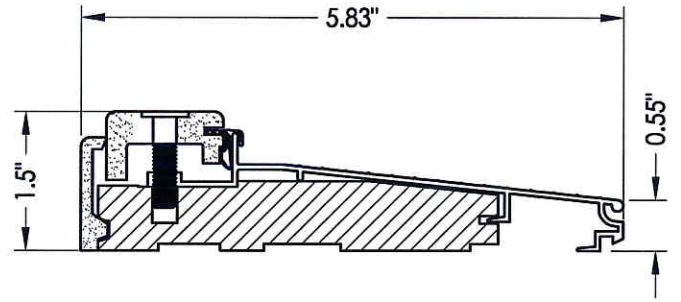

36 INSWING THRESHOLD
Therma-Tru

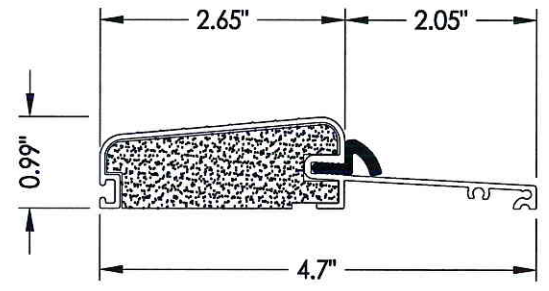

30 OUTSWING THRESHOLD
Columbia 775 Series
w/ Composite Substrate

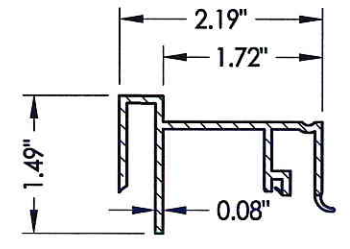

39 INSWING SIDELITE SEAT
Therma-Tru

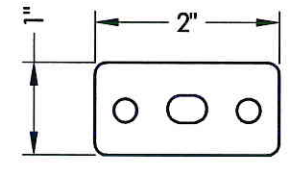

34 HEAD & SILL STRIKE PLATE

| | | |
|-------------------|--------------------------------|----|
| PRODUCT: | FIBERGLASS DOOR | |
| PART OR ASSEMBLY: | BILL OF MATERIALS & COMPONENTS | |
| NO. | DATE | BY |
| REVISIONS | | |
| DATE: | 11/8/12 | |
| SCALE: | N.T.S. | |
| DWG. BY: | JK | |
| CHK. BY: | LFS | |
| DRAWING NO.: | TX-4271 | |
| SHEET | 10 of 10 | |