

# THERMA TRU®

118 INDUSTRIAL DR., EDGERTON, OH 43517

## CLASSIC-CRAFT & CLASSIC-CRAFT RUSTIC SINGLE "IMPACT" DOOR WITH "NON-IMPACT" SIDELITES INSWING / OUTSWING

### EVALUATED FOR USE IN THE STATE OF TEXAS

The Fiberglass Door system described herein complies with the 2018 International Residential Code (IRC), Sections R301 & R609 and the 2018 International Building Code (IBC), Sections 1404.13, 1609, 1709.5, 2403 and 2404 subject to the following conditions:

1. Anchors shall be as listed and spaced as shown in the details. Anchor embedment to base material shall be beyond wall dressing or stucco.
2. When used in areas requiring wind-borne debris protection, the opaque door does not require impact protection and meets missile level "D" as defined in ASTM E 1996. The sidelites are required to be protected with an impact resistant covering that complies with Section R301.2.1.2 of the IRC and Section 1609.1.2 of the IBC.
3. Allowable design pressure requirements must be equal to or less than the design pressure rating shown in the design pressure chart, sheet 1 of this drawing.
4. Conditions not covered by this drawing are subject to further engineering analysis.

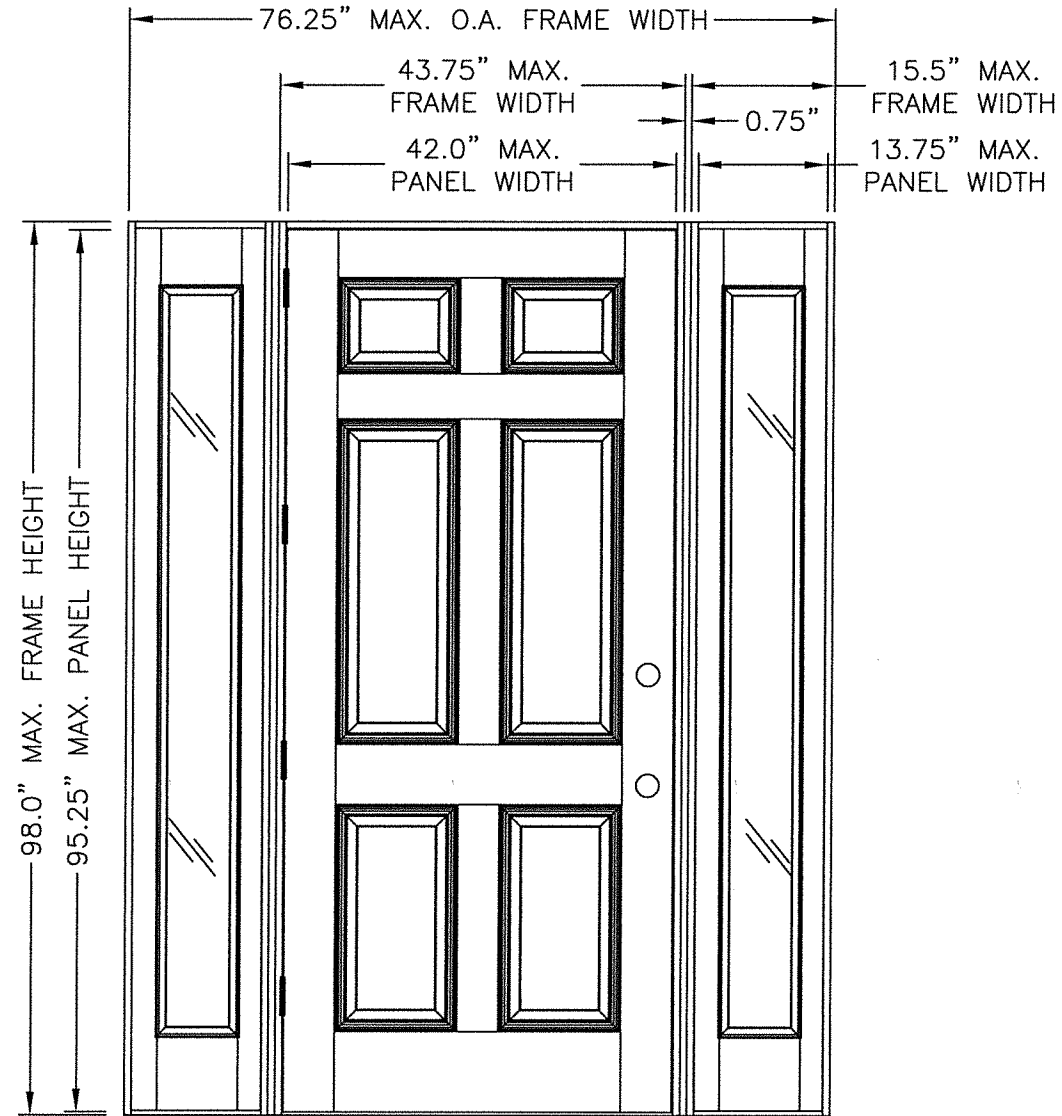

"CLASSIC-CRAFT" & "CLASSIC-CRAFT RUSTIC"

DOOR TYPE	SWING	OVERALL FRAME DIMENSION	OVERALL SIDELITE D.L.O. DIMENSION	DESIGN PRESSURE	
				POSITIVE	NEGATIVE
CLASSIC-CRAFT	OUTSWING	76.25" X 96.5"	6.75"	+65.0	-65.0
	INSWING	76.25" X 98.0"		+65.0	-65.0
CLASSIC-CRAFT RUSTIC	OUTSWING	76.25" X 96.5"	79.0"	+65.0	-65.0
	INSWING	76.25" X 98.0"		+65.0	-65.0

TABLE OF CONTENTS	
SHEET #	DESCRIPTION
1	TYPICAL ELEVATIONS, DESIGN PRESSURES & GENERAL NOTES
2	DOOR PANEL DETAILS (CLASSIC-CRAFT)
3	DOOR PANEL DETAILS (CLASSIC-CRAFT RUSTIC)
4	SIDELITE PANEL DETAILS
5	HORIZONTAL CROSS SECTIONS & GLAZING DETAILS
6	VERTICAL CROSS SECTIONS
7	VERTICAL CROSS SECTIONS
8	FRAME ANCHORING
9	COMPONENTS
10	BILL OF MATERIALS

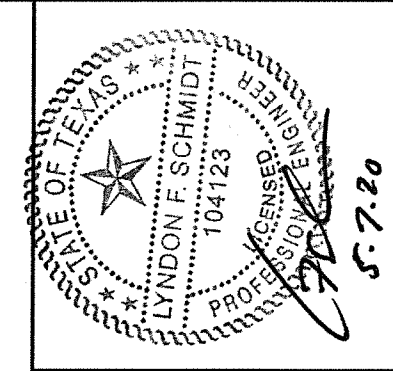

Documents Prepared By: Lyndon F. Schmidt, P.E.  
TEXAS P.E. #104123

**RW** BUILDING CONSULTANTS, INC.  
P.O. Box 230 Valrico FL 33595  
Phone No.: 813.659.9197

TEXAS BOARD OF PROFESSIONAL ENGINEERS  
CERTIFICATE OF REGISTRATION # F-11852

PRODUCT: SINGLE OPAQUE FIBERGLASS DOOR W/ SIDELITES "IMPACT" INSWING / OUTSWING  
PART OR ASSEMBLY: TYPICAL ELEVATIONS, DESIGN PRESSURES & GENERAL NOTES

NO.	DATE	DESCRIPTION	LFS	BY
1	5/07/20	UPDATE TO 2018 IBC/IRC CODE		
REVISIONS				

DATE: 7/16/12  
SCALE: N.T.S.  
DWG. BY: JK  
CHK. BY: LFS  
DRAWING NO.: TX-4183  
SHEET 1 OF 10

R:\Clients\Therma Tru PERMANENT\B - Texas Dept of Ins\TDI - DR 601 - 80 Opaque FG Imp IS - OS Sgls Dbls w-wo Imp SL\C - Drawings\Current\TX-4175-83.dwg, FOX02

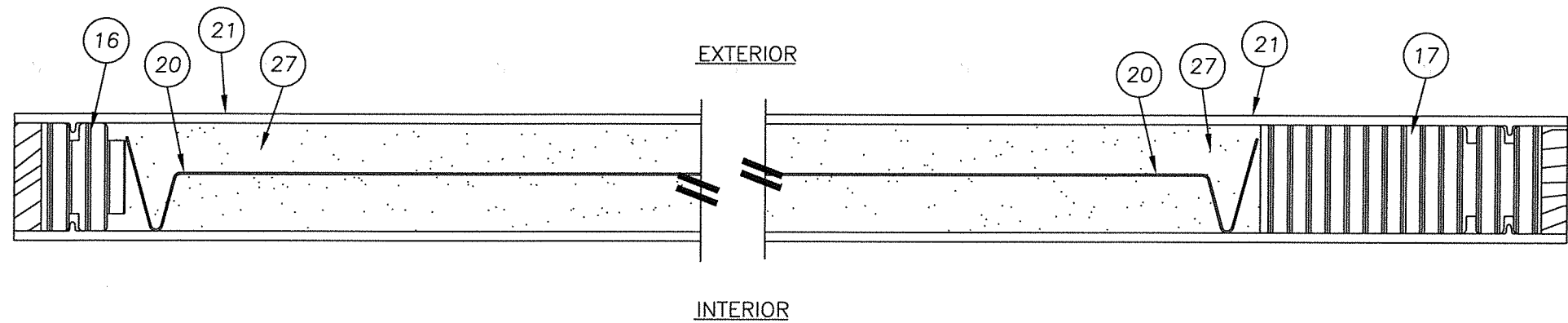

2 HORIZONTAL CROSS SECTION  
2 CLASSIC-CRAFT

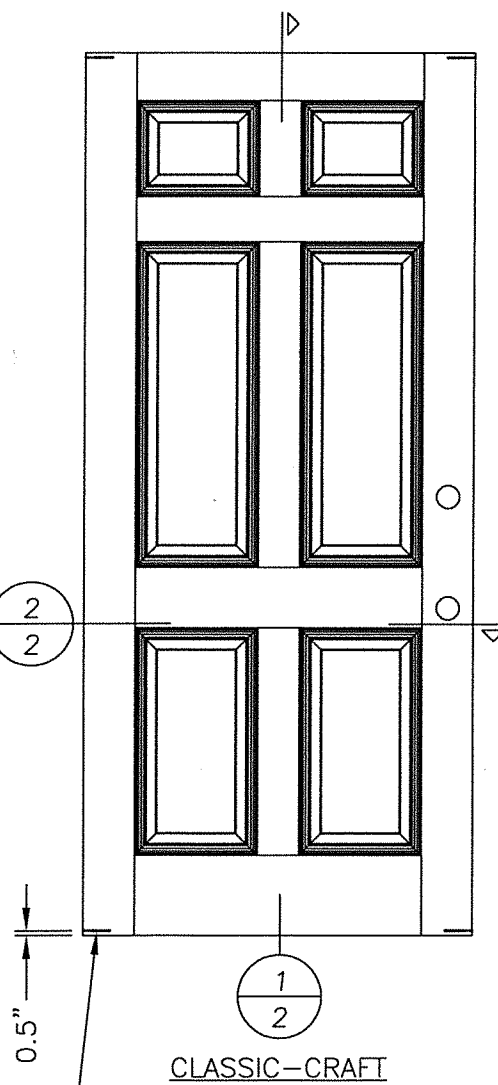

32 TYP. 4 CORNERS OF PANEL

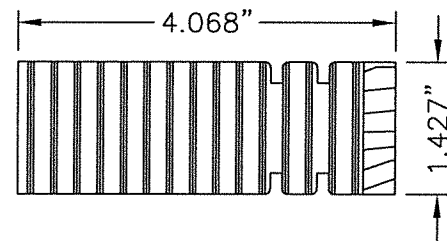
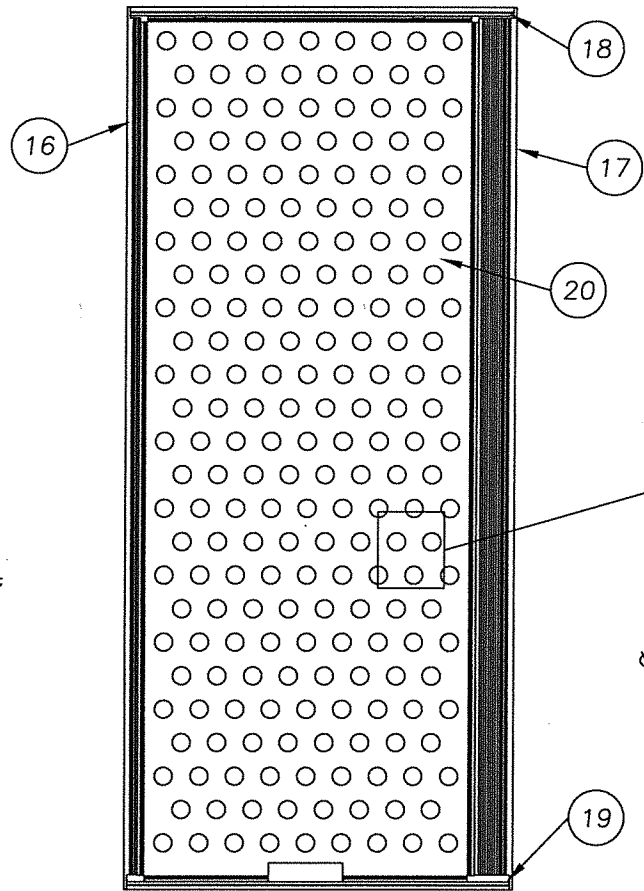

17 LOCK STILE  
CLASSIC-CRAFT

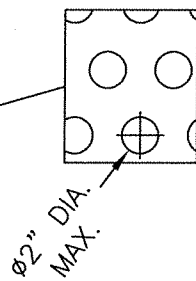

28.86% OPEN AREA MAX.

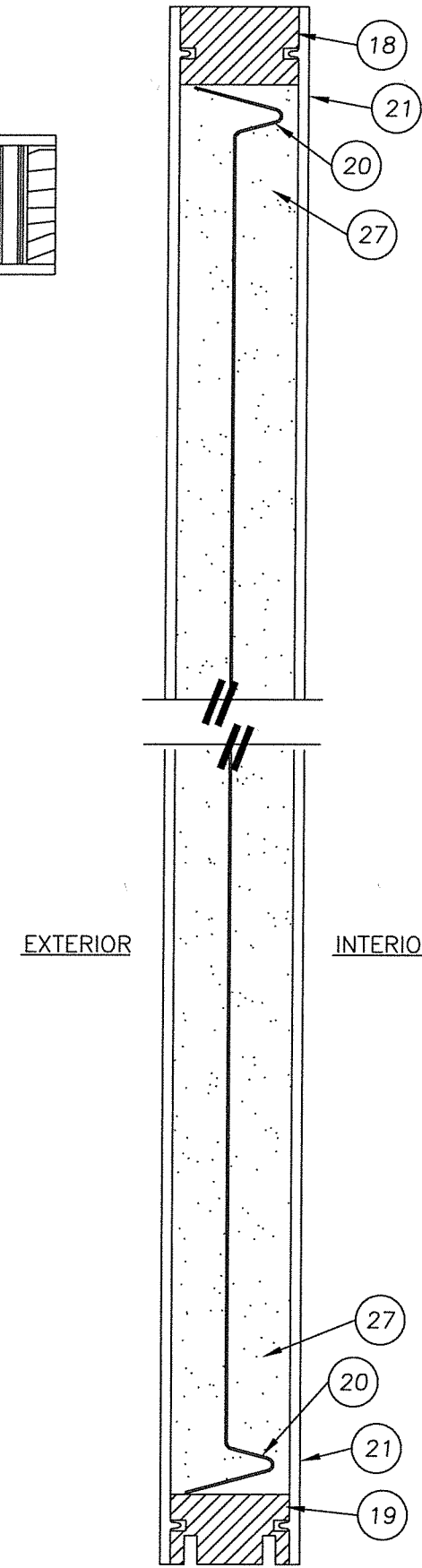

1 VERTICAL CROSS SECTION  
2 CLASSIC-CRAFT

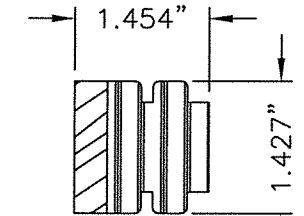

16 HINGE STILE  
CLASSIC-CRAFT

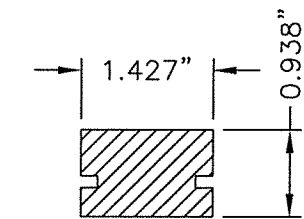

18 TOP RAIL  
CLASSIC-CRAFT

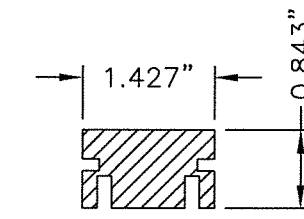

19 BOTTOM RAIL  
CLASSIC-CRAFT

DATE:	7/16/12
SCALE:	N.T.S.
DWG. BY:	JK
CHK. BY:	LFS
DRAWING NO.:	TX-4183
SHEET	2 OF 10

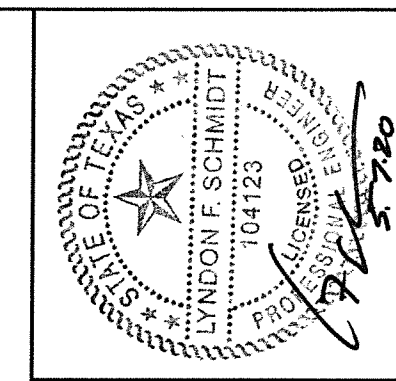

Documents Prepared By: Lyndon F. Schmidt, P.E.  
TEXAS P.E. #104123

**RW** BUILDING CONSULTANTS, INC.  
P.O. Box 250 Valrico FL 33595  
Phone No.: 813.659.9197  
TEXAS BOARD OF PROFESSIONAL ENGINEERS  
CERTIFICATE OF REGISTRATION # F-11852

PRODUCT: SINGLE OPAQUE  
FIBERGLASS DOOR W/SIDELITES  
"IMPACT" INSING / OUTSWING  
PART OR ASSEMBLY:  
DOOR PANEL DETAILS  
(CLASSIC-CRAFT)

NO.	DATE	DESCRIPTION	BY
1	5/07/20	UPDATE TO 2018 IBC/IRC CODE	LFS

© 2012 R.W. BUILDING CONSULTANTS INC.

R:\Clients\Therma Tru PERMANENT\B - Texas Dept of Ins\TDI - DR 601 - 80 Opaque FG Imp IS - OS Sgls Dbls w-wo Imp SLAC - Drawings\Current\TX-4175-83.dwg, FOX03

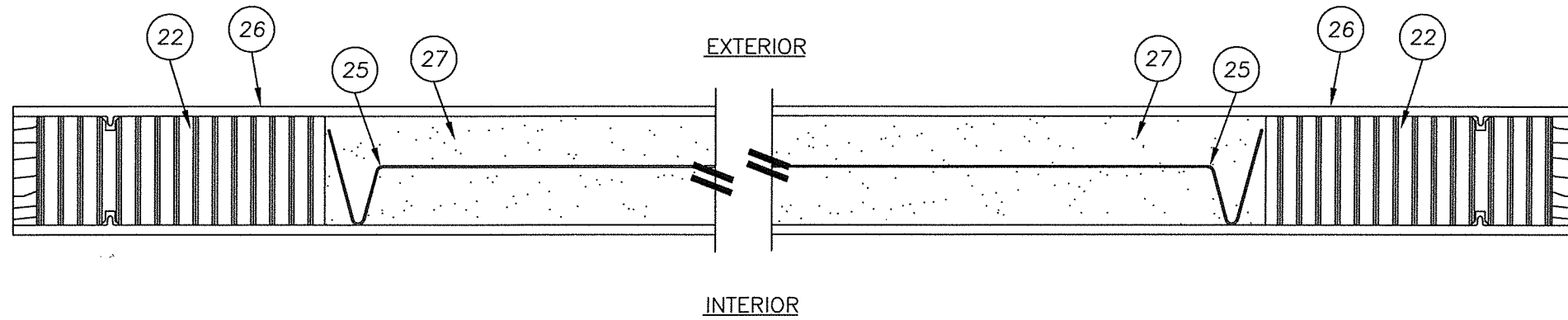

2 HORIZONTAL CROSS SECTION  
3 CLASSIC-CRAFT RUSTIC

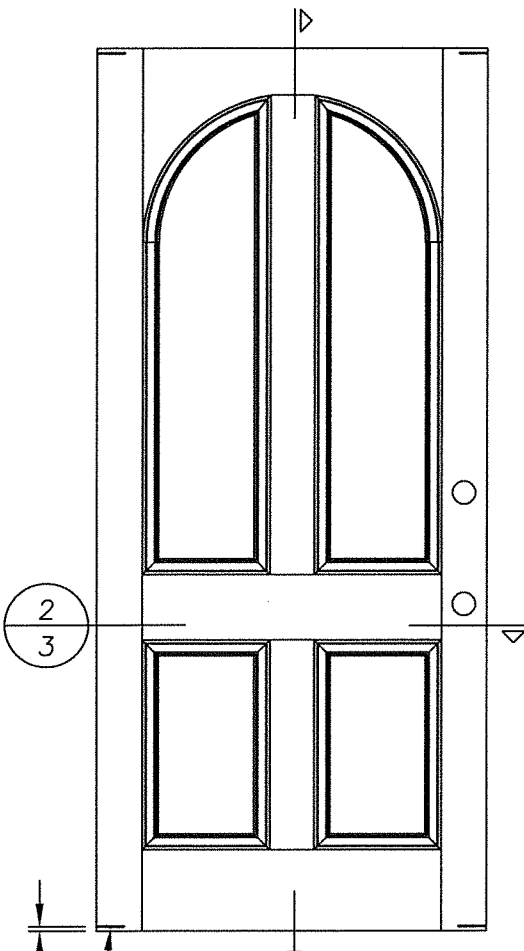

1 VERTICAL CROSS SECTION  
3 CLASSIC-CRAFT RUSTIC

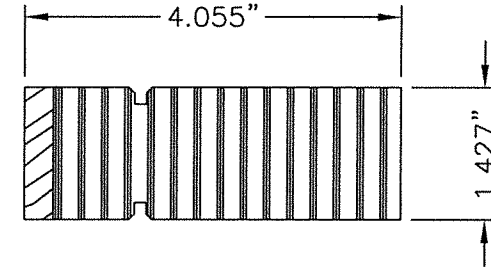
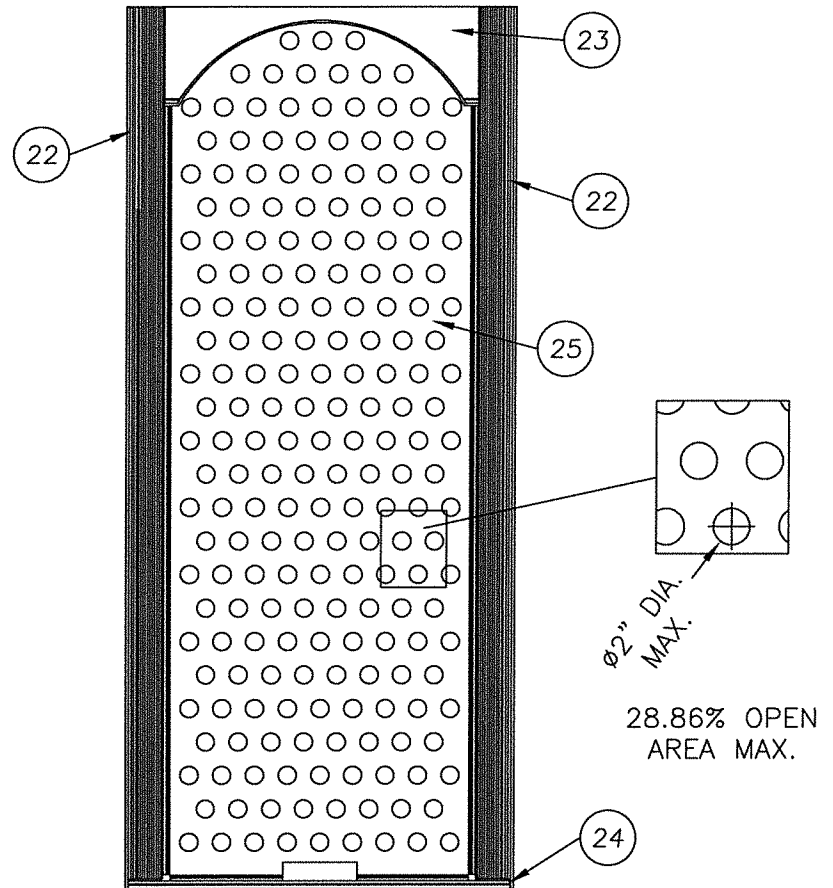

22 LOCK & HINGE STILE  
CLASSIC-CRAFT RUSTIC

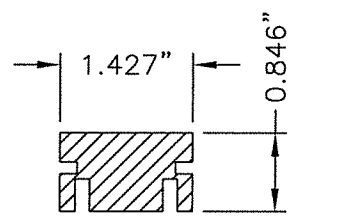

24 BOTTOM RAIL  
CLASSIC-CRAFT RUSTIC

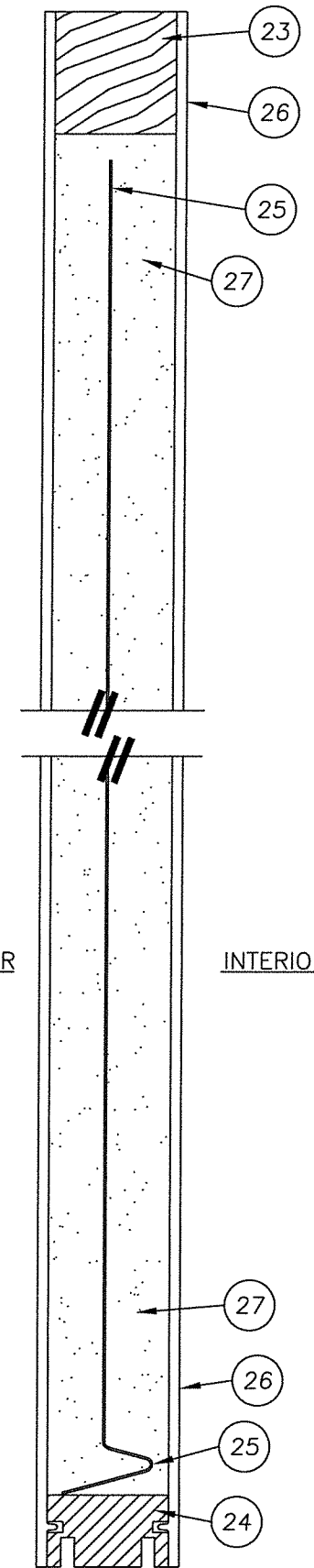

23 TOP RAIL  
CLASSIC-CRAFT RUSTIC

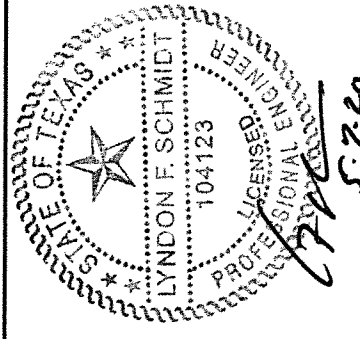
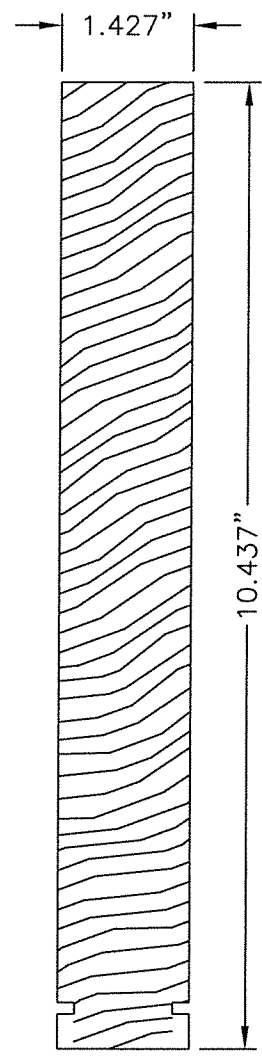

Documents Prepared By: Lyndon F. Schmidt, P.E.  
TEXAS P.E. #104123

**RW** BUILDING CONSULTANTS, INC.  
P.O. Box 230 Valrico FL 33595  
Phone No.: 813.659.9197

TEXAS BOARD OF PROFESSIONAL ENGINEERS  
CERTIFICATE OF REGISTRATION # F-11852

PRODUCT: SINGLE OPAQUE  
FIBERGLASS DOOR W/SIDELITES  
"IMPACT" INSWING / OUTSWING

PART OR ASSEMBLY:  
DOOR PANEL DETAILS  
(CLASSIC-CRAFT RUSTIC)

NO.	DATE	DESCRIPTION	LFS	BY
1	5/07/20	UPDATE TO 2018 IBC/IRC CODE	LFS	BY

DATE: 7/16/12  
SCALE: N.T.S.  
DWG. BY: JK  
CHK. BY: LFS  
DRAWING NO.: TX-4183  
SHEET 3 of 10

R:\Clients\Therma Tru PERMANENT\B - Texas Dept of Ins\TDI - DR 601 - 80 Opaque FG Imp IS - OS Sgls Dbls w-wo Imp SLAC - Drawings\Current\TX-4175-83.dwg, FOXD4

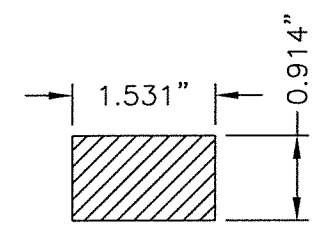
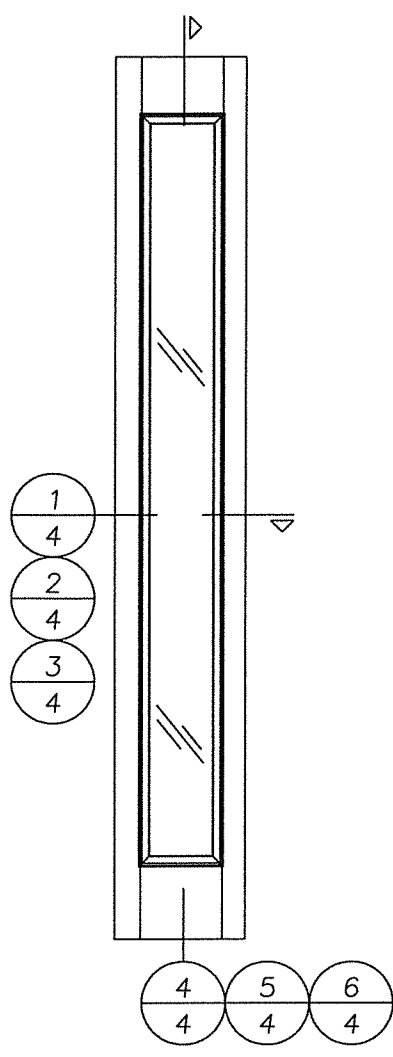

45 TOP RAIL SIDELITE

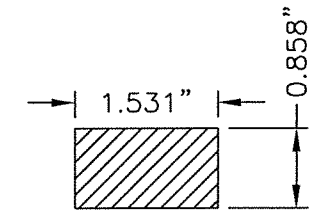

61 BOTTOM RAIL SIDELITE

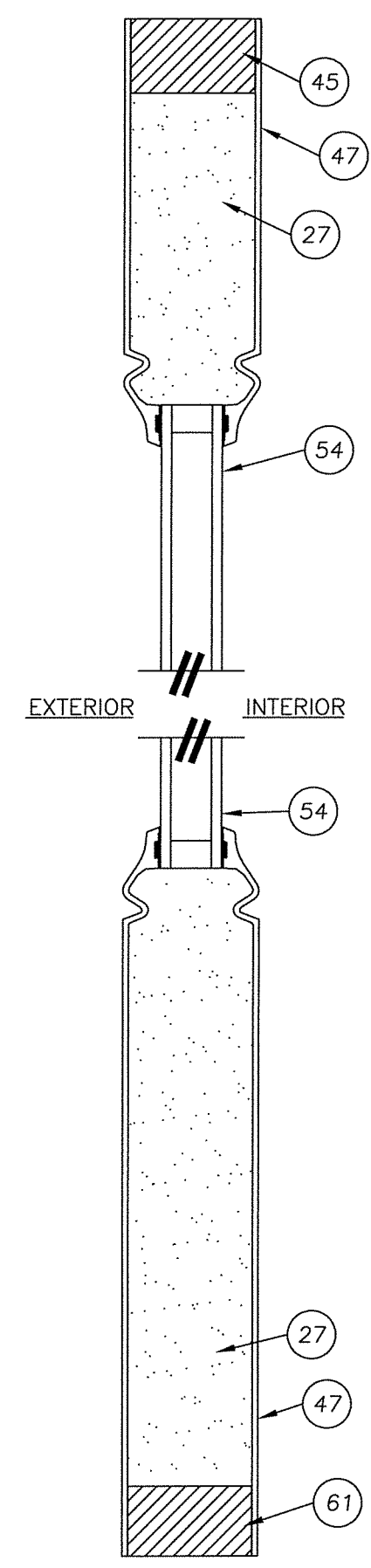

4 VERTICAL CROSS SECTION (CLASSIC-CRAFT)

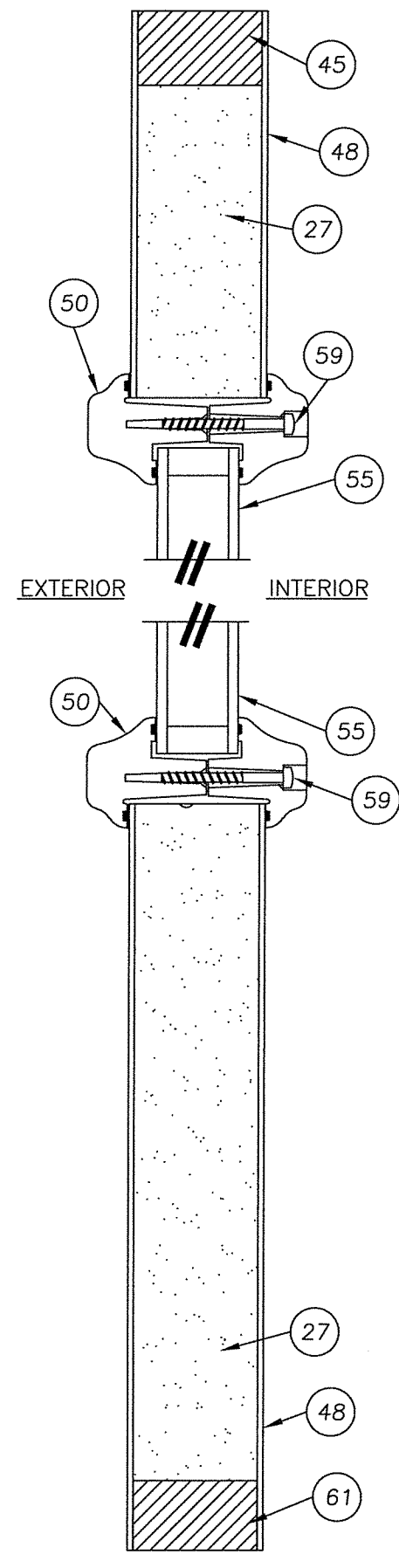

5 VERTICAL CROSS SECTION (FIBER-CLASSIC)

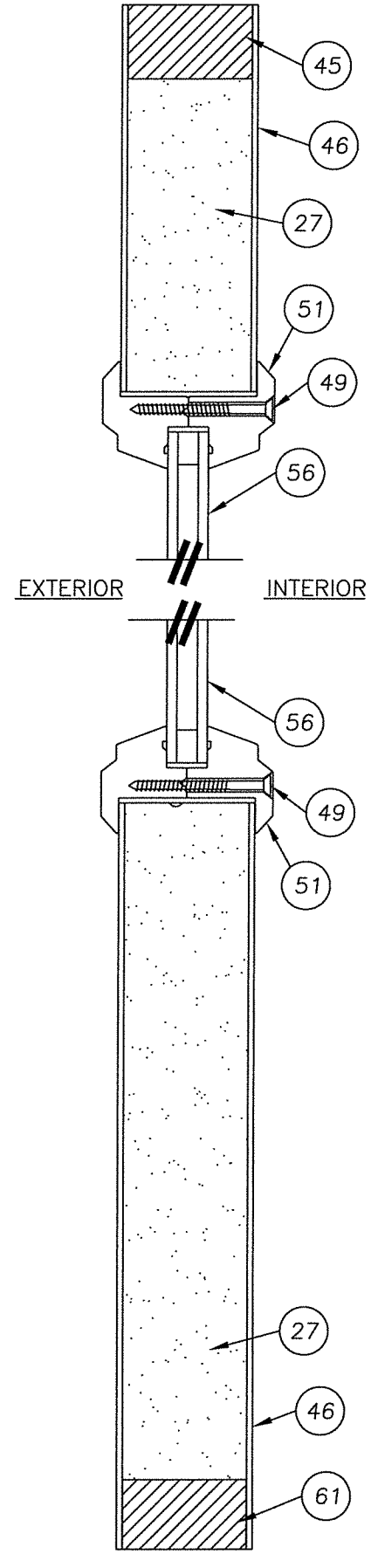

6 VERTICAL CROSS SECTION (SMOOTH-STAR)

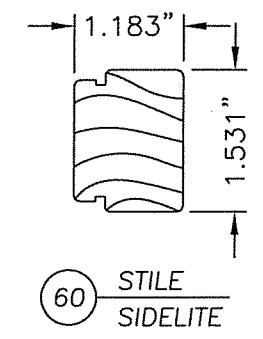

60 STILE SIDELITE

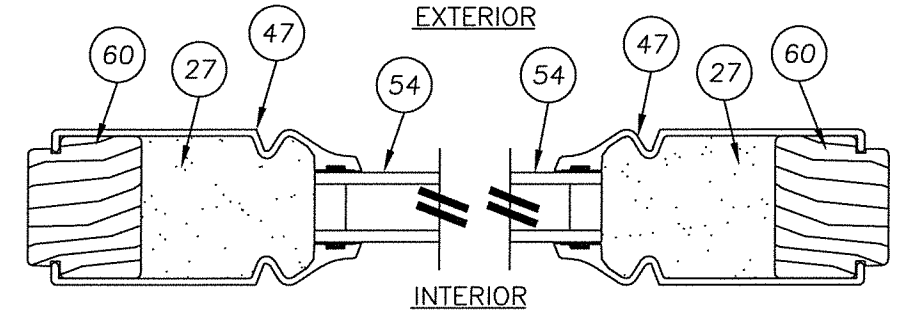

1 HORIZONTAL CROSS SECTION (CLASSIC-CRAFT)

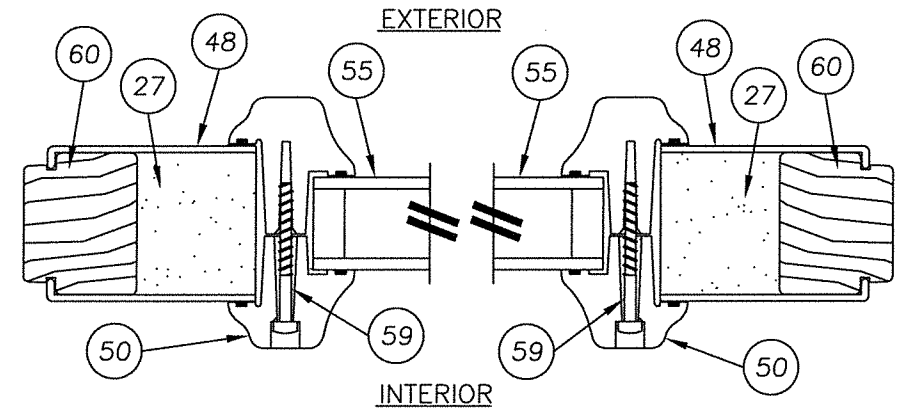

2 HORIZONTAL CROSS SECTION (FIBER-CLASSIC)

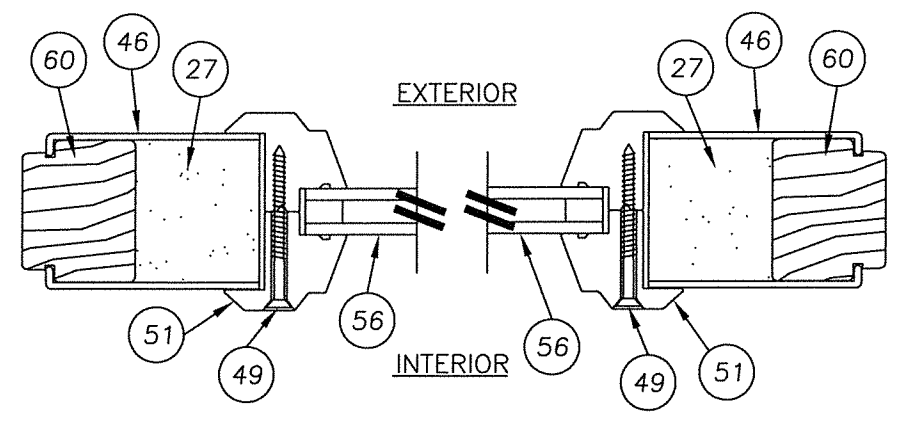

3 HORIZONTAL CROSS SECTION (SMOOTH-STAR)

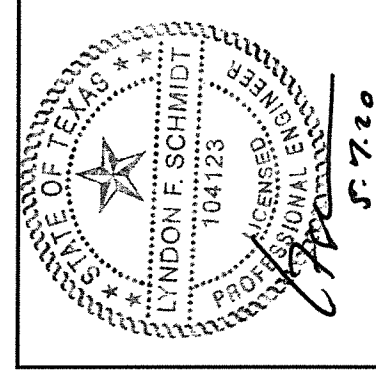

S. 7.20

Documents Prepared By: Lyndon F. Schmidt, P.E.  
TEXAS P.E. #104123

**RW** BUILDING CONSULTANTS, INC.  
P.O. Box 230 Vairico FL 33595  
Phone No.: 813.659.9197

TEXAS BOARD OF PROFESSIONAL ENGINEERS  
CERTIFICATE OF REGISTRATION # F-11852

PRODUCT: SINGLE OPAQUE FIBERGLASS DOOR W/SIDELITES "IMPACT" INSWING / OUTSWING  
PART OR ASSEMBLY: SIDELITE PANEL DETAILS

NO.	DATE	DESCRIPTION	BY
1	5/07/20	UPDATE TO 2018 IBC/IRC CODE	LFS

DATE: 7/16/12  
SCALE: N.T.S.  
DWG. BY: JK  
CHK. BY: LFS  
DRAWING NO.: TX-4183  
SHEET 4 OF 10

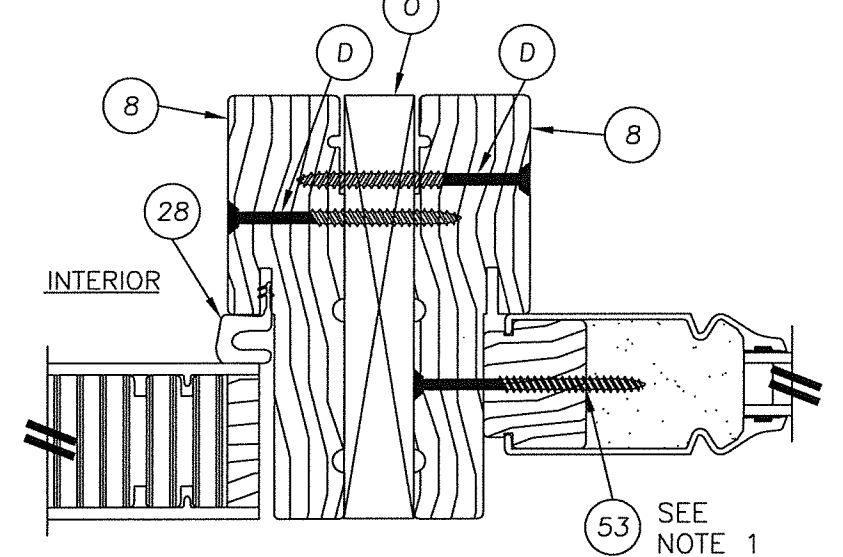
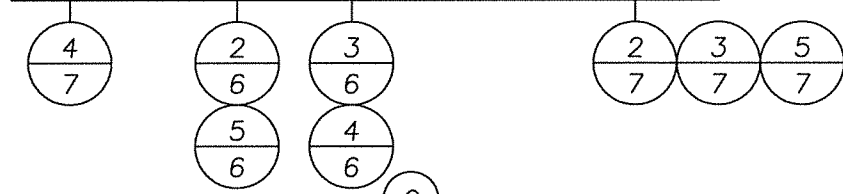
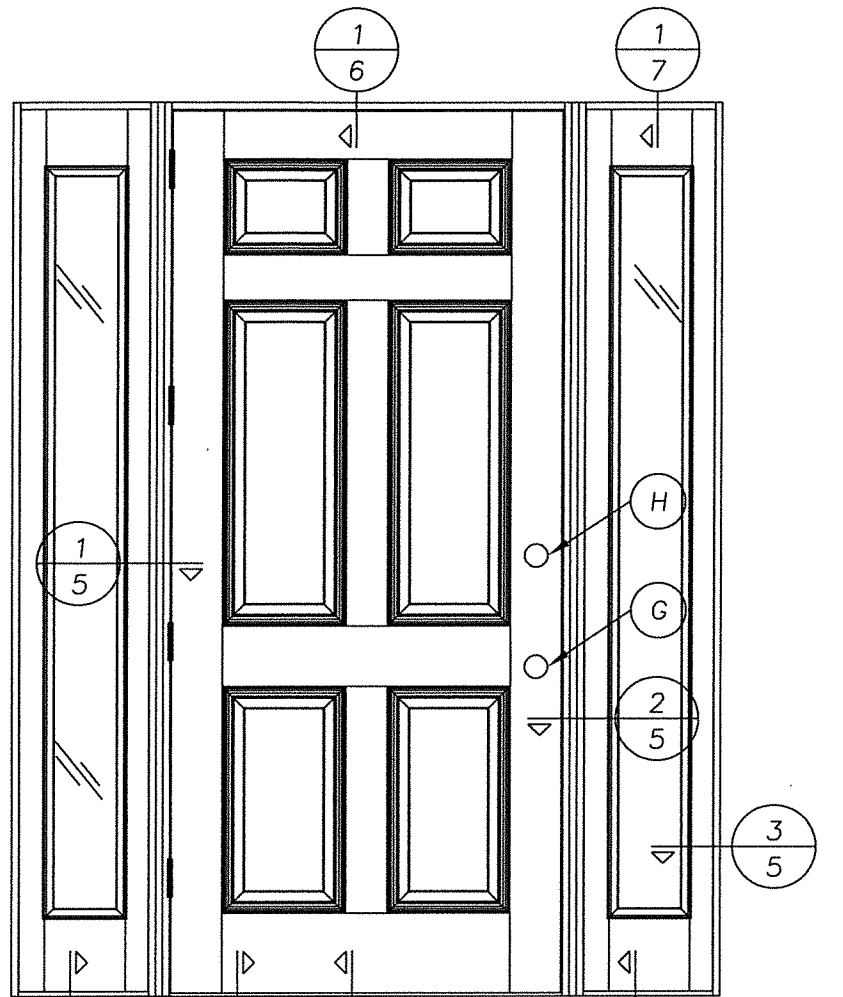

2 HORIZONTAL CROSS SECTION  
 5 OUTSWING SHOWN (INSWING ALSO APPROVED)  
 CLASSIC-CRAFT PANEL SHOWN  
 SEE PANEL DETAILS FOR  
 OPTIONAL PANEL TYPES

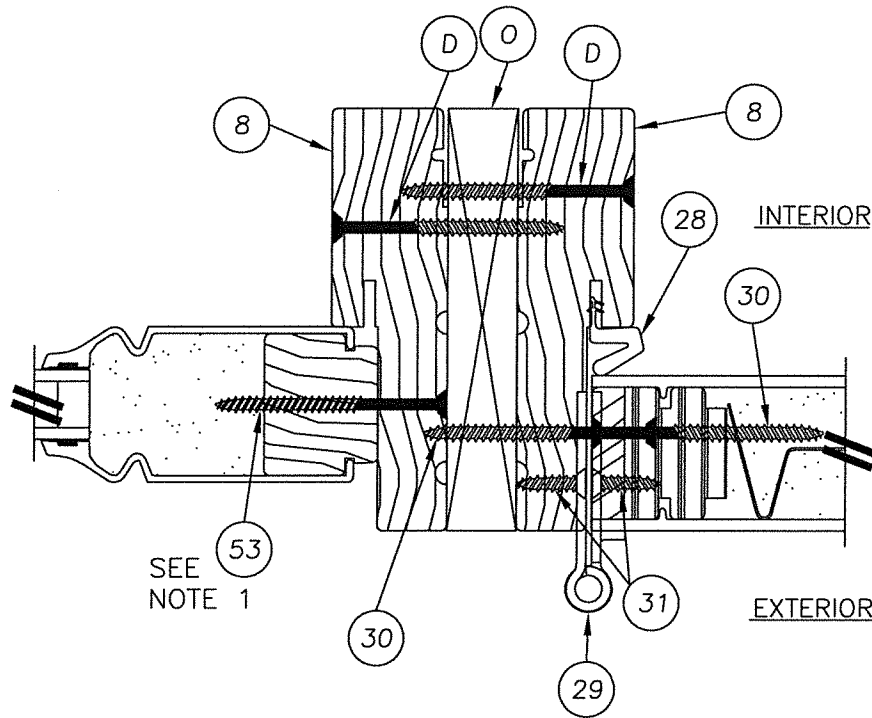

1 HORIZONTAL CROSS SECTION  
 5 OUTSWING SHOWN (INSWING ALSO APPROVED)  
 CLASSIC-CRAFT PANEL SHOWN  
 SEE DOOR PANEL DETAILS FOR  
 OPTIONAL PANEL TYPES

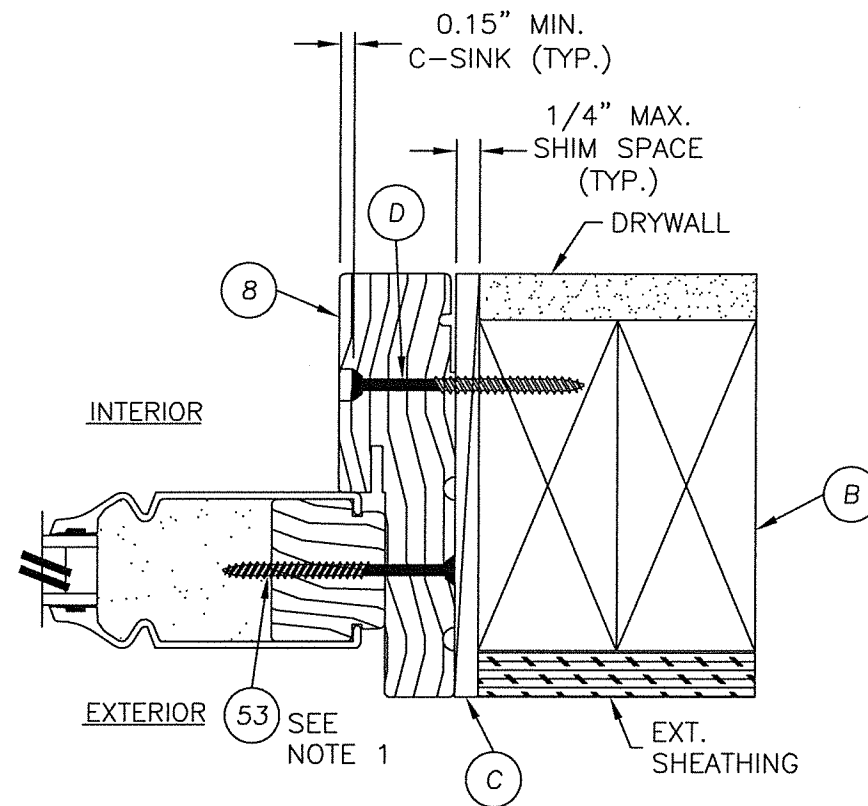

3 HORIZONTAL CROSS SECTION  
 5 OUTSWING SHOWN (INSWING ALSO APPROVED)  
 CLASSIC-CRAFT PANEL SHOWN  
 SEE SIDELITE PANEL DETAILS FOR  
 OPTIONAL PANEL TYPES

NOTE:  
 1. SIDELITE ASSEMBLY SCREWS LOCATED  
 4" FROM ENDS AND 5 MORE EQUALLY  
 SPACED (7 TOTAL).

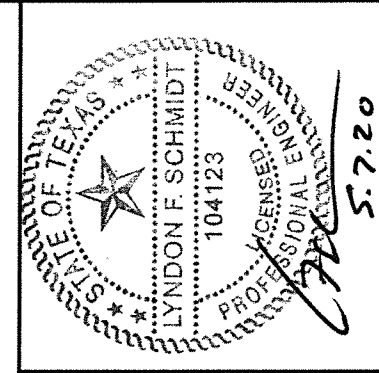

Documents Prepared By: Lyndon F. Schmidt, P.E.  
 TEXAS P.E. #104123

RW BUILDING CONSULTANTS, INC.  
 P.O. Box 230 Valrico FL 33595  
 Phone No.: 813.659.9197

TEXAS BOARD OF PROFESSIONAL ENGINEERS  
 CERTIFICATE OF REGISTRATION # F-11852

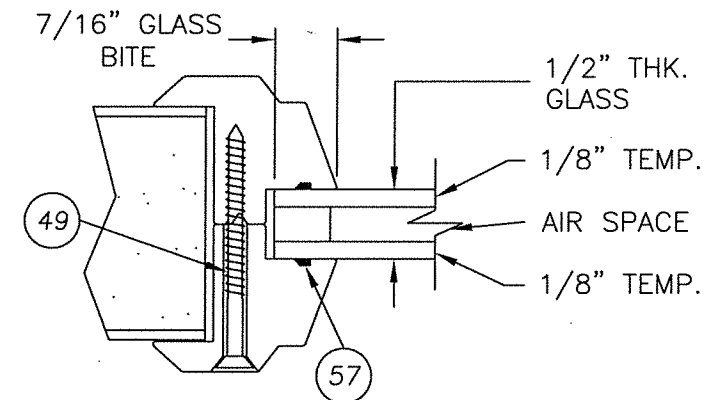

56 GLAZING DETAIL  
 1/2" INSULATED GLASS

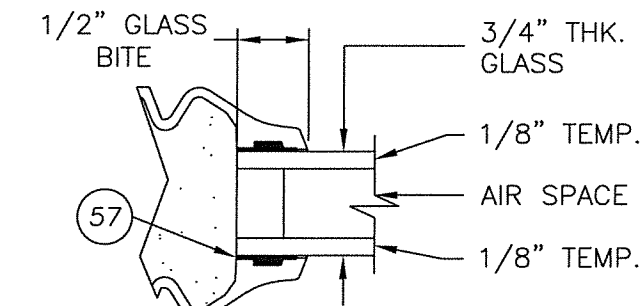

54 GLAZING DETAIL  
 3/4" INSULATED GLASS

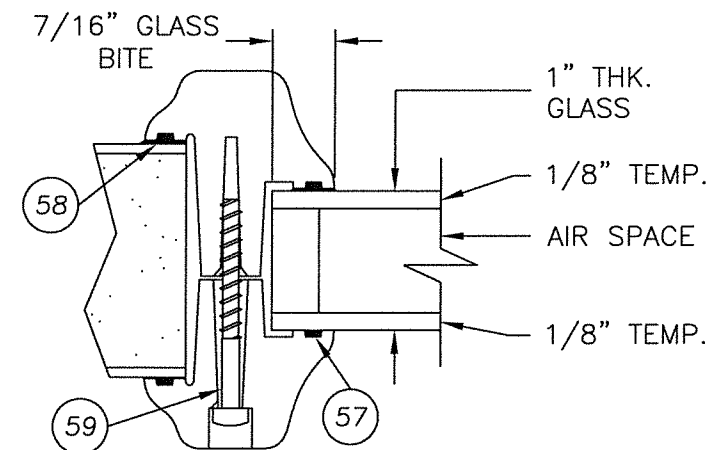

55 GLAZING DETAIL  
 1" INSULATED GLASS

PRODUCT: SINGLE OPAQUE  
 FIBERGLASS DOOR W/SIDELITES  
 "IMPACT" INSWING / OUTSWING  
 PART OR ASSEMBLY:  
 HORIZONTAL CROSS SECTIONS  
 & GLAZING DETAILS

NO.	DATE	DESCRIPTION	BY
1	5/07/20	UPDATE TO 2018 IBC/IRC CODE	LFS

DATE: 7/16/12  
 SCALE: N.T.S.  
 DWG. BY: JK  
 CHK. BY: LFS  
 DRAWING NO.: TX-4183  
 SHEET 5 of 10

R:\Clients\Therma Tru PERMANENT\B - Texas Dept of Ins\TDI - DR 601 - 80 Opaque FG Imp IS - OS Sgls Dbis w-wo Imp SL\C - Drawings\Current\TX-4175-83.dwg, FOX06

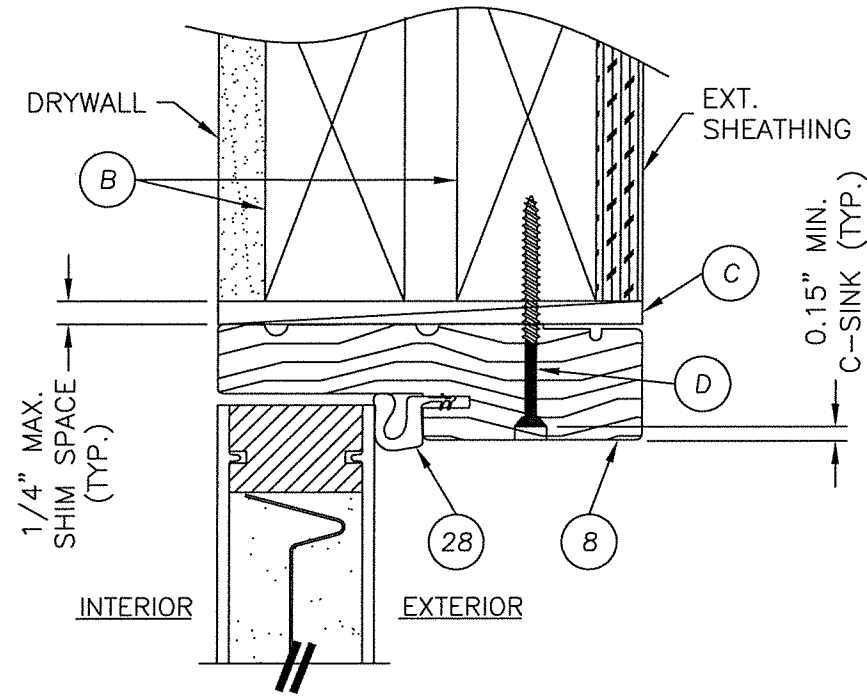

1 VERTICAL CROSS SECTION  
 6 INSWING SHOWN (OUTSWING ALSO APPROVED)  
 CLASSIC-CRAFT PANEL SHOWN  
 SEE DOOR PANEL DETAILS FOR  
 OPTIONAL PANEL TYPES

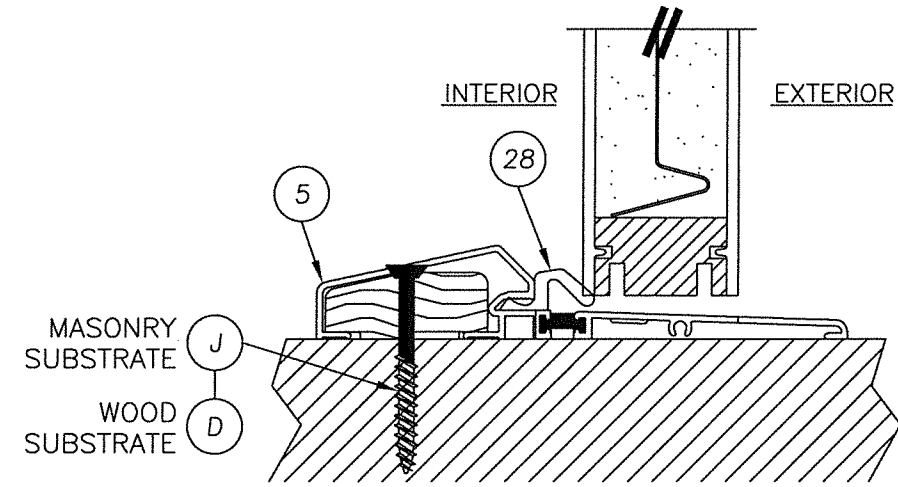

3 VERTICAL CROSS SECTION  
 6 @ THRESHOLD  
 CLASSIC-CRAFT PANEL SHOWN  
 SEE DOOR PANEL DETAILS FOR  
 OPTIONAL PANEL TYPES

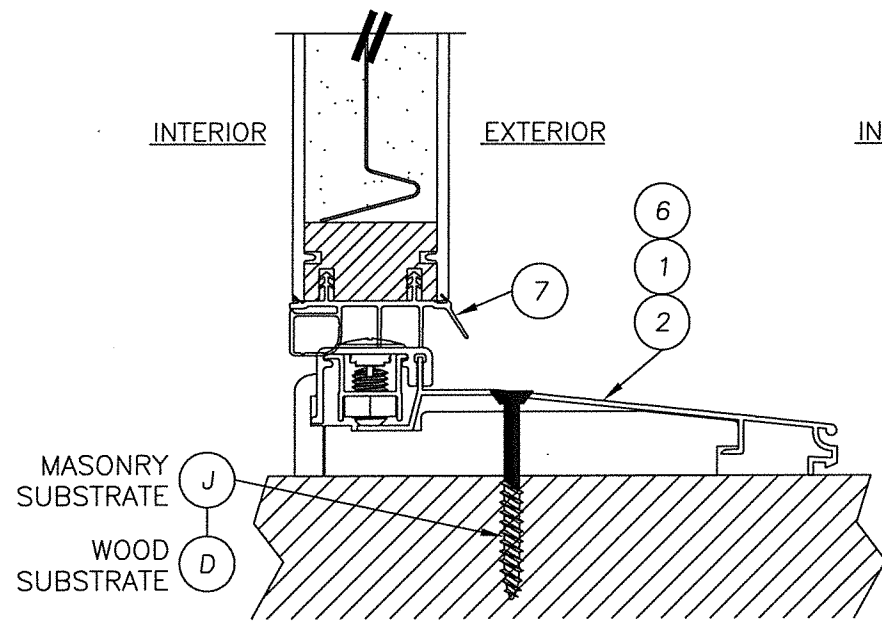

4 VERTICAL CROSS SECTION  
 6 @ THRESHOLD  
 CLASSIC-CRAFT PANEL SHOWN  
 SEE DOOR PANEL DETAILS FOR  
 OPTIONAL PANEL TYPES

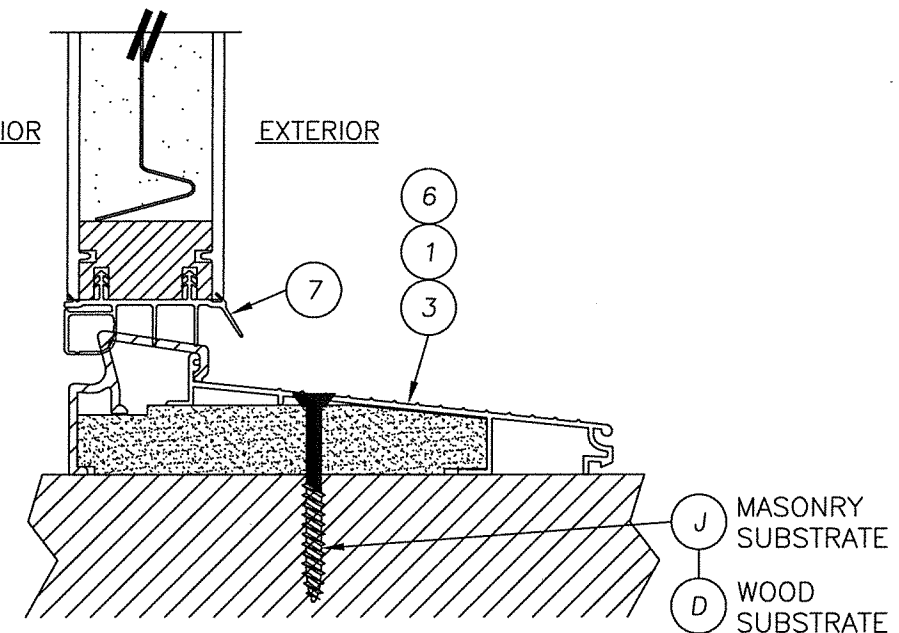

5 VERTICAL CROSS SECTION  
 6 @ THRESHOLD  
 CLASSIC-CRAFT PANEL SHOWN  
 SEE DOOR PANEL DETAILS FOR  
 OPTIONAL PANEL TYPES

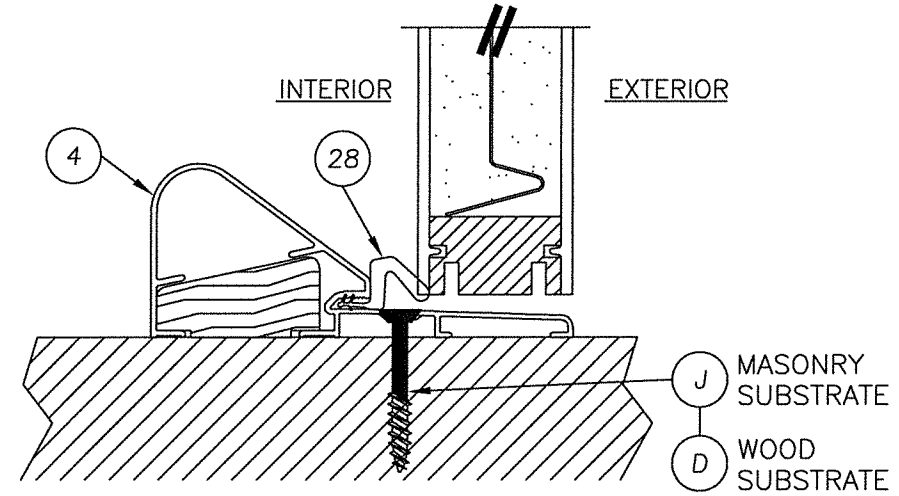

6 VERTICAL CROSS SECTION  
 6 @ THRESHOLD  
 CLASSIC-CRAFT PANEL SHOWN  
 SEE DOOR PANEL DETAILS FOR  
 OPTIONAL PANEL TYPES

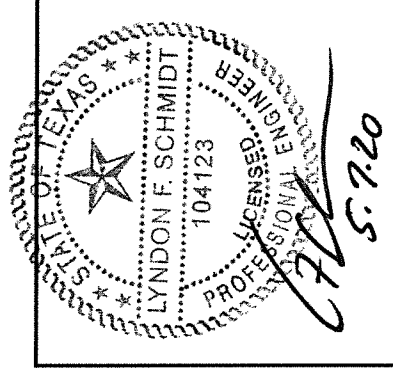

Documents Prepared By: Lyndon F. Schmidt, P.E.  
 TEXAS P.E. #104123

**RW** BUILDING CONSULTANTS, INC.  
 P.O. Box 230 Vairico FL 33595  
 Phone No.: 813.659.9197

TEXAS BOARD OF PROFESSIONAL ENGINEERS  
 CERTIFICATE OF REGISTRATION # F-11852

PRODUCT: SINGLE OPAQUE  
 FIBERGLASS DOOR W/ SIDELITES  
 "IMPACT" INSWING / OUTSWING

PART OR ASSEMBLY: VERTICAL CROSS SECTIONS

NO.	DATE	DESCRIPTION	BY
1	5/07/20	UPDATE TO 2018 IBC/IRC CODE	LFS

DATE: 7/16/12  
 SCALE: N.T.S.  
 DWG. BY: JK  
 CHK. BY: LFS  
 DRAWING NO.: TX-4183  
 SHEET 6 OF 10

R:\Clients\Therma Tru PERMANENT\B - Texas Dept of Ins\TDI - DR 601 - 80 Opaque FG Imp IS - OS Sgls Dbis w-wo Imp S\AC - Drawings\Current\TX-4175-83.dwg, FOX07

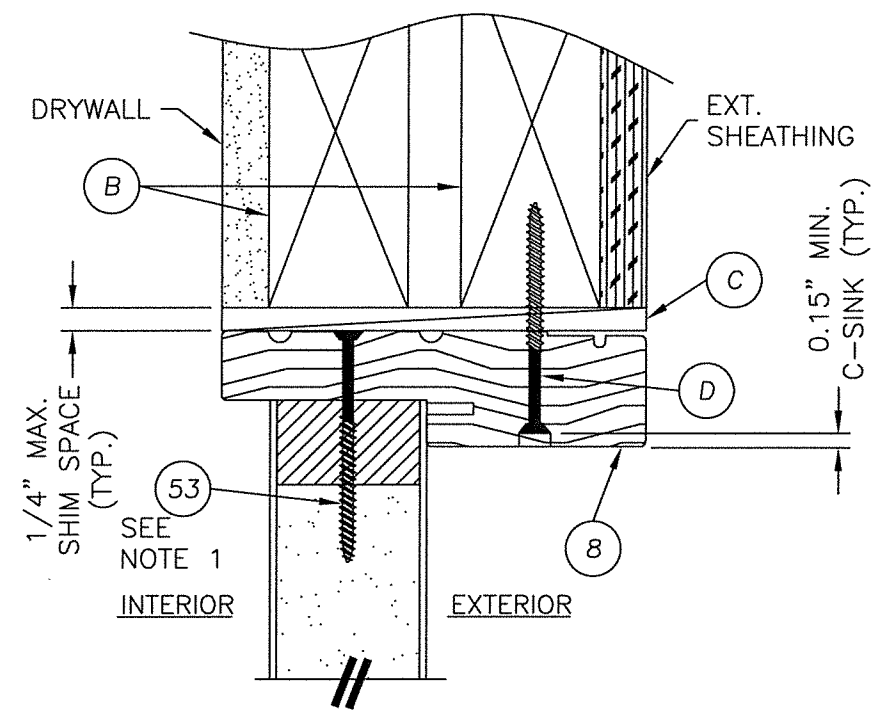

1  
7 VERTICAL CROSS SECTION

NOTE:  
1. SIDELITE ASSEMBLY SCREWS LOCATED 4.25\"/>

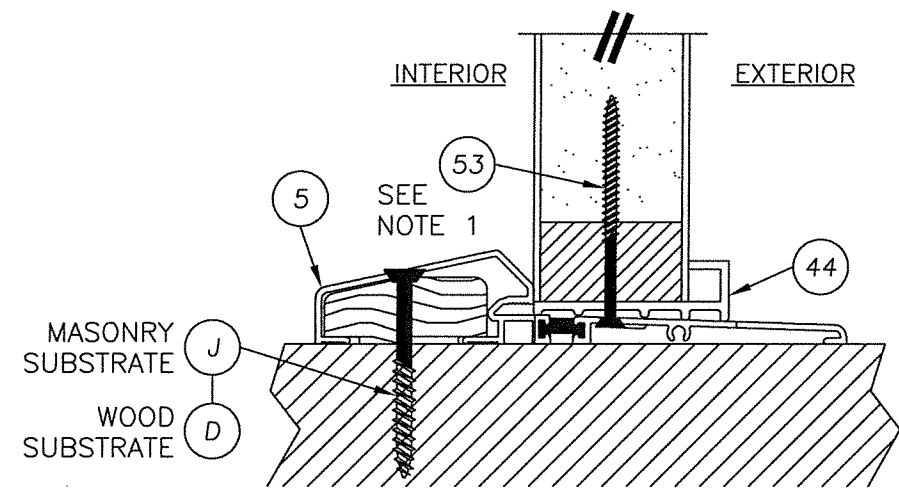

5  
7 VERTICAL CROSS SECTION

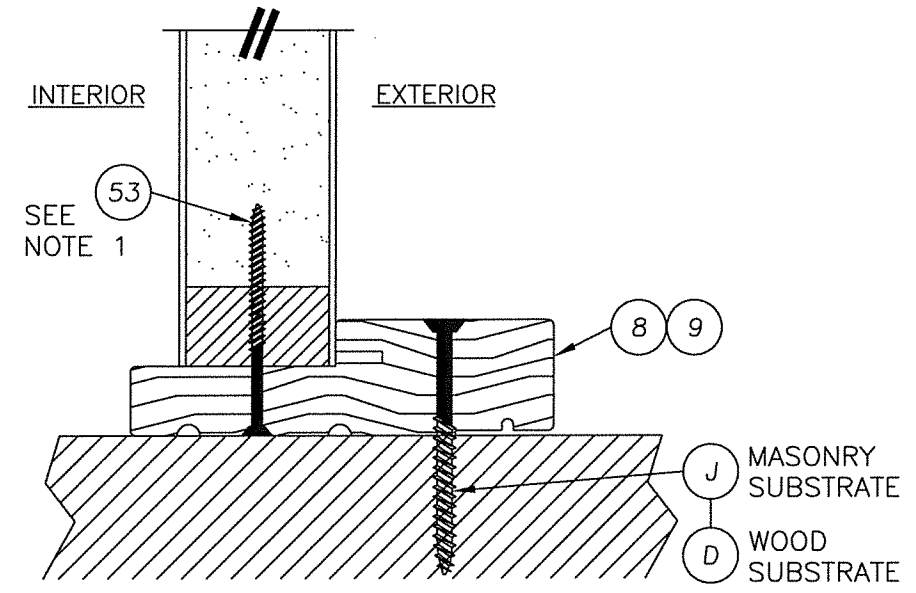

4  
7 VERTICAL CROSS SECTION

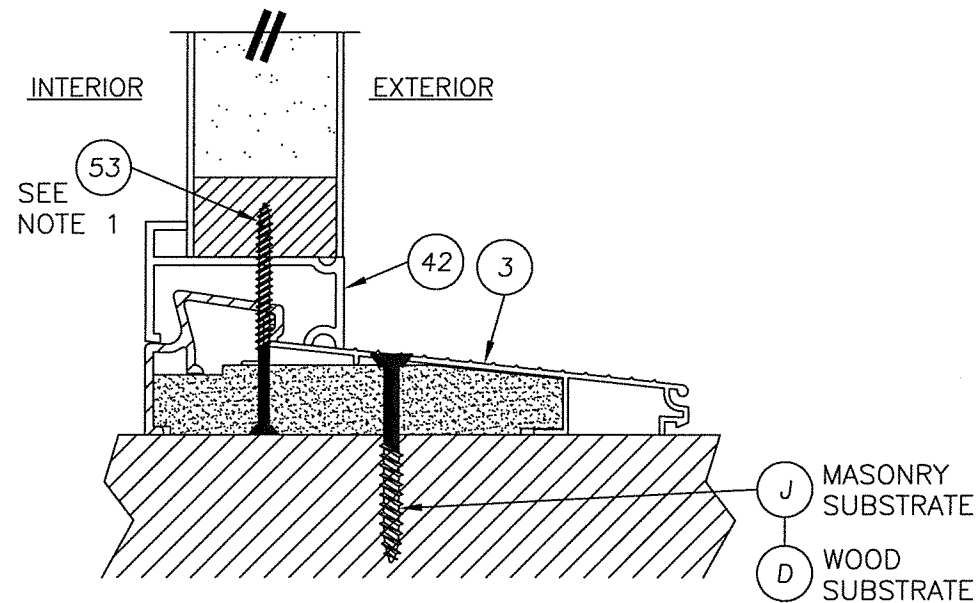

3  
7 VERTICAL CROSS SECTION

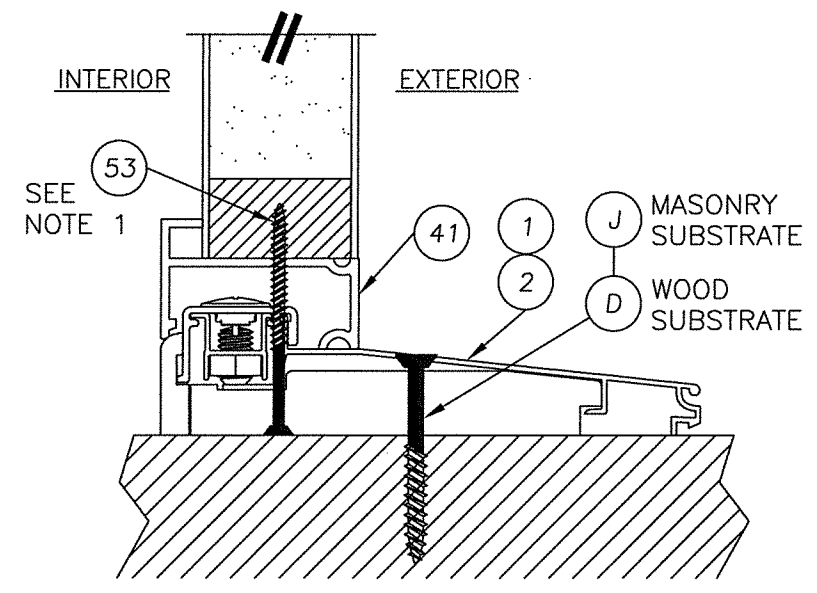

6  
7 VERTICAL CROSS SECTION

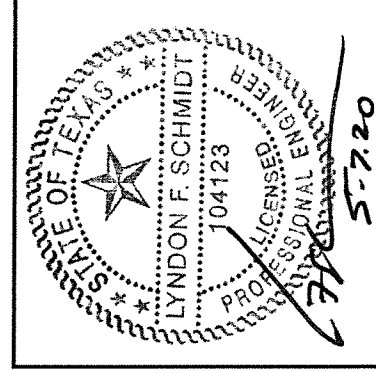

Documents Prepared By: Lyndon F. Schmidt, P.E.  
TEXAS P.E. #104123

**RW** BUILDING CONSULTANTS, INC.  
P.O. Box 230 Valrico FL 33595  
Phone No.: 813.659.9197

TEXAS BOARD OF PROFESSIONAL ENGINEERS  
CERTIFICATE OF REGISTRATION # F-11852

PRODUCT: SINGLE OPAQUE FIBERGLASS DOOR W/SIDELITES "IMPACT" INSURING / OUTSWING PART OR ASSEMBLY: VERTICAL CROSS SECTIONS

NO.	DATE	DESCRIPTION	BY
1	5/07/20	UPDATE TO 2018 IBC/IRC CODE	LFS

DATE: 7/16/12  
SCALE: N.T.S.  
DWG. BY: JK  
CHK. BY: LFS  
DRAWING NO.: TX-4183  
SHEET 7 OF 10

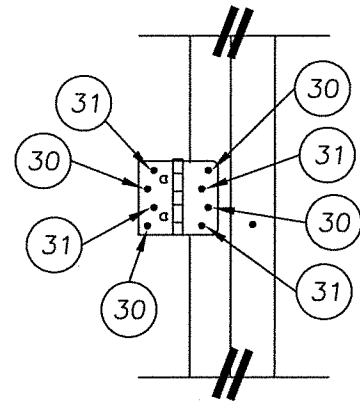

HINGE DETAIL

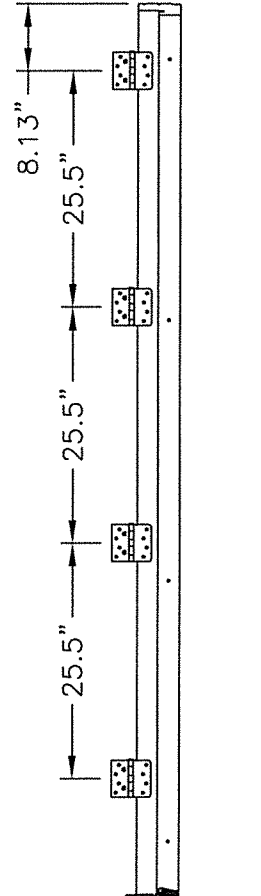

HINGE DETAIL

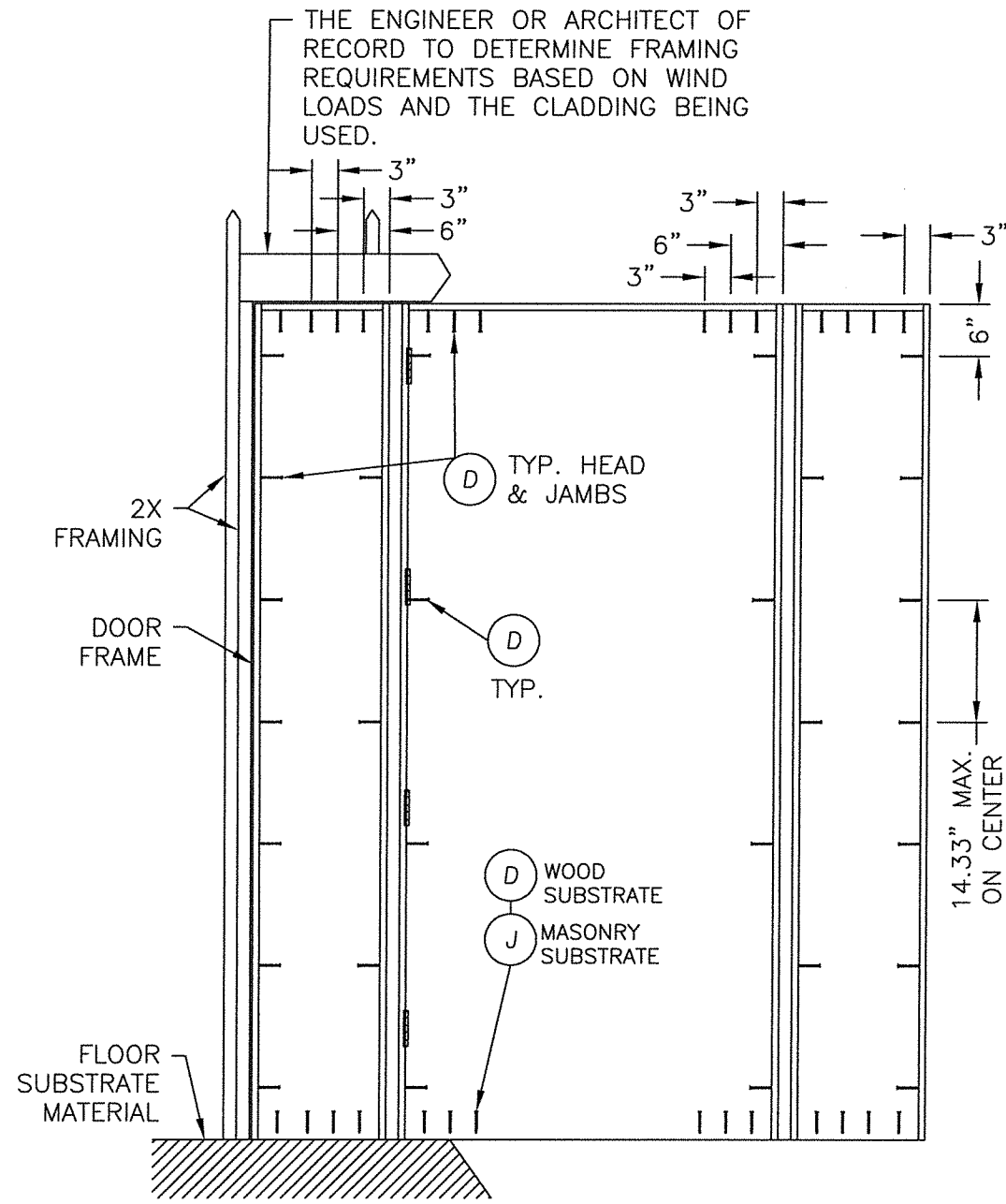

FRAME ANCHORING

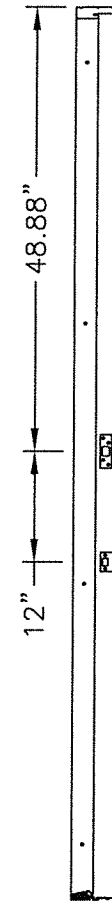

STRIKE PLATE DETAIL

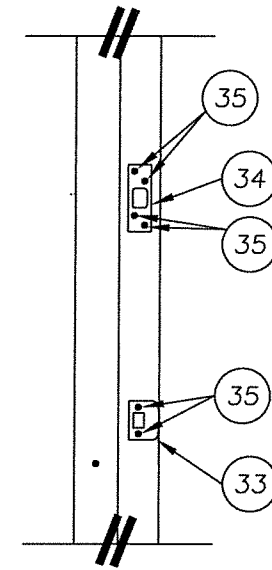

STRIKE PLATE DETAIL

**CONCRETE ANCHOR NOTES:**

1. Concrete anchor locations at the corners may be adjusted to maintain the min. edge distance to mortar joints.
2. Concrete anchor locations noted as "MAX. ON CENTER" must be adjusted to maintain the min. edge distance to mortar joints, additional concrete anchors may be required to ensure the "MAX. ON CENTER" dimension are not exceeded.
3. Concrete anchor table:

ANCHOR TYPE	ANCHOR SIZE	MIN. EMBEDMENT	MIN. CLEARANCE TO MASONRY EDGE	MIN. CLEARANCE TO ADJACENT ANCHOR
ITW TAPCON®	1/4"	1-3/4"	2-1/2"	3"
ELCO ULTRACON®	1/4"	1-3/4"	1"	3"

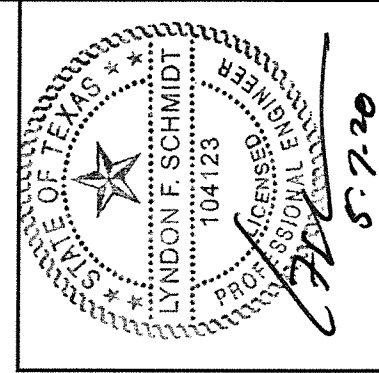

Documents Prepared By: Lyndon F. Schmidt, P.E.  
TEXAS P.E. #104123

**RW** BUILDING CONSULTANTS, INC.  
P.O. Box 230 Vairico FL 33595  
Phone No.: 813.659.9197

TEXAS BOARD OF PROFESSIONAL ENGINEERS  
CERTIFICATE OF REGISTRATION # F-11852

PRODUCT: SINGLE OPAQUE FIBERGLASS DOOR W/SIDELITES "IMPACT" INSWING / OUTSWING  
PART OR ASSEMBLY: FRAME ANCHORING

NO.	DATE	DESCRIPTION	BY
1	5/07/20	UPDATE TO 2018 IBC/IRC CODE	LFS

DATE: 7/16/12

SCALE: N.T.S.

DWG. BY: JK

CHK. BY: LFS

DRAWING NO.: TX-4183

SHEET 8 OF 10



R:\Clients\Therma Tru PERMANENT\B - Texas Dept of Ins\TDI - DR 601 - 80 Opaque FG Imp IS - OS Sgls Dbls w-wo Imp SL\C - Drawings\Current\TX-4175-83.dwg, FOXO9

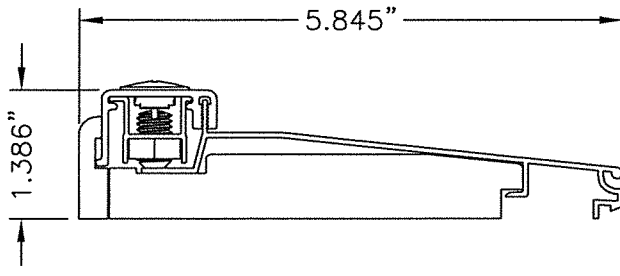

2 THRESHOLD  
INSWING ADJUSTABLE

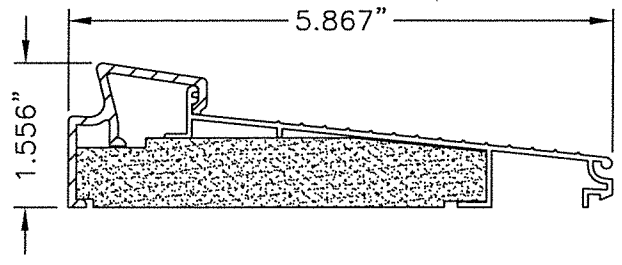

3 THRESHOLD  
INSWING SELF-ADJUST

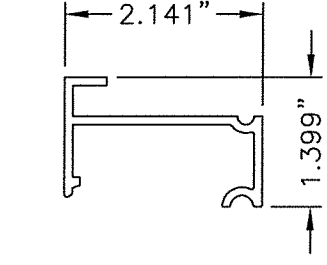

41 INSWING SIDELITE  
SPACER

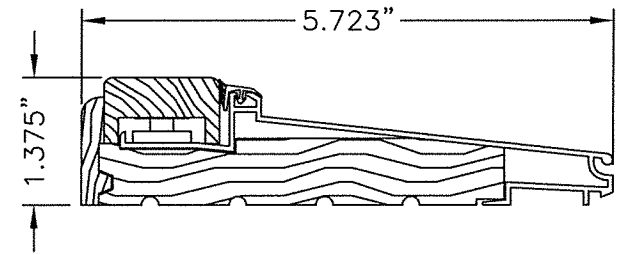

1 THRESHOLD  
INSWING ADJUSTABLE

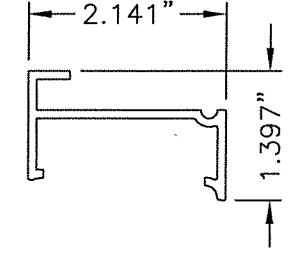

40 INSWING SIDELITE  
SPACER

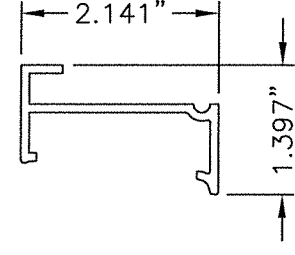

43 INSWING SIDELITE  
SPACER

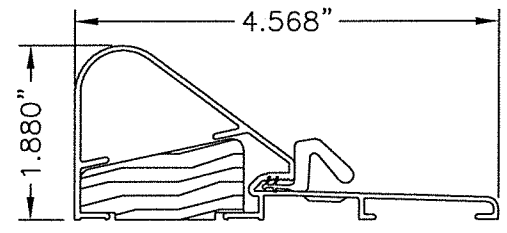

4 THRESHOLD  
OUTSWING COASTAL

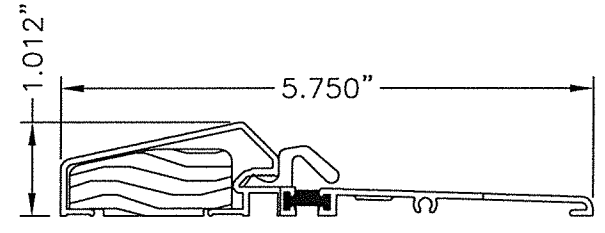

5 THRESHOLD  
OUTSWING STANDARD

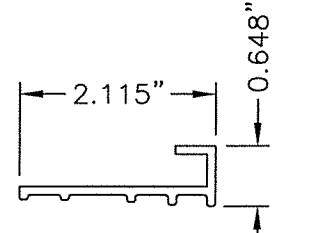

44 OUTSWING SIDELITE  
SPACER

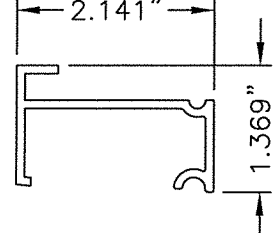

42 INSWING SIDELITE  
SPACER

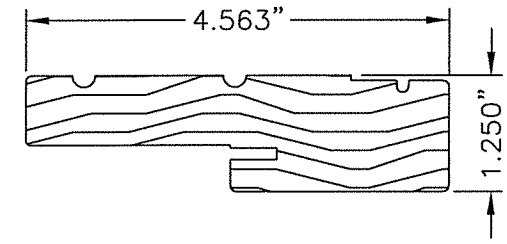

8 JAMB

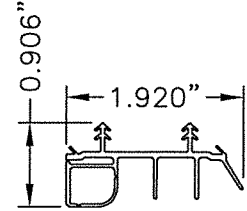

7 SWEEP

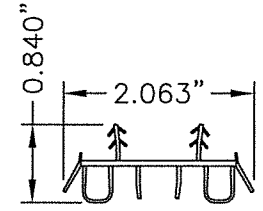

52 SWEEP

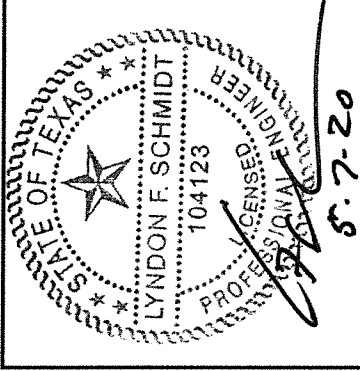

Documents Prepared By: Lyndon F. Schmidt, P.E.  
TEXAS P.E. #104123

**RW** BUILDING CONSULTANTS, INC.  
P.O. Box 230 Valrico FL 33595  
Phone No.: 813.659.9197

TEXAS BOARD OF PROFESSIONAL ENGINEERS  
CERTIFICATE OF REGISTRATION # F-11852

PRODUCT:	SINGLE OPAQUE FIBERGLASS DOOR W/SIDELITES "IMPACT" INSWING / OUTSWING
PART OR ASSEMBLY:	COMPONENTS

NO.	DATE	DESCRIPTION	LFS	BY
1	5/07/20	UPDATE TO 2018 IBC/IRC CODE	LFS	BY

DATE:	7/16/12
SCALE:	N.T.S.
DWG. BY:	JK
CHK. BY:	LFS
DRAWING NO.:	TX-4183
SHEET	9 of 10

© 2012 R.W. BUILDING CONSULTANTS INC.

R:\Clients\Therma Tru PERMANENT\B - Texas Dept of Ins\TDI - DR 601 - 80 Opaque FG Imp IS - OS Sgls Dbls w-wo Imp SL/C - Drawings\Current\TX-4175-83.dwg, FOXO10

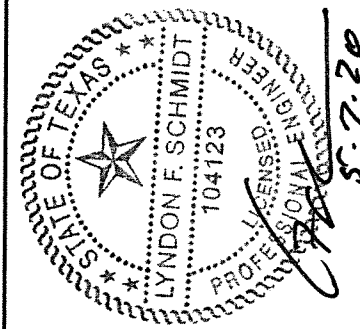

BILL OF MATERIALS		
ITEM	DESCRIPTION	MATERIAL
B	2X FRAMING (G >= 0.42)	WOOD
C	1/4" MAX. SHIM SPACE	WOOD
D	#10 X 2-1/2" PFH WOOD SCREW	STEEL
G	KWIKSET 200 SERIES PASSAGE LOCK	STEEL
H	KWIKSET 600 SERIES DEADBOLT	STEEL
J	1/4" ELCO OR ITW CONCRETE SCREW (1-3/4" MIN. EMB.)	STEEL
O	1X MULLION (G >= 0.42)	WOOD
1	IN swing ADJUSTABLE THRESHOLD (IS300AJ)	ALUM./WOOD
2	IN swing THRESHOLD (IS300HP5)	ALUM./COMP.
3	IN swing SELF ADJUST THERMAL BREAK THRESHOLD (ISP30M)	ALUM./COMP.
4	OUT swing COASTAL THRESHOLD	ALUM./WOOD
5	OUT swing STANDARD THRESHOLD	ALUM./WOOD
7	DOOR BOTTOM SWEEP	VINYL
8	JAMB (OAK)	WOOD
16	HINGE STILE (CLASSIC-CRAFT)	WOOD/LVL
17	LOCK STILE (CLASSIC-CRAFT)	WOOD/LVL
18	TOP RAIL (CLASSIC-CRAFT)	PVC
19	BOTTOM RAIL (CLASSIC-CRAFT)	PVC
20	PANEL REINFORCEMENT 0.023" THK. (CLASSIC-CRAFT)	STEEL
21	DOOR SKIN 0.125" THK. (CLASSIC-CRAFT) Fy = 6,000 PSI MIN.	FIBERGLASS
22	LOCK & HINGE STILE (CLASSIC-CRAFT RUSTIC)	WOOD/LVL
23	TOP RAIL (CLASSIC-CRAFT RUSTIC)	WOOD
24	BOTTOM RAIL (CLASSIC-CRAFT RUSTIC)	PVC
25	PANEL REINFORCEMENT 0.023" THK. (CLASSIC-CRAFT RUSTIC)	STEEL
26	DOOR SKIN 0.125" THK. (CC RUSTIC) Fy = 6,000 PSI MIN.	FIBERGLASS
27	FOAM CORE	POLYURETHANE
28	WEATHERSTRIP	FOAM
29	HINGE	STEEL
30	#10 X 2-1/2" PFH SCREW	STEEL
31	#10 X 3/4" PFH SCREW	STEEL
32	#9 X 3" PFH WOOD SCREW	STEEL
33	LATCH STRIKE PLATE	STEEL
34	SECURITY STRIKE PLATE (SINGLE DOOR ONLY)	STEEL
35	#8 X 3" PFH SCREW	STEEL

BILL OF MATERIALS		
ITEM	DESCRIPTION	MATERIAL
40	IN swing SIDELITE SPACER FOR ADJUSTABLE THRESHOLD (DB14AJA)	PVC
41	IN swing SIDELITE SPACER FOR HP THRESHOLD (DB14HPA)	PVC
42	IN swing SIDELITE SPACER FOR SELF ADJUST THRESHOLD (DB14)	PVC
43	IN swing SIDELITE SPACER	PVC
44	OUT swing SIDELITE SPACER	PVC
45	SIDELITE TOP RAIL	PVC
46	SIDELITE SKIN 0.070" THK. (SMOOTH-STAR) Fy = 6,000 PSI MIN.	FIBERGLASS
47	SIDELITE SKIN 0.090" THK. (CLASSIC-CRAFT) Fy = 6,000 PSI MIN.	FIBERGLASS
48	SIDELITE SKIN 0.070" THK. (FIBER-CLASSIC) Fy = 6,000 PSI MIN.	FIBERGLASS
49	#6 X 1-3/4" PFH SCREW (LITE FRAME)	STEEL
50	LITE FRAME FIBER-CLASSIC	PVC
51	LITE FRAME SMOOTH-STAR	PVC
52	DOOR BOTTOM SWEEP	VINYL
53	#9 X 2-1/2" PFH WOOD SCREW (JAMB TO SIDELITE)	STEEL
54	3/4" INSULATED GLASS 1/8" TEMPERED - AIR - 1/8" TEMPERED	GLASS
55	1" INSULATED GLASS 1/8" TEMPERED - AIR - 1/8" TEMPERED	GLASS
56	1/2" INSULATED GLASS 1/8" TEMPERED - AIR - 1/8" TEMPERED	GLASS
57	GLAZING COMPOUND	SILICONE
58	SEALANT	SILICONE
59	#9 X 1" PPH SCREW (LITE FRAME)	STEEL
60	SIDELITE STILE	WOOD
61	SIDELITE BOTTOM RAIL	PVC

Documents Prepared By: Lyndon F. Schmidt, P.E. TEXAS P.E. #104123

**RW** BUILDING CONSULTANTS, INC.  
P.O. Box 230 Valrico FL 33595  
Phone No.: 813.659.9197

TEXAS BOARD OF PROFESSIONAL ENGINEERS  
CERTIFICATE OF REGISTRATION # F-11852

PRODUCT: SINGLE OPAQUE FIBERGLASS DOOR W/SIDELITES "IMPACT" IN swing / OUT swing

PART OR ASSEMBLY: BILL OF MATERIALS

NO.	DATE	DESCRIPTION
1	5/07/20	UPDATE TO 2018 IBC/IRC CODE

DATE: 7/16/12  
SCALE: N.T.S.  
DWG. BY: JK  
CHK. BY: LFS  
DRAWING NO.: TX-4183  
SHEET 10 of 10

© 2012 R.W. BUILDING CONSULTANTS INC.