

THERMA TRU®

118 INDUSTRIAL DR., EDGERTON, OH 43517

SMOOTH-STAR, FIBER-CLASSIC, CLASSIC-CRAFT & CLASSIC-CRAFT RUSTIC DOUBLE "IMPACT" DOOR WITH "NON-IMPACT" SIDELITES IN SWING / OUT SWING

EVALUATED FOR USE IN THE STATE OF TEXAS

The Fiberglass Door system described herein complies with the 2018 International Residential Code (IRC), Sections R301 & R609 and the 2018 International Building Code (IBC), Sections 1404.13, 1609, 1709.5, 2403 and 2404 subject to the following conditions:

1. Anchors shall be as listed and spaced as shown in the details. Anchor embedment to base material shall be beyond wall dressing or stucco.
2. When used in areas requiring wind-borne debris protection, the opaque door does not require impact protection and meets missile level "D" as defined in ASTM E 1996. The sidelites are required to be protected with an impact resistant covering that complies with Section R301.2.1.2 of the IRC and Section 1609.1.2 of the IBC.
3. Allowable design pressure requirements must be equal to or less than the design pressure rating shown in the design pressure chart, sheet 1 of this drawing.
4. Conditions not covered by this drawing are subject to further engineering analysis.
5. Fiber-Classic and Smooth-Star Door and Sidelite panels require the use of "J" part numbers. These door and sidelite panels must be stained or painted within six months of installation.

TABLE OF CONTENTS	
SHEET #	DESCRIPTION
1	TYPICAL ELEVATION, DESIGN PRESSURES & GENERAL NOTES
2	DOOR PANEL DETAILS (SMOOTH-STAR)
3	DOOR PANEL DETAILS (CLASSIC-CRAFT)
4	DOOR PANEL DETAILS (CLASSIC-CRAFT RUSTIC)
5	DOOR PANEL DETAILS (FIBER-CLASSIC)
6	SIDELITE PANEL DETAILS
7	HORIZONTAL CROSS SECTIONS
8	VERTICAL CROSS SECTIONS
9	VERTICAL CROSS SECTIONS
10	FRAME ANCHORING
11	ASTRAGAL, HARDWARE & GLAZING DETAILS
12	COMPONENTS
13	BILL OF MATERIALS

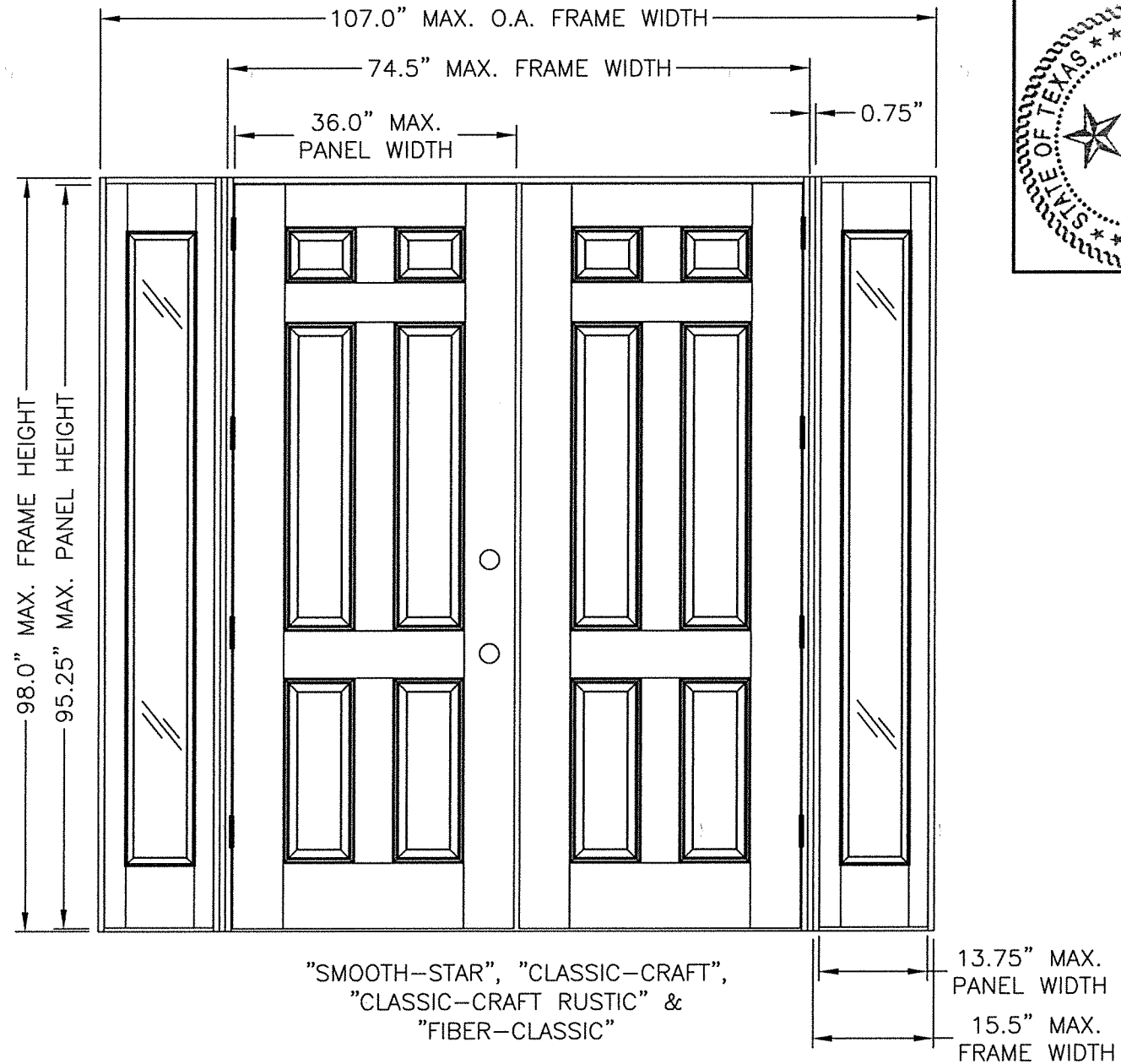

DOOR TYPE	SWING	OVERALL FRAME DIMENSION	DESIGN PRESSURE	
			POSITIVE	NEGATIVE
CLASSIC-CRAFT	OUTSWING	107.0" X 96.5"	+65.0	-65.0
	IN SWING	107.0" X 98.0"	+65.0	-65.0
FIBER-CLASSIC	OUTSWING	107.0" X 96.5"	+65.0	-65.0
	IN SWING	107.0" X 98.0"	+65.0	-65.0
SMOOTH-STAR	OUTSWING	107.0" X 96.5"	+65.0	-65.0
	IN SWING	107.0" X 98.0"	+65.0	-65.0
CLASSIC-CRAFT RUSTIC	OUTSWING	107.0" X 96.5"	+65.0	-65.0
	IN SWING	107.0" X 98.0"	+65.0	-65.0

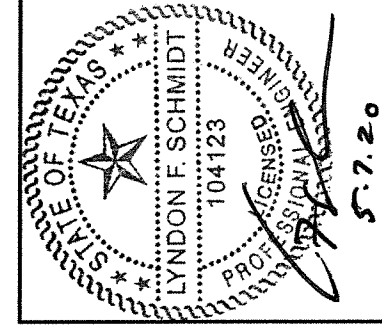

Documents Prepared By: Lyndon F. Schmidt, P.E.
TEXAS P.E. #104123

RW BUILDING CONSULTANTS, INC.
P.O. Box 230 Vairico FL 33595
Phone No.: 813.659.9197

TEXAS BOARD OF PROFESSIONAL ENGINEERS
CERTIFICATE OF REGISTRATION # F-11852

PRODUCT: DOUBLE OPAQUE
FIBERGLASS DOOR W/ SIDELITES
"IMPACT" IN SWING / OUTSWING
PART OR ASSEMBLY:
TYPICAL ELEVATION, DESIGN
PRESSURES & GENERAL NOTES

NO.	DATE	BY	REVISIONS
2	5/07/20	LFS	UPDATE TO 2018 IBC/IRC CODE
1	7/22/15	LFS	ADDED GENERAL NOTE 5.

DATE: 7/16/12
SCALE: N.T.S.
DWG. BY: JK
CHK. BY: LFS
DRAWING NO.: TX-4175

SHEET 1 OF 13

R:\Clients\Therma Tru PERMANENT\B - Texas Dept of Ins\TDI - DR 601 - 80 Opaque FG Imp IS - OS Sgls Dbls w-wo Imp SL\C - Drawings\Current\TX-4175-83.dwg, OXXO2

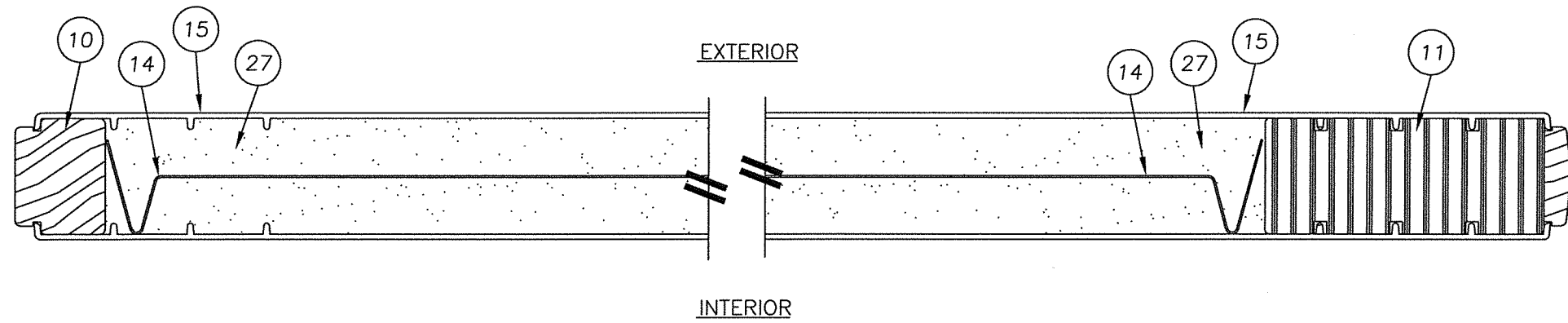

2 HORIZONTAL CROSS SECTION
2 SMOOTH STAR

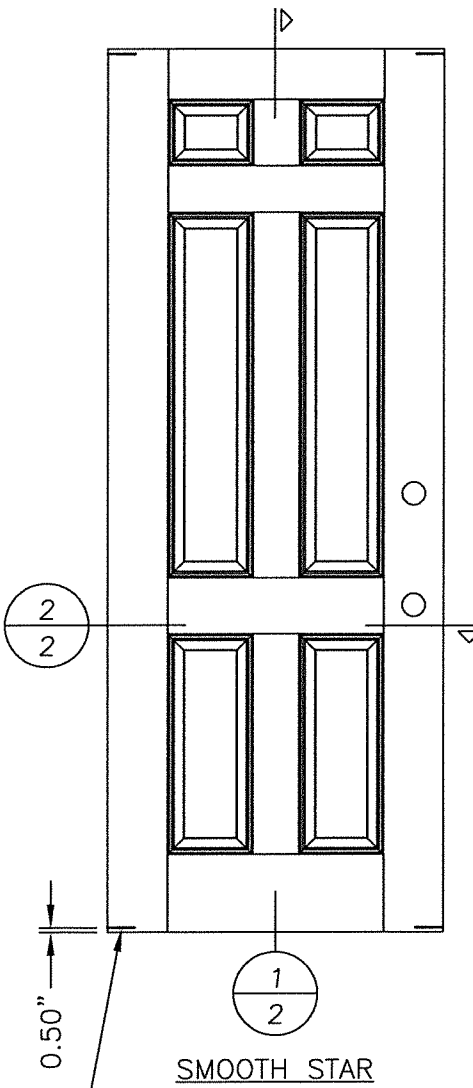

1 2
SMOOTH STAR
TYP. 4 CORNERS OF PANEL

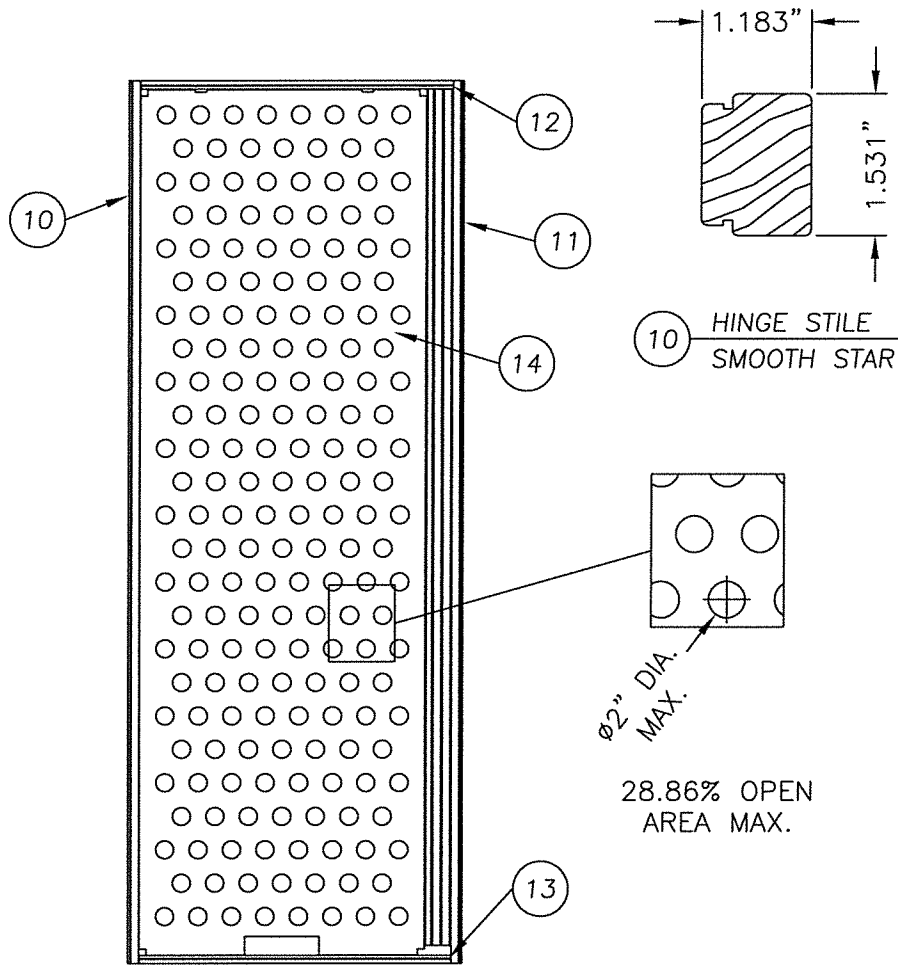

10 HINGE STILE SMOOTH STAR

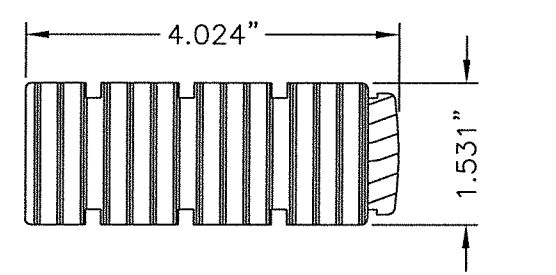

11 LOCK STILE SMOOTH STAR

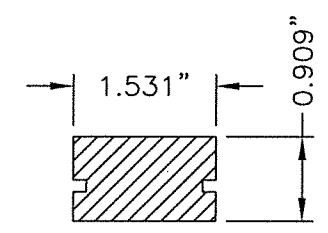

12 TOP RAIL SMOOTH STAR

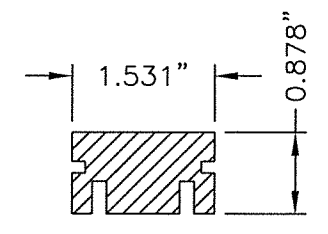

13 BOTTOM RAIL SMOOTH STAR

EXTERIOR INTERIOR

1 VERTICAL CROSS SECTION
2 SMOOTH STAR

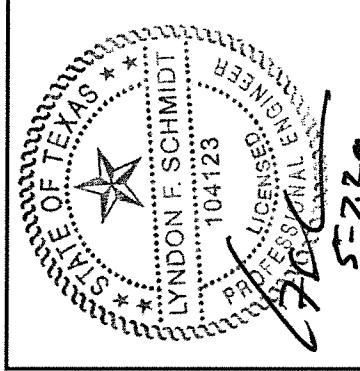
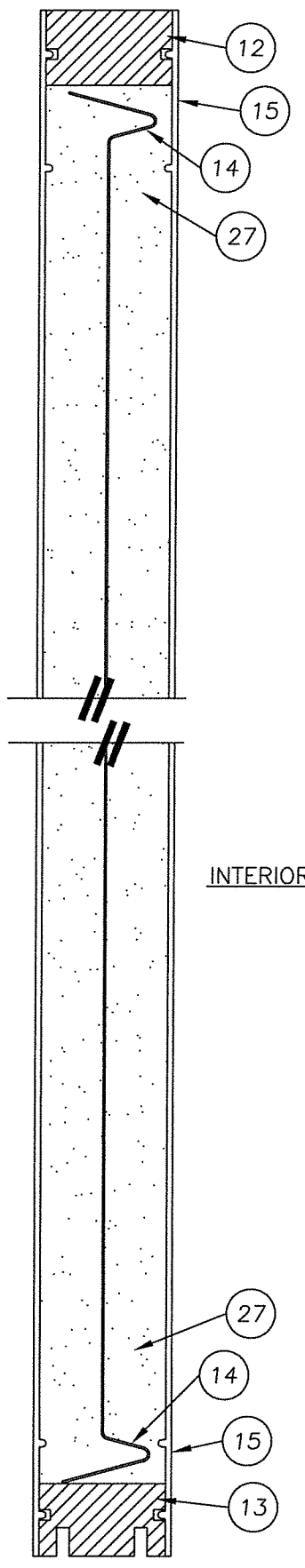

Documents Prepared By: Lyndon F. Schmidt, P.E.
TEXAS P.E. #104123
RW BUILDING CONSULTANTS, INC.
P.O. Box 230 Valrico FL 33595
Phone No.: 813.659.9197
TEXAS BOARD OF PROFESSIONAL ENGINEERS
CERTIFICATE OF REGISTRATION # F-11852

PRODUCT: DOUBLE OPAQUE FIBERGLASS DOOR W/SIDELITES "IMPACT" INSWING / OUTSWING PART OR ASSEMBLY: DOOR PANEL DETAILS (SMOOTH STAR)

NO.	DATE	REVISIONS
2	5/07/20	UPDATE TO 2018 IBC/IRC CODE
1	7/22/15	ADDED GENERAL NOTE 5.
LFS		BY

DATE: 7/16/12
SCALE: N.T.S.
DWG. BY: JK
CHK. BY: LFS
DRAWING NO.: TX-4175
SHEET 2 OF 13

R:\Clients\Therma Tru PERMANENT\B - Texas Dept of Ins\TDI - DR 601 - 80 Opaque FG Imp IS - OS Sgls Dbils w-wo Imp SLIC - Drawings\Current\TX-4175-83.dwg, OXX03

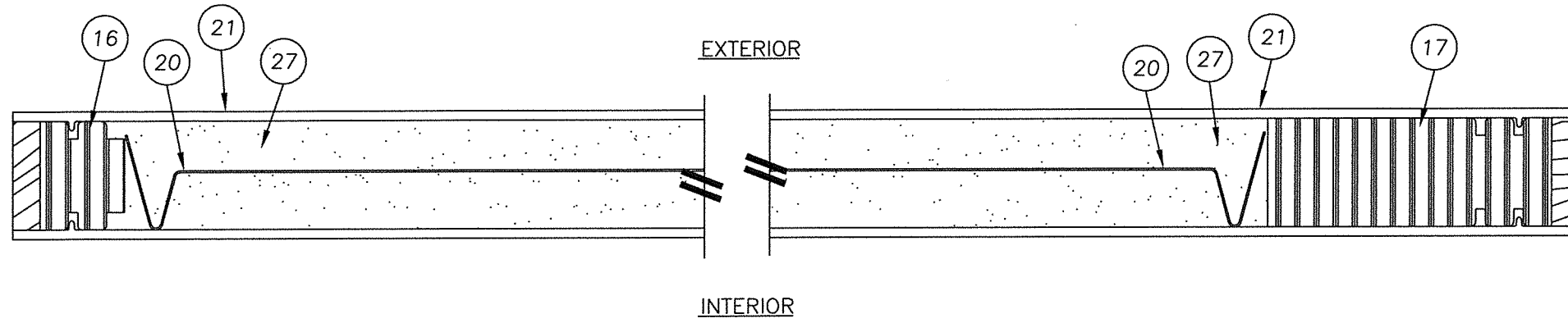

2 HORIZONTAL CROSS SECTION
3 CLASSIC CRAFT

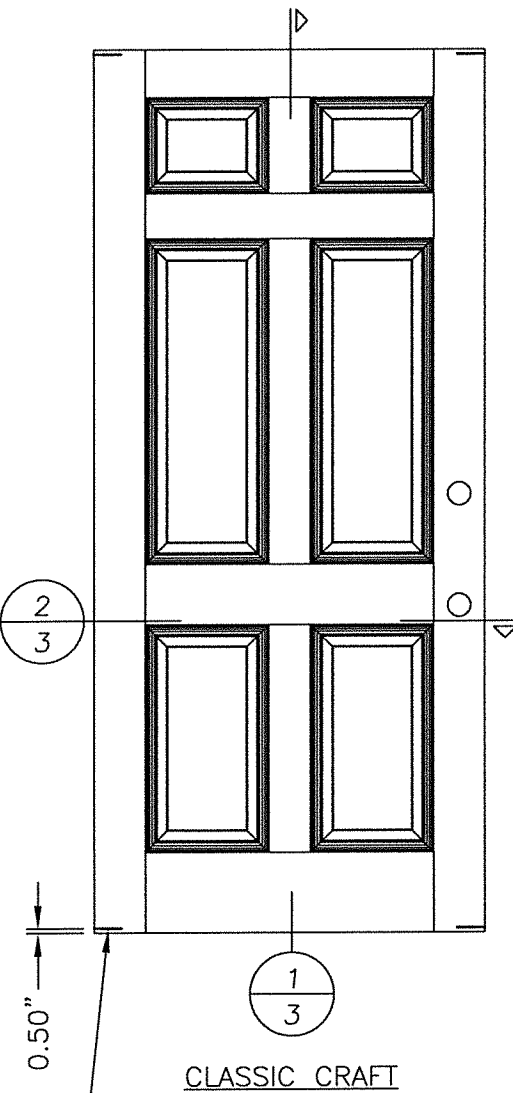

1 VERTICAL CROSS SECTION
3 CLASSIC CRAFT

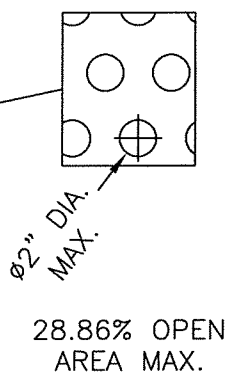
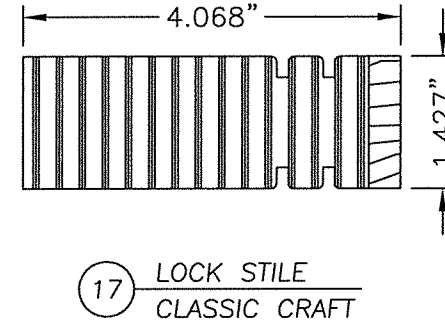
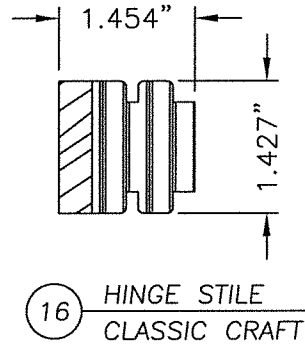
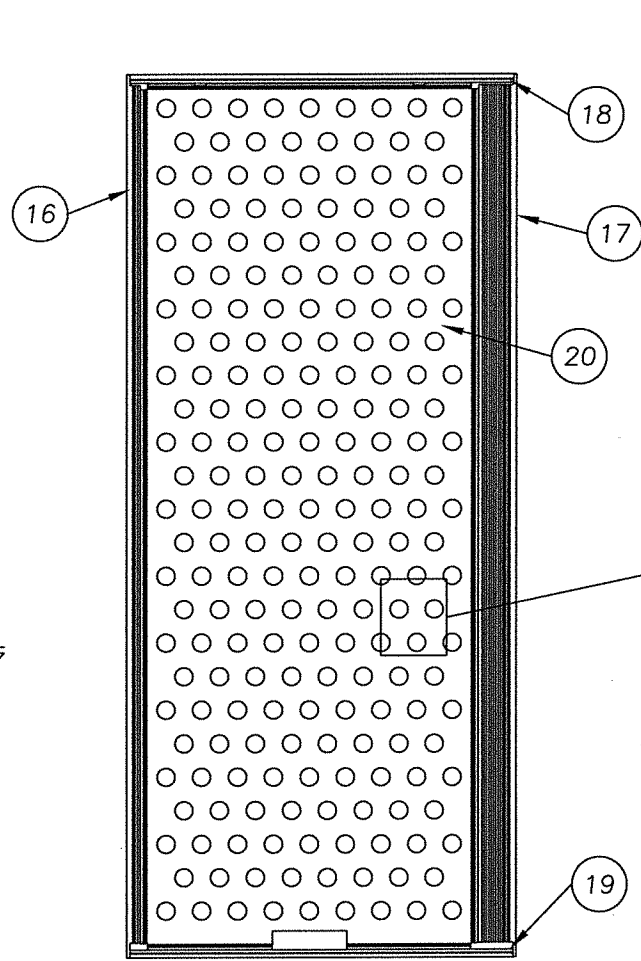

28.86% OPEN AREA MAX.

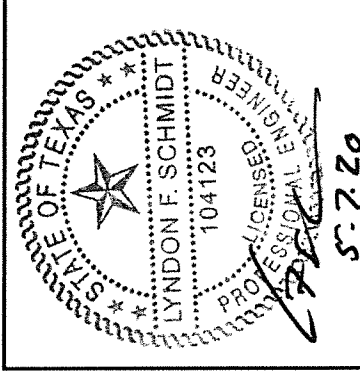
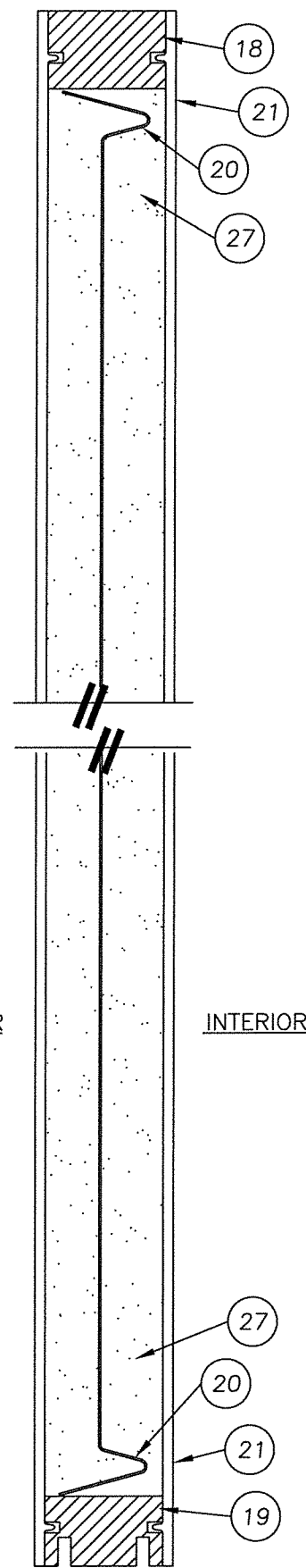
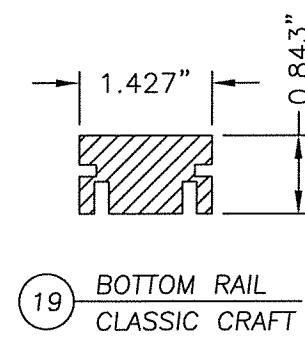
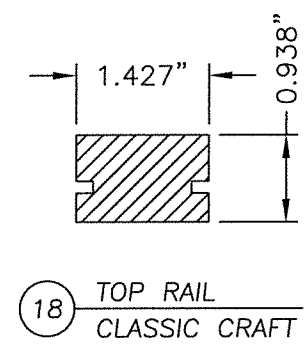

Documents Prepared By: Lyndon F. Schmidt, P.E.
TEXAS P.E. #104123

RW BUILDING CONSULTANTS, INC.
P.O. Box 230 Valrico FL 33595
Phone No.: 813.659.9197

TEXAS BOARD OF PROFESSIONAL ENGINEERS
CERTIFICATE OF REGISTRATION # F-11852

PRODUCT: DOUBLE OPAQUE
FIBERGLASS DOOR W/SIDELITES
"IMPACT" INSWING / OUTSWING
PART OR ASSEMBLY:
DOOR PANEL DETAILS
(CLASSIC CRAFT)

REVISIONS	
NO.	DATE
2	5/07/20
1	7/22/15

DATE: 7/16/12
SCALE: N.T.S.
DWG. BY: JK
CHK. BY: LFS
DRAWING NO.: TX-4175
SHEET 3 OF 13

R:\Clients\Therma Tru PERMANENT\B - Texas Dept of Ins\TDI - DR 601 - 80 Opaque FG Imp IS - OS Sgls Dbis w-wo Imp SLIC - Drawings\Current\TX-4175-83.dwg, OXX04

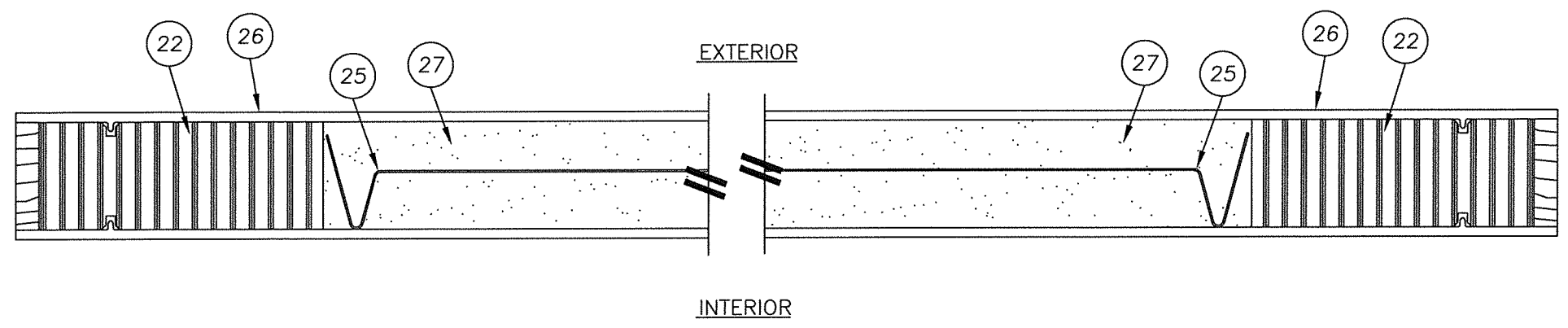

2 HORIZONTAL CROSS SECTION
4 CLASSIC CRAFT RUSTIC

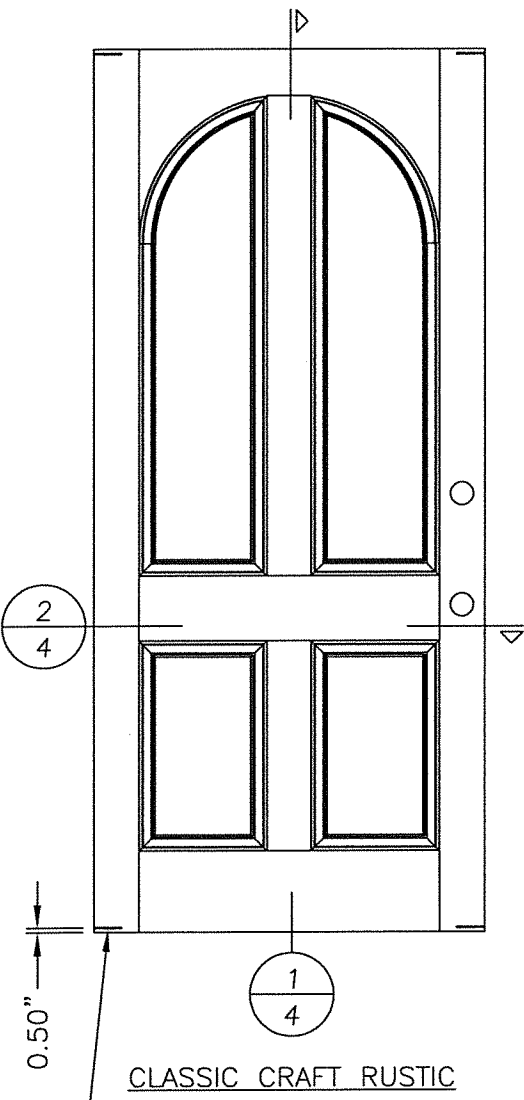

1 VERTICAL CROSS SECTION
4 CLASSIC CRAFT RUSTIC

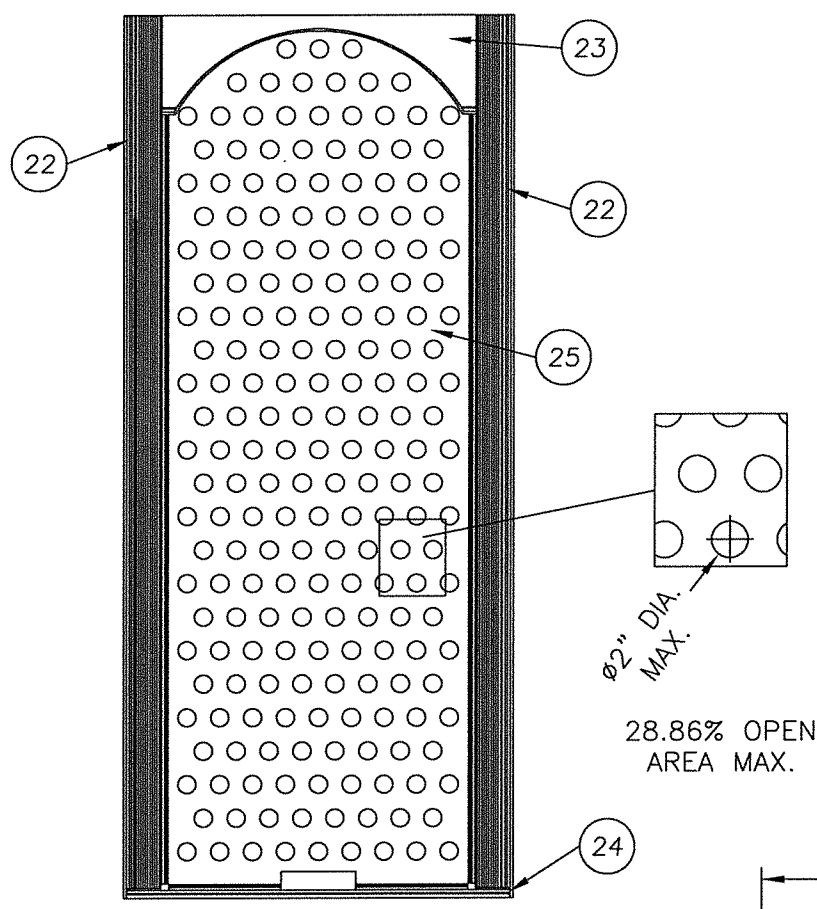

Ø2" DIA. MAX.
28.86% OPEN AREA MAX.

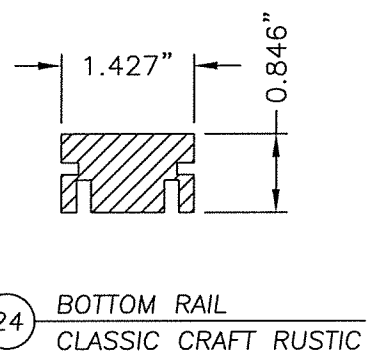

24 BOTTOM RAIL
CLASSIC CRAFT RUSTIC

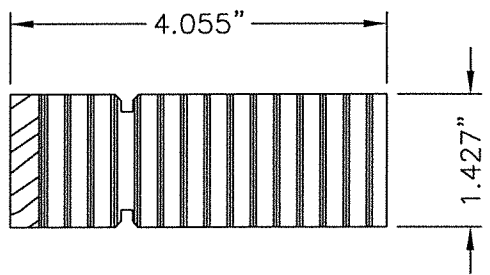

22 LOCK & HINGE STILE
CLASSIC CRAFT RUSTIC

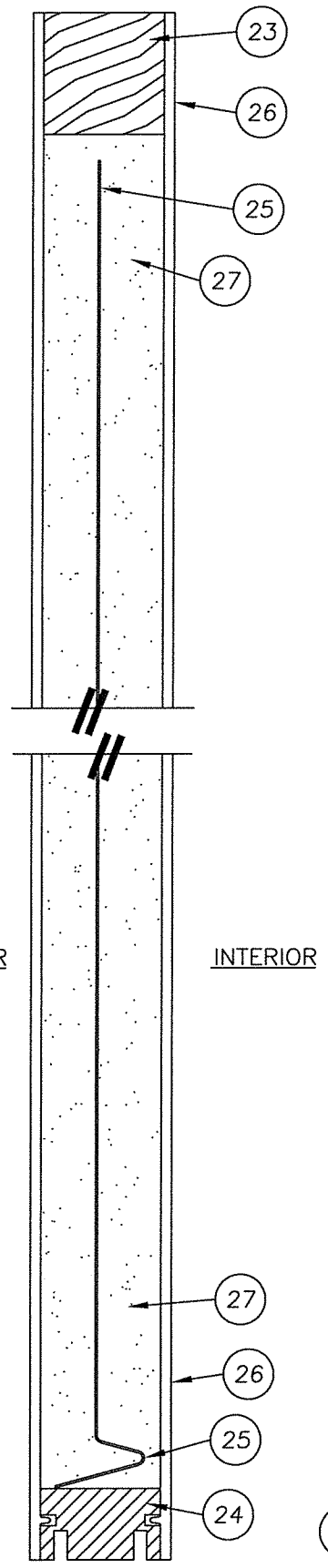

23 TOP RAIL
CLASSIC CRAFT RUSTIC

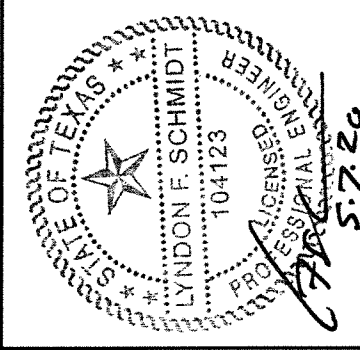
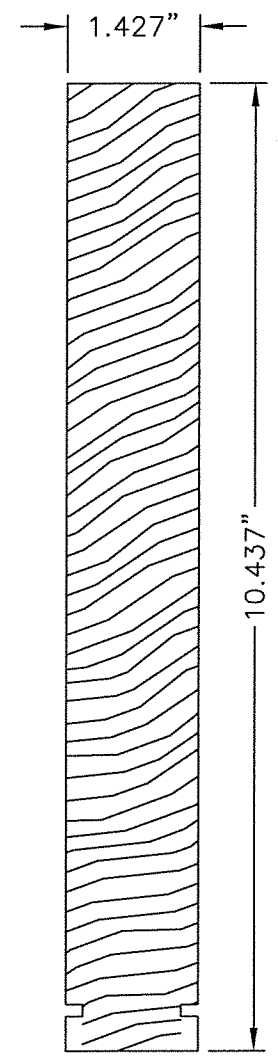

Documents Prepared By: Lyndon F. Schmidt, P.E.
TEXAS P.E. #104123

RW BUILDING CONSULTANTS, INC.
P.O. Box 230 Valrico FL 33595
Phone No.: 813.659.9197

TEXAS BOARD OF PROFESSIONAL ENGINEERS
CERTIFICATE OF REGISTRATION # F-11852

PRODUCT: DOUBLE OPAQUE
FIBERGLASS DOOR W/ SIDELITES
"IMPACT" INSWING / OUTSWING
PART OR ASSEMBLY:

NO.	DATE	REVISIONS
2	5/07/20	UPDATE TO 2018 IBC/IRC CODE
1	7/22/15	ADDED GENERAL NOTE 5.
LFS		
LFS		
BY		

DATE: 7/16/12
SCALE: N.T.S.
DWG. BY: JK
CHK. BY: LFS
DRAWING NO.: TX-4175
SHEET 4 of 13

R:\Clients\Therma Tru PERMANENT\B - Texas Dept of Ins\TDI - DR 601 - 80 Opaque FG Imp IS - OS Sgls Dbls w-wo Imp SLC - Drawings\Current\TX-4175-83.dwg, OXX05

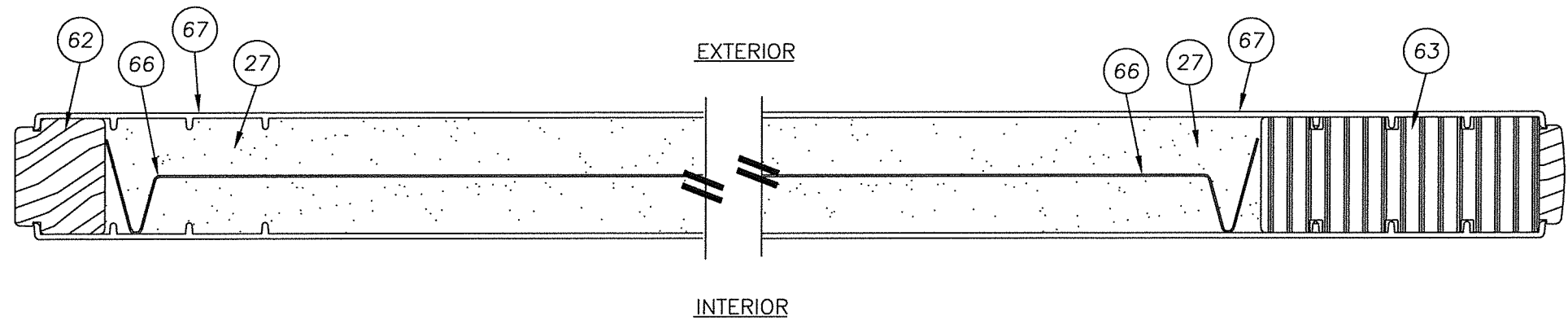

2 HORIZONTAL CROSS SECTION
5 FIBER CLASSIC

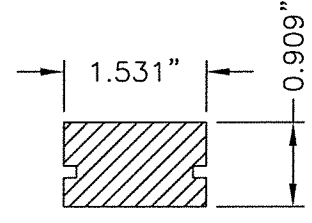

64 TOP RAIL
FIBER CLASSIC

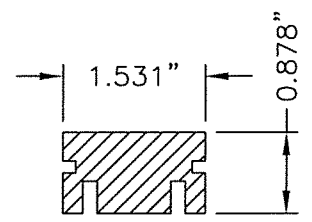

65 BOTTOM RAIL
FIBER CLASSIC

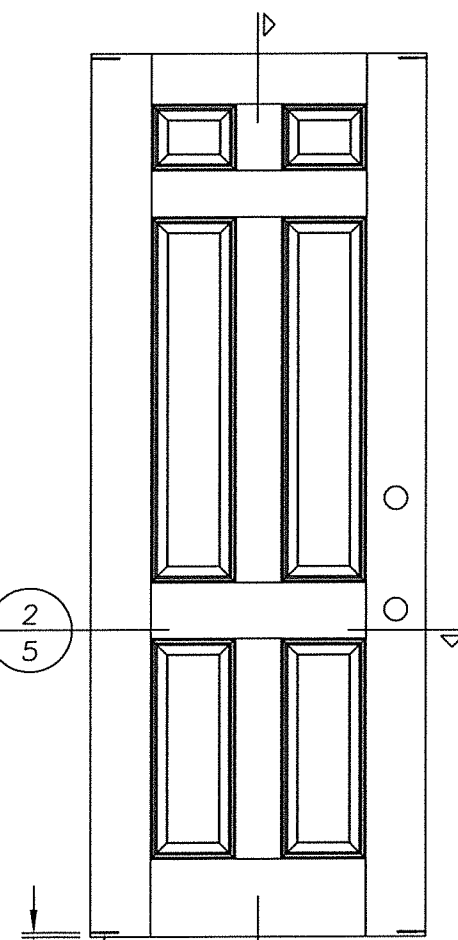

2 TYP. 4 CORNERS OF PANEL
5 FIBER CLASSIC

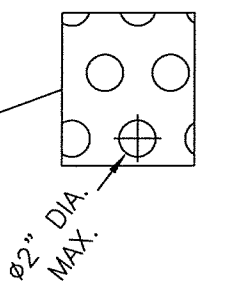
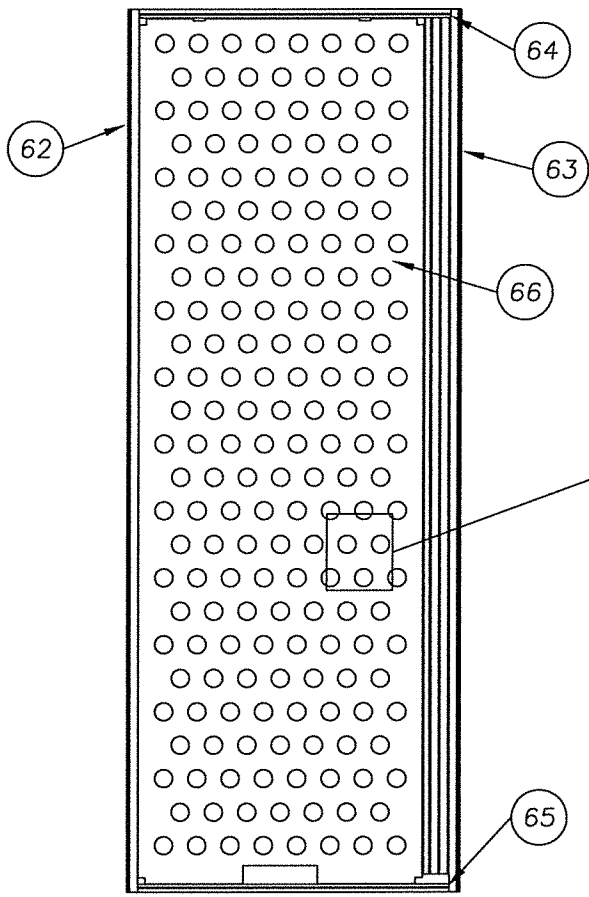

28.86% OPEN AREA MAX.

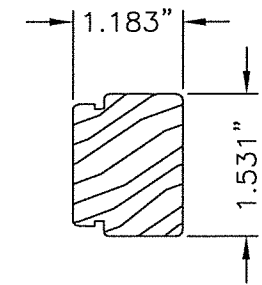

62 HINGE STILE
FIBER CLASSIC

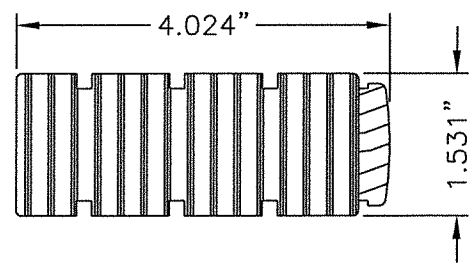

63 LOCK STILE
FIBER CLASSIC

EXTERIOR INTERIOR

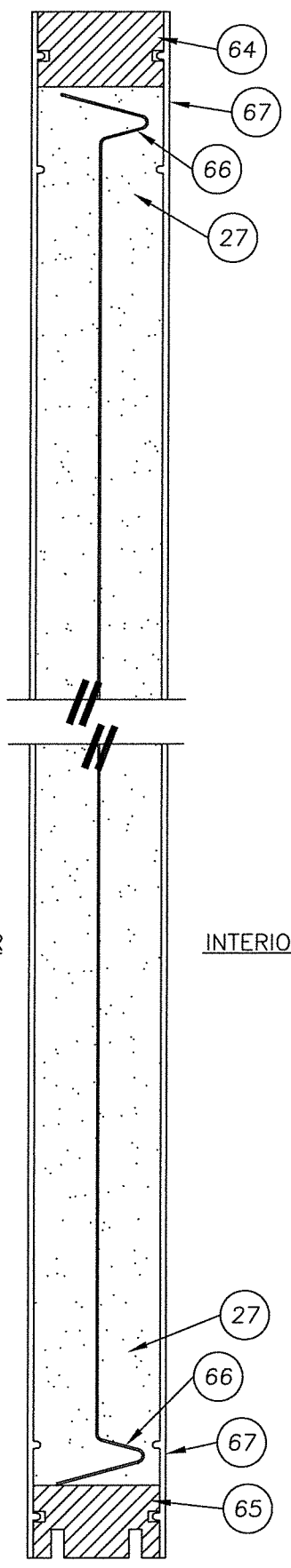

1 VERTICAL CROSS SECTION
5 FIBER CLASSIC

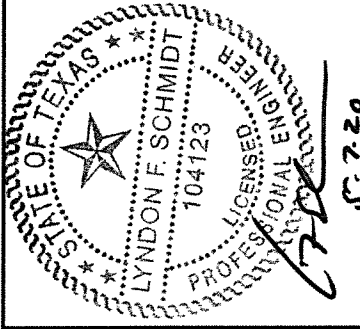

Documents Prepared By: Lyndon F. Schmidt, P.E.
TEXAS P.E. #104123
RW BUILDING CONSULTANTS, INC.
P.O. Box 230 Valrico FL 33595
Phone No.: 813.659.9197
TEXAS BOARD OF PROFESSIONAL ENGINEERS
CERTIFICATE OF REGISTRATION # F-11852

PRODUCT: DOUBLE OPAQUE
FIBERGLASS DOOR W/SIDELITES
"IMPACT" INSWING / OUTSWING
PART OR ASSEMBLY:
DOOR PANEL DETAILS
(FIBER CLASSIC)

NO.	DATE	BY	REVISIONS
2	5/07/20	LFS	UPDATE TO 2018 IBC/IRC CODE
1	7/22/15	LFS	ADDED GENERAL NOTE 5.

DATE: 7/16/12
SCALE: N.T.S.
DWG. BY: JK
CHK. BY: LFS
DRAWING NO.: TX-4175
SHEET 5 OF 13

R:\Clients\Therma Tru PERMANENT\B - Texas Dept of Ins\TDI - DR 601 - 80 Opaque FG Imp IS - OS Sgls Dbils w-wo Imp SLV - Drawings\Current\TX-4175-83.dwg, OXX06

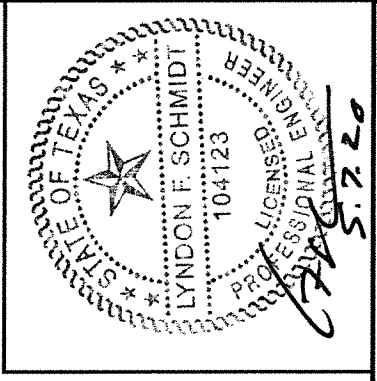
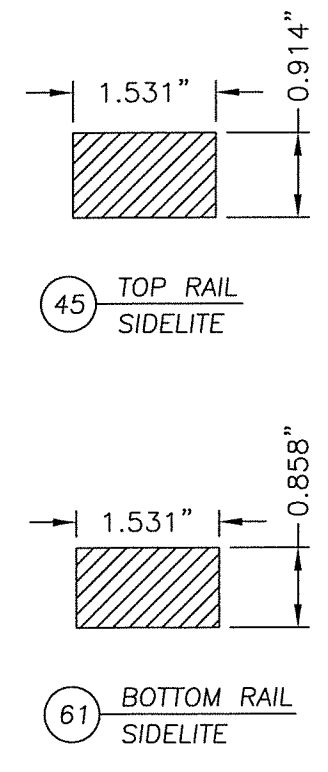
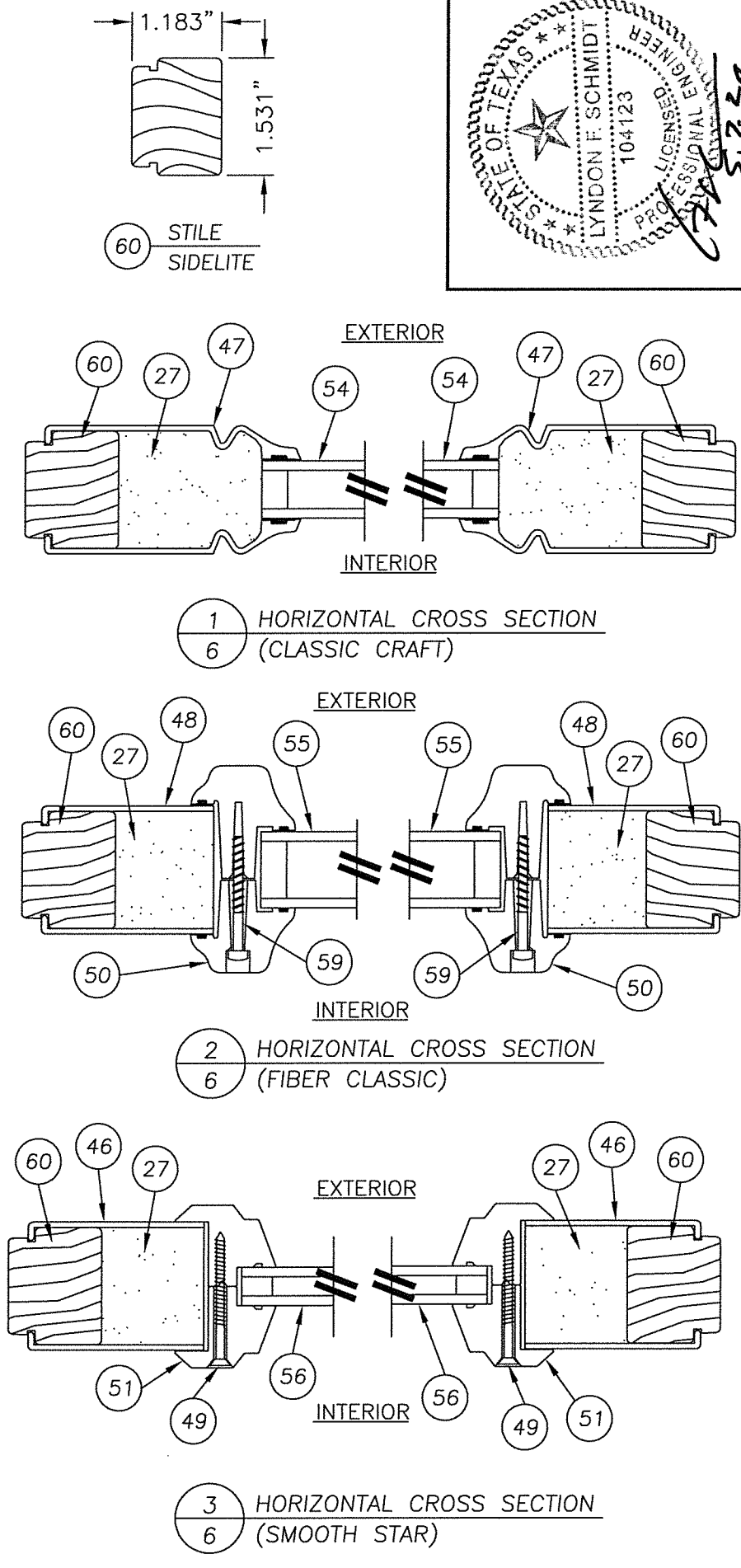
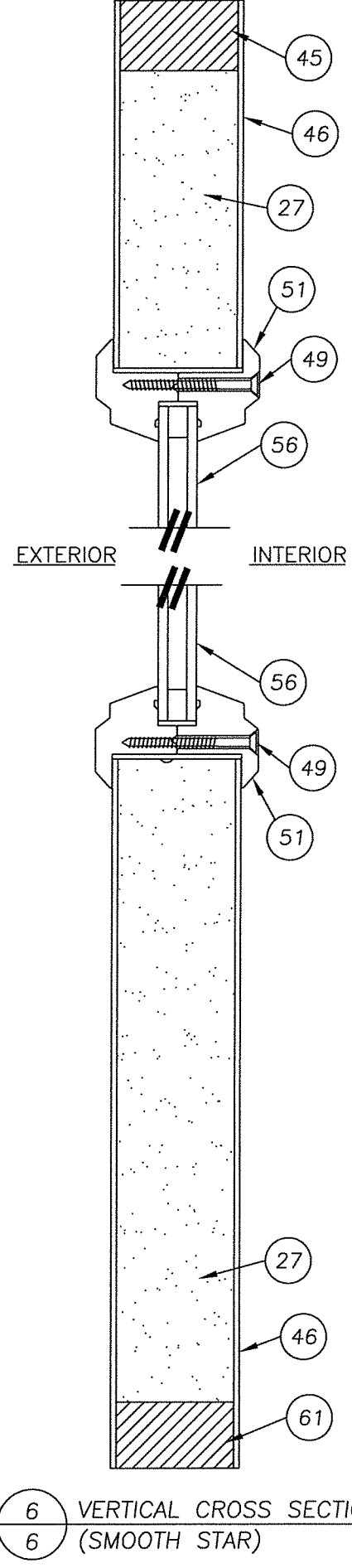
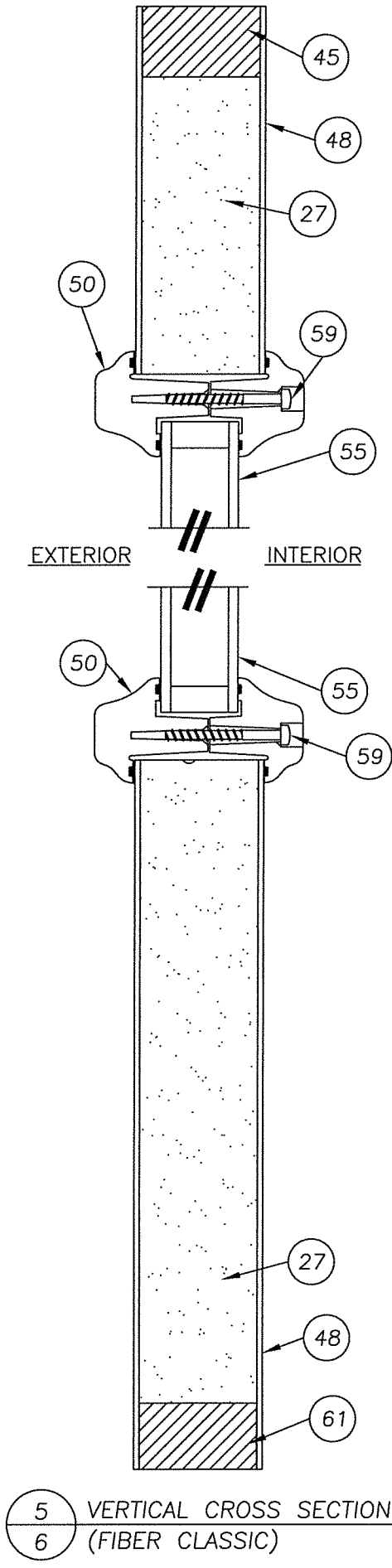
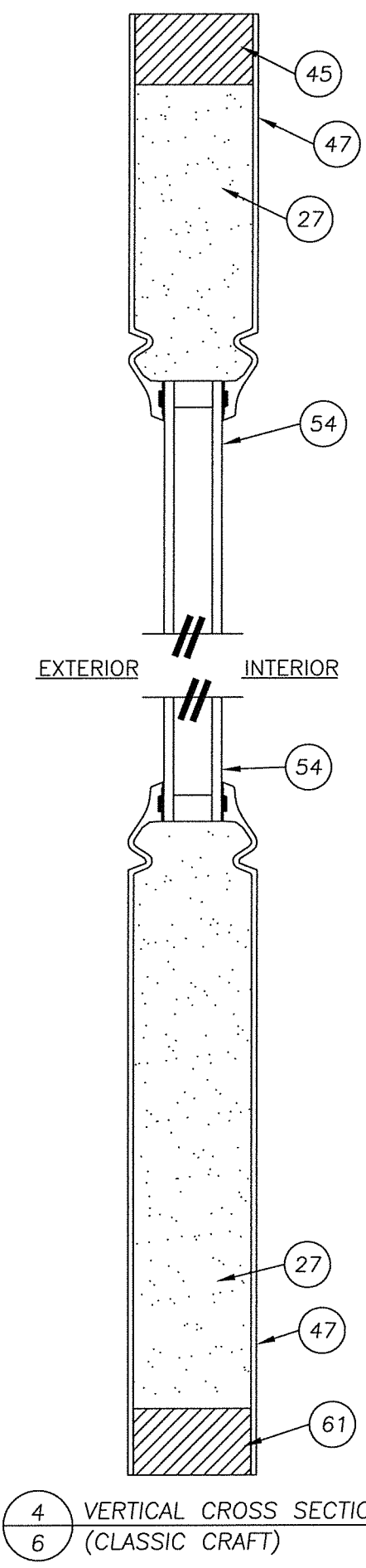
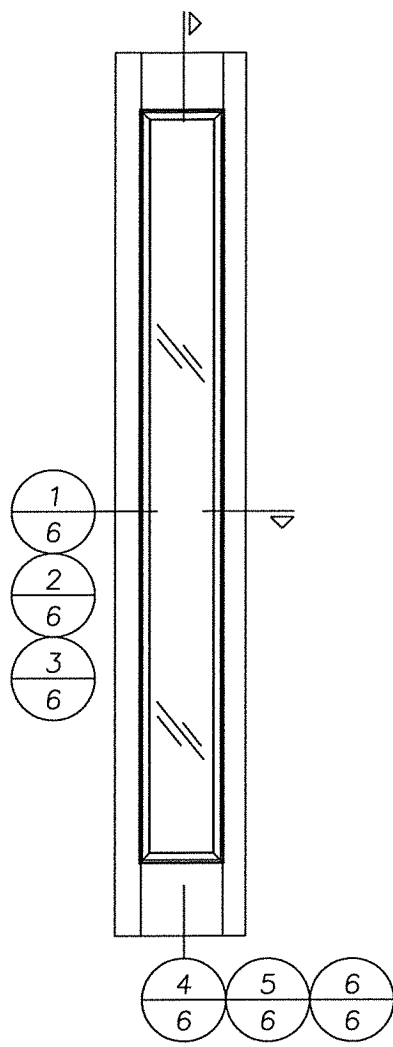

Documents Prepared By: Lyndon F. Schmidt, P.E.
 TEXAS P.E. #104123
RW BUILDING CONSULTANTS, INC.
 P.O. Box 230 Valrico FL 33595
 Phone No.: 813.659.9197
 TEXAS BOARD OF PROFESSIONAL ENGINEERS
 CERTIFICATE OF REGISTRATION # F-11852

PRODUCT: DOUBLE OPAQUE FIBERGLASS DOOR W/ SIDELITES "IMPACT" INSWING / OUTSWING		PART OR ASSEMBLY: SIDELITE PANEL DETAILS	
NO.	DATE	BY	REVISIONS
2	5/07/20	LFS	UPDATE TO 2018 IBC/IRC CODE
1	7/22/15	LFS	ADDED GENERAL NOTE 5.
DATE: 7/16/12		SCALE: N.T.S.	
DWG. BY: JK		CHK. BY: LFS	
DRAWING NO.: TX-4175		SHEET 6 OF 13	

R:\Clients\Therma Tru PERMANENT\B - Texas Dept of Ins\TDI - DR 601 - 80 Opaque FG Imp IS - OS Sgls Dbls w-wo Imp SLIC - Drawings\Current\TX-4175-83.dwg, OXX07

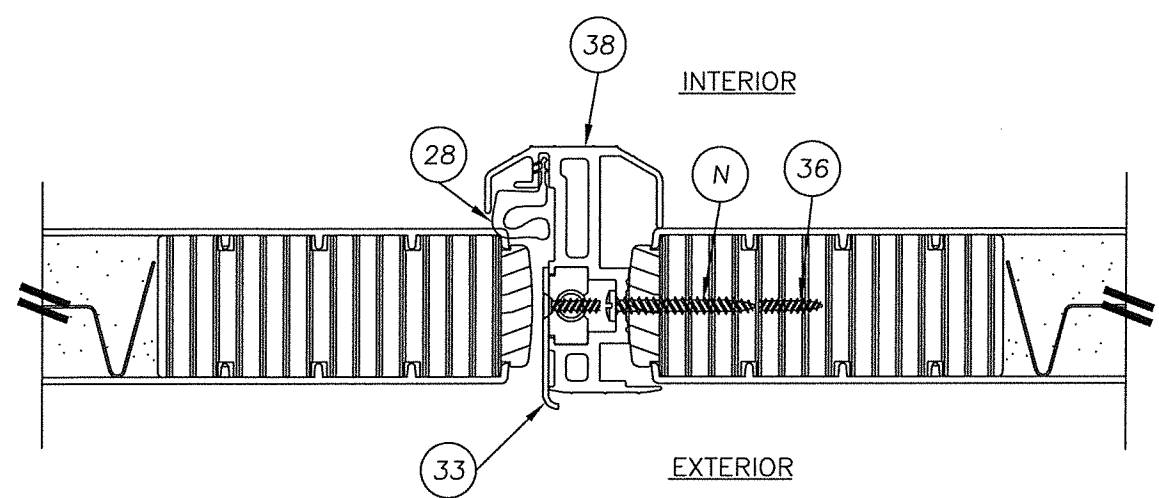

2 HORIZONTAL CROSS SECTION
 7 OUTSWING SHOWN (INSWING ALSO APPROVED)
 SMOOTH STAR PANEL SHOWN
 SEE DOOR PANEL DETAILS FOR
 OPTIONAL PANEL TYPES

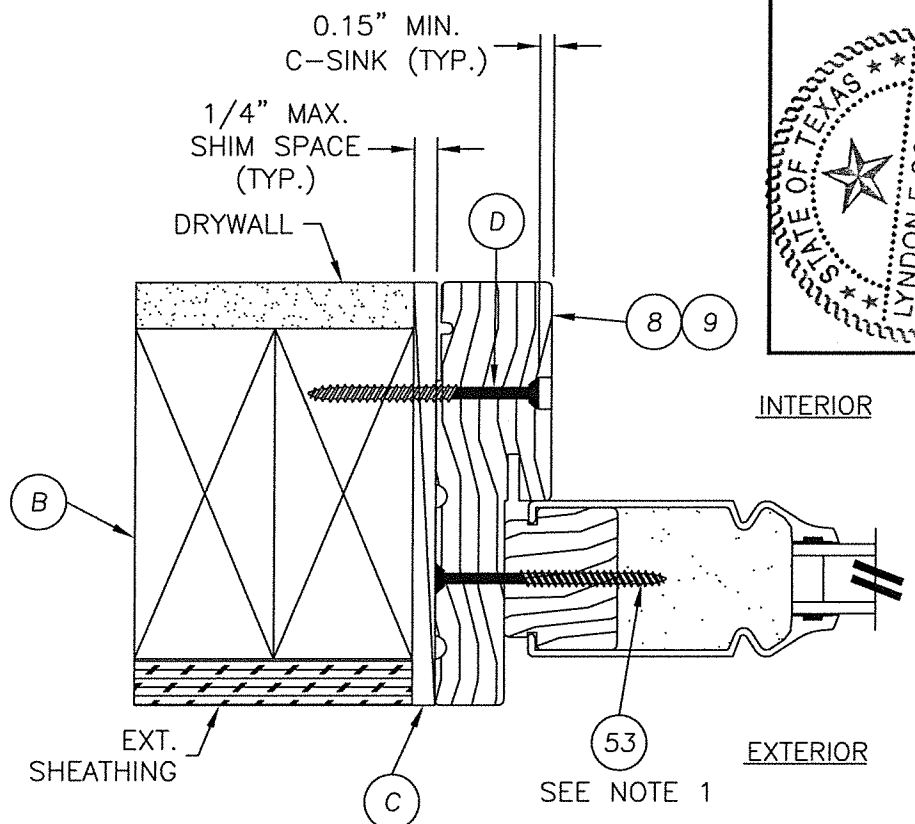
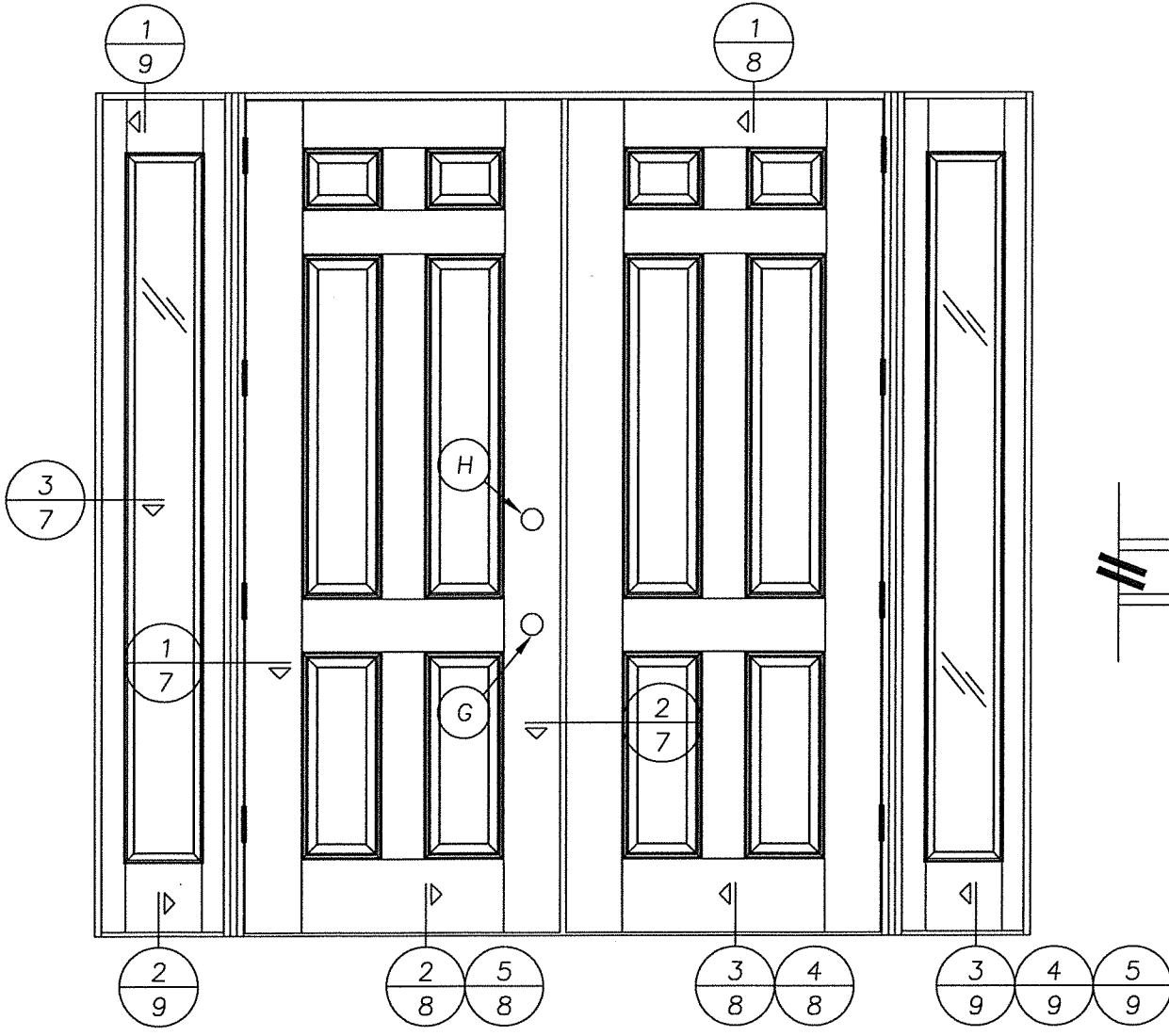

3 HORIZONTAL CROSS SECTION
 7 OUTSWING SHOWN (INSWING ALSO APPROVED)
 CLASSIC CRAFT PANEL SHOWN
 SEE SIDELITE PANEL DETAILS FOR
 OPTIONAL PANEL TYPES

NOTE:
 1. SIDELITE ASSEMBLY SCREWS LOCATED
 6.25" FROM ENDS AND 6 MORE
 EQUALLY SPACED (8 TOTAL).

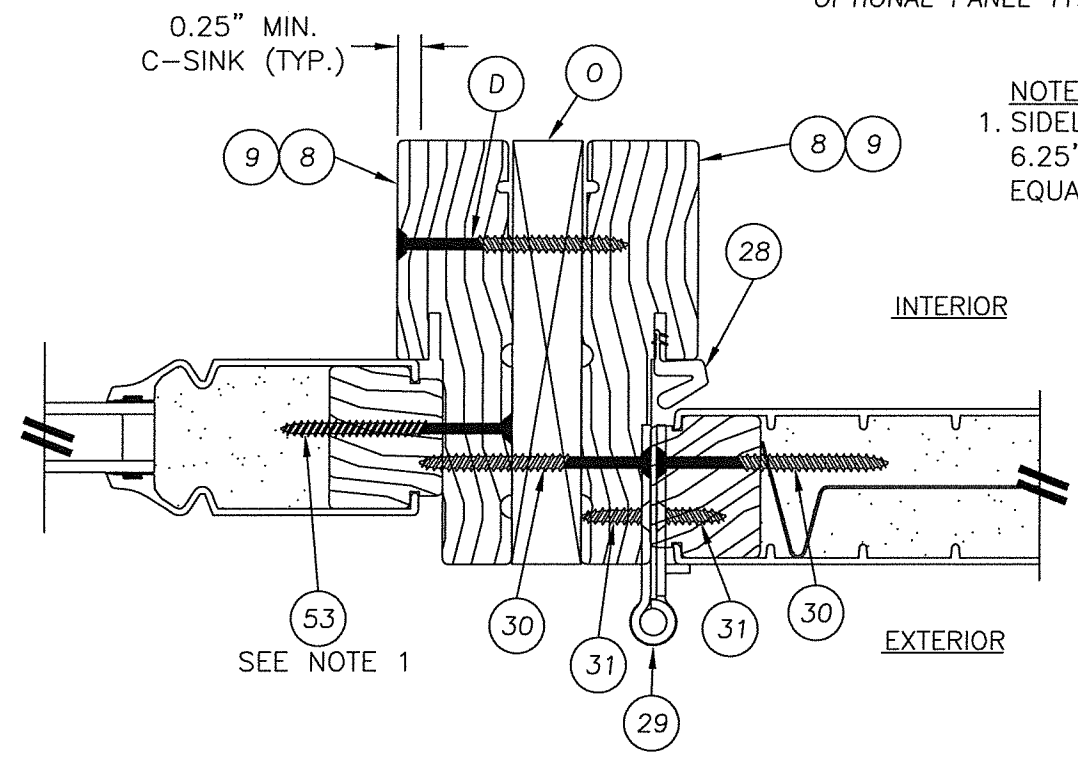

1 HORIZONTAL CROSS SECTION
 7 OUTSWING SHOWN (INSWING ALSO APPROVED)
 SMOOTH STAR PANEL SHOWN
 SEE DOOR PANEL DETAILS FOR
 OPTIONAL PANEL TYPES

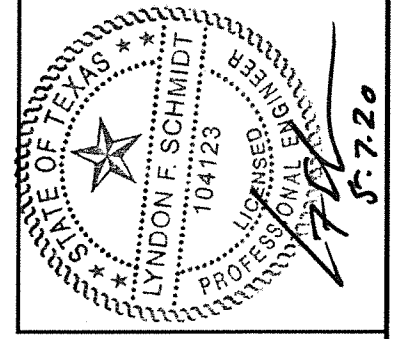

Documents Prepared By: Lyndon F. Schmidt, P.E.
 TEXAS P.E. #104123

RW BUILDING CONSULTANTS, INC.
 P.O. Box 230 Valrico FL, 33595
 Phone No.: 813.659.9197

TEXAS BOARD OF PROFESSIONAL ENGINEERS
 CERTIFICATE OF REGISTRATION # F-11852

PRODUCT: DOUBLE OPAQUE
 FIBERGLASS DOOR W/ SIDELITES
 "IMPACT" INSWING / OUTSWING

PART OR ASSEMBLY:
 HORIZONTAL CROSS SECTIONS

NO.	DATE	BY	REVISIONS
2	5/07/20	LFS	UPDATE TO 2018 IBC/IRC CODE
1	7/22/15	LFS	ADDED GENERAL NOTE 5.

DATE: 7/16/12
 SCALE: N.T.S.
 DWG. BY: JK
 CHK. BY: LFS
 DRAWING NO.: TX-4175
 SHEET 7 of 13

R:\Clients\Therma Tru PERMANENT\B - Texas Dept of Ins\TDI - DR 601 - 80 Opaque FG Imp IS - OS Sgls DbIs w-wo Imp SLV - Drawings\Current\TX-4175-83.dwg, OXX08

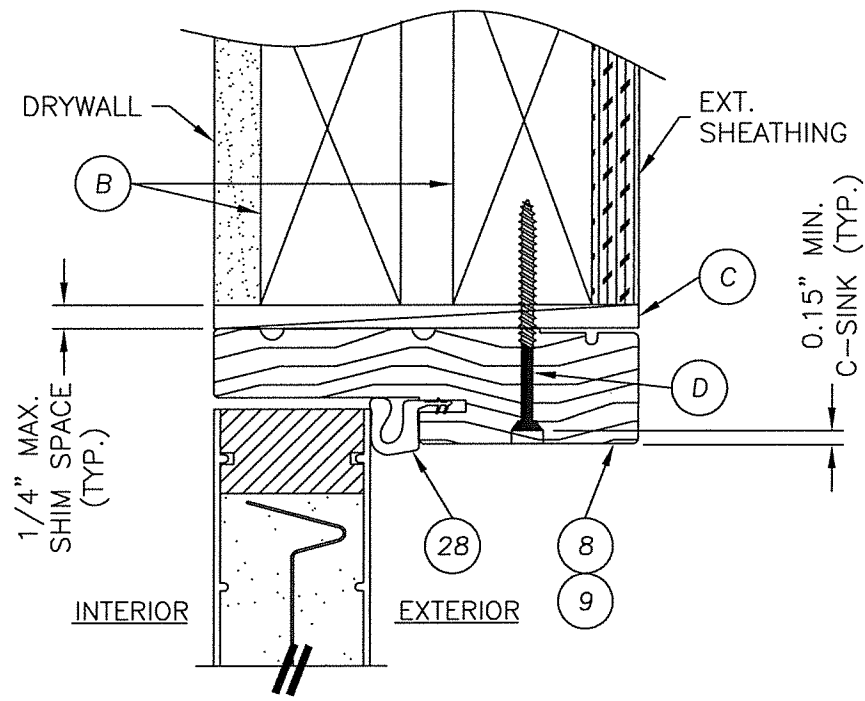

1 VERTICAL CROSS SECTION
8 INSWING SHOWN (OUTSWING ALSO APPROVED)
SMOOTH STAR PANEL SHOWN
SEE DOOR PANEL DETAILS FOR
OPTIONAL PANEL TYPES

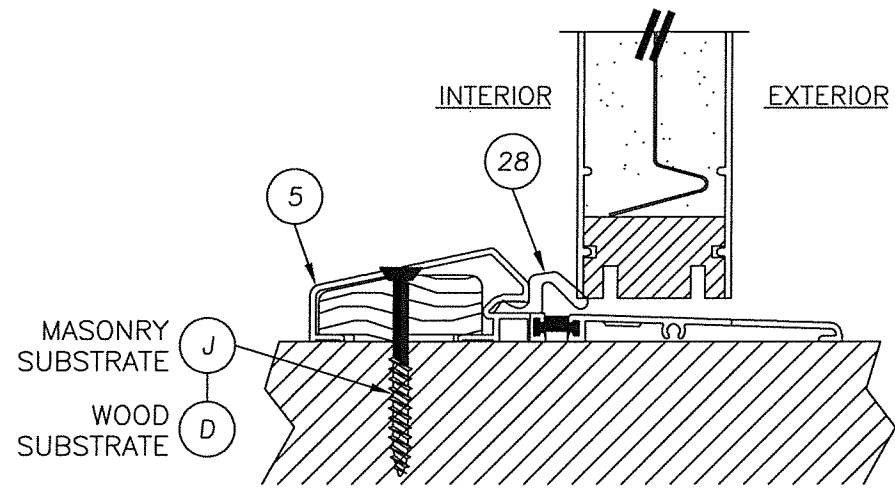

2 VERTICAL CROSS SECTION
8 @ THRESHOLD
SMOOTH STAR PANEL SHOWN
SEE DOOR PANEL DETAILS FOR
OPTIONAL PANEL TYPES

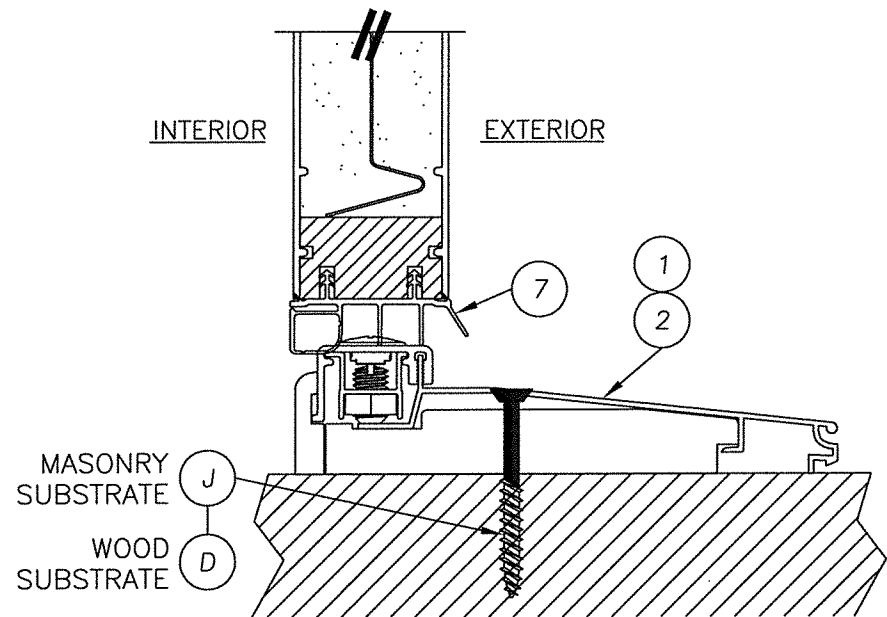

3 VERTICAL CROSS SECTION
8 @ THRESHOLD
SMOOTH STAR PANEL SHOWN
SEE DOOR PANEL DETAILS FOR
OPTIONAL PANEL TYPES

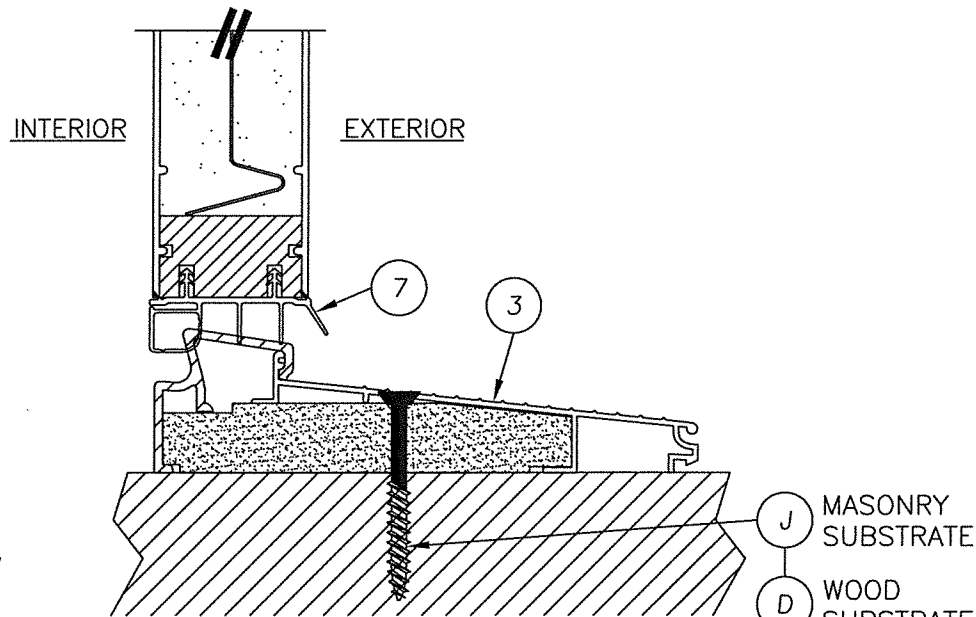

4 VERTICAL CROSS SECTION
8 @ THRESHOLD
SMOOTH STAR PANEL SHOWN
SEE DOOR PANEL DETAILS FOR
OPTIONAL PANEL TYPES

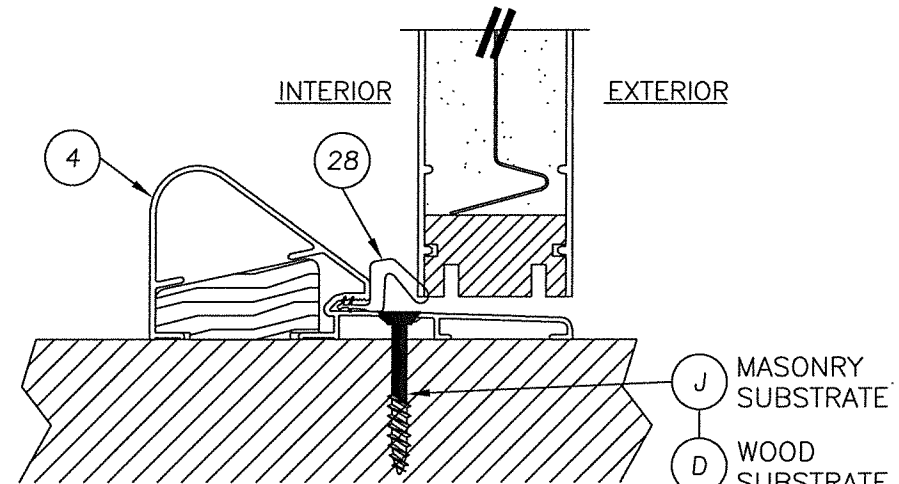

5 VERTICAL CROSS SECTION
8 @ THRESHOLD
SMOOTH STAR PANEL SHOWN
SEE DOOR PANEL DETAILS FOR
OPTIONAL PANEL TYPES

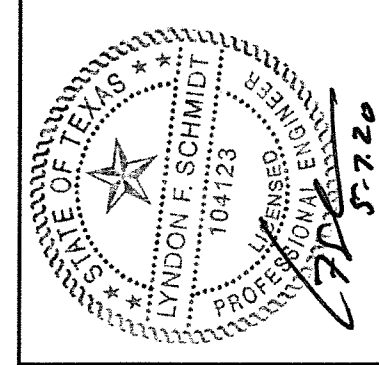

Documents Prepared By: Lyndon F. Schmidt, P.E.
TEXAS P.E. #104123

RW BUILDING CONSULTANTS, INC.
P.O. Box 230 Valrico FL 33595
Phone No.: 813.659.9197
TEXAS BOARD OF PROFESSIONAL ENGINEERS
CERTIFICATE OF REGISTRATION # F-11852

PRODUCT: DOUBLE OPAQUE
FIBERGLASS DOOR W/SIDELITES
"IMPACT" INSWING / OUTSWING

PART OR ASSEMBLY:
VERTICAL CROSS SECTIONS

NO.	DATE	BY	REVISIONS
2	5/07/20	LFS	UPDATE TO 2018 IBC/IRC CODE
1	7/22/15	LFS	ADDED GENERAL NOTE 5.

DATE: 7/16/12

SCALE: N.T.S.

DWG. BY: JK

CHK. BY: LFS

DRAWING NO.: TX-4175

SHEET 8 OF 13

© 2012 R.W. BUILDING CONSULTANTS INC.

R:\Clients\Therma Tru PERMANENT B - Texas Dept of Ins\TDI - DR 601 - 80 Opaque FG Imp IS - OS Sgls Dbis w-wo Imp SLC - Drawings\Current\TX-4175-83.dwg, OXX09

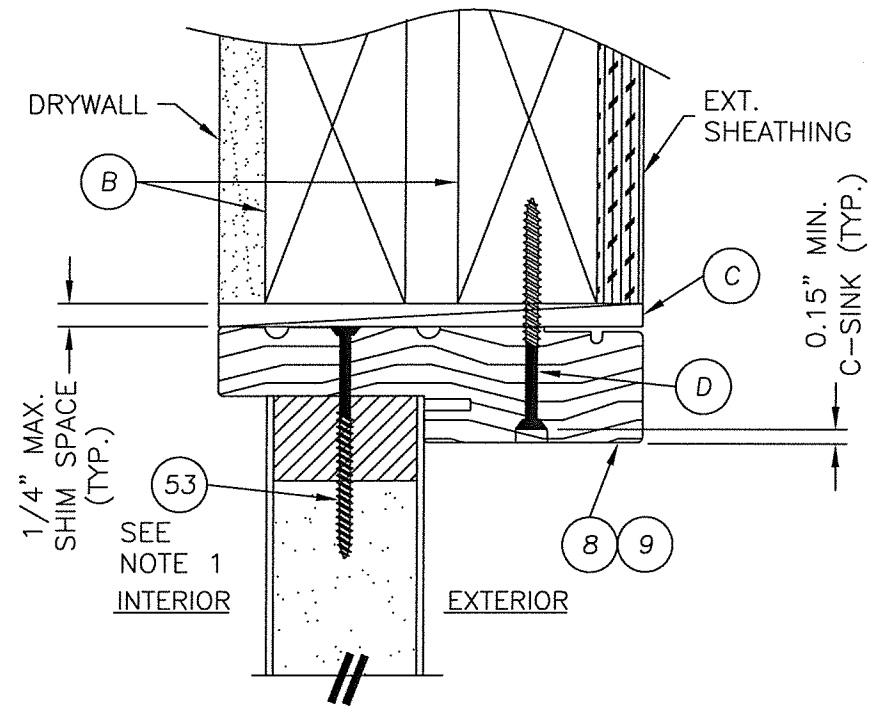

1
9 VERTICAL CROSS SECTION

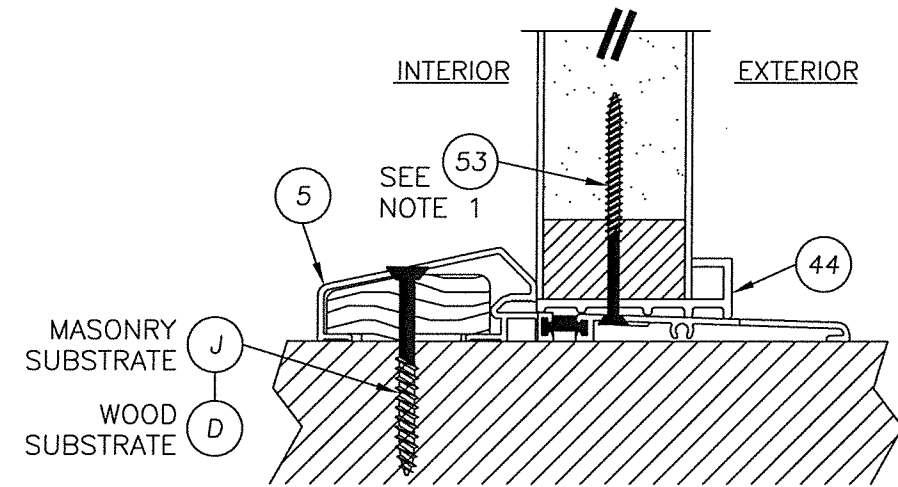

4
9 VERTICAL CROSS SECTION

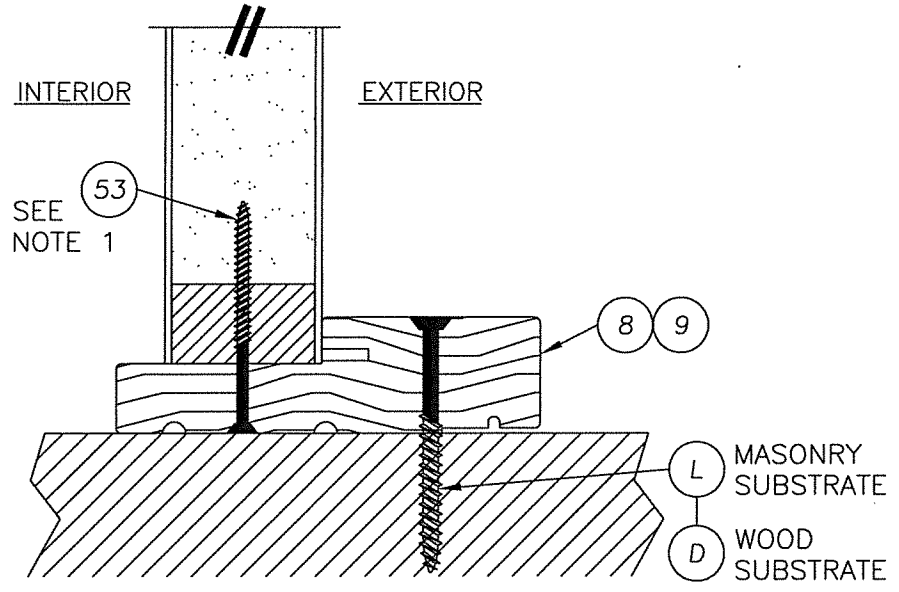

3
9 VERTICAL CROSS SECTION

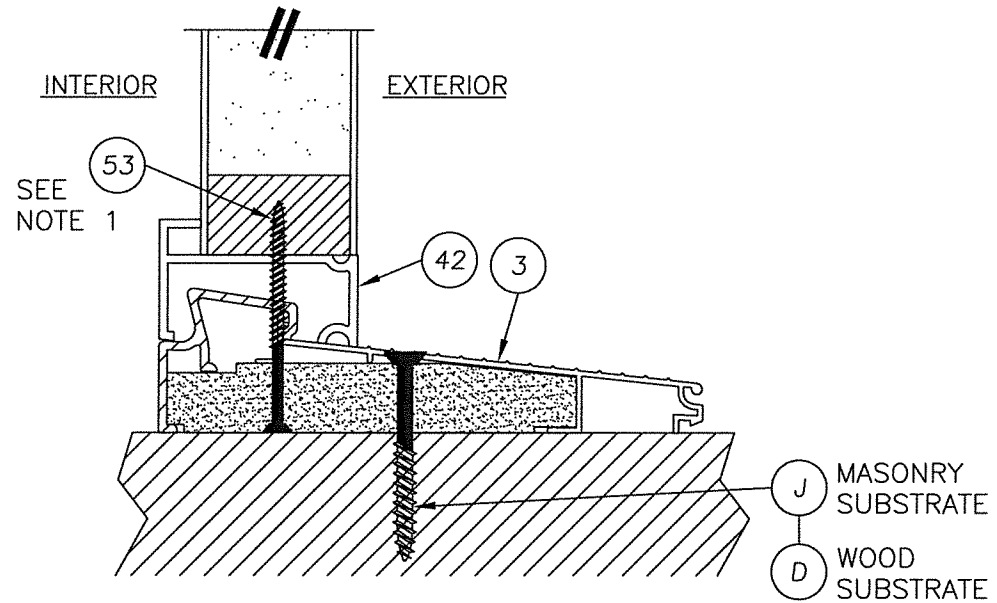

2
9 VERTICAL CROSS SECTION

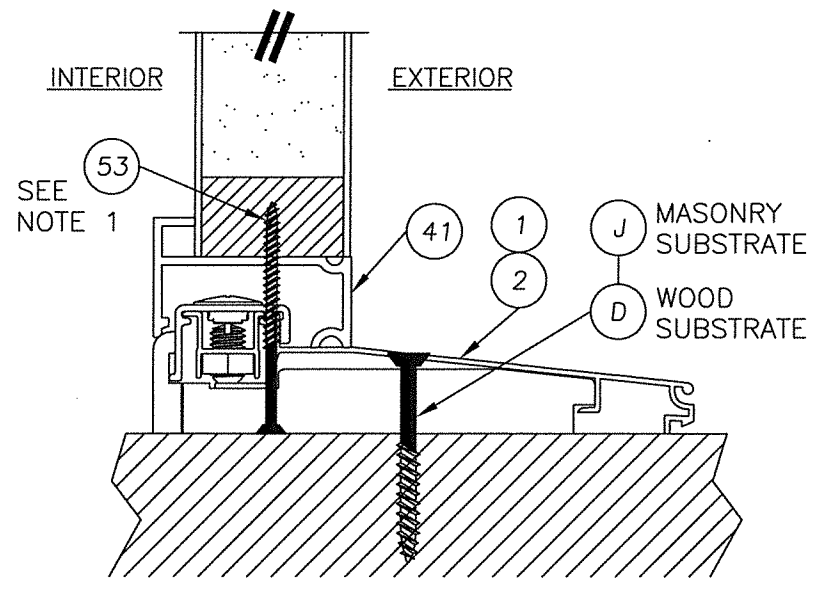

5
9 VERTICAL CROSS SECTION

NOTE:
1. SIDELITE ASSEMBLY SCREWS LOCATED 4.25" FROM ENDS (2 TOTAL).

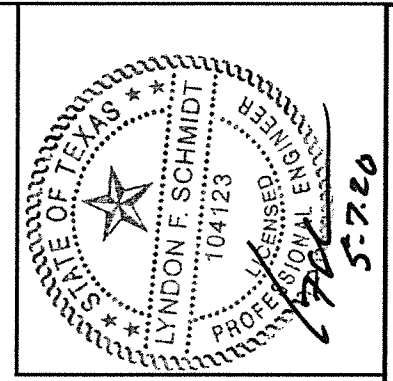

Documents Prepared By: Lyndon F. Schmidt, P.E.
TEXAS P.E. #104123

RW BUILDING CONSULTANTS, INC.
P.O. Box 230 Valrico FL 33595
Phone No.: 813.659.9197

TEXAS BOARD OF PROFESSIONAL ENGINEERS
CERTIFICATE OF REGISTRATION # F-11852

PRODUCT: DOUBLE OPAQUE FIBERGLASS DOOR W/ SIDELITES "IMPACT" INSWING / OUTSWING PART OR ASSEMBLY: VERTICAL CROSS SECTIONS

NO.	DATE	REVISIONS
2	5/07/20	UPDATE TO 2018 IBC/IRC CODE
1	7/22/15	ADDED GENERAL NOTE 5.

DATE: 7/16/12
SCALE: N.T.S.
DWG. BY: JK
CHK. BY: LFS
DRAWING NO.: TX-4175
SHEET 9 of 13

R:\Clients\Therma Tru PERMANENT\B - Texas Dept of Ins\TDI - DR 601 - 80 Opaque FG Imp IS - OS Sgls Dbils w-wo Imp SLYC - Drawings\Current\TX-4175-83.dwg, OXX011

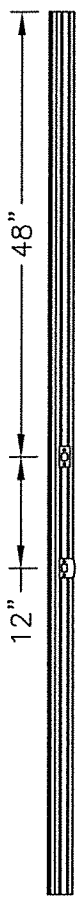

STRIKE PLATE LOCATION

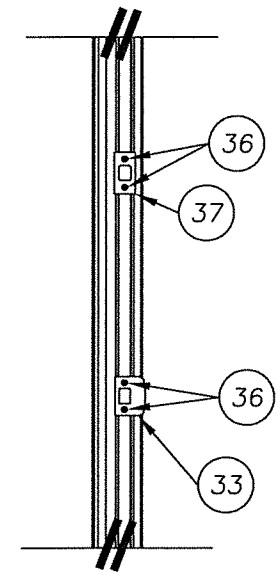

STRIKE PLATE DETAIL

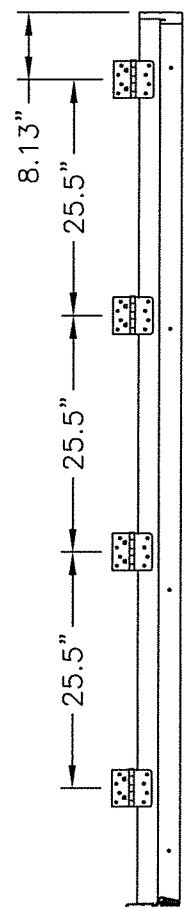

HINGE LOCATION

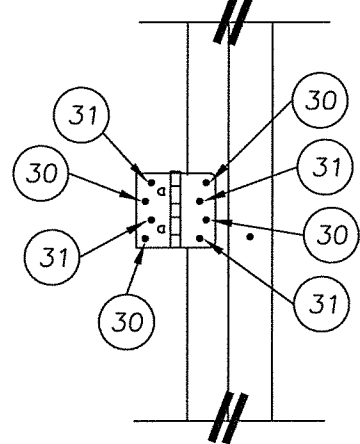

HINGE DETAIL

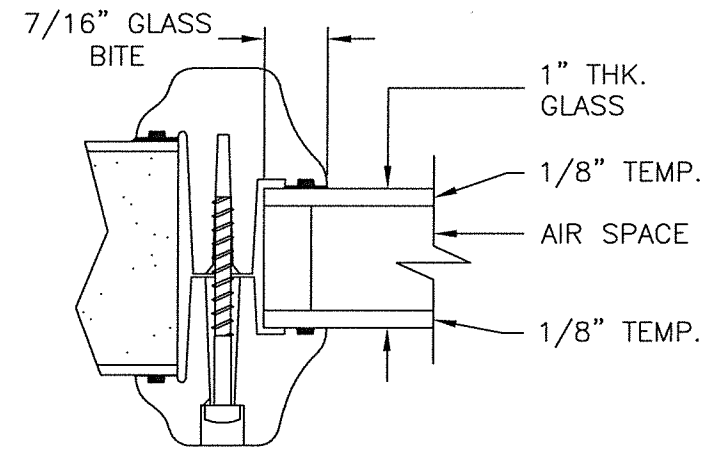

55 GLAZING DETAIL
1" INSULATED GLASS

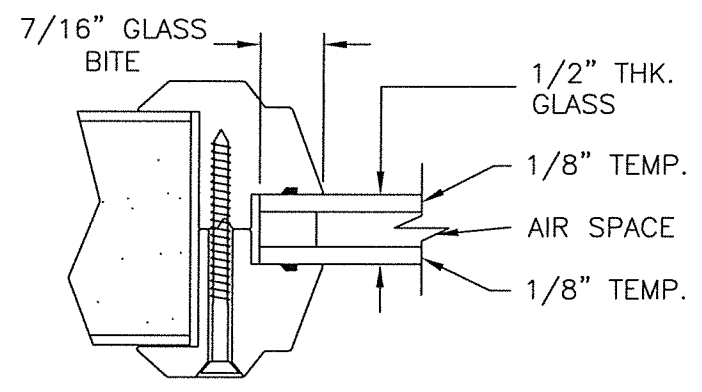

56 GLAZING DETAIL
1/2" INSULATED GLASS

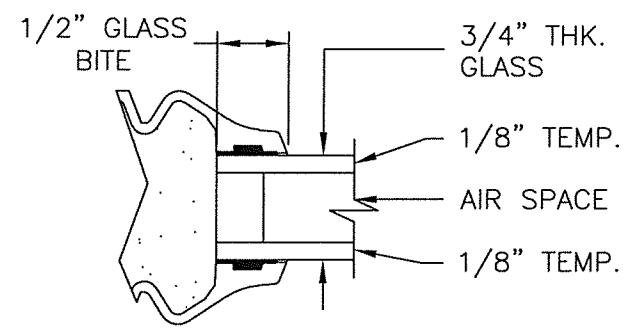

54 GLAZING DETAIL
3/4" INSULATED GLASS

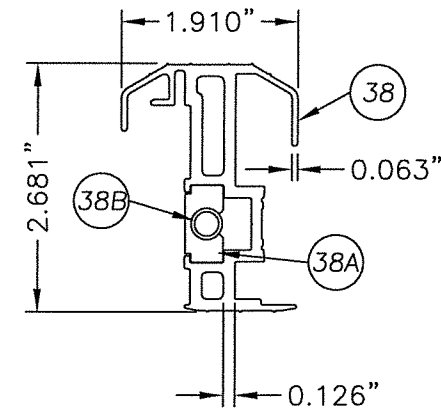
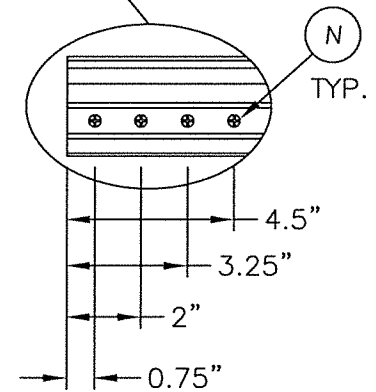
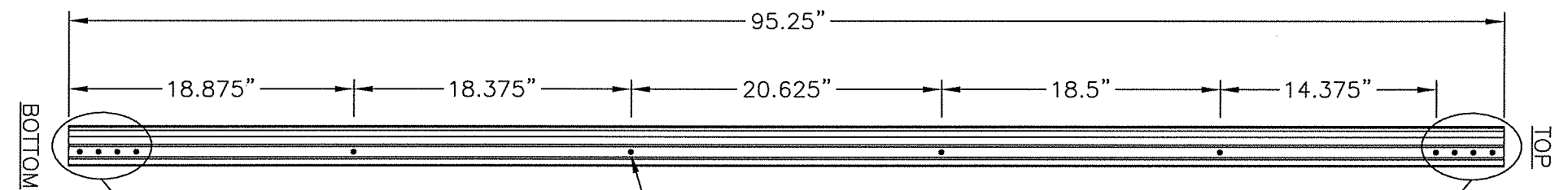

38 ASTRAGAL DETAIL

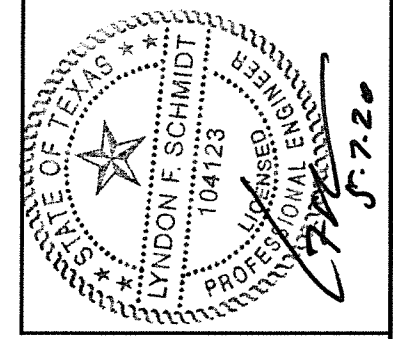
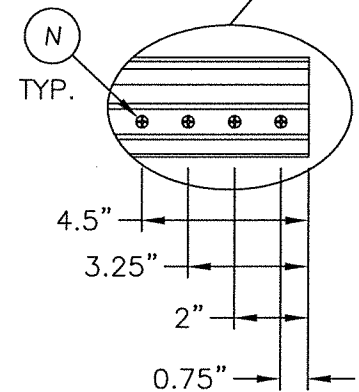

Documents Prepared By: Lyndon F. Schmidt, P.E.
TEXAS P.E. #104123

RW BUILDING CONSULTANTS, INC.
P.O. Box 230 Valrico FL, 33595
Phone No.: 813.659.9197

TEXAS BOARD OF PROFESSIONAL ENGINEERS
CERTIFICATE OF REGISTRATION # F-11852

PRODUCT: DOUBLE OPAQUE
FIBERGLASS DOOR W/SIDELITES
"IMPACT" INSWING / OUTSWING
PART OR ASSEMBLY:
ASTRAGAL, HARDWARE
& GLAZING DETAILS

NO.	DATE	REVISIONS	BY
2	5/07/20	UPDATE TO 2018 IBC/IRC CODE	LFS
1	7/22/15	ADDED GENERAL NOTE 5.	LFS

DATE: 7/16/12
SCALE: N.T.S.
DWG. BY: JK
CHK. BY: LFS
DRAWING NO.: TX-4175
SHEET 11 OF 13

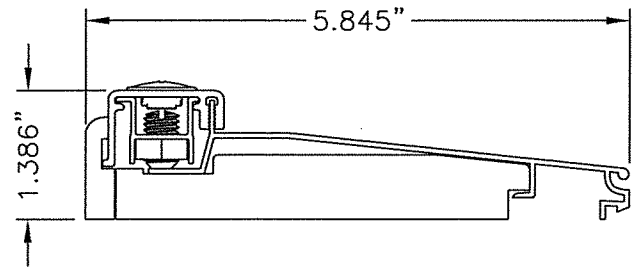

2 THRESHOLD
INSWING ADJUSTABLE

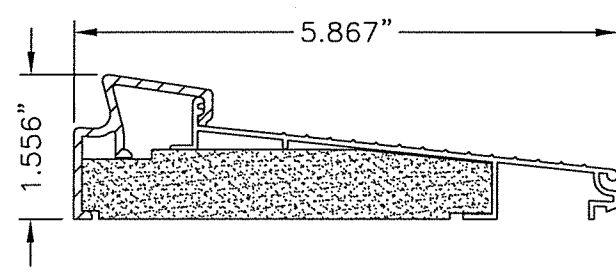

3 THRESHOLD
INSWING SELF-ADJUST

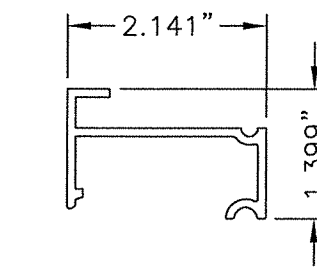

41 INSWING SIDELITE
SPACER

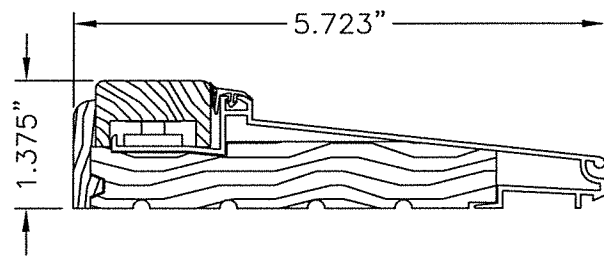

1 THRESHOLD
INSWING ADJUSTABLE

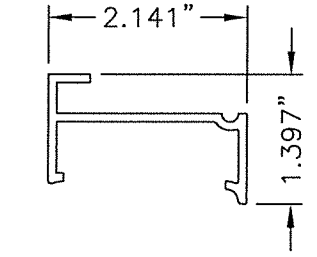

40 INSWING SIDELITE
SPACER

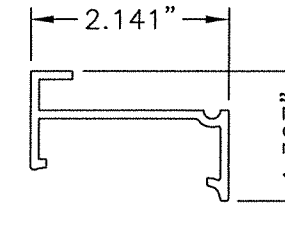

43 INSWING SIDELITE
SPACER

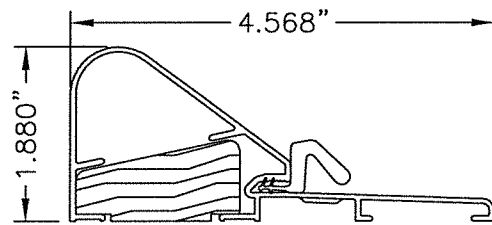

4 THRESHOLD
OUTSWING COASTAL

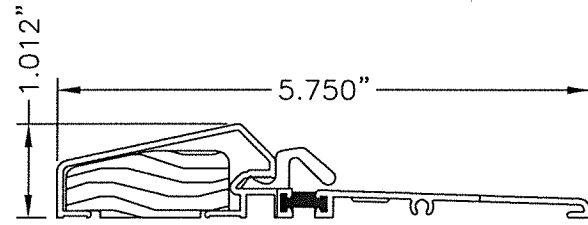

5 THRESHOLD
OUTSWING STANDARD

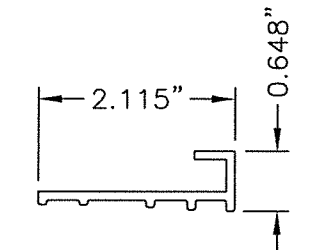

44 OUTSWING SIDELITE
SPACER

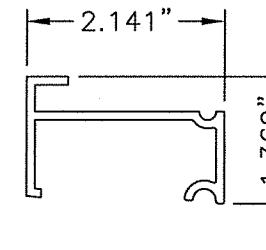

42 INSWING SIDELITE
SPACER

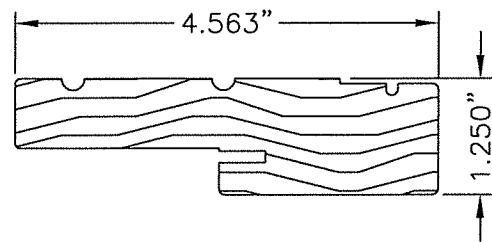

9 8 JAMB

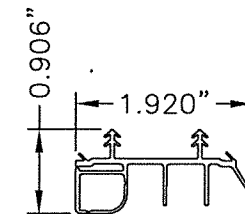

7 SWEEP

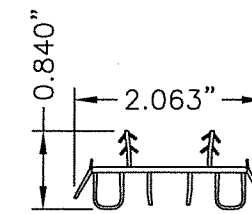

52 SWEEP

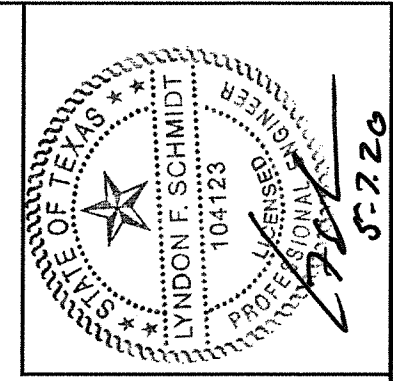

Documents Prepared By: Lyndon F. Schmidt, P.E.
TEXAS P.E. #104123

RW BUILDING CONSULTANTS, INC.
P.O. Box 230 Valrico FL, 33595
Phone No.: 813.659.9197

TEXAS BOARD OF PROFESSIONAL ENGINEERS
CERTIFICATE OF REGISTRATION # F-11852

PRODUCT: DOUBLE OPAQUE
FIBERGLASS DOOR W/SIDELITES
"IMPACT" INSWING / OUTSWING
PART OR ASSEMBLY:
COMPONENTS

NO.	DATE	REVISIONS	BY
2	5/07/20	UPDATE TO 2018 IBC/IRC CODE	LFS
1	7/22/15	ADDED GENERAL NOTE 5.	LFS

DATE: 7/16/12
SCALE: N.T.S.
DWG. BY: JK
CHK. BY: LFS
DRAWING NO.: TX-4175
SHEET 12 OF 13

R:\Clients\Therma Tru PERMANENT\B - Texas Dept of Ins\TDI - DR 601 - 80 Opaque FG Imp IS - OS Sgls Dbis w-wo Imp SLC - Drawings\Current\TX-4175-83.dwg, OXX013

BILL OF MATERIALS		
ITEM	DESCRIPTION	MATERIAL
B	2X FRAMING (G >= 0.42)	WOOD
C	1/4" MAX. SHIM SPACE	WOOD
D	#10 X 2-1/2" PFH WOOD SCREW	STEEL
G	KWIKSET 200 SERIES PASSAGE LOCK	STEEL
H	KWIKSET 600 SERIES DEADBOLT	STEEL
J	1/4" ELCO OR ITW CONCRETE SCREW (1-3/4" MIN. EMB.)	STEEL
K	3/16" ITW CONCRETE SCREW (1-3/4" MIN. EMB.)	STEEL
M	#8 X 3" PFH SCREW (STRIKE PLATES @ HEAD & SILL)	STEEL
N	#10 X 1-1/2" PPH SCREW ASTRAGAL TO PANEL	STEEL
O	1X MULLION (G >= 0.42)	WOOD
1	INSWING ADJUSTABLE THRESHOLD (IS300AJ)	ALUM./WOOD
2	INSWING THRESHOLD (IS300HP5)	ALUM./COMP.
3	INSWING SELF ADJUST THERMAL BREAK THRESHOLD (ISP30M)	ALUM./COMP.
4	OUTSWING COASTAL THRESHOLD	ALUM./WOOD
5	OUTSWING STANDARD THRESHOLD	ALUM./WOOD
7	DOOR BOTTOM SWEEP	VINYL
8	JAMB (OAK)	WOOD
9	JAMB (PINE)	WOOD
10	HINGE STILE (SMOOTH-STAR)	WOOD
11	LOCK STILE (SMOOTH-STAR)	LVL/WOOD
12	TOP RAIL (SMOOTH-STAR)	PVC
13	BOTTOM RAIL (SMOOTH-STAR)	PVC
14	PANEL REINFORCEMENT 0.023" THK. (SMOOTH-STAR)	STEEL
15	DOOR SKIN 0.070" THK. (SMOOTH-STAR) Fy = 6,000 PSI MIN.	FIBERGLASS
16	HINGE STILE (CLASSIC-CRAFT)	WOOD/LVL
17	LOCK STILE (CLASSIC-CRAFT)	WOOD/LVL
18	TOP RAIL (CLASSIC-CRAFT)	PVC
19	BOTTOM RAIL (CLASSIC-CRAFT)	PVC
20	PANEL REINFORCEMENT 0.023" THK. (CLASSIC-CRAFT)	STEEL
21	DOOR SKIN 0.125" THK. (CLASSIC-CRAFT) Fy = 6,000 PSI MIN.	FIBERGLASS
22	LOCK & HINGE STILE (CLASSIC-CRAFT RUSTIC)	WOOD/LVL
23	TOP RAIL (CLASSIC-CRAFT RUSTIC)	WOOD
24	BOTTOM RAIL (CLASSIC-CRAFT RUSTIC)	PVC
25	PANEL REINFORCEMENT 0.023" THK. (CLASSIC-CRAFT RUSTIC)	STEEL
26	DOOR SKIN 0.125" THK. (CC RUSTIC) Fy = 6,000 PSI MIN.	FIBERGLASS
27	FOAM CORE	POLYURETHANE
28	WEATHERSTRIP	FOAM
29	HINGE	STEEL
30	#10 X 2-1/2" PFH SCREW	STEEL
31	#10 X 3/4" PFH SCREW	STEEL
32	#9 X 3" PFH WOOD SCREW	STEEL
33	LATCH STRIKE PLATE	STEEL
36	#8 X 3" PFH SCREW	STEEL
37	DEADBOLT STRIKE PLATE	STEEL

BILL OF MATERIALS			
ITEM	DESCRIPTION	MATERIAL	
38	ASTRAGAL	ALUMINUM	
38A	ASTRAGAL FLUSH BOLT	STEEL	
38B	ASTRAGAL FLUSH BOLT RETAINER	ALUMINUM	
39	ASTRAGAL STRIKE PLATE @ HEAD	STEEL	
40	INSWING SIDELITE SPACER FOR ADJUSTABLE THRESHOLD (DB14AJA)	PVC	
41	INSWING SIDELITE SPACER FOR HP THRESHOLD (DB14HPA)	PVC	
42	INSWING SIDELITE SPACER FOR SELF ADJUST THRESHOLD (DB14)	PVC	
43	INSWING SIDELITE SPACER	PVC	
44	OUTSWING SIDELITE SPACER	PVC	
45	SIDELITE TOP RAIL	PVC	
46	SIDELITE SKIN 0.070" THK. (SMOOTH-STAR) Fy = 6,000 PSI MIN.	FIBERGLASS	
47	SIDELITE SKIN 0.090" THK. (CLASSIC-CRAFT) Fy = 6,000 PSI MIN.	FIBERGLASS	
48	SIDELITE SKIN 0.070" THK. (FIBER-CLASSIC) Fy = 6,000 PSI MIN.	FIBERGLASS	
49	#6 X 1-3/4" PFH SCREW (LITE FRAME)	STEEL	
50	LITE FRAME FIBER-CLASSIC	PVC	
51	LITE FRAME SMOOTH-STAR	PVC	
52	DOOR BOTTOM SWEEP	VINYL	
53	#9 X 2-1/2" PFH WOOD SCREW (JAMB TO SIDELITE)	STEEL	
54	3/4" INSULATED GLASS 1/8" TEMPERED - AIR - 1/8" TEMPERED	GLASS	
55	1" INSULATED GLASS 1/8" TEMPERED - AIR - 1/8" TEMPERED	GLASS	
56	1/2" INSULATED GLASS 1/8" TEMPERED - AIR - 1/8" TEMPERED	GLASS	
57	GLAZING COMPOUND	SILICONE	
58	SEALANT	SILICONE	
59	#9 X 1" PPH SCREW (LITE FRAME)	STEEL	
60	SIDELITE STILE	WOOD	
61	SIDELITE BOTTOM RAIL	PVC	
62	HINGE STILE (FIBER-CLASSIC)	WOOD	
63	LOCK STILE (FIBER-CLASSIC)	LVL/WOOD	
64	TOP RAIL (FIBER-CLASSIC)	PVC	
65	BOTTOM RAIL (FIBER-CLASSIC)	PVC	
66	PANEL REINFORCEMENT 0.023" THK. (FIBER-CLASSIC)	STEEL	
67	DOOR SKIN 0.070" THK. (FIBER-CLASSIC) Fy = 6,000 PSI MIN.	FIBERGLASS	

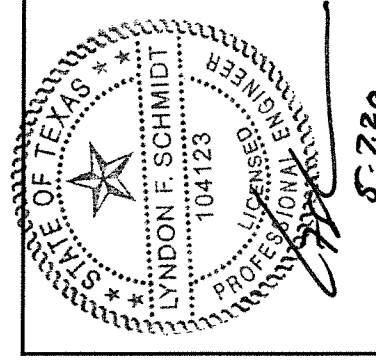

Documents Prepared By: Lyndon F. Schmidt, P.E.
TEXAS P.E. #104123

RW BUILDING CONSULTANTS, INC.
P.O. Box 230 Valrico FL, 33595
Phone No.: 813.659.9197

TEXAS BOARD OF PROFESSIONAL ENGINEERS
CERTIFICATE OF REGISTRATION # F-11852

PRODUCT:	DOUBLE OPAQUE FIBERGLASS DOOR W/SIDELITES "IMPACT" INSWING / OUTSWING	
PART OR ASSEMBLY:	BILL OF MATERIALS	
NO.	DATE	BY
2	5/07/20	LFS
1	7/22/15	LFS

DATE: 7/16/12

SCALE: N.T.S.

DWG. BY: JK

CHK. BY: LFS

DRAWING NO.: TX-4175

SHEET 13 OF 13