

**ELEVATION**

INTERIOR VIEW  
(SHOWN W/ OPTIONAL SURFACE BOLTS)

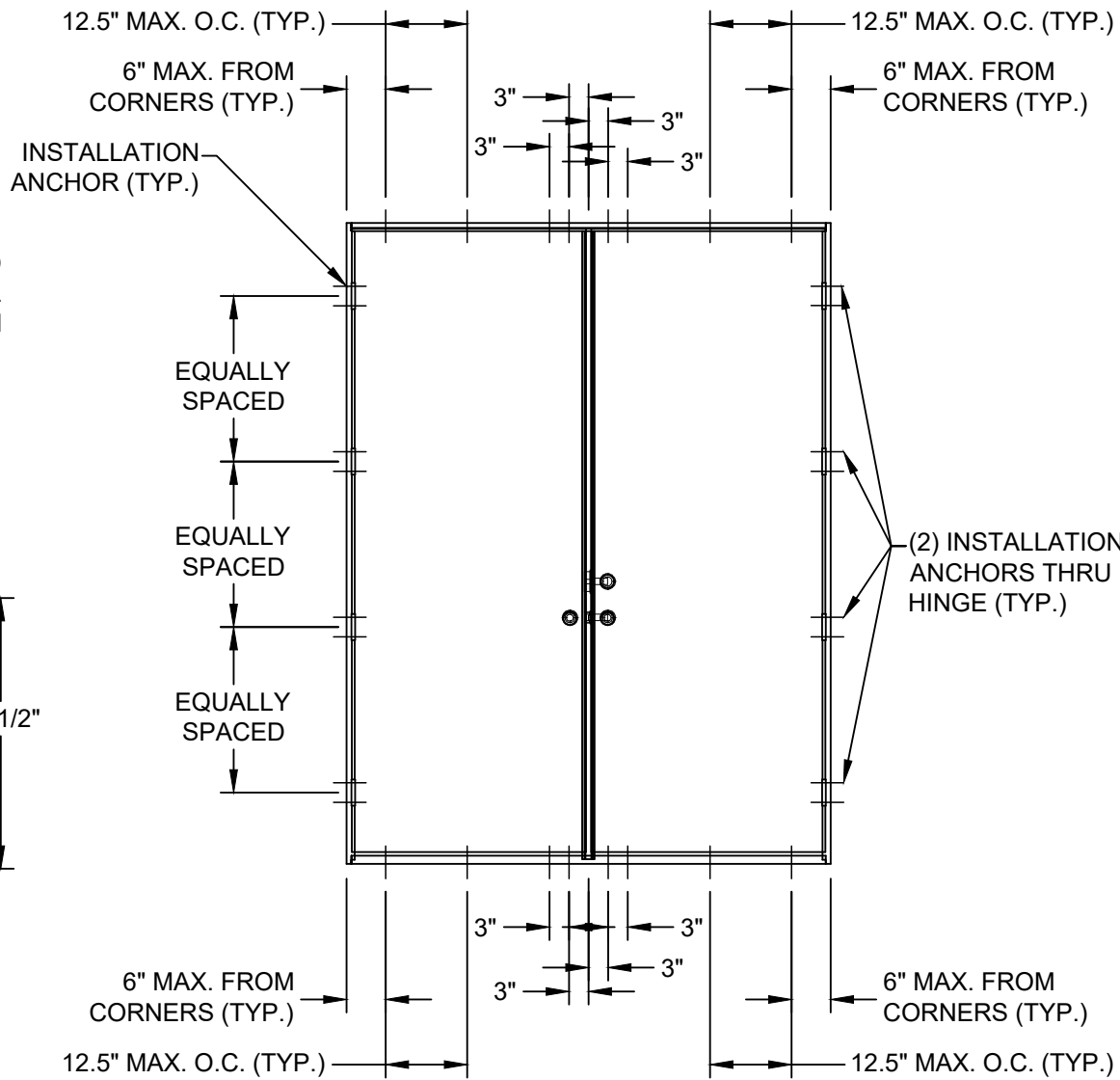

**ANCHOR LAYOUT**  
**35.0 D.P. W/O SURFACE BOLTS**

INTERIOR VIEW  
(SEE INSTALLATION NOTE 2)

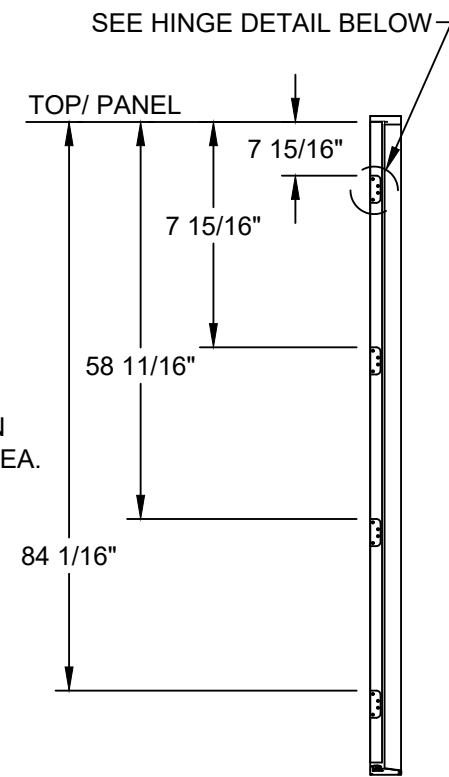

**HINGE JAMB ELEVATION**

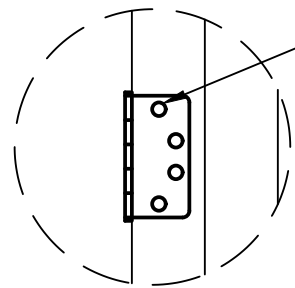

INSTALLATION ANCHOR  
(SEE INSTALLATION NOTE 2, SHEET 1)

**HINGE DETAIL**

PROJECT: #419-1112

SIMPSON DOOR COMPANY  
400 W. SIMPSON AVENUE  
MCCLEARY, WASHINGTON 98557  
GLAZED & OPAQUE WOOD DOORS  
ELEVATION & ANCHOR LAYOUT

DATE:	05/31/12
DRAWING NO.:	SIMP2060
SCALE:	N.T.S.
REV:	A
SHEET:	2 OF 8

Robert J. Amoruso  
TX P.E. No. 80817

BY	RIA
DATE	10/26/21
DESCRIPTION	UPDATE FOR RE-EVALUATION
REV	A



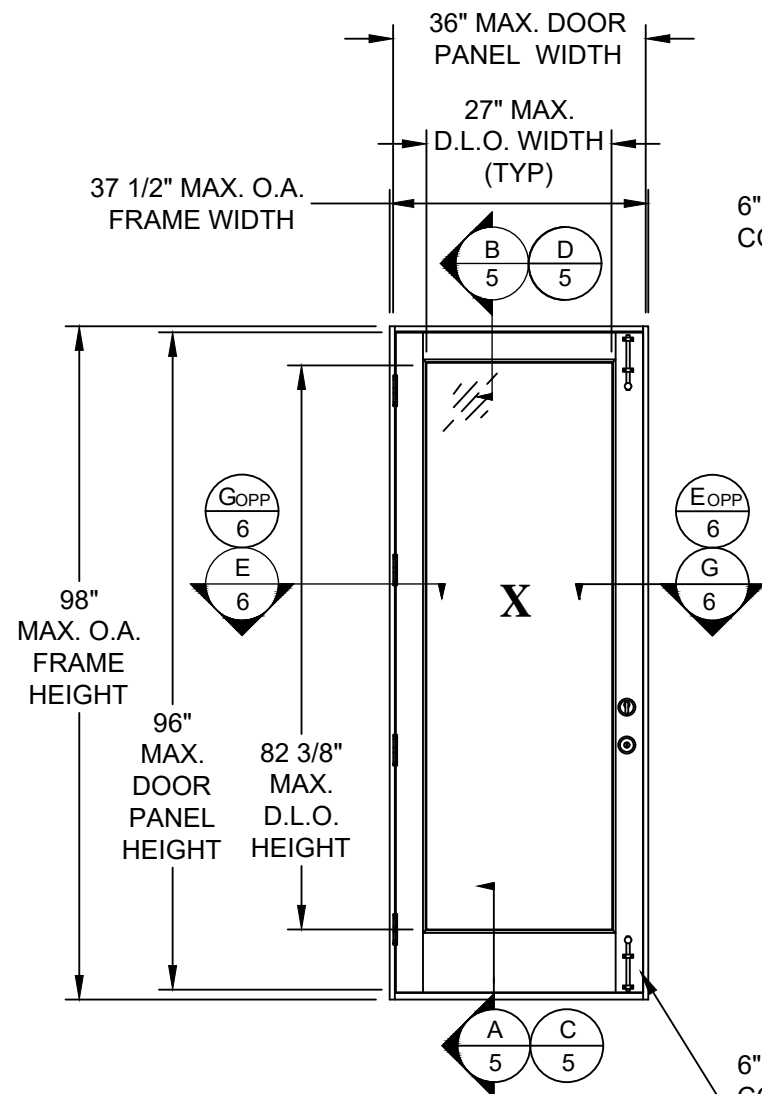

SURFACE BOLTS LOCATED ON INTERIOR SIDE FOR D.P. 50.0 PSF USING STANDARD HARDWARE

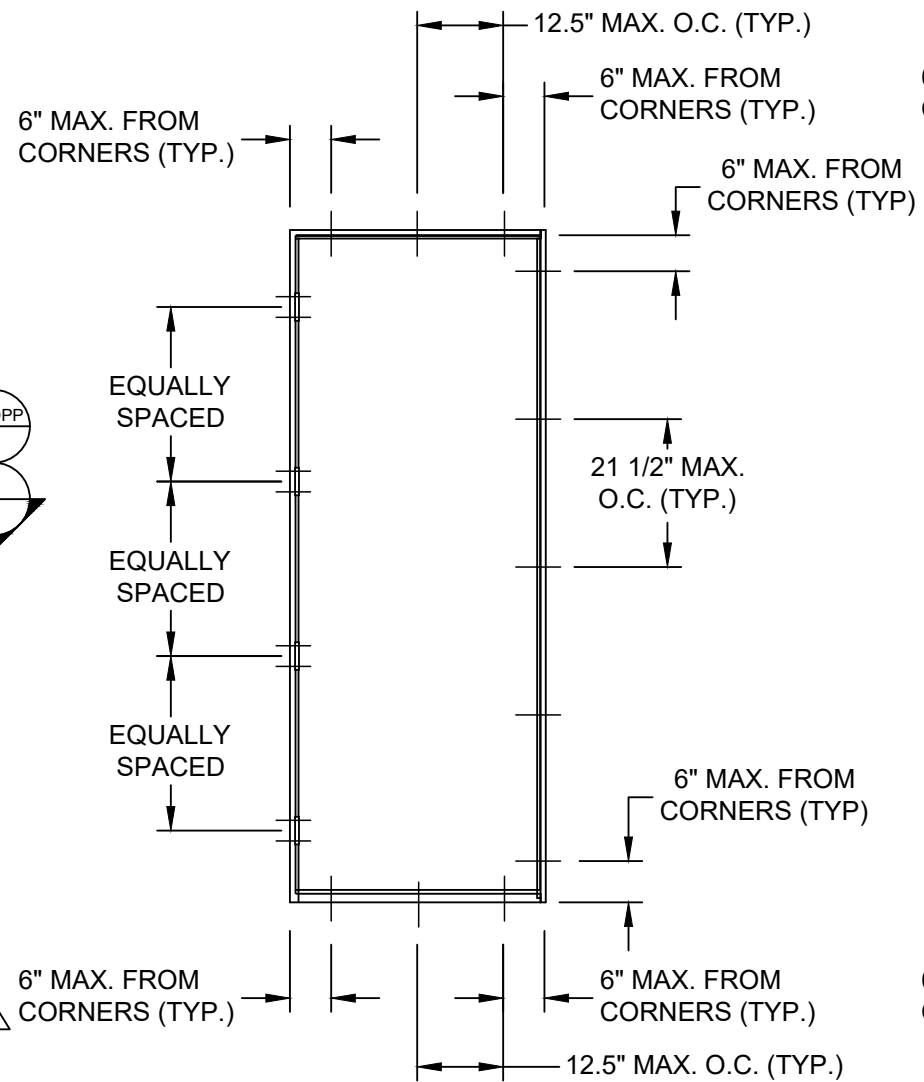

**ANCHOR LAYOUT**  
**35.0 & 40.0 D.P. W/O SURFACE BOLTS**  
**OR WITH MULTIPOINT**  
 INTERIOR VIEW  
 (SEE INSTALLATION NOTE 2)

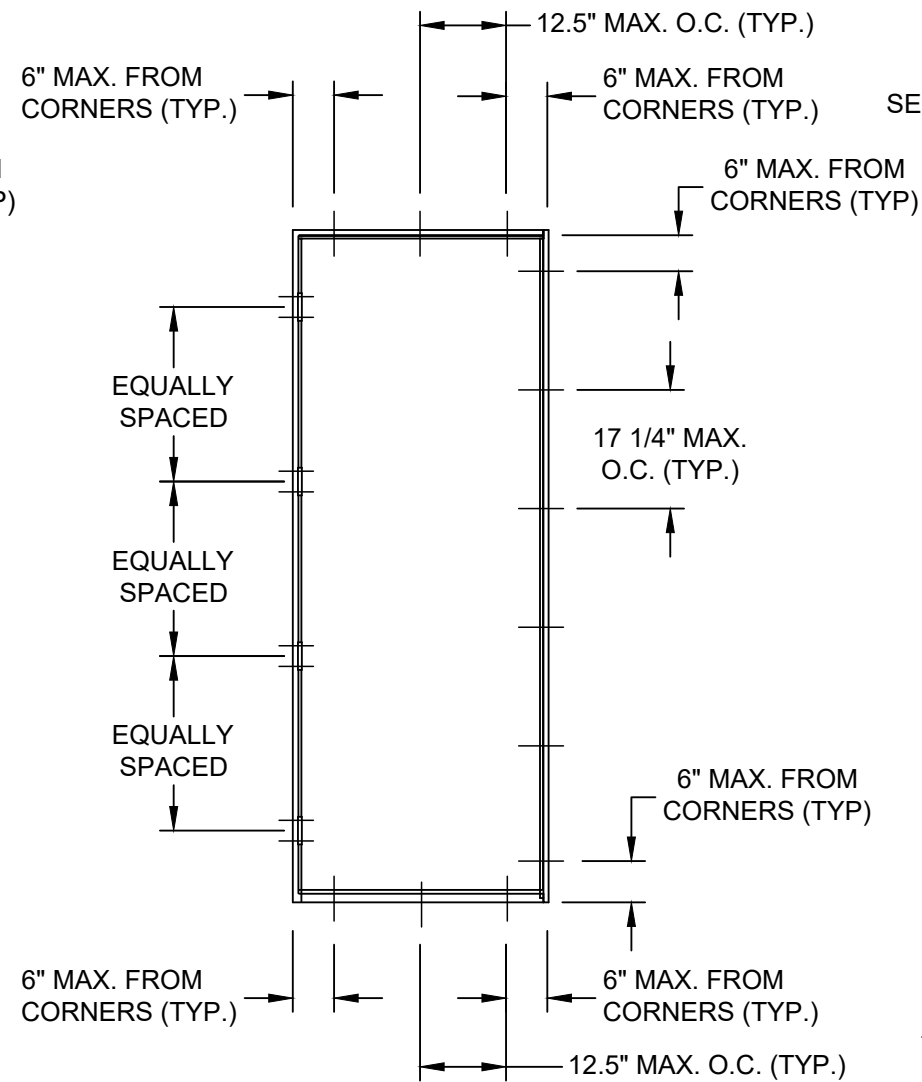

**ANCHOR LAYOUT**  
**50.0 PSF W/ SURFACE BOLTS**  
 INTERIOR VIEW  
 (SEE INSTALLATION NOTE 2)

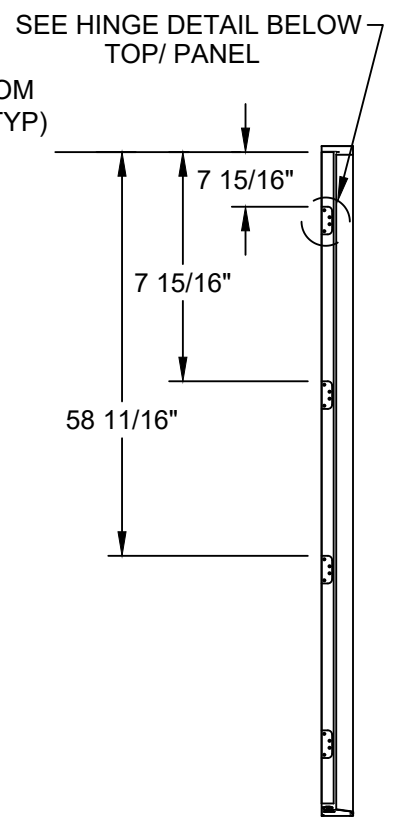

**HINGE JAMB ELEVATION**

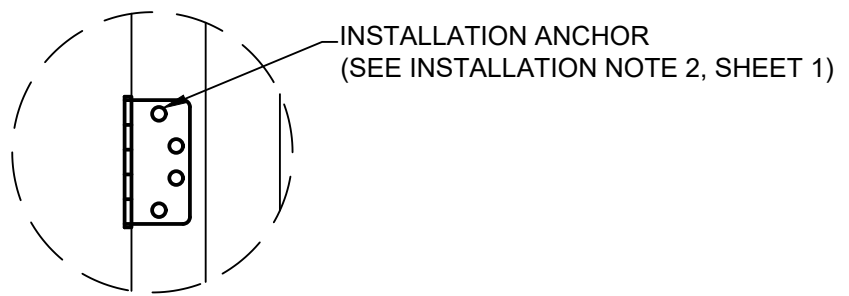

**HINGE DETAIL**

PROJECT: #419-1112

REV	DESCRIPTION	DATE	BY
A	UPDATE FOR RE-EVALUATION	10/26/21	RJA

**SIMPSON DOOR COMPANY**  
 400 W. SIMPSON AVENUE  
 McCLEARY, WASHINGTON 98557

**GLAZED & OPAQUE WOOD DOORS**  
 ELEVATION & ANCHOR LAYOUT

PREPARED BY: T.J.H.  
 SCALE: N.T.S.  
 DRAWING NO: SIMP2060  
 DATE: 05/31/12  
 SHEET: 4 OF 8

PTC PRODUCT DESIGN GROUP, LLC  
 PO BOX 520775  
 LONGWOOD, FLORIDA 32752  
 TX CERTIFICATE OF REGISTRATION: F-13740  
 Phone: 321.690.1788  
 Fax: 321.690.1789  
 Email: info@ptc-corp.com

Robert J. Amoruso  
 TX P.E. No. 80817

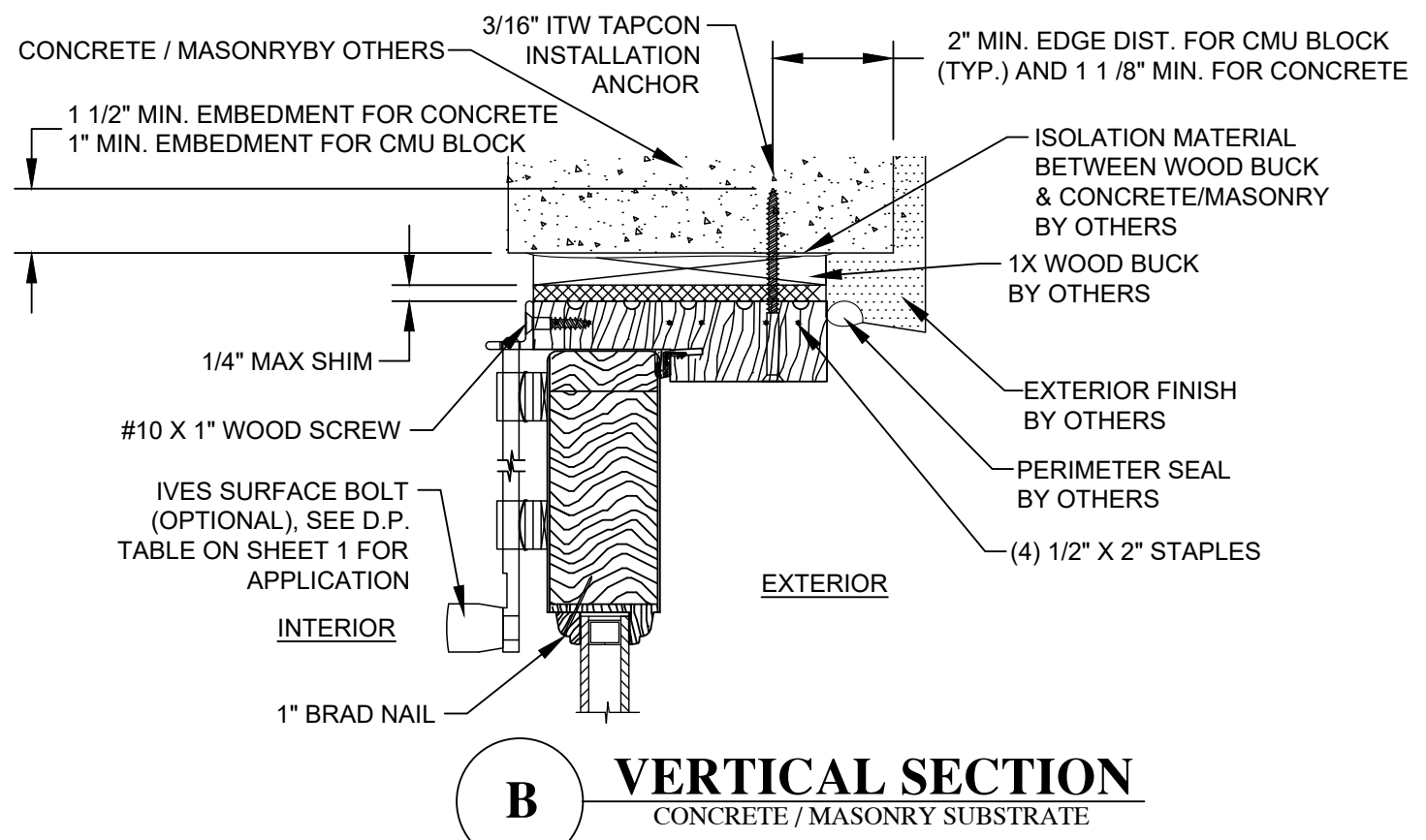

**B** VERTICAL SECTION  
CONCRETE / MASONRY SUBSTRATE

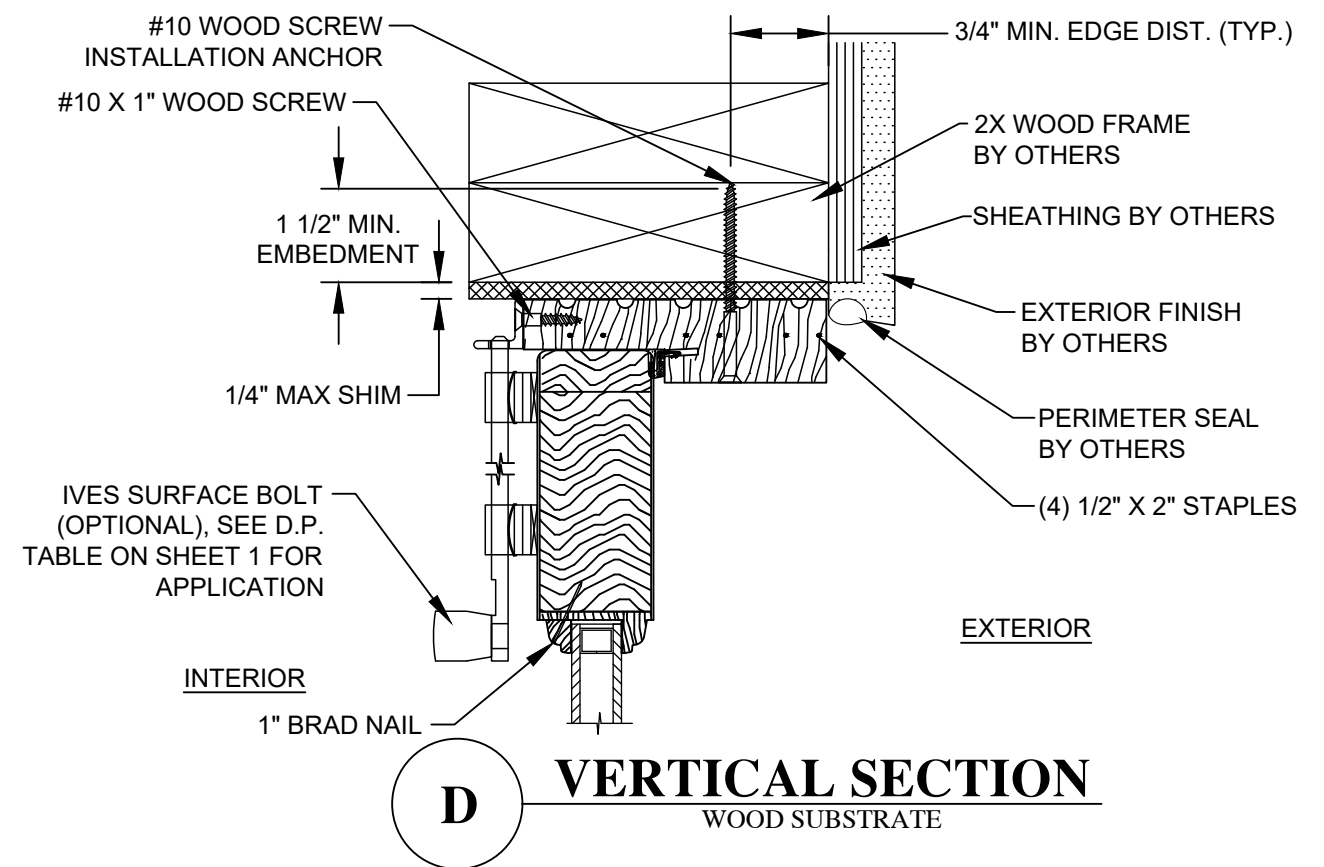

**D** VERTICAL SECTION  
WOOD SUBSTRATE

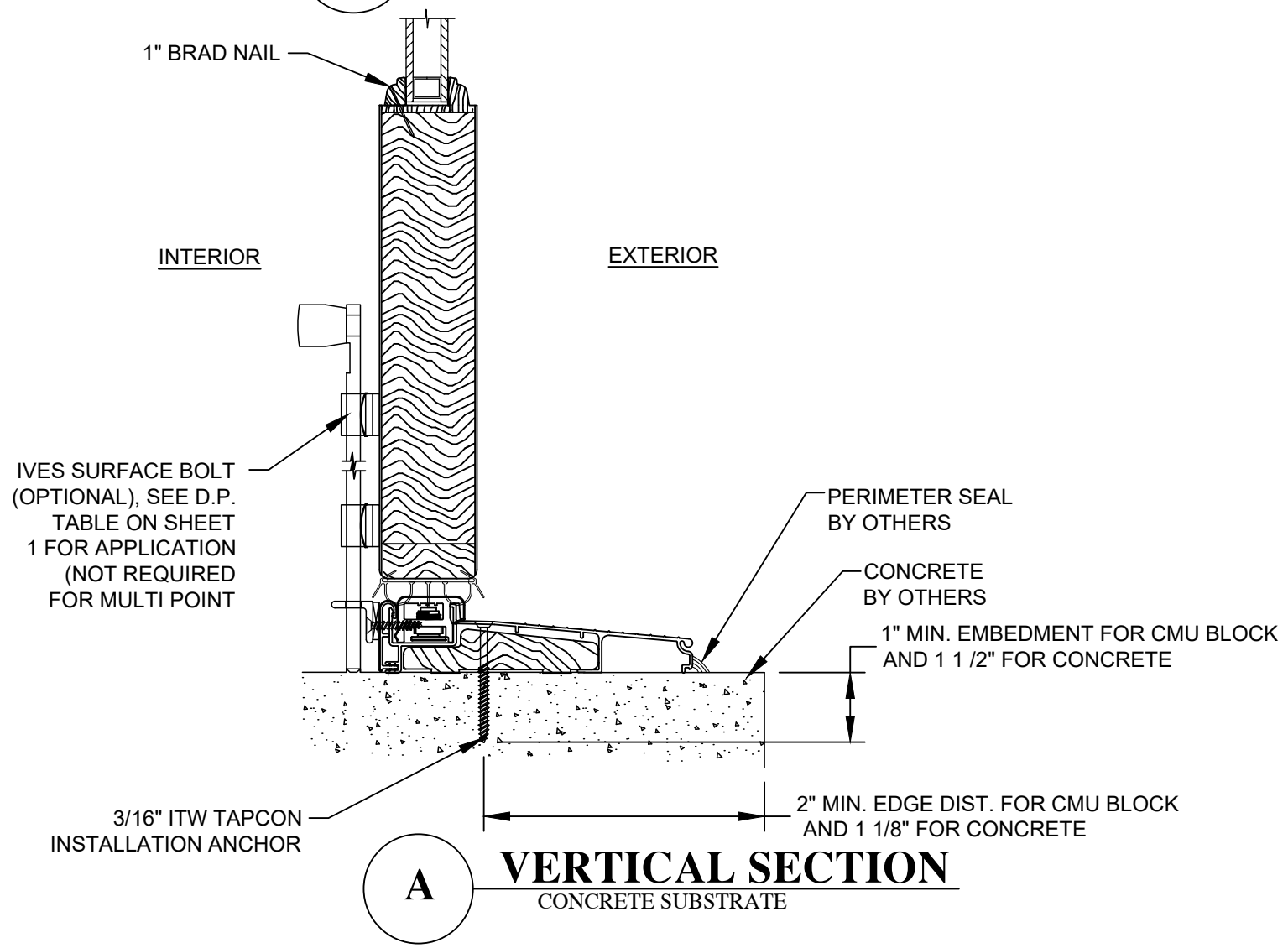

**A** VERTICAL SECTION  
CONCRETE SUBSTRATE

PROJECT: #419-1112

SIMPSON DOOR COMPANY 400 W. SIMPSON AVENUE MCCLEARY, WASHINGTON 98557		DATE: 05/31/12	REVISION: A
GLAZED & OPAQUE WOOD DOORS VERTICAL SECTIONS & GLAZING DETAIL		DRAWING NO: SIMP2060	DESCRIPTION: UPDATE FOR RE-EVALUATION
DRAWN BY: TJH	SCALE: N.T.S.	SHEET: 5 OF 8	DATE: 10/26/21
PREPARED BY: RJA	REV: A		BY: RJA

Robert J. Amoruso  
TX P.E. No. 80817

PTC PRODUCT DESIGN GROUP, LLC  
PO BOX 520775  
LONGWOOD, FLORIDA 32752  
TX CERTIFICATE OF REGISTRATION: F-13740  
Phone: 321.690.1788  
Fax: 321.690.1789  
Email: info@ptc-corp.com

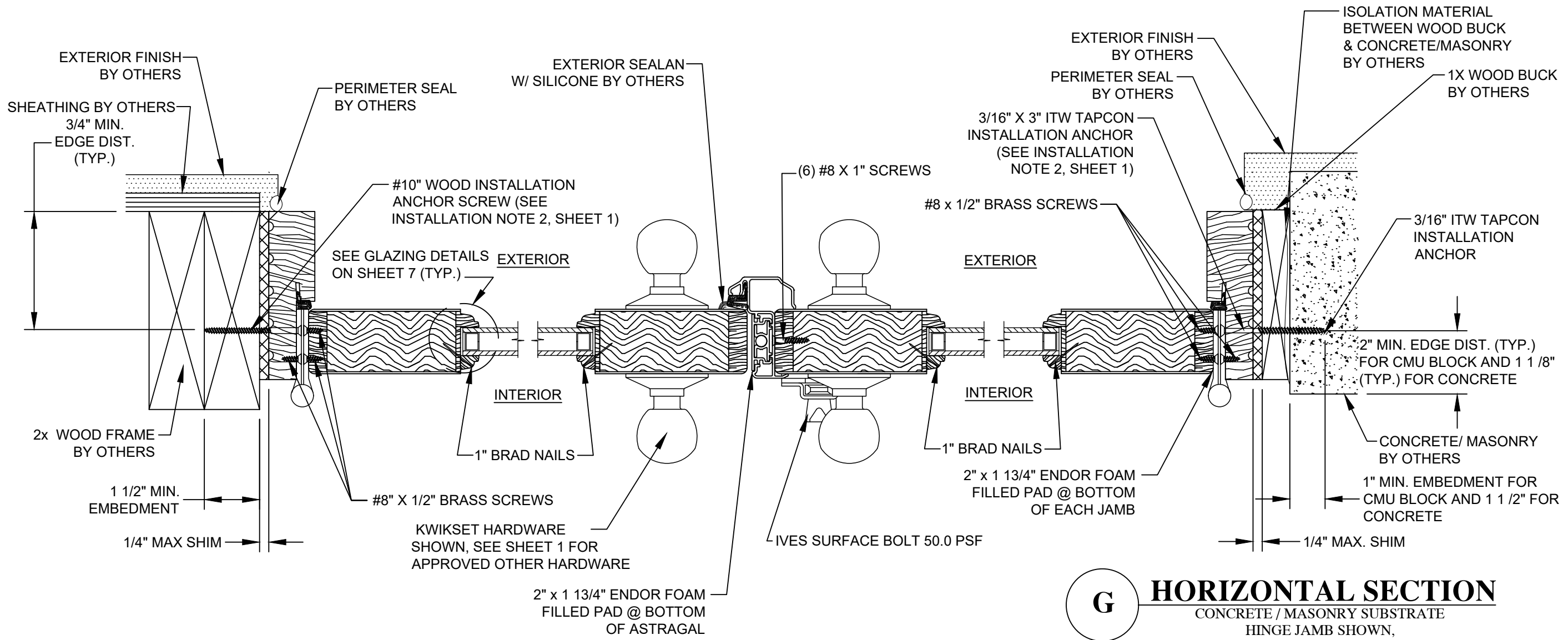

**E HORIZONTAL SECTION**  
WOOD SUBSTRATE  
HINGE JAMB SHOWN,  
STRIKE JAMB SIMILAR

**F HORIZONTAL SECTION**  
ENDORA "ULTIMATE HURRICANE ASTRAGAL"  
W/ & W/O OPTIONAL WOOD VENEER

**G HORIZONTAL SECTION**  
CONCRETE / MASONRY SUBSTRATE  
HINGE JAMB SHOWN,  
STRIKE JAMB SIMILAR

PROJECT: #419-1112

SIMPSON DOOR COMPANY 400 W. SIMPSON AVENUE MCCLEARY, WASHINGTON 98557		DATE: 05/31/12	REV: A
TITLE: GLAZED & OPAQUE WOOD DOORS HORIZONTAL SECTIONS		DRAWING NO: SIMP2060	DATE: 10/26/21
PREPARED BY: T.J.H.	SCALE: N.T.S.	REV: A	DESCRIPTION: UPDATE FOR RE-EVALUATION
DATE: 05/31/12	SCALE: N.T.S.	REV: A	DESCRIPTION: UPDATE FOR RE-EVALUATION
DRAWN BY: T.J.H.		DATE: 05/31/12	BY: RJA
SCALE: N.T.S.		DATE: 05/31/12	BY: RJA
REV: A		DATE: 05/31/12	BY: RJA
SHEET: 6 OF 8		DATE: 05/31/12	BY: RJA

Robert J. Amoruso  
TX P.E. No. 80817



PTC PRODUCT DESIGN GROUP, LLC  
PO BOX 520775  
LONGWOOD, FLORIDA 32752  
TX CERTIFICATE OF REGISTRATION: F-131740  
Phone: 321.690.1788  
Fax: 321.690.1789  
Email: info@ptc-corp.com

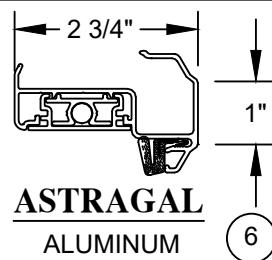

**ASTRAGAL**  
ALUMINUM

6

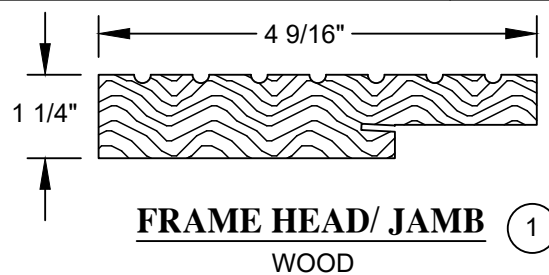

**FRAME HEAD/ JAMB**  
WOOD

1

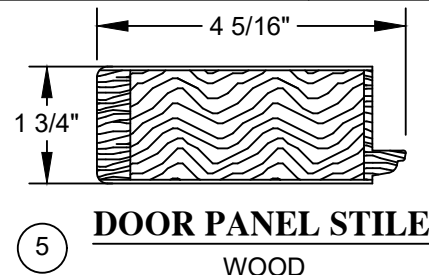

**DOOR PANEL STILE**  
WOOD

5

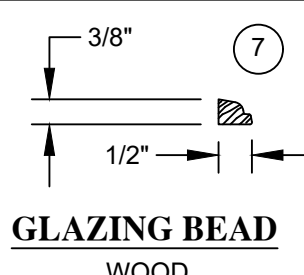

**GLAZING BEAD**  
WOOD

7

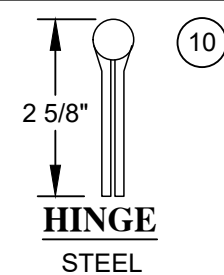

**HINGE**  
STEEL

10

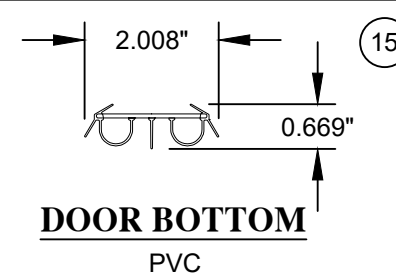

**DOOR BOTTOM**  
PVC

15

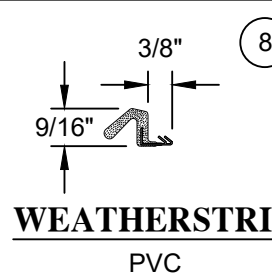

**WEATHERSTRIP**  
PVC

8

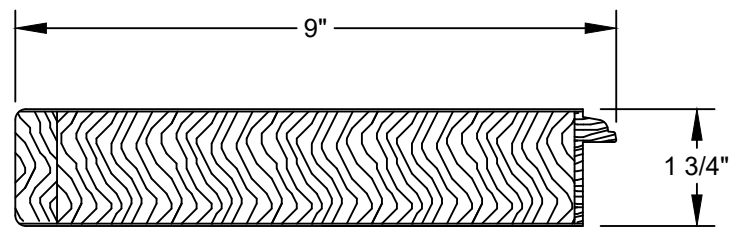

**DOOR PANEL SILL**  
WOOD

4

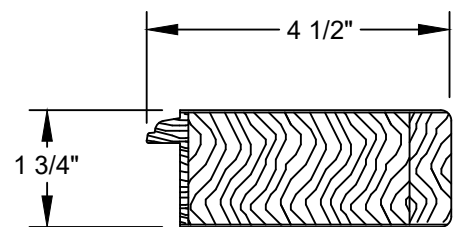

**DOOR PANEL HEAD**  
WOOD

3

ITEM	DESCRIPTION	PART #	MATERIAL	MANUFACTURER
1	FRAME HEAD & JAMB		PINE	SIMPSON DOOR
2	FRAME SILL	ZA15625	6063-T6 ALUMINUM	ENDURA / YOUNG MFG.
3	DOOR PANEL HEAD		WESTERN HEMLOCK *	SIMPSON DOOR
4	DOOR PANEL SILL		WESTERN HEMLOCK *	SIMPSON DOOR
5	DOOR PANEL STILE		WESTERN HEMLOCK *	SIMPSON DOOR
6	ASTRAGAL		ALUMINUM	ENDURA ULTIMATE
7	GLAZING BEAD		WESTERN HEMLOCK *	SIMPSON DOOR
8	WEATHERSTRIPPING	QEBD 650	PVC	SCHLEGAL
9				
10	4" BUTT HINGES		STEEL	
11	STANDARD LOCKSET		STEEL	KWIKSET/SCHLAGE
12	MULTIPOINT LOCKSET		STEEL	W& F
13	SURFACE BOLTS	253B 8"	BRASS	IVES
14	SURFACE BOLT STRIKE PLATE		STEEL	IVES
15	BOTTOM RAIL SWEEP		PVC	ENDURA
16	#9 x 2 1/4" WOOD SCREW		STEEL	
17	3/4" O.A. INSULATED GLASS CONSISTING OF: 1/8" TEMPERED GLASS, 1/2" AIR SPACE, 1/8" TEMPERED GLASS			
19	FRAME SILL I.S. ADA		WOOD	ENDURA

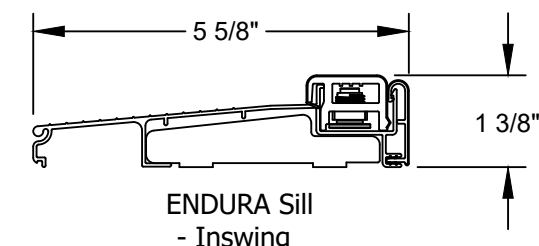

**IN-SWING SILL**  
ALUMINUM 0.053" TYP. WALL THICKNESS

2

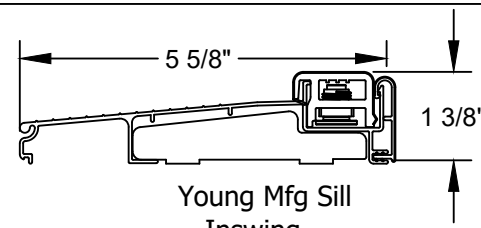

**IN-SWING SILL**  
ALUMINUM/OAK  
0.053" TYP. WALL THICKNESS

2

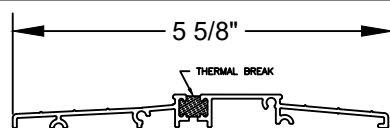

**IN-SWING SILL - ADA**

19

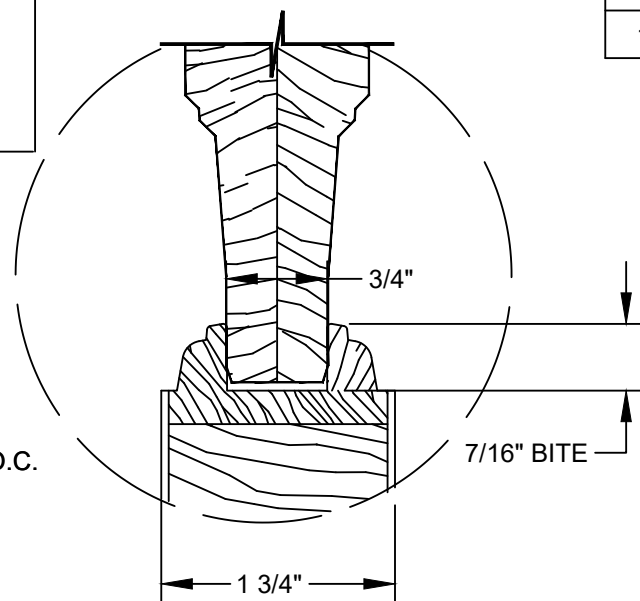

**WOOD PANEL DETAIL**

RAISED WOOD PANEL  
(DOOR LEAF ONLY)

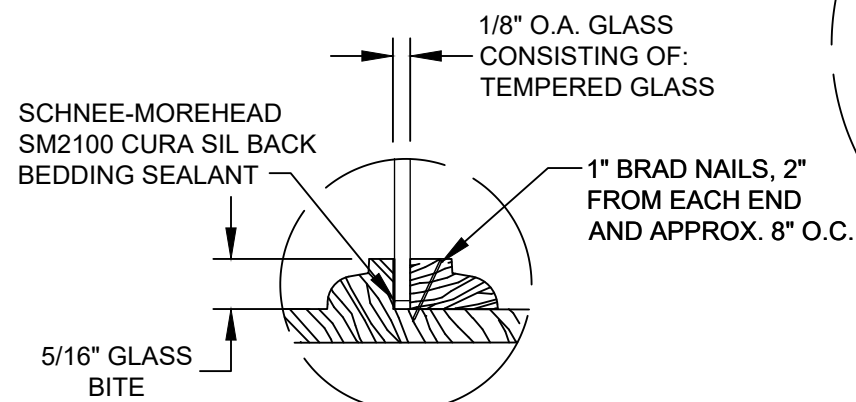

**GLAZING DETAIL 1**

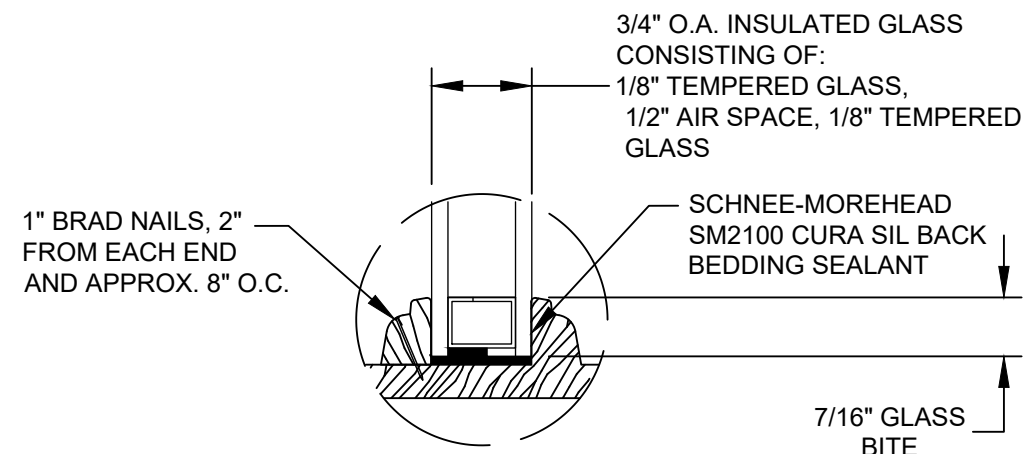

**GLAZING DETAIL 2**

\* DOUGLAS FIR MAY BE USED IN LIEU OF WESTERN HEMLOCK.

3/4" O.A. INSULATED GLASS  
CONSISTING OF:  
1/8" TEMPERED GLASS,  
1/2" AIR SPACE, 1/8" TEMPERED  
GLASS

PROJECT: #419-1112

SIMPSON DOOR COMPANY  
400 W. SIMPSON AVENUE  
MCCLEARY, WASHINGTON 98557

GLAZED & OPAQUE WOOD DOORS  
BILL OF MATERIALS AND GLAZING DETAILS

DATE: 05/31/12  
DRAWING NO: SIMP2060  
SHEET: 7 OF 8  
DRAWN BY: TJH  
SCALE: N.T.S.  
REV: A

PTC PRODUCT DESIGN GROUP, LLC  
PO BOX 520775  
LONGWOOD, FLORIDA 32752  
PHONE: 321.690.1788  
FAX: 321.690.1789  
EMAIL: info@ptc-corp.com  
REGISTRATION NO. F-181749

Robert J. Amoruso  
TX P.E. No. 80817

DATE: 10/26/21  
DESCRIPTION: UPDATE FOR RE-EVALUATION  
REV: A

DATE: 05/31/12  
DRAWING NO: SIMP2060  
SHEET: 7 OF 8

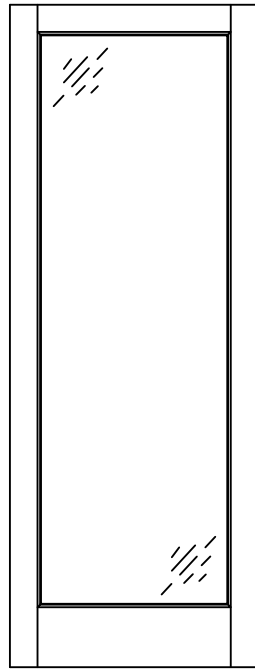

7001  
1501  
7711

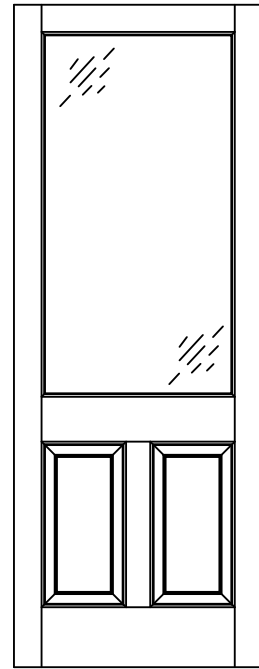

144  
7044

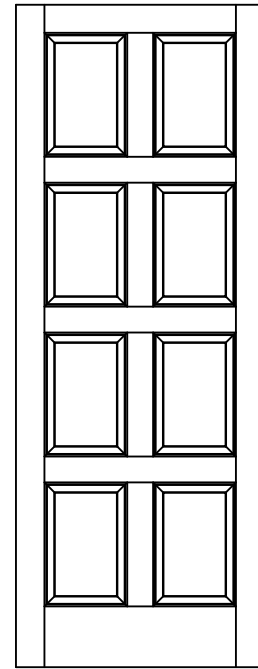

2010

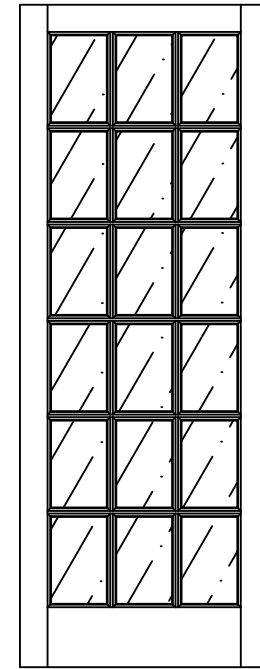

7018  
1518

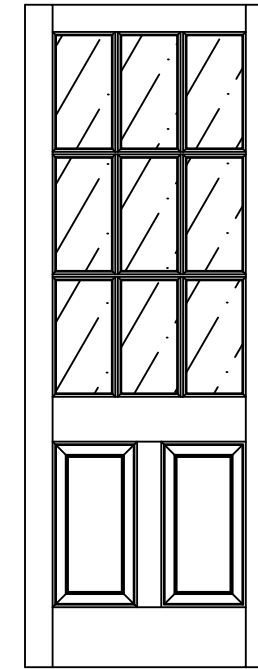

944  
7944

**TYPICAL APPROVED PANEL CONFIGURATIONS**

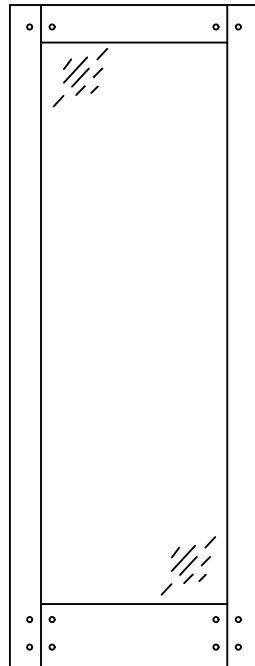

77001

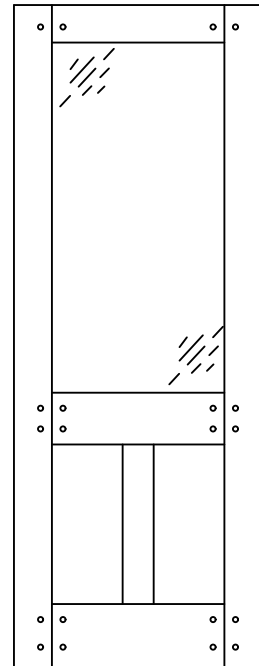

77044

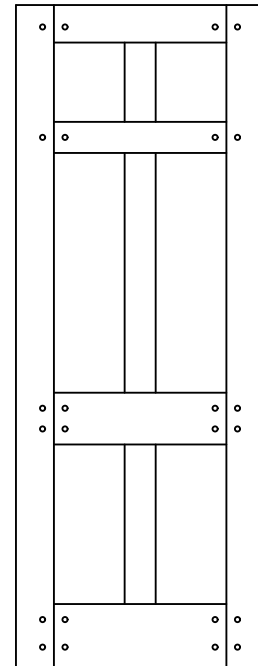

77130

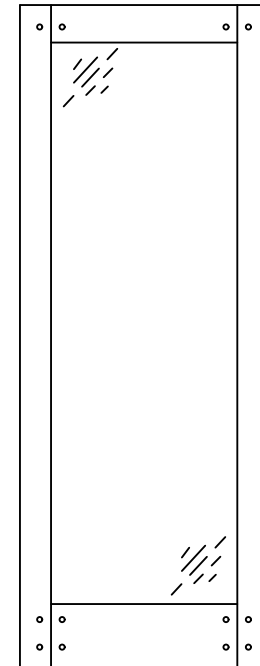

77018  
SDL only

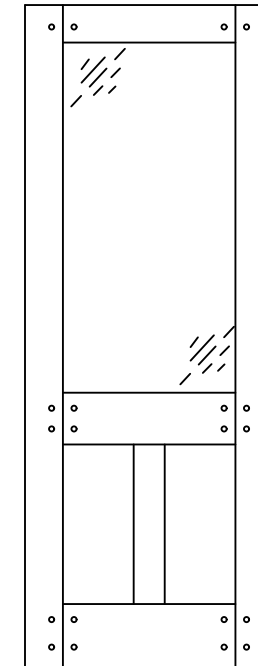

77944  
SDL only

PROJECT: #419-1112

SIMPSON DOOR COMPANY  
400 W. SIMPSON AVENUE  
MCCLARY, WASHINGTON 98557

GLAZED, & OPAQUE WOOD DOORS  
TYPICAL PANEL CONFIGURATIONS

TITLE:	GLAZED, & OPAQUE WOOD DOORS TYPICAL PANEL CONFIGURATIONS
PREPARED BY:	PTC PRODUCT DESIGN GROUP, LLC PO BOX 520775 LONGWOOD, FLORIDA 32752 TX CERTIFICATE OF REGISTRATION: F-13740
DRAWN BY:	TJH
DATE:	05/31/12
SCALE:	N.T.S.
DRAWING NO.:	SIMP2060
REV:	A
SHEET:	8 OF 8

REV	DESCRIPTION	DATE	BY
A	UPDATE FOR RE-EVALUATION	10/26/21	RIA

Robert J. Amoruso  
TX P.E. No. 80817