

THERMA TRU®

118 INDUSTRIAL DR., EDGERTON, OH 43517

SMOOTH-STAR, FIBER-CLASSIC, CLASSIC-CRAFT & CLASSIC-CRAFT RUSTIC SINGLE "IMPACT" DOOR INSWING / OUTSWING

EVALUATED FOR USE IN THE STATE OF TEXAS

The Fiberglass Door system described herein complies with the 2018 International Residential Code (IRC), Sections R301 & R609 and the 2018 International Building Code (IBC), Sections 1404.13, 1609, 1709.5, 2403 and 2404 subject to the following conditions:

1. Anchors shall be as listed and spaced as shown in the details. Anchor embedment to base material shall be beyond wall dressing or stucco.
2. This system has been tested and evaluated as a large missile impact protective system for installation in areas that require wind borne debris protection. This product meets missile level "D" as defined in ASTM E 1996.
3. Allowable design pressure requirements must be equal to or less than the design pressure rating shown in the design pressure chart, sheet 1 of this drawing.
4. Conditions not covered by this drawing are subject to further engineering analysis.
5. Fiber-Classic and Smooth-Star Door and Sidelite panels require the use of "J" part numbers. These door and sidelite panels must be stained or painted within six months of installation.

TABLE OF CONTENTS	
SHEET #	DESCRIPTION
1	TYPICAL ELEVATION, DESIGN PRESSURES & GENERAL NOTES
2	DOOR PANEL DETAILS (SMOOTH STAR)
3	DOOR PANEL DETAILS (CLASSIC CRAFT)
4	DOOR PANEL DETAILS (CLASSIC CRAFT RUSTIC)
5	DOOR PANEL DETAILS (FIBER CLASSIC)
6	HORIZONTAL CROSS SECTIONS
7	VERTICAL CROSS SECTIONS
8	FRAME ANCHORING
9	BILL OF MATERIALS & COMPONENTS

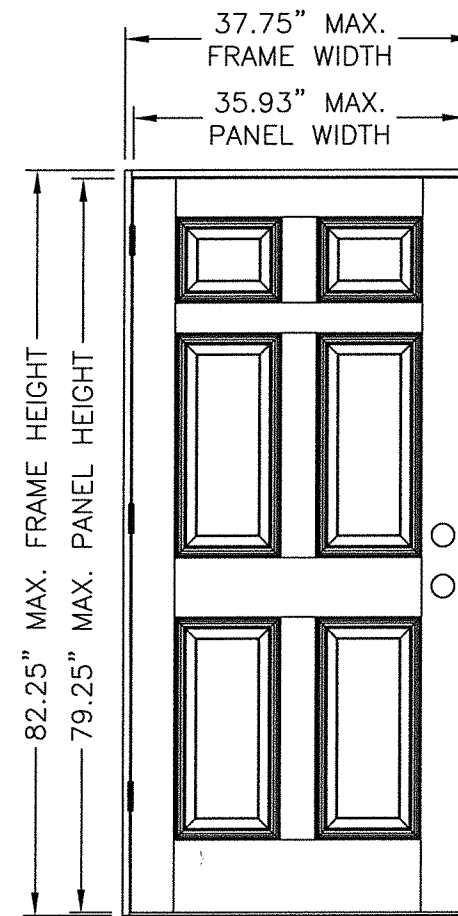

"SMOOTH STAR", "CLASSIC CRAFT", "CLASSIC CRAFT RUSTIC" & "FIBER CLASSIC"

DOOR TYPE	SWING	OVERALL FRAME DIMENSION	DESIGN PRESSURE	
			POSITIVE	NEGATIVE
CLASSIC CRAFT	OUTSWING	37.75" X 80.75"	+100.0	-100.0
	INSWING	37.75" X 82.25"	+100.0	-100.0
FIBER CLASSIC	OUTSWING	37.75" X 80.75"	+80.0	-80.0
	INSWING	37.75" X 82.25"	+75.0	-75.0
SMOOTH STAR	OUTSWING	37.75" X 80.75"	+80.0	-80.0
	INSWING	37.75" X 82.25"	+75.0	-75.0
CLASSIC CRAFT RUSTIC	OUTSWING	37.75" X 80.75"	+90.0	-95.0
	INSWING	37.75" X 82.25"	+90.0	-95.0

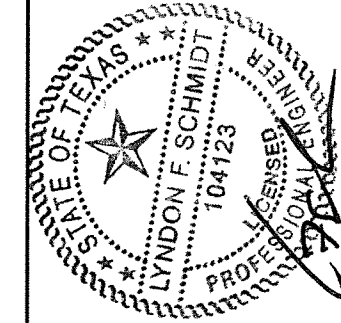

Documents Prepared By: Lyndon F. Schmidt, P.E.
TEXAS P.E. #104123

RW BUILDING CONSULTANTS, INC.
P.O. Box 230 Valrico FL 33595
Phone No.: 813.659.9197
TEXAS BOARD OF PROFESSIONAL ENGINEERS
CERTIFICATE OF REGISTRATION # F-11852

PRODUCT: SINGLE OPAQUE
FIBERGLASS DOOR
"IMPACT" INSWING / OUTSWING
PART OR ASSEMBLY:
TYPICAL ELEVATION, DESIGN
PRESSURES & GENERAL NOTES

NO.	DATE	REVISIONS
2	5/06/20	UPDATE TO 2018 IBC/IRC CODE
1	7/16/15	ADDED GENERAL NOTE 5.

DATE: 07/17/12
SCALE: N.T.S.
DWG. BY: JK
CHK. BY: LFS
DRAWING NO.: TX-4185
SHEET 1 OF 9

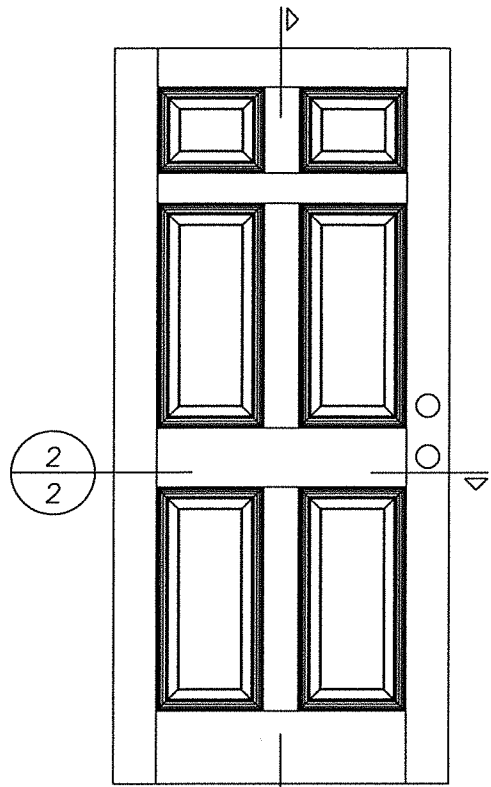

1
2
SMOOTH STAR

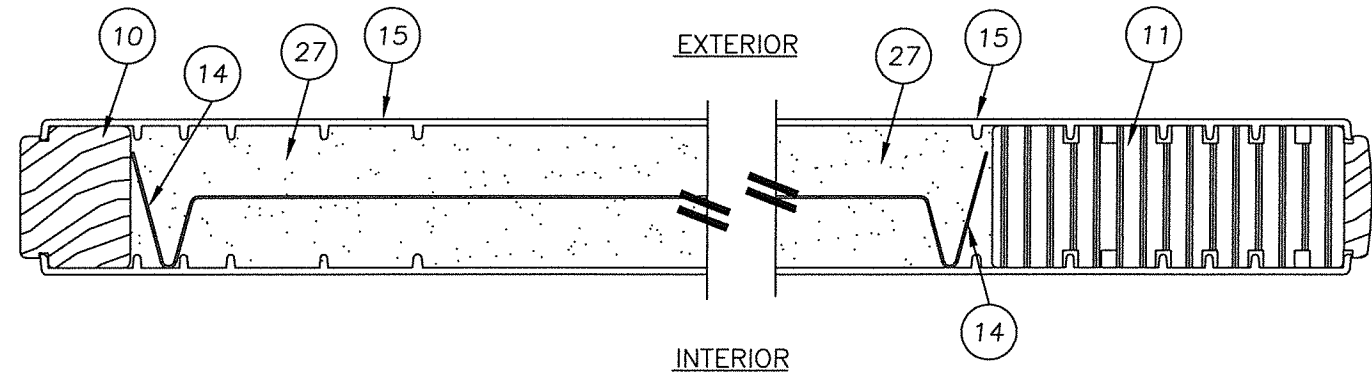

2 HORIZONTAL CROSS SECTION
2 SMOOTH STAR

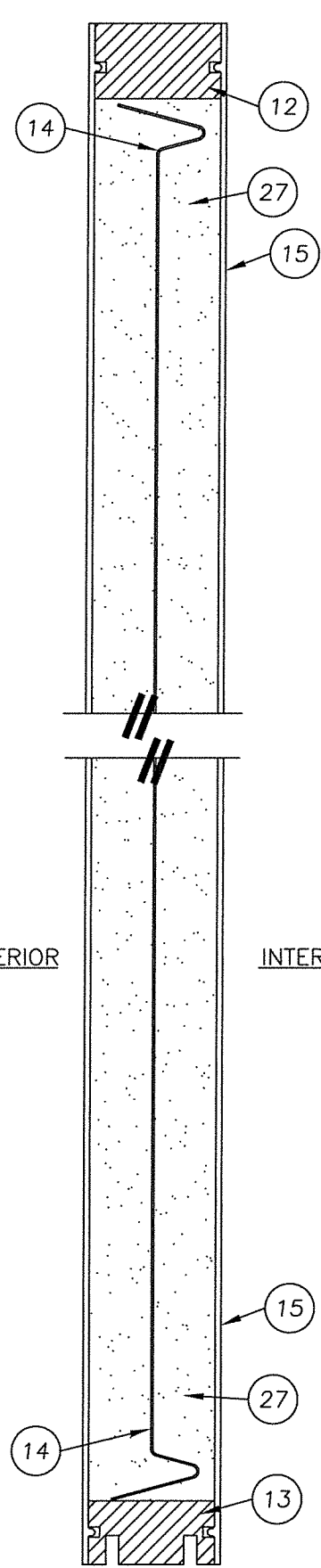

1 VERTICAL CROSS SECTION
2 SMOOTH STAR

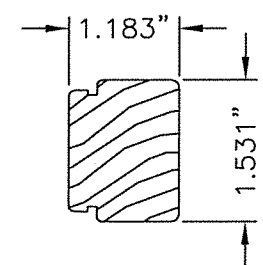

10 HINGE STILE
SMOOTH STAR

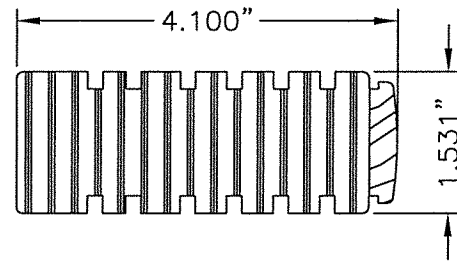

11 LOCK STILE
SMOOTH STAR

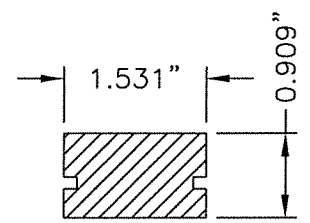

12 TOP RAIL
SMOOTH STAR

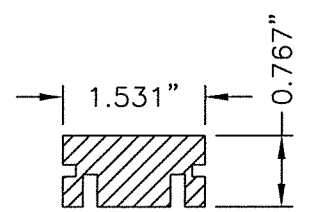

13 BOTTOM RAIL
SMOOTH STAR

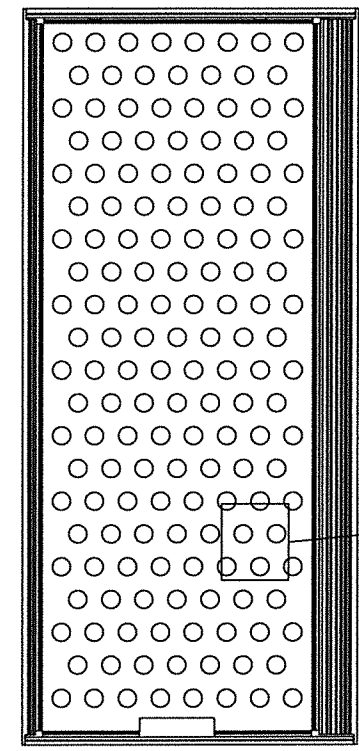

Ø2" DIA.
MAX.

28.86% OPEN
AREA MAX.

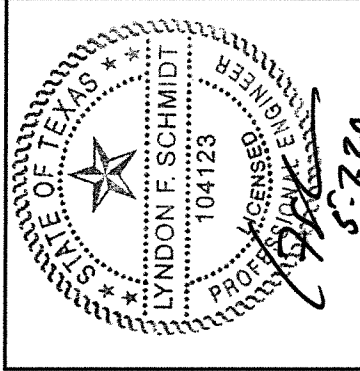

Documents Prepared By: Lyndon F. Schmidt, P.E.
TEXAS P.E. #104123

RW BUILDING CONSULTANTS, INC.
P.O. Box 230 Valrico FL 33595
Phone No.: 813.659.9197

TEXAS BOARD OF PROFESSIONAL ENGINEERS
CERTIFICATE OF REGISTRATION # F-11852

PRODUCT: SINGLE OPAQUE
FIBERGLASS DOOR
"IMPACT" INSWING / OUTSWING
PART OR ASSEMBLY:
DOOR PANEL DETAILS
(SMOOTH STAR)

REVISIONS	
NO.	DATE
2	5/06/20
1	7/16/15

DATE: 07/17/12
SCALE: N.T.S.
DWG. BY: JK
CHK. BY: LFS
DRAWING NO.: TX-4185
SHEET 2 OF 9

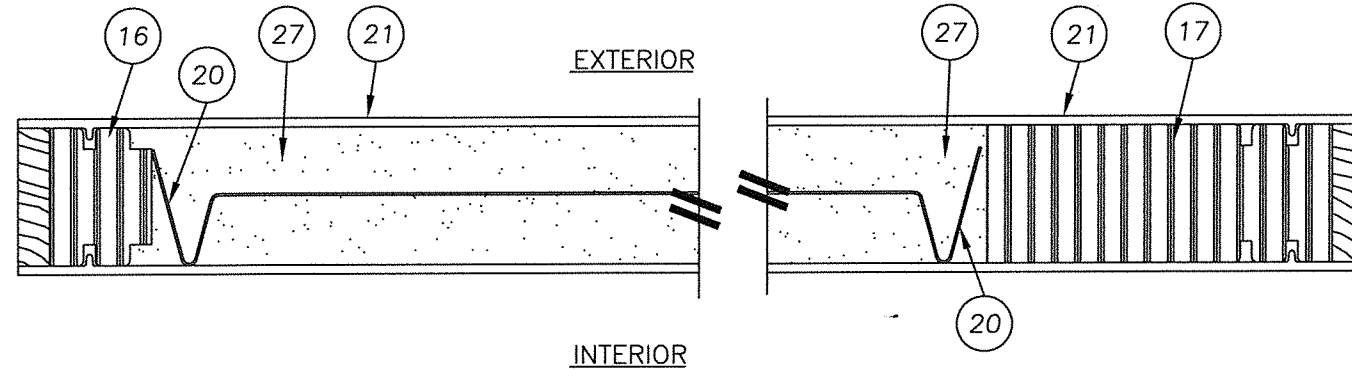
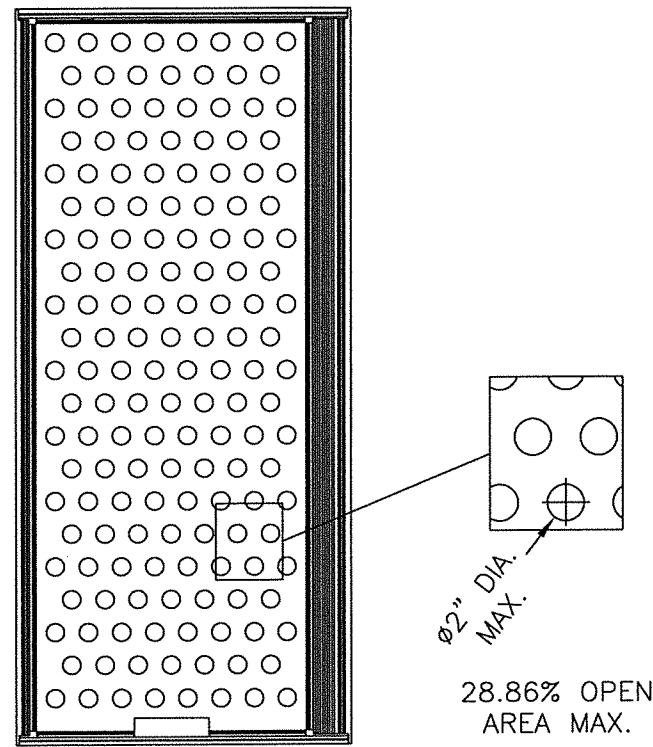
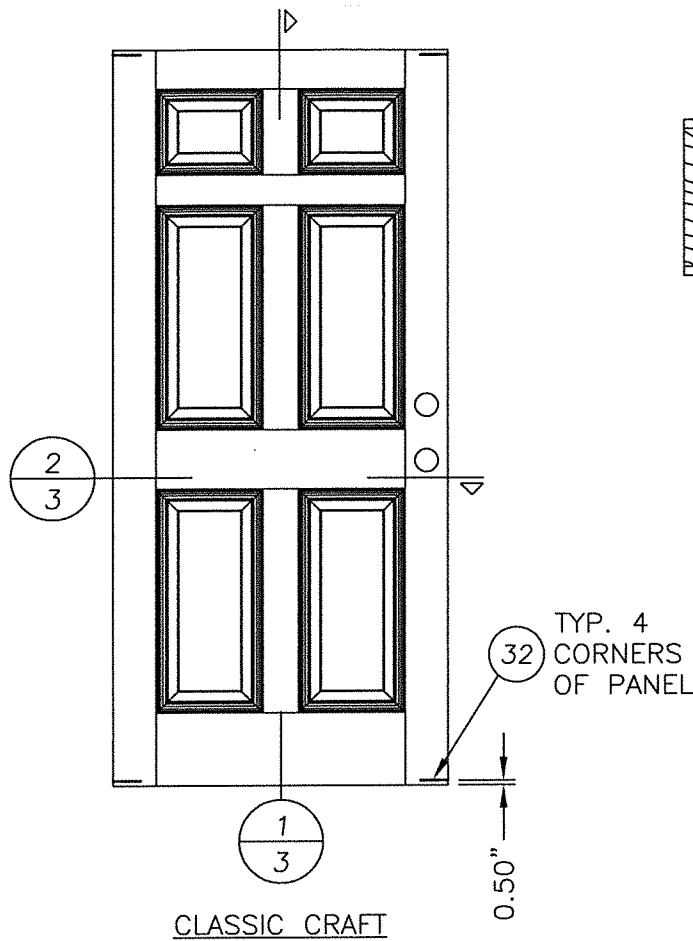

2 HORIZONTAL CROSS SECTION
3 (CLASSIC CRAFT)

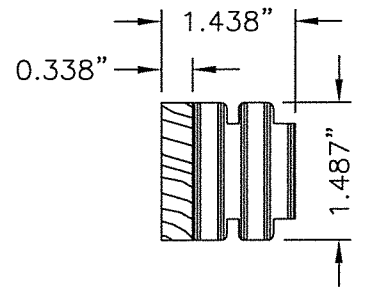

16 HINGE STILE
CLASSIC CRAFT

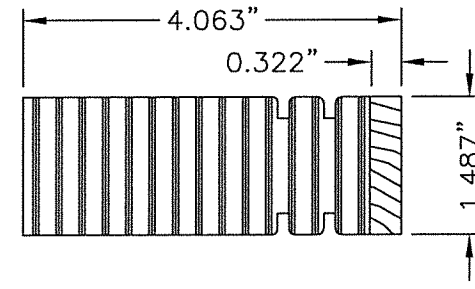

17 LOCK STILE
CLASSIC CRAFT

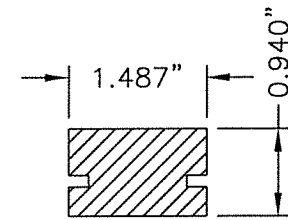

18 TOP RAIL
CLASSIC CRAFT

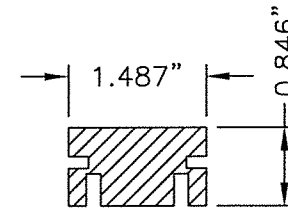

19 BOTTOM RAIL
CLASSIC CRAFT

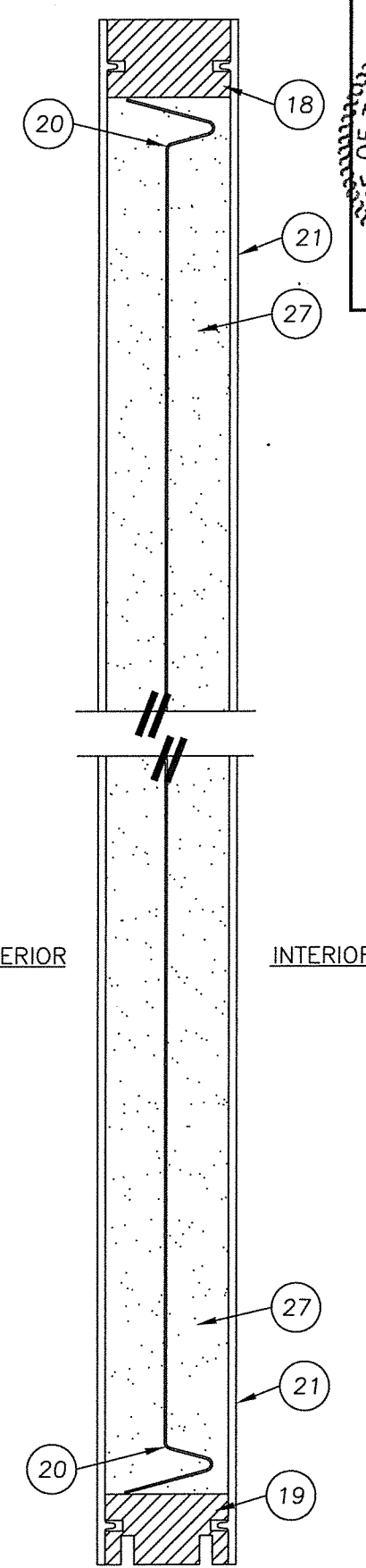

1 VERTICAL CROSS SECTION
3 (CLASSIC CRAFT)

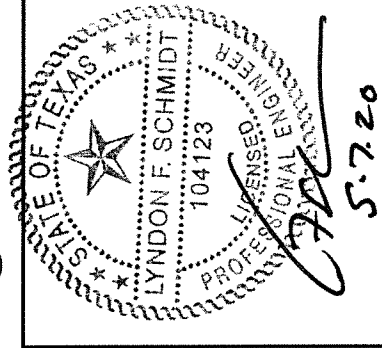

Documents Prepared By: Lyndon F. Schmidt, P.E.
TEXAS P.E. #104123

RW BUILDING CONSULTANTS, INC.
P.O. Box 230 Valrico FL 33595
Phone No.: 813.659.9197
TEXAS BOARD OF PROFESSIONAL ENGINEERS
CERTIFICATE OF REGISTRATION # F-11852

PRODUCT: SINGLE OPAQUE
FIBERGLASS DOOR
"IMPACT" INSWING / OUTSWING
PART OR ASSEMBLY:
DOOR PANEL DETAILS
(CLASSIC CRAFT)

NO.	DATE	BY	REVISIONS
2	5/06/20	LFS	UPDATE TO 2018 IBC/IRC CODE
1	7/16/15	LFS	ADDED GENERAL NOTE 5.

DATE: 7/17/12
SCALE: N.T.S.
DWG. BY: JK
CHK. BY: LFS
DRAWING NO.: TX-4185
SHEET 3 OF 9

R:\Clients\Therma Tru PERMANENT\B - Texas Dept of Ins\TDI - DR 276 - 68 Opaque FG Imp IS - OS Sgls Dbis w-wo Non-imp SLAC - Drawings\Current\RUSTIC.dwg, FX

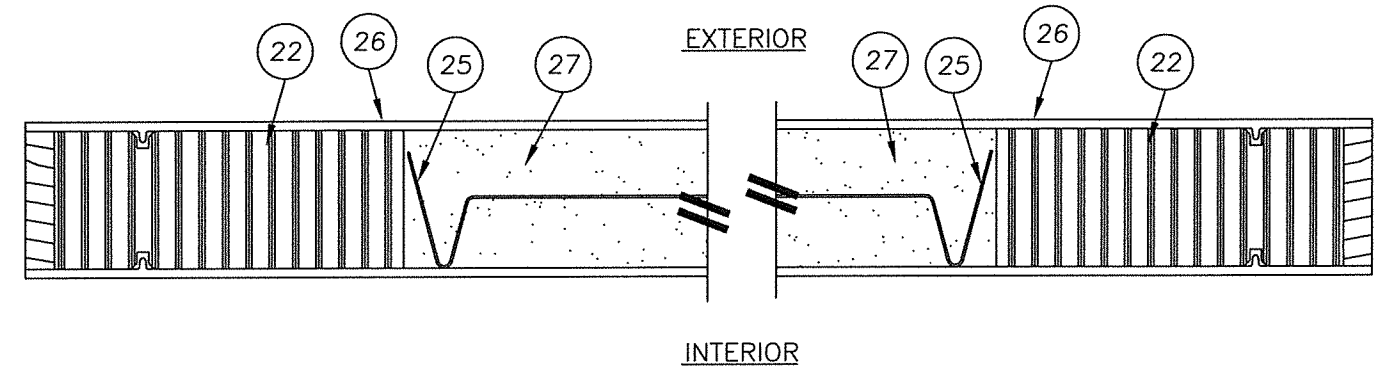
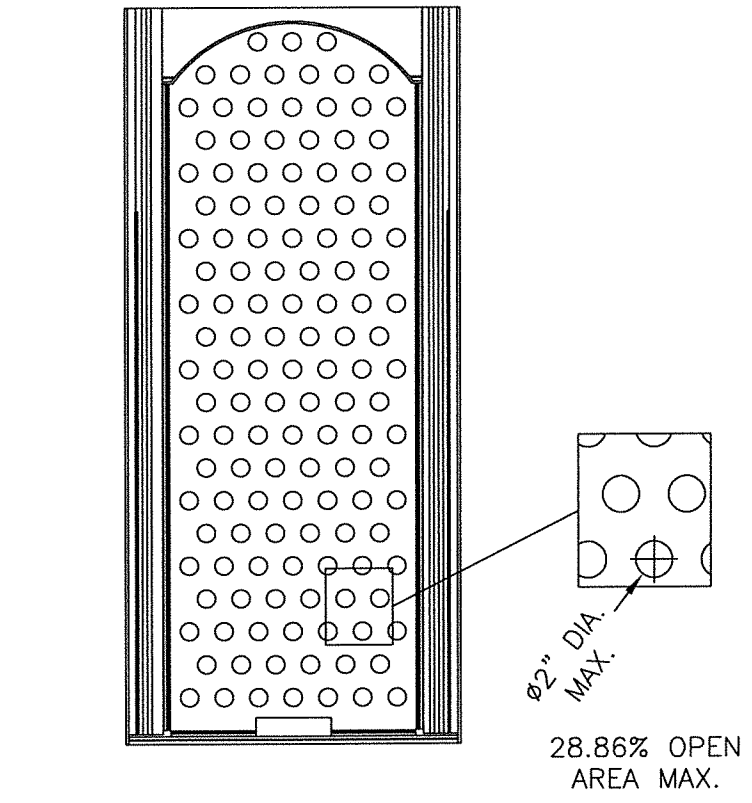
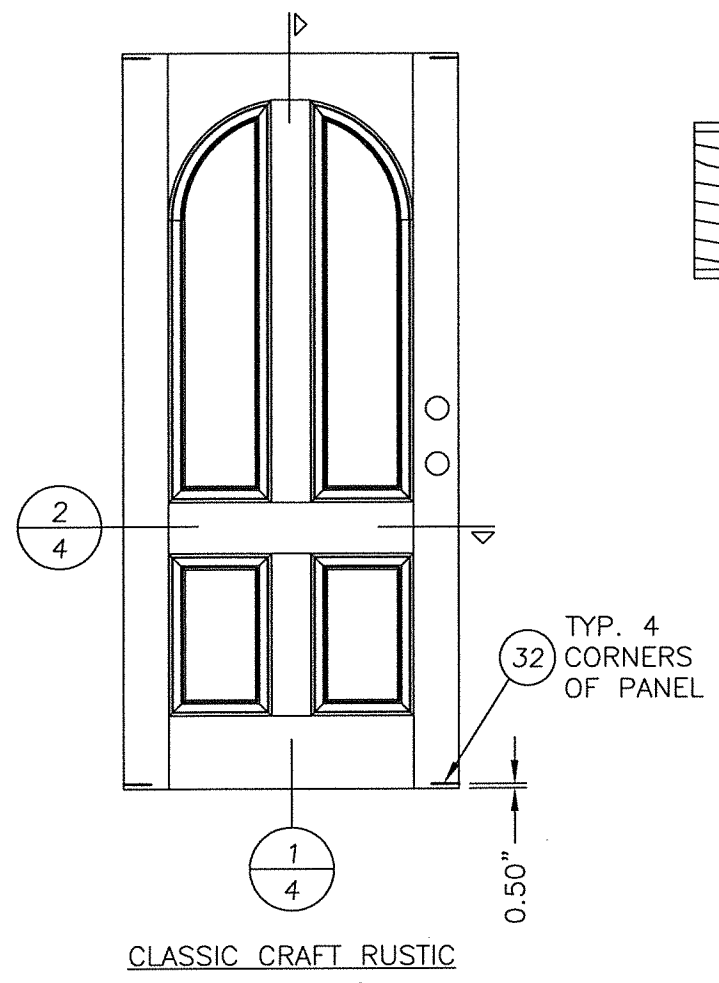

2 HORIZONTAL CROSS SECTION
4 (CLASSIC CRAFT RUSTIC)

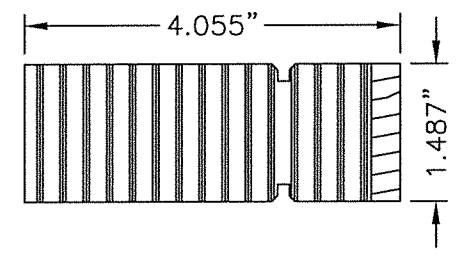

22 LOCK & HINGE STILE
CLASSIC CRAFT RUSTIC

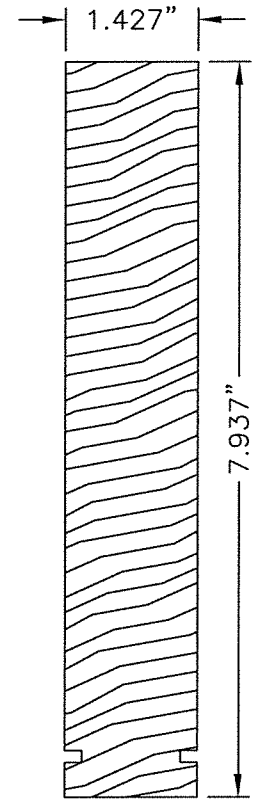

23 TOP RAIL
CLASSIC CRAFT RUSTIC

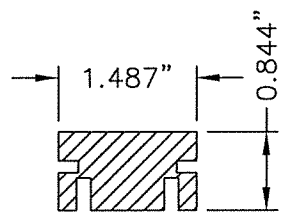

24 BOTTOM RAIL
CLASSIC CRAFT RUSTIC

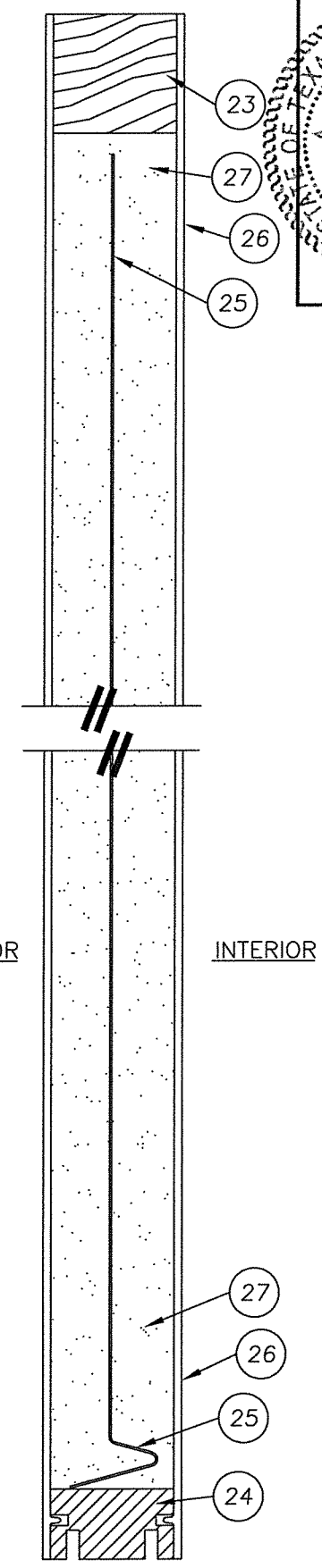

1 VERTICAL CROSS SECTION
4 (CLASSIC CRAFT RUSTIC)

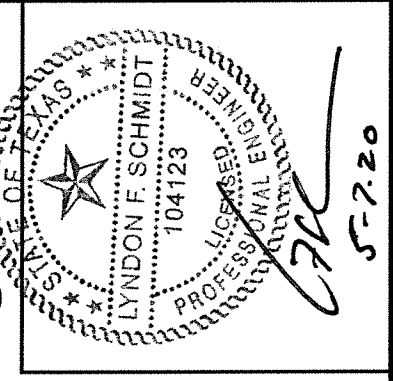

Documents Prepared By: Lyndon F. Schmidt, P.E.
TEXAS P.E. #104123

RW BUILDING CONSULTANTS, INC.
P.O. Box 230 Valrico FL 33595
Phone No.: 813.659.9197

TEXAS BOARD OF PROFESSIONAL ENGINEERS
CERTIFICATE OF REGISTRATION # F-11852

PRODUCT: SINGLE OPAQUE FIBERGLASS DOOR
"IMPACT" INSWING / OUTSWING
PART OR ASSEMBLY:
DOOR PANEL DETAILS
(CLASSIC CRAFT RUSTIC)

NO.	DATE	REVISIONS	BY
2	5/06/20	UPDATE TO 2018 IBC/IRC CODE	LFS
1	7/16/15	ADDED GENERAL NOTE 5.	LFS

DATE: 07/17/12
SCALE: N.T.S.
DWG. BY: JK
CHK. BY: LFS
DRAWING NO.: TX-4185
SHEET 4 OF 9

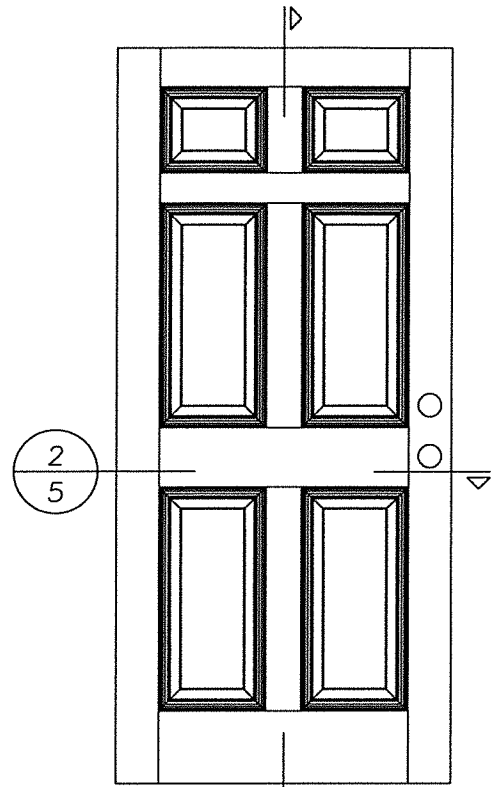

2 HORIZONTAL CROSS SECTION
5 FIBER CLASSIC

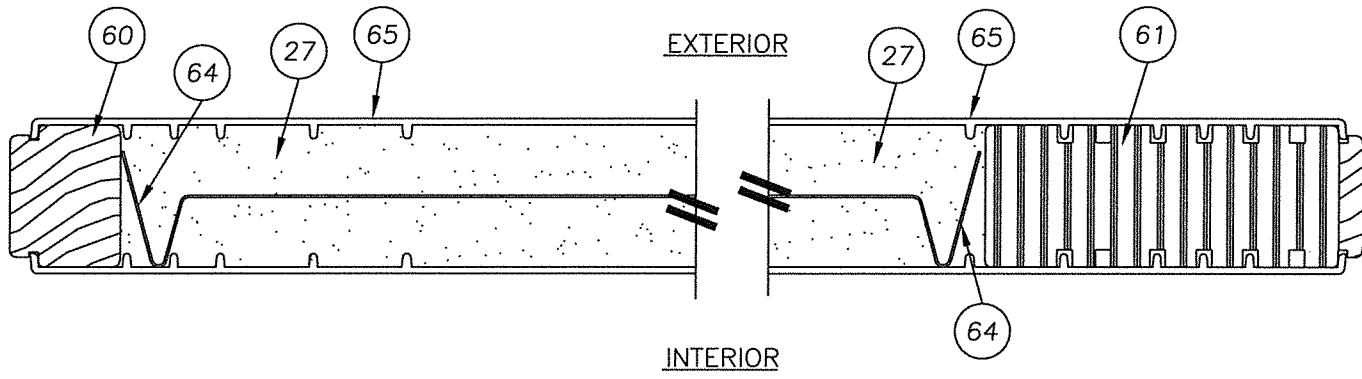

1 VERTICAL CROSS SECTION
5 FIBER CLASSIC

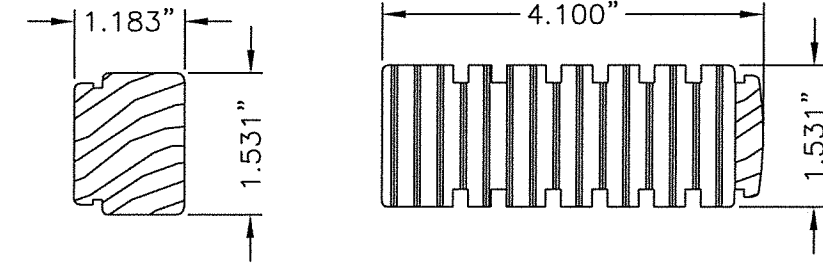
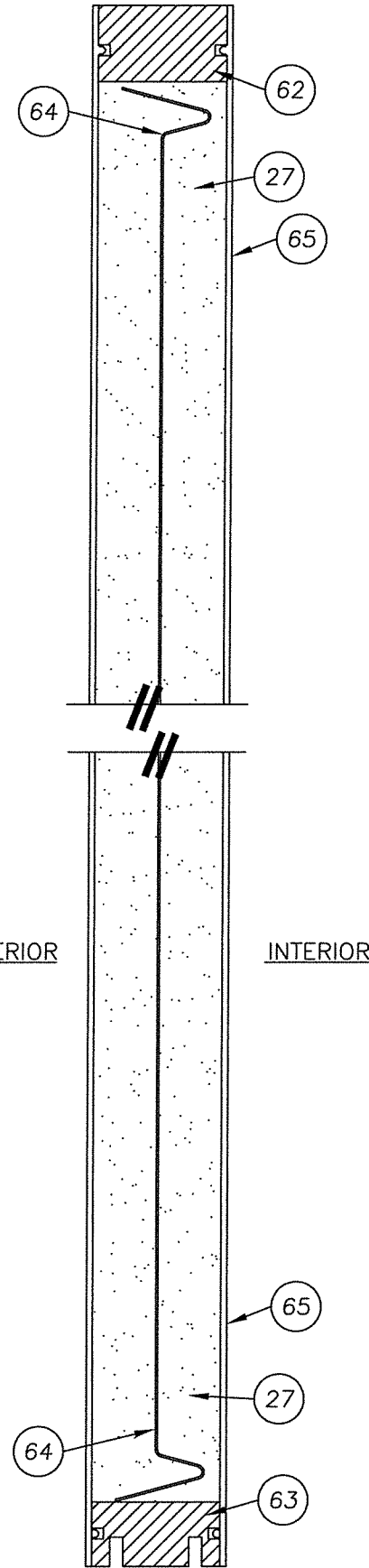

60 HINGE STILE
5 FIBER CLASSIC 61 LOCK STILE
5 FIBER CLASSIC

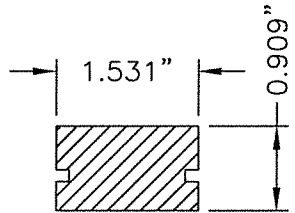

62 TOP RAIL
5 FIBER CLASSIC

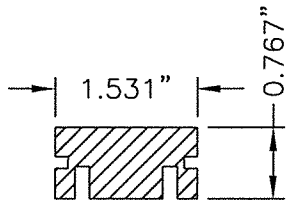

63 BOTTOM RAIL
5 FIBER CLASSIC

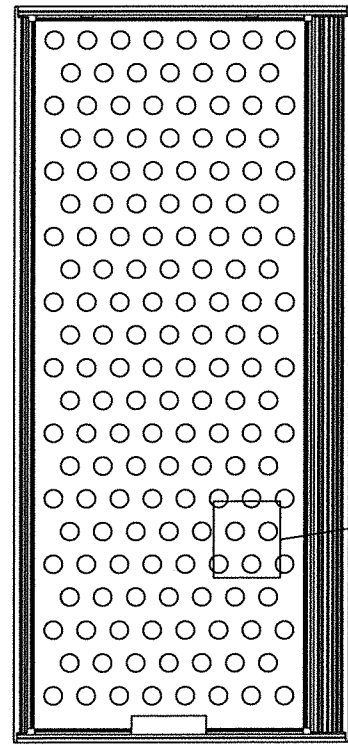

1 FIBER CLASSIC

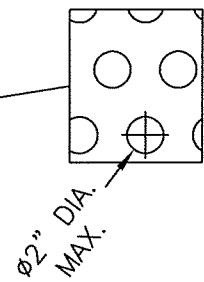

28.86% OPEN
AREA MAX.

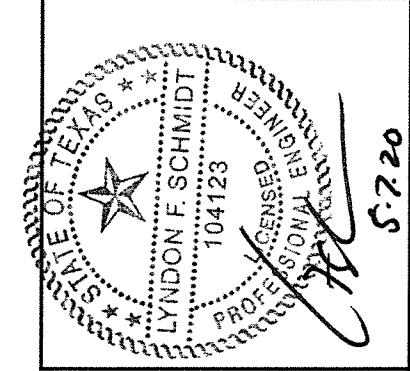

Documents Prepared By: Lyndon F. Schmidt, P.E.
TEXAS P.E. #104123
5-7-20
R.W. BUILDING CONSULTANTS, INC.
P.O. Box 230 Valrico FL 33595
Phone No.: 813.659.9197
TEXAS BOARD OF PROFESSIONAL ENGINEERS
CERTIFICATE OF REGISTRATION # F-11852

PRODUCT: SINGLE OPAQUE
FIBERGLASS DOOR
"IMPACT" INSWING / OUTSWING
PART OR ASSEMBLY:
DOOR PANEL DETAILS
(FIBER CLASSIC)

NO.	DATE	REVISIONS	BY
2	5/06/20	UPDATE TO 2018 IBC/IRC CODE	LFS
1	7/16/15	ADDED GENERAL NOTE 5.	LFS

DATE: 07/17/12
SCALE: N.T.S.
DWG. BY: JK
CHK. BY: LFS
DRAWING NO.: TX-4185
SHEET 5 OF 9

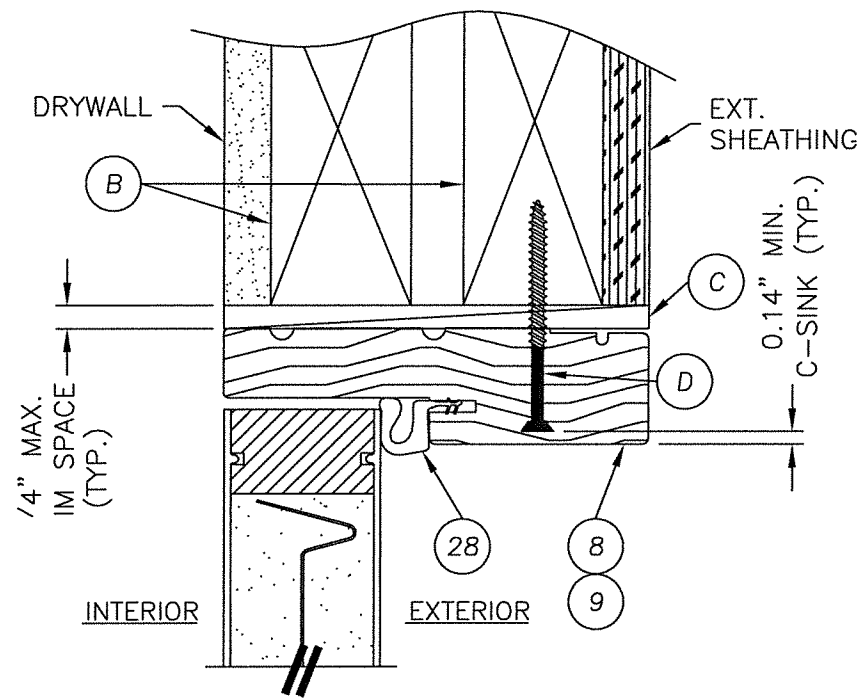

1 VERTICAL CROSS SECTION
 7 INSWING SHOWN - OUTSWING ALSO APPROVED
 SMOOTH STAR PANEL SHOWN
 SEE DOOR PANEL DETAILS FOR
 OPTIONAL PANEL TYPES

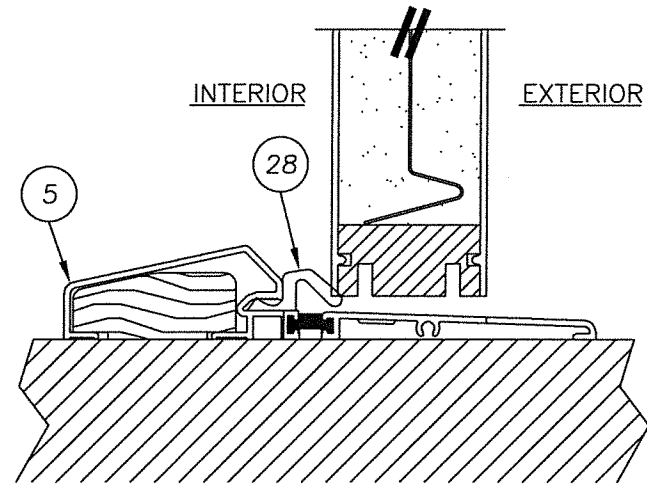

2 VERTICAL CROSS SECTION
 7 @ THRESHOLD
 SMOOTH STAR PANEL SHOWN
 SEE DOOR PANEL DETAILS FOR
 OPTIONAL PANEL TYPES

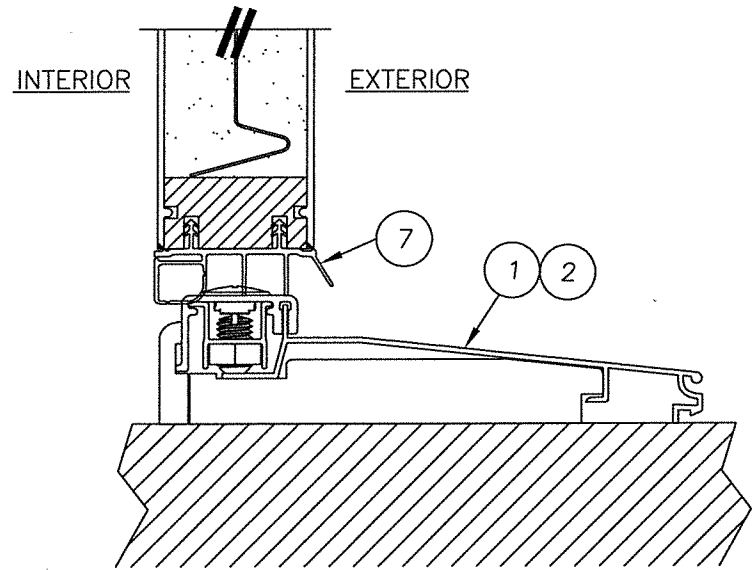

3 VERTICAL CROSS SECTION
 7 @ THRESHOLD
 SMOOTH STAR PANEL SHOWN
 SEE DOOR PANEL DETAILS FOR
 OPTIONAL PANEL TYPES

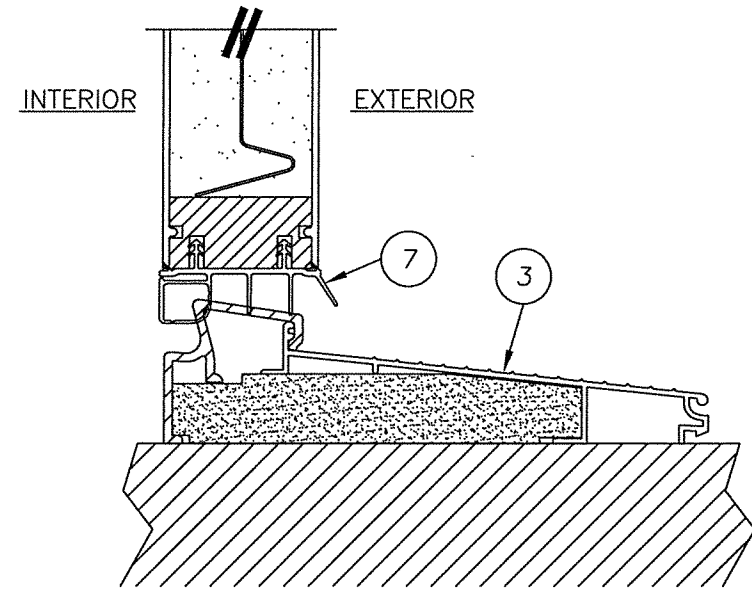

4 VERTICAL CROSS SECTION
 7 @ THRESHOLD
 SMOOTH STAR PANEL SHOWN
 SEE DOOR PANEL DETAILS FOR
 OPTIONAL PANEL TYPES

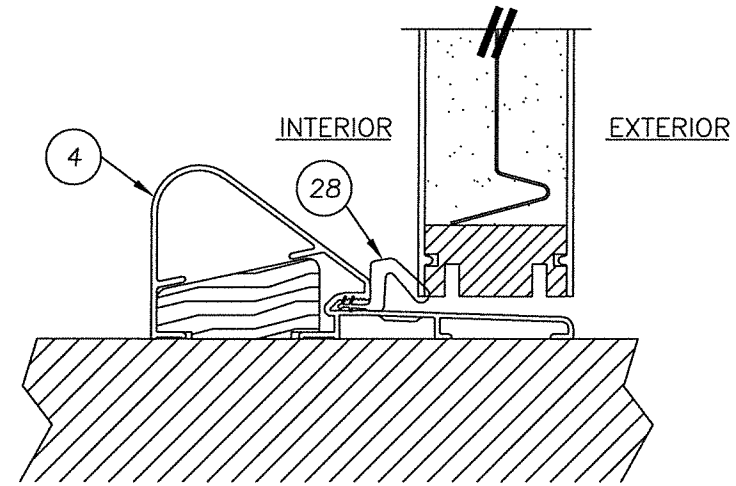

5 VERTICAL CROSS SECTION
 7 @ THRESHOLD
 SMOOTH STAR PANEL SHOWN
 SEE DOOR PANEL DETAILS FOR
 OPTIONAL PANEL TYPES

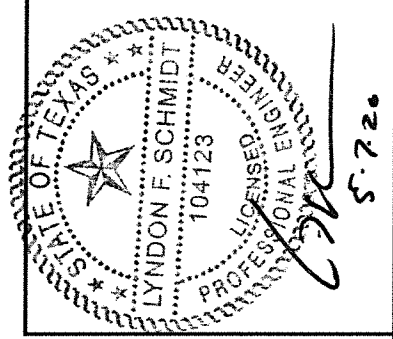

Documents Prepared By: Lyndon F. Schmidt, P.E.
 TEXAS P.E. #104123
RW BUILDING CONSULTANTS, INC.
 P.O. Box 230 Volrico FL 33595
 Phone No.: 813.659.9197
 TEXAS BOARD OF PROFESSIONAL ENGINEERS
 CERTIFICATE OF REGISTRATION # F-11852

PRODUCT: SINGLE OPAQUE
 FIBERGLASS DOOR
 "IMPACT" INSWING / OUTSWING
 PART OR ASSEMBLY:
 VERTICAL CROSS SECTIONS

NO.	DATE	BY
2	5/06/20	LFS
1	7/16/15	LFS

DATE: 07/17/12
 SCALE: N.T.S.
 DWG. BY: JK
 CHK. BY: LFS
 DRAWING NO.: TX-4185
 SHEET 7 OF 9

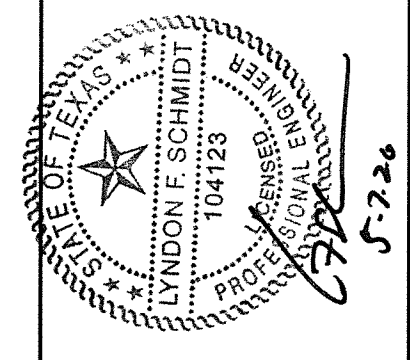
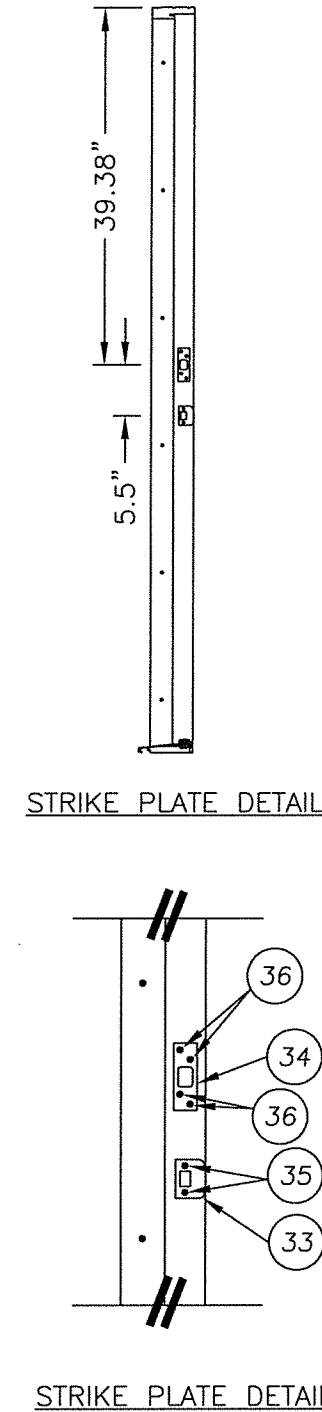
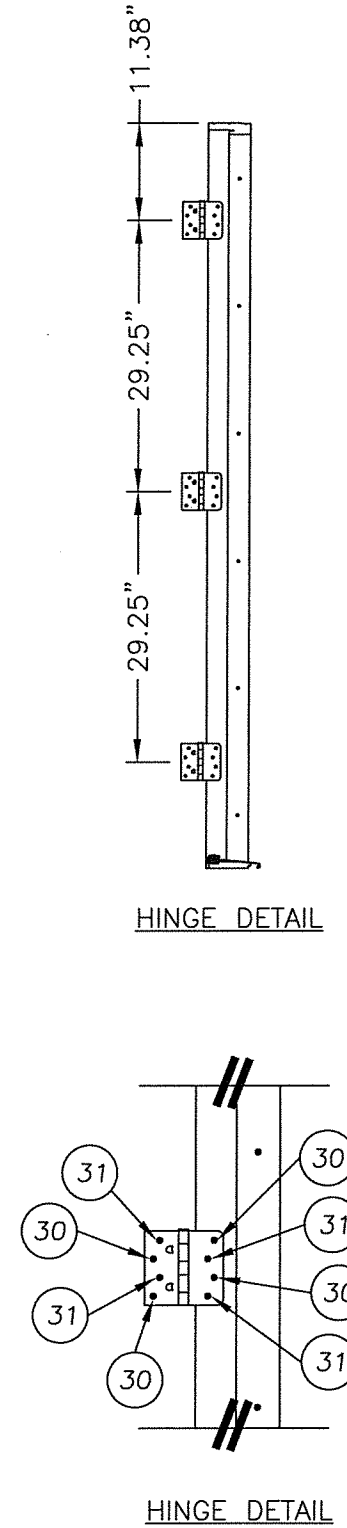
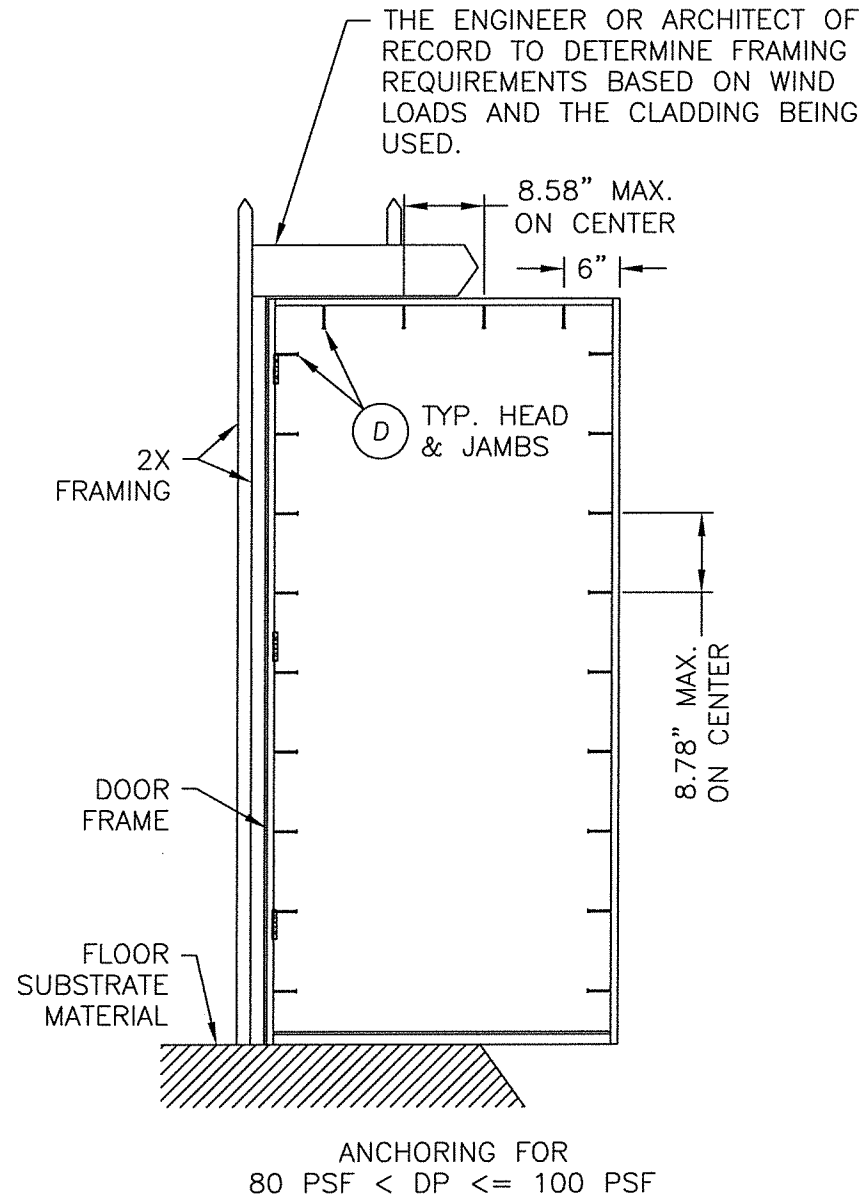
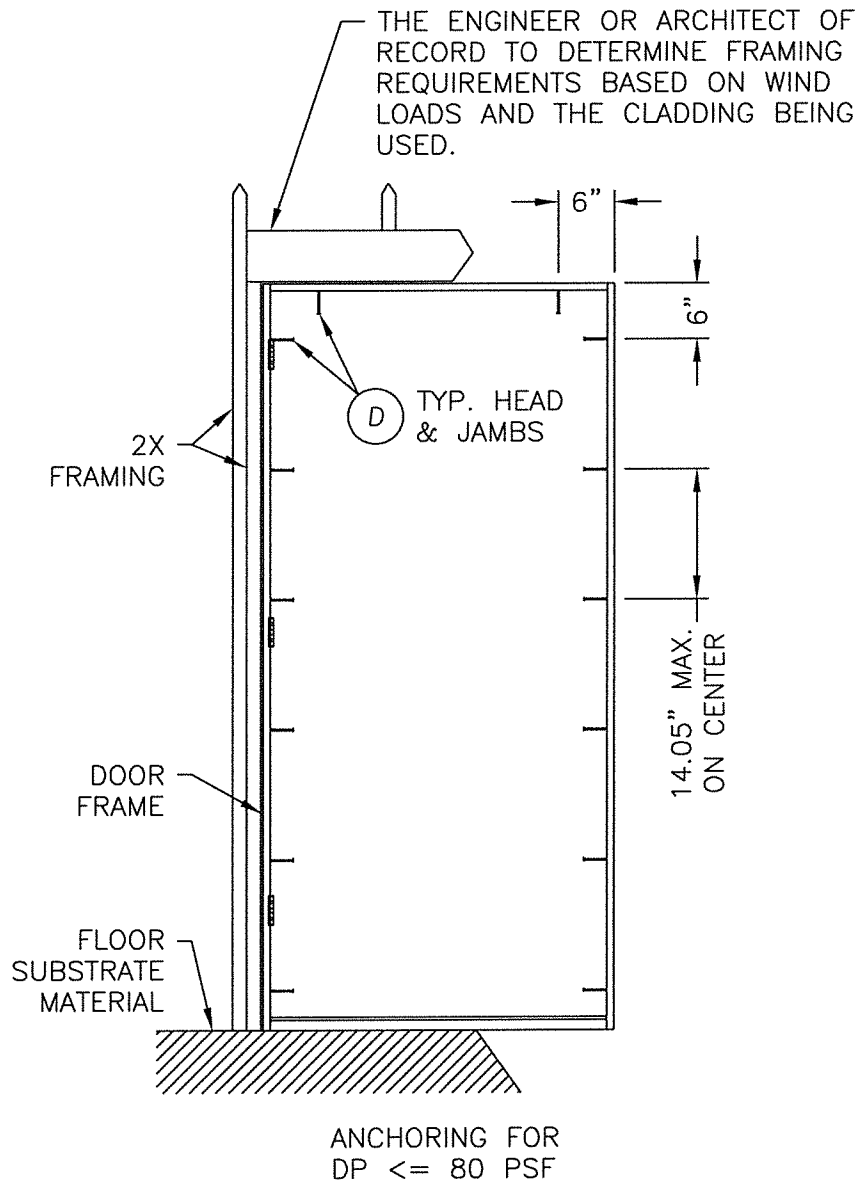

Documents Prepared By: Lyndon F. Schmidt, P.E.
TEXAS P.E. #104123

R.W. BUILDING CONSULTANTS, INC.
P.O. Box 230 Vairico FL 33595
Phone No.: 813.659.9197

TEXAS BOARD OF PROFESSIONAL ENGINEERS
CERTIFICATE OF REGISTRATION # F-11852

PRODUCT: SINGLE OPAQUE FIBERGLASS DOOR "IMPACT" INSWING / OUTSWING PART OR ASSEMBLY: FRAME ANCHORING

NO.	DATE	REVISIONS
2	5/06/20	UPDATE TO 2018 IBC/IRC CODE
1	7/16/15	ADDED GENERAL NOTE 5.
		LFS
		BY

DATE: 07/17/12

SCALE: N.T.S.

DWG. BY: JK

CHK. BY: LFS

DRAWING NO.: TX-4185

SHEET 8 OF 9

R:\Clients\Therma Tru PERMANENT\B - Texas Dept of Ins\TDI - DR 276 - 68 Opaque FG Imp IS - OS 5gls Dbls w-wo Non-imp SLV - Drawings\Current\TX-4184-89.dwg, FX9

BILL OF MATERIALS		
ITEM	DESCRIPTION	MATERIAL
B	2X FRAMING (G >= 0.42)	WOOD
C	1/4" MAX. SHIM SPACE	WOOD
D	#10 X 2-1/2" PFH WOOD SCREW	STEEL
G	KWIKSET 200 SERIES PASSAGE LOCK	STEEL
H	KWIKSET 600 SERIES DEADBOLT	STEEL
1	INSWING ADJUSTABLE THRESHOLD (IS300AJ)	ALUM./WOOD
2	INSWING THRESHOLD (IS300HP5)	-
3	INSWING SELF ADJUST THERMAL BREAK THRESHOLD (ISP30M)	ALUM./COMP.
4	OUTSWING COASTAL THRESHOLD	ALUM./WOOD
5	OUTSWING STANDARD THRESHOLD	ALUM./WOOD
7	DOOR BOTTOM SWEEP	VINYL
8	JAMB (PINE)	WOOD
9	JAMB (OAK)	WOOD
10	HINGE STILE (SMOOTH STAR)	WOOD
11	LOCK STILE (SMOOTH STAR)	LVL/WOOD
12	TOP RAIL (SMOOTH STAR)	PVC
13	BOTTOM RAIL (SMOOTH STAR)	PVC
14	PANEL REINFORCEMENT 0.023" THK. (SMOOTH STAR)	STEEL
15	DOOR SKIN 0.070" THK. (SMOOTH STAR) Fy = 6,000 PSI MIN.	FIBERGLASS
16	HINGE STILE (CLASSIC CRAFT)	WOOD/LVL
17	LOCK STILE (CLASSIC CRAFT)	WOOD/LVL
18	TOP RAIL (CLASSIC CRAFT)	PVC
19	BOTTOM RAIL (CLASSIC CRAFT)	PVC
20	PANEL REINFORCEMENT 0.023" THK. (CLASSIC CRAFT)	STEEL
21	DOOR SKIN 0.090" THK. (CLASSIC CRAFT) Fy = 6,000 PSI MIN.	FIBERGLASS
22	LOCK & HINGE STILE (CLASSIC CRAFT RUSTIC)	WOOD/LVL
23	TOP RAIL (CLASSIC CRAFT RUSTIC)	WOOD
24	BOTTOM RAIL (CLASSIC CRAFT RUSTIC)	PVC
25	PANEL REINFORCEMENT 0.023" THK. (CLASSIC CRAFT RUSTIC)	STEEL
26	DOOR SKIN 0.090" THK. (CC RUSTIC) Fy = 6,000 PSI MIN.	FIBERGLASS
27	FOAM CORE	POLYURETHANE
28	WEATHERSTRIP	FOAM
29	HINGE	STEEL
30	#10 X 2-1/2" PFH SCREW	STEEL
31	#10 X 3/4" PFH SCREW	STEEL
32	#9 X 3" PFH WOOD SCREW	STEEL
33	LATCH STRIKE PLATE	STEEL
34	SECURITY STRIKE PLATE (SINGLE DOOR ONLY)	STEEL
35	#8 X 3" PFH SCREW	STEEL
36	#8 X 3" PFH SCREW	STEEL
37	DEADBOLT STRIKE PLATE	STEEL
52	DOOR BOTTOM SWEEP	VINYL
60	HINGE STILE (FIBER CLASSIC)	WOOD
61	LOCK STILE (FIBER CLASSIC)	LVL/WOOD
62	TOP RAIL (FIBER CLASSIC)	PVC
63	BOTTOM RAIL (FIBER CLASSIC)	PVC
64	PANEL REINFORCEMENT 0.023" THK. (FIBER CLASSIC)	STEEL
65	DOOR SKIN 0.072" THK. (FIBER CLASSIC) Fy = 6,000 PSI MIN.	FIBERGLASS

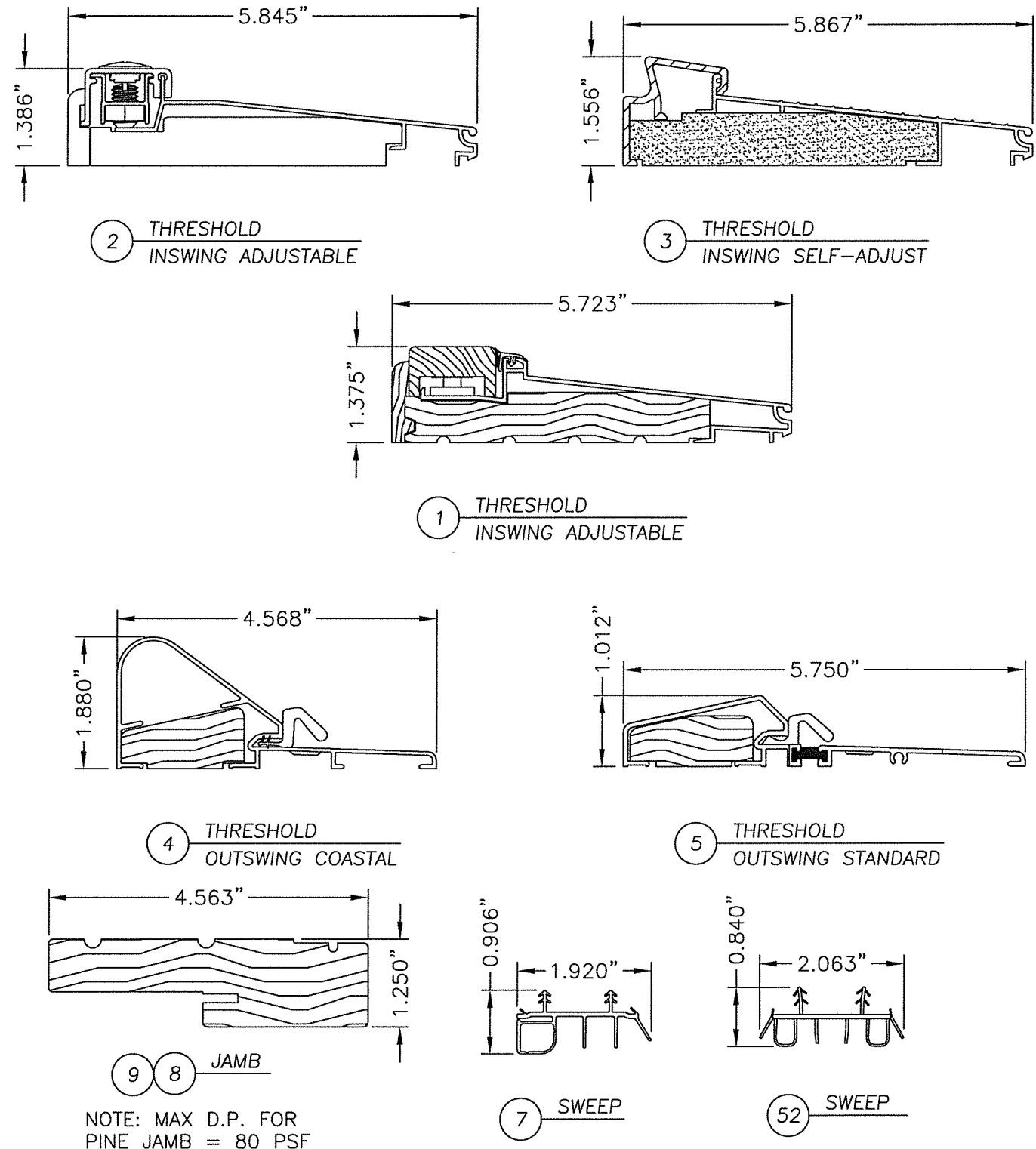

NOTE: MAX D.P. FOR PINE JAMB = 80 PSF

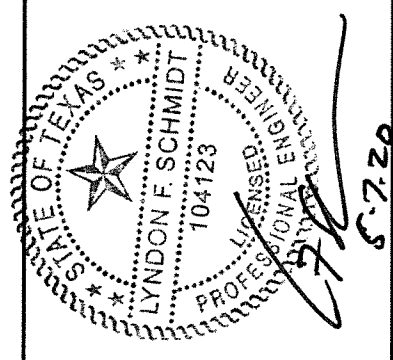

Documents Prepared By: Lyndon F. Schmidt, P.E. TEXAS P.E. #104123
 R.W. BUILDING CONSULTANTS, INC.
 P.O. Box 230 Valrico FL 33595
 Phone No.: 813.659.9197
 TEXAS BOARD OF PROFESSIONAL ENGINEERS
 CERTIFICATE OF REGISTRATION # F-11852

PRODUCT: SINGLE OPAQUE FIBERGLASS DOOR
 "IMPACT" INSWING / OUTSWING
 PART OR ASSEMBLY:
 BILL OF MATERIALS & COMPONENTS

NO.	DATE	BY
2	5/06/20	LFS
1	7/16/15	LFS

DATE: 07/17/12
 SCALE: N.T.S.
 DWG. BY: JK
 CHK. BY: LFS
 DRAWING NO.: TX-4185
 SHEET 9 OF 9

© 2012 R.W. BUILDING CONSULTANTS INC.