

NOTES:

1. Installations depicted satisfy the requirements of the 2018 International Building Code for design wind pressures and overall sizes noted.
2. Wood bucks, wood framing, steel stud framing, concrete and concrete masonry are by others and shall be designed by the architect or engineer of record to resist the loads imparted to them.
3. Wood buck strips and wood frames are assumed S-P-F (G=0.42) or denser. Buck width shall be greater than the frame width. Tapered or partial width buck strips are not allowed.
4. Concrete masonry installations are assumed at least ASTM C90 normal weight hollow masonry units with a 1-1/4" wall thickness or normal weight concrete with a minimum compressive strength of $f'_c = 3,000$ psi.
5. Metal stud frames are assumed to be a minimum 18 gauge 33 KSI steel.
6. Wood screws shall be corrosion resistant and meet the requirements of ANSI/ASME B18.6.1
7. Tapcon masonry anchors shall have a minimum embedment of 1-1/2" or full penetration of concrete masonry unit shell. They shall also have a minimum of 2" edge distance. Install concrete masonry anchors per manufacturer's installation instructions.
8. TEKS screws shall be corrosion resistant and shall be ASTM A510 Grade 1018 or equivalent.
9. Maximum permitted shim thickness is 1/4". Shims shall be non-compressible and load bearing type. Every through-frame fastener shall have a shim.
10. Products are not impact resistant and require approved protection devices if used in wind-borne debris regions.

CONTENTS:

Sheets 1-2	Elevations and Notes
Sheet 3	Fin Install to Wood
Sheet 4	Fin Install to Steel Stud
Sheet 5	Frame Install to Wood
Sheet 6	Frame Install to Steel Stud
Sheets 7-8	Frame Install to Concrete or CMU
Sheet 9	Strap Install to Wood
Sheet 10	Strap Install to Steel Stud
Sheets 11-12	Strap Install to Concrete or CMU
Sheet 13	Glazing Details
Sheet 14	Accessories
Sheet 15	Sections and BOM
Sheet 16	Components

FOR 144" X 82" DOORS
 PANEL SIZE: 48-3/4" X 77-1/2"
 DLO: 42-1/8" X 71"
 GLAZING: INSULATING GLASS; TWO (2) 1/8" TEMPERED GLASS
 OR
 INSULATING GLASS; 1/8" TEMPERED GLASS (EXTERIOR)
 (2) 1/8" ANNEALED GLASS 0.030" PVB (INTERIOR)

△ ANCHOR - SEE SHEET 3 TO SHEET 12

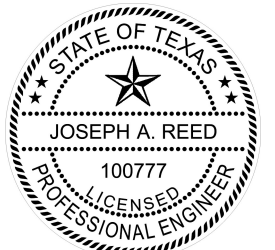

Joseph A. Reed, PE
 TX PE 100777
 5 Leigh Dr.
 York, PA 17406
 717-846-1200
 Project 23550-1

Joseph A. Reed

2020.10.12 07:30:54 -04'00'

5400/5400S/7700/9900 SGD	
Non-Impact	
Elevations and Notes	
Wincore Windows & Doors	
250 Staunton Turnpike Parkersburg, WV 26104	
Drawing No.: 23550-8-1001	
Project No.: 23550-8	
Drawn By: JAR	Rev: - Date: 10/10/20
Scale: NTS	Sheet 1 of 16

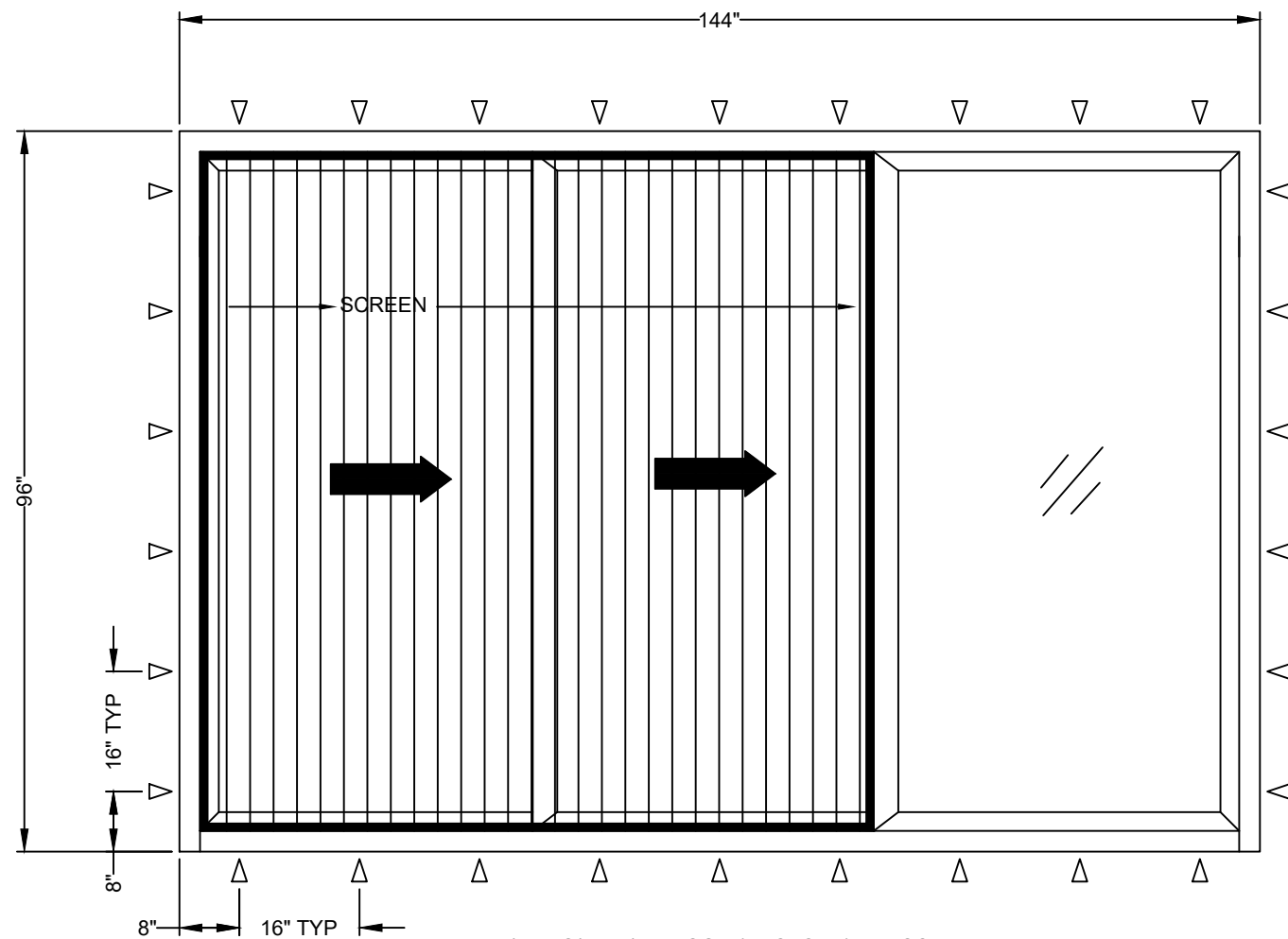

5400/5400S/7700/9900 SGD (XXO, OXX) with SCREEN
 Maximum Size: 144" x 96"
 Design Pressure: +40/-40 psf

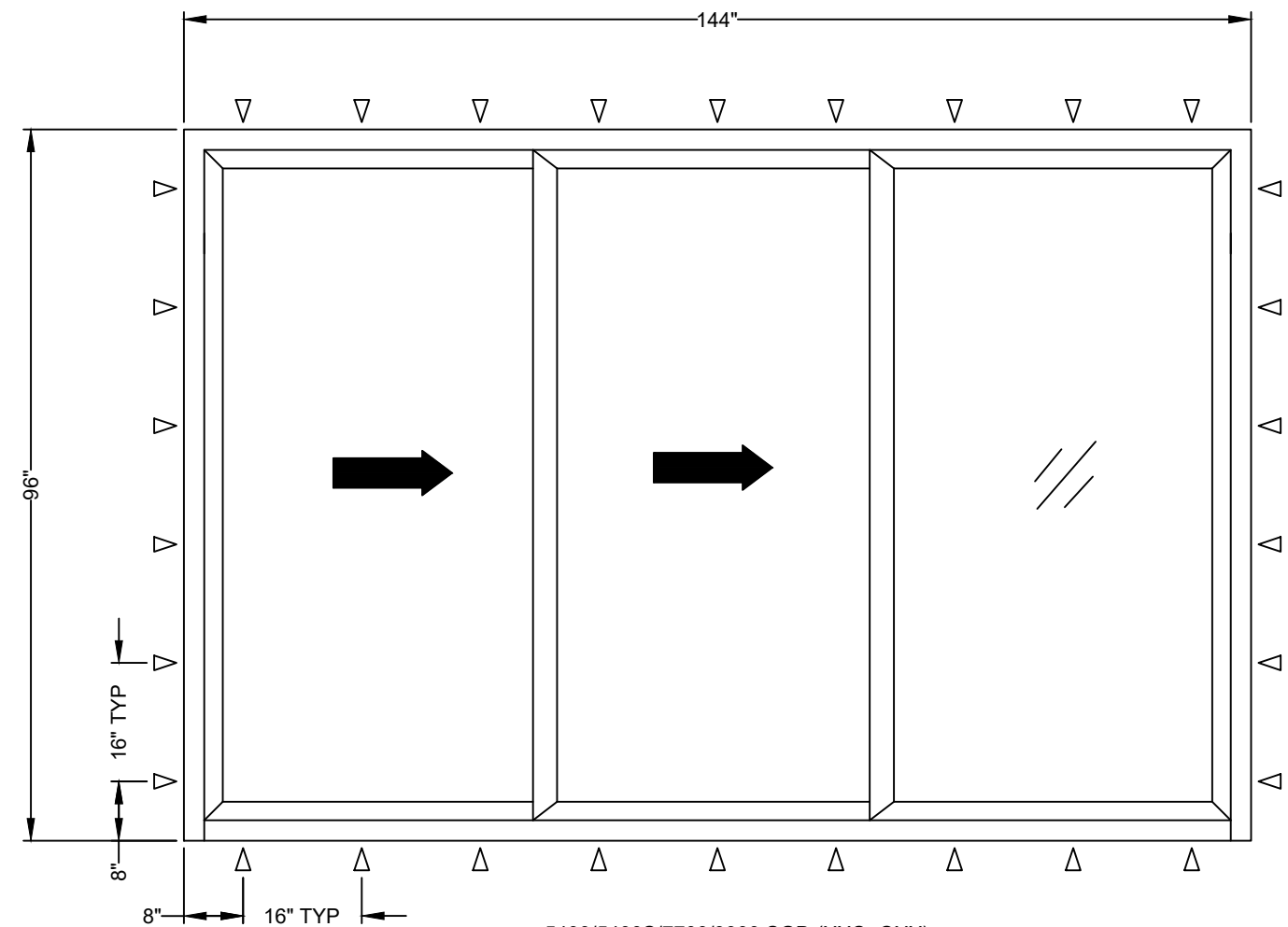

5400/5400S/7700/9900 SGD (XXO, OXX)
 Maximum Size: 144" x 96"
 Design Pressure: +40/-40 psf

△ ANCHOR - SEE SHEET 3 TO SHEET 12

FOR 144" X 96" DOORS
 PANEL SIZE: 48-3/4" X 91-1/4"
 DLO: 42-1/8" X 84-5/8"

GLAZING: INSULATING GLASS; TWO (2) 5/32" TEMPERED GLASS
 OR
 INSULATING GLASS; 5/32" TEMPERED GLASS (EXTERIOR)
 (2) 1/8" ANNEALED GLASS 0.030" PVB (INTERIOR)

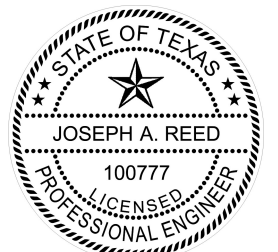

Joseph A. Reed, PE
 TX PE 100777
 5 Leigh Dr.
 York, PA 17406
 717-846-1200
 Project 23550-1

Joseph A. Reed

2020.10.12 07:30:54 -04'00'

5400/5400S/7700/9900 SGD	
Non-Impact	
Elevations and Notes	
Wincore Windows & Doors	
250 Staunton Turnpike Parkersburg, WV 26104	
Drawing No.: 23550-8-1001	
Project No.: 23550-8	
Drawn By: JAR Rev: - Date: 10/10/20	
Scale: NTS	Sheet 2 of 16

HEAD

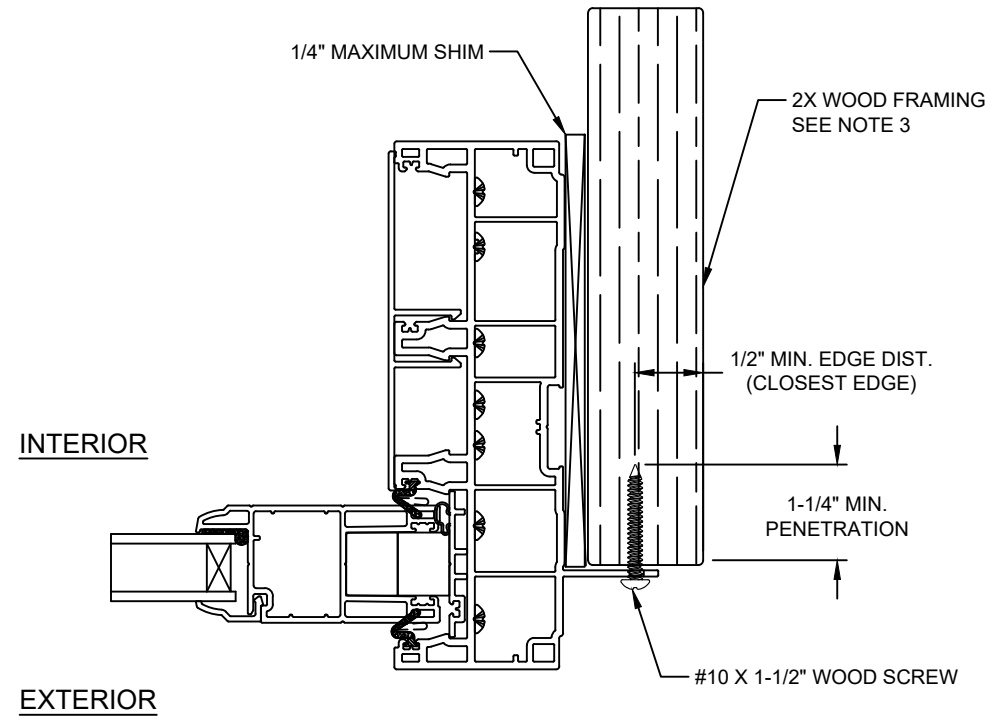
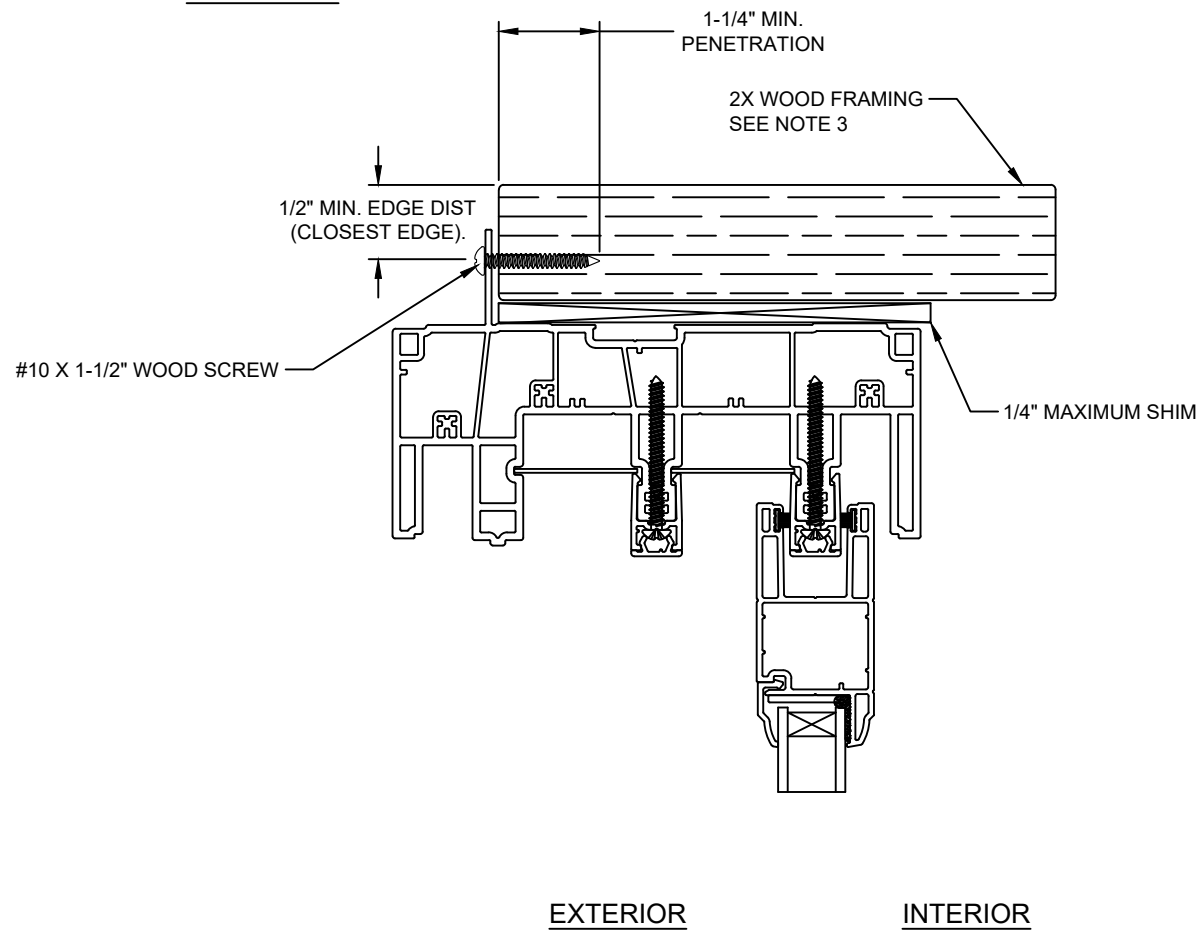

JAMB

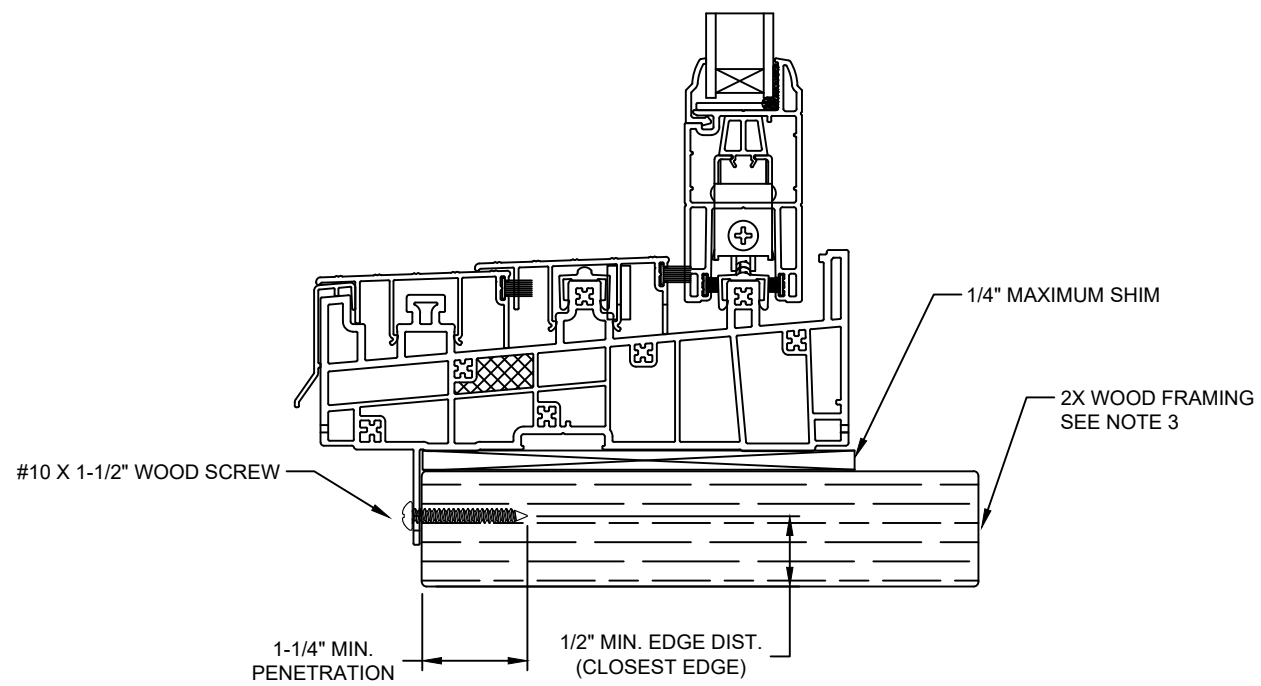

SILL

NOTE:
 IF SILL INSTALLED FINLESS TO WOOD, SEE SHEETS 5 AND 9
 IF SILL INSTALLED FINLESS TO STEEL STUD, SEE SHEETS 6 AND 10
 IF SILL INSTALLED FINLESS TO CONCRETE, SEE SHEETS 7, 8, 11 AND 12

Note:
 Waterproofing and interior finishes by others. Not shown for clarity.

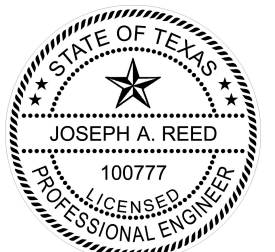

Joseph A. Reed, PE
 TX PE 100777
 5 Leigh Dr.
 York, PA 17406
 717-846-1200
 Project 23550-1

Joseph A. Reed

2020.10.12 07:30:54 -04'00'

5400/5400S/7700/9900 SGD Non-Impact Fin Install to Wood	
Wincore Windows & Doors 250 Staunton Turnpike Parkersburg, WV 26104	
Drawing No.: 23550-8-1001 Project No.: 23550-8 Drawn By: JAR Rev: - Date: 10/10/20	
Scale: NTS	Sheet 3 of 16

HEAD

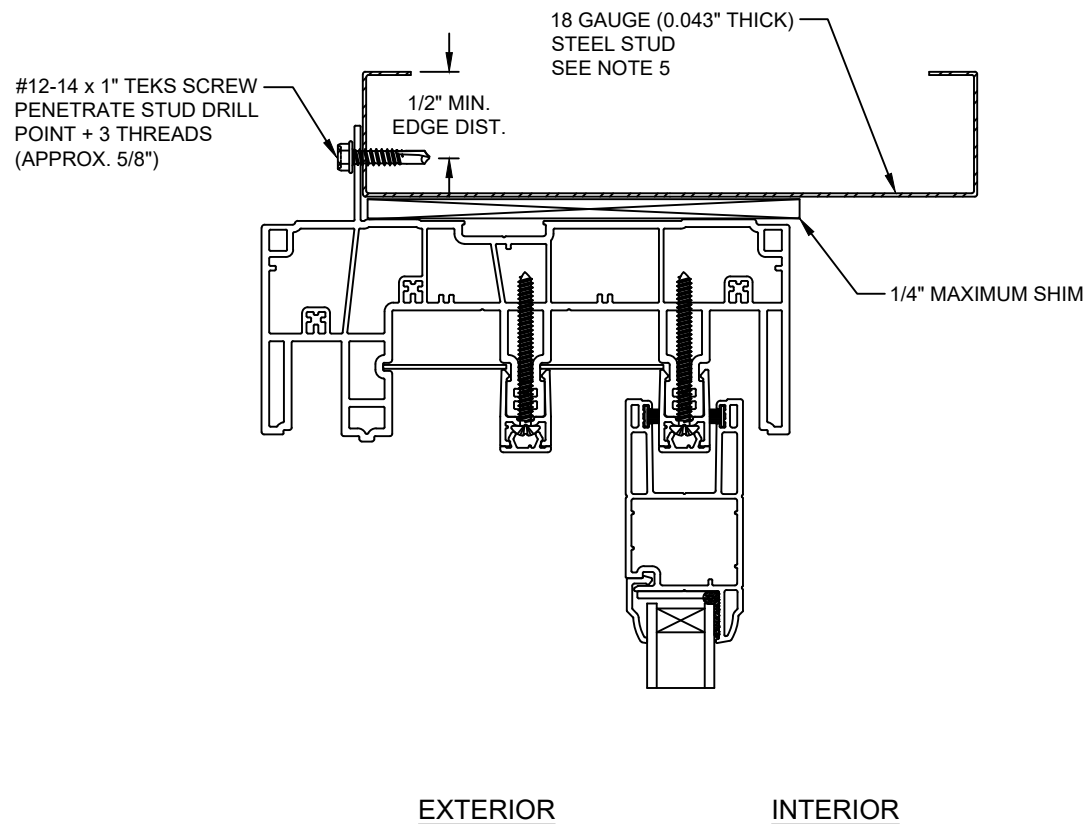

Note:
Waterproofing and interior finishes by others. Not shown for clarity.

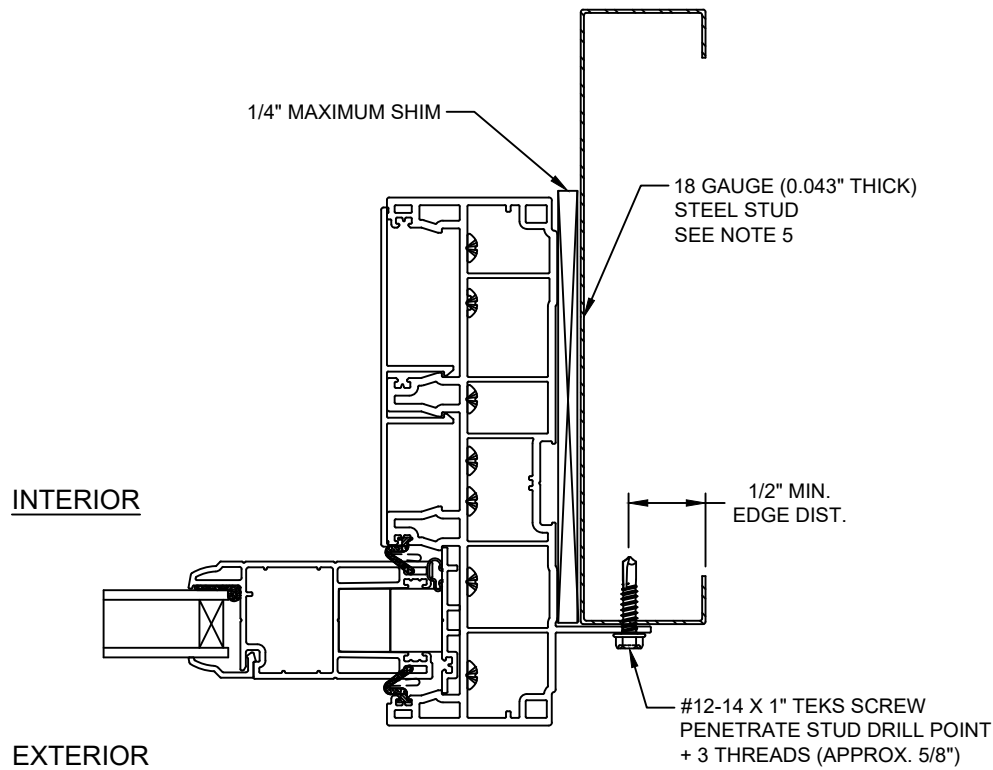

JAMB

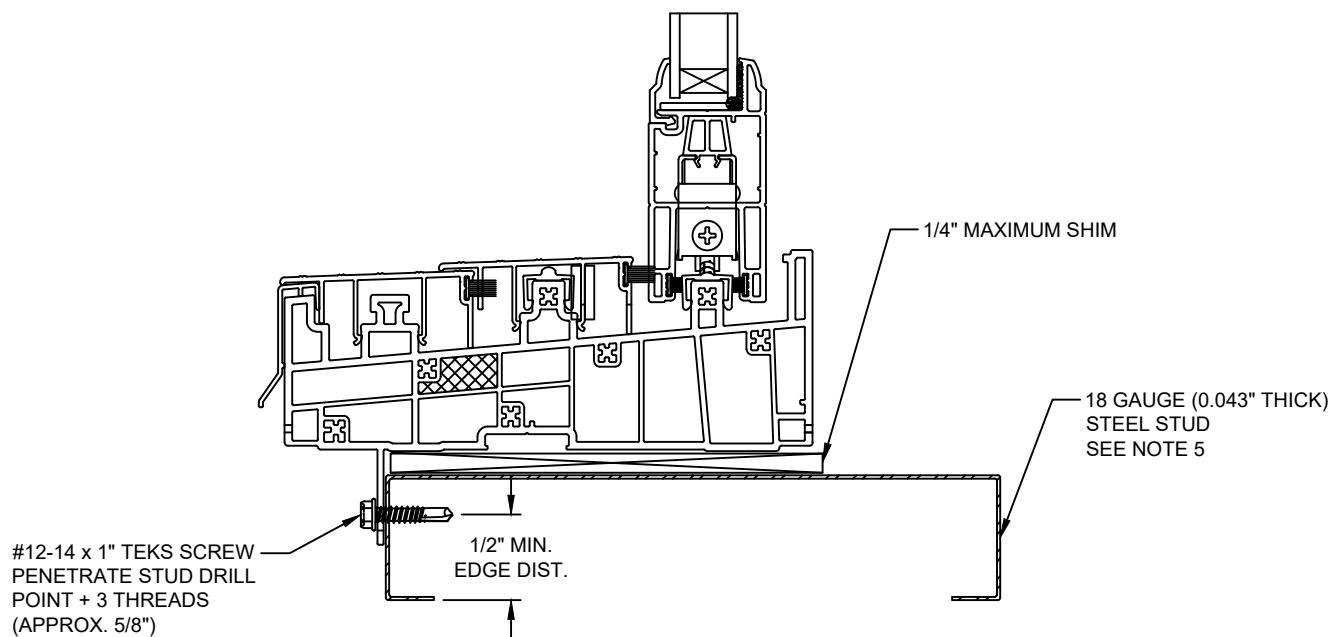

SILL

NOTE:
IF SILL INSTALLED FINLESS TO WOOD, SEE SHEETS 5 AND 9
IF SILL INSTALLED FINLESS TO STEEL STUD, SEE SHEETS 6 AND 10
IF SILL INSTALLED FINLESS TO CONCRETE, SEE SHEETS 7, 8, 11 AND 12

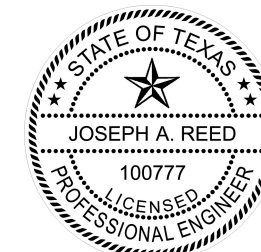

Joseph A. Reed, PE
TX PE 100777
5 Leigh Dr.
York, PA 17406
717-846-1200
Project 23550-1

Joseph A. Reed

2020.10.12 07:30:54 -04'00'

5400/5400S/7700/9900 SGD Non-Impact Fin Install to Steel Stud	
Wincore Windows & Doors 250 Staunton Turnpike Parkersburg, WV 26104	
Drawing No.: 23550-8-1001 Project No.: 23550-8 Drawn By: JAR Rev: - Date: 10/10/20	
Scale: NTS	Sheet 4 of 16

HEAD

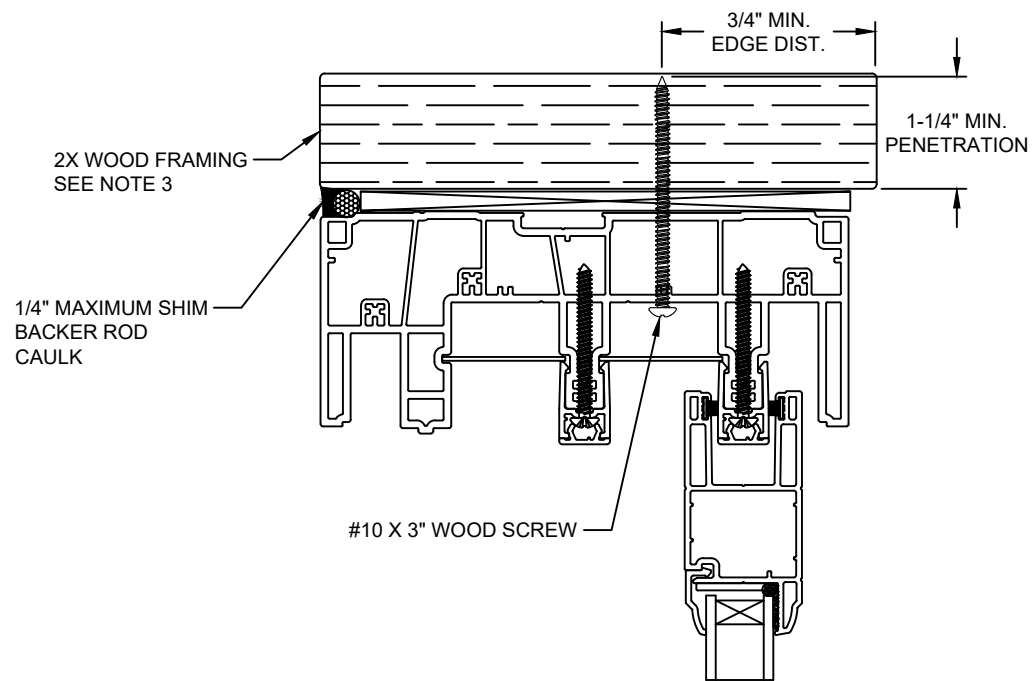

EXTERIOR

INTERIOR

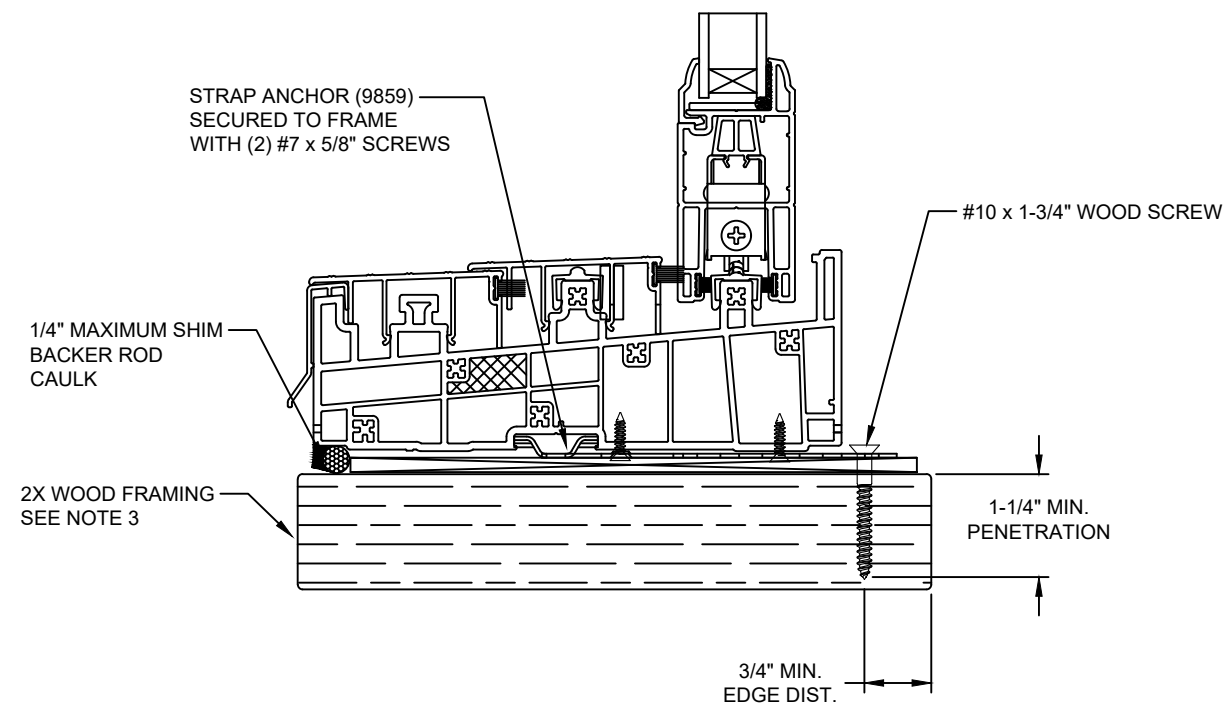

SILL

NOTE:
IF SILL INSTALLED TO STEEL STUD, SEE SHEETS 6 AND 10
IF SILL INSTALLED TO CONCRETE, SEE SHEETS 7, 8, 11 AND 12

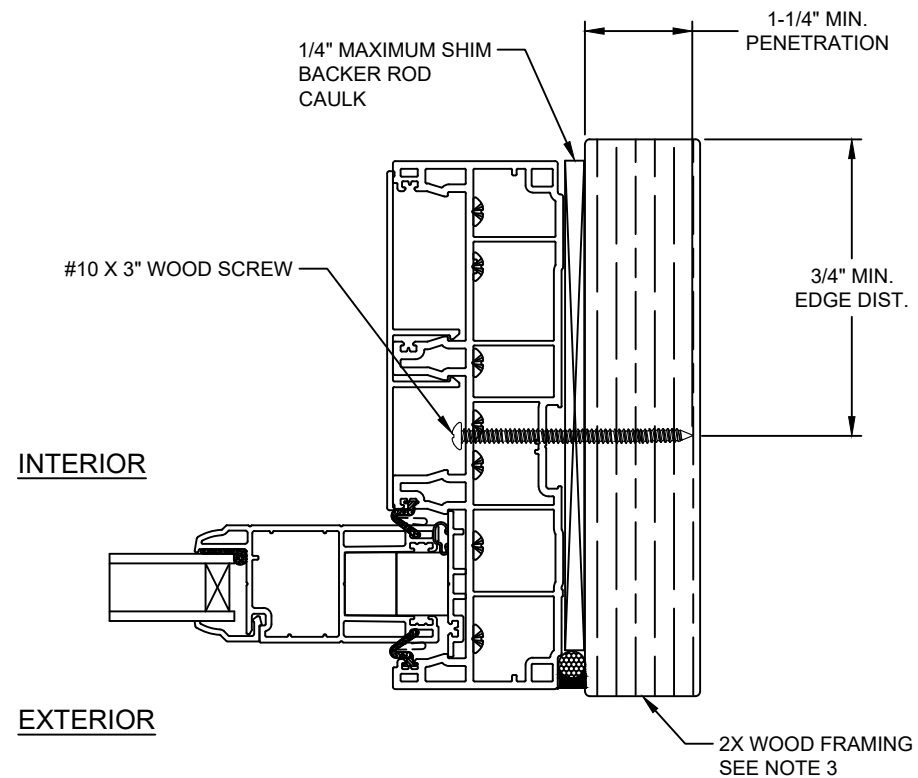

JAMB

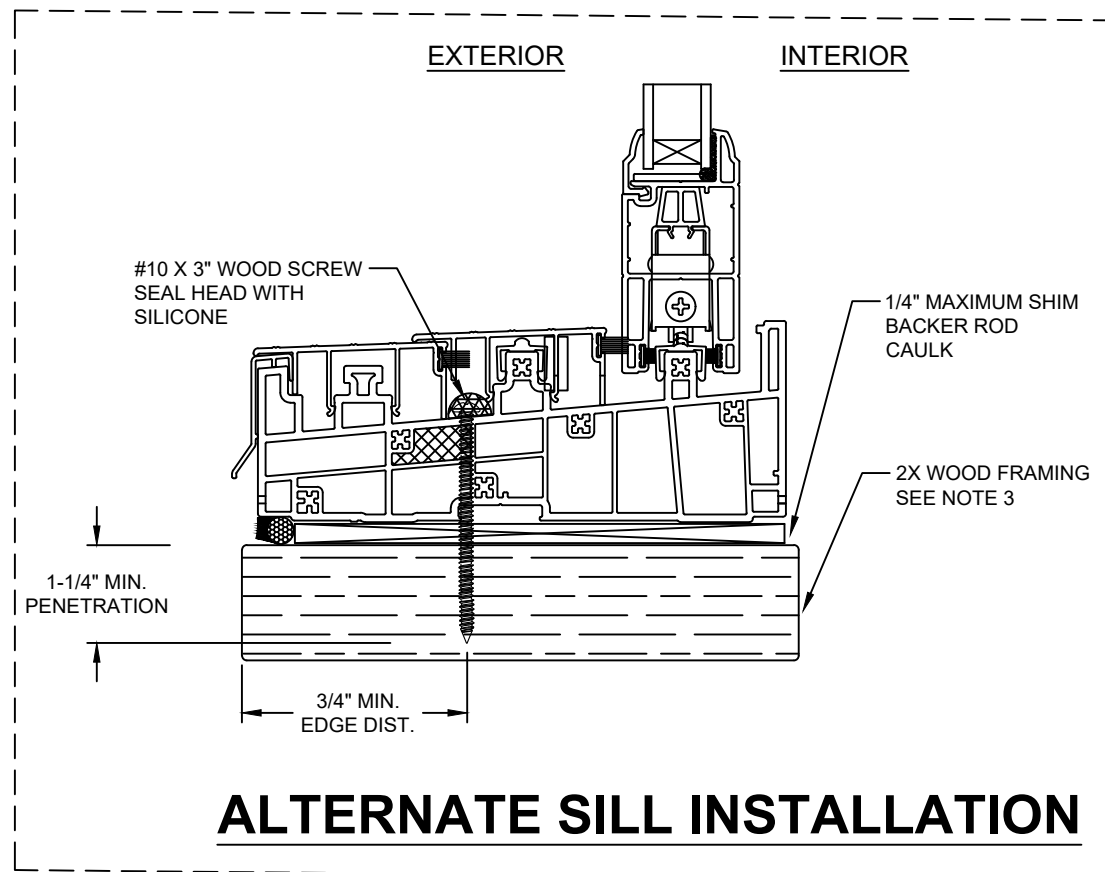

ALTERNATE SILL INSTALLATION

Note:
Waterproofing and interior finishes by others. Not shown for clarity.

Joseph A. Reed, PE
TX PE 100777
5 Leigh Dr.
York, PA 17406
717-846-1200
Project 23550-1

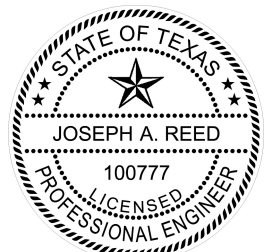

Joseph A. Reed

2020.10.12 07:30:54 -04'00'

5400/5400S/7700/9900 SGD
Non-Impact
Frame Install to Wood
Wincore Windows & Doors
250 Staunton Turnpike
Parkersburg, WV 26104

Drawing No.: 23550-8-1001
Project No.: 23550-8
Drawn By: JAR Rev: - Date: 10/10/20

Scale: NTS

Sheet 5 of 16

HEAD

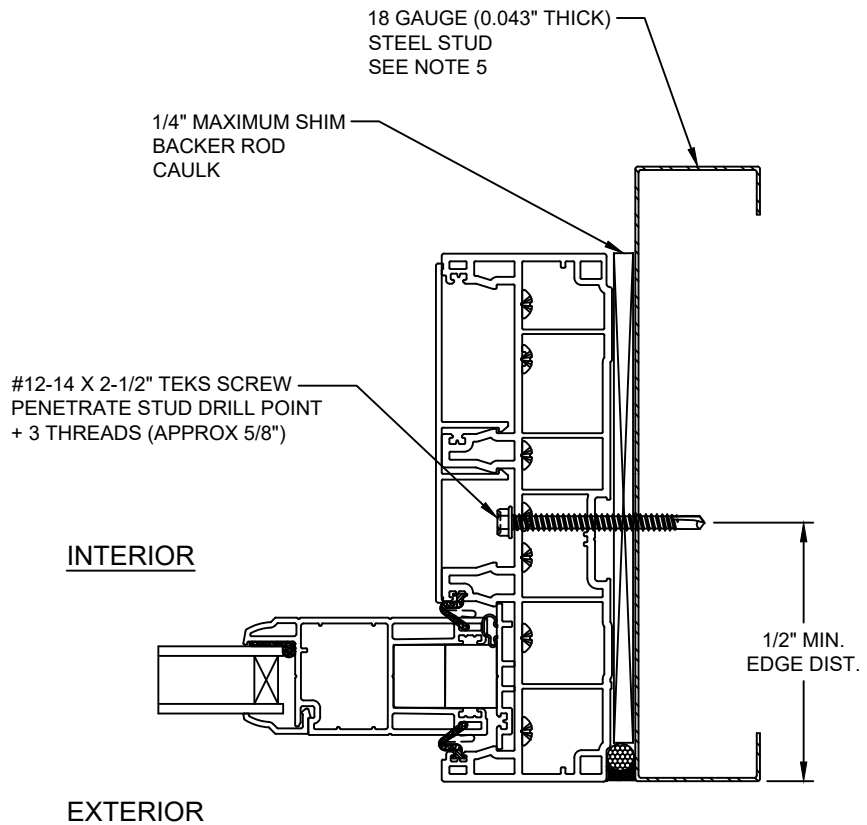
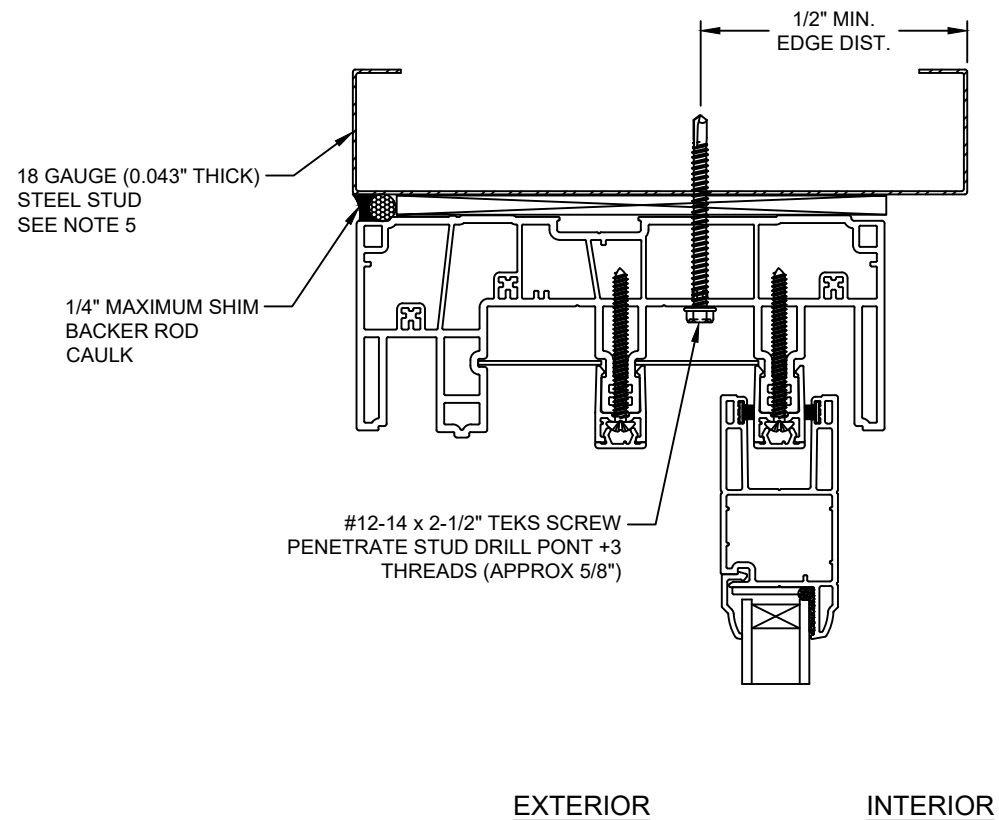

JAMB

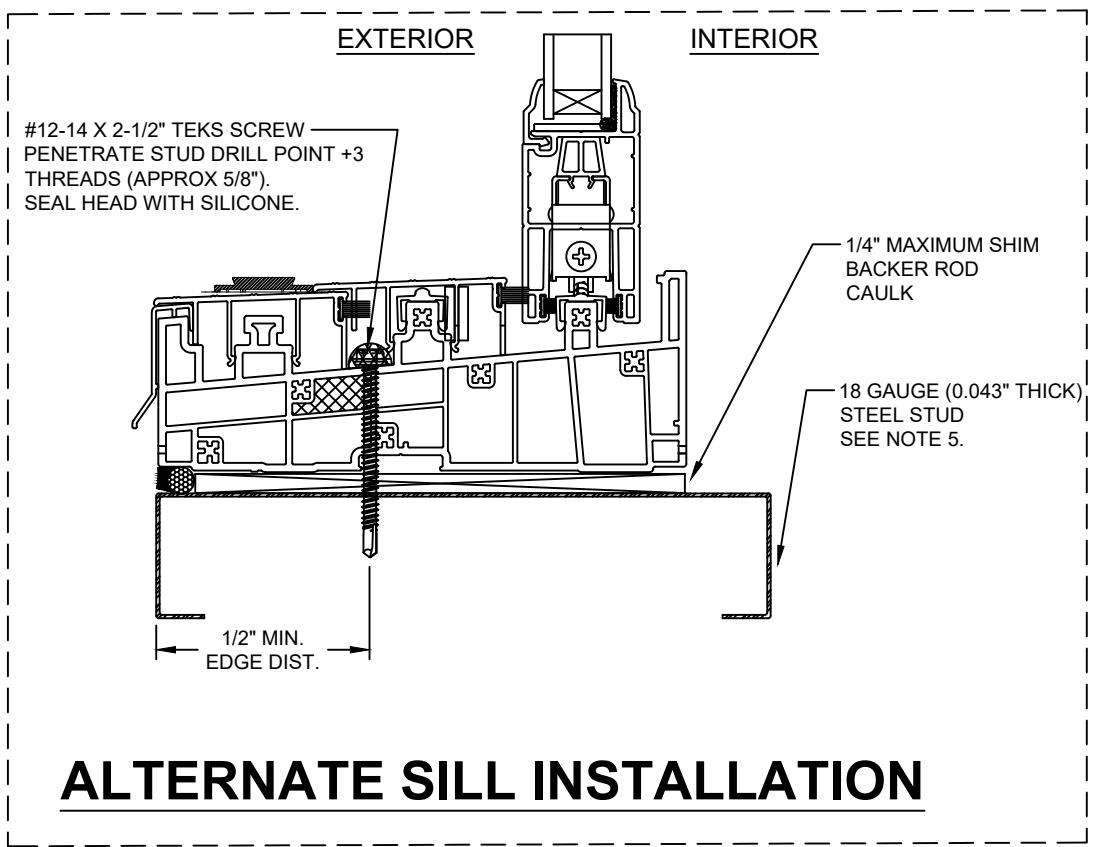
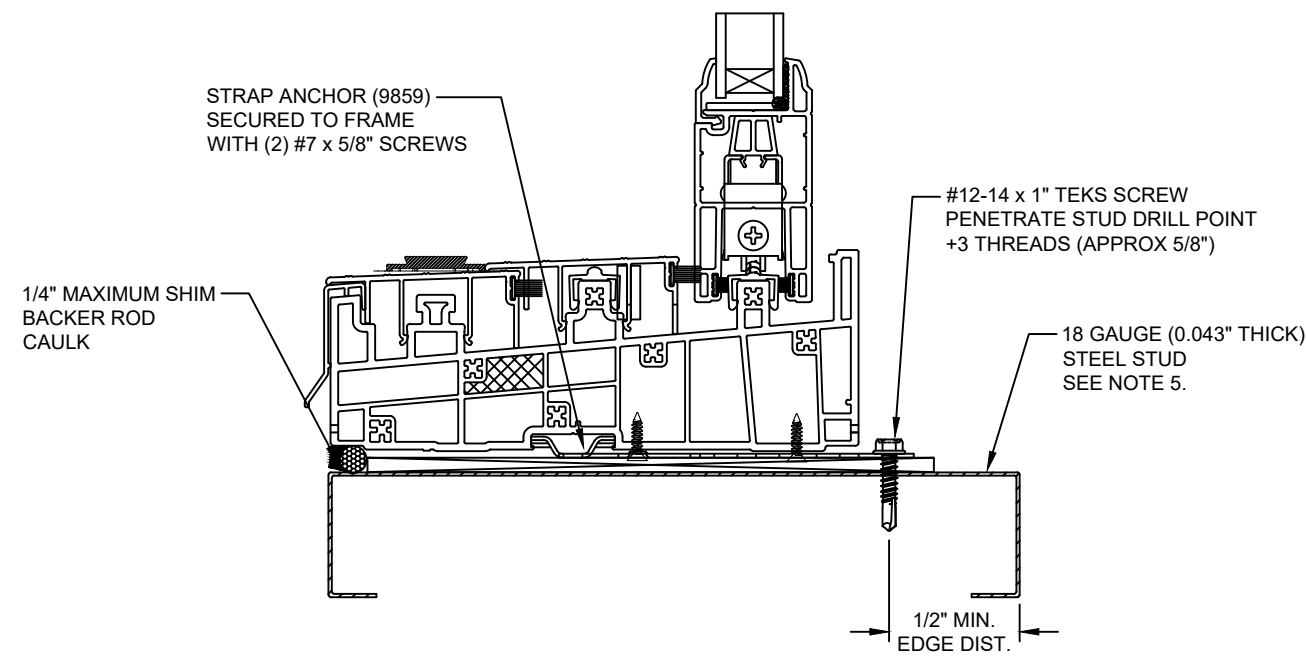

ALTERNATE SILL INSTALLATION

Note:
Waterproofing and interior finishes by others. Not shown for clarity.

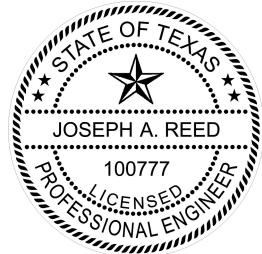

Joseph A. Reed, PE
TX PE 100777
5 Leigh Dr.
York, PA 17406
717-846-1200
Project 23550-1

Joseph A. Reed
2020.10.12 07:30:54 -04'00'

5400/5400S/7700/9900 SGD
Non-Impact
Frame Install to Steel Stud
Wincore Windows & Doors
250 Staunton Turnpike
Parkersburg, WV 26104

Drawing No.: 23550-8-1001
Project No.: 23550-8
Drawn By: JAR Rev: - Date: 10/10/20

Scale: NTS Sheet 6 of 16

SILL

NOTE:
IF SILL INSTALLED TO WOOD, SEE SHEETS 5 AND 9
IF SILL INSTALLED TO CONCRETE, SEE SHEETS 7, 8, 11 AND 12

HEAD

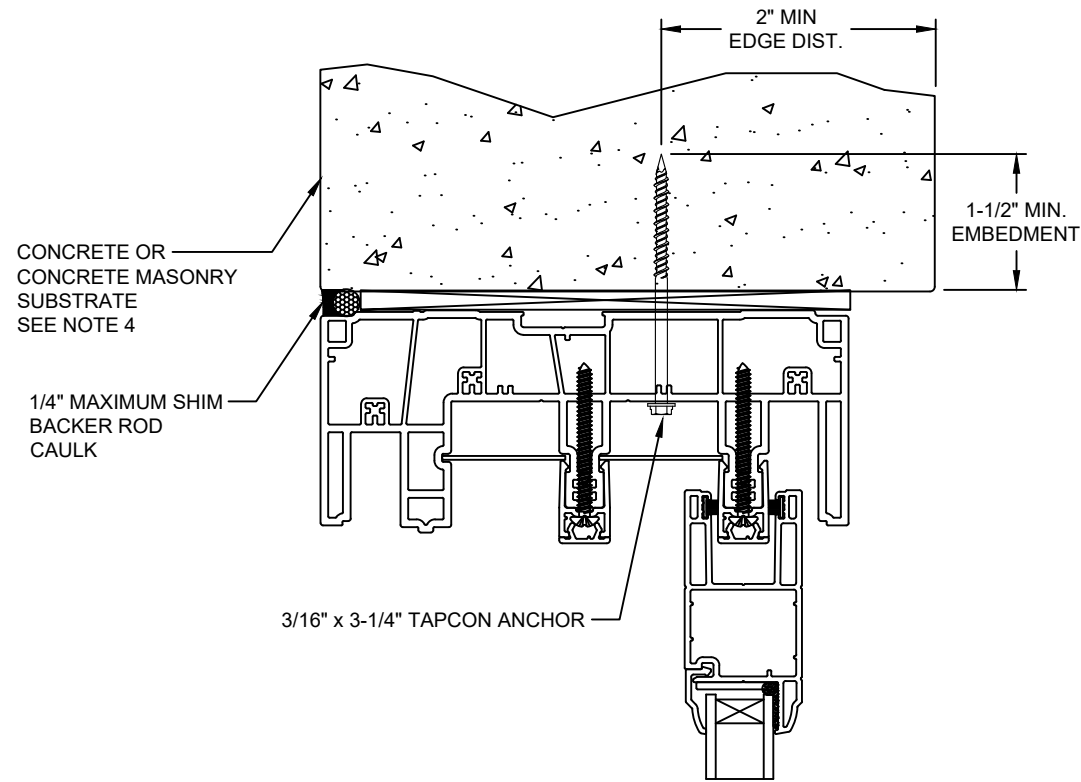

EXTERIOR

INTERIOR

Note:
Waterproofing and interior finishes by others. Not shown for clarity.

JAMB

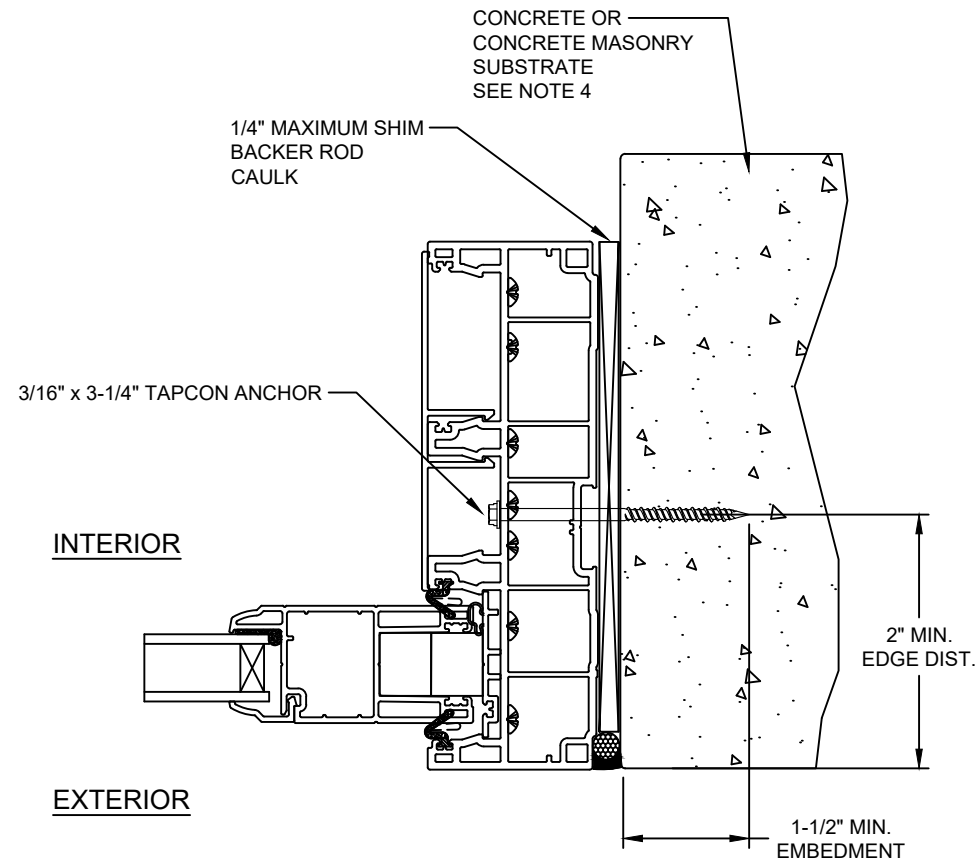

INTERIOR

EXTERIOR

EXTERIOR

INTERIOR

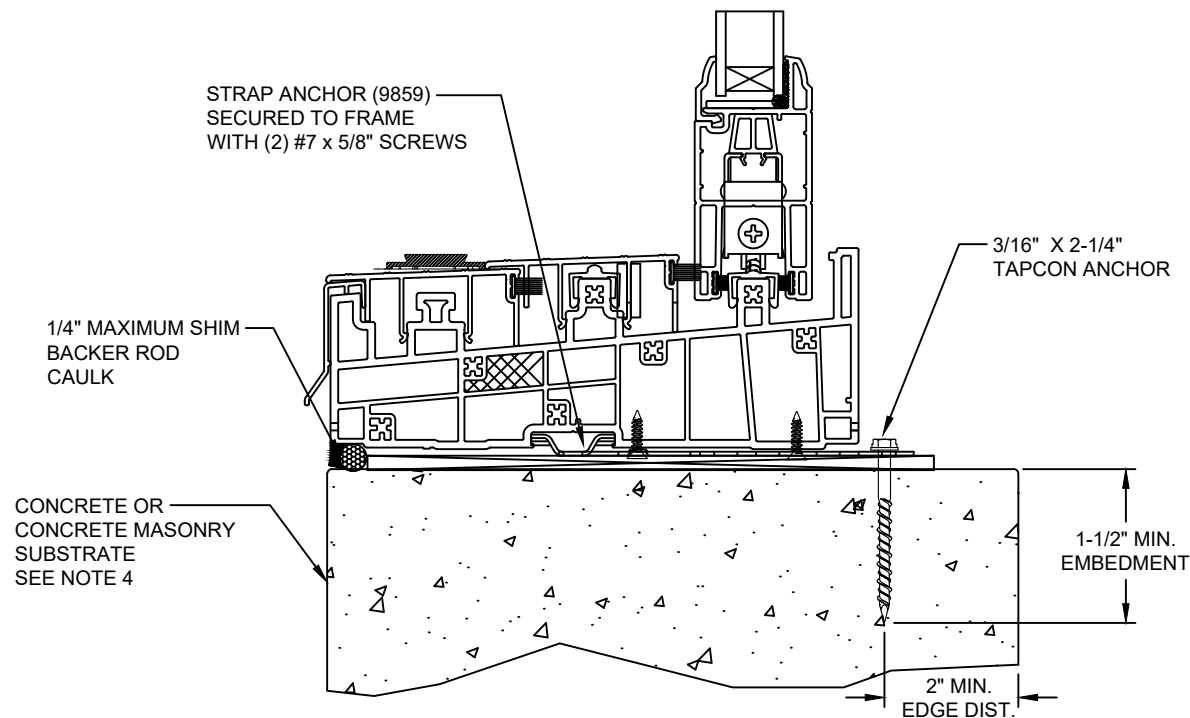

SILL

NOTE:
IF SILL INSTALLED TO WOOD, SEE SHEETS 5 AND 9
IF SILL INSTALLED TO STEEL STUD, SEE SHEETS 6 AND 10

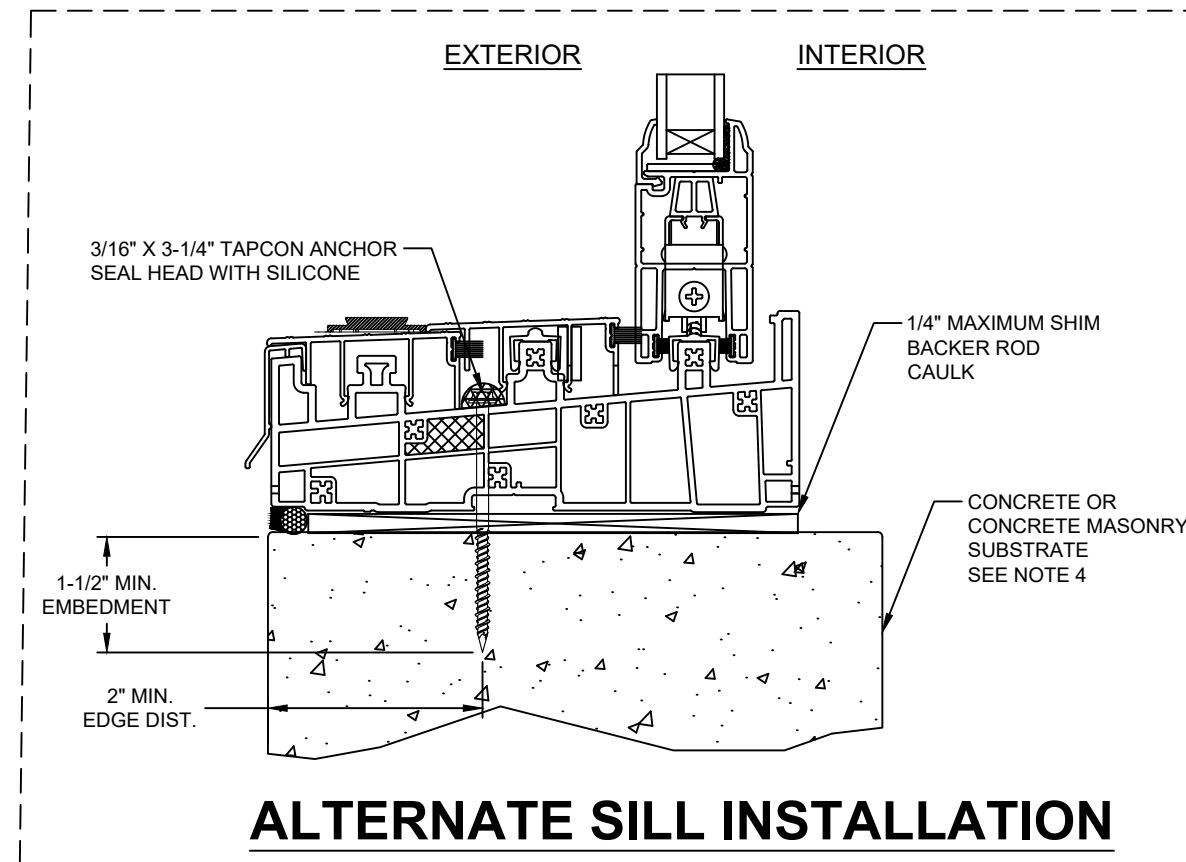

ALTERNATE SILL INSTALLATION

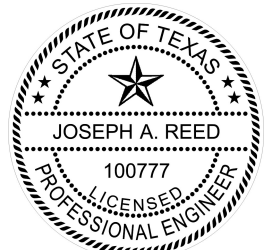

Joseph A. Reed, PE
TX PE 100777
5 Leigh Dr.
York, PA 17406
717-846-1200
Project 23550-1

Joseph A. Reed

2020.10.12 07:30:54 -04'00'

5400/5400S/7700/9900 SGD
Non-Impact
Frame Install to Concrete or CMU
Wincore Windows & Doors
250 Staunton Turnpike
Parkersburg, WV 26104

Drawing No.: 23550-8-1001
Project No.: 23550-8
Drawn By: JAR Rev: - Date: 10/10/20

Scale: NTS

Sheet 7 of 16

HEAD

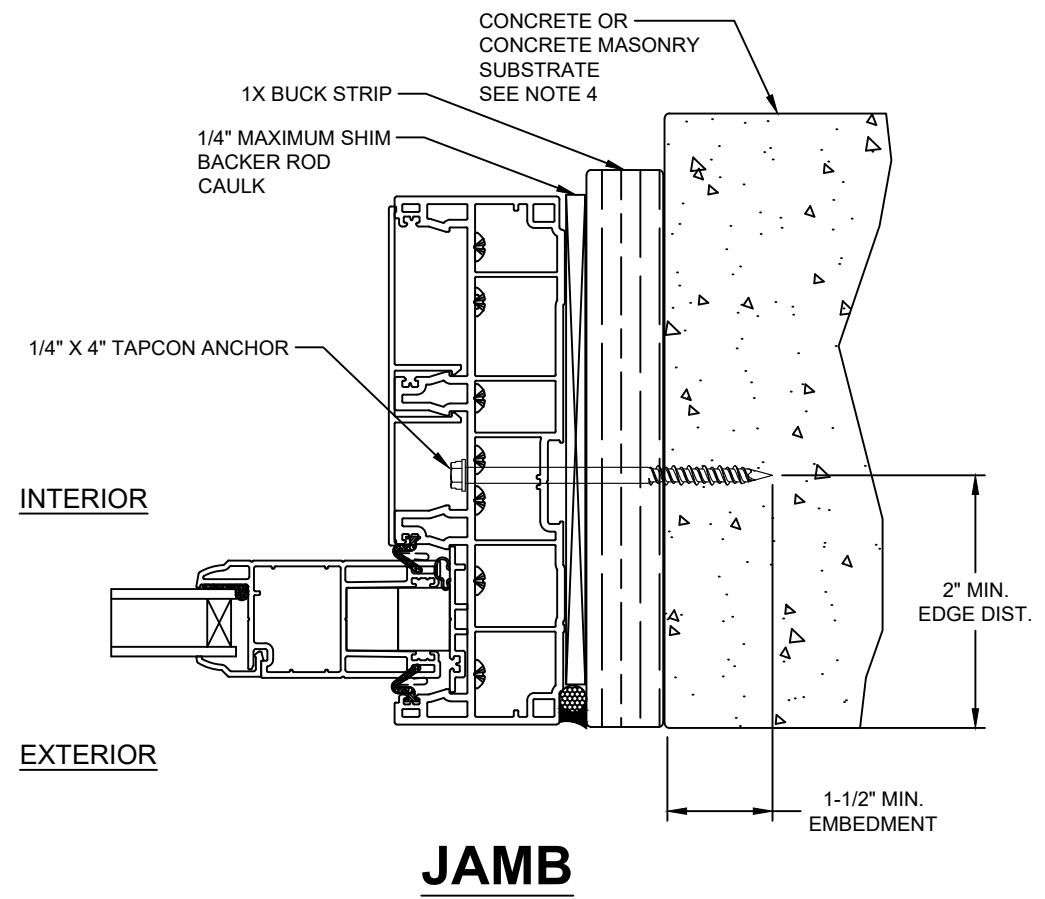
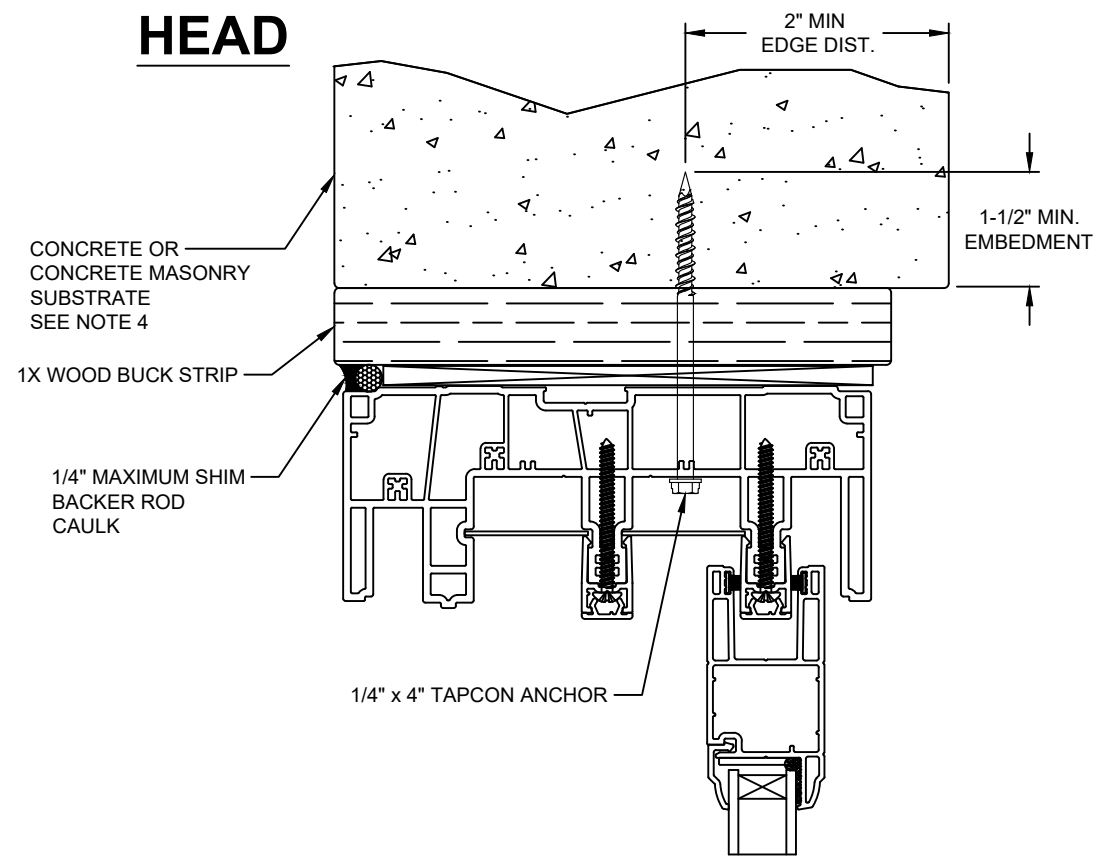

Note:
Waterproofing and interior finishes by others. Not shown for clarity.

EXTERIOR

INTERIOR

JAMB

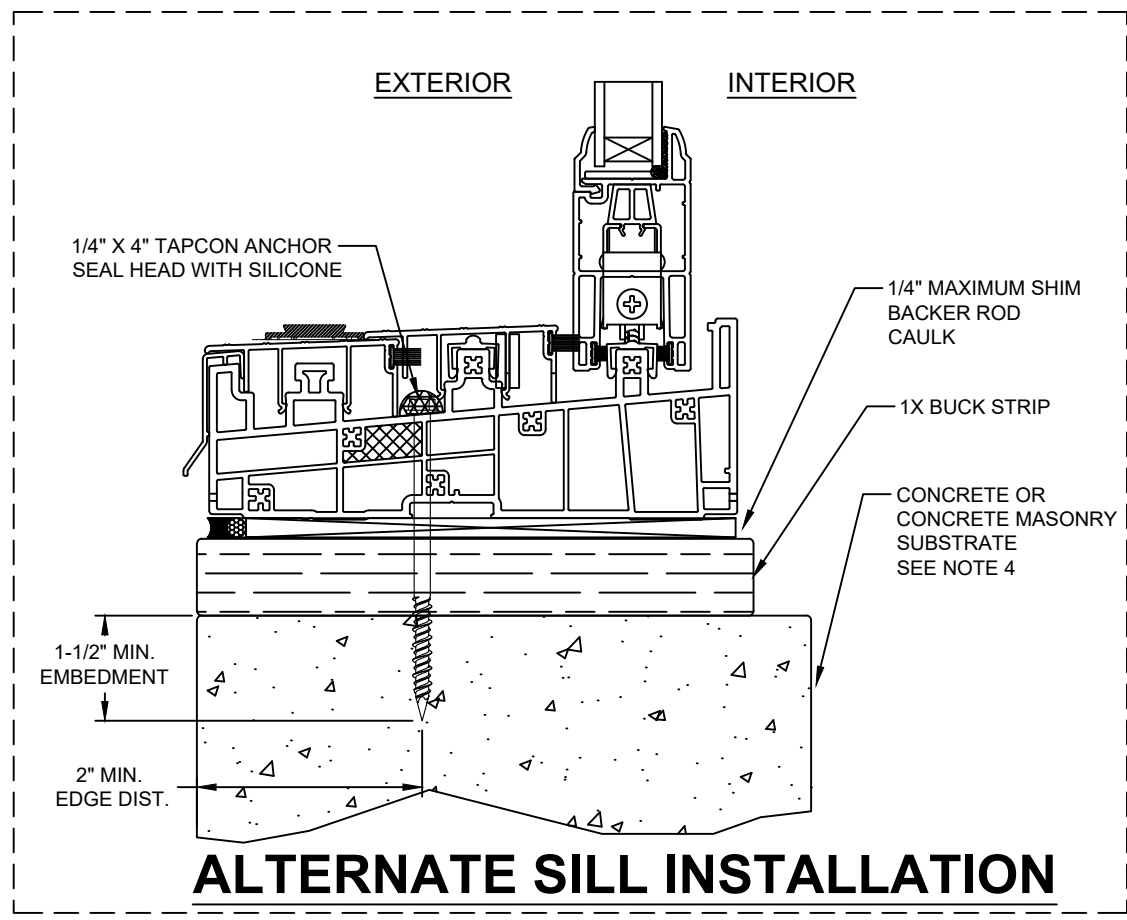

ALTERNATE SILL INSTALLATION

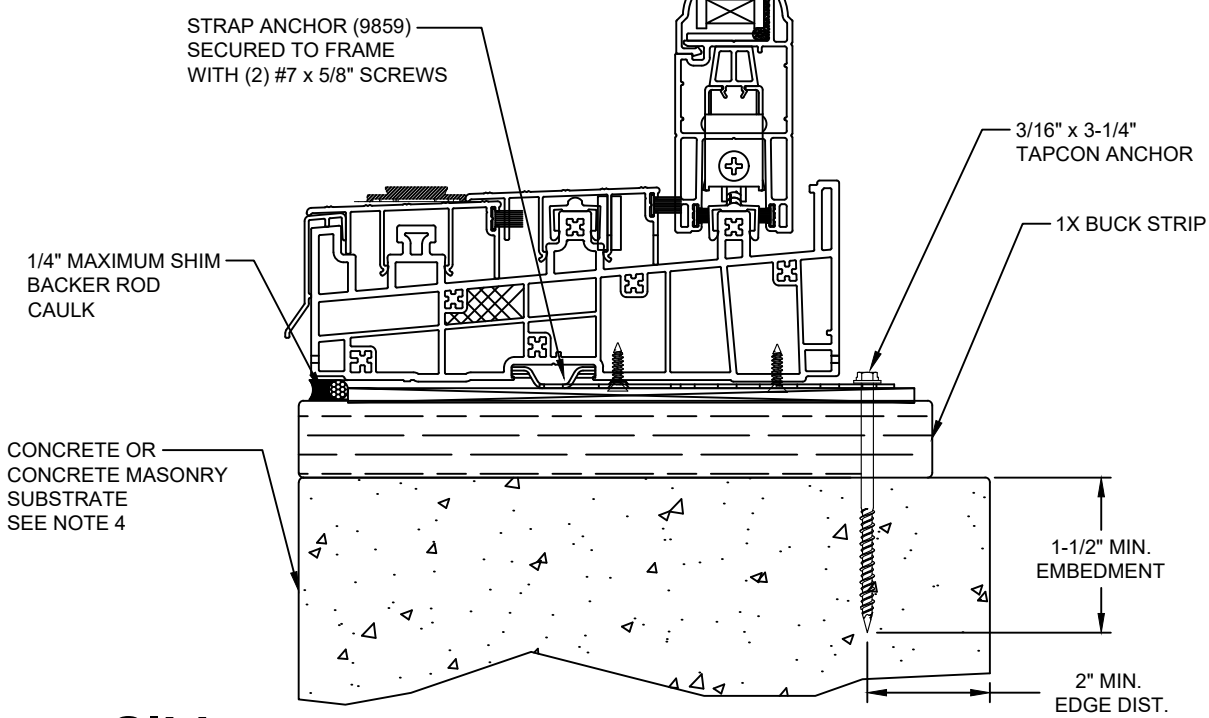

SILL

NOTE:
IF SILL INSTALLED TO WOOD, SEE SHEETS 5 AND 9
IF SILL INSTALLED TO STEEL STUD, SEE SHEETS 6 AND 10



Joseph A. Reed, PE
TX PE 100777
5 Leigh Dr.
York, PA 17406
717-846-1200
Project 23550-1

Joseph A. Reed

2020.10.12 07:30:54 -04'00'

5400/5400S/7700/9900 SGD
Non-Impact
Frame Install to Concrete or CMU
Wincore Windows & Doors
250 Staunton Turnpike
Parkersburg, WV 26104

Drawing No.: 23550-8-1001
Project No.: 23550-8
Drawn By: JAR Rev: - Date: 10/10/20

Scale: NTS

Sheet 8 of 16

HEAD

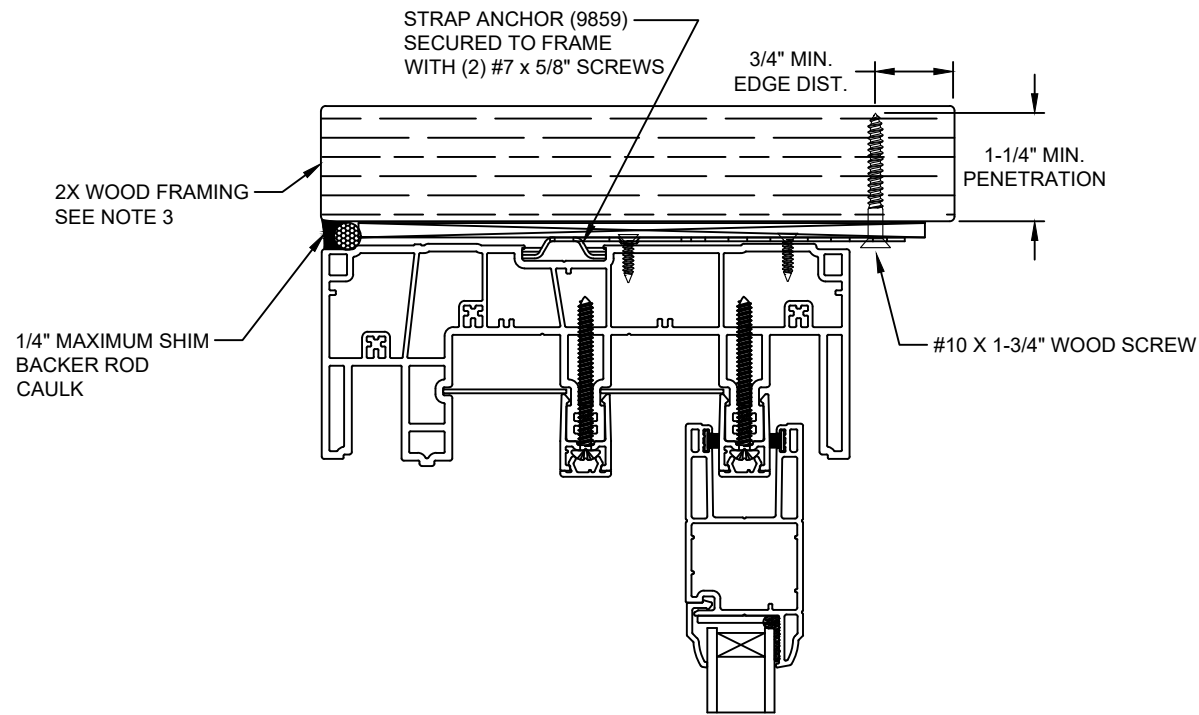

EXTERIOR

INTERIOR

JAMB

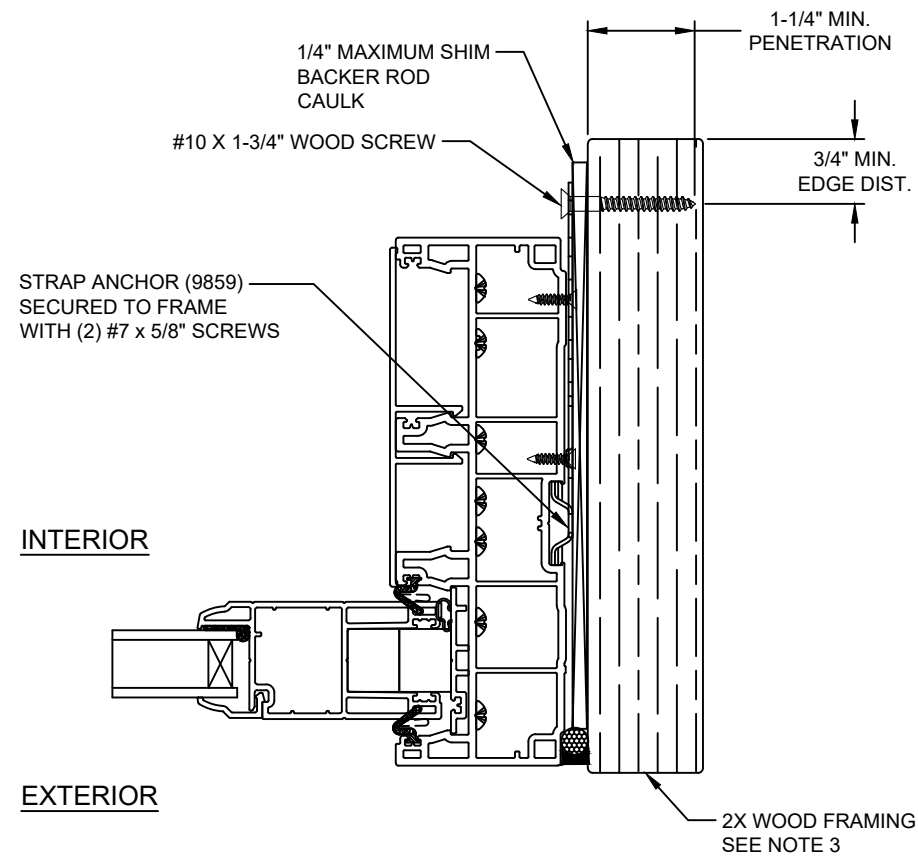

INTERIOR

EXTERIOR

2X WOOD FRAMING
SEE NOTE 3

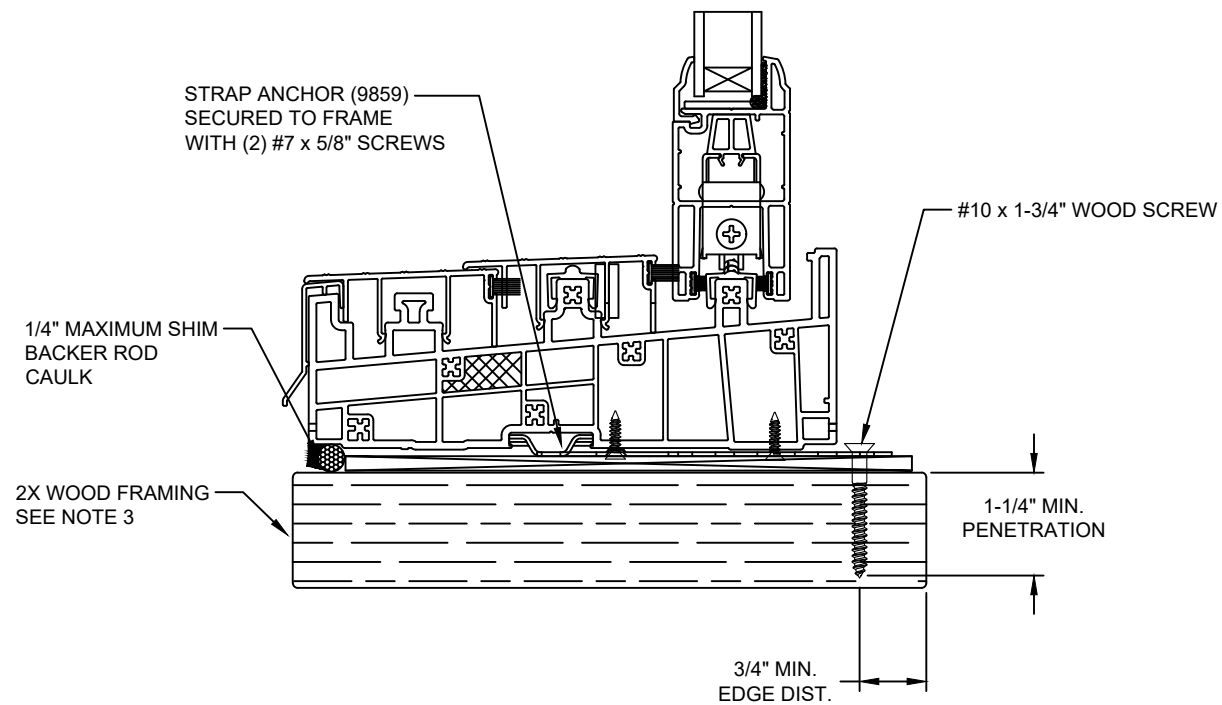

SILL

NOTE:
IF SILL INSTALLED TO STEEL STUD, SEE SHEET 10
IF SILL INSTALLED TO CONCRETE, SEE SHEETS 11 AND 12

Note:
Waterproofing and interior finishes by others. Not shown for clarity.

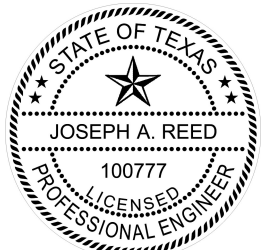

Joseph A. Reed, PE
TX PE 100777
5 Leigh Dr.
York, PA 17406
717-846-1200
Project 23550-1

Joseph A. Reed

2020.10.12 07:30:54 -04'00'

5400/5400S/7700/9900 SGD

**Non-Impact
Strap Install to Wood**

Wincore Windows & Doors

250 Staunton Turnpike
Parkersburg, WV 26104

Drawing No.: 23550-8-1001

Project No.: 23550-8

Drawn By: JAR Rev: - Date: 10/10/20

Scale: NTS

Sheet 9 of 16

Note:
Waterproofing and interior finishes by others. Not shown for clarity.

HEAD

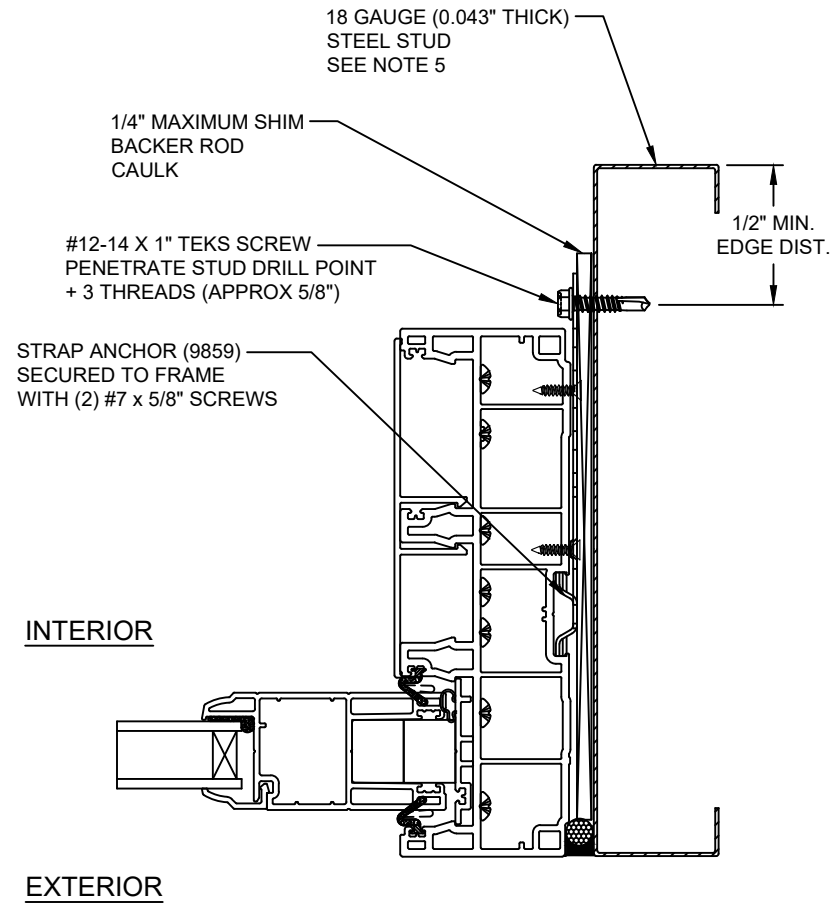
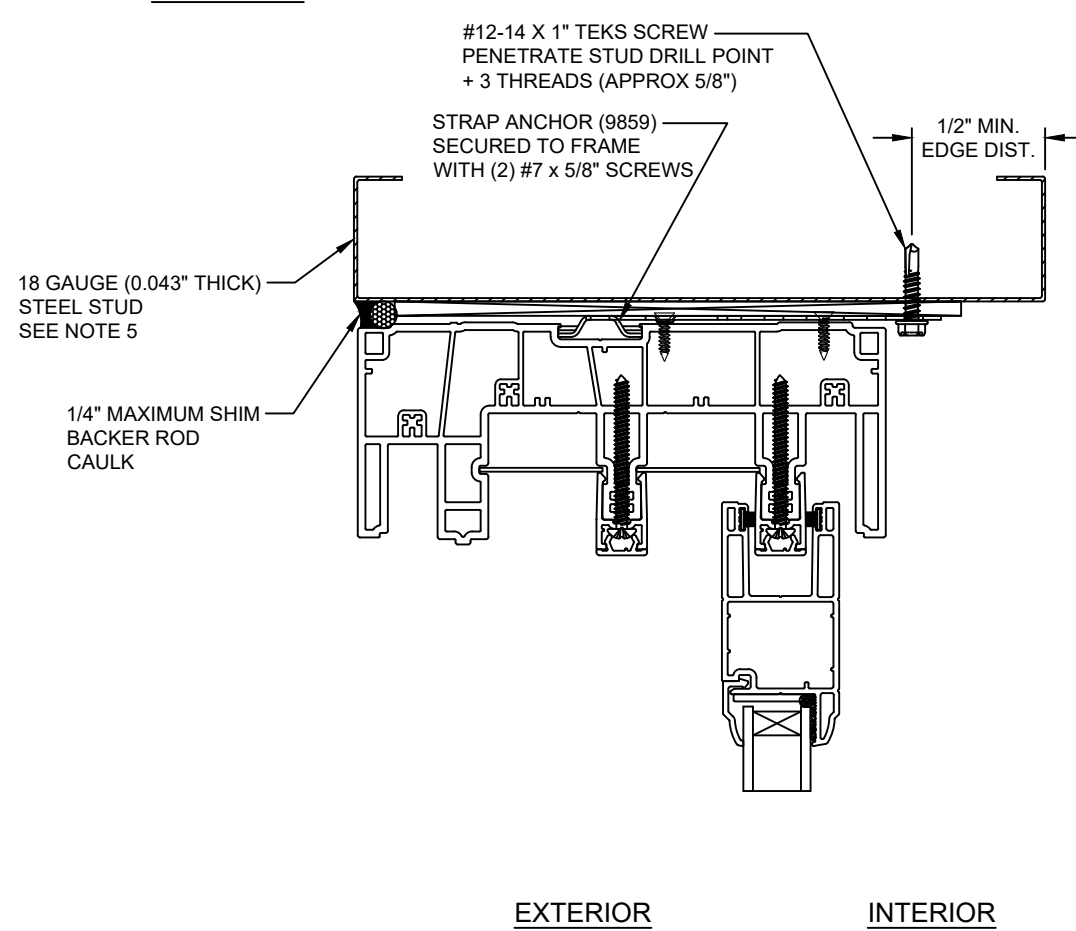

JAMB

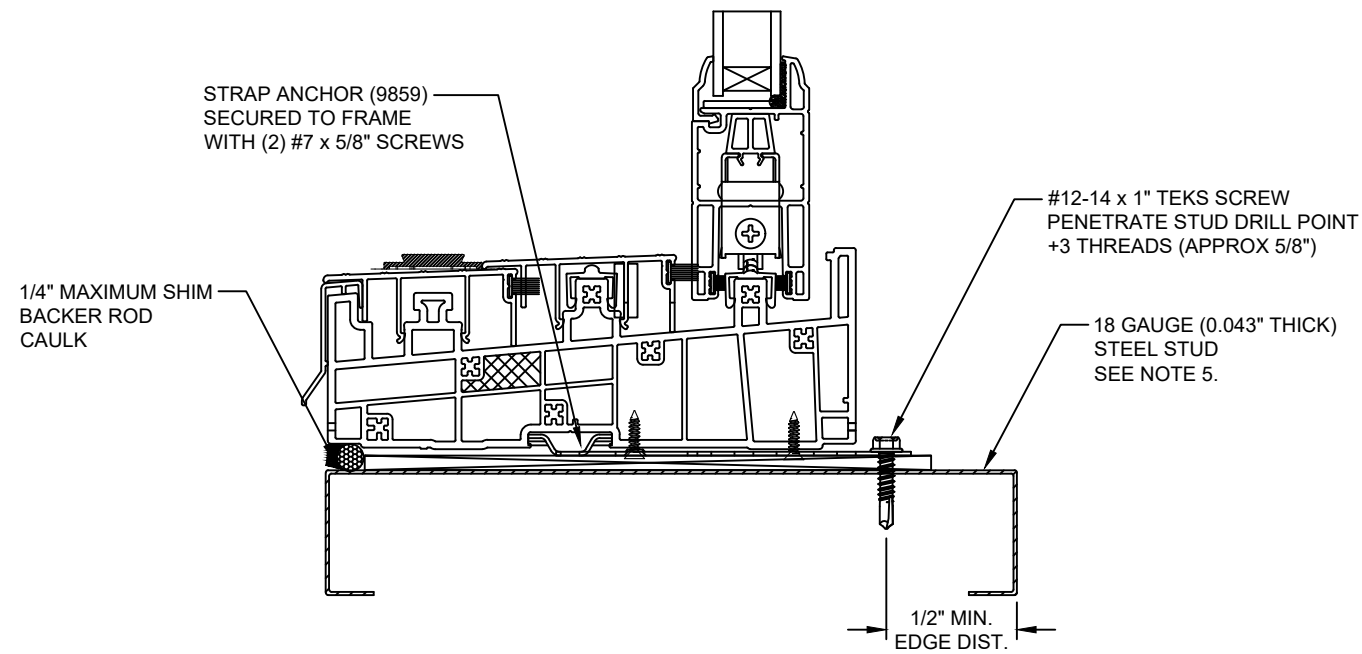

SILL

NOTE:
IF SILL INSTALLED TO WOOD, SEE SHEET 9
IF SILL INSTALLED TO CONCRETE, SEE SHEETS 11 AND 12

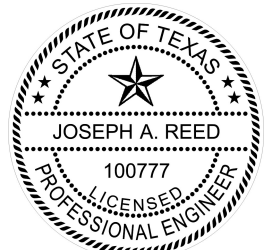

Joseph A. Reed, PE
TX PE 100777
5 Leigh Dr.
York, PA 17406
717-846-1200
Project 23550-1

Joseph A. Reed

2020.10.12 07:30:54 -04'00'

5400/5400S/7700/9900 SGD	
Non-Impact	
Strap Install to Steel Stud	
Wincore Windows & Doors	
250 Staunton Turnpike Parkersburg, WV 26104	
Drawing No.: 23550-8-1001	
Project No.: 23550-8	
Drawn By: JAR	Rev: - Date: 10/10/20
Scale: NTS	Sheet 10 of 16

HEAD

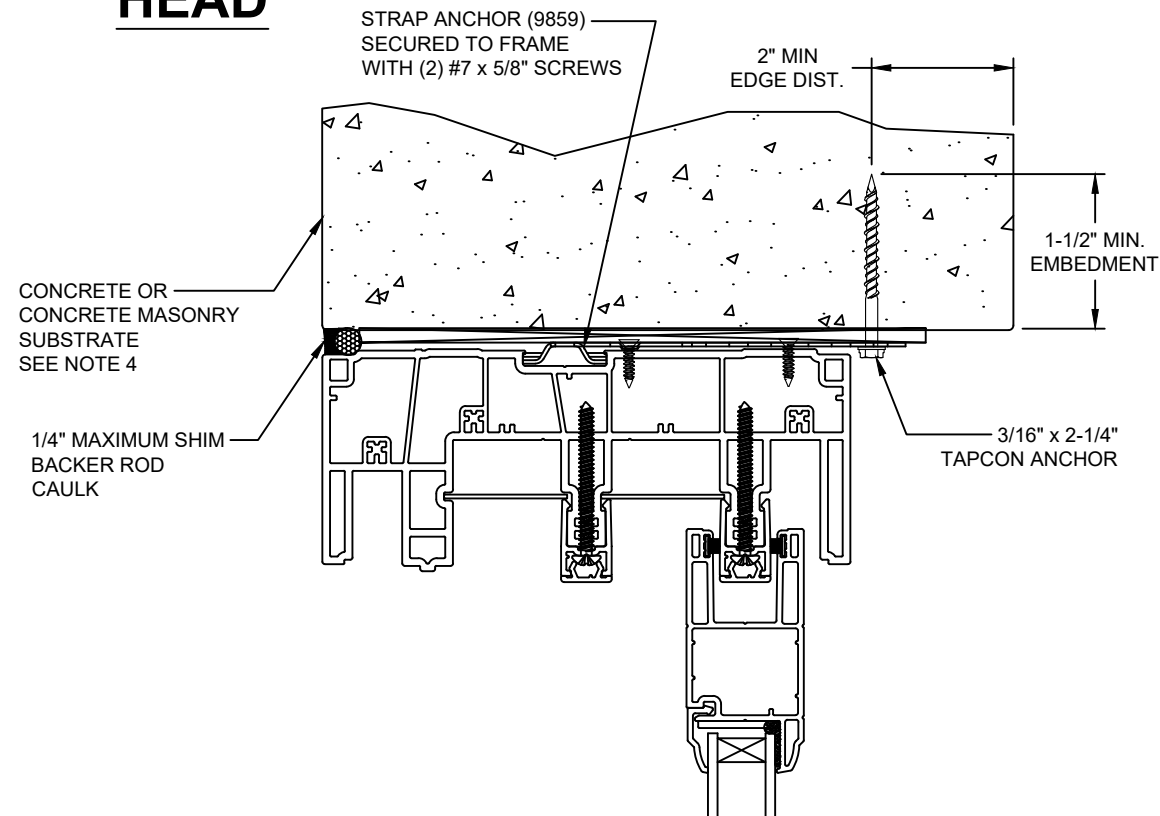

EXTERIOR

INTERIOR

CONCRETE OR CONCRETE MASONRY SUBSTRATE SEE NOTE 4

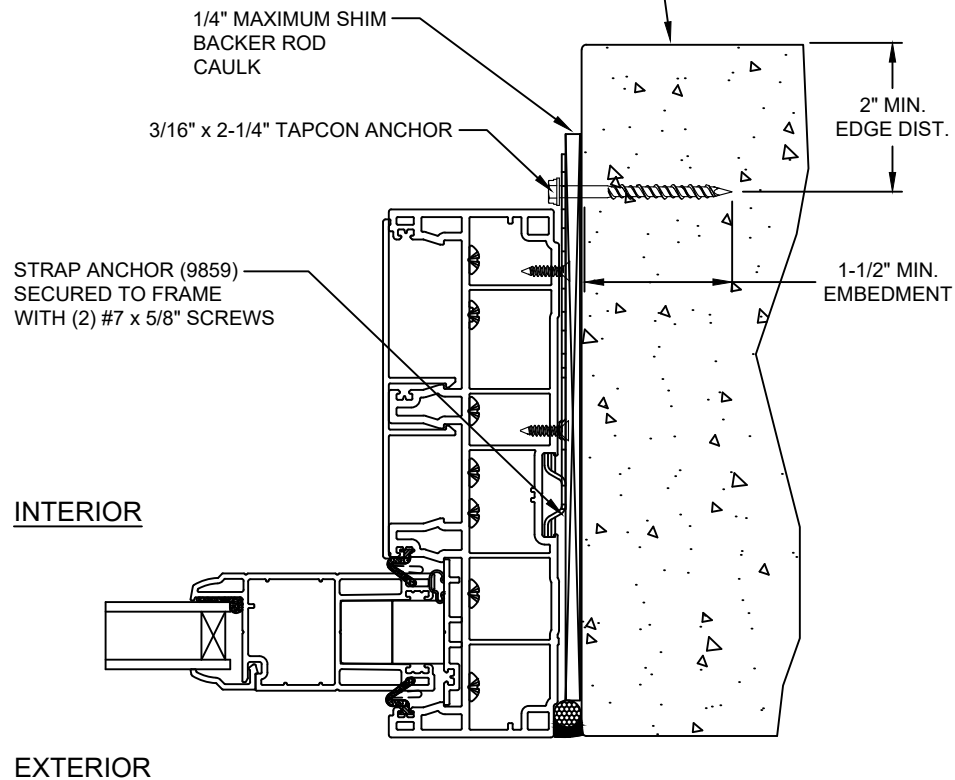

INTERIOR

EXTERIOR

JAMB

Note:
Waterproofing and interior finishes by others. Not shown for clarity.

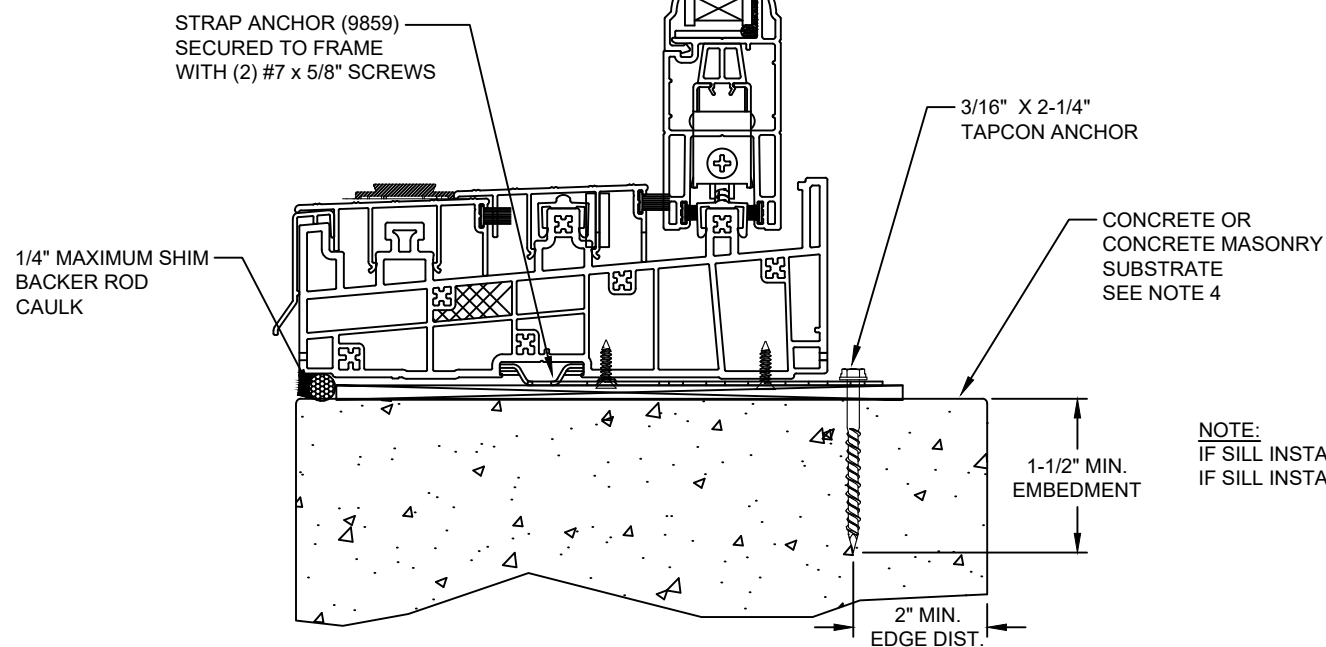

SILL

NOTE:
IF SILL INSTALLED TO WOOD, SEE SHEET 9
IF SILL INSTALLED TO STEEL STUD, SEE SHEET 10

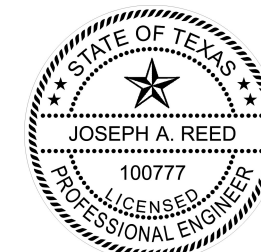

Joseph A. Reed, PE
TX PE 100777
5 Leigh Dr.
York, PA 17406
717-846-1200
Project 23550-1

Joseph A. Reed

2020.10.12 07:30:54 -04'00'

5400/5400S/7700/9900 SGD Non-Impact Strap Install to Concrete or CMU	
Wincore Windows & Doors 250 Staunton Turnpike Parkersburg, WV 26104	
Drawing No.: 23550-8-1001 Project No.: 23550-8 Drawn By: JAR Rev: - Date: 10/10/20	
Scale: NTS	Sheet 11 of 16

Note:
Waterproofing and interior finishes by others. Not shown for clarity.

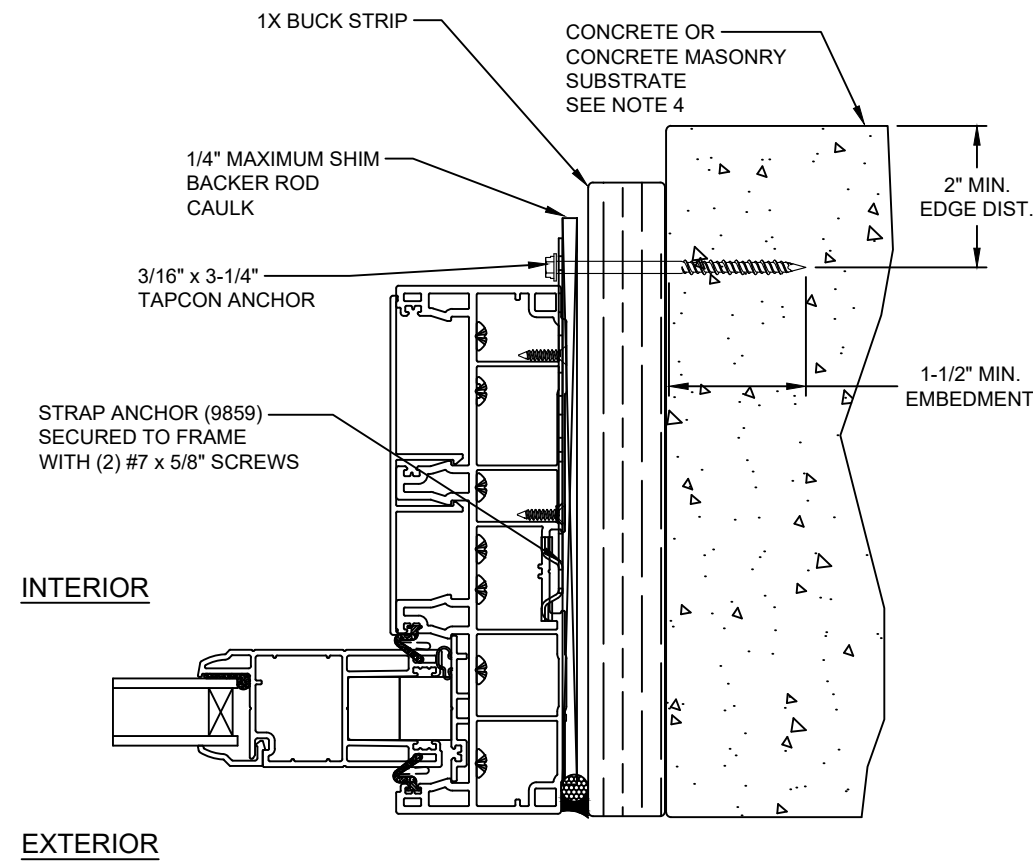
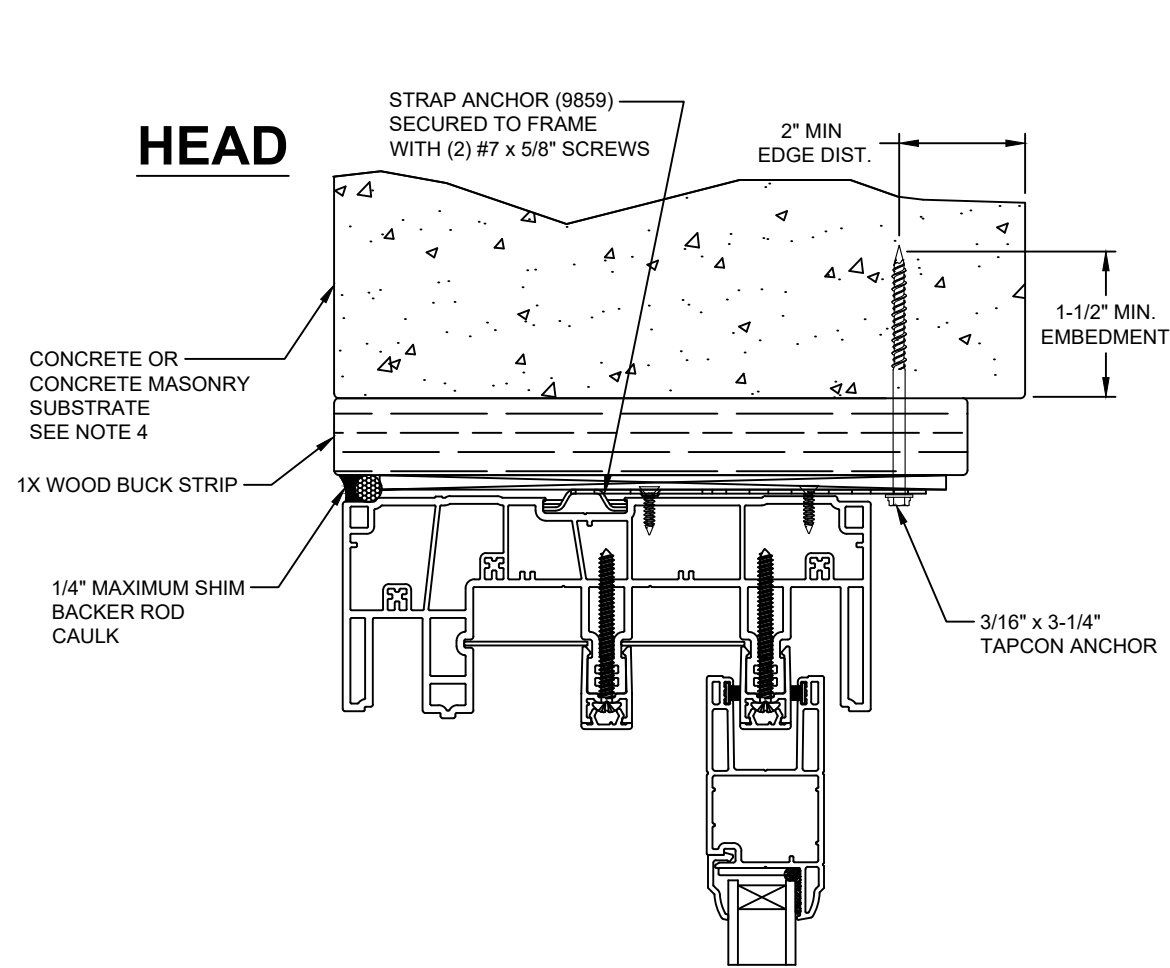

EXTERIOR INTERIOR

JAMB

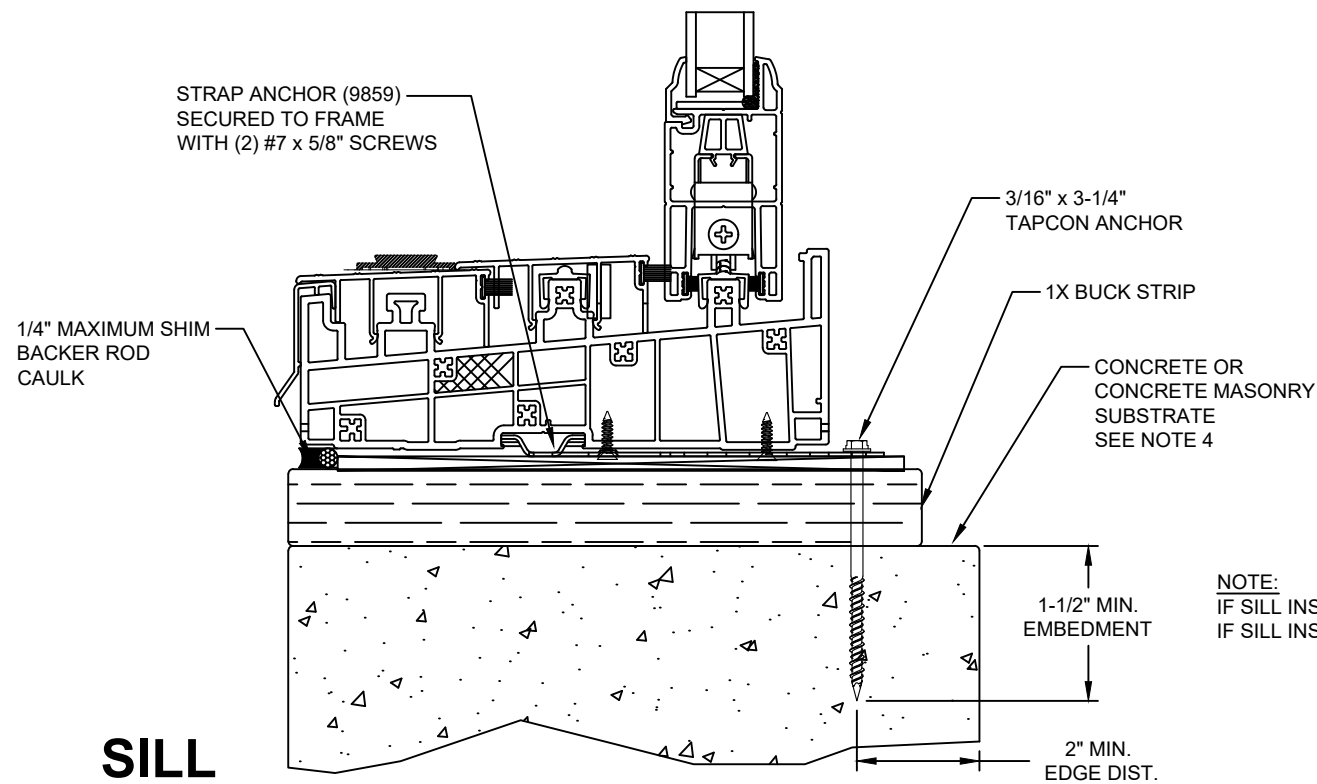

NOTE:
IF SILL INSTALLED TO WOOD, SEE SHEET 9
IF SILL INSTALLED TO STEEL STUD, SEE SHEET 10

SILL

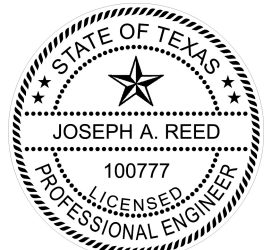

Joseph A. Reed, PE
TX PE 100777
5 Leigh Dr.
York, PA 17406
717-846-1200
Project 23550-1

Joseph A. Reed

2020.10.12 07:30:54 -04'00'

5400/5400S/7700/9900 SGD	
Non-Impact	
Strap Install to Concrete or CMU	
Wincore Windows & Doors	
250 Staunton Turnpike Parkersburg, WV 26104	
Drawing No.: 23550-8-1001	
Project No.: 23550-8	
Drawn By: JAR	Rev: - Date: 10/10/20
Scale: NTS	Sheet 12 of 16

144" X 82" DOOR
48-3/4" X 77-1/2" PANEL
42-1/8" X 71" DLO

EXTERIOR

INTERIOR

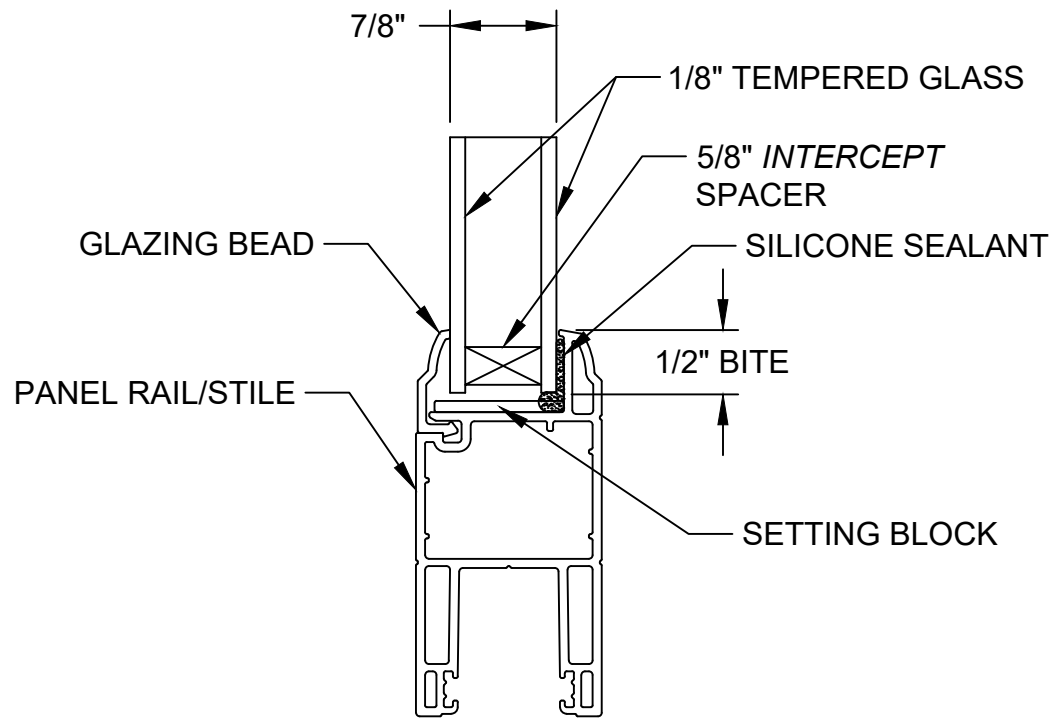

144" X 96" DOOR
48-3/4" X 91-1/4" PANEL
42-1/8" X 84-5/8" DLO

EXTERIOR

INTERIOR

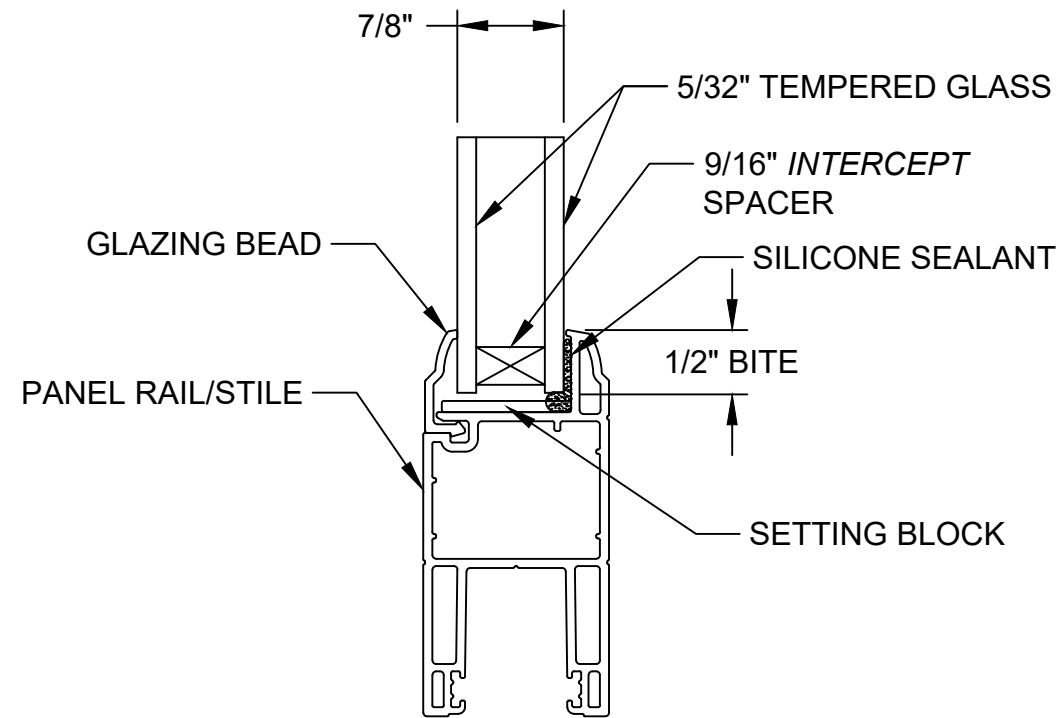

EXTERIOR

INTERIOR

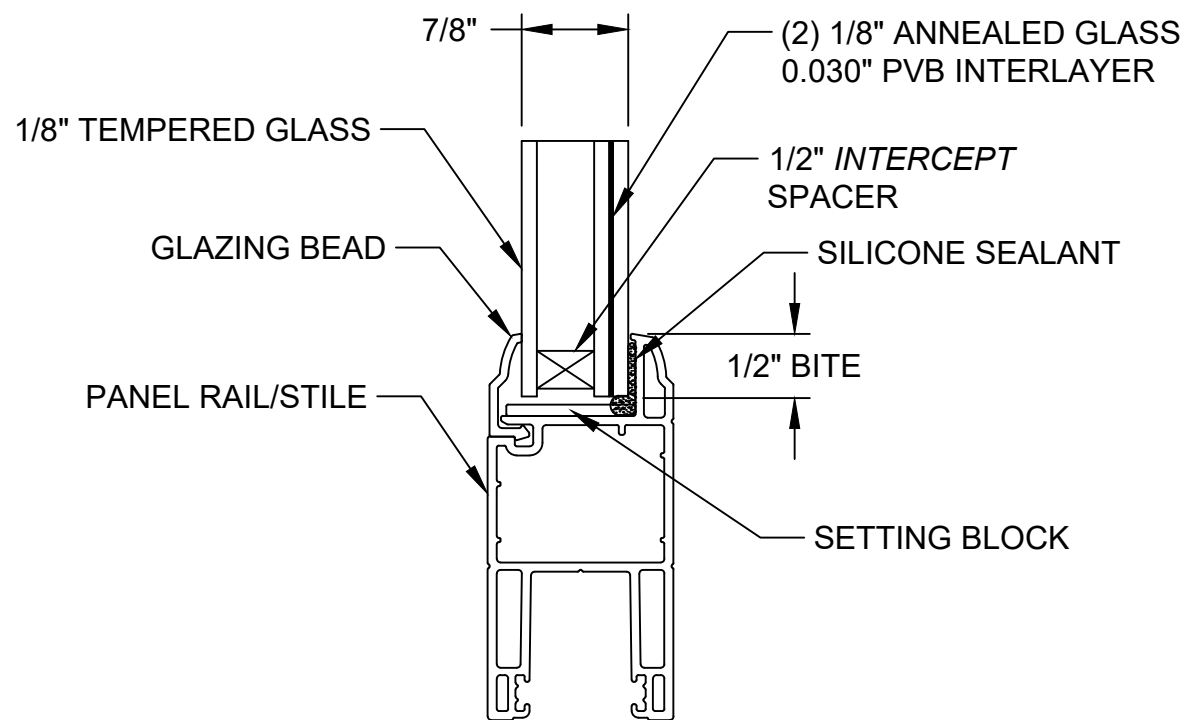

EXTERIOR

INTERIOR

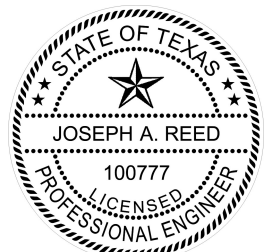
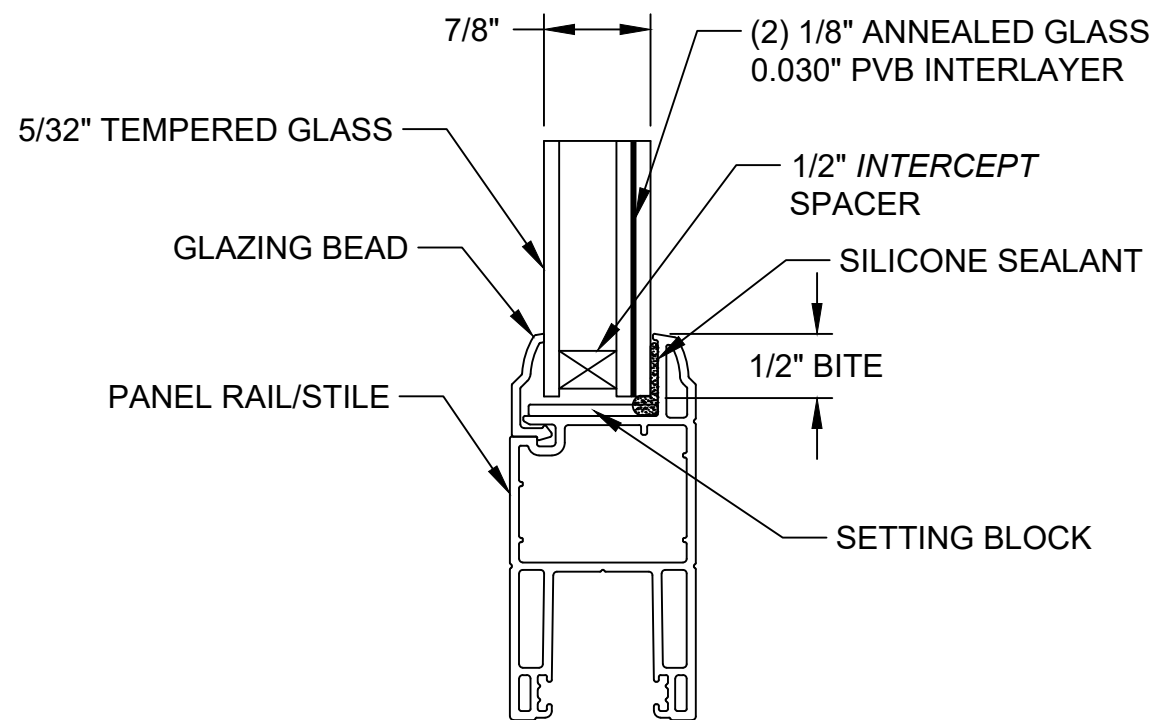

Joseph A. Reed, PE
 TX PE 100777
 5 Leigh Dr.
 York, PA 17406
 717-846-1200
 Project 23550-1

Joseph A. Reed

2020.10.12 07:30:54 -04'00'

5400/5400S/7700/9900 SGD
Non-Impact
Glazing Details

Wincore Windows & Doors
 250 Staunton Turnpike
 Parkersburg, WV 26104

Drawing No.: 23550-8-1001
 Project No.: 23550-8
 Drawn By: JAR Rev: - Date: 10/10/20

Scale: NTS

Sheet 13 of 16

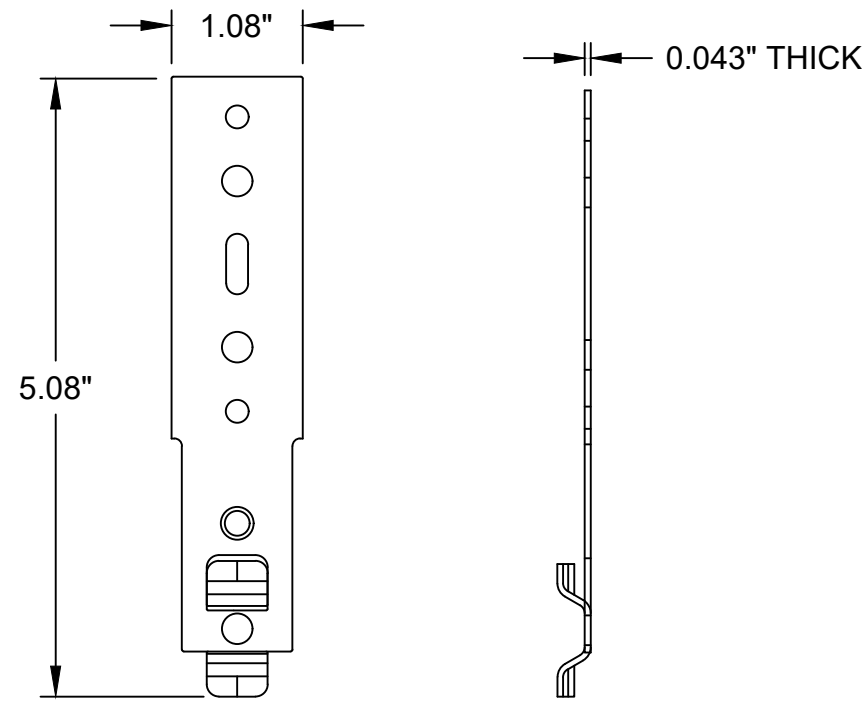

STRAP ANCHOR
 PART NO. 9859
 18 GAUGE STEEL

Joseph A. Reed, PE
 TX PE 100777
 5 Leigh Dr.
 York, PA 17406
 717-846-1200
 Project 23550-1

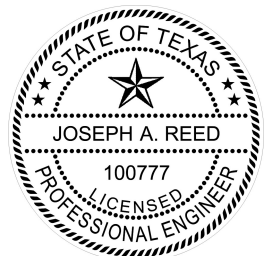

Joseph A. Reed

2020.10.12 07:30:54 -04'00'

5400/5400S/7700/9900 SGD Non-Impact Accessories	
Wincore Windows & Doors 250 Staunton Turnpike Parkersburg, WV 26104	
Drawing No.: 23550-8-1001 Project No.: 23550-8 Drawn By: JAR Rev: - Date: 10/10/20	
Scale: NTS	Sheet 14 of 16

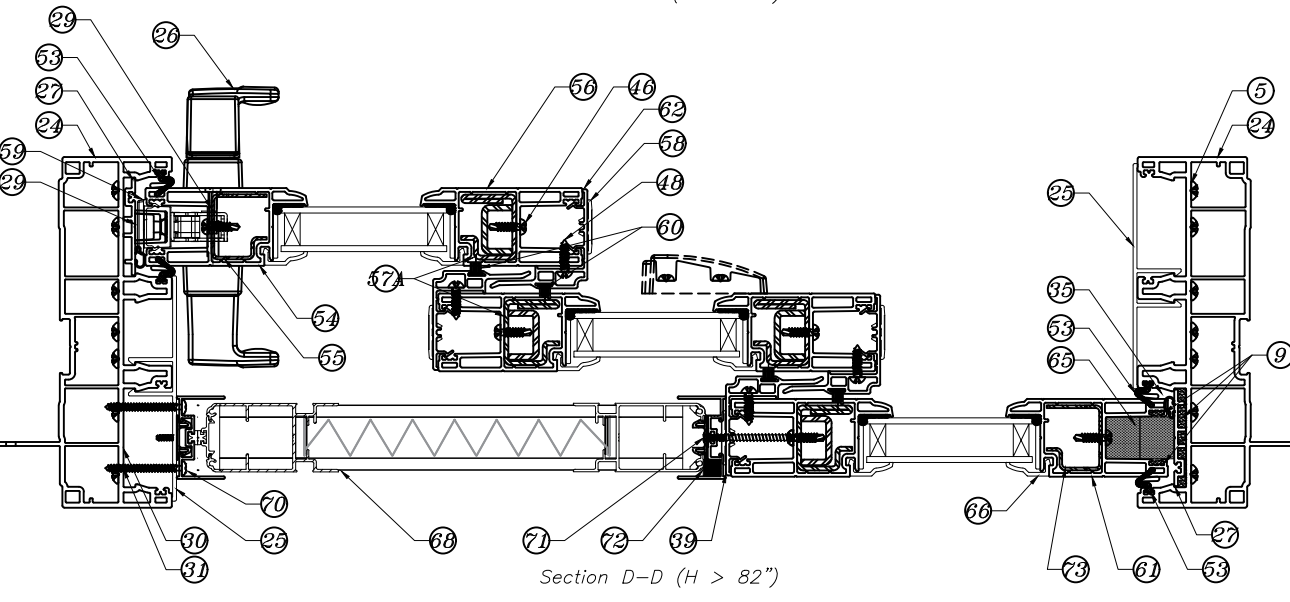
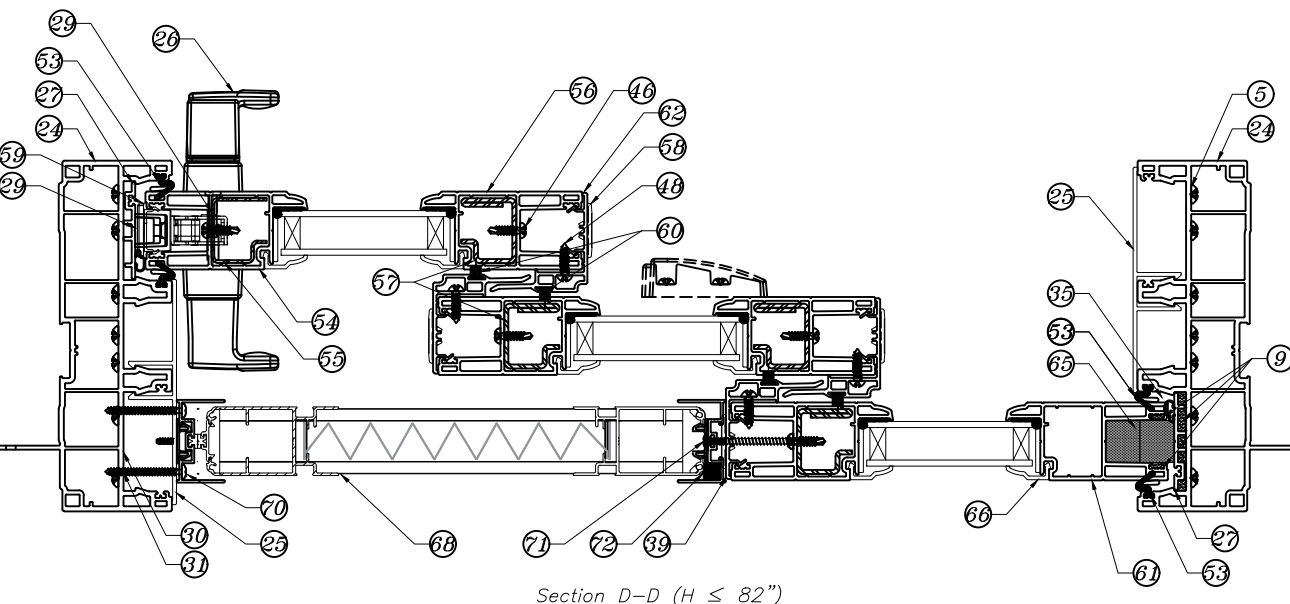
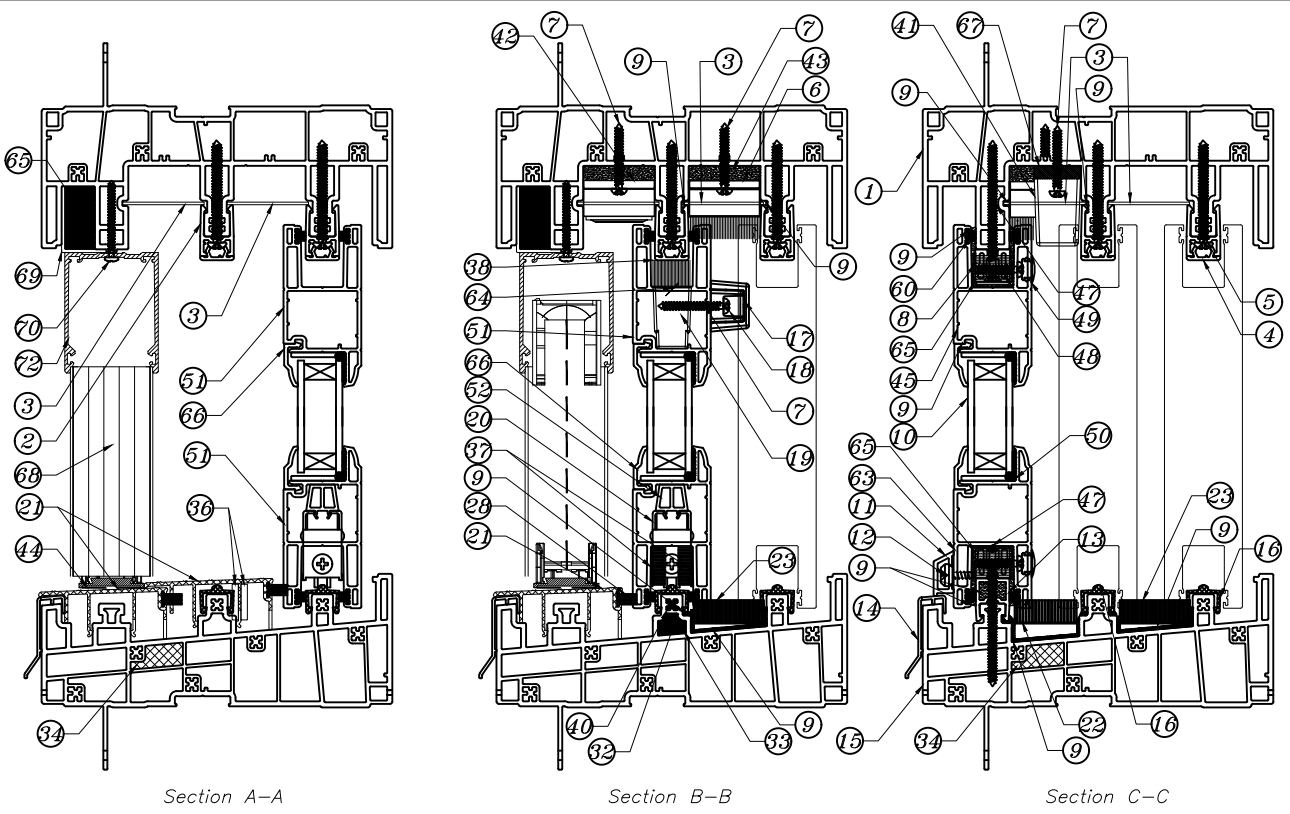

Item	PART No.	Item Description	Source
1	8352, 8302, 8312, 8322, 8332, 8362, 8372, 8382	Head track profile	P.H. Tech
2	8321	Head track	P.H. Tech
3	8323	Head Cover	P.H. Tech
4	8331	Head Cover Rail	P.H. Tech
5	8942.VIS10	No 10 x 2", Pan head, Phillips, SS Screw	P.H. Tech
6	703	Head Weatherseal	P.H. Tech
7	8941	No. 8-18 x 1 1/4", Pan head, Quadrex screw	P.H. Tech
8	7003	Fixed sash anchor block	P.H. Tech
9		Sealant	Various
10		Glass	Various
11	6352	Drip Cap	P.H. Tech
12	8813.VIS10	No. 10-12 x 5/8", special mushroom head, Quadrex	P.H. Tech
13	8301	Fixed Rail Support	P.H. Tech
14	9730	Sill cladding	P.H. Tech
15	8350, 8300, 8310, 8320, 8330, 8360, 8370, 8380	Sill track profile	P.H. Tech
16	9708	Sliding rail	P.H. Tech
17	8389.58.CAPEV	Cap (bumper of the central mobile sash)	P.H. Tech
18	8389.04.ARRREV	Bumper (central mobile sash)	P.H. Tech
19	8397	Mobile welded sash anchor block	P.H. Tech
20	9732	Tandem Wheel	P.H. Tech (Truth)
21	9718	Sill protector	P.H. Tech
22	8371	Sill weatherseal block (33mm)	P.H. Tech
23	8381	Sill Weatherseal block (37mm)	P.H. Tech
24	8354, 8304, 8314, 8324, 8334, 8364, 8374, 8384	Jamb track profile	P.H. Tech
25	8313	Jamb cover	P.H. Tech
26	9748	Handle Kit	P.H. Tech (Roto Fasco)
27	8303	Bulb weatherstrip adaptor	P.H. Tech
28	9581, 9575	Weatherstrip	Ultralab #1-G8-42027045-GY Schlegel #HF-7532-270
29	9250	Mortise Lock / Keeper kit	P.H. Tech (Roto Fasco)
30	8378	Frame Corner Gasket (Sill)	P.H. Tech
31	8379	Frame Corner Gasket (Head)	P.H. Tech
32	8781	Rail foam plug	P.H. Tech
33	8782	Anti bug foam (rail)	P.H. Tech
34	8783	Anti bug foam (sill)	P.H. Tech
35	8784	Fixed sash foam bloc	P.H. Tech
36	8387	Sill protector foam gasket (mobile)	P.H. Tech

Item	PART No.	Item Description	Source
37	8786	Bottom weatherstrip (center sash)	Schlegel #DPAB 0.827" x0.500" x1.125"
38	8787	Top weatherstrip (center sash)	Schlegel #DPAB 0.827" x0.625" x1.000"
39	8377	Sill protector foam gasket	P.H. Tech
40	8788	Rail foam plug	P.H. Tech
41	8940	Bumper	P.H. Tech
42	8703	Head block	P.H. Tech
43	8373	Spacer for blocks 703/8703	P.H. Tech
44			
45	7508.F	Fixed horizontal rail	P.H. Tech
46	9867.VIS08	No. 8-10 x 5/8", pan head, quadrex self-drilling screw	P.H. Tech
47	9619.VIS08	No. 8-15 x 2 3/4", flat head, Quadrex, Wood screw	P.H. Tech
48	9796.VIS08	No. 8-10 x 5/8", pan head, quadrex screw	P.H. Tech
49	9667	Screw Cap	P.H. Tech
50	8933	Setting block (glass)	P.H. Tech
51	7508.M	Mobile horizontal rail	P.H. Tech
52	7541	Cate pour roue tandem	P.H. Tech
53	9584	Weatherstrip	Amesbury/Truth Foamble #32343
54	7587-M	Mobile side stile	P.H. Tech
55	9598-M	Mobile side stile steel reinforcement	P.H. Tech
56	7506	Meeting stile	P.H. Tech
57	9599	Meeting stile steel reinforcement	P.H. Tech
57A	9528	Meeting stile steel reinforcement; H > 82"	P.H. Tech
58	8842	Sliding cap	P.H. Tech
59	7523	Groove cover	P.H. Tech
60	9550	Weatherstrip	Schlegel #HF-7522-270 Nap #RPHF027023
61	7547-F	Fixed side stile	P.H. Tech
62	7026	Interlock	P.H. Tech
63	8395-L/R	Drip Cap Cover (Left/Right)	P.H. Tech
64			
65	9853	Foam plug	P.H. Tech
66	5770, 5771, 5772, 5775, 5792, 5793, 5796	Glazing bead	P.H. Tech
67	8789	Spacer for bumper	P.H. Tech
68	8335	Retractable screen (AIRE Slim or AIRE Grand)	Interlock USA
69	1489	Head moulding	P.H. Tech
70		No 6 x 1-1/2" Pan Quadrex	Interlock USA
71	9785.VIS08	No. 8-15 x 2", truss head, Quadrex, Wood screw	P.H. Tech
72	8989	Foam plug	P.H. Tech

= Option

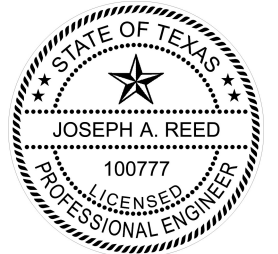
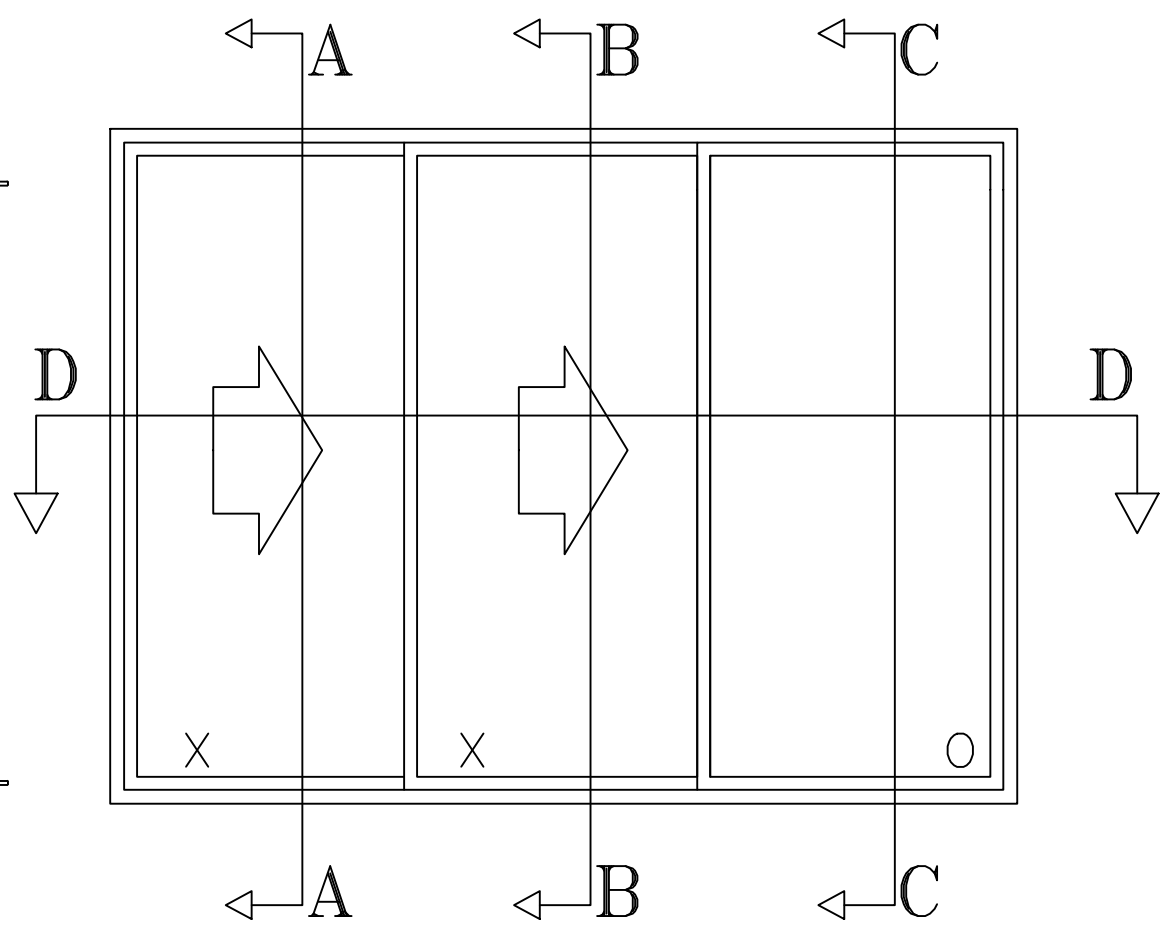

Joseph A. Reed, PE
 TX PE 100777
 5 Leigh Dr.
 York, PA 17406
 717-846-1200
 Project 23550-1

Joseph A. Reed

2020.10.12 07:30:54 -04'00'

5400/5400S/7700/9900 SGD
Non-Impact
Sections and BOM

Wincore Windows & Doors
 250 Staunton Turnpike
 Parkersburg, WV 26104

Drawing No.: 23550-8-1001
 Project No.: 23550-8
 Drawn By: JAR Rev: - Date: 10/10/20

Scale: NTS Sheet 15 of 16

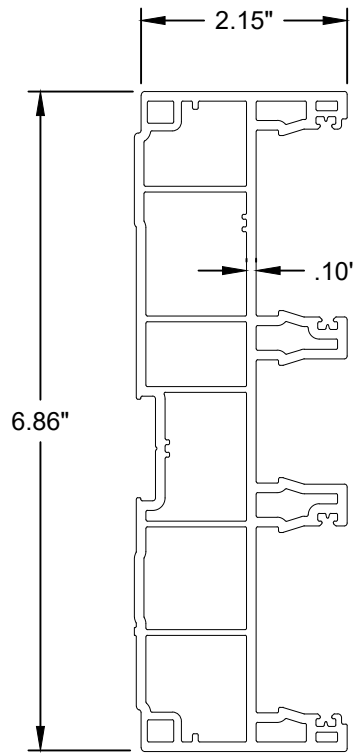

JAMB TRACK
PVC

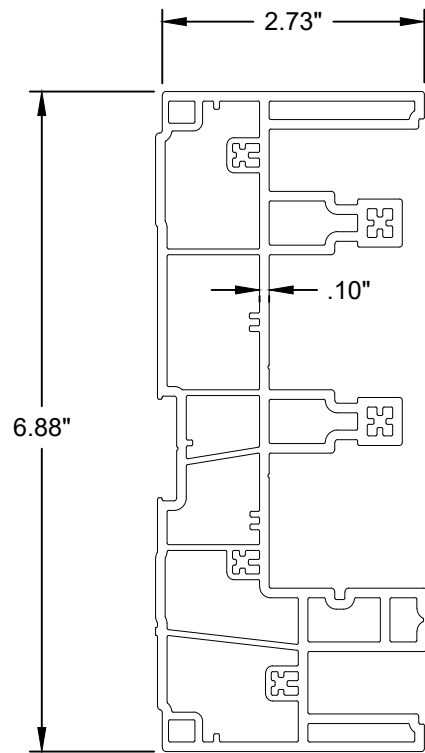

HEAD TRACK
PVC

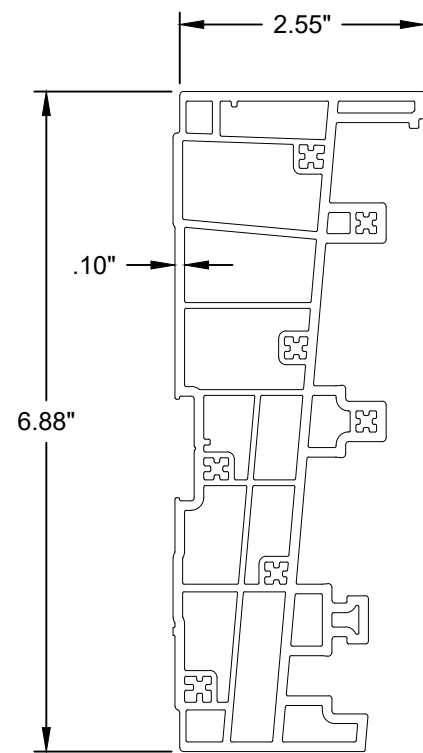

SILL TRACK
PVC

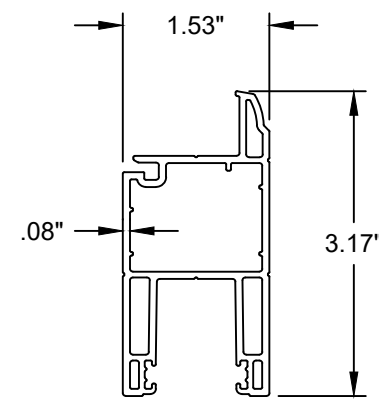

STILE/RAIL
PVC

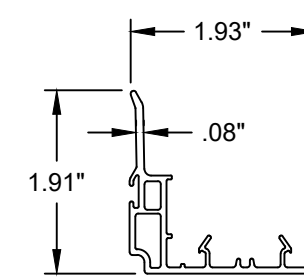

INTERLOCK
PVC

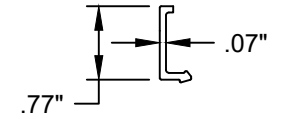

GLAZING BEAD
PVC

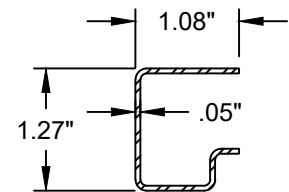

STILE REINFORCEMENT
STEEL

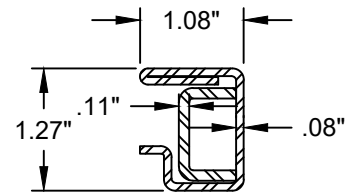

MEETING STILE REINFORCEMENT
STEEL

HARDWARE	
ITEM	LOCATION
HANDLE KIT (ROTO) WITH 2-POINT LOCK	LOCK STILE
METAL KEEPER	LOCK JAMB
NYLON ROLLER WITH METAL HOUSING	EACH END OF BOTTOM RAIL
ALUMINUM ROLLER GUIDE	SILL TRACK

Joseph A. Reed, PE
TX PE 100777
5 Leigh Dr.
York, PA 17406
717-846-1200
Project 23550-1

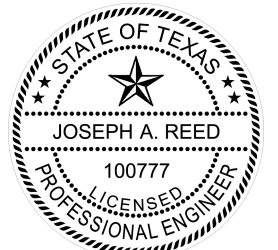

Joseph A. Reed

2020.10.12 07:30:54 -04'00'

5400/5400S/7700/9900 SGD
Non-Impact
Components

Wincore Windows & Doors
250 Staunton Turnpike
Parkersburg, WV 26104

Drawing No.: 23550-8-1001
Project No.: 23550-8
Drawn By: JAR Rev: - Date: 10/10/20

Scale: NTS Sheet 16 of 16