

Z:\Clients\Therma Tru PERMANENT\B - Texas Dept of Ins\TDI - DR XXX - 6'8, 7' & 8' CC Glazed FG NonImp IS Dir Set Sidelites (TX 5152-5157)\C - Drawings\TX-5160-61.dwg

THERMA TRU[®] DOORS

Classic-Craft[®]

GLAZED FIBERGLASS DOUBLE DOOR w/ DIRECT SET SIDELITES

INSWING
"NON-IMPACT"

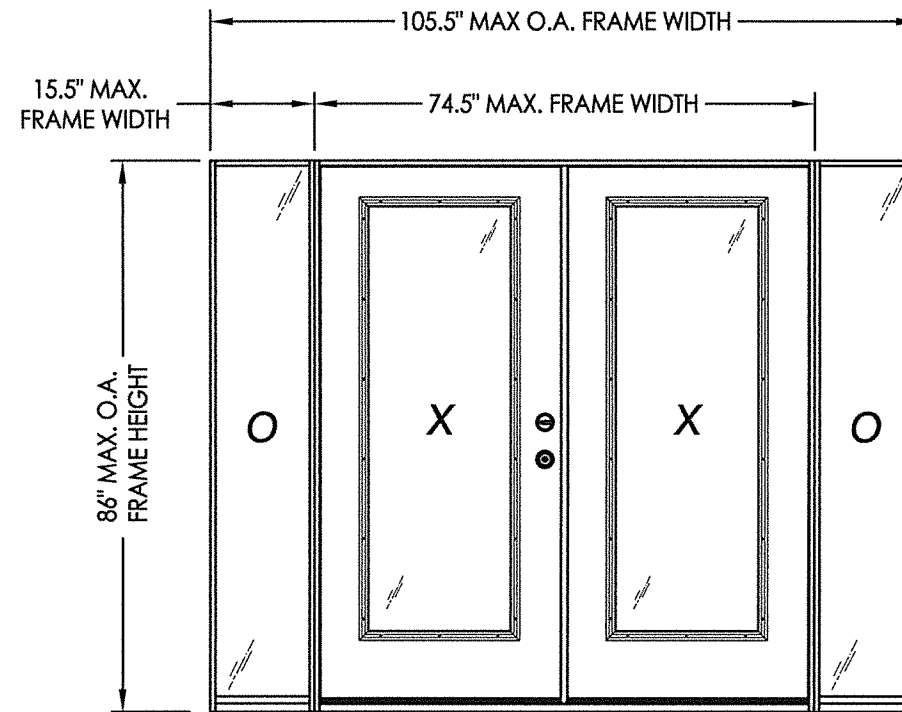

EVALUATED FOR USE IN THE STATE OF TEXAS

The Fiberglass Door system described herein complies with the 2018 International Residential Code (IRC), Sections R301 & R609 and the 2018 International Building Code (IBC), Sections 1404.13, 1609, 1709.5, 2403 and 2404 subject to the following conditions:

1. Anchors shall be as listed and spaced as shown in the details. Anchor embedment to base material shall be beyond wall dressing or stucco.
2. When used in areas requiring wind-borne debris protection this product is required to be protected with an impact resistant covering that complies with Section R301.2.1.2 of the IRC and Section 1609.1.2 of the IBC.
3. Allowable design pressure requirements must be equal to or less than the design pressure rating shown in the design pressure chart, sheet 1 of this drawing.
4. Conditions not covered by this drawing are subject to further engineering analysis.

TABLE OF CONTENTS

| SHEET # | DESCRIPTION | SHEET # | |
|---------|--|---------|--------------------------------|
| 1 | Typical Elevations, Design Pressures & General Notes | 6 | Vertical Cross Sections |
| 2 | Door Panel Details | 7 | Frame Anchoring |
| 3 | Sidelite Panel Details | 8 | Hardware Details |
| 4 | Elevations | 9 | Glazing Details |
| 5 | Horizontal Cross Sections | 10 | Bill of Materials & Components |

| CONFIGURATION | 2X REINFORCEMENT REQUIRED | ASTRAGAL | DESIGN PRESSURE (PSF) w/ FJ PINE JAMBS | | DESIGN PRESSURE (PSF) w/ COMPOSITE JAMBS | |
|---------------|---------------------------|----------|---|----------|---|----------|
| | | | POSITIVE | NEGATIVE | POSITIVE | NEGATIVE |
| OXO | NO | STANDARD | +40.0 | -45.0 | +40.0 | -45.0 |

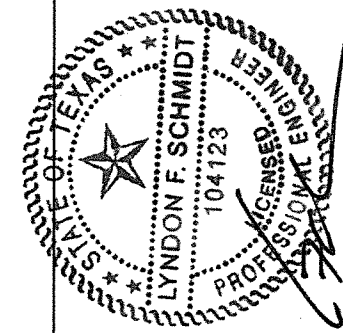

Documents Prepared By: Lyndon F. Schmidt, P.E.
TEXAS P.E. #104123

RW BUILDING CONSULTANTS, INC.
P.O. Box 230 Vairico FL 33595
Phone No.: 813.859.9197

TEXAS BOARD OF PROFESSIONAL ENGINEERS
CERTIFICATE OF REGISTRATION # F-11852

PRODUCT: THERMA-TRU
FIBERGLASS DOOR

PART OR ASSEMBLY:
TYPICAL ELEVATION, DESIGN
PRESSURES & GENERAL NOTES

| NO. | DATE | BY | REVISIONS |
|-----|------|----|-----------|
| | | | |
| | | | |
| | | | |
| | | | |
| | | | |

DATE: 1/06/21

SCALE: N.T.S.

DWG. BY: RW

CHK. BY: LFS

DRAWING NO.:
TX-5161

SHEET 1 OF 10

Z:\Clients\Therma Tru PERMANENT\B - Texas Dept of Ins\TDI - DR XXX - 6'8, 7' & 8' CC Glazed FG NonImp IS Dir Set Sidelites (TX 5152-5157)\C - Drawings\TX-5160-61.dwg

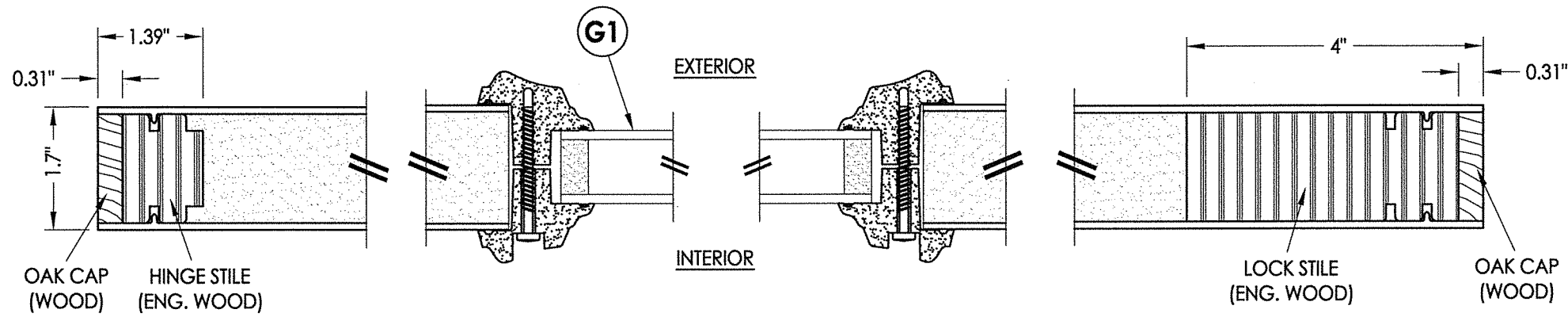

1 HORIZONTAL CROSS SECTION

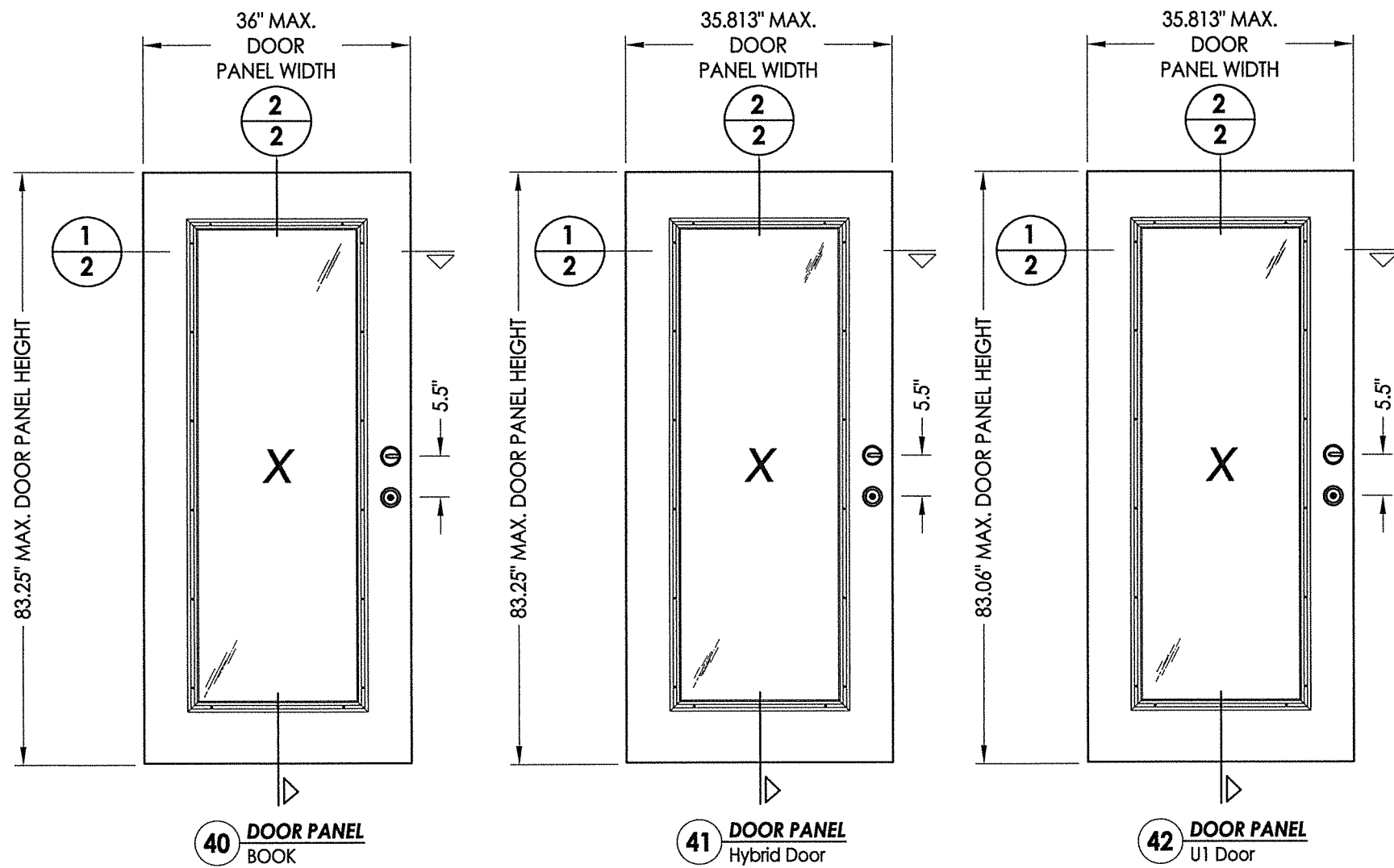

"Classic Craft" SERIES DOOR PANEL
 FIBERGLASS DOOR SKIN: 0.095" MIN. THK.
 FOAM CORE: POLYURETHANE FOAM (1.9 PCF MIN.)

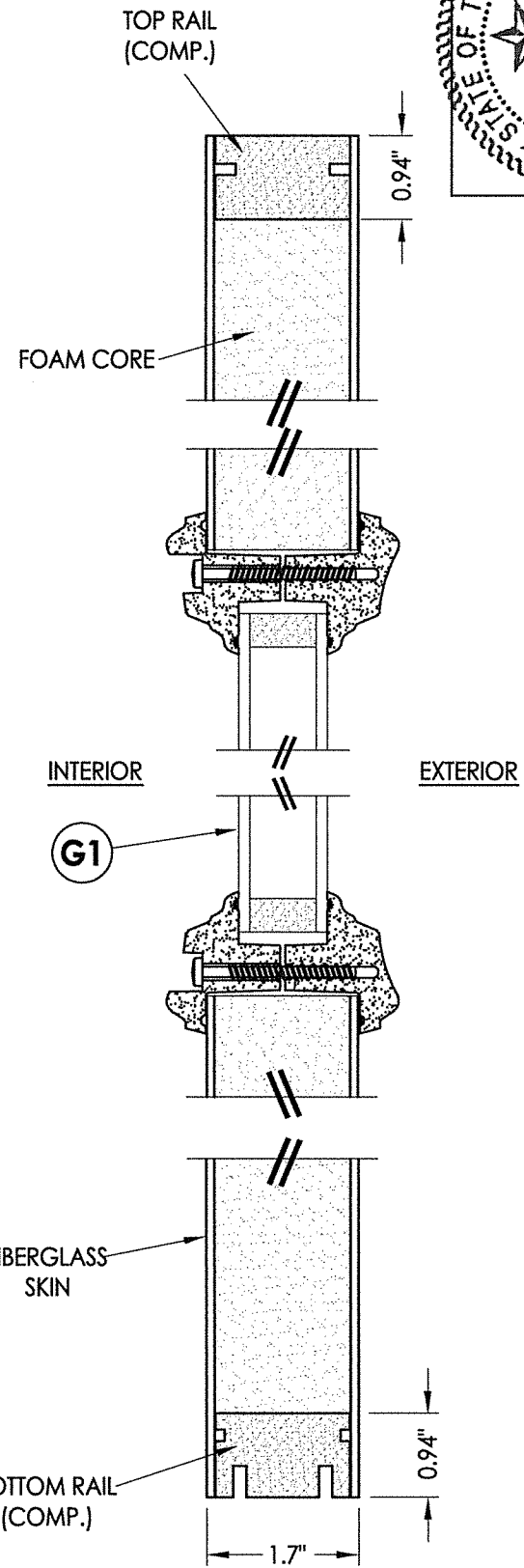

2 VERTICAL CROSS SECTION

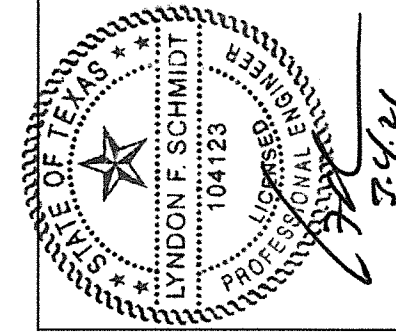

Documents Prepared By: Lyndon F. Schmidt, P.E.
 TEXAS P.E. #104123

RW BUILDING CONSULTANTS, INC.
 P.O. Box 230 Valrico FL 33595
 Phone No.: 813.659.9197
 TEXAS BOARD OF PROFESSIONAL ENGINEERS
 CERTIFICATE OF REGISTRATION # F-11852

PRODUCT: THERMA-TRU FIBERGLASS DOOR
 PART OR ASSEMBLY: DOOR PANEL DETAILS

| NO. | DATE | BY | REVISIONS |
|-----|------|----|-----------|
| | | | |
| | | | |
| | | | |
| | | | |
| | | | |
| | | | |
| | | | |
| | | | |
| | | | |

DATE: 1/06/21
 SCALE: N.T.S.
 DWG. BY: RW
 CHK. BY: LFS
 DRAWING NO.: TX-5161
 SHEET 2 of 10

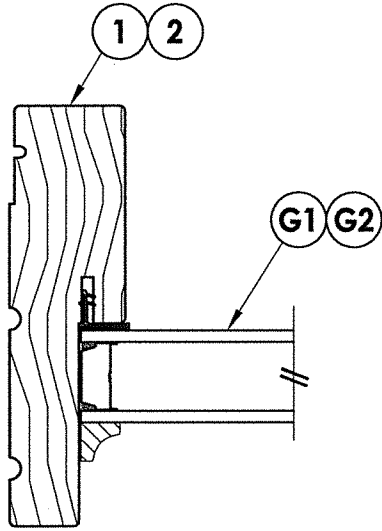

1 **3** **HORIZONTAL CROSS SECTION**

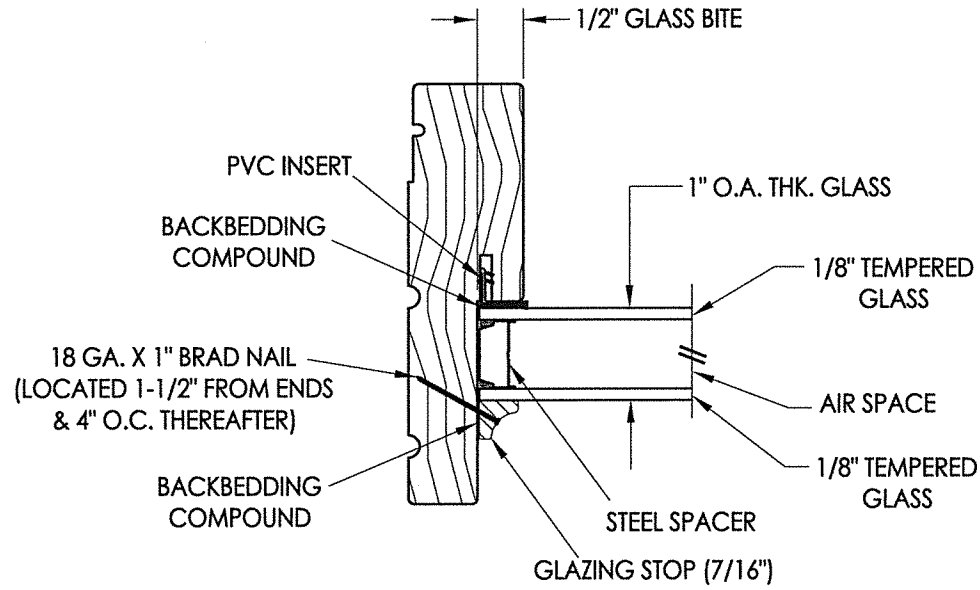

G1 **GLAZING DETAIL**
1" Insulated Glass

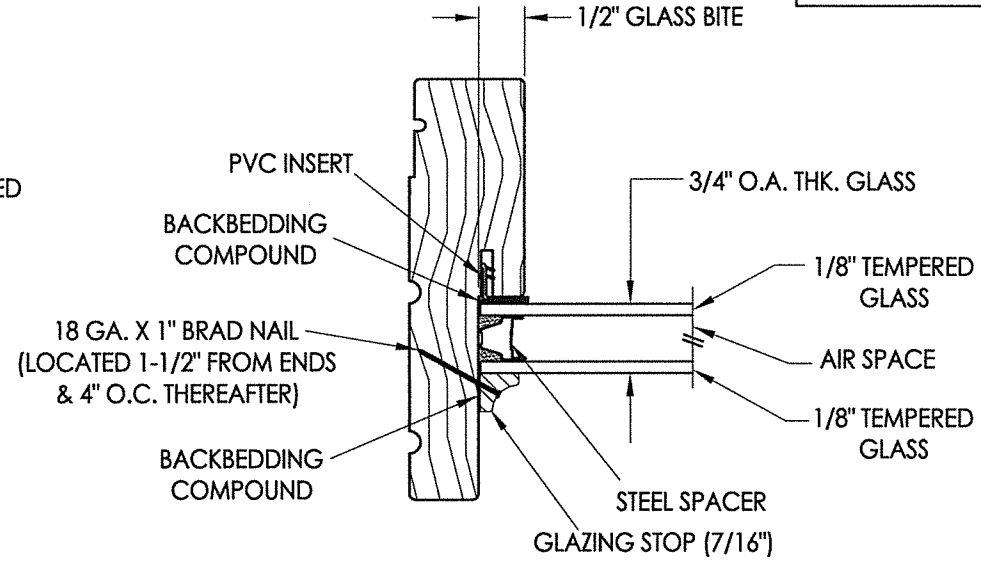

G2 **GLAZING DETAIL**
3/4" Insulated Glass

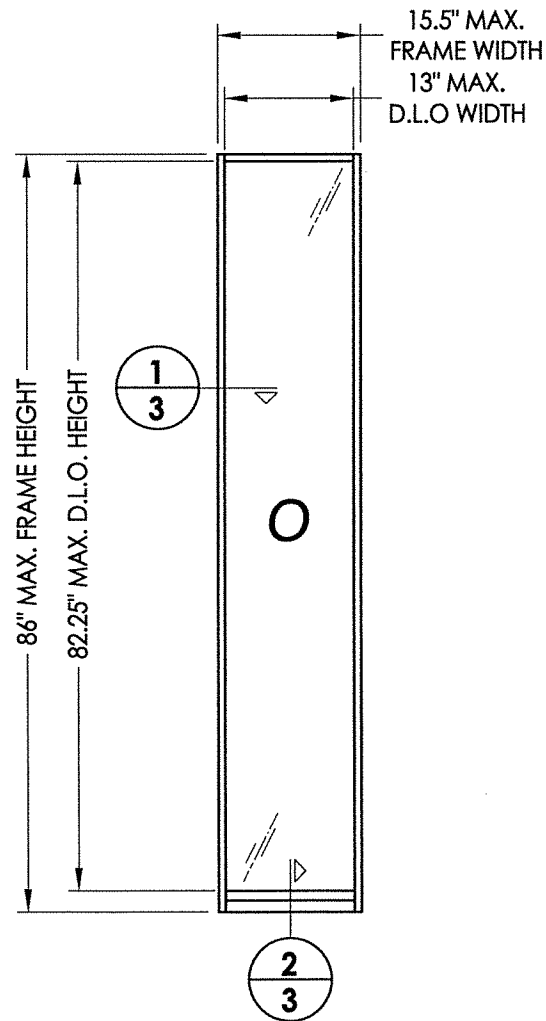

50 **DIRECT SET SIDELITE FRAME**

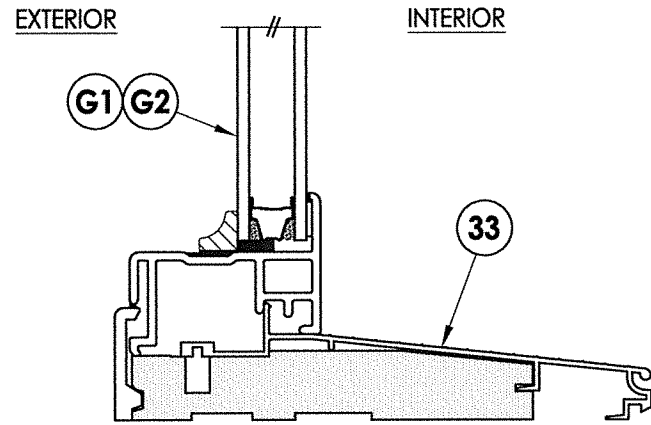

2 **3** **VERTICAL CROSS SECTION**

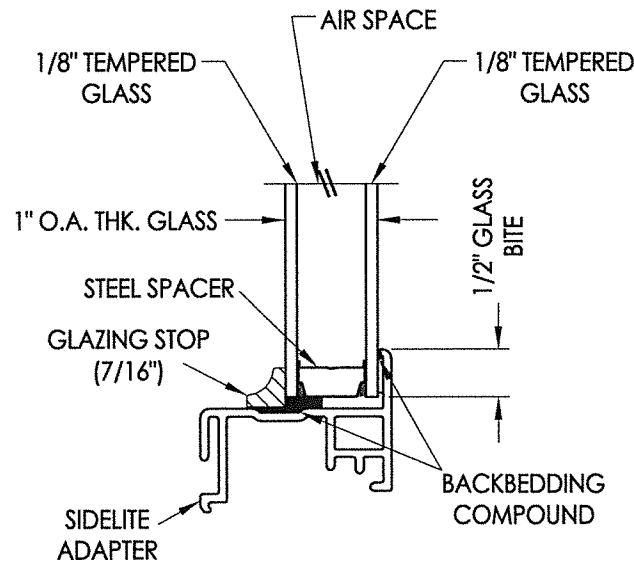

G1 **GLAZING DETAIL**
1" Insulated Glass

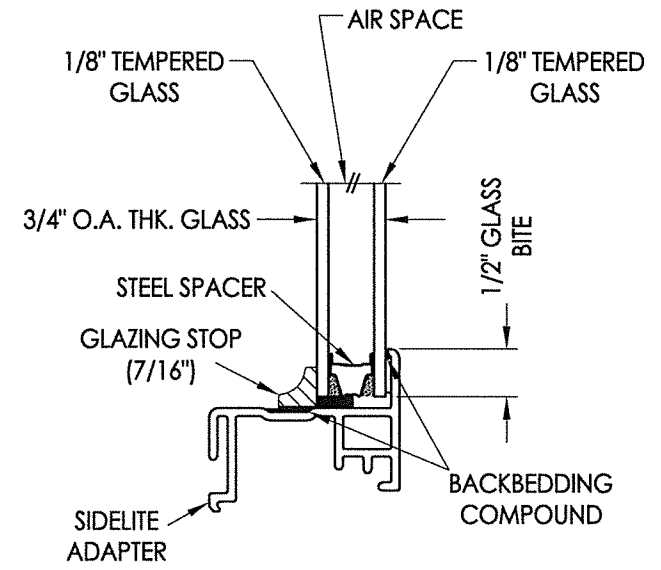

G2 **GLAZING DETAIL**
3/4" Insulated Glass

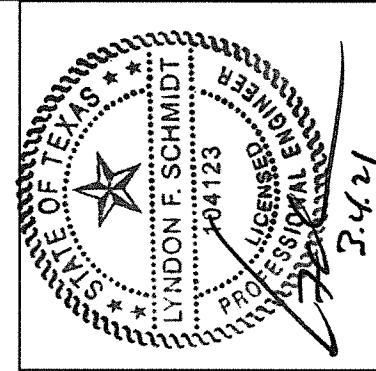

Documents Prepared By: Lyndon F. Schmidt, P.E.
TEXAS P.E. #104123

RW BUILDING CONSULTANTS, INC.
P.O. Box 230 Valrico FL 33595
Phone No.: 813.659.9197

TEXAS BOARD OF PROFESSIONAL ENGINEERS
CERTIFICATE OF REGISTRATION # F-11852

| | |
|-------------------|-------------------------------|
| PRODUCT: | Therma-TRU FIBERGLASS DOOR |
| PART OR ASSEMBLY: | SIDELITE PANEL DETAILS |

| NO. | DATE | BY | REVISIONS |
|-----|------|----|-----------|
| | | | |
| | | | |
| | | | |

| | |
|--------------|---------|
| DATE: | 1/06/21 |
| SCALE: | N.T.S. |
| DWG. BY: | RW |
| CHK. BY: | LFS |
| DRAWING NO.: | TX-5161 |
| SHEET | 3 OF 10 |

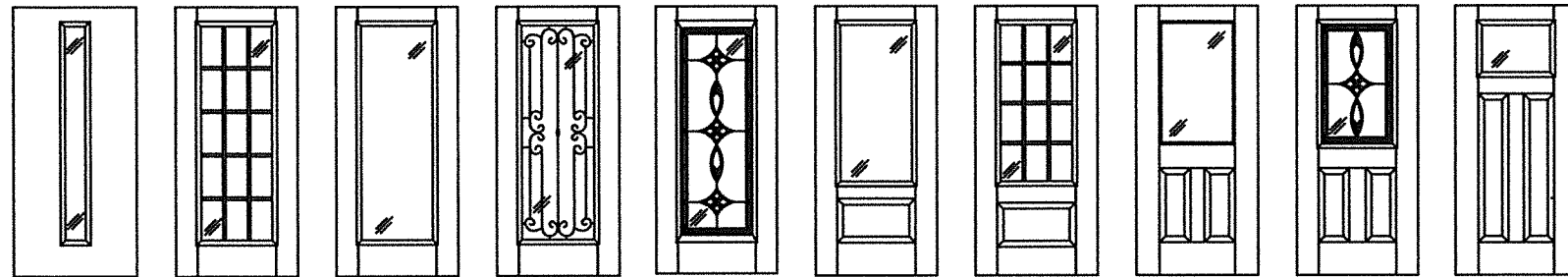

Fiber-Classic/Smooth-Star Door Panel Options
 Panel options shown are for illustration and are representative only
 (similar glazed panel configurations are allowed)

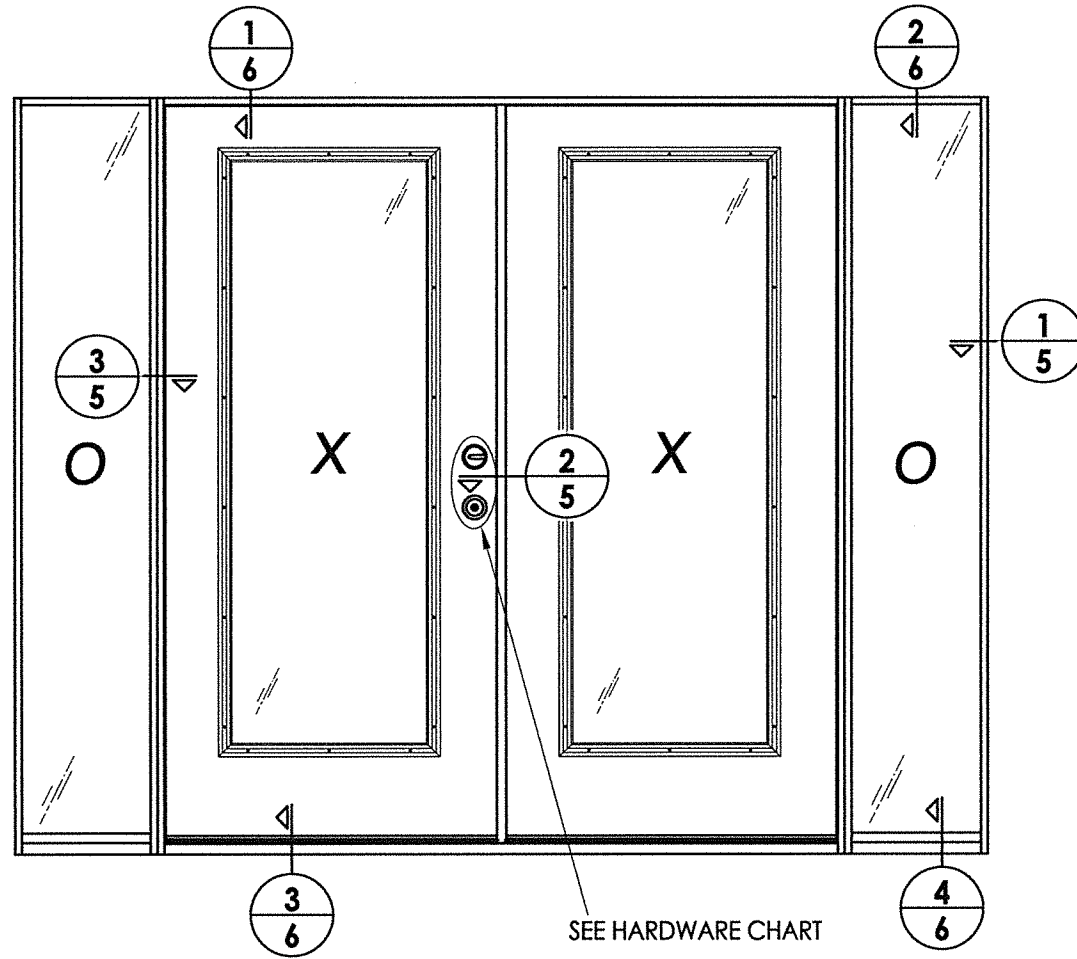

ELEVATION
 OX XO

| HARDWARE TABLE | |
|----------------|--|
| MANUFACTURER | MODEL |
| SCHLAGE | KNOB: F51 DEADBOLT: B60 |
| KWIKSET | KNOB: SIGNATURE SERIES DEADBOLT: SIGNATURE SERIES (980) |

DATE: 1/06/21
 SCALE: N.T.S.
 DWG. BY: RW
 CHK. BY: LFS
 DRAWING NO.: TX-5161
 SHEET 4 OF 10

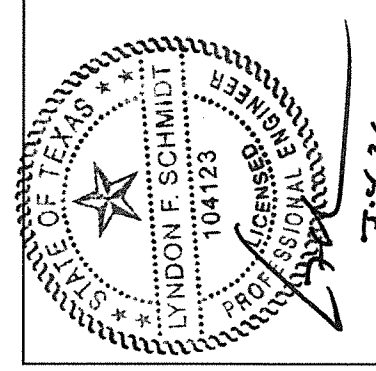

Documents Prepared By: Lyndon F. Schmidt, P.E.
 TEXAS P.E. #104123
 RW BUILDING CONSULTANTS, INC.
 P.O. Box 230 Vairico FL 33595
 Phone No.: 813.659.9197
 TEXAS BOARD OF PROFESSIONAL ENGINEERS
 CERTIFICATE OF REGISTRATION # F-11852

PRODUCT: THERMA-TRU FIBERGLASS DOOR
 PART OR ASSEMBLY: ELEVATIONS

| NO. | DATE | BY | REVISIONS |
|-----|------|----|-----------|
| | | | |
| | | | |
| | | | |
| | | | |

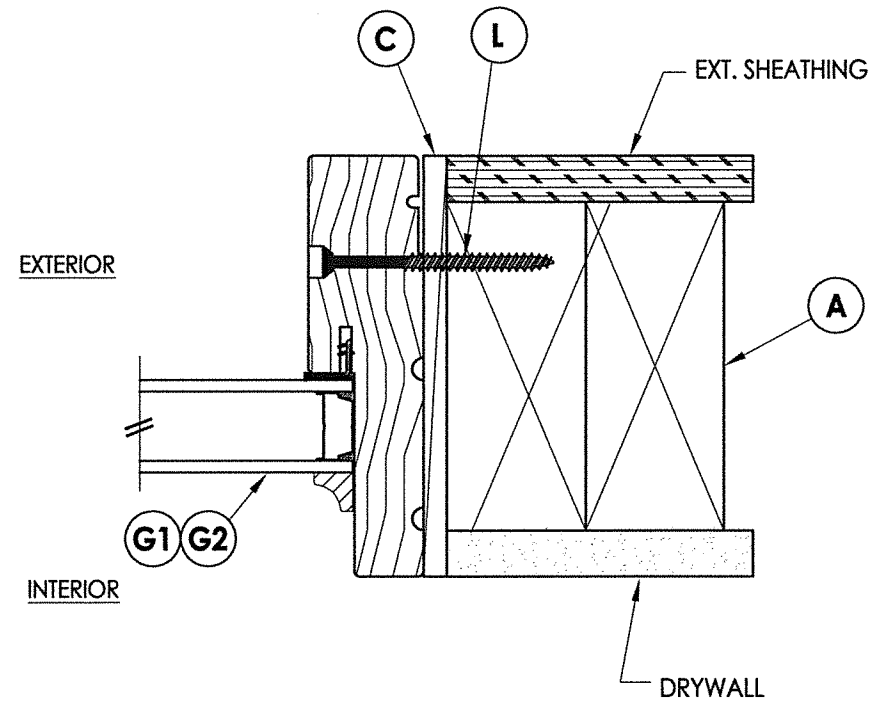

1
5 HORIZONTAL CROSS SECTION

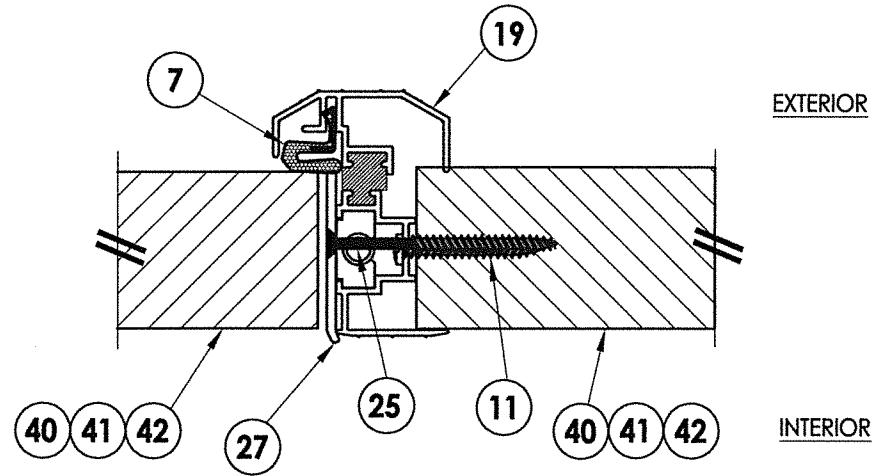

2
5 HORIZONTAL CROSS SECTION

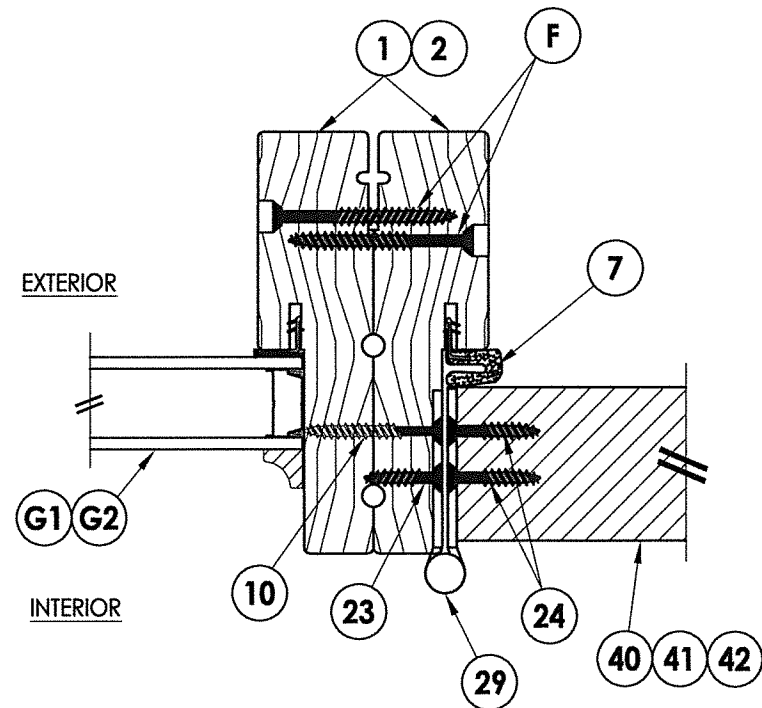

3
5 HORIZONTAL CROSS SECTION
Shown w/ Back-to-Back Jambs

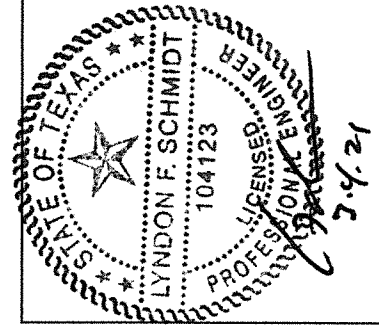

Documents Prepared By: Lyndon F. Schmidt, P.E.
TEXAS P.E. #104123

RW BUILDING CONSULTANTS, INC.
P.O. Box 230 Valrico FL, 33595
Phone No.: 813.659.9197
TEXAS BOARD OF PROFESSIONAL ENGINEERS
CERTIFICATE OF REGISTRATION # F-11852

PRODUCT: THERMA-TRU
FIBERGLASS DOOR

PART OR ASSEMBLY:
HORIZONTAL
CROSS SECTIONS

| NO. | DATE | BY | REVISIONS |
|-----|------|----|-----------|
| | | | |
| | | | |
| | | | |
| | | | |

DATE: 1/06/21

SCALE: N.T.S.

DWG. BY: RW

CHK. BY: LFS

DRAWING NO.:
TX-5161

SHEET 5 OF 10

Note:

1. Sill Item #'s 32 & 33 are attached to jambs w/ (3) #8 X 2-1/2" pfh screws at each end.

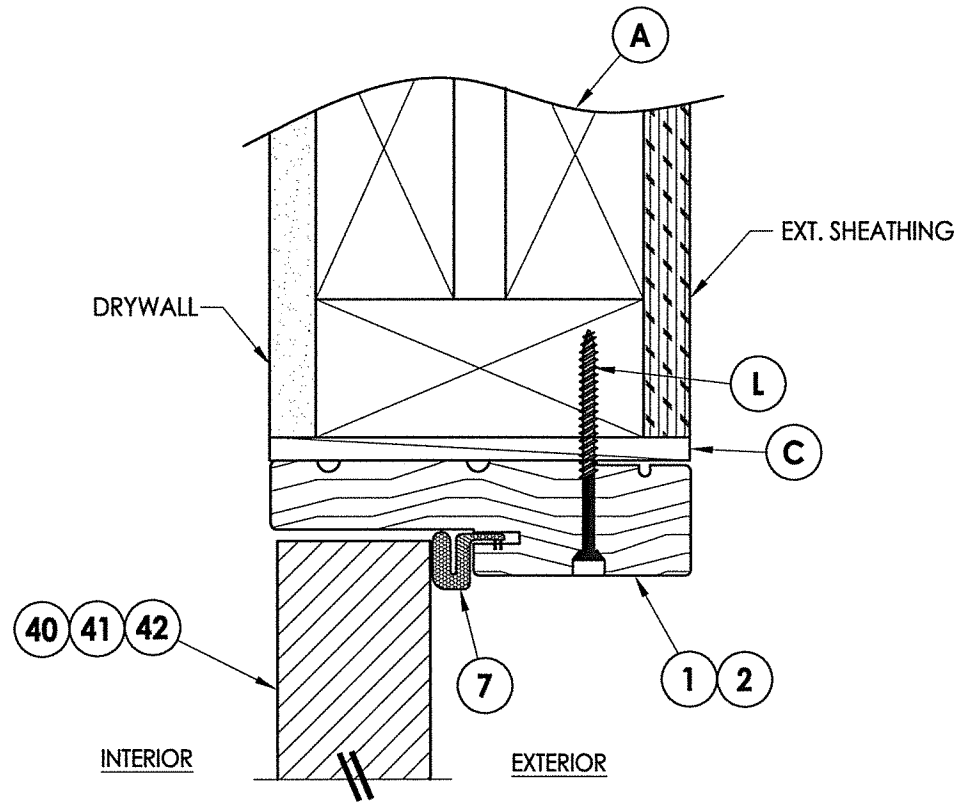

1
6 VERTICAL CROSS SECTION

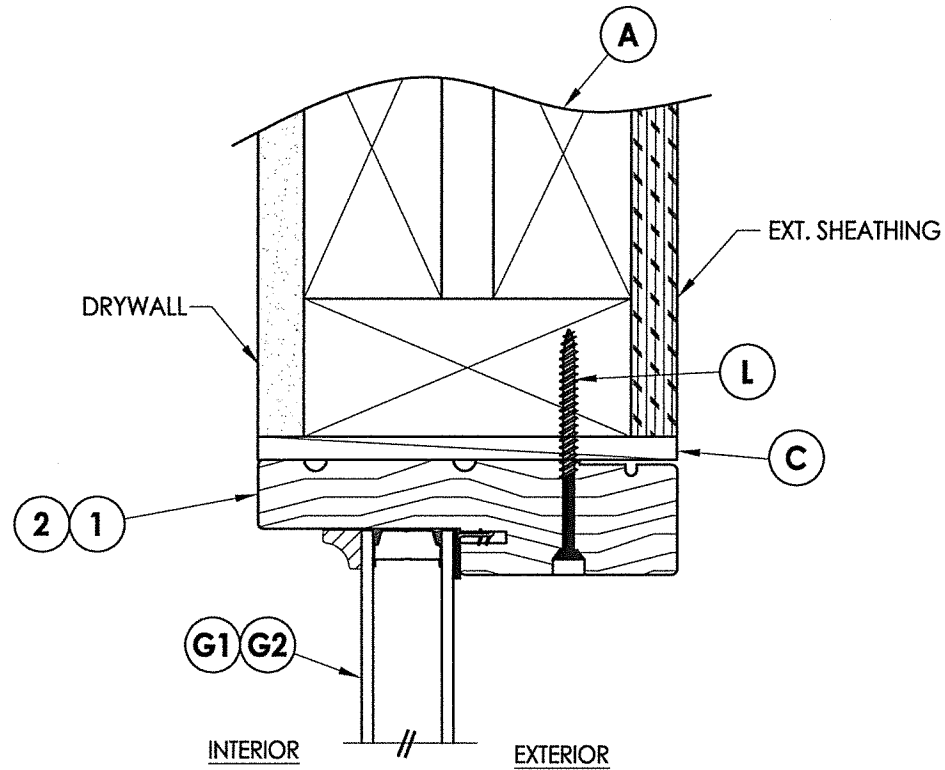

2
6 VERTICAL CROSS SECTION

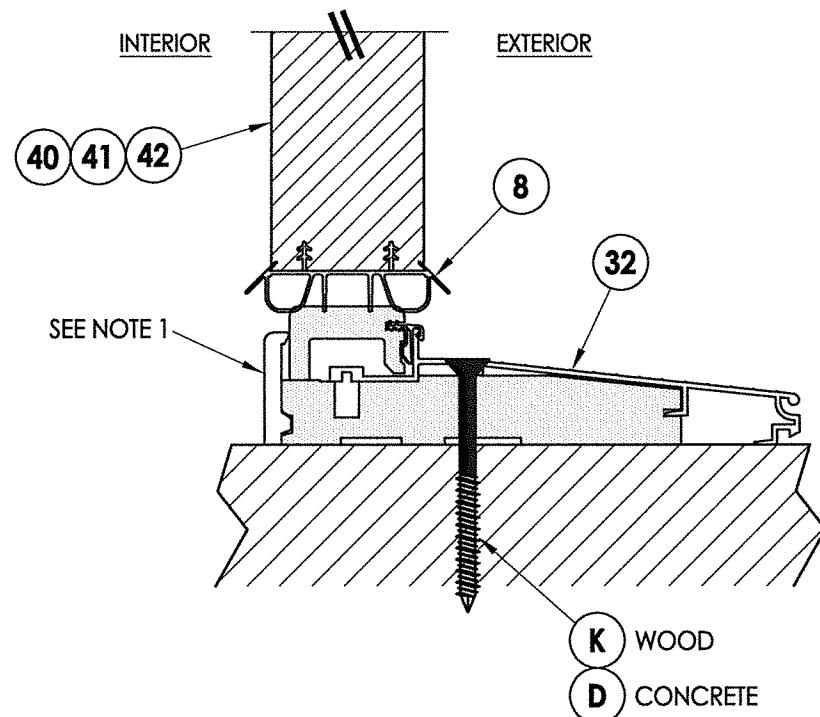

3
6 VERTICAL CROSS SECTION
Inswing Sill

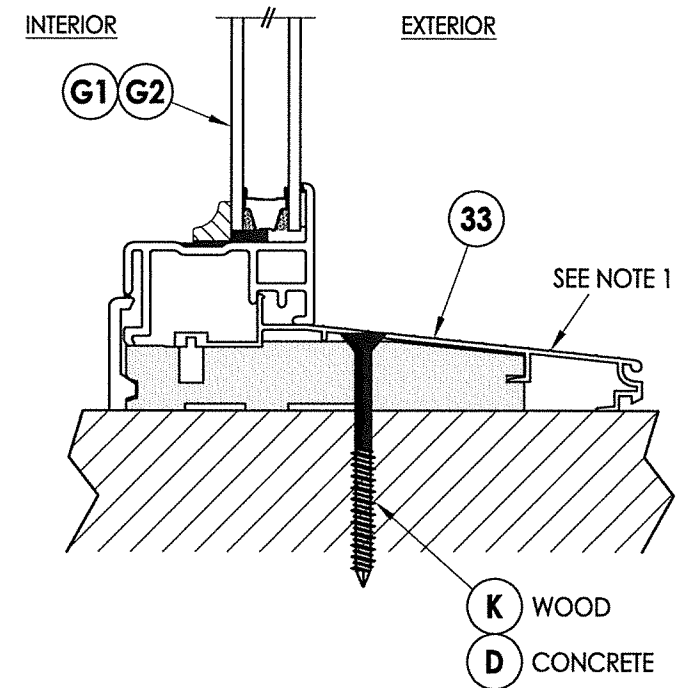

4
6 VERTICAL CROSS SECTION
Inswing Sill

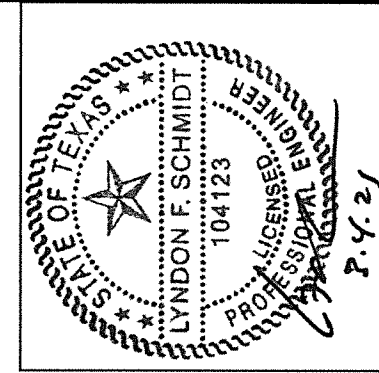

Documents Prepared By: Lyndon F. Schmidt, P.E.
TEXAS P.E. #104123

RW BUILDING CONSULTANTS, INC.
P.O. Box 230 Valrico FL 33595
Phone No.: 813.659.9197
TEXAS BOARD OF PROFESSIONAL ENGINEERS
CERTIFICATE OF REGISTRATION # F-11852

PRODUCT: THERMA-TRU
FIBERGLASS DOOR
PART OR ASSEMBLY: VERTICAL
CROSS SECTIONS

| NO. | DATE | BY |
|-----|------|----|
| | | |
| | | |
| | | |
| | | |

DATE: 1/06/21
SCALE: N.T.S.
DWG. BY: RW
CHK. BY: LFS
DRAWING NO.: TX-5161
SHEET 6 OF 10

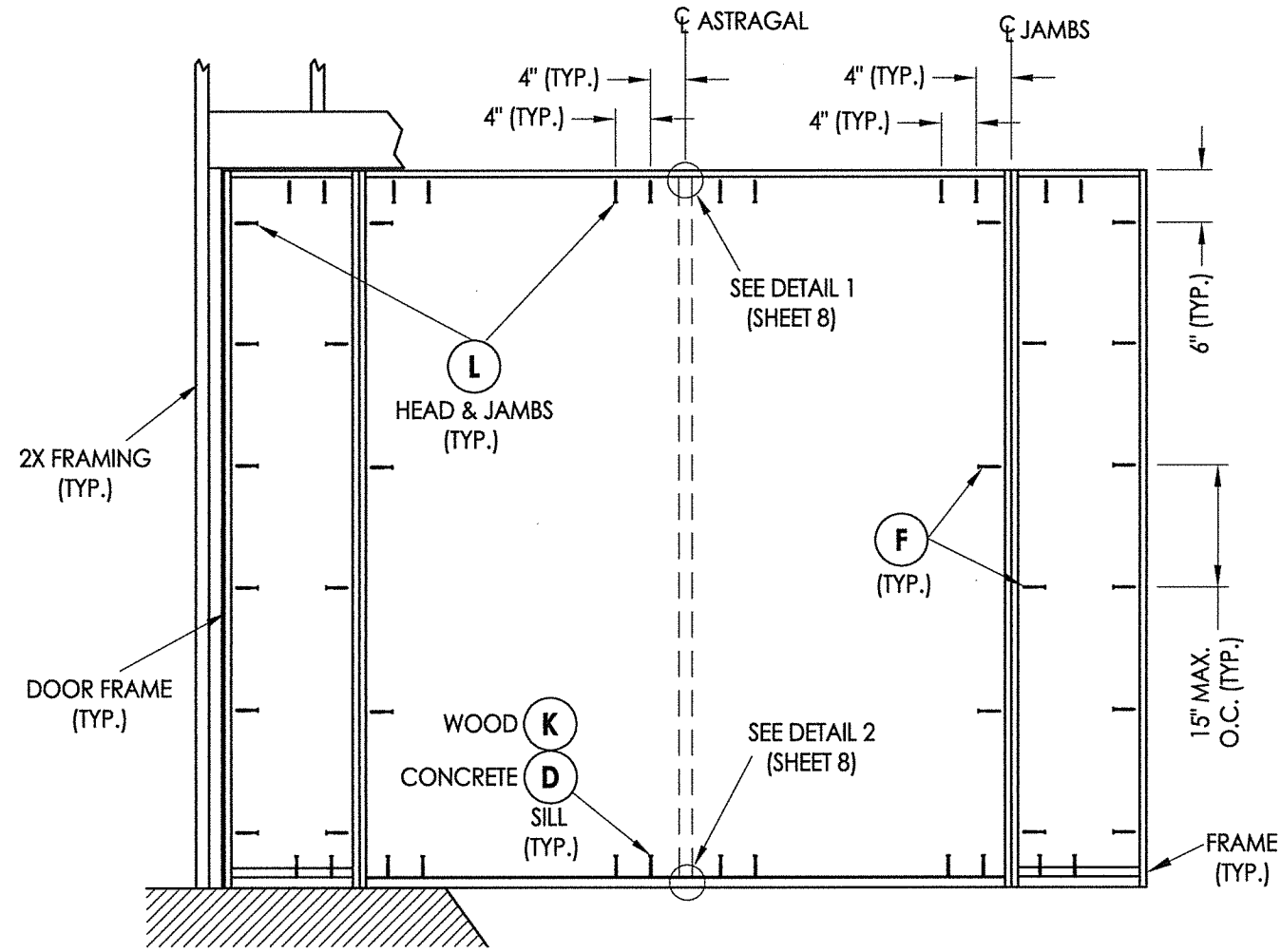

OXXO

FRAME ANCHORING

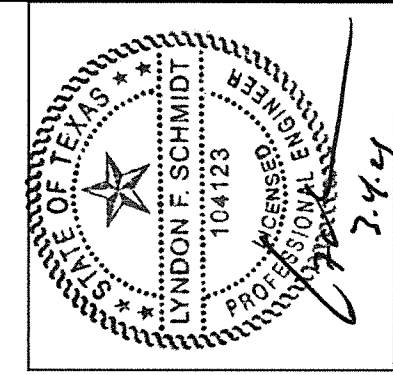
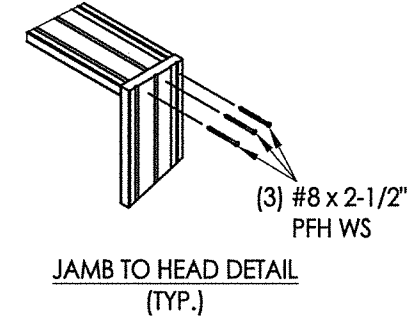

Documents Prepared By: Lyndon F. Schmidt, P.E.
TEXAS P.E. #104123

RW BUILDING CONSULTANTS, INC.
P.O. Box 230 Valrico FL 33595
Phone No.: 813.659.9197

TEXAS BOARD OF PROFESSIONAL ENGINEERS
CERTIFICATE OF REGISTRATION # F-11852

PRODUCT: THERMA-TRU FIBERGLASS DOOR

PART OR ASSEMBLY: FRAME ANCHORING

| NO. | DATE | BY |
|-----|------|----|
| | | |
| | | |
| | | |
| | | |
| | | |

DATE: 1/06/21

SCALE: N.T.S.

DWG. BY: RW

CHK. BY: LFS

DRAWING NO.: TX-5161

SHEET 7 OF 10

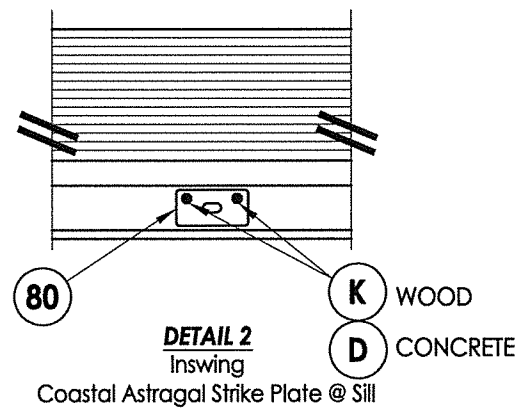
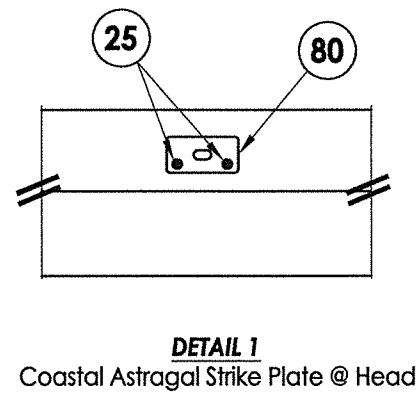
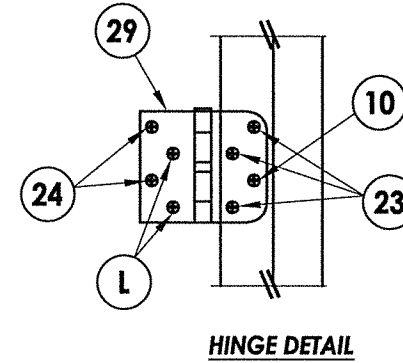
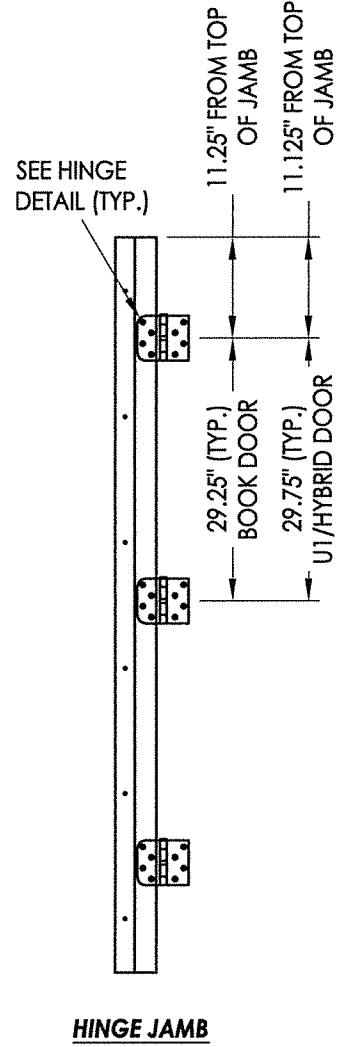
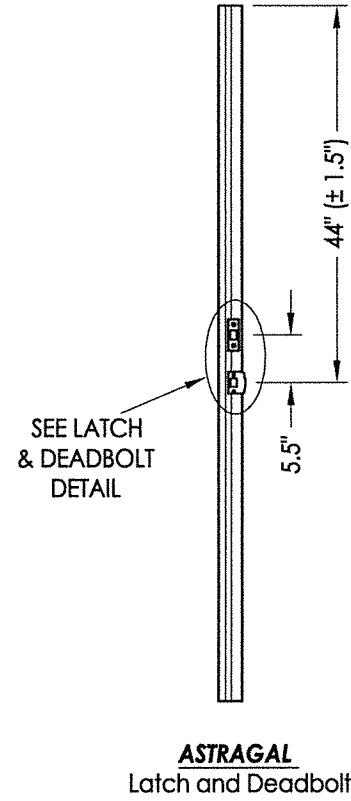
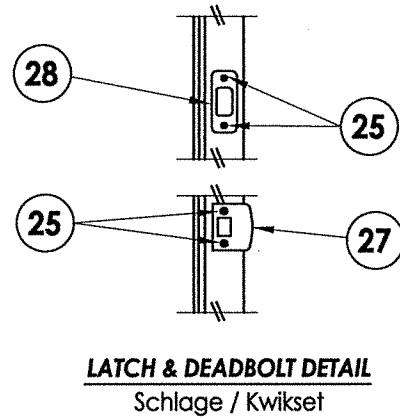

LATCH & DEADBOLT STRIKE DETAILS

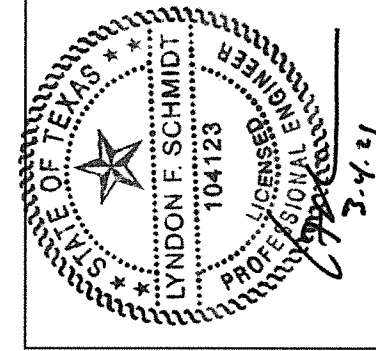

Documents Prepared By: Lyndon F. Schmidt, P.E.
TEXAS P.E. #104123

RW BUILDING CONSULTANTS, INC.
P.O. Box 230 Valrico FL 33595
Phone No.: 813.659.9197

TEXAS BOARD OF PROFESSIONAL ENGINEERS
CERTIFICATE OF REGISTRATION # F-11852

| | |
|-------------------|-------------------------------|
| PRODUCT: | Therma-TRU FIBERGLASS DOOR |
| PART OR ASSEMBLY: | HARDWARE DETAILS |

| NO. | DATE | BY | REVISIONS |
|-----|------|----|-----------|
| | | | |
| | | | |
| | | | |

| | |
|--------------|---------|
| DATE: | 1/06/21 |
| SCALE: | N.T.S. |
| DWG. BY: | RW |
| CHK. BY: | LFS |
| DRAWING NO.: | TX-5161 |
| SHEET | 8 of 10 |

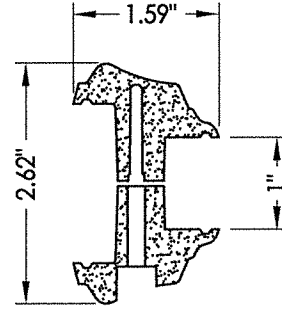
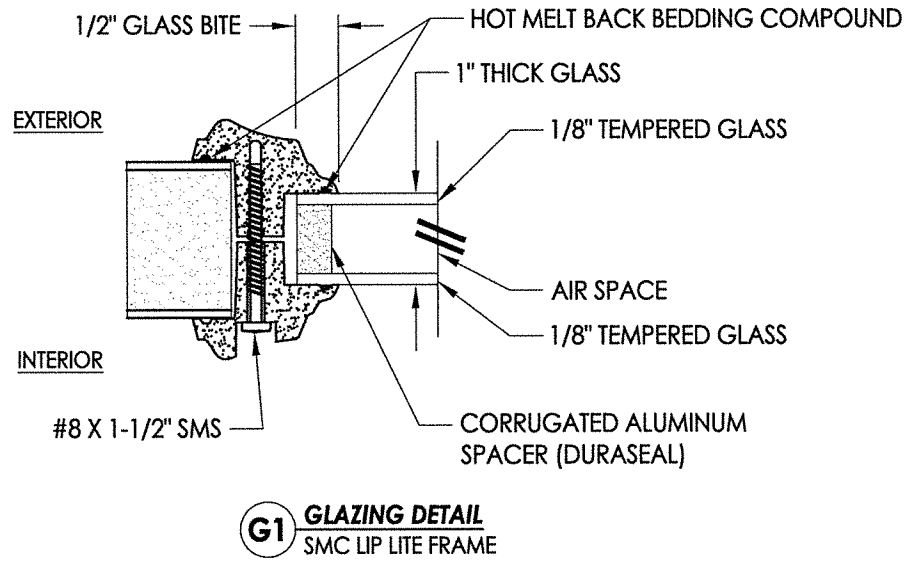

SMC FULL LITE FRAME

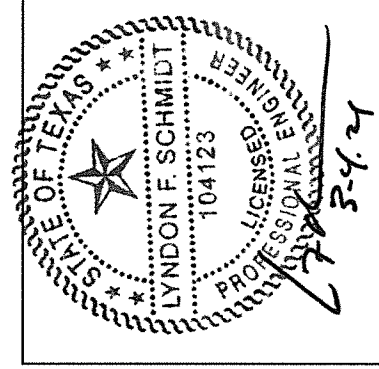
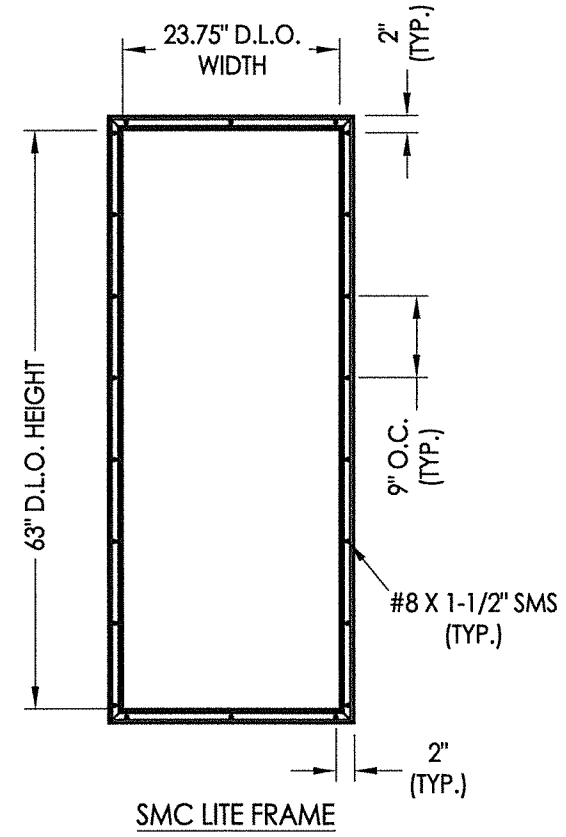

Documents Prepared By: Lyndon F. Schmidt, P.E.
TEXAS P.E. #104123

RW BUILDING CONSULTANTS, INC.
P.O. Box 230 Vairico FL 33595
Phone No.: 813.659.9197

TEXAS BOARD OF PROFESSIONAL ENGINEERS
CERTIFICATE OF REGISTRATION # F-11852

PRODUCT: THERMA-TRU
FIBERGLASS DOOR

PART OR ASSEMBLY:
GLAZING DETAILS

| NO. | DATE | BY | REVISIONS |
|-----|------|----|-----------|
| | | | |
| | | | |
| | | | |
| | | | |
| | | | |
| | | | |
| | | | |
| | | | |

DATE: 1/06/21
SCALE: N.T.S.
DWG. BY: RW
CHK. BY: LFS
DRAWING NO.: TX-5161
SHEET 9 OF 10

Z:\Clients\Therma Tru PERMANENT\B - Texas Dept of Ins\TDI - DR XXX - 6'8, 7' & 8' CC Glazed FG NonImp IS Dir Set Sidelites (TX 5152-5157)\C - Drawings\TX-5160-61.dwg

| BILL OF MATERIALS | | |
|-------------------|--|-----------|
| ITEM # | DESCRIPTION | MATERIAL |
| B | 2X BUCK (G >= 0.42) | WOOD |
| C | 1/4" MAX. SHIM SPACE | - |
| D | 1/4" PFH DeWALT OR ITW CONCRETE SCREW | STEEL |
| F | #10 X 2" PFH WOOD SCREW | STEEL |
| L | #10 X 2-1/2" PFH WOOD SCREW (1.15" MIN. EMBEDMENT) | STEEL |
| 1 | WOOD JAMB (FINGER JOINT PINE) | WOOD |
| 2 | COMPOSITE JAMB | COMP |
| 7 | WEATHERSTRIP | FOAM |
| 8 | DOOR SWEEP | VINYL |
| 10 | #10 X 1-1/2" PFH WOOD SCREW | STEEL |
| 19 | STANDARD ALUMINUM ASTRAGAL | ALUM |
| 22 | #8 X 3/4" PFH WOOD SCREW | STEEL |
| 23 | #9 X 3/4" PFH WOOD SCREW | STEEL |
| 24 | #9 X 1" PFH WOOD SCREW | STEEL |
| 25 | #8 X 1-1/2" PFH WOOD SCREW | STEEL |
| 26 | #8 X 5/8" PFH WOOD SCREW | STEEL |
| 27 | LATCH STRIKE PLATE | STEEL |
| 28 | DEADBOLT STRIKE PLATE | STEEL |
| 28A | DEADBOLT SUB STRIKE PLATE | STEEL |
| 29 | 4" X 4" HINGE | STEEL |
| 32 | INSWING THRESHOLD | ALUM/COMP |
| 33 | INSWING THRESHOLD w/ SIDELITE ADAPTER | ALUM/COMP |
| 40 | DOOR PANEL (BOOK) | - |
| 41 | DOOR PANEL (HYBRID) | - |
| 42 | DOOR PANEL (U1) | - |
| 50 | SIDELITE PANEL | - |
| 80 | ASTRAGAL STRIKE PLATE | STEEL |

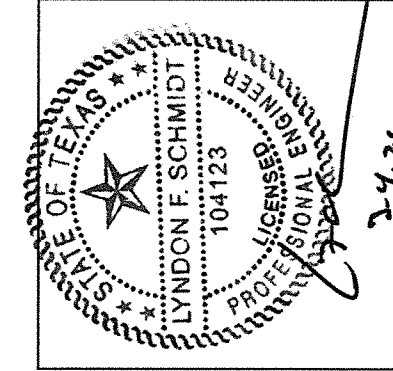
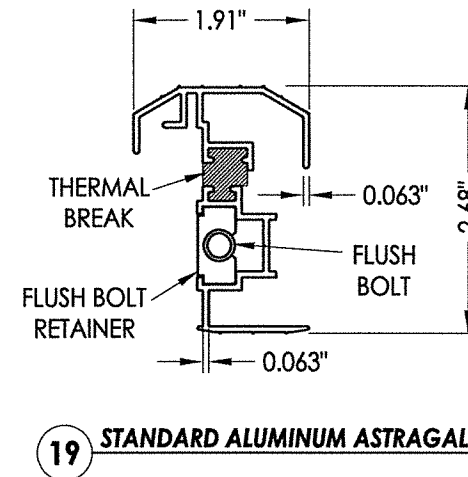
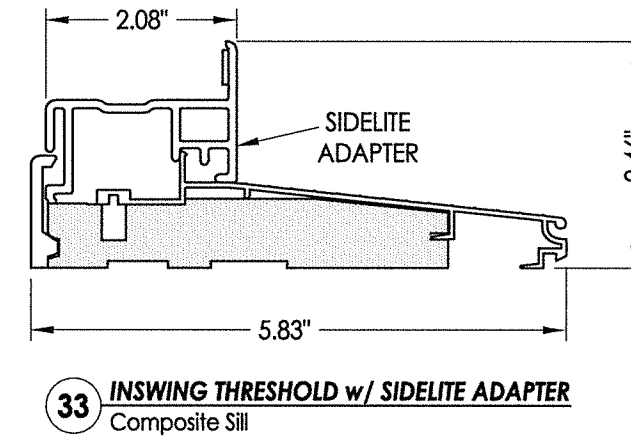
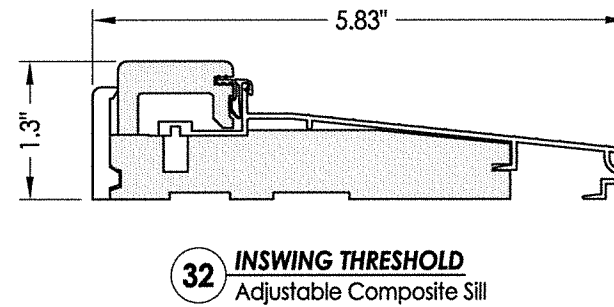
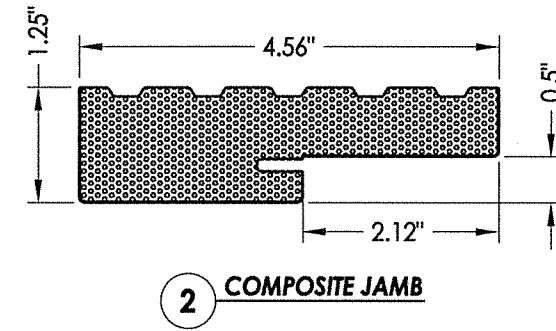
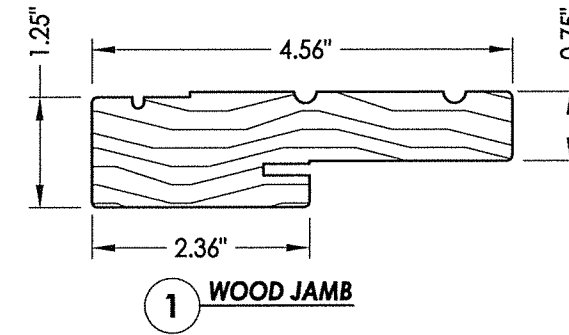

Documents Prepared By: Lyndon F. Schmidt, P.E.
TEXAS P.E. #104123

RW BUILDING CONSULTANTS, INC.
P.O. Box 230 Valrico FL, 33595
Phone No.: 813.659.9197

TEXAS BOARD OF PROFESSIONAL ENGINEERS
CERTIFICATE OF REGISTRATION # F-11852

PRODUCT: THERMA-TRU FIBERGLASS DOOR
PART OR ASSEMBLY: BILL OF MATERIALS & COMPONENTS

| NO. | DATE | BY | REVISIONS |
|-----|------|----|-----------|
| | | | |
| | | | |
| | | | |

DATE: 1/06/21
SCALE: N.T.S.
DWG. BY: RW
CHK. BY: LFS
DRAWING NO.: TX-5161
SHEET 10 OF 10

CONCRETE ANCHOR NOTES:

- Concrete anchor locations at the corners may be adjusted to maintain the min. edge distance to mortar joints.
- Concrete anchor locations noted as "MAX. ON CENTER" must be adjusted to maintain the min. edge distance to mortar joints, additional concrete anchors may be required to ensure the "MAX. ON CENTER" dimension are not exceeded.
- Concrete anchor table:

| ANCHOR TYPE | ANCHOR SIZE | MIN. EMBEDMENT | MIN. CLEARANCE TO MASONRY EDGE | MIN. CLEARANCE TO ADJACENT ANCHOR |
|------------------|-------------|----------------|--------------------------------|-----------------------------------|
| ITW TAPCON® | 1/4" | 1-3/4" | 2" | 4" |
| DeWALT ULTRACON® | 1/4" | 1-3/4" | 1" | 4" |

WOOD SCREW INSTALLATION NOTES:

- Maintain a minimum 5/8" edge distance, 1" end distance, & 1" o.c. spacing of wood screws to prevent the splitting of wood.