

# SLIDING GLASS DOOR - IMPACT

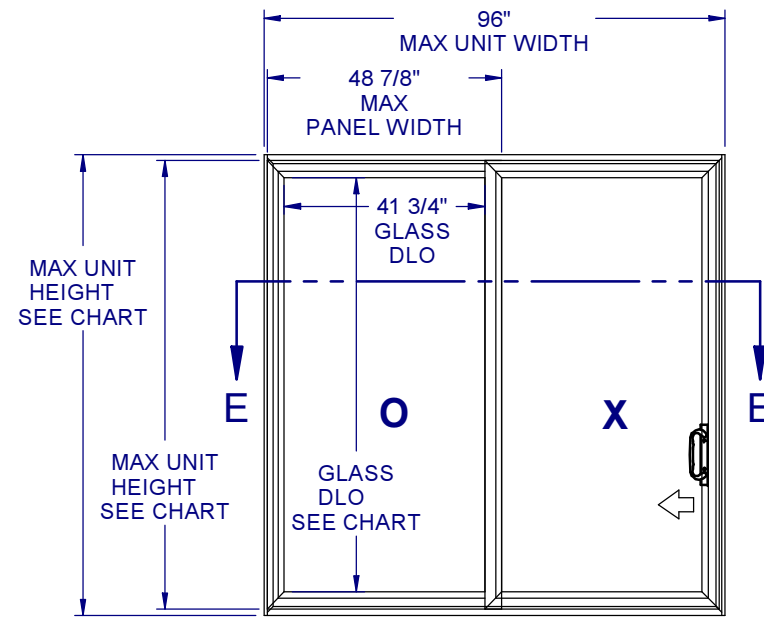
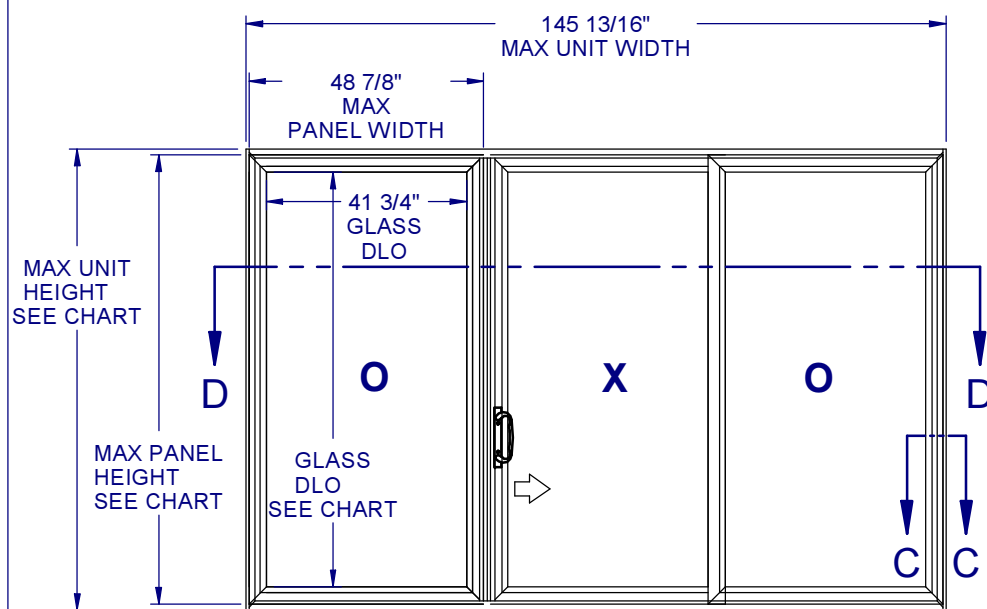
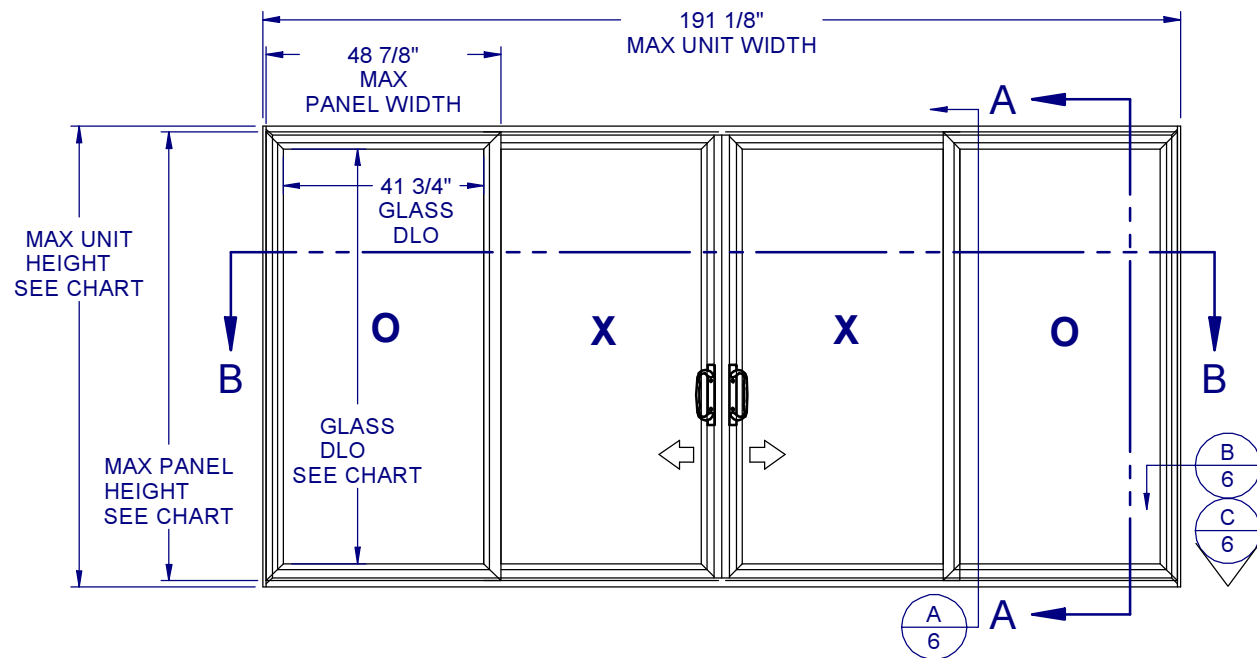

## GENERAL NOTES:

1. THE PRODUCT SHOWN HEREIN IS DESIGNED AND MANUFACTURED TO COMPLY WITH THE REQUIREMENTS OF THE 2018 INTERNATIONAL BUILDING CODE AND INTERNATIONAL RESIDENTIAL CODE.
2. GLAZING DETAIL: (SEE SHEET 2)
3. APPROVED CONFIGURATIONS: "OXXO", "OXO", "XO", "OX"
4. ANCHORAGE: THE 33 1/3% STRESS INCREASE HAS NOT BEEN USED IN THE DESIGN OF THIS PRODUCT. SEE SHEET 6 FOR INSTALLATION DETAIL WIND LOAD DURATION FACTOR Cd=1.6 WAS USED FOR WOOD ANCHOR CALCULATIONS.
5. PRODUCTS APPROVED FOR IMPACT RESISTANCE. SHUTTERS ARE NOT REQUIRED.
6. ALL FRAMES ARE PROCESSED AND SCREWED TOGETHER. VENTS FULLY WELDED.
7. SERIES / MODEL DESIGNATION: SGD-8900.
8. THE DESIGNATION X AND O STAND FOR THE FOLLOWING:  
X=OPERABLE SASH, O=FIXED SASH.
9. SECTION CALLOUTS APPLY TO ALL CONFIGURATIONS.
10. EXTERNAL WEEP SLOT = 1/4 x 1" LOCATED 4" FROM BOTH ENDS.

**Custom**  
WINDOW SYSTEMS

1900 SW 44TH AVE.  
OCALA, FLORIDA 34474  
WWW.CWS.CC

## 8900 PVC SLIDING GLASS DOOR - IMPACT

PROPRIETARY AND CONFIDENTIAL

THE INFORMATION CONTAINED IN THIS DRAWING IS THE SOLE PROPERTY OF CUSTOM WINDOW SYSTEMS, INC. ANY REPRODUCTION IN PART OR AS A WHOLE WITHOUT THE WRITTEN PERMISSION OF CUSTOM WINDOW SYSTEMS, INC IS PROHIBITED.



3/16/2020

LUCAS A. TURNER, P.E.  
TX PE #115094  
TBPE REG. #FL-18075  
2428 OLD NATCHEZ TRC TRL  
CAMDEN, TN 38320  
PH. 941-380-1574

SHEET DESCRIPTION:  
GENERAL NOTES AND ELEVATIONS

DRAWN BY:	DATE:
ADE	06/03/08
DWG #:	REV.:
TDI-298	-
SCALE:	SHEET
1:33.33	1 OF 6

### TABLE OF CONTENTS

GENERAL NOTES & ELEVATIONS.....	1
SECTION VIEWS OXXO & GLAZING DETAIL.....	2
SECTION VIEWS OXO & XO.....	3
EXTRUSIONS & B.O.M.....	4
ANCHOR SCHEDULE & NOTES.....	5
INSTALLATION DETAILS.....	6

CONFIG.	MAX. UNIT SIZE	MAX. PANEL SIZE	DESIGN PRESSURE RATING	GLAZING TYPE (Sht.2)	IMPACT RATING
XO	96" x 96"	48-7/8" x 93-1/2" DLO 41-3/4" x 86-3/8"	+/-60 PSF	A	LARGE MISSILE IMPACT
OXO	145-13/16" x 96"			A	
OXXO	191-1/8" x 96"			A	
XO	96" x 80"	48-7/8" x 77-1/2" DLO 41-3/4" x 70-1/4"	+/-60 PSF	B	LARGE MISSILE IMPACT
OXO	145-13/16" x 80"			B	
OXXO	191-1/8" x 80"			B	

**8900 PVC  
SLIDING GLASS  
DOOR - IMPACT**

PROPRIETARY AND CONFIDENTIAL  
THE INFORMATION CONTAINED IN  
THIS DRAWING IS THE SOLE  
PROPERTY OF CUSTOM WINDOW  
SYSTEMS, INC. ANY  
REPRODUCTION IN PART OR AS A  
WHOLE WITHOUT THE WRITTEN  
PERMISSION OF CUSTOM WINDOW  
SYSTEMS, INC IS PROHIBITED.



3/16/2020

LUCAS A. TURNER, P.E.  
TX PE #115094  
TBPE REG. #FL-18075  
2428 OLD NATCHEZ TRC TRL  
CAMDEN, TN 38320  
PH. 941-380-1574

SHEET DESCRIPTION:  
**SECTION VIEWS - OXO  
AND GLAZING DETAIL**

DRAWN BY: ADE	DATE: 06/03/08
DWG #: TDI-298	REV.: -
SCALE: 1:2.63	SHEET 2 OF 6

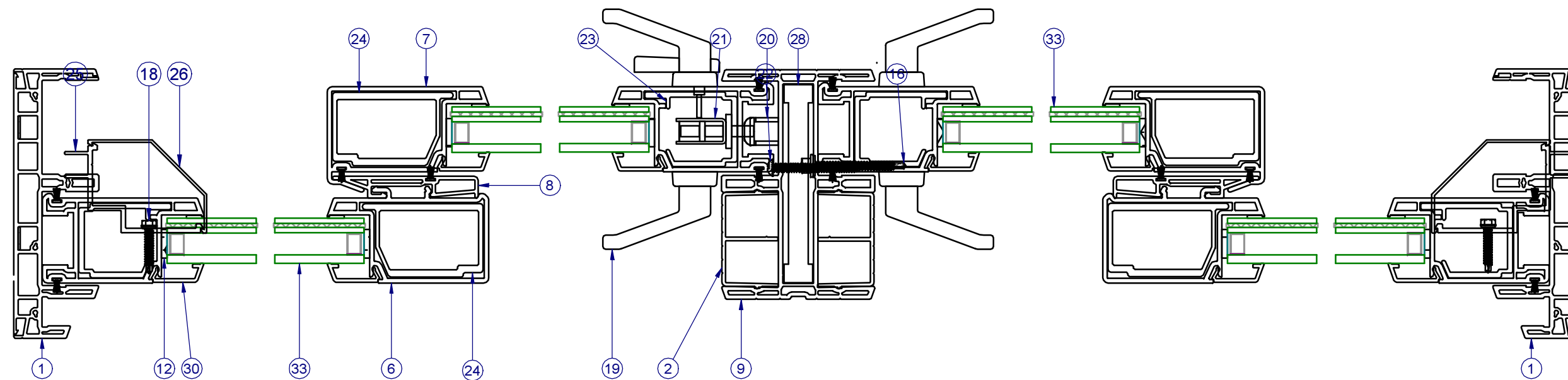

SECTION B-B

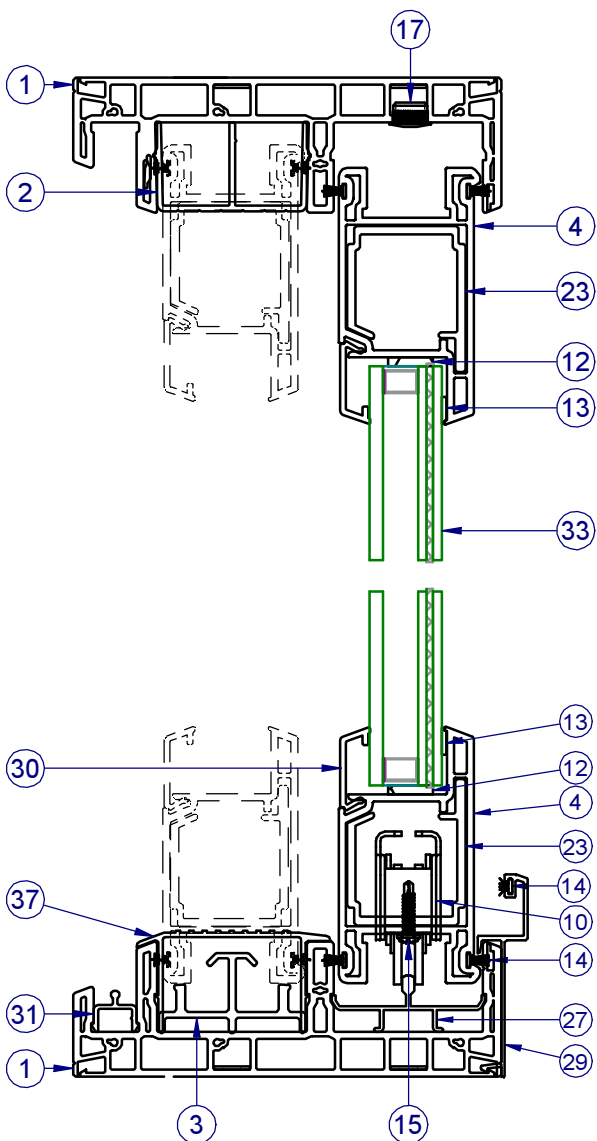

PAIR OF ANCHORS AT EACH CLIP.  
SEE SHT 6 FOR SPACING

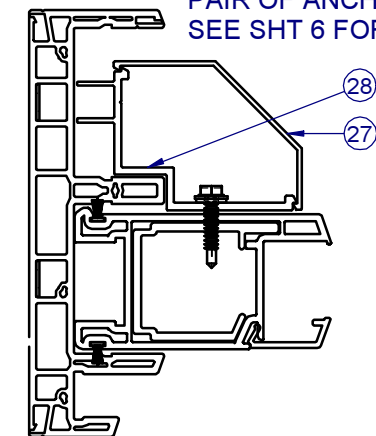

SECTION C-C  
FIXED PANEL ATTACHMENT

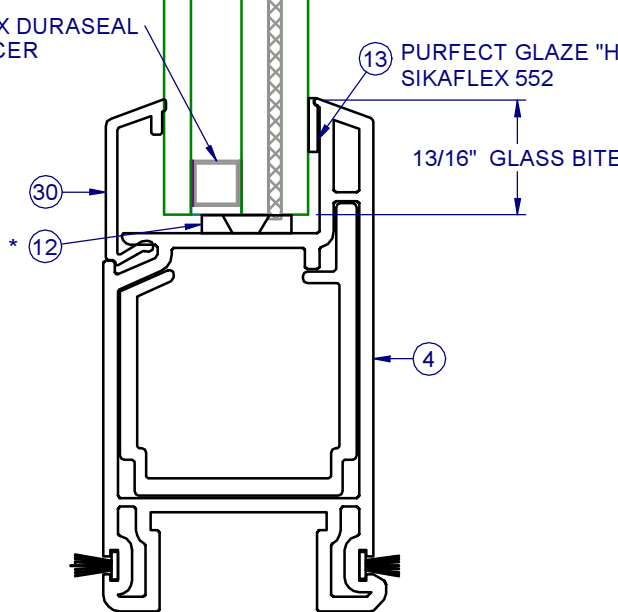
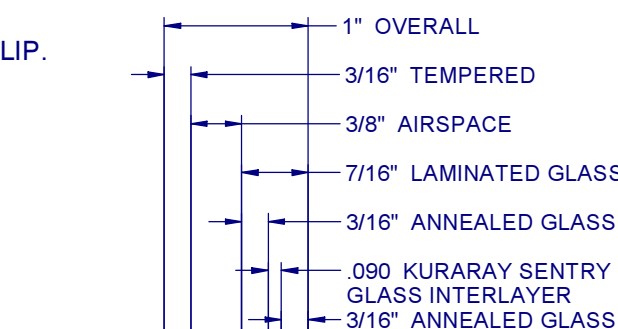

1:1.33

**GLASS TYPE A**

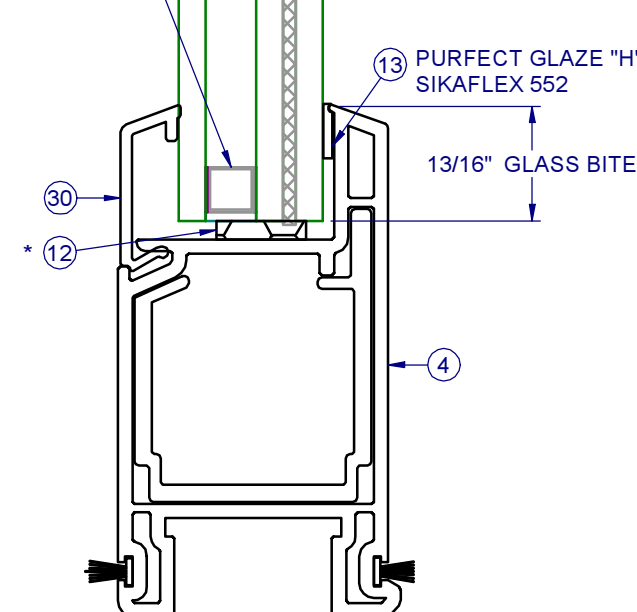
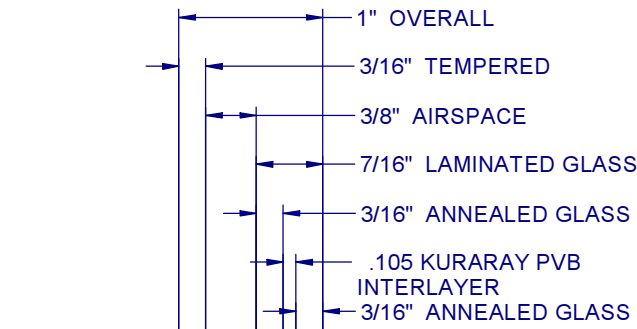

1:1.33

**GLASS TYPE B**

NOTE:  
INSTALLATION WITH NO SILL RISER ALLOWED ONLY WHERE  
WATER INFILTRATION RESISTANCE IS NOT REQUIRED.

\* SETTING BLOCKS PER FBC 2411.3.3.1

**8900 PVC  
SLIDING GLASS  
DOOR - IMPACT**

PROPRIETARY AND CONFIDENTIAL  
THE INFORMATION CONTAINED IN  
THIS DRAWING IS THE SOLE  
PROPERTY OF CUSTOM WINDOW  
SYSTEMS, INC. ANY  
REPRODUCTION IN PART OR AS A  
WHOLE WITHOUT THE WRITTEN  
PERMISSION OF CUSTOM WINDOW  
SYSTEMS, INC IS PROHIBITED.

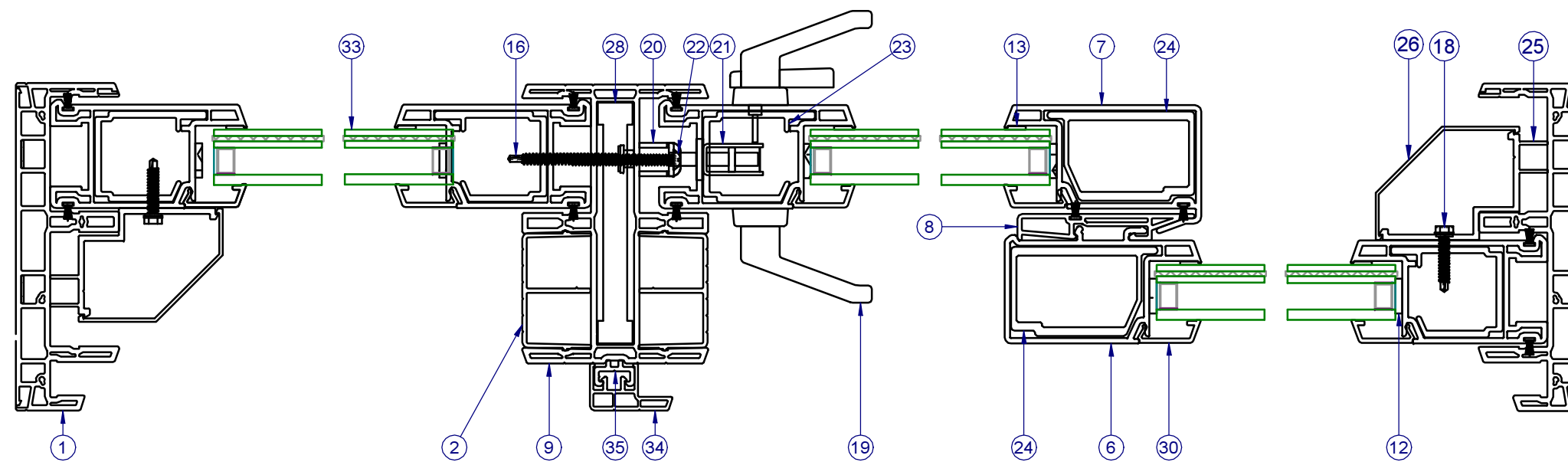

SECTION D-D

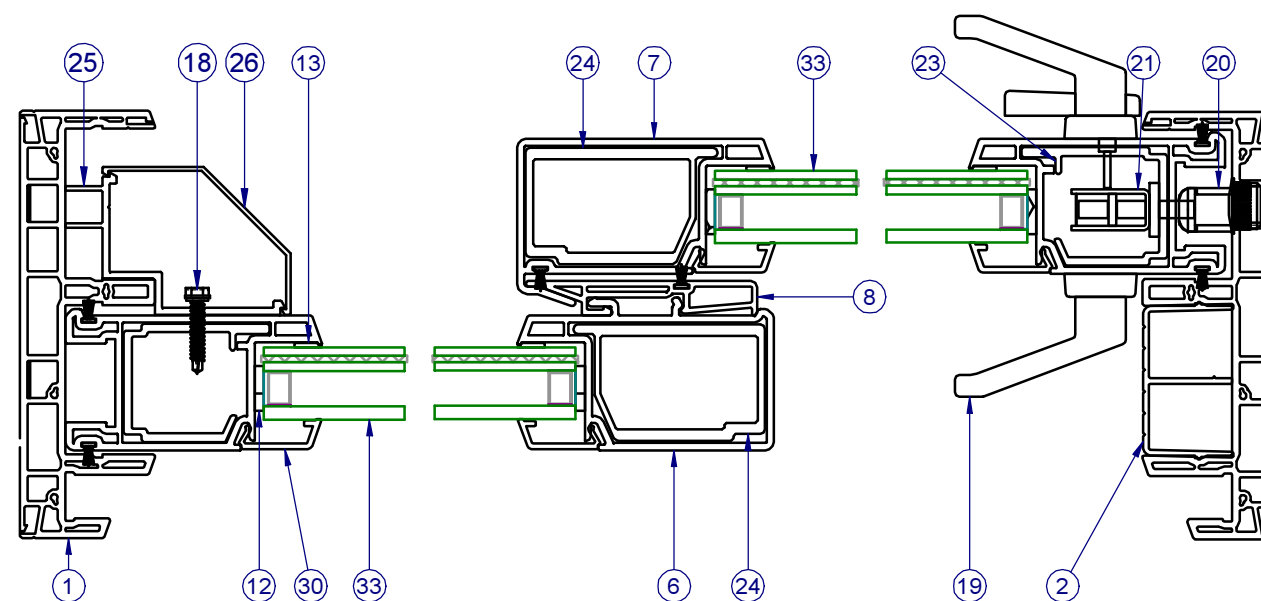

SECTION E-E

NOTES;  
1. ITEMS NOT SHOWN FOR CLARITY: 10, 26-32  
2. VERTICAL SECTION CAN BE SEEN ON SHEET 2.



3/16/2020

LUCAS A. TURNER, P.E.  
TX PE #115094  
TBPE REG. #FL-18075  
2428 OLD NATCHEZ TRC TRL  
CAMDEN, TN 38320  
PH. 941-380-1574

SHEET DESCRIPTION:

SECTION VIEWS - OXO  
AND XO/OX

DRAWN BY: ADE	DATE: 06/03/08
DWG #: TDI-298	REV.: -
SCALE: 1:2.63	SHEET 3 OF 6



PARTS LIST				
ITEM	PART NO.	DESCRIPTION	VENDOR	MATERIAL
1	H-6042	FRAME, MAIN, SGD	MIKRON	PVC
2	S-6040	THRESHOLD/FILLER, SGD	MIKRON	PVC
3	S-1722	SUPPORT BLOCK, FIXED, SGD	KEYMARK	ALUM
4	H-6059	PANEL TOP/BOTTOM RAIL, SGD	MIKRON	PVC
5	H-6059	PANEL SIDE RAIL, SGD	MIKRON	PVC
6	H-6033	PANEL, INTERLOCK, FIXED	MIKRON	PVC
7	H-6060	PANEL, INTERLOCK, OPERABLE	MIKRON	PVC
8	H-6061	INTERLOCK, SNAP-ON	MIKRON	PVC
9	H-6043	ASTRAGAL, SGD,	MIKRON	PVC
10	P-3142	ROLLER, TANDEM	SULLIVAN	STEEL
11	P-3342	SEAM SEALER, SM-5504	SCHNEE	
12	P-3039	SET. BLOCK, 85 DUR. 1/8" X 7/8" X 2"	FRANK LOWE	RUBBER
13	P-3438	SIKAFLEX 552 OR PURFECT GLAZE "H"	SIKA/HENKEL	
14	P-3429	WSTP., 0.270 X .187, BACK FINSEAL	ULTRAFAB	
15	P-3539	#8 X 3/4" QUAD PHILIPS, TEK	FASTENAL	ZINC
16	P-3557	#10 x 2, HEXHEAD, TEK	FASTENAL	ZINC
17	P-3752	CAP PLUG, 1/2" HOLE	M&M	NYLON
18	P-3767	#10 X 1" HEX WASHER HEAD, TEK	FASTENAL	ZINC
19	P-3789	LOCK & HANDLE KIT, PVC, SGD	AMESBURY	STEEL
20	P-3792	3/4" KEEPER	AMESBURY	SS
21	P-3793	MORTISE LOCK	HS&D	SS
22	P-4136	#10 x 2, PAN HEAD PHIL, SMS	FASTENAL	STEEL
23	S-1775	REINFORCEMENT, ALUM., PANEL	KEYMARK	ALUM
24	H-1993	REINFORCEMENT, ALUM., PANEL	KEYMARK	ALUM
25	P-4295	FIXED PANEL CLIP	KEYMARK	ALUM
26	S-1597	COVER, FIXED PANEL CLIP	KEYMARK	ALUM
27	S-1930	PANEL TRACK, ALUMINUM, SGD, SILL	KEYMARK	ALUM
28	S-1726	REINFORCEMENT, ASTRAGAL, SGD	KEYMARK	ALUM
29	S-1737	HIGHRISE SILL, ALUMINUM	KEYMARK	ALUM
30	S-6037	GLAZING BEAD 1.00", SGD	MIKRON	PVC
31	S-6041	TRACK, SCREEN, SGD	MIKRON	PVC
32	S-6046	SUPPORT WELD, SGD	MIKRON	PVC
33		GLASS (SEE SHEET 2)		
34	H-6044	SCREEN CHANNEL	MIKRON	PVC
35	S-6045	SCREEN ADAPTOR	MIKRON	PVC
36	P-4278	WSTP., 0.2" X 1.25" DUST PLUG	ULTRAFAB	
37	S-1764	SILL THRESHOLD COVER (8900)	KEYMARK	ALUM
38	P-4366	WSTP., 1" X 7.1" X 0.7" DUST PLUG	ULTRAFAB	
39	P-3302	WSTP., 0.330" X 0.187" BACK FIN	ULTRAFAB	
40	P-4479	WEEP HOLE COVER	SULLIVAN	PVC

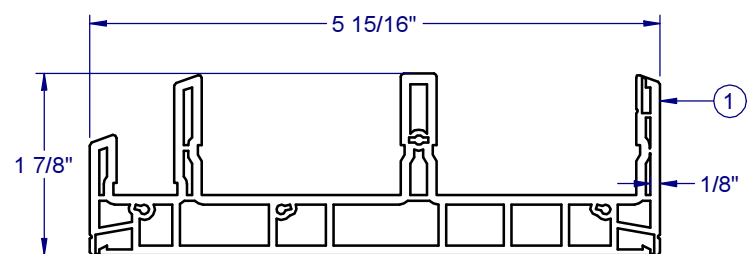

PVC OUTER FRAME - 6042

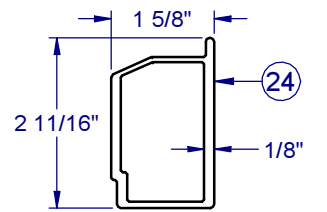

REINF. - 1993

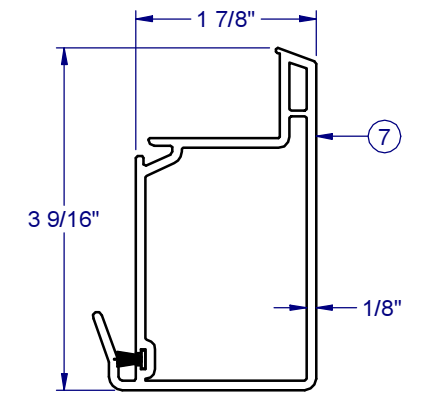

PVC PNL INTERLOCK - 6060

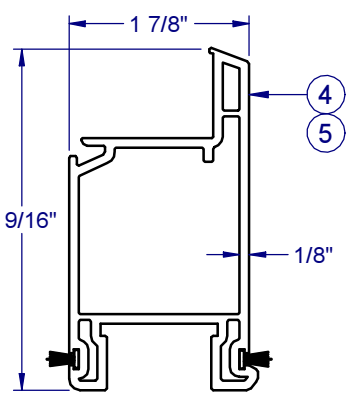

PVC PNL LOCKSTILE - 6059

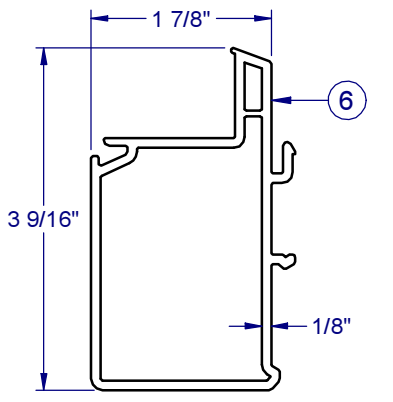

PVC PNL INTERLOCK - 6033

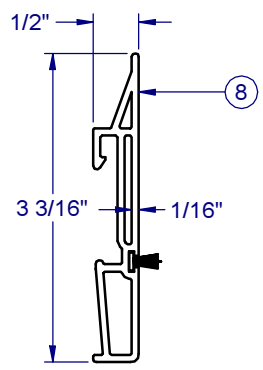

PVC INTERLOCK SNAP - 6061

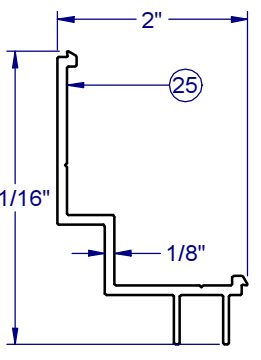

FIXED PNL CLIP - 4295

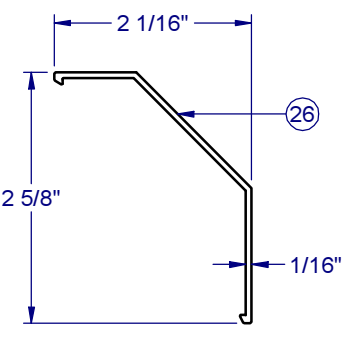

FIXED PNL COVER - 1597

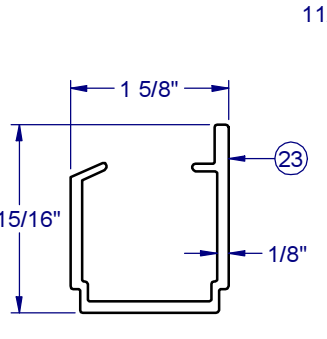

REINF. - 1775

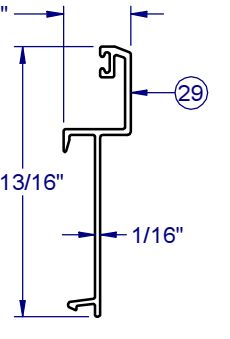

HIGHRISE - 1737

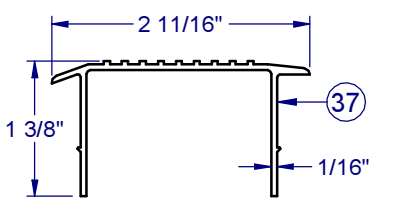

SILL THRESH COVER - 1764

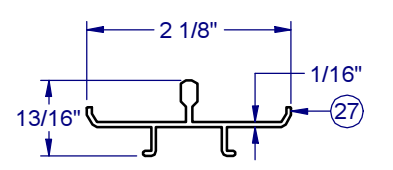

ROLLER TRACK - 1930

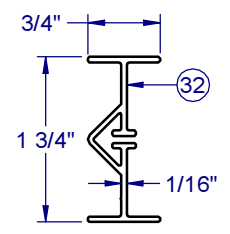

PVC WELD SUPPORT - 6046

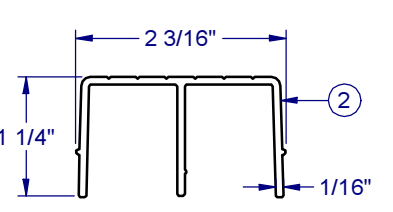
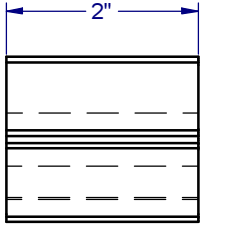

PVC TRACK FILLER - 6040

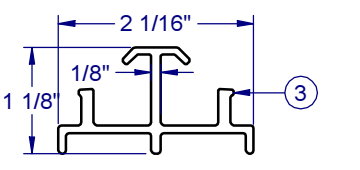

FIXED PNL SUPPORT - 1722

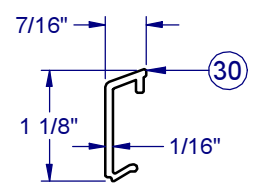

PVC GLAZING BEAD - 6037

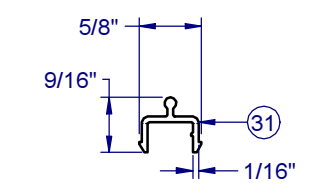

PVC SCREEN TRACK - 6041

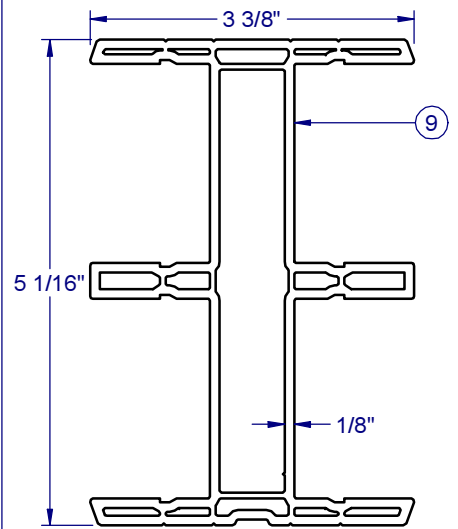

PVC ASTRAGAL - 6043

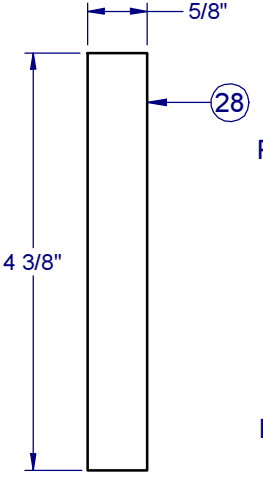

REINF. - 1726

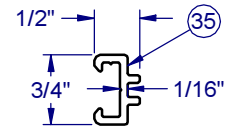

PVC SCREEN ADAPTOR - 6045

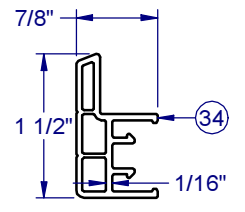

PVC SCREEN CHANNEL - 6044

NOTE: ALL EXTRUSIONS ARE ALUMINUM 6063-T6 UNLESS OTHERWISE SPECIFIED.

FRAME CONSTRUCTION

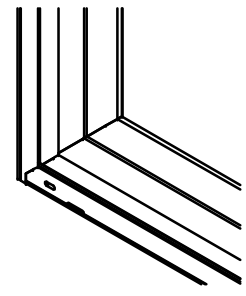

FRAME CORNERS  
SCREWED TOGETHER  
1:10

VENT CONSTRUCTION

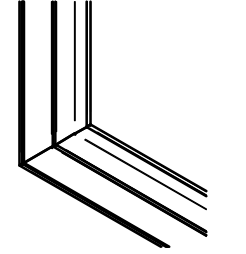

VENTS FULLY WELDED  
1:10

**Custom**  
WINDOW SYSTEMS

1900 SW 44TH AVE.  
OCALA, FLORIDA 34474  
WWW.CWS.CC

**8900 PVC  
SLIDING GLASS  
DOOR - IMPACT**

PROPRIETARY AND CONFIDENTIAL

THE INFORMATION CONTAINED IN THIS DRAWING IS THE SOLE PROPERTY OF CUSTOM WINDOW SYSTEMS, INC. ANY REPRODUCTION IN PART OR AS A WHOLE WITHOUT THE WRITTEN PERMISSION OF CUSTOM WINDOW SYSTEMS, INC IS PROHIBITED.



3/16/2020

LUCAS A. TURNER, P.E.  
TX PE #115094  
TBPE REG. #FL-18075  
2428 OLD NATCHEZ TRC TRL  
CAMDEN, TN 38320  
PH. 941-380-1574

SHEET DESCRIPTION:

BOM AND EXTRUSIONS

DRAWN BY:	DATE:
ADE	06/03/08
DWG #:	REV.:
TDI-298	-
SCALE:	SHEET
1:2	4 OF 6

**8900 PVC  
SLIDING GLASS  
DOOR - IMPACT**

PROPRIETARY AND CONFIDENTIAL  
THE INFORMATION CONTAINED IN  
THIS DRAWING IS THE SOLE  
PROPERTY OF CUSTOM WINDOW  
SYSTEMS, INC. ANY  
REPRODUCTION IN PART OR AS A  
WHOLE WITHOUT THE WRITTEN  
PERMISSION OF CUSTOM WINDOW  
SYSTEMS, INC IS PROHIBITED.



3/16/2020

LUCAS A. TURNER, P.E.  
TX PE #115094  
TBPE REG. #FL-18075  
2428 OLD NATCHEZ TRC TRL  
CAMDEN, TN 38320  
PH. 941-380-1574

SHEET DESCRIPTION:

**ANCHOR SCHEDULE AND  
NOTES**

DRAWN BY:	DATE:
ADE	06/03/08
DWG #:	REV.:
TDI-298	-
SCALE:	SHEET
1:20	5 OF 6

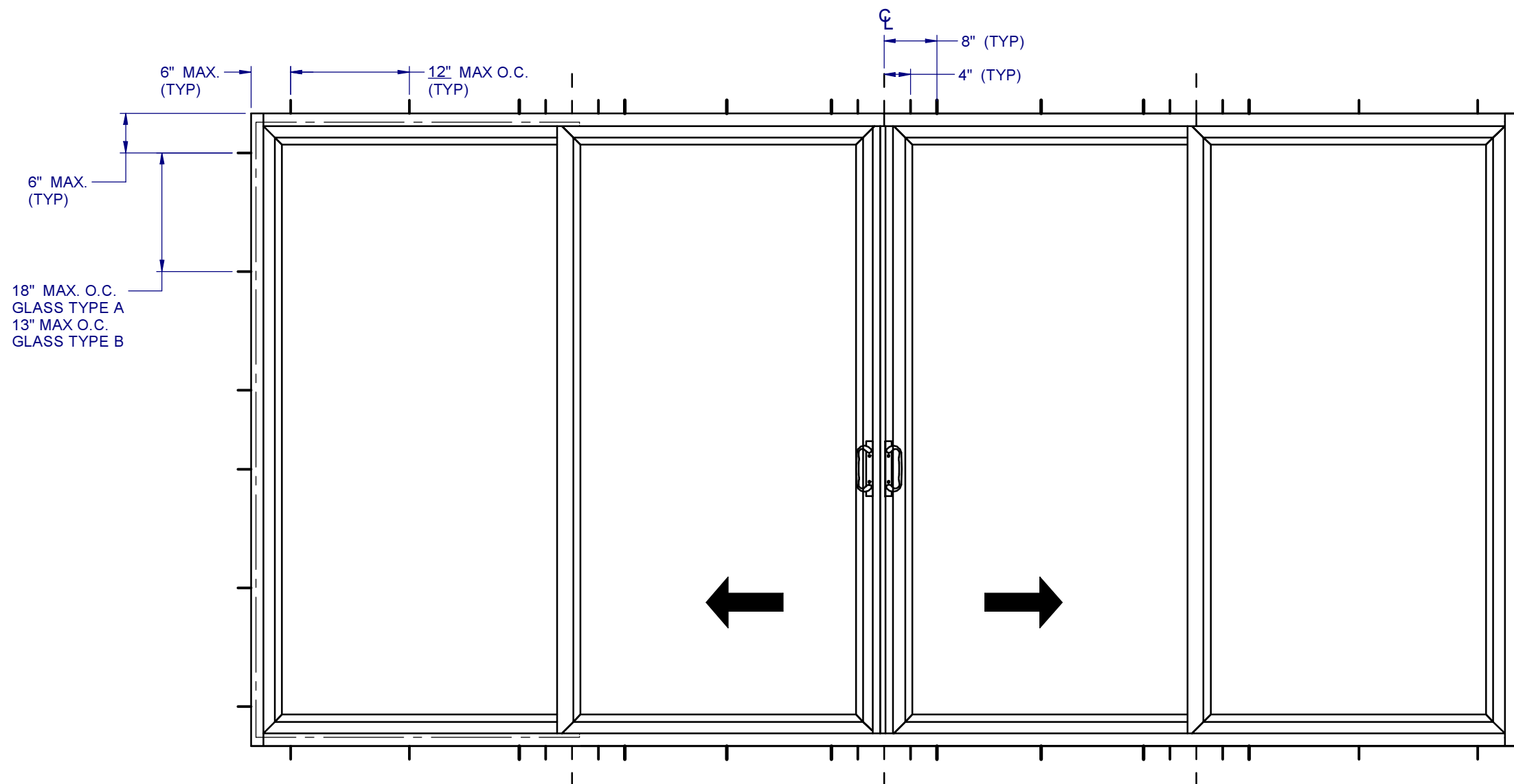

ANCHOR LAYOUT

**NOTES:**

1. INSTALL TWO ANCHORS AT EACH LOCATION. SILL ANCHOR SPACING SAME AS HEAD.
2. SHIM AS REQ'D AT EACH INSTALLATION ANCHOR USING LOAD BEARING SHIMS. MAX. ALLOWABLE SHIM STACK TO BE 1/4". USE SHIMS WHERE SPACE GREATER THAN 1/16" IS PRESENT. LOAD BEARING SHIMS SHALL BE CONSTRUCTED OF HIGH DENSITY PLASTIC OR BETTER. WOOD SHIMS ARE NOT ALLOWED.
3. ANCHOR TYPE, SIZE, SPACING AND EMBEDMENT SHALL BE AS SPECIFIED IN THESE DRAWINGS, SEE TABLE 1, SHEET 6.
4. ALL INSTALLATION ANCHORS MUST BE MADE OF OR PROTECTED WITH A CORROSION RESISTANT MATERIAL OR COATING. DISSIMILAR METALS OR MATERIALS IN CONTACT WITH PRESSURE TREATED WOOD MUST BE PROTECTED TO PREVENT REACTION.
5. INSTALLATION ANCHORS SHALL BE IN ACCORDANCE WITH ANCHOR MANUFACTURER'S INSTALLATION INSTRUCTIONS, AND ANCHORS SHALL NOT BE USED IN SUBSTRATES WITH STRENGTHS LESS THAN THE MINIMUM SPECIFIED IN TABLE 1, SHEET 6.
6. ANCHOR EMBEDMENT TO SUBSTRATE SHALL BE BEYOND WALL DRESSING OR STUCCO. FOR CONCRETE/CMU OPENINGS, EMBEDMENT SHALL BE BEYOND WOOD BUCKS, IF USED, INTO SUBSTRATE. INSTALLATIONS TO SOLID CONCRETE OR GROUT-FILLED CMU MAY INCLUDE BUT DO NOT REQUIRE 1X WOOD BUCKS BETWEEN THE PRODUCT AND SUBSTRATE. INSTALLATIONS TO HOLLOW CMU REQUIRE THE USE OF 1X BUCKS BETWEEN THE PRODUCT AND SUBSTRATE.
7. A MINIMUM CENTER-TO-CENTER SPACING SHALL BE MAINTAINED BETWEEN ALL FASTENERS: 2" FOR MASONRY, 1" FOR WOOD AND METAL.
8. WOOD OR MASONRY OPENINGS, BUCKS AND BUCK FASTENERS SHALL BE PROPERLY DESIGNED BY THE ARCHITECT OR ENGINEER OF RECORD AND INSTALLED TO TRANSFER WIND LOADS TO THE STRUCTURE. SUBSTRATES SHALL MEET THE MINIMUM STRENGTH REQUIREMENTS AS SHOWN IN TABLE 1, SHEET 6. CONCRETE AND MASONRY SUBSTRATES MAY NOT BE CRACKED.
9. SEALING AND FLASHING STRATEGIES FOR OVERALL WATER RESISTANCE OF INSTALLATION SHALL BE DONE BY OTHERS FOLLOWING THE CURRENT VERSION OF THE REFERENCE DOCUMENTS: FMA/AAMA 100(FIN WINDOWS), FMA/AAMA 200(FLANGE WINDOWS), FMA/WDMA 250(BOX WINDOWS), FMA/AAMA/WDMA 300(EXTERIOR DOORS).

**8900 PVC  
SLIDING GLASS  
DOOR - IMPACT**

PROPRIETARY AND CONFIDENTIAL  
THE INFORMATION CONTAINED IN  
THIS DRAWING IS THE SOLE  
PROPERTY OF CUSTOM WINDOW  
SYSTEMS, INC. ANY  
REPRODUCTION IN PART OR AS A  
WHOLE WITHOUT THE WRITTEN  
PERMISSION OF CUSTOM WINDOW  
SYSTEMS, INC IS PROHIBITED.



3/16/2020

LUCAS A. TURNER, P.E.  
TX PE #115094  
TBPE REG. #FL-18075  
2428 OLD NATCHEZ TRC TRL  
CAMDEN, TN 38320  
PH. 941-380-1574

SHEET DESCRIPTION:

**GENERAL NOTES AND  
ELEVATIONS**

DRAWN BY:	DATE:
ADE	06/03/08
DWG #:	REV.:
TDI-298	-
SCALE:	SHEET
1:2.67	6 OF 6

**TYPICAL HEAD ANCHORAGE**

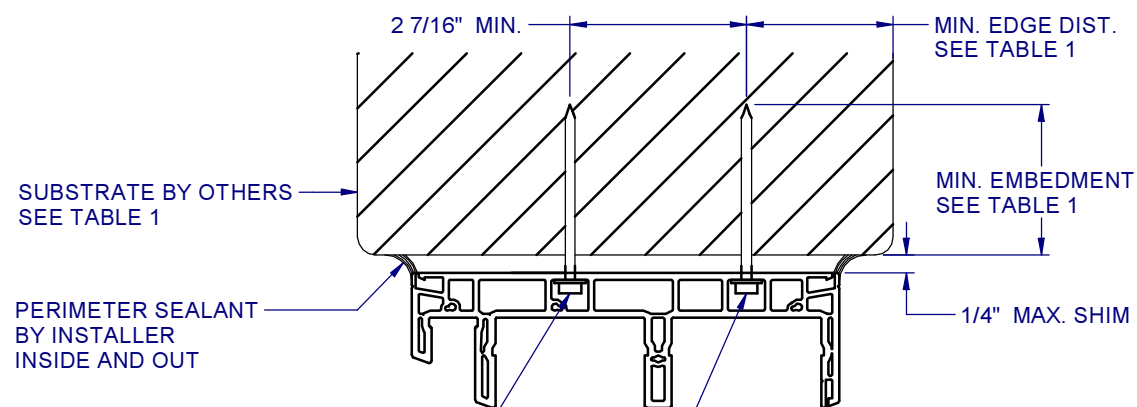

**A**  
6  
VERTICAL SECTION  
TYPICAL SILL ANCHORAGE

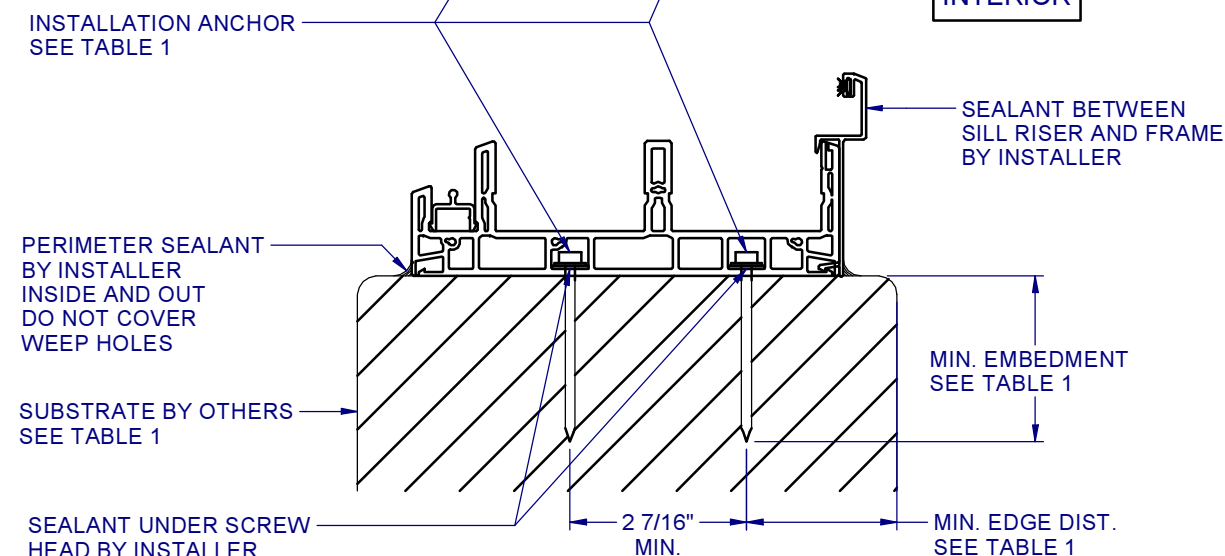

**B**  
6  
HORIZONTAL SECTION  
TYPICAL JAMB ANCHORAGE

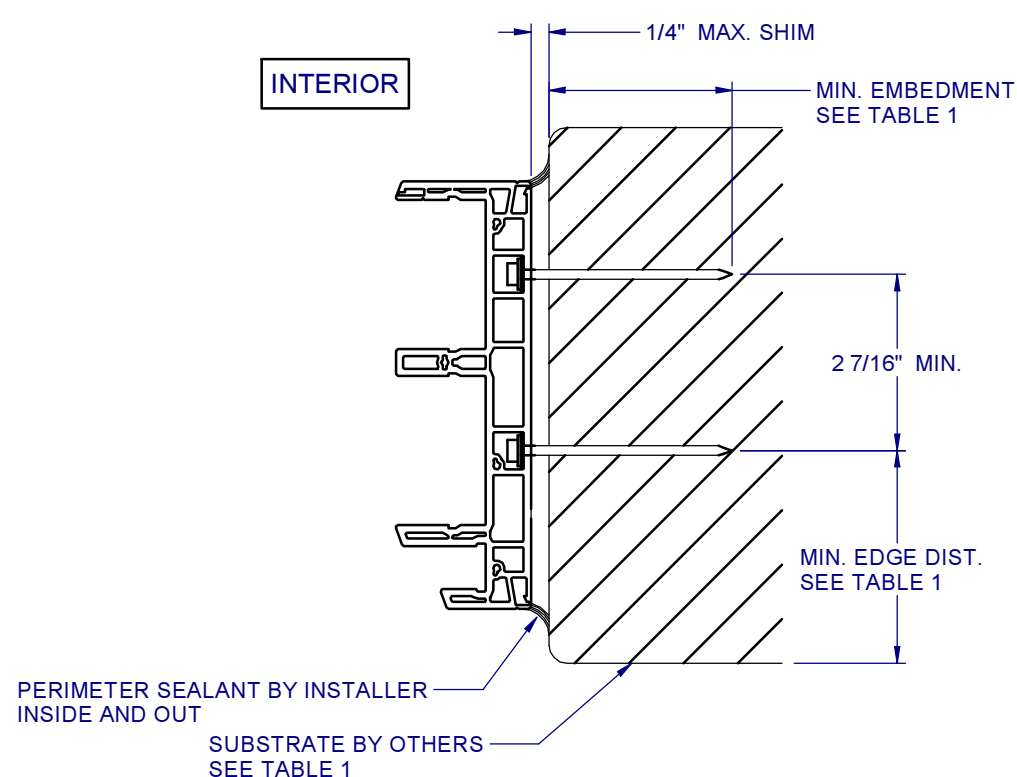

**C**  
6  
HORIZONTAL SECTION  
FIXED PANEL ANCHORAGE

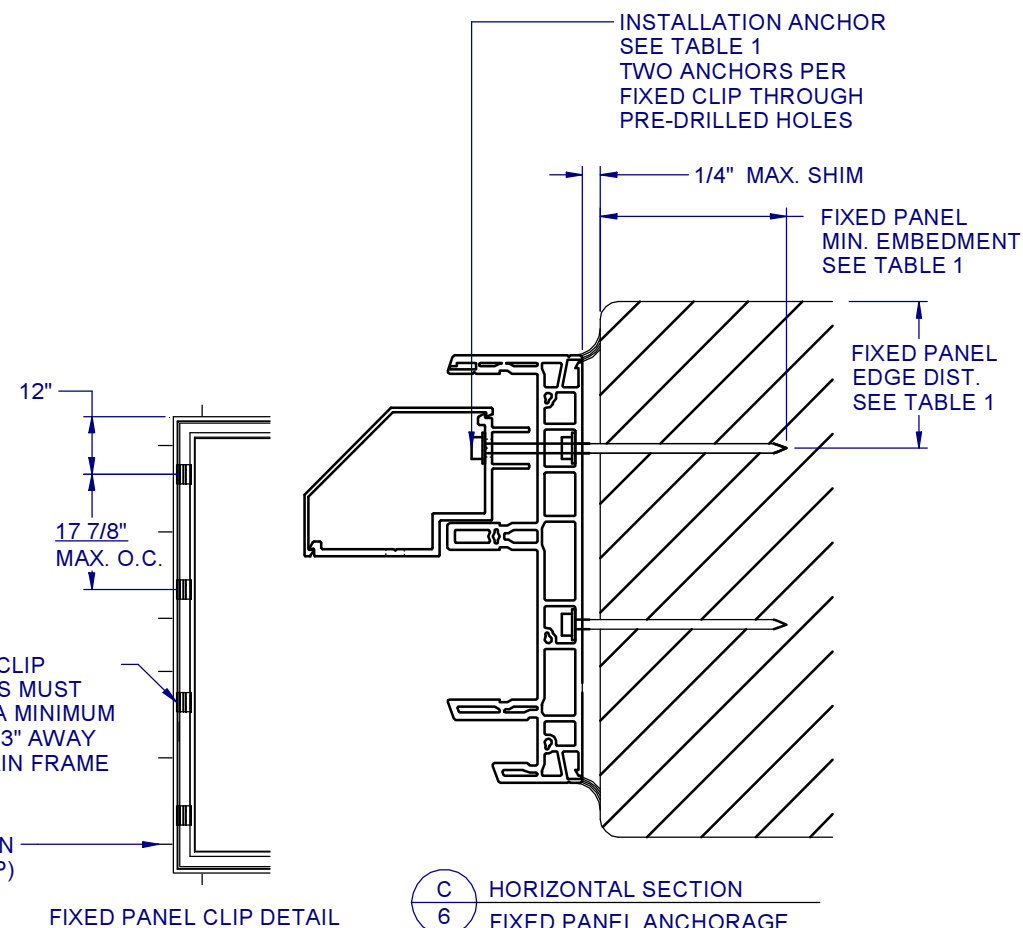

FIXED PANEL CLIP  
CLIP ANCHORS MUST  
BE LOCATED A MINIMUM  
DISTANCE OF 3\"/>

INSTALLATION  
ANCHOR (TYP)

FIXED PANEL CLIP DETAIL

**TABLE 1: APPROVED INSTALLATION FASTENERS**

SUBSTRATE TYPE	ANCHOR TYPE	MIN. EMBEDMENT	MIN. EDGE DIST.
CONCRETE (2.0 KSI MIN.)	3/16" ITW TAPCON	1"	3"
CONCRETE (2.85 KSI MIN.)	3/16" ELCO ULTRACON	1-3/4"	1"
HOLLOW OR GROUT-FILLED CMU (117 PCF MIN.)	3/16" ITW TAPCON	1"	3"
HOLLOW OR GROUT-FILLED CMU (ASTM C-90)	3/16" ELCO ULTRACON	1-1/4"	2-1/2"
2X MIN. SOUTHERN PINE (G=0.55)	3/16" ITW TAPCON	1-3/8"	1"
2X MIN. SOUTHERN PINE (G=0.55)	#10 WOOD SCREW	1-3/8"	1"
16 GAUGE (0.060") MIN. STEEL STUD (33 KSI YIELD MIN)	#10-16 HILTI KWIK-FLEX OR ITW TEKS SELF-DRILLING SCREW	FULL THREAD THRU 0.060"	7/16"
1/8" ALUM. (6063-T5 MIN.) OR 1/8" STEEL (33 KSI MIN.)	#10 GRADE 5 SELF-TAPPING / DRILLING SCREW	FULL THREAD THRU 0.125"	7/16"
FIXED PANEL CLIP ANCHORS INTO: CONCRETE (2.0 KSI MIN.) OR HOLLOW OR GROUT-FILLED CMU (117 PCF MIN.)	3/16" ITW TAPCON	1"	3"
FIXED PANEL CLIP ANCHORS INTO: CONCRETE (2.85 KSI MIN.) OR HOLLOW OR GROUT-FILLED CMU (ASTM C-90)	3/16" ELCO ULTRACON	1-1/4"	2-1/2"

NOTE: FIXED PANEL CLIP ANCHORS INTO WOOD OR METAL SHALL FOLLOW THE ANCHOR TYPE, MIN. EMBEDMENT AND MIN. EDGE DISTANCE LISTED IN TABLE 1.