

WINCORE™

WINDOWS & DOORS

250 Staunton Turnpike, Parkersburg, WV 26104

8800 Series Vinyl Outswing Casement Window "IMPACT"

TDI WIN-1762

EVALUATED FOR USE IN THE STATE OF TEXAS

The Wincore Horizontal Sliding Window described herein complies with the 2018 International Residential Code (IRC), Sections R301 & R609 and the 2018 International Building Code (IBC), Sections 1404.13, 1609, 1709.5, 2403 and 2404 subject to the following conditions:

1. Anchors shall be as listed and spaced as shown in the details. Anchor embedment to base material shall be beyond roof covering.
2. When used in areas requiring wind-borne debris protection, this product complies with Section R301.2.1.2 of the IRC and Section 1609.2 of the IBC and does not require impact protection. This product meets missile level "D" and includes Wind Zone 4 as defined in ASTM E 1996.
3. Allowable design pressure requirements must be equal to or less than the design pressure rating shown in the design pressure chart, sheet 1 of this drawing.
4. Conditions not covered by this drawing are subject to further engineering analysis.

TABLE OF CONTENTS

SHEET#	DESCRIPTION
1	Typical elevations, design pressures and general notes
2	Vertical & horizontal cross sections
3	Frame anchoring
4	Bill of materials, components and glazing details

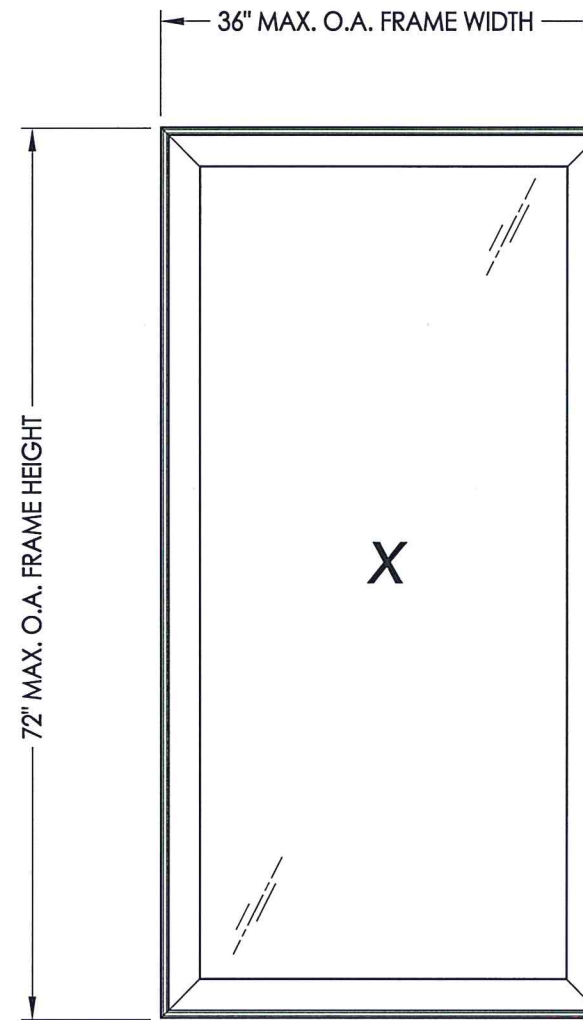

MAX. FRAME DIMENSION	MAX. D.L.O. DIMENSION	GLASS TYPE	DESIGN PRESSURE (PSF)	
			POSITIVE	NEGATIVE
36.0" X 72.0"	29.54" X 65.54"	G1	+50.0	-50.0
		G2	+55.0	-55.0
		G3	+65.0	-70.0



Documents Prepared By: Lyndon F. Schmidt, P.E.
TEXAS P.E. #104123

RW BUILDING CONSULTANTS, INC.
P.O. Box 230 Valrico FL, 33595
Phone No.: 813.659.9197

TEXAS BOARD OF PROFESSIONAL ENGINEERS
CERTIFICATE OF REGISTRATION # F-11852

PRODUCT: 8800 SERIES Vinyl Outswing Casement Window

PART OR ASSEMBLY: TYPICAL ELEVATION, DESIGN PRESSURES & GENERAL NOTES

NO.	DATE	BY	REVISIONS
2	1/20/20	LFS	UPDATE TO 2018 IBC/IRC
1	8/27/13	JK	ADDED NEW GLAZING/D.P.

DATE: 9/10/12

SCALE: N.T.S.

DWG. BY: JK

CHK. BY: LFS

DRAWING NO.: TX-4243

SHEET 1 OF 4

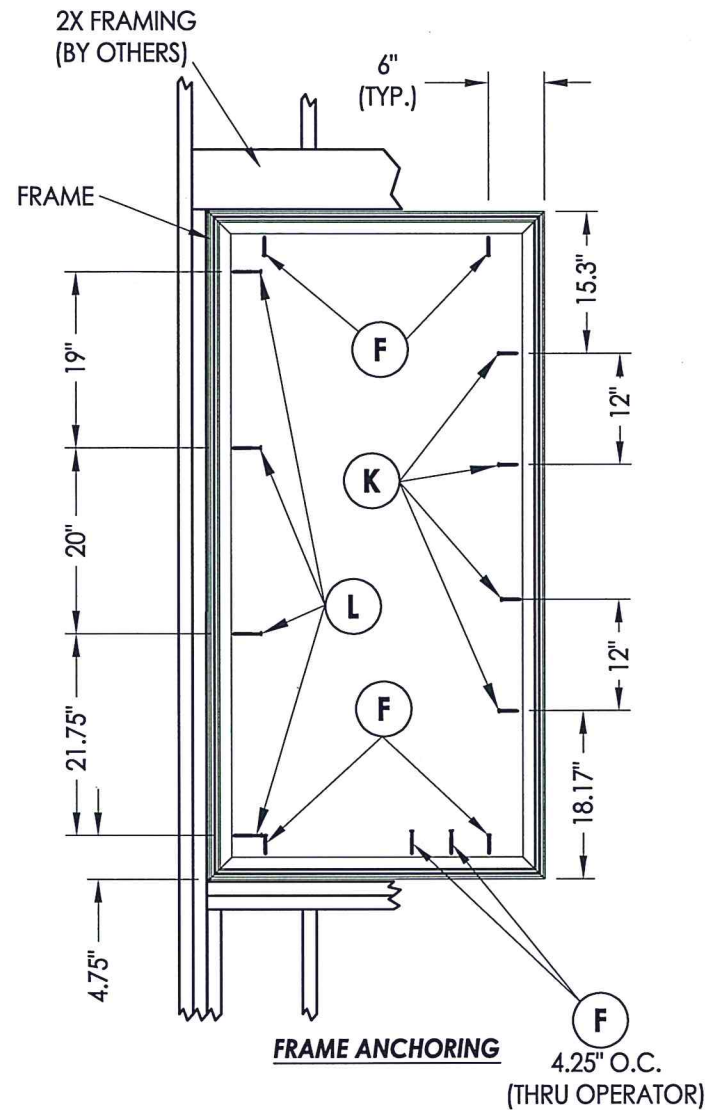

FRAME ANCHORING
4.25" O.C.
(THRU OPERATOR)

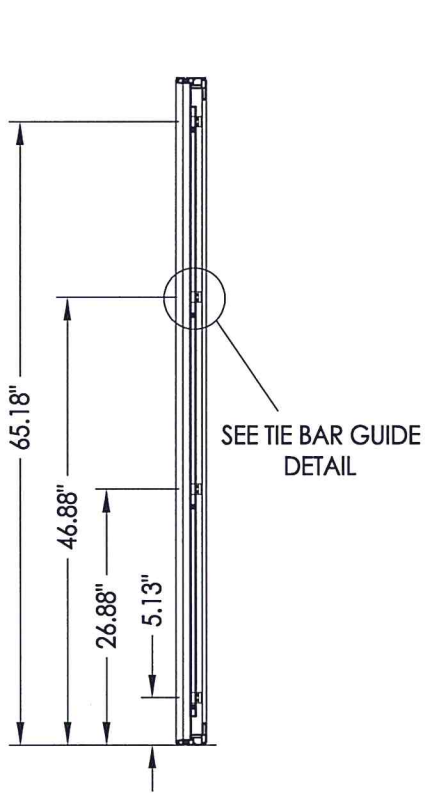

TIE BAR GUIDE LOCATIONS
4 Total

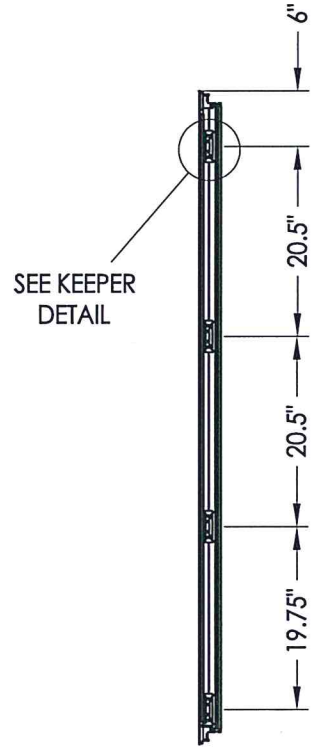

KEEPER LOCATIONS
4 Total

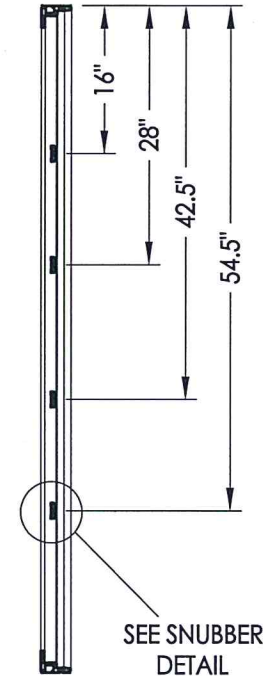

SNUBBER LOCATIONS
4 Total

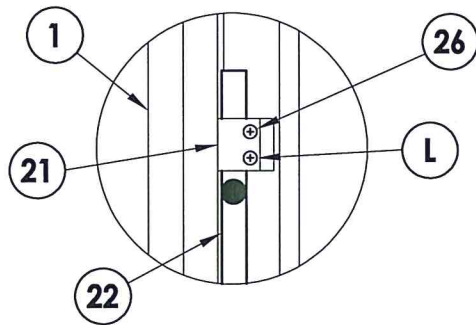

TIE BAR GUIDE DETAIL

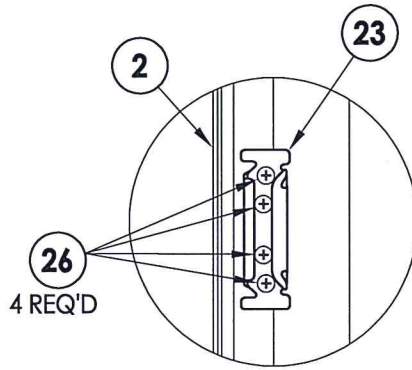

KEEPER DETAIL

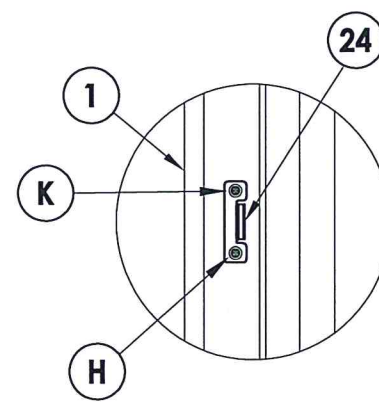

SNUBBER DETAIL

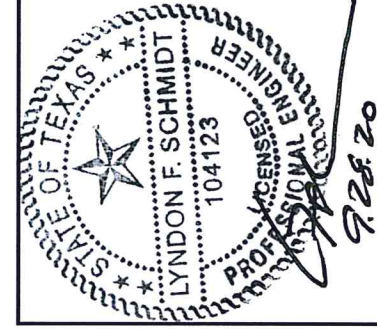

Documents Prepared By: Lyndon F. Schmidt, P.E.
TEXAS P.E. #104123

RW BUILDING CONSULTANTS, INC.
P.O. Box 230 Valrico FL, 33595
Phone No.: 813.659.9197
TEXAS BOARD OF PROFESSIONAL ENGINEERS
CERTIFICATE OF REGISTRATION # F-11852

PRODUCT: 8800 SERIES
Vinyl Outswing Casement Window
PART OR ASSEMBLY:
FRAME ANCHORING

NO.	DATE	BY	REVISIONS
2	1/20/20	LFS	UPDATE TO 2018 IBC/IRC
1	8/27/13	JK	ADDED NEW GLAZING/D.P.

DATE: 9/10/12
SCALE: N.T.S.
DWG. BY: JK
CHK. BY: LFS
DRAWING NO.: TX-4243
SHEET 3 OF 4

R:\Clients\Wincore PERMANENT\B - (2018) Texas Dept of Ins\WIN 1762 - Casement 8800 (Impact)\C - Drawings\2018 IBC UPDATE\TX-4243.dwg, 4.2

BILL OF MATERIALS		
ITEM #	DESCRIPTION	MATERIAL
B	2X FRAMING (SG >= 0.42)	WOOD
C	1/4" MAX. SHIM SPACE	-
F	#8 X 2-1/2" MODIFIED TRUSS HEAD (7/16" Ø) SMS (1-3/8" MIN. EMBEDMENT)	STEEL
G	#8 X 2-1/2" PFH WOOD SCREW (7/8" MIN. EMB.)	STEEL
H	#8 X 1/2" PPH SMS	STEEL
K	#8 X 2-1/2" PPH WOOD SCREW (1-1/2" MIN. EMB.)	STEEL
L	#8 X 3" PFH SMS (1-5/16" MIN. EMB.)	STEEL
1	FRAME*	PVC
2	SASH*	PVC
3	GLAZING BEAD*	PVC
7	WEATHERSTRIP AMESBURY (CS 120 33-SEAL)	FOAM
8	WEATHERSTRIP AMESBURY (12300 SEAL)	VINYL
9	WEATHERSTRIP ULTRA FAB .250 (PILE - 250 - KP52)	VINYL
10	MULTI-POINT LOCK (TRUTH) 24.33.32.004	-
12	OPERATOR HANDLE (TRUTH) 50.10.00.011	-
21	TIE BAR GUIDE (TRUTH) 32384	-
22	TIE BAR (TRUTH) 12926	-
23	KEEPER (TRUTH)	-
24	SNUBBER (TRUTH) (SASH/FRAME) 22999	-
26	#8 X 1/2" PFH SMS	S.S.
27	OPERATOR (TRUTH STANDARD, MAX. CLEAR OR STAINLESS STEEL)	STEEL

* THE APPROVED WHITE RIGID PVC EXTERIOR EXTRUSIONS FOR WINDOWS ARE TO BE PRODUCED BY EXTRUDERS LICENSEES IN "CERTIFICATION PROGRAMS FOR RIGID PVC EXTRUSIONS".

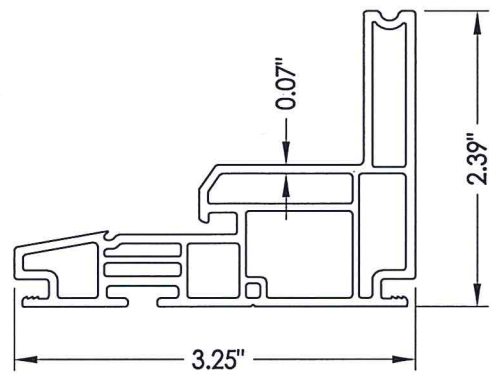

1 FRAME

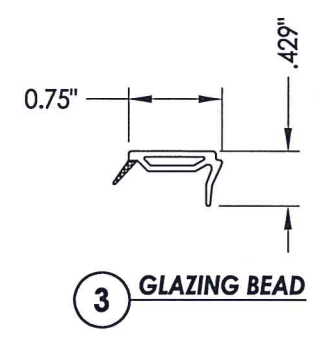

3 GLAZING BEAD

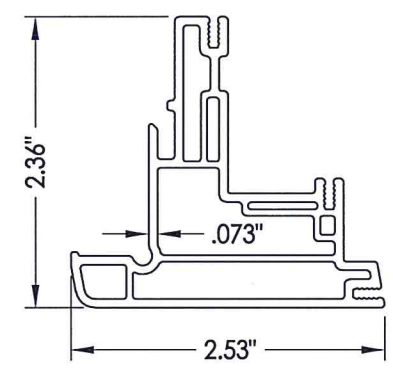

2 SASH

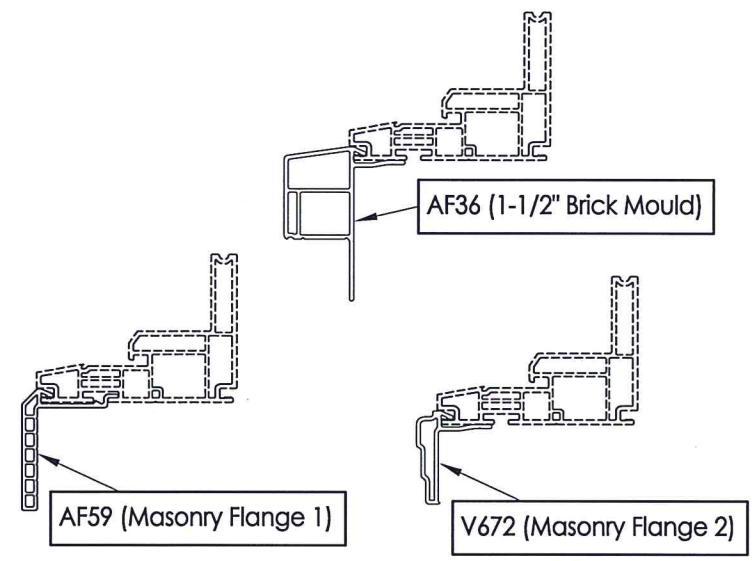

OPTIONAL COSMETIC FLANGES

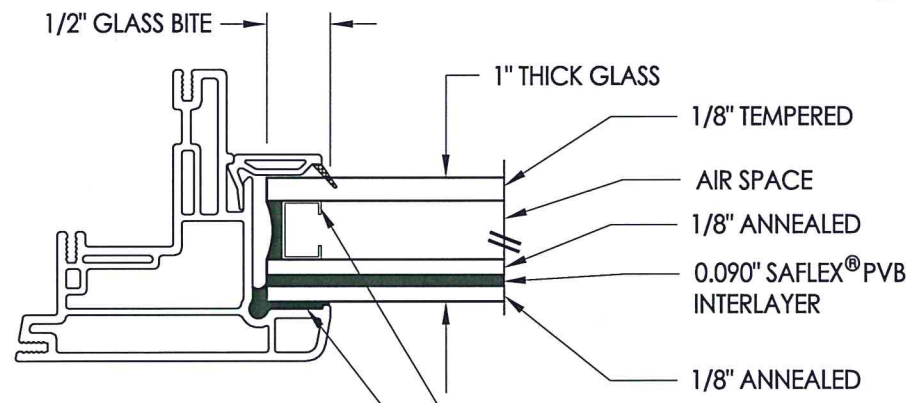

G2 GLAZING DETAIL

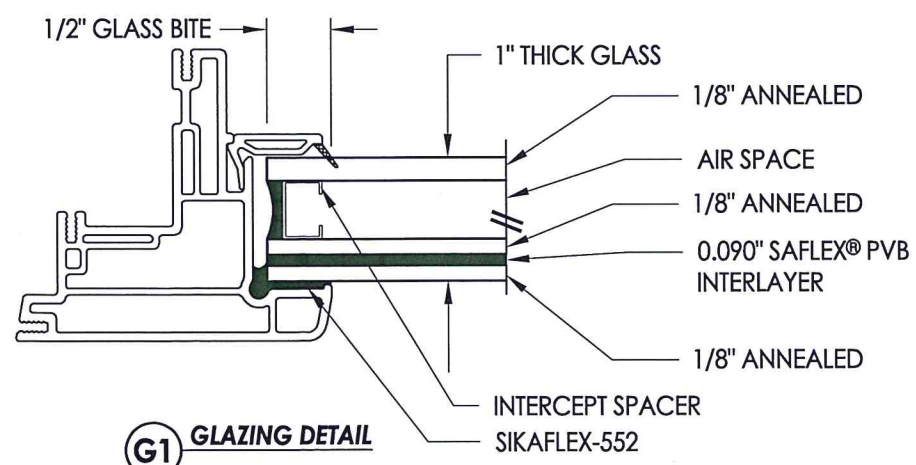

G1 GLAZING DETAIL

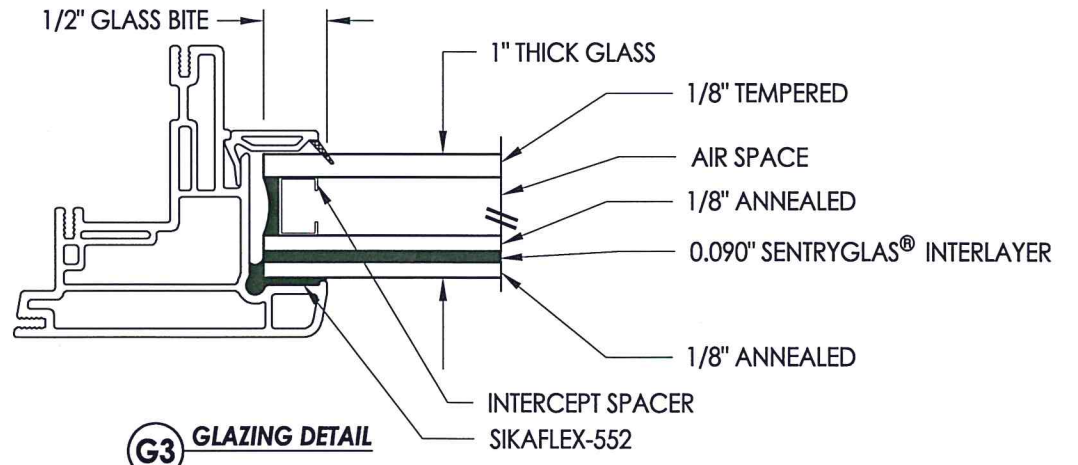

G3 GLAZING DETAIL

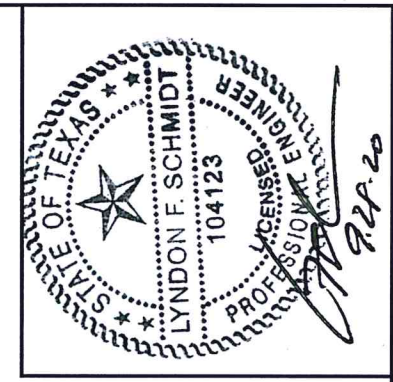

Documents Prepared By: Lyndon F. Schmidt, P.E.
TEXAS P.E. #104123

RW BUILDING CONSULTANTS, INC.
P.O. Box 230 Vairico FL 33595
Phone No.: 813.659.9197
TEXAS BOARD OF PROFESSIONAL ENGINEERS
CERTIFICATE OF REGISTRATION # F-11852

PRODUCT: 8800 SERIES
Vinyl Outswing Casement Window
PART OR ASSEMBLY:
BILL OF MATERIALS, COMPONENTS
AND GLAZING DETAIL

NO.	DATE	BY	REVISIONS
2	1/20/20	LFS	UPDATE TO 2018 IBC/IRC
1	8/27/13	JK	ADDED NEW GLAZING/D.P.

DATE: 9/10/12
SCALE: N.T.S.
DWG. BY: JK
CHK. BY: LFS
DRAWING NO.: TX-4243
SHEET 4 OF 4