

# ANDERSEN CORPORATION, INC

## 400 SERIES TILT-WASH DOUBLE-HUNG WINDOW (IMPACT)

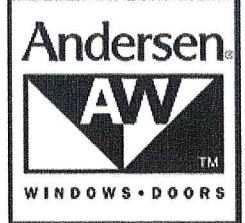

100 FOURTH AVE N NORTH BAYPORT, MN 55003-1096  
PH: (651) 264-5150 FX: (651) 264-5485

**INSTALLATION NOTES:**

1. ONE (1) INSTALLATION ANCHOR CLIP IS REQUIRED AT EACH ANCHOR LOCATION SHOWN, UNLESS OTHERWISE STATED.
2. THE NUMBER OF INSTALLATION ANCHORS DEPICTED IS THE MINIMUM NUMBER OF ANCHORS TO BE USED FOR PRODUCT INSTALLATION.
3. INSTALL INDIVIDUAL INSTALLATION ANCHORS WITHIN A TOLERANCE OF ±1/2 INCH OF THE DEPICTED LOCATION IN THE ANCHOR LAYOUT DETAIL (I.E., WITHOUT CONSIDERATION OF TOLERANCES). TOLERANCES ARE NOT CUMULATIVE FROM ONE INSTALLATION ANCHOR TO THE NEXT.
4. FOR INSTALLATION THROUGH 1X BUCK TO CONCRETE/MASONRY, OR DIRECTLY INTO CONCRETE/MASONRY, USE ONE (1) 3/16 INCH ITW TAPCON PER INSTALLATION CLIP OF SUFFICIENT LENGTH TO ACHIEVE 1 1/4 INCH MINIMUM EMBEDMENT.
5. FOR INSTALLATION INTO 2X BUCK USE TWO (2) #8 WOOD SCREWS OR ONE (1) #10 WOOD SCREW PER INSTALLATION CLIP OF SUFFICIENT LENGTH TO ACHIEVE 1 1/2 INCH MINIMUM EMBEDMENT INTO WOOD SUBSTRATE.
6. FOR INSTALLATION THROUGH METAL STUD USE TWO (2) #10 SELF-TAPPING SCREWS PER INSTALLATION CLIP OF SUFFICIENT LENGTH TO ACHIEVE 3 THREADS MINIMUM PENETRATION BEYOND METAL FRAME SUBSTRATE.
7. MINIMUM EMBEDMENT AND EDGE DISTANCE EXCLUDE WALL FINISHES, INCLUDING BUT NOT LIMITED TO STUCCO, FOAM, BRICK VENEER, AND SIDING.
8. INSTALLATION ANCHORS AND ASSOCIATED HARDWARE MUST BE MADE OF CORROSION RESISTANT MATERIAL OR HAVE A CORROSION RESISTANT COATING.
9. FOR HOLLOW BLOCK AND GROUT FILLED BLOCK, DO NOT INSTALL INSTALLATION ANCHORS INTO MORTAR JOINTS. EDGE DISTANCE IS MEASURED FROM FREE EDGE OF BLOCK OR EDGE OF MORTAR JOINT INTO FACE SHELL OF BLOCK.
10. INSTALLATION ANCHORS SHALL BE INSTALLED IN ACCORDANCE WITH ANCHOR MANUFACTURER'S INSTALLATION INSTRUCTIONS, AND ANCHORS SHALL NOT BE USED IN SUBSTRATES WITH STRENGTHS LESS THAN THE MINIMUM STRENGTH SPECIFIED BY THE ANCHOR MANUFACTURER.
11. INSTALLATION ANCHOR CAPACITIES FOR PRODUCTS HEREIN ARE BASED ON SUBSTRATE MATERIALS WITH THE FOLLOWING PROPERTIES:
  - A. WOOD - MINIMUM SPECIFIC GRAVITY OF 0.55.
  - B. CONCRETE - MINIMUM COMPRESSIVE STRENGTH OF 3000 PSI.
  - C. MASONRY - STRENGTH CONFORMANCE TO ASTM C-90
  - D. STEEL - MINIMUM YIELD STRENGTH OF 33 KSI. MINIMUM WALL THICKNESS OF 33 MILS.
  - E. ALUMINUM - MINIMUM WALL THICKNESS OF 1/8". 6063-T5 ALLOY OR BETTER.

**GENERAL NOTES:**

1. THE PRODUCT SHOWN HEREIN IS DESIGNED AND MANUFACTURED TO COMPLY WITH THE 2006 INTERNATIONAL BUILDING CODE (IBC) AND INTERNATIONAL RESIDENTIAL CODE (IRC) WITH 2006 TEXAS REVISIONS, EFFECTIVE JANUARY 1, 2008 AND HAS BEEN EVALUATED ACCORDING TO THE FOLLOWING:
  - AAMA/WDMA/CSA 101/1.S.2/A440-05
  - ASTM E1886-02
  - ASTM E1996-02
2. ADEQUACY OF THE EXISTING STRUCTURAL CONCRETE/MASONRY, 2X AND METAL STUD FRAMING AS A MAIN WIND FORCE RESISTING SYSTEM CAPABLE OF WITHSTANDING AND TRANSFERRING APPLIED PRODUCT LOADS TO THE FOUNDATION IS THE RESPONSIBILITY OF THE ENGINEER OR ARCHITECT OF RECORD FOR THE PROJECT OF INSTALLATION.
3. 1X AND 2X BUCKS (WHEN USED) SHALL BE DESIGNED AND ANCHORED TO PROPERLY TRANSFER ALL LOADS TO THE STRUCTURE. BUCK DESIGN AND INSTALLATION IS THE RESPONSIBILITY OF THE ENGINEER OR ARCHITECT OF RECORD FOR THE PROJECT OF INSTALLATION.
4. THE INSTALLATION DETAILS DESCRIBED HEREIN ARE GENERIC AND MAY NOT REFLECT ACTUAL CONDITIONS FOR A SPECIFIC SITE. IF SITE CONDITIONS CAUSE INSTALLATION TO DEVIATE FROM THE REQUIREMENTS DETAILED HEREIN, A LICENSED ENGINEER OR ARCHITECT SHALL PREPARE SITE SPECIFIC DOCUMENTS FOR USE WITH THIS DOCUMENT.
5. APPROVED IMPACT PROTECTIVE SYSTEM IS NOT REQUIRED TO PROTECT THIS PRODUCT UP IN AREAS UP TO WIND ZONE 3 REQUIRING IMPACT RESISTANCE.
6. WINDOW FRAME MATERIAL: PONDEROSA PINE.
7. GLASS MEETS THE REQUIREMENTS OF ASTM E1300-04 GLASS CHARTS. SEE SHEET 4 FOR GLAZING DETAILS.
8. DESIGNATIONS "X" AND "O" STAND FOR THE FOLLOWING:  
X: OPERABLE PANEL  
O: FIXED PANEL

TABLE OF CONTENTS		
SHEET	REVISION	SHEET DESCRIPTION
1	-	GENERAL & INSTALLATION NOTES
2	-	ELEVATION & ANCHOR LAYOUTS
3	-	VERTICAL SECTIONS
4	-	HORIZONTAL SECTIONS & GLAZING DETAIL
5	-	COMPONENTS
6	-	COMPONENTS & BILL OF MATERIALS

DESIGN PRESSURE RATING		
GLAZE TYPE	DESIGN PRESSURE - ALL SIZES	MISSILE IMPACT RATING
1	+50.0 / -65.0 PSF	LARGE AND SMALL MISSILE IMPACT RATED
2		

**TITLE:** SERIES 400 TILT WASH DH  
**GENERAL AND INTALLATIONS NOTES**  
**PREPARED BY:** BUILDING DROPS, INC.  
 398 E. DANIA BEACH BLVD. #338  
 DANIA BEACH, FL 33004  
 PH: (954) 399-8478 FX: (954) 744-4738

REVISIONS	DESCRIPTION	BY	DATE
		NO.	

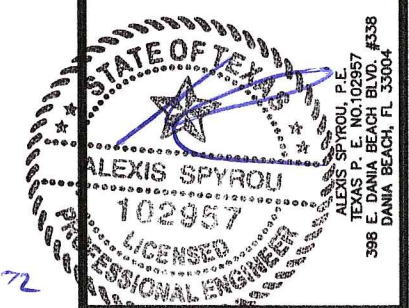

DATE: 8.02.12  
 DWN BY: BD  
 CHK BY: DB  
 SCALE: NTS  
 DWG #: **AWD054**  
 SHEET: **1 OF 6**

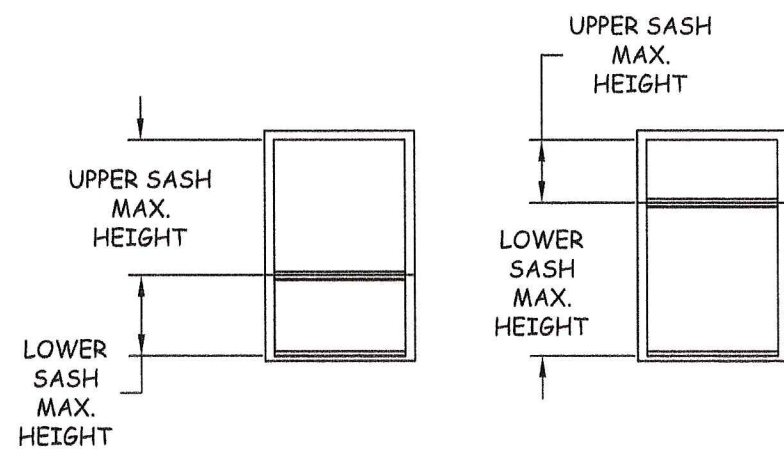
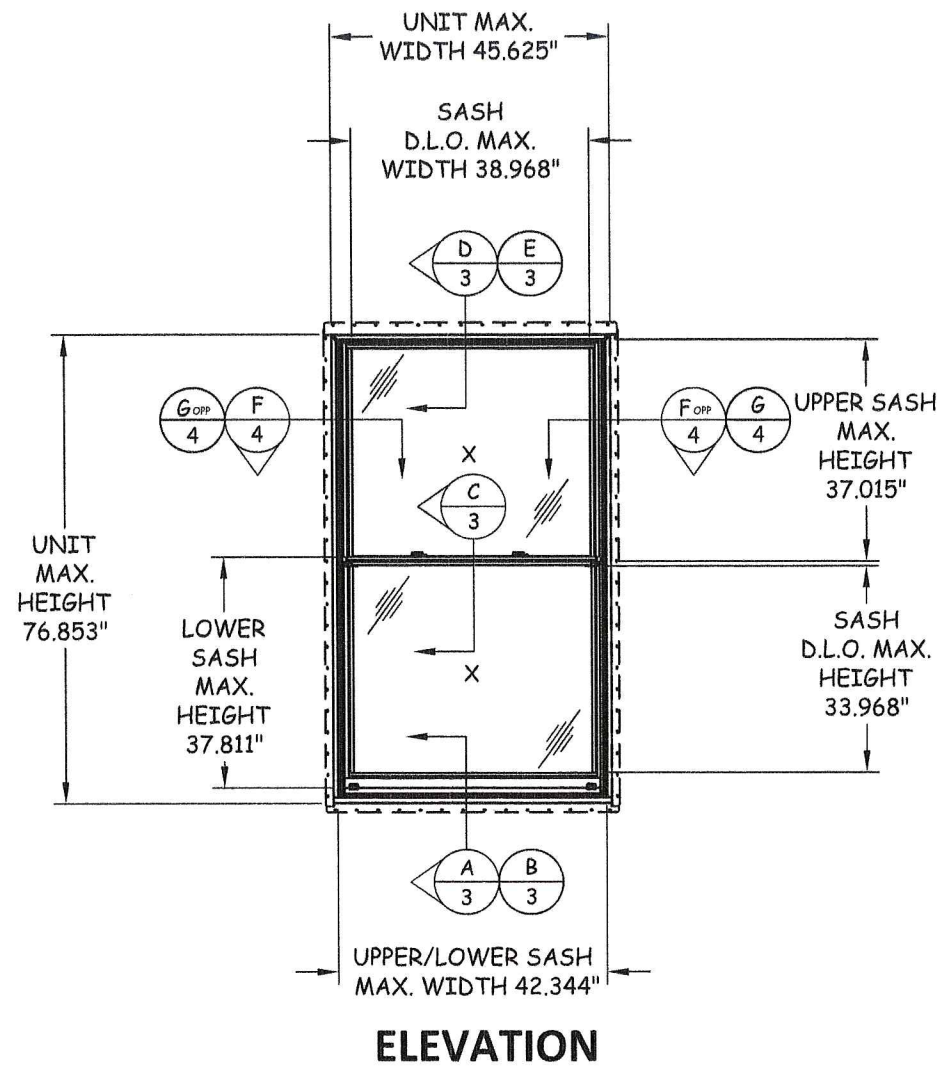

NOTE: COTTAGE & REVERSE COTTAGE DOUBLE HUNG WINDOWS APPROVED SUCH THAT MAXIMUM SASH HEIGHTS DO NOT EXCEED 38".

NOTE: ONE (1) #8 X 3" SCREW WHEN INTO WOOD OR METAL STUD OR ONE (1) 3/16" ITW TAPCON WHEN INTO CONCRETE/MASONRY THROUGH ITEM #31

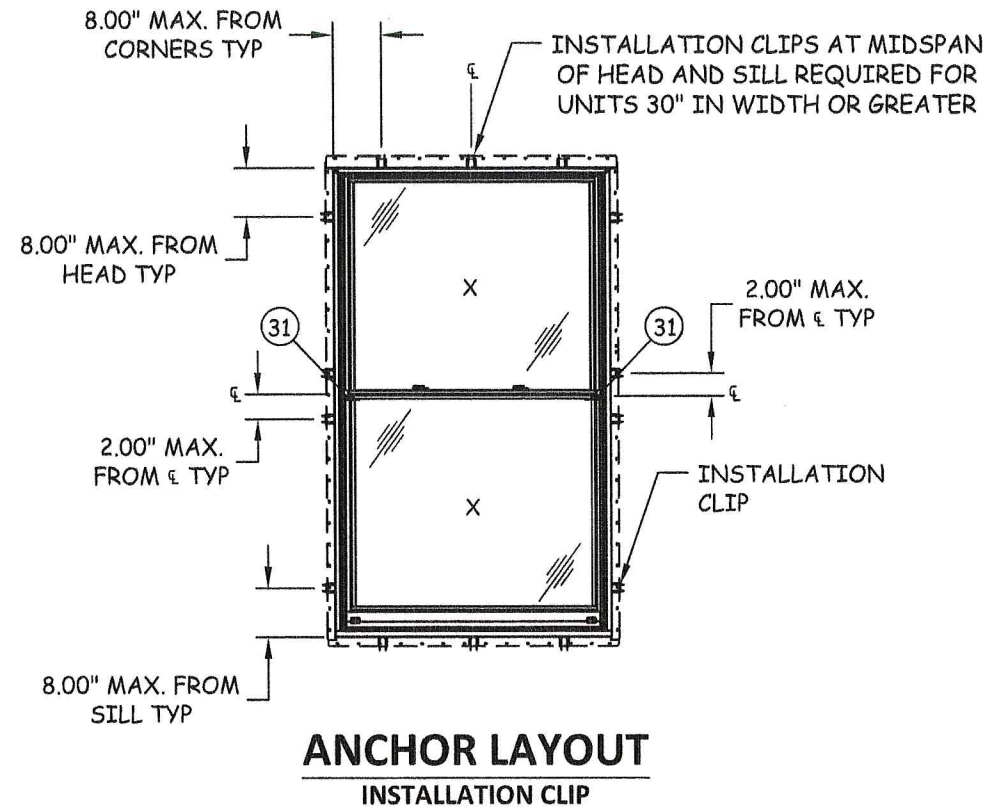

ANCHOR SCHEDULE					
QTY PER CLIP	SUBSTRATE	ANCHOR TYPE	MIN. EMBEDMENT (in.)	MIN. EDGE DISTANCE (in.)	MIN. O.C. DISTANCE (in.)
1	WOOD	#10 WOOD ANCHOR	1.50	0.75	N/A
2	WOOD	#8 WOOD ANCHOR	1.50	0.75	N/A
1	CONCRETE / MASONRY	3/16" ITW TAPCON	1.25	2.50	3.00
2	METAL STUD	#10 SELF-TAPPING SCREW	3 THREADS	0.50	N/A



100 FOURTH AVE N NORTH  
BAYPORT, MN 55003-1096  
PH: (651) 264-5150 FX: (651) 264-5485

TITLE: SERIES 400 TILT WASH DH  
ELEVATION AND ANCHOR LAYOUT

PREPARED BY:  
BUILDING DROPS, INC.  
398 E. DANIA BEACH BLVD. #338  
DANIA BEACH, FL 33004  
PH: (954) 399-8478 FX: (954) 744-4738

**REVISIONS**

NO.	DESCRIPTION	BY	DATE

DATE: 8.02.12  
DWN BY: BD  
CHK BY: DB  
SCALE: NTS

DWG #: **AWD054**  
SHEET: **2 OF 6**

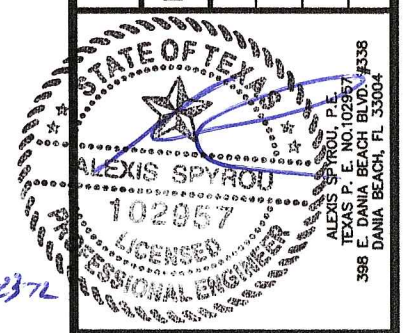

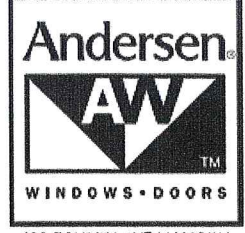

100 FOURTH AVE N NORTH  
BAYPORT, MN 55003-1096  
PH: (651) 264-5150 FX: (651) 264-5485

TITLE: SERIES 400 TILT WASH DH  
VERTICAL SECTIONS  
PREPARED BY:  
BUILDING DROPS, INC.  
398 E. DANIA BEACH BLVD. #338  
DANIA BEACH, FL 33004  
PH: (954) 399-8478 FX: (954) 744-4738

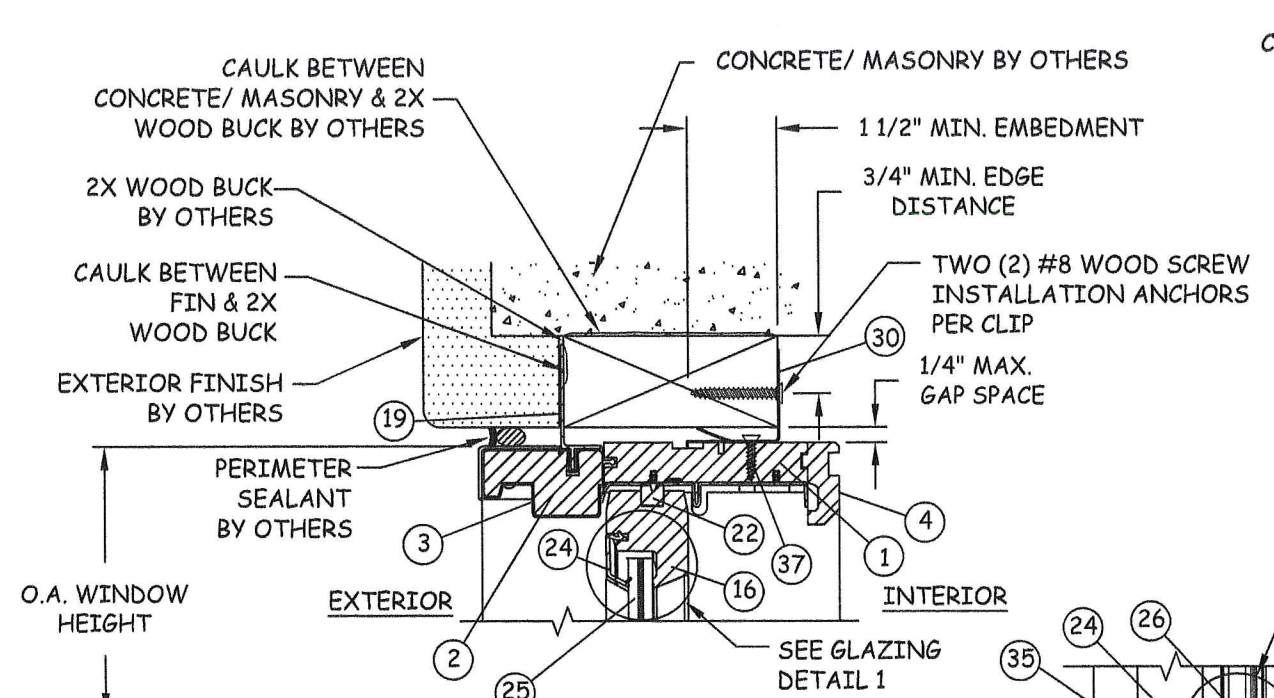

**D**  
**3** VERTICAL SECTION  
HEAD - 2X WOOD/CONCRETE/MASONRY  
INSTALLATION CLIP

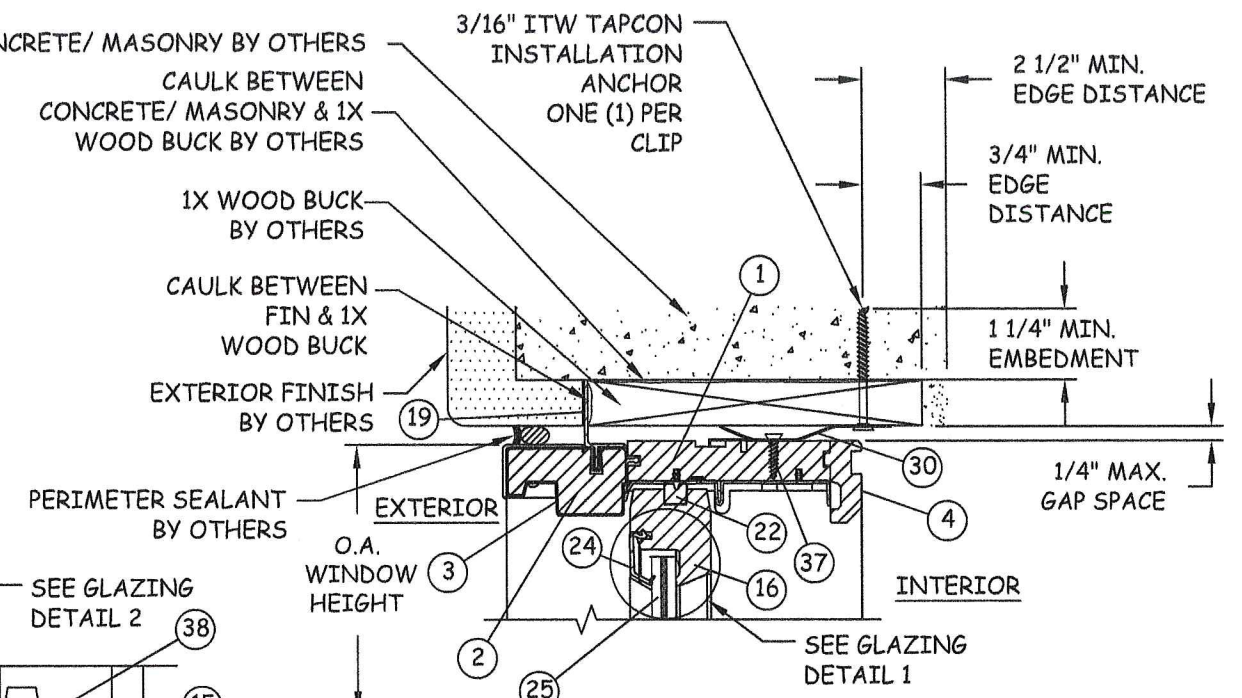

**E**  
**3** VERTICAL SECTION  
HEAD - 1X WOOD/CONCRETE/MASONRY  
INSTALLATION CLIP

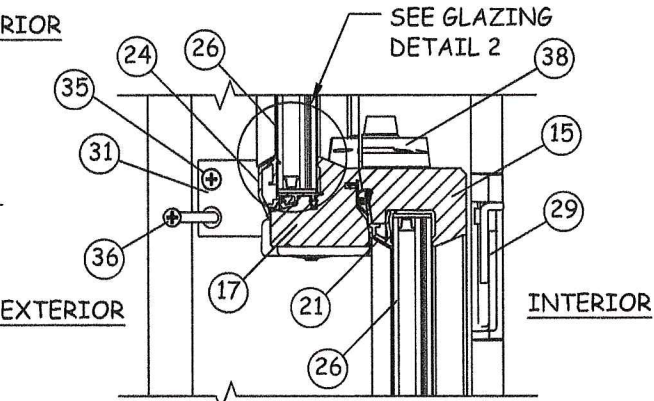

**C**  
**3** VERTICAL SECTION  
MEETING RAIL

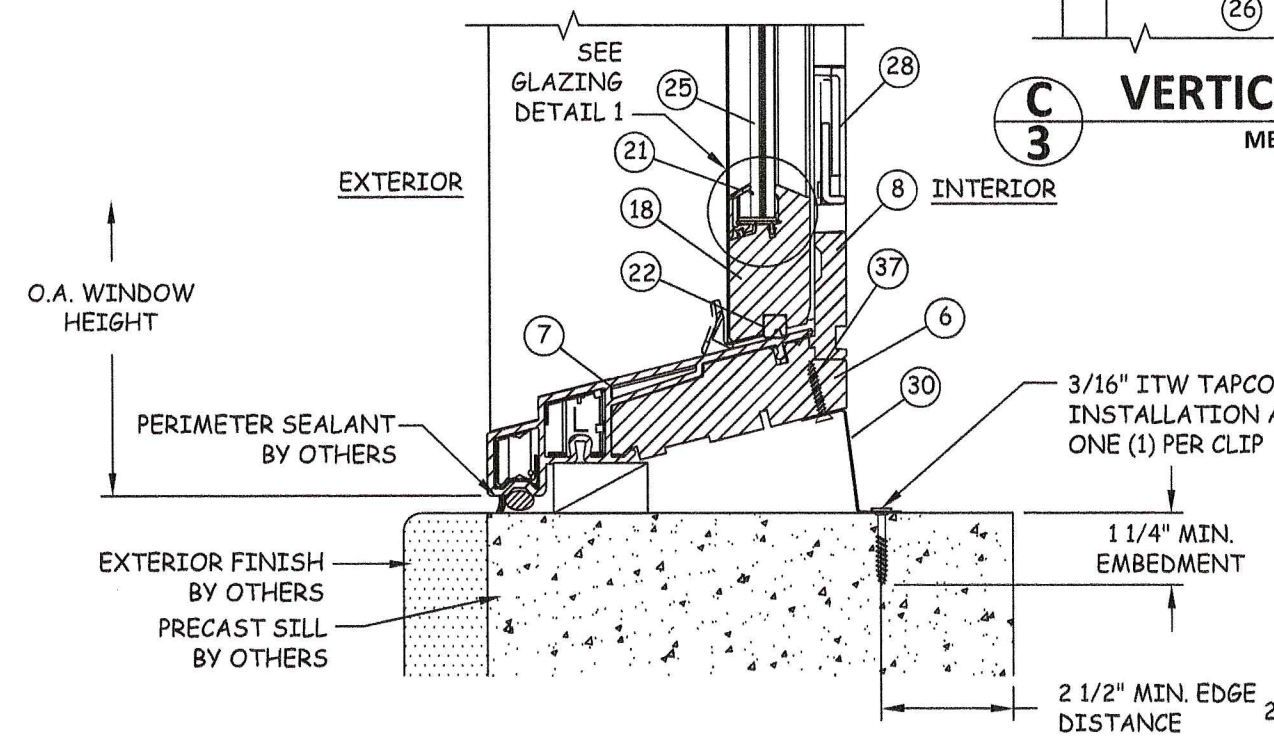

**A**  
**3** VERTICAL SECTION  
SILL - PRECAST CONCRETE  
INSTALLATION CLIP

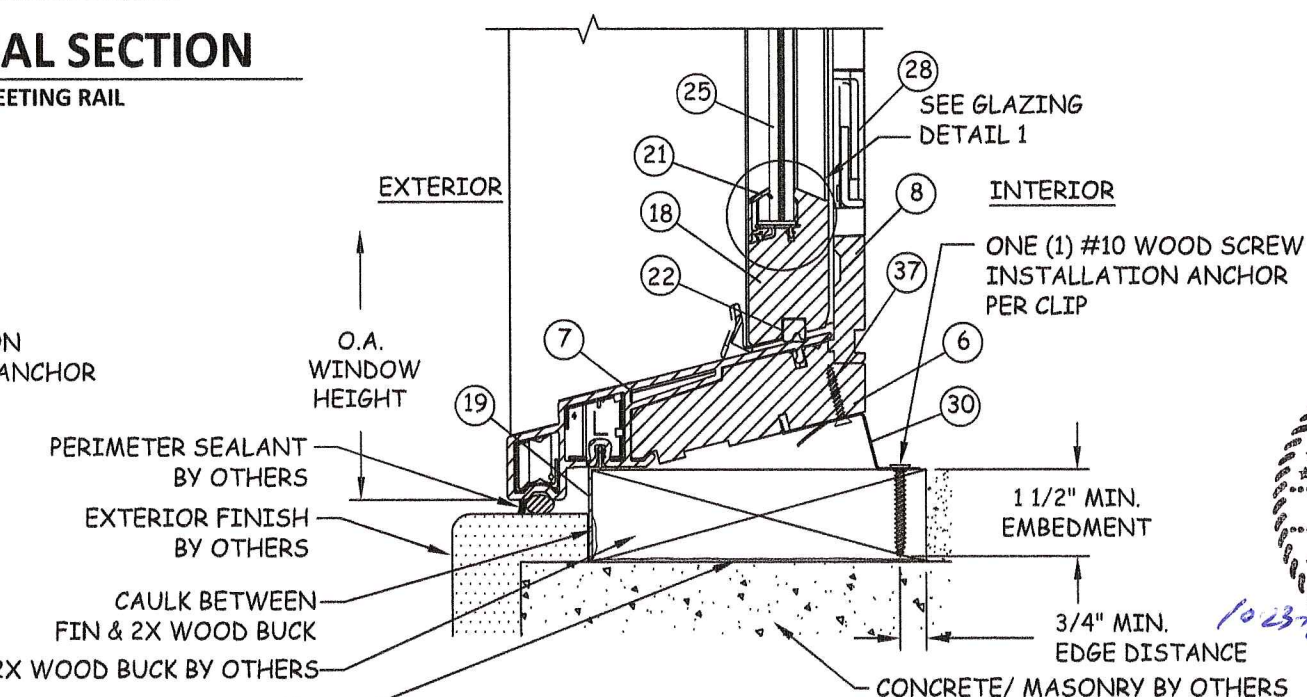

**B**  
**3** VERTICAL SECTION  
SILL - 2X WOOD/CONCRETE/MASONRY  
INSTALLATION CLIP

REVISIONS

NO.	DESCRIPTION	BY	DATE



DATE: 8.02.12  
DWN BY: BD  
CHK BY: DB  
SCALE: NTS  
DWG #: AWD054  
SHEET: 3 OF 6

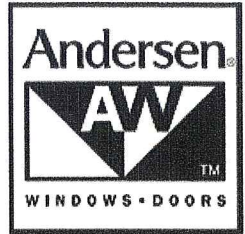

100 FOURTH AVE N NORTH  
BAYPORT, MN 55003-1096  
PH: (651) 264-5150 FX: (651) 264-5485

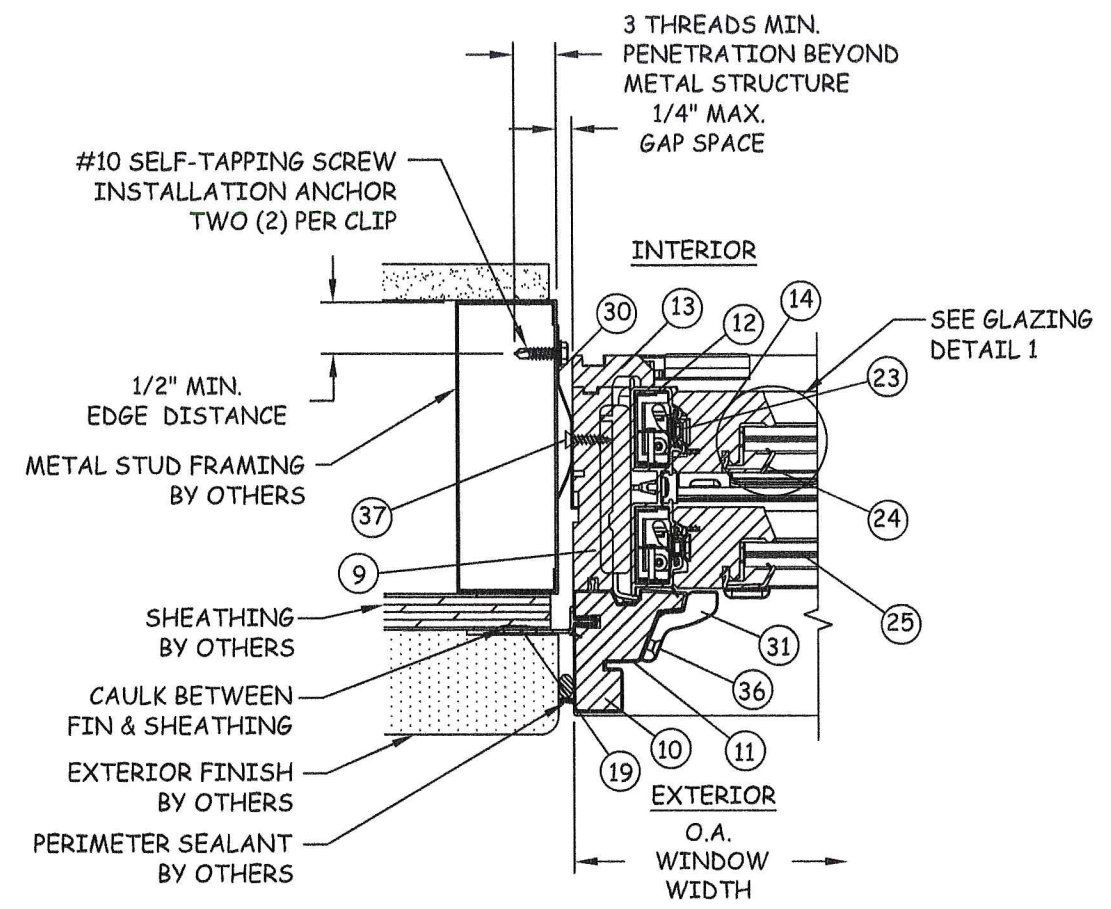

**F**  
**4** **HORIZONTAL SECTION**  
JAMB - STEEL STUD FRAME  
INSTALLATION CLIP

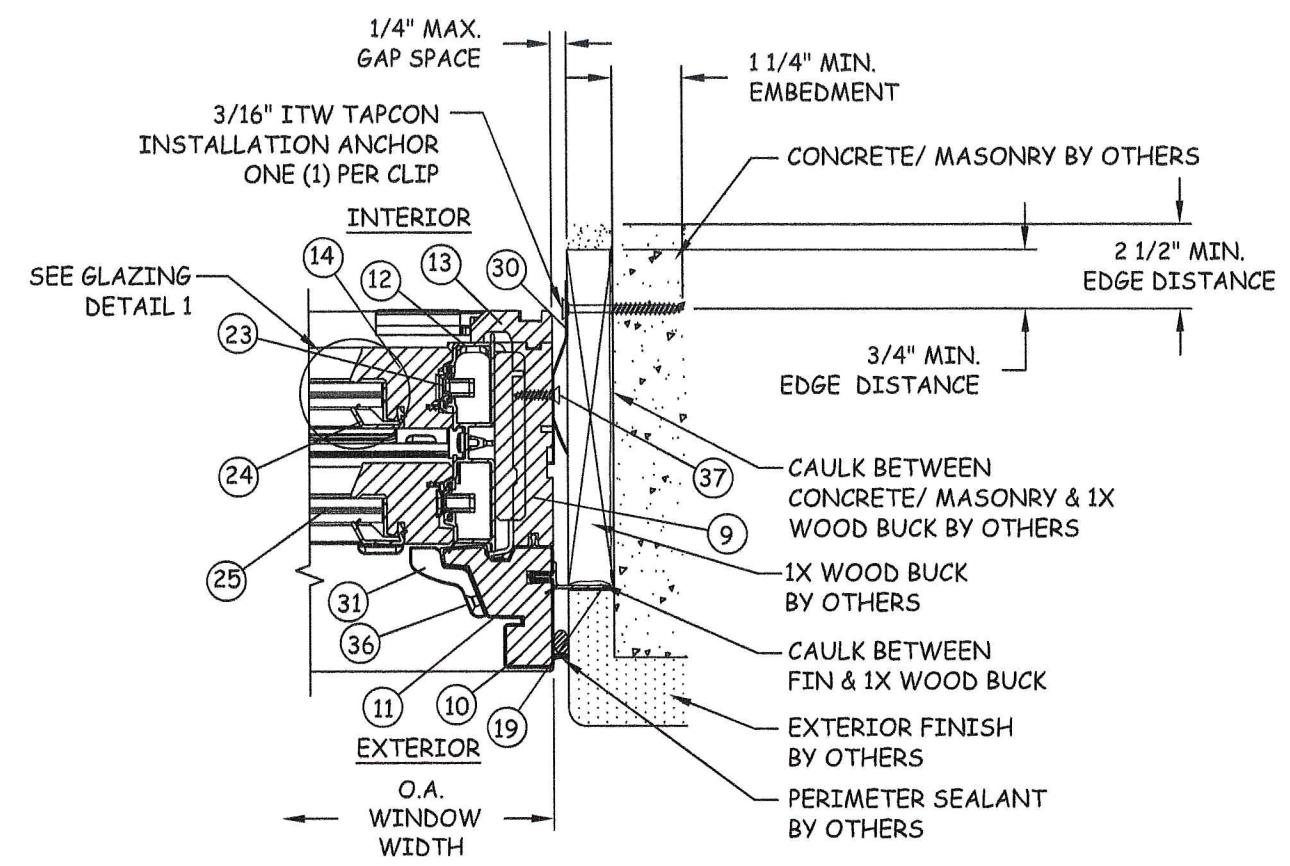

**G**  
**4** **HORIZONTAL SECTION**  
JAMB - 1X WOOD/CONCRETE/MASONRY  
INSTALLATION CLIP

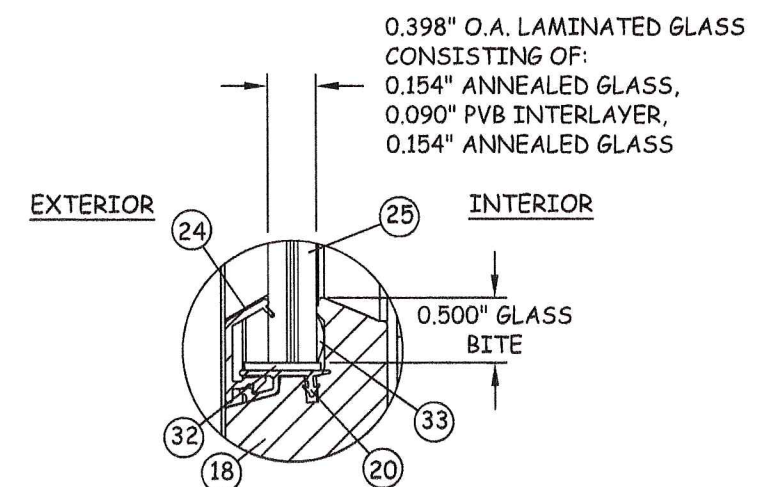

**GLAZING DETAIL 1**

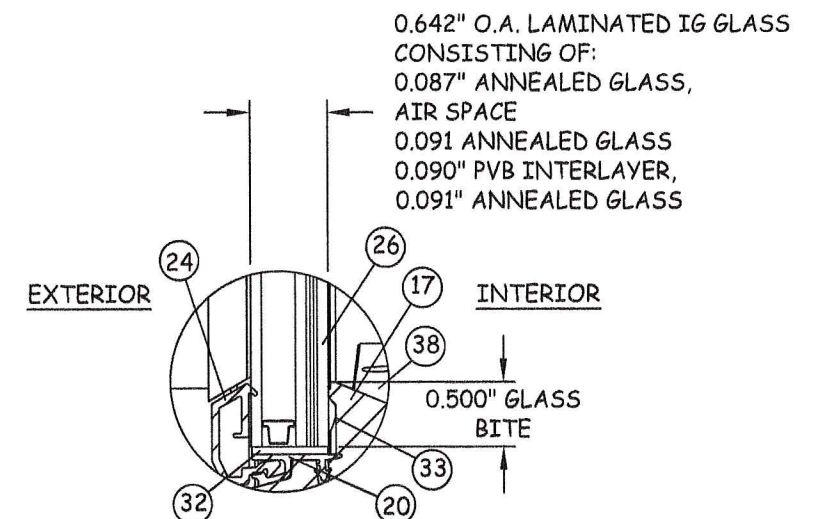

**GLAZING DETAIL 2**

TITLE: SERIES 400 TILT WASH DH  
HORIZONTAL SECTIONS AND  
GLAZING DETAILS

PREPARED BY:  
BUILDING DROPS, INC.  
398 E. DANIA BEACH BLVD. #338  
DANIA BEACH, FL 33004  
PH: (954) 399-8478 FX: (954) 744-4738

REVISIONS	DESCRIPTION	BY	DATE

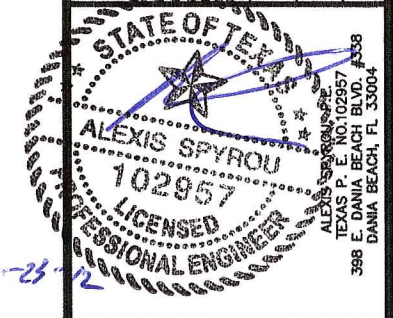

DATE: 8.02.12  
DWN BY: BD  
CHK BY: DB  
SCALE: NTS

DWG #:  
**AWD054**  
SHEET: **4 OF 6**

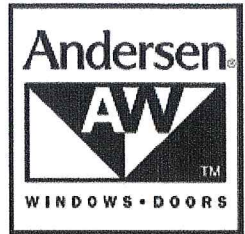

100 FOURTH AVE N NORTH  
BAYPORT, MN 55003-1096  
PH: (651) 264-5150 FX: (651) 264-5485

TITLE: SERIES 400 TILT WASH DH COMPONENTS

PREPARED BY:  
BUILDING DROPS, INC.  
398 E. DANIA BEACH BLVD. #338  
DANIA BEACH, FL 33004  
PH: (954) 399-8478 FX: (954) 744-4738

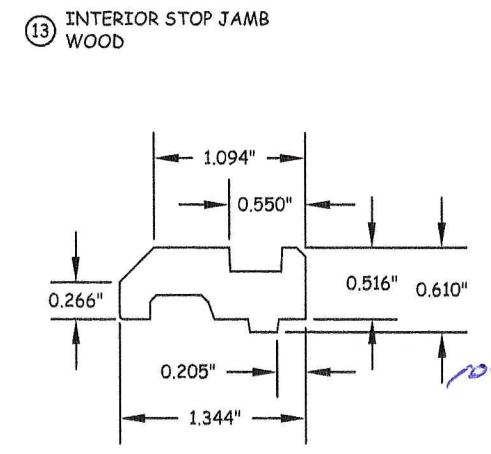
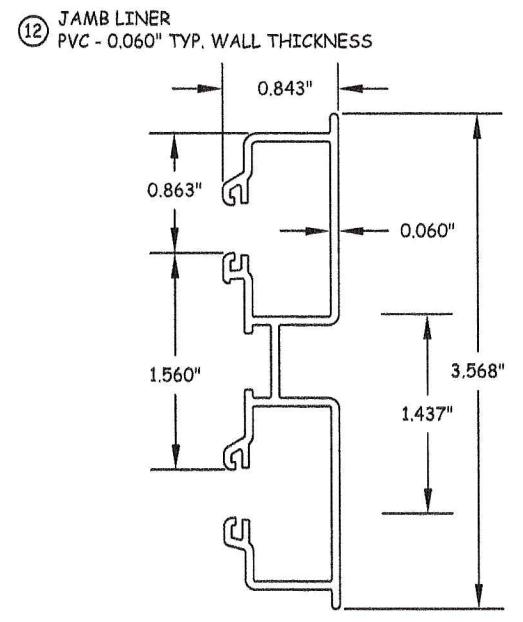
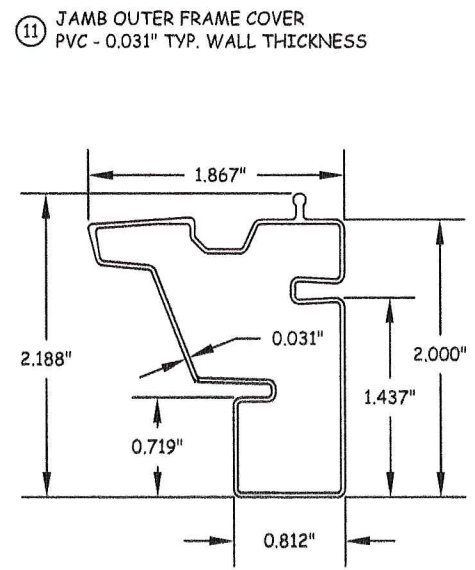
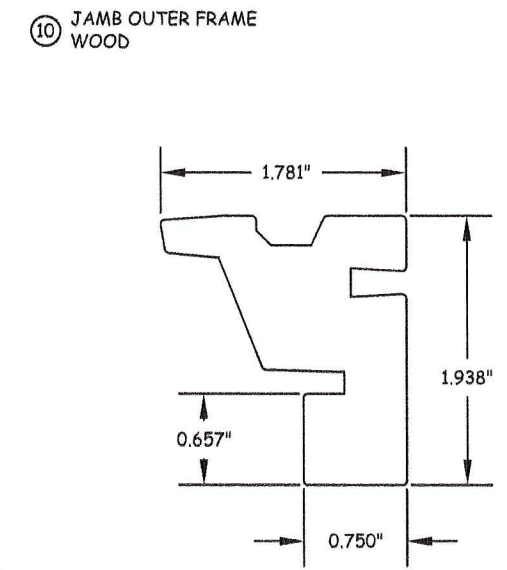
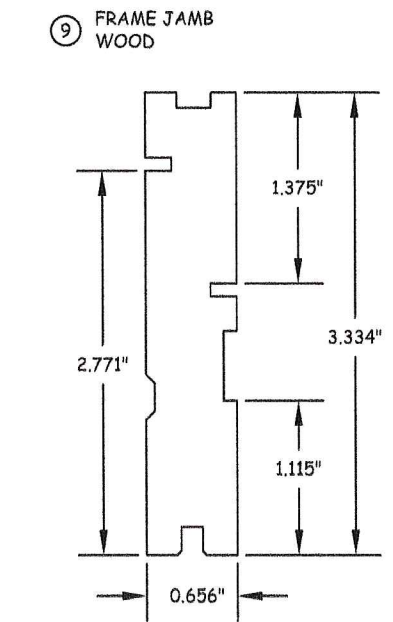
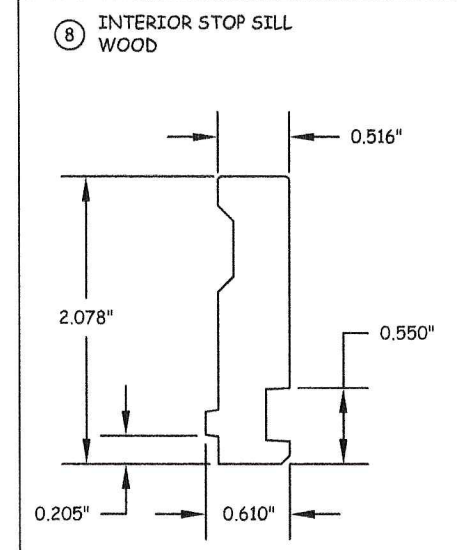
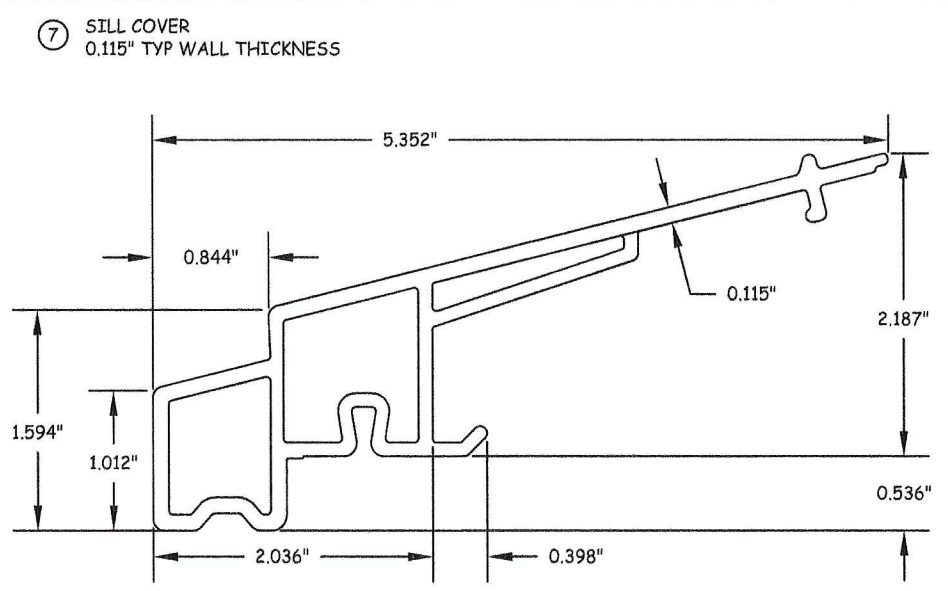
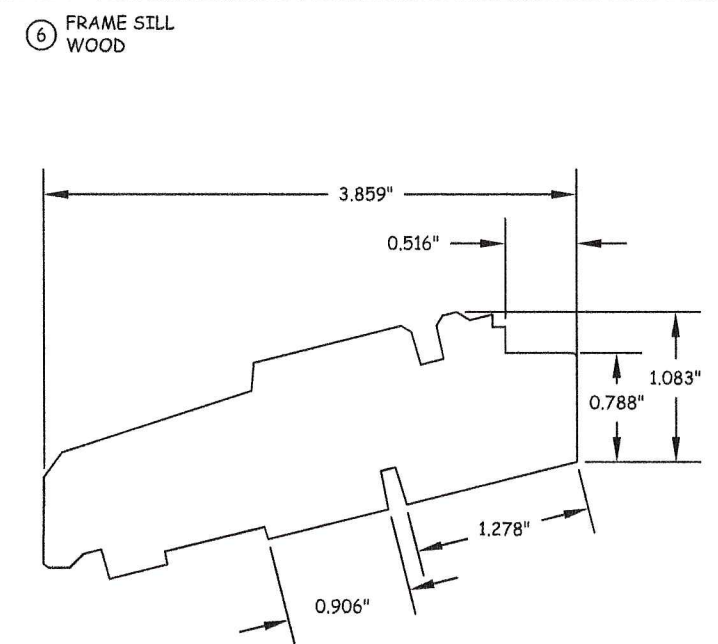
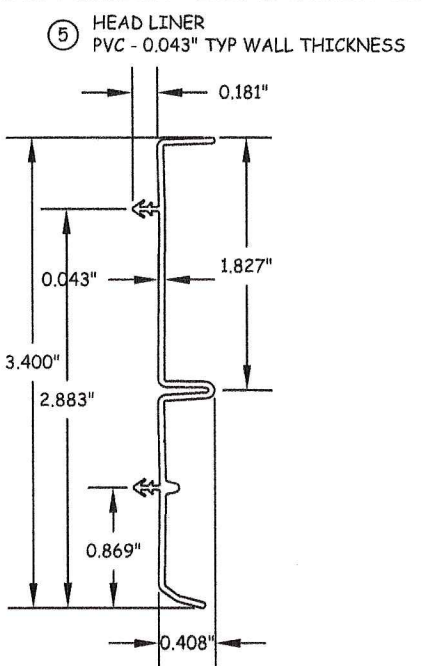
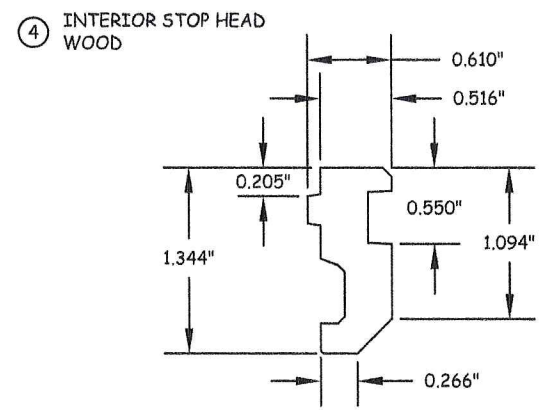
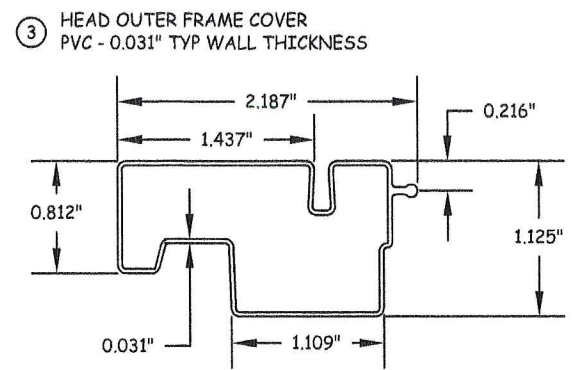
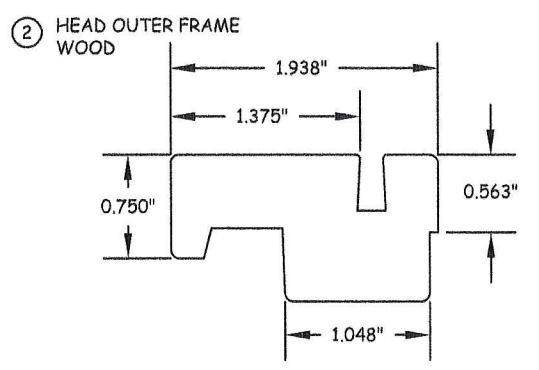
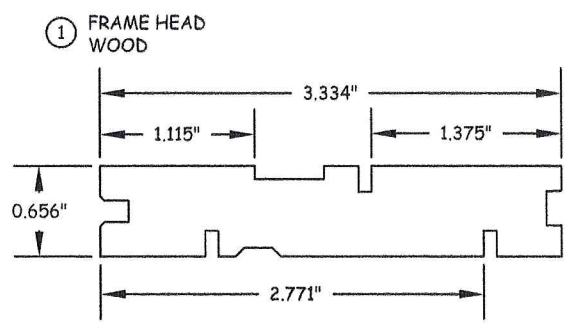

REVISIONS

NO.	DESCRIPTION	BY	DATE

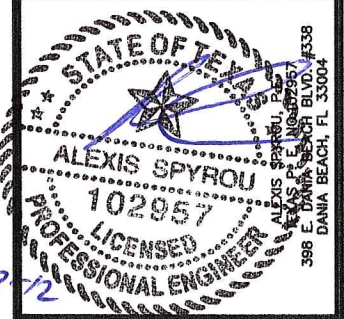

DATE: 8.02.12  
DWN BY: BD  
CHK BY: DB  
SCALE: NTS  
DWG #: AWD054  
SHEET: 5 OF 6

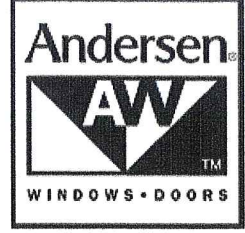

100 FOURTH AVE N NORTH  
 BAYPORT, MN 55003-1096  
 PH: (651) 264-5150 FX: (651) 264-5485

TITLE: SERIES 400 TILT WASH DH  
 COMPONENTS AND  
 BILL OF MATERIALS  
 PREPARED BY: BUILDING DROPS, INC.  
 398 E. DANIA BEACH BLVD. #338  
 DANIA BEACH, FL 33004  
 PH: (954) 399-8478 FX: (954) 744-4738

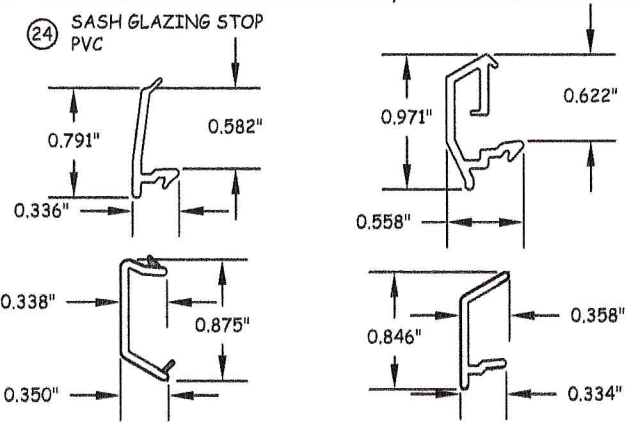
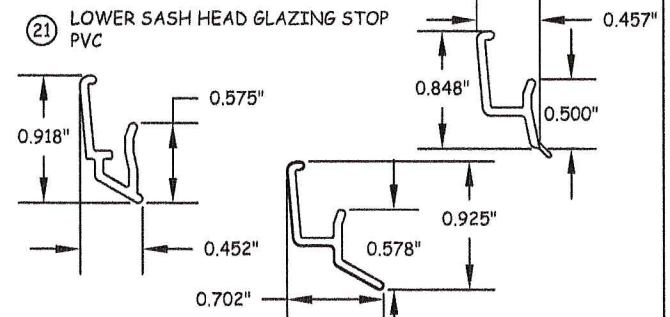
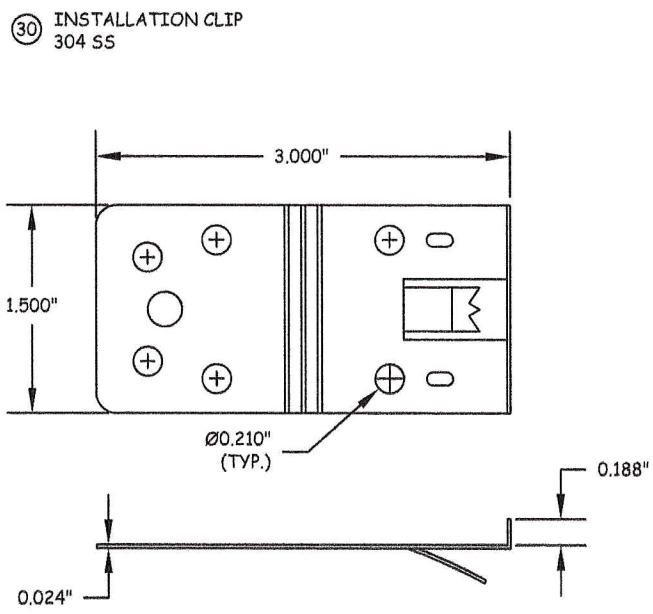
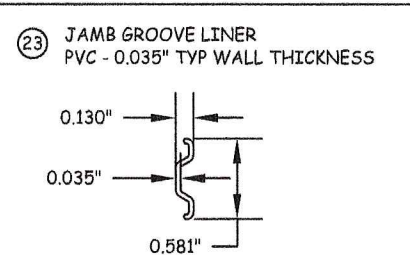
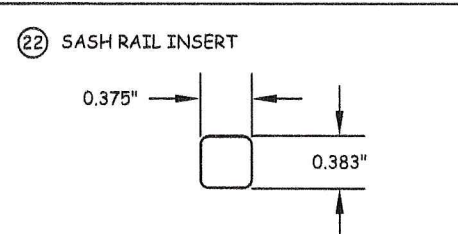
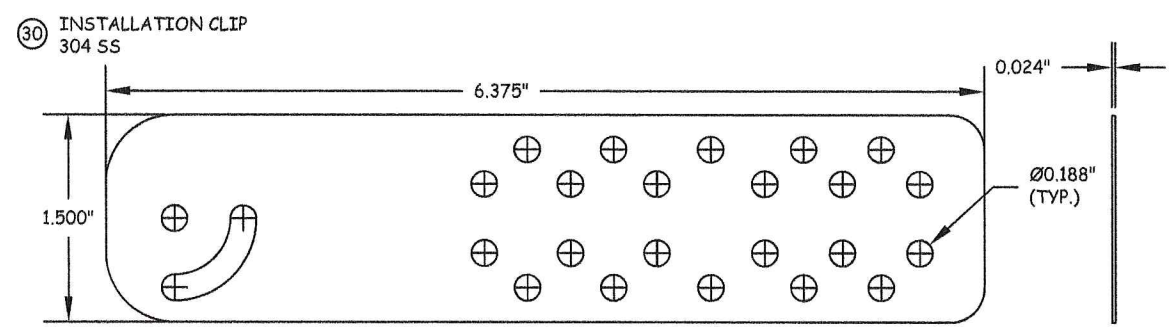
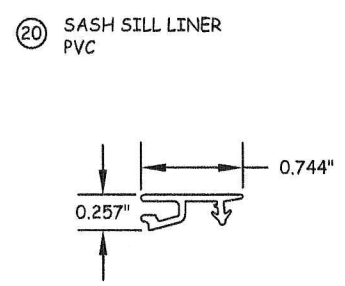
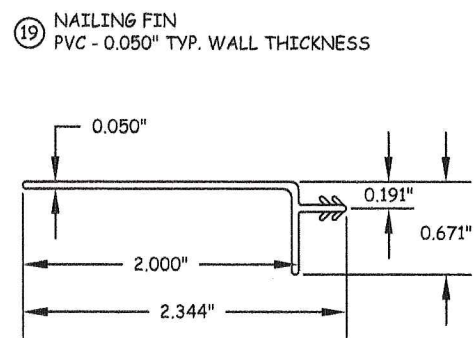
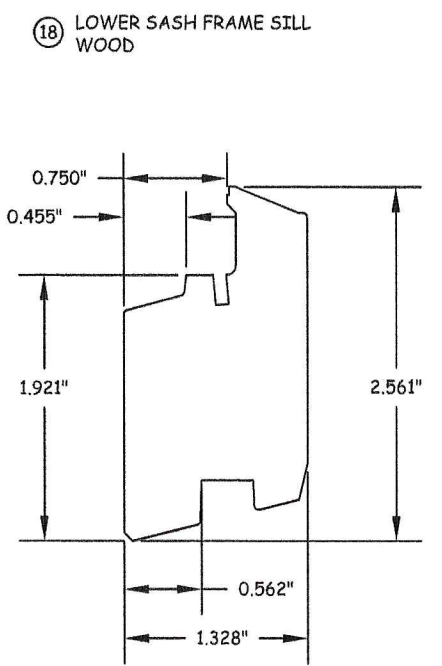
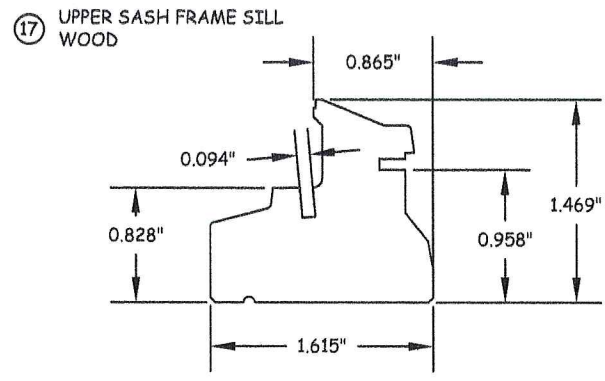
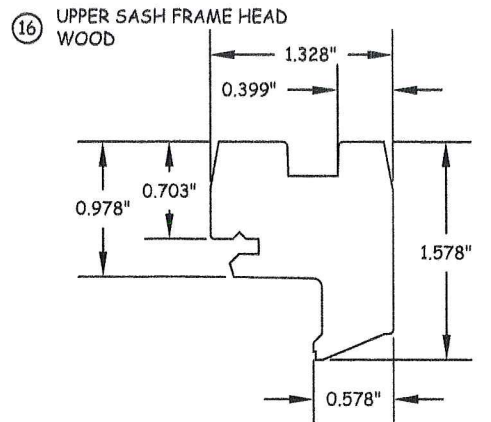
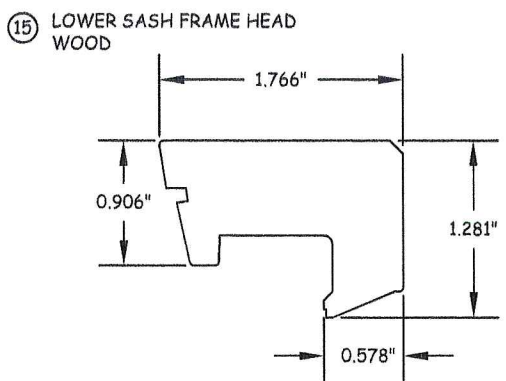
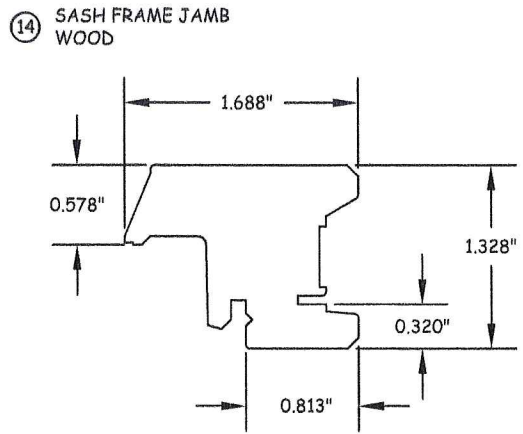

BILL OF MATERIALS			
NO	PART NUMBER	DESCRIPTION	MANUFACTURER
1		FRAME HEAD	ANDERSEN
2		HEAD OUTER FRAME	ANDERSEN
3		HEAD OUTER FRAME COVER	ANDERSEN
4		INTERIOR STOP HEAD	ANDERSEN
5		HEAD LINER	ANDERSEN
6		FRAME SILL	ANDERSEN
7		SILL COVER	ANDERSEN
8		INTERIOR STOP SILL	ANDERSEN
9		FRAME JAMB	ANDERSEN
10		JAMB OUTER FRAME	ANDERSEN
11		JAMB OUTER FRAME COVER	ANDERSEN
12		JAMB LINER	ANDERSEN
13		INTERIOR STOP JAMB	ANDERSEN
14		SASH FRAME JAMB	ANDERSEN
15		LOWER SASH FRAME HEAD	ANDERSEN
16		UPPER SASH FRAME HEAD	ANDERSEN
17		UPPER SASH FRAME SILL	ANDERSEN
18		LOWER SASH FRAME SILL	ANDERSEN
19		NAILING FIN	ANDERSEN
20		SASH SILL LINER	ANDERSEN
21		LOWER SASH HEAD GLAZING STOP	ANDERSEN
22		SASH RAIL INSERT	ANDERSEN
23		JAMB GROOVE LINER	ANDERSEN
24		SASH GLAZING STOP	ANDERSEN
25		0.398" O.A. LAMINATED GLASS CONSISTING OF: 0.154" ANNEALED GLASS, 0.090" PVB INTERLAYER, 0.154" ANNEALED GLASS	
26		0.642" O.A. LAMINATED IG GLASS CONSISTING OF: 0.087" ANNEALED GLASS, AIR SPACE 0.091 ANNEALED GLASS 0.090" PVB INTERLAYER, 0.091" ANNEALED GLASS	
27		NOT USED	
28		WIND LOAD BRACKET, LH	ANDERSEN
29		WIND LOAD BRACKET, RH	ANDERSEN
30		INSTALLATION CLIP	ANDERSEN
31		OFM BRACKET	ANDERSEN
32		SETTING BLOCK	
33		GE 565 7700	GE
34		WEATHER STRIPPING	
35		#8-15 X 1-1/4" PAN HEAD SCREW	
36		#8-15 X 3" PAN HEAD SCREW	
37		#8-15 X 1" FLAT HEAD SCREW	
38		SASH LOCK ASSEMBLY	

NO.	REVISIONS	
	DESCRIPTION	DATE

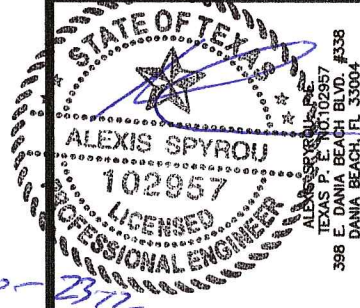

DATE: 8.02.12  
 DWN BY: BD  
 CHK BY: DB  
 SCALE: NTS  
 DWG #: AWD054  
 SHEET: 6 OF 6

NOTE: ALL WOOD TO BE PONDEROSA PINE OR EQUAL