

CLOPAY MODEL 902 / IDEAL MODEL C2AL

MAX 12'-2" WIDE 18' HIGH

NOTE: DOUBLE TRACK LOW HEADROOM, HI-LIFT TRACK, FOLLOW-THE-ROOF TRACK, AND VERTICAL LIFT TRACK ARE AVAILABLE OPTIONS. 3" TRACK ALSO AVAILABLE.

THE OPTIONAL GLAZING SHOWN ON THIS DRAWING MEETS THE WIND LOAD REQUIREMENTS OF THE FLORIDA BUILDING CODE OR INTERNATIONAL BUILDING CODE BUT DOES NOT MEET THE IMPACT RESISTANT REQUIREMENT FOR WINDBORNE DEBRIS REGIONS (REFER TO CHAPTER 16 FBC / IBC).

REV	DATE	DESCRIPTION
01	01/24/05	REVISED BRANDING OF MODELS
02	7/2005	UPDATED CODE REF.
03	10/2005	ADDED ROLLER OPTION
04	11/2008	REVISED JAMB ATTACHMENT AND VERT. TRACK; ADDED MPC.
05	02/2012	UPDATED WINDCODE CHART
06	08/2012	REVISED FOR TDI
07	06/2013	REMOVED ACRYLIC GLAZING.
08	08/2016	REMOVED WIND SPEED TABLE.

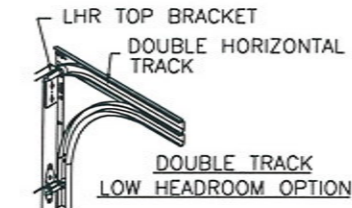
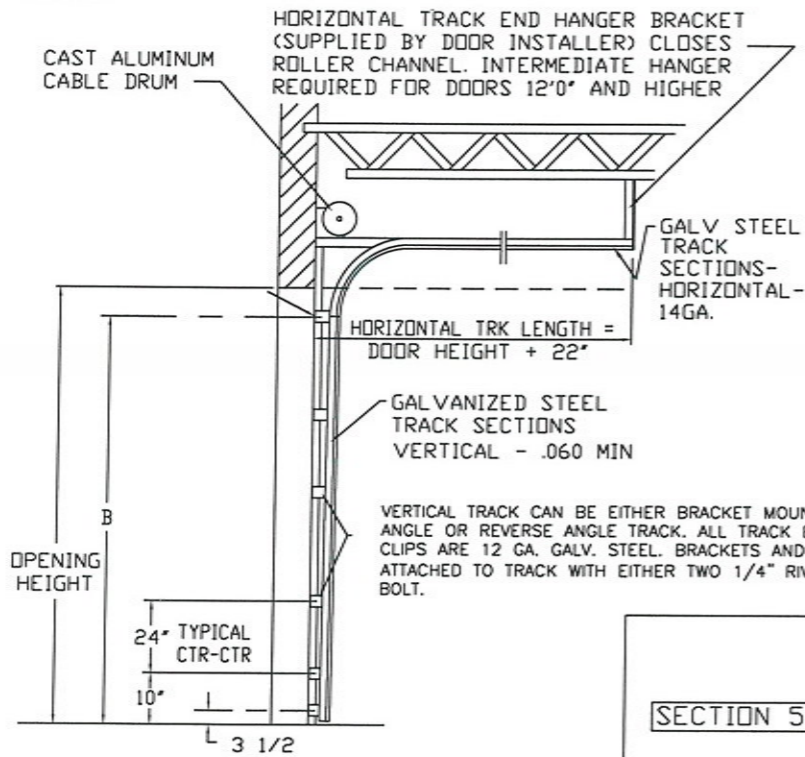

NOTE: DOUBLE TRACK LOW HEADROOM, HI-LIFT TRACK, FOLLOW-THE-ROOF TRACK, AND VERTICAL LIFT TRACK ARE AVAILABLE OPTIONS. 3" TRACK ALSO AVAILABLE.

MODEL IS MADE OF 6063-T5 ALUMINUM EXTRUSIONS.
WALL THICKNESS:
TOP & BOTTOM RAILS .075
INTER. TOP & BOTTOM RAILS .075
TDP HAS .1 x 1.875" FIN
INTER. TOP RAIL CAP .040
SINGLE & DOUBLE END STILES .075
CENTER STILES .062

HEIGHT 'A'	NUMBER OF SECTIONS	NUMBER OF 2 x 2 x 1/8 ALUM ANGLES
UP TO 8-0	4	5
8-3 THRU 10-0	5	6
10-3 THRU 12-0	6	7
12-3 THRU 14-0	7	8
14-3 THRU 16-0	8	9
16-3 THRU 18-0	9	10

MAX. SECTION HEIGHT: 24"

END STILES FASTENED TO RAILS WITH FULL LENGTH 5/16" ALUMINUM RODS AND FLANGE NUTS

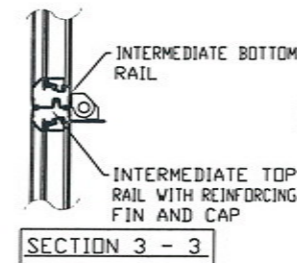

CENTER STILES FASTENED TO RAILS WITH FULL LENGTH 5/16" ALUMINUM RODS AND FLANGE NUTS



COR-LONLY CENTER HINGE OF 16 GA. GALV. STEEL, ATTACHED TO INTER. BOTTOM RAIL WITH (2) #14 x 5/8" SHT MTL SCREWS AND TO INTER. TOP RAIL WITH (2) 1/4" - 20 x 1/2" HEX HEAD MACHINE SCREWS & NUTS

SIDE ELEVATION STANDARD-LIFT TRACK DETAILS

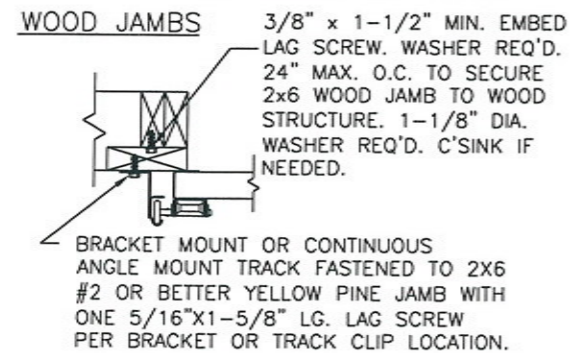

SECTION 5-5

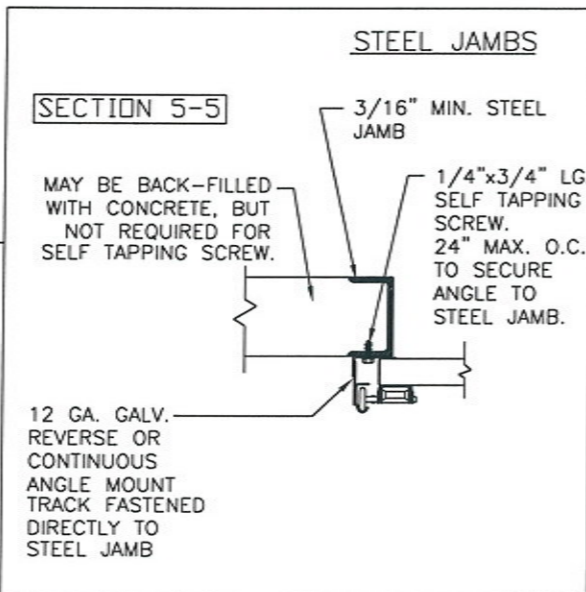

SECTION 5-5

WOOD JAMB ON CONCRETE

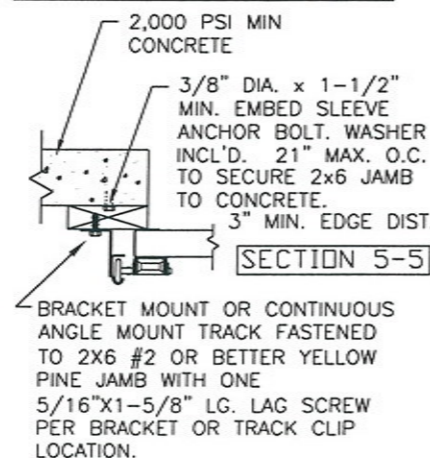

SECTION 5-5

CONCRETE JAMBS

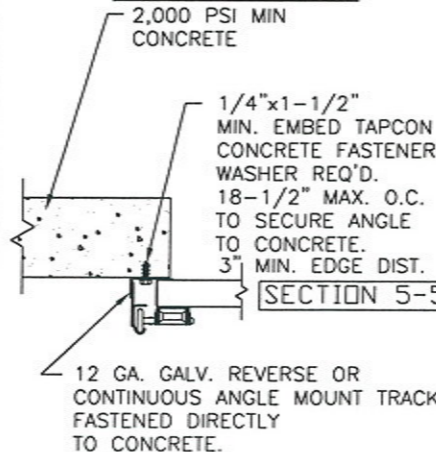

SECTION 5-5

REINFORCING ANGLE - REFER TO SECTION 1-1 FOR INSTALL.

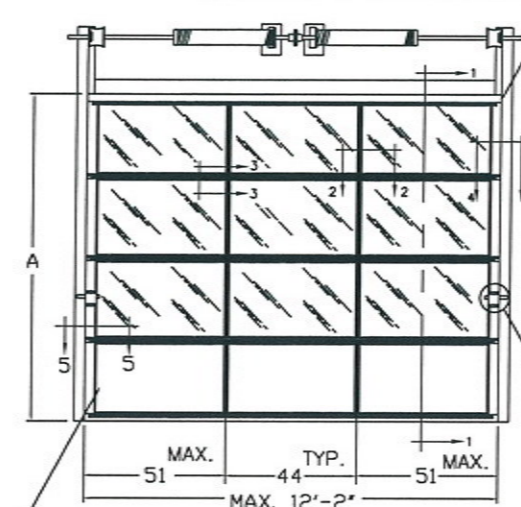

ALL PANELS IN BOTTOM SECTION TO BE .050" THICK SMDTH ALUMINUM.

PADLOCK HOLE



VIEW 'A'

TWO POINT LOCKING

SECTION 1-1

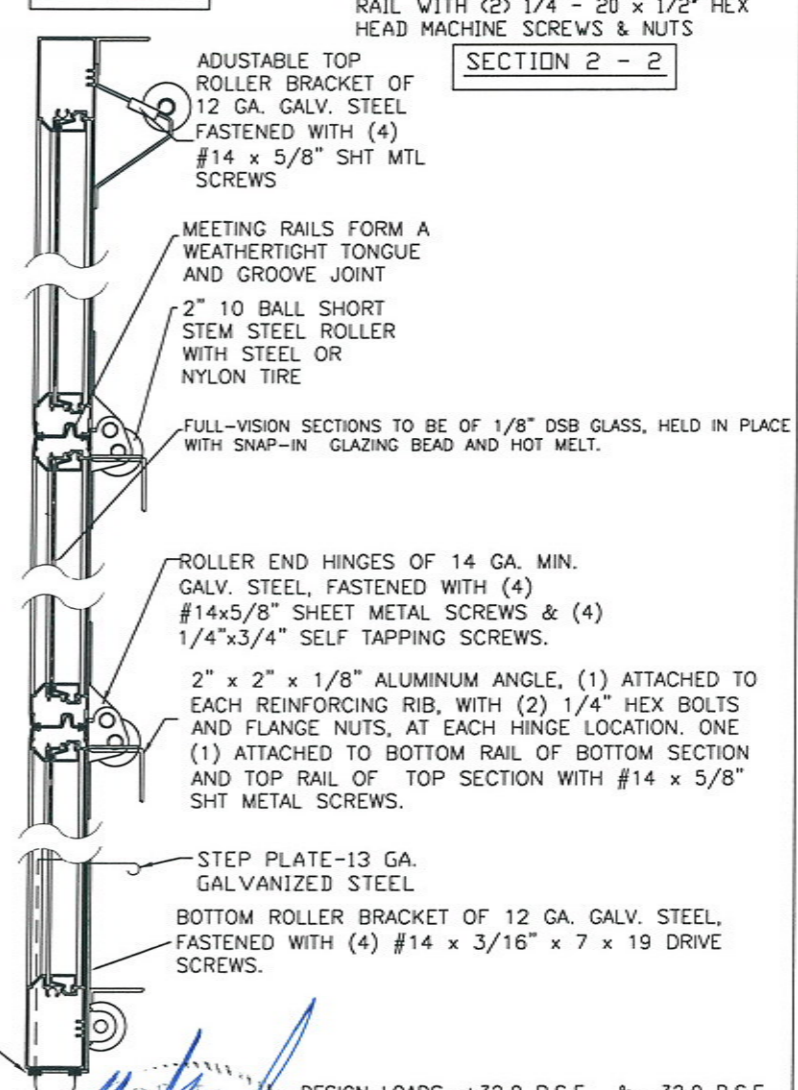

SECTION 2-2

BOTTOM SECTION REINFORCED WITH A TEMPERED ALUMINUM EXTRUSION WITH INTEGRAL RETAINER FOR FLEXIBLE VINYL ASTRAGAL.
ASTRAGAL TO BE 3 1/2" FLEXIBLE VINYL WITH RIBS

DESIGN LOADS: +32.0 P.S.F. & -32.0 P.S.F.
TEST LOADS: +48.0 P.S.F. & -48.0 P.S.F.

DESIGN ENGINEER: MARK WESTERFIELD, P.E.
FLORIDA P.E. #48495, NC P.E. #23832, TEXAS P.E. #9F313

Clopay
Building Products
Company

CLOPAY BUILDING PRODUCTS COMPANY
8585 DUKE BLVD.
MASON, OH 45040
(513) 770-4800
CLOPAY CORP.
ALL RIGHTS RESERVED.

MANUFACTURING PRODUCT CODE:
MPC: C-AL-1F499
DATE: 1-17-92
DRAWN BY: LEG
CHECKED BY:

WINDLOAD RATING: W5
MANUFACTURED / PURCHASED: MAN.
DESCRIPTION: M/N 902 DES LOAD +/-32 PSF
DRAWING NUMBER: 103275
VER: TDI

THE DESIGN OF THE SUPPORTING STRUCTURAL ELEMENTS IS THE RESPONSIBILITY OF THE BUILDING ENGINEER OR ARCHITECT OF RECORD.