

Section A-A

Section B-B

Section C-C

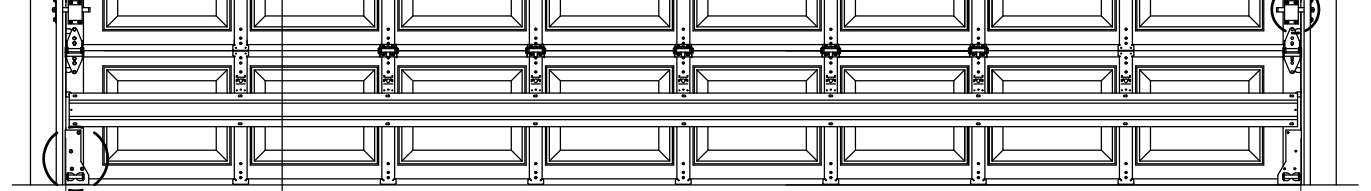

Interior Elevation

Doors tested per ANSI/DASMA 108 for static air pressure and ANSI/DASMA 115 for large missile impact and cyclic wind pressure

Max. Door Width	Colonial			Ranch			Carriage House		
	Stiles per Sect.	Hinges per Sect.	Design Loads	Stiles per Sect.	Hinges per Sect.	Design Loads	Stiles per Sect.	Hinges per Sect.	Design Loads
8'-0"	3	1	29.7 -33.1	3	1	29.7 -33.1	3	1	29.7 -33.1
9'-0"	3	1		3	1		3	1	
10'-0"	4	2		3	1		3	1	
12'-0"	5	3		5	3		5	3	
14'-0"	6	4		5	3		5	3	
16'-0"	7	5	7	5	7	5			

John E. Scates  
2560 King Arthur Blvd, Ste 124-54  
Lewisville, TX 75056  
FL PE #51737  
TX PE #56308-12203

Rev.	Description	ECO	Date	ECO: 7679.01
B	Removed vent option on sheet 1.	7679.04	12/09/19	
A	New release for production.	7679.01	02/18/19	

Scale: None  
 Drawn by: R. Frey  
 Checked by: G. Wedekind  
 Date: 02/18/19  
 Title: Spec, Wind Load BuildMark / TradeMark  
 No. P-2904  
 Sheet 1 of 3  
 Rev B



1101 East River Road  
Dixon, IL 61021

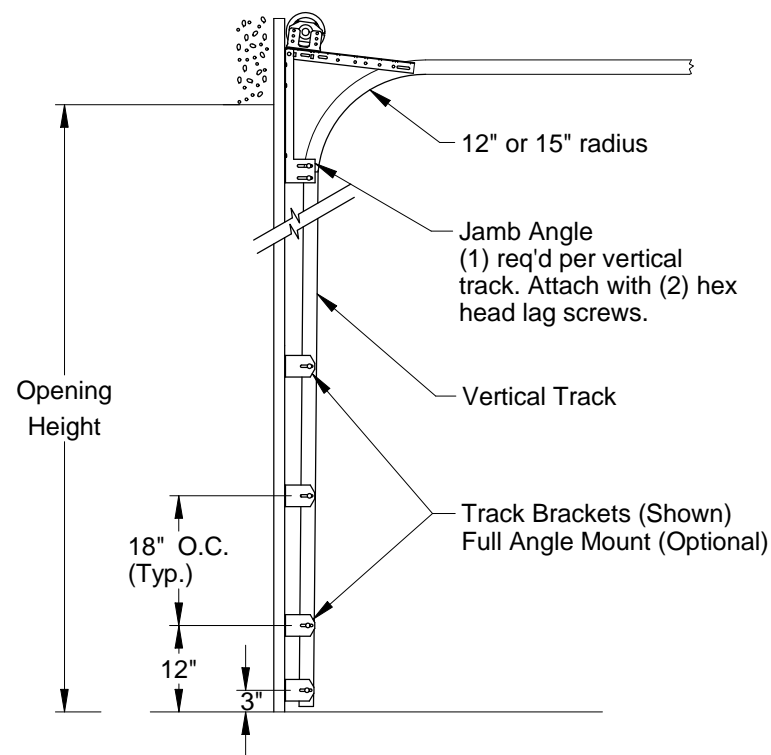

**Typical Track Installation**  
Normal headroom track shown, low headroom, lift clearance and vertical lift track available

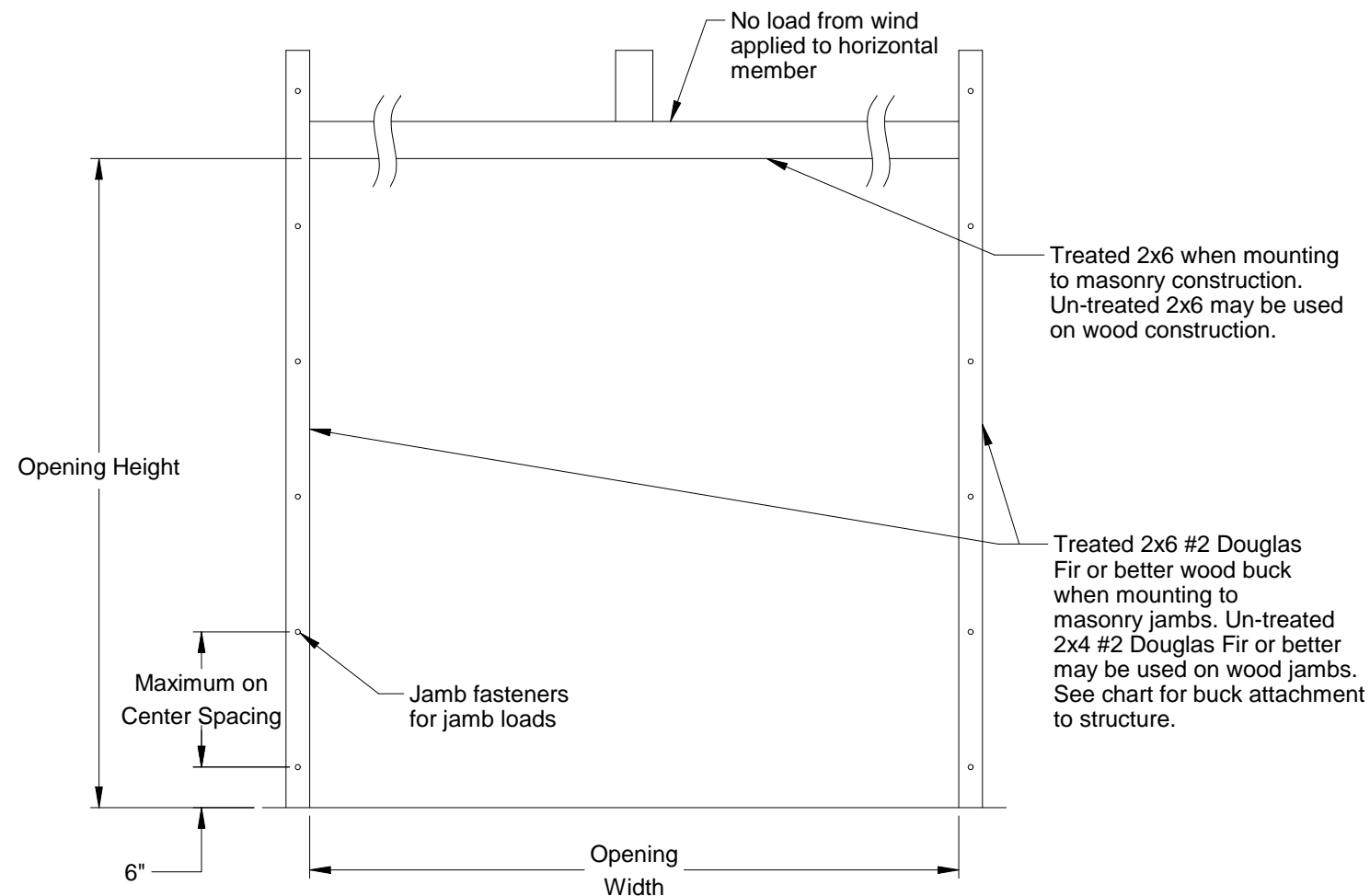

**Jamb Attachment Notes:**

1. Maximum Positive Load per Jamb =  $(16'-0" \times 29.7 \text{ PSF}) / 2 = 238 \text{ lbs. per foot.}$
2. Maximum Negative Load per Jamb =  $(16'-0" \times -33.1 \text{ PSF}) / 2 = 265 \text{ lbs. per foot.}$
3. Design of the supporting structure shall be the sole responsibility of the building designer and shall be designed for the jamb loads listed in notes 1 and 2.
4. Alternate jamb attachments may be used if approved by a registered Professional Engineer.
5. DASMA Technical Data Sheet TDS-161 may be used for alternate jamb attachments.
6. 3/8" diameter lag screws required 1/16" pilot hole and 1-1/2" minimum required distance.

**2x6 Attachment to Structure**

Structure Type	Fastener Type	Minimum Embedment	Minimum Edge Distance	Minimum on Center Spacing	Maximum on Center Spacing	Allowable Tension Load
2500 PSI Min. Concrete	1/4" Tapcon+ (Plus) with 1-1/8" OD Washer	2"	2.5"	6"	24"	526
Southern Pine	3/8" x 3" Lag with 1-1/8" OD Washer	1.50"	1.50"	1.50"	24"	655
Spruce Pine Fir	3/8" x 3" LAG with 1-1/8" OD Washer	1.50"	1.50"	1.50"	24"	482

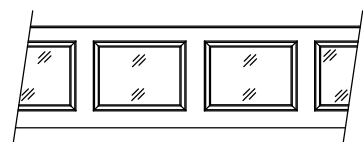

**Window Options**

Colonial windows:  
1/4" Polycarbonate

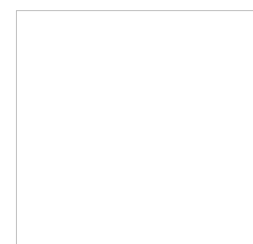

John E. Scates  
2560 King Arthur Blvd, Ste 124-54  
Lewisville, TX 75056  
FL PE #51737  
TX PE #56308-f2203

Scale: None
Drawn by: R. Frey
Checked by: G. Wedekind
Date: 02/18/19
ECO: 7679.01



1101 East River Road  
Dixon, IL. 61021

Title: Spec, Wind Load  
BuildMark / TradeMark

No. P-2904

Sheet 2

Rev B

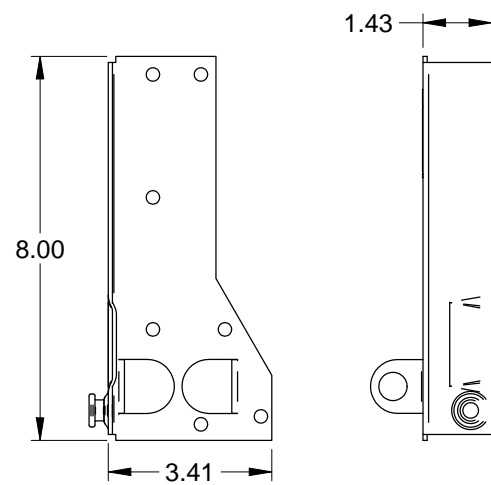

Corner Bracket  
.086 Galv. Steel

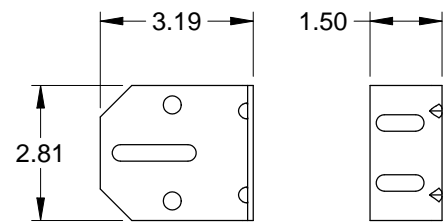

3" Track Bracket  
.116 Galv. Steel

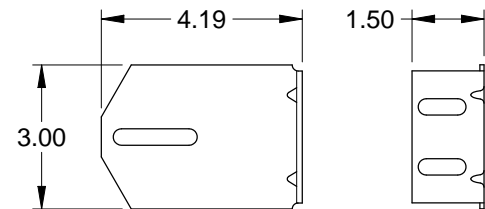

4" Track Bracket  
.116 Galv. Steel

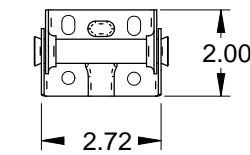

Center Hinge  
.045 Galv. Steel

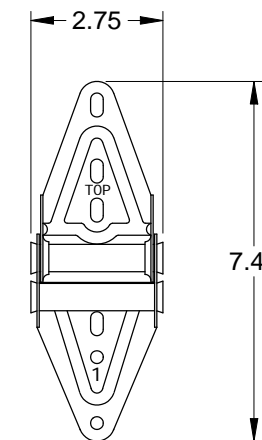

Edge Hinge  
.086 Galv. Steel

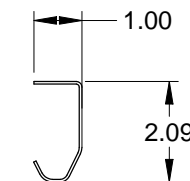

2" Track  
.086 Galv. Steel

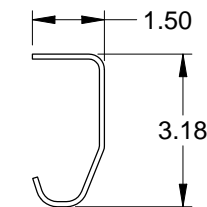

3" Track (Optional)  
.105 Galv. Steel

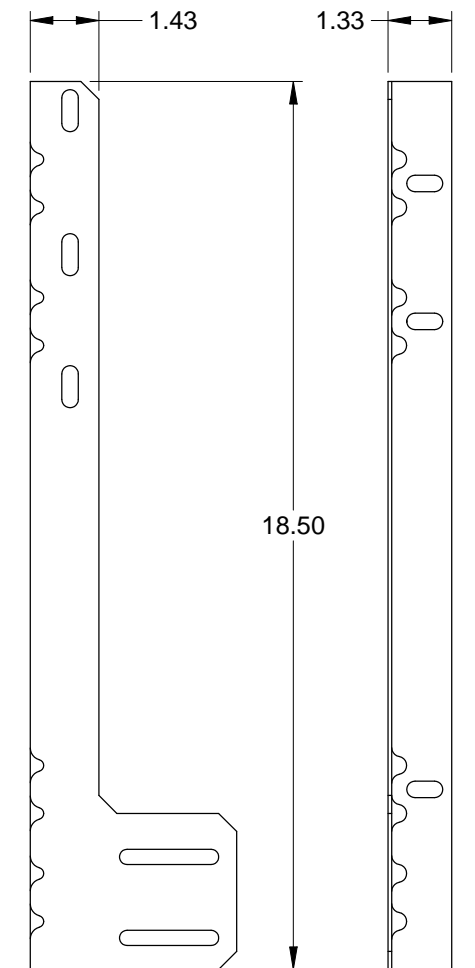

Jamb Angle  
.078 Galv. Steel

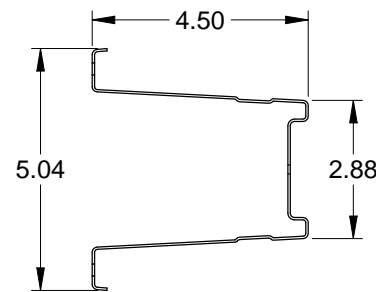

Steel Box Strut  
20 Ga. (.035" Min.) Galvanized  
High Tensile Steel  
80 KSI Minimum Yield

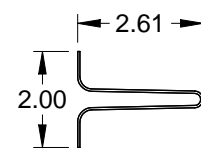

Steel U-Bar  
18 Ga. (.049" min.) Galvanized  
High Tensile Steel  
80 KSI Minimum Yield

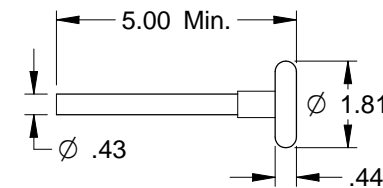

2" Roller  
Nylon 11-ball (Std.)  
Steel 10-ball (Opt.)

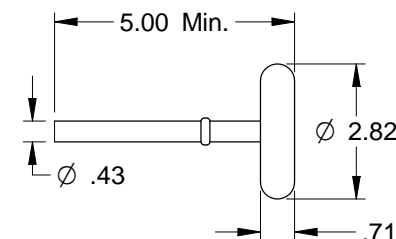

3" Roller  
Steel 10-ball (Opt.)

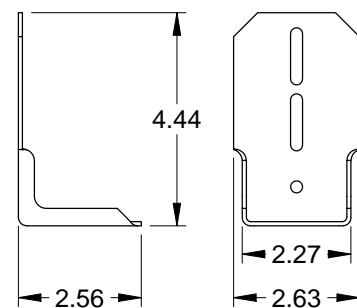

Top Fixture  
.086 Galv. Steel

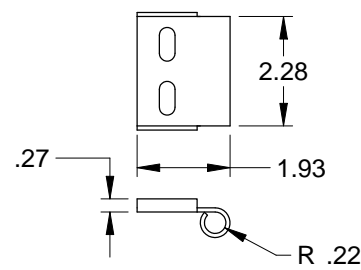

Roller Carrier  
.116 Galv. Steel  
Attached to Top Fixture  
w/(2) Track Bolts and Whiz Nuts

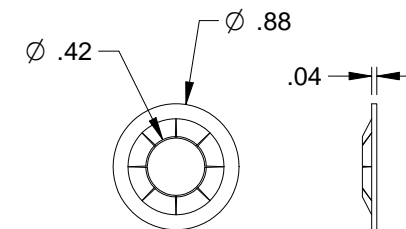

Retaining Nut

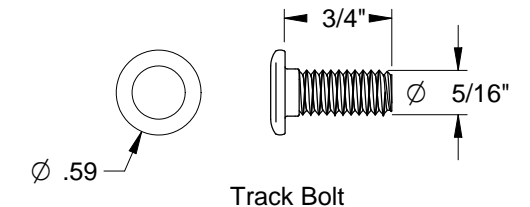

Track Bolt

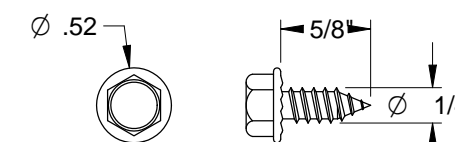

Sheet Metal Screw

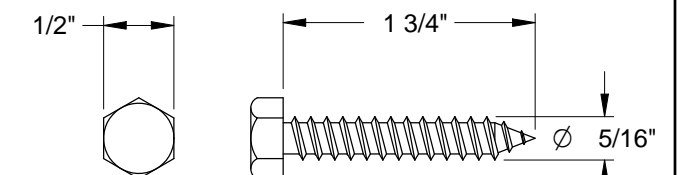

Hex Head Lag Screw

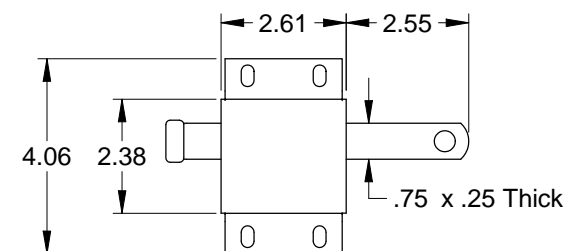

Slide Lock  
Case .086 Galv. Steel

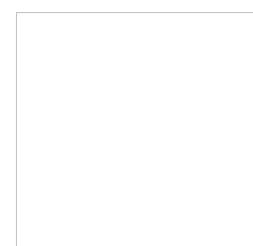

John E. Scates  
2560 King Arthur Blvd, Ste 124-54  
Lewisville, TX 75056  
FL PE #51737  
TX PE #56308-f2203

Scale: None
Drawn by: R. Frey
Checked by: G. Wedekind
Date: 02/18/19
ECO: 7679.01



1101 East River Road  
Dixon, IL 61021

Title:  
Spec, Wind Load  
BuildMark / TradeMark

No. P-2904

Sheet  
3

Rev  
B