

Section Detail

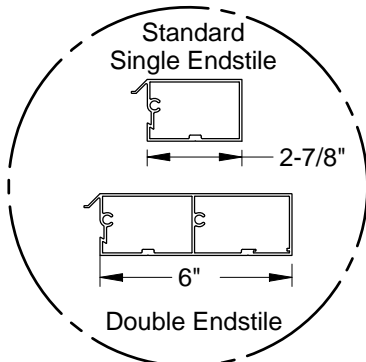

End Stile Detail  
.075 Thick Aluminum Wall Extrusions

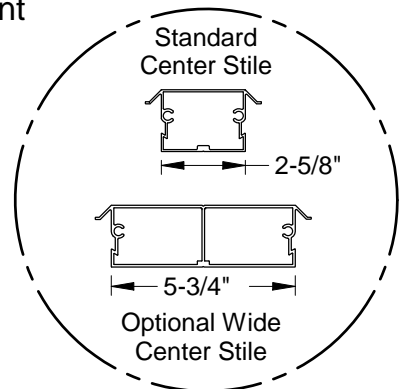

Center Stile Detail  
.075 Thick Aluminum Wall Extrusions

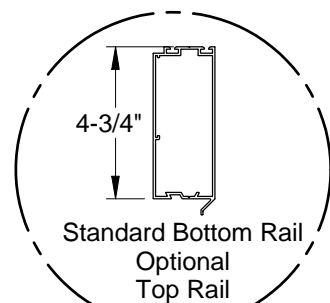

Rail Detail  
.075 Thick Aluminum Wall Extrusions

Doors tested per ANSI/DASMA 108 for static air pressure

Maximum Door Width	Stiles per Sect.	Hinges per Sect.	Design Loads	
12'-2"	2	2	36.5	-46.1
14'-2"	3	3	31.3	-39.6
16'-2"	3	3	27.5	-34.7
18'-2"	4	4	21.8	-27.5

Optional decorative window dividers taped to exterior. 2 over 2 shown, other patterns available.

Panel/Glass  
Max. Size: 44-7/8" x 19-3/4"  
DLO: 44-1/8" x 18-1/2"

Steel Reinforcement  
(2) Ubar per section, fastened to all center and end stiles using (2) self-drilling screws at each stile.

Locks required on doors not electrically operated.

Max. Section Height = 26-1/2"

Max. Door Height  
AlumaView AV200 = 20' - 0"  
StyleView WPF = 10' - 0"  
StyleView CPF = 10' - 0"

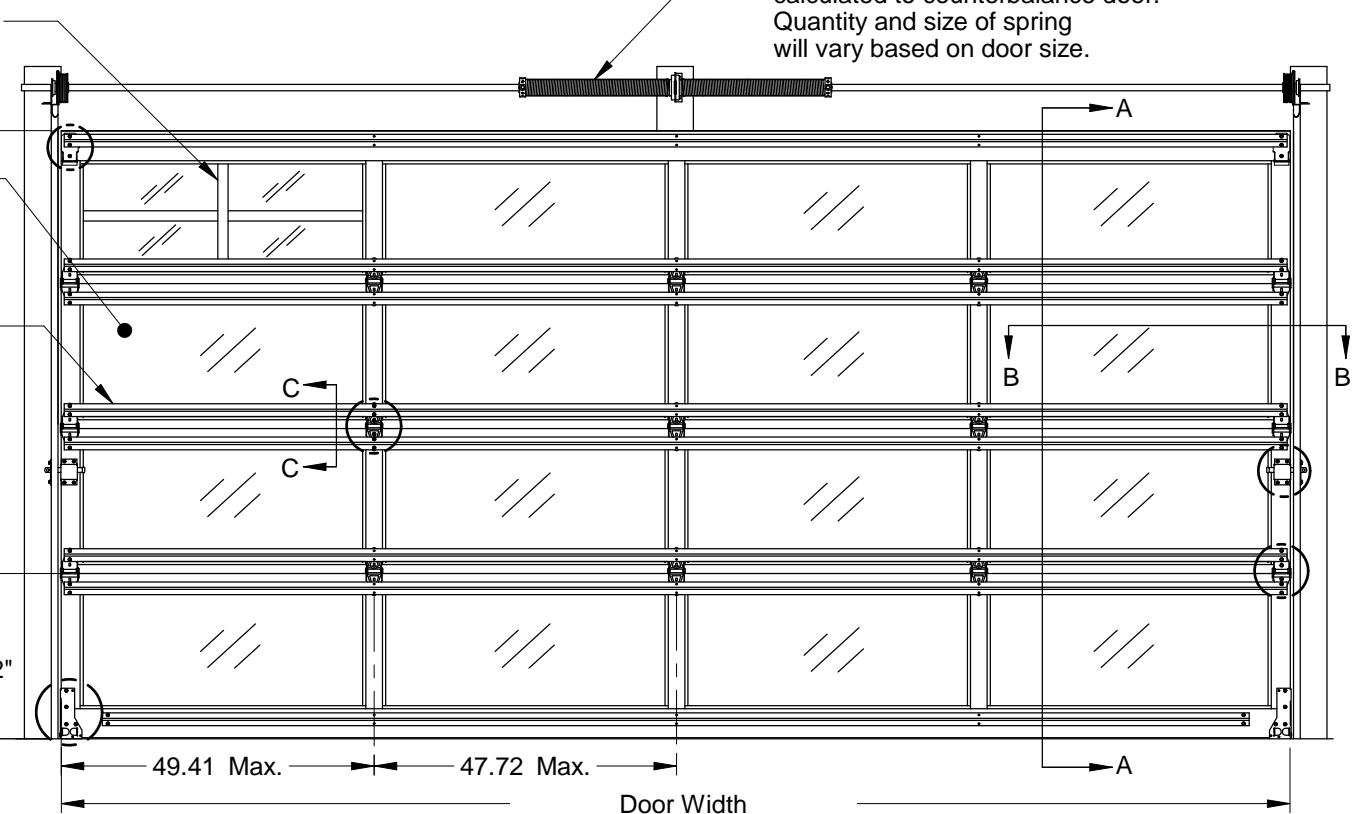

Door Width  
See chart for other door widths (16'-2" shown)  
Interior Elevation

John E. Scates  
2560 King Arthur Blvd, Ste 124-54  
Lewisville, TX 75056  
FL PE #51737  
TX PE #56308-12203

Professional Engineer's seal provided only for verification of wind load construction details

Rev.	Description	ECO	Date	ECO: 7679.01
B	Added glass types on sht 1. Max glass/panel was 19-1/4".	7679.03	12/18/19	
A	New release for production.	7679.01	01/08/19	

Scale: None
Drawn by: R. Frey
Checked by: G. Wedekind
Date: 01/08/19



1101 East River Road  
Dixon, IL. 61021

Title: Spec, Wind Load AlumaView - AV200, StyleView - CPF, WPF	
No. P-2817	Sheet 1 of 3
Rev B	

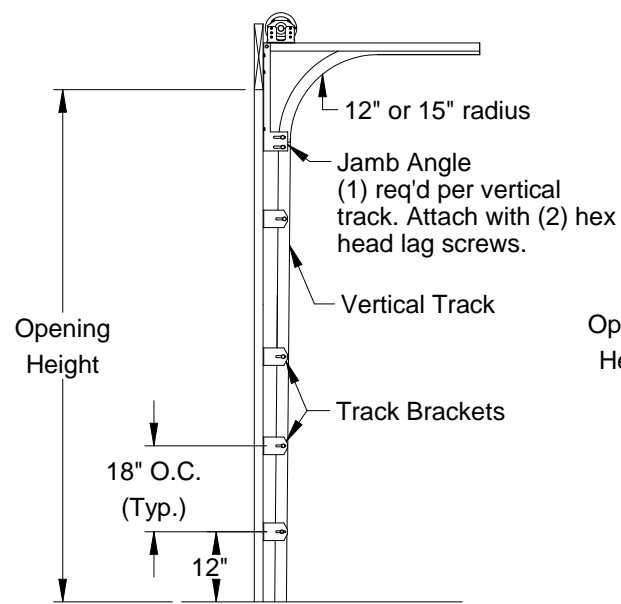

**Typical Track Installation  
Bracket Mount  
Wood Jamb**

Normal headroom track shown, low headroom, lift clearance and vertical lift track available

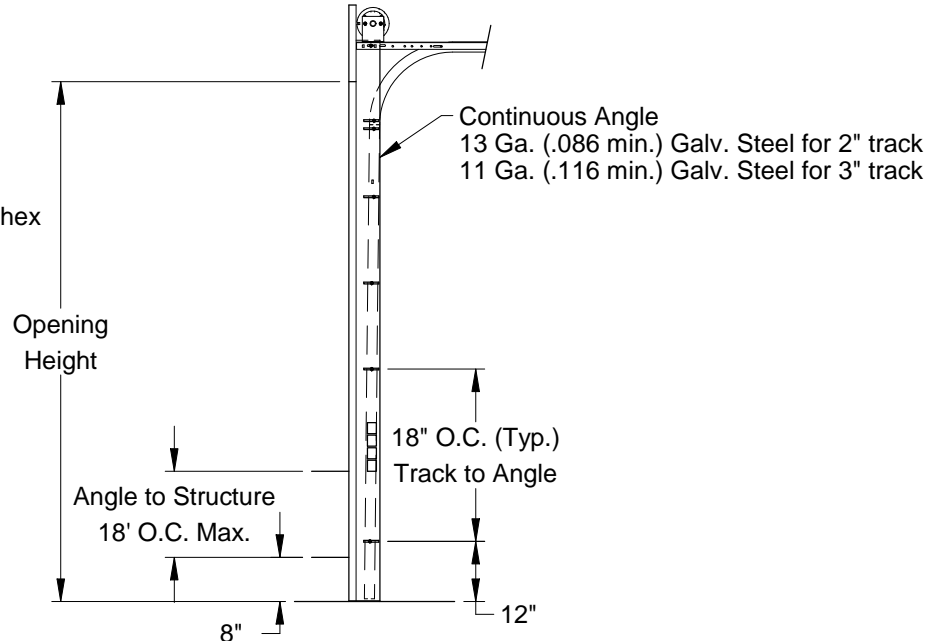

**Typical Track Installation  
Angle Mount  
Wood, Steel or Concrete Jamb**

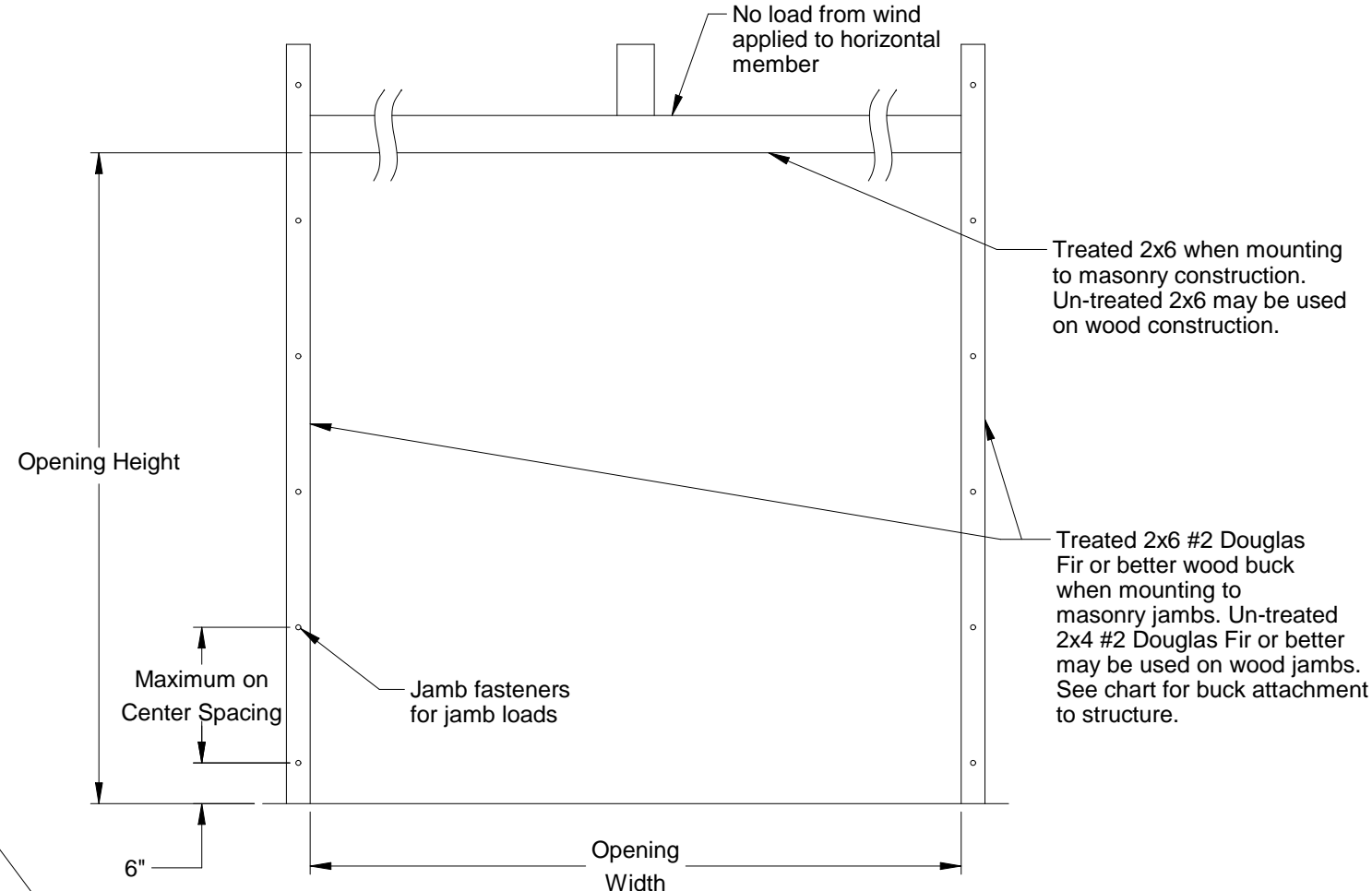

**Jamb Attachment Notes:**

1. Maximum Positive Load per Jamb =  $(16'-2" \times 27.5 \text{ PSF}) / 2 = 223 \text{ lbs. per foot.}$
2. Maximum Negative Load per Jamb =  $(16'-2" \times -34.7 \text{ PSF}) / 2 = 281 \text{ lbs. per foot.}$
3. Design of the supporting structure shall be the sole responsibility of the building designer and shall be designed for the jamb loads listed in notes 1 and 2.
4. Alternate jamb attachments may be used if approved by a registered Professional Engineer.
5. DASMA Technical Data Sheet TDS-161 may be used for alternate jamb attachments.
6. 3/8" diameter lag screws required 1/16" pilot hole and 1-1/2" minimum required distance.

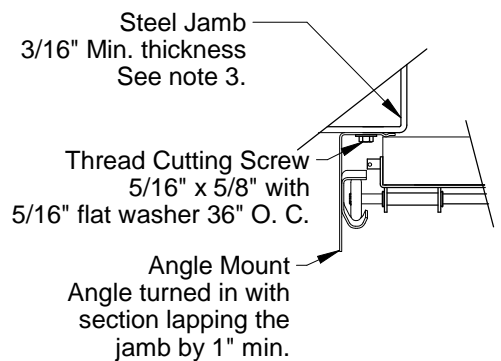

**Track Assembly Attachment  
to Steel Jamb**

2" Track Angle Mount turned in Shown  
3" Track Angle Mount Available

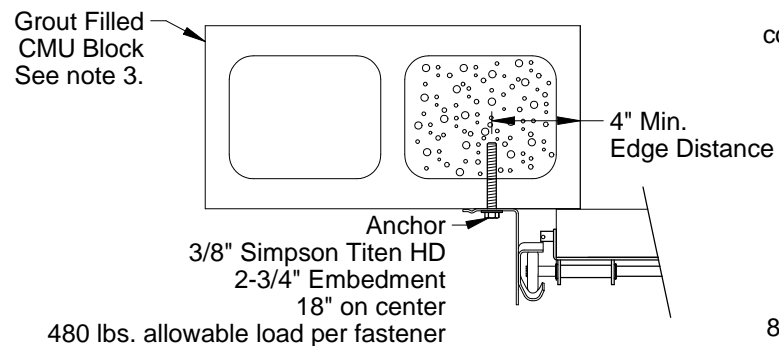

**Track Assembly Attachment  
to Grout Filled CMU Block**

2" Track Angle Mount turned out Shown  
3" Track Angle Mount Available

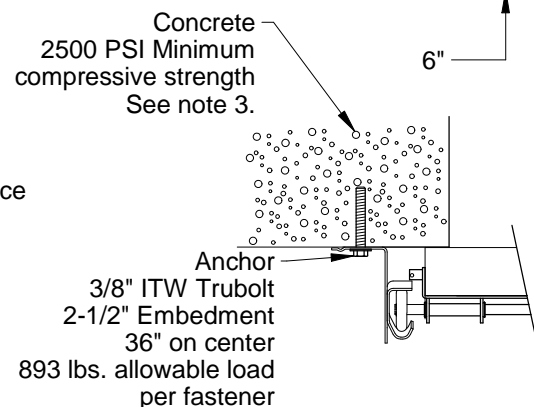

**Track Assembly Attachment  
to 2500 PSI Min. Concrete**

2" Track Angle Mount turned out Shown  
3" Track Angle Mount Available

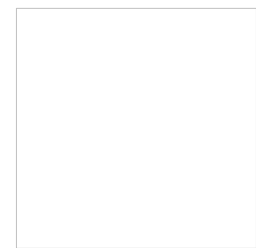

John E. Scates  
2560 King Arthur Blvd, Ste 124-54  
Lewisville, TX 75056  
FL PE #51737  
TX PE #56308-f2203

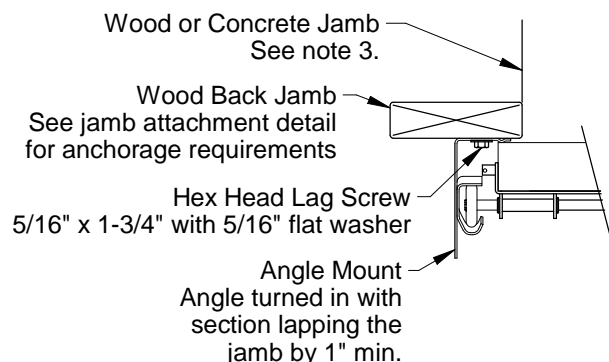

**Track Assembly Attachment  
to Wood Back Jamb**

2" Track Angle Mount turned in Shown  
3" Track Angle Mount Available

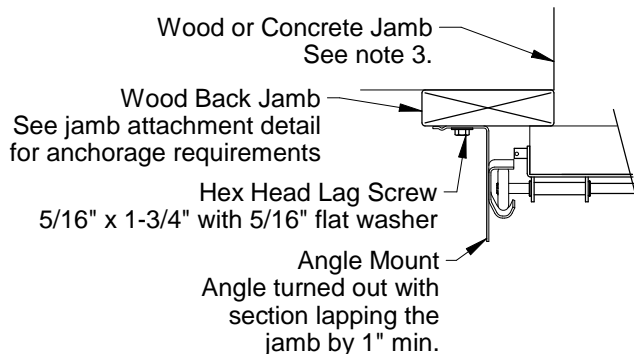

**Track Assembly Attachment  
to Wood Back Jamb**

2" Track Angle Mount turned out Shown  
3" Track Angle Mount Available

2x6 Attachment to Structure						
Structure Type	Fastener Type	Minimum Embedment	Minimum Edge Distance	Minimum on Center Spacing	Maximum on Center Spacing	Allowable Tension Load
2500 PSI Min. Concrete	1/4" Tapcon+ (Plus) with 1-1/8" OD Washer	2"	2.5"	6"	24"	526
Southern Pine	3/8" x 3" Lag with 1-1/8" OD Washer	1.50"	1.50"	1.50"	24"	655
Spruce Pine Fir	3/8" x 3" LAG with 1-1/8" OD Washer	1.50"	1.50"	1.50"	24"	482

Scale: None
Drawn by: R. Frey
Checked by: G. Wedekind
Date: 01/08/19
ECO: 7679.01



1101 East River Road  
Dixon, IL 61021

Title: Spec, Wind Load AlumaView - AV200, StyleView - CPF, WPF		
No. P-2817	Sheet 2	Rev B

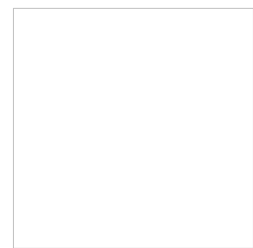
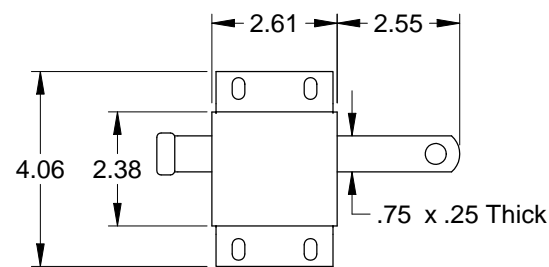
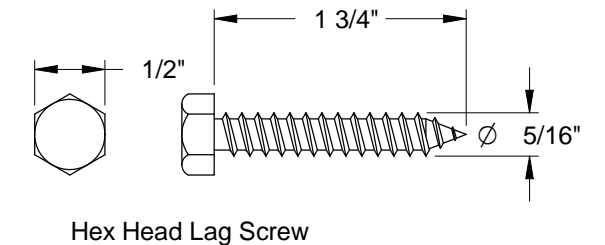
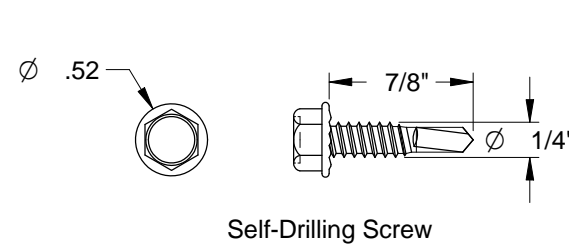
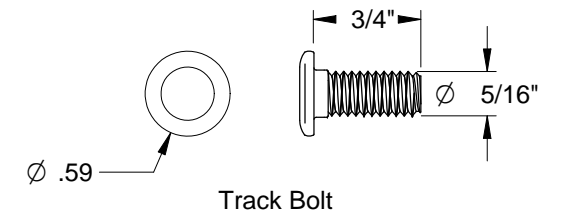
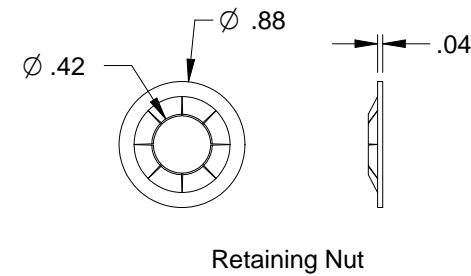
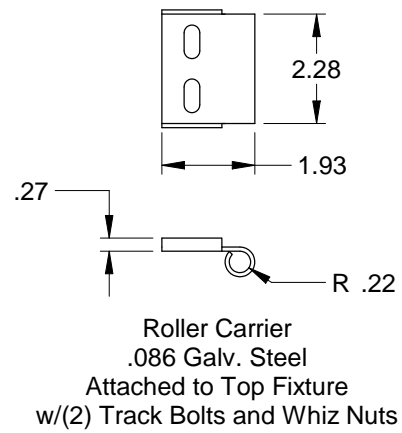
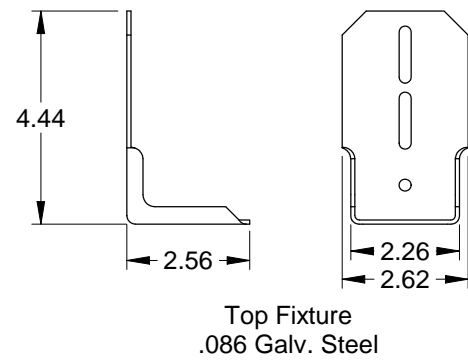
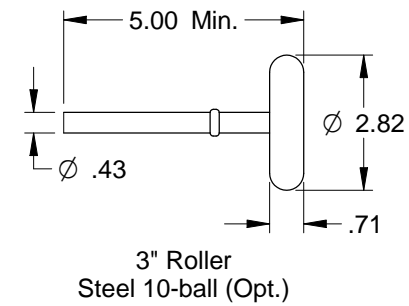
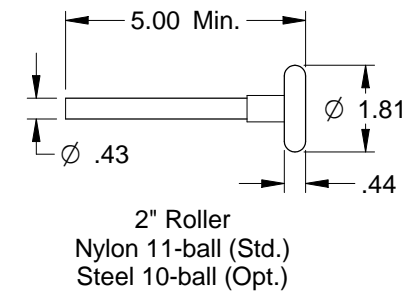
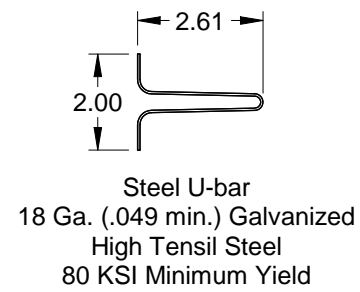
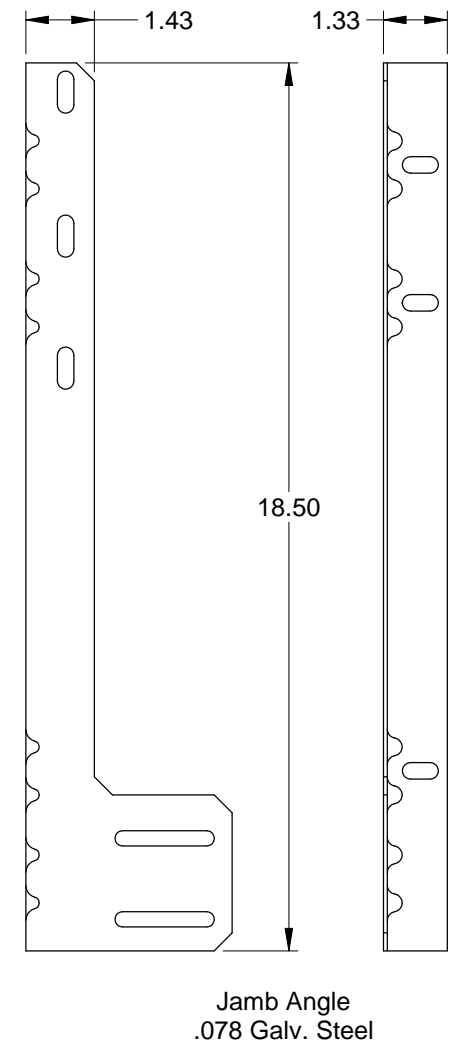
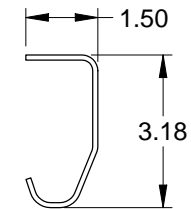
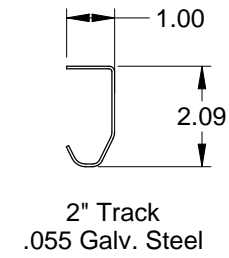
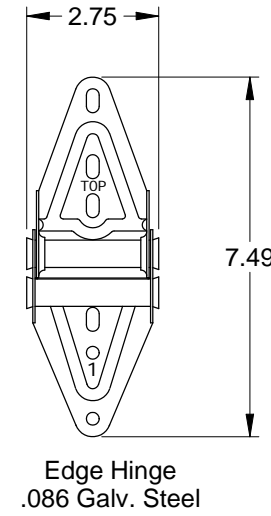
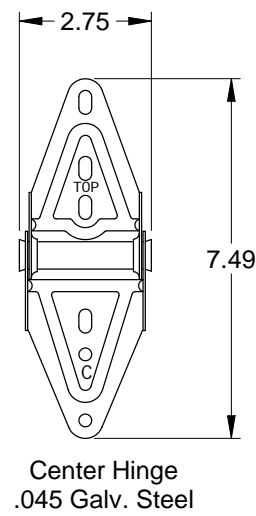
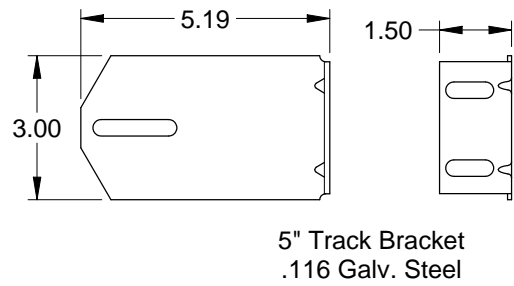
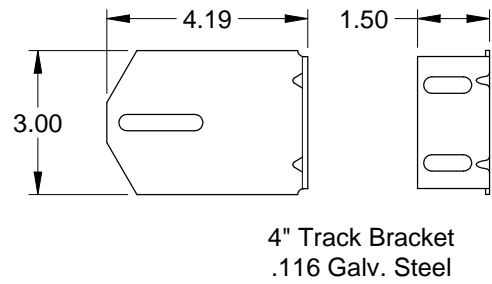
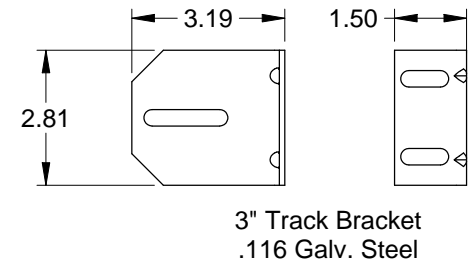
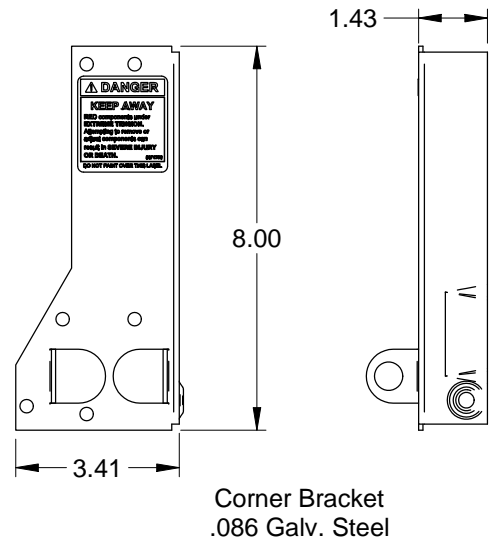

John E. Scates  
2560 King Arthur Blvd, Ste 124-54  
Lewisville, TX 75056  
FL PE #51737  
TX PE #56308-f2203

Scale: None
Drawn by: R. Frey
Checked by: G. Wedekind
Date: 01/08/19
ECO: 7679.01



Title: Spec, Wind Load  
AlumaView - AV200,  
StyleView - CPF, WPF

No. P-2817	Sheet 3	Rev B
------------	---------	-------