

Doors tested per ANSI/DASMA 108 for static air pressure

Maximum Door Width	Stiles per Sect.	Hinges per Sect.	Design Loads
8'-2"	2	2	42.3 -47.9
9'-2"	2	2	37.7 -42.7
10'-2"	2	2	34.0 -38.5
12'-2"	3	3	23.7 -26.9

Rev.	Description	ECO	Date	ECO: 7679.01
B	Added glass types on sht 1. Max glass/panel was 19-1/4".	7679.03	12/18/19	
A	New release for production.	7679.01	01/08/19	

John E. Scates
2560 King Arthur Blvd, Ste 124-54
Lewisville, TX 75056
FL PE #51737
TX PE #56308-12203

Professional Engineer's seal provided only for verification of wind load construction details

Scale: None
 Drawn by: R. Frey
 Checked by: G. Wedekind
 Date: 01/08/19
 ECO: 7679.01

RAYNOR
 1101 East River Road
 Dixon, IL 61021

Title: Spec, Wind Load AlumaView - AV200, StyleView - CPF, WPF

No. **P-2816** Sheet 1 of 3 Rev **B**

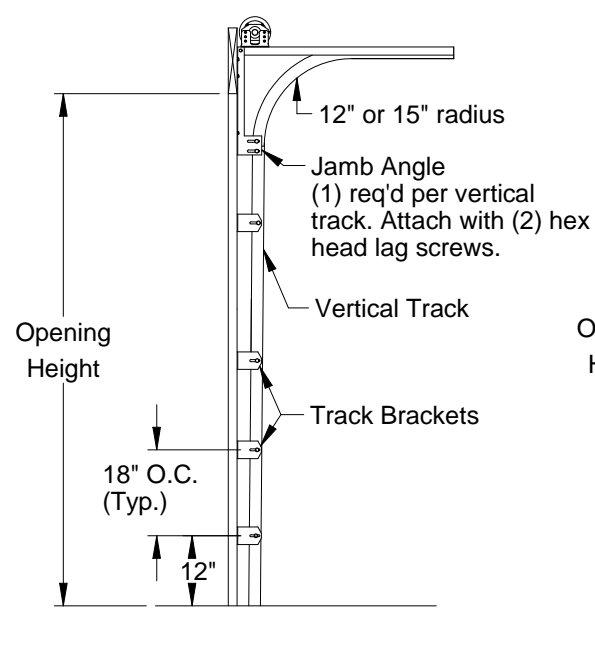

**Typical Track Installation
Bracket Mount
Wood Jamb**

Normal headroom track shown, low headroom, lift clearance and vertical lift track available

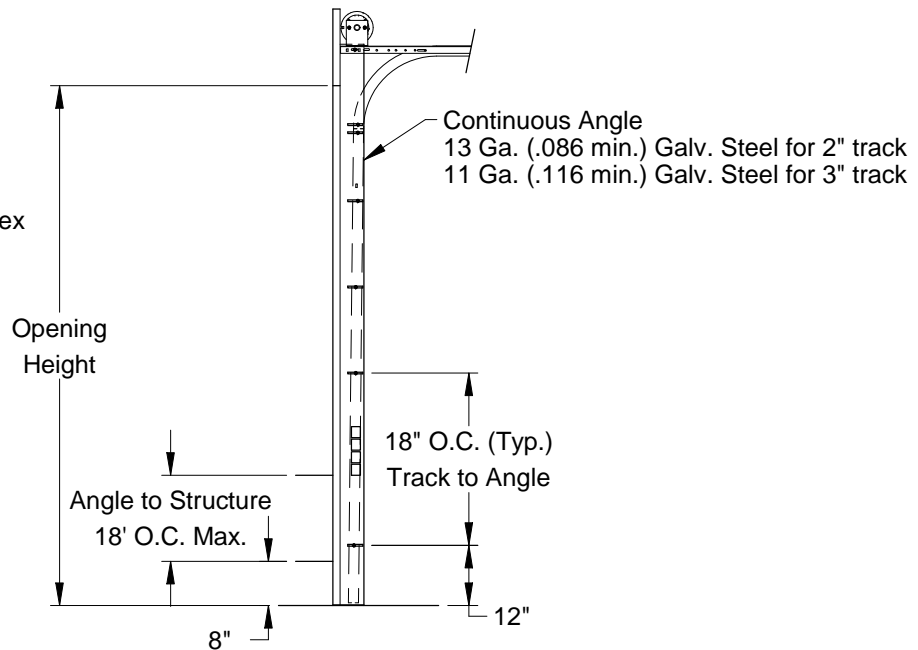

**Typical Track Installation
Angle Mount
Wood, Steel or Concrete Jamb**

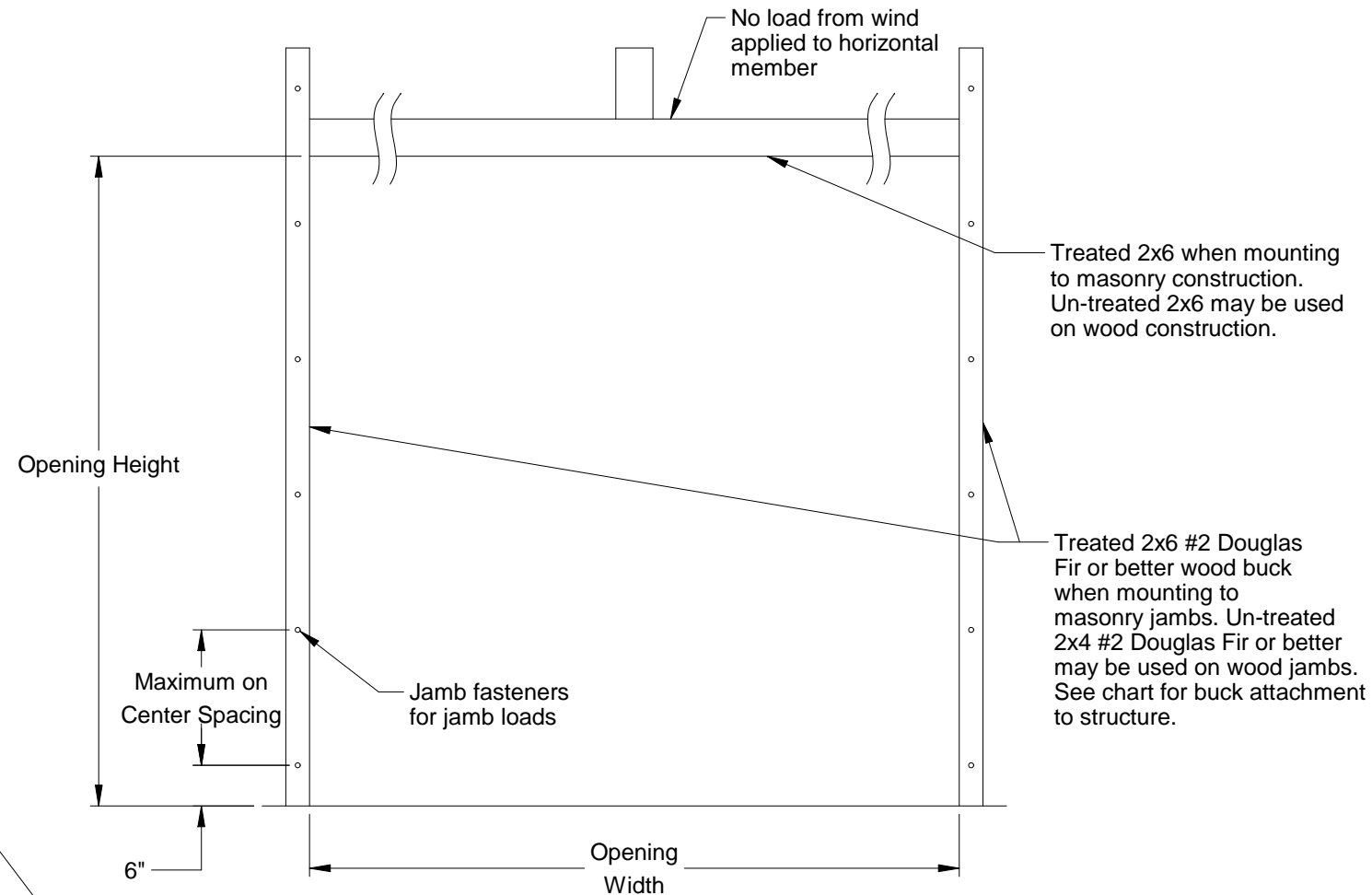

Jamb Attachment Notes:

1. Maximum Positive Load per Jamb = $(10'-2" \times 34.0 \text{ PSF}) / 2 = 173 \text{ lbs. per foot.}$
2. Maximum Negative Load per Jamb = $(10'-2" \times -38.5 \text{ PSF}) / 2 = 196 \text{ lbs. per foot.}$
3. Design of the supporting structure shall be the sole responsibility of the building designer and shall be designed for the jamb loads listed in notes 1 and 2.
4. Alternate jamb attachments may be used if approved by a registered Professional Engineer.
5. DASMA Technical Data Sheet TDS-161 may be used for alternate jamb attachments.
6. 3/8" diameter lag screws required 1/16" pilot hole and 1-1/2" minimum required distance.

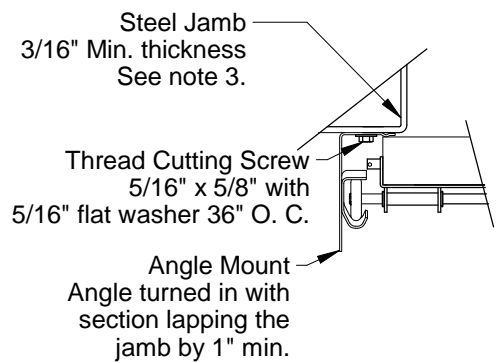

**Track Assembly Attachment
to Steel Jamb**

2" Track Angle Mount turned in Shown
3" Track Angle Mount Available

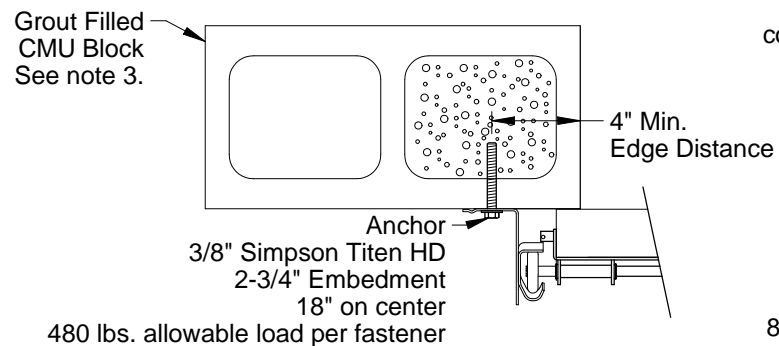

**Track Assembly Attachment
to Grout Filled CMU Block**

2" Track Angle Mount turned out Shown
3" Track Angle Mount Available

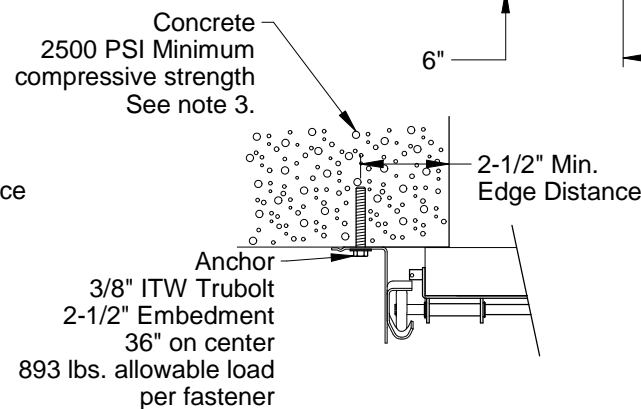

**Track Assembly Attachment
to 2500 PSI Min. Concrete**

2" Track Angle Mount turned out Shown
3" Track Angle Mount Available

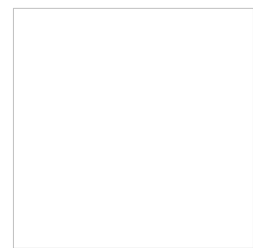

John E. Scates
2560 King Arthur Blvd, Ste 124-54
Lewisville, TX 75056
FL PE #51737
TX PE #56308-12203

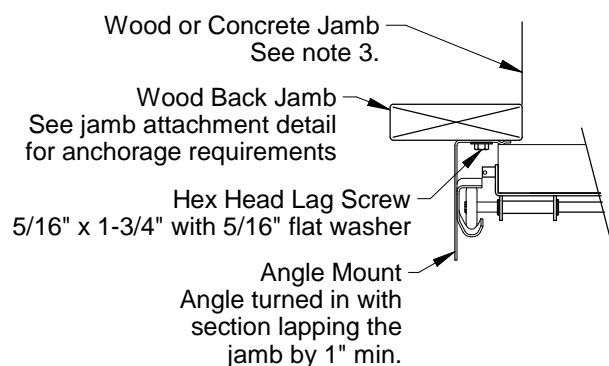

**Track Assembly Attachment
to Wood Back Jamb**

2" Track Angle Mount turned in Shown
3" Track Angle Mount Available

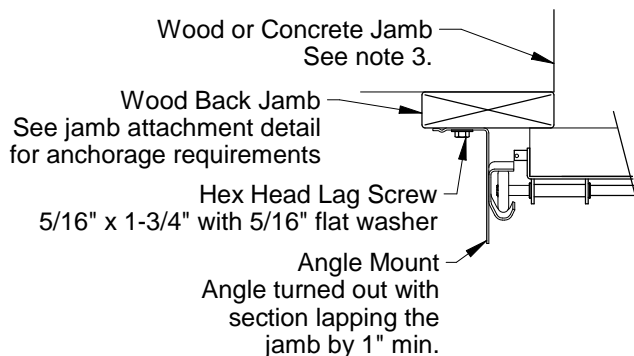

**Track Assembly Attachment
to Wood Back Jamb**

2" Track Angle Mount turned out Shown
3" Track Angle Mount Available

2x6 Attachment to Structure						
Structure Type	Fastener Type	Minimum Embedment	Minimum Edge Distance	Minimum on Center Spacing	Maximum on Center Spacing	Allowable Tension Load
2500 PSI Min. Concrete	1/4" Tapcon+ (Plus) with 1-1/8" OD Washer	2"	2.5"	6"	24"	526
Southern Pine	3/8" x 3" Lag with 1-1/8" OD Washer	1.50"	1.50"	1.50"	24"	655
Spruce Pine Fir	3/8" x 3" LAG with 1-1/8" OD Washer	1.50"	1.50"	1.50"	24"	482

Scale: None
Drawn by: R. Frey
Checked by: G. Wedekind
Date: 01/08/19
ECO: 7679.01



1101 East River Road
Dixon, IL 61021

Title: Spec, Wind Load AlumaView - AV200, StyleView - CPF, WPF		
No. P-2816	Sheet 2	Rev B

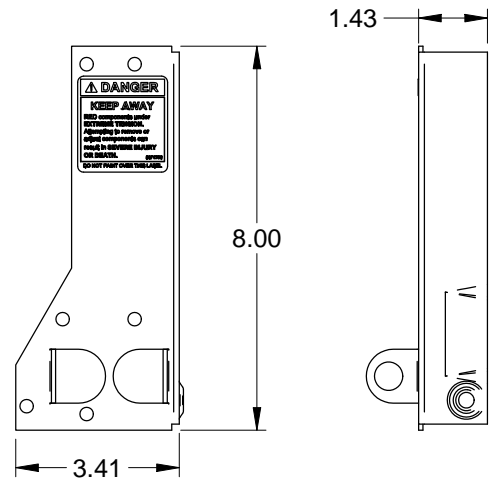

Corner Bracket
.086 Galv. Steel

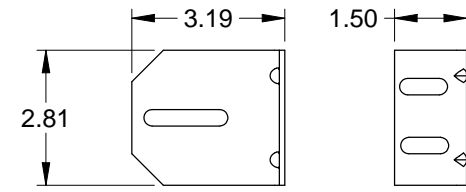

3" Track Bracket
.116 Galv. Steel

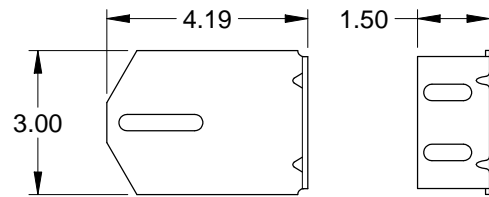

4" Track Bracket
.116 Galv. Steel

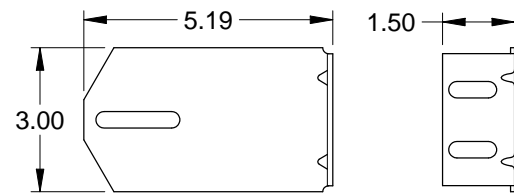

5" Track Bracket
.116 Galv. Steel

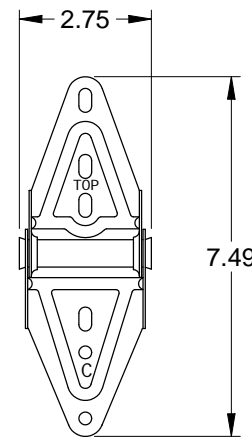

Center Hinge
.045 Galv. Steel

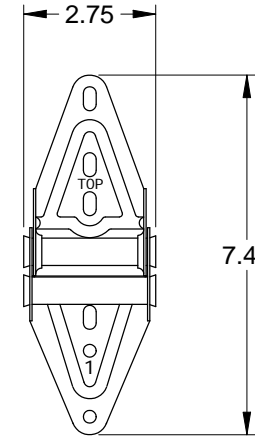

Edge Hinge
.086 Galv. Steel

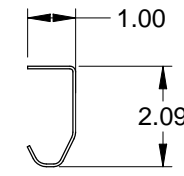

2" Track
.055 Galv. Steel

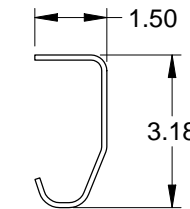

3" Track (Optional)
.105 Galv. Steel

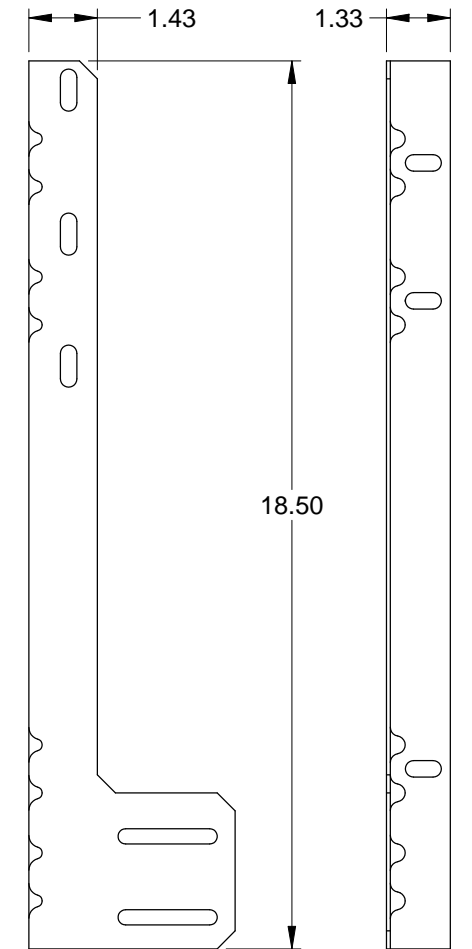

Jamb Angle
.078 Galv. Steel

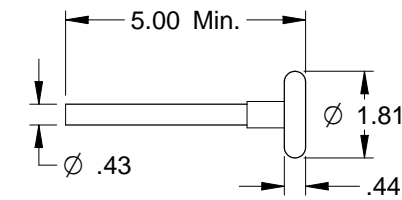

2" Roller
Nylon 11-ball (Std.)
Steel 10-ball (Opt.)

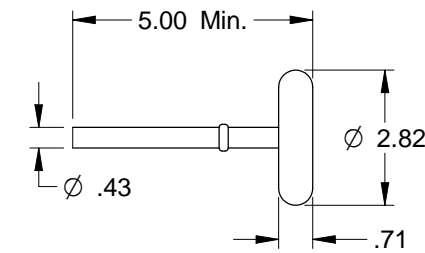

3" Roller
Steel 10-ball (Opt.)

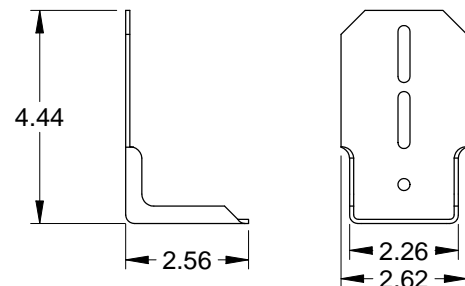

Top Fixture
.086 Galv. Steel

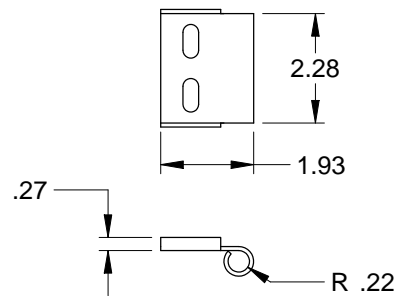

Roller Carrier
.086 Galv. Steel
Attached to Top Fixture
w/(2) Track Bolts and Whiz Nuts

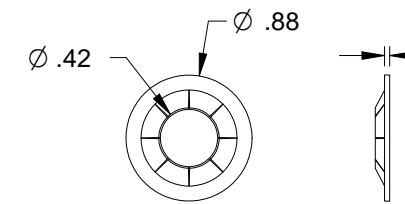

Retaining Nut

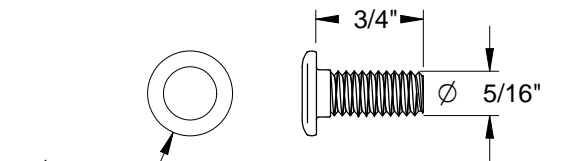

Track Bolt

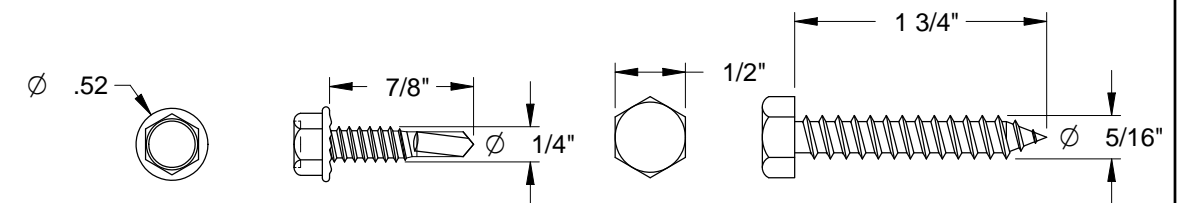

Self-Drilling Screw

Hex Head Lag Screw

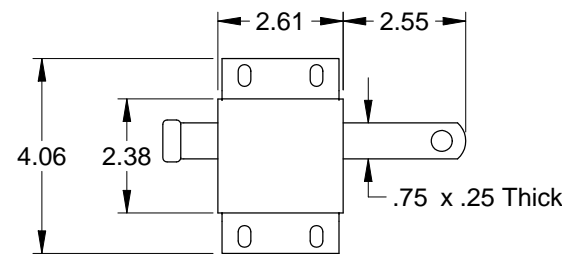

Slide Lock
Case .086 Galv. Steel

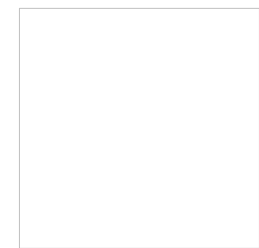

John E. Scates
2560 King Arthur Blvd, Ste 124-54
Lewisville, TX 75056
FL PE #51737
TX PE #56308-f2203

Scale: None
Drawn by: R. Frey
Checked by: G. Wedekind
Date: 01/08/19
ECO: 7679.01



1101 East River Road
Dixon, IL 61021

Title: Spec, Wind Load
AlumaView - AV200,
StyleView - CPF, WPF

No. P-2816

Sheet
3

Rev
B