

Doors tested per ANSI/DASMA 108 for static air pressure

Maximum Door Width	Colonial			Ranch			Carriage House		
	Stiles per Sect.	Hinges per Sect.	Design Loads	Stiles per Sect.	Hinges per Sect.	Design Loads	Stiles per Sect.	Hinges per Sect.	Design Loads
8'-0"	1	1	27.9 -31.5	1	1	27.9 -31.5	1	1	27.9 -31.5
	3	1	34.9 -39.5	3	1	34.9 -39.5	3	1	34.9 -39.5
9'-0"	1	1	24.8 -28.0	1	1	24.8 -28.0	1	1	24.8 -28.0
	3	1	31.0 -35.1	3	1	31.0 -35.1	3	1	31.0 -35.1
10'-0"	2	2	20.1 -22.7	3	1	20.1 -22.7	3	1	20.1 -22.7
	4	2	25.1 -28.4						

John E. Scates
 2560 King Arthur Blvd, Ste 124-54
 Lewisville, TX 75056
 FL PE #51737
 TX PE #56308-f2203

Rev.	Description	ECO	Date	ECO: 7679.01
B	Removed vent option on sheet 1.	7679.02	12/09/19	Checked by: G. Wedekind
A	New release for production.	7679.01	01/08/19	Date: 01/08/19

Scale: None
 Drawn by: R. Frey
 Checked by: G. Wedekind
 Date: 01/08/19
 ECO: 7679.01

RAYNOR
 1101 East River Road
 Dixon, IL 61021

Title: Spec, Wind Load BuildMark / TradeMark
 No. P-2803
 Sheet 1 of 3
 Rev B

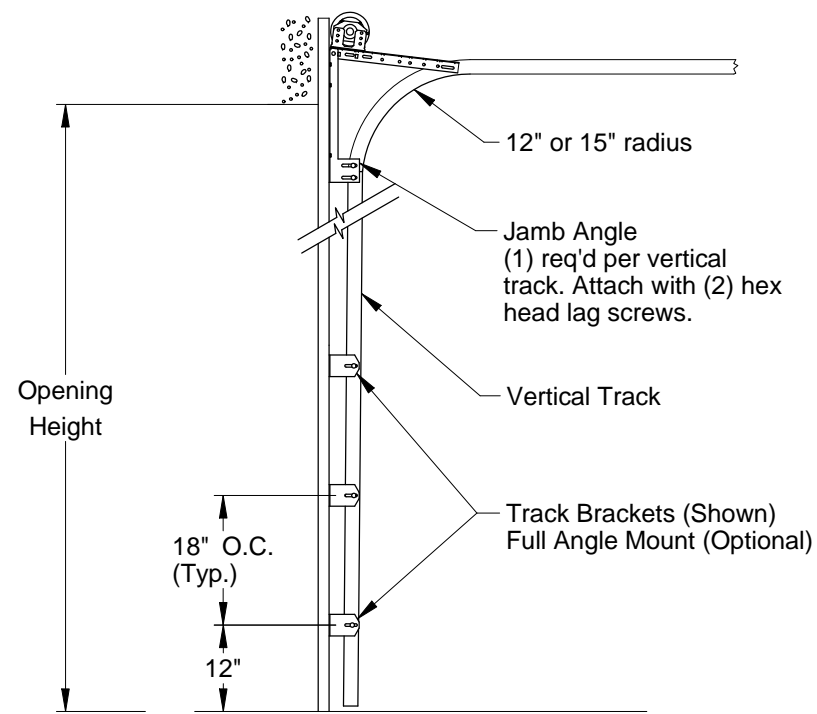

Typical Track Installation
 Normal headroom track shown, low headroom, lift clearance and vertical lift track available

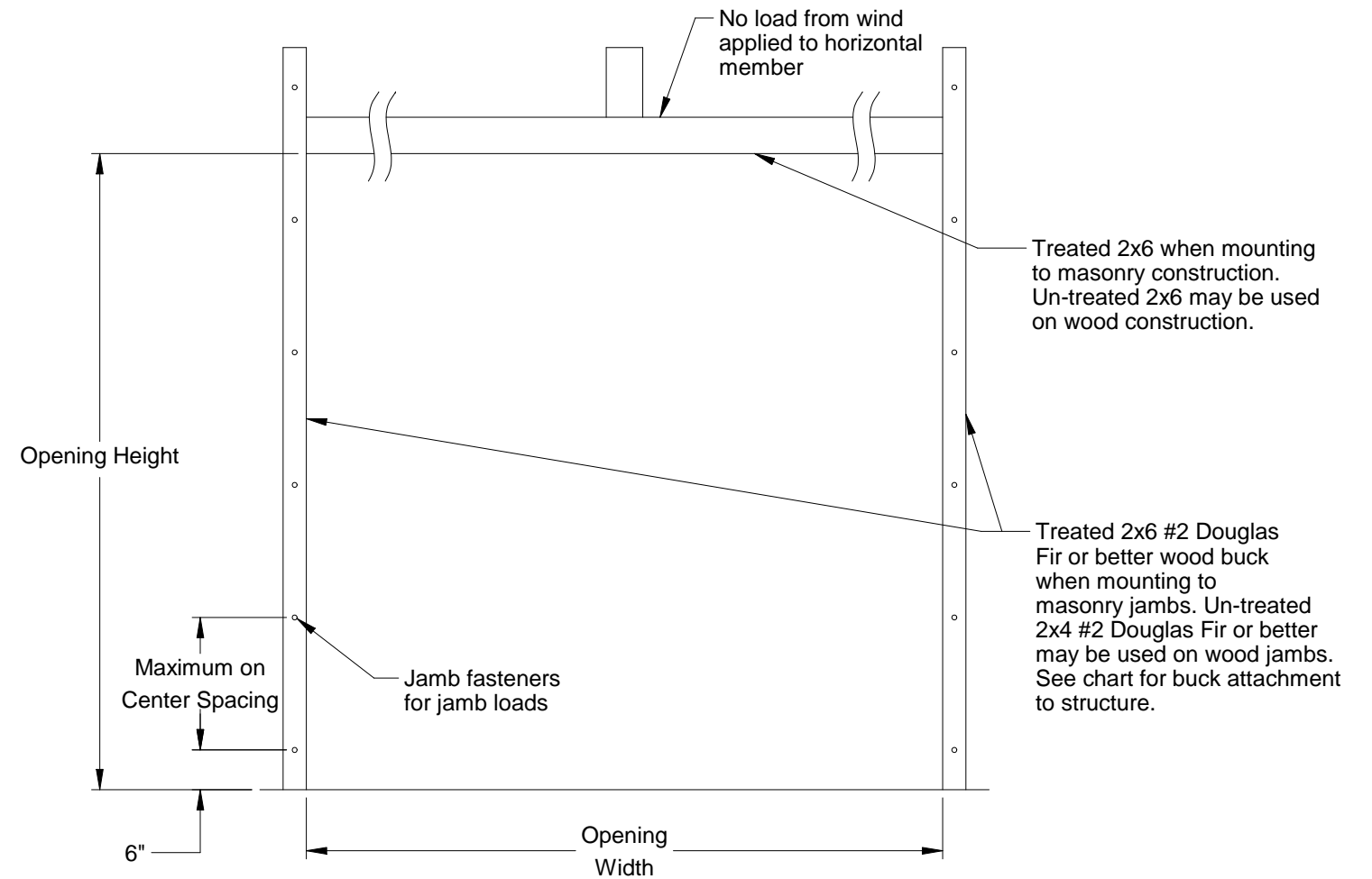

Jamb Attachment Notes:

1. Maximum Positive Load per Jamb = (9'-0" x 31.0 PSF) / 2 = 140 lbs. per foot.
2. Maximum Negative Load per Jamb = (9'-0" x -35.1 PSF) / 2 = 158 lbs. per foot.
3. Design of the supporting structure shall be the sole responsibility of the building designer and shall be designed for the jamb loads listed in notes 1 and 2.
4. Alternate jamb attachments may be used if approved by a registered Professional Engineer.
5. DASMA Technical Data Sheet TDS-161 may be used for alternate jamb attachments.
6. 3/8" diameter lag screws required 1/16" pilot hole and 1-1/2" minimum required distance.

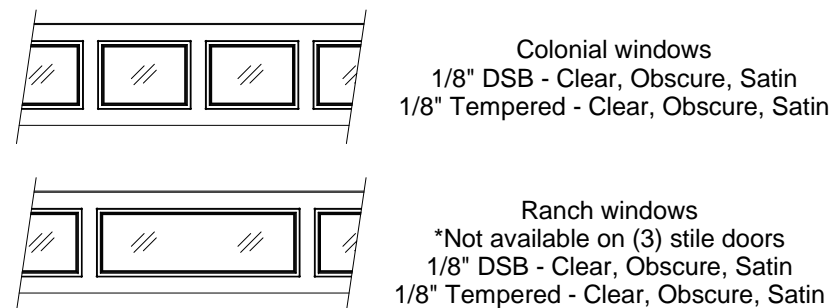

Window Options

2x6 Attachment to Structure						
Structure Type	Fastener Type	Minimum Embedment	Minimum Edge Distance	Minimum on Center Spacing	Maximum on Center Spacing	Allowable Tension Load
2500 PSI Min. Concrete	1/4" Tapcon+ (Plus) with 1-1/8" OD Washer	2"	2.5	6"	24"	526
Southern Pine	3/8" x 3" Lag with 1-1/8" OD Washer	1.50"	1.50"	1.50"	24"	655
Spruce Pine Fir	3/8" x 3" LAG with 1-1/8" OD Washer	1.50"	1.50"	1.50"	24"	482

John E. Scates
 2560 King Arthur Blvd, Ste 124-54
 Lewisville, TX 75056
 FL PE #51737
 TX PE #56308-f2203

Scale: None	 1101 East River Road Dixon, IL 61021	Title: Spec, Wind Load BuildMark / TradeMark	
Drawn by: R. Frey		No. P-2803	Sheet 2
Checked by: G. Wedekind			
Date: 01/08/19			
ECO: 7679.01			

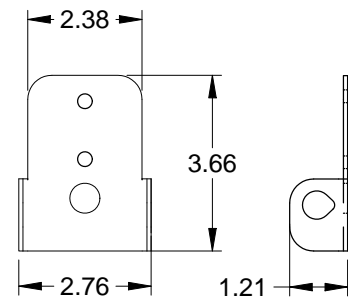

Roller Carrier
.086 Galv. Steel

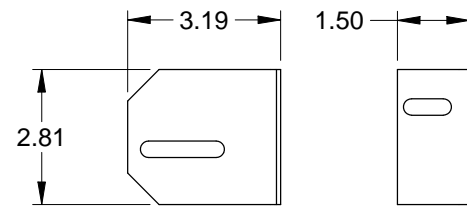

3" Track Bracket
.086 Galv. Steel

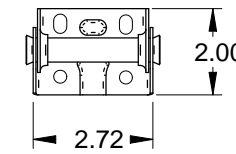

Center Hinge
.045 Galv. Steel

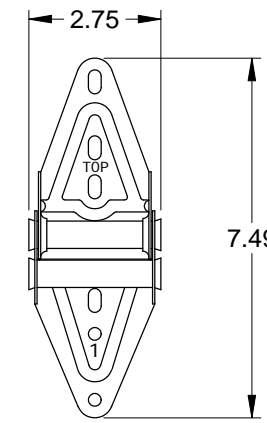

Edge Hinge
.086 Galv. Steel

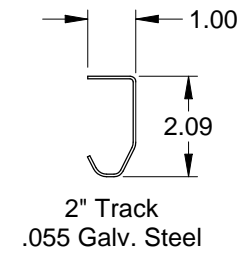

2" Track
.055 Galv. Steel

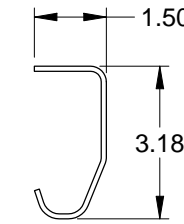

3" Track (Optional)
.105 Galv. Steel

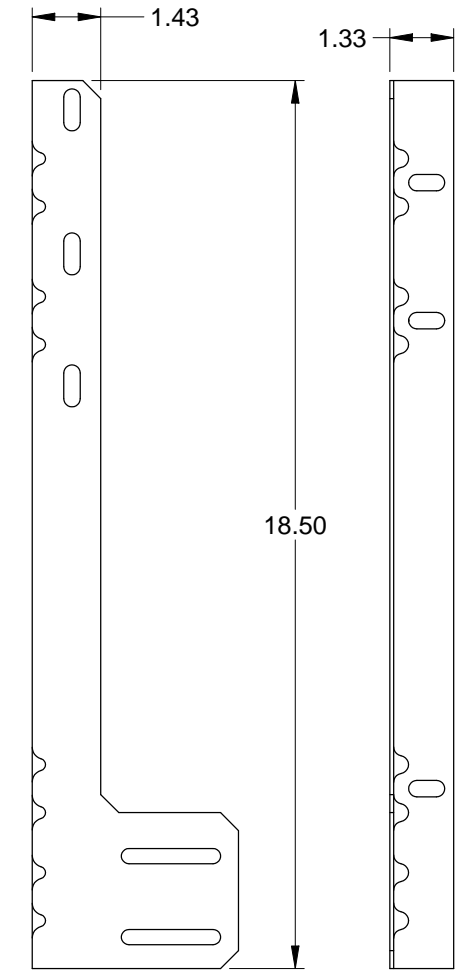

Jamb Angle
.078 Galv. Steel

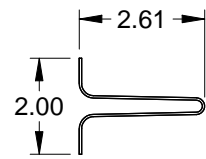

Steel U-Bar
18 Ga. (.049" min.) Galvanized
High Tensile Steel
80 KSI Minimum Yield

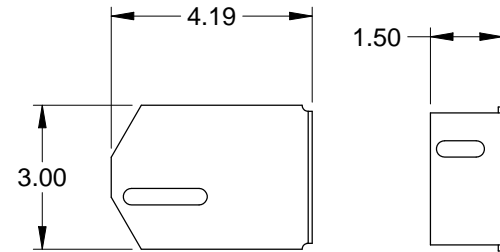

4" Track Bracket
.086 Galv. Steel

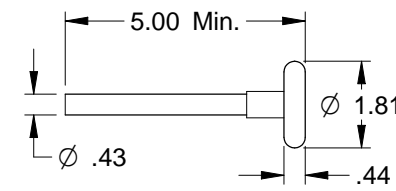

2" Roller
Nylon 11-ball (Std.)
Steel 10-ball (Opt.)

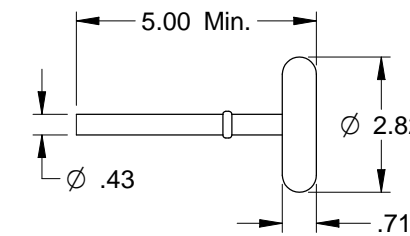

3" Roller
Steel 10-ball (Opt.)

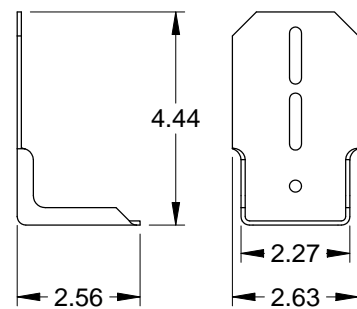

Top Fixture
.086 Galv. Steel

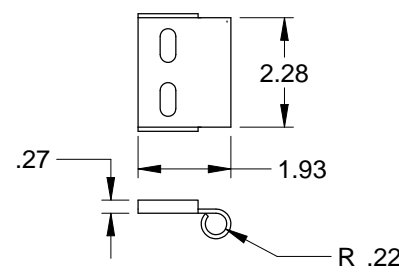

Roller Carrier
.116 Galv. Steel
Attached to Top Fixture
w/(2) Track Bolts and Whiz Nuts

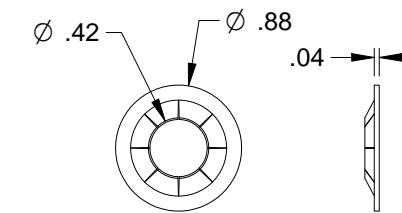

Retaining Nut

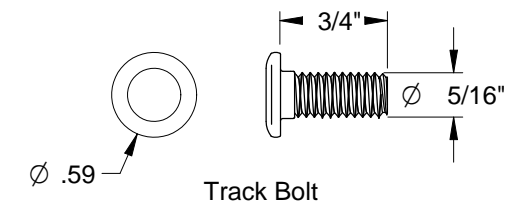

Track Bolt

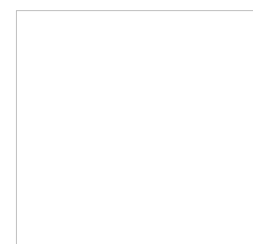

John E. Scates
2560 King Arthur Blvd, Ste 124-54
Lewisville, TX 75056
FL PE #51737
TX PE #56308-f2203

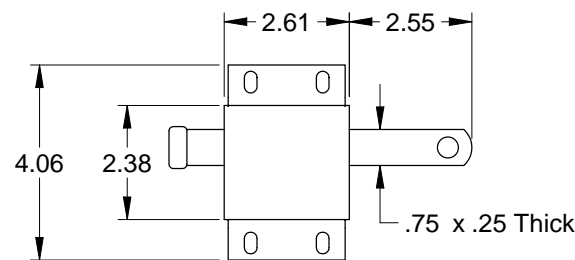

Slide Lock
Case .086 Galv. Steel

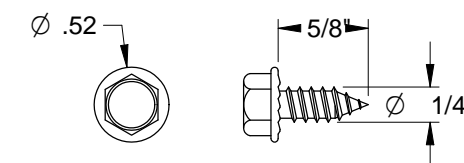

Sheet Metal Screw

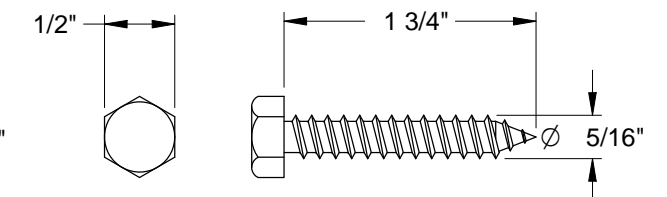

Hex Head Lag Screw

Scale: None	<p>1101 East River Road Dixon, IL 61021</p>	Title: Spec, Wind Load BuildMark / TradeMark	
Drawn by: R. Frey		No. P-2803	Sheet 3
Checked by: G. Wedekind			Rev B
Date: 01/08/19		ECO: 7679.01	